

FINAL PROOF MAP T-8968
 SW1/4SE1/4 & NE1/4SW1/4, SECTION 11
 T.39S., R.3W., W.M.
 JACKSON COUNTY, OREGON
 FOR
 LORETTA M. SHACKELFORD
 AND
 KATHLEEN L. WOODS
 1331 LITTLE APPLGATE ROAD
 JACKSONVILLE, OREGON 97530

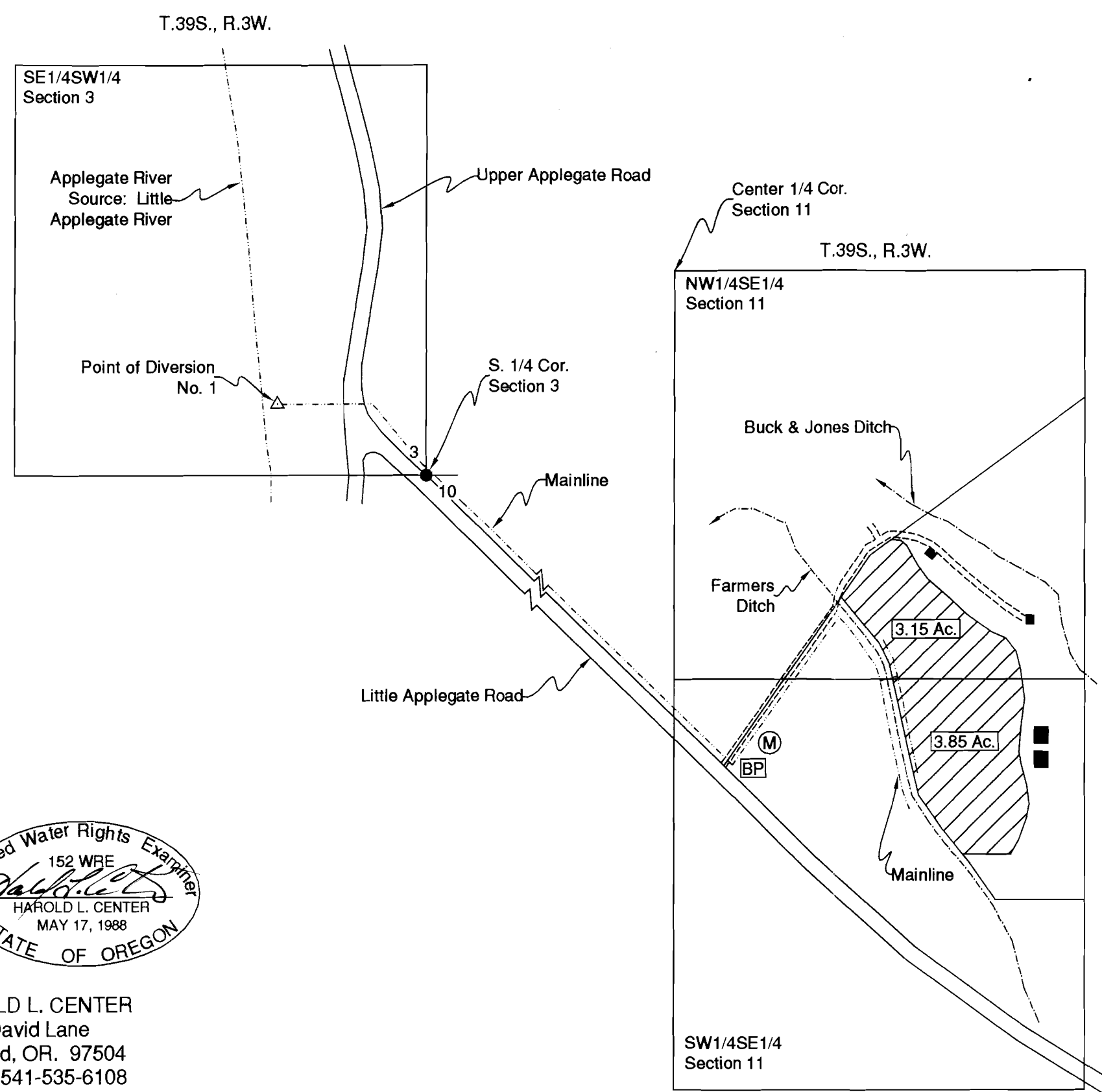

Scale: 1"=400'
 Date: August 7, 2006

LEGEND

- Found Survey Monument
- Denotes Building
- BP Denotes Booster Pump
- Ⓜ Denotes Flow Meter
- Denotes Driveway
- - - - - Denotes Mainline Pipe
- ▨ Denotes Area Under Special Order Volume 61 Pages 440-442, Priority Date: 1885

Point of Diversion No. 1 - Situated 480' West and 230' North of South One-Quarter Corner, Section 3. Fish Screen at Point of Diversion.

This map was prepared for the purpose of identifying the location of a water right only and is not intended to provide legal dimensions or location of property ownership.



HAROLD L. CENTER
 2604 David Lane
 Medford, OR. 97504
 Phone 541-535-6108
 Oregon Certificate No. 152
 Certificate Renewal Date: 12/31/2007

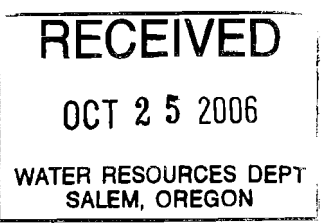

0249