

SECTION 15
T1N, R32E, WM
UMATILLA COUNTY

SW NE

1200

1873
2.6

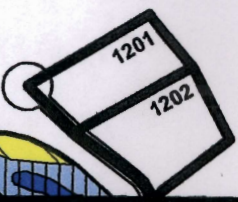

1873
4.05

1900
14.4

1889
3.35

1300 1400

1900
3.6

SE NW

NE SW

NW SE NE SE

POD 2

1889
3.3

1873
0.4

SPARKS STATION ROAD

Birch Creek

1873
0.4

1889
1.2

1900
5.5

1900
6.1

Cert 56172
Same acreage
New shape

1900
1.7

1873
0.4

POD 1

S 1/4 Corner (no monument)

SE SW

SW SE SE SE

PROPOSED CHANGES

Authorized POD/POU (Transfer FROM) shown on Transfer Map dated 31 DEC 2006. This map replaces Detail Map dated 31 DEC 2006.

Point of Diversion

POD 1 located 710 feet N and 2340 feet W from SE Corner of Section 15.

POD 2 located 2265 feet N and 3015 feet W from SE Corner of Section 15.

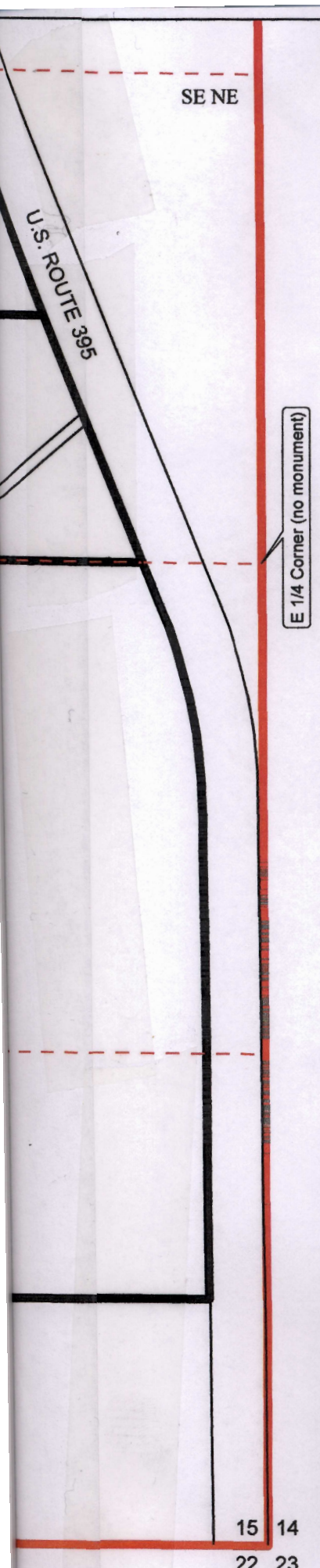

Place of Use



Cert 56171 - 1873 Priority



Cert 56171 - 1889 Priority



Cert 56171 - 1900 Priority

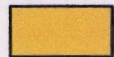

Cert 56172 - No Change in Place of Use (POD only)



Cert 84482 - 1894 Priority - Existing Supplemental Surface Water Right

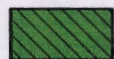

Cert 84483 - 1873 Priority - Existing Supplemental Surface Water Right



Cert 84483 - 1889 Priority - Existing Supplemental Surface Water Right



Cert 84483 - 1900 Priority - Existing Supplemental Surface Water Right



Cert 57558 - Primary Groundwater Right



Cert 84481 - Primary Groundwater Right

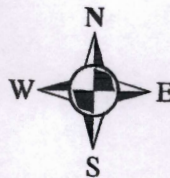

400 200 0 400 Feet



The purpose of this map is to identify the location of a water right. It is not intended to provide information regarding the location of property ownership lines.

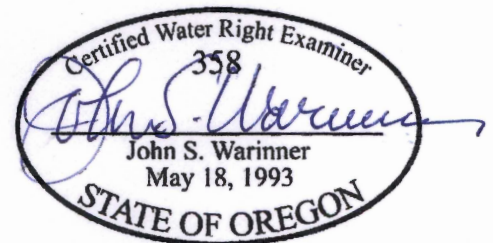

TRANSFER MAP (DETAIL) Place of Use and Point of Diversion Certificates 56171 and 56172

in the name of
PENDLETON COUNTRY CLUB

Revised: 15 NOV 2010



Fountainhead

1204 Alvarado Terrace • Walla Walla, WA 99362

15 14
22 23