

Application for Water Right Transfer

Part 1 of 4 – Minimum Requirements Checklist



Oregon Water Resources Department
 725 Summer Street NE, Suite A
 Salem, Oregon 97301-1266
 (503) 986-0900
 www.wrd.state.or.us

This transfer application will be returned if Parts 1 through 4 and all required attachments are not completed and included.
 For questions, please call (503) 986-0900, and ask for Transfer Section.

RE:
 Final
 PROOF
 #84576

FOR ALL TRANSFER APPLICATIONS

Check all items included with this application. (N/A = Not Applicable)

- Part 1 – Completed Minimum Requirements Checklist.
- Part 2 – Completed Transfer Application Map Checklist.
- Part 3 – Completed Transfer Application – Applicant Information and Signature.
- Part 4 – Completed Transfer Application – Water Right Information. Please include a separate Part 4 for each water right. List all water right certificates to be transferred here:

RECEIVED

MAR 09 2011

WATER RESOURCES DEPT
 SALEM, OREGON

Attachments:

- Completed Transfer Application Map.
- Completed Evidence of Use Affidavit and supporting documentation.
- Fees – Amount enclosed: \$ 900.
 See the Department's Fee Schedule at www.wrd.state.or.us or call (503) 986-0883.
- N/A Affidavit(s) of Consent.
- N/A Supplemental Form D – For water rights served by or issued in the name of an irrigation district. Complete when the transfer applicant is not the irrigation district.
- N/A Land Use Information Form with approval and signature (or signed land use form receipt stub). Not required if water is to be diverted, conveyed, and/or used only on federal lands or if **all** of the following apply: a) a change in place of use only, b) no structural changes, c) the use of water is for irrigation only, and d) the use is located within an irrigation district or an exclusive farm use zone.
- N/A For changes in point(s) of appropriation (well(s)) or additional point(s) of appropriation, Water Well Report/Well Log.
- N/A For Temporary Transfer (one to five years) Begin Year ____ End Year ____.
- N/A For Temporary Transfer only – Current recorded deed for the land **from** which the authorized place of use is being moved.
- N/A Temporary Drought Transfer (For use in counties where the Governor has declared drought)

(For Staff Use Only)

WE ARE RETURNING YOUR APPLICATION FOR THE FOLLOWING REASON(S):

- Application fee not enclosed/insufficient Map not included or incomplete
- Land Use Form not enclosed or incomplete
- Additional signature(s) required Part ____ is incomplete

Other/Explanation _____
 Staff: _____ 503-986-0 _____ Date: ____/____/____

T 11205

Part 2 of 4 – Transfer Application Map Checklist

Your transfer application will be returned if any of the map requirements listed below are not met.

Please be sure that the transfer application map you submit includes all the required items and matches the existing water right map. Check all boxes that apply.

- Final Proof Survey 84576*
- N/A Certified Water Right Examiner (CWRE) ~~_____~~ of CWREs, see http://www1.wrd.state.or.us/pdfs/cwre_listing.pdf. CWRE stamp and signature are not required for temporary changes and substitutions.
 - N/A If **more than three** water rights are involved, separate maps are needed for each water right.
 - Permanent quality printed with dark ink on white or clear paper or film.
 - The size of the map can be 8½ x 11 inches, 8½ x 14 inches, or up to 30 x 30 inches. For 30 x 30 inch maps, three (3) paper copies and an electronic copy in a .pdf, .tiff or .jpg format are required.
 - A north arrow, a legend, and scale.
 - The scale of the map must be: 1 inch = 400 feet, 1 inch = 1,320 feet, the scale of the Final Proof/Claim of Beneficial Use Map (the map used when the permit was certificated), the scale of the county assessor map if the scale is not smaller than 1 inch = 1,320 feet, or a scale that has been pre-approved by the Department.
 - Township, Range, Section, ¼ ¼, DLC, Government Lot, and other recognized public land survey lines.
 - Tax lot boundaries (property lines) are required. Tax lot numbers are recommended.
 - Major physical features including rivers and creeks showing direction of flow, lakes and reservoirs, roads, and railroads.
 - Major water delivery system features from the point(s) of diversion/appropriation such as main pipelines, canals, and ditches.
 - Existing place of use that includes separate hachuring for each water right, priority date, and use including number of acres in each quarter-quarter section, government lot, or in each quarter-quarter section as projected within government lots, donation land claims, or other recognized public land survey subdivisions. If less than the entirety of the water right is being changed, a separate hachuring is needed for lands left unchanged.
 - N/A Proposed place of use that includes separate hachuring for each water right, priority date, and use including number of acres in each quarter-quarter section, government lot, or in each quarter-quarter section as projected within government lots, donation land claims, or other recognized public land survey subdivisions.
 - Existing point(s) of diversion or well(s) with distance and bearing or coordinates from a recognized survey corner. This information can be found in your water right certificate or permit.
 - N/A If you are proposing a change in point(s) of diversion or well(s), show the proposed location and label it clearly with distance and bearing or coordinates. If GPS coordinates are used, latitude-longitude coordinates may be expressed as either degrees-minutes-seconds with at least one digit after the decimal (example – 42°32'15.5") or degrees-decimal with five or more digits after the decimal (example – 42.53764°).

RECEIVED
 MAR 09 2011
 WATER RESOURCES DEPT
 SALEM, OREGON

T 11205

STATE OF OREGON

COUNTY OF LANE

PERMIT TO APPROPRIATE THE PUBLIC WATERS

THIS PERMIT IS HEREBY ISSUED TO

LARRY W AND DOROTHEA M NULL
12022 E MAPLETON RD
MAPLETON, OREGON 97453

(541) 268-3840

The specific limits for the use are listed below along with conditions of use.

APPLICATION FILE NUMBER: S-73770

SOURCE OF WATER: SIUSLAW RIVER, A TRIBUTARY OF THE PACIFIC OCEAN

PURPOSE OR USE: DOMESTIC USE EXPANDED FOR THREE HOUSEHOLDS, FURTHER LIMITED TO HUMAN CONSUMPTION ONLY

RATE OF USE: 0.015 CUBIC FOOT PER SECOND (CFS) - DOMESTIC USE EXPANDED FOR THREE HOUSEHOLDS; FURTHER LIMITED TO 0.005 CFS HUMAN CONSUMPTION ONLY FOR EACH HOUSEHOLD AS LISTED BELOW

PERIOD OF ALLOWED USE: JANUARY 1 THROUGH JUNE 15 AND SEPTEMBER 16 THROUGH DECEMBER 31 FOR DOMESTIC USE EXPANDED FOR THREE HOUSEHOLDS; FURTHER LIMITED TO 0.005 CFS JUNE 16 THROUGH SEPTEMBER 15 FOR HUMAN CONSUMPTION ONLY PER HOUSEHOLD

DATE OF PRIORITY: NOVEMBER 22, 1993

POINT OF DIVERSION LOCATION: NW 1/4 SW 1/4, SECTION 23, T17S, R10W, W.M.; SOUTH 52 DEGREES 34 MINUTES 00 SECONDS EAST 1168 FEET FROM THE W 1/4 CORNER OF SECTION 23

THE PLACE OF USE IS LOCATED AS FOLLOWS:

NW 1/4 SW 1/4
SECTION 23
TOWNSHIP 17 SOUTH, RANGE 10 WEST, W.M.

RECEIVED

MAR 09 2011

WATER RESOURCES DEPT
SALEM, OREGON

Measurement recording and reporting conditions:

- 11205
- A. The Director may require the permittee to install a meter or other suitable measuring device as approved by the Director. If the Director notifies the permittee to install a meter or other measuring device, the permittee shall install such device within the period stated in the notice. Such installation period shall not be less than 90 days unless special circumstances warrant a shorter installation period. Once installed, the permittee shall maintain the meter or

Application S-73770 Water Resources Department

PERMIT 52221

CERTIFICATE #

84576

measuring device in good working order and shall allow the watermaster access to the meter or measuring device. The Director may provide an opportunity for the permittee to submit alternative measuring procedures for review and approval.

- B. The Director may require the permittee to keep and maintain a record of the amount (volume) of water used and may require the permittee to report water use on a periodic schedule as established by the Director. In addition, the Director may require the permittee to report general water use information, the periods of water use and the place and nature of use of water under the permit. The Director may provide an opportunity for the permittee to submit alternative reporting procedures for review and approval.

The permittee shall install, maintain, and operate fish screening to prevent fish from entering the proposed diversion. The permittee shall also install a fishway at the obstruction that will provide adequate upstream and downstream passage for fish. The required screens and fishways are to be in place, functional, and approved by Oregon Department of Fish and Wildlife before diversion of any water.

STANDARD CONDITIONS

The use shall conform to such reasonable rotation system as may be ordered by the proper state officer.

Failure to comply with any of the provisions of this permit may result in action including, but not limited to, restrictions on the use, civil penalties, or cancellation of the permit.

This permit is for the beneficial use of water without waste. The water user is advised that new regulations may require the use of best practical technologies or conservation practices to achieve this end.

By law, the land use associated with this water use must be in compliance with statewide land-use goals and any local acknowledged land-use plan.

The use of water allowed herein may be made only at times when sufficient water is available to satisfy all prior rights, including prior rights for maintaining instream flows.

The Director finds that the proposed use(s) of water described by this permit, as conditioned, will not impair or be detrimental to the public interest.

RECEIVED

MAR 09 2011

WATER RESOURCES DEPT
SALEM, OREGON

T 11205

Application S-73770 Water Resources Department PERMIT 5222

Actual construction work shall begin within one year from permit issuance and shall be completed on or before October 1, 1998. Complete application of the water to the use shall be made on or before October 1, 1999.

Issued May 20, 1996

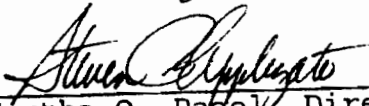
for 
Martha O. Pagel, Director
Water Resources Department

T 11205

RECEIVED

MAR 09 2011

WATER RESOURCES DEPT
SALEM, OREGON

Application S-73770 Water Resources Department
Basin 18 Volume 2, Siuslaw River & Misc.

PERMIT 52221
District 03

Certificate #
84576

RECEIVED

SEP 28 1999

23

WATER RESOURCES DEPT
SALEM, OREGON

22 23

NW 1/4-SW 1/4

NE 1/4 SW 1/4

POINT OF DIVERSION
IS SOUTH 53°14' EAST
1161 FEET FROM THE
W 1/4 CORNER OF
SEC. 23.

NOTE: AREA IRRIGATED (LESS THAN
0.5 AC PER HOUSEHOLD)

INDICATES AREA IRRIGATED.
INDICATES PIPELINE.

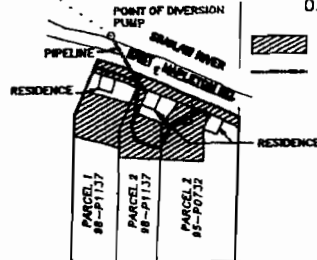

SW 1/4 SW 1/4

SE 1/4 SW 1/4

THIS MAP IS FOR THE PURPOSE
OF IDENTIFYING THE LOCATION
OF THE WATER RIGHT ONLY.
THERE IS NO INTENT TO PROVIDE
DIMENSIONS OR LOCATION OF
PROPERTY OWNERSHIP LINES.

22 23
27 26

FINAL PROOF WATER RIGHTS MAP

UNDER
PERMIT 52221

APPLICATION NO. 73770

17-10-23-3, 504
SW 1/4, SEC 23, T17S, R10W, W.M.
LANE COUNTY, OREGON

FOR: LARRY W. AND DOROTHEA NULL
12022 E. MAPLETON RD.
MAPLETON, OREGON 97439

PREPARED BY: WOBBE & ASSOCIATES, INC.
510 KINGWOOD ST. / P.O. BOX 3093
FLORENCE, OR 97139
DATE: SEPTEMBER 14, 1999



SCALE
1"=400'

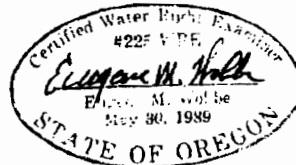

RECEIVED

MAR 09 2011

WATER RESOURCES DEPT
SALEM, OREGON

Applicant Information

APPLICANT/BUSINESS NAME <i>LARRY W. / DOROTHEA M. NULL</i>		PHONE NO. <i>541-991-6202</i>	ADDITIONAL CONTACT NO. <i>902-1415</i>
ADDRESS <i>P.O. Box 2716</i>			FAX NO.
CITY <i>FLORENCE</i>	STATE <i>OR.</i>	ZIP <i>97439</i>	E-MAIL <i>-</i>

Agent Information - The agent is authorized to represent the applicant in all matters relating to this application.

AGENT/BUSINESS NAME <i>SAME</i>		PHONE NO.	ADDITIONAL CONTACT NO.
ADDRESS			FAX NO.
CITY	STATE	ZIP	E-MAIL

If an agent is listed above, please check one of the following:

- N/A* Please send all correspondence to Agent. Send copies of correspondence to Applicant; **OR**
 Please send all correspondence to Applicant. Send copies of correspondence to Agent.

- N/A* Check this box if this project is fully or partially funded by the American Recovery and Reinvestment Act. (Federal stimulus dollars)

Is the applicant the sole owner of the land on which the water right, or portion thereof, proposed for transfer is located? Yes No *Husband/wife*

If NO, include signatures of all landowners (and mailing address if different than the applicant's) or attach affidavits of consent (and mailing addresses) from all landowners or individuals/entities to which the water right(s) has been conveyed.

Permanent Transfers Only (check one box)

- By signing this application, I understand that, upon receipt of the draft preliminary determination and prior to Department approval of the transfer, I will be required to provide landownership information and evidence that I am authorized to pursue the transfer as identified in OAR 690-380-4010(5); **OR**
 I affirm the applicant is a municipality as defined in ORS 540.510(3)(b) and that the right is in the name of the municipality or a predecessor; **OR**
 I affirm that the applicant is an entity with the authority to condemn property and is acquiring by condemnation the property to which the water right proposed for transfer is appurtenant and have supporting documentation.

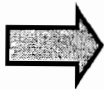

I (we) affirm that the information contained in this application is true and accurate.

Larry W. Null
Applicant signature
Dorothea M. Null
Applicant signature

LARRY W. NULL *3-2-11*
Name (and title if applicable) (print) Date
DOROTHEA M. NULL *3-2-11*
Name (and title if applicable) (print) Date

RECEIVED

MAR 09 2011

WATER RESOURCES DEPT
SALEM, OREGON

In your own words tell us what change(s) you want made and the reason for the change(s): _____

When we sold the VACANT 3AC. TO THE NOFREYS IN 2004, I OWNED THE PARCEL AND WAS USING AREA GARDENING ETC. WITH RIVER PERMITTED WATER. I THOUGHT THE PERMITTED USE FOLLOWED THE LAND AS PER OLD BOOK, LATER STATES BOOK SAYS TO THE DWELLINGS, THUS, IT IS NECESSARY TO TRANSFER THIS PARCEL TO TAX LOT #302 TO TAX LOT #400 FOR LEGAL USAGE PURPOSES.

Check the following boxes that apply:

- The applicant is responsible for completion of change(s). Notices and correspondence should continue to be sent to the applicant.
- The receiving landowner will be responsible for completing the proposed change(s) after the final order is issued. Copies of notices and correspondence should be sent to this landowner.
- The receiving landowner and applicant will be responsible for completion of change(s). Copies of notices and correspondence should be sent to this landowner and the applicant.

At this time, are the lands in this transfer application in the process of being sold? Yes No

N/A

If YES, and you know who the new landowner will be, please complete the receiving landowner information table below. If you do not know who the new landowner will be, then a request for assignment will have to be filed for at a later date.

If a property sells, the certificated water right(s) located on the land belong to the new owner, unless a sale agreement or other document states otherwise. (To learn about sale agreements please visit our web site at: <http://www1.wrd.state.or.us/pdfs/Transfer-PropertyTransactions.pdf>)

RECEIVING LANDOWNER NAME <i>BYRON L. / SUSAN NOJREY</i>		PHONE NO. <i>541-268-6925</i>	ADDITIONAL CONTACT NO.	
ADDRESS <i>12000 E. Mapleton Rd.</i>			FAX NO.	
CITY <i>Mapleton</i>	STATE <i>OR</i>	ZIP <i>97453</i>	E-MAIL	

Describe any special ownership circumstances here: _____

N/A

- Check here if any of the water rights proposed for transfer are or will be located within or served by an irrigation or other water district. (Tip: Complete and attach Supplemental Form D.)

IRRIGATION DISTRICT NAME		ADDRESS		
CITY	STATE	ZIP		

N/A

- Check here if water for any of the rights supplied under a water service agreement or other contract for stored water with a federal agency or other entity.

ENTITY NAME		ADDRESS		
CITY	STATE	ZIP		

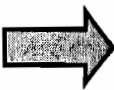

To meet State Land Use Consistency Requirements, you must list all local governments (each county, city, municipal corporation, or tribal government) within whose jurisdiction water will be diverted, conveyed or used.

ENTITY NAME <i>LANE COUNTY</i>		ADDRESS		
CITY	STATE	ZIP		

ENTITY NAME <i>—</i>		ADDRESS		
CITY <i>—</i>	STATE	ZIP		

RECEIVED
MAR 08 2011
WATER RESOURCES DEPT
SALEM, OREGON

T 11205

Part 4 of 4 – Water Right Information

Please use a separate Part 4 for each water right being changed. See instructions at <http://www.wrd.state.or.us/OWRD/PUBS/forms.shtml>.

CERTIFICATE # 84576

Description of Water Delivery System

System capacity: N/A cubic feet per second (cfs) OR
N/A gallons per minute (gpm)

Describe the current water delivery system or the system that was in place at some time within the last five years. Include information on the pumps, canals, pipelines and sprinklers used to divert, convey and apply the water at the authorized place of use. _____

Table 1. Location of Authorized and Proposed Point(s) of Diversion (POD) or Appropriation (POA)
 (Note: If the POD/POA name is not specified on the certificate, assign it a name or number here.)

POD/POA Name or Number	Is this POD/POA Authorized on the Certificate or is it Proposed?	If POA, OWRD Well Log ID# (or Well ID Tag # L-___)	Twp	Rng	Sec	¼ ¼	Tax Lot, DLC or Gov't Lot	Measured Distances (from a recognized survey corner)
<u>NULL</u> <u>No/Ref</u>	<input checked="" type="checkbox"/> Authorized <input type="checkbox"/> Proposed	<u>17-10</u> <u>17-10</u>	<u>10</u>	<u>23</u>	<u>31</u>	<u>00302</u>		
	<input type="checkbox"/> Authorized <input type="checkbox"/> Proposed							
	<input type="checkbox"/> Authorized <input type="checkbox"/> Proposed							
	<input type="checkbox"/> Authorized <input type="checkbox"/> Proposed							

Check all type(s) of change(s) proposed below (change "CODES" are provided in parentheses):

- | | |
|--|---|
| <input checked="" type="checkbox"/> Place of Use (POU) | <input type="checkbox"/> Supplemental Use to Primary Use (S to P) |
| <input type="checkbox"/> Character of Use (USE) | <input type="checkbox"/> Point of Appropriation/Well (POA) |
| <input type="checkbox"/> Point of Diversion (POD) | <input type="checkbox"/> Additional Point of Appropriation (APOA) |
| <input type="checkbox"/> Additional Point of Diversion (APOD) | <input type="checkbox"/> Substitution (SUB) |
| <input type="checkbox"/> Surface Water POD to Ground Water POA (SW/GW) | <input type="checkbox"/> Government Action POD (GOV) |

Will all of the proposed changes affect the entire water right?

- Yes Complete only the Proposed ("to" lands) section of Table 2 on the next page. Use the "CODES" listed above to describe the proposed changes.
- No Complete all of Table 2 to describe the portion of the water right to be changed.

T 11205

RECEIVED

MAR 09 2011

WATER RESOURCES DEPT
SALEM, OREGON

For Place of Use or Character of Use Changes

Are there other water right certificates, water use permits or ground water registrations associated with the "from" or the "to" lands? Yes No

If YES, list the certificate, water use permit, or ground water registration numbers: N/A

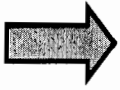

Pursuant to ORS 540.510, any "layered" water use such as an irrigation right that is supplemental to a primary right proposed for transfer must be included in the transfer or be cancelled. Any change to a ground water registration must be filed separately in a ground water registration modification application.

For Substitution (ground water supplemental irrigation will be substituted for surface water primary irrigation)

Ground water supplemental Permit or Certificate # _____;
Surface water primary Certificate # _____.

N/A

For a change from Supplemental Irrigation Use to Primary Irrigation Use

Identify the primary certificate to be cancelled. Certificate # _____

For a change in point(s) of appropriation (well(s)) or additional point(s) of appropriation:

N/A

Well log(s) are attached for each authorized and proposed well(s) that are clearly labeled and associated with the corresponding well(s) in Table 1 above and on the accompanying application map. (**Tip:** You may search for well logs on the Department's web page at: http://apps2.wrd.state.or.us/apps/gw/well_log/Default.aspx)

OR

Describe the construction of the authorized and proposed well(s) in Table 3 for any wells that do not have a well log.

Table 3. Construction of Point(s) of Appropriation N/A

Any well(s) in this listing must be clearly tied to corresponding well(s) described in Table 1 and shown on the accompanying application map. Failure to provide adequate information is likely to delay the processing of your transfer application. For proposed wells, we recommend that you consult a licensed well driller, geologist, or certified water right examiner for the proper information needed to complete the table.

Proposed or Authorized POA Name or Number	Is well already built? (Yes or No)	If an existing well, OWRD Well ID Tag No. L-___	Total well depth	Casing Diameter	Casing Intervals (feet)	Seal depth(s) (intervals)	Perforated or screened intervals (in feet)	Static water level of completed well (in feet)	Source aquifer (sand, gravel, basalt, etc.)	Well-specific rate (cfs or gpm). If less than full rate of water right
		<u>N/A</u>								

RECEIVED

MAR 09 2011

WATER RESOURCES DEPT
SALEM, OREGON

T 11205