

694

694

**FINAL PROOF SURVEY**  
 UNDER  
**APPLICATION T-6863**  
 PERMIT SPECIAL ORDER VOL 67, PG 449

IN NAME OF  
**LUCE-LONG DITCH COMPANY**  
 BY  
 ROBERT D. BAGETT  
 217 N. CANYON BLVD.  
 JOHN DAY, OR. 97846  
 DATE SURVEYED  
 MAY 30, 2012  
 MAP REVISED  
 DECEMBER 4, 2013

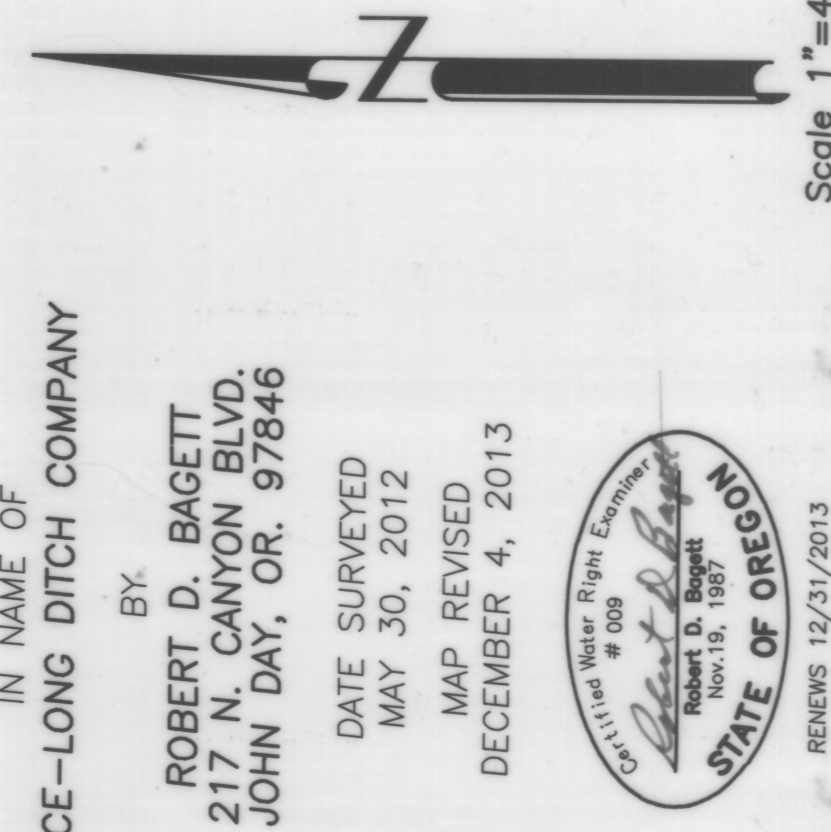

T13S  
 R30E  
 R31E  
 Scale 1"=400'  
 SHEET 2 OF 2

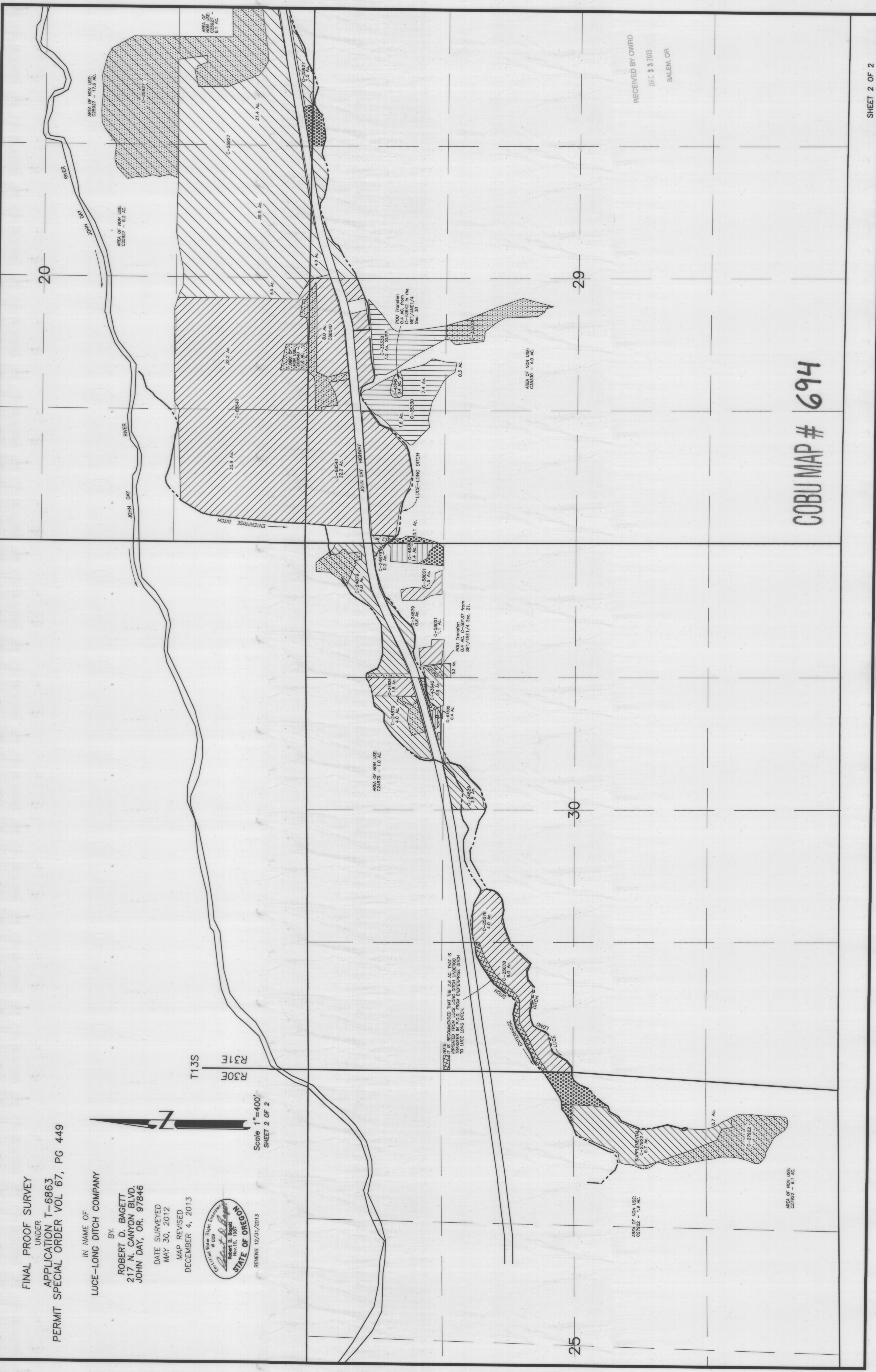

**NOTE** RECOMMENDED THAT THE 2.5 AC. SHAD IS  
 DEDICATED FROM LUCE LONG DITCH UNDERDITCH  
 TO LUCE LONG DITCH. FROM ENTERPRISE DITCH

AREA OF NON USE  
 C-24679 - 1.0 AC.

PCU Transfer:  
 C-43542 in the  
 SE 1/4 SEC 24

AREA OF NON USE  
 C-23330 - 4.0 AC.

AREA OF NON USE  
 C-23927 - 17.8 AC.

AREA OF NON USE  
 C-23927 - 5.2 AC.

AREA OF NON USE  
 C-23927 - 8.1 AC.

RECEIVED BY OWRD  
 DEC 2 2013  
 SALEM, OR

**COBU MAP # 694**