



Oregon Water Resources Department  
 725 Summer Street NE, Suite A  
 Salem Oregon 97301-1266  
 (503) 986-0900  
 www.wrd.state.or.us

Application for  
 District Permanent  
 Water Right

# Transfer

Please type or print legibly in dark ink. If your application is incomplete or inaccurate, we will return it to you. If any requested information does not apply to your application, insert "N/A" to indicate "Not Applicable." As you complete this form, please refer to notes and guidance included on the application. A summary of review criteria and procedures that are generally applicable to the application is available at [www.wrd.state.or.us/OWRD/PUBS/forms.shtml#app\\_criteria\\_review](http://www.wrd.state.or.us/OWRD/PUBS/forms.shtml#app_criteria_review).

Change in Place of Use Only

1. APPLICANT INFORMATION

District: Tualatin Valley I.D.

Address: 2330 Elm

City: Forest Grove State: OR Zip: 97116

Phone: 503-357-3118 Fax: \_\_\_\_\_ E-Mail address: joe.rutledge@tvld.org

2. PROPOSED CHANGE(S) TO WATER RIGHT(S)

- List **all** water rights to be affected by this transfer. Indicate the certificate, permit, decree or other identifying number(s) in the table below: (Attach additional pages as necessary.)

	Certificate	Permit / Previous Transfer	Decree
1.	<del>88722</del> *	N/A -	N/A
2.		-	
3.		-	
4.		-	
5.		-	
6.		-	

\* not signed

REGISTERED CLERK

OCT 01 2014

3-160X-0P

AFFIDAVIT FOR THE PARTIAL CANCELLATION OF A WATER RIGHT CERTIFICATE

RECORDED

2014

SALEM, OR

State of Oregon )

County of Washington )

) ss

I/We (or authorized agent), JAMES M LOVE, residing at 7750 NW Kansas City Rd. Forest Grove, OR 97116, telephone 503-357-2329, being first duly sworn depose and say:

1. I/We are the legal owner(s) of the property described as tax lot number 301, within the NW 1/4, Section 14, Township 1N N/S, Range 4W E/W, of the Willamette Meridian, in Washington County, Oregon, as shown on the attached map and described in the attached deed and legal description and made part of this affidavit;

2. A portion of water right certificate number 42051 issued to Melvin L Love, with a date of priority of 5/25/1966 for use of 14.2 ~~cubic foot per second~~ acre feet of water from Stored water only (source) for the purpose of Stored water only (use) is appurtenant to my/our property;

3. The appurtenant water right is/is not located within the boundaries of an irrigation, drainage, water improvement, or water control district, or federal reclamation project (if the right is located within a district or reclamation project, name it here) Tualatin Valley I.O. (Tualatin Project)

4. If the water right is issued in the name of an irrigation district then the affiant must have the concurrence of the district to the cancellation of the portion of the water right. (Signature of district manager on the line below documents consent of the district.)

Signature of district manager \_\_\_\_\_ Printed Name \_\_\_\_\_ Date \_\_\_\_\_

5. I/We have abandoned any and all interest in the portion of this water right shown on the attached map and described as follows:

The right to the use of \_\_\_\_\_ cubic foot per second from \_\_\_\_\_ for \_\_\_\_\_, and irrigation of \_\_\_\_\_ acres located:

(use) (if applicable)

1/4 1/4 Acres

1/4 1/4 Acres

1/4 1/4 Acres

Section \_\_\_\_\_

Township \_\_\_\_\_ N/S, Range \_\_\_\_\_ E/W, WM; and

6. I/We request the portion of the water right described above be canceled.

James M. Love  
Signature of legal owner as listed on deed, or authorized agent

9/22/14  
Date

\_\_\_\_\_  
Signature of legal co-owner as listed on deed  
(if applicable)

\_\_\_\_\_  
Date

Subscribed and Sworn to Before Me this 22 day of September, 2014.

Randi Slone  
Notary Public for Oregon

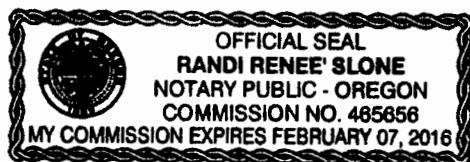

My Commission Expires February 7, 2016

PLEASE ATTACH A LEGIBLE COPY OF : 1) A DEED WHICH LISTS LAND OWNERS AND INCLUDES A LEGAL DESCRIPTION OF AFFECTED LANDS, AND 2) AN ADJUDICATION MAP, WATER RIGHT FINAL PROOF MAP, OR A TAX LOT MAP WITH THE PORTION OF THE ABANDONED RIGHT CLEARLY DRAWN AND IDENTIFIED. IF ACTING AS AN AUTHORIZED AGENT, INCLUDE COPY OF POWER OF ATTORNEY OR OTHER DOCUMENTS GRANTING AUTHORITY TO ACT ON BEHALF OF LEGAL OWNER(S) AS LISTED ON THE DEED.

RECEIVED BY OWRB



OCT 01 2014

SALEM, OR

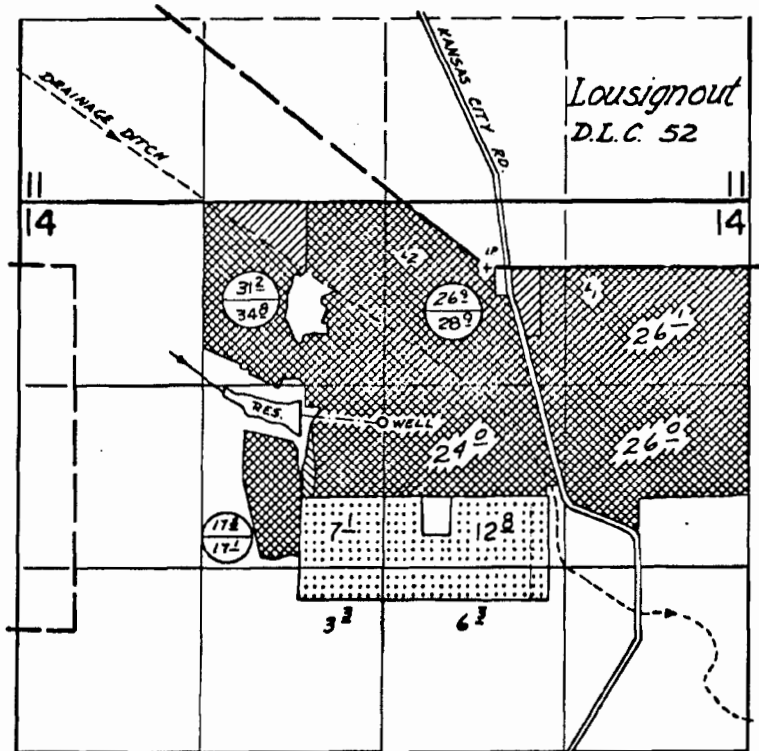
# T. 1N., R. 4W., W.M.

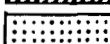

DIV. PT. LOCATED: 1070' S & 1350' W FROM S2LY SW COR. D.L.C. 52  
 WELL LOCATED: 1120' S & 790' W FROM S2LY SW COR. D.L.C. 52

-  SUPPLEMENTAL (Permit 31937)
-  SUPPLEMENTAL (Permit G-4571)
-  PRIMARY (Permit G-4571)

## FINAL PROOF SURVEY UNDER

RECEIVED BY OWNER

OCT 01 2014

SALEM, OR

R-42249                      R-4852  
 42250                         31937  
 Application No. G-4855 Permit No. G-4571  
 IN NAME OF

MELVIN L. LOVE

Surveyed June 7, 1972, by L.E. Gould

T.1N. R.4W. W.M.

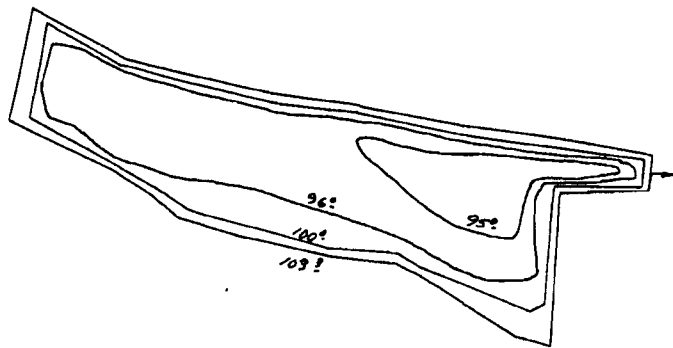

RECEIVED BY OWRD

OCT 01 2014

SALEM, OR

CAPACITY SURVEY  
1" = 200'

**FINAL PROOF SURVEY**  
UNDER

Application No. R-42249 Permit No. R-4852..  
IN NAME OF

.....  
MELVIN L. LOVE  
.....

Surveyed Sep. 3, 1974, by R. G. MUCKEN

STATE OF OREGON  
 COUNTY OF WASHINGTON  
**CERTIFICATE OF WATER RIGHT**

**This Is to Certify, That MELVIN L. LOVE** 97116  
 of **Route 1, Box 358, Forest Grove**, State of **Oregon**, has made proof  
 to the satisfaction of the STATE ENGINEER of Oregon, of a right to the use of the waters of  
**Reservoir constructed under Application No. R-42249, Permit No. R-4852**

a tributary of **Dairy Creek** for the purpose of  
**supplemental irrigation of 152.0 acres**

under Permit No. **31937** of the State Engineer, and that said right to the use of said waters  
 has been perfected in accordance with the laws of Oregon; that the priority of the right hereby  
 confirmed dates from **May 25, 1966**

that the amount of water to which such right is entitled and hereby confirmed, for the purposes  
 aforesaid, is limited to an amount actually beneficially used for said purposes, and shall not exceed  
**14.2 acre feet stored water only**

or its equivalent in case of rotation, measured at the point of diversion from the stream.  
 The point of diversion is located in the **SE $\frac{1}{4}$  NW $\frac{1}{4}$ , Section 14, T. 1 N., R. 4 W., W. M.,  
 1070 feet South and 1350 feet West from Southerly SW Corner, Lousignout DLC 52.**

The amount of water used for irrigation, together with the amount secured under any other  
 right existing for the same lands, shall be limited to **of one cubic foot per second**  
~~per acre~~, a diversion of **2 $\frac{1}{2}$  acre feet** for each acre irrigated during the irrigation  
 season of each year; provided further that the right allowed herein shall be limited  
 to any deficiency in the available supply of any prior right existing for the same  
 land and shall not exceed the limitation allowed herein,

and shall  
 conform to such reasonable rotation system as may be ordered by the proper state officer.

A description of the place of use under the right hereby confirmed, and to which such right is  
 appurtenant, is as follows:

- 26.1 acres Lot 1 (NE $\frac{1}{4}$  NE $\frac{1}{4}$ )
- 26.9 acres Lot 2 (NW $\frac{1}{4}$  NE $\frac{1}{4}$ )
- 24.0 acres SW $\frac{1}{4}$  NE $\frac{1}{4}$
- 26.0 acres SE $\frac{1}{4}$  NE $\frac{1}{4}$
- 31.2 acres NE $\frac{1}{4}$  NW $\frac{1}{4}$
- 17.8 acres SE $\frac{1}{4}$  NW $\frac{1}{4}$
- Section 14
- T. 1 N., R. 4 W., W. M.

RECEIVED BY CLWARD

OCT 01 2014

SALEM, OR

The right to the use of the water for the purposes aforesaid is restricted to the lands or place of  
 use herein described.

WITNESS the signature of the State Engineer, affixed  
 this date. **April 14, 1975**

**Chris L. Wheeler**

State Engineer

AFFIDAVIT FOR THE PARTIAL CANCELLATION OF A WATER RIGHT CERTIFICATE

RECEIVED BY OWRPD

State of Oregon )
County of Washington ) ss

OCT 01 2014

SALEM, OR

I/We (or authorized agent), James M Love, residing at 7750 NW Kansas City Rd, Forest Grove, OR 97116, telephone 503-357-2329, being first duly sworn depose and say:

1 I/We are the legal owner(s) of the property described as tax lot number 301, within the NW 1/4, Section 14, Township 1N N/S, Range 4W E/W, of the Willamette Meridian, in Washington County, Oregon, as shown on the attached map and described in the attached deed and legal description and made part of this affidavit;

2. A portion of water right certificate number 42048 issued to Melvin L Love, with a date of priority of 4/30/1969 for use of 0.24 cubic foot per second of water from Ground water well (source) for the purpose of Irrigation (use) is appurtenant to my/our property;

3. The appurtenant water right is not located within the boundaries of an irrigation, drainage, water improvement, or water control district, or federal reclamation project (if the right is located within a district or reclamation project, name it here) Tualatin Valley I.D. (Tualatin Project)

4. If the water right is issued in the name of an irrigation district then the affiant must have the concurrence of the district to the cancellation of the portion of the water right. (Signature of district manager on the line below documents consent of the district.)

Signature of district manager

Printed Name

Date

5. I/We have abandoned any and all interest in the portion of this water right shown on the attached map and described as follows:

The right to the use of cubic foot per second from for and irrigation of acres located:

(use)

(if applicable)

1/4 1/4 Acres
1/4 1/4 Acres
1/4 1/4 Acres

Section

Township N/S, Range E/W, WM; and

6. I/We request the portion of the water right described above be canceled.

Jama M. Love  
Signature of legal owner as listed on deed, or authorized agent

9/22/14  
Date

\_\_\_\_\_  
Signature of legal co-owner as listed on deed  
(if applicable)

\_\_\_\_\_  
Date

Subscribed and Sworn to Before Me this 22 day of September, 2014.

Randee Slone  
Notary Public for Oregon

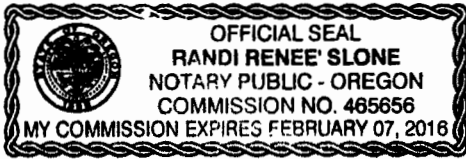

My Commission Expires February 7, 2014

**PLEASE ATTACH A LEGIBLE COPY OF :** 1) A DEED WHICH LISTS LAND OWNERS AND INCLUDES A LEGAL DESCRIPTION OF AFFECTED LANDS, AND 2) AN ADJUDICATION MAP, WATER RIGHT FINAL PROOF MAP, OR A TAX LOT MAP WITH THE PORTION OF THE ABANDONED RIGHT CLEARLY DRAWN AND IDENTIFIED. IF ACTING AS AN AUTHORIZED AGENT, INCLUDE COPY OF POWER OF ATTORNEY OR OTHER DOCUMENTS GRANTING AUTHORITY TO ACT ON BEHALF OF LEGAL OWNER(S) AS LISTED ON THE DEED.

RECEIVED BY OWRD  
OCT 03 2014  
SALEM, OR



STATE OF OREGON  
COUNTY OF WASHINGTON

CERTIFICATE OF WATER RIGHT

This Is to Certify, That MELVIN L. LOVE

97116

of Route 1, Box 358, Forest Grove, State of Oregon, has made proof to the satisfaction of the STATE ENGINEER of Oregon, of a right to the use of the waters of a well

a tributary of Dairy Creek for the purpose of irrigation of 27.3 acres and supplemental irrigation of 156.9 acres

under Permit No. G-4571 of the State Engineer, and that said right to the use of said waters has been perfected in accordance with the laws of Oregon; that the priority of the right hereby confirmed dates from April 30, 1969

that the amount of water to which such right is entitled and hereby confirmed, for the purposes aforesaid, is limited to an amount actually beneficially used for said purposes, and shall not exceed 0.24 cubic foot per second

or its equivalent in case of rotation, measured at the point of diversion from the stream. The point of diversion is located in the SW $\frac{1}{4}$  NE $\frac{1}{4}$ , Section 14, T. 1 N., R. 4 W., W. M., 1120 feet South and 740 feet West from Southerly SW Corner, Lousignout DLC 52.

The amount of water used for irrigation, together with the amount secured under any other right existing for the same lands, shall be limited to one-eightieth of one cubic foot per second per acre, or its equivalent for each acre irrigated and shall be further limited to a diversion of not to exceed 2 $\frac{1}{2}$  acre feet per acre for each acre irrigated during the irrigation season of each year; provided further that the right allowed herein shall be limited to any deficiency in the available supply of any prior right existing for the same land and shall not exceed the limitation allowed herein,

and shall conform to such reasonable rotation system as may be ordered by the proper state officer.

A description of the place of use under the right hereby confirmed, and to which such right is appurtenant, is as follows:

<u>Primary</u>	<u>Supplemental</u>	
	26.1 acres	Lot 1 (NE $\frac{1}{4}$ NE $\frac{1}{4}$ )
	28.9 acres	Lot 2 (NW $\frac{1}{4}$ NE $\frac{1}{4}$ )
11.3 acres	24.0 acres	SW $\frac{1}{4}$ NE $\frac{1}{4}$
	26.0 acres	SE $\frac{1}{4}$ NE $\frac{1}{4}$
	34.8 acres	NE $\frac{1}{4}$ NW $\frac{1}{4}$
7.1 acres	17.1 acres	SE $\frac{1}{4}$ NW $\frac{1}{4}$
3.3 acres		NE $\frac{1}{4}$ SW $\frac{1}{4}$
5.6 acres		NW $\frac{1}{4}$ SE $\frac{1}{4}$
		Section 14
		T. 1 N., R. 4 W., W. M.

RECEIVED BY CWRD

OCT 01 2014

SALEM, OR

The right to the use of the water for the purposes aforesaid is restricted to the lands or place of use herein described.

WITNESS the signature of the State Engineer, affixed this date. April 14, 1975

Chris L. Wheeler

State Engineer

RECEIVED BY CLERK



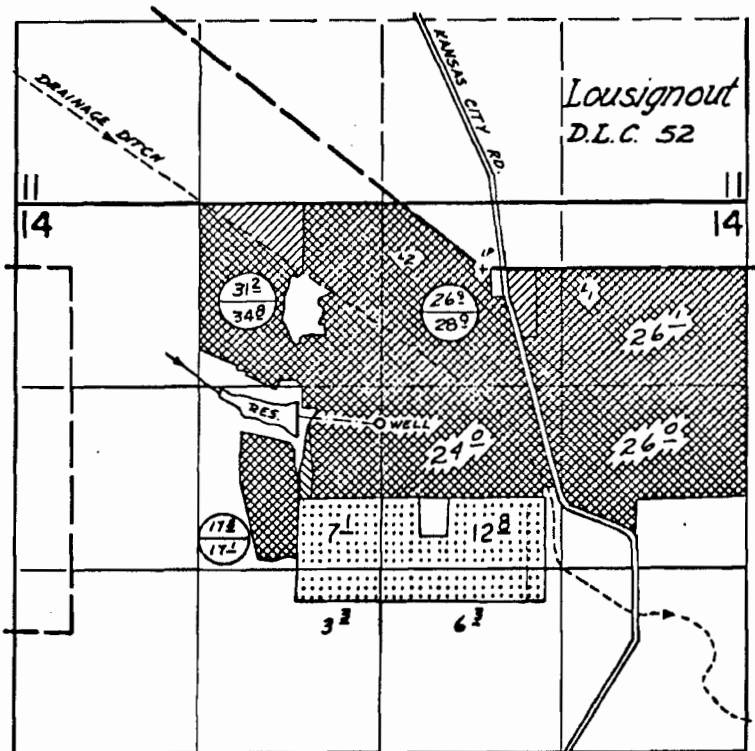

OCT 01 2014

SALEM, OR

# T.1N., R.4W., W.M.

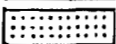

DIV. PT. LOCATED: 1070' S & 1350' W FROM S 1/4 SW COR. D.L.C. 52  
 WELL LOCATED: 1120' S & 790' W FROM S 1/4 SW COR. D.L.C. 52

-  SUPPLEMENTAL (Permit 31937) ———— 
-  SUPPLEMENTAL (Permit G-4571) ———— 
-  PRIMARY (Permit G-4571)

## FINAL PROOF SURVEY UNDER

R-42249                      R-4852  
 42250                        31937  
 Application No. G-4855 Permit No. G-4571  
 IN NAME OF

MELVIN L. LOVE

Surveyed June 7, 1972, by L.E. Gould