



Oregon Water Resources Department
 725 Summer Street NE, Suite A
 Salem Oregon 97301-1266
 (503) 986-0900
 www.wrd.state.or.us

Application for District Permanent Water Right Transfer

Please type or print legibly in dark ink. If your application is incomplete or inaccurate, we will return it to you. If any requested information does not apply to your application, insert "N/A" to indicate "Not Applicable." As you complete this form, please refer to notes and guidance included on the application. A summary of review criteria and procedures that are generally applicable to the application is available at www.wrd.state.or.us/OWRD/PUBS/forms.shtml#app_criteria_review.

Change in Place of Use Only

1. APPLICANT INFORMATION

District: Rogue River Valley Irrigation District

Address: 3139 Merriman Rd.

City: Medford

State: OR

Zip: 97501

Phone: 541-773-3127

Fax: 541-773-5420

E-Mail address: rrvid@rrvid.org

2. PROPOSED CHANGE(S) TO WATER RIGHT(S)

- List **all** water rights to be affected by this transfer. Indicate the certificate, permit, decree or other identifying number(s) in the table below: *(Attach additional pages as necessary.)*

	Certificate	Permit / Previous Transfer	Decree
1.	85288	-	
2.	85876	-	
3.	85877	-	
4.	80576	-	
5.		-	
6.		-	

RECEIVED BY OWRD

DEC 19 2014

SALEM, OR

EXHIBIT 1
POINT OF DIVERSION

POD #	CERTIFICATE	PERMIT # PERFECTED UNDER	POINT OF DIVERSION	USE
1	85288	E-19	North & South Forks of the Little Butte Ck. & Bradshaw Drop	Primary (9,048.20)/Supplemental (705.20) 1/100 th of one CFS per second or it's equivalent
2	85714	Old Certificate 17213	North & South Forks of the Little Butte Ck	Primary Irrigation 1 CFS to 140 acres
3	85286	Old Certificate 17213	North & South Forks of the Little Butte Ck	Primary Irrigation 1 CFS to 140 acres
4	85876	R-50	Four Mile, Fish Lake Reservoir, North Fork Little Butte Ck. & Bradshaw Drop	Supplemental Irrigation
5	85877	1705	Hopkins Canal	Supplemental Irrigation
6	80573	R-50	Four Mile Lake, Fish Lake Dam, North Fork Little Butte Ck. Bradshaw Drop	Manufacturing and Domestic Uses
7	80575	1706	Bear Creek Diversion 37-1W-30 NENW	Supplemental Irrigation
8	80576	R-4563 & R-6175	Agate Dam on Dry Ck.	Supplemental Irrigation
9	80577	2993	Griffin Creek & Jackson Ck. into Hopkins Canal	Supplemental Irrigation
10	86489	407	North & South Forks of the Little Butte Ck.	Manufacturing & Domestic Uses
11	83729	25915	Conde Ck. Dead Indian Ck., Daley Ck./Beaver Dam Ck., South Fork Little Butte Ck., Howard Prairie Dam	Supplemental Irrigation
12	79912	R-4563 & R-6175	Agate Dam on Dry Ck., Antelope Ck., North & South Fork Little Butte Ck. and Agate reservoir	Supplemental Irrigation
13	79911	407	Four Mile Dam and Fish Lake Reservoir	Irrigation, Domestic, Municipal and Manufacturing
14		4951	Lake Osborne, Yankee, Antelope, Dry, Bear, Anderson, Coleman, Griffin, Jackson, Horn, Willow, Little Butte Cks., Bradshaw Drop, Little Butte Canal, Hopkins Canal, Phoenix Canal, Bear Creek Canal, Junction Canal, Oakleigh Canal.	Supplemental Irrigation

RECEIVED BY OWRD
DEC 19 2014
SALEM, OR

DEC 19 2014

SALEM, OR

TABLE 1

WATER RIGHT		LEGAL DESCRIPTION													USER NAME	
PRI	SUP	PRI DATE	USE	POD	TWP	RNG	SEC	QQ	DLC	GLOT	TL	AC-P	AC-S	NOTICE #	USER NAME	
85288		7/23/1909	IRR	1	36	1W	29	SE NW			3000	0.50	0.50	14-01	Rogue River Valley Irrigation Dist. (RRVID)	
	80576	9/6/1915	IRR	8	36	1W	29	SE NW			3000		0.50	14-01	"	
	85876	3/31/1910	IRR	4	36	1W	29	SE NW			3000		0.50	14-01	"	
	85877	6/24/1913	IRR	5	36	1W	29	SE NW			3000		0.50	14-01	"	
85288		7/23/1909	IRR	1	36	2W	35	NE SE			400	1.70	1.70	14-01	RRVID	
	80576	9/6/1915	IRR	8	36	2W	35	NE SE			400		1.70	14-01	"	
	85876	3/31/1910	IRR	4	36	2W	35	NE SE			400		1.70	14-01	"	
	85877	6/24/1913	IRR	5	36	2W	35	NE SE			400		1.70	14-01	"	
85288		7/23/1909	IRR	1	36	2W	35	NW SE			2602	0.20	0.20	14-01	RRVID	
	80576	9/6/1915	IRR	8	36	2W	35	NW SE			2602		0.20	14-01	"	
	85876	3/31/1910	IRR	4	36	2W	35	NW SE			2602		0.20	14-01	"	
	85877	6/24/1913	IRR	5	36	2W	35	NW SE			2602		0.20	14-01	"	
85288		7/23/1909	IRR	1	36	2W	35	NE SE			1300	0.80	0.80	14-01	RRVID	
	80576	9/6/1915	IRR	8	36	2W	35	NE SE			1300		0.80	14-01	"	
	85876	3/31/1910	IRR	4	36	2W	35	NE SE			1300		0.80	14-01	"	
	85877	6/24/1913	IRR	5	36	2W	35	NE SE			1300		0.80	14-01	"	
85288		7/23/1909	IRR	1	36	1W	31	SE SW			3400	2.00	2.00	14-01	RRVID	
	80576	9/6/1915	IRR	8	36	1W	31	SE SW			3400		2.00	14-01	"	
	85876	3/31/1910	IRR	4	36	1W	31	SE SW			3400		2.00	14-01	"	
	85877	6/24/1913	IRR	5	36	1W	31	SE SW			3400		2.00	14-01	"	
85288		7/23/1909	IRR	1	37	2W	01	SE NW			2600	2.60	2.60	14-01	RRVID	
	80576	9/6/1915	IRR	8	37	2W	01	SE NW			2600		2.60	14-01	"	
	85876	3/31/1910	IRR	4	37	2W	01	SE NW			2600		2.60	14-01	"	
	85877	6/24/1913	IRR	5	37	2W	01	SE NW			2600		2.60	14-01	"	
85288		7/23/1909	IRR	1	37	2W	01	NE NW			2600	2.00	2.00	14-01	RRVID	
	80576	9/6/1915	IRR	8	37	2W	01	NE NW			2600		2.00	14-01	"	
	85876	3/31/1910	IRR	4	37	2W	01	NE NW			2600		2.00	14-01	"	
	85877	6/24/1913	IRR	5	37	2W	01	NE NW			2600		2.00	14-01	"	
85288		7/23/1909	IRR	1	36	1W	28	NE NE			200	3.10	3.10	14-01	RRVID	
	80576	9/6/1915	IRR	8	36	1W	28	NE NE			200		3.10	14-01	"	
	85876	3/31/1910	IRR	4	36	1W	28	NE NE			200		3.10	14-01	"	
	85877	6/24/1913	IRR	5	36	1W	28	NE NE			200		3.10	14-01	"	
85288		7/23/1909	IRR	1	37	2W	01	SW NE			1400	0.20	0.20	14-01	RRVID	
	80576	9/6/1915	IRR	8	37	2W	01	SW NE			1400		0.20	14-01	"	
	85876	3/31/1910	IRR	4	37	2W	01	SW NE			1400		0.20	14-01	"	
	85877	6/24/1913	IRR	5	37	2W	01	SW NE			1400		0.20	14-01	"	
85288		7/23/1909	IRR	1	37	1W	05	SW SW			1600	4.90	4.90	14-01	RRVID	
	80576	9/6/1915	IRR	8	37	1W	05	SW SW			1600		4.90	14-01	"	
	85876	3/31/1910	IRR	4	37	1W	05	SW SW			1600		4.90	14-01	"	
	85877	6/24/1913	IRR	5	37	1W	05	SW SW			1600		4.90	14-01	"	
85288		7/23/1909	IRR	1	36	2W	36	SE NW			2104	0.90	0.90	14-01	RRVID	
	80576	9/6/1915	IRR	8	36	2W	36	SE NW			2104		0.90	14-01	"	
	85876	3/31/1910	IRR	4	36	2W	36	SE NW			2104		0.90	14-01	"	
	85877	6/24/1913	IRR	5	36	2W	36	SE NW			2104		0.90	14-01	"	
85288		7/23/1909	IRR	1	37	1W	18	SE SW			3200	0.10	0.10	14-01	RRVID	
	80576	9/6/1915	IRR	8	37	1W	18	SE SW			3200		0.10	14-01	"	
	85876	3/31/1910	IRR	4	37	1W	18	SE SW			3200		0.10	14-01	"	
	85877	6/24/1913	IRR	5	37	1W	18	SE SW			3200		0.10	14-01	"	

TABLE 1

WATER RIGHT		TABLE 1 - AUTHORIZED PLACE OF USE											USER NAME			
PRI	SUP	PRI DATE	USE	POD	TWP	RNG	SEC	SEC	QQ	DLC	GLOT	TL	AC-P	AC-S	NOTICE #	USER NAME
LEGAL DESCRIPTION																
85288		7/23/1909	IRR	1	36	2W	36		NW SE			102	11.30		14-02	RRVID
	80576	9/6/1915	IRR	8	36	2W	36		NW SE			102	11.30		14-02	"
	85876	3/31/1910	IRR	4	36	2W	36		NW SE			102	11.30		14-02	"
	85877	6/24/1913	IRR	5	36	2W	36		NW SE			102	11.30		14-02	"
85288		7/23/1909	IRR	1	36	2W	36		NE SE			102	1.50		14-02	"
	80576	9/6/1915	IRR	8	36	2W	36		NE SE			102	1.50		14-02	"
	85876	3/31/1910	IRR	4	36	2W	36		NE SE			102	1.50		14-02	"
	85877	6/24/1913	IRR	5	36	2W	36		NE SE			102	1.50		14-02	"
													TOTAL ACREAGE	31.80		

RECEIVED BY OWRD

DEC 19 2014

SALEM, OR

TABLE 2

WATER RIGHT		TABLE 2 - PROPOSED PLACE OF USE												USER NAME		
PRI	SUP	PRI DATE	USE	POD	TWP	RNG	SEC	QO	DLC	GLOT	TL	AC-P	AC-S		NOTICE #	
		LEGAL DESCRIPTION														
85288		7/23/1909	IRR	1	36	2W	27	SE SE				2002	0.60		14-01	Horton, Ronald & Christine
	80576	9/6/1915	IRR	8	36	2W	27	SE SE				2002		0.60	14-01	"
	85876	3/31/1910	IRR	4	36	2W	27	SE SE				2002		0.60	14-01	"
	85877	6/24/1913	IRR	5	36	2W	27	SE SE				2002		0.60	14-01	"
85288		7/23/1909	IRR	1	36	2W	26	SW SW				2002	15.50		14-01	"
	80576	9/6/1915	IRR	8	36	2W	26	SW SW				2002		15.50	14-01	"
	85876	3/31/1910	IRR	4	36	2W	26	SW SW				2002		15.50	14-01	"
	85877	6/24/1913	IRR	5	36	2W	26	SW SW				2002		15.50	14-01	"
85288		7/23/1909	IRR	1	36	2W	26	SE SW				2002	2.90		14-01	"
	80576	9/6/1915	IRR	8	36	2W	26	SE SW				2002		2.90	14-01	"
	85876	3/31/1910	IRR	4	36	2W	26	SE SW				2002		2.90	14-01	"
	85877	6/24/1913	IRR	5	36	2W	26	SE SW				2002		2.90	14-01	"
85288		7/23/1909	IRR	1	36	2W	34	SE SE				600	1.31		14-02	Jackson County
	80576	9/6/1915	IRR	8	36	2W	34	SE SE				600		1.31	14-02	"
	85876	3/31/1910	IRR	4	36	2W	34	SE SE				600		1.31	14-02	"
	85877	6/24/1913	IRR	5	36	2W	34	SE SE				600		1.31	14-02	"
85288		7/23/1909	IRR	1	37	2W	03	NE NE				600	2.03		14-02	"
	80576	9/6/1915	IRR	8	37	2W	03	NE NE				600		2.03	14-02	"
	85876	3/31/1910	IRR	4	37	2W	03	NE NE				600		2.03	14-02	"
	85877	6/24/1913	IRR	5	37	2W	03	NE NE				600		2.03	14-02	"
85288		7/23/1909	IRR	1	36	2W	35	SW SW				600	4.99		14-02	"
	80576	9/6/1915	IRR	8	36	2W	35	SW SW				600		4.99	14-02	"
	85876	3/31/1910	IRR	4	36	2W	35	SW SW				600		4.99	14-02	"
	85877	6/24/1913	IRR	5	36	2W	35	SW SW				600		4.99	14-02	"
85288		7/23/1909	IRR	1	37	2W	02	NW NW				600	4.23		14-02	"
	80576	9/6/1915	IRR	8	37	2W	02	NW NW				600		4.23	14-02	"
	85876	3/31/1910	IRR	4	37	2W	02	NW NW				600		4.23	14-02	"
	85877	6/24/1913	IRR	5	37	2W	02	NW NW				600		4.23	14-02	"
85288		7/23/1909	IRR	1	37	2W	02	NE NW				600	0.24		14-02	"
	80576	9/6/1915	IRR	8	37	2W	02	NE NW				600		.24	14-02	"
	85876	3/31/1910	IRR	4	37	2W	02	NE NW				600		.24	14-02	"
	85877	6/24/1913	IRR	5	37	2W	02	NE NW				600		.24	14-02	"
												TOTAL ACRES	31.80			

RECEIVED BY OWRD

DEC 19 2014

SALEM, OR

3. ATTACHMENTS

Check each of the following attachments included with this application.
The application will be returned if all required attachments are not included.

<p>Supplemental Form A – Description of Proposed Change(s) to a Water Right</p> <p><input checked="" type="checkbox"/> A <u>separate</u> Supplemental Form A is enclosed for <u>each</u> water right to be affected by this transfer.</p> <p>Map</p> <p><input checked="" type="checkbox"/> Permanent Transfer A map meeting the requirements of OAR 690-385-3300 must be included but need not be prepared by a Certified Water Right Examiner (CWRE).</p>	<p>Fees:</p> <p><input checked="" type="checkbox"/> Amount enclosed: <u>\$2,350.00</u> See the Department's Fee Schedule at www.wrd.state.or.us or call (503) 986-0900.</p>
------------------------------------------------------------------------------------------------------------------------------------------------------------------------------------------------------------------------------------------------------------------------------------------------------------------------------------------------------------------------------------------------------------------------------------------------------------------------------------------	---------------------------------------------------------------------------------------------------------------------------------------------------------------------------------------------------------------------------------

4. SIGNATURES

The district certifies the following:

- (1) The water rights proposed for transfer are water rights subject to transfer and are not subject to forfeiture for nonuse under ORS 540.610;
- (2) Each user affected by the proposed transfer has provided written authorization for the transfer and such authorization is on file with the district; and
- (3) On behalf of the district, I affirm to the best of my knowledge the information contained in this application is true and accurate.

District Manager signature

name (print)

date

OR

Authorized District Representative signature

June Condie
name (print)

12/13/14
date

Before submitting your application to the Department, be sure you have:

- Answered each question completely.
- Included all the required attachments.
- Included a check payable to the Oregon Water Resources Department for the appropriate amount.

RECEIVED BY OWRD

DEC 19 2014

SALEM, OR

Rogue River Valley Irrigation District Water Rights Transfer Map

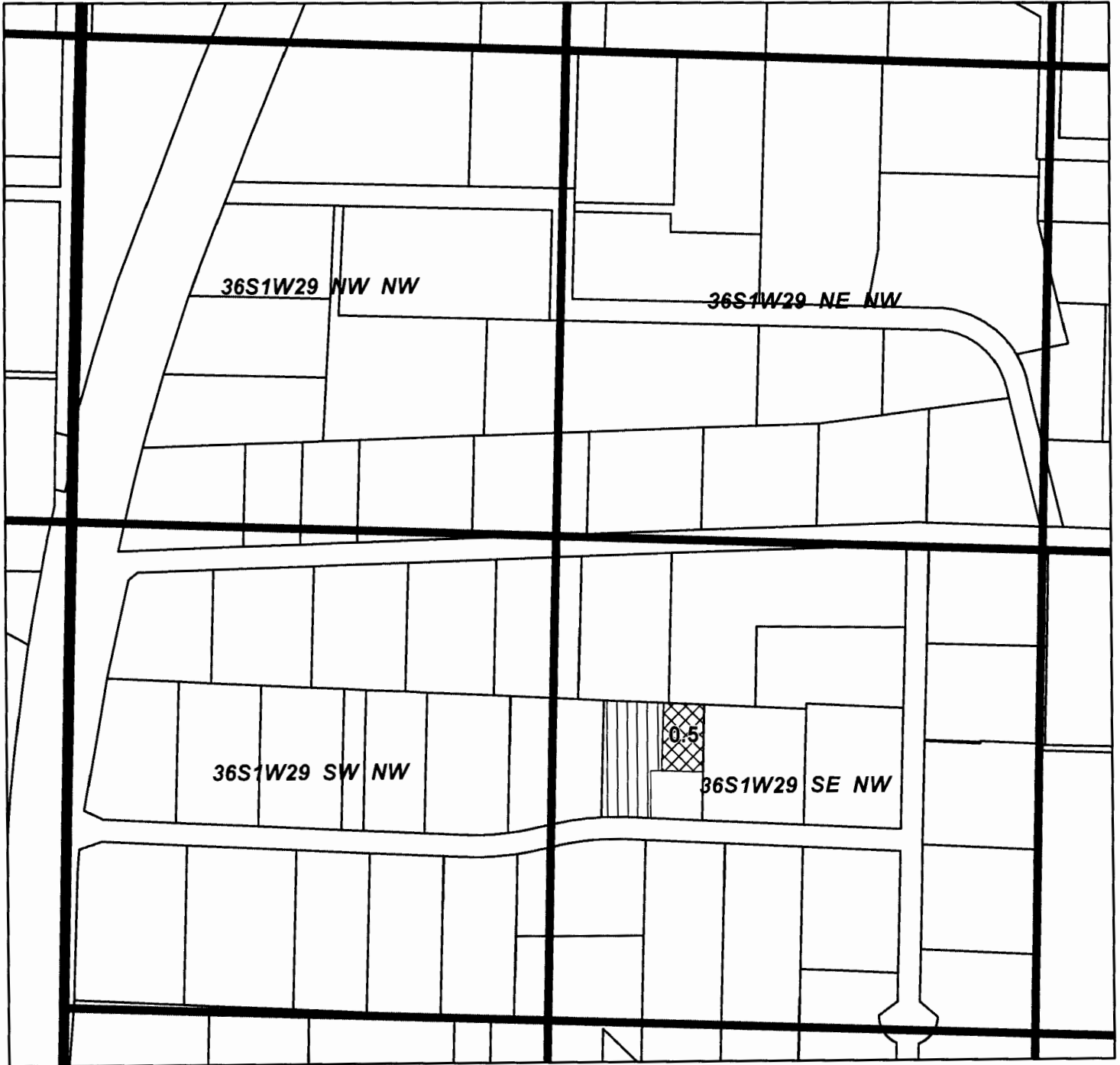





Located in SE 1/4 NW 1/4 SEC 29 T.36S. R.1 W.1M
Tax Lot T36S R1W 29B 3000 - 0.5 ac

RECEIVED BY OWRD
DEC 19 2014

From: RRVID

Certificates
P85288
S80576
S85876
S85877

SALEM, OR

-  Transfer Off
-  Prior Transfer
-  Qtr-Qtr
-  Tax Lot Line



0 200 400 800 Feet

Rogue River Valley Irrigation District Water Rights Transfer Map

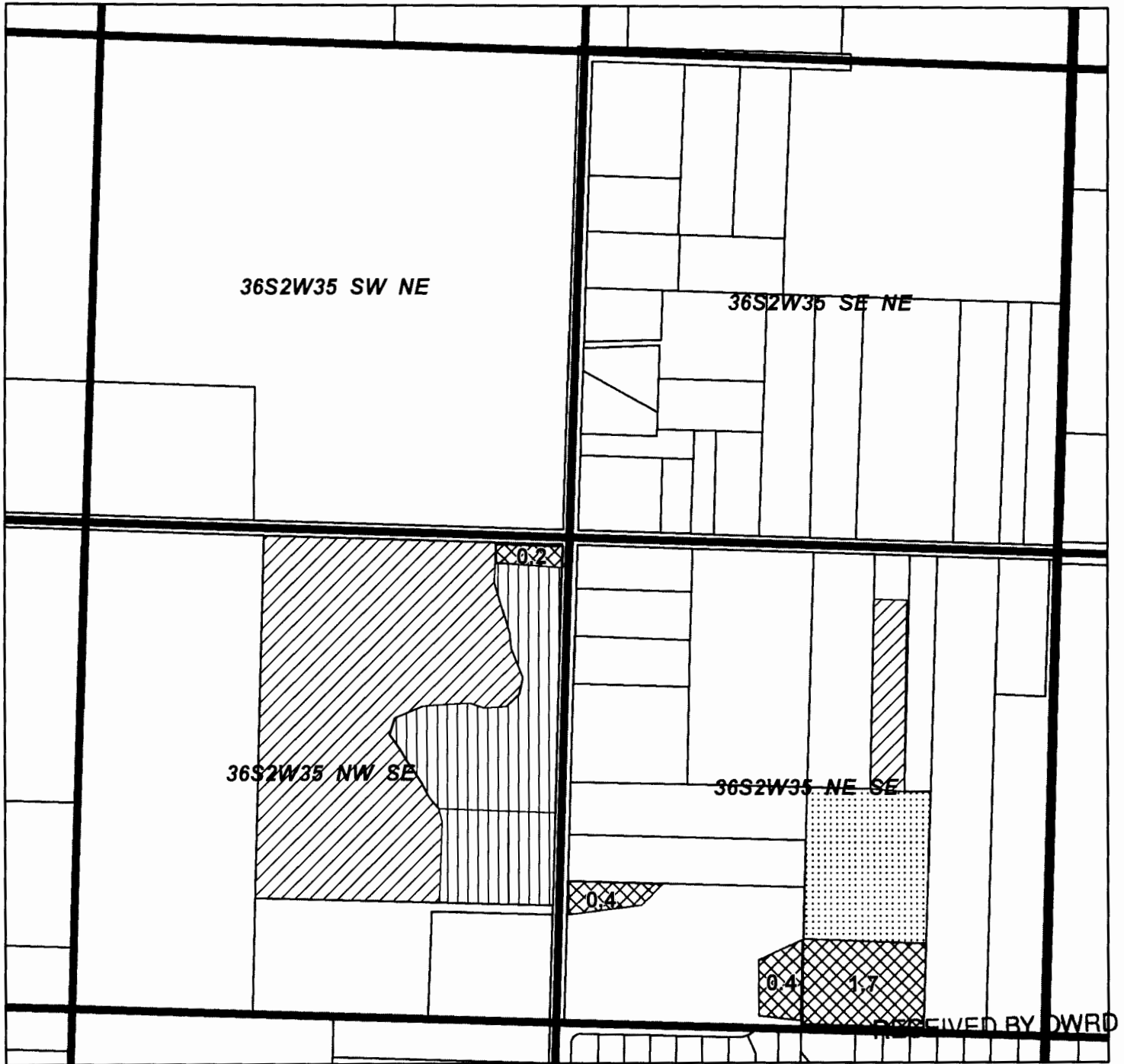

Located in NW 1/4 SE 1/4 SEC 35 T.36S. R.2 W.W.M.
Tax Lot T36S R2W 35D 2602 - 0.2 ac

DEC 19 2014

Located in NE 1/4 SE 1/4 SEC 35 T.36S. R.2 W.W.M.
Tax Lot T36S R2W 35D 1300 - 0.8 ac

SALEM, OR

Located in NE 1/4 SE 1/4 SEC 35 T.36S. R.2 W.W.M.
Tax Lot T36S R2W 35D 400 - 1.7 ac

From: RRVID

Certificates
P85288
S80576
S85876
S85877

RRVID #14-01

- Transfer Off
- Leased
- Remaining Water
- Prior Transfer
- Qtr-Qtr
- Tax Lot Line

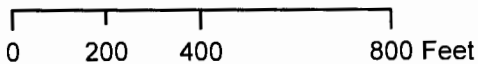

Rogue River Valley Irrigation District Water Rights Transfer Map



Located in SE 1/4 SW 1/4 SEC 31 T.36S. R.1 W.W.M. RECEIVED BY OWRD
Tax Lot T36S R1W 31C 3400 - 2.0 ac

DEC 19 2014

SALEM, OR

From: RRVID

Certificates
P85288
S80576
S85876
S85877

- Transfer Off
- Remaining Water
- Qtr-Qtr
- Tax Lot Line

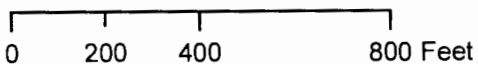

Rogue River Valley Irrigation District Water Rights Transfer Map

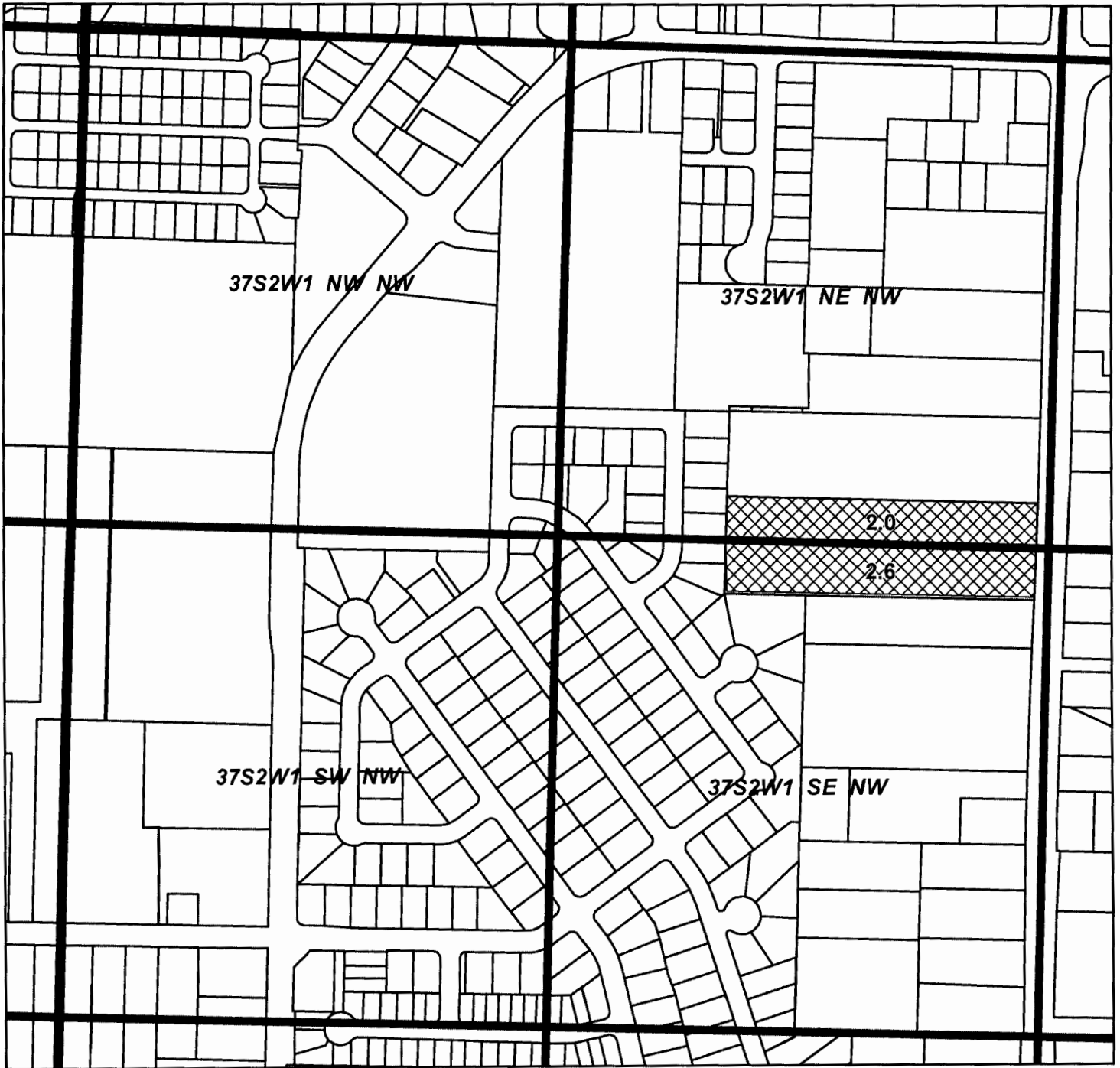

Located in NE 1/4 NW 1/4 SEC 01 T.37S. R.2 W.W.M.
Tax Lot T37S R2W 01BA 2600 - 2.0 ac

RECEIVED BY OWRD



Located in SE 1/4 NW 1/4 SEC 01 T.37S. R.2 W.W.M.
Tax Lot T37S R2W 01BA 2600 - 2.6 ac

DEC 19 2014

SALEM, OR

From: RRVID

- Certificates
- P85288
- S80576
- S85876
- S85877

-  Transfer Off
-  Qtr-Qtr
-  Tax Lot Line

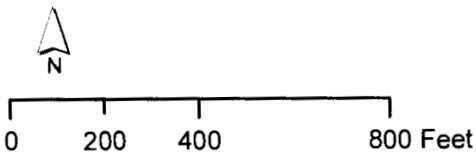

Rogue River Valley Irrigation District Water Rights Transfer Map



Located in NE 1/4 NE 1/4 SEC 28 T.36S. R.1 W.W.M.
Tax Lot T36S R1W 28A 200 - 3.1 ac

RECEIVED BY OWRD

DEC 19 2014

SALEM, OR

From: RRVID

- Certificates
- P85288
- S80576
- S85876
- S85877

- Transfer Off
- Remaining Water
- Qtr-Qtr
- Tax Lot Line

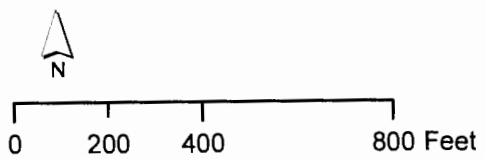

Rogue River Valley Irrigation District Water Rights Transfer Map

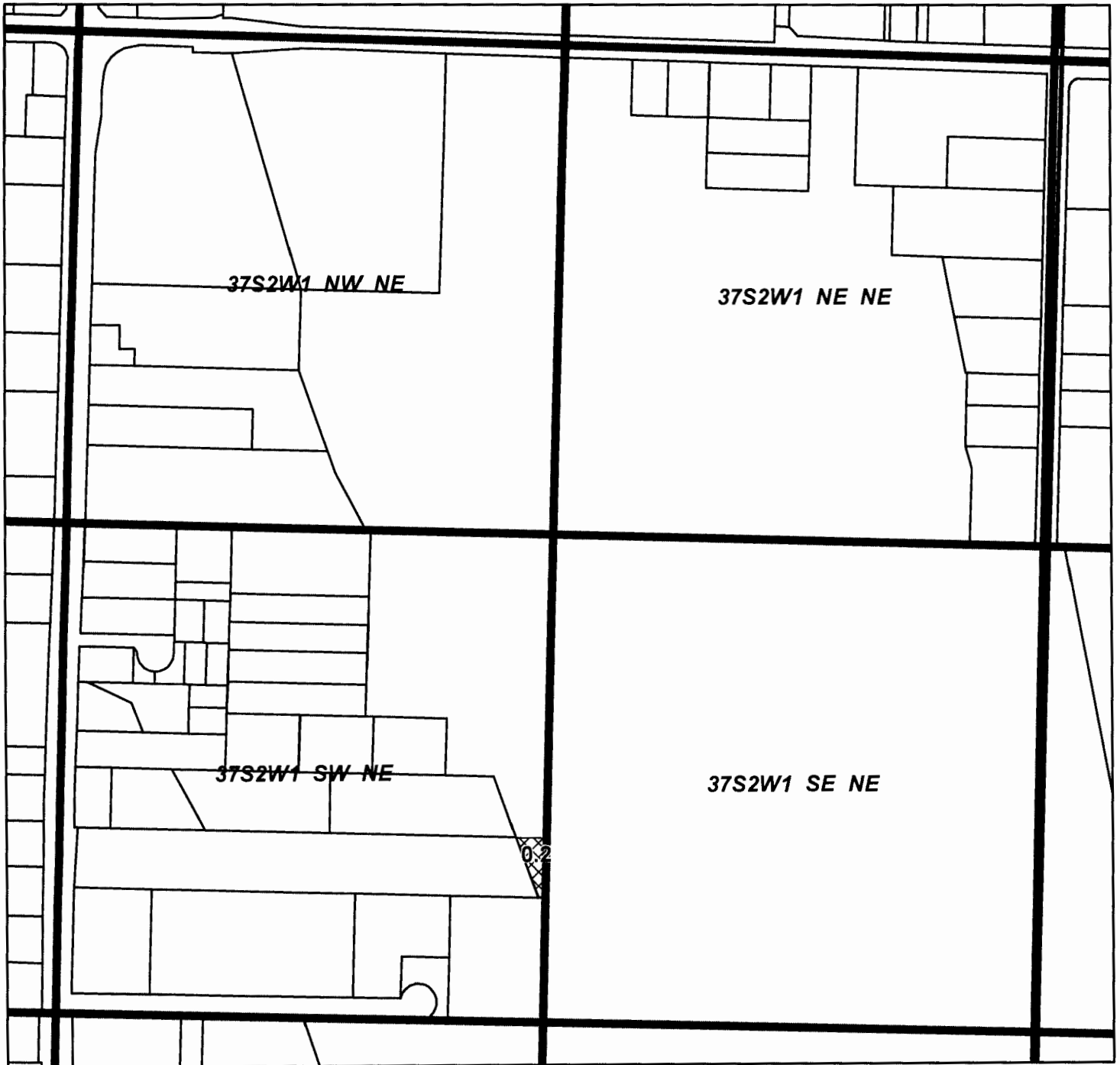

Located in SW 1/4 NE 1/4 SEC 01 T.37S. R.2 W.W.M.
Tax Lot T37S R2W 01A 1400 - 0.2 ac



RECEIVED BY OWRD

DEC 19 2014

SALEM, OR

From: RRVID

Certificates
P85288
S80576
S85876
S85877

-  Transfer Off
-  Qtr-Qtr
-  Tax Lot Line

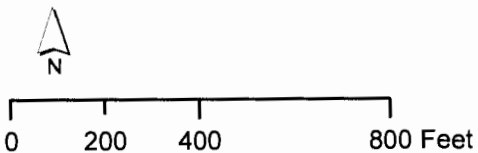

Rogue River Valley Irrigation District Water Rights Transfer Map

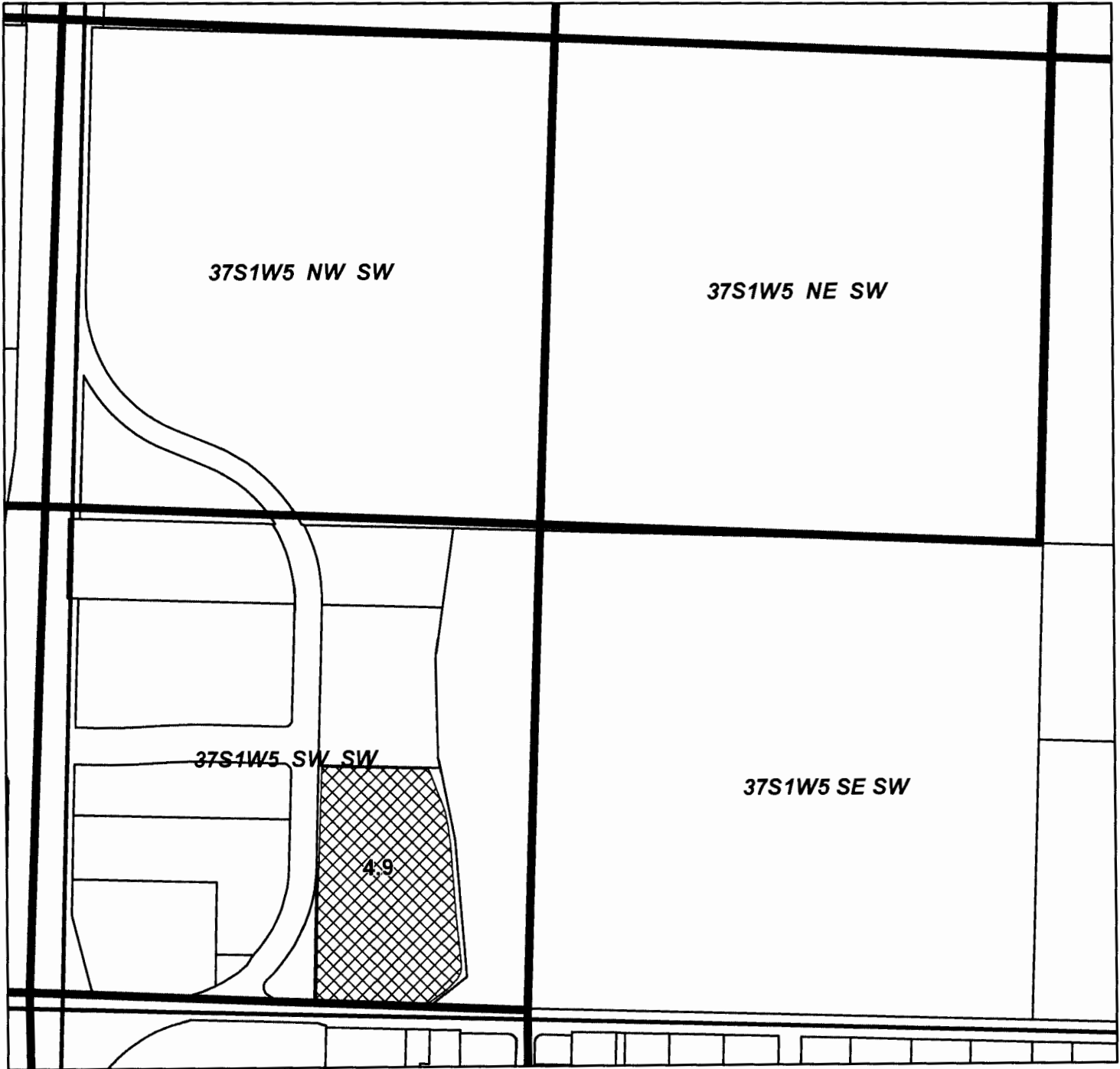



Located in SW 1/4 SW 1/4 SEC 05 T.37S. R.1 W.W.M. RECEIVED BY OWRD
Tax Lot T37S R1W 05 1600 - 4.9 ac

DEC 19 2014

SALEM, OR

From: RRVID

Certificates
P85288
S80576
S85876
S85877

-  Transfer Off
-  Qtr-Qtr
-  Tax Lot Line



0 200 400 800 Feet

Rogue River Valley Irrigation District Water Rights Transfer Map



Located in SE 1/4 NW 1/4 SEC 36 T.36S. R.2 W.W.M.
Tax Lot T36S R2W 36B 2104 - 0.9 ac



RECEIVED BY OWRD

DEC 19 2014

SALEM, OR

From: RRVID

Certificates
P85288
S80576
S85876
S85877

-  Transfer Off
-  Qtr-Qtr
-  Tax Lot Line

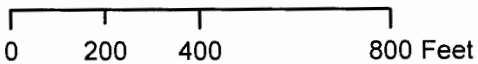

Rogue River Valley Irrigation District Water Rights Transfer Map

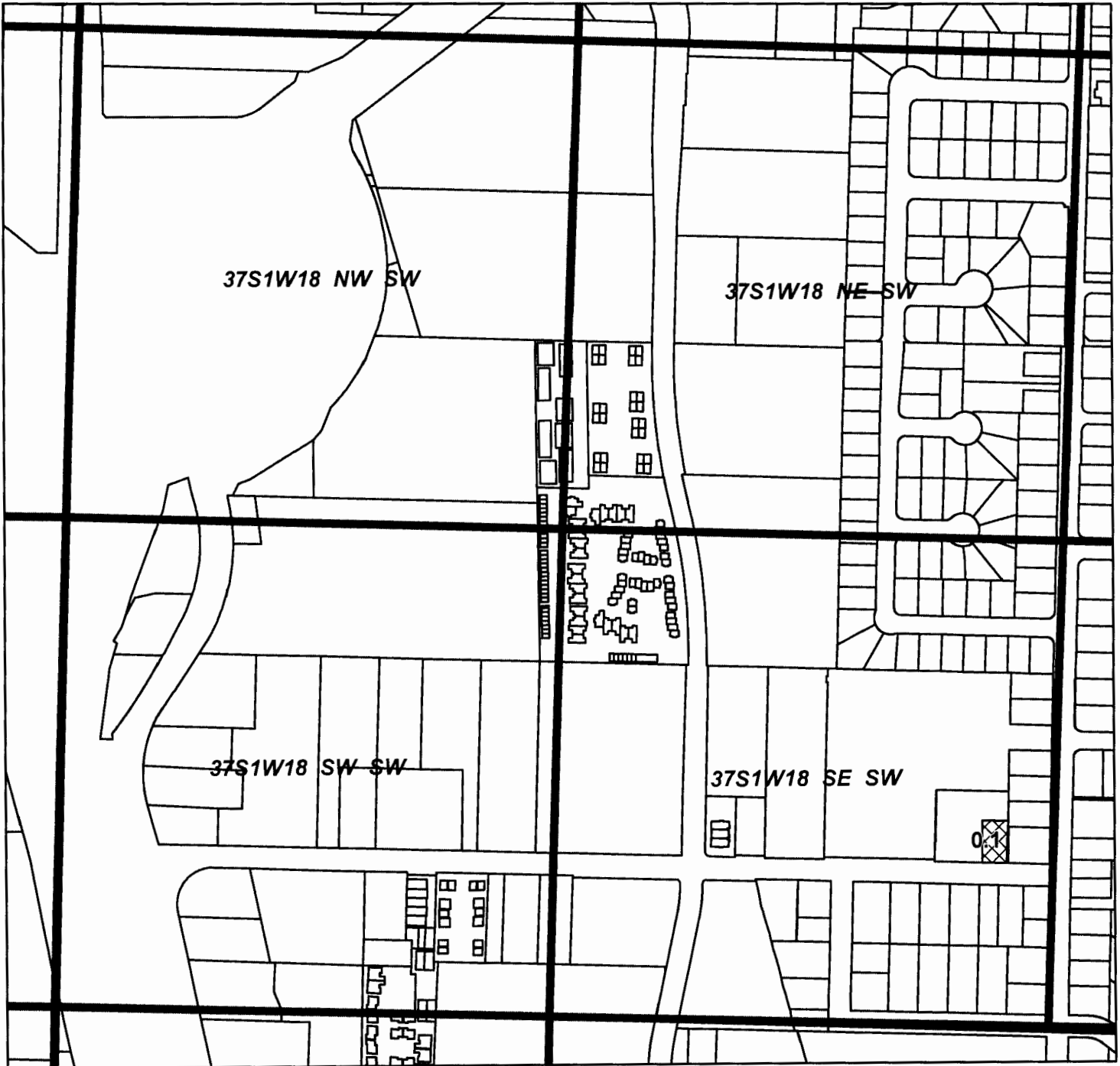



Located in SE 1/4 SW 1/4 SEC 18 T.37S. R.1 W.W.M. RECEIVED BY OWRD
Tax Lot T37S R1W 18CD 3200 - 0.1 ac

DEC 19 2014

SALEM, OR

From: RRVID

Certificates
P85288
S80576
S85876
S85877

-  Transfer Off
-  Qtr-Qtr
-  Tax Lot Line

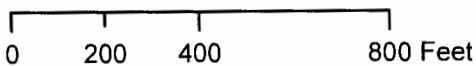

Rogue River Valley Irrigation District Water Rights Transfer Map



Located in NW 1/4 SE 1/4 SEC 36 T.36S. R.2 W.W.M.

Tax Lot T36S R2W 36D 102 -11.3 ac

Located in NE 1/4 SE 1/4 SEC 36 T.36S. R.2 W.W.M.

Tax Lot T36S R2W 36D 102 -1.5 ac

RECEIVED BY OWRD



DEC 19 2014

From: Jackson County

SALEM, OR

Certificates

- P85288
- S80576
- S85876
- S85877

-  Transfer Off
-  Tax Lot Line
-  Qtr-Qtr

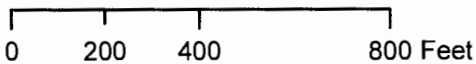

Rogue River Valley Irrigation District Water Rights Transfer Map



Located in SE 1/4 SE 1/4 SEC 27 T.36S. R.2 W.W.M.
Tax Lot T36S R2W 26 2002 - 0.6 ac

RECEIVED BY OWRD

DEC 19 2014

SALEM, OR

To: Ronald and Chrstine Horton

Certificates
P85288
S80576
S85876
S85877

- Transfer On
- Tax Lot Line
- Qtr-Qtr

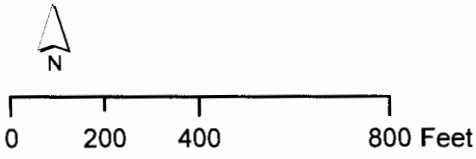

Rogue River Valley Irrigation District Water Rights Transfer Map

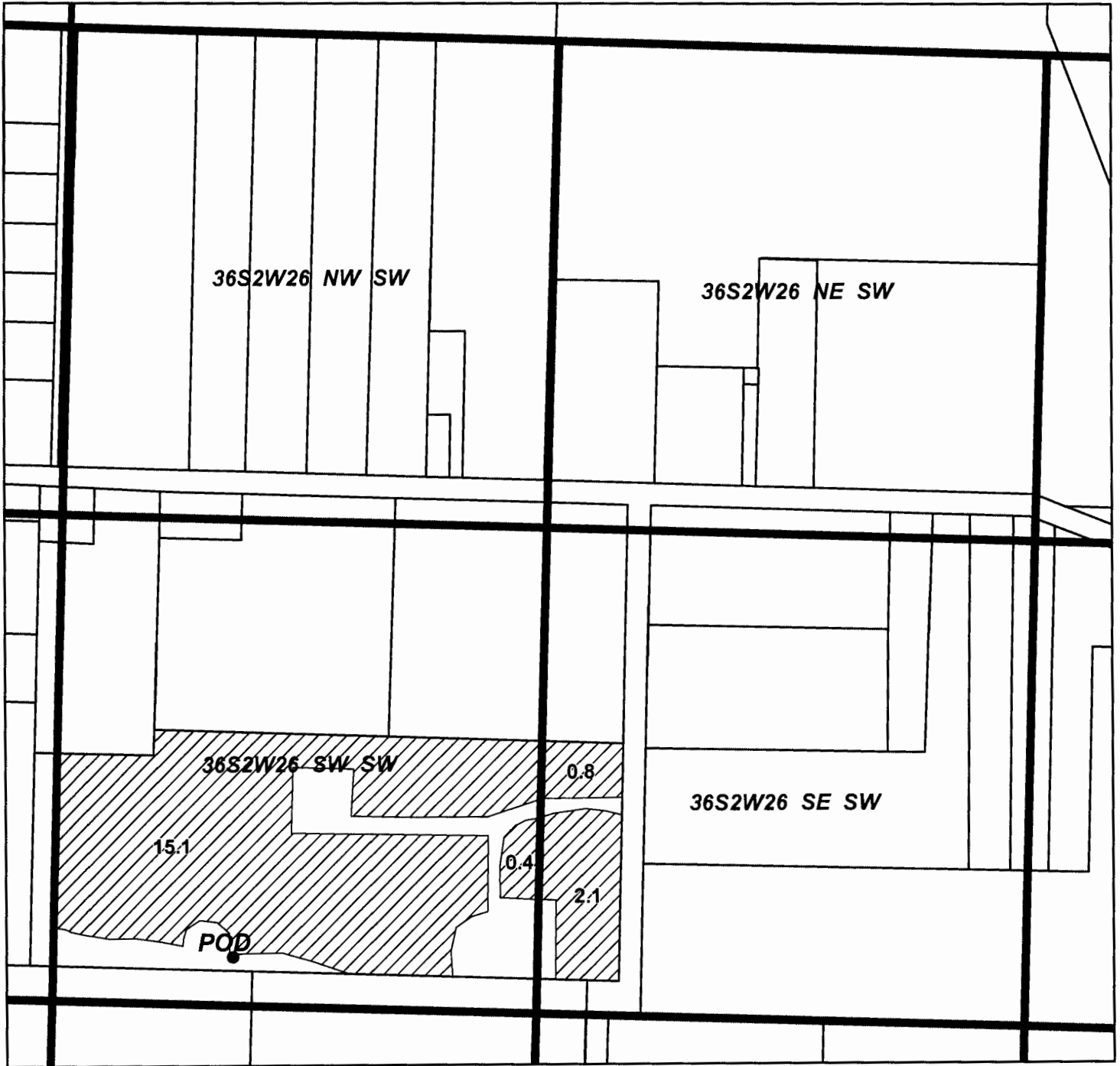

Located in SW 1/4 SW 1/4 SEC 26 T.36S. R.2 W.W.M. RECEIVED BY OWRD
Tax Lot T36S R2W 26 2002 -15.5 ac

Located in SE 1/4 SW 1/4 SEC 26 T.36S. R.2 W.W.M.
Tax Lot T36S R2W 26 2002 -2.9 ac

DEC 19 2014

SALEM, OR

To: Ronald and Chrstine Horton

Certificates
P85288
S80576
S85876
S85877

- Transfer On
- Tax Lot Line
- Qtr-Qtr

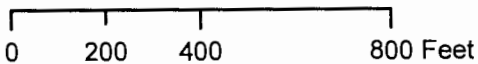

Rogue River Valley Irrigation District Water Rights Transfer Map

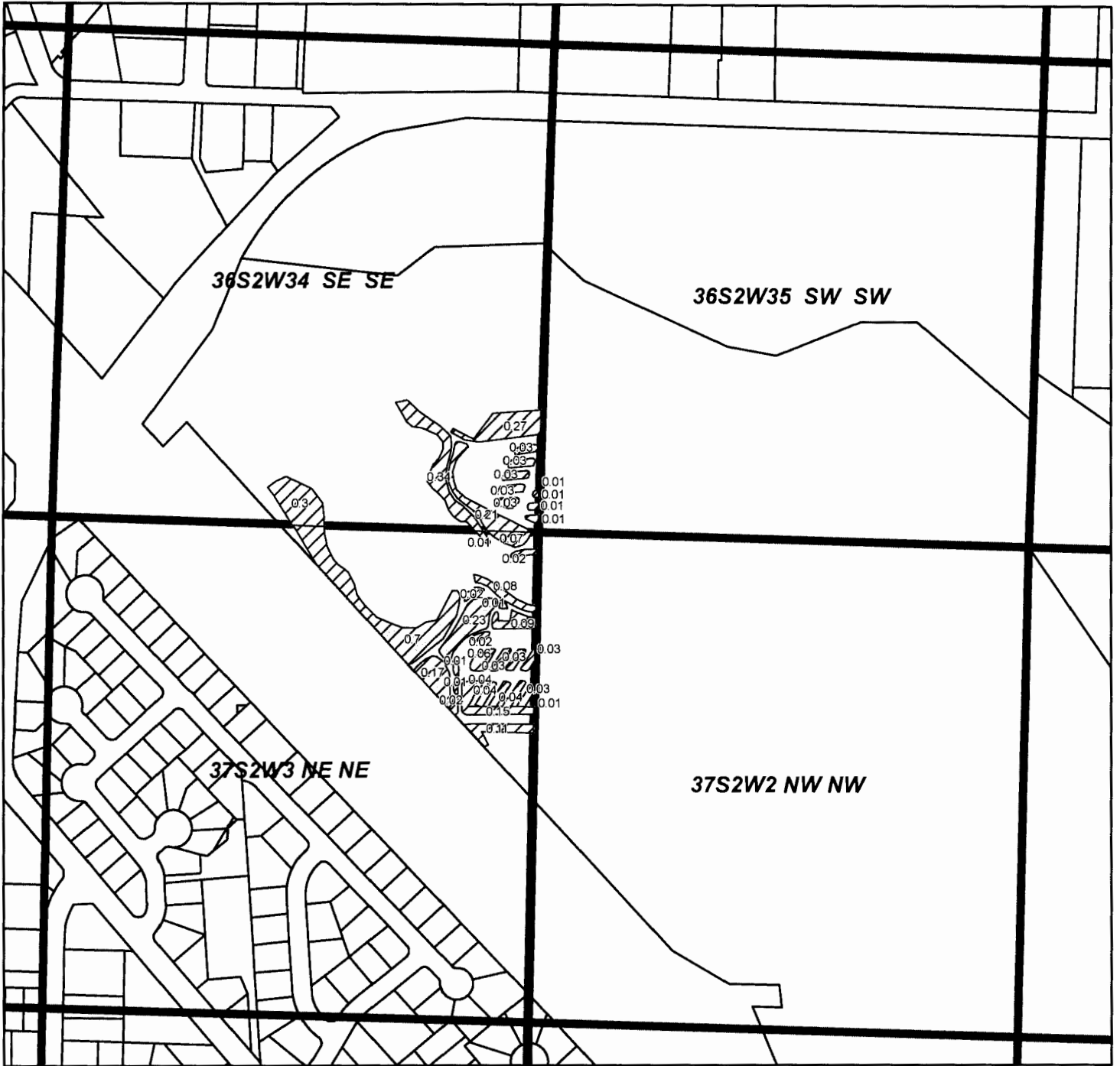

Located in SE 1/4 SE 1/4 SEC 34 T.36S. R.2 W.W.M. RECEIVED BY OWRD
Tax Lot T37S R2W 02 600 -1.31 ac

Located in NE 1/4 NE 1/4 SEC 3 T.37S. R.2 W.W.M.
Tax Lot T37S R2W 02 600 -2.03 ac

DEC 19 2014

SALEM, OR

To: Jackson County

Certificates



P85288

S80576

S85876

S85877

RRVID #14-02

-  Transfer On
-  Tax Lot Line
-  Qtr-Qtr

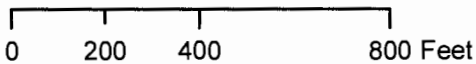

Rogue River Valley Irrigation District Water Rights Transfer Map

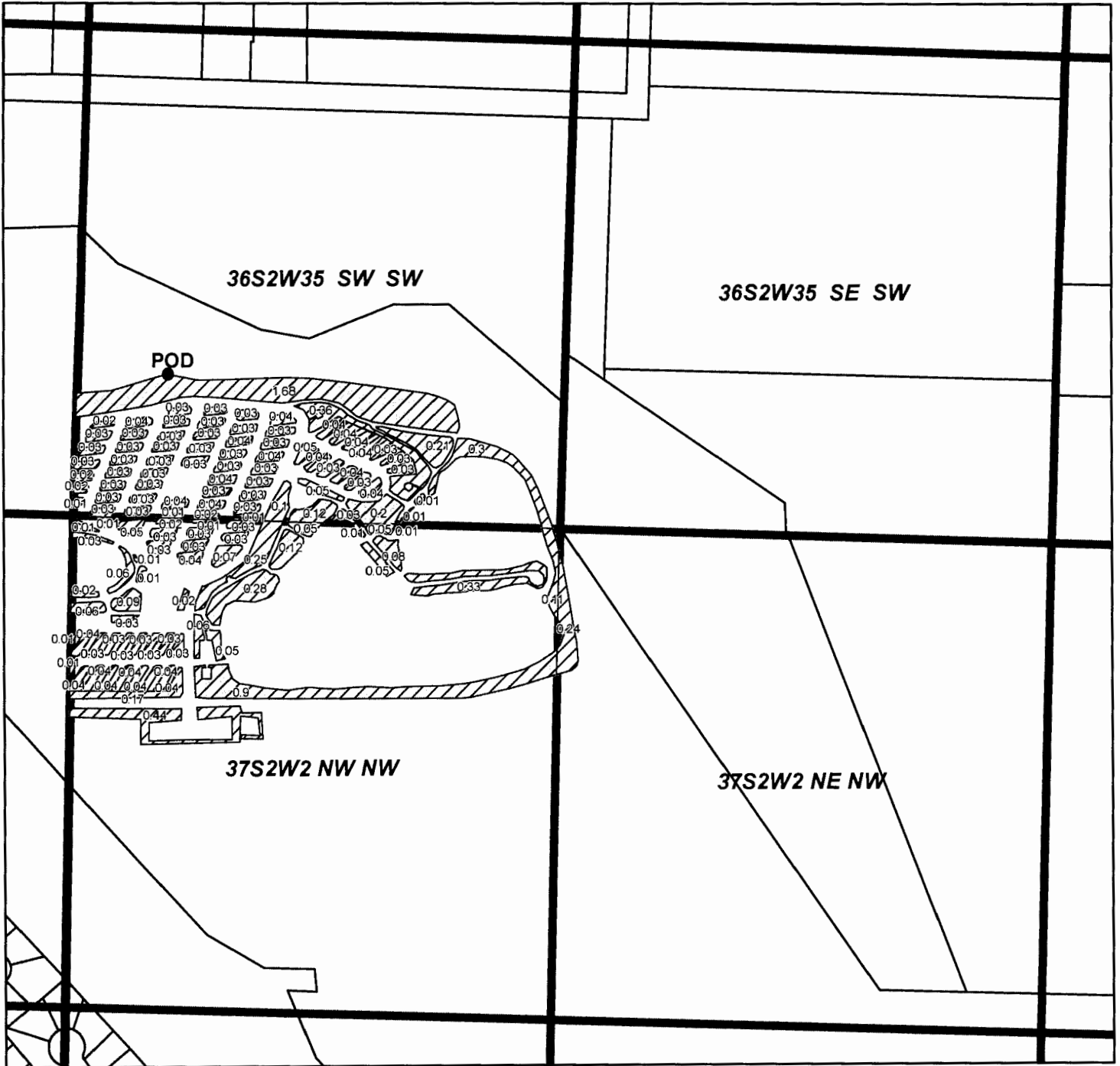

Located in SW 1/4 SW 1/4 SEC 35 T.36S. R.2 W.W.M. RECEIVED BY OWRD
Tax Lot T37S R2W 02 600 -4.99 ac

Located in NW 1/4 NW 1/4 SEC 2 T.37S. R.2 W.W.M. DEC 19 2014
Tax Lot T37S R2W 02 600 -4.23 ac

Located in NE 1/4 NW 1/4 SEC 2 T.37S. R.2 W.W.M. SALEM, OR
Tax Lot T37S R2W 02 600 -0.24 ac

To: Jackson County

Certificates

- P85288
- S80576
- S85876
- S85877

- Transfer On
- Tax Lot Line
- Qtr-Qtr

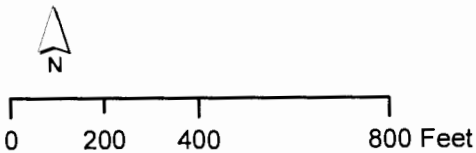

State of Oregon
WATER RESOURCES DEPARTMENT
NOTICE OF DISTRICT PERMANENT TRANSFER
(ORS 540-580)

District Internal
 Notice #: 14-01

3139 Merriman Road
 Medford, OR 97501
 Phone: 541-773-6127 Fax: 541-773-5420

1. WATER RIGHT

CERTIFICATE # See Attachment
 PRIORITY DATE _____
 JACKSON COUNTY
 WATER RIGHT UNDER NAME OF ROGUE RIVER VALLEY IRRIGATION DISTRICT

2. APPLICANT

NAME Rogue River Valley Irrigation District
 ADDRESS 3139 Merriman Rd Medford OR 97501 **RECEIVED BY OWRD**
 ENCUMBRANCE'S _____

DEC 19 2014

3. TYPE OF CHANGE: PERMANENT CHANGE IN PLACE OF USE.

4. LOCATION OF USE

AUTHORIZED POINT OF DIVERSION: SEE ATTACHMENT A **SALEM, OR**

LOCATION OF AUTHORIZED PLACE OF USE:

TOWNSHIP	RANGE	SECTION	¼ ¼ OF SECTION	TAX LOT	# OF ACRES IRRIGATED	OTHER USE

5. RECIPIENT

NAME Ronald and Christine Horton PHONE: 541-941-9999
 ADDRESS 5591 Upton Rd, Central Point, OR 97502

6. LOCATION OF PROPOSED USE

TOWNSHIP	RANGE	SECTION	¼ ¼ OF SECTION	TAX LOT	# OF ACRES IRRIGATED	OTHER USE
<u>36</u>	<u>2W</u>	<u>26</u>		<u>2002</u>	<u>19</u>	

7. EXHIBITS

A. A Map showing the location of the present and proposed irrigated lands.

Rogue River Valley Irrigation District hereby certifies that the applicant and recipient are the deed holders of subject properties; that our files are complete with a copy of the recorded documents; that the applicant's land has been irrigated within the last five years or the right appurtenant is not subject to forfeiture, and that applicant and recipient hereby authorize the transfer proposed herein.

NOTICE IS HEREBY GIVEN that this proposed change is subject to the approval of the Water Resources Department and that the Water Resources Department may reject the transfer or may require mitigation to avoid injury to other water right holders.

ROGUE RIVER VALLEY IRRIGATION DISTRICT AND APPLICANT, HEREBY SWEAR THAT THE ABOVE NOTICE FOR TRANSFER OF WATER RIGHT AND THE STATEMENTS MADE ARE TRUE AND CORRECT.

APPLICANT: Rogue River Valley Irrigation Dist DATE: 3/23/14
Name
 RECIPIENT: [Signature] DATE: 3-23-14
Name (landowner)
[Signature] DATE: 3-23-14
Name (landowner)
 FOR DISTRICT: [Signature] DATE: 3/23/14
Name

Authorized Point of Diversion, Attachment A

DIN#14-01

Priority

Date	Certificate	Authorized Point of Diversion	POD#	Type of Certificate
7/23/1909	P85288	North and South Fork Little Butte Creek	1	Primary
9/6/1915	S80576	Agate Reservoir	8	Supplemental
3/31/1910	S85876	Four Mile and Fish Lake Reservoirs	4	Supplemental
6/24/1913	S85877	North and South Fork Little Butte Creek	5	Supplemental

Location of Authorized Place of Use:

TWP	RNG	SEC	QQ	TL	# ACRES
36	1W	29B	SE NW	3000	.5
36	2W	35	NE SE	400	1.7
36	2W	35D	NW SE	2602	.2
36	2W	35D	NE SE	1300	.8
36	1W	31	SE SW	3400	2.0
37	2W	01BA	SE NW	2600	2.6
37	2W	01BA	NE NW	2600	2.0
36	1W	28A	NE NE	200	3.1
37	2W	01A	SW NE	1400	.2
37	1W	05	SW SW	1600	4.9
36	2W	36B	SE NW	2104	.9
37	1W	18CD	SE SW	3200	.1

Location of Proposed Use:

TWP	RNG	SEC	QQ	TL	# ACRES
36	2W	27	SE SE	2002	.6
36	2W	26	SW SW	2002	15.5
36	2W	26	SE SW	2002	2.9

RECEIVED BY OWRD

DEC 19 2014

SALEM, OR

State of Oregon
WATER RESOURCES DEPARTMENT
NOTICE OF DISTRICT PERMANENT TRANSFER
 (ORS 540-580)

District Internal
 Notice #: 14-02

3139 Merriman Road
 Medford, OR 97501
 Phone: 541-773-6127 Fax: 541-773-5420

1. WATER RIGHT

CERTIFICATE # See Attachment A
 PRIORITY DATE _____
 JACKSON COUNTY
 WATER RIGHT UNDER NAME OF ROGUE RIVER VALLEY IRRIGATION DISTRICT

2. APPLICANT

NAME Rogue River Valley Irrigation District
 ADDRESS 3139 Merriman Rd. Medford, OR 97502
 ENCUMBRANCE'S _____

3. TYPE OF CHANGE: PERMANENT CHANGE IN PLACE OF USE.

4. LOCATION OF USE

AUTHORIZED POINT OF DIVERSION: SEE ATTACHMENT A

LOCATION OF AUTHORIZED PLACE OF USE:

TOWNSHIP	RANGE	SECTION	¼ ¼ OF SECTION	TAX LOT	# OF ACRES IRRIGATED	OTHER USE
<u>36</u>	<u>2W</u>	<u>36D</u>		<u>102</u>	<u>12.8</u>	

5. RECIPIENT

NAME Jackson County Parks PHONE: (541) 774-8183
 ADDRESS 7520 Table Rock Rd Central Point

6. LOCATION OF PROPOSED USE

TOWNSHIP	RANGE	SECTION	¼ ¼ OF SECTION	TAX LOT	# OF ACRES IRRIGATED	OTHER USE
<u>37</u>	<u>2W</u>	<u>02</u>		<u>600</u>	<u>12.8</u>	

7. EXHIBITS

A. A Map showing the location of the present and proposed irrigated lands.

Rogue River Valley Irrigation District hereby certifies that the applicant and recipient are the deed holders of subject properties; that our files are complete with a copy of the recorded documents; that the applicant's land has been irrigated within the last five years or the right appurtenant is not subject to forfeiture, and that applicant and recipient hereby authorize the transfer proposed herein.

NOTICE IS HEREBY GIVEN that this proposed change is subject to the approval of the Water Resources Department and that the Water Resources Department may reject the transfer or may require mitigation to avoid injury to other water right holders.

ROGUE RIVER VALLEY IRRIGATION DISTRICT AND APPLICANT, HEREBY SWEAR THAT THE ABOVE NOTICE FOR TRANSFER OF WATER RIGHT AND THE STATEMENTS MADE ARE TRUE AND CORRECT.

APPLICANT: Rogue River Valley Irrigation
 Name

DATE: 11/13/14

RECIPIENT: [Signature]
 Name (landowner) DANNY JORDAN
 County Administrator

DATE: 11/13/14

Name (landowner) _____

DATE: _____

FOR DISTRICT: _____
 Name

DATE: RECEIVED BY OWRD

DEC 19 2014

SALEM, OR

Authorized Point of Diversion, Attachment A

DIN#14-02

Priority

Date	Certificate	Authorized Point of Diversion	POD#	Type of Certificate
7/23/1909	P85288	North and South Fork Little Butte Creek	1	Primary
3/31/1910	S85876	Four Mile and Fish Lake Reservoirs	4	Supplemental
6/24/1913	S85877	North and South Fork Little Butte Creek	5	Supplemental
9/6/1915	S80576	Agate Reservoir	8	Supplemental

Location of Authorized Place of Use:

TWP	RNG	SEC	QQ	TL	# ACRES
36	2W	36D	NW SE	102	11.30
36	2W	36D	NE SE	102	1.5

Location of Proposed Use:

TWP	RNG	SEC	QQ	TL	# ACRES
36	2W	34	SE SE	600	1.31
37	2W	03	NE NE	600	2.03
36	2W	35	SW SW	600	4.99
37	2W	02	NW NW	600	4.23
37	2W	02	NE NW	600	.24

RECEIVED BY CWRD

DEC 19 2014

SALEM, OR