

# T21S, R46E, Sections 7 and 18, Willamette Meridian

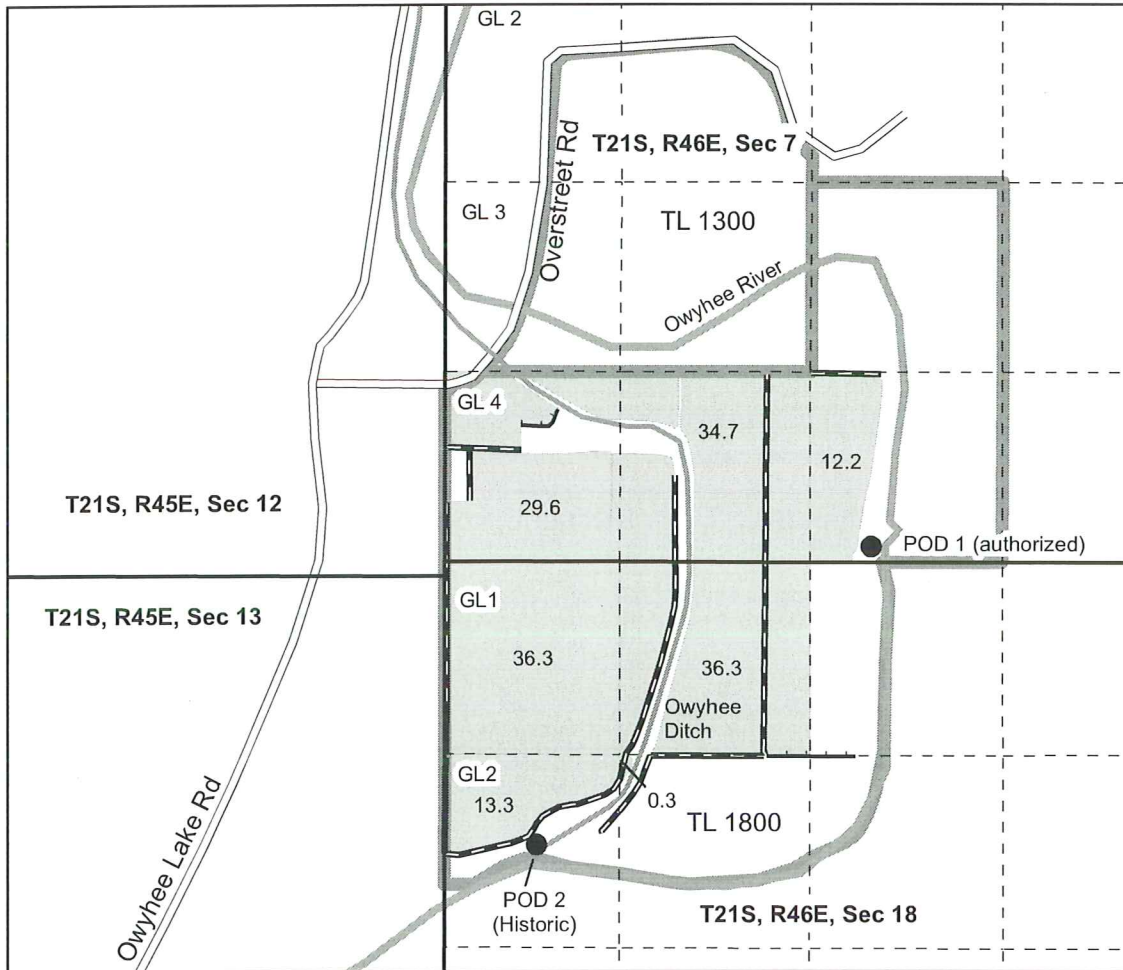

- POD
- District Canal
- Gated pipe
- Irrigation Ditch
- River
- Road
- Certificate 75676, supplemental, priority 1894
- Tax lots
- - - Quarter quarter lines
- Section lines

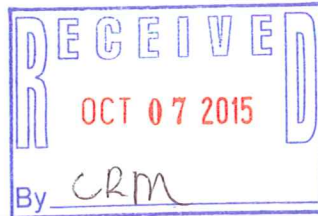

POD 1, the authorized POD is located in the SW SE 1/4, section 7, T21S, R46E; and 2250 feet west and 160 feet north of the SE corner of section 7.

POD2, the Historic POD is located in the SW NW 1/4, Section 18, T21S, R46E; and 640 feet east and 1,950 feet south of the NW corner of Section 18.

This map is not intended to provide legal dimensions or locations of property ownership lines.



*Expires 12/31/2016*

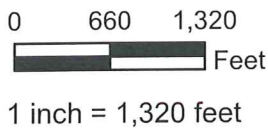

Historic Point of Diversion Transfer  
Certificate 75676  
Tax lot 1800

Map Prepared for  
Mark Dee Hartley and Samuel E. Hartley

Nancy Rorick Consulting

# T21S, R46E, Sections 7 and 18, Willamette Meridian

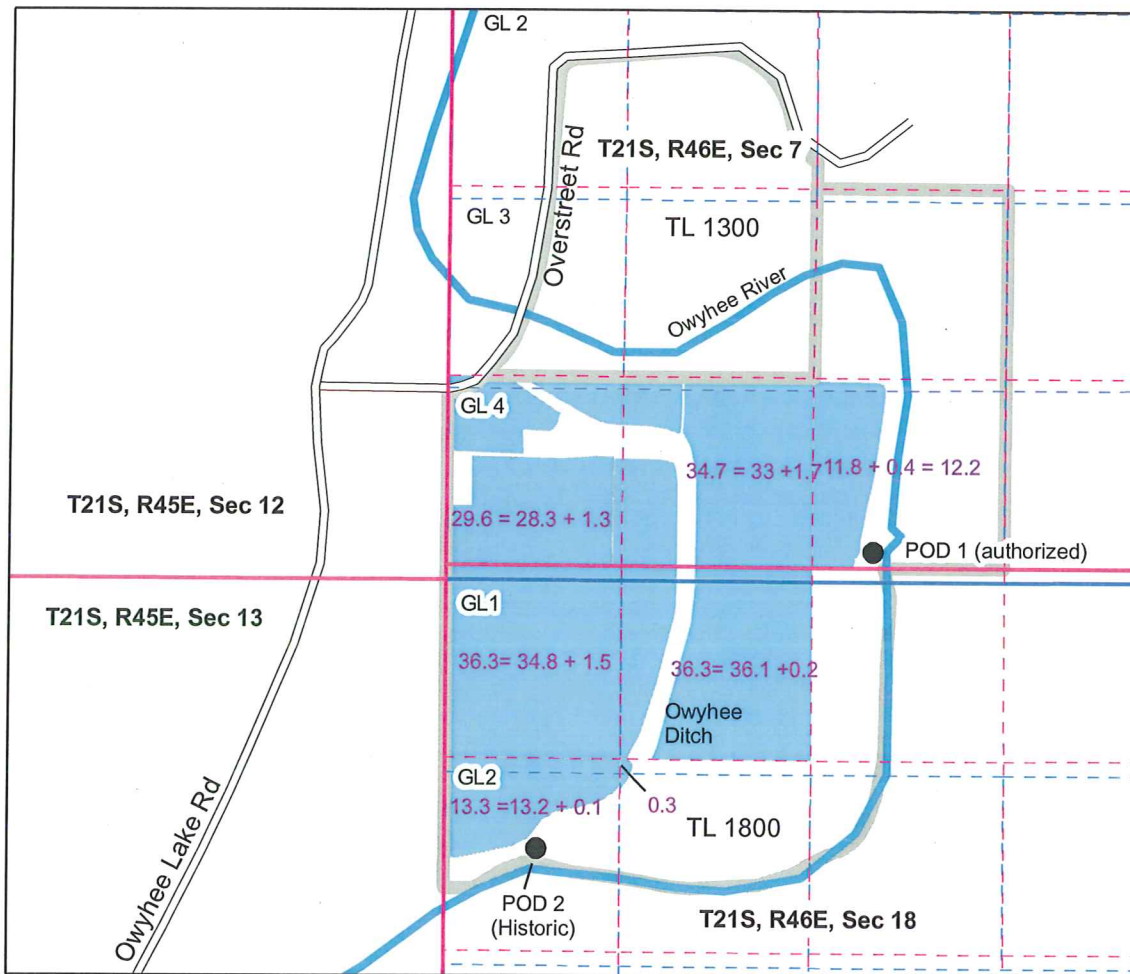

- POD
- River
- Road
- Certificate 75676, supplemental, priority 1894
- Tax lots
- - - Quarter quarter lines
- Section lines
- Original district map lines
- - - Quarter quarter lines
- Section lines
- Corrected map lines based on BLM PLSS and GLO maps
- - - Quarter quarter lines
- Section lines

POD 1, the authorized POD is located in the SW SE ¼, section 7, T21S, R46E; and 2250 feet west and 160 feet north of the SE corner of section 7.

POD2, the Historic POD is located in the SW NW ¼, Section 18, T21S, R46E; and 640 feet east and 1,950 feet south of the NW corner of Section 18.

This map is not intended to provide legal dimensions or locations of property ownership lines.

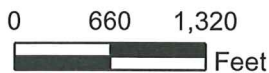

1 inch = 1,320 feet

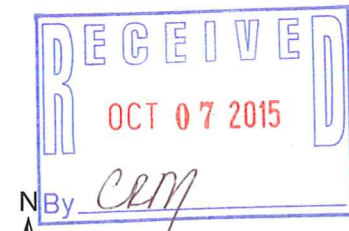

Historic Point of Diversion Transfer  
Certificate 75676  
Tax lot 1800

Map Prepared for  
Mark Dee Hartley and Samuel E. Hartley

Nancy Rorick Consulting