

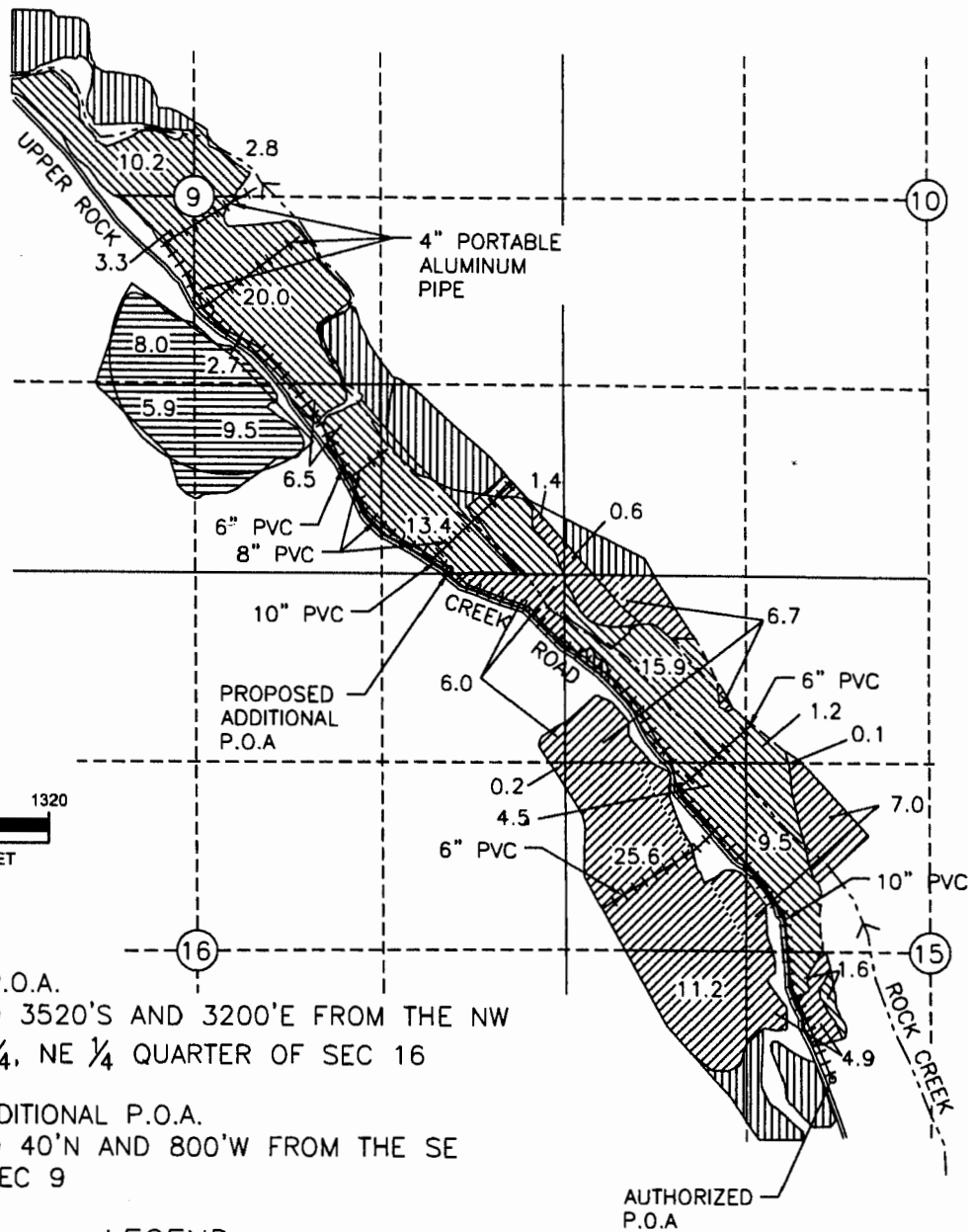



AMENDED (1-13-15) WATER RIGHT TRANSFER APPLICATION MAP
 INVOLVING CERTIFICATES 43898 & 48133
 FOR PATTI KAYSER
 GILLIAM CO
 T2S, R22E, W.M., ALL IN TAX LOT 1001

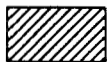

AUTHORIZED P.O.A.
 WELL LOCATED 3520'S AND 3200'E FROM THE NW
 CORNER, NE 1/4, NE 1/4 QUARTER OF SEC 16

PROPOSED ADDITIONAL P.O.A.
 WELL LOCATED 40'N AND 800'W FROM THE SE
 CORNER OF SEC 9

LEGEND

-  PRIMARY UNDER CERTIFICATE 43898
-  SUPPLEMENTAL UNDER CERTIFICATE 48133
-  SUPPLEMENTAL UNDER CERTIFICATE 43898
-  NOT INVOLVED IN THIS TRANSFER

NOTE:
 THE PURPOSE OF THIS MAP IS TO IDENTIFY THE APPROXIMATE LOCATION OF THE WATER RIGHT. IT IS NOT
 INTENDED TO PROVIDE INFORMATION RELATIVE TO THE LOCATION OF PROPERTY OWNERSHIP BOUNDARY LINES.

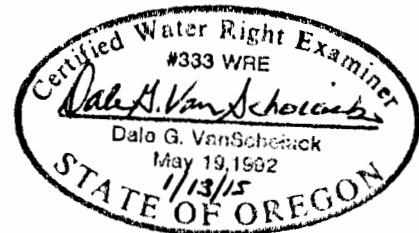

Renews 6/30/16

RECEIVED BY OWRD
 FEB 02 2015
 SALEM, OR

