

**SPLIT A PERMIT and REQUEST FOR ISSUANCE
OF REPLACEMENT PERMITS**

APR 22 2016

APPLICANT'S AGREEMENT

SALEM, OR

This Agreement is between the **Oregon Water Resources Department**, hereafter OWRD, and **Matthew Stashin** hereafter Applicant, hereafter known together as the parties.

OWRD Information	Applicant's Information	Applicant's Representative
Contact: Kelly Starnes	Name: Matthew Stashin	Name: John Short
Title: Transfer Program Analyst	Contact:	Contact: Water Right Services, LLC
Address: 725 Summer Street, NE, Suite A Salem, OR 97301-1266	Address: 21762 SW Mountain Home RD Sherwood, OR 97140	Address: PO Box 1830 Bend, OR 97709
Phone: 503 986-0886		Phone: 541-389-2837
Fax: 503 986-0901		
Email: kerri.h.cope@wrdd.state.or.us	Email:	Email: johnshort@usa.com

Purpose The purpose of this Agreement is to process the **Split a Permit Application. (Permit Number: G-~~13727~~ 7124)** *MA*

1. **Authority** The OWRD has been authorized pursuant to ORS 537.225 to receive and review application for assignment of all or part of the water right permit and for the issuance of a replacement water right permit that reflects that assignment. In addition OAR 690-325-0010 through 0110 establishes the requirements and procedures for evaluating the application. In making this agreement, OWRD shall require the applicant to pay the full cost of evaluating the application.
2. **Restrictions.** **Matthew Stashin** and OWRD agree that this Agreement shall not be construed to restrict in any way the decisions and actions by OWRD. OWRD shall be free to exercise independent judgment consistent with existing laws and regulations.
3. **Effective Date and Duration.** Unless otherwise terminated by non-deposit of funds by the Applicant, this Agreement shall become effective on the date on which both parties have signed the Agreement and the full deposit of the estimated cost of the proposed service.
4. **Statement of Work.** The Statement of Work is contained in Exhibit A attached hereto and incorporated by reference into this Agreement. OWRD agrees to perform this work in accordance with the terms and conditions of this Agreement.
5. **Consideration.**
 - a. **Matthew Stashin** shall pay OWRD in advance for actual costs incurred by OWRD as specified in the Statement of work attached and incorporated as Exhibit A. The estimated maximum reimbursement payable to OWRD under this Agreement is **\$715.00**. **Matthew Stashin** agrees to pay the full amount of **\$715.00** to OWRD prior to commencement of any work stated in this Agreement. This payment will be placed in an account administered by OWRD and drawn upon as costs are actually incurred. If the actual cost of performing the work is less than payments received, OWRD will refund the unspent balance. If the actual cost of processing exceeds the estimate, the Applicant can either elect to terminate this Agreement or amend the Agreement to reflect the increase in cost.
 - b. The costs stated in this Agreement do not include the statutory application processing and filing fees.

Exhibit A

APR 22 2016

Statement of Work

SALEM, OR

Permit Number: G-7124

Name of Applicant: **Matthew Stashin**

**Split a Permit Process
Itemized Estimate Sheet
For
Permit Application**

Action Item	Est. Time (hr.)
Review Application for Completeness	1.0
Verify mailing address of each owner of the authorized place of use	0.5
Verify deed(s) match(es) properties proposed for assignment	1.0
Verify most recent water use under the permit has been exercised within relevant terms and conditions of permit	0.5
Assess application for enlargement of the original permit and injury to other water right holders	1.5
Review and prepare draft documents	5.0
Peer review, issue, mail, and publish draft PFO	0.5
Peer review, issue, mail, and publish PFO	0.5
Peer review, issue and mail Final Order	0.5
Total hours	11.0

Total estimated cost is 11 hours at \$65.00* per hour, totaling \$715.00

* - This figure is representative of the average compensation for staff time, with benefits and overhead, for the staff persons working on this file. You may request a detailed accounting upon completion of this project.

Completion of Draft Proposed Final Order: **April 20, 2016**

**Dates are contingent on the Applicant's expeditious resolution of any deficiency and may be affected by Department's work load.*

Permit #G-7124

Applicant's Agreement

ACCEPTED4-22-2016 MFB of 3

ORIGINALS

Transfer Application and Map

Amendments/Revisions to Appl & Map

Receipt

Deed or Lot Book Report

Notarized Consent

Evidence of Use Affidavit

Land Use Information Form

Lien Holder Notification *(if applicable)*

Report of Ownership and Lien Info *(if applicable)*

8

Other Supporting Documentation

ACCEPTED

4-22-2016 WA



Oregon

Kate Brown, Governor

Water Resources Department

North Mall Office Building
725 Summer St NE, Suite A
Salem, OR 97301
Phone (503) 986-0900
Fax (503) 986-0904
www.wrd.state.or.us

January 15, 2016

Matthew Stashin
21762 SW Mountain Home Road
Sherwood, OR 97140-8636

Dear Matthew:

The Water Resources Department has received your Application to Split a Permit and Request for Issuance of Replacement Permits. At this time however, we are unable to accept your application, because the minimum filing requirements are not met.

The reason for this return is that the request was not signed by the applicant.

We are hereby returning the incomplete application and the fees submitted. Please return the application and the required information, so the Department may begin processing your application in a timely manner.

Should you have any questions, please do not hesitate to contact Customer Service at the address above or by telephone at 503-986-0801.

Sincerely,

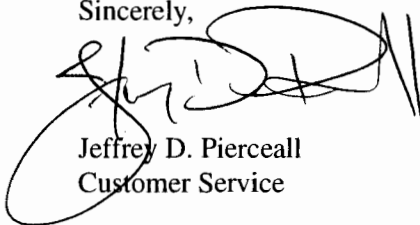

Jeffrey D. Pierceall
Customer Service

Cc: OWRD Fiscal

RECEIVED BY OWRD

FEB 11 2016

SALEM, OR

ACCEPTED

4-22-2016 MA





Oregon Water Resources Department
 725 Summer Street NE, Suite A
 Salem, Oregon 97301-1266
 (503) 986-0900
 www.wrd.state.or.us

Application to Split A Permit and Request for Issuance of Replacement Permits (ORS 537.225)

Part 1 of 5 – Minimum Requirements Checklist

This application will be returned if Parts 1 through 5 and all required attachments are not completed and included.
 For questions, please call (503) 986-0900, and ask for Transfer Section.

Check all items included with this application.

RECEIVED BY OWRD

- Part 1 – Completed Minimum Requirements Checklist. FEB 11 2016
- Part 2 – Completed Application Map Checklist. SALEM, OR
- Part 3 – Completed Application with non-refundable \$125.00 Application Fee, Applicant(s) Information and Signature(s).
- Part 4 – Other Landowner Information and proportionate rate(s).
- Part 5 – Water Right Permit Information. List the permit number to be assigned here: G - 7124.

Attachments:

- Completed application map prepared by Certified Water Right Examiner (CWRE).
- Completed Affidavit(s) from the applicant(s):
 - Certifying the permit has not been conveyed or withheld, and remains appurtenant to the applicant's land.
 - Certifying the applicant has read the permit. RECEIVED BY OWRD

- Copy(s) of current recorded deed(s) showing that the applicant(s) is/are an owner of the land(s) to which the permit is appurtenant. JAN 15 2016
SALEM, OR

INSTRUCTIONS for editing the Application Form

Photocopy pages or tables in Part 5, ~~mark through~~ any non-applicable information, insert/attach photocopied pages to document in the appropriate location, and manually amend page numbers as necessary (e.g., Page 5 of 9 10).

You may refer to additional attachments that you may include, such as separately produced tables or spreadsheets to convey large numbers of rows of place of use listings, owner/property parcels, etc. You may contact the Department at 503-986-0900 and ask for Transfer Staff if you have questions.

For Staff Accounting Purposes Only – PCA #46110 Object #_____

Part 2 of 4 –Application Map Checklist

This application will be returned if any of the map requirements listed below are not met.

Please be sure that the map you submit is based upon the original water right application map or permit amendment map and includes all the items listed below and meets the requirements of OAR 690-325-0050. Check all boxes that apply.

The map shall not include any unauthorized change to the authorized place of use outside of its original perimeters as exhibited on the original water right application map or approved permit amendment map nor any unauthorized change to the location of the point(s) of diversion or appropriation as exhibited on the original water right application map or approved permit amendment map.

Certified Water Right Examiner (CWRE) Stamp and Signature. For a list of CWRE's, **RECEIVED BY OWRD**
http://apps.wrd.state.or.us/apps/wr/cwre_license_view/.

Permanent quality printed with dark ink on good quality paper. **FEB 11 2016**

The size of the map can be 8½ x 11 inches, 8½ x 14 inches, or up to 30 x 30 inches. For 30 x 30 inch maps, one additional paper copy and an electronic copy in a .pdf, .tiff or .jpg format is required. **SALEM, OR**

A north arrow, a legend, and scale. The scale of the map must be: 1 inch = 400 feet, 1 inch = 1,320 feet, the scale of the county assessor map if the scale is not smaller than 1 inch = 1,320 feet, or a scale that has been pre-approved by the Department. **RECEIVED BY OWRI**

Township, Range, Section, ¼ ¼, DLC, Government Lot, and other recognized public land survey lines. **JAN 15 2016**

Tax lot boundaries (property lines) are required. Tax lot numbers are recommended. **SALEM, OR**

Major physical features including rivers and creeks showing direction of flow, lakes and reservoirs, roads, and railroads.

Major water delivery system features from the point(s) of diversion/appropriation such as main pipelines, canals, and ditches.

The place of use of each applicant's portion of the water right permit shall be clearly defined by outline and shaded or hachured and shall show the number of acres for each portion in each quarter-quarter section, government lot, or quarter-quarter section as projected within government lots, donation land claims, or other recognized public land survey subdivisions. If the permit has multiple priority dates or uses, the lands to be served by each priority date and on which use is authorized, must be separately identified.

The place of use of any part of the permit **not** being assigned shall be clearly defined by outline and shaded or hachured and shall show the number of acres for each portion in each quarter-quarter section, government lot, or quarter-quarter section as projected within government lots, donation land claims, or other recognized public land survey subdivisions. If the permit has multiple priority dates or uses, the lands to be served by each priority date and on which use is authorized, must be separately identified.

Each applicant's portion of the permit shall be referenced, by either alphabet letter or number, to each applicant(s) listed in the application form.

The rate and any applicable acre-feet allowance of water use under the permit for each applicant's portion of the permit shall be clearly labeled on the map.

The location of each authorized point of diversion or appropriation.

Please use additional pages as needed

Part 3 of 5 – Applicant Information and Signature

Applicant Information

APPLICANT/BUSINESS NAME MATTHEW STASHIN		MAP ID (LETTER OR NUMBER) 2	PHONE NO.	ADDITIONAL CONTACT NO.
ADDRESS 21762 SW MOUNTAIN HOME ROAD				FAX NO.
CITY SHERWOOD	STATE OR	ZIP 97140-8636	E-MAIL	
BY PROVIDING AN E-MAIL ADDRESS, CONSENT IS GIVEN TO RECEIVE ALL CORRESPONDENCE FROM THE DEPARTMENT ELECTRONICALLY. COPIES OF THE FINAL ORDER AND REPLACEMENT PERMIT DOCUMENTS WILL ALSO BE MAILED.				

Agent Information – This agent is authorized to represent the above applicant in all matters relating to this application

AGENT/BUSINESS NAME JOHN A. SHORT / WATER RIGHT SERVICES, LLC		PHONE NO. 541-389-2837	ADDITIONAL CONTACT NO.	
ADDRESS PO Box 1830			FAX NO.	
CITY BEND	STATE OR	ZIP 97709	E-MAIL JOHNSHORT@USA.COM	
BY PROVIDING AN E-MAIL ADDRESS, CONSENT IS GIVEN TO RECEIVE ALL CORRESPONDENCE FROM THE DEPARTMENT ELECTRONICALLY. COPIES OF THE FINAL ORDER AND REPLACEMENT PERMIT DOCUMENTS WILL ALSO BE MAILED.				

ORS 536.050(1)(aa) authorizes the Oregon Water Resources Department (OWRD) to collect fees based upon the actual cost of work to process an application under ORS 537.225.

I (we) understand the following:

- Upon receipt of my complete application and the non-refundable application fee in the amount of \$125.00, OWRD will, within fifteen (15) days, notify me in writing of the estimate of the cost of work.
- The non-refundable \$125.00 fee covers the cost of OWRD’s staff to evaluate and provide the cost of work estimate for processing the application.
- Upon receiving the estimate I may agree or decline to enter into a formal contract to pay the estimated cost of work in advance to initiate the processing of the application.
- If I decline to enter into a formal contract, OWRD will close my application.
- An incomplete or inaccurate application may delay the process and increase the cost to process my request.
- OWRD does not guarantee a favorable review of the application.

RECEIVED BY OWRD

JAN 15 2016

I (we) affirm that the most recent water use (if any) under my (our) portion of the permit has been exercised within the relevant terms and conditions of the permit.

SALEM, OR

I (we) affirm that the information contained in this application is true and accurate.

RECEIVED BY OWRD



Matthew Stashin
Applicant signature

Matthew Stashin
Name (and title if applicable) (print)

2/9/16
Date

FEB 11 2016

SALEM, OR

Applicant signature

Name (and title if applicable) (print)

Date

ACCEPTED TACS
4-22-2016 MA

Applicant Information

APPLICANT/BUSINESS NAME			MAP ID (LETTER OR NUMBER)	PHONE NO.	ADDITIONAL CONTACT NO.
ADDRESS					FAX NO.
CITY	STATE	ZIP	E-MAIL		
BY PROVIDING AN E-MAIL ADDRESS, CONSENT IS GIVEN TO RECEIVE ALL CORRESPONDENCE FROM THE DEPARTMENT ELECTRONICALLY. COPIES OF THE FINAL ORDER AND REPLACEMENT PERMIT DOCUMENTS WILL ALSO BE MAILED.					

Agent Information – This agent is authorized to represent the above applicant in all matters relating to this application

AGENT/BUSINESS NAME			PHONE NO.	ADDITIONAL CONTACT NO.
ADDRESS				FAX NO.
CITY	STATE	ZIP	E-MAIL	
BY PROVIDING AN E-MAIL ADDRESS, CONSENT IS GIVEN TO RECEIVE ALL CORRESPONDENCE FROM THE DEPARTMENT ELECTRONICALLY. COPIES OF THE FINAL ORDER AND REPLACEMENT PERMIT DOCUMENTS WILL ALSO BE MAILED.				

I (we) affirm that the most recent water use (if any) under my (our) portion of the permit has been exercised within the relevant terms and conditions of the permit.

I (we) affirm that the information contained in this application is true and accurate.



 _____ Name (and title if applicable) (print) _____ Date _____
 Applicant signature
 _____ Name (and title if applicable) (print) _____ Date _____
 Applicant signature

RECEIVED BY OWRD

FEB 11 2016

SALEM, OR

Applicant Information

APPLICANT/BUSINESS NAME			MAP ID (LETTER OR NUMBER)	PHONE NO.	ADDITIONAL CONTACT NO.
ADDRESS					FAX NO.
CITY	STATE	ZIP	E-MAIL		
BY PROVIDING AN E-MAIL ADDRESS, CONSENT IS GIVEN TO RECEIVE ALL CORRESPONDENCE FROM THE DEPARTMENT ELECTRONICALLY. COPIES OF THE FINAL ORDER AND REPLACEMENT PERMIT DOCUMENTS WILL ALSO BE MAILED.					

Agent Information – This agent is authorized to represent the above applicant in all matters relating to this application

AGENT/BUSINESS NAME			PHONE NO.	ADDITIONAL CONTACT NO.
ADDRESS				FAX NO.
CITY	STATE	ZIP	E-MAIL	
BY PROVIDING AN E-MAIL ADDRESS, CONSENT IS GIVEN TO RECEIVE ALL CORRESPONDENCE FROM THE DEPARTMENT ELECTRONICALLY. COPIES OF THE FINAL ORDER AND REPLACEMENT PERMIT DOCUMENTS WILL ALSO BE MAILED.				

I (we) affirm that the most recent water use (if any) under my (our) portion of the permit has been exercised within the relevant terms and conditions of the permit.

I (we) affirm that the information contained in this application is true and accurate.



 _____ Name (and title if applicable) (print) _____ Date _____
 Applicant signature
 _____ Name (and title if applicable) (print) _____ Date _____
 Applicant signature

RECEIVED BY OWRD

JAN 15 2016

SALEM, OR

Please use additional pages as needed

Part 4 of 5 - Other Landowner Information

Please list the owner(s) of land under the permit who are not submitting the assignment and request for issuance of replacement water right permit.

Landowner Information

LANDOWNER/BUSINESS NAME BRIAN G. & GWENDOLYN MOSLEY THORNE / THORNE RANCH		MAP ID (LETTER OR NUMBER) 1	
MAILING ADDRESS 67029 S. NEWTON ROAD	CITY BURNS	STATE OR	ZIP 97720-9478
TOTAL NUMBER OF ACRES UNDER THE PERMIT (AS DEPICTED ON MAP) 155.4 AC	PROPORTIONATE RATE 1.9 CFS		

Landowner Information

LANDOWNER/BUSINESS NAME		MAP ID (LETTER OR NUMBER)	
MAILING ADDRESS	CITY	STATE	ZIP
TOTAL NUMBER OF ACRES UNDER THE PERMIT (AS DEPICTED ON MAP)	PROPORTIONATE RATE		

Landowner Information

LANDOWNER/BUSINESS NAME		MAP ID (LETTER OR NUMBER)	
MAILING ADDRESS	CITY	STATE	ZIP
TOTAL NUMBER OF ACRES UNDER THE PERMIT (AS DEPICTED ON MAP)	PROPORTIONATE RATE		

Landowner Information

LANDOWNER/BUSINESS NAME		MAP ID (LETTER OR NUMBER)	
MAILING ADDRESS	CITY	STATE	ZIP
TOTAL NUMBER OF ACRES UNDER THE PERMIT (AS DEPICTED ON MAP)	PROPORTIONATE RATE		

RECEIVED BY OWRD
RECEIVED BY OWRD

FEB 11 2016

JAN 15 2016

ACCEPTED

4-22-2016 *MA*

SALEM, OR

SALEM, OR

Part 5 of 5 – Permit Information

PERMIT # G-7124

Completion date of the permit: 10-01-1979

Name(s) currently appearing on permit: MEADOWLAND RANCHES, INC.

Type(s) of use as listed on permit: IR

Note: Type of use must be one or more of the following uses approved for assignment under ORS 537.225(1) and OAR 690-325-0010: irrigation, nursery, temperature control, stock watering, or agricultural water use.

Table 1. Location of Authorized Point(s) of Diversion (POD) or Appropriation (POA)

POD/POA Name or Number	If POA, OWRD Well Log ID# (or Well ID Tag # L-___)	Twp	Rng	Sec	¼ ¼	Tax Lot, DLC or Gov't Lot	Measured Distances (from a recognized survey corner)
Well #1	HARN1020	24 S	33 E	18	SE NW	4600	57'S & 393'E from NW corner of the SE ¼ NW ¼
Well#2	L-112479	24 S	33 E	18	NW NE	4601	32'N & 28.7'W from SE corner of the NW ¼ NE ¼
Well #3	HARN1019	24 S	33 E	18	SW SE	4601	42.7'S & 32.9'W from NE corner of the SW ¼ SE ¼
Well #4	HARN1026	24 S	33 E	18	NE SW	4601	60.5'N & 304.75'E from SW corner of the NE ¼ SW ¼
Well #5		24 S	33 E	18	SE NW	4600	72.3'N & 25.55'W from SE corner of the SE ¼ NW ¼

RECEIVED BY OWRD

FEB 11 2016

SALEM, OR

RECEIVED BY OWRD

JAN 15 2016

ACCEPTED

SALEM, OR

4-22-2016 *ma*

Please use additional pages of Table 2 as needed

Table 2. Description of Permit # G 7124.

List all parts of the permit (both assigned and unassigned). For the acreage or place(s) of use in each ¼ ¼, list the Map ID (letter or number from map and Parts 3 and 4) for each parcel. The acreage listed must equal the total acreage on the permit.

Description of Permitted Lands											
Twp	Rng	Sec	¼ ¼		Tax Lot	Gvt Lot or DLC	Acreage (if applicable)	Type of Use	POD(s) or POA(s) (name or number from Table 1)	Map ID (letter or number from map and Parts 3 and 4)	
2	S	9	E	15	NE NW	100	15.0	IR	POD #1	"A"	
2	S	9	E	15	NE NW	200	4.0	NI	POD #2	"B"	
↑ EXAMPLE ↑											
24	S	33	E	18		4600	1	34.8	IR		1
24	S	33	E	18		4600	2	35.9	IR		1
24	S	33	E	18		4601	3	35.9	IR		2
24	S	33	E	18		4601	4	34.8	IR		2
24	S	33	E	18	NE NW	4600		38.8	IR		1
24	S	33	E	18	SE NW	4600		40.0	IR	Wells 1 & 5	1
24	S	33	E	18	NE SW	4601		40.0	IR	Well 4	2
24	S	33	E	18	SE SW	4601		38.8	IR		2
24	S	33	E	18	NW NE	4601		35.9	IR	Well 2	2
24	S	33	E	18	SW NE	4601		37.0	IR		2
24	3	33	E	18	NE NE	4601		37.6	IR		2
24	S	33	E	18	SE NE	4601		38.8	IR		2
24	S	33	E	18	NW SE	4601		40.0	IR		2
24	S	33	E	18	SW SE	4601		38.8	IR	Well 3	2
24	S	33	E	18	NE SE	4601		38.8	IR		2
24	S	33	E	18	SE SE	4601		37.6	IR		2
24	S	33	E	18	NW NE	4600		2.9	IR		1
24	S	33	E	18	SW NE	4600		3.0	IR		1
TOTAL ACRES							609.4				

RECEIVED BY OWRD

FEB 11 2016

RECEIVED BY OWRD

SALEM, OR

JAN 15 2016

ACCEPTED

4-22-2016 MA

SALEM, OR

Permit #

Check the appropriate box, if applicable:

Check here if any portion of the permit is located within an irrigation or other water district.

IRRIGATION DISTRICT NAME	ADDRESS	
CITY	STATE	ZIP

Check here if water for any portion of the permit is supplied under a water service agreement or other contract for stored water with a federal agency or other entity.

ENTITY NAME	ADDRESS	
CITY	STATE	ZIP

Additional Remarks:

RECEIVED BY OWRD

FEB 11 2016

ACCEPTED

4-22-2016 MA

SALEM, OR

RECEIVED BY OWRD

JAN 15 2016

SALEM, OR

T24S, R33E, SECTION 18

HARNEY COUNTY, OREGON

T24S R32E
T24S R33E

07

RECEIVED BY OWRD

FEB 11 2016

SALEM, OR
13

RECEIVED BY OWRD

JAN 15 2016

SALEM, OR

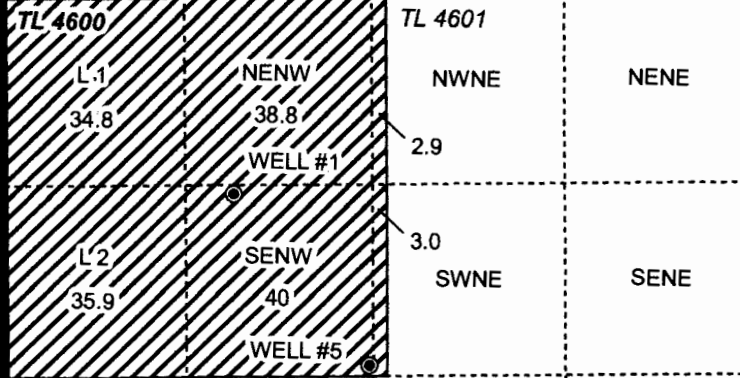

18

17

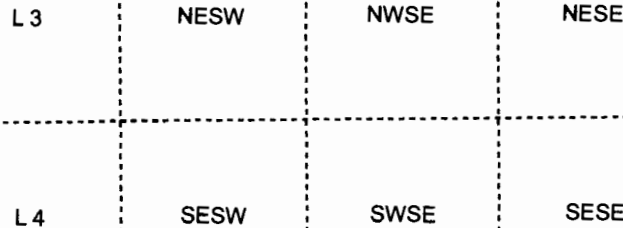

19

WELL:
#1: 57' S AND 393' E OF NW COR OF SE 1/4 OF NW 1/4 OF SEC 18
#5: 72.3' N AND 25.55' W OF SE COR OF SE 1/4 OF NW 1/4 OF SEC 18
Max Cumulative Rate = 1.9 cfs

ACCEPTED
4-22-2016 MA

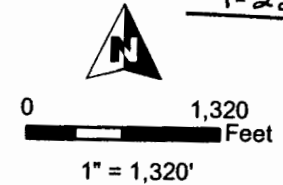

- POU Irrigation
- Township
- Section
- Quarter Quarter
- Tax Lot
- Well



RENEWAL DATE 12/31/2016

PERMIT SPLIT MAP
Thorne Ranch

NOTE: THIS MAP IS NOT INTENDED TO PROVIDE LEGAL DIMENSIONS OR LOCATIONS OF PROPERTY OWNERSHIP LINES.

WATER RIGHT SERVICES, LLC
PO BOX 1830, BEND, OR 97709
CCB# 197121 www.oregonwater.us
541-389-2837 JOHNSHORT@USA.COM

T24S, R33E, SECTION 18
HARNEY COUNTY, OREGON

ACCEPTED
 4-22-2016 *mt*

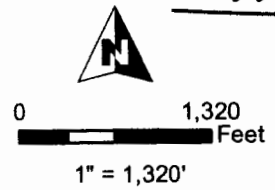

- POU Irrigation
- Township
- Section
- Quarter Quarter
- Tax Lot
- Well



RENEWAL DATE 12/31/2016

RECEIVED BY OWRD
 FEB 11 2016
 SALEM, OR
 13

RECEIVED BY OWRD
 JUN 15 2016
 SALEM, OR

WELL:
 #2: 32' N AND 28.7' W OF SE COR
 OF NW 1/4 OF NE 1/4 OF SEC 18
 #3: 42.7' S AND 32.9' W OF NE COR
 OF SW 1/4 OF SE 1/4 OF SEC 18
 #4: 60.5' N AND 304.75' E OF SW COR
 OF NE 1/4 OF SW 1/4 OF SEC 18
 Max Cumulative Rate = 5.6 cfs

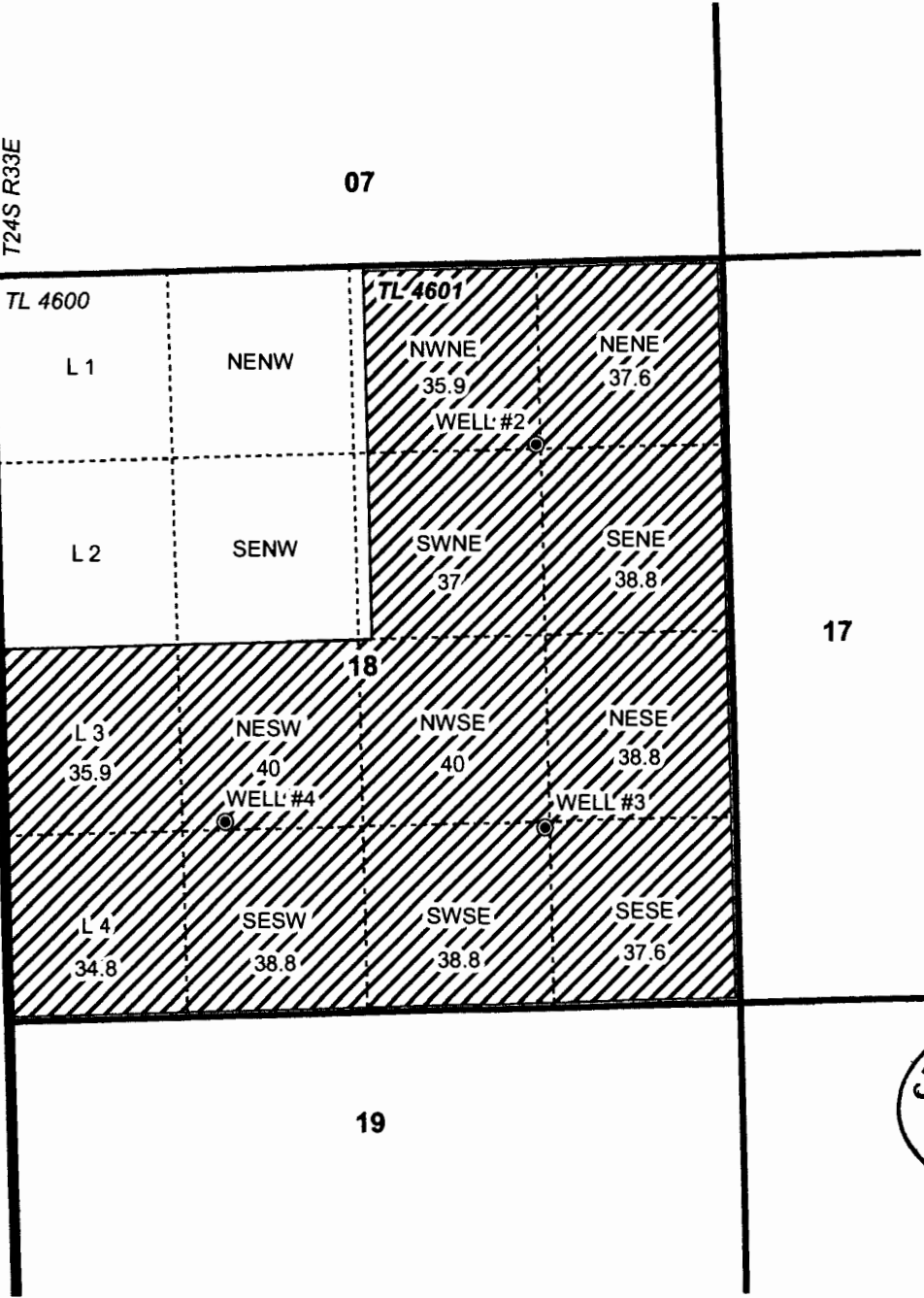

PERMIT SPLIT MAP
 Matthew Stashin

NOTE: THIS MAP IS NOT INTENDED TO
 PROVIDE LEGAL DIMENSIONS OR LOCATIONS
 OF PROPERTY OWNERSHIP LINES.

WATER RIGHT SERVICES, LLC
 PO BOX 1830, BEND, OR 97709
 CCB# 197121 www.oregonwater.us
 541-389-2837 JOHNSHORT@USA.COM



**Oregon Water Resources
Department**
725 Summer Street NE, Suite A
Salem, Oregon 97301-1266
(503) 986-0900
www.wrd.state.or.us

Application to Split A Permit and Request for Issuance of Replacement Permits

Affidavit of Non-Conveyance and Reading of Permit

State of Oregon)
) ss
County of _____)

I/We, MATTHEW STASHIN, mailing address 21762 SW MOUNTAIN HOME ROAD, SHERWOOD, OR 97140-8636, telephone number (503) 7644609, being first duly sworn depose and say:

1. Permit G - 7124, has not been conveyed or withheld and remains appurtenant to my/our land.
2. I/We attest that I/we have read Permit G - 7124.

Matthew Stashin

Signature of Affiant

1/13/16

Date

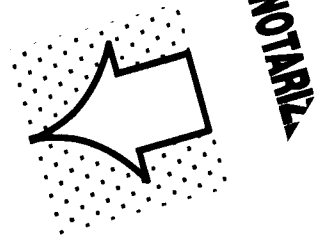

Signature of Affiant

Date

Signed and sworn to (or affirmed) before me this 13th day of January, 2016.

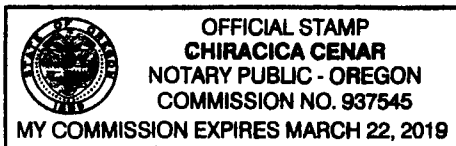

Am

Notary Public for Oregon

My Commission Expires: March 22, 2019

RECEIVED BY OWRD

FEB 11 2016

RECEIVED BY OWRD

JAN 15 2016

ACCEPTED

SALEM, OR

4-22-2016

SALEM, OR

RECEIVED

AUG 18 1975

WATER RESOURCES DEPT.
SALEM, OREGON

RECEIVED BY OWRD

FEB 11 2016

Permit No. G-7124

APPLICATION FOR A PERMIT

SALEM, OR

To Appropriate the Ground Waters of the State of Oregon

I, Meadowland Ranches Inc. (Name of applicant)

of Buchanan Route, Box 50, Burns, county of Harney (Postoffice Address)

state of Oregon 97720, do hereby make application for a permit to appropriate the following described ground waters of the state of Oregon, SUBJECT TO EXISTING RIGHTS:

If the applicant is a corporation, give date and place of incorporation

1962 Burns, Oregon

1. Give name of nearest stream to which the well, tunnel or other source of water development is situated Silvies River (Name of stream)

tributary of Malhuer Lake

2. The amount of water which the applicant intends to apply to beneficial use is 7.62 cubic feet per second or 3419 gallons per minute. Well no. 1 = 820 GPM, Well no. 2 = 820 GPM, Well no. 3 = 820 GPM, Well no. 4 = 820 GPM, and Well no. 5 = 139 GPM

3. The use to which the water is to be applied is irrigation

no. 1

4. The well or other source is located 57 ft. S and 393 ft. E from the NW corner of SE 1/4, NW 1/4, Sec. 18, T24S, R33E, W.M. (N. or S.) (E. or W.) (Section or subdivision)

(If preferable, give distances and bearing to section corners)

(see Remarks for additional wells)

(If there is more than one well, each must be described. Use separate sheet if necessary)

being within the SE 1/4 of the NW 1/4 of Sec. 18, Twp. 24S, R. 33E, W. M., in the county of Harney

5. The pipeline (Canal or pipe line) to be 1/4 miles in length, terminating in the anywhere in the NW 1/4 of Sec. 18, Twp. 24S, R. 33E, W. M., the proposed location being shown throughout on the accompanying map. (Smallest legal subdivision)

6. The name of the well or other works is Sloan Wells

DESCRIPTION OF WORKS

7. If the flow to be utilized is artesian, the works to be used for the control and conservation of the supply when not in use must be described.

5 wells, pipelines, and sprinklers.

(see remarks for data on wells nos. 2, 3, 4, & 5)

8. The development will consist of 5 wells, Well no. 1 having a diameter of 24 inches and an estimated depth of 300 feet. It is estimated that 300 feet of the well will require 12" steel casing. Depth to water table is estimated 6 ft. (Kind) (Feet)

0-20ft is sealed with conc., 20-300ft is 12" perforated casing. Well is gravel-packed.

ACCEPTED

4-22-2016

SP-7028-118

G1-3M

RECEIVED BY OWRD

JAN 15 2016

SALEM, OR

CANAL SYSTEM OR PIPE LINE—

9. (a) Give dimensions at each point of canal where materially changed in size, stating miles from headgate. At headgate: width on top (at water line) feet; width on bottom feet; depth of water feet; grade feet fall per one thousand feet.

(b) At miles from headgate: width on top (at water line) feet; width on bottom feet; depth of water feet; grade feet fall per one thousand feet.

Well no. 1:

(c) Length of pipe, 1260 ft.; size at intake 8 in.; in size at 200 ft. from intake 6 in.; size at place of use 6 in.; difference in elevation between intake and place of use, 3-6 ft. Is grade uniform? Yes Estimated capacity, 2 cubic sec. ft. (see remarks for other pipes)

10. If pumps are to be used, give size and type 4- 10 inch turbines, and 1- 6 inch turbine

Give horsepower and type of motor or engine to be used 4- 50hp electric, and 1- 10hp electric

11. If the location of the well, tunnel, or other development work is less than one-fourth mile from a natural stream or stream channel, give the distance to the nearest point on each of such channels and the difference in elevation between the stream bed and the ground surface at the source of development
none

12. Location of area to be irrigated, or place of use

Township N. or S.	Range E. or W. of Willamette Meridian	Section	Forty-acre Tract	Number Acres To Be Irrigated
T24S	R33E	18	Gov. Lot 1	34.8
			Gov. Lot 2	35.9
			Gov. Lot 3	35.9
			Gov. Lot 4	34.8
			NE 1/4, NW 1/4	38.8
			SE 1/4, NW 1/4	40.0
			NE 1/4, SW 1/4	40.0
			SE 1/4, SW 1/4	38.8
			NW 1/4, NE 1/4	38.8
			SW 1/4, NE 1/4	40.0
			NE 1/4, NE 1/4	37.6
			SE 1/4, NE 1/4	38.8
			NW 1/4, SE 1/4	40.0
			SW 1/4, SE 1/4	38.8
			NE 1/4, SE 1/4	38.8
			SE 1/4, SE 1/4	37.6
		total	609.4	

RECEIVED BY OWRD

FEB 11 2016

SALEM, OR

RECEIVED BY OWRD

(If more space required, attach separate sheet)

Character of soil Sandy Loam

Kind of crops raised hay, grain, and row crops

JAN 15 2016

SALEM, OR

ACCEPTED
4-22-2016 MA

MUNICIPAL SUPPLY—

13. To supply the city of
in county, having a present population of
and an estimated population of in 19.....

ANSWER QUESTIONS 14, 15, 16, 17 AND 18 IN ALL CASES

- 14. Estimated cost of proposed works, \$ 120,000.....
- 15. Construction work will begin on or before September 15, 1974.....
- 16. Construction work will be completed on or before September 1, 1975.....
- 17. The water will be completely applied to the proposed use on or before September 1, 1975.....
- 18. If the ground water supply is supplemental to an existing water supply, identify any application for permit, permit, certificate or adjudicated right to appropriate water, made or held by the applicant. None.....

Meadowland Ranches Inc.
By: Melvin V. Davenport
Melvin V. Davenport, Engineer

Remarks:

Well no. 2 is 24" in diameter and 333 ft deep; 14" casing 0-333ft, perforated 20-333ft, static water 8 ft. Well is located 32 ft N and 28.7 ft W of the SE Corner of the NW 1/4 of the NE 1/4, and is in that 40 acre tract. The pipe will terminate anywhere in the NE 1/4.

Well no. 3 is 24" in diameter and 369 ft deep; 14" casing 0-369 ft, perforated 20-369 ft, static water 9 ft. Well is located 42.7 ft S and 32.9 ft W of the NE Corner of the SW 1/4 of the SE 1/4 and is in that 40 acre tract. The pipe will terminate anywhere in the SE 1/4.

Well no. 4 is 24" in diameter and 320 ft deep; 12" casing 0-320 ft, perforated 20-320 ft, static water 10 ft. Well is located 60.5 ft N and 304.75 ft E of the SW Corner of the NE 1/4 of the SW 1/4 and is in that 40 acre tract. The pipe will terminate anywhere in the SW 1/4. The pipe layout for Wells nos. 2,3,4 is the same as for Well no. 1.

Well No. 5 is 24 " in diameter and approximately 200 feet deep: 12" casing 0 - apx.200 perforated 20- Apx. 200. Static Water 10 ft. Well is located 72.3 ft. N. and 25.55 ft. W. of the SE corner of the SE 1/4 of the NW 1/4 and is in that 40 acre tract. 500 ft. of 4" pipe will terminate in the SW 1/4 of the NE 1/4 and 500 ft. of pipe will terminate in the NE 1/4 of the SW 1/4.

All Wells sealed with concrete from 0 to 20 ft.

All Wells are located in Section 18, T24S, R33E, WM.

RECEIVED BY OWRD

JAN 15 2016

STATE OF OREGON, }
County of Marion, } ss.

SALEM, OR

This is to certify that I have examined the foregoing application, together with the accompanying maps and data, and return the same for

In order to retain its priority, this application must be returned to the State Engineer, with corrections on or before, 19.....

RECEIVED BY OWR

WITNESS my hand this day of, 19.....

FEB 11 2016

SALEM, OR

ACCEPTED

STATE ENGINEER

4-22-2016 MA

By ASSISTANT

STATE OF OREGON, }
County of Marion, } ss.

PERMIT
G 7124

This is to certify that I have examined the foregoing application and do hereby grant the same, SUBJECT TO EXISTING RIGHTS and the following limitations and conditions:

The right herein granted is limited to the amount of water which can be applied to beneficial use and shall not exceed 7.6 cubic feet per second measured at the point of diversion from the well or source of appropriation, or its equivalent in case of rotation with other water users, from 5 wells, 1.83 c.f.s. from each of wells No. 1, 2, 3, & 4 & 0.30 c.f.s. from well No. 5.

The use to which this water is to be applied is irrigation.

If for irrigation, this appropriation shall be limited to 1/80th of one cubic foot per second or its equivalent for each acre irrigated and shall be further limited to a diversion of not to exceed 3 acre feet per acre for each acre irrigated during the irrigation season of each year;

and shall be subject to such reasonable rotation system as may be ordered by the proper state officer.

The well shall be cased as necessary in accordance with good practice and if the flow is artesian the works shall include proper capping and control valve to prevent the waste of ground water.

The works constructed shall include an air line and pressure gauge or an access port for measuring line, adequate to determine water level elevation in the well at all times.

The permittee shall install and maintain a weir, meter, or other suitable measuring device, and shall keep a complete record of the amount of ground water withdrawn.

The priority date of this permit is August 18, 1975

Actual construction work shall begin on or before April 4, 1978 and shall thereafter be prosecuted with reasonable diligence and be completed on or before October 1, 1978

Complete application of the water to the proposed use shall be made on or before October 1, 1979

WITNESS my hand this 4th day of April, 1977.

Jane K. Sexton
WATER RESOURCES DIRECTOR

Application No. G- 7079
Permit No. G- G 7124

PERMIT
TO APPROPRIATE THE GROUND
WATERS OF THE STATE
OF OREGON

This instrument was first received in the
office of the State Engineer at Salem, Oregon,
on the 15th day of August,
1975, at 8 o'clock A. M.

Returned to applicant:

Approved:

Recorded in book No. _____ of
Ground Water Permits on page G 7124
STATE ENGINEER

Drainage Basin No. 12 page 35

RECEIVED BY OWRD
FEB 11 2016
SALEM, OR

RECEIVED BY OWRD
JAN 15 2016
SALEM, OR

4204
ACCEPTED
4-22-2016
WA



After recording return to:

Matthew Stashin

21762 SW Mountain Home Road

Sherwood, OR 97140

Until a change is requested all tax statements shall be sent to the following address:

Matthew Stashin

21762 SW Mountain Home Road

Sherwood, OR 97140

Escrow No. CT92999HC

Title No. 0021313

SWD r.020212

THIS SPACE RESER

HARNEY COUNTY, OR 2014-0102

DEEDWD

Total: \$46.00

01/31/2014 10:41 AM



00007398201400001020020020

I, Derrin Robinson, County Clerk for Harney County, Oregon certify that the instrument identified herein was recorded in the Clerk records.

Derrin Robinson

Derrin E. Robinson, Harney County Clerk



STATUTORY WARRANTY DEED

9L Farms LLC,

Grantor(s), hereby convey and warrant to

Matthew Stashin,

Grantee(s), the following described real property in the County of Harney and State of Oregon free of encumbrances except as specifically set forth herein:

A parcel of land located in Sec. 18, Twp. 24 S., R. 33 E., W.M., Harney County, Oregon, more particularly described as follows:

Parcel No. 2 of Partition Plat No. 08-06-227, recorded June 24, 2008, Instrument No. 20081104, Harney County Plat Records.

FOR INFORMATION PURPOSES ONLY, THE MAP/TAX ACCT #(S) ARE REFERENCED HERE:

Account #93259

TM 24 33 TL04601

The true and actual consideration for this conveyance is **PURSUANT TO AN IRC 1031 TAX DEFERRED EXCHANGE ON BEHALF OF GRANTOR/GRANTEE.**

The above-described property is free of encumbrances except all those items of record, if any, as of the date of this deed and those shown below, if any:

RECEIVED BY OWRD

FEB 11 2016

SALEM, OR

RECEIVED BY OWRD

JAN 15 2016

SALEM, OR

ACCEPTED

4-22-2016 *mt*

Page 2 - Statutory Warranty Deed - Signature/Notary Page
Escrow No. CT92999HC

BEFORE SIGNING OR ACCEPTING THIS INSTRUMENT, THE PERSON TRANSFERRING FEE TITLE SHOULD INQUIRE ABOUT THE PERSON'S RIGHTS, IF ANY, UNDER ORS 195.300, 195.301 AND 195.305 TO 195.336 AND SECTIONS 5 TO 11, CHAPTER 424, OREGON LAWS 2007, SECTIONS 2 TO 9 AND 17, CHAPTER 855, OREGON LAWS 2009, AND SECTIONS 2 TO 7, CHAPTER 8, OREGON LAWS 2010. THIS INSTRUMENT DOES NOT ALLOW USE OF THE PROPERTY DESCRIBED IN THIS INSTRUMENT IN VIOLATION OF APPLICABLE LAND USE LAWS AND REGULATIONS. BEFORE SIGNING OR ACCEPTING THIS INSTRUMENT, THE PERSON ACQUIRING FEE TITLE TO THE PROPERTY SHOULD CHECK WITH THE APPROPRIATE CITY OR COUNTY PLANNING DEPARTMENT TO VERIFY THAT THE UNIT OF LAND BEING TRANSFERRED IS A LAWFULLY ESTABLISHED LOT OR PARCEL, AS DEFINED IN ORS 92.010 OR 215.010, TO VERIFY THE APPROVED USES OF THE LOT OR PARCEL, TO DETERMINE ANY LIMITS ON LAWSUITS AGAINST FARMING OR FOREST PRACTICES, AS DEFINED IN ORS 30.930, AND TO INQUIRE ABOUT THE RIGHTS OF NEIGHBORING PROPERTY OWNERS, IF ANY, UNDER ORS 195.300, 195.301 AND 195.305 TO 195.336 AND SECTIONS 5 TO 11, CHAPTER 424, OREGON LAWS 2007, SECTIONS 2 TO 9 AND 17, CHAPTER 855, OREGON LAWS 2009, AND SECTIONS 2 TO 7, CHAPTER 8, OREGON LAWS 2010.

Dated this 29 day of Jan, 2014.

9L Farms LLC

BY: T. Vonne Leach
T. Vonne Leach, General Manager

State of Oregon
County of Clatsop

This instrument was acknowledged before me on Jan 29, 2014 by T. Vonne Leach, as General Manager of 9L Farms LLC.

Sondy R Wyss
(Notary Public for Oregon)

My commission expires 3-10-14

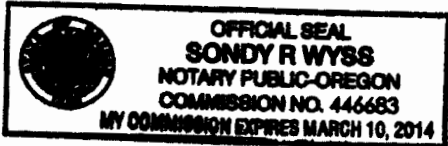

RECEIVED BY OWRD

FEB 11 2016

SALEM, OR

RECEIVED BY OWRD

JAN 15 2016

ACCEPTED

4-22-2016 MA

SALEM, OR