

PERMIT # G-16811

Table 1. Location of Authorized and Proposed Point(s) of Diversion (POD) or Appropriation (POA)
 (Note: If the POD/POA name is not specified in the permit, assign it a name or number here.)

POD/POA Name or Number	Is this POD/POA Authorized by the permit or is it Proposed?	If POA, OWRD Well Log ID# (or Well ID Tag # L-___)	Twp	Rng	Sec	1/4	Tax Lot, DEC or Gov't Lot	Measured Distances (from a recognized survey corner)
POA 1	<input type="checkbox"/> Authorized <input checked="" type="checkbox"/> Proposed	HARN 1336	26 S	30 E	16	NW SW	5000	Located 2464' N & 286' E from the SW cor, Sec 16
POA 9	<input type="checkbox"/> Authorized <input checked="" type="checkbox"/> Proposed	HARN 50472	26 S	30 E	10	SW SW	2300	Located 65' N & 1254' E from the SW cor, Sec 10
POA 7	<input type="checkbox"/> Authorized <input checked="" type="checkbox"/> Proposed	HARN 51973	26 S	30 E	16	NE NE	4900	Located 25' S & 320' W from the NE cor, Sec 16
POA 8	<input type="checkbox"/> Authorized <input checked="" type="checkbox"/> Proposed	HARN 52169	26 S	30 E	16	SE SE	5000	Located 600' N & 185' W from the SE cor, Sec 16

Check all type(s) of change(s) proposed below (change "CODES" are provided in parentheses):

- Place of Use (POU)
- Point of Diversion (POD)
- Additional Point of Diversion (APOD)
- Point of Appropriation/Well (POA)
- Additional Point of Appropriation (APOA)
- Surface water POD to Ground Water POA (SW/GW)

Will all of the proposed changes affect the entire water use permit?

- Yes Complete only the proposed ("to" lands) section of Table 2 on the next page. Use the "CODES" listed above to describe the proposed changes.
- No Complete all of Table 2 to describe the portion of the permit to be changed.

For a change in place of use:

Does the permit holder of record own or control the land TO which the place of use is being moved?

- Yes No

If NO, the landowner of the land TO which the place of use is being moved must be assigned to the permit as a permit holder of record by submitting a completed Request for Assignment form and the required statutory fee for an assignment.

Is the proposed place of use contiguous to the authorized place of use? Yes No

The permitted place of use can be moved only to lands that are contiguous to the authorized place of use unless the change to non-contiguous lands is in furtherance of mitigation or conservation efforts undertaken for the purposes of benefiting a species listed as sensitive, threatened, or endangered under ORS 496.171 to 496.192 or the federal Endangered Species Act of 1973 (16 U.S.C. 1531 to 1544), as determined by the listing agency. Contiguous land being either adjacent land or land separated from the land to which a permit is authorized by roads, utility corridors, irrigation ditches or publicly owned highways.

RECEIVED

FEB 01 2016

OWRD

Please use and attach additional pages of Table 2 as needed.
See page 6 for instructions.

Do you have questions about how to fill-out the tables?
Contact the Department at 503-986-0900 and ask for Transfer Staff.

Revised

Table 2. Description of Changes to Water Use Permit # G-16811

List the change proposed for the acreage in each 1/4 1/4. If more than one change is proposed, specify the acreage associated with each change.
If there is more than one POD/POA involved in the proposed changes, specify the acreage associated with each POD/POA.

AUTHORIZED (the "from" or "off" lands) The listing that appears on the certificate BEFORE PROPOSED CHANGES										PROPOSED (the "to" or "on" lands) The listing as it would appear AFTER PROPOSED CHANGES										
Twp	Rng	Sec	1/4	1/4	Tax Lot	Gvt Lot or DLC	Acreage (if applicable)	POD(s) or POA(s) (name or number from Table 1)	Priority Date	Proposed Changes (see "CODES" from previous page)	Twp	Rng	Sec	1/4	1/4	Tax Lot	Gvt Lot or DLC	Acreage (if applicable)	POD(s) or POA(s) to be used (from Table 1)	Priority Date
26 S	30 E	17	NE	NE	5100		31.4	5 & 6	2009	POU, APOA, POA	26 S	30 E	17	NE	NE	5100		32.0	1,9,7,&8	2009
26 S	30 E	17	NW	NE	5100		31.4	5 & 6	2009	POU, APOA, POA	26 S	30 E	17	NW	NE	5100		29.2	1,9,7,&8	2009
26 S	30 E	17	SW	NE	5100		31.4	5 & 6	2009	POU, APOA, POA	26 S	30 E	17	SW	NE	5100		32.3	1,9,7,&8	2009
26 S	30 E	17	SE	NE	5100		31.4	5 & 6	2009	POU, APOA, POA	26 S	30 E	17	SE	NE	5100		36.0	1,9,7,&8	2009
26 S	30 E	17	NE	NW	5200		40.0	5 & 6	2009	POU, APOA, POA	26 S	30 E	17	NE	NW	5200		21.8	1,9,7,&8	2009
26 S	30 E	17	NW	NW	5200		37.8	5 & 6	2009	POU, APOA, POA	26 S	30 E	17	NW	NW	5200		37.2	1,9,7,&8	2009
26 S	30 E	17	SW	NW	5200		37.8	5 & 6	2009	POU, APOA, POA	26 S	30 E	17	SW	NW	5200		39.5	1,9,7,&8	2009
26 S	30 E	17	SE	NW	5200		40.0	5 & 6	2009	POU, APOA, POA	26 S	30 E	17	SE	NW	5200		37.6	1,9,7,&8	2009
26 S	30 E	18	NE	NE	5200		5.0	5 & 6	2009	POU, APOA, POA	26 S	30 E	18	NE	NE	5200		12.2	1,9,7,&8	2009
26 S	30 E	18	SE	NE	5200		5.0	5 & 6	2009	POU, APOA, POA	26 S	30 E	18	SE	NE	5200		13.4	1,9,7,&8	2009
TOTAL ACRES										TOTAL ACRES										
291.2										291.2										

Additional remarks: Wells 5 & 6 are being replaced by Wells 1 & 9. Wells 7 & 8 are additional.

RECEIVED

FEB 01 2016

OWWRD

Revised

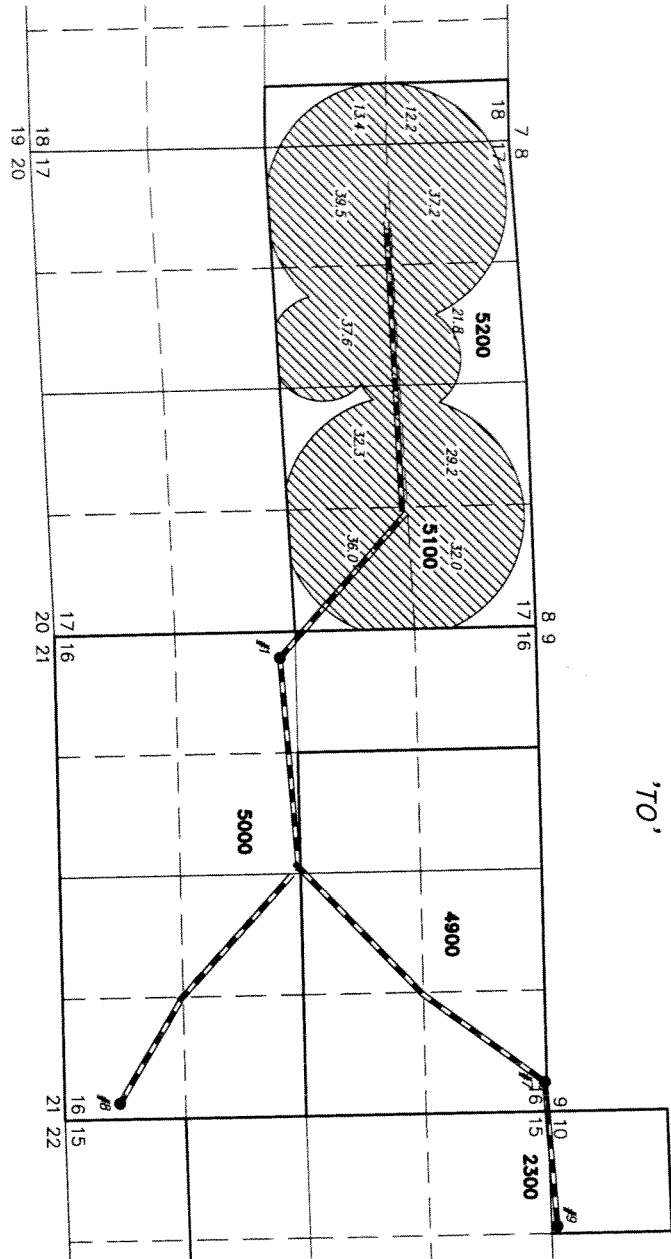
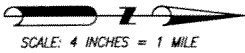

PERMIT AMENDMENT MAP
FOR GROUND WATER PERMIT
APPLICATION G-17189
CHARLES & LOUANNA EGGERT
TOWNSHIP 26 SOUTH, RANGE 30 EAST, SECTIONS 17 & 18, W.M.
TAX LOTS: 2300, 4900, 5000, 5100, & 5200
'TO'

RECEIVED
FEB 01 2016
OWRPD

THIS MAP IS FOR THE PURPOSE OF DESIGNING AN IRRIGATION SYSTEM PLAN AND HAS NO INTENT TO PROVIDE LEGAL DIMENSIONS OR THE LOCATION OF PROPERTY LINES

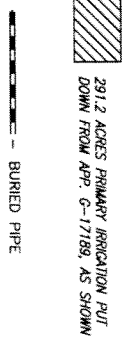

- POA 1 (HARN 1336)
EXISTING WELL TO BE TRANSFERRED IN THE NW 1/4 OF THE SW 1/4 OF SECTION 16 LOCATED 2464 FEET NORTH AND 286 FEET EAST FROM THE SW CORNER.
- POA 9 (HARN 50472)
EXISTING WELL TO BE TRANSFERRED IN THE SW 1/4 OF THE SW 1/4 OF SECTION 10, LOCATED 65 FEET NORTH AND 1254 FEET EAST FROM THE SW CORNER OF SECTION.
- POA 7 (HARN 519723)
EXISTING WELL TO BE TRANSFERRED IN THE NE 1/4 OF THE NE 1/4 OF SECTION 16, LOCATED 23 FEET SOUTH AND 320 FEET WEST FROM THE NE CORNER.
- POA 8 (HARN 52169)
EXISTING WELL TO BE TRANSFERRED IN THE SE 1/4 OF THE SE 1/4 OF SECTION 16 LOCATED 800 FEET NORTH AND 165 FEET WEST FROM THE SE CORNER.

PROJECT No. 15-067

PREPARED AT THE REQUEST OF:
CHARLES EGGERT
9955 SW POTANO ST.
TUALITIN, OR 97062



ALL POINTS ENGINEERING & SURVEYING, INC.
P.O. BOX 767
TERREBONNE, OREGON 97760
(541) 548-5833 PH
Scott@APEandS.com
www.APEandS.com

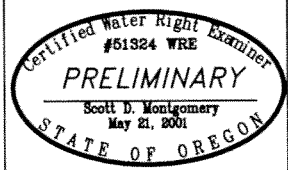

RENEWAL DATE: 12/31/2016