

Revised page 7 T-12496

*LA*

Please use a separate Part 5 for each water right being changed. See instructions on page 6, to copy and paste additional Part 5s, or to add additional rows to tables within the form.

**CERTIFICATE # 35454**

RECEIVED

**Description of Water Delivery System**

System capacity: 3 cubic feet per second (cfs) OR  
 \_\_\_\_\_ gallons per minute (gpm)

NOV 28 2016

OWRD  
 SALEM, OREGON

Describe the current water delivery system or the system that was in place at some time within the last five years. Include information on the pumps, canals, pipelines and sprinklers used to divert, convey and apply the water at the authorized place of use. **30 HP electric pump with portable pipelines and impact sprinklers. POD 1 is actually used for this right**

**Table 1. Location of Authorized and Proposed Point(s) of Diversion (POD) or Appropriation (POA)**  
 (Note: If the POD/POA name is not specified on the certificate, assign it a name or number here.)

POD/POA Name or Number	Is this POD/POA Authorized on the Certificate or is it Proposed?	If POA, OWRD Well Log ID# (or Well ID Tag # L-___)	Twp		Rng		Sec		¼ ¼		Tax Lot, DLC or Gov't Lot	Measured Distances (from a recognized survey corner)
4	<input checked="" type="checkbox"/> Authorized <input type="checkbox"/> Proposed		27	S	6	W	4		SE	NW	7	4330 ft. N & 300 ft. E. from the interior corner on the west boundary of McKinney DLC 50
1	<input type="checkbox"/> Authorized <input checked="" type="checkbox"/> Proposed		27	S	6	W	4		NE	NW	7	1315 ft. S & 2315 ft. E from the NW cor. Sec. 4
2	<input type="checkbox"/> Authorized <input checked="" type="checkbox"/> Proposed		27	S	6	W	4		NE	NW	8	1080 ft. S. & 2175 ft. E. from the NW cor. Sec. 4
3	<input type="checkbox"/> Authorized <input checked="" type="checkbox"/> Proposed		27	S	6	W	5		NE	NE	1	20 ft. S. & 650 ft. W. from the NE Cor. Sec. 5

**Check all type(s) of change(s) proposed below (change "CODES" are provided in parentheses):**

- Place of Use (POU)  Supplemental Use to Primary Use (S to P)
- Character of Use (USE)  Point of Appropriation/Well (POA)
- Point of Diversion (POD)  Additional Point of Appropriation (APOA)
- Additional Point of Diversion (APOD)  Substitution (SUB)
- Surface Water POD to Ground Water POA (SW/GW)  Government Action POD (GOV)

**Will all of the proposed changes affect the entire water right?**

- Yes Complete only the Proposed ("to" or "on" lands) section of Table 2 on the next page. Use the "CODES" listed above to describe the proposed changes.
- No Complete all of Table 2 to describe the portion of the water right to be changed.

*KS*

Please use a separate Part 5 for each water right being changed. See instructions on page 6, to copy and paste additional Part 5s, or to add additional rows to tables within the form.

**CERTIFICATE # 91507**

RECEIVED

NOV 28 2016

OWRD  
SALEM, OREGON

**Description of Water Delivery System**

System capacity: .3 cubic feet per second (cfs) OR  
\_\_\_\_\_ gallons per minute (gpm)

Describe the current water delivery system or the system that was in place at some time within the last five years. Include information on the pumps, canals, pipelines and sprinklers used to divert, convey and apply the water at the authorized place of use. **30 HP electric pump with portable pipelines and impact sprinklers. POD 1 is actually used for this right**

**Table 1. Location of Authorized and Proposed Point(s) of Diversion (POD) or Appropriation (POA)**  
(Note: If the POD/POA name is not specified on the certificate, assign it a name or number here.)

POD/POA Name or Number	Is this POD/POA Authorized on the Certificate or is it Proposed?	If POA, OWRD Well Log ID# (or Well ID Tag # L-___)	Twp		Rng		Sec	¼ ¼		Tax Lot, DLC or Gov't Lot	Measured Distances (from a recognized survey corner)
4	<input checked="" type="checkbox"/> Authorized <input type="checkbox"/> Proposed		27	S	6	W	4	SE	NW	7	1620 ft. S & 140 ft. W. from the N1/4 Corner of Section 4
1	<input type="checkbox"/> Authorized <input checked="" type="checkbox"/> Proposed		27	S	6	W	4	NE	NW	7	1315 ft. S & 2315 ft. E from the NW cor. Sec. 4
2	<input type="checkbox"/> Authorized <input checked="" type="checkbox"/> Proposed		27	S	6	W	4	NE	NW	8	1080 ft. S. & 2175 ft. E. from the NW cor. Sec. 4
3	<input type="checkbox"/> Authorized <input checked="" type="checkbox"/> Proposed		27	S	6	W	5	NE	NE	1	20 ft. S. & 650 ft. W. from the NE Cor. Sec. 5

**Check all type(s) of change(s) proposed below (change "CODES" are provided in parentheses):**

- Place of Use (POU)  Supplemental Use to Primary Use (S to P)
- Character of Use (USE)  Point of Appropriation/Well (POA)
- Point of Diversion (POD)  Additional Point of Appropriation (APOA)
- Additional Point of Diversion (APOD)  Substitution (SUB)
- Surface Water POD to Ground Water POA (SW/GW)  Government Action POD (GOV)

**Will all of the proposed changes affect the entire water right?**

- Yes Complete only the Proposed ("to" or "on" lands) section of Table 2 on the next page. Use the "CODES" listed above to describe the proposed changes.
- No Complete all of Table 2 to describe the portion of the water right to be changed.

*AA*

Please use a separate Part 5 for each water right being changed. See instructions on page 6, to copy and paste additional Part 5s, or to add additional rows to tables within the form.

**CERTIFICATE # 43742**

RECEIVED

**Description of Water Delivery System**

NOV 28 2010

System capacity: 0.3+ cubic feet per second (cfs) OR  
 \_\_\_\_\_ gallons per minute (gpm)

OWRD  
 SALEM, OREGON

Describe the current water delivery system or the system that was in place at some time within the last five years. Include information on the pumps, canals, pipelines and sprinklers used to divert, convey and apply the water at the authorized place of use. **30 HP electric pump with portable pipelines and impact sprinklers.**

**Table 1. Location of Authorized and Proposed Point(s) of Diversion (POD) or Appropriation (POA)**  
 (Note: If the POD/POA name is not specified on the certificate, assign it a name or number here.)

POD/POA Name or Number	Is this POD/POA Authorized on the Certificate or is it Proposed?	If POA, OWRD Well Log ID# (or Well ID Tag # L-___)	Twp	Rng	Sec	¼ ¼	Tax Lot, DLC or Gov't Lot	Measured Distances (from a recognized survey corner)
1	<input checked="" type="checkbox"/> Authorized <input checked="" type="checkbox"/> Proposed		27 S	6 W	4	NE NW	7	1315 ft. S & 2315 ft. E from the NW cor. Sec. 4
2	<input type="checkbox"/> Authorized <input checked="" type="checkbox"/> Proposed		27 S	6 W	4	NE NW	8	1080 ft. S. & 2175 ft. E. from the NW cor. Sec. 4
3	<input type="checkbox"/> Authorized <input checked="" type="checkbox"/> Proposed		27 S	6 W	5	NE NE	1	20 ft. S. & 650 ft. W. from the NE Cor. Sec. 5
	<input type="checkbox"/> Authorized <input type="checkbox"/> Proposed							

**Check all type(s) of change(s) proposed below (change "CODES" are provided in parentheses):**

- Place of Use (POU)  Supplemental Use to Primary Use (S to P)
- Character of Use (USE)  Point of Appropriation/Well (POA)
- Point of Diversion (POD)  Additional Point of Appropriation (APOA)
- Additional Point of Diversion (APOD)  Substitution (SUB)
- Surface Water POD to Ground Water POA (SW/GW)  Government Action POD (GOV)

**Will all of the proposed changes affect the entire water right?**

- Yes Complete only the Proposed ("to" or "on" lands) section of Table 2 on the next page. Use the "CODES" listed above to describe the proposed changes.
- No Complete all of Table 2 to describe the portion of the water right to be changed.

Revised map T-12496  
11/17/2016

# TRANSFER APPLICATION MAP

## MAP 1 OF 2 TRANSFER FROM

*JR*

CERTIFICATES: 35454, 43742, 49118, 49020, 61946 & 91507  
Township 26 & 27 South, Range 6 West, W.M.  
Douglas County, Oregon

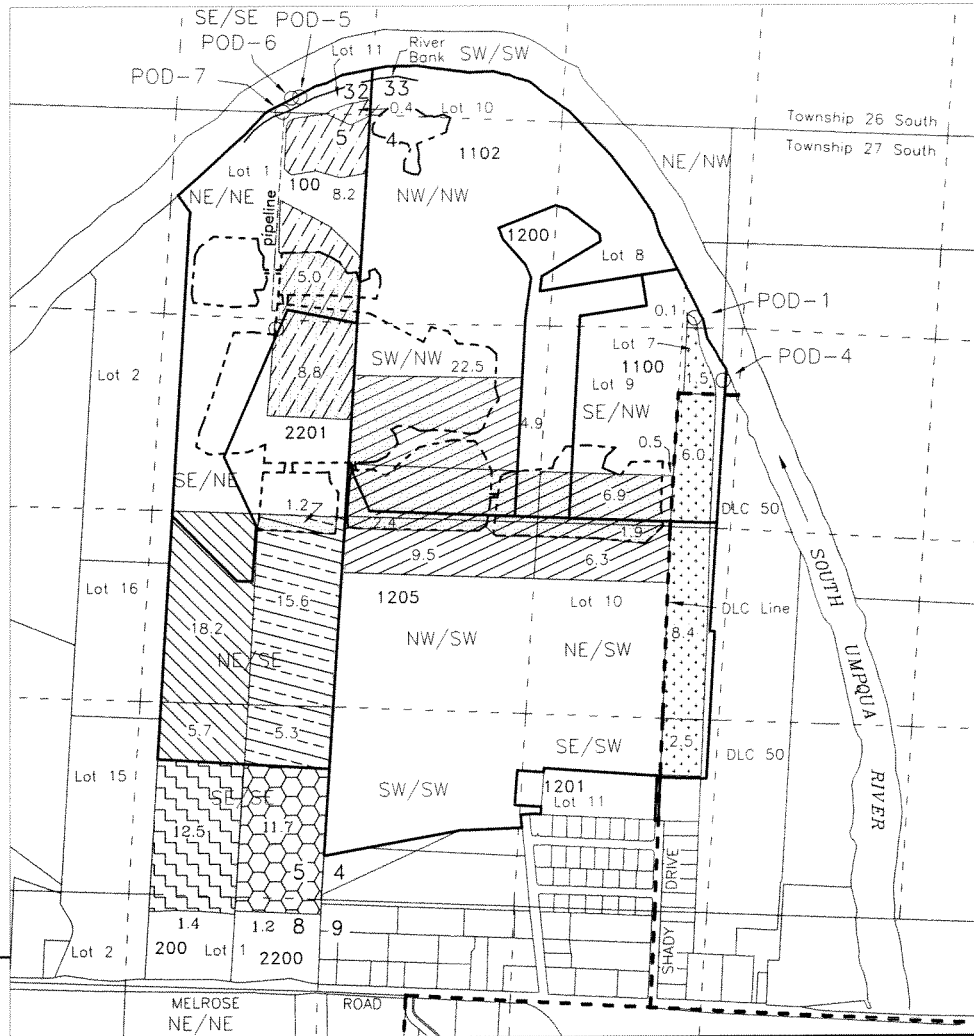

RECEIVED  
NOV 28 2016  
OWFRD  
SALEM, OREGON

For purpose of locating POD's, Cardinal directions are in reference from point of beginning extending along section or DLC boundary lines

Scale  
1" = 1320'

TRANSFER				APPLICANT	AUTHORIZED POD		
POD #	Use PI Use (A)POD	Rem. Right	APOD Only	GUIDO LAND & EQUIPMENT CO., LLC 640 SHADY DRIVE ROSEBURG, OR 97471	CALLAHAN RIDGE, LLC & 640 SHADY DRIVE ROSEBURG, OR 97471		
○ 4	18.5			POD-4 - Lot 7 (SE/NW) Section 4, 4330 ft. N. & 300 ft. E. from Interior corner on west boundary of McKinney DLC 50 (C-35454, C-91507)			
○ 1	21.2	33.7		POD-1 - Lot 7 (NE/NW) Section 4, 1315 ft. S & 2315 ft. E. from the NW corner Section 4 (C-43742)			
○ 5	8.6	13.8		POD-5 - SE/SE Section 32, 110 ft. N. & 490 ft. W. from the SE corner of Section 32 (C-49020)			
○ 6	20.9	1.2	12.9	POD-6 - SE/SE Section 32, 100 ft. N. & 540 ft. W. from the SE corner of Section 32 (C-49118)			
○ 7	23.9		13.9	POD-7 - Lot 1 (NE/NE) Section 5, 600 ft. W. from the NE corner Section 5 (C-61946)			
				TL-200 & 2200 { Guido Rentals, LLC 3077 Garden Valley Road Roseburg, OR 97471			
				Base Map: Douglas County GIS data with May 2014 Oregon Map aerial photo overlay for assumed best fit			

JORDAN ENGINEERING  
460 JORDAN LANE  
ROSEBURG, OR 97471  
(541) 673-1931  
Rev. 8/26/2014 n.e.d.  
Rev. 4/6/2015 n.e.d.  
Rev. 5/26/2015 n.e.d.  
Rev. 8/11/2015 n.e.d.  
Rev. 6/29/2016 n.e.d.  
Rev. 8/3/2016 n.e.d.  
Rev. 11/17/2016 n.e.d.

This map is not intended to provide legal dimensions or locations of property ownership lines

Revised map T-12496  
11/17/2016

# TRANSFER APPLICATION MAP

## MAP 2 OF 2 TRANSFER TO

*KA*

CERTIFICATES: 35454, 43742, 49118, 49020, 61946 & 91507

Township 26 & 27 South, Range 6 West, W.M.  
Douglas County, Oregon

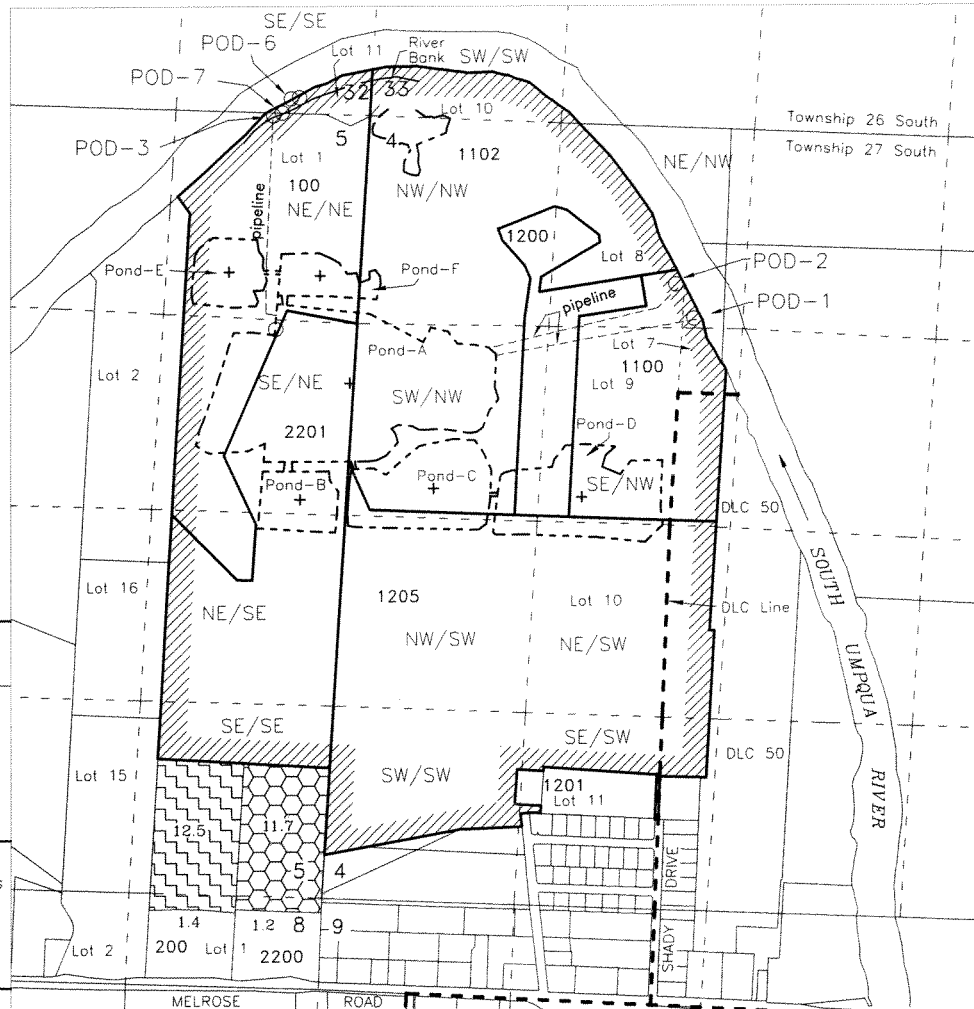

**RECEIVED**  
 NOV 28 2016  
 OWRD  
 SALEM, OREGON

POD's for change to Quasi-Municipal
C-35454 - POD-1,2,3
C-91507 - POD-1,2,3
C-43742 - POD-1,2,3
C-49118 - POD-3
C-49020 - POD-3
C-61946 - POD-3
For purpose of locating POD's, Cardinal directions are in reference from point of beginning extending along section or DLC boundary lines

ADDITIONAL POINTS OF DIVERSION	MELROSE NE/NE ROAD
--------------------------------	--------------------

- POD-1 - Lot 7 (NE/NW) Section 4, 1315 ft. S & 2315 ft. E. from the NW corner Section 4 (35454, C-43742)
- POD-2 - Lot 8 (NE/NW) Section 4, 1080 ft. S & 2175 ft. E. from the NW corner Section 4 (C-43742, C-35454)
- POD-3 - NE/NE Section 5, 20 Feet South & 650 ft. W. from the NE Corner, Section 5 (C-35454, C-43742, C-49118, C-49020, C-61946)
- POD-6 - SE/SE Section 32, 100 ft. N. & 540 ft. W. from the SE corner of Section 32 (C-49020)
- POD-7 - Lot 1 (NE/NE) Section 5, 600 ft. W. from the NE corner Section 5 (C-61946)

APPLICANT	
GUIDO LAND & EQUIPMENT CO., LLC 640 SHADY DRIVE ROSEBURG, OR 97471	CALLAHAN RIDGE, LLC 640 SHADY DRIVE ROSEBURG, OR 97471

	Proposed Place of Use, Quasi-Municipal Use - POD 1, 2 & 3 (see table above)
	Irrigation- POD-3, 6 (C-49020) } Guido Rentals, LLC 3077 Garden Valley Road Roseburg, OR 97471
	Irrigation- POD-3, 7 (C-61496) }

Scale  
1" = 1320'

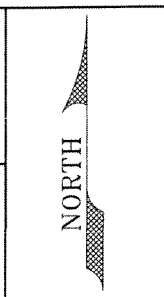

This map is not intended to provide legal dimensions or locations of property ownership lines

Base Map: Douglas County GIS data with May 2014 Oregon Map aerial photo overlay for assumed best fit

**JORDAN ENGINEERING**  
460 JORDAN LANE  
ROSEBURG, OR 97471  
(541) 673-1931

Rev. 8/26/2014 n.e.d.  
Rev. 4/6/2015 n.e.d.  
Rev. 8/11/2015 n.e.d.  
Rev. 6/29/2016 n.e.d.  
Rev. 11/17/2016 n.e.d.