



State of Oregon
Water Resources Department
725 Summer Street NE, Suite A
Salem, Oregon 97301-1266
(503) 986-0900

Application for District Instream Lease

Part 1 of 4 – Minimum Requirements Checklist

This Application to be used for water rights in the name of or conveyed by an Irrigation District (or similar organization) Complete Parts 1 through 4 and any required attachments	OWRD #	1L-1592
	District #	

Check all items included with this application. (N/A = Not Applicable)

Yes N/A Pooled Lease—a lease with more than one Lessor (Landowner/water right interest holder)
Fee in the amount of:

<input type="checkbox"/> \$450.00 for a lease involving four or more landowners or four or more water rights	Or <input checked="" type="checkbox"/> \$300.00 for all other leases
<input type="checkbox"/> Check enclosed or	Deschutes River Cons. (Account name)
<input checked="" type="checkbox"/> Fee Charged to customer account	

Part 1 –

Completed Minimum Requirements Checklist

Part 2 – Completed District and Other Party Signature Page

Part 3 – Completed Place of Use and Lessor Signature Page
(Include a separate Part 3 for each Lessor.)

Part 4 – Completed Water Right and Instream Use Information
(Include a separate Part 4 for each Water Right.)

How many Water Rights are included in the lease application? 1 (# of rights)

List each water right to be leased instream here: 74145

Yes N/A Other water rights, if any, appurtenant to the lands involved in the lease application and not proposed to be leased instream.

List those other water rights here: _____

Yes No Conservation Reserve Enhancement Program CREP—Are some or all of the lands to be leased part of CREP or another Federal program (list here: _____)?

Required Attachments:

Yes N/A Instream lease application map(s). More than one QQ and property may be included on each map. A map is not required if an entire right is being leased or if the right is for use of municipal or quasi-municipal water use. The map should include the following:

- A north arrow and map scale (no smaller than 1" = 1320').
- Label township, range, section and quarter-quarter (QQ).
- If an irrigation right, the numbers of acres to be leased in each quarter-quarter identify and hachure/shade to differentiate between the acreage being leased and any remaining. If the place of use has more than one priority date, source stream, and/or point of diversion you must identify each with separate hachuring or shading and label.
- Tax lot lines and numbers must be included on the map and should clearly identify the property(s) involved.

Yes N/A If the Lessor(s) is not the deeded land owner, include one of the following:

- A notarized statement from the land owner consenting to the lease and a copy of the recorded deed; or
- A water right conveyance agreement and a copy of the recorded deed for the landowner at the time the water right was conveyed; or
- Other documentation.

Yes N/A If the right has not been used in the last five years; provide supporting documentation indicating why a right (or portion thereof) is not subject to forfeiture.

Part 2 of 4 – District and other party Signature

Term of the Lease: The lease is requested to begin in: month <u>April</u> year <u>2017</u> and end: month <u>Oct 25</u> year <u>2017</u> .	
Public use: Check the public use(s) this lease will serve (as defined by ORS 537.332): <input checked="" type="checkbox"/> Conservation, maintenance and enhancement of aquatic, fish and wildlife, fish and wildlife habitat and any other ecological values. <input checked="" type="checkbox"/> Recreation <input checked="" type="checkbox"/> Pollution abatement <input type="checkbox"/> Navigation	Termination provision (for multiyear leases): The parties to the lease request (choose one): <input type="checkbox"/> a. The option of terminating the lease prior to expiration of the full term with written notice to the Department by the Lessor(s) and/or Lessee. <input type="checkbox"/> b. The option of terminating the lease prior to expiration of the full term, with consent by all parties to the lease. <input type="checkbox"/> c. The parties would not like to include a Termination Provision. (See instructions for limitations to this provision)
Additive/Replacing Relationship to other instream water rights: Instream leases are generally additive to other existing instream water rights created as a result of instream leases and transfers and/or allocations of conserved water. Since instream leases are also generally senior to other instream rights created through a state agency process or conversion of minimum flows, they generally replace a portion of these junior instream rights. If you would like this lease to relate to other instream water rights differently than described above, please check this box. <input type="checkbox"/> And attach an explanation of your intent.	
Precedent: If a right which has been leased is later proposed to be leased again or later transferred or become part of an allocation of conserved water project, a new injury review shall be required. An instream lease shall not set a precedent on a future transaction.	
Validity of the rights to be leased: <input checked="" type="checkbox"/> The water right(s) to be leased have been used under the terms and conditions of the right(s) during the last five years or have been leased instream; or <input type="checkbox"/> The water right(s) have not been used for the last five years according to the terms and conditions of the rights. However, the water right(s) is not subject to forfeiture under ORS 540.610(2). Documentation describing why the water right is not subject to forfeiture has been provided.	

SIGNATURES

The undersigned declare that the information contained in this application is true and accurate.



Date: 3/8/17

Signature of Co-Lessor

Printed name (and title): Jer Camarata, GENERAL MANAGER
 Business/Organization name: Swalley Irrigation District
 Mailing Address (with state and zip): 64672 Cook Ave., Ste. 1, Bend, OR 97703
 Phone number (include area code): 541-388-0658 **E-mail address: kathy@swalley.com (contact person)

Date: _____

Signature of Co-Lessor

Printed name (and title): _____
 Business/organization name: _____
 Mailing Address (with state and zip): _____
 Phone number (include area code): _____ **E-mail address: _____

RECEIVED BY OWRD

MAR 15 2017

SALEM, OR

See next page for additional signatures.

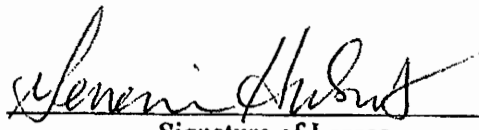
Signature of Lessee

Date: 3/9/17

Printed name (and title): Genevieve Hubert, Program Manager

Business/organization name: Deschutes River Conservancy

Mailing Address (with state and zip): 700 NW Hill St., Suite 1, Bend, OR 97703

Phone number (include area code): 541-382-4077 **E-mail address: gen@deschutesriver.org

**** BY PROVIDING AN E-MAIL ADDRESS, CONSENT IS GIVEN TO RECEIVE ALL CORRESPONDENCE FROM THE DEPARTMENT ELECTRONICALLY. COPIES OF THE FINAL ORDER DOCUMENTS WILL ALSO BE MAILED TO THE LESSOR**

RECEIVED BY OWRD

MAR 15 2017

SALEM, OR

Part 3 of 4 – Place of Use – Lessor Information and Signatures

**Complete Table 1. Identify water right(s) proposed to be leased instream
Provide a separate Part 3 for each Lessor (water right interest holder/landowner)**

Table 1

Irrigation District or other Water Purveyor Name: Swalley Irrigation District

Specify Water Right, Priority Date, point of diversion(s) (POD), place of use, tax lot, gov't lot/DLC, acres to be leased, original use type, certificate page number, and any previous lease:

If not enough room below, you may add rows (see instructions) or create a spreadsheet/table (matching Table 1) and attach.
Any attached table should include reference to the Lessor.

Water Right #	Priority Date	POD #	Twp	Rng	Sec	Q-Q	Tax Lot	Gov't Lot/DLC #	Acres	Use	Page #	Previous Lease #
74145	9-1-1899	3	17	12	07	NE	00100		9.46	Irr	15	
74145	9-1-1899	3	17	12	07	SE	00100		19.48	Irr	15	

Any additional information about the right: _____

Farm Deferral Tax Status: Counties make the determination of whether a property qualifies for the farm use assessment without consideration of whether the lands have an associated water right which is leased instream. If you have questions regarding the farm use assessment you should contact your local county assessor. You should contact your County for any weed ordinance and management requirements.

The undersigned declare:

- I/We agree during the term of this lease to suspend use of water allowed under the water right(s) involved in the lease as well as and any other appurtenant primary or supplemental water right(s); and
- I/We certify are the lessor(s) (water right interest holder) of the water right(s) in Table 1. If not the deced land owner, I/we have obtained consent from the deced land owner and/or have provided documentation of authorization to pursue the instream lease; and
- I/We affirm that the information in this application is true and accurate.

 _____ Date: 3/7/2017

Signature of Lessor

Printed name (and title): Donald Cochran Business name, if applicable: DRP Properties
 Mailing Address (with state and zip): 18624 Penshurst Rd Bend, OR 9701
 Phone number (include area code): _____ **E-mail address: _____

 Date: _____

Signature of Lessor

Printed name (and title): _____ Business name, if applicable: _____
 Mailing Address (with state and zip): _____
 Phone number (include area code): _____ **E-mail address: _____

District Instream Lease Application (revised 2/12/2014)

RECEIVED BY CLERK

Page 4

MAR 15 2017

SALEM, OR

Part 4 of 4-Water Right and Instream Use Information

Use a separate Part 4 for each water right to be leased instream

Table 2

Use Table 2 to illustrate the totals for the water right proposed to be leased instream (based on Part 3 of 4) Water Right #74145

Total rate and volume by priority date, POD, use and acreage as appropriate considering the right to be leased. If not enough room below, you may add rows (see instructions) or create a spreadsheet (matching Table 2 and clearly labeled) and attach.
(cfs = cubic feet per second and af = acre-feet)

Priority Date	POD #	Use	Acre	Other Information (such as conditions/limitations on the right)	Rate (cfs)	Volume (af)
9-1-1899	3-mai	IRR	28.94	Season 1	.221	191.39
				Season 2	.296	
				Season 3	.558	

Total af from storage, if applicable: _____ AF or N/A

If the POD is not described on the certificate or, if there is more than one POD listed on the certificate, then the specific POD must be described:

Table 3

Instream Use created by the lease River Basin: Deschutes River/Stream Name: Deschutes, tributary to Columbia

Proposed Instream Reach: Or Proposed Instream Point:
 A reach typically begins at the POD and ends at the mouth of the source stream: From the POD 3-Main Canal to the mouth of the Deschutes River
 Instream use protected at the POD

OR Please check this box if you are not sure of the proposed reach and want water to be protected within a reach below the POD, if possible. If no reach is identified or the above box is not checked, and there is only one POD listed on the water right, the lease may be processed to be protected at the POD.)

Instream Portion: May not exceed the maximum rate/volume for the right (identified in Table 2)

Use the table 3 to illustrate the instream rate, volume and instream period by priority date, POD, Use and acreage, as appropriate. If not enough room below, you may add rows (see instructions) or create a spreadsheet (clearly labeled and matching the below portion of Table 3) and attach.

Priority date	POD #	Use	Acre	Proposed Instream Period	Instream Rate (cfs)	Total instream volume (af)
9-1-1899	3-Ma	IRR	28.94	Season 1	.199	158.03
				Season 2	.266	
				Season 3	.493	

OR Please check this box if you are not sure of the proposed rate, volume and instream period. As part of its review process, the Department will identify the appropriate instream rate, volume and period considering the water right(s) being leased and instream benefits.

Yes N/A **Conditions to avoid enlargement or injury to other water rights, if any, or other limitations:** list here Instream Lease - April 1- Oct 25

Note: The Department may identify additional conditions to prevent injury and/or enlargement.

RECEIVED BY OWRD

Any additional information about the proposed instream use: _____

District Instream Lease Application (revised 2/12/2014)

RECEIVED BY OWRD

MAR 15 2017

SALEM, OR

Swalley Irrigation District Application for Instream Lease

Cert #: 74145
For: Ron Cochran

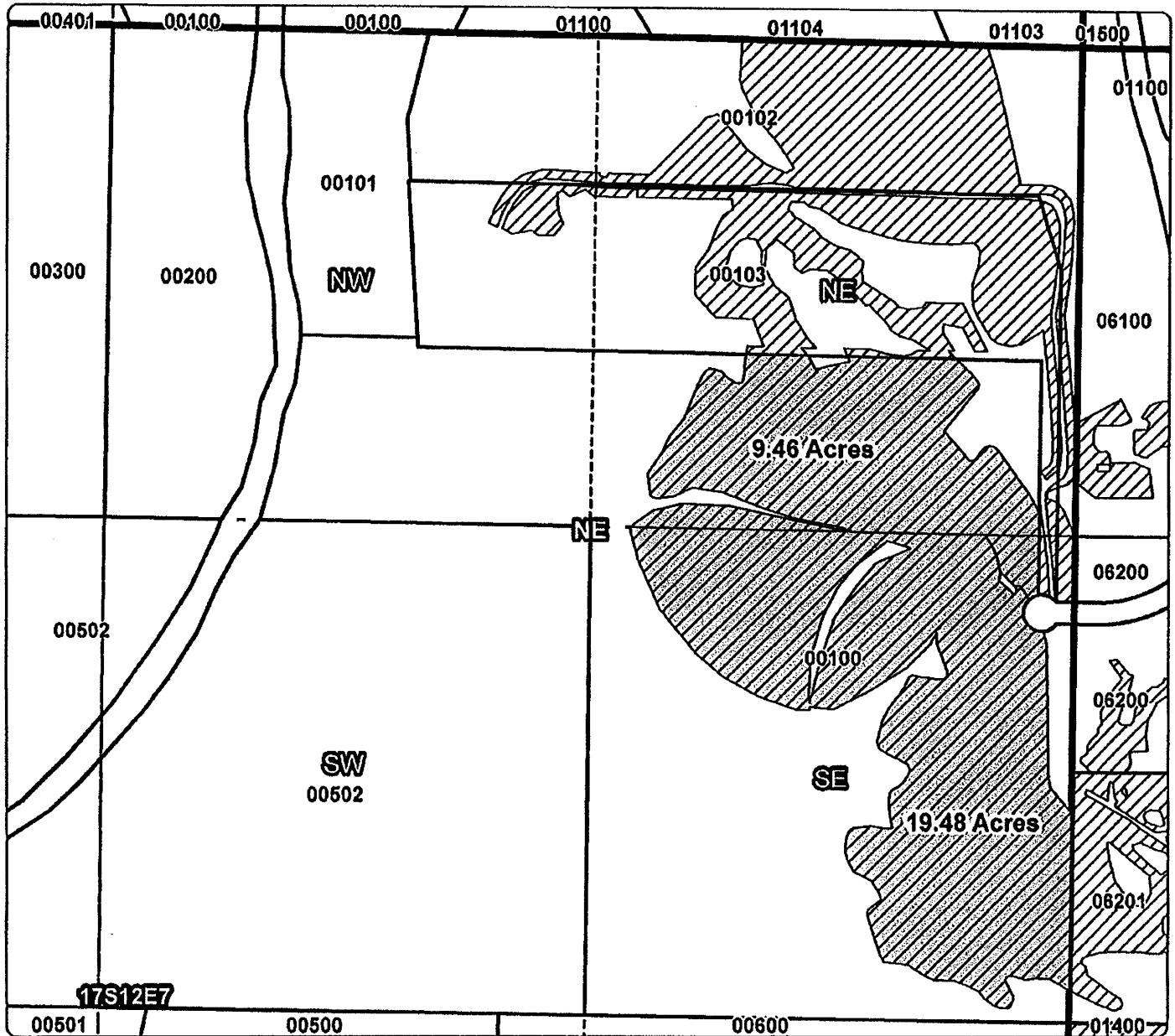
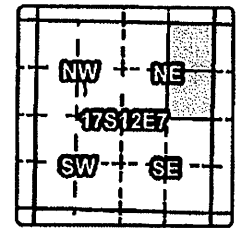

1 YEAR INSTREAM LEASE MAP

Taxlot 00100, 17S12E7NENE: 9.46 Acres Leased
Taxlot 00100, 17S12E7SENE: 19.48 Acres Leased

- Point of Diversion
- TTT Canals
- Taxlots
- ▨ Lease
- ▧ Cert 74145

RECEIVED BY OWRD

MAR 15 2017

SALEM, OR

1 inch = 400 feet
March 2017

