



State of Oregon
 Water Resources Department
 725 Summer Street NE, Suite A
 Salem, Oregon 97301-1266
 (503) 986-0900

Allocation of Conserved Water

60-Day Notice of Use or Disposition for Applicant's Portion of Conserved Water For CW _____

Applicant Information

APPLICANT/BUSINESS NAME*			PHONE NO.	ADDITIONAL CONTACT NO.
EGM, LLC c/o Greg Fries, member			503-538-3199	503-710-1263 (CELL)
ADDRESS				FAX NO.
PO BOX 429				NA
CITY	STATE	ZIP	E-MAIL	
DUNDEE	OR	97115	GREG@DUCKPONDCELLARS.COM	

* Applicant must be the same person(s)/entity as listed in the Finalization Order.

The Applicant provides this notice 60 days prior to changes being made to the utilization of the Applicant's Portion of Conserved Water.

List the portion of the conserved water allocated to the Applicant as listed in the Finalization Order recorded at Special Order Volume _____, Page _____.

Applicant's Portion of Conserved Water	
Maximum Rate (CFS)	Maximum Duty (Volume)/AF
0.76	151.65

RECEIVED BY OWRD

JAN 11 2017

N/A All or part of the Applicant's portion of the conserved water is to be:

SALEM, OR

Leased (If water is to be temporarily leased instream, a separate Instream Lease Application and appropriate fee must be submitted);

Reserved instream for future out-of-stream use (temporary);

Dedicated instream (permanent);

Used out-of-stream.

Applicant's Conserved Water					Applicant's Conserved Water Remaining	
Certificate	Priority	Type of Use	Rate (CFS)	Volume (AF)	CFS	Volume
91450	12/21/55	Irr	0.76	151.65	0	0
Totals			0.76	151.65	0	0

Pursuant to ORS 537.490 and OAR 690-019-0090, the applicant is providing this notice 60 days prior to the following changes being made:

Place of use (must be within the area identified in the Finalization Order (OAR 690-018-0050(4)(h)).

Point of diversion;

Type of use, from _____ to _____. The season of use is to be: _____ to _____;

Revert from use at place of use previously identified to being managed instream within the reach identified in the Finalization Order.

Describe the point of diversion that will be used to deliver water to the new place of use:

Twp	Rng	Mer	Sec	Q-Q	Measured Distances
25S	6W	WM	30	SWSW	305' S. & 1560' E. fr NW COR, DLC 38

Name and address of the person using the water: Applicant

Description of the type of beneficial use of the water: Irrigation

Description of the place of use:

Applicant's Conserved Water Out-of-Stream Use Location											
Priority Date	Twp		Rng		Sec	¼	¼	Tax Lot	Gvt Lot or DLC	Acres	Type of Use
1/1/1865	2	S	9	E	15	NE	NW	100	Example	153.0	Irrigation
	See	Atta	ched	Sheet							
Total											

- N/A The terms of any agreement between the Applicant and the person using the conserved water. Attach a copy of the agreement, or explain the terms of the agreement: _____
- N/A A map depicting the lands identified above that meets the standards in OAR 690-310-0050 (required if out-of-stream use table completed).
- N/A Land Use Information Form with approval and signature. Land use form not required if any of the following apply:
- Water is to be diverted, conveyed, and/or used only on federal lands.
 - All of the following apply: a) a change in place of use only, b) no structural changes, c) the use of water is for irrigation only, and d) the use is located within an irrigation district or an exclusive farm use zone.
- N/A The water right has been sold. The contact information for the new owner is: : _____

Dated: 1-9-2017

Greg FRIER
(Printed Applicant Name)

(Printed Applicant Name)

[Signature]
(Applicant's signature)

(Applicant's signature)

RECEIVED BY OWRD

JAN 11 2017

SALEM, OR

T25&26S, R6&7W, WM
DOUGLAS COUNTY

R7W
R6W



Scale: 1" = 1320'

Legend

- POD
- PUMP
- Meter
- Roads
- Stream
- Pipeline
- Line
- Flow Arrow
- ACW Prop POU, 156.9 Ac
- Cert 91450, 12-21-1955 131.3 Ac
- Meander
- Gov Lot
- Township
- DLC
- Section
- Quarter
- Sixteenth
- Parcels

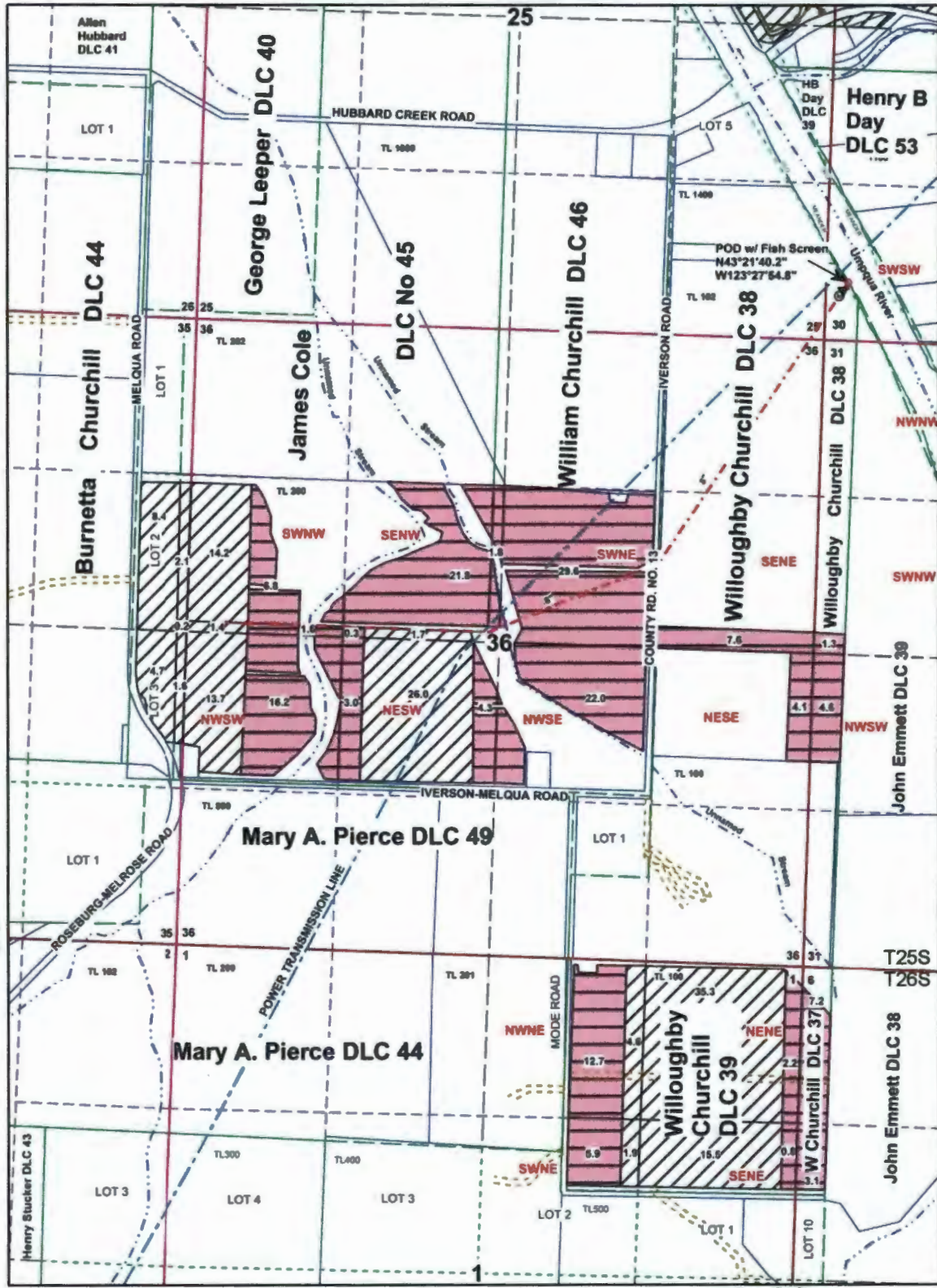

T25S
T26S

T25S
T26S

R7W
R6W

POD LOCATED SWSW, SEC 30, T25S, R6W, AS PROJECTED WITHIN WILLOUGHBY CHURCHILL DLC NO. 38 BEING 1530 FEET EAST AND 250 FEET SOUTH FROM THE NW COR OF WILLOUGHBY CHURCHILL DLC NO. 38

FINAL
APPLICATION ALLOCATION OF CONSERVED WATER
FOR
EGM, LLC

THE PURPOSE OF THIS MAP IS TO IDENTIFY THE LOCATION OF THE WATER RIGHT. IT IS NOT INTENDED TO PROVIDE INFORMATION RELATIVE TO THE LOCATION OF PROPERTY OWNERSHIP BOUNDARY LINES.

MAP PREPARED BY:
NATHAN R. REED, P.E., CWRE
1113 SE CASS AV
ROSEBURG, OR 97470

RECEIVED BY OWRD

JAN 11 2017

SALEM, OR