

MAP TO ACCOMPANY APPLICATION
TO CHANGE PLACE OF USE
AND POINT OF APPROPRIATION
FOR
ROBERT M. COOK

Taxlot
ALL IN TAX LOT 400
IN THE EAST HALF OF SECTION 35, TOWNSHIP 14 SOUTH,
RANGE 4 WEST, W.M.
LINN COUNTY, OREGON

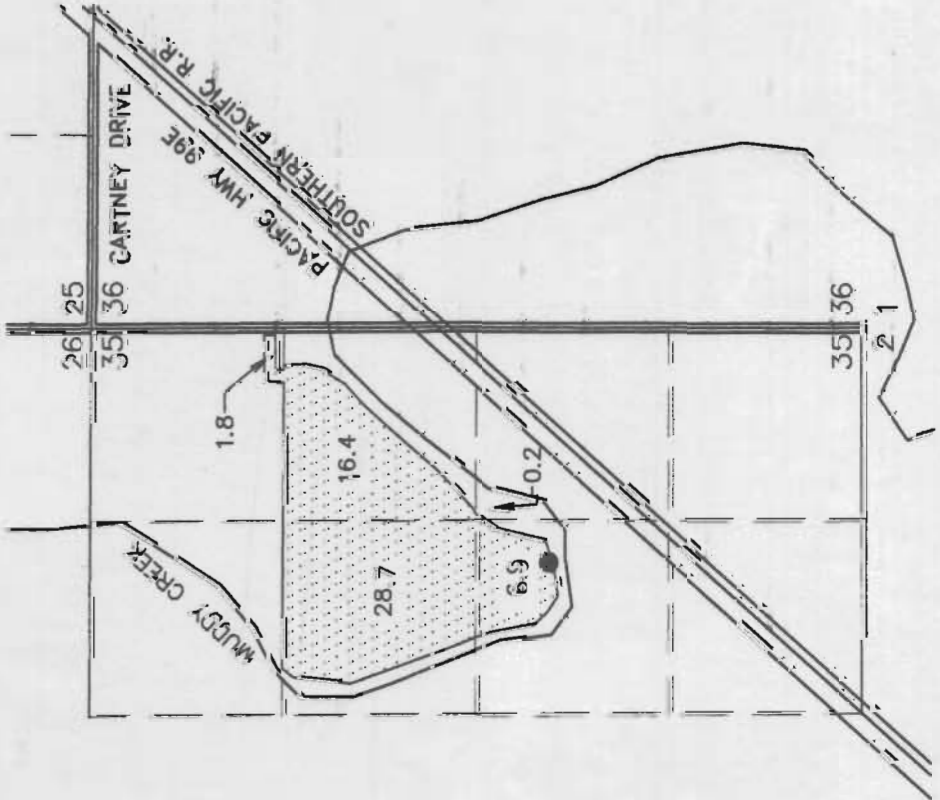

54.0 ACRES FROM 3-17510 (CERT# 76691) TRANSFERRED,
AS SHOWN.

P.O.D. FROM PERMIT 17510 IN THE EAST HALF OF SECTION 35
AND 3150 FT SOUTH AND 1610 FEET WEST FROM THE NE
CORNER OF SECTION 35.

Taxlot
TAX LOTS 100 AND 200
IN THE WEST HALF OF SECTION 30,
TOWNSHIP 14 SOUTH, RANGE 3 WEST, W.M.
AND
TAX LOT 400
IN THE SOUTHEAST QUARTER OF SECTION 25,
TOWNSHIP 14 SOUTH, RANGE 4 WEST, W.M.
LINN COUNTY, OREGON

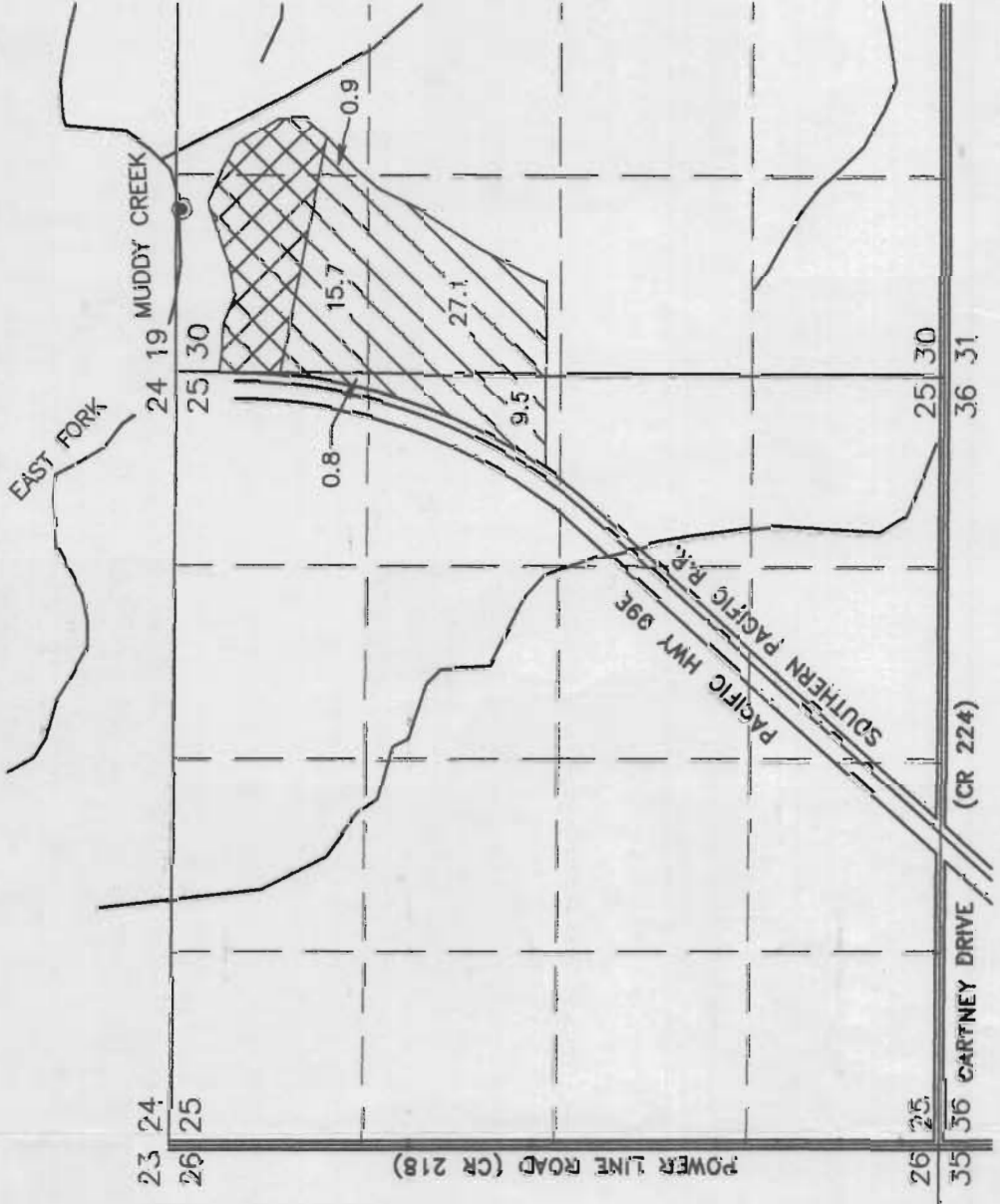

AREA FROM PERMIT 50921 (CERT# 80835) REMAINS, AS
SHOWN.

54.0 ACRES FROM S-17310 (CERT# 76691) TRANSFERRED,
AS SHOWN.

P.O.D. LOCATED IN THE NW 1/4 NW 1/4 SECTION 30 AND 1120
EAST AND 40 FEET SOUTH FROM THE NW CORNER OF SECTION 30.



RECEIVED
JUL 27 2008
WATER RESOURCES DEPT.
SALEM, OREGON

THIS MAP IS FOR THE PURPOSE OF LOCATING A WATER RIGHT ONLY AND HAS NO
INTENT TO PROVIDE LEGAL DIMENSIONS OF THE LOCATION OF PROPERTY LINES.

Certified Water Right Examiner
#64324 WRE
7/10/08
Scott D. Montgomery
May 21, 2001
STATE OF OREGON

ALL POINTS ENGINEERING
& SURVEYING, INC.
P.O. BOX 767 (CRR)
TERREBONNE, OREGON 97760
(541) 548-5833 PH
(541) 585-4602 FX
www.AllPoints.com

PROJECT No. 08-042
PREPARED AT THE REQUEST OF:
ROBERT M. COOK
32041 CARTNEY DRIVE
HARRISBURG, OR 97446

RENEWAL DATE: 12/31/2008