

**T27S, R34E,  
SECTIONS 4 & 9, WM  
HARNEY COUNTY, OREGON**

**WELL LOCATIONS:**

WELL #1 & METER: 1,302' S, 1,302' W OF NE COR SEC 9  
 WELL #2 & METER: 590' S, 1,345' E OF NW COR SEC 9  
 WELL #3 & METER: 505' N, 730' W OF SE COR SEC 9  
 WELL #4: 2,140' N, 1,125' E OF SW COR SEC 9

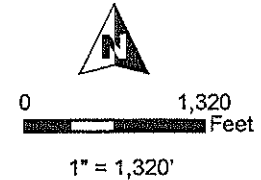
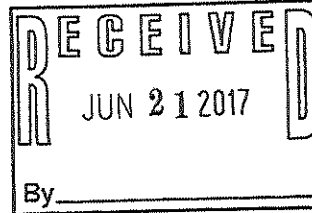

- POU Transfer ON
- Section
- Quarter Quarter
- Tax Lot
- Well



RENEWAL DATE 12/31/2018

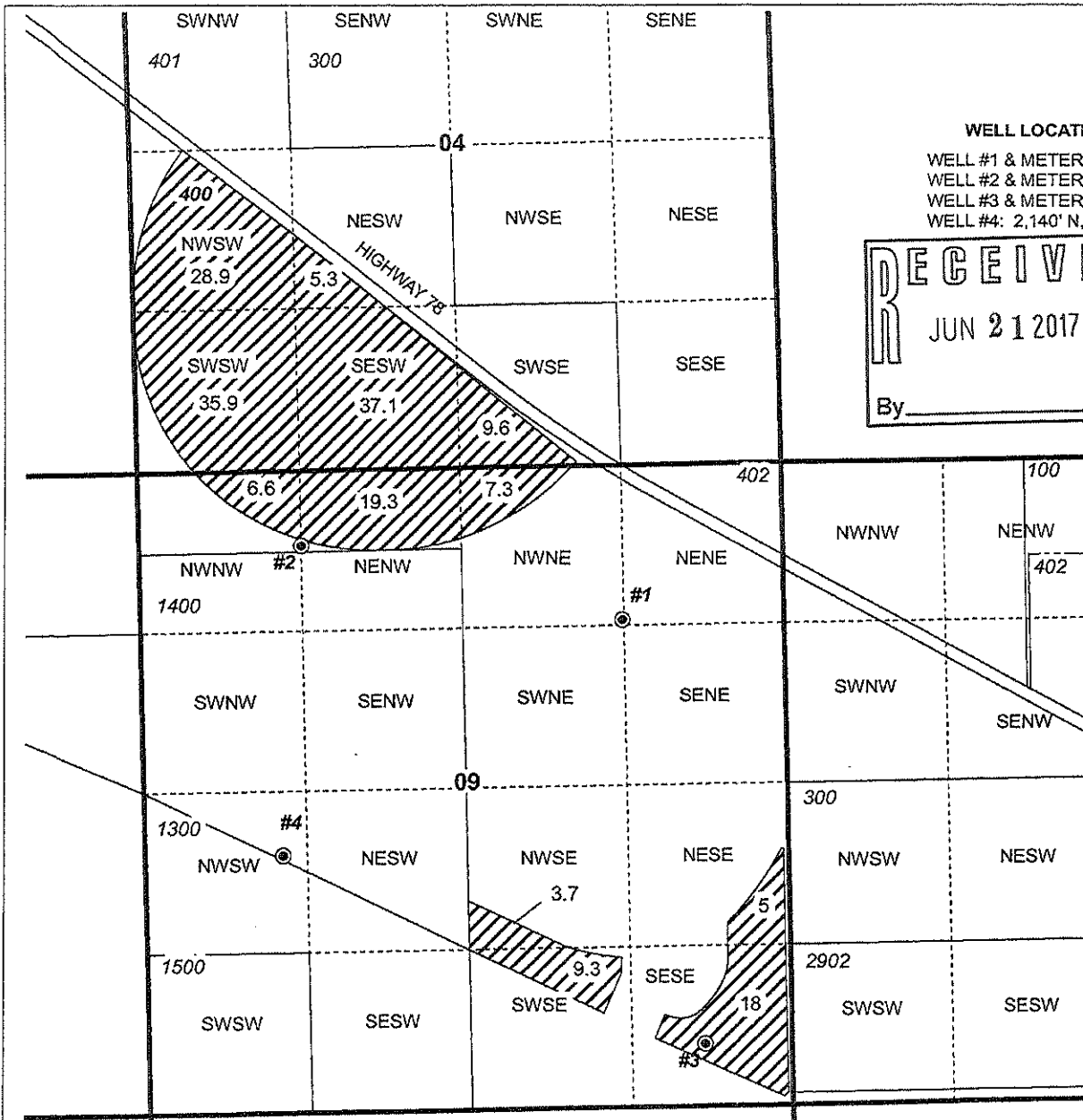

**TRANSFER "ON" MAP**  
**Golden Rule Farms, Inc. / Indian Head**  
 CERTIFICATES 91366 & 91448

NOTE: THIS MAP IS NOT INTENDED TO  
 PROVIDE LEGAL DIMENSIONS OR LOCATIONS  
 OF PROPERTY OWNERSHIP LINES.  
 PAGE 1 OF 2      JUNE 20, 2017

**WATER RIGHT SERVICES, LLC**  
 PO BOX 1830, BEND, OR 97709  
 CCB# 197121    www.oregonwater.us  
 541-389-2837    JOHNSHORT@USA.COM





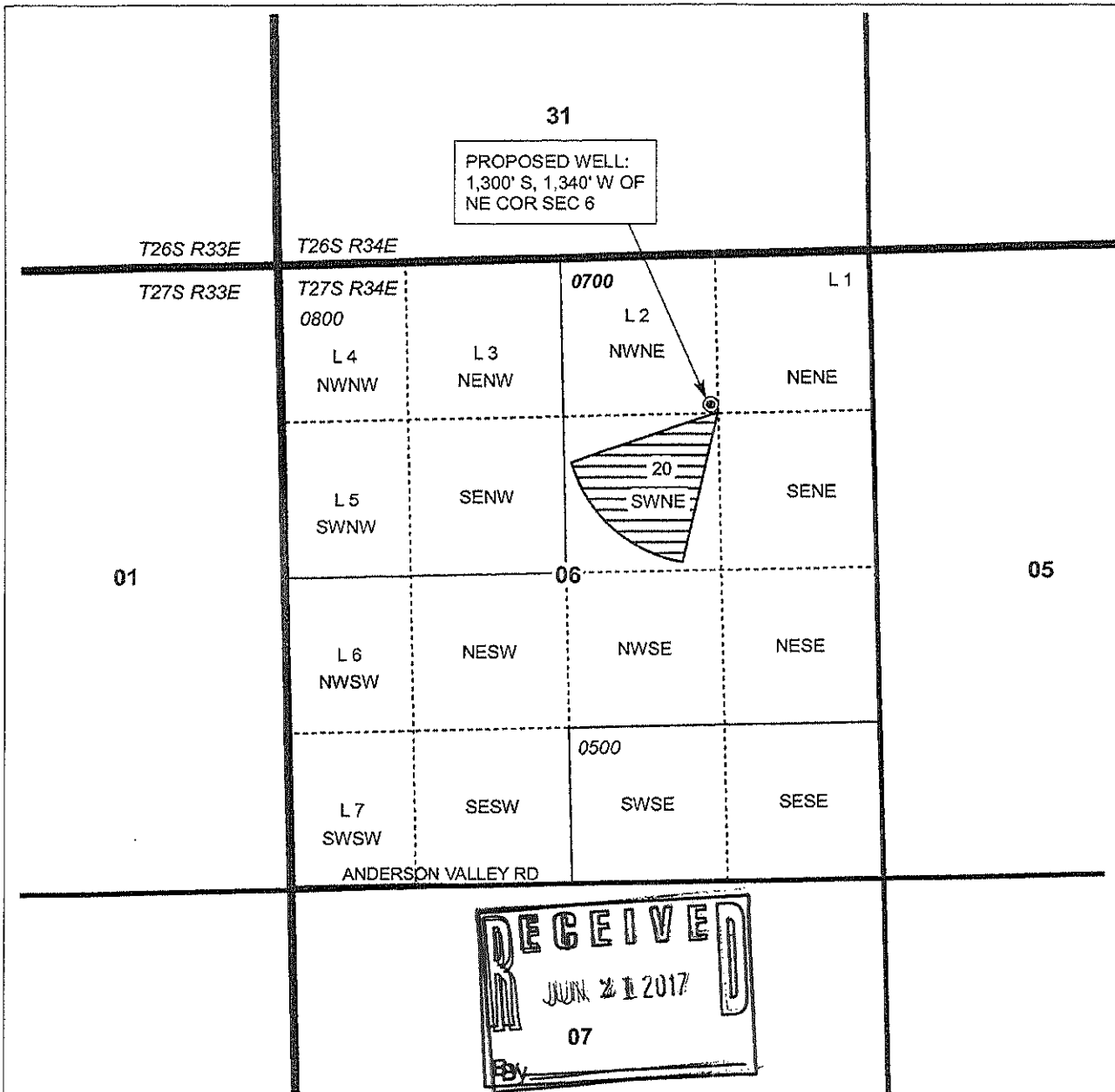

**T27S, R34E,  
SECTION 6, WM**

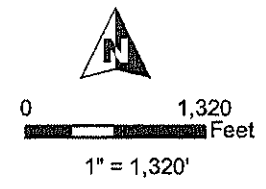
HARNEY COUNTY, OREGON



PROPOSED WELL:  
1,300' S, 1,340' W OF  
NE COR SEC 6



-  POU Transfer ON
-  Township
-  Section
-  Quarter Quarter
-  Tax Lot
-  Well



RENEWAL DATE 12/31/2018

**RECEIVED**  
JUN 21 2017  
07  
By \_\_\_\_\_

**TRANSFER "ON" MAP**  
Golden Rule Farms, Inc. / Junkyard Property  
  
CERTIFICATES 91366 & 91448

NOTE: THIS MAP IS NOT INTENDED TO  
PROVIDE LEGAL DIMENSIONS OR LOCATIONS  
OF PROPERTY OWNERSHIP LINES.  
  
PAGE 2 OF 2  
June 20, 2017

**WATER RIGHT SERVICES, LLC**  
PO BOX 1830, BEND, OR 97709  
CCB# 197121 [www.oregonwater.us](http://www.oregonwater.us)  
541-389-2837 [JOHNSHORT@USA.COM](mailto:JOHNSHORT@USA.COM)