

T.13S., R.33E., W.M.

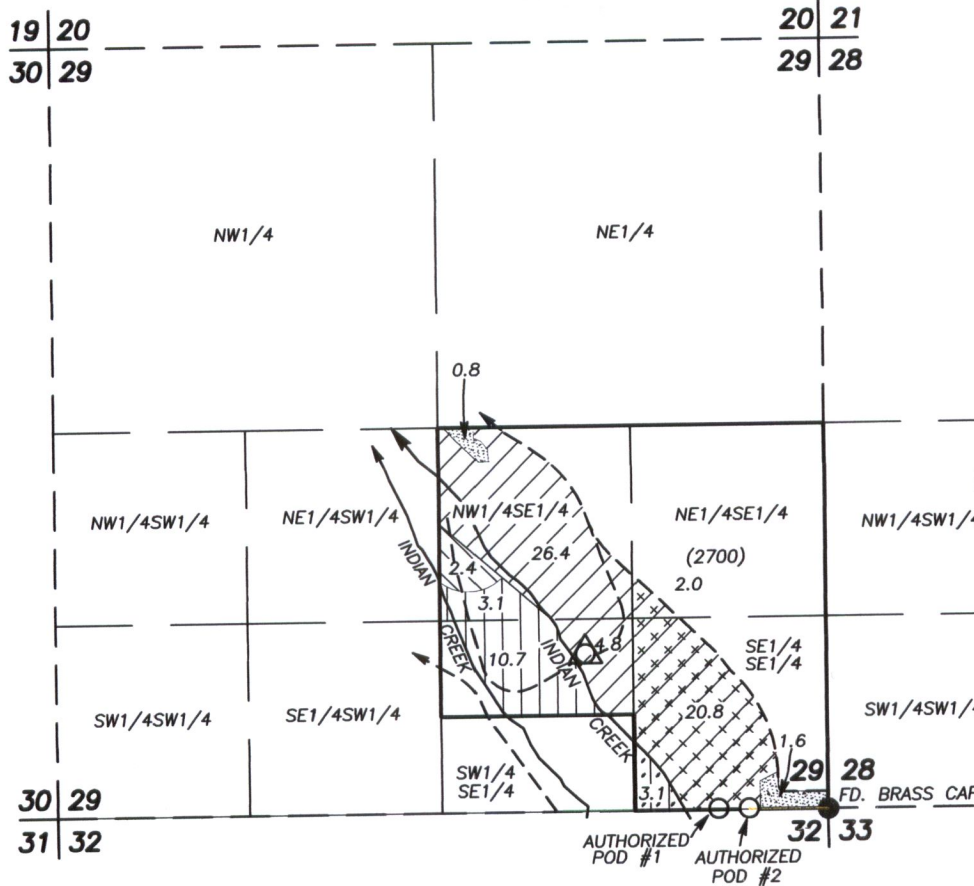

SCALE: 1" = 1320'

RECEIVED
FEB 12 2018
OWRD

TRANSFER APPLICATION MAP

FOR
GRANT AND BONNIE WINEGAR

- AUTHORIZED POD #1 C-82407 IS 10 FT. NORTH & 750 FT. WEST FROM THE SE CORNER SECTION 29, T.13S., R.33E.
- AUTHORIZED POD #2 C-82408 IS 10 FT. NORTH & 540 FT. WEST FROM THE SE CORNER SECTION 29, T.13S., R.33E.
- △ PROPOSED ADDITIONAL POD #3 IS 1080 FT. NORTH & 1650 FT. WEST FROM THE SE CORNER SECTION 29, T.13S., R.33E.

PREPARED BY:
ROBERT D. BAGETT, PLS, CWRE
217 N. CANYON BLVD.
JOHN DAY, OREGON
(541) 575-1251

JANUARY 8, 2018

- PLACE OF USE C-82407 PRIORITY DATE: JUNE 27, 1980
- REMAINING RIGHT C-82407
- PLACE OF USE C-82408 PRIORITY DATE: 1881
- REMAINING RIGHT C-82408
- FROM LANDS C-82408
- TO LANDS C-82408

- DITCH
- () TAX LOT NO.

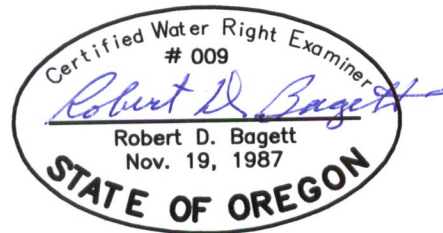

RENEWS: 12/31/2019

DISCLAIMER: THIS MAP IS NOT INTENDED TO PROVIDE LEGAL DIMENSIONS OR LOCATIONS OF PROPERTY BOUNDARY LINES.