

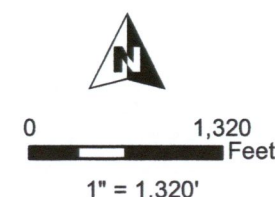

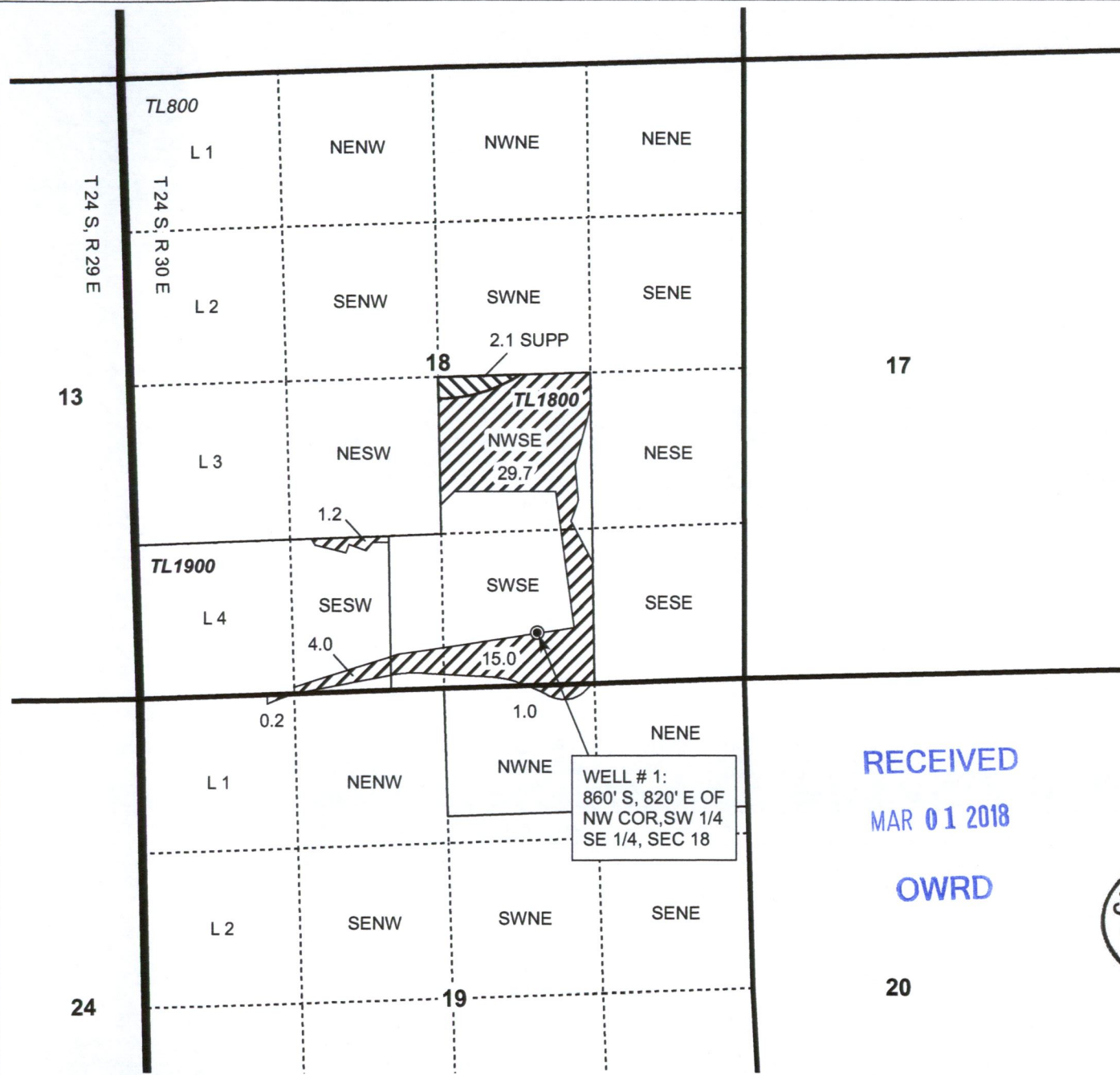





**T24S, R30E,  
SECTIONS 18 AND 19**  
HARNEY COUNTY, OREGON



-  POI Irrigation
-  Supplemental Irrigation
-  Township
-  Section
-  Quarter Quarter
-  Tax lot
-  Well with meter

RECEIVED  
MAR 01 2018  
OWRD

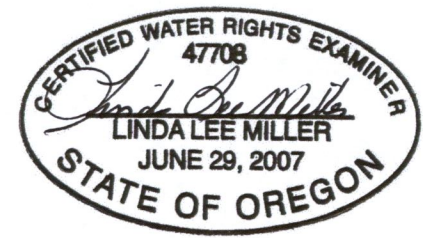

RENEWAL DATE 12/31/2018

**TRANSFER OFF MAP**  
Wilson / Steinbeck

NOTE: THIS MAP IS NOT INTENDED TO  
PROVIDE LEGAL DIMENSIONS OR LOCATIONS  
OF PROPERTY OWNERSHIP LINES.





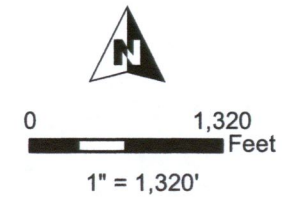
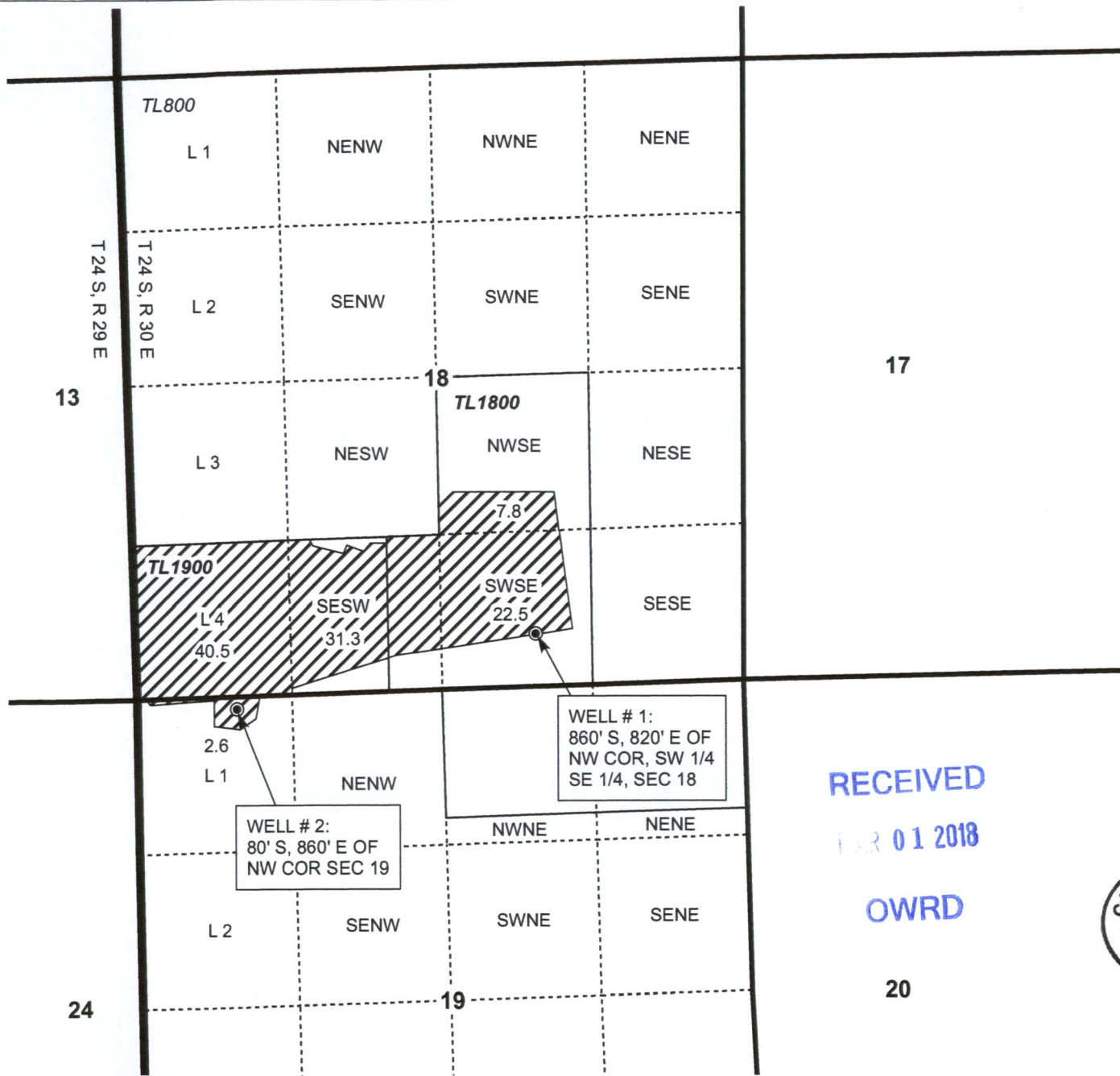

**WATER RIGHT SERVICES, LLC**  
PO BOX 1830, BEND, OR 97709  
CCB# 197121 [www.oregonwater.us](http://www.oregonwater.us)  
541-389-2837 [JOHNSHORT@USA.COM](mailto:JOHNSHORT@USA.COM)

Cert 92939

FEB 13, 2018

**T24S, R30E,  
SECTIONS 18 AND 19**  
HARNEY COUNTY, OREGON



-  POU Irrigation
-  Township
-  Section
-  Quarter Quarter
-  Tax lot
-  Well with meter

RECEIVED  
FEB 01 2018  
OWRD

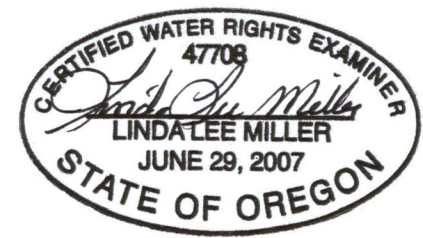

RENEWAL DATE 12/31/2018

**TRANSFER OFF MAP**  
Wilson / Steinbeck

Cert 93552

NOTE: THIS MAP IS NOT INTENDED TO  
PROVIDE LEGAL DIMENSIONS OR LOCATIONS  
OF PROPERTY OWNERSHIP LINES.

FEB 12, 2018

**WATER RIGHT SERVICES, LLC**  
PO BOX 1830, BEND, OR 97709  
CCB# 197121 [www.oregonwater.us](http://www.oregonwater.us)  
541-389-2837 [JOHNSHORT@USA.COM](mailto:JOHNSHORT@USA.COM)



**T24S, R30E,  
SECTION 18 WM  
T24S, R29E,  
SECTION 12 WM**

HARNEY COUNTY  
OREGON



0 1,320  
Feet

1" = 1,320'

 POU Irrigation

 POU IS

 Township

 Section

 Quarter Quarter

 Tax lot

 Well with meter

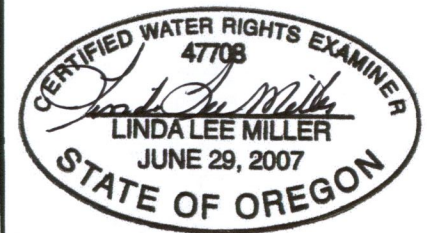

RENEWAL DATE 12/31/2018

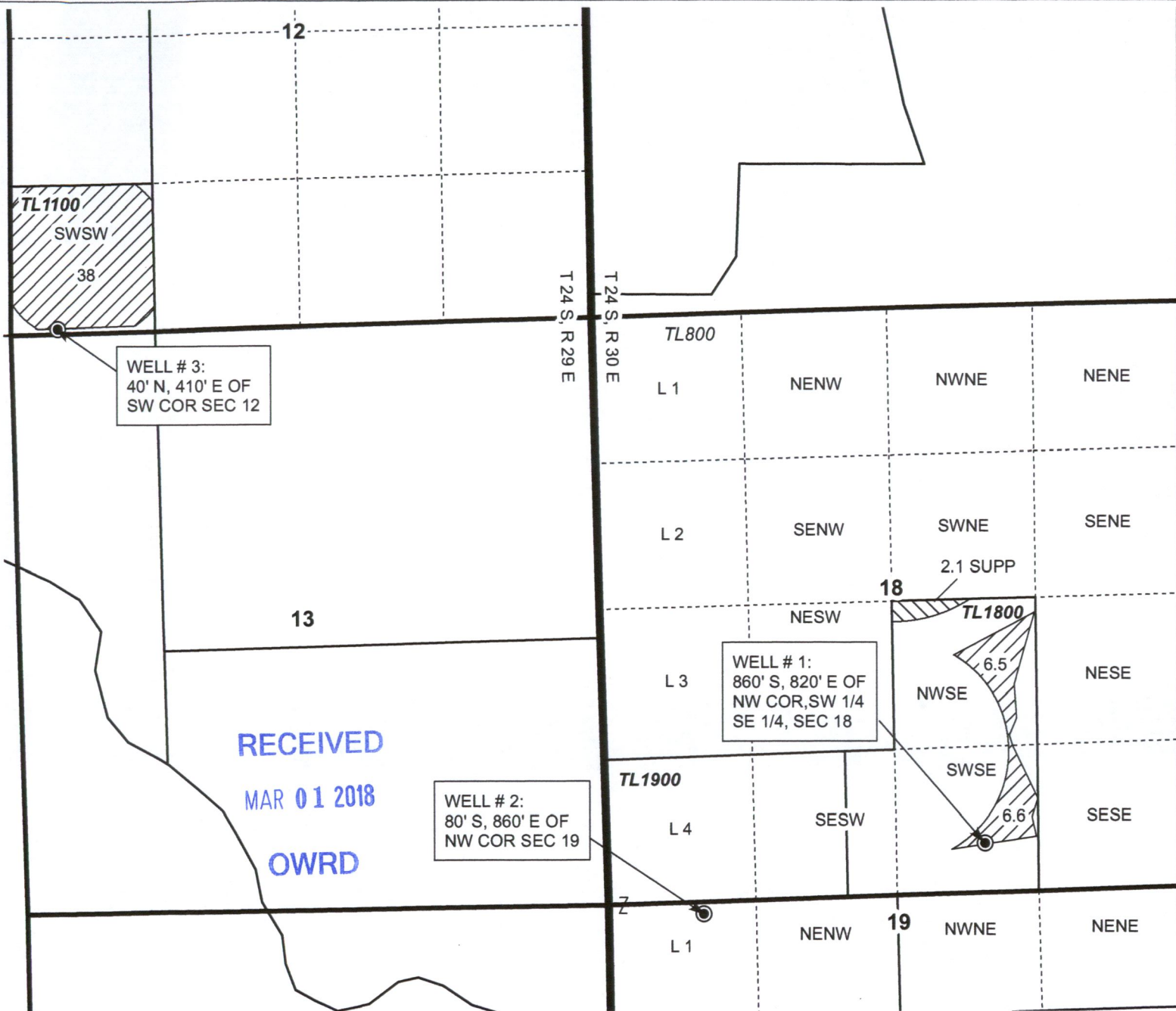

WELL # 3:  
40' N, 410' E OF  
SW COR SEC 12

WELL # 1:  
860' S, 820' E OF  
NW COR, SW 1/4  
SE 1/4, SEC 18

WELL # 2:  
80' S, 860' E OF  
NW COR SEC 19

RECEIVED  
MAR 01 2018  
OWRD

**TRANSFER ON MAP**  
Wilson / Steinbeck

Cert 92939

NOTE: THIS MAP IS NOT INTENDED TO  
PROVIDE LEGAL DIMENSIONS OR LOCATIONS  
OF PROPERTY OWNERSHIP LINES.

FEB 13, 2018

**WATER RIGHT SERVICES, LLC**





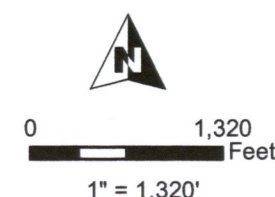
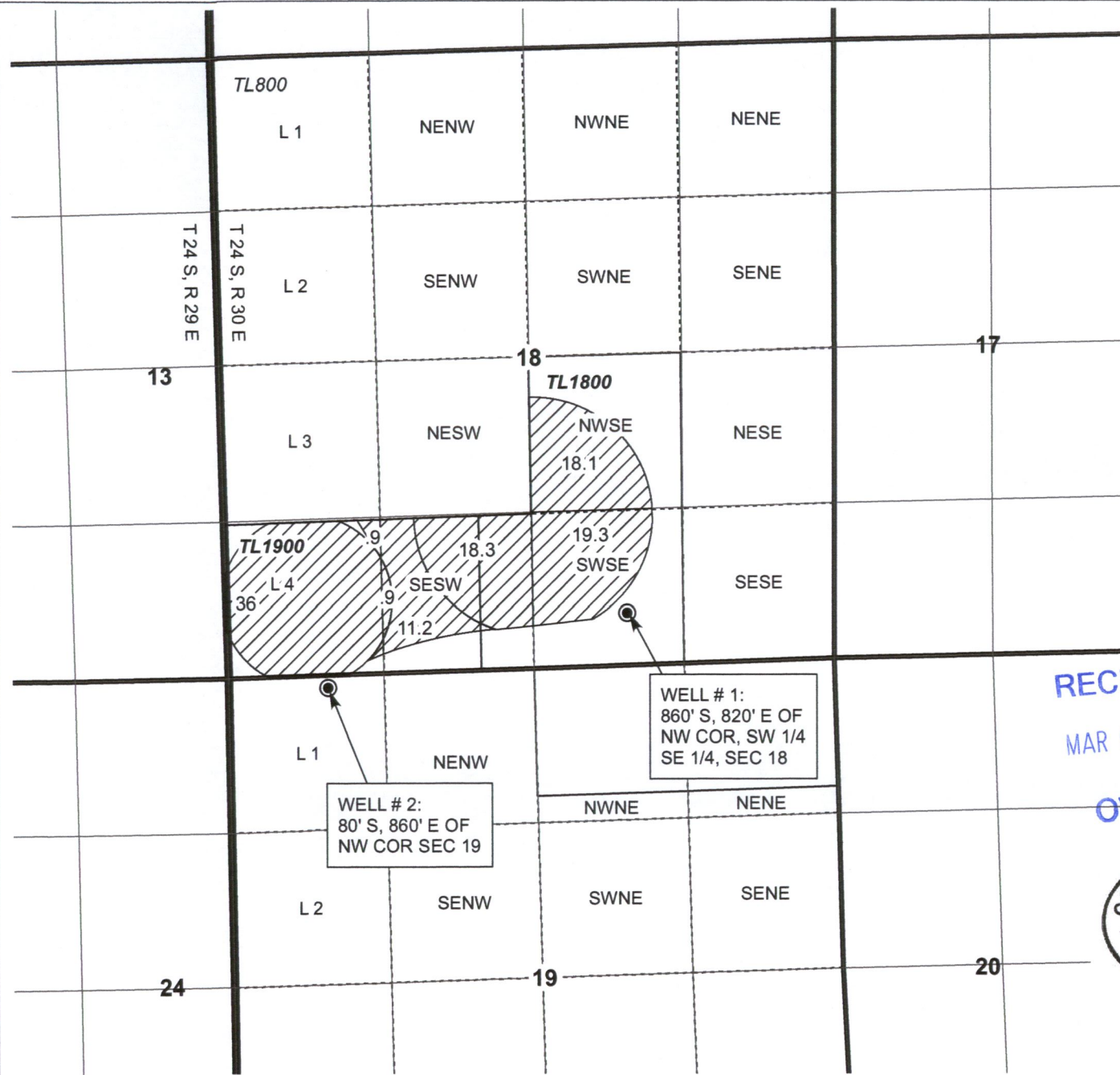

PO BOX 1830, BEND, OR 97709

CCB# 197121 [www.oregonwater.us](http://www.oregonwater.us)

541-389-2837 [JOHNSHORT@USA.COM](mailto:JOHNSHORT@USA.COM)

**T24S, R30E,  
SECTIONS 18 AND 19**  
HARNEY COUNTY, OREGON



-  POU Irrigation
-  Township
-  Section
-  Quarter Quarter
-  Tax lot
-  Well & meter

RECEIVED  
MAR 01 2018

OWRD



RENEWAL DATE 12/31/2018

**TRANSFER ON MAP**  
Wilson / Steinbeck

Cert 93552

NOTE: THIS MAP IS NOT INTENDED TO  
PROVIDE LEGAL DIMENSIONS OR LOCATIONS  
OF PROPERTY OWNERSHIP LINES.

FEB 13, 2018

**WATER RIGHT SERVICES, LLC**  
PO BOX 1830, BEND, OR 97709  
CCB# 197121 [www.oregonwater.us](http://www.oregonwater.us)  
541-389-2837 [JOHNSHORT@USA.COM](mailto:JOHNSHORT@USA.COM)