

# Application for Ground Water Registration Modification in the Name of MWE, LLC

Groundwater Registration 1796

Township 16 South, Range 4 West (W.M.)

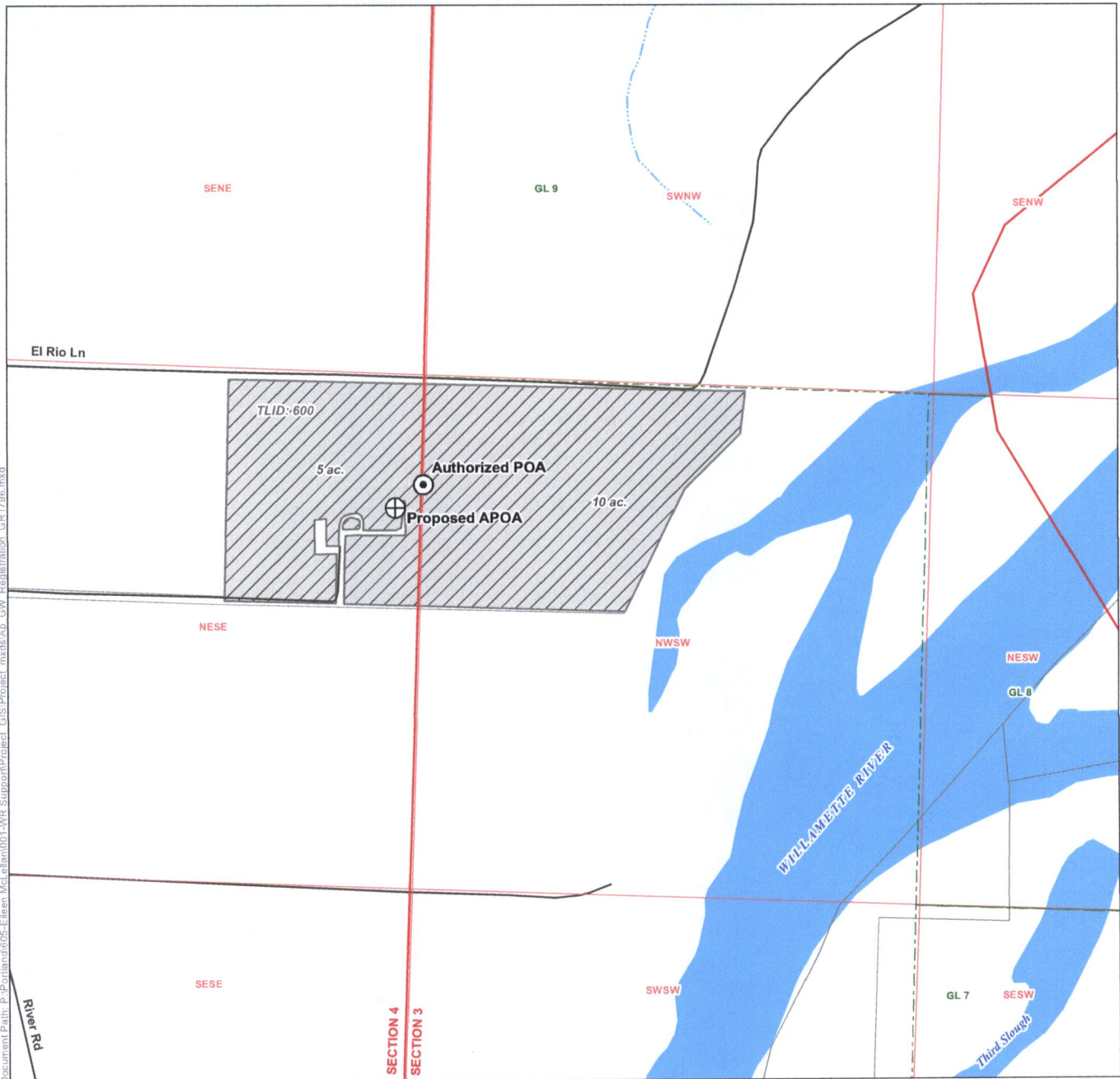

Document Path: P:\Portfolios\05-Eileen McEllean\001-WR Support\Project\_GIS\Project.mxd; App\_GW\_Registration GR1796.mxd

## LEGEND

- Current Authorized Point of Appropriation (POA)
- Proposed Point of Appropriation (POA)
- Place of Use (POU)
- Tax Lot
- Road
- Watercourse, Perennial
- Watercourse, Intermittent
- Waterbody

## POA LOCATION DESCRIPTION

### Authorized POA

Located 300 feet South and 5 feet East from the West quarter corner of Section 3, Township 16 South, Range 4 West (W.M.)

### Proposed APOA

Located 340 feet South and 70 feet West from the East quarter corner of Section 4, Township 16 South, Range 4 West (W.M.)

## NOTE

The groundwater registration GR-1796 is for irrigation of 15.0 acres. To the best of MWE, LLC's knowledge, the above identified place of use is the land that has historically been farmed within tax lot 600 under the registration. MWE, LLC believes the above identified place of use is a more accurate representation of the intended place of use for the registration than the hand-drawn map in the registration or the map shown on WRIS.

RECEIVED

MAR 12 2018

OWRD

## DISCLAIMER

This map was prepared for the purpose of identifying the location of a water right only and it is not intended to provide legal dimensions or location of property ownership lines.

## MAP NOTES

Date: January 30, 2018  
Data Sources: BLM, OWRD, ESRI, Linn Co., Lane Co., USGS

