

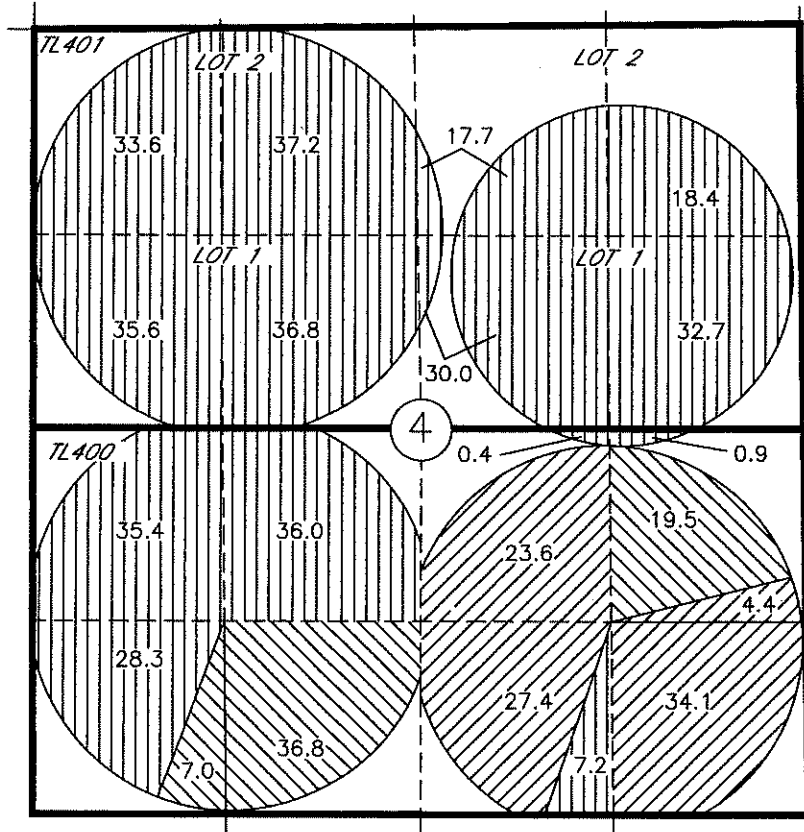

**COLUMBIA IMPROVEMENT DISTRICT**  
**TEMPORARY TRANSFER APPLICATION MAP**  
**WILLOW CREEK DAIRY TO SAGE HOLLOW RANCH, LLC**  
**FOR PORTIONS OF CERTIFICATES 86992, 86993, AND 80062**  
 T3N, R26E, W.M., MORROW COUNTY

SHEET 2 OF 2 " TO MAP "

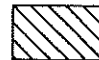

**LEGEND**

-  350.2 AC CERT 80062
-  89.5 AC CERT 86992
-  63.3 AC CERT 86993

P.O.D. COLUMBIA RIVER  
 LOCATED IN LOT 7, NE1/4 NW1/4,  
 SEC 2, T4N, R25E, W.M.; 150 FT  
 SOUTH AND 2990 FT WEST FROM  
 THE NE COR OF SEC 2.

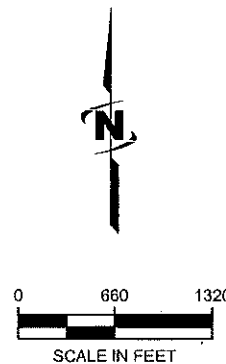

**RECEIVED**

MAR 29 2018

**OWRD**

March 18, 2017

NOTE:  
 THE PURPOSE OF THIS MAP IS TO IDENTIFY THE APPROXIMATE LOCATION OF THE WATER RIGHT. IT IS NOT INTENDED  
 TO PROVIDE INFORMATION RELATIVE TO THE LOCATION OF PROPERTY OWNERSHIP BOUNDARY LINES, PIPE LOCATIONS  
 AND SIZES WHERE SHOWN WERE PROVIDED BY FARM OPERATIONAL PERSONNEL AND ARE APPROXIMATE LOCATIONS AND  
 SIZES.

**COLUMBIA IMPROVEMENT DISTRICT  
 TEMPORARY TRANSFER APPLICATION MAP  
 WILLOW CREEK DAIRY TO SAGE HOLLOW RANCH, LLC  
 FOR PORTIONS OF CERTIFICATES 86992, 86993, AND 80062  
 T3N, R26E, W.M., MORROW COUNTY**

**SHEET 1 OF 2 " FROM MAP "**

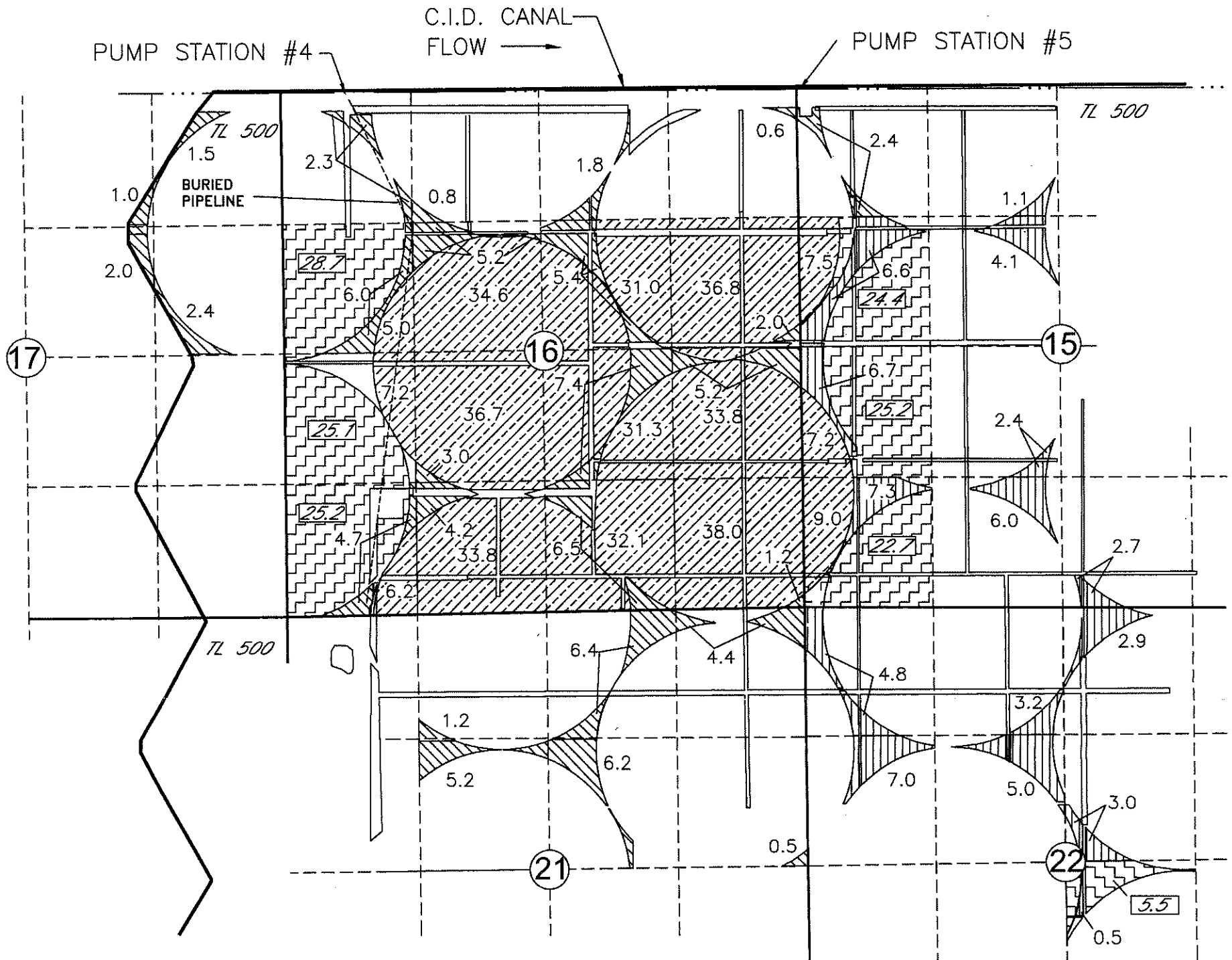

**LEGEND**

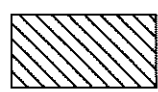
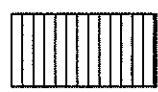
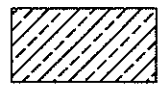
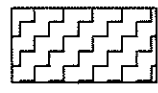
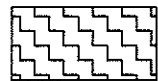
-  89.5 AC OF CERT 86992
-  63.3 AC OF CERT 86993
-  350.2 AC OF CERT 80062
-  AC OF CERT 80062 in QTR  
QTR NOT ASSOCIATED WITH  
THIS TRANSFER
-  AC OF CERT 86993 in QTR  
QTR NOT ASSOCIATED WITH  
THIS TRANSFER

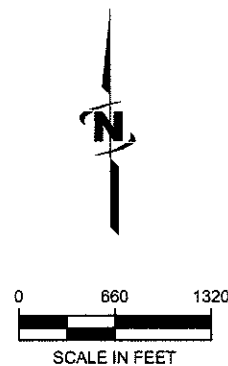

NOTE:  
 THE PURPOSE OF THIS MAP IS TO IDENTIFY THE APPROXIMATE LOCATION OF THE WATER RIGHT. IT IS NOT INTENDED  
 TO PROVIDE INFORMATION RELATIVE TO THE LOCATION OF PROPERTY OWNERSHIP BOUNDARY LINES. PIPE LOCATIONS  
 AND SIZES WHERE SHOWN WERE PROVIDED BY FARM OPERATIONAL PERSONNEL AND ARE APPROXIMATE LOCATIONS AND  
 SIZES.

March 18, 2017

**RECEIVED**

MAR 29 2018

**OWRD**

P.O.D. COLUMBIA RIVER  
 LOCATED IN LOT 7 NE 1/4 NW  
 1/4, SEC 2, T4N, R25 EWM,  
 150' SOUTH AND 2990' W FROM  
 THE NE COR OF SEC 2

**COLUMBIA IMPROVEMENT DISTRICT  
 to VELDE DELIVERY SYSTEM  
 FROM THE COLUMBIA RIVER**

T 2&3 N, R 26, 27 & 28 E. W.M.

R26E  
 R27E

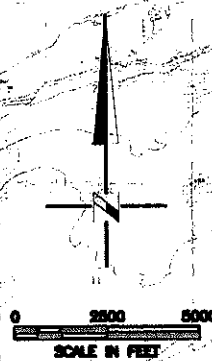
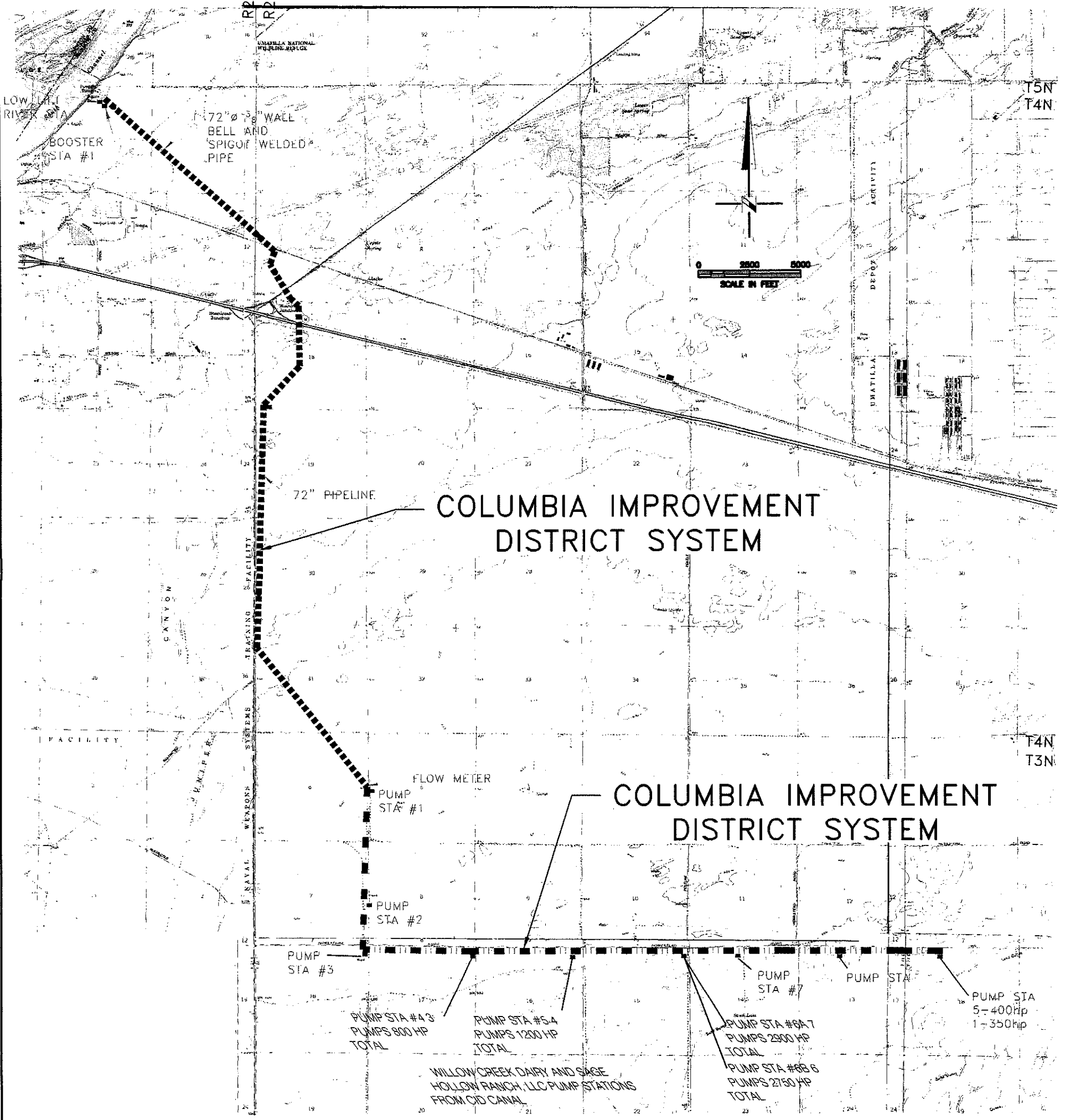

**COLUMBIA IMPROVEMENT  
 DISTRICT SYSTEM**

**COLUMBIA IMPROVEMENT  
 DISTRICT SYSTEM**

- PUMP STA #1
- PUMP STA #2
- PUMP STA #3
- PUMP STA #4 3 PUMPS 800 HP TOTAL
- PUMP STA #5 4 PUMPS 1200 HP TOTAL
- WILLOW CREEK DAIRY AND SAGE HOLLOW RANCH, LLC PUMP STATIONS FROM OLD CANAL
- PUMP STA #6 7 PUMPS 2500 HP TOTAL
- PUMP STA #8 6 PUMPS 2150 HP TOTAL
- PUMP STA 5- 400hp
- PUMP STA 1- 350hp

RECEIVED

MAR 29 2018

OWRD

MAR 29 2018

OWRD