

T.6S. R.1E. Sec. 7, 8, 16, 17, & 18, W.M.

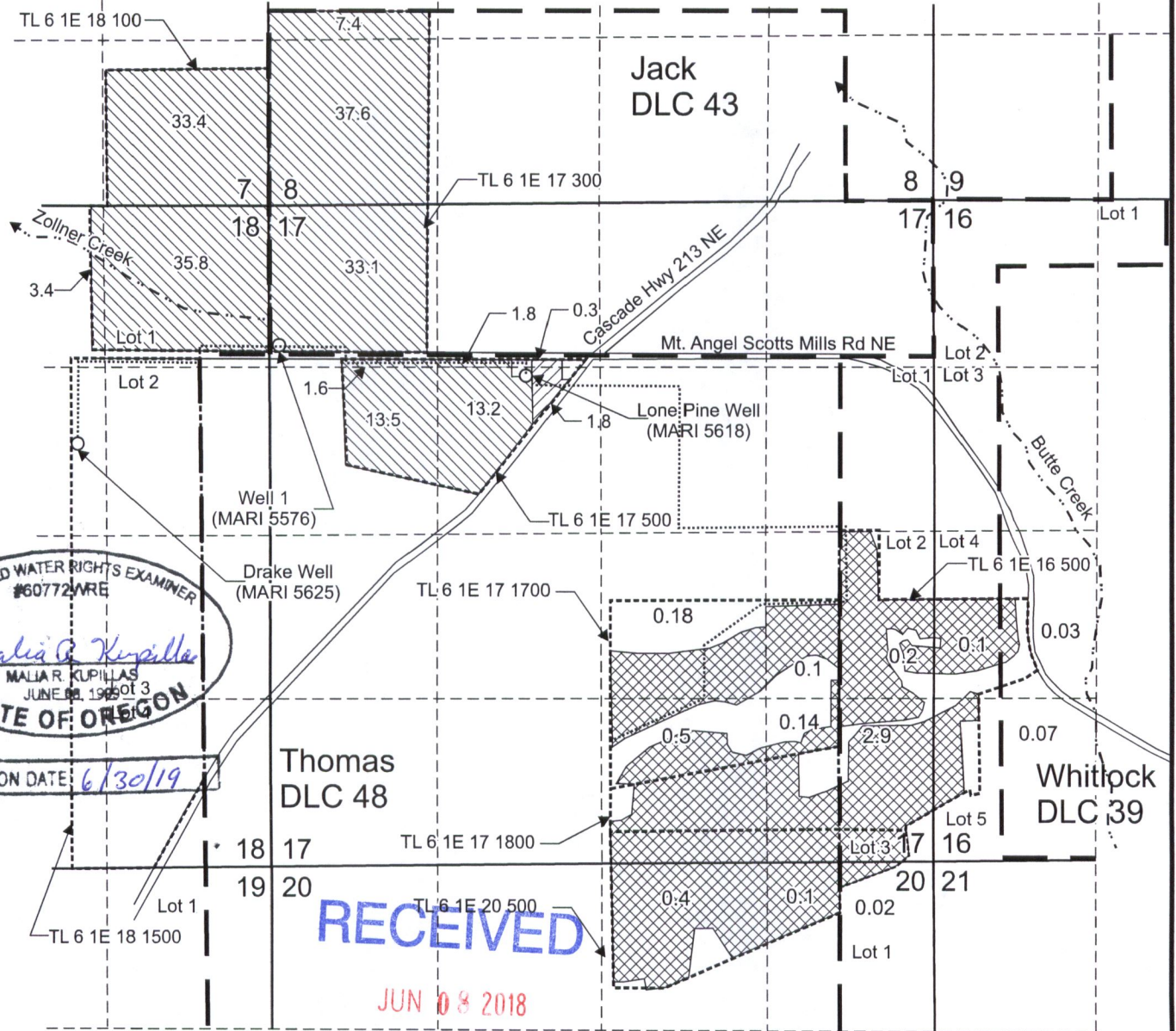

CERTIFIED WATER RIGHTS EXAMINER
#60772/WRE
Malia R. Kupillas
MALIA R. KUPILLAS
JUNE 22, 1965, Not 3
STATE OF OREGON

EXPIRATION DATE: 6/30/19

RECEIVED

JUN 08 2018

OWRD

Well 1 (MARI 5576) is located 1,110 feet south and 80 feet east from the NW corner, Section 17.
Lone Pine Well (MARI 5618) is located 1,425 feet south and 2,075 feet east from the NW corner, Section 17.
Drake Well (MARI 5625) is located 1,900 feet south and 1,660 feet west from the NE corner, Section 18.

- Area (180.8 Acres) irrigated under Certificate 86567, priority 9-18-74, not affected by this transfer.
- "From" Area (2.1 Acres) irrigated under Certificate 86567, priority 9-18-74, affected by this transfer.
- "To" Area (2.1 Acres) to be irrigated by this transfer.

- Tax lot boundary
- Donation Land Claim boundary
- Irrigation mainline

Scale: 1" = 1,320'



This map was prepared for the purpose of identifying the location of a water right only and is not intended to provide legal dimensions or location of property ownership lines.



Pacific Hydro-Geology Inc.

07/2017

Transfer Application Map
Certificate 86567

Kraemer Farms (Teeney)
T.6S. R.1E. Sec. 7, 8, 16, 17, & 18, W.M.