

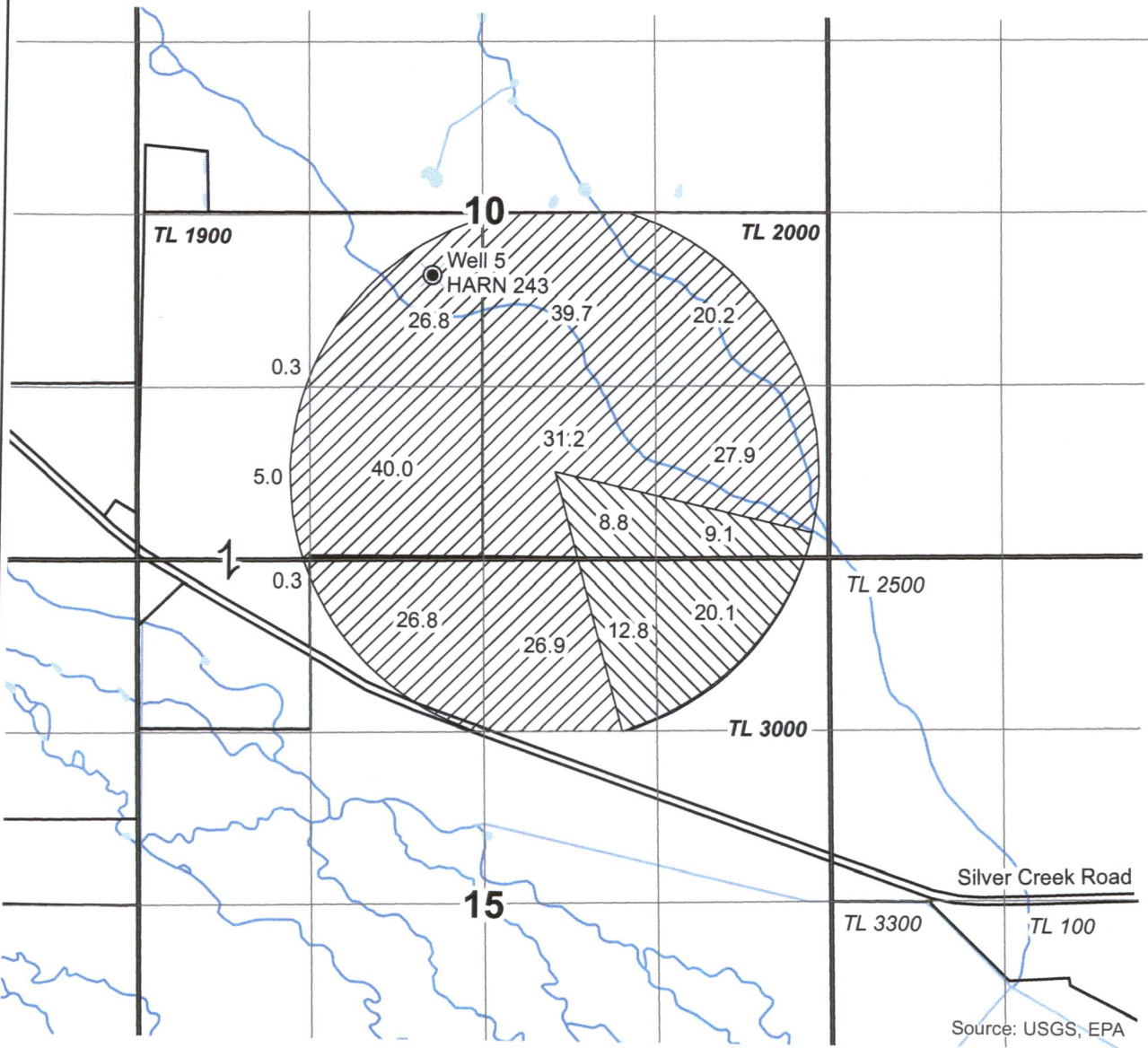





T23S R26E, WM, HARNEY COUNTY, OR



1" = 1,320'

-  POU IR OFF
-  Cert 63600 Remaining
-  QQ
-  Tax Lots
-  Sections
-  Well

Well 5: 2178.5' N, 2205.1' E of SW Cor S10

RECEIVED

JUL 12 2018

OWRD



TRANSFER OFF MAP
Singhose Land & Cattle Company, LLC

Date: 6/29/18 Cert 63600

This map is not intended to provide legal dimensions or locations of property ownership lines.

WATER RIGHT SERVICES, LLC
PO BOX 1830, BEND, OR 97709
WWW.OREGONWATER.US CCB # 197121
johnshort@usa.com 541-389-2837

**T23S R26E, WM
HARNEY COUNTY, OR**



0 1,320
Feet

1" = 1,320'

- Well
- Buried Pipeline
- QQ
- ▨ POU IR ON
- Tax Lots
- Sections

RECEIVED
JUL 12 2018
OWRD

- L-125281: 130' S, 400' E of W 1/4 Cor S1
- L-125280: 50' S, 2620' W of E 1/4 Cor S1
- L-111748: 1320' S, 1315' E of NW Cor S12
- L-115916: 1320' S, 1315' W of NE Cor S12
- L-104459: 1320' N, 1315' W of SE Cor S11
- L-115909: 1320' N, 1315' E of SW Cor S12
- L-125022: 1320' N, 1315' W of SE Cor S12

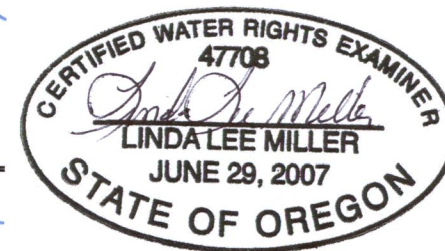

Source: USGS, EPA

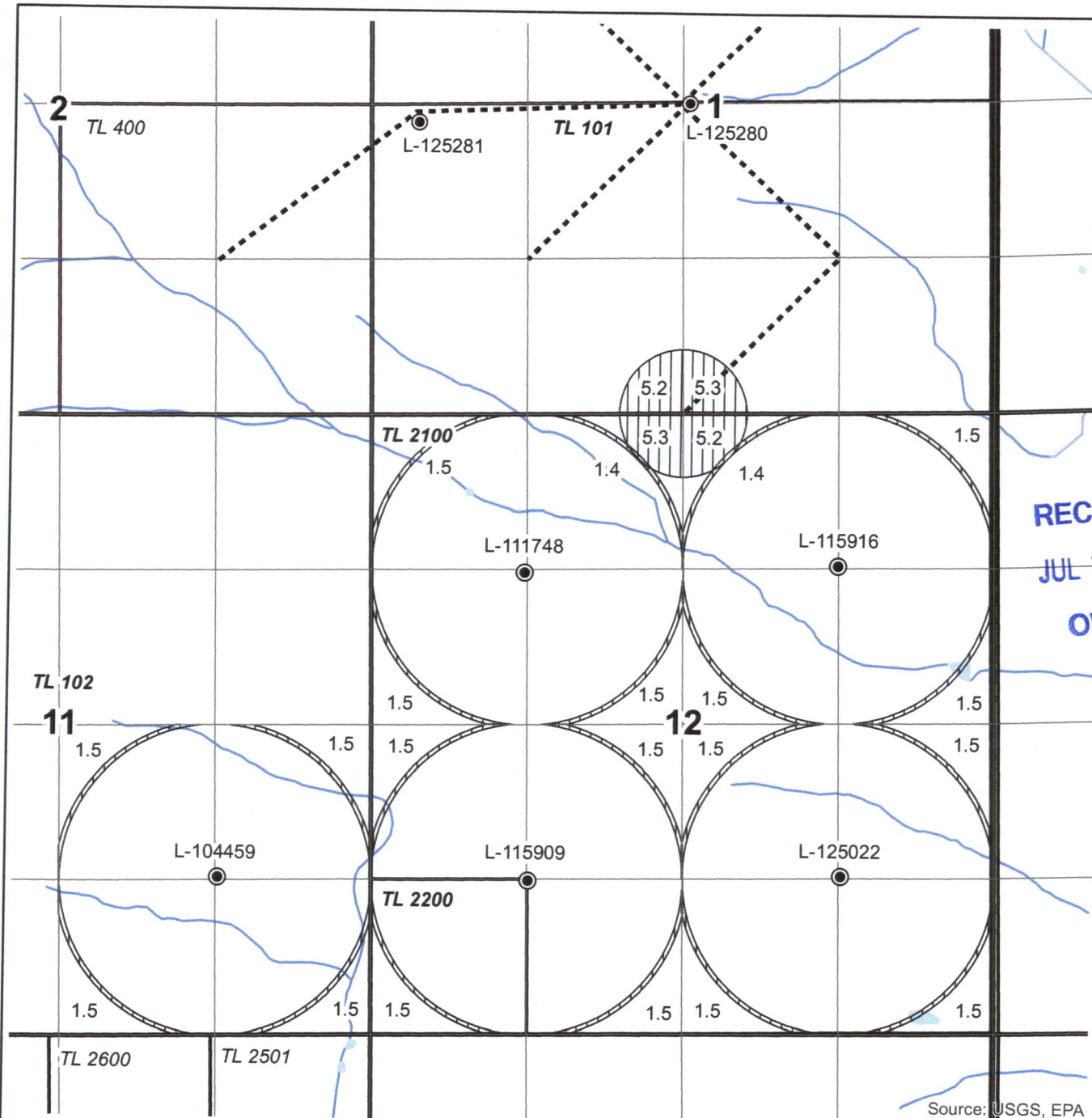

TRANSFER ON MAP
Singhose Land & Cattle Company, LLC

Date: 6/30/18

Cert 63600 Transfer

This map is not intended
to provide legal dimensions
or locations of property
ownership lines.

WATER RIGHT SERVICES, LLC
PO BOX 1830, BEND, OR 97709
WWW.OREGONWATER.US CCB # 197121
johnshort@usa.com 541-389-2837