

FOR: MARK WRIGHT, TRUSTEE  
 GLEN A/ MONICA K WRIGHT LIVING TRUST  
 BY: NATHAN R. REED, P.E., CWRE  
 T27S, R4W, W.M. SECTION 22  
 PERMIT NO. S-44495  
 CERTIFICATE NO. 52763  
 SITE VISIT: JUNE 19, 2018

RECEIVED

JUL 30 2018

OWRD

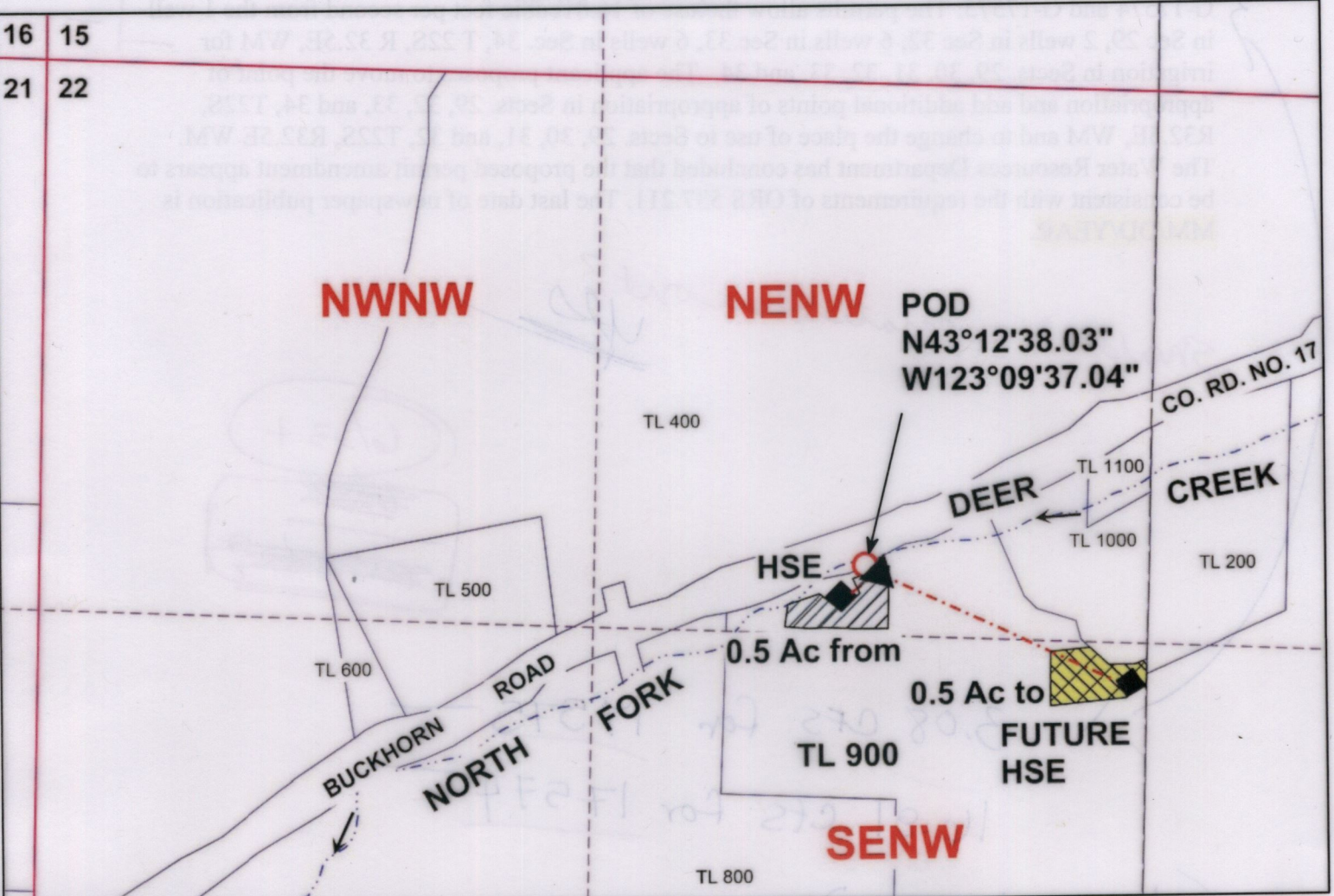
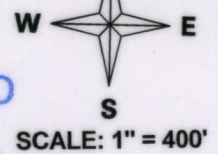

POD IS LOCATED 1220 FEET SOUTH AND 700 FEET WEST FROM THE N1/4 CORNER OF SECTION 22.

MAP PREPARED FOR:  
 MARK WRIGHT  
 6856 CASUAL COURT  
 SAN JOSE, CA 97120

Legend

- |  |            |  |                |  |           |
|--|------------|--|----------------|--|-----------|
|  | Stream     |  | Pipeline       |  | Section   |
|  | Flow arrow |  | Structure      |  | Quarter   |
|  | POD        |  | From 8/27/1979 |  | Sixteenth |
|  | Pump       |  | To 8/27/1979   |  | Parcels   |

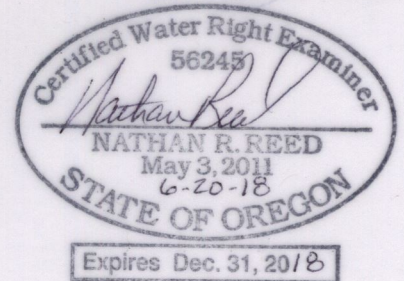

THE PURPOSE OF THIS MAP IS TO IDENTIFY THE LOCATION OF THE WATER RIGHT. IT IS NOT INTENDED TO PROVIDE INFORMATION RELATIVE TO THE LOCATION OF PROPERTY OWNERSHIP BOUNDARY LINES.

MAP PREPARED BY:  
 NATHAN R. REED, P.E., CWRE  
 1113 SE CASS AV  
 ROSEBURG, OR 97470