

Use a separate Part 4 for each water right to be leased instream

Table 2

Use **Table 2** to illustrate the totals for the water right proposed to be leased instream (based on Part 3 of 4) **Water Right # 89006**

Total rate and volume by priority date, POD, use and acreage as appropriate considering the right to be leased. If not enough room below, you may add rows (see instructions) or create a spreadsheet (matching Table 2 and clearly labeled) and attach.
(cfs = cubic feet per second and af = acre-feet)

| Priority Date | POD # | Use | Acre | Other Information (such as conditions/limitations on the right) | Rate (cfs) | Volume (af) |
|---------------|-------|-----|--------|---|------------|-------------|
| 2/25/1904 | 1 | IR | 54.13 | These acres have a duty of 3 acre feet per acre | 0.68 | 162.39 |
| 2/25/1904 | 1 | IR | 219.54 | These acres have a duty of 6 acre feet per acre | 5.49 | 1317.24 |
| 9/6/1905 | 2 | IR | 20.62 | These acres have a duty of 3 acre feet per acre | 0.26 | 61.86 |
| 9/6/1905 | 2 | IR | 38.97 | These acres have a duty of 6 acre feet per acre | 0.97 | 233.82 |

Total af from storage, if applicable: 1775.31 AF or N/A

If the POD is not described on the certificate or, if there is more than one POD listed on the certificate, then the specific POD must be described:

POD 1 = Maxwell Canal; POD 2 = A-Line Canal

Table 3

Instream Use created by the lease **River Basin:** Umatilla **River/Stream Name:** Umatilla, tributary to Columbia River

Proposed Instream Reach: **Or Proposed Instream Point:**

A reach typically begins at the POD and ends at the mouth of the source stream:

Instream use protected at the POD

OR Please check this box if you are not sure of the proposed reach and want water to be protected within a reach below the POD, if possible. If no reach is identified or the above box is not checked, and there is only one POD listed on the water right, the lease may be processed to be protected at the POD.)

Instream Portion: May not exceed the maximum rate/volume for the right (identified in Table 2)

Use the table 3 to illustrate the instream rate, volume and instream period by priority date, POD, Use and acreage, as appropriate. If not enough room below, you may add rows (see instructions) or create a spreadsheet (clearly labeled and matching the below portion of Table 3) and attach.

| Priority date | POD # | Use | Acre | Proposed Instream Period | Instream Rate (cfs) | Total instream volume (af) |
|---------------|-------|-----|--------|--------------------------|---------------------|----------------------------|
| 1904 | 1 | IR | 273.67 | March 1 thru October 31 | | 1,479.63 |
| 1905 | 2 | IR | 59.59 | March 1 thru October 31 | | 295.68 |
| | | | | | | |

OR Please check this box if you are not sure of the proposed rate, volume and instream period. As part of its review process, the Department will identify the appropriate instream rate, volume and period considering the water right(s) being leased and instream benefits.

Yes N/A **Conditions to avoid enlargement or injury to other water rights, if any, or other limitations:** list here _____

Note: The Department may identify additional conditions to prevent injury and/or enlargement.

Any additional information about the proposed instream use: _____

Hermiston Irrigation District
2018 District Instream Lease Summary

| <u>Map/Tax Lot</u> | <u>Last Name</u> | <u>First Name</u> | <u>Duty</u> | <u>POD</u> | <u>W/R Acres to Instream</u> | <u>AC/FT</u> |
|----------------------|------------------------------|--------------------------|----------------|------------|------------------------------|----------------|
| 4N2810DC 1500 | HSD 8R | | 3 | Maxwell | 3.00 | 9.00 |
| 4N2810DC 600 | HSD 8R | | 3 | Maxwell | 3.40 | 10.20 |
| 4N2815BD 900 | HSD 8R | | 3 | Maxwell | 2.00 | 6.00 |
| 4N2815CA 1300 | HSD 8R | | 3 | Maxwell | 13.50 | 40.50 |
| 5N2815BC 100 | Anacapa Land Co | | 3 | Maxwell | 3.40 | 10.20 |
| 5N2815BC 400 | Donn's Places Inc | | 3 | Maxwell | 0.67 | 2.01 |
| 5N2815BCD 606 | Donn's Places Inc | | 3 | Maxwell | 0.57 | 1.71 |
| 5N2815BD 600 | Donn's Places Inc | | 3 | Maxwell | 0.50 | 1.50 |
| 5N2815BD 601 | Donn's Places Inc | | 3 | Maxwell | 0.40 | 1.20 |
| 5N2815BD 602 | Donn's Places Inc | | 3 | Maxwell | 0.10 | 0.30 |
| 5N2815BD 605 | Donn's Places Inc | | 3 | Maxwell | 0.20 | 0.60 |
| 5N2815BD 609 | Donn's Places Inc | | 3 | Maxwell | 3.00 | 9.00 |
| 5N2815CB 100 | Anacapa Land Co | | 3 | Maxwell | 18.80 | 56.40 |
| 5N2824 400 | Fewel | Scott | 3 | Maxwell | 4.59 | 13.77 |
| 4N2803B 700 | Engelhart | Andrew & Charlotte | 6 | Maxwell | 3.40 | 20.40 |
| 4N2803B 704 | Engelhart | Andrew & Charlotte | 6 | Maxwell | 4.00 | 24.00 |
| 4N2804D 1201 | H.A.R.E.C. (OSU) | Clupny | 6 | Maxwell | 0.50 | 3.00 |
| 4N2804D 1901 | Perez | Antonio | 6 | Maxwell | 2.25 | 13.50 |
| 4N2804D 1906 | Frias | Soledad | 6 | Maxwell | 1.30 | 7.80 |
| 4N2810 100 | HSD 8R | | 6 | Maxwell | 3.88 | 23.28 |
| 4N2812B 302 | HSD 8R | | 6 | Maxwell | 23.00 | 138.00 |
| 4N2815 200 | Newman | Jeff | 6 | Maxwell | 6.20 | 37.20 |
| 4N2815CA 100 | HSD 8R | | 6 | Maxwell | 15.60 | 93.60 |
| 4N2816D 101 & 301 | Pedro | Edward & Debbie | 6 | Maxwell | 18.10 | 108.60 |
| 4N2816D 1900 | Swales | Dustin | 6 | Maxwell | 1.20 | 7.20 |
| 4N2821B 801 | Royer | Hoot | 6 | Maxwell | 2.96 | 17.76 |
| 4N28B 8000 | BOR | | 6 | Maxwell | 64.50 | 387.00 |
| 4N28B 8701 | BOR | | 6 | Maxwell | 64.80 | 388.80 |
| 4N28B 9402 | First Church of the Nazarene | | 6 | Maxwell | 1.97 | 11.82 |
| 5N2824 400 | Fewel | Scott | 6 | Maxwell | 2.03 | 12.18 |
| 5N2929DA 500 | Noland | Roberta | 6 | Maxwell | 2.15 | 12.90 |
| 5N2931D 2300 | Ashbeck | Damon & Dianna | 6 | Maxwell | 1.70 | 10.20 |
| 4N2814AD 900 | Graham | Elaina | 3 | A Line | 5.80 | 17.40 |
| 4N2815 1400 | Cook | Ivan & Colleen | 3 | A Line | 3.20 | 9.60 |
| 4N28D 800 | H.A.R.E.C. (OSU) | | 3 | A Line | 3.92 | 11.76 |
| 4N2907B 600 | Schultz | Linda | 3 | A Line | 5.70 | 17.10 |
| 5N2828B 800 | Wood | Thomas & Dana | 3 | A Line | 2.00 | 6.00 |
| 4N2815 1400 | Cook | Ivan & Colleen | 6 | A Line | 3.30 | 19.80 |
| 4N2821B 1103 | Cline | Vicki | 6 | A Line | 2.65 | 15.90 |
| 4N2906A 2400 | Wineland | Ronald & LeEtta | 6 | A Line | 2.02 | 12.12 |
| 4N2907B 600 | Schultz | Linda | 6 | A Line | 1.80 | 10.80 |
| 5N2834B 1000 | Lewis | Brian | 6 | A Line | 9.00 | 54.00 |
| 5N2928C 1300 | Berry nka Harley | Marcie | 6 | A Line | 4.40 | 26.40 |
| 5N2932 2302 | Harris | John (TRS) | 6 | A Line | 3.40 | 20.40 |
| 5N2932CA 601 | Cook | Randy & Christy | 6 | A Line | 2.00 | 12.00 |
| 5N2932CC 1700 | H.A.R.E.C. (OSU) | Wattenburger | 6 | A Line | 0.90 | 5.40 |
| 5N2933 2104 | Acord | John & Julie | 6 | A Line | 1.50 | 9.00 |
| 5N2933 700 | Stull | Matthew & Serenity | 6 | A Line | 4.00 | 24.00 |
| 5N29D 3800 | McLeod nka Bumpaous | Cherie | 6 | A Line | 4.00 | 24.00 |
| Priority Date | | | | | 333.26 | |
| 2/25/1904 | POD 1 - Maxwell | Max Acres 3 AF | 162.39 | | | |
| | | Max Acres 6 AF | 1317.24 | | Total AC/FT | 1775.31 |
| 9/6/1905 | POD 2 - A Line | A Line Acres 3 AF | 61.86 | | | |
| | | A Line Acres 6 AF | 233.82 | | | |
| | | | 1775.31 | | | |

T4N, R28E, Sec 15, Tax Lot 1400

QQ SE SE 6.50 Acres

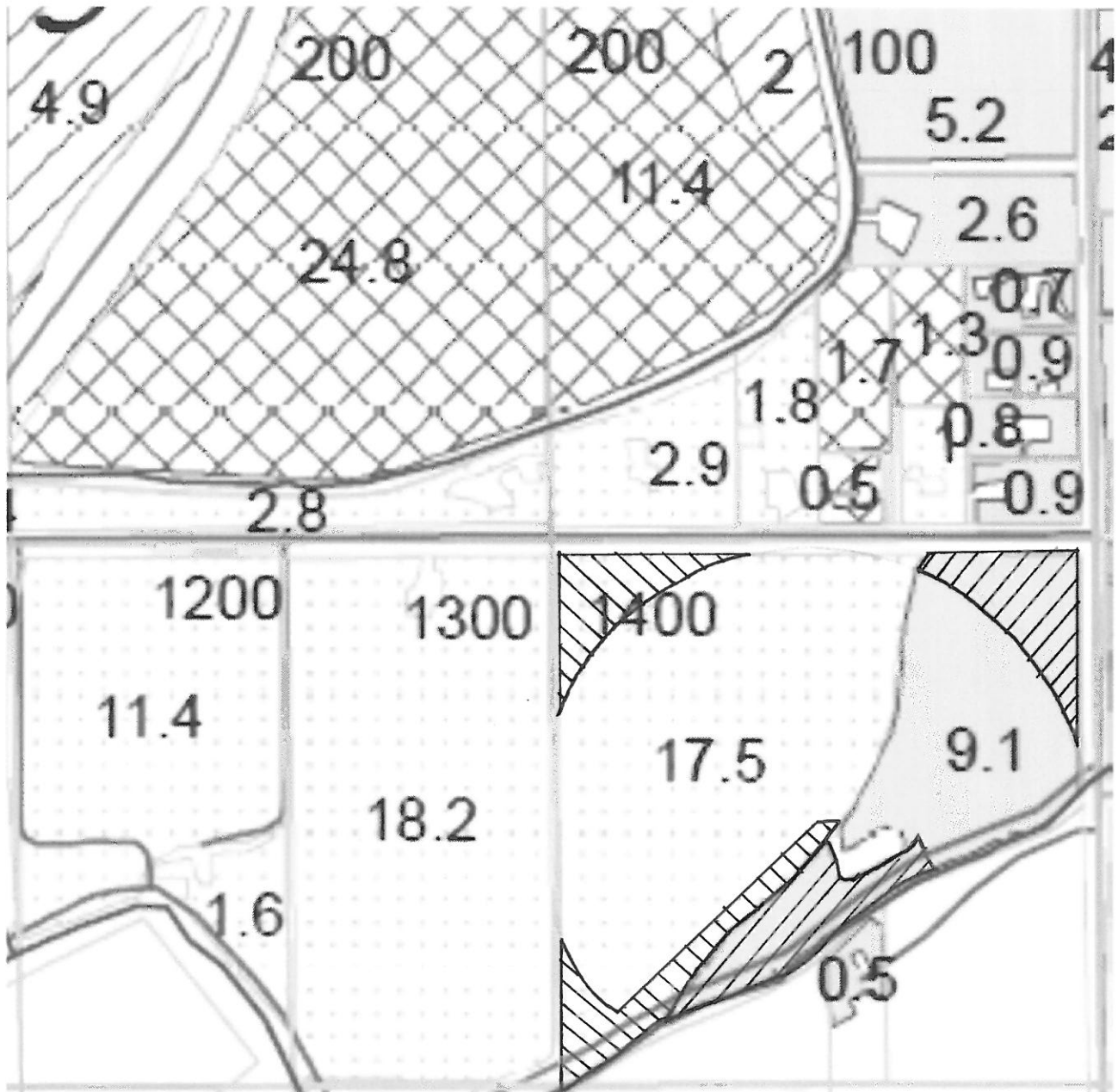

1 Inch = 400 Feet

Hermiston Irrigation District Temporary Instream Transfer Application

T5N, R28E, Sec 24, Tax Lot 400
QQ NE SE 4.59 Acres, SE SE 2.03 Acres

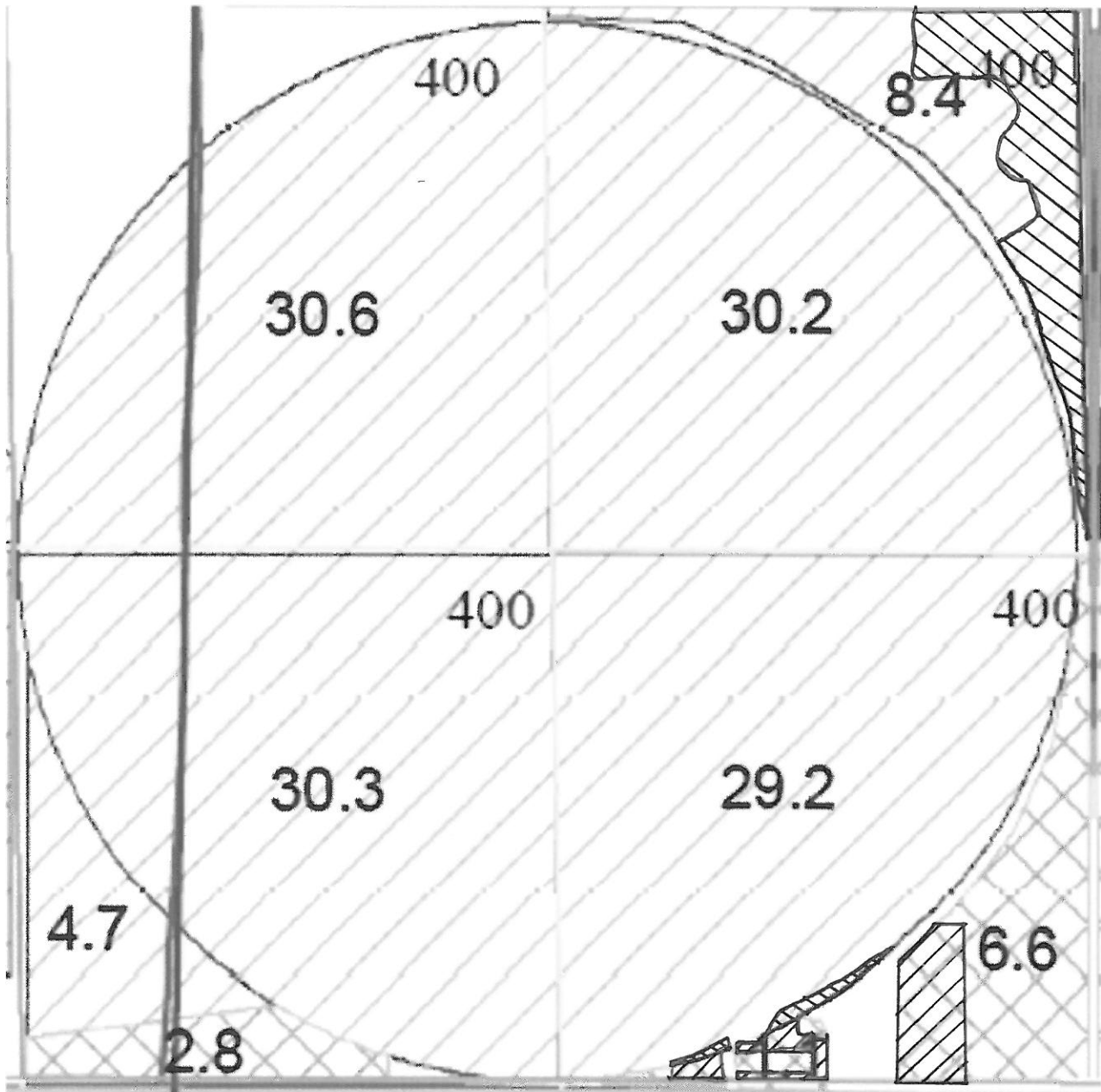



1 Inch = 400 Feet

Hermiston Irrigation District Temporary Instream Transfer Application

T4N, R29E, Sec 15, Tax Lot 600

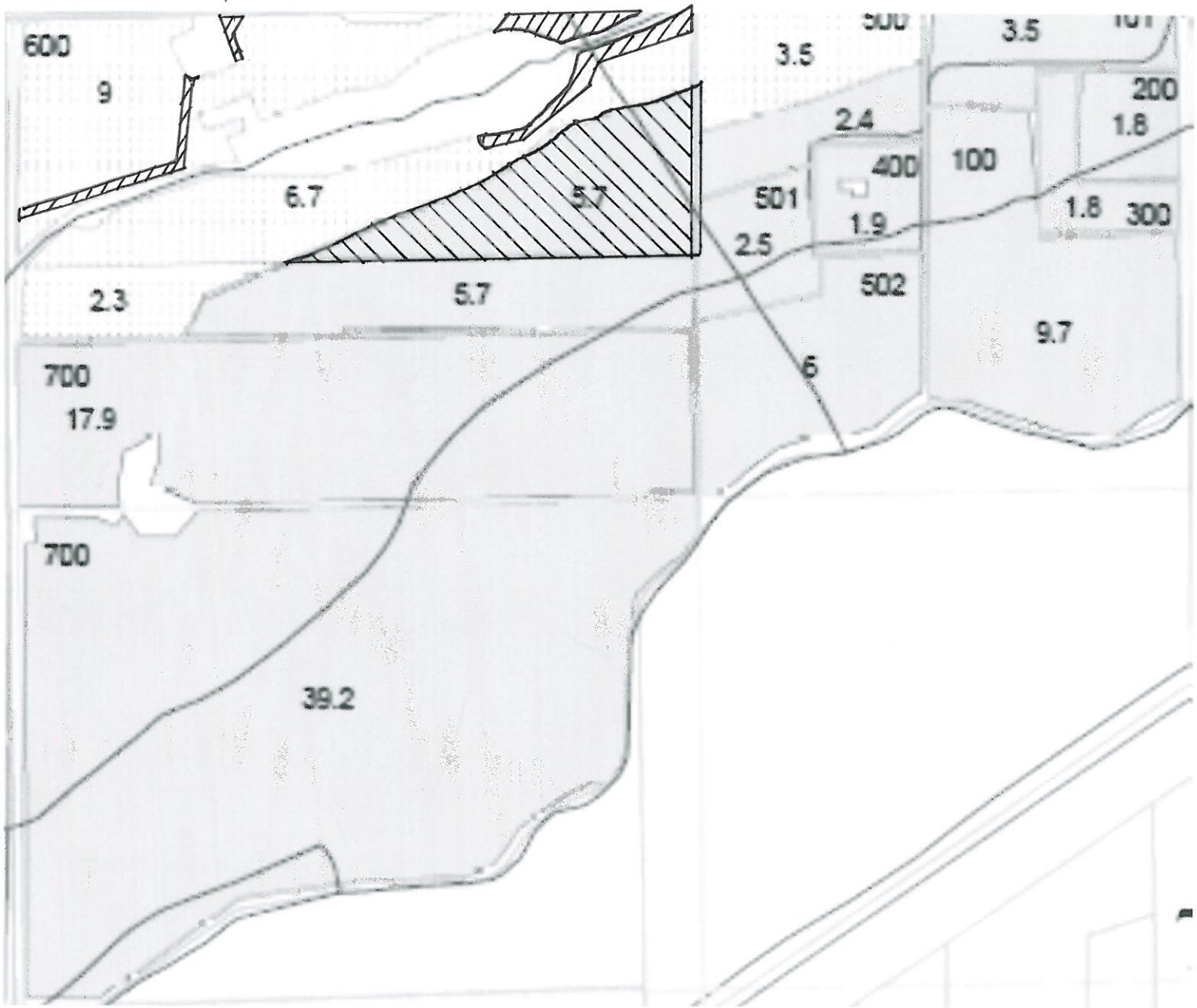
QQ NW NW 7.50 Acres



| | |
|---|---|
|  | 1905 Water Certificate #89006 3 AF 5.70 Acres |
|  | 1905 Water Certificate #89006 6 AF 1.80 Acres |

1 Inch = 400 Feet

Hermiston Irrigation District Temporary Instream Transfer Application

T5N, R29E, Sec 33, Tax Lot 700
QQ SE NW 4.00 Acres



1 Inch = 400 Feet

Hermiston Irrigation District Temporary Instream Transfer Application