

RECEIVED

DEC 05 2018

OWRD

Part 5 of 5 - Water Use Permit Information

Please use a separate Part 5 for each permit being changed. See instructions on page 6, to copy and paste additional Part 5s, or to add additional rows to tables within the form.

PERMIT # (APP) G-17865

Table 1. Location of Authorized and Proposed Point(s) of Diversion (POD) or Appropriation (POA) (Note: If the POD/POA name is not specified in the permit, assign it a name or number here.)

Table with 8 columns: POD/POA Name or Number, Is this POD/POA Authorized by the permit or is it Proposed?, If POA, OWRD Well Log ID# (or Well ID Tag # L-), Twp, Rng, Sec, 1/4 1/4, Tax Lot, DLC or Gov't Lot, Measured Distances (from a recognized survey corner). Handwritten entries include MALH 54314, 24 S 39 E 6, lot 8, 300, 2605' S 1265' E NW Corner Sec 6, 43.57683, -117.98906.

Check all type(s) of change(s) proposed below (change "CODES" are provided in parentheses):

- Place of Use (POU) [checked]
Point of Appropriation/Well (POA) [checked]
Point of Diversion (POD) [ ]
Additional Point of Appropriation (APOA) [ ]
Additional Point of Diversion (APOD) [ ]
Surface water POD to Ground Water POA (SW/GW) [ ]

Will all of the proposed changes affect the entire water use permit?

- Yes [checked] Complete only the proposed ("to" lands) section of Table 2 on the next page. Use the "CODES" listed above to describe the proposed changes.
No [ ] Complete all of Table 2 to describe the portion of the permit to be changed.

For a change in place of use:

Does the permit holder of record own or control the land TO which the place of use is being moved? [checked] Yes [ ] No

If NO, the landowner of the land TO which the place of use is being moved must be assigned to the permit as a permit holder of record by submitting a completed Request for Assignment form and the required statutory fee for an assignment.

Is the proposed place of use contiguous to the authorized place of use? [ ] Yes [checked] No

The permitted place of use can be moved only to lands that are contiguous to the authorized place of use unless the change to non-contiguous lands is in furtherance of mitigation or conservation efforts undertaken for the purposes of benefiting a species listed as sensitive, threatened, or endangered under ORS 496.171 to 496.192 or the federal Endangered Species Act of 1973 (16 U.S.C. 1531 to 1544), as determined by the

RECEIVED

DEC 05 2018

Please use and attach additional pages of Table 2 as needed.  
See page 6 for instructions.

OWRPD

Do you have questions about how to fill-out the tables?  
Contact the Department at 503-986-0900 and ask for Transfer Staff.

**Table 2. Description of Changes to Water Use Permit # E17567 E17685**  
List the change proposed for the acreage in each 1/4 1/4. If more than one change is proposed, specify the acreage associated with each change.  
If there is more than one POD/POA involved in the proposed changes, specify the acreage associated with each POD/POA.

AUTHORIZED (the "from" or "off" lands) CHANGES										PROPOSED (the "to" or "on" lands) are made.											
List only that part or portion of the water right that will be changed.										The listing as it would appear AFTER PROPOSED CHANGES											
Twp	Rng	Sec	1/4	1/4	Tax Lot	Gvt Lot or DLC	Acreage (if applicable)	POD(s) or POA(s) (name or number from Table 1)	Priority Date	Proposed Changes (see "CODES" from previous page)	Twp	Rng	Sec	1/4	1/4	Tax Lot	Gvt Lot or DLC	Acreage (if applicable)	POD(s) or POA(s) to be used (from Table 1)	Priority Date	
EXAMPLE																					
2	S	9	E	15	NE	NW	100	15.0	POD #1		2	S	9	E	15	NW	NW	100	1	10.0	POD #5
								EXAMPLE										200		5.0	POD #6
24	S	39	E	6	NE	NW	300	13.6	Well #3		24	S	39	E	6	NE	NW	300		30.5	Well #3
					NW	NW		36.7	}	POA/POA					NW	NW			30.6		
					SW	NW		36.5		POA/POA						SW	NW			19.7	
					SE	NW		13.6	}	POA/POA					SE	NW			19.6		
					SW	NW		.3		Well #2	POA/POA					SW	NW			.3	Well #2
					NE	SW		19.5		POA/POA					NE	SW			19.5		
					NW	SW		40.6	}	POA/POA					NW	SW			40.6		
					SW	SW		88.0		POA/POA						SW	SW			88.0	
					SE	SW		12.3		POA/POA					SE	SW			12.3		
TOTAL ACRES											TOTAL ACRES										
over											over										

Additional remarks: \_\_\_\_\_





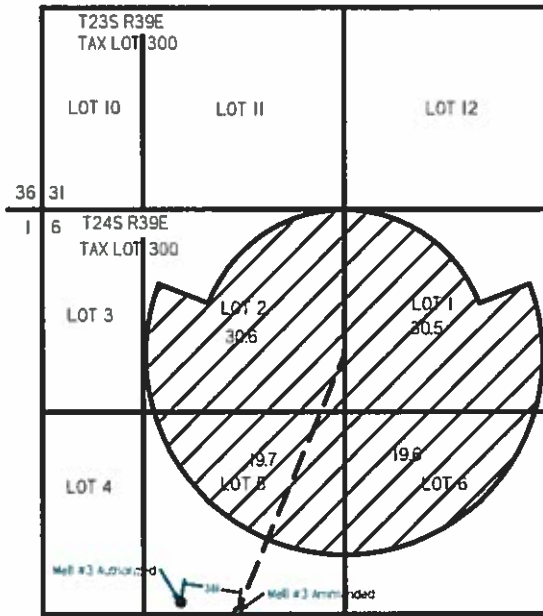

Scale: 1" = 1320'

**RECEIVED**  
**DEC 06 2018**  
**OWRD**

Authorized Locaiton Well#3  
 2560' South of NW Corner of SEC 6  
 900' East of NW Corner of SEC 6

Ammended Locaiton Well#3  
 2605' South of NW Corner of SEC 6  
 1265' East of NW Corner of SEC 6

**LEGEND**



Buried Pipeline Well



Proposed Permit G-17865 Place of Use

APPLICATION MAP FOR PLACE OF  
 USE & POINT OF APPROPRTIAON  
 AMMENDMENT FOR PERMIT  
 G-17865 & G-17567  
 FOR  
 V BOX LAND & LIVESTOCK CO.