

Part 5 of 5 – Water Right Information

Please use a separate Part 5 for each water right being changed. See instructions on page 6, to copy and paste additional Part 5s, or to add additional rows to tables within the form.

CERTIFICATE # 51715

Description of Water Delivery System

System capacity: 0.36 cubic feet per second (cfs) OR
 _____ gallons per minute (gpm)

RECEIVED
 FEB 05 2019

Describe the current water delivery system or the system that was in place at some time within the last five years. Include information on the pumps, canals, pipelines, and sprinklers used to divert, convey, and apply the water at the authorized place of use. Water is pumped from the well using a 15 Hp Jacuzzi submersible pump and conveyed through a buried 4" PVC mainline which supplies laterals for drip irrigation and rotor impact sprinklers to irrigate "test" grass and nursery stock.

Table 1. Location of Authorized and Proposed Point(s) of Diversion (POD) or Appropriation (POA)
 (Note: If the POD/POA name is not specified on the certificate, assign it a name or number here.)

Well Name	Status	MARI	S	S	2	W	34	SE	NE	DLC	Location
West Well 1	<input checked="" type="checkbox"/> Authorized <input type="checkbox"/> Proposed	MARI 2812	5	S	2	W	34	SE	NE	DLC 84	2,170 feet south and 1,100 feet west from the NE corner, Section 34.
East Well 1	<input type="checkbox"/> Authorized <input checked="" type="checkbox"/> Proposed	MARI 2857	5	S	2	W	35	SW	NW	DLC 84	2,685 feet north and 115 feet east from the SE corner, Section 34.
East Well 2	<input type="checkbox"/> Authorized <input checked="" type="checkbox"/> Proposed	NA	5	S	2	W	34	SE	NE	DLC 84	2,170 feet south and 515 feet west from the NE corner, Section 34.

Ranil
2-5-19
D/H

Check all type(s) of change(s) proposed below (change "CODES" are provided in parentheses):

- | | |
|--|---|
| <input type="checkbox"/> Place of Use (POU) | <input type="checkbox"/> Supplemental Use to Primary Use (S to P) |
| <input type="checkbox"/> Character of Use (USE) | <input checked="" type="checkbox"/> Point of Appropriation/Well (POA) |
| <input type="checkbox"/> Point of Diversion (POD) | <input type="checkbox"/> Additional Point of Appropriation (APOA) |
| <input type="checkbox"/> Additional Point of Diversion (APOD) | <input type="checkbox"/> Substitution (SUB) |
| <input type="checkbox"/> Surface Water POD to Ground Water POA (SW/GW) | <input type="checkbox"/> Government Action POD (GOV) |

Will all of the proposed changes affect the entire water right?

- Yes Complete only the Proposed ("to" or "on" lands) section of Table 2 on the next page. Use the "CODES" listed above to describe the proposed changes.
- No Complete all of Table 2 to describe the portion of the water right to be changed.

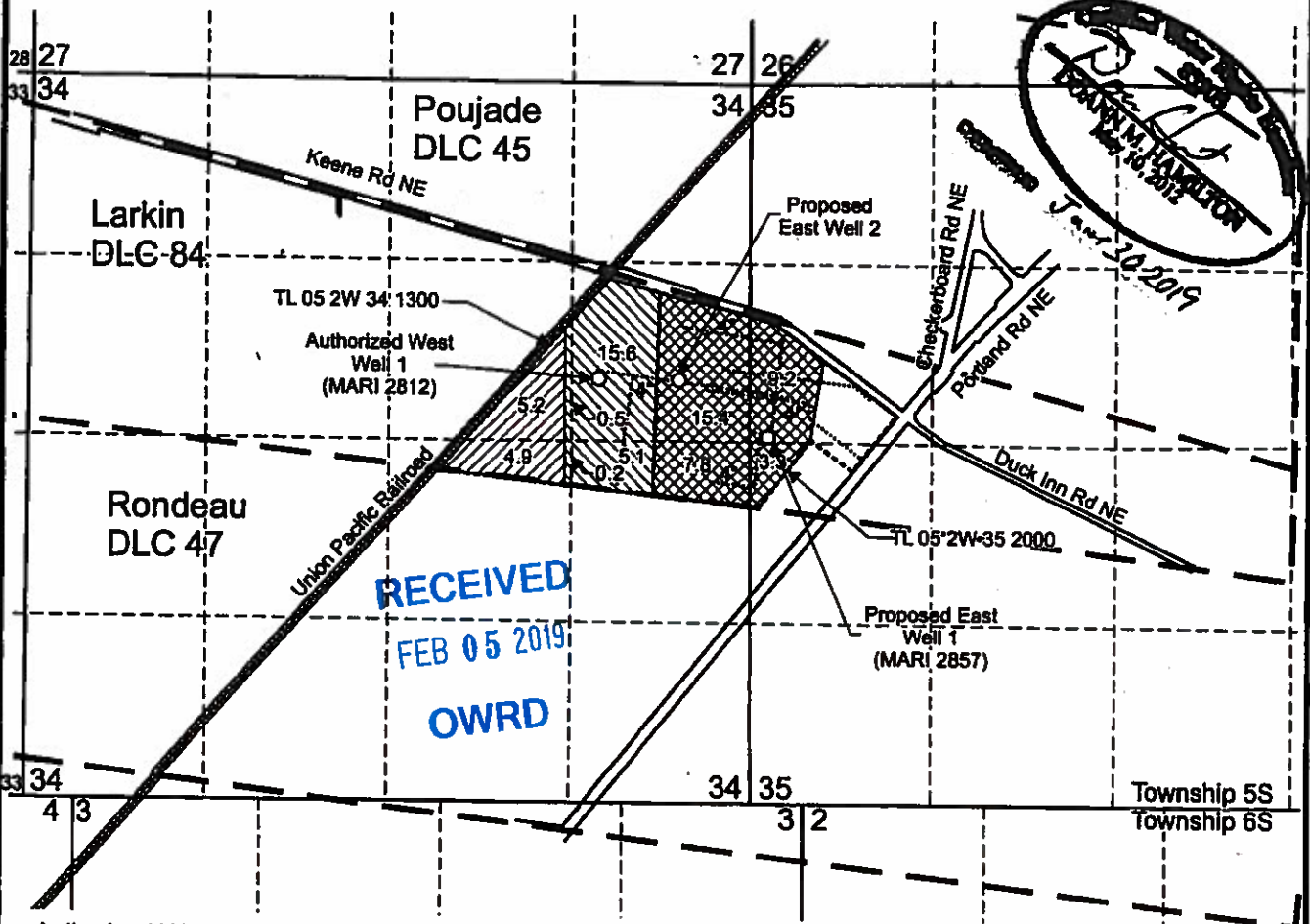

T.5S. R.2W. Sec. 34 & 35, W.M.



Authorized West Well 1 (MARI 2812) is located 2,170 feet south and 1,100 feet west from the NE corner, Section 34.

Proposed East Well 1 (MARI 2857) is located 2,685 feet north and 115 feet east from the SE corner, Section 34.

Proposed East Well 2 is located 2,170 feet south and 515 feet west from the NE corner, Section 34.

-  Area (10.1 Acres) of primary irrigation under Certificate 54715, priority February 10, 1983, not affected by this transfer.
-  Area (21.4 Acres) of supplemental irrigation under Certificate 54715, priority February 10, 1983, not affected by this transfer.
-  Area (35.7 Acres) of supplemental irrigation under Certificate 54715, priority February 10, 1983, affected by this transfer.

----- Tax lot boundary - - - - - Donation Land Claim boundary Water main line

Scale: 1" = 1,320'



This map was prepared for the purpose of identifying the location of a water right only and is not intended to provide legal dimensions or location of property ownership lines.

**Transfer Application Map
Certificate 54715**

The Scotts Company, LLC
T.5S. R.2W. Sec. 34 & 35, W.M.

Pacific Hydro-Geology Inc.

12/2018
Rev 02/2019