

**Application for Water Right
Temporary or Drought Temporary Transfer
Part 1 of 5 – Minimum Requirements Checklist**

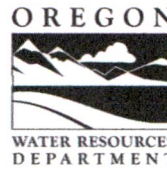

Oregon Water Resources Department
725 Summer Street NE, Suite A
Salem, Oregon 97301-1266
(503) 986-0900
www.oregon.gov/OWRD

This temporary transfer application will be returned if Parts 1 through 5 and all required attachments are not completed and included.
For questions, please call (503) 986-0900, and ask for Transfer Section.

13198

FOR ALL TEMPORARY TRANSFER APPLICATIONS

RECEIVED

JUN 05 2019

OWRD

Check all items included with this application. (N/A = Not Applicable)

- Part 1 – Completed Minimum Requirements Checklist.
- Part 2 – Completed Temporary Transfer Application Map Checklist.
- Part 3 – Application Fee, payable by check to the Oregon Water Resources Department, and completed Fee Worksheet, page 3. Try the online fee calculator at: http://apps.wrd.state.or.us/apps/misc/wrd_fee_calculator. If you have questions, call Customer Service at (503) 986-0801.
- Part 4 – Completed Applicant Information and Signature.
- Part 5 – Information about Transferred Water Rights: **How many water rights are to be transferred? 1 List them here: 76441**
Please include a separate Part 5 for each water right. (See instructions on page 6)
- N/A For standard Temporary Transfer (one to five years) **Begin Year: 2019 End Year: 2023.**
- N/A Temporary Drought Transfer (Only in counties where the Governor has declared drought)

Attachments:

- Completed Temporary Transfer Application Map.
- Completed Evidence of Use Affidavit and supporting documentation.
- Current recorded deed for the land **from** which the authorized place of use is temporarily being moved.
- N/A Affidavit(s) of Consent from Landowner(s) (if the applicant does not own the land upon which the water right is located.)
- N/A Supplemental Form D – For water rights served by or issued in the name of a district. Complete when the temporary transfer applicant is not the district.
- N/A Oregon Water Resources Department’s Land Use Information Form with approval and signature (or signed land use form receipt stub) from each local land use authority in which water is to be diverted, conveyed, and/or used. Not required if water is to be diverted, conveyed, and/or used only on federal lands or if **all** of the following apply: a) a change in place of use only, b) no structural changes, c) the use of water is for irrigation only, and d) the use is located within an irrigation district or an exclusive farm use zone.
- N/A Water Well Report/Well Log for changes in point(s) of appropriation (well(s)) or additional point(s) of appropriation (if necessary to convey water to the proposed place of use).

(For Staff Use Only)

WE ARE RETURNING YOUR APPLICATION FOR THE FOLLOWING REASON(S):

___ Application fee not enclosed/or is insufficient	___ Map not included or incomplete
___ Land Use Form not enclosed or incomplete	___ Additional signature(s) required
___ Part ___ is incomplete	Other/Explanation _____

Staff: _____ 503-986-0 _____ Date: ___/___/___

Part 2 of 5 – Temporary Transfer Application Map Checklist

Your temporary transfer application will be returned if any of the map requirements listed below are not met.

Please be sure that the temporary transfer application map you submit includes all the required items and matches the existing water right map. Check all boxes that apply.

- N/A If **more than three** water rights are involved, separate maps are needed for each water right.
- Permanent quality printed with dark ink on good quality paper. 13198
- The size of the map can be 8½ x 11 inches, 8½ x 14 inches, 11 x 17 inches, or up to 30 x 30 inches. For 30 x 30 inch maps, one extra copy is required. RECEIVED
- A north arrow, a legend, and scale. JUN 05 2019
- The scale of the map must be: 1 inch = 400 feet, 1 inch = 1,320 feet; the scale of the Final Proof/Claim of Beneficial Use Map (the map used when the permit was certificated); the scale of the county assessor map if the scale is not smaller than 1 inch = 1,320 feet; or a scale that has been pre-approved by the Department. OWRD
- Township, Range, Section, ¼ ¼, DLC, Government Lot, and other recognized public land survey lines.
- Tax lot boundaries (property lines) are required. Tax lot numbers are recommended.
- Major physical features including rivers and creeks showing direction of flow, lakes and reservoirs, roads, and railroads.
- Major water delivery system features from the point(s) of diversion/appropriation such as main pipelines, canals, and ditches.
- Existing place of use that includes separate hachuring for each water right, priority date, and use including number of acres in each quarter-quarter section, government lot, or in each quarter-quarter section as projected within government lots, donation land claims, or other recognized public land survey subdivisions. If less than the entirety of the water right is being changed, a separate hachuring is needed for lands left unchanged.
- N/A Proposed temporary place of use that includes separate hachuring for each water right, priority date, and use including number of acres in each quarter-quarter section, government lot, or in each quarter-quarter section as projected within government lots, donation land claims, or other recognized public land survey subdivisions.
- Existing point(s) of diversion or well(s) with distance and bearing or coordinates from a recognized survey corner. This information can be found in your water right certificate or permit.
- N/A If you are proposing a change in point(s) of diversion or well(s) to convey water to the new temporary place of use, show the proposed location and label it clearly with distance and bearing or coordinates. If GPS coordinates are used, latitude-longitude coordinates may be expressed as either degrees-minutes-seconds with at least one digit after the decimal (example – 42°32'15.5") or degrees-decimal with five or more digits after the decimal (example – 42.53764°).

Part 3 of 5 – Fee Worksheet

FEE WORKSHEET for TEMPORARY (not drought) TRANSFERS			
1	Base Fee (includes temporary change to one water right for up to 1 cfs)	1	\$810.00
2	Number of water rights included in transfer: <u>1</u> (2a) Subtract 1 from the number in 3a above: <u>0</u> (2b) <i>If only one water right this will be 0</i> Multiply line 2b by \$260.00 and enter » » » » » » » » » » » » » » » »	2	
3	Do you propose to change the place of use for a non-irrigation use? <input checked="" type="checkbox"/> No: enter 0 on line 3 » » » » » » » » » » » » » » » » <input type="checkbox"/> Yes: enter the cfs for the portions of the rights to be transferred: _____ (3a) Subtract 1.0 from the number in 3a above: _____ (3b) If 3b is 0, enter 0 on line 3 » » » » » » » » » » » » » » » » If 3b is greater than 0, round up to the nearest whole number: _____ (3c) and multiply 4c by \$200.00, then enter on line 3	3	
4	Do you propose to change the place of use for an irrigation use? <input type="checkbox"/> No: enter 0 on line 4 » » » » » » » » » » » » » » » » <input checked="" type="checkbox"/> Yes: enter the number of acres for the portions of the rights to be transferred: <u>21.0</u> (4a) Multiply the number of acres in 4a above by \$2.30 and enter on line 4 » »	4	\$48.30
5	Add entries on lines 1 through 4 above » » » » » » » » » » » » Subtotal:	5	\$858.30
6	Is this transfer: <input type="checkbox"/> necessary to complete a project funded by the Oregon Watershed Enhancement Board (OWEB) under ORS 541.932? <input type="checkbox"/> endorsed in writing by ODFW as a change that will result in a net benefit to fish and wildlife habitat? If one or more boxes is checked, multiply line 5 by 0.5 and enter on line 6 » If no box is applicable, enter 0 on line 7 » » » » » » » » » » » » » » » »	6	
7	Subtract line 6 from line 5 » » » » » » » » » » » » » » » » Transfer Fee:	7	\$858.30

FEE WORKSHEET for TEMPORARY DROUGHT TRANSFERS			
1	Base Fee (includes drought application and recording fee for up to 1 cfs)	1	\$200.00
2	Enter the cfs for the portions of the rights to be transferred (see example below*): _____ (2a) Subtract 1.0 from the number in 2a above: _____ (2b) If 2b is 0, enter 0 on line 2 » » » » » » » » » » » » » » » » If 2b is greater than 0, round up to the nearest whole number: _____ (2c) and multiply 2c by \$50, then enter on line 2 » » » » » » » » » » » »	2	
3	Add entries on lines 1 through 2 above » » » » » » » » » » » » Transfer Fee:	3	

*Example for Line 2a calculation to transfer 45.0 acres of Primary Certificate 12345 (total 1.25 cfs for 100 acres) and 45.0 acres of Supplemental Certificate 87654 (1/80 cfs per acre) on the same land:

1. Divide total authorized cfs by total acres in the water right (for C12345, 1.25 cfs ÷ 100 ac); then multiply by the number of acres to be transferred to get the transfer cfs (x 45 ac = 0.56 cfs).
2. If the water right certificate does not list total cfs, but identifies the allowable use as 1/40 or 1/80 of a cfs per acre; multiply number of acres proposed for change by either 0.025 (1/40) or 0.0125 (1/80). (For C87654, 45.0 ac x 0.0125 cfs/ac = 0.56 cfs)
3. Add cfs for the portions of water rights on all the land included in the transfer; however **do not count cfs for supplemental rights on acreage for which you have already calculated the cfs fee for the primary right on the same land.** The fee should be assessed only once for each "on the ground" acre included in the transfer. (In this example, blank 2a would be only 0.56 cfs, since both rights serve the same 45.0 acres. Blank 2b would be 0 and Line 2 would then also become 0).

13198

RECEIVED

JUN 05 2019

OWRD

Part 4 of 5 – Applicant Information and Signature

Applicant Information

APPLICANT/BUSINESS NAME Jerald Bush		PHONE NO. 541.609.7690	ADDITIONAL CONTACT NO.
ADDRESS 24402 Maxfield Creek Road			FAX NO.
CITY Philomath	STATE Oregon	ZIP 97370	E-MAIL jbushranch@gmail.com
BY PROVIDING AN E-MAIL ADDRESS, CONSENT IS GIVEN TO RECEIVE ALL CORRESPONDENCE FROM THE DEPARTMENT ELECTRONICALLY. COPIES OF THE FINAL ORDER DOCUMENTS WILL ALSO BE MAILED.			

Agent Information – The agent is authorized to represent the applicant in all matters relating to this application.

AGENT/BUSINESS NAME Bill Ferber/BK Water Right Consulting		PHONE NO. 503.910.9212	ADDITIONAL CONTACT NO.
ADDRESS PO Box 13434			FAX NO.
CITY Salem	STATE Oregon	ZIP 97309	E-MAIL bill@bkwrc.com
BY PROVIDING AN E-MAIL ADDRESS, CONSENT IS GIVEN TO RECEIVE ALL CORRESPONDENCE FROM THE DEPARTMENT ELECTRONICALLY. COPIES OF THE FINAL ORDER DOCUMENTS WILL ALSO BE MAILED.			

Explain in your own words what you propose to accomplish with this transfer application and why:
 Temporarily transfer senior water rights to ground planted in high value crop and add an additional POD to facilitate irrigation of the high value crop.
 If you need additional space, continue on a separate piece of paper and attach to the application as "Attachment 1".

I (we) affirm that the information contained in this application is true and accurate.

 Applicant signature	Jerald Bush Print Name (and Title if applicable)	6-4-19 Date
_____ Applicant signature	_____ Print Name (and Title if applicable)	_____ Date

Is the applicant the sole owner of the land on which the water right, or portion thereof, proposed for transfer is located? Yes No

If NO, include signatures of all landowners (and mailing and/or e-mail addresses if different than the applicant's) or attach affidavits of consent from all landowners or individuals/entities (and mailing and/or e-mail addresses) to which the water right(s) has been conveyed.

13198

RECEIVED

JUN 05 2019

OWRD

Check here if any of the water rights proposed for transfer are or will be located within or served by an irrigation or other water district. (NOTE: If this box is checked, you must complete and attach Supplemental Form D.)

DISTRICT NAME	ADDRESS	
CITY	STATE	ZIP

Check here if water for any of the rights supplied under a water service agreement or other contract for stored water with a federal agency or other entity.

ENTITY NAME	ADDRESS	
CITY	STATE	ZIP

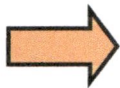

To meet State Land Use Consistency Requirements, you must list all local governments (each county, city, municipal corporation, or tribal government) within whose jurisdiction water will be diverted, conveyed and/or used.

ENTITY NAME Polk County Community Services	ADDRESS 850 Main Street #203	
CITY Dallas	STATE Oregon	ZIP 97338

ENTITY NAME	ADDRESS	
CITY	STATE	ZIP

- 13198

RECEIVED

JUN 05 2019

OWRD

Part 5 of 5 – Water Right Information

Please use a separate Part 5 for each water right being changed. See instructions on page 6, to copy and paste additional Part 5s, or to add rows to tables within the form.

Water Right Certificate # 76441

Description of Water Delivery System

System capacity: 0.8 cubic feet per second (cfs) OR **13198**
 _____ gallons per minute (gpm)

RECEIVED
 JUN 05 2019
 OWRD

Describe the current water delivery system or the system that was in place at some time within the last five years. Include information on the pumps, canals, pipelines, and sprinklers used to divert, convey, and apply the water at the authorized place of use. **40 Hp electric pump pumps from Luckiamute River to a big gun system pumping around 350 gpm to the areas to be irrigated**

Table 1. Location of Authorized and Proposed Point(s) of Diversion (POD) or Appropriation (POA)

(Note: If the POD/POA name is not specified on the certificate, assign it a name or number here.)

POD/POA Name or Number	Is this POD/POA Authorized on the Certificate or is it Proposed?	If POA, OWRD Well Log ID# (or Well ID Tag # L-_____)	Twp		Rng		Sec	¼ ¼		Tax Lot, DLC or Gov't Lot	Measured Distances (from a recognized survey corner)
DIV. PT. #3	<input checked="" type="checkbox"/> Authorized <input type="checkbox"/> Proposed		10	S	6	W	29	SE	N W	-	As projected with Allend DLC 42, W.M.; 200' N and 2950' E from the NW Corner of Watson DLC 40
Point of Diversion	<input type="checkbox"/> Authorized <input checked="" type="checkbox"/> Proposed		9	S	5	W	19	S W	NE		450' N and 1570' W from the East Quarter Corner of Section 19, T 9 S, R 5 W, Willamette Meridian
	<input type="checkbox"/> Authorized <input type="checkbox"/> Proposed										
	<input type="checkbox"/> Authorized <input type="checkbox"/> Proposed										

Check all type(s) of temporary change(s) proposed below (change "CODES" are provided in parentheses):

- Place of Use (POU) Appropriation/Well (POA)
- Point of Diversion (POD) Additional Point of Appropriation (APOA)
- Additional Point of Diversion (APOD)

Check all type(s) of temporary change(s) due to drought proposed below (change "CODES" are provided in parentheses):

- Place of Use (POU) Point of Appropriation/Well (POA)
- Character of Use (USE) Additional Point of Appropriation (APOA)
- Point of Diversion (POD) Additional Point of Diversion (APOD)

Will all of the proposed changes affect the entire water right?

- Yes Complete only the Proposed (“to” lands) section of Table 2 on the next page. Use the “CODES” listed above to describe the proposed changes.
- No Complete all of Table 2 to describe the portion of the water right to be changed.

RECEIVED

JUN 05 2019

OWRD

13198

Please use and attach additional pages of Table 2 as needed.
See page 6 for instructions.

Do you have questions about how to fill-out the tables?
Contact the Department at 503-986-0900 and ask for Transfer Staff.

Table 2. Description of Temporary Changes to Water Right Certificate # 76441

List only the part of the right that will be changed. For the acreage in each 1/4 1/4, list the change proposed. If more than one change, specify the acreage associated with each change. If more than one POD/POA, specify the acreage associated with each POD/POA.

AUTHORIZED (the "from" or "off" lands)											PROPOSED (the "to" or "on" lands)												
The listing that appears on the Certificate BEFORE PROPOSED CHANGES											The listing as it would appear AFTER PROPOSED CHANGES												
List only that part or portion of the water right that will be changed.											are made.												
Twp	Ring	Sec	1/4	1/4	Tax Lot	Gvt Lot or DLC	Acres	Type of USE listed on Certificate	POD(s) or POA(s) (name or number from Table 1)	Priority Date	Proposed Changes (see "CODES" from previous page)	Twp	Ring	Sec	1/4	1/4	Tax Lot	Gvt Lot or DLC	Acres	New Type of USE	POD(s) to be used (from Table 1)	Priority Date	
EXAMPLE																							
2 S	9 E	15 NE	NW	100			15.0	Irrigation	POD #1	1901	POU/POD	2 S	9 E	1 NW	NW	500	1	10.0		POD #5	1901		
" "	" "	" "	" "	" "	" "	" "	" "	EXAMPLE	POD #2	" "	" "	2 S	9 E	2 SW	NW	500		5.0		POD #6	1901		
10 S	6 W	29 NW	NE	500			1.7	Irrigation	DIV. PT. #3	1951	POU	9 S	5 W	20 SW	NW	400	---	2.1		N/A	Point of Diversion	1951	
10 S	6 W	29 NW	NE	300			6.4	Irrigation	DIV. PT. #3	1951	POU	9 S	5 W	20 NW	SW	400	---	12.9		N/A	Point of Diversion	1951	
10 S	6 W	29 SW	NE	300			12.9	Irrigation	DIV. PT #3	1951	POU	9 S	5 W	19 NE	SE	400	---	6.0		N/A	Point of Diversion	1951	
											APOD	9 S	5 W	19 SW	NE	900	---	N/A		N/A	Point of Diversion	1951	
TOTAL ACRES											21.0	TOTAL ACRES											21.0

Additional remarks: **21.0 acres of the total 99.1 acres of C 76441 are involved in this Temporary Transfer.**

RECEIVED

For Place of Use Changes

Are there other water right certificates, water use permits or ground water registrations associated with the “from” or the “to” lands? Yes No

If YES, list the certificate, water use permit, or ground water registration numbers: _____

Pursuant to ORS 540.525, any “layered” water use such as an irrigation right that is supplemental to a primary right proposed for temporary transfer can be included in the transfer or remain unused on the authorized place of use. If the primary water right does not revert soon enough to allow use of the supplemental right within five years, the supplemental right shall become subject to cancellation for nonuse under ORS 540.610.

If a change in point(s) of appropriation (well(s)) or additional point(s) of appropriation is necessary to convey the water to the new temporary place of use you must provide:

- Well log(s) for each authorized and proposed well(s) that are clearly labeled and associated with the corresponding well(s) in Table 1 above and on the accompanying application map. (**Tip:** You may search for well logs on the Department’s web page at: http://apps.wrd.state.or.us/apps/gw/well_log/Default.aspx)

AND/OR

- Describe the construction of the authorized and proposed well(s) in Table 3 below for any well that does not have a well log. For a *proposed well(s) not yet constructed or built*, provide “a best estimate” for each requested information element in the table. The Department recommends you consult a licensed well driller, geologist, or certified water right examiner to assist with assembling the information necessary to complete Table 3.

Table 3. Construction of Point(s) of Appropriation

Any well(s) in this listing must be clearly tied to corresponding well(s) described in Table 1 and shown on the accompanying application map. Failure to provide the information will delay the processing of your transfer application until it is received. The information is necessary for the Department to assess whether the proposed well(s) will access the same source aquifer as the authorized point(s) of appropriation (POA). The Department is prohibited by law from approving POA changes that do not access the same source aquifer.

Proposed or Authorized POA Name or Number	Is well already built? (Yes or No)	If an existing well, OWRD Well ID Tag No. L-___	Total well depth	Casing Diameter	Casing Intervals (feet)	Seal depth(s) (intervals)	Perforated or screened intervals (in feet)	Static water level of completed well (in feet)	Source aquifer (sand, gravel, basalt, etc.)	Well - specific rate (cfs or gpm). If less than full rate of water right

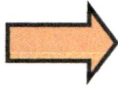

 RECEIVED

 JUN 05 2019

 13198

 OWRD

RECEIVED
 JUL 22 1980
 WATER RESOURCES DEPT.
 SALEM, OREGON

RECEIVED
 AUG 11 1980
 WATER RESOURCES DEPT.
 SALEM, OREGON

T-4569

Jerald Bush 2019 Temporary Transfer
 to Chris Horton

FROM Lands
 T. 10 S, R. 6 W, W.M.

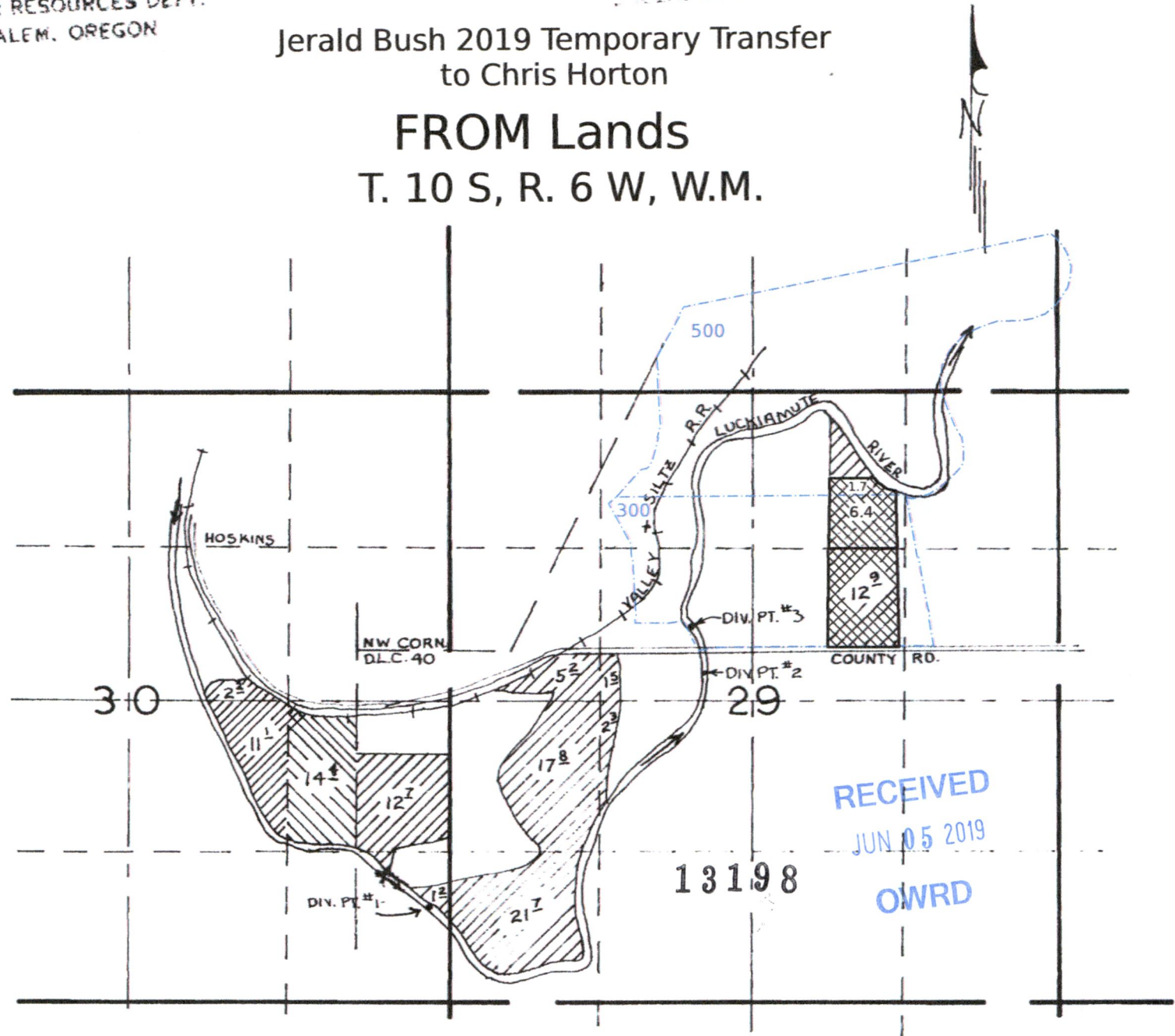

RECEIVED
 JUN 05 2019
 OWRD

Legend

-  **FROM Lands**
 All other lands are not part of this Temporary Transfer
-  **Tax Lot Boundry**

GRACEN L. BUSH

- Div. Pt. #1 - SE1/4 SE1/4, as projected within Watson DLC 40, Section 30, T. 10 S, R. 6 W, W.M.; 2200' S and 620' E from the NW Corner of Watson DLC 40.
- Div. Pt. #2 - SE1/4 NW1/4, as projected within Watson DLC 40, Section 29, T. 10 S, R. 6 W, W.M.; 170' S and 2940' E from the NW Corner of Watson DLC 40.
- Div. Pt. #3 - SE1/4 NW1/4, as projected within Allen DLC 42, Section 29, T. 10 S, R. 6 W, W.M.; 200' N and 2950' E from the NW Corner of Watson DLC 40.

scale: 4" = 1 Mile

STATE OF OREGON
COUNTY OF BENTON
CERTIFICATE OF WATER RIGHT

THIS CERTIFICATE ISSUED TO

GRACEN L. BUSH
ROUTE 1, BOX 76
PHILOMATH, OREGON 97370

confirms the right to use the waters of LUCKIAMUTE RIVER, a tributary of WILLAMETTE RIVER, for IRRIGATION OF 99.1 ACRES.

This right was perfected under Permit 20809. The date of priority is OCTOBER 12, 1951. The amount of water to which this right is entitled is limited to an amount actually beneficially used and shall not exceed 1.24 CUBIC FEET PER SECOND, or its equivalent in case of rotation, measured at the point of diversion from the source.

The points of diversion are located as follows:

SE 1/4 SE 1/4, AS PROJECTED WITH WATSON DLC 40, SECTION 30,
TOWNSHIP 10 SOUTH, RANGE 6 WEST, W.M.; 2200 FEET SOUTH AND 620 FEET EAST
FROM THE NW CORNER OF WATSON DLC 40; AND

SE 1/4 NW 1/4, AS PROJECTED WITH WATSON DLC 40, SECTION 29,
TOWNSHIP 10 SOUTH, RANGE 6 WEST, W.M.; 170 FEET SOUTH AND 2940 FEET EAST
FROM THE NW CORNER OF WATSON DLC 40; AND

SE 1/4 NW 1/4, AS PROJECTED WITH ALLEN DLC 42, SECTION 29,
TOWNSHIP 10 SOUTH, RANGE 6 WEST, W.M.; 200 FEET NORTH AND 2950 FEET EAST
FROM THE NW CORNER OF WATSON DLC 40.

The amount of water used for irrigation, together with the amount secured under any other right existing for the same lands, is limited to ONE-EIGHTIETH of one cubic foot per second per acre, or its equivalent for each acre irrigated and shall be further limited to a diversion of not to exceed 2.5 acre-feet per acre for each acre irrigated during the irrigation season of each year.

The use shall conform to such reasonable rotation system as may be ordered by the proper state officer.

A description of the place of use to which this right is appurtenant is as follows:

NW 1/4 NE 1/4	10.5 ACRES
SW 1/4 NE 1/4	12.9 ACRES
BOTH AS PROJECTED WITHIN ALLEN DLC 42	
SW 1/4 NW 1/4	5.2 ACRES
SE 1/4 NW 1/4	1.5 ACRES
NE 1/4 SW 1/4	2.3 ACRES
NW 1/4 SW 1/4	17.8 ACRES
SW 1/4 SW 1/4	20.4 ACRES
ALL AS PROJECTED WITHIN WATSON DLC 40	
LOT 3 (SW 1/4 SW 1/4)	1.3 ACRES
SECTION 29	

PAGE 1 OF 2

13198

RECEIVED

JUN 05 2019

OWRD

SW 1/4 NE 1/4 2.2 ACRES
NW 1/4 SE 1/4 11.1 ACRES
BOTH AS PROJECTED WITHIN VAN PEER DLC 41

NE 1/4 SE 1/4 12.7 ACRES
SE 1/4 SE 1/4 1.2 ACRES
BOTH AS PROJECTED WITHIN WATSON DLC 40
SECTION 30
TOWNSHIP 10 SOUTH, RANGE 6 WEST, W.M.

The right to the use of the water for the above purpose is restricted to beneficial use on the lands or place of use described. The use confirmed herein may be made only at times when sufficient water is available to satisfy all prior rights, including rights for maintaining instream flows.

This certificate is issued to confirm a change in POINT OF DIVERSION AND PLACE OF USE approved by an order of the Water Resources Director entered MAY 18, 1981, and along with Certificate 50120, supersedes Certificate 24316, State Record of Water Right Certificates.

The issuance of this superseding certificate does not confirm the status of the water right in regard to the provisions of ORS 540.610 pertaining to forfeiture or abandonment.

WITNESS the signature of the Water Resources Director, affixed FEBRUARY 28, 2000.

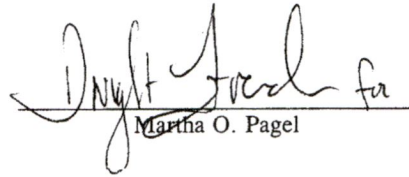
Martha O. Pagel

13198

RECEIVED

JUN 05 2019

OWRD

Recorded in State Record of Water Right Certificates numbered 76441.

RECEIVED

JUN 05 2019

OWRD

13198

Grantor's Name and Address:

Gracen L. Bush, Trustee of the Gracen L. Bush Revocable Living Trust dated April 23, 1990 and Gracen L. Bush, Trustee of the Jessie O. Bush Credit Shelter Trust dated October 14, 1998

Grantee's Name and Address:

Steven R. Bush
23251 Hoskins Rd.
Philomath, OR 97370

Jerald L. Bush
24402 Maxfield Creek Rd.
Philomath, OR 97370

After recording, return to:

Marek & Lanker, LLP
810 SW Madison Avenue
Corvallis, OR 97333

BENTON COUNTY, OREGON 2014-519192
 DE-88
 Cnt=2 Stn=9 PF 06/16/2014 01:12:38 PM
 \$35.00 \$5.00 \$11.00 \$22.00 \$10.00 \$103.00
 00280874201488181820070075



I, James V. Morales, County Clerk for Benton County, Oregon, certify that the instrument identified herein was recorded in the Clerk records.

James V. Morales - County Clerk



Send Tax Statements regarding Tax Lots 360 on Map 10628 and Tax Lot 501 on Map 10620 and Accounts 291631 and 025183 to:
Steven R. Bush
23251 Hoskins Rd.
Philomath, OR 97370

Send Tax Statements regarding Tax Lots 303 on Map 10629 and Tax Lot 500 on Map 10620 and Accounts 291462 and 024475 to:
Jerald L. Bush
24402 Maxfield Creek Rd.
Philomath, OR 97370

Consideration - \$ 0.00

BARGAIN and SALE DEED

GRANTOR, Gracen L. Bush, Trustee of the Gracen L. Bush Revocable Living Trust dated April 23, 1990 and Gracen L. Bush, Trustee of the Jessie O. Bush Credit Shelter Trust dated October 14, 1998 does hereby convey unto

GRANTEE: Jerald L. Bush the following described property located in Benton County, State of Oregon:
Parcels 2 and 3 on the attached Exhibit A

GRANTOR further conveys unto

GRANTEE: Steven R. Bush the following described property located in Benton County, State of Oregon:

Parcels 1 and 4 on the attached Exhibit A

Bargain and Sale Deed / Bush
Page 1

RECEIVED

SEP 04 2015

WATER RESOURCES DEPT
SALEM, OREGON

13198

RECEIVED

JUN 05 2019

OWRD

RECEIVED

JUN 05 2019

13198

OWRD

Each subject to the easements as specified on Exhibit A and other encumbrances of record.

To Have and to Hold the same unto grantee and grantee's heirs, successors and assigns.

The true and actual consideration paid for this transfer is \$0 and other value which is part of the consideration.

IN WITNESS WHEREOF, the grantor has executed this instrument on the 12th day of May, 2014.

BEFORE SIGNING OR ACCEPTING THIS INSTRUMENT, THE PERSON TRANSFERRING FEE TITLE SHOULD INQUIRE ABOUT THE PERSON'S RIGHTS, IF ANY, UNDER ORS 195.300, 195.301 AND 195.305 TO 195.336 AND SECTIONS 5 TO 11, CHAPTER 424, OREGON LAWS 2007, SECTIONS 2 TO 9 AND 17, CHAPTER 855, OREGON LAWS 2009 AND SECTIONS 2 TO 7, CHAPTER 8, OREGON LAWS 2010. THIS INSTRUMENT DOES NOT ALLOW USE OF THE PROPERTY DESCRIBED IN THIS INSTRUMENT IN VIOLATION OF APPLICABLE LAND USE LAWS AND REGULATIONS. BEFORE SIGNING OR ACCEPTING THIS INSTRUMENT, THE PERSON ACQUIRING FEE TITLE TO THE PROPERTY SHOULD CHECK WITH THE APPROPRIATE CITY OR COUNTY PLANNING DEPARTMENT TO VERIFY THAT THE UNIT OF LAND BEING TRANSFERRED IS A LAWFULLY ESTABLISHED LOT OR PARCEL, AS DEFINED IN ORS 92.010 OR 215.010, TO VERIFY THE APPROVED USES OF THE LOT OR PARCEL, TO DETERMINE ANY LIMITS ON LAWSUITS AGAINST FARMING OR FOREST PRACTICES AS DEFINED IN ORS 30.930 AND TO INQUIRE ABOUT THE RIGHTS OF NEIGHBORING PROPERTY OWNERS, IF ANY, UNDER ORS 195.300, 195.301 AND 195.305 TO 195.336 AND SECTIONS 5 TO 11, CHAPTER 424, OREGON LAWS 2007, AND SECTIONS 2 TO 9 AND 17, CHAPTER 855, OREGON LAWS 2009, AND SECTIONS 2 TO 7, CHAPTER 8, OREGON LAWS 2010.

Gracen L. Bush Trustee
Gracen L. Bush, Trustee of the Gracen L. Bush Revocable Living Trust dated April 23, 1990 and Trustee of the Jessie O. Bush Credit Shelter Trust dated October 14, 1998

STATE OF OREGON)
) ss.
County of Benton)

This instrument was acknowledged before me on this 12 day of May, 2014, by Gracen L. Bush, in his capacity as Trustee of the Gracen L. Bush Revocable Living Trust dated April 23, 1990 and Trustee of the Jessie O. Bush Credit Shelter Trust dated October 14, 1998.

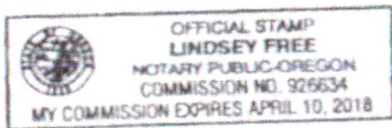

Lindsey Free
NOTARY PUBLIC FOR OREGON
My Commission Expires: 4-10-18

RECEIVED

SEP 04 2015

WATER RESOURCES DEPT
SALEM, OREGON

RECEIVED

JUN 05 2019

13198

OWRD

RECEIVED

SEP 04 2015

WATER RESOURCES DEPT
SALEM, OREGON

Parcel 1:

BEGINNING at the Southwest corner of the Charles Allen Donation Land Claim No. 42 in Township 10 South, Range 6 West of the Willamette Meridian in Benton County, Oregon; thence West 4 chains; thence North 38.64 chains; thence East to the Charles Allen Donation Land Claim No. 42; thence in a Southwesterly direction along West line of said claim to the PLACE OF BEGINNING.

TOGETHER WITH the following described tract of land:

A tract of land in Sections 20 and 29 of Township 10 South, Range 6 West, Willamette Meridian, Benton County, Oregon, said tract of land being a part of Parcels 2 and 3 of a tract described in Document M270382-99 which transferred ownership from the Jessie O. Bush Revocable Living Trust to the Jessie O. Bush Credit Shelter Trust and hereafter referred to as the "Bush tract", and more particularly described as follows:

BEGINNING at the Southwest Corner of the Allen DLC No. 42, which was found and described in a survey recorded as number 9141 by the Benton County Surveyor; thence N. 25 deg. 41'41" E. 2831.30 feet along the West line of the Allen DLC No. 42 to a 1-1/4" outside diameter iron pipe with 5/8" iron rod and yellow plastic cap alongside; thence leaving said DLC line S2 deg. 21'33" E. 687.81 feet to a 5/8" iron rod and yellow plastic

cap set in an angle point in a fence line; thence S. 16 deg. 23'14" W. 245.61 feet to a 5/8" iron rod and yellow plastic cap set in an angle point in a fence line; thence S. 23 deg. 11'10" W. 104.30 feet to a 5/8" iron rod and yellow plastic cap set in an angle point in a fence line; thence S. 71 deg. 59'44" W. 79.46 feet to a 5/8" iron rod and yellow plastic cap set in an angle point in a fence line; thence S. 45 deg. 33'02" W. 392.10 feet to a 5/8" iron rod and red plastic cap under a gate in a fence; thence S. 27 deg. 03'03" E. 402.10 feet to a 5/8" iron rod and yellow plastic cap; thence S. 1 deg. 43'16" E. 643.32 feet to a 5/8" iron rod and yellow plastic cap; thence S. 85 deg. 32'26" E. 192.41 feet to a 5/8" iron rod and yellow plastic cap; thence N. 88 deg. 35'00" E. 127.81 feet to a 5/8" iron rod and yellow plastic cap; thence continuing N. 88 deg. 35'00" E. 122.19 more or less in distance to the centerline of the Luckiamute River; thence S. 23 deg. E. along the centerline of the Luckiamute River 234.92 feet more or less to its intersection with the South line of said Bush tract; thence S. 89 deg. 43'35" W. 1525.82 feet along the South line of said Bush tract to the POINT OF BEGINNING.

SUBJECT TO a 15 foot wide (7-1/2 feet on each side of the waterline) easement for maintenance and construction of a waterline and spring for use by Parcel 2 described below; said spring is located approximately N. 70 deg. W. and 570 feet distant from said Southwest Corner of the Allen DLC No. 42, which was found and described in a survey recorded as number 9141 by the Benton County Surveyor. The spring is developed, but the waterline is not constructed at this time. It is expected that the future water line (and centerline of said easement) will start at the spring and head in an Easterly direction across the above Parcel 1 to Parcel 2 described below. The future waterline will not unreasonably hinder the use and enjoyment of the land by the owner of Parcel 1. The owner of Parcel 2 shall propose a location to the owner of Parcel 1, the owner of Parcel 1 may reject that location, but shall propose an alternate location, and the owner of Parcel 1 shall not unreasonably reject a location proposed by the owner of Parcel 2.

ALSO SUBJECT TO a 30 foot wide (15 feet on each side of the centerline) easement for ingress and egress for Parcels 2 and 3 described below on the existing gravel road, the centerline of said existing gravel road starts at a location within Hoskins County Road (Number 06540) at a point that is approximately N. 89 deg. 43' E. 1185 feet distant from said Southwest Corner of the Allen DLC No. 42, which was found and described in a survey recorded as number 9141 by the Benton County Surveyor; thence continuing along the existing centerline N. 12 deg. W. 220 feet more or less along the centerline of the said existing gravel road to the South boundary of Parcel 2.

ALSO SUBJECT TO an easement for transporting livestock between Parcels 2 and the tract of land directly South of Parcel 1 (across Hoskins County Road), said easement is subject to the rights of the public, said easement shall follow the existing dirt path that is directly west of the Luckiamute River, East of the existing home, garden and septic system, and goes under the bridge that allows said Hoskins County road to cross the Luckiamute River and is more particularly described as follows:

BEGINNING at a point that is approximately N. 89 deg. 43' E. 1450 feet distant from the said Southwest Corner of the Allen DLC No. 42, which was found and described in a survey recorded as number 9141 by the Benton County Surveyor; thence following the existing path that is adjacent to and directly west of the Luckiamute River in a Northerly direction approximately 250 feet to the South boundary of Parcel 2. It is intended that this easement will become void if the easement is no longer needed.

AND TOGETHER WITH a 15 foot wide (7-1/2 feet on each side of the waterline) easement for maintenance of a water line for the portions of the existing waterline that exists on Parcel 2, the centerline of said waterline starts at a spring that is located (on Parcel 1) approximately N. 31 deg. E. and 1200 feet distant from said Southwest Corner of the Allen DLC No. 42, which was found and described in a survey recorded as number 9141 by the Benton County Surveyor, said water line flows from said spring approximately Southeasterly for 1200 feet more or less to the residence on parcel 1, said waterline starts on Parcel 1 and crosses to Parcel 2 and then crosses back onto the above Parcel 1. The easement will follow the present waterline and shall not unreasonably hinder the use and enjoyment of the land by the owner of Parcel 2.

Parcel 2.

BEGINNING at the Southwest corner of the Donation Land Claim of Charles Allen and wife, claim No. 42, Notification 5141 in sections 20, 21, 28 and 29, Township 10 South, Range 6 West of the Willamette Meridian in Benton County, Oregon; thence East 55.98 chains; thence North 19.50 chains; thence West 46.38 chains; thence South 25 deg. 45' West 21.66 chains to the PLACE OF BEGINNING.

EXCEPTING the following described tract:

BEGINNING at the Southwest corner of Parcel 4 of that deed dated April 23, 1990, recorded as M-122238-90, lying on the South line of the Charles Allen DLC No. 42, S 89 deg. 43'35" E 3694.68 feet from a steel hand lever at the Southwest corner thereof; thence along said DLC line N. 89 deg. 43'35" W. 21.41 feet to a point which lies S. 11 deg. 04'01" E. 38.54 feet from a 5/8" iron rod; thence N. 11 deg. 04' 01" W. 1150.16 feet to a 5/8" iron rod; thence continuing N. 11 deg. 04' 01" W. 126.62 feet to the centerline of the Luckiamute River; thence along said centerline, downstream in a Northeasterly direction, 274 feet, more or less to the West line of the tract conveyed to Steven and Glanda Bush per M-96289-87, said Deed Records; thence along said West line South 241 feet, more or less to the Southwest corner thereof, being also the Northwest corner of the above-mentioned Parcel 4; thence South 1108.80 feet to the POINT OF BEGINNING.

ALSO EXCEPTING THEREFROM the following described tract of land:

A tract of land in Sections 20 and 29 of Township 10 South, Range 6 West, Willamette Meridian, Benton County, Oregon, said tract of land being a part of Parcels 2 and 3 of a tract described in Document M270352-99 which transferred ownership from the Jessie O. Bush Revocable Living Trust to the Jessie O. Bush Credit Shelter Trust and hereafter referred to as the "Bush tract", and more particularly described as follows:

13198

RECEIVED
JUN 05 2019
OWRD

RECEIVED

SEP 04 2015

WATER RESOURCES DEPT
SALEM, OREGON

112150

RECEIVED

SEP 04 2015

WATER RESOURCES DEPT
SALEM, OREGON

BEGINNING at the Southwest Corner of the Allen DLC No. 42, which was found and described in a survey recorded as number 9141 by the Benton County Surveyor; thence N. 25 deg. 41'41" E. 2831.30 feet along the West line of the Allen DLC No. 42 to a 1-1/4" outside diameter iron pipe with 5/8" iron rod and yellow plastic cap alongside; thence leaving said DLC line S. 2 deg. 21'33" E. 687.81 feet to 5/8" iron rod and yellow plastic cap set in an angle point in a fence line; thence S. 16 deg. 23'14" W. 245.61 feet to a 5/8" iron rod and yellow plastic cap set in an angle point in a fence line; thence S. 23' 11'10" W. 104.30 feet to a 5/8" iron rod and yellow plastic cap set in an angle point in a fence line; thence S. 71 deg. 59'44" W. 79.46 feet to a 3/8" iron rod and yellow plastic cap set in an angle point in a fence line; thence S. 45 deg. 33'02" W. 392.10 feet to a 5/8" iron rod and red plastic cap under a gate in a fence; thence S. 27 deg. 03'03" E. 402.10 feet to a 5/8" iron rod and yellow plastic cap; thence S. 1 deg. 43'16" E. 643.32 feet to a 5/8" iron rod and yellow plastic cap; thence S. 85 deg. 32'26" E. 192.41 feet to a 5/8" iron rod and yellow plastic cap; thence N. 88 deg. 35'00" E. 127.81 feet to a 5/8" iron rod and yellow plastic cap; thence continuing N. 88 deg. 35'00" E. 122.19 more or less in distance to the centerline of the Luckiamute River; thence S. 23 deg. E. along the centerline of the Luckiamute River 234.92 feet more or less to its intersection with the South line of said Bush tract; thence S. 89 deg. 43'35" W. 1525.82 feet along the South line of said Bush tract to the POINT OF BEGINNING.

TOGETHER WITH a 15 foot wide (7-1/2 feet on each side of the waterline) easement for maintenance and construction of a waterline and spring for use by this Parcel, said spring is located approximately N. 20 deg. W. and 570 feet distant from said Southwest Corner of the Allen DLC No. 42,

which was found and described in a survey recorded as number 9141 by the Benton County Surveyor. The spring is developed, but the waterline is not constructed at this time. It is expected that the future waterline (and centerline of said easement) will start at the spring and head in an Easterly direction across Parcel 1 above to this Parcel. The future waterline will not unreasonably hinder the use and enjoyment of the land by the owner of Parcel 1. The owner of Parcel 2 shall propose a location to the owner of Parcel 1, the owner of Parcel 1 may reject that location, but shall propose an alternate location, and the owner of Parcel 1 shall not unreasonably reject a location proposed by the owner of Parcel 2.

TOGETHER WITH a 30 foot wide (15 feet on each side of the centerline) easement for ingress and egress for this Parcel 2 and Parcel 3 described below on the existing gravel road, the centerline of said existing gravel road starts at a location within Hoskins County Road (Number 06540) at a point that is approximately N. 89 deg. 43' E. 1185 feet distant from said Southwest Corner of the Allen DLC No. 42, which was found and described in a survey recorded as number 9141 by the Benton County Surveyor; thence continuing along the existing centerline N. 12 deg. W. 220 feet more or less along the centerline of said existing gravel road to the South boundary of this Parcel 2.

ALSO SUBJECT TO a 30 foot wide (15 feet on each side of the centerline) easement for ingress and egress on the existing gravel road for the benefit of Parcel 3; said existing gravel road starts at a location within Hoskins County Road (Number 06540) at a point that is approximately N. 89 deg. 43' E. 1185 feet distant from said Southwest Corner of the Allen DLC No. 42, which was found and described in a survey recorded as number 9141 by the Benton County Surveyor; thence continuing N. 12 deg. W. 220 feet more or less along the centerline of the said existing gravel road to the South boundary of Parcel 2 and the TRUE POINT OF BEGINNING of this easement; thence continuing along the centerline of the existing gravel road that is near the old railroad grade in a northerly direction approximately 1200 feet more or less to the South boundary of Parcel 3.

TOGETHER WITH an easement for transporting livestock between the above Parcel 2 and the tract of land directly South of Parcel 1 above (across Hoskins County road), said easement is subject to the rights of the public, said easement shall follow the existing dirt path that is directly west of the Luckiamute River, East of the existing home, garden and septic system, and goes under the bridge that allows said Hoskins County road to cross the Luckiamute River and is more particularly described as follows:

13198

RECEIVED

JUN 05 2019

OWRD

112150

RECEIVED

JUN 05 2019

OWRD

13198

RECEIVED

SEP 04 2019

WATER RESOURCES DEPT
SALEM, OREGON

BEGINNING at a point that is approximately N. 89 deg. 43' E. 1450 feet distant from the said Southwest Corner of the Allen DLC No. 42, which was found and described in a survey recorded as number 9141 by the Benton County Surveyor; thence following the existing path that is adjacent to an directly west of the Luckiamute River in a Northerly direction approximately 250 feet to the South boundary of Parcel 2. It is intended that this easement will become void if the easement is no longer needed.

SUBJECT TO a 15 foot wide (7-1/2 feet on each side of the waterline) easement for maintenance of a water line for the portions of the existing waterline that exist on Parcel 2, the centerline of said waterline starts at a spring that is located (on Parcel 1) approximately N. 31 deg. E. and 1300 feet distant from said Southwest Corner of the Allen DLC No. 42, which was found and described in a survey recorded as number 9141 by the Benton County Surveyor, said water line flows from said spring approximately Southeasterly for 1200 feet more or less to the residence on Parcel 1, said waterline starts on Parcel 1 and crosses to Parcel 2 and then crosses back onto Parcel 1. The easement will follow the present waterline and shall not unreasonably hinder the use and enjoyment of the land by the owner of Parcel 2.

Parcel 3:

BEGINNING at a 3/4 inch pipe on the West line and 13.422 chains South 25 deg. 43' West of the Northwest corner of said Allen Donation Land Claim No. 42, Township 10 South, Range 6 West of Willamette Meridian in

Benton County, Oregon; and running thence South 25 deg. 43' West 28.956 chains along the West line of said claim to a point 21.66 chains North 25 deg. 43' East of the Southwest corner of said claim; thence North 89 deg. 57' East 46.38 chains to a 3/4 inch galvanized pipe; thence North 1.50 chains; thence East 2.00 chains to the center of the Luckiamute River; thence with the meanderings down the center of said stream to a point on the North line of said claim which is 1.00 chain South 86 deg. 48' East of a 3/4 inch pipe; thence North 86 deg. 48' West 2.263 chains to a 3/4 inch pipe; thence South 78 deg. 02' West 47.313 chains to the PLACE OF BEGINNING, all situated in Benton County, Oregon.

EXCEPTING THEREFROM the following described tract of land:

A tract of land in Sections 20 and 29 of Township 10 South, Range 6 West, Willamette Meridian, Benton County, Oregon, said tract of land being a part of Parcels 2 and 3 of a tract described in Document M270352-99 which transferred ownership from the Jessie O. Bush Revocable Living Trust to the Jessie O. Bush Credit Shelter Trust and hereafter referred to as the "Bush tract", and more particularly described as follows:

BEGINNING at the Southwest Corner of the Allen DLC No. 42, which was found and described in a survey recorded as number 9141 by the Benton County Surveyor; thence N. 25 deg. 41'41" E. 2831.30 feet along the West line of the Allen DLC No. 42 to a 1-1/4" outside diameter iron pipe WITH 5/8" iron rod and yellow plastic cap alongside; thence leaving said DLC line S. 2 deg. 21'33" E. 687.81 feet to a 5/8" iron rod and yellow plastic cap set in an angle point in a fence line; thence S. 16 deg. 23' 14" W. 245.61 feet to a 5/8" iron rod and yellow plastic cap set in an angle point in a fence line; thence S. 23 deg. 11'10" W. 104.30 feet to a 5/8" iron rod and yellow plastic cap set in an angle point in a fence line; thence S. 71 deg. 59'44" W. 79.46 feet to a 5/8" iron rod and yellow plastic cap set in an angle point in a fence line; thence S. 45 deg. 33'02" W. 392.10 feet to a 5/8" iron rod and red plastic cap under a gate in a fence; thence S. 27 deg. 03'03" E. 402.10 feet to a 5/8" iron rod and yellow plastic cap; thence S. 1 deg. 43'16" E. 643.32 feet to a 5/8" iron rod and yellow plastic cap; thence S. 85 deg. 32'26" E. 192.41 feet to a 5/8" iron rod and yellow plastic cap; thence N. 88 deg. 35'00" E. 127.81 feet to a 5/8" iron rod and yellow plastic cap; thence continuing N. 88 deg. 35'00" E. 122.19 more or less in distance to the centerline of the Luckiamute River; thence S. 23 deg. E. along the centerline of the Luckiamute River 234.92 feet more or less to its intersection with the South line of said Bush tract; thence S. 89 deg. 43'35" W. 1525.82 feet along the South line of said Bush tract to the POINT OF BEGINNING.

13198

RECEIVED

JUN 05 2019

13198

OWRD

ALSO TOGETHER WITH a 15 foot wide (7-1/2 feet on each side of the waterline) easement for maintenance of a waterline and pond; said pond is located approximately N. 24 deg. 17' E. and 2900 feet distant from said Southwest Corner of the Allen DLC No. 42, which was found and described in a survey recorded as number 9141 by the Benton County Surveyor; said water line flows from said pond approximately S. 45 deg. E. for 75 feet more or less to the west boundary of said Parcel 3. The easement is intended to follow the present waterline and maintenance shall not unreasonably hinder the use and enjoyment of the land by the owner of Parcel 4.

ALSO TOGETHER WITH 30 foot wide (15 feet on each side of the centerline) easement for ingress and egress for on the existing road which exists on Parcel 1 and Parcel 2; said existing gravel road starts at a location within Hoskins County Road (Number 04546) at a point that is approximately N. 89 deg. 43' E. 1185 feet distant from said Southwest Corner of the Allen DLC No. 42, which was found and described in a survey recorded as number 9141 by the Benton County Surveyor; thence continuing N. 12 deg. W. 220 feet more or less along the centerline of the said existing gravel road to the South boundary of Parcel 2; thence continuing along the centerline of the existing gravel road that is near the old railroad grade in a northerly direction approximately 1200 feet more or less to the South boundary of Parcel 3.

Parcel 4:

BEGINNING at a 3/4 inch iron pipe on the West line 13.422 chains South 25 deg. 43' West of the Northwest corner of Charles Allen Donation Land Claim No. 42, Township 10 South, Range 4 West of the Willamette Meridian, in Benton County, Oregon; and running thence South 77 deg. 50' West which is the Westerly extension in a straight line of the North line of Carl L. Bush's land as described in Book 99, page 217, Deed Records, Benton County, Oregon, 26.573 chains to a 1 inch pipe which is 8.547 chains North 38 deg. 53' East of the Southwest corner of Section 20; thence South 1.381 chains to a 3/4 inch pipe which is 38.64 chains North of the North line of James Watson Donation Land Claim No. 40 at a point 4 chains North 89 deg. 44' West of the Southwest corner of said Charles Allen claim; thence East 22.615 chains to a 1 inch pipe at the West line of said Allen claim; thence North 25 deg. 43' East 7.747 chains to the PLACE OF BEGINNING.

SUBJECT TO a 15 foot wide (7 1/2 feet on each side of the waterline) easement for maintenance of a waterline and pond for use by Parcel 3; said pond is located approximately N 24 deg. 17' E and 2900 feet distant from said Southwest Corner of the Allen DLC No. 42, which was found and described in a survey recorded as number 9141 by the Benton County Surveyor; said water line flows from said pond approximately S 45 deg. E for 75 feet more or less to the west boundary of said Parcel 3. The easement is intended to follow the present waterline and maintenance shall not unreasonably hinder the use and enjoyment of the land by the owner of Parcel 4.

RECEIVED

JUN 05 2019

OWRD

RECEIVED

SEP 04 2015

WATER RESOURCES DEPT
SALEM OREGON

112156

Land Use Information Form



Oregon Water Resources Department
725 Summer Street NE, Suite A
Salem, Oregon 97301-1266
(503) 986-0900
www.wrd.state.or.us

13198

RECEIVED
JUN 05 2019

OWRD

NOTE TO APPLICANTS

In order for your application to be processed by the Water Resources Department (WRD), this Land Use Information Form must be completed by a local government planning official in the jurisdiction(s) where your water right will be used and developed. The planning official may choose to complete the form while you wait, or return the receipt stub to you. Applications received by WRD without the Land Use Form or the receipt stub will be returned to you. Please be aware that your application will not be approved without land use approval.

This form is NOT required if:

- 1) Water is to be diverted, conveyed, and/or used only on federal lands; **OR**
- 2) The application is for a water right transfer, allocation of conserved water, exchange, permit amendment, or ground water registration modification, and **all** of the following apply:
 - a) The existing and proposed water use is located entirely within lands zoned for exclusive farm-use or within an irrigation district;
 - b) The application involves a change in place of use only;
 - c) The change does not involve the placement or modification of structures, including but not limited to water diversion, impoundment, distribution facilities, water wells and well houses; **and**
 - d) The application involves irrigation water uses only.

NOTE TO LOCAL GOVERNMENTS

The person presenting the attached Land Use Information Form is applying for or modifying a water right. The Water Resources Department (WRD) requires its applicants to obtain land-use information to be sure the water rights do not result in land uses that are incompatible with your comprehensive plan. Please complete the form or detach the receipt stub and return it to the applicant for inclusion in their water right application. You will receive notice once the applicant formally submits his or her request to the WRD. The notice will give more information about WRD's water rights process and provide additional comment opportunities. You will have 30 days from the date of the notice to complete the land-use form and return it to the WRD. If no land-use information is received from you within that 30-day period, the WRD may presume the land use associated with the proposed water right is compatible with your comprehensive plan. Your attention to this request for information is greatly appreciated by the Water Resources Department. If you have any questions concerning this form, please contact the WRD's Customer Service Group at 503-986-0801.

Land Use Information Form



Oregon Water Resources Department
725 Summer Street NE, Suite A
Salem, Oregon 97301-1266
(503) 986-0900
www.wrd.state.or.us

RECEIVED

13198

JUN 05 2019

OWRD

Applicant(s): Jerald Bush

Mailing Address: 24402 Maxfield Creek Road

City: Philomath

State: Oregon Zip Code: 97370

Daytime Phone: 541.609.7690

A. Land and Location

Please include the following information for all tax lots where water will be diverted (taken from its source), conveyed (transported), and/or used or developed. Applicants for municipal use, or irrigation uses within irrigation districts may substitute existing and proposed service-area boundaries for the tax-lot information requested below.

Township	Range	Section	¼ ¼	Tax Lot #	Plan Designation (e.g., Rural Residential/RR-5)	Water to be:	Proposed Land Use:
<u>9 S</u>	<u>5 W</u>	<u>19</u>	<u>NESE, SENE</u>	<u>400</u>	<u>EFU</u>	<input type="checkbox"/> Diverted <input checked="" type="checkbox"/> Conveyed <input checked="" type="checkbox"/> Used	<u>Irrigation</u>
<u>9 S</u>	<u>5 W</u>	<u>20</u>	<u>SWNW, NWSW</u>	<u>400</u>	<u>EFU</u>	<input type="checkbox"/> Diverted <input checked="" type="checkbox"/> Conveyed <input checked="" type="checkbox"/> Used	<u>Irrigation</u>
<u>9 S</u>	<u>5 W</u>	<u>19</u>	<u>SWNE NWSE NESE</u>	<u>900</u>	<u>EFU</u>	<input checked="" type="checkbox"/> Diverted <input checked="" type="checkbox"/> Conveyed <input type="checkbox"/> Used	<u>N/A</u>

List all counties and cities where water is proposed to be diverted, conveyed, and/or used or developed:

Polk County

B. Description of Proposed Use

Type of application to be filed with the Water Resources Department:

- Permit to Use or Store Water
 Water Right Transfer
 Permit Amendment or Ground Water Registration Modification
 Limited Water Use License
 Allocation of Conserved Water
 Exchange of Water

Source of water: Reservoir/Pond Ground Water Surface Water (name) Luckiamute River

Estimated quantity of water needed: 0.26 cubic feet per second gallons per minute acre-feet

Intended use of water: Irrigation Commercial Industrial Domestic for _____ household(s)
 Municipal Quasi-Municipal Instream Other _____

Briefly describe:

Temporarily transfer upstream irrigation water rights to described lands to irrigate high value crops.

Note to applicant: If the Land Use Information Form cannot be completed while you wait, please have a local government representative sign the receipt at the bottom of the next page and include it with the application filed with the Water Resources Department.

See bottom of Page 3. →

13198

RECEIVED

JUN 05 2019

OWRD

For Local Government Use Only

The following section must be completed by a planning official from each county and city listed unless the project will be located entirely within the city limits. In that case, only the city planning agency must complete this form. This deals only with the local land-use plan. Do not include approval for activities such as building or grading permits.

Please check the appropriate box below and provide the requested information

Land uses to be served by the proposed water uses (including proposed construction) are allowed outright or are not regulated by your comprehensive plan. Cite applicable ordinance section(s): PC20 136.030(A) - "Farm Use"

Land uses to be served by the proposed water uses (including proposed construction) involve discretionary land-use approvals as listed in the table below. (Please attach documentation of applicable land-use approvals which have already been obtained. Record of Action/land-use decision and accompanying findings are sufficient.) **If approvals have been obtained but all appeal periods have not ended, check "Being pursued."**

Type of Land-Use Approval Needed (e.g., plan amendments, rezones, conditional-use permits, etc.)	Cite Most Significant, Applicable Plan Policies & Ordinance Section References	Land-Use Approval:	
		<input type="checkbox"/> Obtained <input type="checkbox"/> Denied	<input type="checkbox"/> Being Pursued <input type="checkbox"/> Not Being Pursued
		<input type="checkbox"/> Obtained <input type="checkbox"/> Denied	<input type="checkbox"/> Being Pursued <input type="checkbox"/> Not Being Pursued
		<input type="checkbox"/> Obtained <input type="checkbox"/> Denied	<input type="checkbox"/> Being Pursued <input type="checkbox"/> Not Being Pursued
		<input type="checkbox"/> Obtained <input type="checkbox"/> Denied	<input type="checkbox"/> Being Pursued <input type="checkbox"/> Not Being Pursued
		<input type="checkbox"/> Obtained <input type="checkbox"/> Denied	<input type="checkbox"/> Being Pursued <input type="checkbox"/> Not Being Pursued
		<input type="checkbox"/> Obtained <input type="checkbox"/> Denied	<input type="checkbox"/> Being Pursued <input type="checkbox"/> Not Being Pursued

Local governments are invited to express special land-use concerns or make recommendations to the Water Resources Department regarding this proposed use of water below, or on a separate sheet.

** Please see attached comments.*

Name: Sidney Mulder Title: Planning Supervisor
 Signature: [Signature] Phone: 503-622-9237 Date: 3-6-19
 Government Entity: Polk County

Note to local government representative: Please complete this form or sign the receipt below and return it to the applicant. If you sign the receipt, you will have 30 days from the Water Resources Department's notice date to return the completed Land Use Information Form or WRD may presume the land use associated with the proposed use of water is compatible with local comprehensive plans.

Receipt for Request for Land Use Information

Applicant name: _____
 City or County: _____ Staff contact: _____
 Signature: _____ Phone: _____ Date: _____

9.5.19

9.5.19

RECEIVED
JUN 05 2019
OWRD

13198

**SEC.19 T9S R5W WM
POLK COUNTY**
Scale 1" = 400'

See Map 9.5.18

IMPORTANT
This Map for Assessment
and Taxation Purposes
ONLY

Canceled No.
101
301
901

See Map 9.5.20

See Map 9.5.30

2-28

2-18

13-8

01/03/18

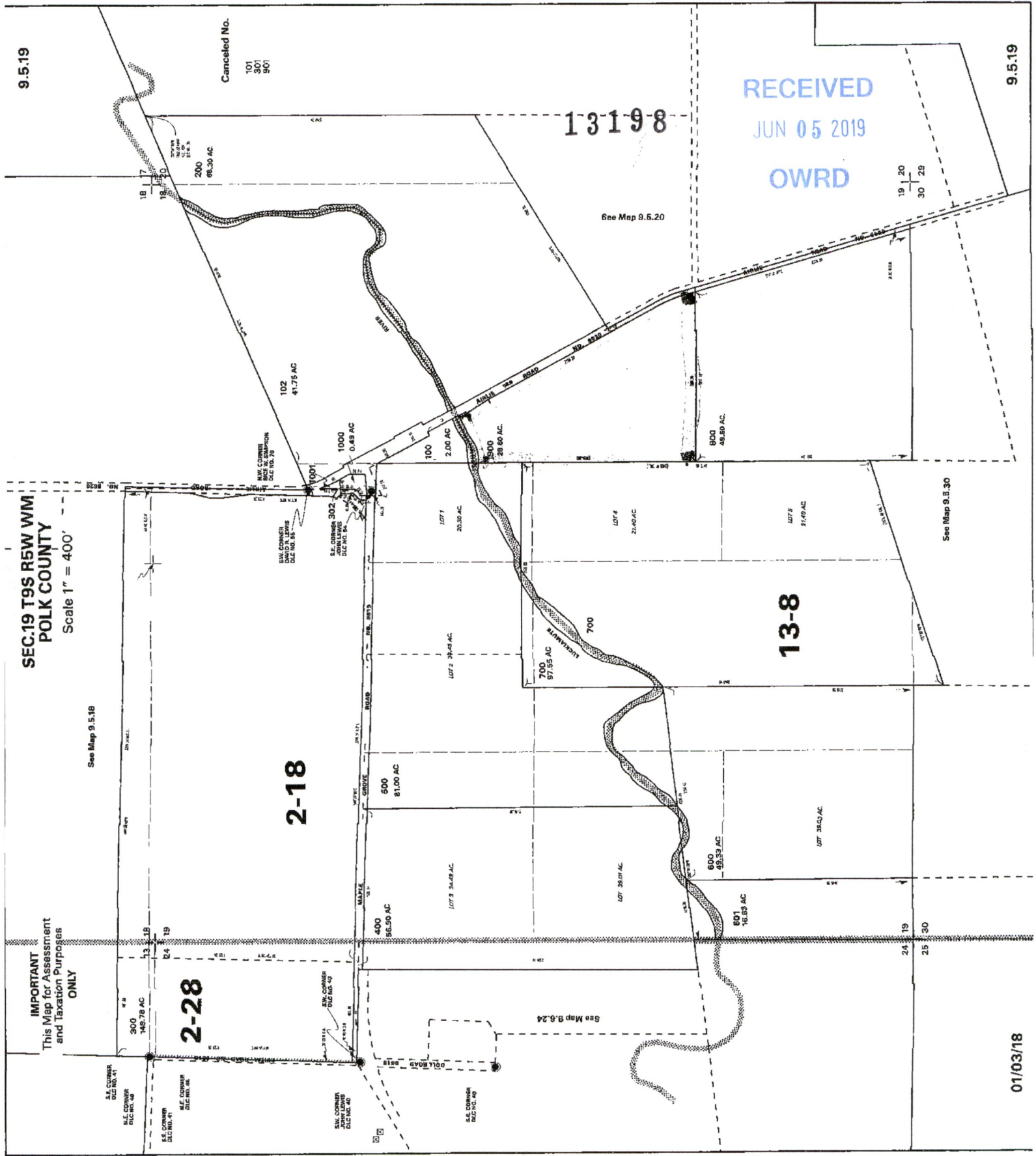

JUN 05 2019

OWRD

9.5.20

9.5.20

Cancelled No.

See Map 9.5.21

SEC. 20 T9S R5W WM
POLK COUNTY,
Scale 1" = 400'

See Map 9.5.17

See Map 9.5.19

IMPORTANT
This Map for Assessment
and Taxation Purposes
ONLY

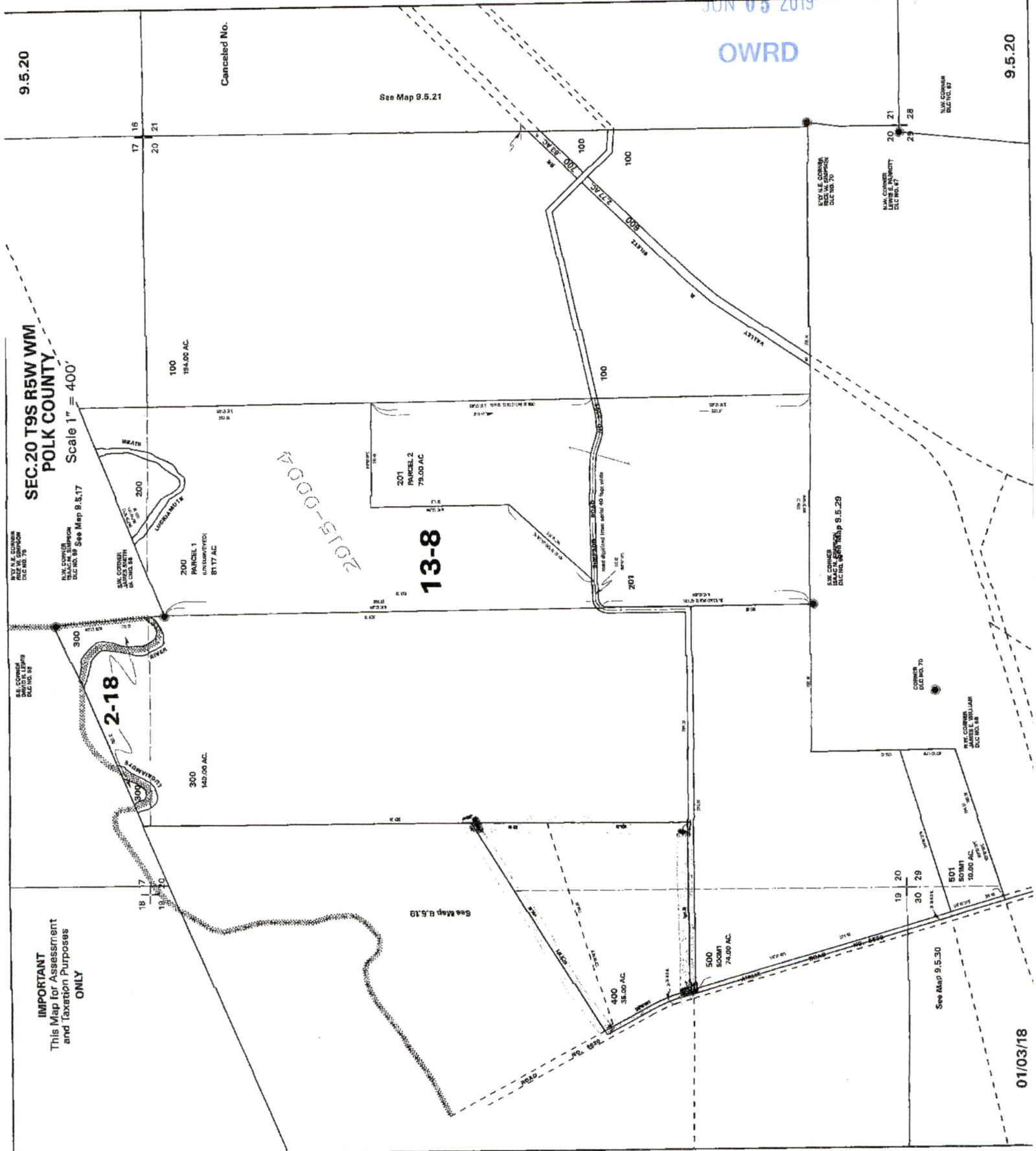

2015-004

13-8

2-18

See Map 9.5.19

See Map 9.5.20

See Map 9.5.30

01/03/18

13198

RECEIVED

JUN 05 2019

OWRD

*Additional notes from Polk County

The subject properties are located partially within the Special Flood Hazard Area (SFHA). Any structural or non-structural (ie excavation) floodplain development would require a floodplain development permit and/or a land use approval to demonstrate compliance with Polk County Zoning Ordinance (PCZO) Chapter 178.

The subject properties are located partially within the inventoried Deer and Elk Habitat Area. Any activities listed as a conflicting use pursuant to PCZO 182.070(A)(2) would require a management plan that has been coordinated with the Oregon Department of Fish and Wildlife pursuant to PCZO 182.040(E). Additional development standards listed in PCZO 182.050(A) may also apply.

According to the Polk County Significant Resources Area (SRA) Map, the Luckiamute River is listed on as fish bearing stream. Any vegetation removal or road construction within the riparian setback area would require a management plan that has been coordinated with the Oregon Department of Fish and Wildlife pursuant to PCZO 182.040(E). The riparian setback is be measured from the banktop on a straight line perpendicular to the flow of the waterway. The width of the riparian management area shall average three times the stream width, but shall not average less than 25 feet or more than 100 feet. Stream width is the average of the main channel width of the stream during its high water level flow.

Application for Water Right Transfer

Evidence of Use Affidavit



Oregon Water Resources Department
 725 Summer Street NE, Suite A
 Salem, Oregon 97301-1266
 (503) 986-0900
 www.wrd.state.or.us

Please print legibly or type. Be as specific as possible. Attach additional pages if you need more spacing. Supporting documentation must be attached.

State of Oregon)
 County of Polk) ss

I, JACK PLATT, in my capacity as Owner,
 mailing address 11070 Oak Hill Rd, Independence OR 97351
 telephone number 503 837-0807, being first duly sworn depose and say:

1. My knowledge of the exercise or status of the water right is based on (check one):

- Personal observation Professional expertise

13198

RECEIVED
 JUN 05 2019
 OWRD

2. I attest that:

Water was used during the previous five years on the **entire** place of use for Certificate # 76441; **OR**

My knowledge is specific to the use of water at the following locations within the last five years:

Certificate #	Township	Range	Mer	Sec	1/4 1/4	Gov't Lot or DLC	Acres (if applicable)

OR

- Confirming Certificate # _____ has been issued within the past five years; **OR**
- Part or all of the water right was leased instream at some time within the last five years. The instream lease number is: _____ (Note: If the entire right proposed for transfer was not leased, additional evidence of use is needed for the portion not leased instream.); **OR**
- The water right is not subject to forfeiture and documentation that a presumption of forfeiture for non-use would be rebutted under ORS 540.610(2) is attached.
- Water has been used at the actual current point of diversion or appropriation for more than 10 years for Certificate # _____ (For Historic POD/POA Transfers)

(continues on reverse side)

3. The water right was used for: (e.g., crops, pasture, etc.): Corn

4. I understand that if I do not attach one or more of the documents shown in the table below to support the above statements, my application will be considered incomplete.

Jack Platt
Signature of Affiant

6-5-2019
Date

Signed and sworn to (or affirmed) before me this 5 day of June, 2019.



[Signature]
Notary Public for Oregon

My Commission Expires: 3-8-2022

Supporting Documents	Examples
<input type="checkbox"/> Copy of a water right certificate that has been issued within the last five years. (not a remaining right certificate)	Copy of confirming water right certificate that shows issue date
<input checked="" type="checkbox"/> Copies of receipts from sales of irrigated crops or for expenditures related to use of water	<input checked="" type="checkbox"/> Power usage records for pumps associated with irrigation use <ul style="list-style-type: none"> Fertilizer or seed bills related to irrigated crops Farmers Co-op sales receipt
<input type="checkbox"/> Records such as FSA crop reports, irrigation district records, NRCS farm management plan, or records of other water suppliers	<ul style="list-style-type: none"> District assessment records for water delivered Crop reports submitted under a federal loan agreement Beneficial use reports from district IRS Farm Usage Deduction Report Agricultural Stabilization Plan CREP Report
<input type="checkbox"/> Aerial photos containing sufficient detail to establish location and date of photograph	<p>Multiple photos can be submitted to resolve different areas of a water right. <i>If the photograph does not print with a "date stamp" or without the source being identified, the date of the photograph and source should be added.</i></p> <p>Sources for aerial photos: OSU – www.oregonexplorer.info/imagery OWRD – www.wrd.state.or.us Google Earth – earth.google.com TerraServer – www.terra-server.com</p>
<input type="checkbox"/> Approved Lease establishing beneficial use within the last 5 years	Copy of instream lease or lease number

13198

RECEIVED
JUN 05 2019
OWRD

PLATTS OAK HILL DAIRY LLC
 11070 OAK HILL RD
 INDEPENDENCE OR 97351-9745



Inquiries? Call your
 Business Solutions Team
 Toll free 1-866-870-3419,
 M-F, 6am-6pm PT
pacificpower.net



BILLING DATE: **Aug 31, 2016**
 ACCOUNT NUMBER: **39933574-001 1**
 DATE DUE: **Sep 19, 2016**
 AMOUNT DUE: **\$32,400.72**



Your Balance With Us

Previous Account Balance	27,502.00
Payments/Credits	-27,502.00
New Charges	+32,400.72
Current Account Balance	\$ 32,400.72

Payments Received

DATE	DESCRIPTION	AMOUNT
Aug 15, 2016	Payment Received - Thank You	27,502.00
Total Payments		\$ 27,502.00

Summary of Account Activity

ITEM 1 ELECTRIC SERVICE	0904 202300 # 75HP Independence OR Seasonal Connect 6-21-2014 Schedule 41L METER # 53306505	3,509.61
ITEM 2 ELECTRIC SERVICE	8505 Matney Way # Pump Klamath Falls OR Horse Power Rating : 0040.0 Schedule N41 METER # 28422611	0.00
ITEM 3 ELECTRIC SERVICE	D5459 Matney Rd 30HP Klamath Falls OR Horse Power Rating : 0030.0 Schedule N41 METER # 28409471	563.36
ITEM 4 ELECTRIC SERVICE	D7993 Cheyne Rd 75HP Merrill OR Horse Power Rating : 0075.0 Schedule N41 METER # 36137974	1.55
ITEM 5 ELECTRIC SERVICE	8505 Matney Way # 40HP Klamath Falls OR Irrigation Pump: 40hp + 20hp Schedule N41 METER # 28422612	7.88
ITEM 6 ELECTRIC SERVICE	D8808 Matney Rd Pump Klamath Falls OR 60hp Pump + 5hp Pivot Schedule N41 METER # 28400053	311.34
ITEM 7 ELECTRIC SERVICE	D14560 Cheyne Rd # 40HP Klamath Falls OR 40-hp At 17011 Cheyne Schedule N41 METER # 35917708	420.55
ITEM 8 ELECTRIC SERVICE	10020 Cheyne Rd 115HP Klamath Falls OR 50+ 15 Hp Schedule N41 METER # 28409479	1,026.14

Go paperless!
 It's even easier for you to be
 paperless. Now you can choose to
 get your electronic statements
 delivered to your email inbox. Sign
 up at pacificpower.net/paperless.

KF 9033.80
OK 23,366.92

RECEIVED
 JUN 05 2019
 OWRD

13198

Late Payment Charge for Oregon
 A late payment charge of 1.8% may be
 charged on any balance not paid in full each

See reverse

Write account numbers check & mail to Pacific Power, PO Box 36999, Portland, OR 97236-0999



Questions about your bill: Call toll free **1-866-870-3419** pacificpower.net

BILLING DATE: **Aug 31, 2016** ACCOUNT NUMBER: **39933574-001 1** DATE DUE: **Sep 19, 2016** AMOUNT DUE: **\$32,400.72**

Summary of Account Activity - Continued

ITEM 9 ELECTRIC SERVICE	D16864 Cheyne Rd # 70HP Klamath Falls OR Horse Power Rating : 30+40hp Schedule N41 METER # 28400036	515.57
ITEM 10 ELECTRIC SERVICE	D13180 Matney Rd 100HP Klamath Falls OR Horse Power Rating : 0100.0 Schedule N41 METER # 28409469	3,612.65
ITEM 11 ELECTRIC SERVICE	D7111 Matney Rd 25HP Klamath Falls OR Xfmr Fuzes Open No Pump 25.0 Schedule F41 METER # 28338426	0.00
ITEM 12 ELECTRIC SERVICE	10610 Hill Rd # 75HP Klamath Falls OR Three Phase, Demand, Var, Bpa Schedule N41 METER # 28322993	1,113.75
ITEM 13 ELECTRIC SERVICE	D10751 Hill Rd # 60HP Klamath Falls OR Horse Power Rating : 0060.0 Schedule N41 METER # 28289918	1,046.49
ITEM 14 ELECTRIC SERVICE	34524 Tennessee Rd # Irr Lebanon OR Horse Power Rating : 0030.0 Schedule 41 METER # 2312433	0.00
ITEM 15 ELECTRIC SERVICE	8212 Matney Way # 50HP Klamath Falls OR 50hp Schedule N41 METER # 28189324	414.52
ITEM 16 ELECTRIC SERVICE	0904 202702 60 HP PUMP Independence OR Seasonal Con 08-15-2016 Schedule 41 METER # 35753216	65.78
ITEM 17 ELECTRIC SERVICE	0904 283601 75 HP Independence OR Horse Power Rating : 0075.0 Schedule 41 METER # 21477400	0.00
ITEM 18 ELECTRIC SERVICE	0904 215500 25 HP Independence OR Horse Power Rating : 0025.0 Schedule 41 METER # 82754670	0.00
ITEM 19 ELECTRIC SERVICE	0904 287300 Independence OR Horse Power Rating : 0025.0 Schedule 41 METER # 50599445	0.00
ITEM 20 ELECTRIC SERVICE	0904 285300 Independence OR Horse Power Rating : 0100.0 Schedule 41L METER # 57957316	5,707.37
ITEM 21 ELECTRIC SERVICE	0904 285300 Independence OR 75 Hp Pump 277/480 Schedule 41L METER # 53306461	3,813.59
ITEM 23 ELECTRIC SERVICE	11070 Oak Hill Rd # Pmp Independence OR Horse Power Rating : 0040.0 Schedule 41L METER # 61078995	1,456.49

RECEIVED
JUN 05 2019
OWRD



Questions about your bill: Call toll free 1-866-870-3419 pacificpower.net

BILLING DATE: Aug 31, 2016 ACCOUNT NUMBER: 39933574-001 1 DATE DUE: Sep 19, 2016 AMOUNT DUE: \$32,400.72

Summary of Account Activity - Continued

ITEM 24 CONTRACT	0904 285300 Independence OR Contract: 75 Hp Irg Pump Site Id 658162957 004/80% Afc Schedule 110	0.00
ITEM 25 ELECTRIC SERVICE	0904 285300 Independence OR 75 Hp Irg Pump 277/480 Schedule 1XL METER # 64844876	2,444.07
ITEM 26 ELECTRIC SERVICE	0904 215600 75HP Independence OR Horse Power Rating : 0100.0 Schedule 41L METER # 28151289	4,517.62
ITEM 27 CONTRACT	11070 Oak Hill Rd Independence OR Contract: Milk Chiller Site:606214957.002 80% Mon Min Schedule 102	0.00
ITEM 28 ELECTRIC SERVICE	11070 Oak Hill Rd Independence OR Milk Chiller Equipment Schedule 28 METER # 63762308	1,852.39

Detailed Account Activity

ITEM 1 - ELECTRIC SERVICE 0904 202300 # 75HP Independence OR
Seasonal Connect 6-21-2014 Schedule 41L
Service ID: 613207957-001

METER NUMBER	SERVICE PERIOD		ELAPSED DAYS	METER READINGS		METER MULTIPLIER	AMOUNT USED THIS MONTH
	From	To		Previous	Current		
53306505	Jul 20, 2016	Aug 22, 2016	33	403554	434937	1.0	31,383 kwh
53306505	Demand	Aug 22, 2016			66.693	1.0	67 kw
53306505	Reactive	Aug 22, 2016			35.806	1.0	36 kvar

Next scheduled read date: 09-20. Date may vary due to scheduling or weather.

NEW CHARGES - 08/16	UNITS	COST PER UNIT	CHARGE
Delivery Charge Secondary	31,383 kwh	0.0369100	1,158.35
Reactive Power Charge Sec (Season End Est Charge Sec Is \$980.00)	9 kvar	0.6500000	5.85
Supply Energy Sec Summer Public Purpose	31,383 kwh	0.0586500	1,840.61
		0.0300000	90.14
Energy Conservation Charge	31,383 kwh	0.0031700	99.48
Low Income Assistance	31,383 kwh	0.0005000	15.69
J C Boyle Dam Removal Surcharge	31,383 kwh	0.0003800	11.93
Copco Iron Gate Dams Remv Schg	31,383 kwh	0.0011600	36.40
B P A Columbia River Benefits	31,383 kwh	-0.0076800	-241.02
B P A Columbia River Benefits	64,086 kwh	0.0076800	492.18
Total New Charges			3,509.61

Note: For 08/2016, 64086 excess BPA credits were given. Agreement 001 has been adjusted.

ITEM 2 - ELECTRIC SERVICE 8505 Matney Way # Pump Klamath Falls OR
Horse Power Rating : 0040.0 Schedule N41
Service ID: 521909791-002

METER NUMBER	SERVICE PERIOD		ELAPSED DAYS	METER READINGS		METER MULTIPLIER	AMOUNT USED THIS MONTH
	From	To		Previous	Current		
28422611	Jul 13, 2016	Aug 12, 2016	30	2123	2123	1.0	0 kwh
28422611	Demand	Aug 12, 2016			0	1.0	0 kw
28422611	Reactive	Aug 12, 2016			0	1.0	0 kvar

Next scheduled read date: 09-13. Date may vary due to scheduling or weather.

NEW CHARGES - 08/16	UNITS	COST PER UNIT	CHARGE
Total New Charges			0.00

13198

RECEIVED

JUN 05 2019

OWRD

Historical Data - ITEM 1

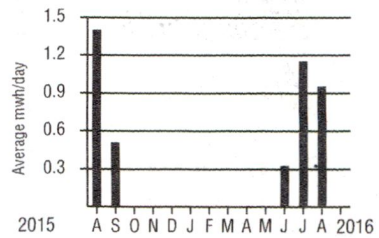

Your Average Daily kwh Usage by Month

PERIOD ENDING	AUG 2016	AUG 2015
Avg. Daily Temp.	71	72
Total kwh	31383	42016
Avg. kwh per Day	951	1401
Cost per Day	\$91.44	\$136.73

Historical Data - ITEM 2

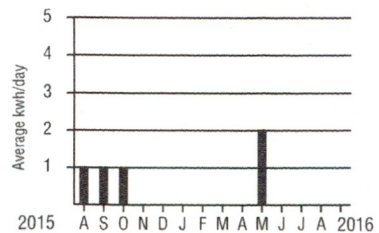

Your Average Daily kwh Usage by Month

PERIOD ENDING	AUG 2016	AUG 2015
Avg. Daily Temp.	66	66
Total kwh	0	22
Avg. kwh per Day	0	1
Cost per Day	\$0.00	\$0.07



BILLING DATE: **Aug 31, 2016** ACCOUNT NUMBER: **39933574-001 1** DATE DUE: **Sep 19, 2016** AMOUNT DUE: **\$32,400.72**

ITEM 3 - ELECTRIC SERVICE

D5459 Matney Rd 30HP Klamath Falls OR
Horse Power Rating : 0030.0 Schedule N41
Service ID: 522309391-002

METER NUMBER	SERVICE PERIOD		ELAPSED DAYS	METER READINGS		METER MULTIPLIER	AMOUNT USED THIS MONTH
	From	To		Previous	Current		
28409471	Jul 13, 2016	Aug 12, 2016	30	227174	233010	1.0	5,836 kwh
28409471	Demand	Aug 12, 2016			24.537	1.0	25 kw
28409471	Reactive	Aug 12, 2016			14.83	1.0	15 kvar

Next scheduled read date: 09-13. Date may vary due to scheduling or weather.

NEW CHARGES - 08/16	UNITS	COST PER UNIT	CHARGE
Delivery Charge	5,836 kwh	0.0369100	215.41
Reactive Power Charge	5 kvar	0.6500000	3.25
Supply Energy Sec Summer	5,836 kwh	0.0586500	342.28
Public Purpose		0.0300000	16.83
Energy Conservation Charge	5,836 kwh	0.0031700	18.50
Low Income Assistance	5,836 kwh	0.0005000	2.92
J C Boyle Dam Removal Surcharge	5,836 kwh	0.0003800	2.22
Copco Iron Gate Dams Remv Schg	5,836 kwh	0.0011600	6.77
B P A Columbia River Benefits	5,836 kwh	-0.0076800	-44.82
(Season End Est Charge Sec Is \$375.00)			
Total New Charges			563.36

ITEM 4 - ELECTRIC SERVICE

D7993 Cheyne Rd 75HP Merrill OR
Horse Power Rating : 0075.0 Schedule N41
Service ID: 518513191-002

METER NUMBER	SERVICE PERIOD		ELAPSED DAYS	METER READINGS		METER MULTIPLIER	AMOUNT USED THIS MONTH
	From	To		Previous	Current		
36137974	Jul 13, 2016	Aug 12, 2016	30	213929	213945	1.0	16 kwh
36137974	Demand	Aug 12, 2016			0.035	1.0	0 kw
36137974	Reactive	Aug 12, 2016			0.027	1.0	0 kvar

Next scheduled read date: 09-13. Date may vary due to scheduling or weather.

NEW CHARGES - 08/16	UNITS	COST PER UNIT	CHARGE
Delivery Charge	16 kwh	0.0369100	0.59
Supply Energy Sec Summer	16 kwh	0.0586500	0.94
Public Purpose		0.0300000	0.05
Energy Conservation Charge	16 kwh	0.0031700	0.05
Low Income Assistance	16 kwh	0.0005000	0.01
J C Boyle Dam Removal Surcharge	16 kwh	0.0003800	0.01
Copco Iron Gate Dams Remv Schg	16 kwh	0.0011600	0.02
B P A Columbia River Benefits	16 kwh	-0.0076800	-0.12
(Season End Est Charge Sec Is \$870.00)			
Total New Charges			1.55

ITEM 5 - ELECTRIC SERVICE

8505 Matney Way # 40HP Klamath Falls OR
Irrigation Pump: 40hp + 20hp Schedule N41
Service ID: 521709991-002

METER NUMBER	SERVICE PERIOD		ELAPSED DAYS	METER READINGS		METER MULTIPLIER	AMOUNT USED THIS MONTH
	From	To		Previous	Current		
28422612	Jul 13, 2016	Aug 12, 2016	30	33603	33685	1.0	82 kwh
28422612	Demand	Aug 12, 2016			0.123	1.0	0 kw
28422612	Reactive	Aug 12, 2016			0.236	1.0	0 kvar

Next scheduled read date: 09-13. Date may vary due to scheduling or weather.

NEW CHARGES - 08/16	UNITS	COST PER UNIT	CHARGE
Delivery Charge	82 kwh	0.0369100	3.03
Supply Energy Sec Summer	82 kwh	0.0586500	4.81
Public Purpose		0.0300000	0.24
Energy Conservation Charge	82 kwh	0.0031700	0.26
Low Income Assistance	82 kwh	0.0005000	0.04
J C Boyle Dam Removal Surcharge	82 kwh	0.0003800	0.03
Copco Iron Gate Dams Remv Schg	82 kwh	0.0011600	0.10
B P A Columbia River Benefits	82 kwh	-0.0076800	-0.63
(Season End Est Charge Sec Is \$615.00)			

Historical Data - ITEM 3

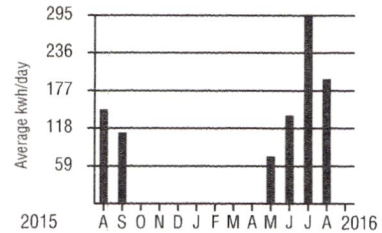

Your Average Daily kwh Usage by Month

PERIOD ENDING	AUG 2016	AUG 2015
Avg. Daily Temp.	66	66
Total kwh	5836	4405
Avg. kwh per Day	195	147
Cost per Day	\$18.78	\$14.43

RECEIVED

JUN 05 2019

OWRD

Historical Data - ITEM 4

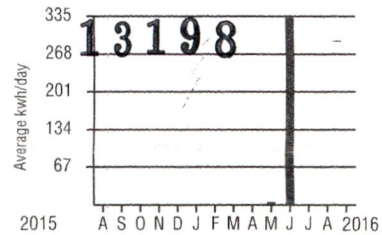

Your Average Daily kwh Usage by Month

PERIOD ENDING	AUG 2016	AUG 2015
Avg. Daily Temp.	66	66
Total kwh	16	0
Avg. kwh per Day	1	0
Cost per Day	\$0.05	\$0.00

Historical Data - ITEM 5

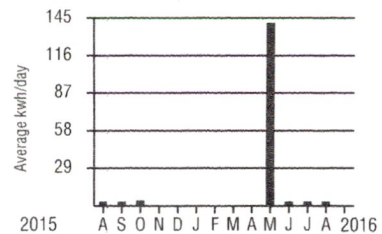

Your Average Daily kwh Usage by Month

PERIOD ENDING	AUG 2016	AUG 2015
Avg. Daily Temp.	66	66
Total kwh	82	83
Avg. kwh per Day	3	3
Cost per Day	\$0.26	\$0.27



Questions about your bill: Call toll free 1-866-870-3419 pacificpower.net

BILLING DATE: Aug 31, 2016 ACCOUNT NUMBER: 39933574-001 1 DATE DUE: Sep 19, 2016 AMOUNT DUE: \$32,400.72

Total New Charges **7.88**

ITEM 6 - ELECTRIC SERVICE

D8808 Matney Rd Pump Klamath Falls OR
60hp Pump + 5hp Pivot Schedule N41
Service ID: 524507191-001

METER NUMBER	SERVICE PERIOD		ELAPSED DAYS	METER READINGS		METER MULTIPLIER	AMOUNT USED THIS MONTH
	From	To		Previous	Current		
28400053	Jul 13, 2016	Aug 12, 2016	30	11605	14738	1.0	3,133 kwh
28400053	Demand	Aug 12, 2016			38.235	1.0	38 kw
28400053	Reactive	Aug 12, 2016			30.714	1.0	31 kvar

Next scheduled read date: 09-13. Date may vary due to scheduling or weather.

NEW CHARGES - 08/16	UNITS	COST PER UNIT	CHARGE
Delivery Charge	3,133 kwh	0.0369100	115.64
Reactive Power Charge	16 kvar	0.6500000	10.40
Supply Energy Sec Summer	3,133 kwh	0.0586500	183.75
Public Purpose		0.0300000	9.29
Energy Conservation Charge	3,133 kwh	0.0031700	9.93
Low Income Assistance	3,133 kwh	0.0005000	1.57
J C Boyle Dam Removal Surcharge	3,133 kwh	0.0003800	1.19
Copco Iron Gate Dams Remv Schg	3,133 kwh	0.0011600	3.63
B P A Columbia River Benefits	3,133 kwh	-0.0076800	-24.06
(Season End Est Charge Sec Is \$645.00)			

Total New Charges **311.34**

ITEM 7 - ELECTRIC SERVICE

D14560 Cheyne Rd # 40HP Klamath Falls OR
40-hp At 17011 Cheyne Schedule N41
Service ID: 515116591-002

METER NUMBER	SERVICE PERIOD		ELAPSED DAYS	METER READINGS		METER MULTIPLIER	AMOUNT USED THIS MONTH
	From	To		Previous	Current		
35917708	Jul 13, 2016	Aug 12, 2016	30	11512	11728	20.0	4,320 kwh
35917708	Demand	Aug 12, 2016			1.607	20.0	32 kw
35917708	Reactive	Aug 12, 2016			1.102	20.0	22 kvar

Next scheduled read date: 09-13. Date may vary due to scheduling or weather.

NEW CHARGES - 08/16	UNITS	COST PER UNIT	CHARGE
Delivery Charge	4,320 kwh	0.0369100	159.45
Reactive Power Charge	9 kvar	0.6500000	5.85
Supply Energy Sec Summer	4,320 kwh	0.0586500	253.37
Public Purpose		0.0300000	12.56
Energy Conservation Charge	4,320 kwh	0.0031700	13.69
Low Income Assistance	4,320 kwh	0.0005000	2.16
J C Boyle Dam Removal Surcharge	4,320 kwh	0.0003800	1.64
Copco Iron Gate Dams Remv Schg	4,320 kwh	0.0011600	5.01
B P A Columbia River Benefits	4,320 kwh	-0.0076800	-33.18
(Season End Est Charge Sec Is \$480.00)			

Total New Charges **420.55**

Historical Data - ITEM 6

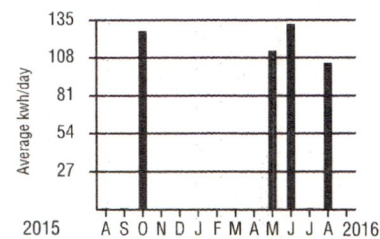

Your Average Daily kwh Usage by Month

PERIOD ENDING	AUG 2016	AUG 2015
Avg. Daily Temp.	66	66
Total kwh	3133	24
Avg. kwh per Day	104	1
Cost per Day	\$10.38	\$0.08

Historical Data - ITEM 7

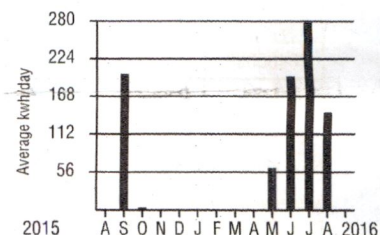

Your Average Daily kwh Usage by Month

PERIOD ENDING	AUG 2016	AUG 2015
Avg. Daily Temp.	66	66
Total kwh	4320	0
Avg. kwh per Day	144	0
Cost per Day	\$14.02	\$0.00

RECEIVED
JUN 05 2016
OWRD

13198



BILLING DATE: **Aug 31, 2016** ACCOUNT NUMBER: **39933574-001 1** DATE DUE: **Sep 19, 2016** AMOUNT DUE: **\$32,400.72**

ITEM 8 - ELECTRIC SERVICE

10020 Cheyne Rd 115HP Klamath Falls OR
50+ 15 Hp Schedule N41
Service ID: 517114591-002

METER NUMBER	SERVICE PERIOD		ELAPSED DAYS	METER READINGS		METER MULTIPLIER	AMOUNT USED THIS MONTH
	From	To		Previous	Current		
28409479	Jul 13, 2016	Aug 12, 2016	30	959247	969850	1.0	10,603 kwh
28409479	Demand	Aug 12, 2016			39.253	1.0	39 kw
28409479	Reactive	Aug 12, 2016			29.144	1.0	29 kvar

Next scheduled read date: 09-13. Date may vary due to scheduling or weather.

NEW CHARGES - 08/16	UNITS	COST PER UNIT	CHARGE
Delivery Charge	10,603 kwh	0.0369100	391.36
Reactive Power Charge	13 kvar	0.6500000	8.45
Supply Energy Sec Summer	10,603 kwh	0.0586500	621.87
Public Purpose		0.0300000	30.65
Energy Conservation Charge	10,603 kwh	0.0031700	33.61
Low Income Assistance	10,603 kwh	0.0005000	5.30
J C Boyle Dam Removal Surcharg	10,603 kwh	0.0003800	4.03
Copco Iron Gate Dams Remv Schg	10,603 kwh	0.0011600	12.30
B P A Columbia River Benefits	10,603 kwh	-0.0076800	-81.43
(Season End Est Charge Sec Is \$675.00)			
Total New Charges			1,026.14

ITEM 9 - ELECTRIC SERVICE

D16864 Cheyne Rd # 70HP Klamath Falls OR
Horse Power Rating : 30+40hp Schedule N41
Service ID: 517314391-002

METER NUMBER	SERVICE PERIOD		ELAPSED DAYS	METER READINGS		METER MULTIPLIER	AMOUNT USED THIS MONTH
	From	To		Previous	Current		
28400036	Jul 13, 2016	Aug 12, 2016	30	258866	264197	1.0	5,331 kwh
28400036	Demand	Aug 12, 2016			23.862	1.0	24 kw
28400036	Reactive	Aug 12, 2016			16.338	1.0	16 kvar

Next scheduled read date: 09-13. Date may vary due to scheduling or weather.

NEW CHARGES - 08/16	UNITS	COST PER UNIT	CHARGE
Delivery Charge	5,331 kwh	0.0369100	196.77
Reactive Power Charge	6 kvar	0.6500000	3.90
Supply Energy Sec Summer	5,331 kwh	0.0586500	312.66
Public Purpose		0.0300000	15.40
Energy Conservation Charge	5,331 kwh	0.0031700	16.90
Low Income Assistance	5,331 kwh	0.0005000	2.67
J C Boyle Dam Removal Surcharg	5,331 kwh	0.0003800	2.03
Copco Iron Gate Dams Remv Schg	5,331 kwh	0.0011600	6.18
B P A Columbia River Benefits	5,331 kwh	-0.0076800	-40.94
(Season End Est Charge Sec Is \$645.00)			
Total New Charges			515.57

ITEM 10 - ELECTRIC SERVICE

D13180 Matney Rd 100HP Klamath Falls OR
Horse Power Rating : 0100.0 Schedule N41
Service ID: 522509191-002

METER NUMBER	SERVICE PERIOD		ELAPSED DAYS	METER READINGS		METER MULTIPLIER	AMOUNT USED THIS MONTH
	From	To		Previous	Current		
28409469	Jul 13, 2016	Aug 12, 2016	30	560352	597959	1.0	37,607 kwh
28409469	Demand	Aug 12, 2016			79.132	1.0	79 kw
28409469	Reactive	Aug 12, 2016			38.12	1.0	38 kvar

Next scheduled read date: 09-13. Date may vary due to scheduling or weather.

NEW CHARGES - 08/16	UNITS	COST PER UNIT	CHARGE
Delivery Charge	37,607 kwh	0.0369100	1,388.07
Reactive Power Charge	6 kvar	0.6500000	3.90
Supply Energy Sec Summer	37,607 kwh	0.0586500	2,205.65
Public Purpose		0.0300000	107.93
Energy Conservation Charge	37,607 kwh	0.0031700	119.21
Low Income Assistance	37,607 kwh	0.0005000	18.80
J C Boyle Dam Removal Surcharg	37,607 kwh	0.0003800	14.29
Copco Iron Gate Dams Remv Schg	37,607 kwh	0.0011600	43.62

Historical Data - ITEM 8

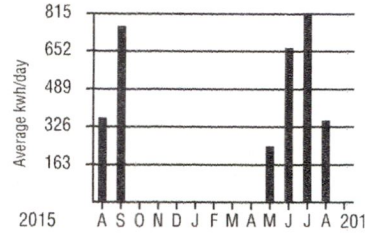

Your Average Daily kwh Usage by Month

PERIOD ENDING	AUG 2016	AUG 2015
Avg. Daily Temp.	66	66
Total kwh	10603	10934
Avg. kwh per Day	353	364
Cost per Day	\$34.20	\$35.80

RECEIVED
JUN 05 2019

OWRD

Historical Data - ITEM 9

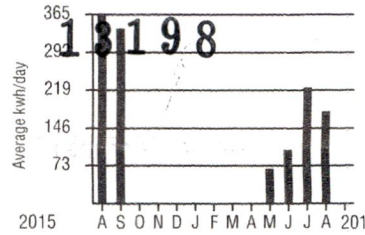

Your Average Daily kwh Usage by Month

PERIOD ENDING	AUG 2016	AUG 2015
Avg. Daily Temp.	66	66
Total kwh	5331	10929
Avg. kwh per Day	178	364
Cost per Day	\$17.19	\$35.76

Historical Data - ITEM 10

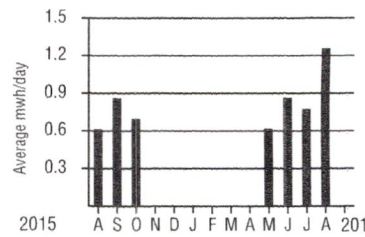

Your Average Daily kwh Usage by Month

PERIOD ENDING	AUG 2016	AUG 2015
Avg. Daily Temp.	66	66
Total kwh	37607	18308
Avg. kwh per Day	1254	610
Cost per Day	\$120.42	\$59.60



Questions about your bill: Call toll free 1-866-870-3419 pacificpower.net

BILLING DATE: **Aug 31, 2016** ACCOUNT NUMBER: **39933574-001 1** DATE DUE: **Sep 19, 2016** AMOUNT DUE: **\$32,400.72**

NEW CHARGES - 08/16 - CONTINUED	UNITS	COST PER UNIT	CHARGE
B P A Columbia River Benefits (Season End Est Charge Sec Is \$1,120.00)	37,607 kwh	-0.0076800	-288.82
Total New Charges			3,612.65

ITEM 11 - ELECTRIC SERVICE

D7111 Matney Rd 25HP Klamath Falls OR
Xfmr Fuzes Open No Pump 25.0 Schedule F41
Service ID: 523907791-002

METER NUMBER	SERVICE PERIOD From To	ELAPSED DAYS	METER READINGS Previous Current	METER MULTIPLIER	AMOUNT USED THIS MONTH
28338426	Jul 13, 2016 Aug 12, 2016	30	0 0	1.0	0 kwh
28338426	Demand Aug 12, 2016			1.0	0 kw
28338426	Reactive Aug 12, 2016			1.0	0 kvar

Current Month Estimated - No Display Meter Unreadable. Your bill may not reflect actual usage.
Previous Month Estimated - No Power Meter Unreadable
Next scheduled read date: 09-13. Date may vary due to scheduling or weather.

NEW CHARGES - 08/16	UNITS	COST PER UNIT	CHARGE
Total New Charges			0.00

ITEM 12 - ELECTRIC SERVICE

10610 Hill Rd # 75HP Klamath Falls OR
Three Phase, Demand, Var, Bpa Schedule N41
Service ID: 500532079-002

METER NUMBER	SERVICE PERIOD From To	ELAPSED DAYS	METER READINGS Previous Current	METER MULTIPLIER	AMOUNT USED THIS MONTH
28322993	Jul 14, 2016 Aug 11, 2016	28	54085 65650	1.0	11,565 kwh
28322993	Demand Aug 11, 2016			1.0	59 kw
28322993	Reactive Aug 11, 2016			1.0	30 kvar

Next scheduled read date: 09-13. Date may vary due to scheduling or weather.

NEW CHARGES - 08/16	UNITS	COST PER UNIT	CHARGE
Delivery Charge	11,565 kwh	0.0369100	426.86
Reactive Power Charge	6 kvar	0.6500000	3.90
Supply Energy Sec Summer	11,565 kwh	0.0586500	678.29
Public Purpose		0.0300000	33.27
Energy Conservation Charge	11,565 kwh	0.0031700	36.66
Low Income Assistance	11,565 kwh	0.0005000	5.78
J C Boyle Dam Removal Surcharge	11,565 kwh	0.0003800	4.39
Copco Iron Gate Dams Remv Schg	11,565 kwh	0.0011600	13.42
B P A Columbia River Benefits (Season End Est Charge Sec Is \$920.00)	11,565 kwh	-0.0076800	-88.82
Total New Charges			1,113.75

ITEM 13 - ELECTRIC SERVICE

D10751 Hill Rd # 60HP Klamath Falls OR
Horse Power Rating : 0060.0 Schedule N41
Service ID: 500332279-002

METER NUMBER	SERVICE PERIOD From To	ELAPSED DAYS	METER READINGS Previous Current	METER MULTIPLIER	AMOUNT USED THIS MONTH
28289918	Jul 14, 2016 Aug 11, 2016	28	592693 603564	1.0	10,871 kwh
28289918	Demand Aug 11, 2016			1.0	51 kw
28289918	Reactive Aug 11, 2016			1.0	25 kvar

Next scheduled read date: 09-13. Date may vary due to scheduling or weather.

NEW CHARGES - 08/16	UNITS	COST PER UNIT	CHARGE
Delivery Charge	10,871 kwh	0.0369100	401.25
Reactive Power Charge	5 kvar	0.6500000	3.25
Supply Energy Sec Summer	10,871 kwh	0.0586500	637.58
Public Purpose		0.0300000	31.26
Energy Conservation Charge	10,871 kwh	0.0031700	34.46
Low Income Assistance	10,871 kwh	0.0005000	5.44
J C Boyle Dam Removal Surcharge	10,871 kwh	0.0003800	4.13
Copco Iron Gate Dams Remv Schg	10,871 kwh	0.0011600	12.61
B P A Columbia River Benefits (Season End Est Charge Sec Is \$820.00)	10,871 kwh	-0.0076800	-83.49

RECEIVED

JUN 05 2019

OWRD

13198

Historical Data - ITEM 12

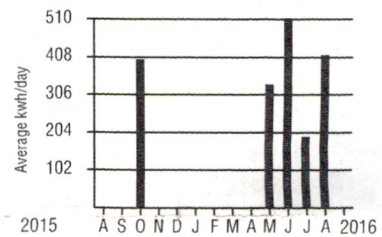

Your Average Daily kwh Usage by Month

PERIOD ENDING	AUG 2016	AUG 2015
Avg. Daily Temp.	65	66
Total kwh	11565	17
Avg. kwh per Day	413	1
Cost per Day	\$39.78	\$0.05

Historical Data - ITEM 13

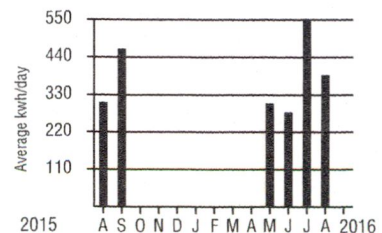

Your Average Daily kwh Usage by Month

PERIOD ENDING	AUG 2016	AUG 2015
Avg. Daily Temp.	65	66
Total kwh	10871	9559
Avg. kwh per Day	388	308
Cost per Day	\$37.37	\$30.17



BILLING DATE: **Aug 31, 2016** ACCOUNT NUMBER: **39933574-001 1** DATE DUE: **Sep 19, 2016** AMOUNT DUE: **\$32,400.72**

Total New Charges **1,046.49**

ITEM 14 - ELECTRIC SERVICE

34524 Tennessee Rd # Irr Lebanon OR
Horse Power Rating : 0030.0 Schedule 41
Service ID: 148071337-001

METER NUMBER	SERVICE PERIOD		ELAPSED DAYS	METER READINGS		METER MULTIPLIER	AMOUNT USED THIS MONTH
	From	To		Previous	Current		
2312433	Jul 28, 2016	Aug 30, 2016	33	158077	158077	1.0	0 kwh
2312433	Demand	Aug 30, 2016			0	1.0	0 kw

Previous Month Estimated - Seasonal Use Meter
Next scheduled read date: 09-26. Date may vary due to scheduling or weather.

NEW CHARGES - 08/16	UNITS	COST PER UNIT	CHARGE
Total New Charges			0.00

13198

RECEIVED
JUN 05 2019
OWRD

ITEM 15 - ELECTRIC SERVICE

8212 Matney Way # 50HP Klamath Falls OR
50hp Schedule N41
Service ID: 519312391-002

METER NUMBER	SERVICE PERIOD		ELAPSED DAYS	METER READINGS		METER MULTIPLIER	AMOUNT USED THIS MONTH
	From	To		Previous	Current		
28189324	Jul 13, 2016	Aug 12, 2016	30	224132	228389	1.0	4,257 kwh
28189324	Demand	Aug 12, 2016			24.9	1.0	25 kw
28189324	Reactive	Aug 12, 2016			18.966	1.0	19 kvar

Next scheduled read date: 09-13. Date may vary due to scheduling or weather.

NEW CHARGES - 08/16	UNITS	COST PER UNIT	CHARGE
Delivery Charge	4,257 kwh	0.0369100	157.13
Reactive Power Charge	9 kvar	0.6500000	5.85
Supply Energy Sec Summer	4,257 kwh	0.0586500	249.67
Public Purpose		0.0300000	12.38
Energy Conservation Charge	4,257 kwh	0.0031700	13.49
Low Income Assistance	4,257 kwh	0.0005000	2.13
J C Boyle Dam Removal Surcharge	4,257 kwh	0.0003800	1.62
Copco Iron Gate Dams Remv Schg	4,257 kwh	0.0011600	4.94
B P A Columbia River Benefits	4,257 kwh	-0.0076800	-32.69
(Season End Est Charge Sec Is \$375.00)			
Total New Charges			414.52

ITEM 16 - ELECTRIC SERVICE

0904 202702 60 HP PUMP Independence OR
Seasonal Con 08-15-2016 Schedule 41
Service ID: 911421370-002

METER NUMBER	SERVICE PERIOD		ELAPSED DAYS	METER READINGS		METER MULTIPLIER	AMOUNT USED THIS MONTH
	From	To		Previous	Current		
35753216	Jul 20, 2016	Aug 15, 2016	26	352462	352462	1.0	0 kwh
35753216	Demand	Aug 15, 2016			0	1.0	0 kw

Previous Month Estimated - Seasonal Use Meter

NEW CHARGES - 08/16	UNITS	COST PER UNIT	CHARGE
CLOSING CHARGES			
Ann Ld Size Deficiency Sec 3p for 259 day(s)			63.86
Public Purpose		0.0300000	1.92
Total New Charges			65.78

Historical Data - ITEM 14

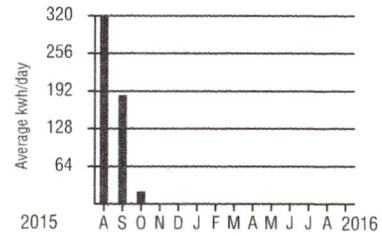

Your Average Daily kwh Usage by Month

PERIOD ENDING	AUG 2016	AUG 2015
Avg. Daily Temp.	71	71
Total kwh	0	9289
Avg. kwh per Day	0	320
Cost per Day	\$0.00	\$31.22

Historical Data - ITEM 15

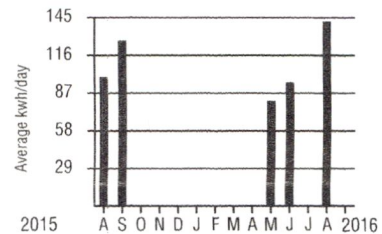

Your Average Daily kwh Usage by Month

PERIOD ENDING	AUG 2016	AUG 2015
Avg. Daily Temp.	66	66
Total kwh	4257	2962
Avg. kwh per Day	142	99
Cost per Day	\$13.82	\$9.83



Questions about your bill: Call toll free 1-866-870-3419 pacificpower.net

BILLING DATE: Aug 31, 2016 ACCOUNT NUMBER: 39933574-001 1 DATE DUE: Sep 19, 2016 AMOUNT DUE: \$32,400.72

ITEM 17 - ELECTRIC SERVICE

0904 283601 75 HP Independence OR
Horse Power Rating : 0075.0 Schedule 41
Service ID: 658362757-001

METER NUMBER	SERVICE PERIOD		ELAPSED DAYS	METER READINGS		METER MULTIPLIER	AMOUNT USED THIS MONTH
	From	To		Previous	Current		
21477400	Jul 21, 2016	Aug 23, 2016	33	24583	24583	1.0	0 kwh
21477400	Demand	Aug 23, 2016			0	1.0	0 kw

Current Month Estimated - Seasonal Use Meter. Your bill may not reflect actual usage.

Previous Month Estimated - Meter Not In Use

Next scheduled read date: 09-20. Date may vary due to scheduling or weather.

NEW CHARGES - 08/16	UNITS	COST PER UNIT	CHARGE
Total New Charges			0.00

ITEM 18 - ELECTRIC SERVICE

0904 215500 25 HP Independence OR
Horse Power Rating : 0025.0 Schedule 41
Service ID: 658962157-001

METER NUMBER	SERVICE PERIOD		ELAPSED DAYS	METER READINGS		METER MULTIPLIER	AMOUNT USED THIS MONTH
	From	To		Previous	Current		
82754670	Jul 21, 2016	Aug 24, 2016	34	77892	77892	1.0	0 kwh
82754670	Demand	Aug 24, 2016			0	1.0	0 kw

Next scheduled read date: 09-21. Date may vary due to scheduling or weather.

NEW CHARGES - 08/16	UNITS	COST PER UNIT	CHARGE
(Season End Est Charge Sec Is \$330.00)			
Total New Charges			0.00

ITEM 19 - ELECTRIC SERVICE

0904 287300 Independence OR
Horse Power Rating : 0025.0 Schedule 41
Service ID: 610210957-001

METER NUMBER	SERVICE PERIOD		ELAPSED DAYS	METER READINGS		METER MULTIPLIER	AMOUNT USED THIS MONTH
	From	To		Previous	Current		
50599445	Jul 21, 2016	Aug 23, 2016	33	36521	36521	1.0	0 kwh
50599445	Demand	Aug 23, 2016			0	1.0	0 kw

Current Month Estimated - Seasonal Use Meter. Your bill may not reflect actual usage.

Previous Month Estimated - No Power Meter Unreadable

Next scheduled read date: 09-20. Date may vary due to scheduling or weather.

NEW CHARGES - 08/16	UNITS	COST PER UNIT	CHARGE
Total New Charges			0.00

Historical Data - ITEM 18

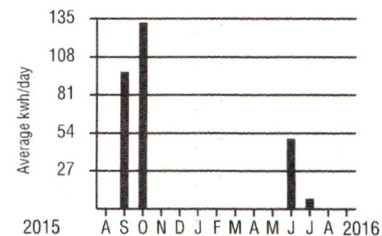

Your Average Daily kwh Usage by Month

PERIOD ENDING	AUG 2016	AUG 2015
Avg. Daily Temp.	71	72
Total kwh	0	0
Avg. kwh per Day	0	0
Cost per Day	\$0.00	\$0.00

RECEIVED
JUN 05 2019
OWRD

13198

BILLING DATE: **Aug 31, 2016** ACCOUNT NUMBER: **39933574-001 1** DATE DUE: **Sep 19, 2016** AMOUNT DUE: **\$32,400.72**

ITEM 20 - ELECTRIC SERVICE

0904 285300 Independence OR
Horse Power Rating : 0100.0 Schedule 41L
Service ID: 658162957-001

METER NUMBER	SERVICE PERIOD		ELAPSED DAYS	METER READINGS		METER MULTIPLIER	AMOUNT USED THIS MONTH
	From	To		Previous	Current		
57957316	Jul 21, 2016	Aug 23, 2016	33	176383	235736	1.0	59,353 kwh
57957316	Demand	Aug 23, 2016			89.566	1.0	90 kw
57957316	Reactive	Aug 23, 2016			54.455	1.0	54 kvar

Next scheduled read date: 09-20. Date may vary due to scheduling or weather.

NEW CHARGES - 08/16	UNITS	COST PER UNIT	CHARGE
Delivery Charge Secondary	59,353 kwh	0.0369100	2,190.72
Reactive Power Charge Sec (Season End Est Charge Sec Is \$1,230.00)	18 kvar	0.6500000	11.70
Supply Energy Sec Summer	59,353 kwh	0.0586500	3,481.05
Public Purpose		0.0300000	170.50
Energy Conservation Charge	59,353 kwh	0.0031700	188.15
Low Income Assistance	59,353 kwh	0.0005000	29.68
J C Boyle Dam Removal Surcharg	59,353 kwh	0.0003800	22.55
Copco Iron Gate Dams Remv Schg	59,353 kwh	0.0011600	68.85
B P A Columbia River Benefits	59,353 kwh	-0.0076800	-455.83
Total New Charges			5,707.37

ITEM 21 - ELECTRIC SERVICE

0904 285300 Independence OR
75 Hp Pump 277/480 Schedule 41L
Service ID: 658162957-002

METER NUMBER	SERVICE PERIOD		ELAPSED DAYS	METER READINGS		METER MULTIPLIER	AMOUNT USED THIS MONTH
	From	To		Previous	Current		
53306461	Jul 21, 2016	Aug 23, 2016	33	490115	529788	1.0	39,673 kwh
53306461	Demand	Aug 23, 2016			58.429	1.0	58 kw
53306461	Reactive	Aug 23, 2016			32.643	1.0	33 kvar

Next scheduled read date: 09-20. Date may vary due to scheduling or weather.

NEW CHARGES - 08/16	UNITS	COST PER UNIT	CHARGE
Delivery Charge Secondary	39,673 kwh	0.0369100	1,464.33
Reactive Power Charge Sec (Season End Est Charge Sec Is \$980.00)	10 kvar	0.6500000	6.50
Supply Energy Sec Summer	39,673 kwh	0.0586500	2,326.82
Public Purpose		0.0300000	113.93
Energy Conservation Charge	39,673 kwh	0.0031700	125.76
Low Income Assistance	39,673 kwh	0.0005000	19.84
J C Boyle Dam Removal Surcharg	39,673 kwh	0.0003800	15.08
Copco Iron Gate Dams Remv Schg	39,673 kwh	0.0011600	46.02
B P A Columbia River Benefits	39,673 kwh	-0.0076800	-304.69
Total New Charges			3,813.59

ITEM 23 - ELECTRIC SERVICE

11070 Oak Hill Rd # Pmp Independence OR
Horse Power Rating : 0040.0 Schedule 41L
Service ID: 610011157-001

METER NUMBER	SERVICE PERIOD		ELAPSED DAYS	METER READINGS		METER MULTIPLIER	AMOUNT USED THIS MONTH
	From	To		Previous	Current		
61078995	Jul 21, 2016	Aug 24, 2016	34	278021	293067	1.0	15,046 kwh
61078995	Demand	Aug 24, 2016			32.295	1.0	32 kw
61078995	Reactive	Aug 24, 2016			31.881	1.0	32 kvar

Next scheduled read date: 09-21. Date may vary due to scheduling or weather.

NEW CHARGES - 08/16	UNITS	COST PER UNIT	CHARGE
Delivery Charge Secondary	15,046 kwh	0.0369100	555.35
Reactive Power Charge Sec (Season End Est Charge Sec Is \$540.00)	19 kvar	0.6500000	12.35
Supply Energy Sec Summer	15,046 kwh	0.0586500	882.45
Public Purpose		0.0300000	43.50
Energy Conservation Charge	15,046 kwh	0.0031700	47.70
Low Income Assistance	15,046 kwh	0.0005000	7.52
J C Boyle Dam Removal Surcharg	15,046 kwh	0.0003800	5.72

Historical Data - ITEM 20

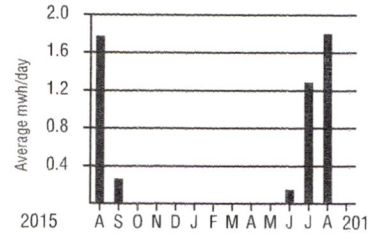

Your Average Daily kwh Usage by Month

PERIOD ENDING	AUG 2016	AUG 2015
Avg. Daily Temp.	71	72
Total kwh	59353	53194
Avg. kwh per Day	1799	1773
Cost per Day	\$172.95	\$173.25

RECEIVED
JUN 05 2019

OWRD
Historical Data - ITEM 21

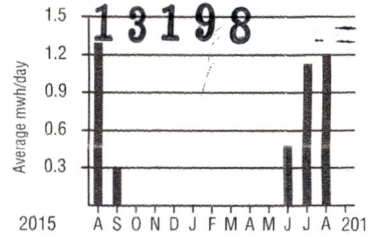

Your Average Daily kwh Usage by Month

PERIOD ENDING	AUG 2016	AUG 2015
Avg. Daily Temp.	71	72
Total kwh	39673	38769
Avg. kwh per Day	1202	1292
Cost per Day	\$115.56	\$126.18

Historical Data - ITEM 23

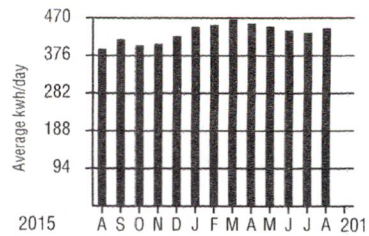

Your Average Daily kwh Usage by Month

PERIOD ENDING	AUG 2016	AUG 2015
Avg. Daily Temp.	71	72
Total kwh	15046	11747
Avg. kwh per Day	443	392
Cost per Day	\$42.84	\$38.62

BILLING DATE: **Aug 31, 2016** ACCOUNT NUMBER: **39933574-001 1** DATE DUE: **Sep 19, 2016** AMOUNT DUE: **\$32,400.72**

NEW CHARGES - 08/16 - CONTINUED	UNITS	COST PER UNIT	CHARGE
Copco Iron Gate Dams Remv Schg	15,046 kwh	0.0011600	17.45
B P A Columbia River Benefits	15,046 kwh	-0.0076800	-115.55
Total New Charges			1,456.49

ITEM 24 - CONTRACT 0904 285300 Independence OR
 Contract: 75 Hp Irg Pump Site Id 658162957 004/80% Afc Schedule 110
 Service ID: 658162957-005

Total New Charges **0.00**

ITEM 25 - ELECTRIC SERVICE 0904 285300 Independence OR
 75 Hp Irg Pump 277/480 Schedule 1XL
 Service ID: 658162957-004

METER NUMBER	SERVICE PERIOD		ELAPSED DAYS	METER READINGS		METER MULTIPLIER	AMOUNT USED THIS MONTH
	From	To		Previous	Current		
64844876	Jul 21, 2016	Aug 23, 2016	33	25898	49481	1.0	23,583 kwh
64844876	Demand	Aug 23, 2016			51.832	1.0	52 kw
64844876	Reactive	Aug 23, 2016			11.825	1.0	12 kvar

Next scheduled read date: 09-20. Date may vary due to scheduling or weather.

NEW CHARGES - 08/16	UNITS	COST PER UNIT	CHARGE
Delivery Charge Secondary (Season End Est Charge Sec Is \$820.00)	23,583 kwh	0.0369100	870.45
Supply Energy Sec Summer	23,583 kwh	0.0586500	1,383.14
Public Purpose		0.0300000	67.61
Energy Conservation Charge	23,583 kwh	0.0031700	74.76
Low Income Assistance	23,583 kwh	0.0005000	11.79
J C Boyle Dam Removal Surcharg	23,583 kwh	0.0003800	8.96
Copco Iron Gate Dams Remv Schg	23,583 kwh	0.0011600	27.36
Total New Charges			2,444.07

ITEM 26 - ELECTRIC SERVICE 0904 215600 75HP Independence OR
 Horse Power Rating : 0100.0 Schedule 41L
 Service ID: 659561557-001

METER NUMBER	SERVICE PERIOD		ELAPSED DAYS	METER READINGS		METER MULTIPLIER	AMOUNT USED THIS MONTH
	From	To		Previous	Current		
28151289	Jul 21, 2016	Aug 24, 2016	34	165682	212692	1.0	47,010 kwh
28151289	Demand	Aug 24, 2016			69.643	1.0	70 kw
28151289	Reactive	Aug 24, 2016			38.085	1.0	38 kvar

Next scheduled read date: 09-21. Date may vary due to scheduling or weather.

NEW CHARGES - 08/16	UNITS	COST PER UNIT	CHARGE
Delivery Charge Secondary	47,010 kwh	0.0369100	1,735.14
Reactive Power Charge Sec (Season End Est Charge Sec Is \$1,010.00)	10 kvar	0.6500000	6.50
Supply Energy Sec Summer	47,010 kwh	0.0586500	2,757.14
Public Purpose		0.0300000	134.96
Energy Conservation Charge	47,010 kwh	0.0031700	149.02
Low Income Assistance	47,010 kwh	0.0005000	23.51
J C Boyle Dam Removal Surcharg	47,010 kwh	0.0003800	17.86
Copco Iron Gate Dams Remv Schg	47,010 kwh	0.0011600	54.53
B P A Columbia River Benefits	47,010 kwh	-0.0076800	-361.04
Total New Charges			4,517.62

ITEM 27 - CONTRACT 11070 Oak Hill Rd Independence OR
 Contract: Milk Chiller Site:606214957.002 80% Mon Min Schedule 102
 Service ID: 606214957-003

Total New Charges **0.00**

RECEIVED
 JUN 05 2019
 OWRD
 13198

Historical Data - ITEM 25

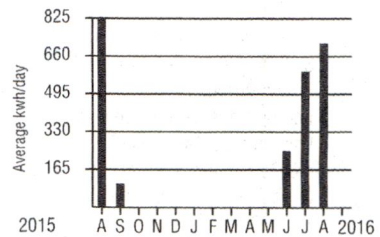

Your Average Daily kwh Usage by Month

PERIOD ENDING	AUG 2016	AUG 2015
Avg. Daily Temp.	71	72
Total kwh	23583	24662
Avg. kwh per Day	715	822
Cost per Day	\$74.06	\$83.60

Historical Data - ITEM 26

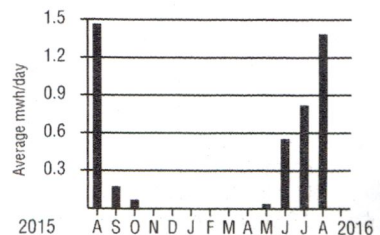

Your Average Daily kwh Usage by Month

PERIOD ENDING	AUG 2016	AUG 2015
Avg. Daily Temp.	71	72
Total kwh	47010	43946
Avg. kwh per Day	1383	1465
Cost per Day	\$132.87	\$143.49



BILLING DATE: **Aug 31, 2016** ACCOUNT NUMBER: **39933574-001 1** DATE DUE: **Sep 19, 2016** AMOUNT DUE: **\$32,400.72**

ITEM 28 - ELECTRIC SERVICE

11070 Oak Hill Rd Independence OR
Milk Chiller Equipment Schedule 28
Service ID: 606214957-002

METER NUMBER	SERVICE PERIOD		ELAPSED DAYS	METER READINGS		METER MULTIPLIER	AMOUNT USED THIS MONTH
	From	To		Previous	Current		
63762308	Jul 21, 2016	Aug 24, 2016	34	193713	214689	1.0	20,976 kwh
63762308	Demand	Aug 24, 2016			37.423	1.0	37 kw
63762308	Reactive	Aug 24, 2016			16.502	1.0	17 kvar

Next scheduled read date: 09-21. Date may vary due to scheduling or weather.

NEW CHARGES - 08/16	UNITS	COST PER UNIT	CHARGE
Basic Charge - 3p Sec Delivery	37 kw		18.00
Load Size Charge - 3p Sec Del	37 kw	1.1500000	42.55
Demand Charge Sec - Min 15 Kw	37 kw	5.7100000	211.27
Delivery Charge Secondary	20,976 kwh	0.0074000	155.22
Reactive Power Charge Sec	2 kvar	0.6500000	1.30
Supply Enrgy Sec 1st 20000 Kwh	20,000 kwh	0.0608500	1,217.00
Supply Enrgy Sec > 20000 Kwh	976 kwh	0.0592100	57.79
Public Purpose		0.0300000	51.09
Energy Conservation Charge	20,976 kwh	0.0026600	55.80
Low Income Assistance	20,976 kwh	0.0005000	10.49
J C Boyle Dam Removal Surcharg	20,976 kwh	0.0003800	7.97
Copco Iron Gate Dams Remv Schg	20,976 kwh	0.0011400	23.91
Total New Charges			1,852.39

Historical Data - ITEM 28

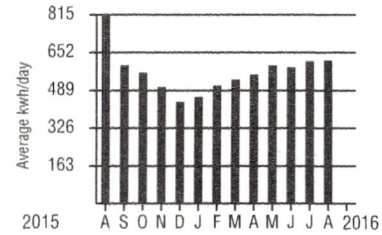

Your Average Daily kwh Usage by Month

PERIOD ENDING	AUG 2016	AUG 2015
Avg. Daily Temp.	71	72
Total kwh	20976	12221
Avg. kwh per Day	617	815
Cost per Day	\$54.48	\$80.27

RECEIVED
JUN 05 2019
OWRD