

CERTIFICATE 50381

T38S, R10E, Sec.'s 11, 12, 13, 14, 23, 24, & 26, W.M.
 T38S, R11 1/2E, Sec.'s 30 & 31, W.M.
 KLAMATH COUNTY, OREGON
 APPLICATION No. U-319
 PERMIT No. U-343

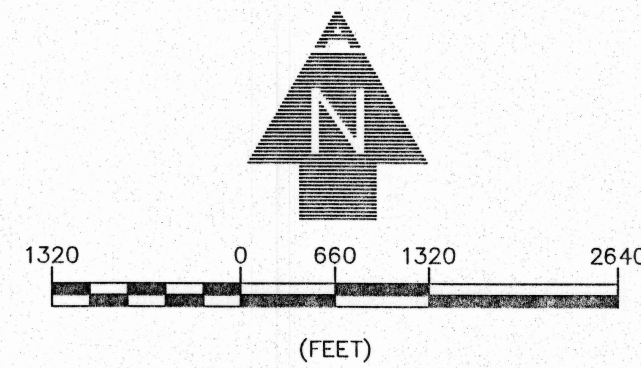

NOTES:

1. THE PURPOSE OF THIS MAP IS TO IDENTIFY THE LOCATION OF THE WATER RIGHT ONLY, AND IS NOT INTENDED TO PROVIDE DIMENSIONS OR LOCATION OF PROPERTY LINES.
2. FOR TAX LOT INFORMATION, SEE TAX MAPS INCLUDED WITH THIS APPLICATION.
3. DATE OF PRIORITY FOR THIS APPLICATION IS JULY 19, 1949.

WELL TIES:

- MITCHELL WELL—780' NORTH & 6' EAST FROM THE SOUTHEAST CORNER OF SECTION 24.
- DEER RIDGE WELL—2,840' NORTH & 80' EAST FROM THE SOUTHWEST CORNER OF SECTION 24.
- SWAN LAKE JUNCTION WELL—3,225' NORTH & 1,260' WEST FROM THE SOUTHEAST CORNER SECTION 23.
- LISKEY WELL—800' SOUTH & 430' EAST FROM THE NORTHWEST CORNER SECTION 13.

- TOTAL REMAINING ACRES IRRIGATED PER 1/4 1/4 AFTER TRANSFER 1/4 1/4 SECTION 2.0 NWSW CERTIFICATE 50381 REMAINING LANDS
- AC. PER QQ TO BE TRANSFERRED 1.3 CERTIFICATE 50381 CHANGE IN POA ONLY
- AC. PER QQ TO BE TRANSFERRED FROM 1.3 CERTIFICATE 50381 RELOCATED 'FROM' LANDS CHANGE IN POU
- AC. PER QQ TO BE TRANSFERRED TO 1.3 CERTIFICATE 50381 RELOCATED 'TO' LANDS CHANGE IN POU
- AC. PER QQ TO BE TRANSFERRED TO 1.3 CERTIFICATE 50381 'TO' LANDS CHANGE IN POA AND POU
- AC. PER QQ TO BE TRANSFERRED FROM 1.3 CERTIFICATE 50381 'FROM' LANDS CHANGE IN POA AND POU

LEGEND

- 14 | 13 SECTION CORNER
- 23 | 24 SECTION CORNER
- TL500 TAX LOT NUMBER
- LOT 1 GOVERNMENT LOT NUMBER
- PROPERTY BOUNDARY
- 30 SECTION CENTER
- 10" MAIN LINE SIZE
- SECTION LINES
- 1/4 1/4 LINES
- ROADS
- DITCH LINE
- EXISTING P.O.A. (WELL)

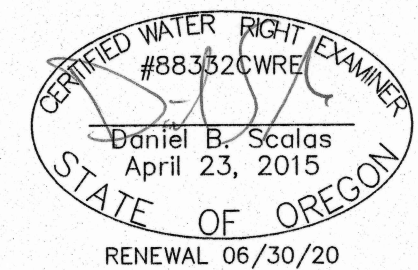

ALADKINS ENGINEERING & SURVEYING o / 541.884.4666 w / AdkinsEngineering.com

1435 ESPLANADE AVENUE, KLAMATH FALLS, OR 97601

SERVING S. OREGON & N. CALIFORNIA

ENGINEERING • SURVEYING • PLANNING • TESTING