

CERTIFICATE 86866

T38S, R10E, Sec.'s 11, 12, 13, 14, & 24, W.M.

KLAMATH COUNTY, OREGON

APPLICATION No. U-319

PERMIT No. U-343

NOTES:

1. THE PURPOSE OF THIS MAP IS TO IDENTIFY THE LOCATION OF THE WATER RIGHT ONLY, AND IS NOT INTENDED TO PROVIDE DIMENSIONS OR LOCATION OF PROPERTY LINES.
2. FOR TAX LOT INFORMATION, SEE TAX MAPS INCLUDED WITH THIS APPLICATION.
3. DATE OF PRIORITY FOR THIS APPLICATION IS JULY 19, 1949.

TOTAL REMAINING ACRES IRRIGATED PER 1/4 1/4 AFTER TRANSFER

- 2.0 NWSW CERTIFICATE 86866 LANDS TO REMAIN UNCHANGED
- 1.3 CERTIFICATE 86866 CHANGE IN POA ONLY
- 1.3 CERTIFICATE 86866 RELOCATED 'FROM' LANDS CHANGE IN POU
- 1.3 CERTIFICATE 86866 RELOCATED 'TO' LANDS CHANGE IN POU
- 1.3 CERTIFICATE 86866 'TO' LANDS CHANGE IN POA AND POU
- 1.3 CERTIFICATE 86866 'FROM' LANDS CHANGE IN POA AND POU

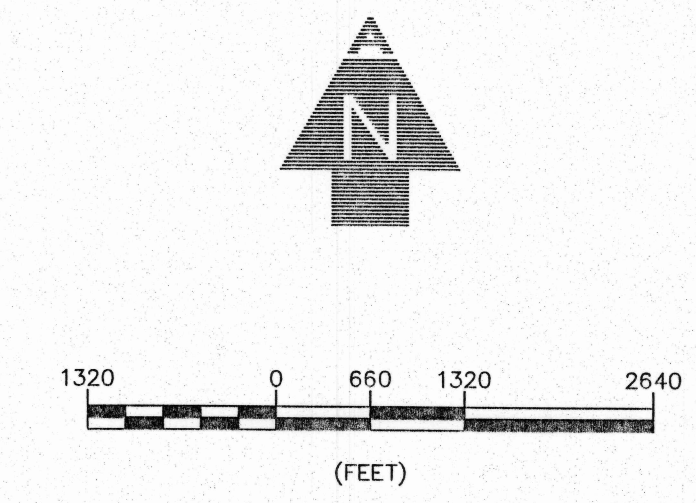

WELL TIES:

- MITCHELL WELL—780' NORTH & 6' EAST FROM THE SOUTHEAST CORNER OF SECTION 24.
- DEER RIDGE WELL—2,840' NORTH & 80' EAST FROM THE SOUTHWEST CORNER OF SECTION 24.
- SWAN LAKE JUNCTION WELL—3,225' NORTH & 1,260' WEST FROM THE SOUTHEAST CORNER SECTION 23.
- LISKEY WELL—800' SOUTH & 430' EAST FROM THE NORTHWEST CORNER SECTION 13.

LEGEND

- 14 | 13 SECTION DESIGNATION
- 23 | 24 TAX LOT NUMBER
- TL500 GOVERNMENT LOT NUMBER
- LOT 1 GOVERNMENT LOT NUMBER
- 30 SECTION CENTER
- 10" MAIN LINE SIZE
- SECTION LINES
- 1/4 1/4 LINES
- ROADS
- DITCH LINE
- EXISTING P.O.A. (WELL)

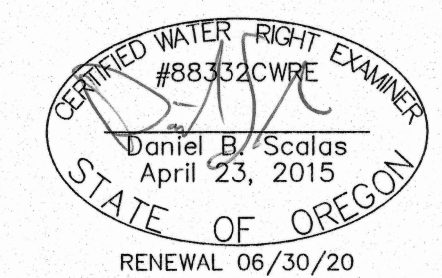

AL ADKINS ENGINEERING & SURVEYING o / 541.884.4666 w / AdkinsEngineering.com

1435 ESPLANADE AVENUE, KLAMATH FALLS, OR 97601

SERVING S. OREGON & N. CALIFORNIA

ENGINEERING • SURVEYING • PLANNING • TESTING

