

Received by OWRD

OCT 04 2019

Salem, OR

Application for Permanent Water Right Transfer

Part 1 of 5 - Minimum Requirements Checklist



State of Oregon
Water Resources Department
725 Summer Street NE, Suite A
Salem, Oregon 97301-1266
(503) 986-0900

This transfer application will be returned if Parts 1 through 5 and all required attachments are not completed and included.

For questions, please call (503) 986-0900, and ask for Transfer Section.

Check all items included with this application. (N/A = Not Applicable)

- Part 1 – Completed Minimum Requirements Checklist.
- Part 2 – Completed Transfer Application Map Checklist.
- Part 3 – Application Fee, payable by check to the Oregon Water Resources Department, and completed Fee Worksheet, page 3. Try the new online fee calculator at: http://apps.wrd.state.or.us/apps/misc/wrd_fee_calculator. If you have questions, call Customer Service at (503) 986-0801.
- Part 4 – Completed Applicant Information and Signature.
- Part 5 – Information about Water Rights to be Transferred: **How many water rights are to be transferred? 5 List them here: C-28656, 33151, 1991, 10660, & 33152**
Please include a separate Part 5 for each water right. (See instructions on page 6)

Attachments:

- Completed Transfer Application Map.
- Completed Evidence of Use Affidavit and supporting documentation.
- N/A Affidavit(s) of Consent from Landowner(s) (if the applicant does not own the land the water right is on.)
- N/A Supplemental Form D – For water rights served by or issued in the name of an irrigation district. Complete when the transfer applicant is not the irrigation district.
- N/A Land Use Information Form with approval and signature (or signed land use form receipt stub). Not required if water is to be diverted, conveyed, and/or used only on federal lands or if **all** of the following apply: a) a change in place of use only, b) no structural changes, c) the use of water is for irrigation only, and d) the use is located within an irrigation district or an exclusive farm use zone.
- N/A Water Well Report/Well Log for changes in point(s) of appropriation (well(s)) or additional point(s) of appropriation.
- N/A Geologist Report for a change from a surface water point of diversion to a ground water point of appropriation (well), if the proposed well is more than 500' from the surface water source and more than 1000' upstream or downstream from the point of diversion. See OAR 690-380-2130 for requirements and applicability.

(For Staff Use Only)

WE ARE RETURNING YOUR APPLICATION FOR THE FOLLOWING REASON(S):

- Application fee not enclosed/insufficient
- Land Use Form not enclosed or incomplete
- Additional signature(s) required
- Map not included or incomplete
- Part _____ is incomplete

Other/Explanation _____

Staff: _____ 503-986-0 _____ Date: ____/____/____

OCT 04 2019

Salem, OR

Part 2 of 5 – Transfer Application Map Checklist

Your transfer application will be returned if any of the map requirements listed below are not met.

Please be sure that the transfer application map you submit includes all the required items and matches the existing water right map. Check all boxes that apply.

- N/A Certified Water Right Examiner (CWRE) Stamp and Original Signature. For a list of CWREs, see http://apps.wrd.state.or.us/apps/wr/cwre_license_view/. CWRE stamp and signature are not required for substitutions.
- N/A If **more than three** water rights are involved, separate maps are needed for each water right.
- Permanent quality printed with dark ink on good quality paper.
- The size of the map can be 8½ x 11 inches, 8½ x 14 inches, 11 x 17 inches, or up to 30 x 30 inches. For 30 x 30 inch maps, one extra copy is required.
- A north arrow, a legend, and scale.
- The scale of the map must be: 1 inch = 400 feet, 1 inch = 1,320 feet, the scale of the Final Proof/Claim of Beneficial Use Map (the map used when the permit was certificated), the scale of the county assessor map if the scale is not smaller than 1 inch = 1,320 feet, or a scale that has been pre-approved by the Department.
- Township, Range, Section, ¼ ¼, DLC, Government Lot, and other recognized public land survey lines.
- Tax lot boundaries (property lines) are required. Tax lot numbers are recommended.
- Major physical features including rivers and creeks showing direction of flow, lakes and reservoirs, roads, and railroads.
- Major water delivery system features from the point(s) of diversion/appropriation such as main pipelines, canals, and ditches.
- Existing place of use that includes separate hachuring for each water right, priority date, and use including number of acres in each quarter-quarter section, government lot, or in each quarter-quarter section as projected within government lots, donation land claims, or other recognized public land survey subdivisions. If less than the entirety of the water right is being changed, a separate hachuring is needed for lands left unchanged.
- N/A Proposed place of use that includes separate hachuring for each water right, priority date, and use including number of acres in each quarter-quarter section, government lot, or in each quarter-quarter section as projected within government lots, donation land claims, or other recognized public land survey subdivisions.
- Existing point(s) of diversion or well(s) with distance and bearing or coordinates from a recognized survey corner. This information can be found in your water right certificate or permit.
- N/A If you are proposing a change in point(s) of diversion or well(s), show the proposed location and label it clearly with distance and bearing or coordinates. If GPS coordinates are used, latitude-longitude coordinates may be expressed as either degrees-minutes-seconds with at least one digit after the decimal (example – 42°32'15.5") or degrees-decimal with five or more digits after the decimal (example – 42.53764°).

Part 3 of 5 – Fee Worksheet

1	Base Fee (includes one type of change to one water right for up to 1 cfs)	1	\$1,160
	Types of change proposed: <input checked="" type="checkbox"/> Place of Use <input type="checkbox"/> Character of Use <input checked="" type="checkbox"/> Point of Diversion/Appropriation Number of above boxes checked = <u>2 (2a)</u> Subtract 1 from the number in line 2a = <u>1 (2b)</u> <i>If only one change, this will be 0</i>		
2	Multiply line 2b by \$930 and enter » » » » » » » » » » » » » » » »	2	\$930
3	Number of water rights included in transfer 5 (3a) Subtract 1 from the number in 3a above: <u>4 (3b)</u> <i>If only one water right this will be 0</i>	3	\$1,580
4	Do you propose to add or change a well, or change from a surface water POD to a well? <input type="checkbox"/> No: enter 0 » <input checked="" type="checkbox"/> Yes: enter \$410 »	4	\$410
5	Do you propose to change the place of use or character of use? <input type="checkbox"/> No: enter 0 on line 5 » <input checked="" type="checkbox"/> Yes: enter the cfs for the portions of the rights to be transferred (see example below*): <u>0.60 (5a)</u> Subtract 1.0 from the number in 5a above: <u>0 (5b)</u> If 5b is 0 or less, enter 0 on line 5 » If 5b is greater than 0, round up to the nearest whole number: _____ (5c) and multiply 5c by \$350, then enter on line 5 » » » » » » » » » »	5	0
6	Add entries on lines 1 through 5 above » » » » » » » » » » Subtotal:	6	\$4,580
7	Is this transfer: <input type="checkbox"/> necessary to complete a project funded by the Oregon Watershed Enhancement Board (OWEB) under ORS 541.932? <input type="checkbox"/> endorsed in writing by ODFW as a change that will result in a net benefit to fish and wildlife habitat? If one or more boxes is checked, multiply line 6 by 0.5 and enter on line 7 » If no box is applicable, enter 0 on line 7 »	7	0
8	Subtract line 7 from line 6 » » » » » » » » » » » » » » » » Transfer Fee:	8	

*Example for Line 5a calculation to transfer 45.0 acres of Primary Certificate 12345 (total 1.25 cfs for 100 acres) and 45.0 acres of Supplemental Certificate 87654 (1/80 cfs per acre) on the same land:

1. For irrigation calculate cfs for each water right involved as follows:
 - a. Divide total authorized cfs by total acres in the water right (for C12345, 1.25 cfs ÷ 100 ac); then multiply by the number of acres to be transferred to get the transfer cfs (x 45 ac = 0.56 cfs).
 - b. If the water right certificate does not list total cfs, but identifies the allowable use as 1/40 or 1/80 of a cfs per acre; multiply number of acres proposed for change by either 0.025 (1/40) or 0.0125 (1/80). (For C87654, 45.0 ac x 0.0125 cfs/ac = 0.56 cfs)
2. Add cfs for the portions of water rights on all the land included in the transfer; however do not count cfs for supplemental rights on acreage for which you have already calculated the cfs fee for the primary right on the same land. The fee should be assessed only once for each "on the ground" acre included in the transfer. (In this example, blank 5a would be only 0.56 cfs, since both rights serve the same 45.0 acres. Blank 5b would be 0 and Line 5 would then also become 0).

FEE WORKSHEET for SUBSTITUTION			
1	Base Fee (includes change to one well)	1	\$840.00
	Number of wells included in substitution _____ (2a) Subtract 1 from the number in 3a above: _____ (2b) <i>If only one well this will be 0</i>		
2	Multiply line 2b by \$410 and enter »	2	
3	Add entries on lines 1 through 2 above » » » » » » Fee for Substitution:	3	

Received by OWRD

OCT 04 2019

Part 4 of 5 – Applicant Information and Signature

Applicant Information

Salem, OR

APPLICANT/BUSINESS NAME William Dunbar/Dunbar Silvies River Ranch			PHONE NO. 541-589-0107	ADDITIONAL CONTACT NO.
ADDRESS 9622 Victor Rd				FAX NO.
CITY Anchorage	STATE AK	ZIP 99515	E-MAIL	
BY PROVIDING AN E-MAIL ADDRESS, CONSENT IS GIVEN TO RECEIVE ALL CORRESPONDENCE FROM THE DEPARTMENT ELECTRONICALLY. COPIES OF THE FINAL ORDER DOCUMENTS WILL ALSO BE MAILED.				

Agent Information – The agent is authorized to represent the applicant in all matters relating to this application.

AGENT/BUSINESS NAME Scott D. Montgomey			PHONE NO. 541-548-5833	ADDITIONAL CONTACT NO. 541-420-0401
ADDRESS PO Box 767				FAX NO. 844-273-9878
CITY Terrebonne	STATE OR	ZIP 97760	E-MAIL scott@apeands.com	
BY PROVIDING AN E-MAIL ADDRESS, CONSENT IS GIVEN TO RECEIVE ALL CORRESPONDENCE FROM THE DEPARTMENT ELECTRONICALLY. COPIES OF THE FINAL ORDER DOCUMENTS WILL ALSO BE MAILED.				

Explain in your own words what you propose to accomplish with this transfer application, and why: Combined wells together from all certificates & move off corners from two fields to a new pivot field under existing certificate 11060. Combining wells & changing well system to center pivot sprinkler instead of flood will save water & make the system more efficient. Surface water system to remain as a flood irrigation application.

If you need additional space, continue on a separate piece of paper and attach to the application as "Attachment 1".

Check this box if this project is fully or partially funded by the American Recovery and Reinvestment Act. (Federal stimulus dollars)

Check One Box

- By signing this application, I understand that, upon receipt of the draft preliminary determination and prior to Department approval of the transfer, I will be required to provide landownership information and evidence that I am authorized to pursue the transfer as identified in OAR 690-380-4010(5); **OR**
- I affirm the applicant is a municipality as defined in ORS 540.510(3)(b) and that the right is in the name of the municipality or a predecessor; **OR**
- I affirm the applicant is an entity with the authority to condemn property and is acquiring by condemnation the property to which the water right proposed for transfer is appurtenant and have supporting documentation.

I understand that prior to Department approval of the transfer application, I may be required to submit payment to the Department for publication of a notice in a newspaper with general circulation in the area where the water right is located, once per week for two consecutive weeks. If more than one qualifying newspaper is available, I suggest publishing the notice in the following newspaper: Burns Herald

I (we) affirm that the information contained in this application is true and accurate.



Applicant signature

William Dunbar
Print Name (and Title if applicable)

Date

Is the applicant the sole owner of the land on which the water right, or portion thereof, proposed for transfer is located? Yes No *If NO, include signatures of all deeded landowners (and mailing and/or e-mail addresses if different than the applicant's) or attach affidavits of consent (and mailing and/or e-mail addresses) from all landowners or individuals/entities to which the water right(s) were conveyed.*

Check the following boxes that apply:

- The applicant is responsible for completion of change(s). Notices and correspondence should continue to be sent to the applicant.
- The receiving landowner will be responsible for completing the proposed change(s) after the final order is issued. Copies of notices and correspondence should be sent to this landowner.
- Both the receiving landowner and applicant will be responsible for completion of change(s). Copies of notices and correspondence should be sent to this landowner and the applicant.

At this time, are the lands in this transfer application in the process of being sold? Yes No

If YES, and you know who the new landowner will be, please complete the receiving landowner information table below. If you do not know who the new landowner will be, then a request for assignment will have to be filed for at a later date.

If a property sells, the certificated water right(s) located on the land belong to the new owner, unless a sale agreement or other document states otherwise. For more information see: <http://www.oregon.gov/owrd/docs/transfer-propertytransactions.pdf>

RECEIVING LANDOWNER NAME NA			PHONE NO.	ADDITIONAL CONTACT NO.
ADDRESS				FAX NO.
CITY	STATE	ZIP	E-MAIL	

Describe any special ownership circumstances here: _____

- Check here if any of the water rights proposed for transfer are or will be located within or served by an irrigation or other water district. (Tip: Complete and attach Supplemental Form D.)

IRRIGATION DISTRICT NAME NA	ADDRESS	
CITY	STATE	ZIP

- Check here if water for any of the rights supplied under a water service agreement or other contract for stored water with a federal agency or other entity.

ENTITY NAME NA	ADDRESS	
CITY	STATE	ZIP

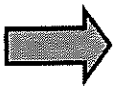

To meet State Land Use Consistency Requirements, you must list all county, city, municipal corporation, or tribal governments within whose jurisdiction water will be diverted, conveyed or used.

ENTITY NAME Harney County	ADDRESS 450 N Buena Vista	
CITY Burns	STATE OR	ZIP 97720

Received by OWRD

OCT 04 2019

Salem, OR

Part 5 of 5 – Water Right Information

Please use a separate Part 5 for each water right being changed. See instructions on page 6, to copy and paste additional Part 5s, or to add additional rows to tables within the form.

CERTIFICATE # 28656

Received by OWRD

Description of Water Delivery System

System capacity: 0.13 cubic feet per second (cfs) OR
 _____ gallons per minute (gpm)

OCT 04 2019

Salem, OR

Describe the current water delivery system or the system that was in place at some time within the last five years. Include information on the pumps, canals, pipelines, and sprinklers used to divert, convey, and apply the water at the authorized place of use. **Water is pumped into ditches that flood irrigate the place of use.**

Table 1. Location of Authorized and Proposed Point(s) of Diversion (POD) or Appropriation (POA)
 (Note: If the POD/POA name is not specified on the certificate, assign it a name or number here.)

Point of Diversion/Appropriation Name	Type	Well ID	N	S	E	W	Direction	Area	Location Description	
Howes Well	<input checked="" type="checkbox"/> Authorized <input type="checkbox"/> Proposed	HARN 592	23	S	32	E	27	SE NW	4600	20.5 Chains S & 21 Chains E from the NW cor, Sec 27
#3	<input type="checkbox"/> Authorized <input checked="" type="checkbox"/> Proposed	Not built	23	S	32	E	28	NW NE	4700	43°33'14.25" N 118°53'16.03" W
#2	<input type="checkbox"/> Authorized <input checked="" type="checkbox"/> Proposed	HARN 602	23	S	32	E	28	SW NE	4700	2890' N & 1520' W from the SE cor, Sec 28

Check all type(s) of change(s) proposed below (change "CODES" are provided in parentheses):

- | | |
|--|--|
| <input checked="" type="checkbox"/> Place of Use (POU) | <input type="checkbox"/> Supplemental Use to Primary Use (S to P) |
| <input type="checkbox"/> Character of Use (USE) | <input type="checkbox"/> Point of Appropriation/Well (POA) |
| <input type="checkbox"/> Point of Diversion (POD) | <input checked="" type="checkbox"/> Additional Point of Appropriation (APOA) |
| <input type="checkbox"/> Additional Point of Diversion (APOD) | <input type="checkbox"/> Substitution (SUB) |
| <input type="checkbox"/> Surface Water POD to Ground Water POA (SW/GW) | <input type="checkbox"/> Government Action POD (GOV) |

Will all of the proposed changes affect the entire water right?

- Yes Complete only the Proposed ("to" or "on" lands) section of Table 2 on the next page. Use the "CODES" listed above to describe the proposed changes.
- No Complete all of Table 2 to describe the portion of the water right to be changed.

Please use and attach additional pages of Table 2 as needed.
See page 6 for instructions.

Do you have questions about how to fill-out the tables?
Contact the Department at 503-986-0900 and ask for Transfer Staff.

Table 2. Description of Changes to Water Right Certificate # 28656

List the change proposed for the acreage in each 1/4 1/4. If more than one change is proposed, specify the acreage associated with each change.
If there is more than one POD/POA involved in the proposed changes, specify the acreage associated with each POD/POA.

AUTHORIZED (the "from" or "off" lands)										PROPOSED (the "to" or "on" lands)											
The listing that appears on the certificate BEFORE PROPOSED CHANGES List only that part or portion of the water right that will be changed.										The listing as it would appear AFTER PROPOSED CHANGES are made.											
Twp	Rng	Sec	1/4	1/4	Tax Lot	Gvt Lot or DLC	Acres	Type of USE listed on Certificate	POD(s) or POA(s) (name or number from Table 1)	Priority Date	Twp	Rng	Sec	1/4	1/4	Tax Lot	Gvt Lot or DLC	Acres	New Type of USE	POD(s) POA(s) to be used (from Table 1)	Priority Date
3	S	32	E	27	NE	NW	8.0	IS	Howes Well	1955	23	S	32	E	27	NE	SW	7.5	IS	Howes #2, #3	1955
3	S	32	E	27	NW	NW	5.1	IS	Howes Well	1955	23	S	32	E	27	NW	SW	7.6	IS	Howes #2, #3	1955
3	S	32	E	27	SW	NW	7.0	IS	Howes #2	1955	23	S	32	E	27	SW	SW	7.5	IS	Howes #2, #3	1955
3	S	32	E	27	SE	NW	10.0	IS	Howes #2	1955	23	S	32	E	27	SE	SW	7.5	IS	Howes #2, #3	1955
TOTAL ACRES: 30.1										TOTAL ACRES: 30.1											

Additional remarks: _____

Received by OWRD
OCT 04 2019
Salem, OR

For Place of Use or Character of Use Changes

Are there other water right certificates, water use permits or ground water registrations associated with the "from" or the "to" lands? Yes No

If YES, list the certificate, water use permit, or ground water registration numbers: 1991 SW "IR"

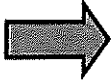

Pursuant to ORS 540.510, any "layered" water use such as an irrigation right that is supplemental to a primary right proposed for transfer must be included in the transfer or be cancelled. Any change to a ground water registration must be filed separately in a ground water registration modification application.

For Substitution (ground water supplemental irrigation will be substituted for surface water primary irrigation)

Ground water supplemental Permit or Certificate # _____;
Surface water primary Certificate # _____.

Received by OWRD

OCT 04 2019

For a change from Supplemental Irrigation Use to Primary Irrigation Use

Identify the primary certificate to be cancelled. Certificate # _____

Salem, OR

For a change in point(s) of appropriation (well(s)) or additional point(s) of appropriation:

Well log(s) are attached for each authorized and proposed well(s) that are clearly labeled and associated with the corresponding well(s) in Table 1 above and on the accompanying application map.

Tip: You may search for well logs on the Department's web page at:
http://apps.wrd.state.or.us/apps/gw/well_log/Default.aspx

AND/OR

Describe the construction of the authorized and proposed well(s) in Table 3 for any wells that do not have a well log. For *proposed wells not yet constructed or built*, provide "a best estimate" for each requested information element in the table. The Department recommends you consult a licensed well driller, geologist, or certified water right examiner to assist with assembling the information necessary to complete Table 3.

Table 3. Construction of Point(s) of Appropriation

Any well(s) in this listing must be clearly tied to corresponding well(s) described in Table 1 and shown on the accompanying application map. Failure to provide the information will delay the processing of your transfer application until it is received. The information is necessary for the department to assess whether the proposed well(s) will access the same source aquifer as the authorized point(s) of appropriation (POA). The Department is prohibited by law from approving POA changes that do not access the same source aquifer.

Proposed or Authorized POA Name or Number	Is well already built? (Yes or No)	If an existing well; OWRD Well ID Tag No. L-	Total well depth	Casing Diameter	Casing Intervals (feet)	Seal depth(s) (intervals)	Perforated or screened intervals (in feet)	Static water level of completed well (in feet)	Source aquifer (sand, gravel, basalt, etc.)	Well -specific rate (cfs or gpm). If less than full rate of water right
Howes Well	Yes	See well log								
#3	Yes	Not built	300'	10"	+1 to -300'	0 to -100		-50'	clay	600 gpm
#2	Yes	See well log								

CERTIFICATE # 33151

OCT 04 2019

Description of Water Delivery System

System capacity: 0.49 cubic feet per second (cfs) OR
 _____ gallons per minute (gpm)

Salem, OR

Describe the current water delivery system or the system that was in place at some time within the last five years. Include information on the pumps, canals, pipelines, and sprinklers used to divert, convey, and apply the water at the authorized place of use. **Water is pumped from well & conveyed into ditches to flood irrigate the place of use.**

Table 1. Location of Authorized and Proposed Point(s) of Diversion (POD) or Appropriation (POA)
 (Note: If the POD/POA name is not specified on the certificate, assign it a name or number here.)

Point of Diversion/Appropriation	Authorized/Proposed	Name	Section	Distance	Direction	Area	Coordinates
#3	<input type="checkbox"/> Authorized <input checked="" type="checkbox"/> Proposed	Not built	23 S	32 E	28	NW NE	4700 43°33'14.25" N 118°53'16.03" W
Howes Well	<input type="checkbox"/> Authorized <input checked="" type="checkbox"/> Proposed	HARN 592	23 S	32 E	27	SE NW	4600 20.5 Chains S & 21 Chains E from the NW cor, Sec 27
#2	<input checked="" type="checkbox"/> Authorized <input type="checkbox"/> Proposed	HARN 602	23 S	32 E	28	SW NE	4700 2890' N & 1520' W from the SE cor, Sec 28

Check all type(s) of change(s) proposed below (change "CODES" are provided in parentheses):

- Place of Use (POU)
- Character of Use (USE)
- Point of Diversion (POD)
- Additional Point of Diversion (APOD)
- Surface Water POD to Ground Water POA (SW/GW)
- Supplemental Use to Primary Use (S to P)
- Point of Appropriation/Well (POA)
- Additional Point of Appropriation (APOA)
- Substitution (SUB)
- Government Action POD (GOV)

Will all of the proposed changes affect the entire water right?

- Yes Complete only the Proposed ("to" or "on" lands) section of Table 2 on the next page. Use the "CODES" listed above to describe the proposed changes.
- No Complete all of Table 2 to describe the portion of the water right to be changed.

Please use and attach additional pages of Table 2 as needed.
See page 6 for instructions.

Do you have questions about how to fill-out the tables?
Contact the Department at 503-986-0900 and ask for Transfer Staff.

Table 2. Description of Changes to Water Right Certificate # 33151

List the change proposed for the acreage in each 1/4 1/4. If more than one change is proposed, specify the acreage associated with each change.
If there is more than one POD/POA involved in the proposed changes, specify the acreage associated with each POD/POA.

AUTHORIZED (the "from" or "off" lands)										PROPOSED (the "to" or "on" lands)											
The listing that appears on the certificate BEFORE PROPOSED CHANGES										The listing as it would appear AFTER PROPOSED CHANGES											
List only that part or portion of the water right that will be changed.										are made.											
Twp	Rng	Sec	1/4 1/4	Tax Lot	Gvt Lot or DLC	Acres	Type of USE listed on Certificate	POD(s) or POA(s) (name or number from Table 1)	Priority Date	Proposed Changes (Sec. "CODES" from previous page)	Twp	Rng	Sec	1/4 1/4	Tax Lot	Gvt Lot or DLC	Acres	New Type of USE	POD(s) to be used (from Table 1)	Priority Date	
23	S	32	E 28	NE SE	4700	7.9	IS	#2	1959	POU/APOA	23	S	32	E 27	NE SW	4600	9.8	IS	Howes well, #2 & #3	1959	
23	S	32	E 28	NW SE	4700	8.3	IS	#2	1959	POU/APOA	23	S	32	E 27	NW SW	4600	9.8	IS	Howes well, #2 & #3	1959	
23	S	32	E 28	SW SE	4700	12.1	IS	#2	1959	POU/APOA	23	S	32	E 27	SW SW	4600	9.7	IS	Howes well, #2 & #3	1959	
23	S	32	E 28	SE SE	4700	10.7	IS	#2	1959	POU/APOA	23	S	32	E 27	SE SW	4600	9.7	IS	Howes well, #2 & #3	1959	
						TOTAL ACRES:	39.0							TOTAL ACRES:	39.0						

Additional remarks: _____.

Received by OWRD
OCT 04 2019
Salem, OR

For Place of Use or Character of Use Changes

Are there other water right certificates, water use permits or ground water registrations associated with the "from" or the "to" lands? Yes No

If YES, list the certificate, water use permit, or ground water registration numbers: 33152 SW "IR".

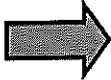

Pursuant to ORS 540.510, any "layered" water use such as an irrigation right that is supplemental to a primary right proposed for transfer must be included in the transfer or be cancelled. Any change to a ground water registration must be filed separately in a ground water registration modification application.

For Substitution (ground water supplemental irrigation will be substituted for surface water primary irrigation)

Ground water supplemental Permit or Certificate # _____;
Surface water primary Certificate # _____.

Received by OWRD
OCT 04 2019
Salem, OR

For a change from Supplemental Irrigation Use to Primary Irrigation Use

Identify the primary certificate to be cancelled. Certificate # _____

For a change in point(s) of appropriation (well(s)) or additional point(s) of appropriation:

Well log(s) are attached for each authorized and proposed well(s) that are clearly labeled and associated with the corresponding well(s) in Table 1 above and on the accompanying application map.

Tip: You may search for well logs on the Department's web page at:
http://apps.wrd.state.or.us/apps/gw/well_log/Default.aspx

AND/OR

Describe the construction of the authorized and proposed well(s) in Table 3 for any wells that do not have a well log. For *proposed wells not yet constructed or built*, provide "a best estimate" for each requested information element in the table. The Department recommends you consult a licensed well driller, geologist, or certified water right examiner to assist with assembling the information necessary to complete Table 3.

Table 3. Construction of Point(s) of Appropriation

Any well(s) in this listing must be clearly tied to corresponding well(s) described in Table 1 and shown on the accompanying application map. Failure to provide the information will delay the processing of your transfer application until it is received. The information is necessary for the department to assess whether the proposed well(s) will access the same source aquifer as the authorized point(s) of appropriation (POA). The Department is prohibited by law from approving POA changes that do not access the same source aquifer.

Proposed or Authorized POA Name or Number	Is well already built? (Yes or No)	If an existing well: OWRD Well ID Tag No. L-	Total well depth	Casing Diameter	Casing Intervals (feet)	Seal depth(s) (intervals)	Perforated or screened intervals (in feet)	Static water level of completed well (in feet)	Source aquifer (sand, gravel, basalt, etc.)	Well -specific rate (cfs or gpm). If less than full rate of water right
#3	#3	Yes	Not built	300'	10"	+1 to -300'	0 to -100		-50'	clay
Howes Well										
#2										

CERTIFICATE # 1991

Received by OWRD
OCT 04 2019
Salem, OR

Description of Water Delivery System

System capacity: **0.38** cubic feet per second (cfs) OR
_____ gallons per minute (gpm)

Describe the current water delivery system or the system that was in place at some time within the last five years. Include information on the pumps, canals, pipelines, and sprinklers used to divert, convey, and apply the water at the authorized place of use. **Water is diverted from slough and conveyed into ditches that flood irrigate the place of use.**

Table 1. Location of Authorized and Proposed Point(s) of Diversion (POD) or Appropriation (POA)
(Note: If the POD/POA name is not specified on the certificate, assign it a name or number here.)

POD/POA Name or Number	POD/POA Authorized or Proposed	POA/POD Well or Well ID	Top	Qty	Sec	St.	Acres	Authorized/Proposed (Acres/Number)
POD	<input checked="" type="checkbox"/> Authorized <input type="checkbox"/> Proposed		23 S	32 E	27	SW NW	4600	Graphically located on App. Map by Dodge halfway between N 1/16 & W 1/4 corners
	<input type="checkbox"/> Authorized <input type="checkbox"/> Proposed							

Check all type(s) of change(s) proposed below (change "CODES" are provided in parentheses):

- | | |
|--|---|
| <input checked="" type="checkbox"/> Place of Use (POU) | <input type="checkbox"/> Supplemental Use to Primary Use (S to P) |
| <input type="checkbox"/> Character of Use (USE) | <input type="checkbox"/> Point of Appropriation/Well (POA) |
| <input type="checkbox"/> Point of Diversion (POD) | <input type="checkbox"/> Additional Point of Appropriation (APOA) |
| <input type="checkbox"/> Additional Point of Diversion (APOD) | <input type="checkbox"/> Substitution (SUB) |
| <input type="checkbox"/> Surface Water POD to Ground Water POA (SW/GW) | <input type="checkbox"/> Government Action POD (GOV) |

Will all of the proposed changes affect the entire water right?

- Yes Complete only the Proposed ("to" or "on" lands) section of Table 2 on the next page. Use the "CODES" listed above to describe the proposed changes.
- No Complete all of Table 2 to describe the portion of the water right to be changed.

Please use and attach additional pages of Table 2 as needed.
See page 6 for instructions.

Do you have questions about how to fill-out the tables?
Contact the Department at 503-986-0900 and ask for Transfer Staff.

Table 2. Description of Changes to Water Right Certificate # 1991

List the change proposed for the acreage in each 1/4 1/4. If more than one change is proposed, specify the acreage associated with each change. If there is more than one POD/POA involved in the proposed changes, specify the acreage associated with each POD/POA.

AUTHORIZED (the "from" or "off" lands)										PROPOSED (the "to" or "on" lands)														
The listing that appears on the certificate BEFORE PROPOSED CHANGES List only that part or portion of the water right that will be changed.										The listing as it would appear AFTER PROPOSED CHANGES are made.														
Twp	Rng	Sec	1/4 1/4	Tax Lot	Gwt Lot or DLC	Acres	Type of USE listed on Certificate	POD(s) or POA(s) name or number from Table 1)	Priority Date	Proposed Changes (see "CODES" from previous page)	Twp	Rng	Sec	1/4 1/4	Tax Lot	Gwt Lot or DLC	Acres	New Type of USE	POD(s) or POA(s) to be used from Table 1)	Priority Date				
23	S	32	E	27	NE	NW	4600	IR	POD #1	1917	POU/POA	23	S	32	E	27	NE	SW	4600	IR	7.5	IR	POD #1	1917
23	S	32	E	27	NW	NW	4600	IR	POD #1	1917	POE/POA	23	S	32	E	27	NW	SW	4600	IR	7.6	IR	POD #1	1917
23	S	32	E	27	SW	NW	4600	IR	POD #1	1917	POU/POA	23	S	32	E	27	SW	SW	4600	IR	7.5	IR	POD #1	1917
23	S	32	E	27	SE	NW	4600	IR	POD #1	1917	POU/POA	23	S	32	E	27	SE	SW	4600	IR	7.5	IR	POD #1	1917
						TOTAL ACRES:	30.1							TOTAL ACRES:	30.1									

Additional remarks: _____.

Received by OWRD
OCT 04 2019
Salem, OR

Received by OWRD
 OCT 04 2019
 Salem, OR

Certificate # 1991

For Place of Use or Character of Use Changes

Are there other water right certificates, water use permits or ground water registrations associated with the "from" or the "to" lands? Yes No

If YES, list the certificate, water use permit, or ground water registration numbers: 28656 & 11060.

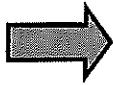

Pursuant to ORS 540.510, any "layered" water use such as an irrigation right that is supplemental to a primary right proposed for transfer must be included in the transfer or be cancelled. Any change to a ground water registration must be filed separately in a ground water registration modification application.

For Substitution (ground water supplemental irrigation will be substituted for surface water primary irrigation)

Ground water supplemental Permit or Certificate # _____;
 Surface water primary Certificate # _____.

For a change from Supplemental Irrigation Use to Primary Irrigation Use

Identify the primary certificate to be cancelled. Certificate # _____

For a change in point(s) of appropriation (well(s)) or additional point(s) of appropriation:

Well log(s) are attached for each authorized and proposed well(s) that are clearly labeled and associated with the corresponding well(s) in Table 1 above and on the accompanying application map.

Tip: You may search for well logs on the Department's web page at:
http://apps.wrd.state.or.us/apps/gw/well_log/Default.aspx

AND/OR

Describe the construction of the authorized and proposed well(s) in Table 3 for any wells that do not have a well log. For *proposed wells not yet constructed or built*, provide "a best estimate" for each requested information element in the table. The Department recommends you consult a licensed well driller, geologist, or certified water right examiner to assist with assembling the information necessary to complete Table 3.

Table 3. Construction of Point(s) of Appropriation

Any well(s) in this listing must be clearly tied to corresponding well(s) described in Table 1 and shown on the accompanying application map. Failure to provide the information will delay the processing of your transfer application until it is received. The information is necessary for the department to assess whether the proposed well(s) will access the same source aquifer as the authorized point(s) of appropriation (POA). The Department is prohibited by law from approving POA changes that do not access the same source aquifer.

Proposed or Authorized POA Name or Number	Is well already built? (Yes or No)	If an existing well: OWRD Well ID Tag No. L-	Total well depth	Casing Diameter	Casing Intervals (feet)	Seal depth(s) (intervals)	Perforated or screened intervals (in feet)	Static water level of completed well (in feet)	Source aquifer (sand, gravel, basalt, etc.)	Well -specific rate (cfs or gpm). If less than full rate of water right
NA										

Received by OWRD
 OCT 04 2019
 Salem, OR

CERTIFICATE # 33152

Description of Water Delivery System

System capacity: 0.49 cubic feet per second (cfs) OR

_____ gallons per minute (gpm)

Describe the current water delivery system or the system that was in place at some time within the last five years. Include information on the pumps, canals, pipelines, and sprinklers used to divert, convey, and apply the water at the authorized place of use. **Water is diverted from the slough and conveyed into ditches that flood irrigate the place of use.**

Table 1. Location of Authorized and Proposed Point(s) of Diversion (POD) or Appropriation (POA)
 (Note: If the POD/POA name is not specified on the certificate, assign it a name or number here.)

POD/POA Name	Authorized	Proposed	Section	Range	Block	Quarter	Acres	Description	
POD #2	<input checked="" type="checkbox"/>	<input type="checkbox"/>	23	S	32	E 28	NW NE	4700	4880' N & 1940' W from SE corner S28
POD #1	<input type="checkbox"/>	<input checked="" type="checkbox"/>	23	S	32	E 27	SW NW	4600	Graphically located on App. Map by Dodge halfway between N 1/16 & W 1/4 corners

Check all type(s) of change(s) proposed below (change "CODES" are provided in parentheses):

- Place of Use (POU)
- Character of Use (USE)
- Point of Diversion (POD)
- Additional Point of Diversion (APOD)
- Surface Water POD to Ground Water POA (SW/GW)
- Supplemental Use to Primary Use (S to P)
- Point of Appropriation/Well (POA)
- Additional Point of Appropriation (APOA)
- Substitution (SUB)
- Government Action POD (GOV)

Will all of the proposed changes affect the entire water right?

- Yes Complete only the Proposed ("to" or "on" lands) section of Table 2 on the next page. Use the "CODES" listed above to describe the proposed changes.
- No Complete all of Table 2 to describe the portion of the water right to be changed.

Please use and attach additional pages of Table 2 as needed.
See page 6 for instructions.

Do you have questions about how to fill-out the tables?
Contact the Department at 503-986-0900 and ask for Transfer Staff.

Table 2. Description of Changes to Water Right Certificate # 33152

List the change proposed for the acreage in each 1/4 1/4. If more than one change is proposed, specify the acreage associated with each change.
If there is more than one POD/POA involved in the proposed changes, specify the acreage associated with each POD/POA.

AUTHORIZED (the "from" or "off" lands)										PROPOSED (the "to" or "on" lands)											
The listing that appears on the certificate BEFORE PROPOSED CHANGES										The listing as it would appear AFTER PROPOSED CHANGES											
List only that part or portion of the water right that will be changed.										are made.											
Twp	Rng	Sec	1/4 1/4	Tax Lot	Gvt Lot or DLC	Acreage	Type of USE listed on Certificate	POD(s) or POA(s) (name or number from Table 1)	Priority Date	Proposed Changes (see "CODES" from previous page)	Twp	Rng	Sec	1/4 1/4	Tax Lot	Gvt Lot or DLC	Acreage	New Type of USE	POD(s)/ POA(s) to be used (from Table 1)	Priority Date	
3	S	32	E	28	NE	SE	IR	POD #2	1958	POU/POD	23	S	32	E	27	NE	SW	4600	IR	POD #1	1958
3	S	32	E	28	NW	SE	IR	POD #2	1958	POU/POD	23	S	32	E	27	NW	SW	4600	IR	POD #1	1958
3	S	32	E	28	SW	SE	IR	POD #2	1958	POU/POD	23	S	32	E	27	SW	SW	4600	IR	POD #1	1958
3	S	32	E	28	SE	SE	IR	POD #2	1958	POU/POD	23	S	32	E	27	SE	SW	4600	IR	POD #1	1958
TOTAL ACRES: 39.0										TOTAL ACRES: 39.0											

Additional remarks: Propose to change the POD for the entire water right to POD #1.

Received by OWRD
OCT 04 2019
Salem, OR

Received by OWRD
 OCT 04 2019
 Salem, OR

Certificate # 33152

For Place of Use or Character of Use Changes

Are there other water right certificates, water use permits or ground water registrations associated with the "from" or the "to" lands? Yes No

If YES, list the certificate, water use permit, or ground water registration numbers: 33151 & 11060.



Pursuant to ORS 540.510, any "layered" water use such as an irrigation right that is supplemental to a primary right proposed for transfer must be included in the transfer or be cancelled. Any change to a ground water registration must be filed separately in a ground water registration modification application.

For Substitution (ground water supplemental irrigation will be substituted for surface water primary irrigation)

Ground water supplemental Permit or Certificate # _____;
 Surface water primary Certificate # _____.

For a change from Supplemental Irrigation Use to Primary Irrigation Use

Identify the primary certificate to be cancelled. Certificate # _____

For a change in point(s) of appropriation (well(s)) or additional point(s) of appropriation:

Well log(s) are attached for each authorized and proposed well(s) that are clearly labeled and associated with the corresponding well(s) in Table 1 above and on the accompanying application map.

Tip: You may search for well logs on the Department's web page at:
http://apps.wrd.state.or.us/apps/gw/well_log/Default.aspx

AND/OR

Describe the construction of the authorized and proposed well(s) in Table 3 for any wells that do not have a well log. For *proposed wells not yet constructed or built*, provide "a best estimate" for each requested information element in the table. The Department recommends you consult a licensed well driller, geologist, or certified water right examiner to assist with assembling the information necessary to complete Table 3.

Table 3. Construction of Point(s) of Appropriation

Any well(s) in this listing must be clearly tied to corresponding well(s) described in Table 1 and shown on the accompanying application map. Failure to provide the information will delay the processing of your transfer application until it is received. The information is necessary for the department to assess whether the proposed well(s) will access the same source aquifer as the authorized point(s) of appropriation (POA). The Department is prohibited by law from approving POA changes that do not access the same source aquifer.

Proposed or Authorized POA Name or Number	Is well already built? (Yes or No)	If an existing well: OWRD Well ID Tag No. L-	Total well depth	Casing Diameter	Casing Intervals (feet)	Seal depth(s) (intervals)	Perforated or screened intervals (in feet)	Static water level of completed well (in feet)	Source aquifer (sand, gravel, basalt, etc.)	Well -specific rate (cfs or gpm). If less than full rate of water right
NA										

CERTIFICATE # 11060

Received by OWRD
OCT 04 2019
Salem, OR

Description of Water Delivery System

System capacity: 0.86 cubic feet per second (cfs) OR
_____ gallons per minute (gpm)

Describe the current water delivery system or the system that was in place at some time within the last five years. Include information on the pumps, canals, pipelines, and sprinklers used to divert, convey, and apply the water at the authorized place of use. **Water is diverted from the slough and conveyed into ditches that flood irrigate the place of use.**

Table 1. Location of Authorized and Proposed Point(s) of Diversion (POD) or Appropriation (POA)
(Note: If the POD/POA name is not specified on the certificate, assign it a name or number here.)

POD/POA Name or Number	POD/POA Authorized on the Certificate or is it Proposed?	IF POA, OVER WHAT LAND TYPE IS IT?	ACRES	FEET	FEET	FEET	FEET	FEET	FEET
POD #3	<input checked="" type="checkbox"/> Authorized <input type="checkbox"/> Proposed		23 S	32 E	27	NW	SW	4600	S79°27'E 518' from W 1/4 corner S27
POD #1	<input type="checkbox"/> Authorized <input checked="" type="checkbox"/> Proposed		23 S	32 E	27	SW	NW	4600	Graphically located on App. Map by Dodge halfway between N 1/16 & W 1/4 corners

Check all type(s) of change(s) proposed below (change "CODES" are provided in parentheses):

- | | |
|--|---|
| <input checked="" type="checkbox"/> Place of Use (POU) | <input type="checkbox"/> Supplemental Use to Primary Use (S to P) |
| <input type="checkbox"/> Character of Use (USE) | <input type="checkbox"/> Point of Appropriation/Well (POA) |
| <input checked="" type="checkbox"/> Point of Diversion (POD) | <input type="checkbox"/> Additional Point of Appropriation (APOA) |
| <input type="checkbox"/> Additional Point of Diversion (APOD) | <input type="checkbox"/> Substitution (SUB) |
| <input type="checkbox"/> Surface Water POD to Ground Water POA (SW/GW) | <input type="checkbox"/> Government Action POD (GOV) |

Will all of the proposed changes affect the entire water right?

- Yes Complete only the Proposed ("to" or "on" lands) section of Table 2 on the next page. Use the "CODES" listed above to describe the proposed changes.
- No Complete all of Table 2 to describe the portion of the water right to be changed.

Please use and attach additional pages of Table 2 as needed.
See page 6 for instructions.

Do you have questions about how to fill-out the tables?
Contact the Department at 503-986-0900 and ask for Transfer Staff.

Table 2. Description of Changes to Water Right Certificate # 11060

List the change proposed for the acreage in each 1/4 1/4. If more than one change is proposed, specify the acreage associated with each change.
If there is more than one POD/POA involved in the proposed changes, specify the acreage associated with each POD/POA.

AUTHORIZED (the "from" or "off" lands)										PROPOSED (the "to" or "on" lands)										
The listing that appears on the certificate BEFORE PROPOSED CHANGES										The listing as it would appear AFTER PROPOSED CHANGES										
List only that part or portion of the water right that will be changed.										are made.										
Twp	Rng	Sec	1/4	Tax Lot	Gvt Lot or DLC	Acres	Type of USE listed on Certificate	POD(s) or POA(s) (name or number from Table 1)	Priority Date	Proposed Changes (see "CODIS" from previous page)	Twp	Rng	Sec	1/4	Tax Lot	Gvt Lot or DLC	Acres	New Type of USE	POD(s)/ POA(s) to be used (from Table 1)	Priority Date
23	S	32	E 28	NE SW	4600	7.5	IR	POD #3	1926	POU/POD	23	S	32	E 27	NE NW	4600	9.8	IR	POD #1	1926
23	S	32	E 28	NW SW	4600	7.6	IR	POD #3	1926	POU/POD	23	S	32	E 27	NW NW	4600	9.8	IR	POD #1	1926
23	S	32	E 28	SW SW	4600	7.5	IR	POD #3	1926	POU/POD	23	S	32	E 27	SW NW	4600	9.7	IR	POD #1	1926
23	S	32	E 28	SE SW	4600	7.5	IR	POD #3	1926	POU/POD	23	S	32	E 27	SE NW	4600	9.7	IR	POD #1	1926
23	S	32	E 28	NE SW	4600	9.8	IR	POD #3	1926	POU/POD	23	S	32	E 28	NE SE	4700	9.7	IR	POD #1	1926
23	S	32	E 28	NW SW	4600	9.8	IR	POD #3	1926	POU/POD	23	S	32	E 28	NW SE	4700	9.7	IR	POD #1	1926
23	S	32	E 28	SW SW	4600	9.7	IR	POD #3	1926	POU/POD	23	S	32	E 28	SW SE	4700	9.7	IR	POD #1	1926
23	S	32	E 28	SE SW	4600	9.7	IR	POD #3	1926	POU/POD	23	S	32	E 28	SE SE	4700	9.7	IR	POD #1	1926
TOTAL ACRES: 69.1										TOTAL ACRES: 69.1										

Additional remarks: Proposing to change POD for all of the water right to POD #1.

Received by OWRD
OCT 04 2019
Salem, OR

Received by OWRD

OCT 04 2019

Salem, OR

Certificate # 11060

For Place of Use or Character of Use Changes

Are there other water right certificates, water use permits or ground water registrations associated with the "from" or the "to" lands? Yes No

If YES, list the certificate, water use permit, or ground water registration numbers: 33151 33152, 28656, & 1991.

 Pursuant to ORS 540.510, any "layered" water use such as an irrigation right that is supplemental to a primary right proposed for transfer must be included in the transfer or be cancelled. Any change to a ground water registration must be filed separately in a ground water registration modification application.

For Substitution (ground water supplemental irrigation will be substituted for surface water primary irrigation)

Ground water supplemental Permit or Certificate # _____;
Surface water primary Certificate # _____.

For a change from Supplemental Irrigation Use to Primary Irrigation Use

Identify the primary certificate to be cancelled. Certificate # _____

For a change in point(s) of appropriation (well(s)) or additional point(s) of appropriation:

- Well log(s) are attached for each authorized and proposed well(s) that are clearly labeled and associated with the corresponding well(s) in Table 1 above and on the accompanying application map.
Tip: You may search for well logs on the Department's web page at:
http://apps.wrd.state.or.us/apps/gw/well_log/Default.aspx

AND/OR

- Describe the construction of the authorized and proposed well(s) in Table 3 for any wells that do not have a well log. For *proposed wells not yet constructed or built*, provide "a best estimate" for each requested information element in the table. The Department recommends you consult a licensed well driller, geologist, or certified water right examiner to assist with assembling the information necessary to complete Table 3.

Table 3. Construction of Point(s) of Appropriation

Any well(s) in this listing must be clearly tied to corresponding well(s) described in Table 1 and shown on the accompanying application map. Failure to provide the information will delay the processing of your transfer application until it is received. The information is necessary for the department to assess whether the proposed well(s) will access the same source aquifer as the authorized point(s) of appropriation (POA). The Department is prohibited by law from approving POA changes that do not access the same source aquifer.

Proposed or Authorized POA Name or Number	Is well already built? (Yes or No)	If an existing well: OWRD Well ID/Tag No. L-	Total well depth	Casing Diameter	Casing Intervals (feet)	Seal depth(s) (intervals)	Perforated or screened intervals (in feet)	Static water level of completed well (in feet)	Source aquifer (sand, gravel, basalt, etc.)	Well -specific rate (cfs or gpm). <i>If less than full rate of water right</i>
NA										

MAP TO ACCOMPANY APPLICATION TO CHANGE PLACE OF USE & POINTS OF APPROPRIATION FOR DUNBAR SILVIES RIVER RANCH, LLC

Received by OWRD

TAX LOTS 4600 & 4700
IN SECTIONS 27 & 28, TOWNSHIP 23 SOUTH, RANGE 32 EAST, W.M.
HARNEY COUNTY, OREGON

OCT 04 2019

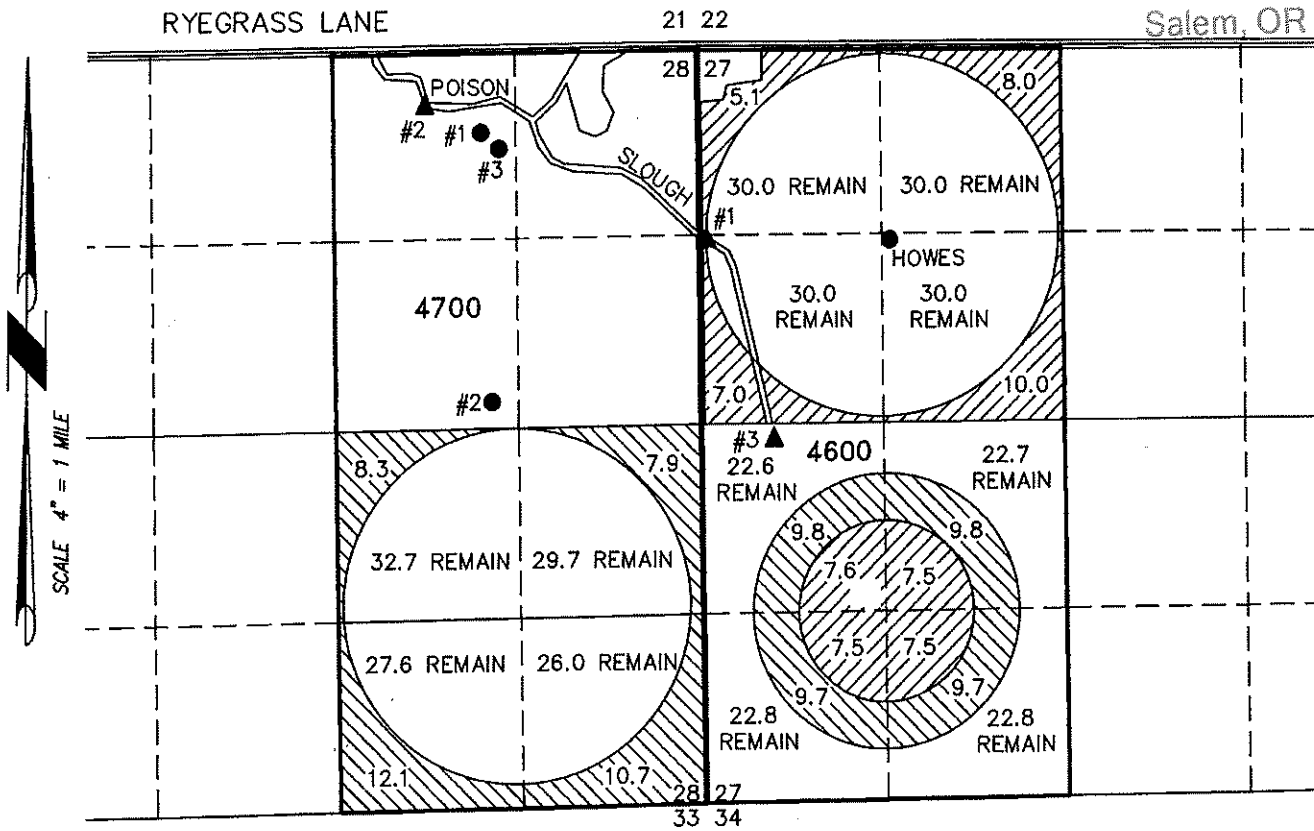

● WELL #2 (HARN 602) IN THE SW 1/4 OF THE NE 1/4 SECTION 28 & 2890' NORTH & 1520' WEST FROM THE SE CORNER SECTION 28.

▲ POINT OF DIVERSION FROM POISON CREEK SLOUGH

● HOWES WELL (HARN 592) IN THE SE 1/4 OF THE NW 1/4 SECTION 27 & 20.5 CHAINS SOUTH & 21 CHAINS EAST FROM THE NW CORNER SECTION 27.

● WELL #3 (HARN 52306) IN THE NW 1/4 OF THE NE 1/4 SECTION 28 AT 43°33'14.25" N 118°53'16.03" W.

30.1 ACRES 'IS' FROM HOWES WELL CERTIFICATE 28656 (PERMIT G-47) & 30.1 ACRES 'IR' FROM POISON CREEK SLOUGH CERTIFICATE 1991 (PERMIT 3372) TRANSFERRED. REPLACED BY 30.1 ACRES 'IR' FROM POISON SLOUGH CERTIFICATE 11060, AS SHOWN

39.0 ACRES 'IS' FROM WELL 2 CERTIFICATE 33151 (PERMIT G-1484) & 39.0 ACRES 'IR' FROM POISON CREEK SLOUGH CERTIFICATE 33152 TRANSFERRED. REPLACE BY 39.0 ACRES 'IR' FROM POISON SLOUGH CERTIFICATE 11060, AS SHOWN

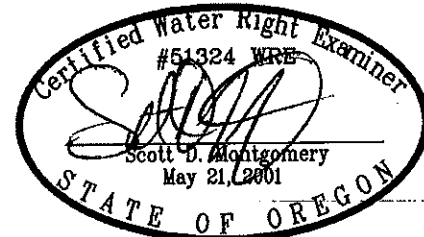

RENEWAL DATE: 12/31/2020

THIS MAP IS FOR THE PURPOSE OF LOCATING A WATER RIGHT ONLY AND HAS NO INTENT TO PROVIDE LEGAL DIMENSIONS OR THE LOCATION OF PROPERTY LINES.

PROJECT No. 18-003

PREPARED AT THE REQUEST OF:
DUNBAR SILVIES RIVER RANCH
9622 VICTOR ROAD
ANCHORAGE, AK 99515

ALL POINTS ENGINEERING & SURVEYING, INC.



P.O. BOX 767
TERREBONNE, OREGON 97760
(541) 548-5833 PH
scott@apeands.com
www.APEandS.com