



State of Oregon
Water Resources Department
 725 Summer Street NE, Suite A
 Salem, Oregon 97301-1266
 (503) 986-0900

Application for Instream Lease

Part 1 of 4 – Minimum Requirements Checklist

Complete Part 1 through 4 and include the required attachments Fill in or check boxes as indicated. (N/A= Not Applicable)	OWRD #	IL-1774
	Fee-	

Pursuant to ORS 537.348(2) and OAR 690-077

Check all items included with this application. (N/A = Not Applicable)

Yes **Part 1 – Completed Minimum Requirements Checklist and Application Fee**

Fees	<input checked="" type="checkbox"/> \$520.00 for a lease involving four or more landowners or four or more water rights	<input type="checkbox"/> \$350.00 for all other leases
	<input checked="" type="checkbox"/> Check enclosed <u>or</u> <input type="checkbox"/> Fee Charged to customer account _____ (account name)	

Yes **Part 2 – Completed Instream Lease Application Map Checklist.**

Yes **Part 3 – Completed Water Right and Instream Use Information**
 Include a separate **Part 3** for **each water right**

Yes **Part 4 – Completed Instream Lease Provisions and Signatures**

Yes **How many water rights are leased? 14 List them here: 1907, 94746, 3340, 4004, 4607, 94769, 94748, 4712, 15177, 22668, 44245, 72199, 72611, 81986**

Include a separate **Part 3** for each **water right**.

Yes **N/A** **Other Water Rights**, if any, appurtenant to the lands involved in the lease application and not proposed to be leased instream?
List those other water rights here: 4103, 4494, 14128, 28855, 72610

Yes **No** Conservation Reserve Enhancement Program (**CREP**). Are some or all of the lands to be leased part of CREP or another Federal program (list here: _____)?

Attachments:

Yes **N/A** **Map:** Instream Lease map requirements (see Part 2 of this application)

Yes **N/A** **Tax Lot Map:** If a portion of the water right *not included in the lease* is appurtenant to lands owned by others, a tax lot map must be included with the lease application. The tax lot map should clearly show the property involved in the lease.

Yes **N/A** Supporting documentation describing why a right (or portion thereof) is valid and not subject to forfeiture even though the right has not been exercised for five or more consecutive years. This information only needs to be provided if the checkbox has been checked to identify that the water right has not been used in the last five years and is not subject to forfeiture (See Part 4 of 4).

Yes **N/A** If the Lessor (water right holder) is not the deeded landowner - provide one of the following.

- A notarized statement from the landowner consenting to the lease and a copy of the recorded deed; or
- A water right conveyance agreement and a copy of the recorded deed for the landowner at the time the water right was conveyed; or

Part 2 of 4 – Instream Lease Application Map Checklist

A Map is generally required for each water right not leased in its entirety

The application map (if required) should include all the items listed below and match the existing water right(s) of record. Check all boxes that apply.

This should be a simple map. (See example below). A copy of a final proof survey map with the portion to be leased shaded or hachured in will also suffice.

- N/A A map is required for each water right not leased in its entirety. More than one QQ and property may be included on each map. A map is not required, if leasing the entire right or if the right to be leased is for municipal or quasi-municipal water use.
- The map should be of sufficient quality to be reproducible. Please do not use highlighters to mark items on the map as highlighters do not always copy.
- A North arrow and map scale (no smaller than 1" = 1320').
- Township, Range, Section, quarter quarter (QQ), and a clearly labeled survey corner.
- For irrigation or other similar use, the number of acres to be leased in each quarter-quarter clearly labeled and hachured to differentiate between the acres being leased and any remaining. If the place of use is broken down by more than one priority date, or source stream, and/or point of diversion you must identify each with separate hachuring and clearly label.
- If available, identify the existing point(s) of diversion.

EXAMPLE MAP (the darker shaded portion representing the portion leased instream)

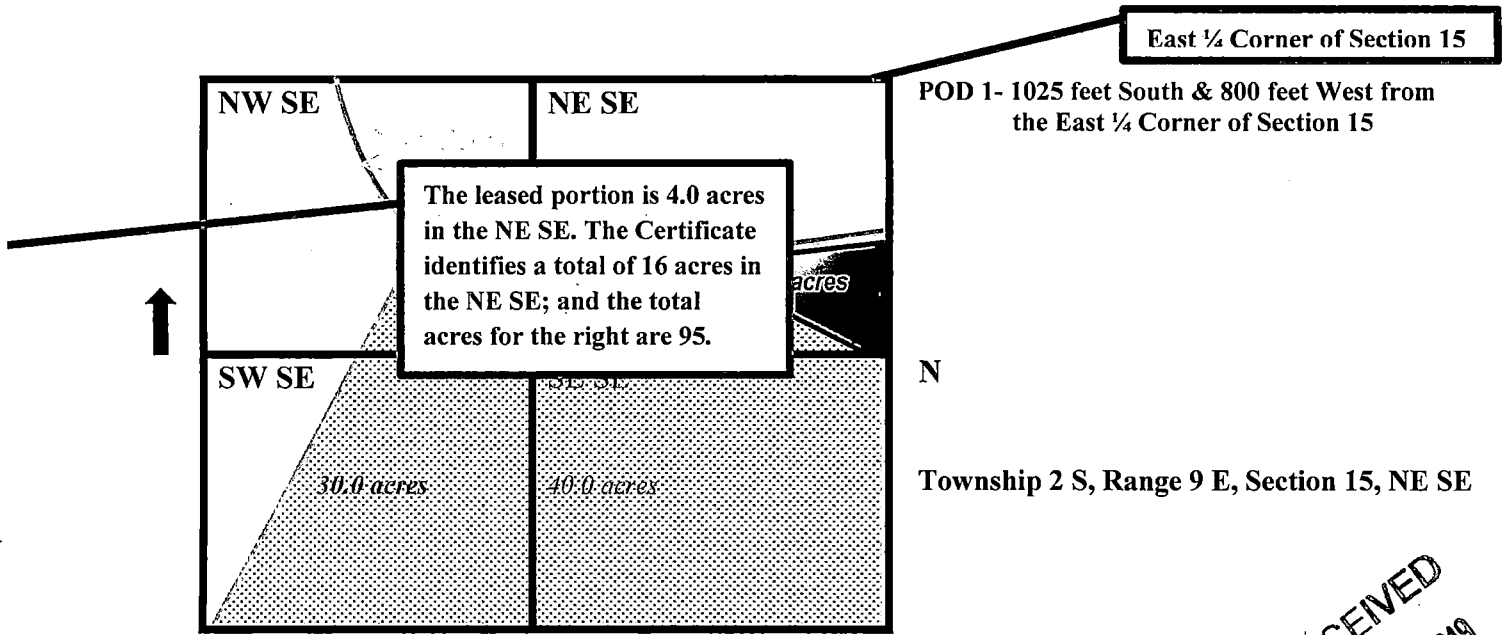

RECEIVED
OCT 29 2019
OWRD

Part 4 of 4 – Lease Provisions and Party Signatures

<p>Term of the Lease (may be from 1 year up to 5 years): The lease is requested to begin in: month 03 year 2020 and end: month 10 year 2024</p> <p>Note: The begin month is generally the first month of the irrigation season and the end month is the last month in the irrigation season. If not an irrigation right, this would be the first and last month of your authorized period of allowed use.</p>	
<p>Public use: Check the public use(s) this lease will serve (as defined by ORS 537.332):</p> <p><input checked="" type="checkbox"/> Conservation, maintenance and enhancement of aquatic, fish and wildlife, fish and wildlife habitat and any other ecological values.</p> <p><input type="checkbox"/> Recreation</p> <p><input type="checkbox"/> Pollution abatement</p> <p><input type="checkbox"/> Navigation</p>	<p>Termination provision (for multiyear leases): The parties to the lease request (choose one):</p> <p><input checked="" type="checkbox"/> a. The option of terminating the lease prior to expiration of the full term with written notice to the Department by the Lessor(s) and/or Lessee.</p> <p><input type="checkbox"/> b. The option of terminating the lease prior to expiration of the full term, with consent by all parties to the lease.</p> <p><input type="checkbox"/> c. The parties would not like to include a Termination Provision.</p> <p>(See instructions for limitations to this provision)</p>
<p>Additive/Replacing Relationship to other instream water rights: Instream leases are generally additive to other existing instream water rights created as a result of instream leases, transfers and/or allocations of conserved water. Since instream leases are also generally senior to other instream rights created through a state agency process or conversion of minimum flows, they generally replace a portion of these junior instream rights.</p> <p>If you would like this lease to relate to other instream water rights differently, please check this box. <input type="checkbox"/></p> <p>And attach an explanation of your intent.</p>	
<p>Validity of the Right(s) to be leased (check the appropriate box):</p> <p><input checked="" type="checkbox"/> The water right(s) to be leased have been used under the terms and conditions of the right(s) during the last five years or have been leased instream; or</p> <p><input checked="" type="checkbox"/> The water right(s) have not been used for the last five years according to the terms and conditions of the right(s). However, the water right(s) is not subject to forfeiture under ORS 540.610(2). Documentation describing why the water right(s) is not subject to forfeiture is provided. The water rights offered for lease to instream uses are included in or associated with pending application for transfer T-8828.</p>	

Precedent: If a right which has been leased is later proposed to be leased again or later transferred or become part of an allocation of conserved water project, a new injury review shall be required. An instream lease shall not set a precedent on a future transaction.

The undersigned declare:

1. The Lessor(s) agree during the term of this lease, to suspend use of water allowed under the subject water right(s) and under any appurtenant primary or supplemental water right(s) not involved in the lease application; and
 2. The Lessor(s) certify that I/we are the water right holder(s) of the right(s) described in this instream lease application. If not the deeded landowner, I/we have provided documentation with the lease application that I/we have authorization to pursue the lease application and/or have obtained consent from the deeded landowner; and
- _____ parties affirm that information provided in this lease application is true and accurate.

Received by
 NOV 08 2019
 SALEM OR

 Signature of Lessor

Date: _____

Printed name (and title): **Shaun Parkinson** Business name, if applicable: **Idaho Power Co.**

Mailing Address (with state and zip): **PO Box 70, Boise, ID 83707**

Phone number (include area code): **208-388-2200****E-mail address: **SParkinson@idahopower.com**

Part 4 of 4 – Lease Provisions and Party Signatures

<p>Term of the Lease (may be from 1 year up to 5 years): The lease is requested to begin in: month 03 year 2020 and end: month 10 year 2024 Note: The begin month is generally the first month of the irrigation season and the end month is the last month in the irrigation season. If not an irrigation right, this would be the first and last month of your authorized period of allowed use.</p>	
<p>Public use: Check the public use(s) this lease will serve (as defined by ORS 537.332):</p> <p><input checked="" type="checkbox"/> Conservation, maintenance and enhancement of aquatic, fish and wildlife, fish and wildlife habitat and any other ecological values.</p> <p><input type="checkbox"/> Recreation</p> <p><input type="checkbox"/> Pollution abatement</p> <p><input type="checkbox"/> Navigation</p>	<p>Termination provision (for multiyear leases): The parties to the lease request (choose one):</p> <p><input checked="" type="checkbox"/> a. The option of terminating the lease prior to expiration of the full term with written notice to the Department by the Lessor(s) and/or Lessee.</p> <p><input type="checkbox"/> b. The option of terminating the lease prior to expiration of the full term, with consent by all parties to the lease.</p> <p><input type="checkbox"/> c. The parties would not like to include a Termination Provision.</p> <p>(See instructions for limitations to this provision)</p>
<p>Additive/Replacing Relationship to other instream water rights: Instream leases are generally additive to other existing instream water rights created as a result of instream leases, transfers and/or allocations of conserved water. Since instream leases are also generally senior to other instream rights created through a state agency process or conversion of minimum flows, they generally replace a portion of these junior instream rights.</p> <p>If you would like this lease to relate to other instream water rights differently, please check this box. <input type="checkbox"/> And attach an explanation of your intent.</p>	
<p>Validity of the Right(s) to be leased (check the appropriate box):</p> <p><input type="checkbox"/> The water right(s) to be leased have been used under the terms and conditions of the right(s) during the last five years or have been leased instream; or</p> <p><input checked="" type="checkbox"/> The water right(s) have not been used for the last five years according to the terms and conditions of the right(s). However, the water right(s) is not subject to forfeiture under ORS 540.610(2). Documentation describing why the water right(s) is not subject to forfeiture is provided. The water rights offered for lease to instream uses are included in or associated with pending application for transfer T-8828.</p>	

Precedent: If a right which has been leased is later proposed to be leased again or later transferred or become part of an allocation of conserved water project, a new injury review shall be required. An instream lease shall not set a precedent on a future transaction.

The undersigned declare:

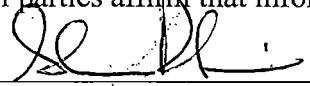

1. The Lessor(s) agree during the term of this lease, to suspend use of water allowed under the subject water right(s) and under any appurtenant primary or supplemental water right(s) not involved in the lease application; and
2. The Lessor(s) certify that I/we are the water right holder(s) of the right(s) described in this instream lease application. If not the deeded landowner, I/we have provided documentation with the lease application that I/we have authorization to pursue the lease application and/or have obtained consent from the deeded landowner; and
3. All parties affirm that information provided in this lease application is true and accurate.



 Signature of Lessor

Date: Oct 21, 2019

Printed name (and title): **Shaun Parkinson** Business name, if applicable: **Idaho Power Co.**
 Mailing Address (with state and zip): **PO Box 70, Boise, ID 83707**
 Phone number (include area code): **208-388-2200** *E-mail address: **SParkinson@idahopower.com**

See next page for additional signatures.

Signature of Co-Lessor Date: _____

Printed name (and title): _____
Business/organization name: _____
Mailing Address (with state and zip): _____
Phone number (include area code): _____ **E-mail address: _____

Signature of Lessee Date: _____

Printed name (and title): _____
Business/organization name: _____
Mailing Address (with state and zip): _____
Phone number (include area code): _____ **E-mail address: _____

**** BY PROVIDING AN E-MAIL ADDRESS, CONSENT IS GIVEN TO RECEIVE ALL CORRESPONDENCE FROM THE DEPARTMENT ELECTRONICALLY. COPIES OF THE FINAL ORDER DOCUMENTS WILL ALSO BE MAILED TO THE LESSOR.**

RECEIVED
OCT 29 2019
OWRD

Part 3 of 4 – Water Right and Instream Use Information

Use a separate Part 3 for each water right to be leased instream

Water Right Information

Water right # 1907

Table 1

Water Right Information: Provide a description of the originating water right to be leased. Also include your tax lot number(s). Fill in all applicable information. For example, if your water right has multiple points of diversion (POD) but they're not numbered, you do not need to include a number. If not enough room below, you may add additional rows (see instructions) or attach spreadsheet (matching Table 1). Please clearly label any attachments.

<input type="checkbox"/> If only leasing a portion of the right - complete Table 1 as indicated					<input checked="" type="checkbox"/> Entirety - If the entire water right is to be leased, skip to Table 3.					
Priority Date	POD #	Twp	Rng	Sec	Q-Q	Tax Lot	Gov't Lot/DLC	Acres	USE	Previous Lease # (if any)
EXAMPLE										
12/2/1901	3	2-S	9-E	15	NE SE	100	47	4.0	IR	IL-1100
		-	-		-					
		-	-		-					
		-	-		-					

Total Acres:

Table 2

To illustrate the totals for the water right proposed to be leased instream						
Total rate and volume by priority date, POD, use and acreage as appropriate considering the right to be leased. If not enough room below, you may add additional rows (see instructions) or attach spreadsheet (matching Table 2). Please clearly label any attachments. (cfs = cubic feet per second and af = acre-feet)						
Priority Date	POD #	Use	Total Acres	Other Information (such as conditions/limitations on the right)	Total Rate (cfs)	Total Volume (af)
Total af from storage, if applicable: _____ AF or N/A						
Any additional information about the right: _____						

Table 3

Point of Diversion (POD) description: If the POD is not described on the certificate or if there is more than one POD listed on the certificate, then **the specific POD(s)** involved in the lease must be described. If not enough room below, you may add additional rows (see instructions) or attach spreadsheet (matching Table 3). Please clearly label any attachments.

POD #	Twp	Rng	Sec	Q-Q	DLC/ Gov't lot	Measured Distances, latitude/longitude coordinates, or river mile (if unknown you may indicate "unknown")
	10-S	46-E	7	SW-NE		Unknown
	-	-		-		

Please check this box if you don't know the location of the POD(s) and want the Department to identify the location of the POD(s) for the purpose of the instream lease.

RECEIVED
OCT 29 2019

OWRD

Part 3 of 4 cont. – Water Right and Instream Use Information

Instream Use Information

Table 4

Instream Use Created by the Lease						
River/ Stream Name: <u>Daly Creek, tributary to Powder River</u>				River Basin: <u>Powder</u>		
<p>Instream Portion: Use Table 4 to illustrate the instream rate, volume and instream period by priority date, POD (if more than one), Use (if more than one), and acreage as appropriate considering the right to be leased.</p> <p>If not enough room below, you may add additional rows (see instructions) or attach a spreadsheet (matching the below portion of Table 4). Please clearly label any attachments.</p>						
Priority date	POD #	Use	Acres	Proposed Instream Period	Total instream rate (cfs)	Total instream volume (af)
6/10/1916		IR	27	3/1 – 10/31	0.17	81
<p>Note: If not certain of the instream rate, volume and/or instream period, see the instructions and/or contact Department Staff for assistance. The instream rate and volume may be up to the maximum rate and duty/volume allowed by the right, as described in Table 2 or on your Certificate if leasing the entire right. The proposed instream period may be no longer than the irrigation season or the authorized period of allowed use.</p>						
<p>OR <input type="checkbox"/> Please check this box if you are not sure of the proposed rate, volume and instream period. As part of its review process, the Department will identify the appropriate instream rate, volume and period considering the water right(s) being leased and instream benefits.</p>						
Instream Reach						
<p>Proposed Instream Reach: <input checked="" type="checkbox"/> A reach typically begins at the point of diversion (POD) and ends at the mouth of the source stream: From the POD to <u>Mouth</u></p>				<p>Or Proposed Instream Point: <input type="checkbox"/> Instream use protected at the POD</p>		
<p>OR <input type="checkbox"/> Please check this box if you are not sure of the proposed reach and want water to be protected within a reach below the POD, if possible. (If no reach is identified or the above box is not checked, and there is only one POD listed on the certificate, the lease may be processed to be protected at the POD.)</p>						
Additional Instream Information						
<p><input type="checkbox"/> Yes <input checked="" type="checkbox"/> N/A Conditions to avoid enlargement or injury to other water rights, if any, or other limitations: list here _____</p> <p>Note: The Department may identify additional conditions to prevent injury and/or enlargement.</p>						
<p>Any additional information about the proposed instream use: _____</p>						

RECEIVED
OCT 29 2019
OWRD

Part 3 of 4 – Water Right and Instream Use Information

Use a separate Part 3 for each water right to be leased instream

Water Right Information

Water right # ~~2750~~ 94746

Table 1

Water Right Information: Provide a description of the originating water right to be leased. Also include your tax lot number(s). Fill in all applicable information. For example, if your water right has multiple points of diversion (POD) but they're not numbered, you do not need to include a number. If not enough room below, you may add additional rows (see instructions) or attach spreadsheet (matching Table 1). Please clearly label any attachments.

<input type="checkbox"/> If only leasing a portion of the right - complete Table 1 as indicated					<input checked="" type="checkbox"/> Entirety - If the entire water right is to be leased, skip to Table 3.					
Priority Date	POD #	Twp	Rng	Sec	Q-Q	Tax Lot	Gov't Lot/DLC	Acres	USE	Previous Lease # (if any)
EXAMPLE										
12/2/1901	3	2-S	9-E	15	NE SE	100	47	4.0	IR	IL-1100
		-	-		-					
		-	-		-					
		-	-		-					

Total Acres:

Table 2

To illustrate the totals for the water right proposed to be leased instream						
Total rate and volume by priority date, POD, use and acreage as appropriate considering the right to be leased. If not enough room below, you may add additional rows (see instructions) or attach spreadsheet (matching Table 2). Please clearly label any attachments. (cfs = cubic feet per second and af = acre-feet)						
Priority Date	POD #	Use	Total Acres	Other Information (such as conditions/limitations on the right)	Total Rate (cfs)	Total Volume (af)
Total af from storage, if applicable: _____ AF or <input type="checkbox"/> N/A						
Any additional information about the right: _____						

Table 3

Point of Diversion (POD) description: If the POD is not described on the certificate or if there is more than one POD listed on the certificate, then **the specific POD(s)** involved in the lease must be described. If not enough room below, you may add additional rows (see instructions) or attach spreadsheet (matching Table 3). Please clearly label any attachments.

POD #	Twp	Rng	Sec	Q-Q	DLC/ Gov't lot	Measured Distances, latitude/longitude coordinates, or river mile (if unknown you may indicate "unknown")
	9-S	45-E	24	SW-SE		Unknown
	-	-		-		

Please check this box if you don't know the location of the POD(s) and want the Department to identify the location of the POD(s) for the purpose of the instream lease.

RECEIVED
OCT 29 2019

OWWRD

Part 3 of 4 cont. – Water Right and Instream Use Information

Instream Use Information

Table 4

Instream Use Created by the Lease						
River/ Stream Name: <u>Squaw Gulch</u> , tributary to <u>Powder River</u>				River Basin: <u>Powder</u>		
<p>Instream Portion: Use Table 4 to illustrate the instream rate, volume and instream period by priority date, POD (if more than one), Use (if more than one), and acreage as appropriate considering the right to be leased.</p> <p>If not enough room below, you may add additional rows (see instructions) or attach a spreadsheet (matching the below portion of Table 4). Please clearly label any attachments.</p>						
Priority date	POD #	Use	Acres	Proposed Instream Period	Total instream rate (cfs)	Total instream volume (af)
4/21/1915		IS	58.6	3/1 – 10/31	0.36	175.8
<p>Note: If not certain of the instream rate, volume and/or instream period, see the instructions and/or contact Department Staff for assistance. The instream rate and volume may be up to the maximum rate and duty/volume allowed by the right, as described in Table 2 or on your Certificate if leasing the entire right. The proposed instream period may be no longer than the irrigation season or the authorized period of allowed use.</p>						
<p>OR <input type="checkbox"/> Please check this box if you are not sure of the proposed rate, volume and instream period. As part of its review process, the Department will identify the appropriate instream rate, volume and period considering the water right(s) being leased and instream benefits.</p>						
Instream Reach						
<p>Proposed Instream Reach: <input checked="" type="checkbox"/> A reach typically begins at the point of diversion (POD) and ends at the mouth of the source stream: From the POD to <u>Mouth</u></p>				<p>Or Proposed Instream Point: <input type="checkbox"/> Instream use protected at the POD</p>		
<p>OR <input type="checkbox"/> Please check this box if you are not sure of the proposed reach and want water to be protected within a reach below the POD, if possible. (If no reach is identified or the above box is not checked, and there is only one POD listed on the certificate, the lease may be processed to be protected at the POD.)</p>						
Additional Instream Information						
<p><input type="checkbox"/> Yes <input checked="" type="checkbox"/> N/A Conditions to avoid enlargement or injury to other water rights, if any, or other limitations: list here _____</p> <p>Note: The Department may identify additional conditions to prevent injury and/or enlargement.</p>						
<p>Any additional information about the proposed instream use: _____</p>						

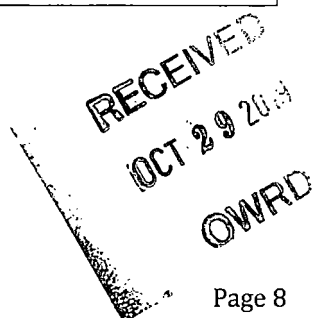

RECEIVED
 OCT 29 2014
 OWRD

Part 3 of 4 – Water Right and Instream Use Information

Use a separate Part 3 for each water right to be leased instream

Water Right Information

Water right # 3340

Table 1

Water Right Information: Provide a description of the originating water right to be leased. Also include your tax lot number(s). Fill in all applicable information. For example, if your water right has multiple points of diversion (POD) but they're not numbered, you do not need to include a number. If not enough room below, you may add additional rows (see instructions) or attach spreadsheet (matching Table 1). Please clearly label any attachments.

If only leasing a portion of the right - complete Table 1 as indicated **Entirety -** If the entire water right is to be leased, skip to Table 3.

Priority Date	POD #	Twp	Rng	Sec	Q-Q	Tax Lot	Gov't Lot/DLC	Acres	USE	Previous Lease # (if any)
EXAMPLE										
12/2/1901	3	2-S	9-E	15	NE SE	100	47	4.0	IR	IL-1100
		-	-		-					
		-	-		-					
		-	-		-					

Total Acres:

Table 2

To illustrate the totals for the water right proposed to be leased instream

Total rate and volume by priority date, POD, use and acreage as appropriate considering the right to be leased. If not enough room below, you may add additional rows (see instructions) or attach spreadsheet (matching Table 2). Please clearly label any attachments. (cfs = cubic feet per second and af = acre-feet)

Priority Date	POD #	Use	Total Acres	Other Information (such as conditions/limitations on the right)	Total Rate (cfs)	Total Volume (af)

Total af from storage, if applicable: _____ AF or N/A

Any additional information about the right: _____

Table 3

Point of Diversion (POD) description: If the POD is not described on the certificate or if there is more than one POD listed on the certificate, then **the specific POD(s)** involved in the lease must be described. If not enough room below, you may add additional rows (see instructions) or attach spreadsheet (matching Table 3). Please clearly label any attachments.

POD #	Twp	Rng	Sec	Q-Q	DLC/ Gov't lot	Measured Distances, latitude/longitude coordinates, or river mile (if unknown you may indicate "unknown")
	10-S	46-E	7	SW-NE		Unknown
	-	-		-		

Please check this box if you don't know the location of the POD(s) and want the Department to identify the location of the POD(s) for the purpose of the instream lease.

RECEIVED

OCT 29 2019

OWRD

Part 3 of 4 cont. – Water Right and Instream Use Information

Instream Use Information

Table 4

Instream Use Created by the Lease						
River/ Stream Name: <u>Daly Creek, tributary to Powder River</u>				River Basin: <u>Powder</u>		
<p>Instream Portion: Use Table 4 to illustrate the instream rate, volume and instream period by priority date, POD (if more than one), Use (if more than one), and acreage as appropriate considering the right to be leased.</p> <p>If not enough room below, you may add additional rows (see instructions) or attach a spreadsheet (matching the below portion of Table 4). Please clearly label any attachments.</p>						
Priority date	POD #	Use	Acres	Proposed Instream Period	Total instream rate (cfs)	Total instream volume (af)
9/16/2014		IR	13	3/1 – 10-31	0.08	39
<p>Note: If not certain of the instream rate, volume and/or instream period, see the instructions and/or contact Department Staff for assistance. The instream rate and volume may be up to the maximum rate and duty/volume allowed by the right, as described in Table 2 or on your Certificate if leasing the entire right. The proposed instream period may be no longer than the irrigation season or the authorized period of allowed use.</p>						
<p>OR <input type="checkbox"/> Please check this box if you are not sure of the proposed rate, volume and instream period. As part of its review process, the Department will identify the appropriate instream rate, volume and period considering the water right(s) being leased and instream benefits.</p>						
Instream Reach						
<p>Proposed Instream Reach: <input checked="" type="checkbox"/> A reach typically begins at the point of diversion (POD) and ends at the mouth of the source stream: From the POD to <u>Mouth</u></p>				<p>Or Proposed Instream Point: <input type="checkbox"/> Instream use protected at the POD</p>		
<p>OR <input type="checkbox"/> Please check this box if you are not sure of the proposed reach and want water to be protected within a reach below the POD, if possible. (If no reach is identified or the above box is not checked, and there is only one POD listed on the certificate, the lease may be processed to be protected at the POD.)</p>						
Additional Instream Information						
<p><input type="checkbox"/> Yes <input checked="" type="checkbox"/> N/A Conditions to avoid enlargement or injury to other water rights, if any, or other limitations: list here _____</p> <p>Note: The Department may identify additional conditions to prevent injury and/or enlargement.</p>						
<p>Any additional information about the proposed instream use: _____</p>						

RECEIVED
OCT 29 2018
OWRD

Part 3 of 4 – Water Right and Instream Use Information

Use a separate Part 3 for each water right to be leased instream

Water Right Information

Water right # **4004**

Table 1

Water Right Information: Provide a description of the originating water right to be leased. Also include your tax lot number(s). Fill in all applicable information. For example, if your water right has multiple points of diversion (POD) but they're not numbered, you do not need to include a number. If not enough room below, you may add additional rows (see instructions) or attach spreadsheet (matching Table 1). Please clearly label any attachments.

<input type="checkbox"/> If only leasing a portion of the right - complete Table 1 as indicated					<input checked="" type="checkbox"/> Entirety - If the entire water right is to be leased, skip to Table 3.					
Priority Date	POD #	Twp	Rng	Sec	Q-Q	Tax Lot	Gov't Lot/DLC	Acres	USE	Previous Lease # (if any)
EXAMPLE										
12/2/1901	3	2-S	9-E	15	NE SE	100	47	4.0	IR	IL-1100
		-	-		-					
		-	-		-					
		-	-		-					

Total Acres:

Table 2

To illustrate the totals for the water right proposed to be leased instream						
Total rate and volume by priority date, POD, use and acreage as appropriate considering the right to be leased. If not enough room below, you may add additional rows (see instructions) or attach spreadsheet (matching Table 2). Please clearly label any attachments. (cfs = cubic feet per second and af = acre-feet)						
Priority Date	POD #	Use	Total Acres	Other Information (such as conditions/limitations on the right)	Total Rate (cfs)	Total Volume (af)
Total af from storage, if applicable: _____ AF or <input type="checkbox"/> N/A						
Any additional information about the right: _____						

Table 3

Point of Diversion (POD) description: If the POD is not described on the certificate or if there is more than one POD listed on the certificate, then the specific POD(s) involved in the lease must be described. If not enough room below, you may add additional rows (see instructions) or attach spreadsheet (matching Table 3). Please clearly label any attachments.						
POD #	Twp	Rng	Sec	Q-Q	DLC/ Gov't lot	Measured Distances, latitude/longitude coordinates, or river mile (if unknown you may indicate "unknown")
	-	-		-		
<input checked="" type="checkbox"/> Please check this box if you don't know the location of the POD(s) and want the Department to identify the location of the POD(s) for the purpose of the instream lease.						

RECEIVED
OCT 29 2019
OWRD

Part 3 of 4 cont. – Water Right and Instream Use Information

Instream Use Information

Table 4

Instream Use Created by the Lease						
River/ Stream Name: <u>Powder River, tributary to Snake River</u>				River Basin: <u>Powder</u>		
<p>Instream Portion: Use Table 4 to illustrate the instream rate, volume and instream period by priority date, POD (if more than one), Use (if more than one), and acreage as appropriate considering the right to be leased.</p> <p>If not enough room below, you may add additional rows (see instructions) or attach a spreadsheet (matching the below portion of Table 4). Please clearly label any attachments.</p>						
Priority date	POD #	Use	Acres	Proposed Instream Period	Total instream rate (cfs)	Total instream volume (af)
1900		IR	10	3/1 – 10/31	0.06	30
<p>Note: If not certain of the instream rate, volume and/or instream period, see the instructions and/or contact Department Staff for assistance. The instream rate and volume may be up to the maximum rate and duty/volume allowed by the right, as described in Table 2 or on your Certificate if leasing the entire right. The proposed instream period may be no longer than the irrigation season or the authorized period of allowed use.</p>						
<p>OR <input type="checkbox"/> Please check this box if you are not sure of the proposed rate, volume and instream period. As part of its review process, the Department will identify the appropriate instream rate, volume and period considering the water right(s) being leased and instream benefits.</p>						
Instream Reach						
<p>Proposed Instream Reach: <input checked="" type="checkbox"/> A reach typically begins at the point of diversion (POD) and ends at the mouth of the source stream: From the POD to <u>Mouth</u></p>				<p>Or Proposed Instream Point: <input type="checkbox"/> Instream use protected at the POD</p>		
<p>OR <input type="checkbox"/> Please check this box if you are not sure of the proposed reach and want water to be protected within a reach below the POD, if possible. (If no reach is identified or the above box is not checked, and there is only one POD listed on the certificate, the lease may be processed to be protected at the POD.)</p>						
Additional Instream Information						
<p><input type="checkbox"/> Yes <input checked="" type="checkbox"/> N/A Conditions to avoid enlargement or injury to other water rights, if any, or other limitations: list here _____</p> <p>Note: The Department may identify additional conditions to prevent injury and/or enlargement.</p>						
<p>Any additional information about the proposed instream use: _____</p>						

RECEIVED
OCT 20 2019
OWRD

Part 3 of 4 – Water Right and Instream Use Information

Use a separate Part 3 for each water right to be leased instream

Water Right Information

Water right # 4607

Table 1

Water Right Information: Provide a description of the originating water right to be leased. Also include your tax lot number(s). Fill in all applicable information. For example, if your water right has multiple points of diversion (POD) but they're not numbered, you do not need to include a number. If not enough room below, you may add additional rows (see instructions) or attach spreadsheet (matching Table 1). Please clearly label any attachments.

<input type="checkbox"/> If only leasing a portion of the right - complete Table 1 as indicated					<input checked="" type="checkbox"/> Entirety - If the entire water right is to be leased, skip to Table 3.					
Priority Date	POD #	Twp	Rng	Sec	Q-Q	Tax Lot	Gov't Lot/DLC	Acres	USE	Previous Lease # (if any)
EXAMPLE										
12/2/1901	3	2-S	9-E	15	NE SE	100	47	4.0	IR	IL-1100
		-	-		-					
		-	-		-					
		-	-		-					
		-	-		-					

Total Acres:

Table 2

To illustrate the totals for the water right proposed to be leased instream

Total rate and volume by priority date, POD, use and acreage as appropriate considering the right to be leased. If not enough room below, you may add additional rows (see instructions) or attach spreadsheet (matching Table 2). Please clearly label any attachments. (cfs = cubic feet per second and af = acre-feet)

Priority Date	POD #	Use	Total Acres	Other Information (such as conditions/limitations on the right)	Total Rate (cfs)	Total Volume (af)

Total af from storage, if applicable: _____ AF or N/A

Any additional information about the right: _____

Table 3

Point of Diversion (POD) description: If the POD is not described on the certificate or if there is more than one POD listed on the certificate, then **the specific POD(s)** involved in the lease must be described. If not enough room below, you may add additional rows (see instructions) or attach spreadsheet (matching Table 3). Please clearly label any attachments.

POD #	Twp	Rng	Sec	Q-Q	DLC/ Gov't lot	Measured Distances, latitude/longitude coordinates, or river mile (if unknown you may indicate "unknown")
	9-S	45-E	10	SW-SE		Unknown
	-	-		-		

Please check this box if you don't know the location of the POD(s) and want the Department to identify the location of the POD(s) for the purpose of the instream lease.



RECEIVED
OCT 29 2019
QWRD

Part 3 of 4 cont. – Water Right and Instream Use Information

Instream Use Information

Table 4

Instream Use Created by the Lease						
River/ Stream Name: <u>Eagle Creek, tributary to Powder River</u>				River Basin: <u>Powder</u>		
<p>Instream Portion: Use Table 4 to illustrate the instream rate, volume and instream period by priority date, POD (if more than one), Use (if more than one), and acreage as appropriate considering the right to be leased.</p> <p>If not enough room below, you may add additional rows (see instructions) or attach a spreadsheet (matching the below portion of Table 4). Please clearly label any attachments.</p>						
Priority date	POD #	Use	Acres	Proposed Instream Period	Total instream rate (cfs)	Total instream volume (af)
1901		IR	6	3/1 – 10/31	0.04	18
<p>Note: If not certain of the instream rate, volume and/or instream period, see the instructions and/or contact Department Staff for assistance. The instream rate and volume may be up to the maximum rate and duty/volume allowed by the right, as described in Table 2 or on your Certificate if leasing the entire right. The proposed instream period may be no longer than the irrigation season or the authorized period of allowed use.</p>						
<p>OR <input type="checkbox"/> Please check this box if you are not sure of the proposed rate, volume and instream period. As part of its review process, the Department will identify the appropriate instream rate, volume and period considering the water right(s) being leased and instream benefits.</p>						
Instream Reach						
<p>Proposed Instream Reach: <input checked="" type="checkbox"/> A reach typically begins at the point of diversion (POD) and ends at the mouth of the source stream: From the POD to <u>Mouth</u></p>				<p>Or Proposed Instream Point: <input type="checkbox"/> Instream use protected at the POD</p>		
<p>OR <input type="checkbox"/> Please check this box if you are not sure of the proposed reach and want water to be protected within a reach below the POD, if possible. (If no reach is identified or the above box is not checked, and there is only one POD listed on the certificate, the lease may be processed to be protected at the POD.)</p>						
Additional Instream Information						
<p><input type="checkbox"/> Yes <input checked="" type="checkbox"/> N/A Conditions to avoid enlargement or injury to other water rights, if any, or other limitations: list here _____</p> <p>Note: The Department may identify additional conditions to prevent injury and/or enlargement.</p>						
<p>Any additional information about the proposed instream use: _____</p>						

 OCT 20 2019

 Page 14

Part 3 of 4 – Water Right and Instream Use Information

Use a separate Part 3 for each water right to be leased instream

Water Right Information

94769
Water right # ~~4611~~ 94747

Table 1

Water Right Information: Provide a description of the originating water right to be leased. Also include your tax lot number(s). Fill in all applicable information. For example, if your water right has multiple points of diversion (POD) but they're not numbered, you do not need to include a number. If not enough room below, you may add additional rows (see instructions) or attach spreadsheet (matching Table 1). Please clearly label any attachments.

If only leasing a portion of the right - complete Table 1 as indicated **Entirety** - If the entire water right is to be leased, skip to Table 3.

Priority Date	POD #	Twp	Rng	Sec	Q-Q	Tax Lot	Gov't Lot/DLC	Acres	USE	Previous Lease # (if any)
EXAMPLE										
12/2/1901	3	2-S	9-E	15	NE SE	100	47	4.0	IR	IL-1100
7/12/1900		9-S	46-E	30	SW-SE	4500		3.4	IR	
7/12/1900		9-S	46-E	30	SE-SW	4500		18.6	IR	
		-	-	-	-					

Total Acres: 22

Table 2

To illustrate the totals for the water right proposed to be leased instream						
Total rate and volume by priority date, POD, use and acreage as appropriate considering the right to be leased. If not enough room below, you may add additional rows (see instructions) or attach spreadsheet (matching Table 2). Please clearly label any attachments. (cfs = cubic feet per second and af = acre-feet)						
Priority Date	POD #	Use	Total Acres	Other Information (such as conditions/limitations on the right)	Total Rate (cfs)	Total Volume (af)
7/12/1900		IR	22	All of right under 1900 priority.	0.55	66
Total af from storage, if applicable: _____ AF or <input checked="" type="checkbox"/> N/A						
Any additional information about the right:						

Table 3

Point of Diversion (POD) description: If the POD is not described on the certificate or if there is more than one POD listed on the certificate, then **the specific POD(s)** involved in the lease must be described. If not enough room below, you may add additional rows (see instructions) or attach spreadsheet (matching Table 3). Please clearly label any attachments.

POD #	Twp	Rng	Sec	Q-Q	DLC/ Gov't lot	Measured Distances, latitude/longitude coordinates, or river mile (if unknown you may indicate "unknown")
	9-S	45-E	10	SW-SE		Unknown
	-	-	-	-		

Please check this box if you don't know the location of the POD(s) and want the Department to identify the location of the POD(s) for the purpose of the instream lease.

RECEIVED
OCT 29 2019
OWRD

Part 3 of 4 cont. – Water Right and Instream Use Information

Instream Use Information

Table 4

Instream Use Created by the Lease						
River/ Stream Name: <u>Eagle Creek, tributary to Powder River</u>				River Basin: <u>Powder</u>		
<p>Instream Portion: Use Table 4 to illustrate the instream rate, volume and instream period by priority date, POD (if more than one), Use (if more than one), and acreage as appropriate considering the right to be leased.</p> <p>If not enough room below, you may add additional rows (see instructions) or attach a spreadsheet (matching the below portion of Table 4). Please clearly label any attachments.</p>						
Priority date	POD #	Use	Acres	Proposed Instream Period	Total instream rate (cfs)	Total instream volume (af)
7/12/1900		IR	22	3/1 – 10/31	0.14	66
<p>Note: If not certain of the instream rate, volume and/or instream period, see the instructions and/or contact Department Staff for assistance. The instream rate and volume may be up to the maximum rate and duty/volume allowed by the right, as described in Table 2 or on your Certificate if leasing the entire right. The proposed instream period may be no longer than the irrigation season or the authorized period of allowed use.</p>						
<p>OR <input type="checkbox"/> Please check this box if you are not sure of the proposed rate, volume and instream period. As part of its review process, the Department will identify the appropriate instream rate, volume and period considering the water right(s) being leased and instream benefits.</p>						
Instream Reach						
<p>Proposed Instream Reach: <input checked="" type="checkbox"/> A reach typically begins at the point of diversion (POD) and ends at the mouth of the source stream: From the POD to <u>Mouth</u></p>				<p>Or Proposed Instream Point: <input type="checkbox"/> Instream use protected at the POD</p>		
<p>OR <input type="checkbox"/> Please check this box if you are not sure of the proposed reach and want water to be protected within a reach below the POD, if possible. (If no reach is identified or the above box is not checked, and there is only one POD listed on the certificate, the lease may be processed to be protected at the POD.)</p>						
Additional Instream Information						
<p><input type="checkbox"/> Yes <input checked="" type="checkbox"/> N/A Conditions to avoid enlargement or injury to other water rights, if any, or other limitations: list here _____</p> <p>Note: The Department may identify additional conditions to prevent injury and/or enlargement.</p>						
<p>Any additional information about the proposed instream use: <u>See attached map of portion of the right being leased.</u></p>						

RECEIVED
OCT 27

Certificate 4611 Partial Instream Lease

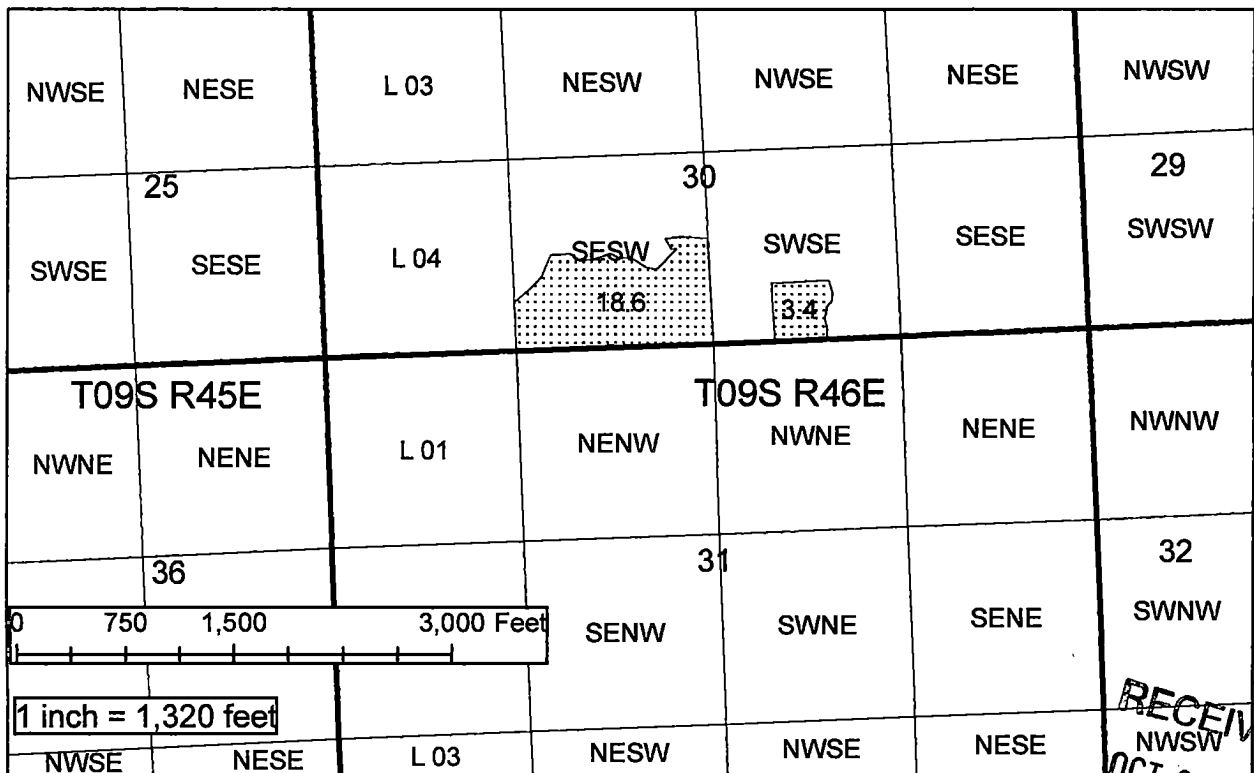
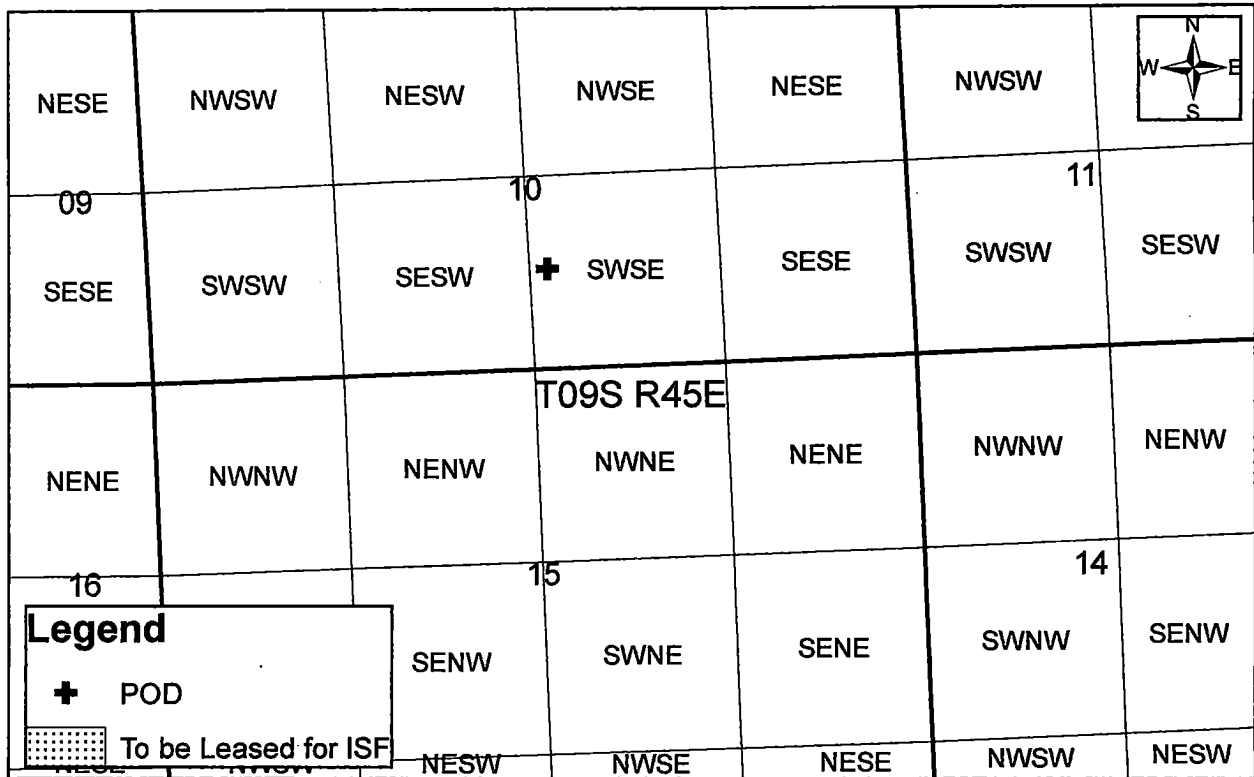

RECEIVED
 NWSW
 OCT 29 2019
 OWRD

Part 3 of 4 – Water Right and Instream Use Information

Use a separate Part 3 for each water right to be leased instream

Water Right Information

Water right # ~~4665~~ 94748

Table 1

Water Right Information: Provide a description of the originating water right to be leased. Also include your tax lot number(s). Fill in all applicable information. For example, if your water right has multiple points of diversion (POD) but they're not numbered, you do not need to include a number. If not enough room below, you may add additional rows (see instructions) or attach spreadsheet (matching Table 1). Please clearly label any attachments.

<input type="checkbox"/> If only leasing a portion of the right - complete Table 1 as indicated					<input checked="" type="checkbox"/> Entirety - If the entire water right is to be leased, skip to Table 3.					
Priority Date	POD #	Twp	Rng	Sec	Q-Q	Tax Lot	Gov't Lot/DLC	Acres	USE	Previous Lease # (if any)
EXAMPLE										
12/2/1901	3	2-S	9-E	15	NE SE	100	47	4.0	IR	IL-1100
		-	-		-					
		-	-		-					
		-	-		-					
		-	-		-					

Total Acres: 39.8

Table 2

To illustrate the totals for the water right proposed to be leased instream						
Total rate and volume by priority date, POD, use and acreage as appropriate considering the right to be leased. If not enough room below, you may add additional rows (see instructions) or attach spreadsheet (matching Table 2). Please clearly label any attachments. (cfs = cubic feet per second and af = acre-feet)						
Priority Date	POD #	Use	Total Acres	Other Information (such as conditions/limitations on the right)	Total Rate (cfs)	Total Volume (af)
Total af from storage, if applicable: _____ AF or <input type="checkbox"/> N/A						
Any additional information about the right: _____						

Table 3

Point of Diversion (POD) description: If the POD is not described on the certificate or if there is more than one POD listed on the certificate, then the specific POD(s) involved in the lease must be described. If not enough room below, you may add additional rows (see instructions) or attach spreadsheet (matching Table 3). Please clearly label any attachments.						
POD #	Twp	Rng	Sec	Q-Q	DLC/ Gov't lot	Measured Distances, latitude/longitude, and flow rates or river mile (if unknown you may indicate "unknown")
	8-S	45-E	33	SE-NW		Unknown
	-	-		-		
<input type="checkbox"/> Please check this box if you don't know the location of the POD(s) and want the Department to identify the location of the POD(s) for the purpose of the instream lease.						

RECEIVED
OCT 29 2019

OWRD

Part 3 of 4 cont. – Water Right and Instream Use Information

Instream Use Information

Table 4

Instream Use Created by the Lease						
River/ Stream Name: <u>Eagle Creek, tributary to Powder River</u>				River Basin: <u>Powder</u>		
<p>Instream Portion: Use Table 4 to illustrate the instream rate, volume and instream period by priority date, POD (if more than one), Use (if more than one), and acreage as appropriate considering the right to be leased.</p> <p>If not enough room below, you may add additional rows (see instructions) or attach a spreadsheet (matching the below portion of Table 4). Please clearly label any attachments.</p>						
Priority date	POD #	Use	Acres	Proposed Instream Period	Total instream rate (cfs)	Total instream volume (af)
1897		IR	3.5	3/1 – 10/31	0.02	10.5
1901		IR	12	3/1 – 10/31	0.08	36
1909		IR	24.3	3/1 – 10/31	0.15	72.9
<p>Note: If not certain of the instream rate, volume and/or instream period, see the instructions and/or contact Department Staff for assistance. The instream rate and volume may be up to the maximum rate and duty/volume allowed by the right, as described in Table 2 or on your Certificate if leasing the entire right. The proposed instream period may be no longer than the irrigation season or the authorized period of allowed use.</p>						
<p>OR <input type="checkbox"/> Please check this box if you are not sure of the proposed rate, volume and instream period. As part of its review process, the Department will identify the appropriate instream rate, volume and period considering the water right(s) being leased and instream benefits.</p>						
Instream Reach						
<p>Proposed Instream Reach: <input checked="" type="checkbox"/> A reach typically begins at the point of diversion (POD) and ends at the mouth of the source stream: From the POD to <u>Mouth</u></p>				<p>Or Proposed Instream Point: <input type="checkbox"/> Instream use protected at the POD</p>		
<p>OR <input type="checkbox"/> Please check this box if you are not sure of the proposed reach and want water to be protected within a reach below the POD, if possible. (If no reach is identified or the above box is not checked, and there is only one POD listed on the certificate, the lease may be processed to be protected at the POD.)</p>						
Additional Instream Information						
<p><input type="checkbox"/> Yes <input checked="" type="checkbox"/> N/A Conditions to avoid enlargement or injury to other water rights, if any, or other limitations: list here _____</p> <p>Note: The Department may identify additional conditions to prevent injury and/or enlargement.</p>						
<p>Any additional information about the proposed instream use: _____</p>						

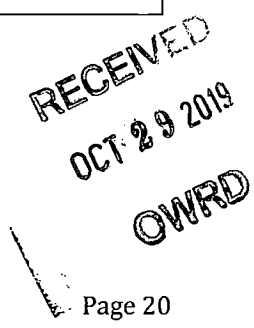

Part 3 of 4 – Water Right and Instream Use Information

Use a separate Part 3 for each water right to be leased instream

Water Right Information

Water right # 4712

Table 1

Water Right Information: Provide a description of the originating water right to be leased. Also include your tax lot number(s). Fill in all applicable information. For example, if your water right has multiple points of diversion (POD) but they're not numbered, you do not need to include a number. If not enough room below, you may add additional rows (see instructions) or attach spreadsheet (matching Table 1). Please clearly label any attachments.

<input type="checkbox"/> If only leasing a portion of the right - complete Table 1 as indicated					<input checked="" type="checkbox"/> Entirety - If the entire water right is to be leased, skip to Table 3.					
Priority Date	POD #	Twp	Rng	Sec	Q-Q	Tax Lot	Gov't Lot/DLC	Acres	USE	Previous Lease # (if any)
EXAMPLE										
12/2/1901	3	2-S	9-E	15	NE-SE	100	47	4.0	IR	IL-1100
		-	-		-					
		-	-		-					
		-	-		-					
		-	-		-					

Total Acres: _____

Table 2

To illustrate the totals for the water right proposed to be leased instream						
Total rate and volume by priority date, POD, use and acreage as appropriate considering the right to be leased. If not enough room below, you may add additional rows (see instructions) or attach spreadsheet (matching Table 2). Please clearly label any attachments. (cfs = cubic feet per second and af = acre-feet)						
Priority Date	POD #	Use	Total Acres	Other Information (such as conditions/limitations on the right)	Total Rate (cfs)	Total Volume (af)
Total af from storage, if applicable: _____ AF or <input type="checkbox"/> N/A						
Any additional information about the right: _____						

Table 3

Point of Diversion (POD) description: If the POD is not described on the certificate or if there is more than one POD listed on the certificate, then **the specific POD(s)** involved in the lease must be described. If not enough room below, you may add additional rows (see instructions) or attach spreadsheet (matching Table 3). Please clearly label any attachments.

POD #	Twp	Rng	Sec	Q-Q	DLC/ Gov't lot	Measured Distances, latitude/longitude coordinates, or river mile (if unknown you may indicate "unknown")
	9-S	45-E	10	SW-SE		Unknown
	-	-		-		

Please check this box if you don't know the location of the POD(s) and want the Department to identify the location of the POD(s) for the purpose of the instream lease.

RECEIVED
OCT 29 2019
DWRD

Part 3 of 4 cont. – Water Right and Instream Use Information

Instream Use Information

Table 4

Instream Use Created by the Lease						
River/ Stream Name: <u>Eagle Creek, tributary to Powder River</u>				River Basin: <u>Powder</u>		
<p>Instream Portion: Use Table 4 to illustrate the instream rate, volume and instream period by priority date, POD (if more than one), Use (if more than one), and acreage as appropriate considering the right to be leased.</p> <p>If not enough room below, you may add additional rows (see instructions) or attach a spreadsheet (matching the below portion of Table 4). Please clearly label any attachments.</p>						
Priority date	POD #	Use	Acres	Proposed Instream Period	Total instream rate (cfs)	Total instream volume (af)
1904		IR	10	3/1 – 10/31	0.06	30
<p>Note: If not certain of the instream rate, volume and/or instream period, see the instructions and/or contact Department Staff for assistance. The instream rate and volume may be up to the maximum rate and duty/volume allowed by the right, as described in Table 2 or on your Certificate if leasing the entire right. The proposed instream period may be no longer than the irrigation season or the authorized period of allowed use.</p>						
<p>OR <input type="checkbox"/> Please check this box if you are not sure of the proposed rate, volume and instream period. As part of its review process, the Department will identify the appropriate instream rate, volume and period considering the water right(s) being leased and instream benefits.</p>						
Instream Reach						
<p>Proposed Instream Reach: <input checked="" type="checkbox"/> A reach typically begins at the point of diversion (POD) and ends at the mouth of the source stream: From the POD to <u>Mouth</u></p>				<p>Or Proposed Instream Point: <input type="checkbox"/> Instream use protected at the POD</p>		
<p>OR <input type="checkbox"/> Please check this box if you are not sure of the proposed reach and want water to be protected within a reach below the POD, if possible. (If no reach is identified or the above box is not checked, and there is only one POD listed on the certificate, the lease may be processed to be protected at the POD.)</p>						
Additional Instream Information						
<p><input type="checkbox"/> Yes <input checked="" type="checkbox"/> N/A Conditions to avoid enlargement or injury to other water rights, if any, or other limitations: list here _____</p> <p>Note: The Department may identify additional conditions to prevent injury and/or enlargement.</p>						
<p>Any additional information about the proposed instream use: _____</p>						

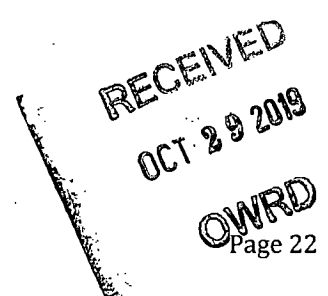

RECEIVED
 OCT 29 2019
 OWRD
 Page 22

Part 3 of 4 – Water Right and Instream Use Information

Use a separate Part 3 for each water right to be leased instream

Water Right Information

Water right # 15177

Table 1

Water Right Information: Provide a description of the originating water right to be leased. Also include your tax lot number(s). Fill in all applicable information. For example, if your water right has multiple points of diversion (POD) but they're not numbered, you do not need to include a number. If not enough room below, you may add additional rows (see instructions) or attach spreadsheet (matching Table 1). Please clearly label any attachments.

<input type="checkbox"/> If only leasing a portion of the right - complete Table 1 as indicated					<input checked="" type="checkbox"/> Entirety - If the entire water right is to be leased, skip to Table 3.					
Priority Date	POD #	Twp	Rng	Sec	Q-Q	Tax Lot	Gov't Lot/DLC	Acres	USE	Previous Lease # (if any)
EXAMPLE										
12/2/1901	3	2-S	9-E	15	NE SE	100	47	4.0	IR	IL-1100
		-	-		-					
		-	-		-					
		-	-		-					
		-	-		-					

Total Acres: _____

Table 2

To illustrate the totals for the water right proposed to be leased instream						
Total rate and volume by priority date, POD, use and acreage as appropriate considering the right to be leased. If not enough room below, you may add additional rows (see instructions) or attach spreadsheet (matching Table 2). Please clearly label any attachments. (cfs = cubic feet per second and af = acre-feet)						
Priority Date	POD #	Use	Total Acres	Other Information (such as conditions/limitations on the right)	Total Rate (cfs)	Total Volume (af)
Total af from storage, if applicable: _____ AF or <input type="checkbox"/> N/A						
Any additional information about the right: _____						

Table 3

Point of Diversion (POD) description: If the POD is not described on the certificate or if there is more than one POD listed on the certificate, then **the specific POD(s)** involved in the lease must be described. If not enough room below, you may add additional rows (see instructions) or attach spreadsheet (matching Table 3). Please clearly label any attachments.

POD #	Twp	Rng	Sec	Q-Q	DLC/ Gov't lot	Measured Distances, latitude/longitude coordinates, or river mile (if unknown you may indicate "unknown")
	10-S	46-E	7	SW-NE		Unknown
	-	-		-		

Please check this box if you don't know the location of the POD(s) and want the Department to identify the location of the POD(s) for the purpose of the instream lease.



RECEIVED
OCT 29 2019
OWRD

Part 3 of 4 cont. – Water Right and Instream Use Information

Instream Use Information

Table 4

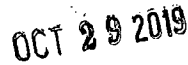
Instream Use Created by the Lease						
River/ Stream Name: <u>Daly Creek, tributary to Powder River</u>				River Basin: <u>Powder</u>		
<p>Instream Portion: Use Table 4 to illustrate the instream rate, volume and instream period by priority date, POD (if more than one), Use (if more than one), and acreage as appropriate considering the right to be leased.</p> <p>If not enough room below, you may add additional rows (see instructions) or attach a spreadsheet (matching the below portion of Table 4). Please clearly label any attachments.</p>						
Priority date	POD #	Use	Acres	Proposed Instream Period	Total instream rate (cfs)	Total instream volume (af)
1908		IR	129.8	3/1 – 10/31	0.80	389.4
<p>Note: If not certain of the instream rate, volume and/or instream period, see the instructions and/or contact Department Staff for assistance. The instream rate and volume may be up to the maximum rate and duty/volume allowed by the right, as described in Table 2 or on your Certificate if leasing the entire right. The proposed instream period may be no longer than the irrigation season or the authorized period of allowed use.</p>						
<p>OR <input type="checkbox"/> Please check this box if you are not sure of the proposed rate, volume and instream period. As part of its review process, the Department will identify the appropriate instream rate, volume and period considering the water right(s) being leased and instream benefits.</p>						
Instream Reach						
<p>Proposed Instream Reach:</p> <p><input checked="" type="checkbox"/> A reach typically begins at the point of diversion (POD) and ends at the mouth of the source stream: From the POD to <u>Mouth</u></p>				<p>Or Proposed Instream Point:</p> <p><input type="checkbox"/> Instream use protected at the POD</p>		
<p>OR <input type="checkbox"/> Please check this box if you are not sure of the proposed reach and want water to be protected within a reach below the POD, if possible. (If no reach is identified or the above box is not checked, and there is only one POD listed on the certificate, the lease may be processed to be protected at the POD.)</p>						
Additional Instream Information						
<p><input type="checkbox"/> Yes <input checked="" type="checkbox"/> N/A Conditions to avoid enlargement or injury to other water rights, if any, or other limitations: list here _____</p> <p>Note: The Department may identify additional conditions to prevent injury and/or enlargement.</p>						
<p>Any additional information about the proposed instream use: _____</p>						



 Page 24

Part 3 of 4 – Water Right and Instream Use Information

Use a separate Part 3 for each water right to be leased instream

Water Right Information

Water right # 22668

Table 1

Water Right Information: Provide a description of the originating water right to be leased. Also include your tax lot number(s). Fill in all applicable information. For example, if your water right has multiple points of diversion (POD) but they're not numbered, you do not need to include a number. If not enough room below, you may add additional rows (see instructions) or attach spreadsheet (matching Table 1). Please clearly label any attachments.

<input type="checkbox"/> If only leasing a portion of the right - complete Table 1 as indicated					<input checked="" type="checkbox"/> Entirety - If the entire water right is to be leased, skip to Table 3.					
Priority Date	POD #	Twp	Rng	Sec	Q-Q	Tax Lot	Gov't Lot/DLC	Acres	USE	Previous Lease # (if any)
EXAMPLE										
12/2/1901	3	2-S	9-E	15	NE-SE	100	47	4.0	IR	IL-1100
		-	-		-					
		-	-		-					

Total Acres: _____

Table 2

To illustrate the totals for the water right proposed to be leased instream						
Total rate and volume by priority date, POD, use and acreage as appropriate considering the right to be leased. If not enough room below, you may add additional rows (see instructions) or attach spreadsheet (matching Table 2). Please clearly label any attachments. (cfs = cubic feet per second and af = acre-feet)						
Priority Date	POD #	Use	Total Acres	Other Information (such as conditions/limitations on the right)		Total Rate (cfs)
Total af from storage, if applicable: _____ AF or <input type="checkbox"/> N/A						
Any additional information about the right: _____						

Table 3

Point of Diversion (POD) description: If the POD is not described on the certificate or if there is more than one POD listed on the certificate, then **the specific POD(s)** involved in the lease must be described. If not enough room below, you may add additional rows (see instructions) or attach spreadsheet (matching Table 3). Please clearly label any attachments.

POD #	Twp	Rng	Sec	Q-Q	DLC/ Gov't	Measured Distances, latitude/longitude coordinates, or river mile (if unknown you may indicate "unknown")
1	9-S	45-E	35	NE-SE		Unknown
2	-	-		SE-SE		Unknown
3	10-S	45-E	1	NW-SW		Unknown

Please check this box if you don't know the location of the POD(s) and want the Department to identify the location of the POD(s) for the purpose of the instream lease.

RECEIVED

OCT 20 2019

OWBD

Instream Use Information

Table 4

Instream Use Created by the Lease						
River/ Stream Name: <u>Squaw Creek, tributary to Powder River</u>				River Basin: <u>Powder</u>		
Cherry Gulch aka Cherry Spring Creek, tributary to Powder River						
<p>Instream Portion: Use Table 4 to illustrate the instream rate, volume and instream period by priority date, POD (if more than one), Use (if more than one), and acreage as appropriate considering the right to be leased.</p> <p>If not enough room below, you may add additional rows (see instructions) or attach a spreadsheet (matching the below portion of Table 4). Please clearly label any attachments.</p>						
Priority date	POD #	Use	Acres	Proposed Instream Period	Total instream rate (cfs)	Total instream volume (af)
10-18-1949	3	IR	17.6	3/1 – 10/31	0.13	61.6
3-23-1950	2	IR	3.5	3/1 – 10/31	0.03	12.25
<p>Note: If not certain of the instream rate, volume and/or instream period, see the instructions and/or contact Department Staff for assistance. The instream rate and volume may be up to the maximum rate and duty/volume allowed by the right, as described in Table 2 or on your Certificate if leasing the entire right. The proposed instream period may be no longer than the irrigation season or the authorized period of allowed use.</p>						
<p>OR <input type="checkbox"/> Please check this box if you are not sure of the proposed rate, volume and instream period. As part of its review process, the Department will identify the appropriate instream rate, volume and period considering the water right(s) being leased and instream benefits.</p>						
Instream Reach						
<p>Proposed Instream Reach: <input checked="" type="checkbox"/> A reach typically begins at the point of diversion (POD) and ends at the mouth of the source stream: From the POD to <u>Mouth</u></p>				<p>Or Proposed Instream Point: <input type="checkbox"/> Instream use protected at the POD</p>		
<p>OR <input type="checkbox"/> Please check this box if you are not sure of the proposed reach and want water to be protected within a reach below the POD, if possible. (If no reach is identified or the above box is not checked, and there is only one POD listed on the certificate, the lease may be processed to be protected at the POD.)</p>						
Additional Instream Information						
<p><input type="checkbox"/> Yes <input checked="" type="checkbox"/> N/A Conditions to avoid enlargement or injury to other water rights, if any, or other limitations: list here _____</p> <p>Note: The Department may identify additional conditions to prevent injury and/or enlargement.</p>						
<p>Any additional information about the proposed instream use: _____</p>						

RECEIVED
 OCT 29 2017
 QW

Part 3 of 4 – Water Right and Instream Use Information

Use a separate Part 3 for each water right to be leased instream

Water Right Information

Water right # 44245

Table 1

Water Right Information: Provide a description of the originating water right to be leased. Also include your tax lot number(s). Fill in all applicable information. For example, if your water right has multiple points of diversion (POD) but they're not numbered, you do not need to include a number. If not enough room below, you may add additional rows (see instructions) or attach spreadsheet (matching Table 1). Please clearly label any attachments.

<input type="checkbox"/> If only leasing a portion of the right - complete Table 1 as indicated					<input checked="" type="checkbox"/> Entirety - If the entire water right is to be leased, skip to Table 3.					
Priority Date	POD #	Twp	Rng	Sec	Q-Q	Tax Lot	Gov't Lot/DLC	Acres	USE	Previous Lease # (if any)
EXAMPLE										
12/2/1901	3	2-S	9-E	15	NE SE	100	47	4.0	IR	IL-1100
		-	-		-					
		-	-		-					
		-	-		-					
		-	-		-					

Total Acres: _____

Table 2

To illustrate the totals for the water right proposed to be leased instream						
Total rate and volume by priority date, POD, use and acreage as appropriate considering the right to be leased. If not enough room below, you may add additional rows (see instructions) or attach spreadsheet (matching Table 2). Please clearly label any attachments. (cfs = cubic feet per second and af = acre-feet)						
Priority Date	POD #	Use	Total Acres	Other Information (such as conditions/limitations on the right)	Total Rate (cfs)	Total Volume (af)
Total af from storage, if applicable: _____ AF or <input type="checkbox"/> N/A						
Any additional information about the right: _____						

Table 3

Point of Diversion (POD) description: If the POD is not described on the certificate or if there is more than one POD listed on the certificate, then the specific POD(s) involved in the lease must be described. If not enough room below, you may add additional rows (see instructions) or attach spreadsheet (matching Table 3). Please clearly label any attachments.						
POD #	Twp	Rng	Sec	Q-Q	DLC/ Gov't lot	Measured Distances, latitude/longitude coordinates, or river mile (if unknown you may indicate "unknown")
	-	-		-		
	-	-		-		
<input checked="" type="checkbox"/> Please check this box if you don't know the location of the POD(s) and want the Department to identify the location of the POD(s) for the purpose of the instream lease.						

RECEIVED
OCT 29 2019

OWTPD

Part 3 of 4 cont. – Water Right and Instream Use Information

Instream Use Information

Table 4

Instream Use Created by the Lease						
River/ Stream Name: <u>Powder River, tributary to Snake River</u>				River Basin: <u>Powder</u>		
<p>Instream Portion: Use Table 4 to illustrate the instream rate, volume and instream period by priority date, POD (if more than one), Use (if more than one), and acreage as appropriate considering the right to be leased.</p> <p>If not enough room below, you may add additional rows (see instructions) or attach a spreadsheet (matching the below portion of Table 4). Please clearly label any attachments.</p>						
Priority date	POD #	Use	Acres	Proposed Instream Period	Total instream rate (cfs)	Total instream volume (af)
1900		IR	27	3/1 – 10/31	0.17	81
<p>Note: If not certain of the instream rate, volume and/or instream period, see the instructions and/or contact Department Staff for assistance. The instream rate and volume may be up to the maximum rate and duty/volume allowed by the right, as described in Table 2 or on your Certificate if leasing the entire right. The proposed instream period may be no longer than the irrigation season or the authorized period of allowed use.</p>						
<p>OR <input type="checkbox"/> Please check this box if you are not sure of the proposed rate, volume and instream period. As part of its review process, the Department will identify the appropriate instream rate, volume and period considering the water right(s) being leased and instream benefits.</p>						
Instream Reach						
<p>Proposed Instream Reach: <input checked="" type="checkbox"/> A reach typically begins at the point of diversion (POD) and ends at the mouth of the source stream: From the POD to <u>Mouth</u></p>				<p>Or Proposed Instream Point: <input type="checkbox"/> Instream use protected at the POD</p>		
<p>OR <input type="checkbox"/> Please check this box if you are not sure of the proposed reach and want water to be protected within a reach below the POD, if possible. (If no reach is identified or the above box is not checked, and there is only one POD listed on the certificate, the lease may be processed to be protected at the POD.)</p>						
Additional Instream Information						
<p><input type="checkbox"/> Yes <input checked="" type="checkbox"/> N/A Conditions to avoid enlargement or injury to other water rights, if any, or other limitations: list here _____</p> <p>Note: The Department may identify additional conditions to prevent injury and/or enlargement.</p>						
<p>Any additional information about the proposed instream use: _____</p>						

RECEIVED
OCT 29 2019
OWRD

Part 3 of 4 – Water Right and Instream Use Information

Use a separate Part 3 for each water right to be leased instream

Water Right Information

Water right # 72199

Table 1

Water Right Information: Provide a description of the originating water right to be leased. Also include your tax lot number(s). Fill in all applicable information. For example, if your water right has multiple points of diversion (POD) but they're not numbered, you do not need to include a number. If not enough room below, you may add additional rows (see instructions) or attach spreadsheet (matching Table 1). Please clearly label any attachments.

<input checked="" type="checkbox"/> If only leasing a portion of the right - complete Table 1 as indicated	<input type="checkbox"/> Entirety - If the entire water right is to be leased, skip to Table 3.
---	--

Priority Date	POD #	Twp	Rng	Sec	Q-Q	Tax Lot	Gov't Lot/DLC	Acres	USE	Previous Lease # (if any)
EXAMPLE										
12/2/1901	3	2-S	9-E	15	NE SE	100	47	4.0	IR	IL-1100
7/12/1901		9-S	45-E	36	SE-NE	6100		30	IR	
					NW-NE	6100		5.1	IR	
		-	-		NE-NW	6100		16.5	IR	
		-	-		NW-NW	6100		10	IR	
		-	-		SW-NW	6100		36.5	IR	
					SE-NW	6100		25.5	IR	
					NW-SW	6100		4.5	IR	
			46-E	30	NW-SE	4500		6.3	IR	
					SW-SE	4500		8.2	IR	
				31	NW-NE	4500		9	IR	
					NE-NW	4500		19	IR	
		-	-		NW-NW	4500	1	28	IR	

Total Acres: 198.6

Table 2

To illustrate the totals for the water right proposed to be leased instream

Total rate and volume by priority date, POD, use and acreage as appropriate considering the right to be leased. If not enough room below, you may add additional rows (see instructions) or attach spreadsheet (matching Table 2). Please clearly label any attachments. (cfs = cubic feet per second and af = acre-feet)

Priority Date	POD #	Use	Total Acres	Other Information (such as conditions/limitations on the right)	Total Rate (cfs)	Total Volume (af)
7/12/1901	Daly	IR	198.6	Both PODs deliver to the same acres and	4.96	595.8
7/12/1901	Eagle	IR		The diversion rate is shared by the PODs		

Total af from storage, if applicable: _____ AF or N/A

Any additional information about the right: This is a single water right with 2 sources that share the diversion rate and acres. This water right is for 264 acres, 65.4 acres will continue to be used for irrigation and 198.6 acres will be leased for instream purposes.

RECEIVED
OCT 29 2019
OWRD

Table 3

Point of Diversion (POD) description: If the POD is not described on the certificate or if there is more than one POD listed on the certificate, then **the specific POD(s)** involved in the lease must be described. If not enough room below, you may add additional rows (see instructions) or attach spreadsheet (matching Table 3). Please clearly label any attachments.

POD #	Twp	Rng	Sec	Q-Q	DLC/ Gov't lot	Measured Distances, latitude/longitude coordinates, or river mile (if unknown you may indicate "unknown")
Daly	10-S	46-E	6	NE-SW		Unknown
Eagle	9-S	45-E	10	SW-SE		Unknown

Please check this box if you don't know the location of the POD(s) and want the Department to identify the location of the POD(s) for the purpose of the instream lease.

Part 3 of 4 cont. – Water Right and Instream Use Information

Instream Use Information

Table 4

Instream Use Created by the Lease						
River/ Stream Name: <u>Daly Creek</u> , tributary to <u>Powder River</u> <u>Eagle Creek</u> tributary to <u>Powder River</u>				River Basin: <u>Powder</u>		
Instream Portion: Use Table 4 to illustrate the instream rate, volume and instream period by priority date, POD (if more than one), Use (if more than one), and acreage as appropriate considering the right to be leased. If not enough room below, you may add additional rows (see instructions) or attach a spreadsheet (matching the below portion of Table 4). Please clearly label any attachments.						
Priority date	POD #	Use	Acres	Proposed Instream Period	Total instream rate (cfs)	Total instream volume (af)
7/12/1901	Daly	IR	198.6	3/1 – 10/31	1.23	595.8
7/12/1901	Eagle	IR	Shared	3/1 – 10/31	Shared	Shared
Note: If not certain of the instream rate, volume and/or instream period, see the instructions and/or contact Department Staff for assistance. The instream rate and volume may be up to the maximum rate and duty/volume allowed by the right, as described in Table 2 or on your Certificate if leasing the entire right. The proposed instream period may be no longer than the irrigation season or the authorized period of allowed use.						
OR <input type="checkbox"/> Please check this box if you are not sure of the proposed rate, volume and instream period. As part of its review process, the Department will identify the appropriate instream rate, volume and period considering the water right(s) being leased and instream benefits.						
Instream Reach						
Proposed Instream Reach: <input checked="" type="checkbox"/> A reach typically begins at the point of diversion (POD) and ends at the mouth of the source stream: From the POD to <u>Mouth</u>				Or Proposed Instream Point: <input type="checkbox"/> Instream use protected at the POD		
OR <input type="checkbox"/> Please check this box if you are not sure of the proposed reach and want water to be protected within a reach below the POD, if possible. (If no reach is identified or the above box is not checked, and there is only one POD listed on the certificate, the lease may be processed to be protected at the POD.)						
Additional Instream Information						

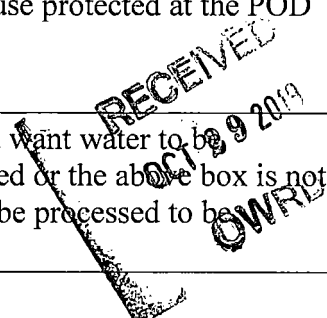

Yes N/A **Conditions to avoid enlargement or injury to other water rights, if any, or other limitations:** list here This water right has 2 points of diversion from 2 different sources that share the diversion rate and water volume between the 2 sources.

Note: The Department may identify additional conditions to prevent injury and/or enlargement.

Any additional information about the proposed instream use: _____

RECEIVED

OCT 29 2019

OWRD

Part 3 of 4 – Water Right and Instream Use Information

Use a separate Part 3 for each water right to be leased instream

Water Right Information

Water right # 72611

Table 1

Water Right Information: Provide a description of the originating water right to be leased. Also include your tax lot number(s). Fill in all applicable information. For example, if your water right has multiple points of diversion (POD) but they're not numbered, you do not need to include a number. If not enough room below, you may add additional rows (see instructions) or attach spreadsheet (matching Table 1). Please clearly label any attachments.

<input type="checkbox"/> If only leasing a portion of the right - complete Table 1 as indicated					<input checked="" type="checkbox"/> Entirety - If the entire water right is to be leased, skip to Table 3.					
Priority Date	POD #	Twp	Rng	Sec	Q-Q	Tax Lot	Gov't Lot/DLC	Acres	USE	Previous Lease # (if any)
EXAMPLE										
12/2/1901	3	2-S	9-E	15	NE SE	100	47	4.0	IR	IL-1100
		-	-		-					
		-	-		-					
		-	-		-					

Total Acres: _____

Table 2

To illustrate the totals for the water right proposed to be leased instream						
Total rate and volume by priority date, POD, use and acreage as appropriate considering the right to be leased. If not enough room below, you may add additional rows (see instructions) or attach spreadsheet (matching Table 2). Please clearly label any attachments. (cfs = cubic feet per second and af = acre-feet)						
Priority Date	POD #	Use	Total Acres	Other Information (such as conditions/limitations on the right)		Total Rate (cfs)
Total af from storage, if applicable: _____ AF or <input type="checkbox"/> N/A						
Any additional information about the right: _____						

Table 3

Point of Diversion (POD) description: If the POD is not described on the certificate or if there is more than one POD listed on the certificate, then the specific POD(s) involved in the lease must be described. If not enough room below, you may add additional rows (see instructions) or attach spreadsheet (matching Table 3). Please clearly label any attachments.						
POD #	Twp	Rng	Sec	Q-Q	DLC/ Gov't	Measured Distances, latitude/longitude coordinates, or river mile (if unknown you may indicate "unknown")
1	9-S	45-E	25	SW-SE		Unknown
2	-	-	36	NW-NW		Unknown
<input type="checkbox"/> Please check this box if you don't know the location of the POD(s) and want the Department to identify the location of the POD(s) for the purpose of the instream lease.						

RECEIVED
OCT 29 2019
OWRD

Part 3 of 4 cont. – Water Right and Instream Use Information

Instream Use Information

Table 4

Instream Use Created by the Lease						
River/ Stream Name: <u>Powder, tributary to Snake River</u>				River Basin: <u>Powder</u>		
<p>Instream Portion: Use Table 4 to illustrate the instream rate, volume and instream period by priority date, POD (if more than one), Use (if more than one), and acreage as appropriate considering the right to be leased.</p> <p>If not enough room below, you may add additional rows (see instructions) or attach a spreadsheet (matching the below portion of Table 4). Please clearly label any attachments.</p>						
Priority date	POD #	Use	Acres	Proposed Instream Period	Total instream rate (cfs)	Total instream volume (af)
5/31/1947	1	IR	51.5	3/1 – 10/31	0.37	180.25
<p>Note: If not certain of the instream rate, volume and/or instream period, see the instructions and/or contact Department Staff for assistance. The instream rate and volume may be up to the maximum rate and duty/volume allowed by the right, as described in Table 2 or on your Certificate if leasing the entire right. The proposed instream period may be no longer than the irrigation season or the authorized period of allowed use.</p>						
<p>OR <input type="checkbox"/> Please check this box if you are not sure of the proposed rate, volume and instream period. As part of its review process, the Department will identify the appropriate instream rate, volume and period considering the water right(s) being leased and instream benefits.</p>						
Instream Reach						
<p>Proposed Instream Reach: <input checked="" type="checkbox"/> A reach typically begins at the point of diversion (POD) and ends at the mouth of the source stream: From the POD to <u>Mouth</u></p>				<p>Or Proposed Instream Point: <input type="checkbox"/> Instream use protected at the POD</p>		
<p>OR <input type="checkbox"/> Please check this box if you are not sure of the proposed reach and want water to be protected within a reach below the POD, if possible. (If no reach is identified or the above box is not checked, and there is only one POD listed on the certificate, the lease may be processed to be protected at the POD.)</p>						
Additional Instream Information						
<p><input type="checkbox"/> Yes <input checked="" type="checkbox"/> N/A Conditions to avoid enlargement or injury to other water rights, if any, or other limitations: list here _____</p> <p>Note: The Department may identify additional conditions to prevent injury and/or enlargement.</p>						
<p>Any additional information about the proposed instream use: _____</p>						

RECEIVED
 OCT 23
 OW

Part 3 of 4 – Water Right and Instream Use Information

Use a separate Part 3 for each water right to be leased instream

Water Right Information

Water right # 81986

Table 1

Water Right Information: Provide a description of the originating water right to be leased. Also include your tax lot number(s). Fill in all applicable information. For example, if your water right has multiple points of diversion (POD) but they're not numbered, you do not need to include a number. If not enough room below, you may add additional rows (see instructions) or attach spreadsheet (matching Table 1). Please clearly label any attachments.

If only leasing a portion of the right - complete Table 1 as indicated **Entirety - If the entire water right is to be leased, skip to Table 3.**

Priority Date	POD #	Twp	Rng	Sec	Q-Q	Tax Lot	Gov't Lot/DLC	Acres	USE	Previous Lease # (if any)
EXAMPLE										
12/2/1901	3	2-S	9-E	15	NE SE	100	47	4.0	IR	IL-1100
5/25/1978		9-S	45-E	36	NW-NE	6100		0.2	IS	
		-	-		SW-NE	6100		13	IS	
		-	-		SE-NE	6100		28.5	IS	
		-	-		SE-NW	6100		17.3	IS	
					NE-SW	6100		1	IS	
					SW-NW	6100		10	IS	
					NW-SW	6100		1	IR	
					NW-SW	6100		4.5	IS	
			46-E	30	SW-SW	4500	4	0.7	IS	
					SE-SW	4500		14.3	IS	
					NW-SE	4500		3.4	IS	
					SW-SE	4500		15.2	IS	
				31	NW-NE	4500		9	IS	
					NE-NW	4500		23.8	IS	
					NW-NW	4500	1	30	IS	
					SW-NW	4500	2	6	IR	
					SW-NW	4500	2	25.6	IS	
					SE-NW	4500		16.5	IS	
					NE-SW	4500		7.6	IS	
					NW-SW	4500	3	2.5	IR	
					NW-SW	4500	3	19.5	IS	
					SE-SW	4500		13.1	IS	
					NW-SE	4500		13.8	IS	
					SW-SE	4500		9.8	IS	

Total Acres: 9.5 IR
276.8 IS

RECEIVED

OCT 29 2019

OWRD

Table 2

To illustrate the totals for the water right proposed to be leased instream						
Total rate and volume by priority date, POD, use and acreage as appropriate considering the right to be leased. If not enough room below, you may add additional rows (see instructions) or attach spreadsheet (matching Table 2). Please clearly label any attachments. (cfs = cubic feet per second and af = acre-feet)						
Priority Date	POD #	Use	Total Acres	Other Information (such as conditions/limitations on the right)	Total Rate (cfs)	Total Volume (af)
5/25/1978		IS	276.8		6.92	968.8
5/25/1978		IR	9.5		0.24	33.25
Total af from storage, if applicable: _____ AF or <input checked="" type="checkbox"/> N/A						
Any additional information about the right: _____						

Table 3

Point of Diversion (POD) description: If the POD is not described on the certificate or if there is more than one POD listed on the certificate, then the specific POD(s) involved in the lease must be described. If not enough room below, you may add additional rows (see instructions) or attach spreadsheet (matching Table 3). Please clearly label any attachments.						
POD #	Twp	Rng	Sec	Q-Q	DLC/ Gov't	Measured Distances, latitude/longitude coordinates, or river mile (if unknown you may indicate "unknown")
1	9-S	45-E	35	NE-NW		850' South & 3150' West from NE Corner Sec 35
2	-	-	36	NW-NW		380' South from NW Corner Sec 36
<input type="checkbox"/> Please check this box if you don't know the location of the POD(s) and want the Department to identify the location of the POD(s) for the purpose of the instream lease.						

Part 3 of 4 cont. – Water Right and Instream Use Information

RECEIVED
 OCT 29 2019
 OWRD

Instream Use Information

Table 4

Instream Use Created by the Lease						
River/ Stream Name: <u>Powder River</u> , tributary to <u>Snake River</u>				River Basin: <u>Powder</u>		
<p>Instream Portion: Use Table 4 to illustrate the instream rate, volume and instream period by priority date, POD (if more than one), Use (if more than one), and acreage as appropriate considering the right to be leased.</p> <p>If not enough room below, you may add additional rows (see instructions) or attach a spreadsheet (matching the below portion of Table 4). Please clearly label any attachments.</p>						
Priority date	POD #	Use	Acres	Proposed Instream Period	Total instream rate (cfs)	Total instream volume (af)
5/25/1978	1	IR	9.5	3/1 – 10/31	0.07	33.25
5/25/1978	1	IS	248.2	3/1 – 10/31	1.99	968.8
<p>Note: If not certain of the instream rate, volume and/or instream period, see the instructions and/or contact Department Staff for assistance. The instream rate and volume may be up to the maximum rate and duty/volume allowed by the right, as described in Table 2 or on your Certificate if leasing the entire right. The proposed instream period may be no longer than the irrigation season or the authorized period of allowed use.</p>						
<p>OR <input type="checkbox"/> Please check this box if you are not sure of the proposed rate, volume and instream period. As part of its review process, the Department will identify the appropriate instream rate, volume and period considering the water right(s) being leased and instream benefits.</p>						
Instream Reach						
<p>Proposed Instream Reach: <input checked="" type="checkbox"/> A reach typically begins at the point of diversion (POD) and ends at the mouth of the source stream: From the POD to <u>Mouth</u></p>				<p>Or Proposed Instream Point: <input type="checkbox"/> Instream use protected at the POD</p>		
<p>OR <input type="checkbox"/> Please check this box if you are not sure of the proposed reach and want water to be protected within a reach below the POD, if possible. (If no reach is identified or the above box is not checked, and there is only one POD listed on the certificate, the lease may be processed to be protected at the POD.)</p>						
Additional Instream Information						
<p><input type="checkbox"/> Yes <input checked="" type="checkbox"/> N/A Conditions to avoid enlargement or injury to other water rights, if any, or other limitations: list here _____</p> <p>Note: The Department may identify additional conditions to prevent injury and/or enlargement.</p>						
<p>Any additional information about the proposed instream use: _____</p>						

RECEIVED

OCT 29 2019

OWRD

