

# Sec. 11, S1/2 of Sec. 2, N1/2 of Sec. 14 Township 39 South, Range 5 West, W.M.

RECEIVED  
DEC 20 2019  
OWNRD

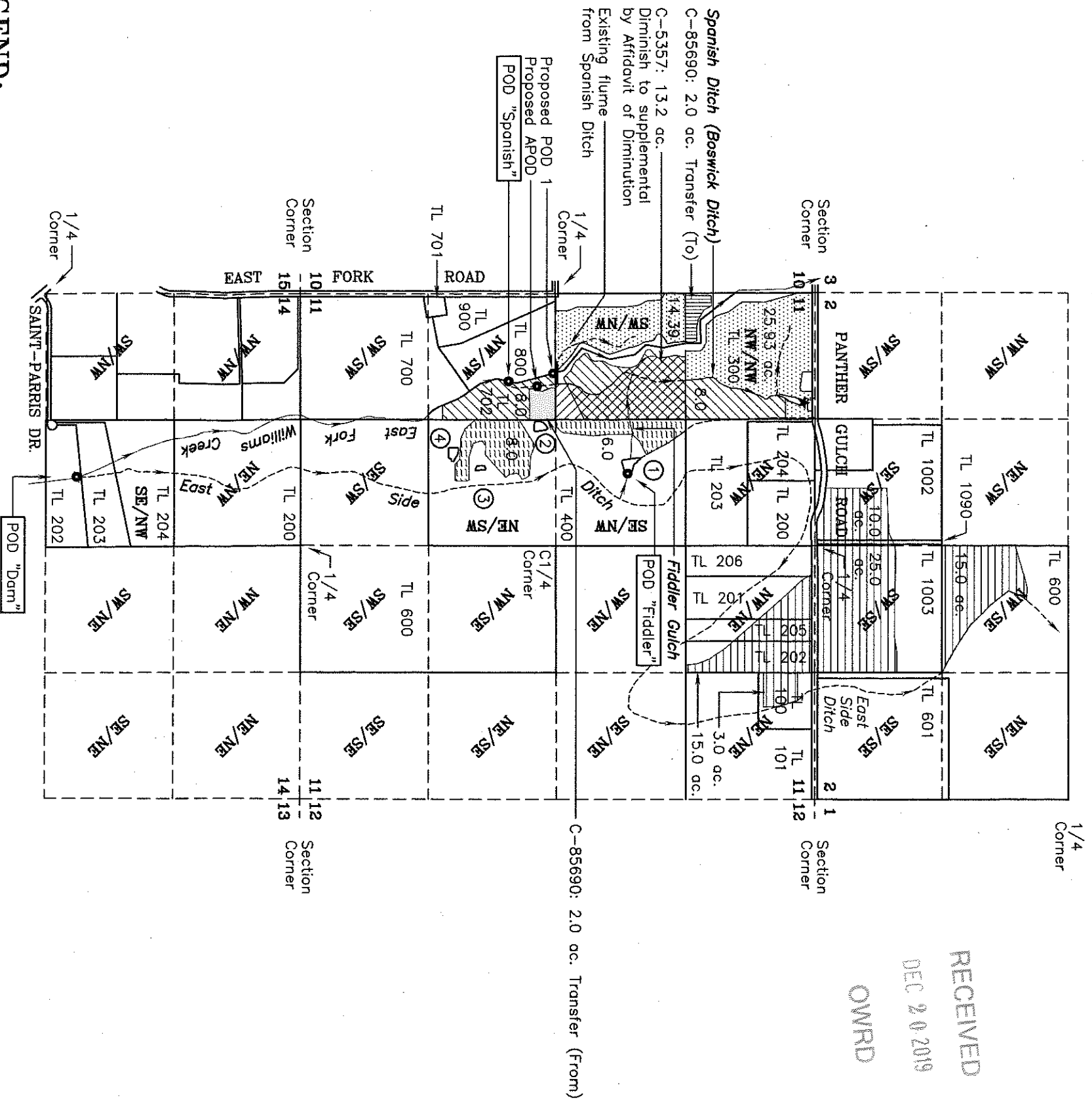

## LEGEND:

- Place of Use (POU) per Certificate No. 16330 (1875). Not part of transfer application; shown to clarify POU. NW1/4NW1/4 Sec. 11 = 25.93 Acres  
SW1/4NW1/4 Sec. 11 = 14.39 Acres
- Place of Use per Certificate No. 85690 (Aug. 3, 1915). NW1/4NW1/4 Sec. 11 = 8.0 Acres  
SW1/4NW1/4 Sec. 11 = 17.0 Acres (Total Existing)  
NW1/4SW1/4 Sec. 11 = 10.0 Acres (Total Existing)  
8.0 remains unchanged; 2.0 ac. to be transferred to NW1/4NW1/4 Sec. 11.
- Place of Use per Certificate No. 5357 (Sept. 10, 1918). Not part of transfer application; shown to clarify POU. SW1/4NW1/4 Sec. 11 = 15.0 Acres (Total Existing); 1.8 ac. remain primary; 13.2 ac. diminish to supplemental. (See Affidavit of Diminution)
- Place of Use per Certificate No. 8861. Unchanged by this transfer; Priority Date = April 24, 1920. SE1/4NW1/4 Sec. 11 = 6.0 Acres  
NE1/4SW1/4 Sec. 11 = 8.0 Acres
- Place of Use per Certificate No. 85690 (Remainder). Unchanged by this transfer; Priority Date = Aug. 3, 1915
- Area of POU transfer FROM (C-85690: 2.0 Acres)
- Area of POU transfer TO (C-85690: 2.0 Acres)
- Existing Ditch (Named ditches as shown)
- Point of Diversion (POD) as shown
- Authorized POD "Dam"; to be abandoned (1930E & 320N of W1/4 Corner, Sec. 14)
- Authorized POD "Fiddler" (1890E & 760N of W1/4 Corner, Sec. 11)
- Authorized POD "Spanish" (920E & 490S of W1/4 Corner, Sec. 11)
- Proposed POD 1 (840E & 20S of W1/4 Corner, Sec. 11)
- Additional POD (APOD) (970E & 190S of W1/4 Corner, Sec. 11)
- APOD
- Pond number per Exempt Reservoir Permit No. P-74225
- Auxiliary Pump Site (1160E & 120S of the NW Corner, Sec. 11)
- Additional point of diversion

This map is not intended to provide legal dimensions or locations of property ownership lines.

PROJECT NO.  
1281-17-779  
DRAWING NO.  
183-11.17  
REVISION DATE:  
12-10-19  
SCALE:  
1" = 1320'  
SHEET NO.  
1 of 1

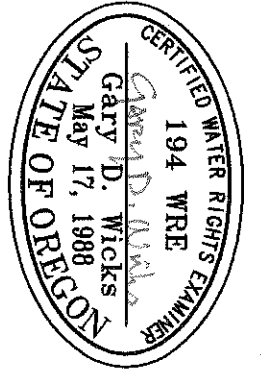

RENEWAL DATE: 6-30-20

## APPLICATION MAP FOR TRANSFER NO. T-12832

LOCATED IN

Section 11, South 1/2 of Section 2, and North 1/2 of Section 14  
Township 39 South, Range 5 West, W.M.  
Josephine County, Oregon

PREPARED FOR:  
**Gregg & Wilma Hyde**  
501 Panther Gulch Road  
Williams, OR 97544  
Tel: 541-846-6469

PREPARED BY:  
**WICKS ENGINEERING & SURVEYING**  
311 N.E. "D" Street  
Grants Pass, Oregon 97526  
Tel. (541) 479-3436 Fax (541) 479-1014