

Revised

Received by OWRD

FEB 07 2020

Salem, OR

T23S R31E, WM,
HARNEY COUNTY, OR

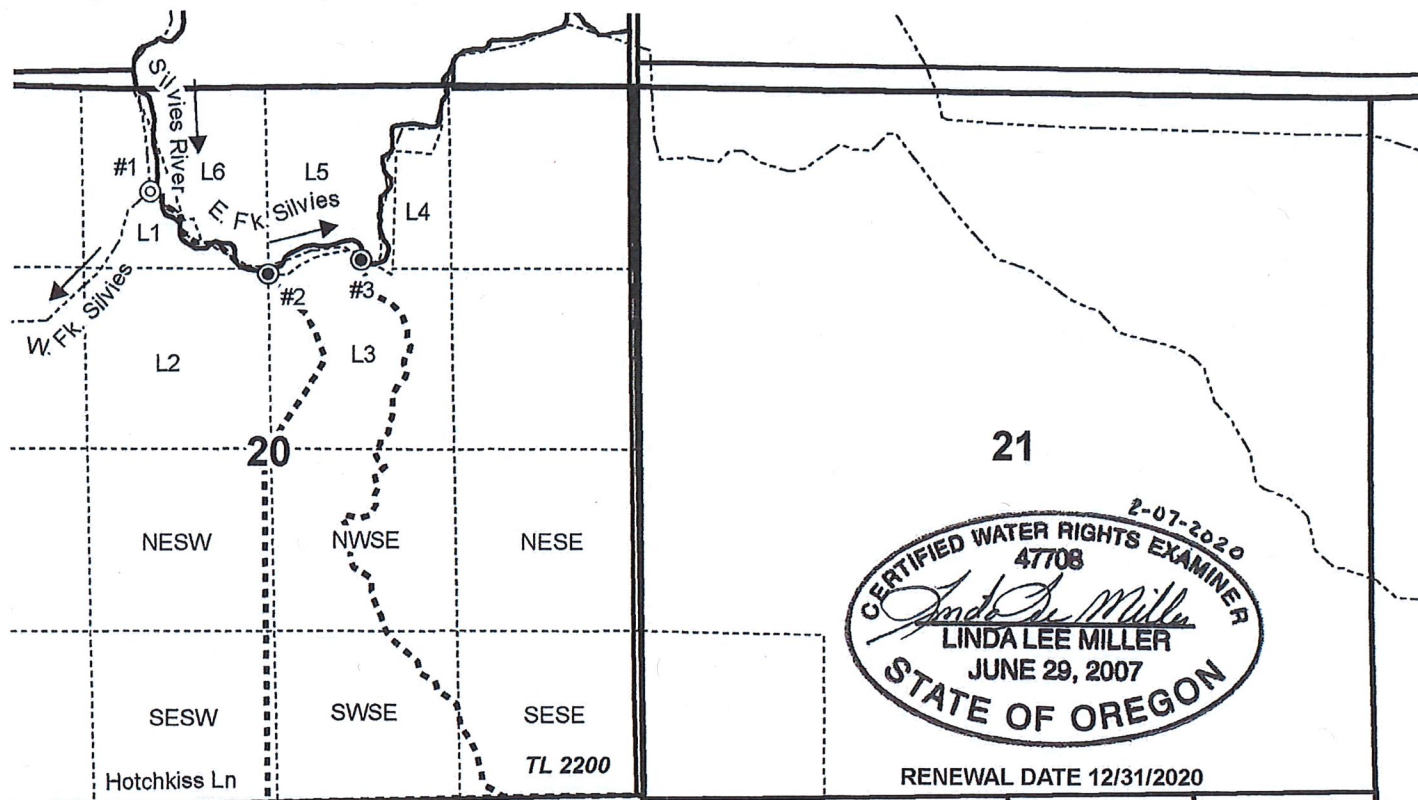
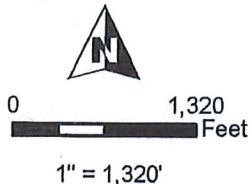

RENEWAL DATE 12/31/2020

- ⊙ Authorized POD
- ⊙ Proposed APOD
- Ditch
- ▨ POU IR (1886)
- ▭ Section
- Quarter Quarter
- ▭ Taxlot

POD Locations: **29**

Authorized POD #1: 750' S, 1840' E of NW Cor Sec 20
 Proposed APOD #2: 1290' S of N 1/4 Cor Sec 20
 Proposed APOD #3: 1220' S, 700' E of N 1/4 Cor Sec 20



Please use and attach additional pages of Table 2 as needed.
See page 6 for instructions.

Do you have questions about how to fill-out the tables?
Contact the Department at 503-986-0900 and ask for Transfer Staff.

Table 2. Description of Changes to Water Right Certificate # Silvies River Decree Vol. 9, Pg. 170

List the change proposed for the acreage in each ¼ ¼. If more than one change is proposed, specify the acreage associated with each change.
If there is more than one POD/POA involved in the proposed changes, specify the acreage associated with each POD/POA.

AUTHORIZED (the "from" or "off" lands)										PROPOSED (the "to" or "on" lands)															
The listing that appears on the certificate BEFORE PROPOSED CHANGES										The listing as it would appear AFTER PROPOSED CHANGES															
List only that part or portion of the water right that will be changed.										are made.															
Twp	Rng	Sec	¼ ¼	Tax Lot/lot or DLC	Gvt	Acres	Type of USE listed on Certificate	POD(s) or POA(s) (name or number from Table 1)	Priority Date	Proposed Changes (see "CODES" from previous page)	Twp	Rng	Sec	¼ ¼	Tax Lot/lot or DLC	Gvt	Acres	New Type of USE	POD(s) to be used (from Table 1)	Priority Date					
EXAMPLE																									
2	S	9	E	15	NE	NW	100	15.0	Irrigation	POD #1 POD #2	1901	POU/POD	2	S	9	E	1	NW	NW	500	1	10.0	POD #5	1901	
23	S	31	E	28	NE	NW	2300	40.0	IR	POD 1	1886	APOD	23	S	31	E	28	NE	NW	2300		40.0	IR	POD 1, 2 & 3	1886
23	S	31	E	28	NW	NW	"	40.0	"	"	"	"	23	S	31	E	28	NW	NW	"	"	40.0	"	"	"
23	S	31	E	28	SW	NW	"	40.0	"	"	"	"	23	S	31	E	28	SW	NW	"	"	40.0	"	"	"
23	S	31	E	28	SE	NW	"	40.0	"	"	"	"	23	S	31	E	28	SE	NW	"	"	40.0	"	"	"
23	S	31	E	28	NW	SW	"	39.7	"	"	"	"	23	S	31	E	28	NW	SW	"	"	39.7	"	"	"
23	S	31	E	28	SW	SW	"	25.0	"	"	"	"	23	S	31	E	28	SW	SW	"	"	25.0	"	"	"
TOTAL ACRES: 224.7										TOTAL ACRES: 224.7															

Levised

Additional remarks: _____

Received by OWRD