

~~Water Right Permit Application~~ *SB*

William Baldwin

SW 1/4 Section 20 T.32S., R.5W., W.M.

Douglas County

Scale 1" = 400'

RECEIVED

FEB 07 2020

OWRD

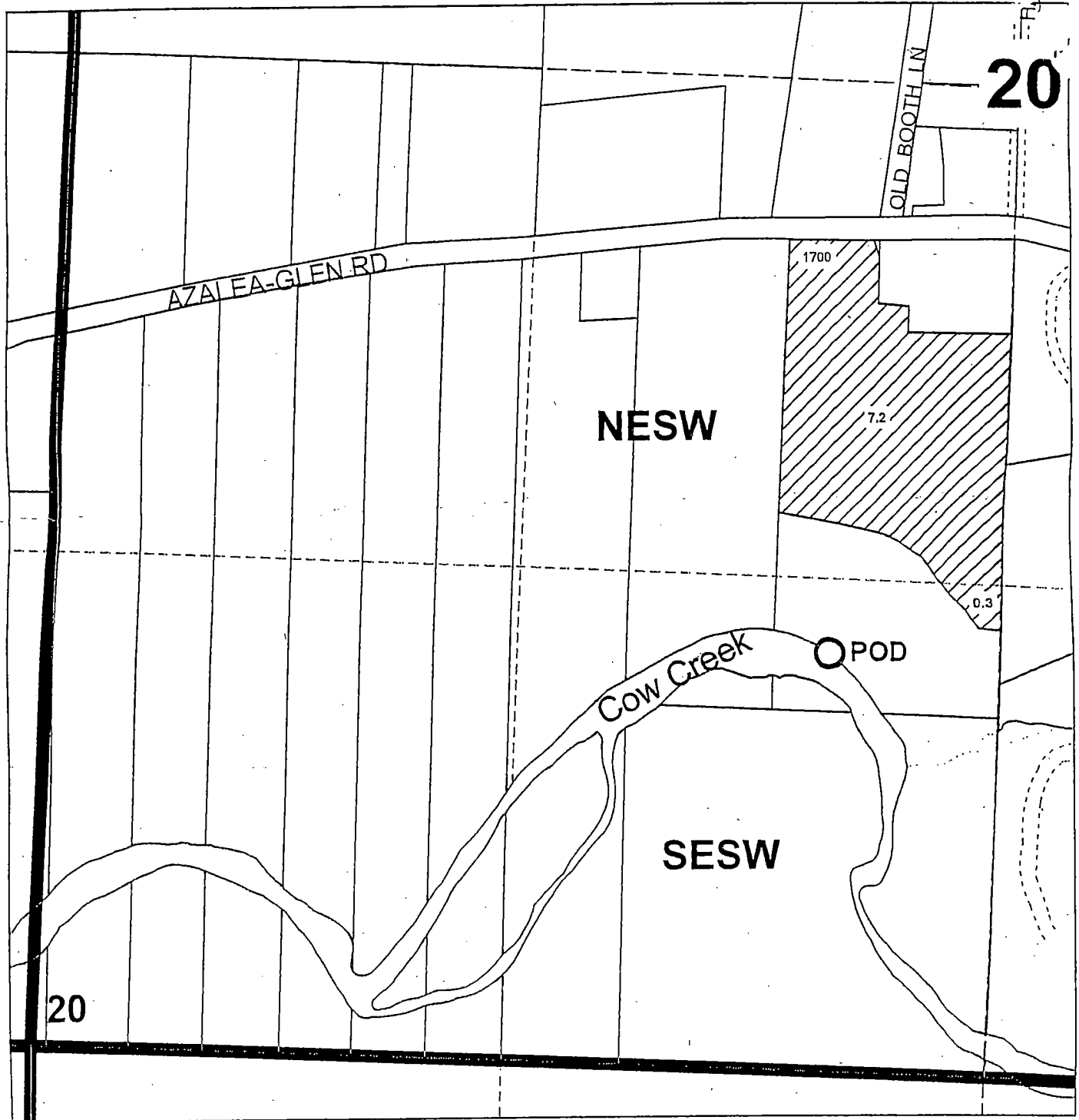
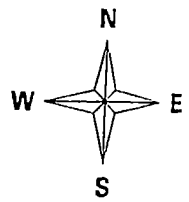

Point of diversion is 1100 ft. North and 2150 ft. East from the SW Corner of Section 20