

JACKSON COUNTY SEC.1 T38S R2W

SCALE - 1" = 400'



CITY OF MEDFORD
38-2W-01C 100 1.75 AC
38-2W-01CD 100 1.25 AC

NE 1/4 OF THE SW 1/4; SE 1/4 OF THE SW 1/4

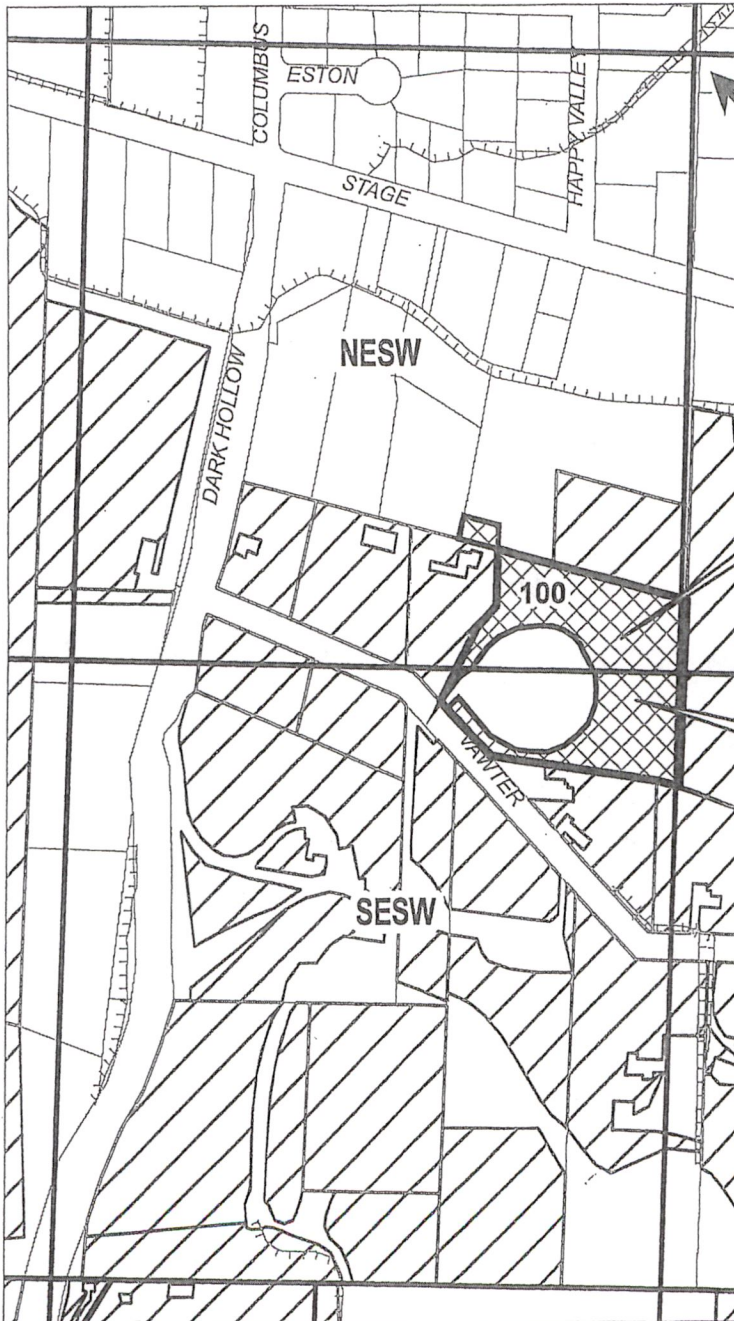

TOTAL WATER RIGHTS:
11.1 AC

TOTAL WATER RIGHTS:
25.3 AC

RECEIVED

MAR 02 2020

OWRD

CERTIFICATE #:

83727

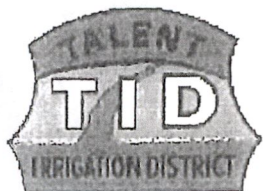

APPLICATION FOR 1 YEAR INSTREAM LEASE

NAME: CITY OF MEDFORD

TAXLOT #: 100

3.0 ACRES

	INSTREAM LAND
	EXISTING WATER RIGHTS

1/31/2020

JACKSON COUNTY SEC.1 T38S R2W

SCALE - 1" = 400'

CITY OF MEDFORD

38-2W-01CA 2600 1.30 ACRES



NE 1/4 OF THE SW 1/4; SE 1/4 OF THE SW 1/4

TOTAL WATER RIGHTS:
11.1 AC

TOTAL WATER RIGHTS:
25.3 AC

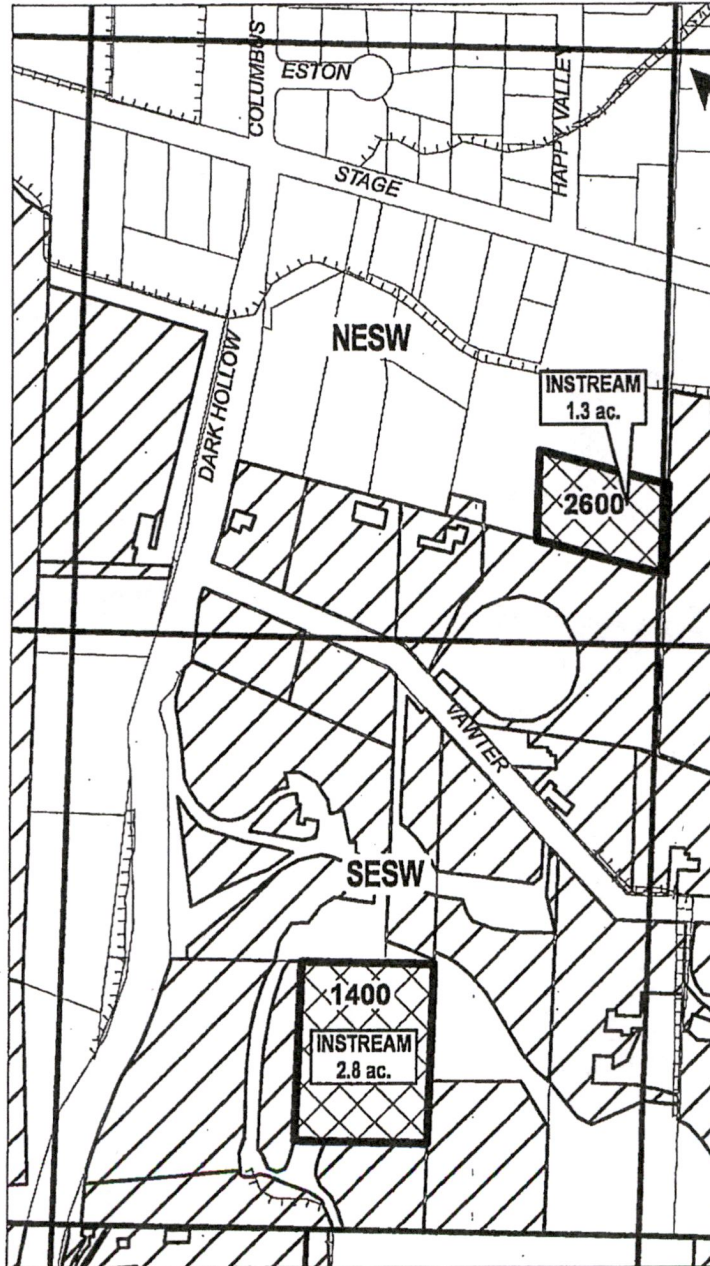

C 1/4 COR

RECEIVED

MAR 02 2020

OWRD

CERTIFICATE #:
79212
83727

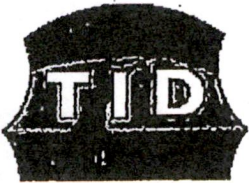



1/31/2020

APPLICATION FOR 1 YEAR INSTREAM LEASE

NAME: CITY OF MEDFORD

TAXLOT #: 2600 38-2W-01CA 1.30 ACRES

 INSTREAM LAND
 EXISTING WATER RIGHTS

**JACKSON COUNTY
SEC.1 T38S R2W**

**MEDFORD WATER
COMMISSION**

SCALE - 1" = 400'

38-2W-01CD 1400 2.80 AC



NE 1/4 OF THE SW 1/4; SE 1/4 OF THE SW 1/4

**TOTAL WATER RIGHTS:
11.1 AC**

**TOTAL WATER RIGHTS:
25.3 AC**

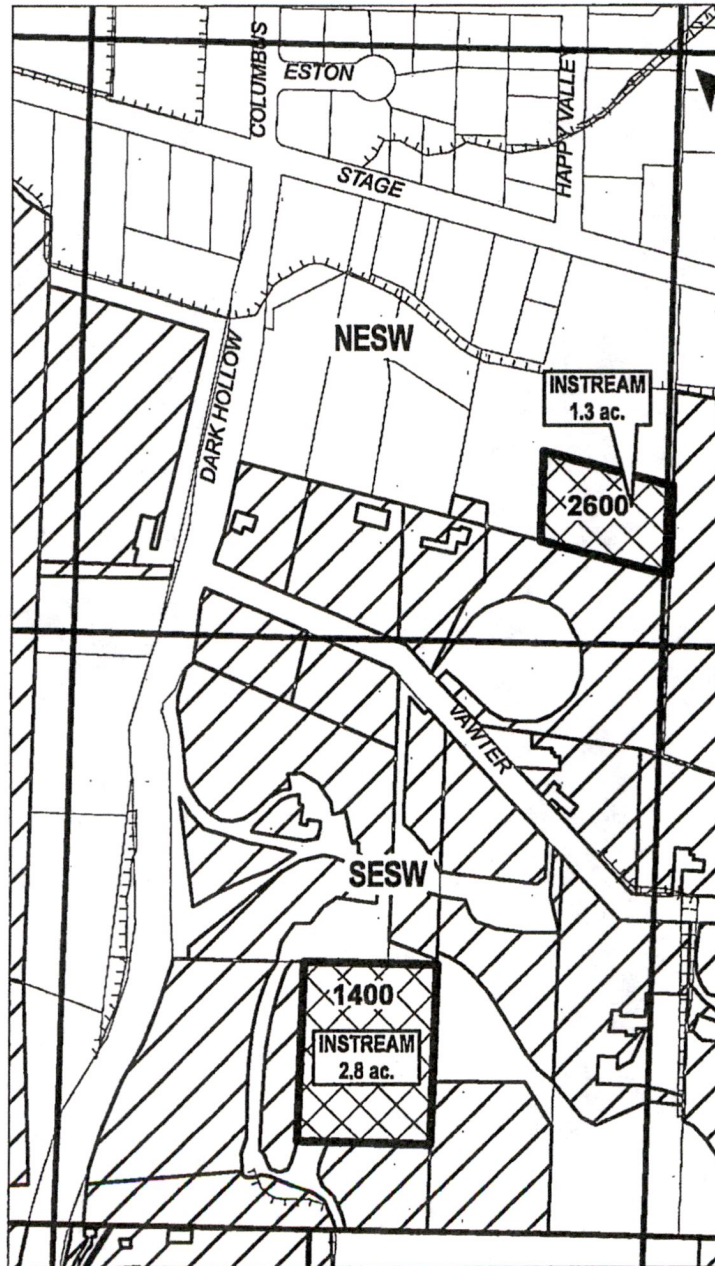

C 1/4 COR

RECEIVED

MAR 02 2020

OWRD

**CERTIFICATE #:
79212
83727**

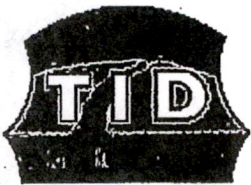

1/31/2020

APPLICATION FOR 1 YEAR INSTREAM LEASE

NAME: MEDFORD WATER COMMISSION

TAXLOT #:

1400

2.8 ACRES



INSTREAM LAND



EXISTING WATER RIGHTS