

Please use and attach additional pages of Table 2 as needed.
See page 6 for instructions.

Do you have questions about how to fill-out the tables?
Contact the Department at 503-986-0900 and ask for Transfer Staff.

Table 2. Description of Changes to Water Use Permit # G-16411

List the change proposed for the acreage in each 1/4 1/4. If more than one change is proposed, specify the acreage associated with each change.
If there is more than one POD/POA involved in the proposed changes, specify the acreage associated with each POD/POA.

| AUTHORIZED (the "from" or "off" lands) The listing that appears on the certificate BEFORE PROPOSED CHANGES | | | | | | | PROPOSED (the "to" or "on" lands) The listing as it would appear AFTER PROPOSED CHANGES | | | | | | | | | | | | | | |
|---|-----|-----|---------|---------|----------------|----------------------|--|---------------|---|-------------|-----|-----|---------|---------|----------------|----------------------|--|----------------|------|---------------------------|---------------|
| List only that part or portion of the water right that will be changed. | | | | | | | are made. | | | | | | | | | | | | | | |
| Twp | Rng | Sec | 1/4 1/4 | Tax Lot | Gvt Lot or DLC | Acre (if applicable) | POD(S) or POA(S) (name or number from Table 1) | Priority Date | Proposed Changes (see "CODES" from previous page) | Twp | Rng | Sec | 1/4 1/4 | Tax Lot | Gvt Lot or DLC | Acre (if applicable) | POD(S) or POA(S) to be used (from Table 1) | Priority Date | | | |
| | | | | | | | | | APOA | 3 | S | 1 | W | 32 | NE | NE | 2200 | DLC 48 | 29.4 | Wells 1, 2, 3, 4, 5, 7, 8 | June 29, 2007 |
| | | | | | | | | | APOA | 3 | S | 1 | W | 32 | NW | NE | 2200 | DLC 48 | 18.7 | Wells 1, 2, 3, 4, 5, 7, 8 | June 29, 2007 |
| | | | | | | | | | APOA | 3 | S | 1 | W | 32 | SW | NE | 2200 | DLC 48 | 13.7 | Wells 1, 2, 3, 4, 5, 7, 8 | June 29, 2007 |
| | | | | | | | | | APOA | 3 | S | 1 | W | 32 | SE | NE | 2200 | DLC 48 | 22.2 | Wells 1, 2, 3, 4, 5, 7, 8 | June 29, 2007 |
| | | | | | | | | | APOA | 3 | S | 1 | W | 33 | NW | NW | 2200 | DLC 48 / Lot 1 | 20.7 | Wells 1, 2, 3, 4, 5, 7, 8 | June 29, 2007 |
| | | | | | | | | | APOA | 3 | S | 1 | W | 33 | SW | NW | 2200 | Lot 1 | 28.5 | Wells 1, 2, 3, 4, 5, 7, 8 | June 29, 2007 |
| TOTAL ACRES | | | | | | | | | | TOTAL ACRES | | | | | | | | | | | |
| | | | | | | | | | | 133.2 | | | | | | | | | | | |

Additional remarks: There are no major pipelines shown on the application map because only portable irrigation piping and sprinklers are used for irrigation.

WV
Received by OWRD

Received 4/15/2020 DLD

T.3S. R.1W. Sec. 32 & 33, W.M.

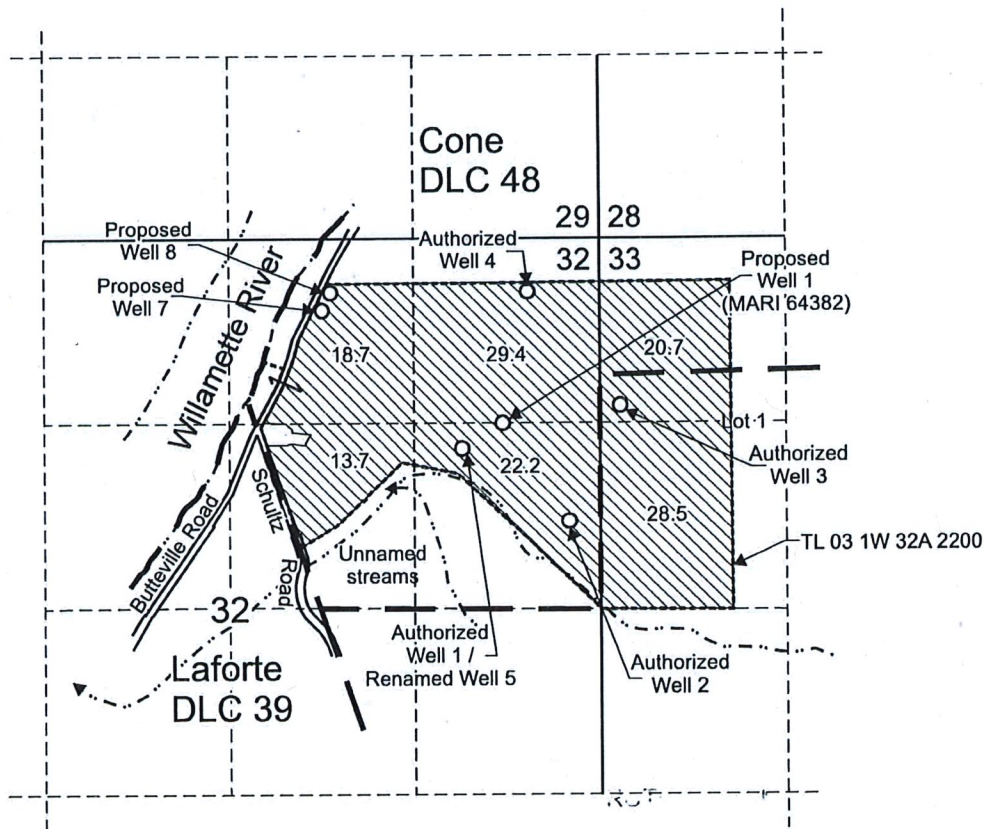



Swind
Received by OWRD

APR 15 2020

Salem, OR

Authorized Well 1 (Renamed Well 5) is located 1,500 feet south and 970 feet west from the NE corner, Section 32.
 Authorized Well 2 is located 2,020 feet south and 220 feet west from the NE corner, Section 32.
 Authorized Well 3 is located 1,200 feet south and 150 feet east from the NW corner, Section 33.
 Authorized Well 4 is located 390 feet south and 510 feet west from the NE corner, Section 32.
 Proposed Well 1 is located 1,320 feet south and 683 feet west from the NE corner, Section 32
 Proposed Well 7 is located 520 feet south and 1,975 feet west from the NE corner, Section 32
 Proposed Well 8 is located 395 feet south and 1,915 feet west from the NE corner, Section 32

-  Area (133.2 Acres) to be irrigated.
-  Tax lot boundary
-  Donation Land Claim boundary

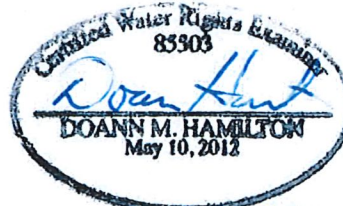

Scale: 1" = 1,320'



This map was prepared for the purpose of identifying the location of a water right only and is not intended to provide legal dimensions or location of property ownership lines.



Permit Amendment Application Map
 Application G-16890, Permit G-16411

Pacific Hydro-Geology Inc.

08/2019
 Rev. 03/2020
 Rev2. 04/2020

Keystone Pacific LLC c/o Chuck Eggert.
 T.3S. R.1W. Sec. 32 & 33, W.M.