



State of Oregon
 Water Resources Department
 725 Summer Street NE, Suite A
 Salem, Oregon 97301-1266
 (503) 986-0900

Application for Groundwater Registration Modification

Part 1 of 5 – Minimum Requirements Checklist

This Groundwater Registration Modification application will be returned if Parts 1 through 4 and all required attachments are not completed and included.
 For questions, please call (503) 986-0900, and ask for Transfer Section.

RECEIVED

OCT 16 2020

OWRD

Check all included with this application (N/A = Not Applicable)

- Part 1 – Completed Minimum Requirements Checklist.
 - Part 2 – Completed Application Map Checklist.
 - Part 3 – Completed Applicant Information and Signature.
 - Part 4 – Completed Groundwater Registration Modification Application – Groundwater Registration Information. (Only one Groundwater registration per application, unless the Groundwater registrations to be modified are layered).
 - Completed Groundwater Registration Modification Application Map (Does not have to be prepared by a Certified Water Right Examiner).
 - Groundwater registration modification fees – Amount enclosed: \$ 1,250. (\$875.00 for a place of use change only; \$1,250.00 for any other change or combination).
- Attachments:**
- N/A Request for Assignment Form and statutory fee. This form needs to be completed if the applicant owns the land to which the registration is appurtenant and is **not** the registration certificate holder of record. The Request for Assignment Form is available at <https://www.oregon.gov/OWRD/Forms/Pages/default.aspx>.
 Assignment is not needed for any person or entity who can demonstrate authorization to request recognition of a modification (e.g. legal representative, power of attorney, agent, etc.) **or** the applicant is named on the certificate of registration, or has been assigned to the certificate of registration.
 - N/A Oregon Water Resources Department’s Land Use Information Form with approval and signature (or signed land use form receipt stub) from each local land use authority in which water is to be diverted, conveyed, and/or used. Not required if water is to be diverted, conveyed, and/or used only on federal lands or if **all** of the following apply: a) a change in place of use only, b) no structural changes, c) the use of water is for irrigation only, and d) the use is located within an irrigation district or an exclusive farm use zone.
 - N/A Water Well Report/Well Log for changes in point(s) of appropriation (well(s)) or additional point(s) of appropriation.

(For Staff Use Only)

WE ARE RETURNING YOUR APPLICATION FOR THE FOLLOWING REASON(S):

___ Application fee not enclosed/insufficient	___ Map not included or incomplete
___ Land Use Form not enclosed or incomplete	___ Assignment Form and fee not enclosed/insufficient
___ Additional signature(s) required	___ Part ___ is incomplete

Other/Explanation _____

Staff: _____ 503-986-0 _____ Date: ___/___/___

Part 2 of 4 – Groundwater Registration Modification Map Checklist

Your Groundwater Registration Modification application will be returned if any of the map requirements listed below are not met.

Please be sure that the map you submit includes all the items listed below and meets the requirements of OAR 690-380-3100, however, the map does not have to be prepared by a Certified Water Right Examiner. Check all boxes that apply.

- Permanent quality printed with dark ink on good quality paper.
- The size of the map can be 8½ x 11 inches, 8½ x 14 inches, 11 x 17 inches, or up to 30 x 30 inches. For 30 x 30 inch maps, one extra copy is required.
- A north arrow, a legend, and scale.
- The scale of the map must be: 1 inch = 400 feet, 1 inch = 1,320 feet, the scale of the county assessor map if the scale is not smaller than 1 inch = 1,320 feet, or a scale that has been pre-approved by the Department.
- Township, Range, Section, ¼ ¼, DLC, Government Lot, and other recognized public land survey lines.

- Major water delivery system features from the point(s) of appropriation such as main pipelines, canals, and ditches.

- Existing place of use that includes hachuring, priority date, and use including number of acres in each quarter-quarter section, government

- Tax lot boundaries (property lines) are required. Tax lot numbers are recommended.

- Major physical features including rivers and creeks showing direction of flow, lakes and reservoirs, roads and railroads.

- Major water delivery system features from the point(s) of appropriation such as main pipelines, canals, and ditches.

- Existing place of use that includes hachuring, priority date, and use including number of acres in each quarter-quarter section, government lot, or in each quarter-quarter section as projected within government lots, donation land claims, or other recognized public land survey subdivisions. If less than the entirety of the registration is being changed, a separate hachuring is needed for the portion of the registration left unchanged.

- N/A If you are proposing a modification in place of use, show the proposed place of use with hachuring including priority date and use including number of acres in each quarter-quarter section, government lot, or in each quarter-quarter section as projected within government lots, donation land claims, or other recognized public land survey subdivisions.

- Existing point(s) of appropriation with distance and bearing or coordinates from a recognized survey corner.

- N/A If you are proposing a modification in point(s) of appropriation, show the proposed location and label it clearly with distance and bearing or coordinates. If GPS coordinates are used, latitude-longitude coordinates may be expressed as either degrees-minutes-seconds with at least one digit after the decimal (example – 42°32'15.5") or degrees-decimal with five or more digits after the decimal (example – 42.53764°).

RECEIVED

OCT 16 2020

OWRD

18545

TACS

Part 3 of 4 – Applicant Information and Signature

Applicant Information

APPLICANT/BUSINESS NAME Watkinson Family Trust, W. Grant and Diane R. Watkinson Trustee			PHONE NO. 503-635-0163	ADDITIONAL CONTACT NO. 503-708-8682 cell
ADDRESS 15784 Twin Fir Rd				FAX NO.
CITY Lake Oswego	STATE OR	ZIP 97035	E-MAIL Gwatkinson0163@gmail.com	
BY PROVIDING AN E-MAIL ADDRESS, CONSENT IS GIVEN TO RECEIVE ALL CORRESPONDENCE FROM THE DEPARTMENT ELECTRONICALLY. COPIES OF THE FINAL ORDER DOCUMENTS WILL ALSO BE MAILED.				

Agent Information – The agent is authorized to represent the applicant in all matters relating to this application

AGENT/BUSINESS NAME Doann Hamilton/Pacific Hydro-Geology, Inc.			PHONE NO. (503) 632-5016	ADDITIONAL CONTACT NO. (503) 349-6946 (cell)
ADDRESS 18487 S. Valley Vista Road				FAX NO. (503) 632-5983
CITY Mulino	STATE OR	ZIP 97042	E-MAIL phgdmh@gmail.com	
BY PROVIDING AN E-MAIL ADDRESS, CONSENT IS GIVEN TO RECEIVE ALL CORRESPONDENCE FROM THE DEPARTMENT ELECTRONICALLY. COPIES OF THE FINAL ORDER DOCUMENTS WILL ALSO BE MAILED.				

Explain in your own words what you propose to accomplish with this modification; and why:
We recently have the site in escrow with a tentative schedule of finalizing the purchase in December 2020, but the authorized well is on another property. We need to apply for the groundwater registration modification to change the well from the current, authorized well, to a well that will be located on our property.

If you need additional space, continue on a separate piece of paper and attach to the application as "Attachment 1".

Check this box if this project is fully or partially funded by the American Recovery and Reinvestment Act. (Federal stimulus dollars)

(Check one box)

- By signing this application, I (we) understand that, upon receipt of the draft preliminary determination and prior to Department approval of the Groundwater modification, I (we) will be required to provide landownership information and evidence that I am authorized to pursue the modification as identified in OAR 690-382-0400(16)(a); **OR**
- I (we) affirm the applicant is a municipality as defined in ORS 540.510(3)(b) and that the right is in the name of the municipality or a predecessor; **OR**
- I (we) affirm that the applicant is an entity with the authority to condemn property and is acquiring the property to which the Groundwater registration proposed for modification is appurtenant by condemnation and have attached supporting documentation.

RECEIVED

OCT 16 2020

OWRD

I understand that prior to Department approval of the groundwater registration modification, I may be required to submit payment to the Department for publication of a notice in a newspaper with general circulation in the area where the groundwater registration is located, once per week for two consecutive weeks. If more than one qualifying newspaper is available, I suggest publishing the notice in the following paper: Wilsonville Spokesman.

I (we) affirm that the information contained in this application is true and accurate.

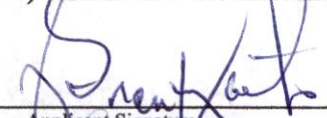
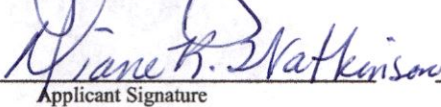
 Applicant Signature	W. Grant WATKINSON Print Name and title if applicable	9-17-2020 Date	
 Applicant Signature	Diane R. Watkinson Print Name and title if applicable	9-17-2020 Date	

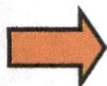

Dear Sir,
I have the honor to acknowledge the receipt of your letter of the 14th inst. regarding the matter mentioned therein.

The same has been referred to the appropriate authorities for their consideration and they will be pleased to advise you of the result thereof.

I am, Sir, very respectfully,
Yours faithfully,
[Signature]

[Name]
[Title]
[Address]

Enclosed for you are the documents mentioned in your letter of the 14th inst. and also a copy of the report of the committee appointed to inquire into the matter.

I am, Sir, very respectfully,
Yours faithfully,
[Signature]

[Name]
[Title]
[Address]

I am, Sir, very respectfully,
Yours faithfully,
[Signature]

[Name]
[Title]
[Address]



Is the applicant the sole owner of the land on which the Groundwater registration modification or portion thereof, is located? Yes No *If NO, include signatures of all deeded landowners (and mailing and/or e-mail addresses if different than the applicant's) or attach affidavits of consent (and mailing and/or e-mail addresses) from all landowners or individuals/entities to which the Groundwater registration has been conveyed.*

Check the appropriate box, if applicable:

Check here if the Groundwater registration proposed for modification is or will be located within or served by an irrigation or other water district.

IRRIGATION DISTRICT NAME NA	ADDRESS	
CITY	STATE	ZIP

Check here if water for the Groundwater registration is supplied under a water service agreement or other contract with a federal agency or other entity.

ENTITY NAME NA	ADDRESS	
CITY	STATE	ZIP

To meet State Land Use Consistency Requirements, you must list all local governments (each county, city, municipal corporation, or tribal government) within whose jurisdiction water will be diverted, conveyed or used.

ENTITY NAME Clackamas Co. Department of Transportation and Development, Planning Division	ADDRESS 150 Beavercreek Road	
CITY Oregon City	STATE Oregon	ZIP 97045

ENTITY NAME	ADDRESS	
CITY	STATE	ZIP

RECEIVED
OCT 16 2020
OWRD

13545

Part 4 of 4 – Groundwater Registration Information

Please use a separate Part 4 for each registration being modified. See instructions on page 5, to copy and paste additional Part 4s, or to add additional rows to tables within the form.

Table 1. Location of Authorized and Proposed Point(s) of Appropriation (POA)

(Note: If the POA name is not specified in the registration, assign it a name or number here.)

POA Name or Number	Is this POA Authorized by the registration or is it Proposed?	OWRD Well Log ID# (or Well ID Tag # L-___)	Twp		Rng		Sec	¼ ¼		Tax Lot, DLC or Gov't Lot	Measured Distances (from a recognized survey corner)
Well	<input checked="" type="checkbox"/> Authorized <input type="checkbox"/> Proposed	CLAC 9387	3	S	1	E	18	NW	NE	800	1,070 feet south and 2,360 feet west from the NE corner, Section 18
Well 1	<input type="checkbox"/> Authorized <input checked="" type="checkbox"/> Proposed	NA	3	S	1	E	18	NW	NE	600	800 feet south and 2,160 feet west from the NE corner, Section 18
Well 2	<input type="checkbox"/> Authorized <input checked="" type="checkbox"/> Proposed	NA	3	S	1	E	18	NW	NE	600	675 feet south and 2,160 feet west from the NE corner, Section 18

Check all type(s) of modifications(s) proposed below (modification “CODES” are provided in parentheses):

- | | |
|---|---|
| <input type="checkbox"/> Place of Use (POU) | <input checked="" type="checkbox"/> Point of Appropriation (well) (POA) |
| <input type="checkbox"/> Character of Use (USE) | <input type="checkbox"/> Additional Point of Appropriation (APOA) |

Will all of the proposed changes affect the entire Groundwater registration?

- Yes Complete only the proposed (“to” lands) section of Table 2 on the next page. Use the “CODES” listed above to describe the proposed changes.
- No Complete all of Table 2 to describe the portion of the registration to be changed.

RECEIVED

OCT 16 2020

OWRD

Please use and attach additional pages of Table 2 as needed.
See page 5 for instructions.

Do you have questions about how to fill-out the tables?
Contact the Department at 503-986-0900 and ask for Transfer

Table 2. Description of Modifications to Registration GR-3380 (Certificate # GR-3123)

List only the part of the registration that will be modified. For the acreage in each 1/4 1/4, list the modification proposed. If more than one modification, specify the acreage associated with each modification. If more than one POA, specify the acreage associated with each POA.

AUTHORIZED (the "from" or "off" lands)										PROPOSED (the "to" or "on" lands)															
The listing that appears in the registration BEFORE PROPOSED CHANGES										The listing as it would appear AFTER PROPOSED CHANGES															
List only that part or portion of the groundwater registration that will be changed.										are made.															
Twp	Rng	Sec	1/4	1/4	Tax Lot	Gvt Lot or DLC	Acres	Type of USE listed on Certificate	POA(s) (name or number from Table 1)	Priority Date	Proposed Changes (see "CODES" from previous page)	Twp	Rng	Sec	1/4	1/4	Tax Lot	Gvt Lot or DLC	Acres	New Type of USE	POA(s) to be used (from Table 1)	Priority Date			
3	S	1	E	18	NW	NE	600	NA	3.6	IR	Authorized Well	9-30-1950	3	S	1	E	18	NW	NE	600	NA	3.6	IR	Wells 1 & 2	9-30-1950
TOTAL ACRES										TOTAL ACRES															
3.6										3.6															

Additional remarks: None.

RECEIVED

OCT 16 2020

OWRD

13545

Groundwater Registration # GR-3380 (Certificate # GR-3123)

For a modification in place of use or character of use:

Are there other water right certificates, water use permits, or Groundwater registrations associated with the “from” or “to” lands? Yes No

If YES, list the other certificate, water use permit, or other Groundwater registration numbers:
CERTIFICATES 40750 AND 40752

Pursuant to OAR 690-382-0200, any “layered” water use, such as an irrigation right that is supplemental to a primary irrigation right proposed for transfer, must be concurrently transferred with the registration or be cancelled. Any change to a water right must be filed separately in a transfer application. Any change to a water use permit must be filed separately with a permit amendment. Any modification to a Groundwater registration on the “to” lands must be filed separately with a Groundwater registration modification.

For modifications in point(s) of appropriation (well(s) or additional point(s) of appropriation:

- Well log(s) are attached for each well that are clearly labeled and associated with the corresponding well(s) in Table 1 above and on the accompanying application map.
(Tip: You may search for well logs on the Department’s web page at:
http://apps.wrd.state.or.us/apps/gw/well_log/)

RECEIVED
OCT 16 2021
OWRD

AND/OR

- Describe the construction of the authorized and proposed well(s) in Table 3 for any wells that do not have a well log. For *proposed wells not yet constructed or built*, provide “a best estimate” for each requested information element in the table. The Department recommends you consult a licensed well driller, geologist, or certified water right examiner to assist with assembling the information necessary to complete Table 3.

Table 3. Construction of Point(s) of Appropriation

Any well(s) in this listing must be clearly tied to corresponding well(s) described in Table 1 and shown on the accompanying application map. Failure to provide adequate information is likely to delay the processing of your modification application until it is received. The information is necessary for the department to assess whether the proposed well(s) will access the same source aquifer as the authorized point(s) of appropriation (POA). The Department is prohibited by law from approving POA changes that do not access the same source aquifer.

Proposed or Authorized POA Name or Number	Is well already built? (Yes or No)	If an existing well, OWRD Well ID Tag No. L-___	Total well depth	Casing Diameter	Casing Intervals (feet)	Seal depth(s) (intervals)	Perforated or screened intervals (in feet)	Static water level of completed well (in feet)	Source aquifer (sand, gravel, basalt, etc.)	Well -specific rate (cfs or gpm). If less than full rate of water right
Well	Yes	CLAC 9387	See Well log CLAC 9387							
Well 1	No	NA	300 ft	6 inch	0 to 300	0 to 60	TBD	NA	Alluvial	Not less than full rate of water right
Well 2	No	NA	300 ft	6 inch	0 to 300	0 to 60	TBD	NA	Alluvial	

**Application for Water Right
Transfer
Consent by Deeded Landowner**



Oregon Water Resources Department
725 Summer Street NE, Suite A
Salem, Oregon 97301-1266
(503) 986-0900
www.wrd.state.or.us

RECEIVED

OCT 16 2020

OWRD

State of Oregon)
)ss
County of Clackamas)

I Judy Steagall in my capacity as owner,

mailing address 13805 NE Lawson, Prineville, OR 97754,

telephone number: 503-349-7743, duly sworn depose and say that I

consent to the proposed change to Water Right Certificate Number GR-3380

described in a Transfer Application (T-NA) submitted by W. Grant Watkinson,
(transfer number, if known)

on the property in tax lot number 600, Section 18, Township 3 South, Range 1 East, W.M.,
located across the street to the NE of 28428 SW 53rd Ave, Wilsonville, 97070.
(site address)

Judy Steagall
Signature of Affiant

9-17-2020
Date

Signature of Affiant

Date

Subscribed and Sworn to before me this 17 day of September, 2020

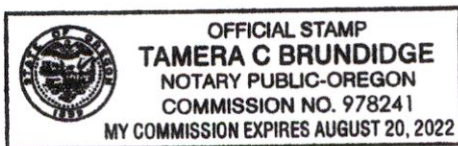

Tamera C Brundidge
Notary Public for Oregon

My commission expires 8/20/22

13545



Oregon

Kate Brown, Governor

Water Resources Department

North Mall Office Building

725 Summer St NE, Ste A

Salem, OR 97301

Phone: 503-986-0900

Fax: 503-986-0904

www.Oregon.gov/OWRD

October 27, 2020

Judy Steagall
13805 NE Lawson
Prineville, OR 97754

Reference: Application GR-3380, GR Registration GR-3123

The partial assignment by proof from Wilbur Bruck to Judy Steagall has been recorded in the records of the Water Resources Department.

The Departments records will now show Wilbur Bruck and Judy Steagall as the registration holders of record.

Our records have been changed accordingly and the original request is enclosed. Receipt number 133694 covering the recording fee has been sent to W. Grant Watkinson and Diane R. Watkinson.

A registration is not a perfected water right, and will in the future be adjudicated.

Sincerely,

Mary F. Bjork
Water Rights Program Analyst
Water Right Services Division

Enclosure: Original Request and Receipt #133526

cc: Watermaster #22

W. Grant & Diane R. Watkinson – 15784 Twin Fir Road, Lake Oswego, OR 97035

Data Center, OWRD (cover letter, request & map)

File

13545



Registration No. GR - 5380

Certificate No. GR - 3123

Registration Statement

OF CLAIMANT OF RIGHT TO APPROPRIATE GROUND WATER

TO THE STATE ENGINEER OF OREGON:

I, Wilbur Bruck
of Route 1 Box 316 Wilsonville County of Clackamas
(Mailing address)

State of Oregon, do hereby make application for a certificate of registration as evidence of a right to appropriate ground water.

1. Source from which water is withdrawn is pump well
(Flowing well, pump well, infiltration trench, or tunnel)

2. Location is: 2 1/2 mi. E of Wilsonville
(Approximate distance and direction from nearest city or town)

and is more particularly described as follows:

(a) 2360' west and 1070' south of N.E. corner Sec 18
(Give distance and bearing to corner of section or other legal subdivision)

being within NW 1/4 of NE 1/4 of Sec. 18, Twp. 3 S, Rge. 1 E
(Smallest legal subdivision) (N, or S.) (E. or W.)

or (b) within limits of recorded platted property, town or city:

in Lot _____ Block _____ of _____
(Name of plat or addition)

County of _____
(If within city or town, give name)

3. Construction Work was begun on September 1950; was completed on October 1950
(Date) (Date)

and the ground water claimed was first used for the purposes set out below on May 1951
(Date)

since which time the water has been used intermittently (for irrigation)
(Continuously or intermittently)

from May to October
(Date) (Date)

4. Quantity of water claimed and used is 100 gallons per minute; _____ acre feet per year.

5. Purpose or Purposes for which water is used irrigation and irrigated pasture
(Domestic irrigation, municipal, manufacturing, industrial, etc.)

6. Description of Well: Depth 254 feet Type drilled
(Dug or drilled)

diameter 6 inches. Elevation of ground at well site 160 feet mean sea level.
(As near as known)

Depth to water table 78 feet.

7. Capacity of Well: 160 g.p.m. with 22 feet drawdown.
_____ g.p.m. with _____ feet drawdown.

Date of test October 1950

If Flowing Well: Measured discharge _____ g.p.m. on _____
(Date)

Shut-in pressure at ground surface _____ lbs. per sq. in. on _____
(Date)

Water is controlled by _____
(Cap, valve, etc.)

13545

8. Casing: (Give diameter, commercial specifications and depth below ground surface of each casing size.)

6 inch diameter from 0 to 2.54 feet
 inch diameter from to feet
 inch diameter from to feet
 inch diameter from to feet

Describe and show depth of shoe, plug, adapter, liner or other details:

9. Perforated Casings or Screens:

5 slots Per ft. of 3/8 x 1/2 2 rows from 18.5 to 200
 (Number per foot and size of perforations, or describe screen)
 from 22.3 to 235
 from 250 to 254
 from to

10. Log of Well: (Describe each stratum or formation clearly, indicate if water bearing, and give thickness and depth as indicated.)

MATERIAL	Thickness (Feet)	Depth to Bottom (Feet)
Top Soil + Red Clay	64	64
Brown Sand + Clay (Fine)	10	174
Brown Sand + small gravel	20	198
Light blue clay	25	223
Black Basalt	6	229
Light brown clay mixed with weathered rock	20	249
Sand + gravel	5	254

Township 3 S Range 1 E W.M.

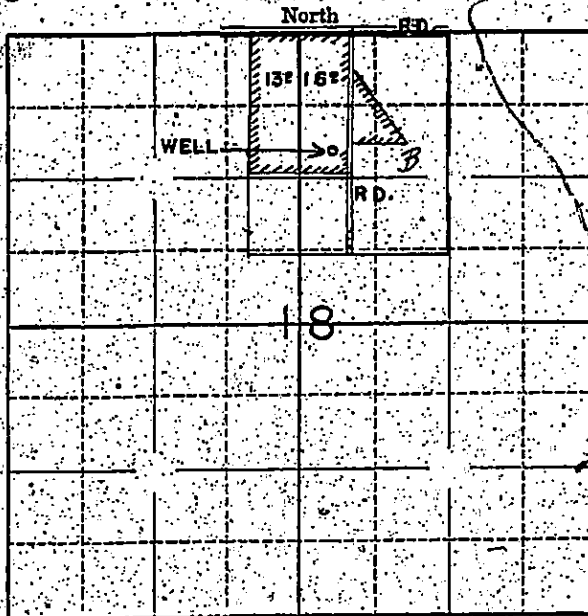

Locate well and acreage of irrigated land on plat:

Scale: $\frac{1}{2}$ " = 1 Mile

STATE OF OREGON

County of Clackamas

I, Wilbur Bruck, being first duly sworn, do hereby certify that I have read the foregoing Registration Statement and that all of the items therein contained are true to the best of my knowledge and belief.

Wilbur Bruck
(Signature of Registrant)

Subscribed and sworn to before me this 30th day of July, 1959

My commission expires MY COMMISSION EXPIRES OCT 15 1959

W. H. Dippner
(Notary Public)

(SEAL)

CERTIFICATE OF REGISTRATION

STATE OF OREGON

County of Marion

This is to certify that the foregoing Registration Statement was received in the office of the State Engineer on the 31st day of July, 1959, at 11:00 o'clock A.M. and has been duly recorded in said office in Book No. 13 of Registration Statements on page GR-3123

Witness my hand this 16th day of June, 1959

Lewis A. Stanley
(State Engineer)

By _____ (Deputy)

GR 3123

STATE ENGINEER
Salem, Oregon

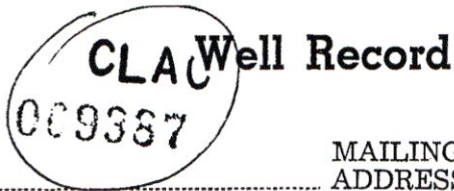

STATE WELL NO. 3/1-18-B
COUNTY Clackamas
APPLICATION NO. GR-3380

OWNER: Wilbur Bruck

MAILING ADDRESS: Route 1 Box 316

LOCATION OF WELL: Owner's No.

CITY AND STATE: Wilsonville, Oregon

NW 1/4 NE 1/4 Sec. 18 T. 3 N. S. R. 1 E. W.M.

Bearing and distance from section or subdivision corner 2360' W and 1070' S.

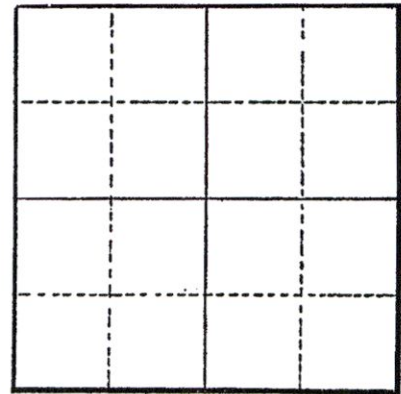

Section

Altitude at well

TYPE OF WELL: drilled Date Constructed 1950

Depth drilled 254' Depth cased 254'

CASING RECORD:

6"

RECEIVED
OCT 16 2020

FINISH:

5 slots per ft. of 3/8 x 1 1/2 2 rows from 185 to 200
from 223 to 235
from 250 to 254

OWRD

AQUIFERS:

clay, topsoil, sand, basalt, gravel

WATER LEVEL:

78'

PUMPING EQUIPMENT: Type Peerless Turbine H.P. 10
Capacity 100 G.P.M.

WELL TESTS:

Drawdown 22 ft. after hours pumping 160 G.P.M.
Drawdown ft. after hours G.P.M.

USE OF WATER Irrigation Temp. °F., 19.

SOURCE OF INFORMATION GR-3123

DRILLER or DIGGER

ADDITIONAL DATA:

Log Water Level Measurements Chemical Analysis Aquifer Test

REMARKS:

13545

