



State of Oregon
 Water Resources Department
 725 Summer Street NE, Suite A
 Salem, Oregon 97301-1266
 (503) 986-0900

Application for Groundwater Registration Modification

Part 1 of 5 – Minimum Requirements Checklist

This Groundwater Registration Modification application will be returned if Parts 1 through 4 and all required attachments are not completed and included.
 For questions, please call (503) 986-0900, and ask for Transfer Section.

Check all included with this application (N/A = Not Applicable)

RECEIVED

- Part 1 – Completed Minimum Requirements Checklist.
- Part 2 – Completed Application Map Checklist.
- Part 3 – Completed Applicant Information and Signature.
- Part 4 – Completed Groundwater Registration Modification Application – Groundwater Registration Information. (Only one Groundwater registration per application, unless the Groundwater registrations to be modified are layered).
- Completed Groundwater Registration Modification Application Map (Does not have to be prepared by a Certified Water Right Examiner).
- Groundwater registration modification fees – Amount enclosed: \$ 1250.
 (\$875.00 for a place of use change only; \$1,250.00 for any other change or combination).

FEB 04 2021

OWRD

Attachments:

- N/A Request for Assignment Form and statutory fee. This form needs to be completed if the applicant owns the land to which the registration is appurtenant and is **not** the registration certificate holder of record. The Request for Assignment Form is available at <https://www.oregon.gov/OWRD/Forms/Pages/default.aspx>.
 Assignment is not needed for any person or entity who can demonstrate authorization to request recognition of a modification (e.g. legal representative, power of attorney, agent, etc.) **or** the applicant is named on the certificate of registration, or has been assigned to the certificate of registration.
- N/A Oregon Water Resources Department’s Land Use Information Form with approval and signature (or signed land use form receipt stub) from each local land use authority in which water is to be diverted, conveyed, and/or used. Not required if water is to be diverted, conveyed, and/or used only on federal lands or if **all** of the following apply: a) a change in place of use only, b) no structural changes, c) the use of water is for irrigation only, and d) the use is located within an irrigation district or an exclusive farm use zone.
- N/A Water Well Report/Well Log for changes in point(s) of appropriation (well(s)) or additional point(s) of appropriation.

(For Staff Use Only)

WE ARE RETURNING YOUR APPLICATION FOR THE FOLLOWING REASON(S):

<input type="checkbox"/> Application fee not enclosed/insufficient	<input type="checkbox"/> Map not included or incomplete
<input type="checkbox"/> Land Use Form not enclosed or incomplete	<input type="checkbox"/> Assignment Form and fee not enclosed/insufficient
<input type="checkbox"/> Additional signature(s) required	<input type="checkbox"/> Part _____ is incomplete

Other/Explanation _____

Staff: _____ 503-986-0 _____ Date: 01 / 20 / 2021

Joe Davis

1-20-2021
 13610 TACS

Part 2 of 4 – Groundwater Registration Modification Map Checklist

Your Groundwater Registration Modification application will be returned if any of the map requirements listed below are not met.

Please be sure that the map you submit includes all the items listed below and meets the requirements of OAR 690-380-3100, however, the map does not have to be prepared by a Certified Water Right Examiner. Check all boxes that apply.

- Permanent quality printed with dark ink on good quality paper.
- The size of the map can be 8½ x 11 inches, 8½ x 14 inches, 11 x 17 inches, or up to 30 x 30 inches. For 30 x 30 inch maps, one extra copy is required.
- A north arrow, a legend, and scale.
- The scale of the map must be: 1 inch = 400 feet, 1 inch = 1,320 feet, the scale of the county assessor map if the scale is not smaller than 1 inch = 1,320 feet, or a scale that has been pre-approved by the Department.
- Township, Range, Section, ¼ ¼, DLC, Government Lot, and other recognized public land survey lines.
- Tax lot boundaries (property lines) are required. Tax lot numbers are recommended.
- Major physical features including rivers and creeks showing direction of flow, lakes and reservoirs, roads and railroads.
- Major water delivery system features from the point(s) of appropriation such as main pipelines, canals, and ditches.
- Existing place of use that includes hachuring, priority date, and use including number of acres in each quarter-quarter section, government lot, or in each quarter-quarter section as projected within government lots, donation land claims, or other recognized public land survey subdivisions. If less than the entirety of the registration is being changed, a separate hachuring is needed for the portion of the registration left unchanged.
- N/A If you are proposing a modification in place of use, show the proposed place of use with hachuring including priority date and use including number of acres in each quarter-quarter section, government lot, or in each quarter-quarter section as projected within government lots, donation land claims, or other recognized public land survey subdivisions.
- Existing point(s) of appropriation with distance and bearing or coordinates from a recognized survey corner.
- N/A If you are proposing a modification in point(s) of appropriation, show the proposed location and label it clearly with distance and bearing or coordinates. If GPS coordinates are used, latitude-longitude coordinates may be expressed as either degrees-minutes-seconds with at least one digit after the decimal (example – 42°32'15.5") or degrees-decimal with five or more digits after the decimal (example – 42.53764°).

RECEIVED

FEB 04 2021

13610 -
OWRD TACS

Part 3 of 4 – Applicant Information and Signature

Applicant Information

APPLICANT/BUSINESS NAME Jose Garcia		PHONE NO. 971-216-9372	ADDITIONAL CONTACT NO.
ADDRESS PO Box 571		FAX NO.	
CITY Aurora	STATE OR	ZIP 97002	E-MAIL jrgarci2@gmail.com
BY PROVIDING AN E-MAIL ADDRESS, CONSENT IS GIVEN TO RECEIVE ALL CORRESPONDENCE FROM THE DEPARTMENT ELECTRONICALLY. COPIES OF THE FINAL ORDER DOCUMENTS WILL ALSO BE MAILED.			

RECEIVED
FEB 04 2021
OWRD

Agent Information – The agent is authorized to represent the applicant in all matters relating to this application

APPLICANT/BUSINESS NAME Lyle Misbach, PE, AKS Engineering & Forestry, LLC		PHONE NO. 503-400-6028	ADDITIONAL CONTACT NO.
ADDRESS 3700 River Road N, Suite 1		FAX NO.	
CITY Keizer	STATE OR	ZIP 97303	E-mail MisbachL@aks-eng.com
BY PROVIDING AN E-MAIL ADDRESS, CONSENT IS GIVEN TO RECEIVE ALL CORRESPONDENCE FROM THE DEPARTMENT ELECTRONICALLY. COPIES OF THE FINAL ORDER DOCUMENTS WILL ALSO BE MAILED.			

Explain in your own words what you propose to accomplish with this modification; and why:

To drill my own well and use it as part of the existing GR-471 Claim.

If you need additional space, continue on a separate piece of paper and attach to the application as "Attachment 1".

Check this box if this project is fully or partially funded by the American Recovery and Reinvestment Act. (Federal stimulus dollars)

(Check one box)

- By signing this application, I (we) understand that, upon receipt of the draft preliminary determination and prior to Department approval of the Groundwater modification, I (we) will be required to provide landownership information and evidence that I am authorized to pursue the modification as identified in OAR 690-382-0400(16)(a); **OR**
- I (we) affirm the applicant is a municipality as defined in ORS 540.510(3)(b) and that the right is in the name of the municipality or a predecessor; **OR**
- I (we) affirm that the applicant is an entity with the authority to condemn property and is acquiring the property to which the Groundwater registration proposed for modification is appurtenant by condemnation and have attached supporting documentation.

I understand that prior to Department approval of the groundwater registration modification, I may be required to submit payment to the Department for publication of a notice in a newspaper with general circulation in the area where the groundwater registration is located, once per week for two consecutive weeks. If more than one qualifying newspaper is available, I suggest publishing the notice in the following paper: _____.

I (we) affirm that the information contained in this application is true and accurate.

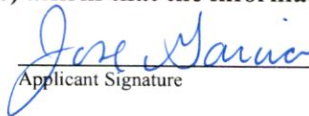

Applicant Signature

Jose Garcia

Print Name (and Title if applicable)

1-20-2021

Date

Applicant Signature

Print Name (and Title if applicable)

Date

Is the applicant the sole owner of the land on which the Groundwater registration modification or portion thereof, is located? Yes No *If NO, include signatures of all deeded landowners (and mailing and/or e-mail addresses if different than the applicant's) or attach affidavits of consent (and mailing and/or e-mail addresses) from all landowners or individuals/entities to which the Groundwater registration has been conveyed.*

Check the appropriate box, if applicable:

- Check here if the Groundwater registration proposed for modification is or will be located within or served by an irrigation or other water district.

IRRIGATION DISTRICT NAME	ADDRESS	
CITY	STATE	ZIP

- Check here if water for the Groundwater registration is supplied under a water service agreement or other contract with a federal agency or other entity.

ENTITY NAME	ADDRESS	
CITY	STATE	ZIP

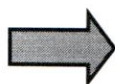

To meet State Land Use Consistency Requirements, you must list all local governments (each county, city, municipal corporation, or tribal government) within whose jurisdiction water will be diverted, conveyed or used.

ENTITY NAME Marion County	ADDRESS PO Box 14500	
CITY Salem	STATE OR	ZIP 97309

ENTITY NAME	ADDRESS	
CITY	STATE	ZIP

13610 -

Part 4 of 4 – Groundwater Registration Information

Please use a separate Part 4 for each registration being modified. See instructions on page 5, to copy and paste additional Part 4s, or to add additional rows to tables within the form.

Table 1. Location of Authorized and Proposed Point(s) of Appropriation (POA)
 (Note: If the POA name is not specified in the registration, assign it a name or number here.)

POA Name or Number	Is this POA Authorized by the registration or is it Proposed?	OWRD Well Log ID# (or Well ID Tag # L-___)	Twp		Rng		Sec	¼ ¼		Tax Lot, DLC or Gov't Lot	Measured Distances (from a recognized survey corner)
POD #1	<input checked="" type="checkbox"/> Authorized <input type="checkbox"/> Proposed	9/1W-19N(1)	9	S	1	W	19	SW	SW		N.30°06'E.10.986ch.frSW
	<input type="checkbox"/> Authorized <input checked="" type="checkbox"/> Proposed	new	9	S	2	W	19	SW	SW	01900	tbd
	<input type="checkbox"/> Authorized <input type="checkbox"/> Proposed										
	<input type="checkbox"/> Authorized <input type="checkbox"/> Proposed										

Check all type(s) of modifications(s) proposed below (modification "CODES" are provided in parentheses):

- | | |
|---|--|
| <input type="checkbox"/> Place of Use (POU) | <input type="checkbox"/> Point of Appropriation (well) (POA) |
| <input type="checkbox"/> Character of Use (USE) | <input checked="" type="checkbox"/> Additional Point of Appropriation (APOA) |

Will all of the proposed changes affect the entire Groundwater registration?

- Yes** Complete only the proposed ("to" lands) section of Table 2 on the next page. Use the "CODES" listed above to describe the proposed changes.
- No** Complete all of Table 2 to describe the portion of the registration to be changed.

RECEIVED

FEB 04 2021

OWRD

Please use and attach additional pages of Table 2 as needed. See page 5 for instructions.

Do you have questions about how to fill-out the tables? Contact the Department at 503-986-0900 and ask for Transfer

Table 2. Description of Modifications to Registration GR-471 (Certificate # GR-453)

List only the part of the registration that will be modified. For the acreage in each 1/4 1/4, list the modification proposed. If more than one modification, specify the acreage associated with each modification. If more than one POA, specify the acreage associated with each POA.

AUTHORIZED (the "from" or "off" lands)										PROPOSED (the "to" or "on" lands)											
The listing that appears in the registration BEFORE PROPOSED CHANGES										The listing as it would appear AFTER PROPOSED CHANGES											
List only that part or portion of the groundwater registration that will be changed.										are made.											
Twp	Rng	Sec	1/4	1/4	Gvt Lot or DLC	Acres	Type of USE listed on Certificate	POA(s) (name or number from Table 1)	Priority Date	Twp	Rng	Sec	1/4	1/4	Tax Lot	Gvt Lot or DLC	Acres	New Type of USE	POA(s) to be used (from Table 1)	Priority Date	
EXAMPLE																					
2	S	9	E	15	NW	100	15.0	Irrigation	1901	2	S	9	E	1	NW	500	1	10.0	POD #5	1901	
								EXAMPLE		2	S	9	E	2	SW	500		5.0	POD #6	1901	
9	S	1	W	19	SW	20	20	Irrigation	1941	9	S	1	W	19	SW	02000		10	Irrigation	POD #1	1941
										9	S	1	W	19	SW	01900		10	Irrigation	POD #3	2020
TOTAL ACRES										TOTAL ACRES											
13610										20											

Additional remarks: _____

RECEIVED

FEB 04 2021

OWRD

For a modification in place of use or character of use:

Are there other water right certificates, water use permits, or Groundwater registrations associated with the "from" or "to" lands? Yes No

RECEIVED

FEB 04 2021

If YES, list the other certificate, water use permit, or other Groundwater registration numbers:

OWRD



Pursuant to OAR 690-382-0200, any "layered" water use, such as an irrigation right that is supplemental to a primary irrigation right proposed for transfer, must be concurrently transferred with the registration or be cancelled. Any change to a water right must be filed separately in a transfer application. Any change to a water use permit must be filed separately with a permit amendment. Any modification to a Groundwater registration on the "to" lands must be filed separately with a Groundwater registration modification.

For modifications in point(s) of appropriation (well(s) or additional point(s) of appropriation:

- Well log(s) are attached for each well that are clearly labeled and associated with the corresponding well(s) in Table 1 above and on the accompanying application map. (Tip: You may search for well logs on the Department's web page at: http://apps.wrd.state.or.us/apps/gw/well_log/)

AND/OR

- Describe the construction of the authorized and proposed well(s) in Table 3 for any wells that do not have a well log. For *proposed wells not yet constructed or built*, provide "a best estimate" for each requested information element in the table. The Department recommends you consult a licensed well driller, geologist, or certified water right examiner to assist with assembling the information necessary to complete Table 3.

Table 3. Construction of Point(s) of Appropriation

Any well(s) in this listing must be clearly tied to corresponding well(s) described in Table 1 and shown on the accompanying application map. Failure to provide adequate information is likely to delay the processing of your modification application until it is received. The information is necessary for the department to assess whether the proposed well(s) will access the same source aquifer as the authorized point(s) of appropriation (POA). The Department is prohibited by law from approving POA changes that do not access the same source aquifer.

Proposed or Authorized POA Name or Number	Is well already built? (Yes or No)	If an existing well, OWRD Well ID Tag No. L-___	Total well depth	Casing Diameter	Casing Intervals (feet)	Seal depth(s) (intervals)	Perforated or screened intervals (in feet)	Static water level of completed well (in feet)	Source aquifer (sand, gravel, basalt, etc.)	Well - specific rate (cfs or gpm). If less than full rate of water right
tbd	No		25 +/-	8" +/-	tbd	10' +/-	last 10'	12' +/-	gravel	est. 200 gpm

0

RECEIVED
MAY 3 1957
STATE ENGINEER
SALES DIVISION

Registration Statement

REGISTRATION NO. G.R. 471

CERTIFICATE NO. GR 453

Well No. 1 East side of

OF CLAIMANT OF RIGHT TO APPROPRIATE GROUND WATER

(Under Chapter 768, Oregon Laws 1955.)

RECEIVED

FEB 04 2021

OWRD

TO THE STATE ENGINEER OF OREGON:

I, Alfred, Carl and Lucile Hofmann

of Route 1, Box 109 Aumsville County of Marion

State of Oregon, do hereby make application for a certificate of registration as evidence of a right to appropriate ground water.

1. Source from which water is withdrawn is drum well #1
(Flowing well, pump well, infiltration trench, or tunnel)

2. Location is: 4 miles southwest of Starbuck, Oregon
(Approximate distance and direction from nearest city or town)

and is more particularly described as follows:

(a) N 30° 06' East 10,936 chains from the S. W. Cor. Sec. 10 T. 3 S. R. 1 W. N.
(Give distance and bearing to corner of section or other legal subdivision)

being within S. W. 1/4 of Sec. 19, Twp. 9 S, Rge. 1 W.
(Smallest legal subdivision) (N. or S.) (E. or W.)

or (b) within limits of recorded platted property, town or city:

in Lot _____, Block _____ of _____
(Name of plat or addition)

(If within city or town, give name)

County of _____

3. Construction Work was begun on 12/1; was completed on 12/1
(Date) (Date)

and the ground water claimed was first used for the purposes set out below on 12/1
(Date)

since which time the water has been used continuously
(Continuously or Intermittently)

from 12/1 to October 1
(Date) (Date)

4. Quantity of water claimed and used is 200 gallons per minute; 30 acre feet per year.

5. Purpose or Purposes for which water is used irrigation of row crops

(Domestic, irrigation, municipal, manufacturing, industrial, etc.)

6. Description of Well: Depth 24 feet. Type drilled
(Dug or drilled)

diameter 5 inches. Elevation of ground at well site 365 feet, mean sea level.
(As near as known)

Depth to water table 12 feet.

7. Capacity of Well: 200 g.p.m. with _____ feet drawdown.

_____ g.p.m. with _____ feet drawdown.

Date of test _____

If Flowing Well: Measured discharge _____ g.p.m. on _____
(Date)

Shut-in pressure at ground surface _____ lbs. per sq. in. on _____
(Date)

Water is controlled by _____
(Cap. valve, etc.)

13610-

RECEIVED

FEB 04 2021

OWRD

8. Casing: (Give diameter, commercial specifications and depth below ground surface of each casing size.)

8. inch diameter from 0 to 24 feet
inch diameter from to feet
inch diameter from to feet
inch diameter from to feet

Describe and show depth of shoe, plug, adapter, liner or other details:

9. Perforated Casings or Screens:

3/4" x 6" from 14 to 24
(Number per foot and size of perforations, or describe screen)
from to
from to
from to

10. Log of Well: (Describe each stratum or formation clearly, indicate if water bearing, and give thickness and depth as indicated.)

MATERIAL	Thickness (Feet)	Depth to Bottom (Feet)
Sand loam	8	8
River gravel	6	14

CR - 458 A

13610

If log of well is not available, give name and address of driller. _____

11. Infiltration Trench: Covered or open _____

Dimensions: Length _____ ft. Minimum depth _____ ft. Maximum depth _____ ft.

Bottom width _____ ft. Discharge _____ g.p.m. Date of test _____

12. Tunnel: Type of lining _____

Dimensions: _____
(Length, course, and cross sectional size)

Position of water bearing stratum with reference to portal of tunnel _____

Log of tunnel: (Preceding table for log of well may be used, if desired. Give footage from portal and character of material, as pertinent.)

13. Pumping Equipment:

(a) Pump: Centrifugal 3" x 2" Fairbank Morse Capacity 200 g.p.m.
(Make, type and size)

(b) Motor: 10 H.P. Motor 3 phase
(Type and horsepower)

14. Location of area irrigated or to be irrigated, or place of use if for purposes other than irrigation:

Township North or South	Range E. or W. of Willamette Meridian	Section	Forty-acre Tract	Number Acres To Be Irrigated	Date of Reclamation
9 S	2 W	19	Site of Site	20	1941

15. If the ground water supply is supplemental to an existing water supply, identification of any application for a permit, permit, certificate or adjudicated right to appropriate water made or held by the registrant.

RECEIVED
FEB 04 2021
OWRD

13610 - 453 B

Township 2 S. Range 1 W. W.M.
North

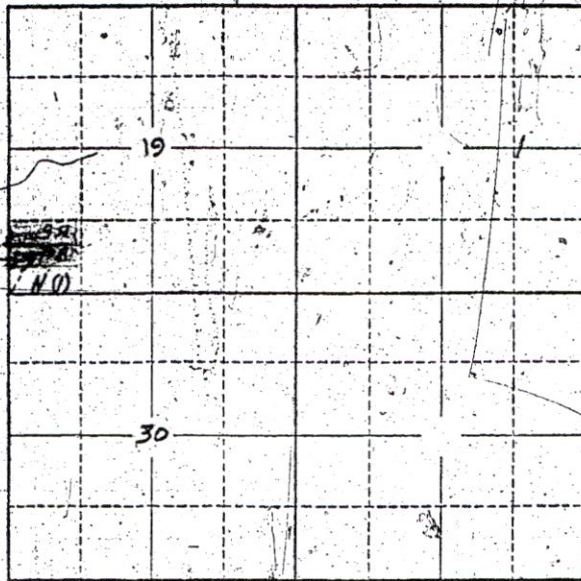

Locate well and acreage of irrigated land on plat.
Scale: 2" = 1 Mile

RECEIVED

FEB 04 2021

OWRD

STATE OF OREGON

County of Marion } ss.

I, Wesley Hofman being first duly sworn, do hereby certify that I have read the foregoing Registration Statement and that all of the items therein contained are true to the best of my knowledge and belief.

Wesley Hofman
(Signature of Registrant)

Subscribed and sworn to before me this 1st day of May, 1957

My commission expires 8/21/58
Paul H. Beebe
(Notary Public)

(SEAL)

See Page GR-453 G for
CERTIFICATE OF REGISTRATION

STATE OF OREGON

County of Marion } ss.

This is to certify that the foregoing Registration Statement was received in the office of the State Engineer on the 1st day of May, 1957, at Marion, Oregon, and has been duly recorded in said office in Book No. 106 Registration Statements on page 106

Construction shall be completed by 1958 and the water completely applied for beneficial use by 1958

Witness my hand this 1st day of May, 1957

13610
(State Engineer)

By _____
(Deputy)

GR - 453 C

RECEIVED
MAY 3 1957
STATE ENGINEER
SALEM, OREGON

REGISTRATION NO. GR 491
CERTIFICATE NO. GR 453

Registration Statement

OF CLAIMANT OF RIGHT TO APPROPRIATE GROUND WATER

(Under Chapter 708, Oregon Laws 1955.)

Well No. 2
West side of tract

RECEIVED
FEB 04 2021

TO THE STATE ENGINEER OF OREGON:

OWRD

I, Alfred, Carl and Lucile Hofmann

of Route 1, Box 109, Sunsville County of Marion

State of Oregon, do hereby make application for a certificate of registration as evidence of a right to appropriate ground water.

1. Source from which water is withdrawn is Pump well #2
(Flowing well, pump well, infiltration trench, or tunnel)

2. Location is: 4 miles SW of Stayton, Oregon
(Approximate distance and direction from nearest city or town)

and is more particularly described as follows:

(a) N. 61° 33' West 12.3 chains from S. E. Cor. of Sec. 24, T. 9 S., R. 2 W. 1.
(Give distance and bearing to corner of section or other legal subdivision)

being within SW 1/4 of SW 1/4 of Sec. 24, Twp. 9 S., Rge. 2 W.
(Smallest legal subdivision) (N. or S.) (E. or W.)

or (b) within limits of recorded platted property, town or city:

in Lot _____ Block _____ of _____
(Name of plat or addition)

_____ County of _____
(If within city or town, give name)

3. Construction Work was begun on 1939; was completed on 1939
(Date) (Date)

and the ground water claimed was first used for the purposes set out below on 1939
(Date)

since which time the water has been used continuously
(Continuously or Intermittently)

from March 15 to October 1
(Date) (Date)

4. Quantity of water claimed and used is 272 gallons per minute; 60 acre feet per year.

5. Purpose or Purposes for which water is used irrigation of new crops
(Domestic, irrigation, municipal, manufacturing, industrial, etc.)

6. Description of Well: Depth 26 feet. Type dug and drilled
(Dug or drilled)

3' 24" concrete tile diameter over 3' 4 1/2" inches. Elevation of ground at well site 335 feet, mean sea level.
(As near as known)

Depth to water table 11 feet.

7. Capacity of Well: 272 g.p.m. with _____ feet drawdown.

_____ g.p.m. with _____ feet drawdown.

Date of test _____ and duration _____

If Flowing Well: Measured discharge _____ g.p.m. on _____
(Date)

Shut-in pressure at ground surface _____ lbs. per sq. in. on _____
(Date)

Water is controlled by _____
(Cap, valve, etc.)

GR - 453 D

13610 -

8. Casing: (Give diameter, commercial specifications and depth below ground surface of each casing size.)

2 1/2 inch diameter from 0 to 18 feet
 3 inch diameter from 18 to 25 feet
 inch diameter from to feet
 inch diameter from to feet

Describe and show depth of shoe, plug, adapter, liner or other details:

9. Perforated Casings or Screens:

(Number per foot and size of perforations, or describe screen)
 3/16 x 5/8 from to
 from 18 to 24
 from to
 from to

10. Log of Well: (Describe each stratum or formation clearly, indicate if water bearing, and give thickness and depth as indicated.)

MATERIAL	Thickness (Feet)	Depth (to Bottom) (Feet)
Lead pipe	3	
Pipe	13	23

REEL 4051 PAGE 438
MARION COUNTY
BILL BURGESS, COUNTY CLERK
03-02-2018 02:53 pm.
Control Number 497548 \$
51.00
Instrument 2018 00010169

RECEIVED
FEB 04 2021
OWRD

Fidelity National Title # 60221705511

RECORDING REQUESTED BY:
Fidelity National Title
Company of Oregon

500 Liberty St. SE, Ste 200
Salem, OR 97301

GRANTOR'S NAME:
Tong Yang and Pa Nhia Thao

AFTER RECORDING RETURN TO:
Order No.: 60221705511-SK
Jose Robert Garcia
9312 Santiam Loop SE
Aumsville, OR 97325

SEND TAX STATEMENTS TO:
Jose Robert Garcia
9312 Santiam Loop SE
Aumsville, OR 97325

APN: R34934
Map: 091W19 01900
9312 Santiam Loop SE, Aumsville, OR 97325

SPACE ABOVE THIS LINE FOR RECORDER'S USE

STATUTORY WARRANTY DEED

Tong Yang and Pa Nhia Thao, Grantor, conveys and warrants to Jose Robert Garcia, Grantee, the following described real property, free and clear of encumbrances except as specifically set forth below, situated in the County of Marion, State of Oregon:

A tract of land situated in Section 19, Township 9 South, Range 1 West of the Willamette Meridian, in the County of Marion, State of Oregon, more particularly described as follows:

Commencing 55 rods North of the Southwest corner of Section 19 in Township 9 South, Range 1 West of the Willamette Meridian, Marion County, Oregon; thence East 80 rods; thence North 25 rods; thence West 80 rods; thence South 25 rods to the place of beginning, situated in Marion County, Oregon.

EXCEPTING THEREFROM the following described property:

Beginning at a point on the Easterly right-of-way line of County Road 945 in Section 19, Township 9 South, Range 1 West of the Willamette Meridian, Marion County, Oregon, which place of beginning is 80 rods North, along the Section line, and 54.72 feet North 89°54' East from the Southwest corner of said Section 19; running thence North 89°54' East 357.05 feet, along the Section Subdivision line; thence South 0°07'45" West 122.00 feet, on a line parallel to the Easterly right-of-way line of said county road; thence South 89°54' West 357.05 feet to said Easterly right-of-way line; thence North 0°07'45" East 122.00 feet to the point of beginning.

THE TRUE AND ACTUAL CONSIDERATION FOR THIS CONVEYANCE IS ONE HUNDRED THOUSAND AND NO/100 DOLLARS (\$100,000.00). (See ORS 93.030).

Subject to:

- I. The Land has been classified as farm land, as disclosed by the tax roll. If the Land becomes disqualified, said Land may be subject to additional taxes and/or penalties.
- II. Rights of the public to any portion of the Land lying within the area commonly known as streets, roads and/or highways.

BEFORE SIGNING OR ACCEPTING THIS INSTRUMENT, THE PERSON TRANSFERRING FEE TITLE SHOULD INQUIRE ABOUT THE PERSON'S RIGHTS, IF ANY, UNDER ORS 195.300, 195.301 AND 195.305 TO 195.336 AND SECTIONS 5 TO 11, CHAPTER 424, OREGON LAWS 2007, SECTIONS 2 TO 9 AND 17, CHAPTER 855, OREGON LAWS 2009, AND SECTIONS 2 TO 7, CHAPTER 8, OREGON LAWS 2010. THIS INSTRUMENT DOES NOT ALLOW USE OF THE PROPERTY DESCRIBED IN THIS INSTRUMENT IN VIOLATION OF APPLICABLE LAND USE LAWS AND REGULATIONS. BEFORE SIGNING OR ACCEPTING THIS INSTRUMENT, THE PERSON ACQUIRING FEE TITLE TO THE PROPERTY SHOULD CHECK WITH THE APPROPRIATE CITY OR COUNTY PLANNING DEPARTMENT TO VERIFY THAT THE UNIT OF LAND BEING TRANSFERRED IS A LAWFULLY ESTABLISHED LOT OR PARCEL, AS DEFINED IN ORS 92.010 OR 215.010, TO VERIFY THE APPROVED USES OF THE LOT OR PARCEL, TO DETERMINE ANY LIMITS ON LAWSUITS AGAINST FARMING OR FOREST PRACTICES, AS DEFINED IN ORS 30.930, AND TO INQUIRE ABOUT THE RIGHTS OF NEIGHBORING PROPERTY OWNERS, IF ANY, UNDER ORS 195.300, 195.301 AND 195.305 TO 195.336 AND SECTIONS 5 TO 11, CHAPTER 424, OREGON LAWS 2007, SECTIONS 2 TO 9 AND 17, CHAPTER 855, OREGON LAWS 2009, AND SECTIONS 2 TO 7, CHAPTER 8, OREGON LAWS 2010.

STATUTORY WARRANTY DEED
(continued)

RECEIVED

FEB 04 2021

OWRD

IN WITNESS WHEREOF, the undersigned have executed this document on the date(s) set forth below.

Dated: 3-2-18

Tong Yang

Pa Nhia Thao

State of OR
County of Marion

This instrument was acknowledged before me on 3/2/18 by Tong Yang and Pa Nhia Thao.

Mary Angeline Simmons
Notary Public - State of Oregon

My Commission Expires: 8/2/2019



RECEIVED

FEB 04 2021

OWRD

REEL: 4051

PAGE: 438

March 02, 2018, 02:53 pm.

CONTROL #: 497548

State of Oregon
County of Marion

I hereby certify that the attached instrument was received and duly recorded by me in Marion County records:

FEE: \$ 51.00

BILL BURGESS
COUNTY CLERK

THIS IS NOT AN INVOICE.

13610 -