

# Application for Permanent Water Right Transfer

## Part 1 of 5 – Minimum Requirements Checklist



Oregon Water Resources Department  
 725 Summer Street NE, Suite A  
 Salem, Oregon 97301-1266  
 (503) 986-0900  
 www.oregon.gov/OWRD

**This transfer application will be returned if Parts 1 through 5 and all required attachments are not completed and included.**  
 For questions, please call (503) 986-0900, and ask for Transfer Section.

RECEIVED

JUN 11 2021

OWRD

**Check all items included with this application. (N/A = Not Applicable)**

- Part 1 – Completed Minimum Requirements Checklist.
- Part 2 – Completed Transfer Application Map Checklist.
- Part 3 – Application Fee, payable by check to the Oregon Water Resources Department, and completed Fee Worksheet, page 3. Try the new online fee calculator at: [http://apps.wrd.state.or.us/apps/misc/wrd\\_fee\\_calculator](http://apps.wrd.state.or.us/apps/misc/wrd_fee_calculator). If you have questions, call Customer Service at (503) 986-0801.
- Part 4 – Completed Applicant Information and Signature.
- Part 5 – Information about Water Rights to be Transferred: **How many water rights are to be transferred? 9 List them here: 30166, 94039, 94040, 94041, 94042, 94043, 94044, 94045, 94046,**

Please include a separate Part 5 for each water right. (See instructions on page 6)

**Attachments:**

- Completed Transfer Application Map.
- Completed Evidence of Use Affidavit and supporting documentation.
- N/A Affidavit(s) of Consent from Landowner(s) (if the applicant does not own the land the water right is on.)
- N/A Supplemental Form D – For water rights served by or issued in the name of an irrigation district. Complete when the transfer applicant is not the irrigation district.
- N/A Oregon Water Resources Department’s Land Use Information Form with approval and signature (or signed land use form receipt stub) from each local land use authority in which water is to be diverted, conveyed, and/or used. Not required if water is to be diverted, conveyed, and/or used only on federal lands or if **all** of the following apply: a) a change in place of use only, b) no structural changes, c) the use of water is for irrigation only, and d) the use is located within an irrigation district or an exclusive farm use zone.
- N/A Water Well Report/Well Log for changes in point(s) of appropriation (well(s)) or additional point(s) of appropriation.
- N/A Geologist Report for a change from a surface water point of diversion to a ground water point of appropriation (well), if the proposed well is more than 500’ from the surface water source and more than 1000’ upstream or downstream from the point of diversion. See OAR 690-380-2130 for requirements and applicability.

**(For Staff Use Only)**

**WE ARE RETURNING YOUR APPLICATION FOR THE FOLLOWING REASON(S):**

<input type="checkbox"/> Application fee not enclosed/insufficient	<input type="checkbox"/> Map not included or incomplete
<input type="checkbox"/> Land Use Form not enclosed or incomplete	<input type="checkbox"/> Evidence of Use Form not enclosed or incomplete
<input type="checkbox"/> Additional signature(s) required	<input type="checkbox"/> Part _____ is incomplete

Other/Explanation \_\_\_\_\_

Staff: \_\_\_\_\_ 503-986-0\_\_\_\_\_ Date: \_\_\_\_/\_\_\_\_/\_\_\_\_



## Part 2 of 5 – Transfer Application Map

Your transfer application will be returned if any of the map requirements listed below are not met.

Please be sure that the transfer application map you submit includes all the required items and matches the existing water right map. Check all boxes that apply.

- N/A Certified Water Right Examiner (CWRE) Stamp and Original Signature. For a list of CWREs, see [http://apps.wrd.state.or.us/apps/wr/cwre\\_license\\_view/](http://apps.wrd.state.or.us/apps/wr/cwre_license_view/). CWRE stamp and signature are not required for substitutions.
- N/A If **more than three** water rights are involved, separate maps are needed for each water right.
- Permanent quality printed with dark ink on good quality paper.
- The size of the map can be 8½ x 11 inches, 8½ x 14 inches, 11 x 17 inches, or up to 30 x 30 inches. For 30 x 30 inch maps, one extra copy is required.
- A north arrow, a legend, and scale.
- The scale of the map must be: 1 inch = 400 feet, 1 inch = 1,320 feet, the scale of the Final Proof/Claim of Beneficial Use Map (the map used when the permit was certificated), the scale of the county assessor map if the scale is not smaller than 1 inch = 1,320 feet, or a scale that has been pre-approved by the Department.
- Township, Range, Section, ¼ ¼, DLC, Government Lot, and other recognized public land survey lines.
- Tax lot boundaries (property lines) are required. Tax lot numbers are recommended.
- Major physical features including rivers and creeks showing direction of flow, lakes and reservoirs, roads, and railroads.
- Major water delivery system features from the point(s) of diversion/appropriation such as main pipelines, canals, and ditches.
- Existing place of use that includes separate hachuring for each water right, priority date, and use including number of acres in each quarter-quarter section, government lot, or in each quarter-quarter section as projected within government lots, donation land claims, or other recognized public land survey subdivisions. If less than the entirety of the water right is being changed, a separate hachuring is needed for lands left unchanged.
- N/A Proposed place of use that includes separate hachuring for each water right, priority date, and use including number of acres in each quarter-quarter section, government lot, or in each quarter-quarter section as projected within government lots, donation land claims, or other recognized public land survey subdivisions.
- Existing point(s) of diversion or well(s) with distance and bearing or coordinates from a recognized survey corner. This information can be found in your water right certificate or permit.
- N/A If you are proposing a change in point(s) of diversion or well(s), show the proposed location and label it clearly with distance and bearing or coordinates. If GPS coordinates are used, latitude-longitude coordinates may be expressed as either degrees-minutes-seconds with at least one digit after the decimal (example – 42°32'15.5") or degrees-decimal with five or more digits after the decimal (example – 42.53764°).

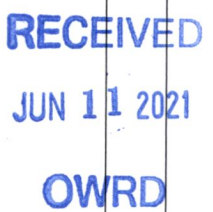

**Part 3 of 5 – Fee Worksheet**

FEE WORKSHEET for PERMANENT TRANSFER (except Substitution)			
1	Base Fee (includes one type of change to one water right for up to 1 cfs)	1	\$1,160
Types of change proposed: <input checked="" type="checkbox"/> Place of Use <input type="checkbox"/> Character of Use <input type="checkbox"/> Point of Diversion/Appropriation Number of above boxes checked = <u>1 (2a)</u> Subtract 1 from the number in line 2a = <u>0 (2b)</u> <i>If only one change, this will be 0</i>			
2	Multiply line 2b by \$930 and enter »	2	0
Number of water rights included in transfer <u>9 (3a)</u> Subtract 1 from the number in 3a above: <u>8 (3b)</u> <i>If only one water right this will be 0</i>		3	\$4,160
Do you propose to add or change a well, or change from a surface water POD to a well? <input checked="" type="checkbox"/> No: enter 0 » <input type="checkbox"/> Yes: enter \$410 »		4	0
Do you propose to change the place of use or character of use? <input type="checkbox"/> No: enter 0 on line 5 » <input checked="" type="checkbox"/> Yes: enter the cfs for the portions of the rights to be transferred (see example below*): <u>7.51 (5a)</u> Subtract 1.0 from the number in 5a above: <u>6.51 (5b)</u> If 5b is 0 or less, enter 0 on line 5 » If 5b is greater than 0, round up to the nearest whole number: <u>7 (5c)</u> and multiply 5c by \$350, then enter on line 5 » » » » » » » » » »		5	\$2,450
6	Add entries on lines 1 through 5 above » » » » » » » » » » Subtotal:	6	\$7,770
Is this transfer: <input type="checkbox"/> necessary to complete a project funded by the Oregon Watershed Enhancement Board (OWEB) under ORS 541.932? <input type="checkbox"/> endorsed in writing by ODFW as a change that will result in a net benefit to fish and wildlife habitat? If one or more boxes is checked, multiply line 6 by 0.5 and enter on line 7 » If no box is applicable, enter 0 on line 7 »		7	0
8	Subtract line 7 from line 6 » <b>Transfer Fee:</b>	8	<b>\$7,770</b>

\*Example for Line 5a calculation to transfer 45.0 acres of Primary Certificate 12345 (total 1.25 cfs for 100 acres) and 45.0 acres of Supplemental Certificate 87654 (1/80 cfs per acre) on the same land:

1. For irrigation calculate cfs for each water right involved as follows:
  - a. Divide total authorized cfs by total acres in the water right (for C12345,  $1.25 \text{ cfs} \div 100 \text{ ac}$ ); then multiply by the number of acres to be transferred to get the transfer cfs ( $\times 45 \text{ ac} = 0.56 \text{ cfs}$ ).
  - b. If the water right certificate does not list total cfs, but identifies the allowable use as 1/40 or 1/80 of a cfs per acre; multiply number of acres proposed for change by either 0.025 (1/40) or 0.0125 (1/80). (For C87654,  $45.0 \text{ ac} \times 0.0125 \text{ cfs/ac} = 0.56 \text{ cfs}$ )
2. Add cfs for the portions of water rights on all the land included in the transfer; however **do not count cfs for supplemental rights on acreage for which you have already calculated the cfs fee for the primary right on the same land.** The fee should be assessed only once for each “on the ground” acre included in the transfer. (In this example, blank 5a would be only 0.56 cfs, since both rights serve the same 45.0 acres. Blank 5b would be 0 and Line 5 would then also become 0).

FEE WORKSHEET for SUBSTITUTION			
1	Base Fee (includes change to one well)	1	\$840.00
Number of wells included in substitution _____ (2a) Subtract 1 from the number in 2a above: _____ (2b) <i>If only one well this will be 0</i>		2	N/A
2	Multiply line 2b by \$410 and enter »	2	N/A
3	Add entries on lines 1 through 2 above » » » » » » <b>Fee for Substitution:</b>	3	N/A



**Part 4 of 5 – Applicant Information and Signature**

**Applicant Information**

APPLICANT/BUSINESS NAME <b>Dennis MacNab</b>		PHONE NO. <b>(541) 296-2447</b>	ADDITIONAL CONTACT NO.
ADDRESS <b>1215 Dry Hollow Road</b>		FAX NO.	
CITY <b>The Dalles</b>	STATE <b>OR</b>	ZIP <b>97058</b>	E-MAIL <b>info@highlandhillsranch.com</b>
BY PROVIDING AN E-MAIL ADDRESS, CONSENT IS GIVEN TO RECEIVE ALL CORRESPONDENCE FROM THE DEPARTMENT ELECTRONICALLY. COPIES OF THE FINAL ORDER DOCUMENTS WILL ALSO BE MAILED.			

**Agent Information** – The agent is authorized to represent the applicant in all matters relating to this application.

AGENT/BUSINESS NAME <b>Molly Reid, GeoEngineers, Inc.</b>		PHONE NO. <b>(509) 209-2846</b>	ADDITIONAL CONTACT NO. <b>(541) 310-7264 CELL</b>
ADDRESS <b>8019 W. Quinault Avenue, Suite 201</b>		FAX NO.	
CITY <b>Kennewick</b>	STATE <b>WA</b>	ZIP <b>99336</b>	E-MAIL <b>mreid@geoengineers.com</b>
BY PROVIDING AN E-MAIL ADDRESS, CONSENT IS GIVEN TO RECEIVE ALL CORRESPONDENCE FROM THE DEPARTMENT ELECTRONICALLY. COPIES OF THE FINAL ORDER DOCUMENTS WILL ALSO BE MAILED.			

Explain in your own words what you propose to accomplish with this transfer application, and why: Filing this permanent transfer application to accurately show where irrigation is currently occurring.  
If you need additional space, continue on a separate piece of paper and attach to the application as "Attachment 1".

**Check One Box**

- By signing this application, I understand that, upon receipt of the draft preliminary determination and prior to Department approval of the transfer, I will be required to provide landownership information and evidence that I am authorized to pursue the transfer as identified in OAR 690-380-4010(5); **OR**
- I affirm the applicant is a municipality as defined in ORS 540.510(3)(b) and that the right is in the name of the municipality or a predecessor; **OR**
- I affirm the applicant is an entity with the authority to condemn property and is acquiring by condemnation the property to which the water right proposed for transfer is appurtenant and have supporting documentation.

**By my signature below, I confirm that I understand:**

- Prior to Department approval of the transfer application, I may be required to submit payment to the Department for publication of a notice in a newspaper with general circulation in the area where the water right is located, once per week for two consecutive weeks. If more than one qualifying newspaper is available, I suggest publishing the notice in the following newspaper: Condon Times Journal.
- Amendments to the application may only be made in response to the Department’s Draft Preliminary Determination (DPD). The applicant will have a period of at least 30 days to amend the application to address any issues identified by the Department in the DPD, or to withdraw the application. Note that amendments may be subject to additional fees, pursuant to ORS 536.050.
- Failure to complete an approved change in place of use and/or change in character of use, will result in loss of the water right (OAR 690-380-6010).

**I (we) affirm that the information contained in this application is true and accurate.**

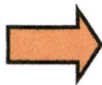

*[Handwritten Signature]*  
Applicant signature

**Dennis MacNab**  
Print Name (and Title if applicable)

*5/31/21*  
Date

Applicant signature

Print Name (and Title if applicable)

Date

**RECEIVED**  
**JUN 11 2021**  
**OWRD**

Is the applicant the sole owner of the land on which the water right, or portion thereof, proposed for transfer is located?  Yes  No *If NO, include signatures of all deeded landowners (and mailing and/or e-mail addresses if different than the applicant’s) or attach affidavits of consent (and mailing and/or e-mail addresses) from all landowners or individuals/entities to which the water right(s) were conveyed.*



Check the following boxes that apply:

- The applicant is responsible for completion of change(s). Notices and correspondence should continue to be sent to the applicant.
- The receiving landowner will be responsible for completing the proposed change(s) after the final order is issued. Copies of notices and correspondence should be sent to this landowner.
- Both the receiving landowner and applicant will be responsible for completion of change(s). Copies of notices and correspondence should be sent to this landowner and the applicant.

At this time, are the lands in this transfer application in the process of being sold?  Yes  No

If YES, and you know who the new landowner will be, please complete the receiving landowner information table below. If you do not know who the new landowner will be, then a request for assignment will have to be filed for at a later date.

If a property sells, the certificated water right(s) located on the land belong to the new owner, unless a sale agreement or other document states otherwise. For more information see:

[https://www.oregon.gov/owrd/WRDFormsPDF/Transfer\\_Property\\_Transactions.pdf](https://www.oregon.gov/owrd/WRDFormsPDF/Transfer_Property_Transactions.pdf)

RECEIVING LANDOWNER NAME <b>Non-Applicable</b>			PHONE NO.	ADDITIONAL CONTACT NO.
ADDRESS				FAX NO.
CITY	STATE	ZIP	E-MAIL	

Describe any special ownership circumstances here: \_\_\_\_\_

- Check here if any of the water rights proposed for transfer are or will be located within or served by an irrigation or other water district. (**Tip: Complete and attach Supplemental Form D.**)

IRRIGATION DISTRICT NAME <b>Non-Applicable</b>	ADDRESS	
CITY	STATE	ZIP

- Check here if water for any of the rights supplied under a water service agreement or other contract for stored water with a federal agency or other entity.

ENTITY NAME <b>Non-Applicable</b>	ADDRESS	
CITY	STATE	ZIP

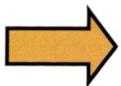

To meet State Land Use Consistency Requirements, you must list all county, city, municipal corporation, or tribal governments within whose jurisdiction water will be diverted, conveyed or used.

ENTITY NAME <b>Gilliam County Planning Department</b>	ADDRESS <b>221 S. Oregon Street</b>	
CITY <b>Condon</b>	STATE <b>OR</b>	ZIP <b>97823</b>

ENTITY NAME	ADDRESS	
CITY	STATE	ZIP

**RECEIVED**  
**JUN 11 2021**



**Part 5 of 5 – Water Right Information**

Please use a separate Part 5 for each water right being changed. See instructions on page 6, to copy and paste additional Part 5s, or to add rows to tables within the form.

**Water Right Certificate # 30166**

**RECEIVED**

**JUN 11 2021**

**Description of Water Delivery System**

System capacity: 2.0 cubic feet per second (cfs) **OR**  
 \_\_\_\_\_ gallons per minute (gpm)

**OWRD**

Describe the current water delivery system or the system that was in place at some time within the last five years. Include information on the pumps, canals, pipelines, and sprinklers used to divert, convey, and apply the water at the authorized place of use. **Surface water is provided by a screened inlet to a 75hp pressure pump that feeds a 10 inch mainline that can serve all lands North and South of the POD.**

**Table 1. Location of Authorized and Proposed Point(s) of Diversion (POD) or Appropriation (POA)**

(Note: If the POD/POA name is not specified on the certificate, assign it a name or number here.)

POD/POA Name or Number	Is this POD/POA Authorized on the Certificate or is it Proposed?	If POA, OWRD Well Log ID# (or Well ID Tag # L-___)	Twp	Rng	Sec	¼	¼	Tax Lot, DLC or Gov't Lot	Measured Distances (from a recognized survey corner)
<b>POD 1 Rock Cr</b>	<input checked="" type="checkbox"/> Authorized <input type="checkbox"/> Proposed	N/A	2 S	22 E	27	NE	NE	1300	1200 feet S and 110 feet W from the NE Corner, Section 27
<b>Portable Pumps</b>	<input checked="" type="checkbox"/> Authorized <input type="checkbox"/> Proposed	N/A	2 S	22 E	15	SE	SW	1300	Portable pump – no metes and bounds descriptions provided
<b>Portable Pumps</b>	<input checked="" type="checkbox"/> Authorized <input type="checkbox"/> Proposed	N/A	2 S	22 E	22	NW	NE	1300	Additional portable pumps located in NESE, SESE, Section 22 – no metes and bounds description provided
<b>Portable Pumps</b>	<input checked="" type="checkbox"/> Authorized <input type="checkbox"/> Proposed	N/A	2 S	22 E	27	NE	SE	1300	Additional portable pump located in SESE, Section 27 – no metes and bounds description provided

**Check all type(s) of change(s) proposed below (change “CODES” are provided in parentheses):**

- Place of Use (POU)  Appropriation/Well (POA)
- Point of Diversion (POD)  Additional Point of Appropriation (APOA)
- Additional Point of Diversion (APOD)

**Will all of the proposed changes affect the entire water right?**

- Yes Complete only the Proposed (“to” lands) section of Table 2 on the next page. Use the “CODES” listed above to describe the proposed changes.
- No Complete all of Table 2 to describe the portion of the water right to be changed.

**13739**



Please use and attach additional pages of Table 2 as needed.  
See page 6 for instructions.

Do you have questions about how to fill-out the tables?  
Contact the Department at 503-986-0900 and ask for Transfer Staff.

**Table 2. Description of Changes to Water Right Certificate # 30166**

List only the part of the right that will be changed. For the acreage in each ¼ ¼, list the change proposed. If more than one change, specify the acreage associated with each change. If more than one POD/POA, specify the acreage associated with each POD/POA.

AUTHORIZED (the "from" or "off" lands) The listing that appears on the Certificate BEFORE PROPOSED CHANGES List only that part or portion of the water right that will be changed.													Proposed Changes (see "CODES" from previous page)	PROPOSED (the "to" or "on" lands) The listing as it would appear AFTER PROPOSED CHANGES are made.												
Twp	Rng	Sec	¼	¼	Tax Lot	Gvt Lot or DLC	Acres	Type of USE listed on Certificate	POD(s) or POA(s) (name or number from Table 1)	Priority Date	Twp	Rng		Sec	¼	¼	Tax Lot	Gvt Lot or DLC	Acres	New Type of USE	POD(s)/ POA(s) to be used (from Table 1)	Priority Date				
2	S	22	E	15	SE	SW	1300		0.2	IR	Rock Cr	1953	POU	2	S	22	E	15	SW	SE	1300		23.1	IR	Rock Cr	1953
2	S	22	E	15	SW	SE	1300		21.8	IR	Rock Cr	1953	POU	2	S	22	E	22	NW	NE	1300		6.2	IR	Rock Cr	1953
2	S	22	E	22	NE	NE	1300		2.8	IR	Rock Cr	1953	POU	2	S	22	E	22	SE	NE	1300		19.2	IR	Rock Cr	1953
2	S	22	E	22	NW	NE	1300		1.0	IR	Rock Cr	1953	POU	2	S	22	E	22	NE	SE	1300		8.3	IR	Rock Cr	1953
2	S	22	E	22	SE	NE	1300		22.8	IR	Rock Cr	1953	POU	2	S	22	E	22	SE	SE	1300		1.1	IR	Rock Cr	1953
2	S	22	E	22	NE	SE	1300		7.5	IR	Rock Cr	1953	POU	2	S	22	E	23	SW	NW	1300		7.8	IR	Rock Cr	1953
2	S	22	E	22	SE	SE	1300		7.6	IR	Rock Cr	1953	POU	2	S	22	E	23	NW	SW	1300		13.9	IR	Rock Cr	1953
2	S	22	E	23	SW	NW	1300		2.4	IR	Rock Cr	1953	POU	2	S	22	E	23	SW	SW	1300		10.9	IR	Rock Cr	1953
2	S	22	E	23	NW	SW	1300		7.6	IR	Rock Cr	1953	POU	2	S	22	E	26	NW	NW	1300		25.4	IR	Rock Cr	1953
2	S	22	E	23	SW	SW	1300		6.9	IR	Rock Cr	1953	POU	2	S	22	E	26	SW	NW	1300		7.1	IR	Rock Cr	1953
2	S	22	E	26	NW	NW	1300		17.0	IR	Rock Cr	1953	POU	2	S	22	E	26	NW	SW	1300		15.2	IR	Rock Cr	1953
2	S	22	E	26	SW	NW	1300		10.3	IR	Rock Cr	1953	POU	2	S	22	E	26	SW	SW	1300		0.3	IR	Rock Cr	1953
TOTAL ACRES													TOTAL ACRES													

Additional remarks: **See following page for total of Certificate 30166**

RECEIVED  
TACS  
JUN 11 2021

13739



Please use and attach additional pages of Table 2 as needed.  
See page 6 for instructions.

Do you have questions about how to fill-out the tables?  
Contact the Department at 503-986-0900 and ask for Transfer Staff.

**Table 2. Description of Changes to Water Right Certificate # 30166**

List only the part of the right that will be changed. For the acreage in each ¼ ¼, list the change proposed. If more than one change, specify the acreage

AUTHORIZED (the "from" or "off" lands) The listing that appears on the Certificate BEFORE PROPOSED CHANGES List only that part or portion of the water right that will be changed.												Proposed Changes (see "CODES" from previous page)	PROPOSED (the "to" or "on" lands) The listing as it would appear AFTER PROPOSED CHANGES are made.													
Twp	Rng	Sec	¼ ¼	Tax Lot	Gvt Lot or DLC	Acres	Type of USE listed on Certificate	POD(s) or POA(s) (name or number from Table 1)	Priority Date	Twp	Rng		Sec	¼ ¼	Tax Lot	Gvt Lot or DLC	Acres	New Type of USE	POD(s)/ POA(s) to be used (from Table 1)	Priority Date						
2	S	22	E	26	NW	SW	1300		10.0	IR	Rock Cr	1953	POU	2	S	22	E	27	NE	NE	1300		2.4	IR	Rock Cr	1953
2	S	22	E	27	NE	NE	1300		13.5	IR	Rock Cr	1953	POU	2	S	22	E	27	SE	NE	1300		0.1	IR	Rock Cr	1953
2	S	22	E	27	SE	NE	1300		4.9	IR	Rock Cr	1953	POU	2	S	22	E	27	NE	SE	1300		10.8	IR	Rock Cr	1953
2	S	22	E	27	NE	SE	1300		14.3	IR	Rock Cr	1953	POU	2	S	22	E	27	SE	SE	1300		0.4	IR	Rock Cr	1953
2	S	22	E	27	SE	SE	1300		1.6	IR	Rock Cr	1953	POU													
						TOTAL ACRES						152.2							TOTAL ACRES						152.2	

Additional remarks: **The remaining PODs listed on Certificate 30166 by quarter-quarter are portable pumps and currently are not used. The authorized Rock Creek POD in the NENE Section 27 is the only POD currently used for this water right at this time. A metes and bounds description has been added to correctly reflect this location of the POD.**

RECEIVED  
JUN 11 2021

OWRD

TACS

13739



## Part 5 of 5 – Water Right Information

Please use a separate Part 5 for each water right being changed. See instructions on page 6, to copy and paste additional Part 5s, or to add rows to tables within the form.

Water Right Certificate # 94039

### Description of Water Delivery System

System capacity: **0.43** cubic feet per second (cfs) **OR**  
 \_\_\_\_\_ gallons per minute (gpm)

Describe the current water delivery system or the system that was in place at some time within the last five years. Include information on the pumps, canals, pipelines, and sprinklers used to divert, convey, and apply the water at the authorized place of use. **Surface water is provided by a screened inlet to a 75hp pressure pump that feeds a 10 inch mainline that can serve all lands North and South of the POD.**

**Table 1. Location of Authorized and Proposed Point(s) of Diversion (POD) or Appropriation (POA)**

(Note: If the POD/POA name is not specified on the certificate, assign it a name or number here.)

POD/POA Name or Number	Is this POD/POA Authorized on the Certificate or is it Proposed?	If POA, OWRD Well Log ID# (or Well ID Tag # L-___)	Twp		Rng		Sec	¼ ¼		Tax Lot, DLC or Gov't Lot	Measured Distances (from a recognized survey corner)
Ditch	<input checked="" type="checkbox"/> Authorized <input type="checkbox"/> Proposed	N/A									Nichols and Fletcher Ditch per certificate
POD 1 Rock Cr	<input checked="" type="checkbox"/> Authorized <input type="checkbox"/> Proposed	N/A	2	S	22	E	27	NE	NE	1300	1200 feet S and 110 feet W from the NE Corner, Section 27

**Check all type(s) of change(s) proposed below (change "CODES" are provided in parentheses):**

- |   |   |
|---|---|
| <input checked="" type="checkbox"/> Place of Use (POU)        | <input type="checkbox"/> Appropriation/Well (POA)                 |
| <input type="checkbox"/> Point of Diversion (POD)             | <input type="checkbox"/> Additional Point of Appropriation (APOA) |
| <input type="checkbox"/> Additional Point of Diversion (APOD) |   |

**Will all of the proposed changes affect the entire water right?**

- Yes      Complete only the Proposed ("to" lands) section of Table 2 on the next page. Use the "CODES" listed above to describe the proposed changes.
- No      Complete all of Table 2 to describe the portion of the water right to be changed.

RECEIVED

JUN 11 2021

OWRD

Please use and attach additional pages of Table 2 as needed.  
See page 6 for instructions.

Do you have questions about how to fill-out the tables?  
Contact the Department at 503-986-0900 and ask for Transfer Staff.

**Table 2. Description of Changes to Water Right Certificate # 94039**

List only the part of the right that will be changed. For the acreage in each ¼ ¼, list the change proposed. If more than one change, specify the acreage associated with each change. If more than one POD/POA, specify the acreage associated with each POD/POA.

AUTHORIZED (the "from" or "off" lands) The listing that appears on the Certificate BEFORE PROPOSED CHANGES List only that part or portion of the water right that will be changed.											Proposed Changes (see "CODES" from previous page)	PROPOSED (the "to" or "on" lands) The listing as it would appear AFTER PROPOSED CHANGES are made.														
Twp	Rng	Sec	¼	¼	Tax Lot	Gvt Lot or DLC	Acres	Type of USE listed on Certificate	POD(s) or POA(s) (name or number from Table 1)	Priority Date		Twp	Rng	Sec	¼	¼	Tax Lot	Gvt Lot or DLC	Acres	New Type of USE	POD(s)/ POA(s) to be used (from Table 1)	Priority Date				
2	S	22	E	15	SE	SW	1300		2.4	IR	Rock Cr	1897	POU	2	S	22	E	27	NE	NE	1300		3.5	IR	Rock Cr	1897
2	S	22	E	15	SW	SE	1300		1.0	IR	Rock Cr	1897	POU	2	S	22	E	27	SE	NE	1300		3.45	IR	Rock Cr	1897
2	S	22	E	22	NW	NE	1300		9.0	IR	Rock Cr	1897	POU	2	S	22	E	27	NE	SE	1300		2.8	IR	Rock Cr	1897
2	S	22	E	22	SW	NE	1300		5.0	IR	Rock Cr	1897	POU	2	S	22	E	27	NW	SE	1300		0.65	IR	Rock Cr	1897
													POU	2	S	22	E	27	SW	SE	1300		0.1	IR	Rock Cr	1897
													POU	2	S	22	E	27	SE	SE	1300		6.9	IR	Rock Cr	1897
TOTAL ACRES							17.4												TOTAL ACRES							17.4

Additional remarks: \_\_\_\_\_

RECEIVED

JUN 11 2021

TACS

OWRD 13739



**Part 5 of 5 – Water Right Information**

Please use a separate Part 5 for each water right being changed. See instructions on page 6, to copy and paste additional Part 5s, or to add rows to tables within the form.

**Water Right Certificate # 94040**

**Description of Water Delivery System**

System capacity: **0.21** cubic feet per second (cfs) **OR**  
 \_\_\_\_\_ gallons per minute (gpm)

Describe the current water delivery system or the system that was in place at some time within the last five years. Include information on the pumps, canals, pipelines, and sprinklers used to divert, convey, and apply the water at the authorized place of use. **Surface water is provided by a screened inlet to a 75hp pressure pump that feeds a 10 inch mainline that can serve all lands North and South of the POD.**

**Table 1. Location of Authorized and Proposed Point(s) of Diversion (POD) or Appropriation (POA)**

(Note: If the POD/POA name is not specified on the certificate, assign it a name or number here.)

POD/POA Name or Number	Is this POD/POA Authorized on the Certificate or is it Proposed?	If POA, OWRD Well Log ID# (or Well ID Tag # L-___)	Twp		Rng		Sec	¼ ¼		Tax Lot, DLC or Gov't Lot	Measured Distances (from a recognized survey corner)
Ditch	<input checked="" type="checkbox"/> Authorized <input type="checkbox"/> Proposed	N/A									Dam and Moore Ditch per certificate
POD 1 Rock Cr	<input checked="" type="checkbox"/> Authorized <input type="checkbox"/> Proposed	N/A	2	S	22	E	27	NE	NE	1300	1200 feet S and 110 feet W from the NE Corner, Section 27

**Check all type(s) of change(s) proposed below (change "CODES" are provided in parentheses):**

- Place of Use (POU)  Appropriation/Well (POA)
- Point of Diversion (POD)  Additional Point of Appropriation (APOA)
- Additional Point of Diversion (APOD)

**Will all of the proposed changes affect the entire water right?**

- Yes Complete only the Proposed ("to" lands) section of Table 2 on the next page. Use the "CODES" listed above to describe the proposed changes.
- No Complete all of Table 2 to describe the portion of the water right to be changed.

**RECEIVED**  
**JUN 11 2021**  
**OWRD**



Please use and attach additional pages of Table 2 as needed.  
See page 6 for instructions.

Do you have questions about how to fill-out the tables?  
Contact the Department at 503-986-0900 and ask for Transfer Staff.

**Table 2. Description of Changes to Water Right Certificate # 94040**

List only the part of the right that will be changed. For the acreage in each ¼ ¼, list the change proposed. If more than one change, specify the acreage associated with each change. If more than one POD/POA, specify the acreage associated with each POD/POA.

AUTHORIZED (the "from" or "off" lands) The listing that appears on the Certificate BEFORE PROPOSED CHANGES List only that part or portion of the water right that will be changed.													Proposed Changes (see "CODES" from previous page)	PROPOSED (the "to" or "on" lands) The listing as it would appear AFTER PROPOSED CHANGES are made.														
Twp	Rng	Sec	¼	¼	Tax Lot	Gvt Lot or DLC	Acres	Type of USE listed on Certificate	POD(s) or POA(s) (name or number from Table 1)	Priority Date	Twp	Rng		Sec	¼	¼	Tax Lot	Gvt Lot or DLC	Acres	New Type of USE	POD(s)/ POA(s) to be used (from Table 1)	Priority Date						
2	S	22	E	26	SW	NW	1300		2.8	IR	Rock Cr	1902	POU	2	S	22	E	26	NW	NW	1300		1.8	IR	Rock Cr	1902		
2	S	22	E	27	SE	NE	1300		5.6	IR	Rock Cr	1902	POU	2	S	22	E	26	SW	NW	1300		0.6	IR	Rock Cr	1902		
													POU	2	S	22	E	27	NE	NE	1300		6.0	IR	Rock Cr	1902		
TOTAL ACRES							8.4														TOTAL ACRES							8.4

RECEIVED  
JUN 11 2021  
OWRD

Additional remarks:

**Part 5 of 5 – Water Right Information**

Please use a separate Part 5 for each water right being changed. See instructions on page 6, to copy and paste additional Part 5s, or to add rows to tables within the form.

**Water Right Certificate # 94041**

**Description of Water Delivery System**

System capacity: **0.33** cubic feet per second (cfs) **OR**  
 \_\_\_\_\_ gallons per minute (gpm)

Describe the current water delivery system or the system that was in place at some time within the last five years. Include information on the pumps, canals, pipelines, and sprinklers used to divert, convey, and apply the water at the authorized place of use. **Surface water is provided by a screened inlet to a 75hp pressure pump that feeds a 10 inch mainline that can serve all lands North and South of the POD.**

**Table 1. Location of Authorized and Proposed Point(s) of Diversion (POD) or Appropriation (POA)**

(Note: If the POD/POA name is not specified on the certificate, assign it a name or number here.)

POD/POA Name or Number	Is this POD/POA Authorized on the Certificate or is it Proposed?	If POA, OWRD Well Log ID# (or Well ID Tag # L-___)	Twp	Rng	Sec	¼	¼	Tax Lot, DLC or Gov't Lot	Measured Distances (from a recognized survey corner)
Nichols Ditch	<input checked="" type="checkbox"/> Authorized <input type="checkbox"/> Proposed	N/A							Nichols and Fletcher Ditch per certificate – no metes and bounds description provided
POD 1 Rock Cr	<input checked="" type="checkbox"/> Authorized <input type="checkbox"/> Proposed	N/A	2 S	22 E	27	NE	NE	1300	1200 feet S and 110 feet W from the NE Corner, Section 27

**Check all type(s) of change(s) proposed below (change “CODES” are provided in parentheses):**

- Place of Use (POU)  Appropriation/Well (POA)
- Point of Diversion (POD)  Additional Point of Appropriation (APOA)
- Additional Point of Diversion (APOD)

**Will all of the proposed changes affect the entire water right?**

- Yes Complete only the Proposed (“to” lands) section of Table 2 on the next page. Use the “CODES” listed above to describe the proposed changes.
- No Complete all of Table 2 to describe the portion of the water right to be changed.

**RECEIVED**

**JUN 11 2021**

**OWRD**



Please use and attach additional pages of Table 2 as needed.  
See page 6 for instructions.

Do you have questions about how to fill-out the tables?  
Contact the Department at 503-986-0900 and ask for Transfer Staff.

**Table 2. Description of Changes to Water Right Certificate # 94041**

List only the part of the right that will be changed. For the acreage in each ¼ ¼, list the change proposed. If more than one change, specify the acreage associated with each change. If more than one POD/POA, specify the acreage associated with each POD/POA.

AUTHORIZED (the "from" or "off" lands) The listing that appears on the Certificate BEFORE PROPOSED CHANGES List only that part or portion of the water right that will be changed.												Proposed Changes (see "CODES" from previous page)	PROPOSED (the "to" or "on" lands) The listing as it would appear AFTER PROPOSED CHANGES are made.													
Twp	Rng	Sec	¼	¼	Tax Lot	Gvt Lot or DLC	Acres	Type of USE listed on Certificate	POD(s) or POA(s) (name or number from Table 1)	Priority Date	Twp		Rng	Sec	¼	¼	Tax Lot	Gvt Lot or DLC	Acres	New Type of USE	POD(s)/ POA(s) to be used (from Table 1)	Priority Date				
2	S	22	E	22	NE	SE	1300		12.5	IR	Rock Cr	1905	POU	2	S	22	E	22	NW	NE	1300		2.7	IR	Rock Cr	1905
2	S	22	E	22	NW	SE	1300		0.4	IR	Rock Cr	1905	POU	2	S	22	E	22	SW	NE	1300		4.4	IR	Rock Cr	1905
2	S	22	E	22	SE	SE	1300		0.4	IR	Rock Cr	1905	POU	2	S	22	E	22	SE	NE	1300		6.2	IR	Rock Cr	1905
TOTAL ACRES							13.3												TOTAL ACRES							13.3

Additional remarks: :

RECEIVED

JUN 11 2021

OWRD

TACS

13739

## Part 5 of 5 – Water Right Information

Please use a separate Part 5 for each water right being changed. See instructions on page 6, to copy and paste additional Part 5s, or to add rows to tables within the form.

### Water Right Certificate # 94042

#### Description of Water Delivery System

System capacity: 0.18 cubic feet per second (cfs) **OR**  
 \_\_\_\_\_ gallons per minute (gpm)

Describe the current water delivery system or the system that was in place at some time within the last five years. Include information on the pumps, canals, pipelines, and sprinklers used to divert, convey, and apply the water at the authorized place of use. **Surface water is provided by a screened inlet to a 75hp pressure pump that feeds a 10 inch mainline that can serve all lands North and South of the POD.**

**Table 1. Location of Authorized and Proposed Point(s) of Diversion (POD) or Appropriation (POA)**

(Note: If the POD/POA name is not specified on the certificate, assign it a name or number here.)

POD/POA Name or Number	Is this POD/POA Authorized on the Certificate or is it Proposed?	If POA, OWRD Well Log ID# (or Well ID Tag # L-___)	Twp		Rng		Sec	¼ ¼		Tax Lot, DLC or Gov't Lot	Measured Distances (from a recognized survey corner)
<b>Original</b>	<input checked="" type="checkbox"/> Authorized <input type="checkbox"/> Proposed	N/A	3	S	22	E	3	NW	NW		Not listed on certificate
<b>POD 1 Rock Cr</b>	<input checked="" type="checkbox"/> Authorized <input type="checkbox"/> Proposed	N/A	2	S	22	E	27	NE	NE	1300	1200 feet S and 110 feet W from NE Corner, Section 27

**Check all type(s) of change(s) proposed below (change "CODES" are provided in parentheses):**

- |   |   |
|---|---|
| <input checked="" type="checkbox"/> Place of Use (POU)        | <input type="checkbox"/> Appropriation/Well (POA)                 |
| <input type="checkbox"/> Point of Diversion (POD)             | <input type="checkbox"/> Additional Point of Appropriation (APOA) |
| <input type="checkbox"/> Additional Point of Diversion (APOD) |   |

**Will all of the proposed changes affect the entire water right?**

- Yes      Complete only the Proposed ("to" lands) section of Table 2 on the next page. Use the "CODES" listed above to describe the proposed changes.
- No      Complete all of Table 2 to describe the portion of the water right to be changed.

**RECEIVED**

**JUN 11 2021**

**OWRD**



Please use and attach additional pages of Table 2 as needed.  
See page 6 for instructions.

Do you have questions about how to fill-out the tables?  
Contact the Department at 503-986-0900 and ask for Transfer Staff.

**Table 2. Description of Changes to Water Right Certificate # 94042**

List only the part of the right that will be changed. For the acreage in each ¼ ¼, list the change proposed. If more than one change, specify the acreage associated with each change. If more than one POD/POA, specify the acreage associated with each POD/POA.

AUTHORIZED (the "from" or "off" lands) The listing that appears on the Certificate BEFORE PROPOSED CHANGES List only that part or portion of the water right that will be changed.											Proposed Changes (see "CODES" from previous page)	PROPOSED (the "to" or "on" lands) The listing as it would appear AFTER PROPOSED CHANGES are made.														
Twp	Rng	Sec	¼	¼	Tax Lot	Gvt Lot or DLC	Acres	Type of USE listed on Certificate	POD(s) or POA(s) (name or number from Table 1)	Priority Date		Twp	Rng	Sec	¼	¼	Tax Lot	Gvt Lot or DLC	Acres	New Type of USE	POD(s)/ POA(s) to be used (from Table 1)	Priority Date				
2	S	22	E	27	NE	SE	1300		4.0	IR	Rock Cr	1924	POU	2	S	22	E	26	SW	NW	1300		2.4	IR	Rock Cr	1924
2	S	22	E	27	SE	SE	1300		9.0	IR	Rock Cr	1924	POU	2	S	22	E	26	NE	SW	13600		4.5	IR	Rock Cr	1924
													POU	2	S	22	E	26	NE	SE	1300		1.8	IR	Rock Cr	1924
													POU	2	S	22	E	26	NW	SE	1300		2.7	IR	Rock Cr	1924
													POU	2	S	22	E	27	SE	NE	1300		1.6	IR	Rock Cr	1924
							TOTAL ACRES	13.0												TOTAL ACRES	13.0					

RECEIVED  
JUN 11 2021  
OWRD

Additional remarks:

**Part 5 of 5 – Water Right Information**

Please use a separate Part 5 for each water right being changed. See instructions on page 6, to copy and paste additional Part 5s, or to add rows to tables within the form.

**Water Right Certificate # 94043**

**Description of Water Delivery System**

System capacity: 0.61 cubic feet per second (cfs) **OR**  
 \_\_\_\_\_ gallons per minute (gpm)

Describe the current water delivery system or the system that was in place at some time within the last five years. Include information on the pumps, canals, pipelines, and sprinklers used to divert, convey, and apply the water at the authorized place of use. **Groundwater is provided by 4 wells serving a 10 inch mainline. Laterals of 8, 6 and 4 inches provide control of the distribution system. The lowlands are irrigated with hand line and wheel line setups with circles on the upper benches. The orchards are served with micro sprinkler systems.**

**Table 1. Location of Authorized and Proposed Point(s) of Diversion (POD) or Appropriation (POA)**

(Note: If the POD/POA name is not specified on the certificate, assign it a name or number here.)

POD/POA Name or Number	Is this POD/POA Authorized on the Certificate or is it Proposed?	If POA, OWRD Well Log ID# (or Well ID Tag # L-___)	Twp		Rng		Sec	¼ ¼		Tax Lot, DLC or Gov't Lot	Measured Distances (from a recognized survey corner)
Well 1	<input checked="" type="checkbox"/> Authorized <input type="checkbox"/> Proposed	GILL 154	2	S	22	E	26	NW	NW	1300	4000 feet N and 170 feet E from SW Corner, Section 26
Well 2	<input checked="" type="checkbox"/> Authorized <input type="checkbox"/> Proposed	GILL 155	2	S	22	E	26	SE	NW	1300	3070 feet N and 1560 feet E from SW Corner, Section 26
Well 3	<input checked="" type="checkbox"/> Authorized <input type="checkbox"/> Proposed	GILL 151	2	S	22	E	23	SW	SW	1300	1320 feet N and 80 feet E from SE Corner, Section 22
Well 4	<input checked="" type="checkbox"/> Authorized <input type="checkbox"/> Proposed	GILL 149	2	S	22	E	15	SW	SE	1300	50 feet N and 2480 feet W from SE Corner, Section 15

**Check all type(s) of change(s) proposed below (change "CODES" are provided in parentheses):**

- Place of Use (POU)  Appropriation/Well (POA)
- Point of Diversion (POD)  Additional Point of Appropriation (APOA)
- Additional Point of Diversion (APOD)

**Will all of the proposed changes affect the entire water right?**

- Yes Complete only the Proposed ("to" lands) section of Table 2 on the next page. Use the "CODES" listed above to describe the proposed changes.
- No Complete all of Table 2 to describe the portion of the water right to be changed.



Please use and attach additional pages of Table 2 as needed.  
See page 6 for instructions.

Do you have questions about how to fill-out the tables?  
Contact the Department at 503-986-0900 and ask for Transfer Staff.

**Table 2. Description of Changes to Water Right Certificate # 94043 PRIMARY GW**

List only the part of the right that will be changed. For the acreage in each ¼ ¼, list the change proposed. If more than one change, specify the acreage associated with each change. If more than one POD/POA, specify the acreage associated with each POD/POA.

AUTHORIZED (the "from" or "off" lands) The listing that appears on the Certificate BEFORE PROPOSED CHANGES List only that part or portion of the water right that will be changed.											Proposed Changes (see "CODES" from previous page)	PROPOSED (the "to" or "on" lands) The listing as it would appear AFTER PROPOSED CHANGES are made.															
Twp	Rng	Sec	¼ ¼	Tax Lot	Gvt Lot or DLC	Acres	Type of USE listed on Certificate	POD(s) or POA(s) (name or number from Table 1)	Priority Date	Twp		Rng	Sec	¼ ¼	Tax Lot	Gvt Lot or DLC	Acres	New Type of USE	POD(s)/ POA(s) to be used (from Table 1)	Priority Date							
2	S	22	E	23	SW	SW	1300		8.8	IR	Wells 1,2,3,4	1966	POU	2	S	22	E	22	NE	SE	1300		10.3	IR	Wells 1,2,3,4	1966	
2	S	22	E	26	NW	NW	1300		10.6	IR	Wells 1,2,3,4	1966	POU	2	S	22	E	22	SE	SE	1300		5.3	IR	Wells 1,2,3,4	1966	
													POU	2	S	22	E	23	SW	SW	1300		2.25	IR	Wells 1,2,3,4	1966	
													POU	2	S	22	E	23	SE	SW	1300		0.2	IR	Wells 1,2,3,4	1966	
													POU	2	S	22	E	26	NE	NW	1300		0.25	IR	Wells 1,2,3,4	1966	
													POU	2	S	22	E	26	NW	NW	1300		0.25	IR	Wells 1,2,3,4	1966	
													POU	2	S	22	E	27	SE	NE	1300		0.1	IR	Wells 1,2,3,4	1966	
													POU	2	S	22	E	27	NE	SE	1300		0.75	IR	Wells 1,2,3,4	1966	
						TOTAL ACRES		19.4												TOTAL ACRES		19.4					

RECEIVED  
JUN 11 2021  
OWRD

Additional remarks:



Please use and attach additional pages of Table 2 as needed.  
See page 6 for instructions.

Do you have questions about how to fill-out the tables?  
Contact the Department at 503-986-0900 and ask for Transfer Staff.

**Table 2. Description of Changes to Water Right Certificate # 94043 – SUPPLEMENTAL GW**

List only the part of the right that will be changed. For the acreage in each ¼ ¼, list the change proposed. If more than one change, specify the acreage

AUTHORIZED (the "from" or "off" lands) The listing that appears on the Certificate BEFORE PROPOSED CHANGES List only that part or portion of the water right that will be changed.											Proposed Changes (see "CODES" from previous page)	PROPOSED (the "to" or "on" lands) The listing as it would appear AFTER PROPOSED CHANGES are made.														
Twp	Rng	Sec	¼	¼	Tax Lot	Gvt Lot or DLC	Acres	Type of USE listed on Certificate	POD(s) or POA(s) (name or number from Table 1)	Priority Date		Twp	Rng	Sec	¼	¼	Tax Lot	Gvt Lot or DLC	Acres	New Type of USE	POD(s)/ POA(s) to be used (from Table 1)	Priority Date				
<b>FOLLOWING CERTIFICATE #30166 – TO LANDS</b>																										
2	S	22	E	22	SE	SE	1300		2.2	IS	Wells 1,2,3,4	1966	POU	2	S	22	E	15	SW	SE	1300		23.1	IS	Wells 1,2,3,4	1966
2	S	22	E	23	SW	SW	1300		6.9	IS	Wells 1,2,3,4	1966	POU	2	S	22	E	22	NW	NE	1300		6.2	IS	Wells 1,2,3,4	1966
2	S	22	E	26	NW	NW	1300		17.0	IS	Wells 1,2,3,4	1966										(29.3)				
2	S	22	E	26	SW	NW	1300		1.2	IS	Wells 1,2,3,4	1966														
2	S	22	E	27	NE	NE	1300		2.0	IS	Wells 1,2,3,4	1966														
							TOTAL ACRES	29.3															TOTAL ACRES	29.3		

RECEIVED  
JUN 11 2021  
OWRD

Additional remarks: These acres are supplemental to Certificate #30166 only.



## Part 5 of 5 – Water Right Information

Please use a separate Part 5 for each water right being changed. See instructions on page 6, to copy and paste additional Part 5s, or to add rows to tables within the form.

**Water Right Certificate # 94044**

**RECEIVED**

**JUN 11 2021**

### Description of Water Delivery System

System capacity: **1.16** cubic feet per second (cfs) OR  
 \_\_\_\_\_ gallons per minute (gpm)

**OWRD**

Describe the current water delivery system or the system that was in place at some time within the last five years. Include information on the pumps, canals, pipelines, and sprinklers used to divert, convey, and apply the water at the authorized place of use. **Groundwater is provided by 4 wells serving a 10 inch mainline. Laterals of 8, 6, and 4 inches provide control of the distribution system. The lowlands are irrigated with h and line and wheel line setups with circles on the upper benches. The orchards are served with micro sprinkler systems.**

**Table 1. Location of Authorized and Proposed Point(s) of Diversion (POD) or Appropriation (POA)**

(Note: If the POD/POA name is not specified on the certificate, assign it a name or number here.)

POD/POA Name or Number	Is this POD/POA Authorized on the Certificate or is it Proposed?	If POA, OWRD Well Log ID# (or Well ID Tag # L-___)	Twp		Rng		Sec	¼ ¼		Tax Lot, DLC or Gov't Lot	Measured Distances (from a recognized survey corner)
Well 1	<input checked="" type="checkbox"/> Authorized <input type="checkbox"/> Proposed	GILL 154	2	S	22	E	26	NW	NW	1300	4000 feet N and 170 feet E from SW Corner, Section 26
Well 2	<input checked="" type="checkbox"/> Authorized <input type="checkbox"/> Proposed	GILL 155	2	S	22	E	26	SE	NW	1300	3070 feet N and 1560 feet E from SW Corner, Section 26
Well 3	<input checked="" type="checkbox"/> Authorized <input type="checkbox"/> Proposed	GILL 151	2	S	22	E	23	SW	SW	1300	1320 feet N and 80 feet E from SE Corner, Section 22
Well 4	<input checked="" type="checkbox"/> Authorized <input type="checkbox"/> Proposed	GILL 149	2	S	22	E	15	SW	SE	1300	50 feet N and 2480 feet W from SE Corner, Section 15

**Check all type(s) of change(s) proposed below (change "CODES" are provided in parentheses):**

- |   |   |
|---|---|
| <input checked="" type="checkbox"/> Place of Use (POU)        | <input type="checkbox"/> Appropriation/Well (POA)                 |
| <input type="checkbox"/> Point of Diversion (POD)             | <input type="checkbox"/> Additional Point of Appropriation (APOA) |
| <input type="checkbox"/> Additional Point of Diversion (APOD) |   |

**Will all of the proposed changes affect the entire water right?**

- Yes      Complete only the Proposed ("to" lands) section of Table 2 on the next page. Use the "CODES" listed above to describe the proposed changes.
- No        Complete all of Table 2 to describe the portion of the water right to be changed.

Please use and attach additional pages of Table 2 as needed.  
See page 6 for instructions.

Do you have questions about how to fill-out the tables?  
Contact the Department at 503-986-0900 and ask for Transfer Staff.

**Table 2. Description of Changes to Water Right Certificate # 94044 – PRIMARY GW**

List only the part of the right that will be changed. For the acreage in each ¼ ¼, list the change proposed. If more than one change, specify the acreage associated with each change. If more than one POD/POA, specify the acreage associated with each POD/POA.

AUTHORIZED (the "from" or "off" lands) The listing that appears on the Certificate BEFORE PROPOSED CHANGES List only that part or portion of the water right that will be changed.											Proposed Changes (see "CODES" from previous page)	PROPOSED (the "to" or "on" lands) The listing as it would appear AFTER PROPOSED CHANGES are made.											
Twp	Rng	Sec	¼ ¼	Tax Lot	Gvt Lot or DLC	Acres	Type of USE listed on Certificate	POD(s) or POA(s) (name or number from Table 1)	Priority Date	Twp		Rng	Sec	¼ ¼	Tax Lot	Gvt Lot or DLC	Acres	New Type of USE	POD(s)/ POA(s) to be used (from Table 1)	Priority Date			
2	S	22	E 27	NE SE	1300		3.2	IR	Wells 1,2,3,4	1967	POU	2	S	22	E 22	NW NE	1300		2.0	IR	Wells 1,2,3,4	1967	
2	S	22	E 27	SE SE	1300		1.0	IR	Wells 1,2,3,4	1967	POU	2	S	22	E 27	NE SE	1300		2.2	IR	Wells 1,2,3,4	1967	
TOTAL ACRES						4.2						TOTAL ACRES						4.2					

RECEIVED  
JUN 11 2021  
OWRD

Additional remarks:



Table 2. Description of Changes to Water Right Certificate # 94044 – SUPPLEMENTAL GW

OWRD

AUTHORIZED (the "from" or "off" lands) The listing that appears on the Certificate BEFORE PROPOSED CHANGES List only that part or portion of the water right that will be changed.											Proposed Changes (see "CODES" from previous page)	PROPOSED (the "to" or "on" lands) The listing as it would appear AFTER PROPOSED CHANGES are made.														
Twp	Rng	Sec	¼	¼	Tax Lot	Gvt Lot or DLC	Acres	Type of USE listed on Certificate	POD(s) or POA(s) (name or number from Table 1)	Priority Date		Twp	Rng	Sec	¼	¼	Tax Lot	Gvt Lot or DLC	Acres	New Type of USE	POD(s)/ POA(s) to be used (from Table 1)	Priority Date				
2	S	22	E	22	SE	SE	1300		2.2	IS	Wells 1,2,3,4	1967		2	S	22	E	15	SW	SE	1300		23.1	IS	Wells 1,2,3,4	1967
2	S	22	E	23	SW	SW	1300		15.7	IS	Wells 1,2,3,4	1967		2	S	22	E	22	NW	NE	1300		6.2	IS	Wells 1,2,3,4	1967
2	S	22	E	26	NW	NW	1300		27.6	IS	Wells 1,2,3,4	1967		2	S	22	E	22	SE	NE	1300		9.9	IS	Wells 1,2,3,4	1967
2	S	22	E	26	SW	NW	1300		11.2	IS	Wells 1,2,3,4	1967		2	S	22	E	22	NE	SE	1300		10.3	IS	Wells 1,2,3,4	1967
2	S	22	E	26	NW	SW	1300		10.0	IS	Wells 1,2,3,4	1967		2	S	22	E	22	SE	SE	1300		5.3	IS	Wells 1,2,3,4	1967
2	S	22	E	27	NE	NE	1300		2.0	IS	Wells 1,2,3,4	1967		2	S	22	E	23	SW	SW	1300		2.25	IS	Wells 1,2,3,4	1967
2	S	22	E	27	SE	NE	1300		2.8	IS	Wells 1,2,3,4	1967		2	S	22	E	23	SE	SW	1300		0.2	IS	Wells 1,2,3,4	1967
2	S	22	E	27	NE	SE	1300		16.3	IS	Wells 1,2,3,4	1967		2	S	22	E	26	NE	NW	1300		0.25	IS	Wells 1,2,3,4	1967
2	S	22	E	27	SE	SE	1300		0.4	IS	Wells 1,2,3,4	1967		2	S	22	E	26	NW	NW	1300		0.55	IS	Wells 1,2,3,4	1967
														2	S	22	E	26	SW	NW	1300		8.6	IS	Wells 1,2,3,4	1967
														2	S	22	E	26	NW	SW	1300		14.9	IS	Wells 1,2,3,4	1967
TOTAL ACRES							(88.2)	TOTAL ACRES																		

Please use and attach additional pages of Table 2 as needed.  
See page 6 for instructions.

Do you have questions about how to fill-out the tables?  
Contact the Department at 503-986-0900 and ask for Transfer Staff.

**Table 2. Description of Changes to Water Right Certificate # 94044 – SUPPLEMENTAL GW**

AUTHORIZED (the "from" or "off" lands) The listing that appears on the Certificate BEFORE PROPOSED CHANGES List only that part or portion of the water right that will be changed.										Proposed Changes (see "CODES" from previous page)	PROPOSED (the "to" or "on" lands) The listing as it would appear AFTER PROPOSED CHANGES are made.												
Twp	Rng	Sec	¼ ¼	Tax Lot	Gvt Lot or DLC	Acres	Type of USE listed on Certificate	POD(s) or POA(s) (name or number from Table 1)	Priority Date		Twp	Rng	Sec	¼ ¼	Tax Lot	Gvt Lot or DLC	Acres	New Type of USE	POD(s)/ POA(s) to be used (from Table 1)	Priority Date			
<b>FOLLOWING CERTIFICATE #94040 – TO LANDS</b>																							
											2	S	22	E	27	SE	NE	1300		1.8	IS	Wells 1,2,3,4	1967
											2	S	22	E	27	NE	SE	1300		4.85	IS	Wells 1,2,3,4	1967
TOTAL ACRES											TOTAL ACRES										88.2		

RECEIVED  
JUN 11 2021  
OWRD



## Part 5 of 5 – Water Right Information

Please use a separate Part 5 for each water right being changed. See instructions on page 6, to copy and paste additional Part 5s, or to add rows to tables within the form.

### Water Right Certificate # 94045

#### Description of Water Delivery System

System capacity: 0.94 cubic feet per second (cfs) **OR**  
 \_\_\_\_\_ gallons per minute (gpm)

Describe the current water delivery system or the system that was in place at some time within the last five years. Include information on the pumps, canals, pipelines, and sprinklers used to divert, convey, and apply the water at the authorized place of use. **Groundwater is provided by 4 wells serving a 10 inch mainline. Laterals of 8, 6, and 4 inches provide control of the distribution system. The lowlands are irrigated with handline and wheel line setups with circles on the upper benches. The orchards are served with micro sprinkler systems.**

#### Table 1. Location of Authorized and Proposed Point(s) of Diversion (POD) or Appropriation (POA)

(Note: If the POD/POA name is not specified on the certificate, assign it a name or number here.)

POD/POA Name or Number	Is this POD/POA Authorized on the Certificate or is it Proposed?	If POA, OWRD Well Log ID# (or Well ID Tag # L-___)	Twp		Rng		Sec	¼ ¼		Tax Lot, DLC or Gov't Lot	Measured Distances (from a recognized survey corner)
Well 1	<input type="checkbox"/> Authorized <input type="checkbox"/> Proposed	GILL 154	2	S	22	E	26	NW	NW	1300	4000 feet N and 170 feet E from SW Corner, Section 26
Well 2	<input type="checkbox"/> Authorized <input type="checkbox"/> Proposed	GILL 155	2	S	22	E	26	SE	NW	1300	3070 feet N and 1560 feet E from SW Corner, Section 26
Well 3	<input type="checkbox"/> Authorized <input type="checkbox"/> Proposed	GILL 151	2	S	22	E	23	SW	SW	1300	1320 feet N and 80 feet E from SE Corner, Section 22
Well 4	<input type="checkbox"/> Authorized <input type="checkbox"/> Proposed	GILL 149	2	S	22	E	15	SW	SE	1300	50 feet N and 2480 feet W from SE Corner, Section 15

#### Check all type(s) of change(s) proposed below (change "CODES" are provided in parentheses):

- |   |   |
|---|---|
| <input checked="" type="checkbox"/> Place of Use (POU)        | <input type="checkbox"/> Appropriation/Well (POA)                 |
| <input type="checkbox"/> Point of Diversion (POD)             | <input type="checkbox"/> Additional Point of Appropriation (APOA) |
| <input type="checkbox"/> Additional Point of Diversion (APOD) |   |

#### Will all of the proposed changes affect the entire water right?

- Yes Complete only the Proposed ("to" lands) section of Table 2 on the next page. Use the "CODES" listed above to describe the proposed changes.
- No Complete all of Table 2 to describe the portion of the water right to be changed.

**RECEIVED**

**JUN 11 2021**

**OWRD**

**13739**

Please use and attach additional pages of Table 2 as needed.  
See page 6 for instructions.

Do you have questions about how to fill-out the tables?  
Contact the Department at 503-986-0900 and ask for Transfer Staff.

**Table 2. Description of Changes to Water Right Certificate # 94045 – PRIMARY GW**

List only the part of the right that will be changed. For the acreage in each ¼ ¼, list the change proposed. If more than one change, specify the acreage associated with each change. If more than one POD/POA, specify the acreage associated with each POD/POA.

AUTHORIZED (the "from" or "off" lands) The listing that appears on the Certificate BEFORE PROPOSED CHANGES List only that part or portion of the water right that will be changed.											Proposed Changes (see "CODES" from previous page)	PROPOSED (the "to" or "on" lands) The listing as it would appear AFTER PROPOSED CHANGES are made.														
Twp	Rng	Sec	¼	¼	Tax Lot	Gvt Lot or DLC	Acres	Type of USE listed on Certificate	POD(s) or POA(s) (name or number from Table 1)	Priority Date		Twp	Rng	Sec	¼	¼	Tax Lot	Gvt Lot or DLC	Acres	New Type of USE	POD(s)/ POA(s) to be used (from Table 1)	Priority Date				
2	S	22	E	22	NE	SE	1300		4.9	IR	Wells 1,2,3,4	1971	POU	2	S	22	E	15	SE	SW	1300		1.9	IR	Wells 1,2,3,4	1971
2	S	22	E	22	NW	SE	1300		0.5	IR	Wells 1,2,3,4	1971	POU	2	S	22	E	15	SW	SE	1300		2.8	IR	Wells 1,2,3,4	1971
2	S	22	E	23	SW	SW	1300		0.5	IR	Wells 1,2,3,4	1971	POU	2	S	22	E	22	NW	NE	1300		1.2	IR	Wells 1,2,3,4	1971
							TOTAL ACRES	5.9												TOTAL ACRES	5.9					

RECEIVED  
JUN 11 2021  
OWRD

Additional remarks:



**Table 2. Description of Changes to Water Right Certificate # 94045 – SUPPLEMENTAL GW**

List only the part of the right that will be changed. For the acreage in each ¼ ¼, list the change proposed. If more than one change, specify the acreage

AUTHORIZED (the "from" or "off" lands) The listing that appears on the Certificate BEFORE PROPOSED CHANGES List only that part or portion of the water right that will be changed.											Proposed Changes (see "CODES" from previous page)	PROPOSED (the "to" or "on" lands) The listing as it would appear AFTER PROPOSED CHANGES are made.														
Twp	Rng	Sec	¼	¼	Tax Lot	Gvt Lot or DLC	Acres	Type of USE listed on Certificate	POD(s) or POA(s) (name or number from Table 1)	Priority Date		Twp	Rng	Sec	¼	¼	Tax Lot	Gvt Lot or DLC	Acres	New Type of USE	POD(s)/ POA(s) to be used (from Table 1)	Priority Date				
2	S	22	E	22	SE	NE	1300		20.0	IS	Wells 1,2,3,4	1971	POU	2	S	22	E	22	NW	NE	1300		11.5	IS	Wells 1,2,3,4	1971
2	S	22	E	22	NE	SE	1300		20.0	IS	Wells 1,2,3,4	1971	POU	2	S	22	E	22	SW	NE	1300		6.5	IS	Wells 1,2,3,4	1971
2	S	22	E	22	NW	SE	1300		0.4	IS	Wells 1,2,3,4	1971	POU	2	S	22	E	22	SE	NE	1300		15.5	IS	Wells 1,2,3,4	1971
2	S	22	E	22	SE	SE	1300		4.6	IS	Wells 1,2,3,4	1971	POU	2	S	22	E	22	NE	NW	1300		3.3	IS	Wells 1,2,3,4	1971
2	S	22	E	23	SW	NW	1300		3.2	IS	Wells 1,2,3,4	1971	POU	2	S	22	E	22	NE	SE	1300		4.2	IS	Wells 1,2,3,4	1971
2	S	22	E	23	NW	SW	1300		21.0	IS	Wells 1,2,3,4	1971	POU	2	S	22	E	23	SW	SW	1300		10.6	IS	Wells 1,2,3,4	1971
													POU	2	S	22	E	26	NW	NW	1300		17.6	IS	Wells 1,2,3,4	1971
TOTAL ACRES							69.2											TOTAL ACRES							69.2	

Additional remarks:

RECEIVED

JUN 11 2021

OWRD

## Part 5 of 5 – Water Right Information

Please use a separate Part 5 for each water right being changed. See instructions on page 6, to copy and paste additional Part 5s, or to add rows to tables within the form.

### Water Right Certificate # 94046

#### Description of Water Delivery System

System capacity: 1.65 cubic feet per second (cfs) **OR**  
 \_\_\_\_\_ gallons per minute (gpm)

Describe the current water delivery system or the system that was in place at some time within the last five years. Include information on the pumps, canals, pipelines, and sprinklers used to divert, convey, and apply the water at the authorized place of use. **Groundwater is provided by 4 wells serving a 10 inch mainline. Laterals of 8, 6, and 4 inches provide control of the distribution system. The lowlands are irrigated with handline and wheel line setups with circles on the upper benches. The orchards are served with micro sprinkler systems.**

#### Table 1. Location of Authorized and Proposed Point(s) of Diversion (POD) or Appropriation (POA)

(Note: If the POD/POA name is not specified on the certificate, assign it a name or number here.)

POD/POA Name or Number	Is this POD/POA Authorized on the Certificate or is it Proposed?	If POA, OWRD Well Log ID# (or Well ID Tag # L-___)	Twp	Rng	Sec	¼	¼	Tax Lot, DLC or Gov't Lot	Measured Distances (from a recognized survey corner)
Well 1	<input checked="" type="checkbox"/> Authorized <input type="checkbox"/> Proposed	GILL 154	2 S	22 E	26	NW	NW	1300	4000 feet N and 170 feet E from SW Corner, Section 26
Well 2	<input checked="" type="checkbox"/> Authorized <input type="checkbox"/> Proposed	GILL 155	2 S	22 E	26	SE	NW	1300	3070 feet N and 1560 feet E from SW Corner, Section 26
Well 3	<input checked="" type="checkbox"/> Authorized <input type="checkbox"/> Proposed	GILL 151	2 S	22 E	23	SW	SW	1300	1320 feet N and 80 feet E from SE Corner, Section 22
Well 4	<input checked="" type="checkbox"/> Authorized <input type="checkbox"/> Proposed	GILL 149	2 S	22 E	15	SW	SE	1300	50 feet N and 2480 feet W from SE Corner, Section 15

#### Check all type(s) of change(s) proposed below (change "CODES" are provided in parentheses):

- |   |   |
|---|---|
| <input checked="" type="checkbox"/> Place of Use (POU)        | <input type="checkbox"/> Appropriation/Well (POA)                 |
| <input type="checkbox"/> Point of Diversion (POD)             | <input type="checkbox"/> Additional Point of Appropriation (APOA) |
| <input type="checkbox"/> Additional Point of Diversion (APOD) |   |

#### Will all of the proposed changes affect the entire water right?

- Yes Complete only the Proposed ("to" lands) section of Table 2 on the next page. Use the "CODES" listed above to describe the proposed changes.
- No Complete all of Table 2 to describe the portion of the water right to be changed.

RECEIVED

JUN 11 2021

OWRD  
13739



Please use and attach additional pages of Table 2 as needed.  
See page 6 for instructions.

Do you have questions about how to fill-out the tables?  
Contact the Department at 503-986-0900 and ask for Transfer Staff.

**Table 2. Description of Changes to Water Right Certificate # 94046 – PRIMARY GW**

List only the part of the right that will be changed. For the acreage in each ¼ ¼, list the change proposed. If more than one change, specify the acreage associated with each change. If more than one POD/POA, specify the acreage associated with each POD/POA.

AUTHORIZED (the "from" or "off" lands) The listing that appears on the Certificate BEFORE PROPOSED CHANGES List only that part or portion of the water right that will be changed.											Proposed Changes (see "CODES" from previous page)	PROPOSED (the "to" or "on" lands) The listing as it would appear AFTER PROPOSED CHANGES are made.														
Twp	Rng	Sec	¼ ¼	Tax Lot	Gvt Lot or DLC	Acres	Type of USE listed on Certificate	POD(s) or POA(s) (name or number from Table 1)	Priority Date	Twp		Rng	Sec	¼ ¼	Tax Lot	Gvt Lot or DLC	Acres	New Type of USE	POD(s)/ POA(s) to be used (from Table 1)	Priority Date						
2	S	22	E	15	SE	SW	1300		8.2	IR	Wells 1,2,3,4	1968	POU	2	S	22	E	15	SE	SW	1300		4.9	IR	Wells 1,2,3,4	1968
2	S	22	E	15	SW	SE	1300		0.5	IR	Wells 1,2,3,4	1968	POU	2	S	22	E	22	NW	NE	1300		8.8	IR	Wells 1,2,3,4	1968
2	S	22	E	22	NW	NE	1300		14.2	IR	Wells 1,2,3,4	1968	POU	2	S	22	E	22	SW	NE	1300		2.1	IR	Wells 1,2,3,4	1968
2	S	22	E	22	SW	NE	1300		2.2	IR	Wells 1,2,3,4	1968	POU	2	S	22	E	22	NE	NW	1300		8.3	IR	Wells 1,2,3,4	1968
2	S	22	E	22	SE	NE	1300		0.6	IR	Wells 1,2,3,4	1968	POU	2	S	22	E	23	NW	SW	1300		11.9	IR	Wells 1,2,3,4	1968
2	S	22	E	22	NE	NW	1300		8.4	IR	Wells 1,2,3,4	1968	POU	2	S	22	E	23	SW	SW	1300		9.5	IR	Wells 1,2,3,4	1968
2	S	22	E	23	SW	NW	1300		0.8	IR	Wells 1,2,3,4	1968	POU	2	S	22	E	23	SE	SW	1300		2.8	IR	Wells 1,2,3,4	1968
2	S	22	E	23	NW	SW	1300		13.4	IR	Wells 1,2,3,4	1968	POU													
TOTAL ACRES						48.3	TOTAL ACRES						48.3													

RECEIVED

JUN 11 2021

OWRD

Additional remarks:



Please use and attach additional pages of Table 2 as needed.  
See page 6 for instructions.

Do you have questions about how to fill-out the tables?  
Contact the Department at 503-986-0900 and ask for Transfer Staff.

**Table 2. Description of Temporary Changes to Water Right Certificate # 94046 – SUPPLEMENTAL GW**

List only the part of the right that will be changed. For the acreage in each ¼ ¼, list the change proposed. If more than one change, specify the acreage

AUTHORIZED (the "from" or "off" lands) The listing that appears on the Certificate BEFORE PROPOSED CHANGES List only that part or portion of the water right that will be changed.													Proposed Changes (see "CODES" from previous page)	PROPOSED (the "to" or "on" lands) The listing as it would appear AFTER PROPOSED CHANGES are made.												
Twp	Rng	Sec	¼	¼	Tax Lot	Gvt Lot or DLC	Acres	Type of USE listed on Certificate	POD(s) or POA(s) (name or number from Table 1)	Priority Date	Twp	Rng		Sec	¼	¼	Tax Lot	Gvt Lot or DLC	Acres	New Type of USE	POD(s)/ POA(s) to be used (from Table 1)	Priority Date				
<b>FOLLOWING CERTIFICATE #30166 – TO LANDS</b>																										
2	S	22	E	15	SE	SW	1300		2.6	IS	Wells 1,2,3,4	1968	POU	2	S	22	E	22	SE	NE	1300		11.9	IS	Wells 1,2,3,4	1968
2	S	22	E	15	SW	SE	1300		22.8	IS	Wells 1,2,3,4	1968	POU	2	S	22	E	22	NE	SE	1300		4.1	IS	Wells 1,2,3,4	1968
2	S	22	E	22	NW	NE	1300		10.0	IS	Wells 1,2,3,4	1968	POU	2	S	22	E	23	SW	NW	1300		7.8	IS	Wells 1,2,3,4	1968
2	S	22	E	22	SW	NE	1300		5.0	IS	Wells 1,2,3,4	1968	POU	2	S	22	E	23	NW	SW	1300		13.9	IS	Wells 1,2,3,4	1968
2	S	22	E	22	SE	NE	1300		22.8	IS	Wells 1,2,3,4	1968		2	S	22	E	23	SW	SW	1300		10.6	IS	Wells 1,2,3,4	1968
2	S	22	E	22	NE	SE	1300		10.1	IS	Wells 1,2,3,4	1968		2	S	22	E	26	NW	NW	1300		17.6	IS	Wells 1,2,3,4	1968
2	S	22	E	23	SW	NW	1300		2.4	IS	Wells 1,2,3,4	1968		2	S	22	E	27	NE	NE	1300		3.5	IS	Wells 1,2,3,4	1968
2	S	22	E	23	NW	SW	1300		7.6	IS	Wells 1,2,3,4	1968		2	S	22	E	27	SE	NE	1300		3.45	IS	1,2,3,4	1968
														2	S	22	E	27	NE	SE	1300		2.8	IS	1,2,3,4	1968
														2	S	22	E	27	NW	SE	1300		0.65			
TOTAL ACRES													TOTAL ACRES													

Additional remarks: \_\_\_\_\_

RECEIVED

JUN 11 2021



**Table 2. Description of Temporary Changes to Water Right Certificate #94046 - SUPPLEMENTAL GW**

List only the part of the right that will be changed. For the acreage in each ¼ ¼, list the change proposed. If more than one change, specify the acreage.

AUTHORIZED (the "from" or "off" lands) The listing that appears on the Certificate BEFORE PROPOSED CHANGES List only that part or portion of the water right that will be changed.										Proposed Changes (see "CODES" from previous page)	PROPOSED (the "to" or "on" lands) The listing as it would appear AFTER PROPOSED CHANGES are made.												
Twp	Rng	Sec	¼ ¼	Tax Lot	Gvt Lot or DLC	Acres	Type of USE listed on Certificate	POD(s) or POA(s) (name or number from Table 1)	Priority Date		Twp	Rng	Sec	¼ ¼	Tax Lot	Gvt Lot or DLC	Acres	New Type of USE	POD(s)/POA(s) to be used (from Table 1)	Priority Date			
<b>FOLLOWING CERTIFICATE #94039 – TO LANDS (Continued)</b>																							
											2	S	22	E	27	SW	SE	1300		0.1	IS	Wells 1,2,3,4	1968
											2	S	22	E	27	SE	SE	1300		6.9	IS	Wells 1,2,3,4	1968
						TOTAL ACRES	83.3											TOTAL ACRES	83.3				

RECEIVED

JUN 11 2021

OWRD

**Attachment #1**

**POU Transfer Application Map**

Transfer Application for Certificates 30166, 94039, 94040, 94041, 94042, 94043, 94044, 94045, 94046

---



RECEIVED

JUN 11 2021

OWRD

**Attachment #2**

Evidence of Use Affidavit and Supporting Documents

Transfer Application for Certificates 30166, 94039, 94040, 94041, 94042, 94043, 94044, 94045, 94046

---

13739

# Application for Water Right Transfer

## Evidence of Use Affidavit



**Oregon Water Resources Department**  
 725 Summer Street NE, Suite A  
 Salem, Oregon 97301-1266  
 (503) 986-0900  
 www.wrd.state.or.us

Please print legibly or type. Be as specific as possible. Attach additional pages if you need more spacing. Supporting documentation must be attached.

State of Oregon )  
 ) ss  
 County of GILLIAM)

I, DENNIS MACNAB, in my capacity as LANDOWNER,  
 mailing address 1215 DRY HOLLOW ROAD, THE DALLES, OR 97058  
 telephone number (541)296-2447, being first duly sworn depose and say:

RECEIVED

JUN 11 2021

OWRD

1. My knowledge of the exercise or status of the water right is based on (check one):

- Personal observation                       Professional expertise

2. I attest that:

Water was used during the previous five years on the **entire** place of use for Certificate # 30166, 94039, 94040, 94041, 94042, 94043, 94044, 94045, 94046; **OR**

My knowledge is specific to the use of water at the following locations within the last five years:

Certificate #	Township	Range	Mer	Sec	¼ ¼	Gov't Lot or DLC	Acres (if applicable)

**OR**

- Confirming Certificate # \_\_\_\_\_ has been issued within the past five years; **OR**
- Part or all of the water right was leased instream at some time within the last five years. The instream lease number is: \_\_\_\_\_ (Note: If the entire right proposed for transfer was not leased, additional evidence of use is needed for the portion not leased instream.); **OR**
- The water right is not subject to forfeiture and documentation that a presumption of forfeiture for non-use would be rebutted under ORS 540.610(2) is attached.
- Water has been used at the actual current point of diversion or appropriation for more than 10 years for Certificate # \_\_\_\_\_ (For Historic POD/POA Transfers)

(continues on reverse side)



3. The water right was used for: (e.g., crops, pasture, etc.): GRASSES, ORCHARDS

4. I understand that if I do not attach one or more of the documents shown in the table below to support the above statements, my application will be considered incomplete.

RECEIVED

JUN 11 2021

OWRD

[Signature]  
Signature of Affiant

11/9/20  
Date

Signed and sworn to (or affirmed) before me this 9<sup>th</sup> day of November, 2020.

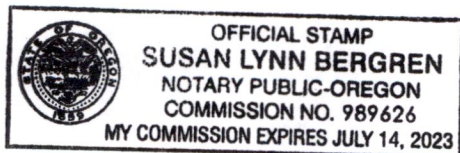

[Signature]  
Notary Public for Oregon

My Commission Expires: 7-14-2023

Supporting Documents	Examples
<input type="checkbox"/> Copy of a water right certificate that has been issued within the last five years. (not a remaining right certificate)	Copy of <b>confirming</b> water right certificate that shows issue date
<input checked="" type="checkbox"/> Copies of receipts from sales of irrigated crops or for expenditures related to use of water	<ul style="list-style-type: none"> <li>• Power usage records for pumps associated with irrigation use</li> <li>• Fertilizer or seed bills related to irrigated crops</li> <li>• Farmers Co-op sales receipt</li> </ul>
<input type="checkbox"/> Records such as FSA crop reports, irrigation district records, NRCS farm management plan, or records of other water suppliers	<ul style="list-style-type: none"> <li>• District assessment records for water delivered</li> <li>• Crop reports submitted under a federal loan agreement</li> <li>• Beneficial use reports from district</li> <li>• IRS Farm Usage Deduction Report</li> <li>• Agricultural Stabilization Plan</li> <li>• CREP Report</li> </ul>
<input checked="" type="checkbox"/> Aerial photos containing sufficient detail to establish location and date of photograph	<p>Multiple photos can be submitted to resolve different areas of a water right. If the photograph does not print with a "date stamp" or without the source being identified, the date of the photograph and source should be added.</p> <p>Sources for aerial photos: OSU – <a href="http://www.oregonexplorer.info/imagery">www.oregonexplorer.info/imagery</a> OWRD – <a href="http://www.wrd.state.or.us">www.wrd.state.or.us</a> Google Earth – <a href="http://earth.google.com">earth.google.com</a> TerraServer – <a href="http://www.terra-server.com">www.terra-server.com</a></p>
<input type="checkbox"/> Approved Lease establishing beneficial use within the last 5 years	Copy of instream lease or lease number

CUSTOMER PROFILE/BILLING HIST

RECEIVED

JUN 11 2021

OWRD

Rev YrMo	Bill Dt	Revenuc	Demand	Device	PCA	Other	Tax	Adjust	Total
Jan 2019	01/23/2019	60.90	.00	.00	.00	.00	.00	.00	60.90
Feb 2019	02/20/2019	60.90	.00	.00	.00	.00	.00	.00	60.90
Mar 2019	03/26/2019	71.57	.00	.00	.00	.00	.00	.00	71.57
Apr 2019	04/24/2019	146.27	.00	.00	.00	.00	.00	.00	146.27
May 2019	05/24/2019	196.07	.00	.00	.00	.00	.00	.00	196.07
Jun 2019	06/25/2019	349.03	.00	.00	.00	.00	.00	.00	349.03
Jul 2019	07/23/2019	292.12	.00	.00	.00	.00	.00	.00	292.12
Aug 2019	08/27/2019	395.28	.00	.00	.00	.00	.00	.00	395.28
Sep 2019	09/25/2019	292.12	.00	.00	.00	.00	.00	.00	292.12
Oct 2019	10/29/2019	128.57	.00	.00	.00	.00	.00	.00	128.57
Nov 2019	11/25/2019	89.44	.00	.00	.00	.00	.00	.00	89.44
Dec 2019	12/23/2019	85.89	.00	.00	.00	.00	.00	.00	85.89
Jan 2020	01/22/2020	89.44	.00	.00	.00	.00	.00	.00	89.44
Feb 2020	02/24/2020	89.44	.00	.00	.00	.00	.00	.00	89.44
Mar 2020	03/20/2020	93.00	.00	.00	.00	.00	.00	.00	93.00
Apr 2020	04/28/2020	228.17	.00	.00	.00	.00	.00	.00	228.17
May 2020	05/27/2020	526.98	.00	.00	.00	.00	.00	.00	526.98
Jun 2020	06/23/2020	395.36	.00	.00	.00	.00	.00	.00	395.36
Jul 2020	07/23/2020	523.42	.00	.00	.00	.00	.00	.00	523.42
Aug 2020	08/25/2020	551.88	.00	.00	.00	.00	.00	.00	551.88
Sep 2020	09/23/2020	313.55	.00	.00	.00	.00	.00	.00	313.55
Oct 2020	10/27/2020	381.13	.00	.00	.00	.00	.00	.00	381.13
Totals:		\$5,360.53	\$0.00	\$0.00	\$0.00	\$0.00	\$0.00	\$0.00	\$5,360.53
Averages:		\$243.66	\$0.00	\$0.00	\$0.00	\$0.00	\$0.00	\$0.00	\$243.66

Billing acct. # 6337  
 met. # 0119  
 15 HP - Domestic Well/Lodge



CUSTOMER PROFILE/BILLING HIST

RECEIVED

JUN 11 2021

OWRD

Rev YrMo	Bill Dt	Revenue	Demand	Device	PCA	Other	Tax	Adjust	Total
Jan 2019	01/23/2019	.00	332.10	.00	.00	.00	.00	.00	332.10
Feb 2019	02/20/2019	.00	332.10	.00	.00	.00	.00	.00	332.10
Mar 2019	03/26/2019	.00	332.10	.00	.00	.00	.00	.00	332.10
Apr 2019	04/24/2019	253.84	332.10	.00	.00	.00	.00	.00	585.94
May 2019	05/24/2019	1,095.37	332.10	.00	.00	.00	.00	.00	1,427.47
Jun 2019	06/25/2019	1,575.26	332.10	.00	.00	.00	.00	.00	1,907.36
Jul 2019	07/23/2019	1,127.65	332.10	.00	.00	.00	.00	.00	1,459.75
Aug 2019	08/27/2019	1,097.52	332.10	.00	.00	.00	.00	.00	1,429.62
Sep 2019	09/25/2019	155.29	332.10	.00	.00	.00	.00	.00	487.39
Oct 2019	10/29/2019	.00	332.10	.00	.00	.00	.00	.00	332.10
Nov 2019	11/25/2019	.00	332.10	.00	.00	.00	.00	.00	332.10
Dec 2019	12/23/2019	.00	332.10	.00	.00	.00	.00	.00	332.10
Jan 2020	01/22/2020	.00	332.10	.00	.00	.00	.00	.00	332.10
Feb 2020	02/24/2020	.00	332.10	.00	.00	.00	.00	.00	332.10
Mar 2020	03/20/2020	.00	332.10	.00	.00	.00	.00	.00	332.10
Apr 2020	04/28/2020	925.78	332.10	.00	.00	.00	.00	.00	332.10
May 2020	05/27/2020	1,185.75	332.10	.00	.00	.00	.00	.00	1,257.88
Jun 2020	06/23/2020	822.06	332.10	.00	.00	.00	.00	.00	1,517.85
Jul 2020	07/23/2020	871.56	332.10	.00	.00	.00	.00	.00	1,154.16
Aug 2020	08/25/2020	839.28	332.10	.00	.00	.00	.00	.00	1,203.66
Sep 2020	09/23/2020	418.10	332.10	.00	.00	.00	.00	.00	1,171.38
Oct 2020	10/27/2020	.00	332.10	.00	.00	.00	.00	.00	750.20
Totals:		\$10,367.46	\$7,306.20	\$0.00	\$0.00	\$0.00	\$0.00	\$0.00	\$17,673.66
Averages:		\$471.25	\$332.10	\$0.00	\$0.00	\$0.00	\$0.00	\$0.00	\$803.35

Billing acct. # 6247  
 met # 0165  
 60 HP

CUSTOMER PROFILE/BILLING HIST

RECEIVED

JUN 11 2021

OWRD

Rev YrMo	Bill Dt	Revenue	Demand	Device	PCA	Other	Tax	Adjust	Total
Jan 2019	01/23/2019	.00	667.60	.00	.00	.00	.00	.00	667.60
Feb 2019	02/20/2019	.00	667.60	.00	.00	.00	.00	.00	667.60
Mar 2019	03/26/2019	.00	667.60	.00	.00	.00	.00	.00	667.60
Apr 2019	04/24/2019	215.02	667.60	.00	.00	.00	.00	.00	882.62
May 2019	05/24/2019	776.87	667.60	.00	.00	.00	.00	.00	1,444.47
Jun 2019	06/25/2019	1,919.58	667.60	.00	.00	.00	.00	.00	2,587.18
Jul 2019	07/23/2019	1,816.29	667.60	.00	.00	.00	.00	.00	2,483.89
Aug 2019	08/27/2019	2,616.83	667.60	.00	.00	.00	.00	.00	3,284.43
Sep 2019	09/25/2019	498.73	667.60	.00	.00	.00	.00	.00	1,166.33
Oct 2019	10/29/2019	.00	667.60	.00	.00	.00	.00	.00	667.60
Nov 2019	11/25/2019	.00	667.60	.00	.00	.00	.00	.00	667.60
Dec 2019	12/23/2019	.00	667.60	.00	.00	.00	.00	.00	667.60
Jan 2020	01/22/2020	.00	667.60	.00	.00	.00	.00	.00	667.60
Feb 2020	02/24/2020	.00	667.60	.00	.00	.00	.00	.00	667.60
Mar 2020	03/20/2020	.00	667.60	.00	.00	.00	.00	.00	667.60
Apr 2020	04/28/2020	1,290.12	667.60	.00	.00	.00	.00	.00	1,957.72
May 2020	05/27/2020	2,102.50	667.60	.00	.00	.00	.00	.00	2,770.10
Jun 2020	06/23/2020	2,025.03	667.60	.00	.00	.00	.00	.00	2,692.63
Jul 2020	07/23/2020	2,003.51	667.60	.00	.00	.00	.00	.00	2,671.11
Aug 2020	08/25/2020	2,558.73	667.60	.00	.00	.00	.00	.00	3,226.33
Sep 2020	09/23/2020	1,555.91	667.60	.00	.00	.00	.00	.00	2,223.51
Oct 2020	10/27/2020	.00	667.60	.00	.00	.00	.00	.00	667.60
Totals:		\$19,379.12	\$14,687.20	\$ .00	\$ .00	\$ .00	\$ .00	\$ .00	\$34,066.32
Averages:		\$880.87	\$667.60	\$ .00	\$ .00	\$ .00	\$ .00	\$ .00	\$1,548.47

Billing - acct. # 6244  
 mt. # 0192  
 170 HP



CUSTOMER PROFILE/BILLING HIST

RECEIVED  
 JUN 11 2021  
 OWRD

Rev YrMo	Bill Dt	Revenue	Demand	Device	PCA	Other	Tax	Adjust	Total
Jan 2019	01/23/2019	210.48	.00	.00	.00	.00	.00	.00	210.48
Feb 2019	02/20/2019	189.68	.00	.00	.00	.00	.00	.00	189.68
Mar 2019	03/26/2019	262.81	.00	.00	.00	.00	.00	.00	262.81
Apr 2019	04/24/2019	134.72	.00	.00	.00	.00	.00	.00	134.72
May 2019	05/24/2019	139.65	.00	.00	.00	.00	.00	.00	139.65
Jun 2019	06/25/2019	95.81	.00	.00	.00	.00	.00	.00	95.81
Jul 2019	07/23/2019	87.63	.00	.00	.00	.00	.00	.00	87.63
Aug 2019	08/27/2019	100.02	.00	.00	.00	.00	.00	.00	100.02
Sep 2019	09/25/2019	103.28	.00	.00	.00	.00	.00	.00	103.28
Oct 2019	10/29/2019	168.30	.00	.00	.00	.00	.00	.00	168.30
Nov 2019	11/25/2019	165.12	.00	.00	.00	.00	.00	.00	165.12
Dec 2019	12/23/2019	204.98	.00	.00	.00	.00	.00	.00	204.98
Jan 2020	01/22/2020	218.80	.00	.00	.00	.00	.00	.00	218.80
Feb 2020	02/24/2020	220.47	.00	.00	.00	.00	.00	.00	220.47
Mar 2020	03/20/2020	181.72	.00	.00	.00	.00	.00	.00	181.72
Apr 2020	04/28/2020	186.40	.00	.00	.00	.00	.00	.00	186.40
May 2020	05/27/2020	99.45	.00	.00	.00	.00	.00	.00	99.45
Jun 2020	06/23/2020	85.87	.00	.00	.00	.00	.00	.00	85.87
Jul 2020	07/23/2020	90.32	.00	.00	.00	.00	.00	.00	90.32
Aug 2020	08/25/2020	93.57	.00	.00	.00	.00	.00	.00	93.57
Sep 2020	09/23/2020	85.87	.00	.00	.00	.00	.00	.00	85.87
Oct 2020	10/27/2020	109.53	.00	.00	.00	.00	.00	.00	109.53
Totals:		\$3,234.48	\$0.00	\$0.00	\$0.00	\$0.00	\$0.00	\$0.00	\$3,234.48
Averages:		\$147.02	\$0.00	\$0.00	\$0.00	\$0.00	\$0.00	\$0.00	\$147.02

Billing - acct. # 66530  
 met. # 9190  
 storage shed / dog kennels

RECEIVED

JUN 11 2021

OWRD

**Attachment #3**

**Land Use Information Form**

Transfer Application for Certificates 30166, 94039, 94040, 94041, 94042, 94043, 94044, 94045, 94046

---

13739



# Land Use Information Form



Oregon Water Resources Department  
 725 Summer Street NE, Suite A  
 Salem, Oregon 97301-1266  
 (503) 986-0900  
 www.wrd.state.or.us

RECEIVED

JUN 11 2021

OWRD

Applicant(s): Dennis MacNab - Highland Hills Ranch

Mailing Address: 1215 Dry Hollow Road

City: The Dalles

State: OR

Zip Code: 97058

Daytime Phone: 541-296-2447

## A. Land and Location

Please include the following information for all tax lots where water will be diverted (taken from its source), conveyed (transported), and/or used or developed. Applicants for municipal use, or irrigation uses within irrigation districts may substitute existing and proposed service-area boundaries for the tax-lot information requested below.

Township	Range	Section	¼ ¼	Tax Lot #	Plan Designation (e.g., Rural Residential/RR-5)	Water to be:			Proposed Land Use:
<u>2S</u>	<u>22E</u>	<u>15</u>	<u>SESW, SWSE</u>	<u>1300</u>	<u>EFU</u>	<input checked="" type="checkbox"/> Diverted	<input checked="" type="checkbox"/> Conveyed	<input checked="" type="checkbox"/> Used	<u>Irrigation</u>
<u>2S</u>	<u>22E</u>	<u>22</u>	<u>E 1/2</u>	<u>1300</u>	<u>EFU</u>	<input checked="" type="checkbox"/> Diverted	<input checked="" type="checkbox"/> Conveyed	<input checked="" type="checkbox"/> Used	<u>Irrigation</u>
<u>2S</u>	<u>22E</u>	<u>23</u>	<u>W 1/2</u>	<u>1300</u>	<u>EFU</u>	<input checked="" type="checkbox"/> Diverted	<input checked="" type="checkbox"/> Conveyed	<input checked="" type="checkbox"/> Used	<u>Irrigation</u>
<u>2S</u>	<u>22E</u>	<u>26, 27</u>	<u>ALL</u>	<u>1300</u>	<u>EFU</u>	<input checked="" type="checkbox"/> Diverted	<input checked="" type="checkbox"/> Conveyed	<input checked="" type="checkbox"/> Used	<u>Irrigation</u>

List all counties and cities where water is proposed to be diverted, conveyed, and/or used or developed:

Gilliam

## B. Description of Proposed Use

Type of application to be filed with the Water Resources Department:

- Permit to Use or Store Water   
  Water Right Transfer   
  Permit Amendment or Ground Water Registration Modification  
 Limited Water Use License   
  Allocation of Conserved Water   
  Exchange of Water

Source of water:  Reservoir/Pond     Ground Water     Surface Water (name) Rock Creek

Estimated quantity of water needed: 3.1 & 4.3  cubic feet per second     gallons per minute     acre-feet

Intended use of water:  Irrigation     Commercial     Industrial     Domestic for \_\_\_\_\_ household(s)  
 Municipal     Quasi-Municipal     Instream     Other \_\_\_\_\_

Briefly describe:

Permanent transfer application to correctly show where water is currently being used. Place of use change only

**Note to applicant:** If the Land Use Information Form cannot be completed while you wait, please have a local government representative sign the receipt at the bottom of the next page and include it with the application filed with the Water Resources Department.

See bottom of Page 3. →

# For Local Government Use Only

OWRD

The following section must be completed by a planning official from each county and city listed unless the project will be located entirely within the city limits. In that case, only the city planning agency must complete this form. This deals only with the local land-use plan. Do not include approval for activities such as building or grading permits.

**Please check the appropriate box below and provide the requested information**

- Land uses to be served by the proposed water uses (including proposed construction) are allowed outright or are not regulated by your comprehensive plan. Cite applicable ordinance section(s):
- Land uses to be served by the proposed water uses (including proposed construction) involve discretionary land-use approvals as listed in the table below. (Please attach documentation of applicable land-use approvals which have already been obtained. Record of Action/land-use decision and accompanying findings are sufficient.) **If approvals have been obtained but all appeal periods have not ended, check "Being pursued."**

Type of Land-Use Approval Needed (e.g., plan amendments, rezones, conditional-use permits, etc.)	Cite Most Significant, Applicable Plan Policies & Ordinance Section References	Land-Use Approval:	
		<input type="checkbox"/> Obtained <input type="checkbox"/> Denied	<input type="checkbox"/> Being Pursued <input type="checkbox"/> Not Being Pursued
		<input type="checkbox"/> Obtained <input type="checkbox"/> Denied	<input type="checkbox"/> Being Pursued <input type="checkbox"/> Not Being Pursued
		<input type="checkbox"/> Obtained <input type="checkbox"/> Denied	<input type="checkbox"/> Being Pursued <input type="checkbox"/> Not Being Pursued
		<input type="checkbox"/> Obtained <input type="checkbox"/> Denied	<input type="checkbox"/> Being Pursued <input type="checkbox"/> Not Being Pursued
		<input type="checkbox"/> Obtained <input type="checkbox"/> Denied	<input type="checkbox"/> Being Pursued <input type="checkbox"/> Not Being Pursued

Local governments are invited to express special land-use concerns or make recommendations to the Water Resources Department regarding this proposed use of water below, or on a separate sheet.

**Consistent with Gilliam County Land Use Comprehensive Plan Goal3: To preserve and maintain agricultural lands. Authorization for Dennis MacNab 2S 22E Sections 15, 22, 23, 26, 27 Tax Lot 1300**

Name: Michelle L. Colby Title: Planning Director

Signature: *Michelle L. Colby* Phone: 541-384-2381 Date: 11-10-2020

Government Entity: Gilliam County

**Note to local government representative:** Please complete this form or sign the receipt below and return it to the applicant. If you sign the receipt, you will have 30 days from the Water Resources Department's notice date to return the completed Land Use Information Form or WRD may presume the land use associated with the proposed use of water is compatible with local comprehensive plans.

**Receipt for Request for Land Use Information**

Applicant name: \_\_\_\_\_

City or County: \_\_\_\_\_ Staff contact: \_\_\_\_\_

Signature: \_\_\_\_\_ Phone: \_\_\_\_\_ Date: \_\_\_\_\_



RECEIVED

JUN 11 2021

OWRD

**Attachment #4**

**Certificates and FPS Maps**

Transfer Application for Certificates 30166, 94039, 94040, 94041, 94042, 94043, 94044, 94045, 94046

---

STATE OF OREGON  
COUNTY OF GILLIAM

## CERTIFICATE OF WATER RIGHT

RECEIVED

JUN 11 2021

OWRD

**This Is to Certify, That** HARVEY SMITH

of Ione, State of Oregon, has made proof to the satisfaction of the STATE ENGINEER of Oregon, of a right to the use of the waters of Rock Creek

a tributary of John Day River for the purpose of irrigation of 152.2 acres

under Permit No. 22580 of the State Engineer, and that said right to the use of said waters has been perfected in accordance with the laws of Oregon; that the priority of the right hereby confirmed dates from August 3, 1953

that the amount of water to which such right is entitled and hereby confirmed, for the purposes aforesaid, is limited to an amount actually beneficially used for said purposes, and shall not exceed 2.0 cubic feet per second

or its equivalent in case of rotation, measured at the point of diversion from the stream. The point of diversion is located in the NE $\frac{1}{4}$  NE $\frac{1}{4}$ , NE $\frac{1}{4}$  SE $\frac{1}{4}$ , SE $\frac{1}{4}$  SE $\frac{1}{4}$ , Section 27; SE $\frac{1}{4}$  SW $\frac{1}{4}$ , Section 15; NW $\frac{1}{4}$  NE $\frac{1}{4}$ , NE $\frac{1}{4}$  SE $\frac{1}{4}$ , SE $\frac{1}{4}$  SE $\frac{1}{4}$ , Section 22, Township 2 S., Range 22 E., W.M.

The amount of water used for irrigation, together with the amount secured under any other right existing for the same lands, shall be limited to ~~one-fourtieth~~ of one cubic foot per second per acre, or its equivalent for each acre irrigated and shall be further limited to a diversion of not to exceed 4 acre feet per acre for each acre irrigated during the irrigation season of each year,

and shall conform to such reasonable rotation system as may be ordered by the proper state officer.

A description of the place of use under the right hereby confirmed, and to which such right is appurtenant, is as follows:

0.2 acre SE $\frac{1}{4}$ SW $\frac{1}{4}$	13.5 acres NE $\frac{1}{4}$ NE $\frac{1}{4}$
21.8 acres SW $\frac{1}{4}$ SE $\frac{1}{4}$	4.9 acres SE $\frac{1}{4}$ NE $\frac{1}{4}$
Section 15	14.3 acres NE $\frac{1}{4}$ SE $\frac{1}{4}$
1.0 acre NW $\frac{1}{4}$ NE $\frac{1}{4}$	1.6 acres SE $\frac{1}{4}$ SE $\frac{1}{4}$
2.8 acres NE $\frac{1}{4}$ NE $\frac{1}{4}$	Section 27
22.8 acres SE $\frac{1}{4}$ NE $\frac{1}{4}$	17.0 acres NW $\frac{1}{4}$ NW $\frac{1}{4}$
7.5 acres NE $\frac{1}{4}$ SE $\frac{1}{4}$	10.3 acres SW $\frac{1}{4}$ NW $\frac{1}{4}$
7.6 acres SE $\frac{1}{4}$ SE $\frac{1}{4}$	10.0 acres NW $\frac{1}{4}$ SW $\frac{1}{4}$
Section 22	Section 26
2.4 acres SW $\frac{1}{4}$ NW $\frac{1}{4}$	
7.6 acres NW $\frac{1}{4}$ SW $\frac{1}{4}$	
6.9 acres SW $\frac{1}{4}$ SW $\frac{1}{4}$	
Section 23	

All in T. 2 S., R. 22 E., W. M.

The right to the use of the water for the purposes aforesaid is restricted to the lands or place of use herein described.

WITNESS the signature of the State Engineer, affixed

this date. OCTOBER 15 1962

CHRIS L. WHEELER

State Engineer

Recorded in State Record of Water Right Certificates, Volume 22, page 30166

13739



RECEIVED

JUN 11 2021

OWRD

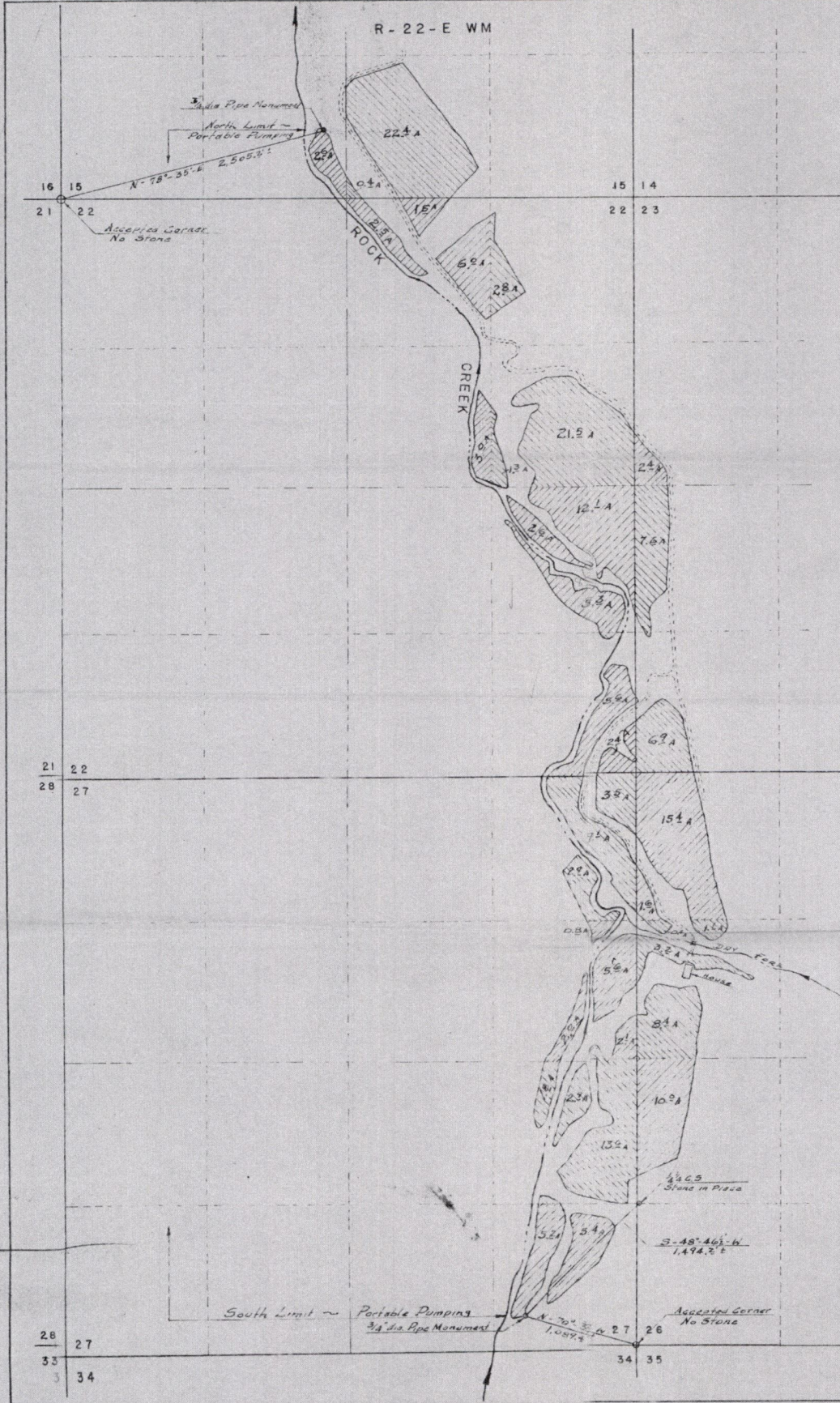

LAND

T-2-S, R-22-E WM

SEC 15 -	SE 1/4 SW 1/4	2.6 ACRES
	SW 1/4 SE 1/4	22.8
SEC 22 -	NW 1/4 NE 1/4	10.0
	NE 1/4 NE 1/4	2.8
	SW 1/4 NE 1/4	3.0
	SE 1/4 NE 1/4	22.8
	NE 1/4 SE 1/4	20.0
	SE 1/4 SE 1/4	8.0
SEC 23 -	SW 1/4 NW 1/4	2.4
	NW 1/4 SW 1/4	7.6
	SW 1/4 SW 1/4	6.9
SEC 27 -	NE 1/4 NE 1/4	13.5
	SE 1/4 NE 1/4	10.5
	NE 1/4 SE 1/4	18.3
	SE 1/4 SE 1/4	10.6
SEC 26	NW 1/4 NW 1/4	17.0
	SW 1/4 NW 1/4	13.1
	NW 1/4 SW 1/4	10.0
		TOTAL 201.9 ACRES

T  
2  
S

RECEIVED  
AUG 3 1953  
STATE ENGINEER  
SALEM, OREGON

Map prepared from field survey data taken by the Soil Conservation Service. Notes on file Gilliam County S&S office

WATER APPLICATION MAP  
 HARVEY SMITH-OWNER, IONE OREGON  
 ALL LAND IN GILLIAM COUNTY OREGON

U. S. DEPARTMENT OF AGRICULTURE  
 SOIL CONSERVATION SERVICE  
 H. H. BENNETT, CHIEF  
 REGION 7 DIRECTOR: J. H. CHRIST

PREPARED BY: W. R. STANLEY

DATE	TRACED	CHECKED	DATE	DRAWING NO.
WRS	WRS		7-53	

Application No. 28675  
Permit No. 22580

13739



STATE OF OREGON

COUNTY OF GILLIAM

CERTIFICATE OF WATER RIGHT

RECEIVED

JUN 11 2021

OWRD

THIS CERTIFICATE ISSUED TO

DENNIS MACNAB  
1629 E 12TH ST  
THE DALLES OR 97058

confirms the right to use the waters of ROCK CREEK for IRRIGATION of 17.4 ACRES.

This right was confirmed by decree of the Circuit Court of the State of Oregon for Grant County. The decree is of record at Salem, in the Order Record of the Water Resources Director in Volume 15, at Page 461. The date of priority is 1897.

The amount of water to which such right is entitled, for purposes aforesaid, is limited to an amount actually beneficially used for said purposes, and shall not exceed ONE-FORTIETH cubic foot per second per acre irrigated to June 1 and ONE-EIGHTIETH cubic foot per second per acre thereafter; further limited to 1.0 acre-foot per calendar month to June 1 and 4.0 acre-feet per acre during season April 1 to September 30, measured at the point of diversion.

The points of diversion are located as follows:

Twp	Rng	Mer	Sec	Q-Q	Measured Distances
ORIGINAL - NICHOLS AND FLETCHER DITCH					
2 S	22 E	WM	27	NE NE	ADDITIONAL - 1200 FEET SOUTH AND 110 FEET WEST FROM NE CORNER, SECTION 27

A description of the place of use is as follows:

Twp	Rng	Mer	Sec	Q-Q	Acres
2 S	22 E	WM	15	SE SW	2.4
2 S	22 E	WM	15	SW SE	1.0
2 S	22 E	WM	22	NW NE	9.0
2 S	22 E	WM	22	SW NE	5.0

The quantity of water diverted at the new point of diversion, together with that diverted at the old point of diversion, shall not exceed the quantity of water lawfully available at the original point of diversion described as follows: NICHOLS AND FLETCHER DITCH

When required by the Department, the water user shall install and maintain a headgate, an in-line flow meter, weir, or other suitable device for measuring and recording the quantity of water diverted. The type and plans of the headgate and measuring device must be approved by the Department prior to beginning construction and shall be installed under the general supervision of the Department.

Water shall be acquired from the same surface water source as the original points of diversion.

**NOTICE OF RIGHT TO PETITION FOR RECONSIDERATION OR JUDICIAL REVIEW**

This is an order in other than a contested case. This order is subject to judicial review under ORS 183.482. Any petition for judicial review must be filed within the 60-day time period specified by ORS 183.482. Pursuant to ORS 183.482, ORS 536.075 and OAR 137-003-0675, you may petition for judicial review and petition the Director for reconsideration of this order. A petition for reconsideration may be granted or denied by the Director, and if no action is taken within 60 days following the date the petition was filed, the petition shall be deemed denied.



The right to use water for the above purpose is restricted to beneficial use on the lands or place of use described and is subject to all other conditions and limitations contained in the decree.

This certificate is issued to confirm an ADDITIONAL POINT OF DIVERSION approved by an order of the Water Resources Director entered August 26, 2003, at Special Order Volume 58, Page 60, approving Transfer Application T-8596, and supercedes Certificate 25630, State record of Water Right Certificates.

Issued DEC 14 2018

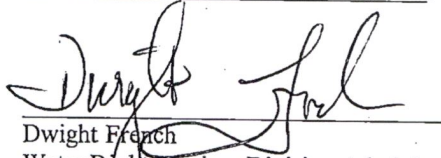

Dwight French  
Water Right Services Division Administrator, for  
Thomas M. Byler, Director  
Oregon Water Resources Department

RECEIVED

JUN 11 2021

OWRD

STATE OF OREGON

COUNTY OF GILLIAM

CERTIFICATE OF WATER RIGHT

RECEIVED

JUN 11 2021

OWRD

THIS CERTIFICATE ISSUED TO

DENNIS MACNAB  
1629 E 12TH ST  
THE DALLES OR 97058

confirms the right to use the waters of DRY FORK OF ROCK CREEK for IRRIGATION of 8.4 ACRES.

This right was confirmed by decree of the Circuit Court of the State of Oregon for Grant County. The decree is of record at Salem, in the Order Record of the Water Resources Director in Volume 15, at Page 461. The date of priority is 1902.

The amount of water to which such right is entitled, for purposes aforesaid, is limited to an amount actually beneficially used for said purposes, and shall not exceed ONE-FORTIETH cubic foot per second per acre irrigated to June 1 and ONE-EIGHTIETH cubic foot per second per acre thereafter; further limited to 1.0 acre-foot per calendar month to June 1 and 4.0 acre-feet per acre during season April 1 to September 30, measured at the point of diversion.

The points of diversion are located as follows:

Twp	Rng	Mer	Sec	Q-Q	Measured Distances
ORIGINAL - DAM AND MOORE DITCH					
2 S	22 E	WM	27	NE NE	ADDITIONAL - 1200 FEET SOUTH AND 110 FEET WEST FROM NE CORNER, SECTION 27

A description of the place of use is as follows:

Twp	Rng	Mer	Sec	Q-Q	Acres
2 S	22 E	WM	26	SW NW	2.8
2 S	22 E	WM	27	SE NE	5.6

The quantity of water diverted at the new point of diversion, together with that diverted at the old point of diversion, shall not exceed the quantity of water lawfully available at the original point of diversion described as follows: DAM AND MOORE DITCH.

When required by the Department, the water user shall install and maintain a headgate, an in-line flow meter, weir, or other suitable device for measuring and recording the quantity of water diverted. The type and plans of the headgate and measuring device must be approved by the Department prior to beginning construction and shall be installed under the general supervision of the Department.

Water shall be acquired from the same surface water source as the original points of diversion.

The right to use water for the above purpose is restricted to beneficial use on the lands or place of use described and is subject to all other conditions and limitations contained in the decree.

**NOTICE OF RIGHT TO PETITION FOR RECONSIDERATION OR JUDICIAL REVIEW**

This is an order in other than a contested case. This order is subject to judicial review under ORS 183.482. Any petition for judicial review must be filed within the 60-day time period specified by ORS 183.482. Pursuant to ORS 183.482, ORS 536.075 and OAR 137-003-0675, you may petition for judicial review and petition the Director for reconsideration of this order. A petition for reconsideration may be granted or denied by the Director, and if no action is taken within 60 days following the date the petition was filed, the petition shall be deemed denied.



This certificate is issued to confirm an ADDITIONAL POINT OF DIVERSION approved by an order of the Water Resources Director entered August 26, 2003, at Special Order Volume 58, Page 60, approving Transfer Application T-8596, and supercedes Certificate 25573, State record of Water Right Certificates.

Issued DEC 14 2018

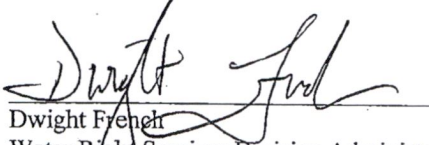

Dwight French  
Water Right Services Division Administrator, for  
Thomas M. Byler, Director  
Oregon Water Resources Department

RECEIVED

JUN 11 2021

OWRD

STATE OF OREGON  
 COUNTY OF GILLIAM  
 CERTIFICATE OF WATER RIGHT

**RECEIVED**

**JUN 11 2021**

**OWRD**

THIS CERTIFICATE ISSUED TO

DENNIS MACNAB  
 1629 E 12TH ST  
 THE DALLES OR 97058

confirms the right to use the waters of ROCK CREEK for IRRIGATION of 13.3 ACRES.

This right was confirmed by decree of the Circuit Court of the State of Oregon for Grant County. The decree is of record at Salem, in the Order Record of the Water Resources Director in Volume 15, at Page 461. The date of priority is 1905.

The amount of water to which such right is entitled, for purposes aforesaid, is limited to an amount actually beneficially used for said purposes, and shall not exceed ONE-FORTIETH cubic foot per second per acre irrigated to June 1 and ONE-EIGHTIETH cubic foot per second per acre thereafter; further limited to 1.0 acre-foot per calendar month to June 1 and 4.0 acre-feet per acre during season April 1 to September 30, measured at the point of diversion.

The points of diversion are located as follows:

Twp	Rng	Mer	Sec	Q-Q	Measured Distances
ORIGINAL - NICHOLS AND FLETCHER DITCH					
2 S	22 E	WM	27	NE NE	ADDITIONAL - 1200 FEET SOUTH AND 110 FEET WEST FROM NE CORNER, SECTION 27

A description of the place of use is as follows:

Twp	Rng	Mer	Sec	Q-Q	Acres
2 S	22 E	WM	22	NE SE	12.5
2 S	22 E	WM	22	NW SE	0.4
2 S	22 E	WM	22	SE SE	0.4

The quantity of water diverted at the new point of diversion, together with that diverted at the old point of diversion, shall not exceed the quantity of water lawfully available at the original point of diversion described as follows: NICHOLS AND FLETCHER DITCH

When required by the Department, the water user shall install and maintain a headgate, an in-line flow meter, weir, or other suitable device for measuring and recording the quantity of water diverted. The type and plans of the headgate and measuring device must be approved by the Department prior to beginning construction and shall be installed under the general supervision of the Department.

Water shall be acquired from the same surface water source as the original points of diversion.

The right to use water for the above purpose is restricted to beneficial use on the lands or place of use described and is subject to all other conditions and limitations contained in the decree.

**NOTICE OF RIGHT TO PETITION FOR RECONSIDERATION OR JUDICIAL REVIEW**

This is an order in other than a contested case. This order is subject to judicial review under ORS 183.482. Any petition for judicial review must be filed within the 60-day time period specified by ORS 183.482. Pursuant to ORS 183.482, ORS 536.075 and OAR 137-003-0675, you may petition for judicial review and petition the Director for reconsideration of this order. A petition for reconsideration may be granted or denied by the Director, and if no action is taken within 60 days following the date the petition was filed, the petition shall be deemed denied.



This certificate is issued to confirm an ADDITIONAL POINT OF DIVERSION approved by an order of the Water Resources Director entered August 26, 2003, at Special Order Volume 58, Page 60, approving Transfer Application T-8596, and supercedes Certificate 24943, State record of Water Right Certificates.

Issued DEC 14 2018



Dwight French  
Water Right Services Division Administrator, for  
Thomas M. Byler, Director  
Oregon Water Resources Department

RECEIVED

JUN 11 2021

OWRD

STATE OF OREGON

COUNTY OF GILLIAM

CERTIFICATE OF WATER RIGHT

RECEIVED

JUN 11 2021

OWRD

THIS CERTIFICATE ISSUED TO

DENNIS MACNAB  
1629 E 12TH ST  
THE DALLES OR 97058

confirms the right to the use of water perfected under the terms of Permit S-6408. The amount of water used to which this right is entitled is limited to the amount used beneficially, and shall not exceed the amount specified, or its equivalent in the case of rotation, measured at the point of diversion from the source. The specific limits and conditions of the use are listed below.

SOURCE OF WATER: ROCK CREEK, A TRIBUTARY OF JOHN DAY RIVER

PURPOSE OR USE: IRRIGATION OF 13.0 ACRES

MAXIMUM RATE: 0.18 CUBIC FOOT PER SECOND

DATE OF PRIORITY: JULY 5, 1924

The points of diversion are located as follows:

Twp	Rng	Mer	Sec	Q-Q	Measured Distances
2 S	22 E	WM	3	NW NW	ORIGINAL
2 S	22 E	WM	27	NE NE	ADDITIONAL - 1200 FEET SOUTH AND 110 FEET WEST FROM NE CORNER, SECTION 27

The amount of water used for irrigation, together with the amount secured under any other right existing for the same lands, is limited to ONE-EIGHTIETH of one cubic foot per second per acre or its equivalent, in case of rotation.

The use shall conform to any reasonable rotation system ordered by the proper state officer.

A description of the place of use is as follows:

Twp	Rng	Mer	Sec	Q-Q	Acres
2 S	22 E	WM	27	NE SE	4.0
2 S	22 E	WM	27	SE SE	9.0

The quantity of water diverted at the new point of diversion, together with that diverted at the old point of diversion, shall not exceed the quantity of water lawfully available at the original point of diversion.

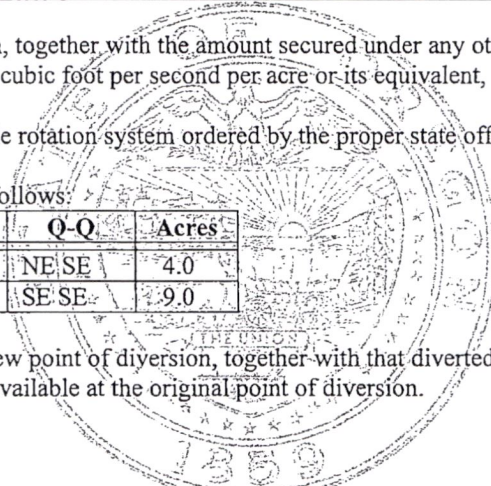

**NOTICE OF RIGHT TO PETITION FOR RECONSIDERATION OR JUDICIAL REVIEW**

This is an order in other than a contested case. This order is subject to judicial review under ORS 183.482. Any petition for judicial review must be filed within the 60-day time period specified by ORS 183.482. Pursuant to ORS 183.482, ORS 536.075 and OAR 137-003-0675, you may petition for judicial review and petition the Director for reconsideration of this order. A petition for reconsideration may be granted or denied by the Director, and if no action is taken within 60 days following the date the petition was filed, the petition shall be deemed denied.



When required by the Department, the water user shall install and maintain a headgate, an in-line flow meter, weir, or other suitable device for measuring and recording the quantity of water diverted. The type and plans of the headgate and measuring device must be approved by the Department prior to beginning construction and shall be installed under the general supervision of the Department.

Water shall be acquired from the same surface water source as the original points of diversion.

The right to the use of the water for the above purpose is restricted to beneficial use on the place of use described.

This certificate is issued to confirm an ADDITIONAL POINT OF DIVERSION approved by an order of the Water Resources Director entered August 26, 2003, at Special Order Volume 58, Page 60, approving Transfer Application T-8596, and supercedes Certificate 6126, State record of Water Right Certificates.

Issued DEC 14 2018



Dwight French  
Water Right Services Division Administrator, for  
Thomas M. Byler, Director  
Oregon Water Resources Department

RECEIVED

JUN 11 2021

OWRD

STATE OF OREGON  
 COUNTY OF GILLIAM  
 CERTIFICATE OF WATER RIGHT

RECEIVED

JUN 11 2021

OWRD

THIS CERTIFICATE ISSUED TO

DENNIS MACNAB  
 1629 E 12TH ST  
 THE DALLES OR 97058

confirms the right to the use of water perfected under the terms of Permit G-3400. The amount of water used to which this right is entitled is limited to the amount used beneficially, and shall not exceed the amount specified, or its equivalent in the case of rotation, measured at the wells. The specific limits and conditions of the use are listed below.

SOURCE OF WATER: FOUR WELLS, TRIBUTARIES OF ROCK CREEK

PURPOSE OR USE: IRRIGATION OF 19.4 ACRES AND SUPPLEMENTAL IRRIGATION OF 29.3 ACRES

MAXIMUM RATE: 0.61 CUBIC FOOT PER SECOND

DATE OF PRIORITY: AUGUST 15, 1966

The wells are located as follows:

Twp	Rng	Mer	Sec	Q-Q	Measured Distances
2 S	22 E	WM	15	SW SE	WELL 4 (ADDITIONAL) - 50 FEET NORTH AND 2480 FEET WEST FROM SE CORNER, SECTION 15
2 S	22 E	WM	23	SW SW	WELL 3 (ADDITIONAL) - 1320 FEET NORTH AND 80 FEET EAST FROM SE CORNER, SECTION 22
2 S	22 E	WM	26	NW NW	WELL 1 (ORIGINAL) - 4000 FEET NORTH AND 170 FEET EAST FROM SW CORNER, SECTION 26
2 S	22 E	WM	26	SE NW	WELL 2 (ADDITIONAL) - 3070 FEET NORTH AND 1560 FEET EAST FROM SW CORNER, SECTION 26

The amount of water used for irrigation, together with the amount secured under any other right existing for the same lands, shall be limited to ONE-EIGHTIETH of one cubic foot per second per acre, or its equivalent for each acre irrigated, and shall be further limited to a diversion of not to exceed 3.0 acre-feet per acre for each acre irrigated during the irrigation season of each year; provided further that the right allowed herein shall be limited to any deficiency in the available supply of any prior right existing for the same land and shall not exceed the limitation allowed herein.

The use shall conform to such reasonable rotation system as may be ordered by the proper state officer.

A description of the place of use is as follows:

PRIMARY IRRIGATION					
Twp	Rng	Mer	Sec	Q-Q	Acres
2 S	22 E	WM	23	SW SW	8.8
2 S	22 E	WM	26	NW NW	10.6

**NOTICE OF RIGHT TO PETITION FOR RECONSIDERATION OR JUDICIAL REVIEW**

This is an order in other than a contested case. This order is subject to judicial review under ORS 183.482. Any petition for judicial review must be filed within the 60-day time period specified by ORS 183.482. Pursuant to ORS 183.482, ORS 536.075 and OAR 137-003-0675, you may petition for judicial review and petition the Director for reconsideration of this order. A petition for reconsideration may be granted or denied by the Director, and if no action is taken within 60 days following the date the petition was filed, the petition shall be deemed denied.



RECEIVED

JUN 11 2021

OWRD

SUPPLEMENTAL IRRIGATION					
Twp	Rng	Mer	Sec	Q-Q	Acres
2 S	22 E	WM	22	SE SE	2.2
2 S	22 E	WM	23	SW SW	6.9
2 S	22 E	WM	26	NW NW	17.0
2 S	22 E	WM	26	SW NW	1.2
2 S	22 E	WM	27	NE NE	2.0

The quantity of water diverted at the new additional points of appropriation (well), together with the quantity diverted at the old point of appropriation, shall not exceed the quantity of water lawfully available from the original point of appropriation.

When required by the Department, the water user shall install and maintain a headgate, an in-line flow meter, weir, or other suitable device for measuring and recording the quantity of water diverted. The type and plans of the headgate and measuring device must be approved by the Department prior to beginning construction and shall be installed under the general supervision of the Department.

The Director may require the water user to keep and maintain a record of the amount (volume) of water used and may require the water user to report water use on a periodic schedule as established by the Director. In addition, the Director may require the water user to report general water use information, the periods of water use and the place and nature of use of water under the right. The Director may provide an opportunity for the water user to submit alternative reporting procedures for review and approval.

Water shall be acquired from the same aquifer as the original point of appropriation.

The right to the use of the water for the above purpose is restricted to beneficial use on the place of use described.

This certificate is issued to confirm ADDITIONAL POINTS OF APPROPRIATION approved by an order of the Water Resources Director entered August 12, 2003, at Special Order Volume 57, Page 1285, approving Transfer Application T-8597, and supercedes Certificate 42294, State record of Water Right Certificates.

Issued DEC 14 2018

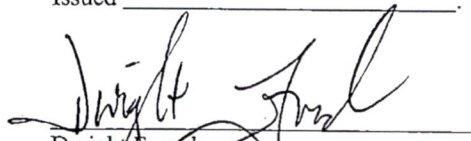

Dwight French  
Water Right Services Division Administrator, for  
Thomas M. Byler, Director  
Oregon Water Resources Department

RECEIVED

JUN 11 2021

STATE OF OREGON

COUNTY OF GILLIAM

CERTIFICATE OF WATER RIGHT

OWRD

THIS CERTIFICATE ISSUED TO

DENNIS MACNAB  
1629 E 12TH ST  
THE DALLES OR 97058

confirms the right to the use of water perfected under the terms of Permit G-3780. The amount of water used to which this right is entitled is limited to the amount used beneficially, and shall not exceed the amount specified, or its equivalent in the case of rotation, measured at the wells. The specific limits and conditions of the use are listed below.

SOURCE OF WATER: FOUR WELLS, TRIBUTARIES OF ROCK CREEK

PURPOSE OR USE: IRRIGATION OF 4.2 ACRES AND SUPPLEMENTAL IRRIGATION OF 88.2 ACRES

MAXIMUM RATE: 1.16 CUBIC FEET PER SECOND (CFS), FURTHER LIMITED TO 0.61 CFS FROM WELL 1, 1.16 CFS FROM WELL 2, 0.94 CFS FROM WELL 3 AND 1.16 CFS FROM WELL 4, IN ANY COMBINATION, OR ITS EQUIVALENT IN CASE OF ROTATION, MEASURED AT THE WELL

DATE OF PRIORITY: AUGUST 10, 1967

The wells are located as follows:

Twp	Rng	Mer	Sec	Q-Q	Measured Distances
2 S	22 E	WM	15	SW SE	WELL 4 (ADDITIONAL) - 50 FEET NORTH AND 2480 FEET WEST FROM SE CORNER, SECTION 15
2 S	22 E	WM	23	SW SW	WELL 3 (ADDITIONAL) - 1320 FEET NORTH AND 80 FEET EAST FROM SE CORNER, SECTION 22
2 S	22 E	WM	26	NW NW	WELL 1 (ADDITIONAL) - 4000 FEET NORTH AND 170 FEET EAST FROM SW CORNER, SECTION 26
2 S	22 E	WM	26	SE NW	WELL 2 (ORIGINAL) - 3070 FEET NORTH AND 1560 FEET EAST FROM SW CORNER, SECTION 26

The amount of water used for irrigation, together with the amount secured under any other right existing for the same lands, shall be limited to ONE-EIGHTIETH of one cubic foot per second per acre, or its equivalent for each acre irrigated, and shall be further limited to a diversion of not to exceed 3.0 acre-feet per acre for each acre irrigated during the irrigation season of each year; provided further that the right allowed herein shall be limited to any deficiency in the available supply of any prior right existing for the same land and shall not exceed the limitation allowed herein.

The use shall conform to such reasonable rotation system as may be ordered by the proper state officer.

**NOTICE OF RIGHT TO PETITION FOR RECONSIDERATION OR JUDICIAL REVIEW**

This is an order in other than a contested case. This order is subject to judicial review under ORS 183.482. Any petition for judicial review must be filed within the 60-day time period specified by ORS 183.482. Pursuant to ORS 183.482, ORS 536.075 and OAR 137-003-0675, you may petition for judicial review and petition the Director for reconsideration of this order. A petition for reconsideration may be granted or denied by the Director, and if no action is taken within 60 days following the date the petition was filed, the petition shall be deemed denied.



RECEIVED

JUN 11 2021

OWRD

A description of the place of use is as follows:

PRIMARY IRRIGATION					
Twp	Rng	Mer	Sec	Q-Q	Acres
2 S	22 E	WM	27	NE SE	3.2
2 S	22 E	WM	27	SE SE	1.0

SUPPLEMENTAL IRRIGATION					
Twp	Rng	Mer	Sec	Q-Q	Acres
2 S	22 E	WM	22	SE SE	2.2
2 S	22 E	WM	23	SW SW	15.7
2 S	22 E	WM	26	NW NW	27.6
2 S	22 E	WM	26	SW NW	11.2
2 S	22 E	WM	26	NW SW	10.0
2 S	22 E	WM	27	NE NE	2.0
2 S	22 E	WM	27	SE NE	2.8
2 S	22 E	WM	27	NE SE	16.3
2 S	22 E	WM	27	SE SE	0.4

The quantity of water diverted at the new additional points of appropriation (well), together with the quantity diverted at the old point of appropriation, shall not exceed the quantity of water lawfully available from the original point of appropriation.

When required by the Department, the water user shall install and maintain a headgate, an in-line flow meter, weir, or other suitable device for measuring and recording the quantity of water diverted. The type and plans of the headgate and measuring device must be approved by the Department prior to beginning construction and shall be installed under the general supervision of the Department.

The Director may require the water user to keep and maintain a record of the amount (volume) of water used and may require the water user to report water use on a periodic schedule as established by the Director. In addition, the Director may require the water user to report general water use information, the periods of water use and the place and nature of use of water under the right. The Director may provide an opportunity for the water user to submit alternative reporting procedures for review and approval.

Water shall be acquired from the same aquifer as the original point of appropriation.

The right to the use of the water for the above purpose is restricted to beneficial use on the place of use described.

This certificate is issued to confirm ADDITIONAL POINTS OF APPROPRIATION approved by an order of the Water Resources Director entered August 12, 2003, at Special Order Volume 57, Page 1285, approving Transfer Application T-8597, and supercedes Certificate 42295, State record of Water Right Certificates.

Issued DEC 14 2018

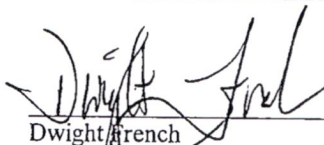

Dwight French  
Water Right Services Division Administrator, for  
Thomas M. Byler, Director  
Oregon Water Resources Department

STATE OF OREGON

COUNTY OF GILLIAM

CERTIFICATE OF WATER RIGHT

RECEIVED

JUN 11 2021

OWRD

THIS CERTIFICATE ISSUED TO

DENNIS MACNAB  
1629 E 12TH ST  
THE DALLES OR 97058

confirms the right to the use of water perfected under the terms of Permit G-5356. The amount of water used to which this right is entitled is limited to the amount used beneficially, and shall not exceed the amount specified, or its equivalent in the case of rotation, measured at the wells. The specific limits and conditions of the use are listed below.

SOURCE OF WATER: FOUR WELLS, TRIBUTARIES OF ROCK CREEK

PURPOSE OR USE: IRRIGATION OF 5.9 ACRES AND SUPPLEMENTAL IRRIGATION OF 69.2 ACRES

MAXIMUM RATE: 0.94 CUBIC FOOT PER SECOND (CFS), FURTHER LIMITED TO 0.61 CFS FROM WELL 1 AND 0.94 CFS EACH FROM WELL 2, WELL 3 AND WELL 4, IN ANY COMBINATION, OR ITS EQUIVALENT IN CASE OF ROTATION, MEASURED AT THE WELL

DATE OF PRIORITY: FEBRUARY 12, 1971

The wells are located as follows:

Twp	Rng	Mer	Sec	Q-Q	Measured Distances
2 S	22 E	WM	15	SW SE	WELL 4 (ADDITIONAL) - 50 FEET NORTH AND 2480 FEET WEST FROM SE CORNER, SECTION 15
2 S	22 E	WM	23	SW SW	WELL 3 (ORIGINAL) - 1320 FEET NORTH AND 80 FEET EAST FROM SE CORNER, SECTION 22
2 S	22 E	WM	26	NW NW	WELL 1 (ADDITIONAL) - 4000 FEET NORTH AND 170 FEET EAST FROM SW CORNER, SECTION 26
2 S	22 E	WM	26	SE NW	WELL 2 (ADDITIONAL) - 3070 FEET NORTH AND 1560 FEET EAST FROM SW CORNER, SECTION 26

The amount of water used for irrigation, together with the amount secured under any other right existing for the same lands, shall be limited to ONE-EIGHTIETH of one cubic foot per second per acre, or its equivalent for each acre irrigated, and shall be further limited to a diversion of not to exceed 3.0 acre-feet per acre for each acre irrigated during the irrigation season of each year.

The use shall conform to such reasonable rotation system as may be ordered by the proper state officer.

**NOTICE OF RIGHT TO PETITION FOR RECONSIDERATION OR JUDICIAL REVIEW**

This is an order in other than a contested case. This order is subject to judicial review under ORS 183.482. Any petition for judicial review must be filed within the 60-day time period specified by ORS 183.482. Pursuant to ORS 183.482, ORS 536.075 and OAR 137-003-0675, you may petition for judicial review and petition the Director for reconsideration of this order. A petition for reconsideration may be granted or denied by the Director, and if no action is taken within 60 days following the date the petition was filed, the petition shall be deemed denied.



A description of the place of use is as follows:

PRIMARY IRRIGATION					
Twp	Rng	Mer	Sec	Q-Q	Acres
2 S	22 E	WM	22	NE SE	4.9
2 S	22 E	WM	22	NW SE	0.5
2 S	22 E	WM	23	SW SW	0.5

RECEIVED

JUN 11 2021

OWRD

SUPPLEMENTAL IRRIGATION					
Twp	Rng	Mer	Sec	Q-Q	Acres
2 S	22 E	WM	22	SE NE	20.0
2 S	22 E	WM	22	NE SE	20.0
2 S	22 E	WM	22	NW SE	0.4
2 S	22 E	WM	22	SE SE	4.6
2 S	22 E	WM	23	SW NW	3.2
2 S	22 E	WM	23	NW SW	21.0

The quantity of water diverted at the new additional points of appropriation (well), together with the quantity diverted at the old point of appropriation, shall not exceed the quantity of water lawfully available from the original point of appropriation.

When required by the Department, the water user shall install and maintain a headgate, an in-line flow meter, weir, or other suitable device for measuring and recording the quantity of water diverted. The type and plans of the headgate and measuring device must be approved by the Department prior to beginning construction and shall be installed under the general supervision of the Department.

The Director may require the water user to keep and maintain a record of the amount (volume) of water used and may require the water user to report water use on a periodic schedule as established by the Director. In addition, the Director may require the water user to report general water use information, the periods of water use and the place and nature of use of water under the right. The Director may provide an opportunity for the water user to submit alternative reporting procedures for review and approval.

Water shall be acquired from the same aquifer as the original point of appropriation.

The right to the use of the water for the above purpose is restricted to beneficial use on the place of use described.

This certificate is issued to confirm ADDITIONAL POINTS OF APPROPRIATION approved by an order of the Water Resources Director entered August 12, 2003, at Special Order Volume 57, Page 1285, approving Transfer Application T-8597, and supercedes Certificate 46548, State record of Water Right Certificates.

Issued DEC 14 2018

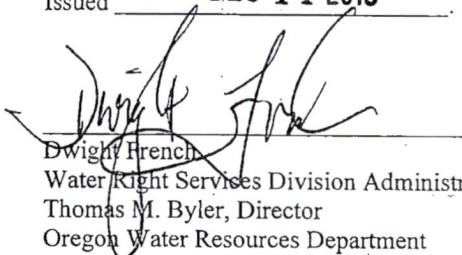
  
 \_\_\_\_\_  
 Dwight French  
 Water Right Services Division Administrator, for  
 Thomas M. Byler, Director  
 Oregon Water Resources Department

STATE OF OREGON  
COUNTY OF GILLIAM  
CERTIFICATE OF WATER RIGHT

RECEIVED

JUN 11 2021

OWRD

THIS CERTIFICATE ISSUED TO

DENNIS MACNAB  
1629 E 12TH ST  
THE DALLES OR 97058

confirms the right to the use of water perfected under the terms of Permit G-3952. The amount of water used to which this right is entitled is limited to the amount used beneficially, and shall not exceed the amount specified, or its equivalent in the case of rotation, measured at the wells. The specific limits and conditions of the use are listed below.

SOURCE OF WATER: FOUR WELLS, TRIBUTARIES OF ROCK CREEK

PURPOSE OR USE: IRRIGATION OF 48.3 ACRES AND SUPPLEMENTAL IRRIGATION OF 83.3 ACRES

MAXIMUM RATE: 1.65 CUBIC FEET PER SECOND (CFS), FURTHER LIMITED TO 0.61 CFS FROM WELL 1, 1.16 CFS FROM WELL 2, 0.94 CFS FROM WELL 3 AND 1.65 CFS FROM WELL 4, IN ANY COMBINATION, OR ITS EQUIVALENT IN CASE OF ROTATION, MEASURED AT THE WELL

DATE OF PRIORITY: JANUARY 17, 1968

The wells are located as follows:

Twp	Rng	Mer	Sec	Q-Q	Measured Distances
2 S	22 E	WM	15	SW SE	WELL 4 (ORIGINAL) - 50 FEET NORTH AND 2480 FEET WEST FROM SE CORNER, SECTION 15
2 S	22 E	WM	23	SW SW	WELL 3 (ADDITIONAL) - 1320 FEET NORTH AND 80 FEET EAST FROM SE CORNER, SECTION 22
2 S	22 E	WM	26	NW NW	WELL 1 (ADDITIONAL) - 4000 FEET NORTH AND 170 FEET EAST FROM SW CORNER, SECTION 26
2 S	22 E	WM	26	SE NW	WELL 2 (ADDITIONAL) - 3070 FEET NORTH AND 1560 FEET EAST FROM SW CORNER, SECTION 26

The amount of water used for irrigation, together with the amount secured under any other right existing for the same lands, shall be limited to ONE-EIGHTIETH of one cubic foot per second per acre, or its equivalent for each acre irrigated, and shall be further limited to a diversion of not to exceed 3.0 acre-feet per acre for each acre irrigated during the irrigation season of each year; provided further that the right allowed herein shall be limited to any deficiency in the available supply of any prior right existing for the same land and shall not exceed the limitation allowed herein and shall be further limited to appropriation of water only to the extent that it does not impair or substantially interfere with existing surface water rights of others.

The use shall conform to such reasonable rotation system as may be ordered by the proper state officer.

**NOTICE OF RIGHT TO PETITION FOR RECONSIDERATION OR JUDICIAL REVIEW**

This is an order in other than a contested case. This order is subject to judicial review under ORS 183.482. Any petition for judicial review must be filed within the 60-day time period specified by ORS 183.482. Pursuant to ORS 183.482, ORS 536.075 and OAR 137-003-0675, you may petition for judicial review and petition the Director for reconsideration of this order. A petition for reconsideration may be granted or denied by the Director, and if no action is taken within 60 days following the date the petition was filed, the petition shall be deemed denied.



A description of the place of use is as follows:

PRIMARY IRRIGATION					
Twp	Rng	Mer	Sec	Q-Q	Acres
2 S	22 E	WM	15	SE SW	8.2
2 S	22 E	WM	15	SW SE	0.5
2 S	22 E	WM	22	NW NE	14.2
2 S	22 E	WM	22	SW NE	2.2
2 S	22 E	WM	22	SE NE	0.6
2 S	22 E	WM	22	NE NW	8.4
2 S	22 E	WM	23	SW NW	0.8
2 S	22 E	WM	23	NW SW	13.4

SUPPLEMENTAL IRRIGATION					
Twp	Rng	Mer	Sec	Q-Q	Acres
2 S	22 E	WM	15	SE SW	2.6
2 S	22 E	WM	15	SW SE	22.8
2 S	22 E	WM	22	NW NE	10.0
2 S	22 E	WM	22	SW NE	5.0
2 S	22 E	WM	22	SE NE	22.8
2 S	22 E	WM	22	NE SE	10.1
2 S	22 E	WM	23	SW NW	2.4
2 S	22 E	WM	23	NW SW	7.6

RECEIVED

JUN 11 2021

OWRD

The quantity of water diverted at the new additional points of appropriation (well), together with the quantity diverted at the old point of appropriation, shall not exceed the quantity of water lawfully available from the original point of appropriation.

When required by the Department, the water user shall install and maintain a headgate, an in-line flow meter, weir, or other suitable device for measuring and recording the quantity of water diverted. The type and plans of the headgate and measuring device must be approved by the Department prior to beginning construction and shall be installed under the general supervision of the Department.

The Director may require the water user to keep and maintain a record of the amount (volume) of water used and may require the water user to report water use on a periodic schedule as established by the Director. In addition, the Director may require the water user to report general water use information, the periods of water use and the place and nature of use of water under the right. The Director may provide an opportunity for the water user to submit alternative reporting procedures for review and approval.

Water shall be acquired from the same aquifer as the original point of appropriation.

The right to the use of the water for the above purpose is restricted to beneficial use on the place of use described.

This certificate is issued to confirm ADDITIONAL POINTS OF APPROPRIATION approved by an order of the Water Resources Director entered August 12, 2003, at Special Order Volume 57, Page 1285, approving Transfer Application T-8597, and together with Certificate 80401, supercedes Certificate 42297, State record of Water Right Certificates.

JEC 14 2018

Issued

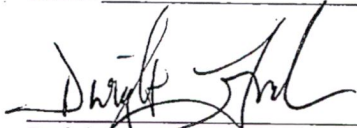

Dwight French  
Water Right Services Division Administrator, for  
Thomas M. Byler, Director  
Oregon Water Resources Department

RECEIVED

JUN 11 2021

OWRD

**Attachment #5**

**Well Logs**

Transfer Application for Certificates 30166, 94039, 94040, 94041, 94042, 94043, 94044, 94045, 94046

---

13739



NOTICE TO WATER WELL CONTRACTOR  
The original and first copy  
of this report are to be  
filed with the

RECEIVED  
DEC 30 1967

STATE ENGINEER, SALEM, OREGON 97310  
STATE OF OREGON  
(Please type or print)

State Well No. 2/22-15 Q

STATE ENGINEER, SALEM, OREGON 97310  
within 30 days from the date  
of well completion.

STATE OF OREGON  
(Please type or print)

G-4185

State Permit No. ....

(1) OWNER:

Name Harvey Smith  
Address Box 448, Ione, Oregon 97843

(2) LOCATION OF WELL:

County Gilliam Driller's well number  
1/4 Section 15 T. 2S R. EW W.M.  
Bearing and distance from section or subdivision corner

(3) TYPE OF WORK (check):

Well  Deepening  Reconditioning  Abandon   
abandonment, describe material and procedure in Item 12.

(4) PROPOSED USE (check):

Domestic  Industrial  Municipal  Rotary  Driven   
Irrigation  Test Well  Other  Cable  Jetted   
Dug  Bored

(5) TYPE OF WELL:

Rotary  Driven   
Cable  Jetted   
Dug  Bored

(6) CASING INSTALLED:

Threaded  Welded   
12" Diam. from 0 ft. to 3617 ft. Gage std.  
" Diam. from ..... ft. to ..... ft. Gage  
" Diam. from ..... ft. to ..... ft. Gage

(7) PERFORATIONS:

Perforated?  Yes  No  
Type of perforator used  
Size of perforations in. by in.  
..... perforations from ..... ft. to ..... ft.  
..... perforations from ..... ft. to ..... ft.  
..... perforations from ..... ft. to ..... ft.  
..... perforations from ..... ft. to ..... ft.  
..... perforations from ..... ft. to ..... ft.

(8) SCREENS:

Well screen installed?  Yes  No  
Manufacturer's Name ..... Model No. ....  
Diam. .... Slot size ..... Set from ..... ft. to ..... ft.  
Diam. .... Slot size ..... Set from ..... ft. to ..... ft.

(9) CONSTRUCTION:

Well seal—Material used in seal cement  
Depth of seal 3617 ft. Was a packer used? no  
Diameter of well bore to bottom of seal 15 in.  
Were any loose strata cemented off?  Yes  No Depth .....  
Was a drive shoe used?  Yes  No  
Was well gravel packed?  Yes  No Size of gravel: .....  
Gravel placed from ..... ft. to ..... ft.  
Did any strata contain unusable water?  Yes  No  
Type of water? ..... depth of strata .....  
Method of sealing strata off .....

(10) WATER LEVELS:

Static level 60 ft. below land surface Date 11/28/67  
Artesian pressure ..... lbs. per square inch Date .....

(11) WELL TESTS:

Drawdown is amount water level is lowered below static level  
Was a pump test made?  Yes  No If yes, by whom? Driller  
Yield: 1,000 gal./min. with 35 ft. drawdown after 12 hrs.  
" " " " " "  
" " " " " "  
" " " " " "  
Ballor test gal./min. with ft. drawdown after hrs.  
Artesian flow g.p.m. Date  
Temperature of water Was a chemical analysis made?  Yes  No

(12) WELL LOG:

Diameter of well below casing ..... 12  
Depth drilled 300 ft. Depth of completed well 300 ft.  
Formation: Describe by color, character, size of material and structure, and show thickness of aquifers and the kind and nature of the material in each stratum penetrated, with at least one entry for each change of formation.

MATERIAL	FROM	TO
Surface soil	0	7
rock - basalt- firm - <u>red</u>	<u>7</u>	<u>35</u>
" " " <u>red</u>	<u>35</u>	<u>50</u>
" " " <u>firm</u>	<u>50</u>	<u>70</u>
" " " <u>black firm</u>	<u>70</u>	<u>105</u>
" " " "	<u>105</u>	<u>165</u>
" <u>and clay</u>	<u>165</u>	<u>190</u>
" <u>basalt- black</u>	<u>190</u>	<u>240</u>
" <u>red- porous-making water</u>	<u>240</u>	<u>250</u>
" <u>black- porous</u> " "	<u>250</u>	<u>300</u>

RECEIVED

JUN 11 2021

OWRD

Work started Sept. 18 19 67 Completed Nov. 28 19 67  
Date well drilling machine moved off of well ..... 19 .....

(13) PUMP:

Manufacturer's Name Driller Dale Wickizer  
Type No. 180 11/Dec. 13. 67

Water Well Contractor's Certification:

This well was drilled under my jurisdiction and this report is true to the best of my knowledge and belief.

NAME Barron & Strayer  
(Person, firm or corporation) (Type or print)  
Address Rt. 1, Box 254, Beaverton, Ore.

Drilling Machine Operator's License No. 180

[Signed] A H Barron  
(Water Well Contractor)

Contractor's License No. 35 Date Dec. 13, 19 67



MAY-02-1996 13:35

OWRD PENDELTON

**WELL IDENTIFICATION FORM**

Owner's Well Number: #1

**CURRENT WELL OWNER:**

Phone 276-8354

Name: DR. KENDALL EARLY DENNIS & SANDY MACNA

Mailing Address: P.O. Box 1088 1629 E 12th St

City: PENDELTON State: Oregon Zip: 97801 The Dal 97058

**WELL LOCATION:**

County: Gilliam 149 Latitude: \_\_\_\_\_ Longitude: \_\_\_\_\_

Township: 25 N or S, Range: 22 E or W Section: 24, 25, 27, 35 1/4 \_\_\_\_\_ 1/4

Tax Lot Number: 25-22 1300 31813, 1859, 60132

Street Address of Well (if different from above):  
ROCK CREEK OUT OF ARLINGTON

*If a well report is available for this well, please attach a copy of it to this form and return. It is not necessary for you to complete the remainder of the form if the well report is attached. If a well report is not available, please complete the remainder of the form to the best of your ability.*

**WELL INFORMATION:**

RECEIVED

Start Card Number: \_\_\_\_\_ Approx. Construction Date: JUN 11 2021

Well Constructor: \_\_\_\_\_

OWRD

Name of Owner at Time of Construction: \_\_\_\_\_

Well Depth (in feet): \_\_\_\_\_ Static Water Level (in feet): \_\_\_\_\_

Diameter of Exposed Well Casing (in inches): \_\_\_\_\_

Does this well have a formal water right associated with it? Yes: \_\_\_\_\_ No: \_\_\_\_\_ If yes:

Application #: \_\_\_\_\_ Permit #: \_\_\_\_\_ Certificate #: \_\_\_\_\_

Please Return Completed Form to: Oregon Water Resources Department 1-800-624-3199  
158 12th Street NE  
Salem, OR 97310 FAX 503-578-6203

(Office use only)

Well Identification Number: 204903



NOTICE TO WATER WELL CONTRACTOR

The original and first copy of this report are to be filed with the

STATE ENGINEER, SALEM, OREGON 97310 within 30 days from the date of well completion.

GILL 15 GILL 15

RECEIVED MAR 12 1971

WATER WELL REPORT

STATE OF OREGON

(Please type or print) (Do not write above this line)

RECEIVED MAR 20 1971

State Well No. 2/22-23

State Permit No.

STATE ENGINEER SALEM, OREGON

(1) OWNER:

Name Harvey Smith Address Box 448, Ione Oregon 97843

(2) TYPE OF WORK (check):

New Well [X] Deepening [ ] Reconditioning [ ] Abandon [ ] If abandonment, describe material and procedure in Item 12.

(3) TYPE OF WELL:

Rotary [ ] Cable [X] Dug [ ] Driven [ ] Jetted [ ] Bored [ ]

(4) PROPOSED USE (check):

Domestic [ ] Irrigation [X] Industrial [ ] Test Well [ ] Municipal [ ] Other [ ]

CASING INSTALLED:

12" Diam. from 0 ft. to 31 ft. Gage std. Threaded [ ] Welded [X]

PERFORATIONS:

Perforated? [ ] Yes [X] No. Type of perforator used Size of perforations in. by in. perforations from ft. to ft.

(7) SCREENS:

Well screen installed? [ ] Yes [X] No Manufacturer's Name Type Model No. Diam. Slot size Set from ft. to ft.

(8) WATER LEVEL: Completed well.

Static level 30 ft. below land surface Date 2/10/71 Ian pressure lbs. per square inch Date

(9) WELL TESTS:

Drawdown is amount water level is lowered below static level Was a pump test made? [X] Yes [ ] No If yes, by whom? owner -id: 500 gal./min. with 232 ft. drawdown after 8 hrs.

(10) CONSTRUCTION:

Well seal—Material used Betonite- basalt cuttings Depth of seal 31 Diameter of well bore to bottom of seal 16 Were any loose strata cemented off? [ ] Yes [X] No Depth Was a drive shoe used? [ ] Yes [X] No Did any strata contain unusable water? [ ] Yes [X] No Type of water? depth of strata Method of sealing strata off Was well gravel packed? [ ] Yes [X] No Size of gravel: Gravel placed from ft. to ft.

(11) LOCATION OF WELL:

County Gilliam Driller's well number 1/4 1/4 Section 23 T. 2S R. 22E W.M. Bearing and distance from section or subdivision corner

(12) WELL LOG:

Diameter of well below casing 12 Depth drilled 370 ft. Depth of completed well 300 ft. Formation: Describe color, texture, grain size and structure of materials; and show thickness and nature of each stratum and aquifer penetrated, with at least one entry for each change of formation. Report each change in position of Static Water Level as drilling proceeds. Note drilling rates.

Table with columns: MATERIAL, From, To, SWL. Rows include top soil, gravel-broken rock, basalt-black-hard, rock-brown-porous (making water), basalt-gray hard, black-hard, brown, black, crevices-making water, basalt-black-hard, basalt-brown, basalt-black.

RECEIVED

JUN 11 2021

OWRD

Work started 4/15 1970 Completed Feb. 10 1971 Date well drilling machine moved off of well FEB. 10 1971

Drilling Machine Operator's Certification:

This well was constructed under my direct supervision. Materials used and information reported above are true to my best knowledge and belief.

[Signed] Dale Wickizer (Drilling Machine Operator) Date MAR 6 1971

Drilling Machine Operator's License No. 180

Water Well Contractor's Certification:

This well was drilled under my jurisdiction and this report is true to the best of my knowledge and belief.

NAME Barron & Strayer (Person, firm or corporation) (Type or print) 7990 S.W. Sorrento Rd. Beaverton, Ore 97005 Address

[Signed] A.H. Barron (Water Well Contractor)

Contractor's License No. 35 Exp. Jan. 11, 1971



JUN 11 2021

MAY-02-1996 13:35

OWRD FENCE...

OWRD

Owner's Well Number: #2

WELL IDENTIFICATION FORM

CURRENT WELL OWNER:

Phone 276-8354

Name: DR. KENOALL EARLY

Mailing Address: P.O. Box 1088

City: PENOLETON

State: Oregon

Zip: 97801

WELL LOCATION:

County: Gilliam 151

Latitude:

Longitude:

Township: 25

N or S, Range: 22

E or W Section: 23

14, 15, 23, 23

25, 26, 27, 35

1/4 1/4

Tax Lot Number: 25-22

1300

#s - 31813, 1859, 60132

Street Address of Well (if different from above):

ROCK CREEK out of Hillman

If a well report is available for this well, please attach a copy of it to this form and return. It is not necessary for you to complete the remainder of the form if the well report is attached. If a well report is not available, please complete the remainder of the form to the best of your ability.

WELL INFORMATION:

Start Card Number: Approx. Construction Date:

Well Constructor:

Name of Owner at Time of Construction:

Well Depth (in feet): Static Water Level (in feet):

Diameter of Exposed Well Casing (in inches):

Does this well have a formal water right associated with it? Yes: No: If yes:

Application #: Permit #: Certificate #:

Please Return Completed Form to:

Oregon Water Resources Department 1-800-624-1588  
158 12th Street NE  
Salem, OR 97310

3199  
TAX 503-378-6203

(Office use only)

Well Identification Number:

LO 4904



GILL 154

NOTICE TO WATER WELL CONTRACTOR

The original and first copy of this report are to be filed with the

STATE ENGINEER, SALEM, OREGON 97310 within 30 days from the date of well completion.

WATER WELL REPORT

STATE OF OREGON (Please type or print)

State Well No. 2/22-26 E(1)

State Permit No.

(1) OWNER:

Name Harvey Smith
Address Box 448
Ione, Oregon

(2) LOCATION OF WELL:

County Gilliam Driller's well number
1/4 Section 26 T. 2 S R. 22 E W.M.
Bearing and distance from section or subdivision corner

RECEIVED JUN 11 2021

(3) TYPE OF WORK (check):

Well [X] Deepening [ ] Reconditioning [ ] Abandon [ ]
andonment, describe material and procedure in Item 12.

OWRD

(4) PROPOSED USE (check):

Domestic [ ] Industrial [ ] Municipal [ ]
Irrigation [X] Test Well [ ] Other [ ]

(5) TYPE OF WELL:

Rotary [ ] Driven [ ]
Cable [X] Jetted [ ]
Dug [ ] Bored [ ]

(6) CASING INSTALLED:

12" Diam. from 0 ft. to 6.5 ft. Gage 1st
Threaded [ ] Welded [X]

(7) PERFORATIONS:

Type of perforator used
Size of perforations in. by in.
perforations from ft. to ft.

(8) SCREENS:

Well screen installed? [ ] Yes [X] No
Manufacturer's Name
Model No.
Slot size Set from ft. to ft.

(9) CONSTRUCTION:

Well seal-Material used in seal Betonite
Depth of seal 40 ft. Was a packer used? No
Diameter of well bore to bottom of seal 15 in.
Were any loose strata cemented off? [X] Yes [ ] No Depth 470-500
Was a drive shoe used? [ ] Yes [X] No
Was well gravel packed? [ ] Yes [ ] No Size of gravel:
Gravel placed from ft. to ft.
Did any strata contain unusable water? [ ] Yes [ ] No
Type of water? depth of strata
Method of sealing strata off

(10) WATER LEVELS:

Static level 11 ft. below land surface Date 7/2/66
Artesian pressure lbs. per square inch Date

(11) WELL TESTS:

Drawdown is amount water level is lowered below static level
Was a pump test made? [X] Yes [ ] No If yes, by whom? Driller
Yield: 300 gal./min. with 115 ft. drawdown after 6 hrs.

(12) WELL LOG:

Diameter of well below casing 12
Depth drilled 558 reduced to 10" at 408 ft.
ft. Depth of completed well 558 ft.

Table with columns: MATERIAL, FROM, TO. Rows include Top soil, Gravel-boulders, Rock-basalt-black, brown, brownish gray, gray-firm, gray-brown, brown-hard streaks, black, gray, gray hard, pirates iron very hard, rock-basalt-gray very hard, black, brown, clay-compacted, gray, basalt-black, brown, clay-blue-gravel-hard pacted, sand-silky-black-some water.

(13) PUMP:

Manufacturer's Name
Type: H.P.
Water Well Contractor's Certification:
This well was drilled under my jurisdiction and this report is true to the best of my knowledge and belief.
NAME Barron & Strayer
Address Rt. 1, Box 254, Beaverton, Ore.
Drilling Machine Operator's License No. 180
[Signed] A. H. Barron
Contractor's License No. 35 Date July 1966







**WELL IDENTIFICATION FORM**

Owner's Well Number: # 3

**CURRENT WELL OWNER:**

Name: DR. KENDALL EARLY

Phone 276-8354

Mailing Address: P.O. Box 1088

Dennis & Sandy MacNa

City: PENDLETON

1629 E 12<sup>th</sup> St AL Da

State: Oregon

Zip: 97801 970

**WELL LOCATION:**

County: Hillman 154

Latitude: \_\_\_\_\_ Longitude: \_\_\_\_\_

Township: 25 N or S, Range: 22 E or W Section: 24 <sup>14, 15, 23, 25</sup> 26 <sup>27, 35</sup> 1/4 \_\_\_\_\_ 1/4

Tax Lot Number: 25-22 1300 - # 31813, 1859, 60132

Street Address of Well (if different from above):  
ROCK CREEK out of Arlington

*If a well report is available for this well, please attach a copy of it to this form and return. It is not necessary for you to complete the remainder of the form if the well report is attached. If a well report is not available, please complete the remainder of the form to the best of your ability.*

**WELL INFORMATION:**

Start Card Number: \_\_\_\_\_ Approx. Construction Date: \_\_\_\_\_ **RECEIVED**

Well Constructor: \_\_\_\_\_ **JUN 11 2021**

Name of Owner at Time of Construction: \_\_\_\_\_ **OWRD**

Well Depth (in feet): \_\_\_\_\_ Static Water Level (in feet): \_\_\_\_\_

Diameter of Exposed Well Casing (in inches): \_\_\_\_\_

Does this well have a formal water right associated with it? Yes: \_\_\_\_\_ No: \_\_\_\_\_ If yes:

Application #: \_\_\_\_\_ Permit #: \_\_\_\_\_ Certificate #: \_\_\_\_\_

Please Return Completed Form to: Oregon Water Resources Department 1-800-624-3199  
158 12th Street NE  
Salem, OR 97310 FAX 503-378-6203

(Office use only)

Well Identification Number: 204905



JUN 11 2021

GILL 155

NOTICE TO WATER WELL CONTRACTOR

The original and first copy of this report are to be filed with the

WATER WELL REPORT

STATE ENGINEER, SALEM, OREGON within 30 days from the date of well completion.

RECEIVED STATE ENGINEER SALEM, OREGON SEP 10 1967

STATE OF OREGON (Please type or print) (Do not write above this line)

OWRD

State Well No. 2/22-26 F State Permit No.

GILL 155

(1) OWNER:

Name Harvey Smith

Address Box 448 Ione, Oregon 97843

(2) TYPE OF WORK (check):

New Well [X] Deepening [ ] Reconditioning [ ] Abandon [ ] If abandonment, describe material and procedure in Item 12.

(3) TYPE OF WELL:

Rotary [ ] Driven [ ] Cable [X] Jetted [ ] Dug [ ] Bored [ ]

(4) PROPOSED USE (check):

Domestic [ ] Industrial [ ] Municipal [ ] Irrigation [X] Test Well [ ] Other [ ]

CASING INSTALLED:

10" Diam. from 0 ft. to 30 ft. Gage 1 std. 12" Diam. from 0 ft. to 23 ft. Gage 1 std.

PERFORATIONS:

Perforated? [ ] Yes [X] No. Type of perforator used Size of perforations in. by in.

(7) SCREENS:

Well screen installed? [ ] Yes [X] No Manufacturer's Name Type Model No. Diam. Slot size Set from ft. to ft.

(8) WATER LEVEL: Completed well.

Static level ft. below land surface Date Artesian pressure lbs. per square inch Date

(9) WELL TESTS:

Drawdown is amount water level is lowered below static level Was a pump test made? [X] Yes [ ] No If yes, by whom? Driller 1: 600 gal./min. with 240 ft. drawdown after 60 hrs.

(10) CONSTRUCTION:

Well seal—Material used Cement Depth of seal 30 ft. Diameter of well bore to bottom of seal 14 in. Were any loose strata cemented off? [ ] Yes [X] No Depth ... Was a drive shoe used? [ ] Yes [X] No Did any strata contain unusable water? [ ] Yes [X] No

(11) LOCATION OF WELL:

County Gilliam Driller's well number SE 1/4 NW 1/4 Section 26 T. 2S R. 22E W.M. Bearing and distance from section or subdivision corner

(12) WELL LOG:

Diameter of well below casing 10" & 8" Depth drilled 700 ft. Depth of completed well 700 ft. Formation: Describe color, texture, grain size and structure of materials; and show thickness and nature of each stratum and aquifer penetrated, with at least one entry for each change of formation.

Table with columns: MATERIAL, From, To, SWL. Rows include: rock-loose-silt, basalt-brown, black, basalt-black, hard-medium streaks, Clay & rock mixed-firm, rock-basalt-Med. & hard, rock-basalt-gray-hard, -black-with some water 335 ft., rock-basalt-black-water 335 410 12ft, 160 gal. per Min. 200 ft., draw down, rock-basalt-black-crevis between 400-470ft., rock-black-basalt 470 600, -hard-making, some water 600 665, rock-black-hard 665 700, The hole is 12" to 260 ft., 10" from 260 to 270ft., 8" from 270 to 700 ft.

Work started 3/7/67 19 Completed 8/20/67 19 Date well drilling machine moved off of well 19

Drilling Machine Operator's Certification:

This well was constructed under my direct supervision. Materials used and information reported above are true to my best knowledge and belief.

[Signed] Dale Wickizer Date Sept., 1967 (Drilling Machine Operator)

Drilling Machine Operator's License No. 180

Water Well Contractor's Certification:

This well was drilled under my jurisdiction and this report is true to the best of my knowledge and belief.

NAME Barron & Strayer (Person, firm or corporation) (Type or print)

Address Rt. 1, Box 254, Beaverton, Ore.

[Signed] A H Barron (Water Well Contractor)

Contractor's License No. 35 Date 9/16/67, 19



MAY-02-1996 13:35

OWRD PENDELTON

OWRD

Owner's Well Number: #4

**WELL IDENTIFICATION FORM**

**CURRENT WELL OWNER:**

Phone 276-8354

Name: DR. KENDALL EARLY

DENNIS & SANDY

Mailing Address: P.O. Box 1088

1629 E 12th St

City: PENDELTON

State: Oregon

Zip: 97801

the  
Dalle  
970

**WELL LOCATION:**

County: Hillman 155

Latitude: \_\_\_\_\_

Longitude: \_\_\_\_\_

Township: 25 N or S,

Range: 22 E or W

Section: 26

14, 15, 23, 23

24, 26, 27, 35

1/4 1/4

Tax Lot Number: 25-22 1300

# 31813, 1857, 60132

Street Address of Well (if different from above): \_\_\_\_\_

ROCK CREEK OUT OF ARLINGTON

*If a well report is available for this well, please attach a copy of it to this form and return. It is not necessary for you to complete the remainder of the form if the well report is attached. If a well report is not available, please complete the remainder of the form to the best of your ability.*

**WELL INFORMATION:**

Start Card Number: \_\_\_\_\_ Approx. Construction Date: \_\_\_\_\_

Well Constructor: \_\_\_\_\_

Name of Owner at Time of Construction: \_\_\_\_\_

Well Depth (in feet): \_\_\_\_\_ Static Water Level (in feet): \_\_\_\_\_

Diameter of Exposed Well Casing (in inches): \_\_\_\_\_

Does this well have a formal water right associated with it? Yes: \_\_\_\_\_ No: \_\_\_\_\_ If yes: \_\_\_\_\_

Application #: \_\_\_\_\_ Permit #: \_\_\_\_\_ Certificate #: \_\_\_\_\_

Please Return Completed Form to:

Oregon Water Resources Department  
158 12th Street NE  
Salem, OR 97310

1-800-624-  
3199  
FAX 503-378-6203

(Office use only)

Well Identification Number: LD 4906



8019 West Quinault Avenue, Suite 201  
Kennewick, Washington 99336  
509.209-2846

RECEIVED

JUN 11 2021

OWRD

June 4, 2021

Kelly Starnes, Transfer Section  
Oregon Water Resources Department  
725 Summer Street NE, Suite A  
Salem, OR 97301

RE: Place of Use Transfer Application for Highland Hills Ranch (Dennis MacNab)  
Certificates 30166, 94039, 94040, 94041, 94042, 94043, 94044, 94045, 94046

Dear Kelly:

Enclosed please find a Place of Use Transfer Application with supporting documents submitted on behalf of our client, Dennis MacNab (Highland Hills Ranch). A check in the amount of \$7,770.00 for application fees is also enclosed. This application is being filed at the request of the local watermaster to reflect the current place of use for irrigation.

Should you have any questions regarding this application packet, please do not hesitate to contact me.

Sincerely,

Molly Reid  
Senior Planner

Cc: Dennis MacNab  
File