

Application for Permanent Water Right Transfer

Part 1 of 5 – Minimum Requirements Checklist



Oregon Water Resources Department
 725 Summer Street NE, Suite A
 Salem, Oregon 97301-1266
 (503) 986-0900
 www.oregon.gov/OWRD

This transfer application will be returned if Parts 1 through 5 and all required attachments are not completed and included.
 For questions, please call (503) 986-0900, and ask for Transfer Section.

RECEIVED

JUN 28 2021

Check all items included with this application. (N/A = Not Applicable)

OWRD

- Part 1 – Completed Minimum Requirements Checklist.
- Part 2 – Completed Transfer Application Map Checklist.
- Part 3 – Application Fee, payable by check to the Oregon Water Resources Department, and completed Fee Worksheet, page 3. Try the new online fee calculator at: http://apps.wrd.state.or.us/apps/misc/wrd_fee_calculator. If you have questions, call Customer Service at (503) 986-0801.
- Part 4 – Completed Applicant Information and Signature.
- Part 5 – Information about Water Rights to be Transferred: **How many water rights are to be transferred? four** List them here: **Certificates 30636, 42976, 89896, 95268**
 Please include a separate Part 5 for each water right. (See instructions on page 6)

Attachments:

- Completed Transfer Application Map. **Attachment #1**
- Completed Evidence of Use Affidavit and supporting documentation. **Attachment #2**
- N/A Affidavit(s) of Consent from Landowner(s) (if the applicant does not own the land the water right is on.)
- N/A Supplemental Form D – For water rights served by or issued in the name of an irrigation district. Complete when the transfer applicant is not the irrigation district. **Attachment #5**
- N/A Oregon Water Resources Department’s Land Use Information Form with approval and signature (or signed land use form receipt stub) from each local land use authority in which water is to be diverted, conveyed, and/or used. Not required if water is to be diverted, conveyed, and/or used only on federal lands or if **all** of the following apply: a) a change in place of use only, b) no structural changes, c) the use of water is for irrigation only, and d) the use is located within an irrigation district or an exclusive farm use zone.
- N/A Water Well Report/Well Log for changes in point(s) of appropriation (well(s)) or additional point(s) of appropriation. **Attachment #6**
- N/A Geologist Report for a change from a surface water point of diversion to a ground water point of appropriation (well), if the proposed well is more than 500’ from the surface water source and more than 1000’ upstream or downstream from the point of diversion. See OAR 690-380-2130 for requirements and applicability.

(For Staff Use Only)

WE ARE RETURNING YOUR APPLICATION FOR THE FOLLOWING REASON(S):

<input type="checkbox"/> Application fee not enclosed/insufficient	<input type="checkbox"/> Map not included or incomplete
<input type="checkbox"/> Land Use Form not enclosed or incomplete	<input type="checkbox"/> Evidence of Use Form not enclosed or incomplete
<input type="checkbox"/> Additional signature(s) required	<input type="checkbox"/> Part _____ is incomplete

Other/Explanation _____

Staff: _____ 503-986-0_____ Date: ____/____/____

JUN 28 2021

Part 2 of 5 – Transfer Application Map

Your transfer application will be returned if any of the map requirements listed below are not met.

OWRD

Please be sure that the transfer application map you submit includes all the required items and matches the existing water right map. Check all boxes that apply.

- N/A Certified Water Right Examiner (CWRE) Stamp and Original Signature. For a list of CWREs, see http://apps.wrd.state.or.us/apps/wr/cwre_license_view/. CWRE stamp and signature are not required for substitutions.
- N/A If **more than three** water rights are involved, separate maps are needed for each water right.
- Permanent quality printed with dark ink on good quality paper.
- The size of the map can be 8½ x 11 inches, 8½ x 14 inches, 11 x 17 inches, or up to 30 x 30 inches. For 30 x 30 inch maps, one extra copy is required.
- A north arrow, a legend, and scale.
- The scale of the map must be: 1 inch = 400 feet, 1 inch = 1,320 feet, the scale of the Final Proof/Claim of Beneficial Use Map (the map used when the permit was certificated), the scale of the county assessor map if the scale is not smaller than 1 inch = 1,320 feet, or a scale that has been pre-approved by the Department.
- Township, Range, Section, ¼ ¼, DLC, Government Lot, and other recognized public land survey lines.
- Tax lot boundaries (property lines) are required. Tax lot numbers are recommended.
- Major physical features including rivers and creeks showing direction of flow, lakes and reservoirs, roads, and railroads.
- Major water delivery system features from the point(s) of diversion/appropriation such as main pipelines, canals, and ditches.
- Existing place of use that includes separate hachuring for each water right, priority date, and use including number of acres in each quarter-quarter section, government lot, or in each quarter-quarter section as projected within government lots, donation land claims, or other recognized public land survey subdivisions. If less than the entirety of the water right is being changed, a separate hachuring is needed for lands left unchanged.
- N/A Proposed place of use that includes separate hachuring for each water right, priority date, and use including number of acres in each quarter-quarter section, government lot, or in each quarter-quarter section as projected within government lots, donation land claims, or other recognized public land survey subdivisions.
- Existing point(s) of diversion or well(s) with distance and bearing or coordinates from a recognized survey corner. This information can be found in your water right certificate or permit.
- N/A If you are proposing a change in point(s) of diversion or well(s), show the proposed location and label it clearly with distance and bearing or coordinates. If GPS coordinates are used, latitude-longitude coordinates may be expressed as either degrees-minutes-seconds with at least one digit after the decimal (example – 42°32'15.5") or degrees-decimal with five or more digits after the decimal (example – 42.53764°).

Part 4 of 5 – Applicant Information and Signature

Applicant Information

APPLICANT/BUSINESS NAME Pendleton Land LLC c/o Alternative Equity Advisors LLC (Dave Muth)		PHONE NO. 515-222-1347	ADDITIONAL CONTACT NO. Not applicable
ADDRESS 12119 Stratford Drive, Suite B			FAX NO. Not applicable
CITY Clive	STATE Iowa	ZIP 50325	E-MAIL dave@alternativeequityadvisors.com
BY PROVIDING AN E-MAIL ADDRESS, CONSENT IS GIVEN TO RECEIVE ALL CORRESPONDENCE FROM THE DEPARTMENT ELECTRONICALLY. COPIES OF THE FINAL ORDER DOCUMENTS WILL ALSO BE MAILED.			

Agent Information – The agent is authorized to represent the applicant in all matters relating to this application.

AGENT/BUSINESS NAME Molly Reid, GeoEngineers, Inc.		PHONE NO. 509-209-2846	ADDITIONAL CONTACT NO. 541-310-7264 (cell)
ADDRESS 8019 W Quinault Avenue Suite 201			FAX NO. Not applicable
CITY Kennewick	STATE WA	ZIP 99336	E-MAIL mreid@geoengineers.com
BY PROVIDING AN E-MAIL ADDRESS, CONSENT IS GIVEN TO RECEIVE ALL CORRESPONDENCE FROM THE DEPARTMENT ELECTRONICALLY. COPIES OF THE FINAL ORDER DOCUMENTS WILL ALSO BE MAILED.			

Explain in your own words what you propose to accomplish with this transfer application, and why:
 Replacing three existing wells to create more efficiency in operation of irrigation systems.
 If you need additional space, continue on a separate piece of paper and attach to the application as "Attachment 1".

Check One Box

- By signing this application, I understand that, upon receipt of the draft preliminary determination and prior to Department approval of the transfer, I will be required to provide landownership information and evidence that I am authorized to pursue the transfer as identified in OAR 690-380-4010(5); **OR**
- I affirm the applicant is a municipality as defined in ORS 540.510(3)(b) and that the right is in the name of the municipality or a predecessor; **OR**
- I affirm the applicant is an entity with the authority to condemn property and is acquiring by condemnation the property to which the water right proposed for transfer is appurtenant and have supporting documentation.

RECEIVED

JUN 28 2021

OWRD

By my signature below, I confirm that I understand:

- Prior to Department approval of the transfer application, I may be required to submit payment to the Department for publication of a notice in a newspaper with general circulation in the area where the water right is located, once per week for two consecutive weeks. If more than one qualifying newspaper is available, I suggest publishing the notice in the following newspaper: East Oregonian.
- Amendments to the application may only be made in response to the Department’s Draft Preliminary Determination (DPD). The applicant will have a period of at least 30 days to amend the application to address any issues identified by the Department in the DPD, or to withdraw the application. Note that amendments may be subject to additional fees, pursuant to ORS 536.050.
- Failure to complete an approved change in place of use and/or change in character of use, will result in loss of the water right (OAR 690-380-6010).

I (we) affirm that the information contained in this application is true and accurate.

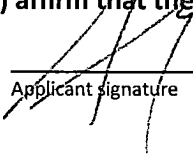

 Applicant signature	Adam D. Borod, Authorized Person <small>Print Name (and Title if applicable)</small>	June 22, 2021 Date
Applicant signature	Print Name (and Title if applicable)	Date

Is the applicant the sole owner of the land on which the water right, or portion thereof, proposed for transfer is located? Yes No *If NO, include signatures of all deeded landowners (and mailing and/or e-mail*

addresses if different than the applicant's) or attach affidavits of consent (and mailing and/or e-mail addresses) from all landowners or individuals/entities to which the water right(s) were conveyed.

RECEIVED

JUN 28 2021

OWRD

Check the following boxes that apply:

- The applicant is responsible for completion of change(s). Notices and correspondence should continue to be sent to the applicant.
- The receiving landowner will be responsible for completing the proposed change(s) after the final order is issued. Copies of notices and correspondence should be sent to this landowner.
- Both the receiving landowner and applicant will be responsible for completion of change(s). Copies of notices and correspondence should be sent to this landowner and the applicant.

At this time, are the lands in this transfer application in the process of being sold? Yes No

If YES, and you know who the new landowner will be, please complete the receiving landowner information table below. If you do not know who the new landowner will be, then a request for assignment will have to be filed for at a later date.

If a property sells, the certificated water right(s) located on the land belong to the new owner, unless a sale agreement or other document states otherwise. For more information see: https://www.oregon.gov/owrd/WRDFormsPDF/Transfer_Property_Transactions.pdf

RECEIVING LANDOWNER NAME Not applicable		PHONE NO.	ADDITIONAL CONTACT NO.
ADDRESS			FAX NO.
CITY	STATE	ZIP	E-MAIL

Describe any special ownership circumstances here: _____

- Check here if any of the water rights proposed for transfer are or will be located within or served by an irrigation or other water district. (**Tip: Complete and attach Supplemental Form D.**)

IRRIGATION DISTRICT NAME Hudson Bay District Improvement Company	ADDRESS P.O. Box 110	
CITY Milton-Freewater	STATE OR	ZIP 97862

- Check here if water for any of the rights supplied under a water service agreement or other contract for stored water with a federal agency or other entity.

ENTITY NAME Not applicable	ADDRESS	
CITY	STATE	ZIP



To meet State Land Use Consistency Requirements, you must list all county, city, municipal corporation, or tribal governments within whose jurisdiction water will be diverted, conveyed or used.

ENTITY NAME Umatilla County Planning Department	ADDRESS 216 SE 4th Street		RECEIVED JUN 28 2021
CITY Pendleton	STATE OR	ZIP 97801	

ENTITY NAME Not applicable	ADDRESS		OWRD
CITY	STATE	ZIP	

RECEIVED

JUN 28 2021

OWRD

Part 5 of 5 – Water Right Information

Please use a separate Part 5 for each water right being changed. See instructions on page 6, to copy and paste additional Part 5s, or to add additional rows to tables within the form.

CERTIFICATE # 30636

RECEIVED

Description of Water Delivery System

JUN 28 2021

System capacity: 3.79 cubic feet per second (cfs) **OR**
 _____ gallons per minute (gpm)

OWRD

Describe the current water delivery system or the system that was in place at some time within the last five years. Include information on the pumps, canals, pipelines, and sprinklers used to divert, convey, and apply the water at the authorized place of use. Water is pumped from the well with 25-150 hp pumps into 15 inch to 8 inch buried PVC and steel mainline to center pivots with drop tube sprinklers, and 3 inch wheel and handlines. There are three boosters (one 25hp centrifugal, one 50 hp turbine, and one 50 hp centrifugal) used to convey water across the property site.

Table 1. Location of Authorized and Proposed Point(s) of Diversion (POD) or Appropriation (POA)

(Note: If the POD/POA name is not specified on the certificate, assign it a name or number here.)

POD/POA Name or Number	Is this POD/POA Authorized on the Certificate or is it Proposed?	If POA, OWRD Well Log ID# (or Well ID Tag # L-___)	Twp		Rng		Sec	¼ ¼		Tax Lot, DLC or Gov't Lot	Measured Distances (from a recognized survey corner)
Williams Well #1 (W1 Well)	<input checked="" type="checkbox"/> Authorized <input type="checkbox"/> Proposed	UMAT 4178	6	N	34	E	35	NW	NW	2702	11 chains South and ¼ chain East from NW corner, Section 35; further described as 726 feet South and 16.5 feet East from NW Corner Section 35
Williams Well #1 Replacement (WWR1 Well)	<input type="checkbox"/> Authorized <input checked="" type="checkbox"/> Proposed	NOT DRILLED YET	6	N	34	E	35	NW	NW	2702	45.959971 -118.537696 715 ft South & 161 ft East from the NW Corner, Section 35

Check all type(s) of change(s) proposed below (change "CODES" are provided in parentheses):

- | | |
|--|---|
| <input type="checkbox"/> Place of Use (POU) | <input type="checkbox"/> Supplemental Use to Primary Use (S to P) |
| <input type="checkbox"/> Character of Use (USE) | <input checked="" type="checkbox"/> Point of Appropriation/Well (POA) |
| <input type="checkbox"/> Point of Diversion (POD) | <input type="checkbox"/> Additional Point of Appropriation (APOA) |
| <input type="checkbox"/> Additional Point of Diversion (APOD) | <input type="checkbox"/> Substitution (SUB) |
| <input type="checkbox"/> Surface Water POD to Ground Water POA (SW/GW) | <input type="checkbox"/> Government Action POD (GOV) |

Will all of the proposed changes affect the entire water right?

- Yes Complete only the Proposed ("to" or "on" lands) section of Table 2 on the next page. Use the "CODES" listed above to describe the proposed changes.
- No Complete all of Table 2 to describe the portion of the water right to be changed.

Please use and attach additional pages of Table 2 as needed.
See page 6 for instructions.

Do you have questions about how to fill-out the tables?
Contact the Department at 503-986-0900 and ask for Transfer Staff.

Table 2. Description of Changes to Water Right Certificate # 30636

List the change proposed for the acreage in each ¼ ¼. If more than one change is proposed, specify the acreage associated with each change.
If there is more than one POD/POA involved in the proposed changes, specify the acreage associated with each POD/POA.

AUTHORIZED (the "from" or "off" lands) The listing that appears on the certificate BEFORE PROPOSED CHANGES List only that part or portion of the water right that will be changed.											Proposed Changes (see "CODES" from previous page)	PROPOSED (the "to" or "on" lands) The listing as it would appear AFTER PROPOSED CHANGES are made.															
Twp	Rng	Sec	¼	¼	Tax Lot	Gvt Lot or DLC	Acres	Type of USE listed on Certificate	POD(s) or POA(s) (name or number from Table 1)	Priority Date		Twp	Rng	Sec	¼	¼	Tax Lot	Gvt Lot or DLC	Acres	New Type of USE	POD(s)/ POA(s) to be used (from Table 1)	Priority Date					
6	N	34	E	26	NE	NW	2701		18.9	IS	W1 Well	3/7/1949	POA	6	N	34	E	26	NE	NW	2701		18.9	IS	WWR1 Well	3/7/1949	
6	N	34	E	26	NW	NW	2701		35.8	IS	W1 Well	3/7/1949	POA	6	N	34	E	26	NW	NW	2701		35.8	IS	WWR1 Well	3/7/1949	
6	N	34	E	26	SW	NW	2702		24.5	IS	W1 Well	3/7/1949	POA	6	N	34	E	26	SW	NW	2702		24.5	IS	WWR1 Well	3/7/1949	
6	N	34	E	26	SE	NW	2702		12.0	IS	W1 Well	3/7/1949	POA	6	N	34	E	26	SE	NW	2702		12.0	IS	WWR1 Well	3/7/1949	
6	N	34	E	26	NE	SW	2702		7.0	IS	W1 Well	3/7/1949	POA	6	N	34	E	26	NE	SW	2702		7.0	IS	WWR1 Well	3/7/1949	
6	N	34	E	26	NW	SW	2702		36.8	IS	W1 Well	3/7/1949	POA	6	N	34	E	26	NW	SW	2702		36.8	IS	WWR1 Well	3/7/1949	
6	N	34	E	26	SE	SW	2702		36.5	IS	W1 Well	3/7/1949	POA	6	N	34	E	26	SE	SW	2702		36.5	IS	WWR1 Well	3/7/1949	
6	N	34	E	27	NE	NE	2701		35.8	IS	W1 Well	3/7/1949	POA	6	N	34	E	27	NE	NE	2701		35.8	IS	WWR1 Well	3/7/1949	
6	N	34	E	27	SE	NE	2702		34.7	IS	W1 Well	3/7/1949	POA	6	N	34	E	27	SE	NE	2702		34.7	IS	WWR1 Well	3/7/1949	
6	N	34	E	35	NW	NW	2702		12.1	IS	W1 Well	3/7/1949	POA	6	N	34	E	35	NW	NW	2702		12.1	IS	WWR1 Well	3/7/1949	
							(254.1)	TOTAL IS													(254.1)	TOTAL IS					
TOTAL ACRES:							254.1						TOTAL ACRES:							254.1							

Additional remarks: Certificate 30636 affects the Basalt aquifer only. "W1" refers to Williams Well #1. "WWR1" refers to Williams Well #1 Replacement. The final proof survey map for Certificate 30636 does not delineate between primary and supplemental acres. This will be rectified upon final proof of this transfer.

RECEIVED

JUN 28 2021

Please use and attach additional pages of Table 2 as needed.
See page 6 for instructions.

Do you have questions about how to fill-out the tables?
Contact the Department at 503-986-0900 and ask for Transfer Staff.

Table 2. Description of Changes to Water Right Certificate # 30636

List the change proposed for the acreage in each ¼ ¼. If more than one change is proposed, specify the acreage associated with each change. If there is more than one POD/POA involved in the proposed changes, specify the acreage associated with each POD/POA.

AUTHORIZED (the "from" or "off" lands) The listing that appears on the certificate BEFORE PROPOSED CHANGES List only that part or portion of the water right that will be changed.											Proposed Changes (see "CODES" from previous page)	PROPOSED (the "to" or "on" lands) The listing as it would appear AFTER PROPOSED CHANGES are made.															
Twp	Rng	Sec	¼	¼	Tax Lot	Gvt Lot or DLC	Acres	Type of USE listed on Certificate	POD(s) or POA(s) (name or number from Table 1)	Priority Date		Twp	Rng	Sec	¼	¼	Tax Lot	Gvt Lot or DLC	Acres	New Type of USE	POD(s)/ POA(s) to be used (from Table 1)	Priority Date					
6	N	34	E	26	NE	NW	2701		14.3	IR	W1 Well	3/7/1949	POA	6	N	34	E	26	NE	NW	2701		14.3	IR	W1 Well Replace	3/7/1949	
6	N	34	E	26	NW	NW	2701		3.8	IR	W1 Well	3/7/1949	POA	6	N	34	E	26	NW	NW	2701		3.8	IR	W1 Well Replace	3/7/1949	
6	N	34	E	26	SW	NW	2702		4.7	IR	W1 Well	3/7/1949	POA	6	N	34	E	26	SW	NW	2702		4.7	IR	W1 Well Replace	3/7/1949	
6	N	34	E	26	SE	NW	2702		20.9	IR	W1 Well	3/7/1949	POA	6	N	34	E	26	SE	NW	2702		20.9	IR	W1 Well Replace	3/7/1949	
6	N	34	E	26	NE	SW	2702		8.2	IR	W1 Well	3/7/1949	POA	6	N	34	E	26	NE	SW	2702		8.2	IR	W1 Well Replace	3/7/1949	
6	N	34	E	26	SW	SW	2702		0.5	IR	W1 Well	3/7/1949	POA	6	N	34	E	26	SW	SW	2702		0.5	IR	W1 Well Replace	3/7/1949	
6	N	34	E	27	SE	NE	2702		3.7	IR	W1 Well	3/7/1949	POA	6	N	34	E	27	SE	NE	2702		3.7	IR	W1 Well Replace	3/7/1949	
6	N	34	E	35	NW	NW	2702		2.3	IR	W1 Well	3/7/1949	POA	6	N	34	E	35	NW	NW	2702		2.3	IR	W1 Well Replace	3/7/1949	
							(58.4)	TOTAL IR													(58.4)	TOTAL IR					
TOTAL ACRES:											TOTAL ACRES:																

Additional remarks: The 58.4 acres associated with Williams Well #1 are from the Basalt aquifer. The 3.4 acres on Tax Lot 2601 in the SESW of Section 26, and 4.0 acres on Tax Lot 2703 in the NWNW of Section 35 are not part of this transfer.

RECEIVED

JUN 28 2021

For Place of Use or Character of Use Changes

Are there other water right certificates, water use permits or ground water registrations associated with the "from" or the "to" lands? Yes No

If YES, list the certificate, water use permit, or ground water registration numbers: **89896, 83956.**



Pursuant to ORS 540.510, any "layered" water use such as an irrigation right that is supplemental to a primary right proposed for transfer must be included in the transfer or be cancelled. Any change to a ground water registration must be filed separately in a ground water registration modification application.

For Substitution (ground water supplemental irrigation will be substituted for surface water primary irrigation)

Ground water supplemental Permit or Certificate # **NA**;
Surface water primary Certificate # **NA**.

RECEIVED

JUN 28 2021

For a change from Supplemental Irrigation Use to Primary Irrigation Use

Identify the primary certificate to be cancelled. Certificate # **NA**

OWRD

For a change in point(s) of appropriation (well(s)) or additional point(s) of appropriation:

Well log(s) are attached for each authorized and proposed well(s) that are clearly labeled and associated with the corresponding well(s) in Table 1 above and on the accompanying application map.

Tip: You may search for well logs on the Department's web page at:

http://apps.wrd.state.or.us/apps/gw/well_log/Default.aspx

AND/OR

Describe the construction of the authorized and proposed well(s) in Table 3 for any wells that do not have a well log. For *proposed wells not yet constructed or built*, provide "a best estimate" for each requested information element in the table. The Department recommends you consult a licensed well driller, geologist, or certified water right examiner to assist with assembling the information necessary to complete Table 3.

Table 3. Construction of Point(s) of Appropriation

Any well(s) in this listing must be clearly tied to corresponding well(s) described in Table 1 and shown on the accompanying application map. Failure to provide the information will delay the processing of your transfer application until it is received. The information is necessary for the department to assess whether the proposed well(s) will access the same source aquifer as the authorized point(s) of appropriation (POA). The Department is prohibited by law from approving POA changes that do not access the same source aquifer.

Proposed or Authorized POA Name or Number	Is well already built? (Yes or No)	If an existing well: OWRD Well ID Tag No.	Total well depth	Casing Diameter	Casing Intervals (feet)	Seal depth(s) (intervals)	Perforated or screened intervals (in feet)	Static water level of completed well (in feet)	Source aquifer (sand, gravel, basalt, etc.)	Well-specific rate (cfs or gpm). If less than full rate of water right
Authorized Williams Well #1	Yes	UMAT 4178	702' bgs	12- & 18-inch	0-60' bgs	Not on well log	No	Not on well log	Basalt	Not on well log
Replacement Williams Well #1	No	N/A	710' bgs	12- to 14 inch	0-90' bgs	90' Top of Basalt	No	Not known at this time	Basalt	Not known at this time

Part 5 of 5 – Water Right Information

OWRD

Please use a separate Part 5 for each water right being changed. See instructions on page 6, to copy and paste additional Part 5s, or to add additional rows to tables within the form.

CERTIFICATE # 42976

Description of Water Delivery System

System capacity: **1.0** cubic feet per second (cfs) **OR**
 _____ gallons per minute (gpm)

Describe the current water delivery system or the system that was in place at some time within the last five years. Include information on the pumps, canals, pipelines, and sprinklers used to divert, convey, and apply the water at the authorized place of use. Water is pumped from the well with 50 hp, submersible pump into 15 inch to 8 inch buried PVC and steel mainline to center pivots with drop tube sprinklers, and 3 inch wheel and handlines. There are three boosters (one 25hp centrifugal, one 50 hp turbine, and one 50 hp centrifugal) used to convey water across property site.

Table 1. Location of Authorized and Proposed Point(s) of Diversion (POD) or Appropriation (POA)

(Note: If the POD/POA name is not specified on the certificate, assign it a name or number here.)

POD/POA Name or Number	Is this POD/POA Authorized on the Certificate or is it Proposed?	If POA, OWRD Well Log ID# (or Well ID Tag # L-___)	Twp		Rng		Sec	¼ ¼		Tax Lot, DLC or Gov't Lot	W
Well U-452	<input checked="" type="checkbox"/> Authorized <input type="checkbox"/> Proposed	UMAT 4627	6	N	34	E	21	SE	SW	1000	690 ft North, 420 ft West from the South ¼ corner, Section 21
Replacement Well U-452	<input type="checkbox"/> Authorized <input checked="" type="checkbox"/> Proposed	NOT DRILLED YET	6	N	34	E	21	SW	SE	1000	45.976565, -118.568334 107 ft North and 282 ft East from the S ¼ corner, Section 21

Check all type(s) of change(s) proposed below (change "CODES" are provided in parentheses):

- | | |
|--|---|
| <input type="checkbox"/> Place of Use (POU) | <input type="checkbox"/> Supplemental Use to Primary Use (S to P) |
| <input type="checkbox"/> Character of Use (USE) | <input checked="" type="checkbox"/> Point of Appropriation/Well (POA) |
| <input type="checkbox"/> Point of Diversion (POD) | <input type="checkbox"/> Additional Point of Appropriation (APOA) |
| <input type="checkbox"/> Additional Point of Diversion (APOD) | <input type="checkbox"/> Substitution (SUB) |
| <input type="checkbox"/> Surface Water POD to Ground Water POA (SW/GW) | <input type="checkbox"/> Government Action POD (GOV) |

Will all of the proposed changes affect the entire water right?

- Yes Complete only the Proposed ("to" or "on" lands) section of Table 2 on the next page. Use the "CODES" listed above to describe the proposed changes.
- No Complete all of Table 2 to describe the portion of the water right to be changed.

Please use and attach additional pages of Table 2 as needed.
See page 6 for instructions.

Do you have questions about how to fill-out the tables?
Contact the Department at 503-986-0900 and ask for Transfer Staff.

Table 2. Description of Changes to Water Right Certificate # 42976

List the change proposed for the acreage in each ¼ ¼. If more than one change is proposed, specify the acreage associated with each change.
If there is more than one POD/POA involved in the proposed changes, specify the acreage associated with each POD/POA.

AUTHORIZED (the "from" or "off" lands) The listing that appears on the certificate BEFORE PROPOSED CHANGES List only that part or portion of the water right that will be changed.													Proposed Changes (see "CODES" from previous page)	PROPOSED (the "to" or "on" lands) The listing as it would appear AFTER PROPOSED CHANGES are made.												
Twp	Rng	Sec	¼	¼	Tax Lot	Gvt Lot or DLC	Acres	Type of USE listed on Certificate	POD(s) or POA(s) (name or number from Table 1)	Priority Date	Twp	Rng		Sec	¼	¼	Tax Lot	Gvt Lot or DLC	Acres	New Type of USE	POD(s)/ POA(s) to be used (from Table 1)	Priority Date				
6	N	34	E	21	NE	SW	1000		16.2	IR	Well U-452	3/27/1952	POA	6	N	34	E	21	NE	SW	1000		16.2	IR	Well R-U-452	3/27/1952
6	N	34	E	21	SE	SW	1000		2.1	IR	Well U-452	3/27/1952	POA	6	N	34	E	21	SE	SW	1000		2.1	IR	Well R-U-452	3/27/1952
									(18.3)	TOTAL IR													(18.3)	TOTAL IR		
6	N	34	E	21	NE	SW	1000		23.8	IS	Well U-452	3/27/1952	POA	6	N	34	E	21	NE	SW	1000		23.8	IS	Well R-U-452	3/27/1952
6	N	34	E	21	SE	SW	1000		37.9	IS	Well U-452	3/27/1952	POA	6	N	34	E	21	SE	SW	1000		37.9	IS	Well R-U-452	3/27/1952
									(61.7)	TOTAL IS													(61.7)	TOTAL SI		
TOTAL ACRES:									80.0						TOTAL ACRES:									80.0		

Additional remarks: The 18.3 acres associated with Well U-452 is for Primary Irrigation from the gravel alluvial aquifer. The 61.7 acres associated with Well U-452 is for Supplemental Irrigation from the gravel alluvial aquifer. R-U-452 is the replacement well. The Final Proof survey map for Certificate 42976 does not distinguish between primary and supplemental acres. This will be rectified upon completion of proof for the transfer.

RECEIVED

JUN. 28 2021

For Place of Use or Character of Use Changes

Are there other water right certificates, water use permits or ground water registrations associated with the “from” or the “to” lands? Yes No

If YES, list the certificate, water use permit, or ground water registration numbers: 95268, 83953, 87556, 93399.

 Pursuant to ORS 540.510, any “layered” water use such as an irrigation right that is supplemental to a primary right proposed for transfer must be included in the transfer or be cancelled. Any change to a ground water registration must be filed separately in a ground water registration modification application.

For Substitution (ground water supplemental irrigation will be substituted for surface water primary irrigation)

Ground water supplemental Permit or Certificate # N/A;
Surface water primary Certificate # N/A.

RECEIVED

JUN 28 2021

For a change from Supplemental Irrigation Use to Primary Irrigation Use

Identify the primary certificate to be cancelled. Certificate # N/A

OWRD

For a change in point(s) of appropriation (well(s)) or additional point(s) of appropriation:

Well log(s) are attached for each authorized and proposed well(s) that are clearly labeled and associated with the corresponding well(s) in Table 1 above and on the accompanying application map.

Tip: You may search for well logs on the Department’s web page at:
http://apps.wrd.state.or.us/apps/gw/well_log/Default.aspx

AND/OR

Describe the construction of the authorized and proposed well(s) in Table 3 for any wells that do not have a well log. For *proposed wells not yet constructed or built*, provide “a best estimate” for each requested information element in the table. The Department recommends you consult a licensed well driller, geologist, or certified water right examiner to assist with assembling the information necessary to complete Table 3.

Table 3. Construction of Point(s) of Appropriation

Any well(s) in this listing must be clearly tied to corresponding well(s) described in Table 1 and shown on the accompanying application map. Failure to provide the information will delay the processing of your transfer application until it is received. The information is necessary for the department to assess whether the proposed well(s) will access the same source aquifer as the authorized point(s) of appropriation (POA). The Department is prohibited by law from approving POA changes that do not access the same source aquifer.

Proposed or Authorized POA Name or Number	Is well already built? (Yes or No)	If an existing well: OWRD Well ID Tag No. L_____	Total well depth	Casing Diameter	Casing Intervals (feet)	Seal depth(s) (intervals)	Perforated or screened intervals (in feet)	Static water level of completed well (in feet)	Source aquifer (sand, gravel, basalt, etc.)	Well-specific rate (cfs or gpm). If less than full rate of water right
Authorized Well U-452	YES	UMAT 4627	231’ bgs	12-inch	Not on well log	Not on well log	Not on well log	Not on well log	Gravel alluvial	Not on well log
Replacement Well U-452	No	N/A	250’ bgs	12-inch	0-100 bgs	0-100 bgs	100-250’	Not known at this time	Gravel alluvial	Not known at this time

Part 5 of 5 – Water Right Information

Please use a separate Part 5 for each water right being changed. See instructions on page 6, to copy and paste additional Part 5s, or to add additional rows to tables within the form.

CERTIFICATE # 89896

RECEIVED

Description of Water Delivery System

JUN 28 2021

System capacity: 9.56 cubic feet per second (cfs) OR
 _____ gallons per minute (gpm)

OWRD

Describe the current water delivery system or the system that was in place at some time within the last five years. Include information on the pumps, canals, pipelines, and sprinklers used to divert, convey, and apply the water at the authorized place of use. Water is pumped from the wells with 25-150 hp pumps into 8 inch to 15 inch buried PVC and steel mainline to center pivots with drop tube sprinklers, and 3 inch wheel and handlines. There are three boosters (one 25hp centrifugal, one 50 hp turbine, and one 50 hp centrifugal) used to convey water across property site.

Table 1. Location of Authorized and Proposed Point(s) of Diversion (POD) or Appropriation (POA)

(Note: If the POD/POA name is not specified on the certificate, assign it a name or number here.)

POD/POA Name or Number	Is this POD/POA Authorized on the Certificate or is it Proposed?	If POA, OWRD Well Log ID# (or Well ID Tag # L-___)	Twp.		Rng		Sec	¼ ¼		Tax Lot, DLC or Gov't Lot	Measured Distances (from a recognized survey corner)
March well 3 (MW3)	<input checked="" type="checkbox"/> Authorized <input type="checkbox"/> Proposed	UMAT 5378	6	N	34	E	22	NE	NE	1700	Alluvial: 60 Feet South and 10 Feet West from NE Corner, Section 22
March Well 1 (MW1)	<input checked="" type="checkbox"/> Authorized <input type="checkbox"/> Proposed	UMAT 4113	6	N	34	E	23	NE	NW	1700	Alluvial: 650 Feet South and 90 Feet West from N ¼ Corner, Section 23
March Well 2 (MW2)	<input checked="" type="checkbox"/> Authorized <input type="checkbox"/> Proposed	UMAT 5357	6	N	34	E	23	SW	NW	1700	Alluvial: 10 Feet North and 350 Feet East from W ¼ Corner, Section 23
Key Bros Well 1 (KBW1)	<input checked="" type="checkbox"/> Authorized <input type="checkbox"/> Proposed	UMAT 4121	6	N	34	E	23	SW	SW	1800	Alluvial: 260 Feet North and 1230 Feet East from SW Corner, Section 23
Williams Well 7 (WW7)	<input checked="" type="checkbox"/> Authorized <input type="checkbox"/> Proposed	UMAT 52037	6	N	34	E	23	SW	SW	1800	Alluvial: 1230 Feet North and 90 Feet East from SW Corner, Section 23
Key Bros Well 2 (KBW2)	<input checked="" type="checkbox"/> Authorized <input type="checkbox"/> Proposed	UMAT 4122	6	N	34	E	23	SE	SW	1800	Alluvial: 30 Feet North and 1620 Feet East From SW Corner, Section 23
Williams Well 3 (WW3)	<input checked="" type="checkbox"/> Authorized <input type="checkbox"/> Proposed	UMAT 53567	6	N	34	E	27	SE	SE	2702	Basalt: 970 Feet North and 5 Feet East from SW Corner, Section 26
Williams Well 4 (WW4)	<input checked="" type="checkbox"/> Authorized <input type="checkbox"/> Proposed	UMAT 4177	6	N	34	E	35	SE	NW	4400	Basalt: 1290 Feet South and 1710 Feet East from NW Corner, Section 35.
Williams Well 1 (WW1) (Basalt)	<input checked="" type="checkbox"/> Authorized <input type="checkbox"/> Proposed	UMAT 4178	6	N	34	E	35	NW	NW	2702	Basalt: 670 feet South & 35 feet East from NW Corner, Section 35
Williams Well 1 (WW1R) Replacement (Basalt)	<input type="checkbox"/> Authorized <input checked="" type="checkbox"/> Proposed	NOT DRILLED	6	N	34	E	35	NW	NW	2702	45.959971 -118.537696 Basalt: 715 ft South & 161 ft East from the NW Corner, Section 35

Check all type(s) of change(s) proposed below (change "CODES" are provided in parentheses):

- | | |
|---|---|
| <input type="checkbox"/> Place of Use (POU) | <input type="checkbox"/> Supplemental Use to Primary Use (S to P) |
| <input type="checkbox"/> Character of Use (USE) | <input checked="" type="checkbox"/> Point of Appropriation/Well (POA) |
| <input type="checkbox"/> Point of Diversion (POD) | <input type="checkbox"/> Additional Point of Appropriation (APOA) |
| <input type="checkbox"/> Additional Point of Diversion (APOD) | <input type="checkbox"/> Substitution (SUB) |
| <input type="checkbox"/> Surface Water POD to Ground Water
POA (SW/GW) | <input type="checkbox"/> Government Action POD (GOV) |

Will all of the proposed changes affect the entire water right?

- Yes Complete only the Proposed ("to" or "on" lands) section of Table 2 on the next page. Use the "CODES" listed above to describe the proposed changes.
- No Complete all of Table 2 to describe the portion of the water right to be changed.

RECEIVED

JUN 28 2021

OWRD

Please use and attach additional pages of Table 2 as needed.
See page 6 for instructions.

Do you have questions about how to fill-out the tables?
Contact the Department at 503-986-0900 and ask for Transfer Staff.

Table 2. Description of Changes to Water Right Certificate # 89896

List the change proposed for the acreage in each ¼ ¼. If more than one change is proposed, specify the acreage associated with each change.
If there is more than one POD/POA involved in the proposed changes, specify the acreage associated with each POD/POA.

AUTHORIZED (the "from" or "off" lands) The listing that appears on the certificate BEFORE PROPOSED CHANGES List only that part or portion of the water right that will be changed.											Proposed Changes (see "CODES" from previous page)	PROPOSED (the "to" or "on" lands) The listing as it would appear AFTER PROPOSED CHANGES are made.														
Twp	Rng	Sec	¼ ¼	Tax Lot	Gvt Lot or DLC	Acres	Type of USE listed on Certificate	POD(s) or POA(s) (name or number from Table 1)	Priority Date	Twp		Rng	Sec	¼ ¼	Tax Lot	Gvt Lot or DLC	Acres	New Type of USE	POD(s)/ POA(s) to be used (from Table 1)	Priority Date						
6	N	34	E	22	NE	NE	1700		24.9	IR	MW3, MW1, MW2, KBW1, WW7, KBW2 WW3, WW1, WW4	4/20/98	POA	6	N	34	E	22	NE	NE	1700		24.9	IR	MW3, MW1, MW2, KBW1, WW7, KBW2 WW3, WW1R, WW4	4/20/98
6	N	34	E	22	NW	NE	1700		15.0	IR	MW3, MW1, MW2, KBW1, WW7, KBW2 WW3, WW1, WW4	4/20/98	POA	6	N	34	E	22	NW	NE	1700		15.0	IR	MW3, MW1, MW2, KBW1, WW7, KBW2 WW3, WW1R, WW4	4/20/98
6	N	34	E	22	SW	NE	1700		15.9	IR	MW3, MW1, MW2, KBW1, WW7, KBW2 WW3, WW1, WW4	4/20/98	POA	6	N	34	E	22	SW	NE	1700		15.9	IR	MW3, MW1, MW2, KBW1, WW7, KBW2 WW3, WW1R, WW4	4/20/98
6	N	34	E	22	SE	NE	1700		16.8	IR	MW3, MW1, MW2, KBW1, WW7, KBW2 WW3, WW1, WW4	4/20/98	POA	6	N	34	E	22	SE	NE	1700		16.8	IR	MW3, MW1, MW2, KBW1, WW7, KBW2 WW3, WW1R, WW4	4/20/98
6	N	34	E	22	NE	SE	1700		20.7	IR	MW3, MW1, MW2, KBW1, WW7, KBW2 WW3, WW1, WW4	4/20/98	POA	6	N	34	E	22	NE	SE	1700		20.7	IR	MW3, MW1, MW2, KBW1, WW7, KBW2 WW3, WW1R, WW4	4/20/98
6	N	34	E	22	NW	SE	1700		9.1	IR	MW3, MW1, MW2, KBW1, WW7, KBW2 WW3, WW1, WW4	4/20/98	POA	6	N	34	E	22	NW	SE	1700		9.1	IR	MW3, MW1, MW2, KBW1, WW7, KBW2 WW3, WW1R, WW4	4/20/98
6	N	34	E	23	NE	NW	1700		13.4	IR	MW3, MW1, MW2, KBW1, WW7, KBW2 WW3, WW1, WW4	4/20/98	POA	6	N	34	E	23	NE	NW	1700		13.4	IR	MW3, MW1, MW2, KBW1, WW7, KBW2 WW3, WW1R, WW4	4/20/98
6	N	34	E	23	NW	NW	1700		15.5	IR	MW3, MW1, MW2, KBW1, WW7, KBW2 WW3, WW1, WW4	4/20/98	POA	6	N	34	E	23	NW	NW	1700		15.5	IR	MW3, MW1, MW2, KBW1, WW7, KBW2 WW3, WW1R, WW4	4/20/98
6	N	34	E	23	SW	NW	1700		36.7	IR	MW3, MW1, MW2, KBW1, WW7, KBW2 WW3, WW1, WW4	4/20/98	POA	6	N	34	E	23	SW	NW	1700		36.7	IR	MW3, MW1, MW2, KBW1, WW7, KBW2 WW3, WW1R, WW4	4/20/98
6	N	34	E	23	NW	SW	1700		5.6	IR	MW3, MW1, MW2, KBW1, WW7, KBW2 WW3, WW1, WW4	4/20/98	POA	6	N	34	E	23	NW	SW	1700		5.6	IR	MW3, MW1, MW2, KBW1, WW7, KBW2 WW3, WW1R, WW4	4/20/98
6	N	34	E	26	NE	NW	2701		1.6	IR	MW3, MW1, MW2, KBW1, WW7, KBW2 WW3, WW1, WW4	4/20/98	POA	6	N	34	E	26	NE	NW	2701		1.6	IR	MW3, MW1, MW2, KBW1, WW7, KBW2 WW3, WW1R, WW4	4/20/98
6	N	34	E	26	SW	NW	2702		4.8	IR	MW3, MW1, MW2, KBW1, WW7, KBW2 WW3, WW1, WW4	4/20/98	POA	6	N	34	E	26	SW	NW	2702		4.8	IR	MW3, MW1, MW2, KBW1, WW7, KBW2 WW3, WW1R, WW4	4/20/98
TOTAL ACRES:						See total on next page					TOTAL ACRES:															

RECEIVED

Additional remarks: This POA transfer affects the basalt aquifer portions of Pendleton Land's acreage only. The POA transfer map legend lists location of affected wells only.

Additional remarks: **The water right allows 33 acres for Supplemental Irrigation to be used from either the Alluvial aquifer or the Basalt aquifer. The replacement well for Williams Well #1 will be Basalt.**

AUTHORIZED (the "from" or "off" lands) The listing that appears on the certificate BEFORE PROPOSED CHANGES List only that part or portion of the water right that will be changed.											Proposed Changes (see "CODES" from previous page)	PROPOSED (the "to" or "on" lands) The listing as it would appear AFTER PROPOSED CHANGES are made.														
Twp	Rng	Sec	¼	¼	Tax Lot	Gvt Lot or DLC	Acres	Type of USE listed on Certificate	POD(s) or POA(s) (name or number from Table 1)	Priority Date		Twp	Rng	Sec	¼	¼	Tax Lot	Gvt Lot or DLC	Acres	New Type of USE	POD(s)/ POA(s) to be used (from Table 1)	Priority Date				
6	N	34	E	26	SE	NW	2702	2.2	IR	MW3, MW1, MW2, KBW1, WW7, KBW2 WW3, WW1, WW4	4/20/98	POA	6	N	34	E	26	SE	NW	2702	2.2	IR	MW3, MW1, MW2, KBW1, WW7, KBW2 WW3, WW1R, WW4	4/20/98		
6	N	34	E	26	NE	SW	2702	7.4	IR	MW3, MW1, MW2, KBW1, WW7, KBW2 WW3, WW1, WW4	4/20/98	POA	6	N	34	E	26	NE	SW	2702	7.4	IR	MW3, MW1, MW2, KBW1, WW7, KBW2 WW3, WW1R, WW4	4/20/98		
6	N	34	E	26	NW	SW	2702	4.5	IR	MW3, MW1, MW2, KBW1, WW7, KBW2 WW3, WW1, WW4	4/20/98	POA	6	N	34	E	26	NW	SW	2702	4.5	IR	MW3, MW1, MW2, KBW1, WW7, KBW2 WW3, WW1R, WW4	4/20/98		
6	N	34	E	26	SW	SW	2702	1.0	IR	MW3, MW1, MW2, KBW1, WW7, KBW2 WW3, WW1, WW4	4/20/98	POA	6	N	34	E	26	SW	SW	2702	1.0	IR	MW3, MW1, MW2, KBW1, WW7, KBW2 WW3, WW1R, WW4	4/20/98		
6	N	34	E	35	NW	NW	2702	0.5	IR	MW3, MW1, MW2, KBW1, WW7, KBW2 WW3, WW1, WW4	4/20/98	POA	6	N	34	E	35	NW	NW	2702	0.5	IR	MW3, MW1, MW2, KBW1, WW7, KBW2 WW3, WW1R, WW4	4/20/98		
							(195.6)	TOTAL												(195.6)	TOTAL					
6	N	34	E	22	NW	NE	1700	23.0	IS either aquifer	MW3, MW1, MW2, KBW1, WW7, KBW2 WW3, WW1, WW4	4/20/98	POA	6	N	34	E	22	NW	NE	1700	23.0	IS either aquifer	MW3, MW1, MW2, KBW1, WW7, KBW2 WW3, WW1R, WW4	4/20/98		
6	N	34	E	22	SW	NE	1700	10.0	IS either aquifer	MW3, MW1, MW2, KBW1, WW7, KBW2 WW3, WW1, WW4	4/20/98	POA	6	N	34	E	22	SW	NE	1700	10.0	IS either aquifer	MW3, MW1, MW2, KBW1, WW7, KBW2 WW3, WW1R, WW4	4/20/98		
							(33.0)	TOTAL												(33.0)	TOTAL					
TOTAL ACRES:																				TOTAL ACRES:						

Table 2. Description of Changes to Water Right Certificate # 89896

List the change proposed for the acreage in each ¼ ¼. If more than one change is proposed, specify the acreage associated with each change.

If there is more than one POD/POA involved in the proposed changes, specify the acreage associated with each POD/POA.

AUTHORIZED (the "from" or "off" lands) The listing that appears on the certificate BEFORE PROPOSED CHANGES List only that part or portion of the water right that will be changed.													Proposed Changes (see "CODES" from previous page)	PROPOSED (the "to" or "on" lands) The listing as it would appear AFTER PROPOSED CHANGES are made.											
Twp	Rng	Sec	¼	¼	Tax Lot	Gvt Lot or DLC	Acres	Type of USE listed on Certificate	POD(s) or POA(s) (name or number from Table 1)	Priority Date	Twp	Rng		Sec	¼	¼	Tax Lot	Gvt Lot or DLC	Acres	New Type of USE	POD(s)/ POA(s) to be used (from Table 1)	Priority Date			
6	N	34	E	23	NW	NW	1700	1.6	IS basalt	WW3, WW1, WW4	4/20/98	POA	6	N	34	E	23	NW	NW	1700	1.6	IS basalt	WW3, WW1R, WW4	4/20/98	
6	N	34	E	23	SW	SW	1800	37.3	IS basalt	WW3, WW1, WW4	4/20/98	POA	6	N	34	E	23	SW	SW	1800	37.3	IS basalt	WW3, WW1R, WW4	4/20/98	
6	N	34	E	23	SE	SW	1800	38.4	IS basalt	WW3, WW1, WW4	4/20/98	POA	6	N	34	E	23	SE	SW	1800	38.4	IS basalt	WW3, WW1R, WW4	4/20/98	
6	N	34	E	26	NE	NW	2701	8.0	IS basalt	WW3, WW1, WW4	4/20/98	POA	6	N	34	E	26	NE	NW	2701	8.0	IS basalt	WW3, WW1R, WW4	4/20/98	
6	N	34	E	26	NE	SW	2702	3.5	IS basalt	WW3, WW1, WW4	4/20/98	POA	6	N	34	E	26	NE	SW	2702	3.5	IS basalt	WW3, WW1R, WW4	4/20/98	
6	N	34	E	26	NW	SW	2702	0.4	IS basalt	WW3, WW1, WW4	4/20/98	POA	6	N	34	E	26	NW	SW	2702	0.4	IS basalt	WW3, WW1R, WW4	4/20/98	
6	N	34	E	27	NE	NE	2701	2.2	IS basalt	WW3, WW1, WW4	4/20/98	POA	6	N	34	E	27	NE	NE	2701	2.2	IS basalt	WW3, WW1R, WW4	4/20/98	
6	N	34	E	27	SE	NE	2702	0.4	IS basalt	WW3, WW1, WW4	4/20/98	POA	6	N	34	E	27	SE	NE	2702	0.4	IS basalt	WW3, WW1R, WW4	4/20/98	
							(91.8)	TOTAL																	
TOTAL ACRES:									TOTAL			TOTAL ACRES:													

Additional remarks: **These 91.8 acres of Certificate 89896 associated with Williams Well #1 are for Supplemental Irrigation from Basalt aquifer.**

RECEIVED

JUN 28 2021

OWRD

Table 2. Description of Changes to Water Right Certificate # 89896

AUTHORIZED (the "from" or "off" lands) The listing that appears on the certificate BEFORE PROPOSED CHANGES List only that part or portion of the water right that will be changed.													Proposed Changes (see "CODES" from previous page)	PROPOSED (the "to" or "on" lands) The listing as it would appear AFTER PROPOSED CHANGES are made.												
Twp	Rng	Sec	¼	¼	Tax Lot	Gvt Lot or DLC	Acres	Type of USE listed on Certificate	POD(s) or POA(s) (name or number from Table 1)	Priority Date	Twp	Rng		Sec	¼	¼	Tax Lot	Gvt Lot or DLC	Acres	New Type of USE	POD(s)/ POA(s) to be used (from Table 1)	Priority Date				
6	N	34	E	26	NE	NW	2701		33.2	IS Deficiency Basalt	W1 Well	4/20/98	POA	6	N	34	E	26	NE	NW	2701		33.2	IS Deficiency Basalt	W1 Well Replace	4/20/98
6	N	34	E	26	NW	NW	2701		39.6	IS Deficiency Basalt	W1 Well	4/20/98	POA	6	N	34	E	26	NW	NW	2701		39.6	IS Deficiency Basalt	W1 Well Replace	4/20/98
6	N	34	E	26	SW	NW	2702		29.2	IS Deficiency Basalt	W1 Well	4/20/98	POA	6	N	34	E	26	SW	NW	2702		29.2	IS Deficiency Basalt	W1 Well Replace	4/20/98
6	N	34	E	26	SE	NW	2702		32.9	IS Deficiency Basalt	W1 Well	4/20/98	POA	6	N	34	E	26	SE	NW	2702		32.9	IS Deficiency Basalt	W1 Well Replace	4/20/98
6	N	34	E	26	NE	SW	2702		15.2	IS Deficiency Basalt	W1 Well	4/20/98	POA	6	N	34	E	26	NE	SW	2702		15.2	IS Deficiency Basalt	W1 Well Replace	4/20/98
6	N	34	E	26	NW	SW	2702		36.8	IS Deficiency Basalt	W1 Well	4/20/98	POA	6	N	34	E	26	NW	SW	2702		36.8	IS Deficiency Basalt	W1 Well Replace	4/20/98
6	N	34	E	26	SW	SW	2702		37.1	IS Deficiency Basalt	W1 Well	4/20/98	POA	6	N	34	E	26	SW	SW	2702		37.1	IS Deficiency Basalt	W1 Well Replace	4/20/98
6	N	34	E	27	NE	NE	2701		35.8	IS Deficiency Basalt	W1 Well	4/20/98	POA	6	N	34	E	27	NE	NE	2701		35.8	IS Deficiency Basalt	W1 Well Replace	4/20/98
6	N	34	E	27	SE	NE	2702		38.4	IS Deficiency Basalt	W1 Well	4/20/98	POA	6	N	34	E	27	SE	NE	2702		38.4	IS Deficiency Basalt	W1 Well Replace	4/20/98
6	N	34	E	35	NW	NW	2702		19.4	IS Deficiency Basalt	W1 Well	4/20/98	POA	6	N	34	E	35	NW	NW	2702		19.4	IS Deficiency Basalt	W1 Well Replace	4/20/98
									(317.6)	TOTAL													(317.6)	TOTAL		
TOTAL ACRES:										TOTAL				TOTAL ACRES:												

Comments: These 317.6 acres associated with Williams Well #1 are for Supplemental Irrigation for Deficiency from Basalt Aquifer. The acres associated with Supplemental Irrigation from Alluvial Aquifer and Supplemental Irrigation for a Deficiency from Alluvial Aquifer are not part of this transfer as we are only replacing a basalt well.

For Place of Use or Character of Use Changes

Are there other water right certificates, water use permits or ground water registrations associated with the “from” or the “to” lands? Yes No

If YES, list the certificate, water use permit, or ground water registration numbers: 2810, 5516, 5528, 6323, 7967, 30636, 36131, 36132, 66888, 76705, 83954, 83956, 87556, 93399, 94536, T-8286, G-12728.



Pursuant to ORS 540.510, any “layered” water use such as an irrigation right that is supplemental to a primary right proposed for transfer must be included in the transfer or be cancelled. Any change to a ground water registration must be filed separately in a ground water registration modification application.

For Substitution (ground water supplemental irrigation will be substituted for surface water primary irrigation)

Ground water supplemental Permit or Certificate # N/A;
Surface water primary Certificate # N/A.

RECEIVED

JUN 28 2021

For a change from Supplemental Irrigation Use to Primary Irrigation Use

Identify the primary certificate to be cancelled. Certificate # N/A

OWRD

For a change in point(s) of appropriation (well(s)) or additional point(s) of appropriation:

Well log(s) are attached for each authorized and proposed well(s) that are clearly labeled and associated with the corresponding well(s) in Table 1 above and on the accompanying application map.

Tip: You may search for well logs on the Department’s web page at:

http://apps.wrd.state.or.us/apps/gw/well_log/Default.aspx

AND/OR

Describe the construction of the authorized and proposed well(s) in Table 3 for any wells that do not have a well log. For *proposed wells not yet constructed or built*, provide “a best estimate” for each requested information element in the table. The Department recommends you consult a licensed well driller, geologist, or certified water right examiner to assist with assembling the information necessary to complete Table 3.

Table 3. Construction of Point(s) of Appropriation

Any well(s) in this listing must be clearly tied to corresponding well(s) described in Table 1 and shown on the accompanying application map. Failure to provide the information will delay the processing of your transfer application until it is received. The information is necessary for the department to assess whether the proposed well(s) will access the same source aquifer as the authorized point(s) of appropriation (POA). The Department is prohibited by law from approving POA changes that do not access the same source aquifer.

Proposed or Authorized POA Name or Number	Is well already built? (Yes or No)	If an existing well: OWRD Well ID Tag No. L-_____	Total well depth	Casing Diameter	Casing Intervals (feet)	Seal depth(s) (intervals)	Perforated or screened intervals (in feet)	Static water level of completed well (in feet)	Source aquifer (sand, gravel, basalt, etc.)	Well-specific rate (cfs or gpm). If less than full rate of water right
Authorized Williams Well #1	Yes	UMAT 4178	702' bgs	14- & 18-inch	60' bgs	Not on well log	Not on well log	Not on well log	Basalt	Not on well log
Replacement Williams Well #1	No	N/A	710' bgs	12- to 14-inch	0-90'	90 minimum top of basalt	No	Not known at this time	Basalt	Not known at this time

Part 5 of 5 – Water Right Information

Please use a separate Part 5 for each water right being changed. See instructions on page 6, to copy and paste additional Part 5s, or to add additional rows to tables within the form.

CERTIFICATE # 95268

RECEIVED

Description of Water Delivery System

JUN 28 2021

System capacity: **10.98** cubic feet per second (cfs) **OR**

_____ gallons per minute (gpm)

OWRD

Describe the current water delivery system or the system that was in place at some time within the last five years. Include information on the pumps, canals, pipelines, and sprinklers used to divert, convey, and apply the water at the authorized place of use. **Water is pumped from the wells with 50 and 75 hp, submersible pumps into 8 inch to 15 inch buried PVC and steel mainline to center pivots with drop tube sprinklers, and 3 inch wheel and handlines. There are three boosters (one 25hp centrifugal, one 50 hp turbine, and one 50 hp centrifugal) used to convey water across property site.**

Table 1. Location of Authorized and Proposed Point(s) of Diversion (POD) or Appropriation (POA)

(Note: If the POD/POA name is not specified on the certificate, assign it a name or number here.)

POD/POA Name or Number	Is this POD/POA Authorized on the Certificate or is it Proposed?	If POA, OWRD Well Log ID# (or Well ID Tag # L-___)	Twp		Rng		Sec	¼ ¼		Tax Lot, DLC or Gov't Lot	Measured Distances (from a recognized survey corner)
Well 4	<input checked="" type="checkbox"/> Authorized <input type="checkbox"/> Proposed	UMAT 53646	6	N	34	E	21	SE	NW	403	85 feet North and 40 feet West from C 1/4 corner, Section 21
Well 8	<input checked="" type="checkbox"/> Authorized <input type="checkbox"/> Proposed	UMAT 52007	6	N	34	E	21	SW	NW	403	125 feet North and 90 feet East from West ¼ corner, Section 21
Well U-452	<input checked="" type="checkbox"/> Authorized <input type="checkbox"/> Proposed	UMAT 4627	6	N	34	E	21	SE	SW	1000	690 feet North and 420 feet West from South ¼ corner, Section 21
Well 1	<input checked="" type="checkbox"/> Authorized <input type="checkbox"/> Proposed	UMAT 4167	6	N	34	E	28	SW	NE	3600	2,130 feet South and 2,930 feet East from NW corner, Section 28
Replacement Well 4	<input type="checkbox"/> Authorized <input checked="" type="checkbox"/> Proposed	NOT DRILLED YET	6	N	34	E	21	SE	NW	403	45.984155, -118.568686 147 ft North & 179 Ft East from Center Section 21
Replacement Well U-452	<input type="checkbox"/> Authorized <input checked="" type="checkbox"/> Proposed	NOT DRILLED	6	N	34	E	21	SE	SW	1000	45.976565, -118.568334 107 ft North & 282 ft East from the S ¼ corner, Section 21

Check all type(s) of change(s) proposed below (change "CODES" are provided in parentheses):

- | | |
|---|---|
| <input type="checkbox"/> Place of Use (POU) | <input type="checkbox"/> Supplemental Use to Primary Use (S to P) |
| <input type="checkbox"/> Character of Use (USE) | <input checked="" type="checkbox"/> Point of Appropriation/Well (POA) |
| <input type="checkbox"/> Point of Diversion (POD) | <input type="checkbox"/> Additional Point of Appropriation (APOA) |

- | | |
|---|--|
| <input type="checkbox"/> Additional Point of Diversion (APOD) | <input type="checkbox"/> Substitution (SUB) |
| <input type="checkbox"/> Surface Water POD to Ground Water
POA (SW/GW) | <input type="checkbox"/> Government Action POD (GOV) |

Will all of the proposed changes affect the entire water right?

- Yes Complete only the Proposed ("to" or "on" lands) section of Table 2 on the next page. Use the "CODES" listed above to describe the proposed changes.
- No Complete all of Table 2 to describe the portion of the water right to be changed.

RECEIVED
JUN 28 2021
OWRD

Please use and attach additional pages of Table 2 as needed.
See page 6 for instructions.

Do you have questions about how to fill-out the tables?
Contact the Department at 503-986-0900 and ask for Transfer Staff.

Table 2. Description of Changes to Water Right Certificate # 95268

List the change proposed for the acreage in each ¼ ¼. If more than one change is proposed, specify the acreage associated with each change.
If there is more than one POD/POA involved in the proposed changes, specify the acreage associated with each POD/POA.

AUTHORIZED (the "from" or "off" lands) The listing that appears on the certificate BEFORE PROPOSED CHANGES List only that part or portion of the water right that will be changed.											Proposed Changes (see "CODES" from previous page)	PROPOSED (the "to" or "on" lands) The listing as it would appear AFTER PROPOSED CHANGES are made.										
Twp	Rng	Sec	¼ ¼	Tax Lot	Gvt Lot or DLC	Acres	Type of USE listed on Certificate	POD(s) or POA(s) (name or number from Table 1)	Priority Date	Twp		Rng	Sec	¼ ¼	Tax Lot	Gvt Lot or DLC	Acres	New Type of USE	POD(s)/ POA(s) to be used (from Table 1)	Priority Date		
6	N	34	E 28 SW NE	3500		4.6	IR	Well 1, 4, 8, U-452	8/10/2001	POA	6	N	34	E 28 SW NE	3500	4.6	IR	Well 1, 8, R-4, R-U-452	8/10/2001			
						(4.6)	Total IR									(4.6)	Total IR					
6	N	34	E 20 SW NW	900		0.2	IS	Well 1, 4, 8, U-452	8/10/2001	POA	6	N	34	E 20 SW NW	900	0.2	IS	Well 1, 8, R-4, R-U-452	8/10/2001			
6	N	34	E 20 SE NW	900		0.2	IS	Well 1, 4, 8, U-452	8/10/2001	POA	6	N	34	E 20 SE NW	900	0.2	IS	Well 1, 8, R-4, R-U-452	8/10/2001			
6	N	34	E 20 NE SW	900		25.2	IS	Well 1, 4, 8, U-452	8/10/2001	POA	6	N	34	E 20 NE SW	900	25.2	IS	Well 1, 8, R-4, R-U-452	8/10/2001			
6	N	34	E 20 NW SW	900		35.5	IS	Well 1, 4, 8, U-452	8/10/2001	POA	6	N	34	E 20 NW SW	900	35.5	IS	Well 1, 8, R-4, R-U-452	8/10/2001			
6	N	34	E 20 SW SW	900		39.1	IS	Well 1, 4, 8, U-452	8/10/2001	POA	6	N	34	E 20 SW SW	900	39.1	IS	Well 1, 8, R-4, R-U-452	8/10/2001			
6	N	34	E 20 SE SW	900		35.1	IS	Well 1, 4, 8, U-452	8/10/2001	POA	6	N	34	E 20 SE SW	900	35.1	IS	Well 1, 8, R-4, R-U-452	8/10/2001			
6	N	34	E 20 NW SE	900		5.1	IS	Well 1, 4, 8, U-452	8/10/2001	POA	6	N	34	E 20 NW SE	900	5.1	IS	Well 1, 8, R-4, R-U-452	8/10/2001			
6	N	34	E 20 SW SE	900		36.0	IS	Well 1, 4, 8, U-452	8/10/2001	POA	6	N	34	E 20 SW SE	900	36.0	IS	Well 1, 8, R-4, R-U-452	8/10/2001			
6	N	34	E 20 SE SE	900		15.8	IS	Well 1, 4, 8, U-452	8/10/2001	POA	6	N	34	E 20 SE SE	900	15.8	IS	Well 1, 8, R-4, R-U-452	8/10/2001			
TOTAL ACRES:							SEE NEXT PAGE				TOTAL ACRES:							SEE NEXT PAGE				

Additional remarks: R-4 and R-U-452 are replacement wells.

RECEIVED

JUN 28 2021

OWRD

Please use and attach additional pages of Table 2 as needed.
See page 6 for instructions.

Do you have questions about how to fill-out the tables?
Contact the Department at 503-986-0900 and ask for Transfer Staff.

Table 2. Description of Changes to Water Right Certificate # 95268

List the change proposed for the acreage in each ¼ ¼. If more than one change is proposed, specify the acreage associated with each change.

AUTHORIZED (the "from" or "off" lands) The listing that appears on the certificate BEFORE PROPOSED CHANGES List only that part or portion of the water right that will be changed.											Proposed Changes (see "CODES" from previous page)	PROPOSED (the "to" or "on" lands) The listing as it would appear AFTER PROPOSED CHANGES are made.														
Twp	Rng	Sec	¼ ¼	Tax Lot	Gvt Lot or DLC	Acres	Type of USE listed on Certificate	POD(s) or POA(s) (name or number from Table 1)	Priority Date	Twp		Rng	Sec	¼ ¼	Tax Lot	Gvt Lot or DLC	Acres	New Type of USE	POD(s)/ POA(s) to be used (from Table 1)	Priority Date						
6	N	34	E	21	NE	SW	1000		40.0	IS	Well 1, 4, 8, U-452	8/10/2001	POA	6	N	34	E	21	NE	SW	1000		40.0	IS	Well 1, 8, R-4, R-U-452	8/10/2001
6	N	34	E	21	NW	SW	1000		40.0	IS	Well 1, 4, 8, U-452	8/10/2001	POA	6	N	34	E	21	NW	SW	1000		40.0	IS	Well 1, 8, R-4, R-U-452	8/10/2001
6	N	34	E	21	SW	SW	1000		37.4	IS	Well 1, 4, 8, U-452	8/10/2001	POA	6	N	34	E	21	SW	SW	1000		37.4	IS	Well 1, 8, R-4, R-U-452	8/10/2001
6	N	34	E	21	SE	SW	1000		38.2	IS	Well 1, 4, 8, U-452	8/10/2001	POA	6	N	34	E	21	SE	SW	1000		38.2	IS	Well 1, 8, R-4, R-U-452	8/10/2001
6	N	34	E	21	NW	SE	1000		1.4	IS	Well 1, 4, 8, U-452	8/10/2001	POA	6	N	34	E	21	NW	SE	1000		1.4	IS	Well 1, 8, R-4, R-U-452	8/10/2001
6	N	34	E	21	SW	SE	1000		4.9	IS	Well 1, 4, 8, U-452	8/10/2001	POA	6	N	34	E	21	SW	SE	1000		4.9	IS	Well 1, 8, R-4, R-U-452	8/10/2001
6	N	34	E	28	NW	NE	3500		6.9	IS	Well 1, 4, 8, U-452	8/10/2001	POA	6	N	34	E	28	NW	NE	3500		6.9	IS	Well 1, 8, R-4, R-U-452	8/10/2001
6	N	34	E	28	SW	NE	3500		4.3	IS	Well 1, 4, 8, U-452	8/10/2001	POA	6	N	34	E	28	SW	NE	3500		4.3	IS	Well 1, 8, R-4, R-U-452	8/10/2001
6	N	34	E	28	NE	NW	3600		39.0	IS	Well 1, 4, 8, U-452	8/10/2001	POA	6	N	34	E	28	NE	NW	3600		39.0	IS	Well 1, 8, R-4, R-U-452	8/10/2001
6	N	34	E	28	NW	NW	3600		36.1	IS	Well 1, 4, 8, U-452	8/10/2001	POA	6	N	34	E	28	NW	NW	3600		36.1	IS	Well 1, 8, R-4, R-U-452	8/10/2001
6	N	34	E	28	SW	NW	900		39.8	IS	Well 1, 4, 8, U-452	8/10/2001	POA	6	N	34	E	28	SW	NW	900		39.8	IS	Well 1, 8, R-4, R-U-452	8/10/2001
6	N	34	E	28	SE	NW	900		37.3	IS	Well 1, 4, 8, U-452	8/10/2001	POA	6	N	34	E	28	SE	NW	900		37.3	IS	Well 1, 8, R-4, R-U-452	8/10/2001
TOTAL ACRES:						SEE NEXT PAGE					TOTAL ACRES:						SEE NEXT PAGE									

If there is more than one POD/POA involved in the proposed changes, specify the acreage associated with each POD/POA.

Additional remarks: **R-4 and R-U-452 are replacement wells.**

RECEIVED

JUN 28 2021

Please use and attach additional pages of Table 2 as needed.
See page 6 for instructions.

Do you have questions about how to fill-out the tables?
Contact the Department at 503-986-0900 and ask for Transfer Staff.

Table 2. Description of Changes to Water Right Certificate # 95268

List the change proposed for the acreage in each ¼ ¼. If more than one change is proposed, specify the acreage associated with each change.

AUTHORIZED (the "from" or "off" lands) The listing that appears on the certificate BEFORE PROPOSED CHANGES List only that part or portion of the water right that will be changed.											Proposed Changes (see "CODES" from previous page)	PROPOSED (the "to" or "on" lands) The listing as it would appear AFTER PROPOSED CHANGES are made.												
Twp	Rng	Sec	¼ ¼	Tax Lot	Gvt Lot or DLC	Acres	Type of USE listed on Certificate	POD(s) or POA(s) (name or number from Table 1)	Priority Date	Twp		Rng	Sec	¼ ¼	Tax Lot	Gvt Lot or DLC	Acres	New Type of USE	POD(s)/ POA(s) to be used (from Table 1)	Priority Date				
6	N	34	E	28	NE SW	900		41.1	IS	Well 1, 4, 8, U-452	8/10/2001	POA	6	N	34	E	28	NE SW	900		41.1	IS	Well 1, 8, R-4, R-U-452	8/10/2001
6	N	34	E	28	NW SW	900		26.9	IS	Well 1, 4, 8, U-452	8/10/2001	POA	6	N	34	E	28	NW SW	900		26.9	IS	Well 1, 8, R-4, R-U-452	8/10/2001
6	N	34	E	28	SW SW	3700		27.9	IS	Well 1, 4, 8, U-452	8/10/2001	POA	6	N	34	E	28	SW SW	3700		27.9	IS	Well 1, 8, R-4, R-U-452	8/10/2001
6	N	34	E	28	SE SW	900		31.7	IS	Well 1, 4, 8, U-452	8/10/2001	POA	6	N	34	E	28	SE SW	900		31.7	IS	Well 1, 8, R-4, R-U-452	8/10/2001
6	N	34	E	28	NW SE	900		10.2	IS	Well 1, 4, 8, U-452	8/10/2001	POA	6	N	34	E	28	NW SE	900		10.2	IS	Well 1, 8, R-4, R-U-452	8/10/2001
6	N	34	E	28	SW SE	900		10.9	IS	Well 1, 4, 8, U-452	8/10/2001	POA	6	N	34	E	28	SW SE	900		10.9	IS	Well 1, 8, R-4, R-U-452	8/10/2001
6	N	34	E	29	NE NE	900		29.2	IS	Well 1, 4, 8, U-452	8/10/2001	POA	6	N	34	E	29	NE NE	900		29.2	IS	Well 1, 8, R-4, R-U-452	8/10/2001
6	N	34	E	29	NW NE	900		39.1	IS	Well 1, 4, 8, U-452	8/10/2001	POA	6	N	34	E	29	NW NE	900		39.1	IS	Well 1, 8, R-4, R-U-452	8/10/2001
6	N	34	E	29	SW NE	900		38.9	IS	Well 1, 4, 8, U-452	8/10/2001	POA	6	N	34	E	29	SW NE	900		38.9	IS	Well 1, 8, R-4, R-U-452	8/10/2001
6	N	34	E	29	SE NE	900		34.2	IS	Well 1, 4, 8, U-452	8/10/2001	POA	6	N	34	E	29	SE NE	900		34.2	IS	Well 1, 8, R-4, R-U-452	8/10/2001
6	N	34	E	29	NE NW	900		39.1	IS	Well 1, 4, 8, U-452	8/10/2001	POA	6	N	34	E	29	NE NW	900		39.1	IS	Well 1, 8, R-4, R-U-452	8/10/2001
6	N	34	E	29	SW NW	900		14.0	IS	Well 1, 4, 8, U-452	8/10/2001	POA	6	N	34	E	29	SW NW	900		14.0	IS	Well 1, 8, R-4, R-U-452	8/10/2001
TOTAL ACRES:							SEE NEXT PAGE						TOTAL ACRES:							SEE NEXT PAGE				

If there is more than one POD/POA involved in the proposed changes, specify the acreage associated with each POD/POA.

Additional remarks: R-4 and R-U-452 are replacement wells.

RECEIVED

JUN 28 2021

Please use and attach additional pages of Table 2 as needed.
See page 6 for instructions.

Do you have questions about how to fill-out the tables?
Contact the Department at 503-986-0900 and ask for Transfer Staff.

AUTHORIZED (the "from" or "off" lands) The listing that appears on the certificate BEFORE PROPOSED CHANGES List only that part or portion of the water right that will be changed.											Proposed Changes (see "CODES" from previous page)	PROPOSED (the "to" or "on" lands) The listing as it would appear AFTER PROPOSED CHANGES are made.														
Twp	Rng	Sec	¼	¼	Tax Lot	Gvt Lot or DLC	Acres	Type of USE listed on Certificate	POD(s) or POA(s) (name or number from Table 1)	Priority Date		Twp	Rng	Sec	¼	¼	Tax Lot	Gvt Lot or DLC	Acres	New Type of USE	POD(s)/ POA(s) to be used (from Table 1)	Priority Date				
6	N	34	E	29	SE	NW	900		38.8	IS	Well 1, 4, 8, U-452	8/10/2001	POA	6	N	34	E	29	SE	NW	900		38.8	IS	Well 1, 8, R-4, R-U-452	8/10/2001
6	N	34	E	29	NE	SW	900 901		40.7	IS	Well 1, 4, 8, U-452	8/10/2001	POA	6	N	34	E	29	NE	SW	900 901		40.7	IS	Well 1, 8, R-4, R-U-452	8/10/2001
6	N	34	E	29	NW	SW	900 901		40.0	IS	Well 1, 4, 8, U-452	8/10/2001	POA	6	N	34	E	29	NW	SW	900 901		40.0	IS	Well 1, 8, R-4, R-U-452	8/10/2001
6	N	34	E	29	SW	SW	901		39.1	IS	Well 1, 4, 8, U-452	8/10/2001	POA	6	N	34	E	29	SW	SW	901		39.1	IS	Well 1, 8, R-4, R-U-452	8/10/2001
6	N	34	E	29	SE	SW	901		39.3	IS	Well 1, 4, 8, U-452	8/10/2001	POA	6	N	34	E	29	SE	SW	901		39.3	IS	Well 1, 8, R-4, R-U-452	8/10/2001
6	N	34	E	29	NE	SE	900 901		31.9	IS	Well 1, 4, 8, U-452	8/10/2001	POA	6	N	34	E	29	NE	SE	900 901		31.9	IS	Well 1, 8, R-4, R-U-452	8/10/2001
6	N	34	E	29	NW	SE	900 901		41.3	IS	Well 1, 4, 8, U-452	8/10/2001	POA	6	N	34	E	29	NW	SE	900 901		41.3	IS	Well 1, 8, R-4, R-U-452	8/10/2001
6	N	34	E	29	SW	SE	901		33.5	IS	Well 1, 4, 8, U-452	8/10/2001	POA	6	N	34	E	29	SW	SE	901		33.5	IS	Well 1, 8, R-4, R-U-452	8/10/2001
6	N	34	E	29	SE	SE	901		32.5	IS	Well 1, 4, 8, U-452	8/10/2001	POA	6	N	34	E	29	SE	SE	901		32.5	IS	Well 1, 8, R-4, R-U-452	8/10/2001
							(1197.8)	Total IS					POA								(1197.8)	TOTAL IS				
TOTAL ACRES:							1197.8						TOTAL ACRES:							1197.8						

Table 2. Description of Changes to Water Right Certificate # 95268

List the change proposed for the acreage in each ¼ ¼. If more than one change is proposed, specify the acreage associated with each change.

If there is more than one POD/POA involved in the proposed changes, specify the acreage associated with each POD/POA.

Additional remarks: R-4 and R-U-452 are replacement wells. Well 4 and Well U-452 will be decommissioned.

RECEIVED

JUN 28 2021

For Place of Use or Character of Use Changes

Are there other water right certificates, water use permits or ground water registrations associated with the "from" or the "to" lands? Yes No

If YES, list the certificate, water use permit, or ground water registration numbers: 42976, 66553, 83940, 83953, 87556, 93399.



Pursuant to ORS 540.510, any "layered" water use such as an irrigation right that is supplemental to a primary right proposed for transfer must be included in the transfer or be cancelled. Any change to a ground water registration must be filed separately in a ground water registration modification application.

For Substitution (ground water supplemental irrigation will be substituted for surface water primary irrigation)

Ground water supplemental Permit or Certificate # N/A;

Surface water primary Certificate # N/A.

For a change from Supplemental Irrigation Use to Primary Irrigation Use

Identify the primary certificate to be cancelled. Certificate # N/A

For a change in point(s) of appropriation (well(s)) or additional point(s) of appropriation:

- Well log(s) are attached for each authorized and proposed well(s) that are clearly labeled and associated with the corresponding well(s) in Table 1 above and on the accompanying application map.

Tip: You may search for well logs on the Department's web page at:

http://apps.wrd.state.or.us/apps/gw/well_log/Default.aspx

AND/OR

- Describe the construction of the authorized and proposed well(s) in Table 3 for any wells that do not have a well log. For *proposed wells not yet constructed or built*, provide "a best estimate" for each requested information element in the table. The Department recommends you consult a licensed well driller, geologist, or certified water right examiner to assist with assembling the information necessary to complete Table 3.

Table 3. Construction of Point(s) of Appropriation

Any well(s) in this listing must be clearly tied to corresponding well(s) described in Table 1 and shown on the accompanying application map. Failure to provide the information will delay the processing of your transfer application until it is received. The information is necessary for the department to assess whether the proposed well(s) will access the same source aquifer as the authorized point(s) of appropriation (POA). The Department is prohibited by law from approving POA changes that do not access the same source aquifer.

RECEIVED

JUN 28 2021

OWRD

Proposed or Authorized POA Name or Number	Is well already built? (Yes or No)	If an existing well: OWRD Well ID Tag No. L-	Total well depth	Casing Diameter	Casing Intervals (feet)	Seal depth(s) (intervals)	Perforated or screened intervals (in feet)	Static water level of completed well (in feet)	Source aquifer (sand, gravel, basalt, etc.)	Well-specific rate (cfs or gpm). If less than full rate of water right
Well 4	Yes	UMAT 53646	660' bgs	10-, 14-, and 16-inch	16" = +2-217' 14" = 150-495' 10" = 486-660'	Not on well log	150-495' and 567-623' bgs	Not on well log	Gravel alluvial	Not on well log
Well 8	Yes	UMAT 52007	423' bgs	10-, 12-, and 16-inch	12" = +2-348'	Not on well log	353-423' and 333-353' bgs	Not on well log	Gravel alluvial	Not on well log
Well U-452	Yes	UMAT 4627	231' bgs	12-inch	Not on well log	Not on well log	Not on well log	Not on well log	Gravel alluvial	Not on well log
Well 1	Yes	UMAT 4167	323' bgs	12-inch	0-160' bgs	Not on well log	Not on well log	Not on well log	Gravel alluvial	Not on well log
Replacement Well 4	No	N/A	660' bgs	16-14-inch	0-220 bgs	220-660'	Not known at this time	Not known at this time	Gravel alluvial	Not known at this time
Replacement Well U-452	No	N/A	250' bgs	12-inch	0-100' bgs	100-250'	Not known at this time	Not known at this time	Gravel alluvial	Not known at this time

RECEIVED

JUN 28 2021

OWRD

Application for Water Right Transfer

Evidence of Use Affidavit



Oregon Water Resources Department
 725 Summer Street NE, Suite A
 Salem, Oregon 97301-1266
 (503) 986-0900
 www.wrd.state.or.us

Please print legibly or type. Be as specific as possible. Attach additional pages if you need more spacing. Supporting documentation must be attached.

RECEIVED

JUN 28 2021

State of Oregon)
) ss
 County of UMATILLA)

OWRD

I, GRIFFIN MURPHY, in my capacity as FARM MANAGER,

mailing address PENDLETON LAND, LCC C/O ALTERNATIVE EQUITY ADVISORS, 12119 STRATFORD DRIVE, SUITE B, CLIVE, IOWA, 50325

telephone number (509)876-8633, being first duly sworn depose and say:

1. My knowledge of the exercise or status of the water right is based on (check one):

- Personal observation Professional expertise

2. I attest that:

Water was used during the previous five years on the **entire** place of use for Certificate # 30636, 42976, 89896, AND 95268; **OR**

My knowledge is specific to the use of water at the following locations within the last five years:

Certificate #	Township	Range	Mer	Sec	¼ ¼	Gov't Lot or DLC	Acres (if applicable)

OR

- Confirming Certificate # _____ has been issued within the past five years; **OR**
- Part or all of the water right was leased instream at some time within the last five years. The instream lease number is: _____ (Note: If the entire right proposed for transfer was not leased, additional evidence of use is needed for the portion not leased instream.); **OR**
- The water right is not subject to forfeiture and documentation that a presumption of forfeiture for non-use would be rebutted under ORS 540.610(2) is attached.
- Water has been used at the actual current point of diversion or appropriation for more than 10 years for Certificate # _____ (For Historic POD/POA Transfers)

(continues on reverse side)

3. The water right was used for: (e.g., crops, pasture, etc.): IRRIGATION FOR WHEAT, PINTO BEANS, BLACK BEANS, CORN FOR GRAIN, AND COVER CROPS

4. I understand that if I do not attach one or more of the documents shown in the table below to support the above statements, my application will be considered incomplete.

Justin M. [Signature]
Signature of Affiant

5/5/2021
Date

Signed and sworn to (or affirmed) before me this 5th day of May, 2021.

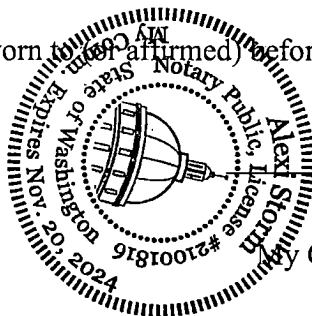

[Signature]
Notary Public for Oregon

Washington

Commission Expires: 11-20-2024

Supporting Documents	Examples
<input type="checkbox"/> Copy of a water right certificate that has been issued within the last five years. (not a remaining right certificate)	Copy of confirming water right certificate that shows issue date
<input checked="" type="checkbox"/> Copies of receipts from sales of irrigated crops or for expenditures related to use of water	<ul style="list-style-type: none"> • Power usage records for pumps associated with irrigation use • Fertilizer or seed bills related to irrigated crops • Farmers Co-op sales receipt
<input type="checkbox"/> Records such as FSA crop reports, irrigation district records, NRCS farm management plan, or records of other water suppliers	<ul style="list-style-type: none"> • District assessment records for water delivered • Crop reports submitted under a federal loan agreement • Beneficial use reports from district • IRS Farm Usage Deduction Report • Agricultural Stabilization Plan • CREP Report
<input type="checkbox"/> Aerial photos containing sufficient detail to establish location and date of photograph	<p>Multiple photos can be submitted to resolve different areas of a water right. If the photograph does not print with a "date stamp" or without the source being identified, the date of the photograph and source should be added.</p> <p>Sources for aerial photos: OSU – www.oregonexplorer.info/imagery OWRD – www.wrd.state.or.us Google Earth – earth.google.com TerraServer – www.terra-server.com</p>
<input type="checkbox"/> Approved Lease establishing beneficial use within the last 5 years	Copy of instream lease or lease number

RECEIVED

JUN 28 2021

RECEIVED

JUN 28 2021

COLUMBIA REA

Revision: 20602

OWRD

05/06/2021 8:30:14 am

USAGE HISTORY

Page: 1

Customer: [REDACTED] Name: CARBONDALE OPERATIONS LLC
Account: [REDACTED] Cycle: 1
Service: ELEC Provider: CREA

Revenue Class: 3
Srv Loc Nbr: [REDACTED]

Service Status: 1
Substation: S

Table with 15 columns: Rate, Year, Jan, Feb, Mar, Apr, May, Jun, Jul, Aug, Sep, Oct, Nov, Dec, Total. Rows for rates 450 and 4502 for years 2020 and 2021.

Customer: [REDACTED] Name: CARBONDALE OPERATIONS LLC
Account: [REDACTED] Cycle: 1
Service: ELEC Provider: CREA

Revenue Class: 3
Srv Loc Nbr: [REDACTED]

Service Status: 1
Substation: S

Table with 15 columns: Rate, Year, Jan, Feb, Mar, Apr, May, Jun, Jul, Aug, Sep, Oct, Nov, Dec, Total. Rows for rates 450 and 4502 for years 2020 and 2021.

Customer: [REDACTED] Name: CARBONDALE OPERATIONS LLC
Account: [REDACTED] Cycle: 1
Service: ELEC Provider: CREA

Revenue Class: 3
Srv Loc Nbr: [REDACTED]

Service Status: 1
Substation: S

Table with 15 columns: Rate, Year, Jan, Feb, Mar, Apr, May, Jun, Jul, Aug, Sep, Oct, Nov, Dec, Total. Rows for rates 430 and 430 for years 2020 and 2021.

Customer: [REDACTED] Name: CARBONDALE OPERATIONS LLC
Account: [REDACTED] Cycle: 1
Service: ELEC Provider: CREA

Revenue Class: 3
Srv Loc Nbr: [REDACTED]

Service Status: 1
Substation: S

Table with 15 columns: Rate, Year, Jan, Feb, Mar, Apr, May, Jun, Jul, Aug, Sep, Oct, Nov, Dec, Total. Rows for rates 430 and 430 for years 2020 and 2021.

Customer: [REDACTED] Name: CARBONDALE OPERATIONS LLC
Account: [REDACTED] Cycle: 1
Service: ELEC Provider: CREA

Revenue Class: 3
Srv Loc Nbr: [REDACTED]

Service Status: 43
Substation: S

Table with 15 columns: Rate, Year, Jan, Feb, Mar, Apr, May, Jun, Jul, Aug, Sep, Oct, Nov, Dec, Total. Rows for rates 430 and 430 for years 2020 and 2021.

RECEIVED

JUN 28 2021

COLUMBIA REA

Revision: 20602

05/06/2021 8:30:14 am

USAGE HISTORY

OWRD

Page: 2

Customer: [REDACTED] Name: CARBONDALE OPERATIONS LLC
Account: [REDACTED] Cycle: 1
Service: ELEC Provider: CREA

Revenue Class: 3
Srv Loc Nbr: [REDACTED]

Service Status: 43
Substation: S

Table with 14 columns: Rate, Year, Jan, Feb, Mar, Apr, May, Jun, Jul, Aug, Sep, Oct, Nov, Dec, Total. Row 1: 420, 2020, 0, 0, 0, 1, 374, 0, 0, 0, 0, 0, 0, 375

Customer: [REDACTED] Name: CARBONDALE OPERATIONS LLC
Account: [REDACTED] Cycle: 1
Service: ELEC Provider: CREA

Revenue Class: 3
Srv Loc Nbr: [REDACTED]

Service Status: 41
Substation: S

Table with 14 columns: Rate, Year, Jan, Feb, Mar, Apr, May, Jun, Jul, Aug, Sep, Oct, Nov, Dec, Total. Row 1: 420, 2020, 0, 0, 0, 0, 0, 0, 0, 0, 0, 0, 0, 0

Customer: [REDACTED] Name: CARBONDALE OPERATIONS LLC
Account: [REDACTED] Cycle: 1
Service: ELEC Provider: CREA

Revenue Class: 3
Srv Loc Nbr: [REDACTED]

Service Status: 41
Substation: S

Table with 14 columns: Rate, Year, Jan, Feb, Mar, Apr, May, Jun, Jul, Aug, Sep, Oct, Nov, Dec, Total. Row 1: 430, 2020, 0, 0, 0, 0, 0, 0, 0, 0, 0, 0, 0, 0

Customer: [REDACTED] Name: CARBONDALE OPERATIONS LLC
Account: [REDACTED] Cycle: 1
Service: ELEC Provider: CREA

Revenue Class: 3
Srv Loc Nbr: [REDACTED]

Service Status: 41
Substation: S

Table with 14 columns: Rate, Year, Jan, Feb, Mar, Apr, May, Jun, Jul, Aug, Sep, Oct, Nov, Dec, Total. Row 1: 430, 2020, 0, 0, 0, 0, 0, 0, 0, 0, 0, 0, 0, 0

Customer: [REDACTED] Name: CARBONDALE OPERATIONS LLC
Account: [REDACTED] Cycle: 1
Service: ELEC Provider: CREA

Revenue Class: 5
Srv Loc Nbr: [REDACTED]

Service Status: 1
Substation: S

Table with 14 columns: Rate, Year, Jan, Feb, Mar, Apr, May, Jun, Jul, Aug, Sep, Oct, Nov, Dec, Total. Row 1: 132, 2020, 0, 0, 0, 304, 378, 312, 267, 266, 234, 258, 135, 124, 2,278. Row 2: 132, 2021, 141, 173, 171, 355, 0, 0, 0, 0, 0, 0, 0, 0, 840

Customer: [REDACTED] Name: CARBONDALE OPERATIONS LLC
Account: [REDACTED] Cycle: 1
Service: ELEC Provider: CREA

Revenue Class: 1
Srv Loc Nbr: [REDACTED]

Service Status: 1
Substation: S

Table with 14 columns: Rate, Year, Jan, Feb, Mar, Apr, May, Jun, Jul, Aug, Sep, Oct, Nov, Dec, Total. Row 1: 110, 2020, 0, 0, 0, 0, 0, 0, 0, 1,437, 1,001, 1,782, 2,533, 3,535, 10,288

RECEIVED

JUN 28 2021

COLUMBIA REA

Revision: 20602

USAGE HISTORY

OWRD

Page: 3

05/06/2021 8:30:14 am

Customer: [REDACTED] Name: CARBONDALE OPERATIONS LLC
Account: [REDACTED] Cycle: 1
Service: ELEC Provider: CREA

Revenue Class: 1
Srv Loc Nbr: [REDACTED]

Service Status: 1
Substation: S

Table with 14 columns: Rate, Year, Jan, Feb, Mar, Apr, May, Jun, Jul, Aug, Sep, Oct, Nov, Dec, Total. Row 1: 110, 2021, 3,162, 3,414, 2,500, 1,795, 0, 0, 0, 0, 0, 0, 0, 10,871

Customer: [REDACTED] Name: CARBONDALE OPERATIONS LLC
Account: [REDACTED] Cycle: 1
Service: ELEC Provider: CREA

Revenue Class: 1
Srv Loc Nbr: [REDACTED]

Service Status: 1
Substation: S

Table with 14 columns: Rate, Year, Jan, Feb, Mar, Apr, May, Jun, Jul, Aug, Sep, Oct, Nov, Dec, Total. Row 1: 110, 2020, 0, 0, 0, 1,750, 1,187, 743, 591, 613, 683, 1,907, 3,094, 3,670, 14,238. Row 2: 110, 2021, 3,346, 3,610, 2,836, 1,622, 0, 0, 0, 0, 0, 0, 0, 11,414

Customer: [REDACTED] Name: CARBONDALE OPERATIONS LLC
Account: [REDACTED] Cycle: 1
Service: ELEC Provider: CREA

Revenue Class: 5
Srv Loc Nbr: [REDACTED]

Service Status: 43
Substation: S

Table with 14 columns: Rate, Year, Jan, Feb, Mar, Apr, May, Jun, Jul, Aug, Sep, Oct, Nov, Dec, Total. Row 1: 132, 2020, 0, 0, 0, 0, 0, 0, 0, 0, 0, 0, 0, 0. Row 2: 132, 2021, 0, 0, 0, 0, 0, 0, 0, 0, 0, 0, 0, 0

Customer: [REDACTED] Name: CARBONDALE OPERATIONS LLC
Account: [REDACTED] Cycle: 1
Service: ELEC Provider: CREA

Revenue Class: 5
Srv Loc Nbr: [REDACTED]

Service Status: 1
Substation: S

Table with 14 columns: Rate, Year, Jan, Feb, Mar, Apr, May, Jun, Jul, Aug, Sep, Oct, Nov, Dec, Total. Row 1: 130, 2020, 0, 0, 0, 119, 110, 153, 105, 125, 99, 82, 354, 1,085, 2,232. Row 2: 130, 2021, 1,179, 33, 42, 44, 0, 0, 0, 0, 0, 0, 0, 1,298

Customer: [REDACTED] Name: CARBONDALE OPERATIONS LLC
Account: [REDACTED] Cycle: 1
Service: ELEC Provider: CREA

Revenue Class: 3
Srv Loc Nbr: [REDACTED]

Service Status: 43
Substation: S

Table with 14 columns: Rate, Year, Jan, Feb, Mar, Apr, May, Jun, Jul, Aug, Sep, Oct, Nov, Dec, Total. Row 1: 420, 2020, 0, 0, 0, 276, 16, 325, 2, 0, 0, 0, 0, 0, 619

Customer: [REDACTED] Name: CARBONDALE OPERATIONS LLC
Account: [REDACTED] Cycle: 1
Service: ELEC Provider: CREA

Revenue Class: 3
Srv Loc Nbr: [REDACTED]

Service Status: 1
Substation: S

Table with 14 columns: Rate, Year, Jan, Feb, Mar, Apr, May, Jun, Jul, Aug, Sep, Oct, Nov, Dec, Total. Row 1: 420, 2020, 0, 0, 0, 276, 16, 325, 2, 0, 0, 0, 0, 0, 619

05/06/2021	8:30:14 am	USAGE HISTORY	Page: 4
------------	------------	----------------------	---------

Customer: [REDACTED] Name: CARBONDALE OPERATIONS LLC
 Account: [REDACTED] Cycle: 1 Revenue Class: 3 Service Status: 1
 Service: ELEC Provider: CREA Srv Loc Nbr: [REDACTED] Substation: S

Rate	Year	Jan	Feb	Mar	Apr	May	Jun	Jul	Aug	Sep	Oct	Nov	Dec	Total
430	2020	0	0	0	9,527	5,232	9,534	4,650	32	296	18	1,178	52	30,519
430	2021	51	46	73	10,612	0	0	0	0	0	0	0	0	10,782

Customer: [REDACTED] Name: CARBONDALE OPERATIONS LLC
 Account: [REDACTED] Cycle: 1 Revenue Class: 5 Service Status: 43
 Service: ELEC Provider: CREA Srv Loc Nbr: [REDACTED] Substation: S

Rate	Year	Jan	Feb	Mar	Apr	May	Jun	Jul	Aug	Sep	Oct	Nov	Dec	Total
330	2020	0	0	0	400	140	160	160	160	140	140	120	120	1,540
330	2021	40	0	0	0	0	0	0	0	0	0	0	0	40

Customer: [REDACTED] Name: CARBONDALE OPERATIONS LLC
 Account: [REDACTED] Cycle: 1 Revenue Class: 5 Service Status: 43
 Service: ELEC Provider: CREA Srv Loc Nbr: [REDACTED] Substation: S

Rate	Year	Jan	Feb	Mar	Apr	May	Jun	Jul	Aug	Sep	Oct	Nov	Dec	Total
332	2020	0	0	0	0	0	0	0	0	0	0	0	0	0
332	2021	0	0	0	0	0	0	0	0	0	0	0	0	0

Customer: [REDACTED] Name: CARBONDALE OPERATIONS LLC
 Account: [REDACTED] Cycle: 1 Revenue Class: 3 Service Status: 1
 Service: ELEC Provider: CREA Srv Loc Nbr: [REDACTED] Substation: S

Rate	Year	Jan	Feb	Mar	Apr	May	Jun	Jul	Aug	Sep	Oct	Nov	Dec	Total
440	2020	0	0	0	231	20	147	17	146	5,141	19	18	20	5,759
440	2021	19	17	47	20,531	0	0	0	0	0	0	0	0	20,614

Customer: [REDACTED] Name: CARBONDALE OPERATIONS LLC
 Account: [REDACTED] Cycle: 1 Revenue Class: 3 Service Status: 43
 Service: ELEC Provider: CREA Srv Loc Nbr: [REDACTED] Substation: S

Rate	Year	Jan	Feb	Mar	Apr	May	Jun	Jul	Aug	Sep	Oct	Nov	Dec	Total
420	2020	0	0	0	0	0	0	0	0	0	0	0	0	0

Customer: [REDACTED] Name: CARBONDALE OPERATIONS LLC
 Account: [REDACTED] Cycle: 1 Revenue Class: 3 Service Status: 1
 Service: ELEC Provider: CREA Srv Loc Nbr: 3729 Substation: S

RECEIVED

JUN 28 2021

COLUMBIA REA

Revision: 20602

OWRD

USAGE HISTORY

05/06/2021 8:30:14 am

Page: 5

Rate	Year	Jan	Feb	Mar	Apr	May	Jun	Jul	Aug	Sep	Oct	Nov	Dec	Total
430	2020	0	0	0	3,907	2,545	13,131	11,100	2,424	3,619	16	0	0	36,742
430	2021	0	0	0	1	0	0	0	0	0	0	0	0	1

Customer: [REDACTED] Name: CARBONDALE OPERATIONS LLC
 Account: [REDACTED] Cycle: 1
 Service: ELEC Provider: CREA

Revenue Class: 3
 Srv Loc Nbr: [REDACTED] Service Status: 6
 Substation: S

Rate	Year	Jan	Feb	Mar	Apr	May	Jun	Jul	Aug	Sep	Oct	Nov	Dec	Total
430	2020	0	0	0	0	0	0	0	0	0	0	0	0	0
430	2021	0	0	0	0	0	0	0	0	0	0	0	0	0

Customer: [REDACTED] Name: CARBONDALE OPERATIONS LLC
 Account: [REDACTED] Cycle: 1
 Service: ELEC Provider: CREA

Revenue Class: 3
 Srv Loc Nbr: [REDACTED] Service Status: 1
 Substation: S

Rate	Year	Jan	Feb	Mar	Apr	May	Jun	Jul	Aug	Sep	Oct	Nov	Dec	Total
430	2020	0	0	0	91	367	1,951	13,858	7,640	15,373	92	43	44	39,459
430	2021	43	40	43	35	0	0	0	0	0	0	0	0	161

Customer: [REDACTED] Name: CARBONDALE OPERATIONS LLC
 Account: [REDACTED] Cycle: 1
 Service: ELEC Provider: CREA

Revenue Class: 5
 Srv Loc Nbr: [REDACTED] Service Status: 1
 Substation: S

Rate	Year	Jan	Feb	Mar	Apr	May	Jun	Jul	Aug	Sep	Oct	Nov	Dec	Total
130	2020	0	0	0	3,840	3,320	2,920	3,040	2,760	2,240	2,640	4,480	5,240	30,480
130	2021	5,200	5,280	4,320	3,280	0	0	0	0	0	0	0	0	18,080

Customer: [REDACTED] Name: CARBONDALE OPERATIONS LLC
 Account: [REDACTED] Cycle: 1
 Service: ELEC Provider: CREA

Revenue Class: 5
 Srv Loc Nbr: [REDACTED] Service Status: 1
 Substation: S

Rate	Year	Jan	Feb	Mar	Apr	May	Jun	Jul	Aug	Sep	Oct	Nov	Dec	Total
132	2020	0	0	0	50	43	40	37	43	48	54	63	64	442
132	2021	27	5	5	3	0	0	0	0	0	0	0	0	40

Customer: [REDACTED] Name: CARBONDALE OPERATIONS LLC
 Account: [REDACTED] Cycle: 1
 Service: ELEC Provider: CREA

Revenue Class: 3
 Srv Loc Nbr: [REDACTED] Service Status: 1
 Substation: S

Rate	Year	Jan	Feb	Mar	Apr	May	Jun	Jul	Aug	Sep	Oct	Nov	Dec	Total
430	2020	0	0	0	68	99	1,609	8,836	2,888	5,346	1,780	4,471	122	25,219

RECEIVED

JUN 28 2021

COLUMBIA REA

Revision: 20602

05/06/2021 8:30:14 am

USAGE HISTORY

OWRD

Page: 6

Customer: [REDACTED] Name: CARBONDALE OPERATIONS LLC
Account: [REDACTED] Cycle: 1
Service: ELEC Provider: CREA

Revenue Class: 3
Srv Loc Nbr: [REDACTED]
Service Status: 1
Substation: S

Table with 14 columns: Rate, Year, Jan, Feb, Mar, Apr, May, Jun, Jul, Aug, Sep, Oct, Nov, Dec, Total. Row 1: 430, 2021, 69, 60, 37, 305, 0, 0, 0, 0, 0, 0, 0, 471

Customer: [REDACTED] Name: CARBONDALE OPERATIONS LLC
Account: [REDACTED] Cycle: 1
Service: ELEC Provider: CREA

Revenue Class: 3
Srv Loc Nbr: [REDACTED]
Service Status: 41
Substation: S

Table with 14 columns: Rate, Year, Jan, Feb, Mar, Apr, May, Jun, Jul, Aug, Sep, Oct, Nov, Dec, Total. Row 1: 430, 2020, 0, 0, 0, 0, 0, 0, 0, 0, 0, 0, 0, 0

Customer: [REDACTED] Name: CARBONDALE OPERATIONS LLC
Account: [REDACTED] Cycle: 1
Service: ELEC Provider: CREA

Revenue Class: 3
Srv Loc Nbr: [REDACTED]
Service Status: 41
Substation: S

Table with 14 columns: Rate, Year, Jan, Feb, Mar, Apr, May, Jun, Jul, Aug, Sep, Oct, Nov, Dec, Total. Row 1: 430, 2020, 0, 0, 0, 0, 0, 0, 0, 0, 0, 0, 0, 0

Customer: [REDACTED] Name: CARBONDALE OPERATIONS LLC
Account: [REDACTED] Cycle: 1
Service: ELEC Provider: CREA

Revenue Class: 3
Srv Loc Nbr: [REDACTED]
Service Status: 41
Substation: S

Table with 14 columns: Rate, Year, Jan, Feb, Mar, Apr, May, Jun, Jul, Aug, Sep, Oct, Nov, Dec, Total. Row 1: 420, 2020, 0, 0, 0, 0, 0, 0, 0, 0, 0, 0, 0, 0

Customer: [REDACTED] Name: CARBONDALE OPERATIONS LLC
Account: [REDACTED] Cycle: 1
Service: ELEC Provider: CREA

Revenue Class: 5
Srv Loc Nbr: [REDACTED]
Service Status: 41
Substation: S

Table with 14 columns: Rate, Year, Jan, Feb, Mar, Apr, May, Jun, Jul, Aug, Sep, Oct, Nov, Dec, Total. Row 1: 332, 2020, 0, 0, 0, 0, 0, 0, 0, 0, 0, 0, 0, 0

Customer: [REDACTED] Name: CARBONDALE OPERATIONS LLC
Account: [REDACTED] Cycle: 1
Service: ELEC Provider: CREA

Revenue Class: 4
Srv Loc Nbr: [REDACTED]
Service Status: 1
Substation: S

Table with 14 columns: Rate, Year, Jan, Feb, Mar, Apr, May, Jun, Jul, Aug, Sep, Oct, Nov, Dec, Total. Row 1: 450, 2020, 0, 0, 0, 7,640, 10,600, 23,280, 11,400, 0, 0, 0, 26,840, 0, 79,760. Row 2: 450, 2021, 0, 0, 0, 0, 0, 0, 0, 0, 0, 0, 0, 0, 0

RECEIVED

JUN 28 2021

COLUMBIA REA

Revision: 20602

05/06/2021 8:30:14 am

USAGE HISTORY

OWRD

Page: 7

Customer: [REDACTED] Name: CARBONDALE OPERATIONS LLC
Account: [REDACTED] Cycle: 1
Service: ELEC Provider: CREA

Revenue Class: 4
Srv Loc Nbr: [REDACTED]

Service Status: 1
Substation: S

Table with 14 columns: Rate, Year, Jan, Feb, Mar, Apr, May, Jun, Jul, Aug, Sep, Oct, Nov, Dec, Total. Rows for rates 510 and 5102 in 2021.

Customer: [REDACTED] Name: CARBONDALE OPERATIONS LLC
Account: [REDACTED] Cycle: 1
Service: ELEC Provider: CREA

Revenue Class: 3
Srv Loc Nbr: [REDACTED]

Service Status: 43
Substation: S

Table with 14 columns: Rate, Year, Jan, Feb, Mar, Apr, May, Jun, Jul, Aug, Sep, Oct, Nov, Dec, Total. Rows for rates 450 in 2020 and 2021.

Customer: [REDACTED] Name: CARBONDALE OPERATIONS LLC
Account: [REDACTED] Cycle: 1
Service: ELEC Provider: CREA

Revenue Class: 3
Srv Loc Nbr: [REDACTED]

Service Status: 43
Substation: S

Table with 14 columns: Rate, Year, Jan, Feb, Mar, Apr, May, Jun, Jul, Aug, Sep, Oct, Nov, Dec, Total. Rows for rates 420 in 2020 and 2021.

Customer: [REDACTED] Name: CARBONDALE OPERATIONS LLC
Account: [REDACTED] Cycle: 1
Service: ELEC Provider: CREA

Revenue Class: 3
Srv Loc Nbr: [REDACTED]

Service Status: 43
Substation: S

Table with 14 columns: Rate, Year, Jan, Feb, Mar, Apr, May, Jun, Jul, Aug, Sep, Oct, Nov, Dec, Total. Rows for rates 420 in 2020 and 2021.

Customer: [REDACTED] Name: CARBONDALE OPERATIONS LLC
Account: [REDACTED] Cycle: 1
Service: ELEC Provider: CREA

Revenue Class: 3
Srv Loc Nbr: [REDACTED]

Service Status: 41
Substation: S

Table with 14 columns: Rate, Year, Jan, Feb, Mar, Apr, May, Jun, Jul, Aug, Sep, Oct, Nov, Dec, Total. Row for rate 430 in 2020.

RECEIVED

JUN 28 2021

COLUMBIA REA

Revision: 20602

USAGE HISTORY

OWRD

Page: 8

05/06/2021 8:30:14 am

Customer: [REDACTED] Name: CARBONDALE OPERATIONS LLC
Account: [REDACTED] Cycle: 1
Service: ELEC Provider: CREA

Revenue Class: 3 Service Status: 41
Srv Loc Nbr: [REDACTED] Substation: S

Table with 14 columns: Rate, Year, Jan, Feb, Mar, Apr, May, Jun, Jul, Aug, Sep, Oct, Nov, Dec, Total. Row 1: 430, 2020, 0, 0, 0, 0, 0, 0, 0, 0, 0, 0, 0, 0.

Customer: [REDACTED] Name: CARBONDALE OPERATIONS LLC
Account: [REDACTED] Cycle: 1
Service: ELEC Provider: CREA

Revenue Class: 3 Service Status: 1
Srv Loc Nbr: [REDACTED] Substation: S

Table with 14 columns: Rate, Year, Jan, Feb, Mar, Apr, May, Jun, Jul, Aug, Sep, Oct, Nov, Dec, Total. Row 1: 440, 2020, 0, 0, 0, 1,399, 565, 2,641, 7,764, 5,532, 2,871, 1,743, 74, 103, 22,692. Row 2: 440, 2021, 90, 113, 127, 1,275, 0, 0, 0, 0, 0, 0, 0, 0, 1,605.

Customer: [REDACTED] Name: CARBONDALE OPERATIONS LLC
Account: [REDACTED] Cycle: 1
Service: ELEC Provider: CREA

Revenue Class: 3 Service Status: 1
Srv Loc Nbr: [REDACTED] Substation: S

Table with 14 columns: Rate, Year, Jan, Feb, Mar, Apr, May, Jun, Jul, Aug, Sep, Oct, Nov, Dec, Total. Row 1: 440, 2020, 0, 0, 0, 0, 0, 0, 40, 0, 0, 0, 0, 0, 40. Row 2: 440, 2021, 0, 0, 0, 40, 0, 0, 0, 0, 0, 0, 0, 0, 40.

Customer: [REDACTED] Name: CARBONDALE OPERATIONS LLC
Account: [REDACTED] Cycle: 1
Service: ELEC Provider: CREA

Revenue Class: 3 Service Status: 1
Srv Loc Nbr: [REDACTED] Substation: S

Table with 14 columns: Rate, Year, Jan, Feb, Mar, Apr, May, Jun, Jul, Aug, Sep, Oct, Nov, Dec, Total. Row 1: 430, 2020, 0, 0, 0, 1,403, 6,281, 8,457, 5,804, 876, 991, 41, 259, 53, 24,165. Row 2: 430, 2021, 38, 35, 538, 3,529, 0, 0, 0, 0, 0, 0, 0, 0, 4,140.

Customer: [REDACTED] Name: CARBONDALE OPERATIONS LLC
Account: [REDACTED] Cycle: 1
Service: ELEC Provider: CREA

Revenue Class: 5 Service Status: 1
Srv Loc Nbr: [REDACTED] Substation: S

Table with 14 columns: Rate, Year, Jan, Feb, Mar, Apr, May, Jun, Jul, Aug, Sep, Oct, Nov, Dec, Total. Row 1: 380, 2020, 0, 0, 0, 30, 79, 17, 256, 175, 26, 18, 40, 19, 660. Row 2: 380, 2021, 18, 16, 18, 34, 0, 0, 0, 0, 0, 0, 0, 0, 86.

Grand Totals table with 14 columns: Jan, Feb, Mar, Apr, May, Jun, Jul, Aug, Sep, Oct, Nov, Dec, Total. Values: 13,737, 13,098, 10,896, 162,308, 55,104, 83,999, 137,946, 91,310, 94,200, 28,896, 45,945, 14,453, 751,892.

05/06/2021 8:30:14 am

USAGE HISTORY

Page: 9

RECEIVED

JUN 28 2021

OWRD

05/06/2021 8:30:14 am

USAGE HISTORY

Page: 10

PARAMETERS ENTERED:

Format: Detail
Primary Group: None
Customer Number: ██████████
Account Number: 0
Months of History: 13
Include DVC Usage: No
Service: All
Provider: All
Service Status: All
Rate Schedule: All
Billing Cycle: All
Revenue Class: All
Substation: All
Register Mode: All

RECEIVED

JUN 28 2021

OWRD

RECEIVED

JUN 28 2021

OWRD

Attachment #3

Land Use Information Form

POA Transfer Application for Certificates 30636, 42976, 89896, 95268

Land Use Information Form

RECEIVED

JUN 28 2021



Oregon Water Resources Department
725 Summer Street NE, Suite A
Salem, Oregon 97301-1266
(503) 986-0900
www.wrd.state.or.us

OWRD

Applicant(s): Pendleton Land, LLC, Dave Muth

Mailing Address: 12119 Stratford Drive, Suite B c/o Alternative Equity Advisors

City: Clive

State: Iowa

Zip Code: 50325

Daytime Phone: 515-222-1347

A. Land and Location

Please include the following information for all tax lots where water will be diverted (taken from its source), conveyed (transported), and/or used or developed. Applicants for municipal use, or irrigation uses within irrigation districts may substitute existing and proposed service-area boundaries for the tax-lot information requested below.

Township	Range	Section	¼ ¼	Tax Lot #	Plan Designation (e.g., Rural Residential/RR-5)	Water to be:			Proposed Land Use:
<u>6N</u>	<u>34E</u>	<u>26, 27, 35</u>	<u>Many, see map</u>	<u>2701, 2702</u>	<u>EFU</u>	<input checked="" type="checkbox"/> Diverted	<input checked="" type="checkbox"/> Conveyed	<input checked="" type="checkbox"/> Used	<u>Irrigation</u>
<u>6N</u>	<u>34E</u>	<u>21</u>	<u>SW 1/4</u>	<u>1000</u>	<u>EFU</u>	<input checked="" type="checkbox"/> Diverted	<input checked="" type="checkbox"/> Conveyed	<input checked="" type="checkbox"/> Used	<u>Irrigation</u>
<u>6N</u>	<u>34E</u>	<u>22, 23, 26, 27, 35</u>	<u>Many, see map</u>	<u>1700, 1800, 2701, 2702</u>	<u>EFU</u>	<input checked="" type="checkbox"/> Diverted	<input checked="" type="checkbox"/> Conveyed	<input checked="" type="checkbox"/> Used	<u>Irrigation</u>
<u>6N</u>	<u>34E</u>	<u>20, 21, 28, 29</u>	<u>Many, see map</u>	<u>900, 901, 902, 903, 1000, 3600</u>	<u>EFU</u>	<input checked="" type="checkbox"/> Diverted	<input checked="" type="checkbox"/> Conveyed	<input checked="" type="checkbox"/> Used	<u>Irrigation</u>

List all counties and cities where water is proposed to be diverted, conveyed, and/or used or developed:

Umatilla County

B. Description of Proposed Use

Type of application to be filed with the Water Resources Department:

- Permit to Use or Store Water
 Water Right Transfer
 Permit Amendment or Ground Water Registration Modification
 Limited Water Use License
 Allocation of Conserved Water
 Exchange of Water

Source of water: Reservoir/Pond Ground Water Surface Water (name) _____

Estimated quantity of water needed: 15.77 cubic feet per second gallons per minute acre-feet

Intended use of water: Irrigation Commercial Industrial Domestic for _____ household(s)
 Municipal Quasi-Municipal Instream Other _____

Briefly describe:

Replacing three old wells to water rights (Certificates 30636, 42976, 89896, and 95268) with three new ones for better efficiency in distribution and use of the resource.

JUN 28 2021

For Local Government Use Only

OWRD

The following section must be completed by a planning official from each county and city listed unless the project will be located entirely within the city limits. In that case, only the city planning agency must complete this form. This deals only with the local land-use plan. Do not include approval for activities such as building or grading permits.

Please check the appropriate box below and provide the requested information

Land uses to be served by the proposed water uses (including proposed construction) are allowed outright or are not regulated by your comprehensive plan. Cite applicable ordinance section(s): UCDC Section 15A.054(A)

Land uses to be served by the proposed water uses (including proposed construction) involve discretionary land-use approvals as listed in the table below. (Please attach documentation of applicable land-use approvals which have already been obtained. Record of Action/land-use decision and accompanying findings are sufficient.) **If approvals have been obtained but all appeal periods have not ended, check "Being pursued."**

Type of Land-Use Approval Needed (c.g., plan amendments, rezones, conditional-use permits, etc.)	Cite Most Significant, Applicable Plan Policies & Ordinance Section References	Land-Use Approval:	
		<input type="checkbox"/> Obtained <input type="checkbox"/> Denied	<input type="checkbox"/> Being Pursued <input type="checkbox"/> Not Being Pursued
		<input type="checkbox"/> Obtained <input type="checkbox"/> Denied	<input type="checkbox"/> Being Pursued <input type="checkbox"/> Not Being Pursued
		<input type="checkbox"/> Obtained <input type="checkbox"/> Denied	<input type="checkbox"/> Being Pursued <input type="checkbox"/> Not Being Pursued
		<input type="checkbox"/> Obtained <input type="checkbox"/> Denied	<input type="checkbox"/> Being Pursued <input type="checkbox"/> Not Being Pursued
		<input type="checkbox"/> Obtained <input type="checkbox"/> Denied	<input type="checkbox"/> Being Pursued <input type="checkbox"/> Not Being Pursued
		<input type="checkbox"/> Obtained <input type="checkbox"/> Denied	<input type="checkbox"/> Being Pursued <input type="checkbox"/> Not Being Pursued

Local governments are invited to express special land-use concerns or make recommendations to the Water Resources Department regarding this proposed use of water below, or on a separate sheet.

Name: CAROL JOHNSON Title: Planner

Signature: *Carol Johnson* Phone: 541-278-6252 Date: 04/26/2021

Government Entity: Umatilla County

Note to local government representative: Please complete this form or sign the receipt below and return it to the applicant. If you sign the receipt, you will have 30 days from the Water Resources Department's notice date to return the completed Land Use Information Form or WRD may presume the land use associated with the proposed use of water is compatible with local comprehensive plans.

Receipt for Request for Land Use Information

Applicant name: _____

City or County: _____ Staff contact: _____

Signature: _____ Phone: _____ Date: _____

RECEIVED

JUN 28 2021

OWRD

Attachment #4

Certificates and FPS Maps

POA Transfer Application for Certificates 30636, 42976, 89896, 95268

STATE OF OREGON
 COUNTY OF UMATILLA

RECEIVED
 JUN 28 2021

CERTIFICATE OF WATER RIGHT

OWRD

This Is to Certify, That DOROTHY KELLY COCKBURN

of Route 2, Box 109, Milton-Freewater, State of Oregon, has made proof to the satisfaction of the STATE ENGINEER of Oregon, of a right to the use of the waters of a well

a tributary of Pine Creek (Walla Walla River) for the purpose of irrigation of 65.8 acres and supplemental irrigation of 254.1 acres under Permit No. U-269 of the State Engineer, and that said right to the use of said waters has been perfected in accordance with the laws of Oregon; that the priority of the right hereby confirmed dates from March 7, 1949,

that the amount of water to which such right is entitled and hereby confirmed, for the purposes aforesaid, is limited to an amount actually beneficially used for said purposes, and shall not exceed 3.79 cubic feet per second

or its equivalent in case of rotation, measured at the point of diversion from the stream. The point of diversion is located in the NW $\frac{1}{4}$ NE $\frac{1}{4}$, Section 35, T. 6 N., R. 34 E., W. M. Well located 11 chains South and $\frac{1}{4}$ chain East from NW corner, Section 35.

The amount of water used for irrigation, together with the amount secured under any other right existing for the same lands, shall be limited to one-eightieth of one cubic foot per second per acre, or its equivalent for each acre irrigated and shall be further limited to a diversion of not to exceed 3 acre feet per acre for each acre irrigated during the irrigation season of each year,

and shall conform to such reasonable rotation system as may be ordered by the proper state officer.

A description of the place of use under the right hereby confirmed, and to which such right is appurtenant, is as follows:

	Supplemental	Primary
NE $\frac{1}{4}$ NW $\frac{1}{4}$	18.9 acres	14.3 acres
NW $\frac{1}{4}$ NW $\frac{1}{4}$	35.8 acres	3.8 acres
SW $\frac{1}{4}$ NW $\frac{1}{4}$	24.5 acres	4.7 acres
SE $\frac{1}{4}$ NW $\frac{1}{4}$	12.0 acres	20.9 acres
NE $\frac{1}{4}$ SW $\frac{1}{4}$	7.0 acres	8.2 acres
NW $\frac{1}{4}$ SW $\frac{1}{4}$	36.8 acres	
SW $\frac{1}{4}$ SW $\frac{1}{4}$	36.5 acres	0.5 acre
SE $\frac{1}{4}$ SW $\frac{1}{4}$		3.4 acres
Section 26		
NE $\frac{1}{4}$ NE $\frac{1}{4}$	35.8 acres	
SE $\frac{1}{4}$ NE $\frac{1}{4}$	34.7 acres	3.7 acres
Section 27		
NW $\frac{1}{4}$ NW $\frac{1}{4}$	12.1 acres	6.3 acres
Section 35		
T. 6 N., R. 34 E., W. M.		

The right to the use of the water for the purposes aforesaid is restricted to the lands or place of use herein described.

WITNESS the signature of the State Engineer, affixed

this date. FEBRUARY 8 1963

CHRIS L. WHEELER

State Engineer

A-269
C-30636

T.6N.R.34E.W.M.

RECEIVED

JUN 28 2021

OWRD

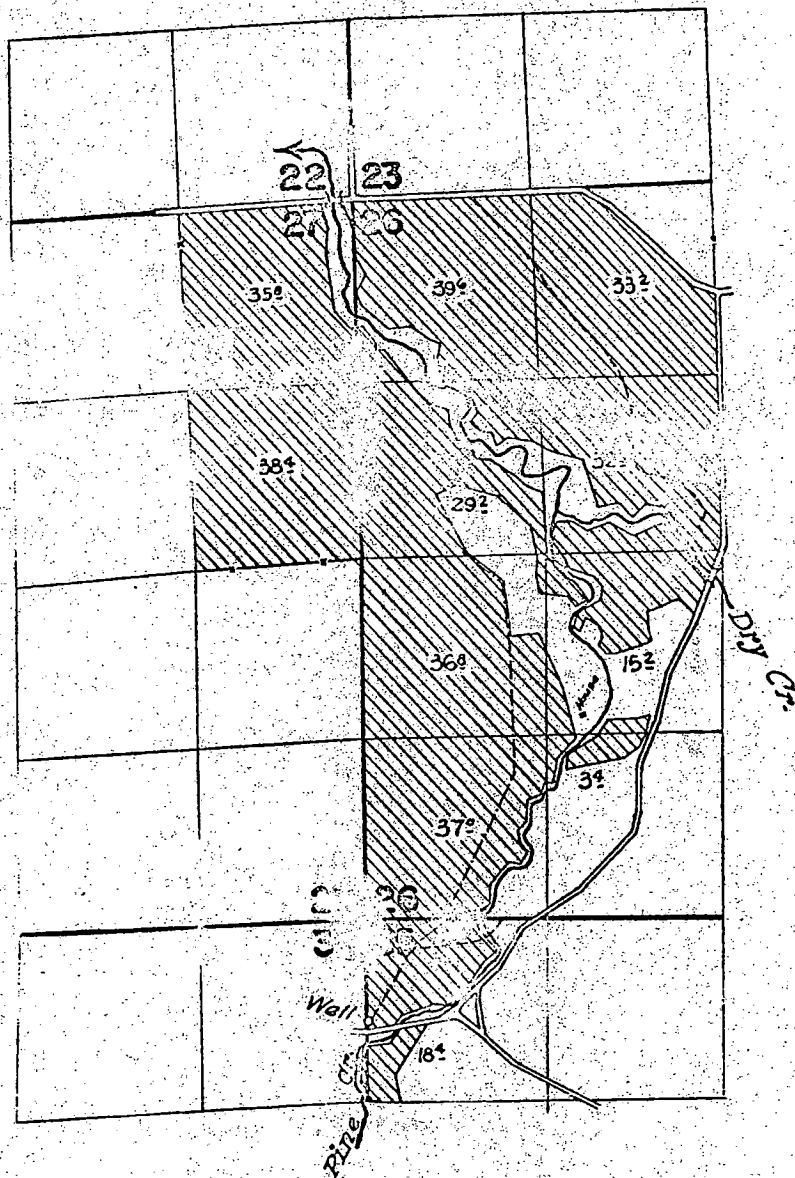

FINAL PROOF SURVEY UNDER

Application No. U-294 Permit No. U-269
IN NAME OF

DOROTHY KELLY COCKBURN

Surveyed Sept. 13-14 1962, by C. O. Bartels.

1961-

STATE OF OREGON

RECEIVED

COUNTY OF

UMATILLA

JUN 28 2021

CERTIFICATE OF WATER RIGHT

OWRD

This Is to Certify, That EUGENE M. KEY

of Milton-Freewater, State of Oregon, 97862, has made proof to the satisfaction of the Water Resources Director, of a right to the use of the waters of Well No. 1

a tributary of Pine Creek (Walla Walla River) for the purpose of irrigation and supplemental irrigation of 80.0 acres

under Permit No. U-452 and that said right to the use of said waters has been perfected in accordance with the laws of Oregon; that the priority of the right hereby confirmed dates from March 27, 1952

that the amount of water to which such right is entitled and hereby confirmed, for the purposes aforesaid, is limited to an amount actually beneficially used for said purposes, and shall not exceed 1.0 cubic foot per second

or its equivalent in case of rotation, measured at the point of diversion from the stream. The point of diversion is located in the SE $\frac{1}{4}$ SW $\frac{1}{4}$, Section 21, T. 6 N., R. 34 E., W. M.

The amount of water used for irrigation, together with the amount secured under any other right existing for the same lands, shall be limited to one-eightieth of one cubic foot per second per acre, or its equivalent for each acre irrigated and shall be further limited to a diversion of not to exceed 3 acre feet per acre for each acre irrigated during the irrigation season of each year;

and shall conform to such reasonable rotation system as may be ordered by the proper state officer.

A description of the place of use under the right hereby confirmed, and to which such right is appurtenant, is as follows:

Primary
2.1 acres SE $\frac{1}{4}$ SW $\frac{1}{4}$
16.2 acres NE $\frac{1}{4}$ SW $\frac{1}{4}$
Section 21
T. 6 N., R. 34 E., W. M.

Supplemental
37.9 acres SE $\frac{1}{4}$ SW $\frac{1}{4}$
23.8 acres NE $\frac{1}{4}$ SW $\frac{1}{4}$
Section 21
T. 6 N., R. 34 E., W. M.

An order of the State Engineer entered April 18, 1963, canceled the right for the irrigation of 40.0 acres. This certificate is issued to confirm the remaining right and supersedes the certificate heretofore issued to Howard S. Murray and recorded at Page 22882, Volume 16, State Record of Water Right Certificates.

The right to the use of the water for the purposes aforesaid is restricted to the lands or place of use herein described.

WITNESS the signature of the Water Resources Director, affixed

this date. April 21, 1976

James E. Sexson
Water Resources Director

Recorded in State Record of Water Right Certificates, Volume 35, page 42976

RECEIVED

JUN 28 2021

OWRD

T. 6 N. R. 34 E. W. M.

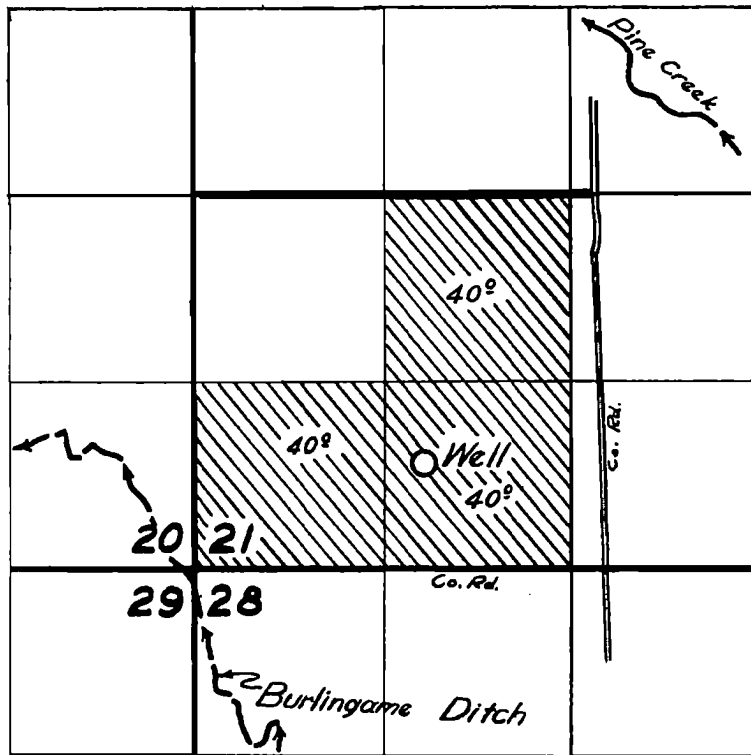

FINAL PROOF SURVEY

UNDER

Application No. U-484 Permit No. U-452

IN NAME OF

H. S. MURRAY

Surveyed 5 Nov. 1955, by [Signature]

NZ-5F-111

RECEIVED

JUN 28 2021

OWRD

STATE OF OREGON
COUNTY OF UMATILLA
CERTIFICATE OF WATER RIGHT

THIS CERTIFICATE ISSUED TO

T.O. WILLIAMS & ASSOCIATES
C/O RAY WILLIAMS
49654 UMAPINE RD
MILTON FREEWATER OR 97862

JOHN C & LINDA K VANDREE,
TRUSTEES of the REVOCABLE LIVING TRUST OF JOHN C VANDREE & LINDA K VANDREE
812 GRAND AVENUE
EVERETT WA 98201

confirms the right to use the waters of NINE WELLS in the SWARTZ SPRING CANYON AND PINE CREEK BASINS for IRRIGATION of 238.4 ACRES, SUPPLEMENTAL IRRIGATION FROM BOTH AQUIFERS OF 33.0 ACRES, SUPPLEMENTAL IRRIGATION from the BASALT AQUIFER OF 91.8 ACRES, SUPPLEMENTAL IRRIGATION FROM THE ALLUVIAL AQUIFER OF 494.4 ACRES, and SUPPLEMENTAL IRRIGATION TO MAKE UP DEFICIENCY IN RATE OF 433.0 ACRES FROM BASALT AQUIFER, AND SUPPLEMENTAL IRRIGATION TO MAKE UP A DEFICIENCY IN RATE OF 6.4 ACRES FROM THE ALLUVIAL AQUIFER.

This right was perfected under Permit G-13697. The date of priority is APRIL 20, 1998. The amount of water to which this right is entitled is limited to an amount actually used beneficially, and shall not exceed 9.562 CUBIC FEET PER SECOND (CFS) measured at the wells as follows: 2.77 CFS FOR IRRIGATION, 0.412 CFS FOR SUPPLEMENTAL IRRIGATION FROM EITHER AQUIFER, AND 1.15 CFS SUPPLEMENTAL IRRIGATION FROM THE BASALT AQUIFER, AND 4.892 CFS FOR SUPPLEMENTAL IRRIGATION FROM THE ALLUVIAL AQUIFER, 0.338 CFS FOR SUPPLEMENTAL IRRIGATION TO MAKE UP A DEFICIENCY IN RATE FROM THE BASALT AQUIFER, AND 0.006 CFS FOR SUPPLEMENTAL IRRIGATION TO MAKE UP DEFICIENCY IN RATE FROM ALLUVIAL AQUIFER. (FOR DEFICIENT RATE FROM THE BASALT AQUIFER DEFICIENCY SEE CERTIFICATES 30636 AND 30638; FOR DEFICIENT RATE FROM THE ALLUVIAL AQUIFER SEE CERTIFICATES 36131 AND 36132 AND PERMIT G-12940) FURTHER LIMITED TO A MAXIMUM RATE OF 4.67 CFS FROM BASALT WELLS: WILLIAMS WELLS 1, 3, & 4; AND 4.892 FROM ALLUVIAL WELLS: MARCH WELLS 1, 2 & 3, KEY BROTHERS WELLS 1 & 2, AND FROM WILLIAMS WELL 7.

The period of use is March 1 through October 31.

NOTICE OF RIGHT TO PETITION FOR RECONSIDERATION OR JUDICIAL REVIEW

This is an order in other than a contested case. This order is subject to judicial review under ORS 183.484 and ORS 536.075. Any petition for judicial review must be filed within the 60-day time period specified by ORS 183.484(2). Pursuant to ORS 183.484, ORS 536.075 and OAR 137-004-0080, you may petition for judicial review and petition the Director for reconsideration of this order. A petition for reconsideration may be granted or denied by the Director, and if no action is taken within 60 days following the date the petition was filed, the petition shall be deemed denied. In addition, under ORS 537.260 any person with an application, permit or water right certificate subsequent in priority may jointly or severally contest the issuance of the certificate within three months after issuance of the certificate.

The wells are located as follows:

Twp	Rng	Mer	Sec	Q-Q	Measured Distances
6 N	34 E	WM	22	NE NE	MARCH WELL 3 (UMAT 5378) - ALLUVIAL 60 FEET SOUTH & 10 FEET WEST FROM NE CORNER, SECTION 22
6 N	34 E	WM	23	NE NW	MARCH WELL 1 (UMAT 4113) - ALLUVIAL 650 FEET SOUTH & 90 FEET WEST FROM N1/4 CORNER, SECTION 23
6 N	34 E	WM	23	SW NW	MARCH WELL 2 (UMAT 5357) - ALLUVIAL 10 FEET NORTH & 350 FEET EAST FROM W1/4 CORNER, SECTION 23
6 N	34 E	WM	23	SW SW	KEY BROS WELL 1 (UMAT 4121) - ALLUVIAL 260 FEET NORTH & 1230 FEET EAST FROM SW CORNER, SECTION 23
6 N	34 E	WM	23	SW SW	WILLIAMS WELL 7 (UMAT 52037) - ALLUVIAL 1230 FEET NORTH & 90 FEET EAST FROM SW CORNER, SECTION 23
6 N	34 E	WM	23	SE SW	KEY BROS WELL 2 (UMAT 4122) - ALLUVIAL 30 FEET NORTH & 1620 FEET EAST FROM SW CORNER, SECTION 23
6 N	34 E	WM	27	SE SE	WILLIAMS WELL 3 (UMAT 53567) - BASALT 970 FEET NORTH & 5 FEET EAST FROM SW CORNER, SECTION 26
6 N	34 E	WM	35	NW NW	WILLIAMS WELL 1 (UMAT 4178) - BASALT 670 FEET SOUTH & 35 FEET EAST FROM NW CORNER, SECTION 35
6 N	34 E	WM	35	SE NW	WILLIAMS WELL 4 (UMAT 4177) - BASALT 1290 FEET SOUTH & 1710 FEET EAST FROM NW CORNER, SECTION 35

The amount of water used for irrigation under this right, together with the amount secured under any other right existing for the same lands, is limited to a diversion of ONE-EIGHTIETH of one cubic foot per second (or its equivalent) and 3.0 acre-feet for each acre irrigated during the irrigation season of each year.

BASALT WELLS = Williams 1, 3, and 4

ALLUVIAL WELLS = Williams 7; March 1, 2, and 3; and Key Brothers 1 and 2

The place of use is as follows:

IRRIGATION					
Twp	Rng	Mer	Sec	Q-Q	Acres
6 N	34 E	WM	22	NE NE	24.9
6 N	34 E	WM	22	NW NE	15.0
6 N	34 E	WM	22	SW NE	15.9
6 N	34 E	WM	22	SE NE	16.8
6 N	34 E	WM	22	NE SE	20.7
6 N	34 E	WM	22	NW SE	9.1
6 N	34 E	WM	23	NE NW	13.4
6 N	34 E	WM	23	NW NW	15.5
6 N	34 E	WM	23	SW NW	36.7
6 N	34 E	WM	23	NW SW	5.6
6 N	34 E	WM	26	NE NW	1.6
6 N	34 E	WM	26	SW NW	4.8
6 N	34 E	WM	26	SE NW	2.2
6 N	34 E	WM	26	NE SW	7.4
6 N	34 E	WM	26	NW SW	4.5
6 N	34 E	WM	26	SW SW	1.0
6 N	34 E	WM	26	SE SW	11.8
6 N	34 E	WM	26	SW SE	27.5
6 N	34 E	WM	35	NW NE	3.5
6 N	34 E	WM	35	NW NW	0.5

RECEIVED

JUN 28 2021

OWRD

RECEIVED

JUN 28 2021

OWRD

**SUPPLEMENTAL IRRIGATION FROM EITHER
AQUIFER**

Twp	Rng	Mer	Sec	Q-Q	Acres
6 N	34 E	WM	22	NW NE	23.0
6 N	34 E	WM	22	SW NE	10.0

**SUPPLEMENTAL IRRIGATION FROM BASALT
AQUIFER**

6 N	34 E	WM	23	NW NW	1.6
6 N	34 E	WM	23	SW SW	37.3
6 N	34 E	WM	23	SE SW	38.4
6 N	34 E	WM	26	NE NW	8.0
6 N	34 E	WM	26	NE SW	3.5
6 N	34 E	WM	26	NW SW	0.4
6 N	34 E	WM	27	NE NE	2.2
6 N	34 E	WM	27	SE NE	0.4

**SUPPLEMENTAL IRRIGATION FROM ALLUVIAL
AQUIFER**

Twp	Rng	Mer	Sec	Q-Q	Acres
6 N	34 E	WM	26	NE NW	34.8
6 N	34 E	WM	26	NW NW	39.6
6 N	34 E	WM	26	SW NW	29.2
6 N	34 E	WM	26	SE NW	32.9
6 N	34 E	WM	26	NE SW	18.7
6 N	34 E	WM	26	NW SW	37.2
6 N	34 E	WM	26	SW SW	37.1
6 N	34 E	WM	26	SE SW	25.2
6 N	34 E	WM	26	SW SE	12.5
6 N	34 E	WM	27	NE NE	38.0
6 N	34 E	WM	27	SE NE	38.8
6 N	34 E	WM	27	NE SE	36.7
6 N	34 E	WM	27	SE SE	16.6
6 N	34 E	WM	35	NW NE	37.1
6 N	34 E	WM	35	NE NW	40.6
6 N	34 E	WM	35	NW NW	19.4

**SUPPLEMENTAL IRRIGATION FOR A
DEFICIENCY FROM BASALT AQUIFER**

Twp	Rng	Mer	Sec	Q-Q	Acres
6 N	34 E	WM	26	NE NW	33.2
6 N	34 E	WM	26	NW NW	39.6
6 N	34 E	WM	26	SW NW	29.2
6 N	34 E	WM	26	SE NW	32.9
6 N	34 E	WM	26	NE SW	15.2
6 N	34 E	WM	26	NW SW	36.8
6 N	34 E	WM	26	SW SW	37.1
6 N	34 E	WM	26	SE SW	25.2
6 N	34 E	WM	26	SW SE	12.5
6 N	34 E	WM	27	NE NE	35.8
6 N	34 E	WM	27	SE NE	38.4
6 N	34 E	WM	35	NW NE	37.1
6 N	34 E	WM	35	NE NW	40.6
6 N	34 E	WM	35	NW NW	19.4

RECEIVED

JUN 28 2021

OWRD

SUPPLEMENTAL IRRIGATION FOR A DEFICIENCY FROM ALLUVIAL AQUIFER					
Twp	Rng	Mer	Sec	Q-Q	Acres
6 N	34 E	WM	26	NE NW	6.4

Measurement, recording and reporting conditions:

- A. The water user shall maintain the meter or other measuring device in good working order, shall keep a complete record of the amount of water used each month, and shall submit a report which includes the recorded water use measurements to the Department annually or more frequently as may be required by the Director. Further, the Director may require the water user to report general water use information, including the place and nature of use of water under the right.
- B. The water user shall allow the watermaster access to the meter or measuring device; provided however, where the meter or measuring device is located within a private structure, the watermaster shall request access upon reasonable notice.

If substantial interference with a senior water right occurs due to withdrawal of water from any well listed on this right, then use of water from the well(s) shall be discontinued or reduced and/or the schedule of withdrawal shall be regulated until or unless the Department approves or implements an alternative administrative action to mitigate the interference. The Department encourages junior and senior appropriators to jointly develop plans to mitigate interference.

The Water Resources Department has determined the reference levels based on the March 2007 static water levels in the basalt Williams Wells 1, 3, and 4 and non-basalt March Wells 1 and 2, and Williams Well 7. The table below identifies the reference level below ground surface for each of these six wells.

Static Water Level Reference Levels	
WELL	Below Land Surface
Williams Well 1	60
Williams Well 3	73
Williams Well 4	45
March Well 1	25
March Well 2	45
Williams Well 7	14

For Williams Wells 3 and 4, ground water for use under this permit shall be produced from the basalt aquifers only.

The works shall be equipped with a usable access port, and may also include an air line and pressure gauge to determine the water level elevation in the well at all times.

The Director may require water level or pump test results every ten years.

Failure to comply with any of the provisions of this right may result in action including, but not limited to, restrictions on the use, civil penalties, or cancellation of the right.

This right is for the beneficial use of water without waste. The water user is advised that new regulations may require the use of best practical technologies or conservation practices to achieve this end.

By law, the land use associated with this water use must be in compliance with statewide land-use goals and any local acknowledged land-use plan.

The use of water shall be limited when it interferes with any prior surface or ground water rights.

RECEIVED

JUN 28 2021

Issued FEB 20 2015

OWRD

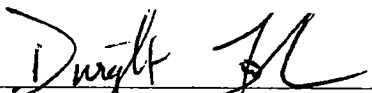

Dwight W. French
Water Right Services Division Administrator, for
Thomas M. Byler, Director
Oregon Water Resources Department

RECEIVED

JUN 28 2021

OWRD

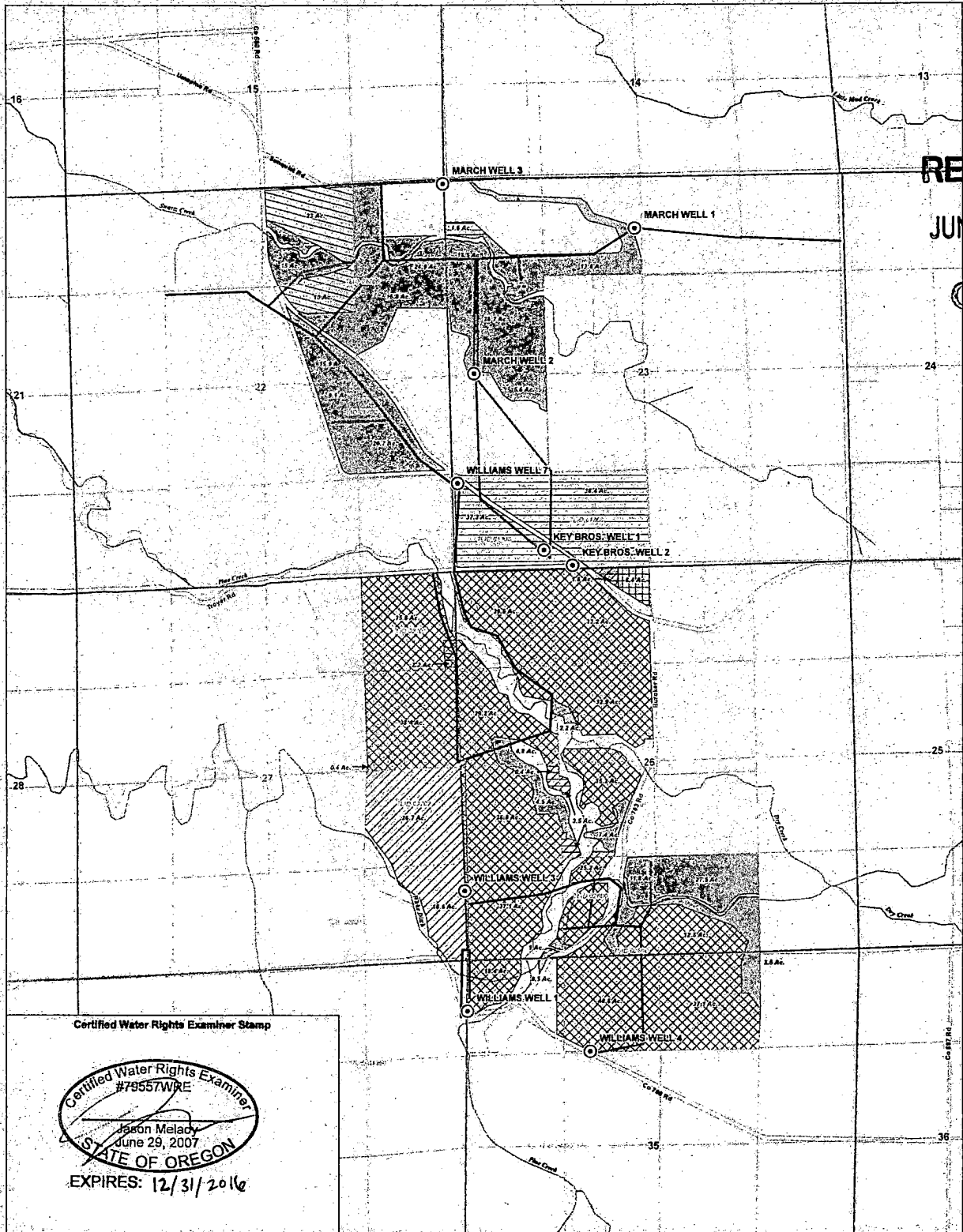

Certified Water Rights Examiner Stamp

Certified Water Rights Examiner
#79557WRE
Jason Melady
June 29, 2007
STATE OF OREGON
EXPIRES: 12/31/2016

- LEGEND**
- ⊙ Point of Appropriation (POA)
 - ▭ Tax Lot
 - ~ Watercourse
 - Place of Use**
 - ▨ Primary
 - ▩ Supplemental
 - ▧ Supplemental Alluvial
 - ▦ Supplemental Basal
 - ▥ Supplemental for a Deficiency Alluvial
 - ▤ Supplemental for a Deficiency Basal

- Irrigation Distribution System**
- ~ 15" Intake Main
 - ~ 12" PVC
 - ~ 10" PVC
 - ~ 8" PVC
 - ~ 6" PVC

NOTE:
In-line flow meter installed at the wethead for each well, with the exception of the Key Brothers wells. A combined power meter to measure flow at both Key Brothers wells is located near Key Brothers Well 2.

POA Legal Description:
March Well 1 - Located 650 feet South and 90 feet West from the North quarter corner of Section 23, Township 6 North, Range 34 East (W.M.).
March Well 2 - Located 10 feet North and 350 feet East from the West quarter corner of Section 23, Township 6 North, Range 34 East (W.M.).
March Well 3 - Located 90 feet South and 10 feet West from the Northwest corner of Section 23, Township 6 North, Range 34 East (W.M.).
Key Bros. Well 1 - Located 260 feet North and 1,230 feet East from the Southwest corner of Section 23, Township 6 North, Range 34 East (W.M.).
Key Bros. Well 2 - Located 30 feet North and 1,620 feet East from the Southwest corner of Section 23, Township 6 North, Range 34 East (W.M.).
Williams Well 1 - Located 670 feet South and 35 feet East from the Northwest corner of Section 35, Township 6 North, Range 34 East (W.M.).
Williams Well 2 - Located 970 feet North and 5 feet East from the Southwest corner of Section 26, Township 6 North, Range 34 East (W.M.).
Williams Well 3 - Located 1,290 feet South and 1,710 feet East from the Northwest corner of Section 35, Township 6 North, Range 34 East (W.M.).
Williams Well 4 - Located 1,230 feet North and 90 feet East from the Southwest corner of Section 23, Township 6 North, Range 34 East (W.M.).

FIGURE 1
Claim of Beneficial Use Map
Permit G13697 (Application G14728)
Township 6N, Range 34E
Sections 22, 23, 26, 27, 34, 35

Disclaimer
This map was prepared for the purpose of identifying the location of a water right only and it is not intended to provide legal dimensions or location of property ownership lines.

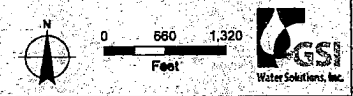

MAP NOTES:
Date: December 4, 2014
Data Sources: ESRI, OWRD

RECEIVED BY OWRD
FEB 02 2015
SALEM, OR

RECEIVED

JUN 28 2021

OWRD

STATE OF OREGON

COUNTY OF UMATILLA

CERTIFICATE OF WATER RIGHT

THIS CERTIFICATE ISSUED TO

PENDLETON LAND LLC
C/O ALTERNATIVE EQUITY ADVISORS
12119 STRATFORD DR SUITE B
CLIVE IA 50325

confirms the right to the use of water perfected under the terms of Permit G-15272. The amount of water used to which this right is entitled is limited to the amount used beneficially, and shall not exceed the amount specified, or its equivalent in the case of rotation, measured at the point of diversion from the source. The specific limits and conditions of the use are listed below.

APPLICATION FILE NUMBER: G-15579

SOURCE OF WATER: FOUR WELLS IN PINE CREEK BASIN

PURPOSE OR USE: PRIMARY IRRIGATION OF 4.6 ACRES AND SUPPLEMENTAL IRRIGATION OF 1197.8 ACRES

MAXIMUM RATE: 10.98 CUBIC FEET PER SECOND (CFS), BEING NO MORE THAN 3.79 CFS FROM WELL 1, 2.10 CFS FROM WELL 4, 3.75 CFS FROM WELL 8, AND 1.34 CFS FROM WELL U 452

PERIOD OF USE: MARCH 1 THROUGH OCTOBER 31

DATE OF PRIORITY: AUGUST 10, 2001

WELL LOCATIONS:

Twp	Rng	Mer	Sec	Q-Q	Measured Distances
6 N	34 E	WM	21	SE NW	WELL 4 - 85 FEET NORTH AND 40 FEET WEST FROM C1/4 CORNER, SECTION 21
6 N	34 E	WM	21	SW NW	WELL 8 - 125 FEET NORTH AND 90 FEET EAST FROM W1/4 CORNER, SECTION 21
6 N	34 E	WM	21	SE SW	WELL U 452 - 690 FEET NORTH AND 420 FEET WEST FROM S1/4 CORNER, SECTION 21
6 N	34 E	WM	28	SW NE	WELL 1 - 2130 FEET SOUTH AND 2930 FEET EAST FROM NW CORNER, SECTION 28

NOTICE OF RIGHT TO PETITION FOR RECONSIDERATION OR JUDICIAL REVIEW

This is an order in other than a contested case. This order is subject to judicial review under ORS 183.484 and ORS 536.075. Any petition for judicial review must be filed within the 60-day time period specified by ORS 183.484(2). Pursuant to ORS 183.484, ORS 536.075 and OAR 137-004-0080, you may petition for judicial review and petition the Director for reconsideration of this order. A petition for reconsideration may be granted or denied by the Director, and if no action is taken within 60 days following the date the petition was filed, the petition shall be deemed denied. In addition, under ORS 537.260 any person with an application, permit or water right certificate subsequent in priority may jointly or severally contest the issuance of the certificate within three months after issuance of the certificate.

The amount of water used for irrigation under this right, together with the amount secured under any other right existing for the same lands, is limited to a diversion of ONE-EIGHTIETH of one cubic foot per second (or its equivalent) and 3.0 acre-feet for each acre irrigated during the irrigation season of each year.

THE PLACE OF USE IS LOCATED AS FOLLOWS:

PRIMARY IRRIGATION					
Twp	Rng	Mer	Sec	Q-Q	Acres
6 N	34 E	WM	28	SW NE	4.6

SUPPLEMENTAL IRRIGATION					
Twp	Rng	Mer	Sec	Q-Q	Acres
6 N	34 E	WM	20	SW NW	0.2
6 N	34 E	WM	20	SE NW	0.2
6 N	34 E	WM	20	NE SW	25.2
6 N	34 E	WM	20	NW SW	35.5
6 N	34 E	WM	20	SW SW	39.1
6 N	34 E	WM	20	SE SW	35.1
6 N	34 E	WM	20	NW SE	5.1
6 N	34 E	WM	20	SW SE	36.0
6 N	34 E	WM	20	SE SE	15.8
6 N	34 E	WM	21	NE SW	40.0
6 N	34 E	WM	21	NW SW	40.0
6 N	34 E	WM	21	SW SW	37.4
6 N	34 E	WM	21	SE SW	38.2
6 N	34 E	WM	21	NW SE	1.4
6 N	34 E	WM	21	SW SE	4.9
6 N	34 E	WM	28	NW NE	6.9
6 N	34 E	WM	28	SW NE	4.3
6 N	34 E	WM	28	NE NW	39.0
6 N	34 E	WM	28	NW NW	36.1
6 N	34 E	WM	28	SW NW	39.8
6 N	34 E	WM	28	SE NW	37.3
6 N	34 E	WM	28	NE SW	41.1
6 N	34 E	WM	28	NW SW	26.9
6 N	34 E	WM	28	SW SW	27.9
6 N	34 E	WM	28	SE SW	31.7
6 N	34 E	WM	28	NW SE	10.2
6 N	34 E	WM	28	SW SE	10.9
6 N	34 E	WM	29	NE NE	29.2
6 N	34 E	WM	29	NW NE	39.1
6 N	34 E	WM	29	SW NE	38.9
6 N	34 E	WM	29	SE NE	34.2
6 N	34 E	WM	29	NE NW	39.1
6 N	34 E	WM	29	SW NW	14.0
6 N	34 E	WM	29	SE NW	38.8
6 N	34 E	WM	29	NE SW	40.7
6 N	34 E	WM	29	NW SW	40.0
6 N	34 E	WM	29	SW SW	39.1
6 N	34 E	WM	29	SE SW	39.3
6 N	34 E	WM	29	NE SE	31.9
6 N	34 E	WM	29	NW SE	41.3
6 N	34 E	WM	29	SW SE	33.5
6 N	34 E	WM	29	SE SE	32.5

RECEIVED

JUN 28 2021

OWRD

Measurement, recording and reporting conditions:

- A. The water user shall maintain the meter or other suitable measuring device approved by the Director in good working order. The water user shall keep a complete record of the amount of water used each month, and shall submit a report which includes the recorded water use measurements to the Department annually or more frequently as may be required by the Director. Further, the Director may require the water user to report general water-use information, including the place and nature of use of water under the right.
- B. The water user shall allow the watermaster access to the meter or measuring device; provided however, where the meter or device is located within a private structure, the watermaster shall request access upon reasonable notice.

The water user shall monitor and report the impact of water use under this right in accordance with the approved water level monitoring plan on file with the Department. The reference level against which any future measurements will be compared is 113.55 feet below ground surface (bgs) for Well 1, 90.00 feet bgs for Well 4, 120.00 feet bgs for Well 8, and 74.00 feet bgs for Well U 452.

If a well listed on this right (or replacement well) displays a total static water-level decline of 25 or more feet over any period of years, as compared to the reference level, then the water user shall discontinue use of, or reduce the rate or volume of withdrawal from, the well(s). Such action shall be taken until the water level recovers to above the 25-foot decline level or until the Department determines, based on the water user's and/or the Department's data and analysis, that no action is necessary because the aquifer in question can sustain the observed declines without adversely impacting the resource or senior water rights. The water user shall in no instance allow excessive decline, as defined in Commission rules, to occur within the aquifer as a result of use under this right.

If substantial interference with a senior water right occurs due to withdrawal of water from any well listed on this right, then use of water from the well(s) shall be discontinued or reduced and/or the schedule of withdrawal shall be regulated until or unless the Department approves or implements an alternative administrative action to mitigate the interference. The Department encourages junior and senior appropriators to jointly develop plans to mitigate interferences.

The wells shall be maintained in accordance with the General Standards for the Construction and Maintenance of Water Wells in Oregon. The works shall be equipped with a usable access port, and may also include an air line and pressure gauge adequate to determine the water level elevation in the well at all times.

The Director may require water level or pump test results every ten years.

Failure to comply with any of the provisions of this right may result in action including, but not limited to, restrictions on the use, civil penalties, or cancellation of the right.

This right is for the beneficial use of water without waste. The water user is advised that new regulations may require the use of best practical technologies or conservation practices to achieve this end.

By law, the land use associated with this water use must be in compliance with statewide land-use goals and any local acknowledged land-use plan.

The use of water shall be limited when it interferes with any prior surface or ground water rights.

The right to the use of the water for the above purpose is restricted to beneficial use on the place of use described.

Issued SEP 29 2020

Dwight French
Water Right Services Division Administrator, for
Thomas M. Byler, Director
Oregon Water Resources Department

RECEIVED

JUN 28 2021

OWRD

RECEIVED

JUN 28 2021

OWRD

CLAIM OF BENEFICIAL USE MAP
 FOR APPLICATION G-15579, PERMIT G-15272
 IN THE NAME OF RAY WILLIAMS
 SECTIONS 20, 21, 28, & 29 T6N, R34E W.M.
 UMATILLA COUNTY

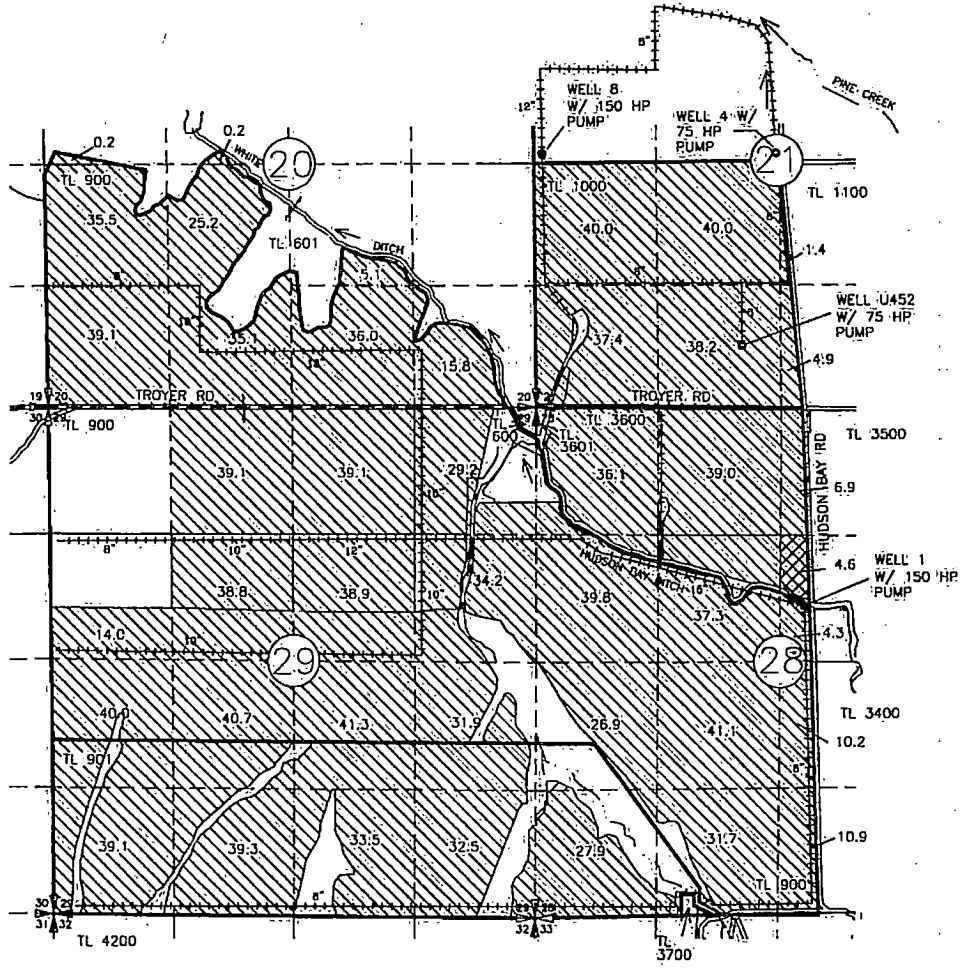

LEGEND AND LOCATION OF
 WELLS & FLOW METERS

- WELL 1 & FLOW METER
 LOCATED 2130' SOUTH AND 2930' EAST FROM THE
 NW COR SEC 28
- WELL 4 & FLOW METER
 LOCATED 85' NORTH AND 40' WEST FROM THE
 CENTER OF SEC 21
- WELL 8 & FLOW METER
 LOCATED 125' NORTH AND 90' EAST FROM THE
 W 1/4 COR SEC 21
- WELL U452 & FLOW METER
 LOCATED 690' NORTH AND 420' WEST FROM THE
 S 1/4 COR SEC 21

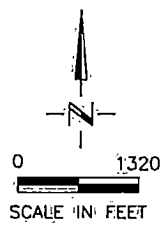

- PRIMARY IRR
- SUPPLEMENTAL IRR
- BURIED PIPELINE
- TAX LOT BOUNDARY

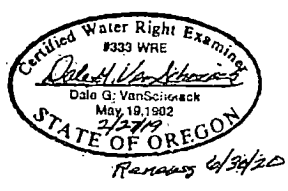

NOTE:
 THE PURPOSE OF THIS MAP IS TO IDENTIFY THE APPROXIMATE LOCATION
 OF THE WATER RIGHT. IT IS NOT INTENDED TO PROVIDE INFORMATION
 RELATIVE TO THE LOCATION OF PROPERTY OWNERSHIP BOUNDARY LINES.

RECEIVED
 JUN 08 2021
 OWRD

DGV Consulting, PLLC
 PHONE (509) 627-8717
 dalevconsulting@gmail.com
 Date: Oct 07, 2018

RECEIVED

JUN 28 2021

OWRD

Attachment #5

Supplemental Form D – Hudson Bay District Improvement Company

POA Transfer Application for Certificates 30636, 42976, 89896, 95268

Supplemental Form D

Water Right Transfers Within the Boundaries of or Served by an Irrigation District or other Water Supplier (Association, Ditch Co., etc.)

[For transfers submitted under OAR Chapter 690 Division 380]



Oregon Water Resources Department
 725 Summer Street NE, Suite A
 Salem, Oregon 97301-1266
 503-986-0900
 www.oregon.gov/OWRD

The Department requires non-district applicants to communicate with districts/water suppliers during the planning and preparation of transfer applications involving water rights having a point of diversion or appropriation (POD/POA) or place of use (POU) served by or located within the boundaries of an irrigation district, or other type of water supplier to which assessments are paid. In some cases consent will be required from the district or water supplier.

This form must be included with any transfer application that involves rights served by or located within the boundaries of a district or other type of water supplier.

1. APPLICANT INFORMATION

RECEIVED

JUN 28 2021

OWRD

NAME PENDLETON LAND LLC C/O ALTERNATIVE EQUITY ADVISORS LLC (DAVE MUTH)			PHONE (HM)
PHONE (WK) 515-222-1347	CELL	FAX	
ADDRESS 12119 STRATFORD DRIVE, SUITE B			
CITY CLIVE	STATE IOWA	ZIP 50325	E-MAIL** DAVE@ALTERNATIVEEQUITYADVISORS.COM

2. DISTRICT or WATER SUPPLIER INFORMATION

DISTRICT/WATER SUPPLIER NAME HUDSON BAY DISTRICT IMPROVEMENT COMPANY (TIM DERUWE -- BOARD CHAIRMAN)			PHONE (HM)
PHONE (WK) (541) 938-5989	CELL	FAX	
ADDRESS P.O. Box 110			
CITY MILTON-FREEWATER	STATE OR	ZIP 97862	E-MAIL**

** By providing an e-mail address, the applicant and/or the district/water supplier consents to receive all correspondence from the Department electronically. Copies of final order documents will also be mailed.

3. WATER RIGHTS ISSUED IN THE NAME OF, or LOCATED WITHIN, or SERVED BY AN IRRIGATION DISTRICT, OTHER DISTRICT, OR WATER SUPPLIER

a. List the water right(s) involved in this transfer:

	Application / Decree	Permit / Previous Transfer	Certificate	Is the water right in the name of a district, water supplier, or BOR*?
1.		-	30636	No
2.		-	42976	No
3.		-	89896 & 95268	No

Attach additional pages for additional water rights if necessary.

*Bureau of Reclamation

b. Determine a district's/water supplier's connection to your points of diversion (POD) or appropriation (POA) and places of use (POU). [You may need to consult with your district/water supplier.]

CURRENT ASSOCIATIONS Please answer the following "yes" or "no" questions:

YES NO One or more of the current POD(s) / POA(s) involved in the transfer are served by a district/water supplier or rely on BOR water.

YES NO All or a portion of the current POU involved in this proposed transfer receives water for either primary or supplemental irrigation from the district/water supplier; i.e., the POU is currently layered with a district or BOR water supplied water right(s).

PROPOSED ASSOCIATIONS Please answer the following "yes" or "no" questions:

YES NO One or more of the proposed POD(s) / POA(s) involved in the transfer are currently served or will be served by a district/water supplier if the transfer is approved, or rely on BOR water.

YES NO All or a portion of the proposed POU involved in this proposed transfer currently receives or will receive either primary or supplemental irrigation from the district/water supplier; i.e., the POU will be layered with a district/water supplier or BOR water supplied water right(s).

RECEIVED

JUN 28 2021

COMMENTS OR ADDITIONAL INFORMATION

4. APPLICANT'S SIGNATURE

(1) I certify that I have notified the district/water supplier about the proposed water right transfer application by [check one]: **OWRD**
 email, phone, postal mail, in person, or other (please specify) _____

(2) I certify that to the best of my knowledge the information contained in this Supplemental Form D is true and accurate.

Ad B

Adam D. Borod

June 23, 2021

Applicant Signature

Name (print)

Date

5. (WHEN REQUIRED) DISTRICT or WATER SUPPLIER CONSENT TO THE PROPOSED WATER RIGHT TRANSFER

District Manager or Water Supplier consent is required if any box on this form is marked "YES."

The district/water supplier certifies the following:

(1) The district/water supplier has reviewed the applicant's proposed water right transfer application and maps; and

(2) The district/water supplier consents to the proposed water right transfer application.

YES NO After proof of completion, the confirming water right certificate is to remain in the name of the U.S. Bureau of Reclamation or the district/water supplier.

YES NO The district/water supplier will be responsible for submitting the claim of beneficial use prepared by a Certified Water Rights Examiner (CWRE).

Tim DeRauw

Tim DeRauw

23 June 2021

Signature of District Manager /Water Supplier

Name (print), Title

Date

RECEIVED

JUN 28 2021

OWRD

Attachment #6

Well Logs on Wells to be Replaced

POA Transfer Application for Certificates 30636, 42976, 89896, 95268

STATE ENGINEER
Salem, Oregon

UMAT
4178

Well Record

STATE WELL NO. 6N/34-35D(1)
COUNTY UMATILLA
APPLICATION NO. U-294

OWNER: Dorothy Kelly Cookburn MAILING ADDRESS: _____

LOCATION OF WELL: Owner's No. _____ CITY AND STATE: _____

NW 1/4 NW 1/4 Sec. _____ T. _____ N. S., R. _____ E. W., W.M.

Bearing and distance from section or subdivision corner 746' S. & 23' E. of NW corner of Sec. 35.

Altitude at well _____

TYPE OF WELL: Drilled Date Constructed Sept. '47 - Mar '48

Depth drilled 702 Depth cased 60 Section 35

CASING RECORD:
18 and 14 inch - set to 60 feet

FINISH: _____

AQUIFERS: _____

WATER LEVEL: _____

PUMPING EQUIPMENT: Type _____ H.P. _____
Capacity _____ G.P.M.

WELL TESTS:
Drawdown _____ ft. after _____ hours _____ G.P.M.
Drawdown _____ ft. after _____ hours _____ G.P.M.

USE OF WATER Irrigation Temp. _____ °F. _____, 19.

SOURCE OF INFORMATION U-294, U.S.G.S. Report

DRILLER or DIGGER A. A. Durand & Son

ADDITIONAL DATA:
Log Water Level Measurements _____ Chemical Analysis _____ Aquifer Test _____

REMARKS: _____

RECEIVED

JUN 28 2021

OWRD

RECEIVED

JUN 28 2021

STATE ENGINEER
Salem, Oregon

OWRD

State Well No. 6N/34-35D(1)
County Umatilla
Application No. U-294

Well Log

Owner: Dorothy Kelly Cockburn Owner's No. _____

Driller: A. A. Durand & Son Date Drilled Sept. 14, Mar. 148

CHARACTER OF MATERIAL	(Feet below land surface)		Thickness (feet)
	From	To	
Soil and yellow clay	0	11	11
Gravel, cemented	11	20	9
Rock and boulders	20	21	1
Gravel, cemented	21	37	16
Rock, water bearing	37	38	1
Basalt, brown	38	48	10
Gravel	48	51	3
Gravel and clay	51	58	7
Gravel, cemented	58	75	17
Basalt, brown	75	90	15
Basalt, brown, hard	90	102	12
Basalt, crevice	102	106	4
Basalt, honey combed, water bearing	106	108	2
Basalt, brown, hard	108	120	12
Gravel, gray, cemented	120	125	5
Clay, blue and gravel	125	140	15
Basalt, brown, water bearing	140	160	20
Basalt, hard, gray	160	168	8
Basalt, gray	168	178	10
Basalt, gray, soft	178	200	22
Basalt, broken, brown	200	220	20
Basalt, blue	220	255	35
Basalt, brown honeycombed	255	260	5
Basalt, blue	260	270	10

RECEIVED

JUN 28 2021

STATE ENGINEER
Salem, Oregon

OWRD

State Well No. 6N/34-35D(1)

County Umatilla

Application No. U-294

Well Log - Cont.

Owner: Dorothy Kelly Cockburn

Owner's No. _____

Driller: A. A. Durand

Date Drilled Sept. '47 - Mar. '48

CHARACTER OF MATERIAL	(Feet below land surface)		Thickness (feet)
	From	To	
Basalt, gray	270	280	10
Rock, honeycombed	280	304	24
Basalt, blue	304	354	50
Basalt, black	354	371	17
Basalt, blue	371	378	7
Basalt, black	378	388	10
Basalt, blue, water bearing	388	394	6
Basalt, black	394	403	9
Basalt, firm, water flowing	403	408	5
Basalt	408	430	22
Basalt, hard	430	434	4
Basalt	434	436	2
Basalt, hard and sharp formation	436	440	4
Basalt, sandy	440	443	3
Basalt	443	454	11
Basalt, hard	454	458	4
Basalt, flowing 165 gpm	458	575	117
Shale, brown	575	580	5
Basalt	580	600	-20
Basalt, hard	600	702	102

RECEIVED

JUN 28 2021

OWRD

9-1857
(Oct. 1936)

DEC 19 1963

NOTEBOOK SHEET

Name Newcomb, Sava & Turn Date Dec. 17, 1963

Current metering deep wells near
Milton - Freeewater

Marion Cockburn well 6/34-35D1

Well flowing 5 gpm (est) over 14-inch
flange at land surface

Depth (ft below land surface)	inches/min	ft/sec	Flow (gpm)
----------------------------------	------------	--------	---------------

50

0

100

0

200

0

300

0

400

0

500

0

540 entered smaller hole, or pipe, or offset

550

0

600

0

650

0

666 passed pipe, hole offset, or such

690

0

699±

on bottom

Conclusion:

No water moving in well, except
the 5± gpm over flange, at
this time and hydraulic
condition.

RCW

6N/34-21 P(1)

RECEIVED
1953
ENGINEER
OREGON

UMAT
4627

Application No. U U-484
Permit No. U 452
Well No. 1

UMATILLA

REPORT ON COMPLETION OF WELL

(Note: This report should be submitted to the State Engineer, Salem, Oregon, as soon as possible after the well is completed. If more than one well is covered by this permit, a separate report shall be filed for each)

Date of Report Oct 20th, 1953

1. Location of well: S E of SW 1/4 of Section 21 Twp. 6 N Rge. 34, W. M.
2. Name of nearest natural surface stream Pina Creek
3. Distance from well to that stream: 5000 feet.
4. If the well is less than 1300 feet from a natural surface stream, give the difference in elevation between the ground surface at the well and the lowest point in stream channel: - feet.
5. Date of beginning drilling or digging. March 1952
6. Date well was completed April 1952

LOG OF MATERIALS ENCOUNTERED

Character of Material	Depth at which encountered	Thickness of stratum
Volcanic Ash	At surface	ft.
Top Soil	0 ft.	28 ft.
Loose gravel	28 ft.	32 ft.
Clay & "	32 ft.	80 ft.
Cement & "	80 ft.	103 ft.
Clay	103 ft.	110 ft.
Cement gravel	110 ft.	160 ft.
Clay	160 ft.	166 ft.
Cement gravel	166 ft.	204 ft.
Remarks: <u>Little or no rock encountered</u>		
Clay	204 "	212 "
Gravel	212 "	220 "
Cement Gravel	220 "	231 "

WELL INFORMATION

8. Diameter of well 12 inches. Depth of well 231 feet.
9. Depth at which water was first encountered 35 feet.
10. Water level when completed: 23 feet below ground surface.
11. Additional information regarding well; such as soil conditions, quick sand, caves, obstructions, rock, etc.:

RECEIVED

JUN 28 2021

OWRD

6N/34-2 P(1)
UMATILLA

VED
1953
ENGINEER
SALEM, OREGON

PUMP INFORMATION

RECEIVED

JUN 28 2021

- 12. Manufacturer of pump: Peerless
- 13. Address: _____
- 14. Data on name or base plate: _____
- 15. Data on pump bowl assembly: No- 154082
- 16. Size of pump: _____
- 17. Rated capacity: 10 inch _____ gallons per minute.
- 18. Rated speed: 600 _____ revolutions per minute.
- 19. Number of stages: 1750 _____
- 20. Size of intake pipe: 6 _____
- 21. Size of discharge pipe: 8 " _____
- 22. Length of intake pipe: _____
- 23. Length of discharge pipe: _____
- 24. Suction lift: (difference in elevation between water surface in well and pump) _____
- 25. Discharge lift: (difference in elevation between pump and end of discharge line) _____
- 26. Depth of pump intake below ground surface: _____ feet.
- 27. Remarks: _____

OWRD

MOTOR OR ENGINE INFORMATION

- 28. Name of manufacturer: General Electric
- 29. Address: _____
- 30. Type of motor or engine: _____
- 31. Data on name or base plate: Model 5K6522 X A 1 A
- 32. Rated horsepower: 50
- 33. Rated speed of motor or engine: 1770 _____ revolutions per minute.

34. Rated Capacity of Pump (with described motor)	<u>600</u> g.p.m. at <u>270'</u> ft. head
	_____ g.p.m. at _____ ft. head
	_____ g.p.m. at _____ ft. head
	_____ g.p.m. at _____ ft. head
	_____ g.p.m. at _____ ft. head

- 35. Remarks: _____

6N/39-21P(1)

IVED
4 1953

CAPACITY TEST

ENGINEER
SALEM, OREGON

- 36. Date of test: April 1952 37. Temperature of water °F. or °C.
- 38. Motor speed during test: 1750
- 39. Test made by (weir, tank or other means): Orifice

40. Pounds pressure	TOTAL HEAD	*Total lift in feet		Gallons per min.	°Feet to water level	Draw-down	+Time
	lbs.; Gauge at pump	Total	ft. in.		ft.	ft.	M.
	lbs.; Gauge at pump	Total	ft. in.		ft.	ft.	M.
	lbs.; Gauge at pump	Total	ft. in.		ft.	ft.	M.
	lbs.; Gauge at pump	Total	ft. in.		ft.	ft.	M.
	lbs.; Gauge at pump	Total	ft. in.		ft.	ft.	M.
	lbs.; Gauge at pump	Total	ft. in.		ft.	ft.	M.
	lbs.; Gauge at pump	Total	ft. in.		ft.	ft.	M.
	lbs.; Gauge at pump	Total	ft. in.		ft.	ft.	M.
	lbs.; Gauge at pump	Total	ft. in.		ft.	ft.	M.
	lbs.; Gauge at pump	Total	ft. in.		ft.	ft.	M.
	lbs.; Gauge at pump	Total	ft. in.		ft.	ft.	M.
	lbs.; Gauge at pump	Total	ft. in.		ft.	ft.	M.
	lbs.; Gauge at pump	Total	ft. in.		ft.	ft.	M.
	lbs.; Gauge at pump	Total	ft. in.		ft.	ft.	M.
	lbs.; Gauge at pump	Total	ft. in.		ft.	ft.	M.
	lbs.; Gauge at pump	Total	ft. in.		ft.	ft.	M.
	lbs.; Gauge at pump	Total	ft. in.		ft.	ft.	M.
	lbs.; Gauge at pump	Total	ft. in.		ft.	ft.	M.
	lbs.; Gauge at pump	Total	ft. in.		ft.	ft.	M.
	lbs.; Gauge at pump	Total	ft. in.		ft.	ft.	M.

* Difference in elevation between water level in well and outlet of pump test line.
 ° Distance from ground ^{25 ft} to water surface in well. 25 ft
 ° Distance water level is lowered during time interval. 110 ft
 + Hour and minute at which observation was made.

- 41. Installation will work efficiently under normal head of 170 ft.
- 42. Water is discharged into: sprinkling system
- 43. Was water lowered to pump intake by test? yes
- 44. Remarks: _____

GENERAL INFORMATION

- 45. Name of contractor or other party who drilled or dug well: Heitstuman Brothers Address: Freewater, Oregon- Route # 2
- 46. Pump and motor were installed by: White Brothers Address: Walla Walla, Washington.
- 47. Capacity test was made by: Heitstuman Brothers Address: Freewater, Oregon Route
- 48. General remarks: _____

RECEIVED
JUN 28 2021
OWRD

2ND AMENDED COPY Well # 4 UMAT 53646

STATE OF OREGON WATER SUPPLY WELL REPORT (as required by ORS 537.765)

WELL I.D. # 32546 START CARD # 100776

Instructions for completing this report are on the last page of this form.

(1) OWNER: Name To William & Susan Address 49654 Umagine Rd City Milton Freewater State OR Zip 97862

(9) LOCATION OF WELL by legal description: County Umatilla Latitude Longitude Township 6N N or S Range 34E E or W. WM. Section 21 SE 1/4 NW 1/4 Tax Lot 403 Lot Block Subdivision Street Address of Well (or nearest address)

(2) TYPE OF WORK: [X] New Well [] Deepening [] Alteration (repair/recondition) [] Abandonment

(3) DRILL METHOD: [X] Rotary Air [] Rotary Mud [] Cable [] Auger [] Other

(10) STATIC WATER LEVEL: 84 ft. below land surface. Date 10-6-99 Artesian pressure lb. per square inch. Date

(4) PROPOSED USE: [] Domestic [] Community [] Industrial [X] Irrigation [] Thermal [] Injection [] Livestock [] Other

(11) WATER BEARING ZONES: Depth at which water was first found

(5) BORE HOLE CONSTRUCTION: Special Construction approval [] Yes [X] No Depth of Completed Well 660 ft. Explosives used [] Yes [X] No Type Amount

Table with 4 columns: From, To, Estimated Flow Rate, SWL. Rows show data for 200-210, 430-500, and 550-560 ft depths.

HOLE SEAL table with columns: Diameter, From, To, Material, From, To, Sacks or pounds. Rows show seal material (PTD Con) from 0 to 217 ft.

(12) WELL LOG: Ground Elevation

How was seal placed: Method [] A [] B [X] C [] D [] E [] Other

WELL LOG table with columns: Material, From, To, SWL. Lists soil, cemented gravel, tan clay, green & brown clayston, etc.

CASING/LINER table with columns: Diameter, From, To, Gauge, Steel, Plastic, Welded, Threaded. Shows casing sizes 16, 14, and 10.

(7) PERFORATIONS/SCREENS table with columns: From, To, Slot size, Number, Diameter, Tele/pipe size, Casing, Liner. Method TORCH.

Date started 4-28-99 Completed 10-7-99

(8) WELL TESTS: Minimum testing time is 1 hour

Well Tests table with columns: Pump, Bailer, Air, Artesian, Yield gal/min, Drawdown, Drill stem at, Time. Values: 1000+, 500, 1 hr.

(unbonded) Water Well Constructor Certification: I certify that the work I performed on the construction, alteration, or abandonment of this well is in compliance with Oregon water supply well construction standards.

Temperature of water 68 Depth Artesian Flow Found Was a water analysis done? [] Yes [] No

Signed Chad Courtney WWC Number 1735 Date 10-17-99

(bonded) Water Well Constructor Certification: I accept responsibility for the construction, alteration, or abandonment work performed on this well during the construction dates reported above.

Depth of strata: ORIGINAL - WATER RESOURCES DEPARTMENT FIRST COPY - CONSTRUCTOR SECOND COPY - CUSTOMER

Signed Larry [unclear] WWC Number 544 Date 10-17-99

RECEIVED JUN 28 2021

RECEIVED

UMAT 53646

AMENDED COPY

APR 20 2000

STATE OF OREGON WATER SUPPLY WELL REPORT (as required by ORS 537.765)

WATER RESOURCES DEPT. SALEM, OREGON

WELL I.D. # 32546 START CARD # 100776

Instructions for completing this report are on the last page of this form.

(1) OWNER: Well Number

Name To Williams + Assoc. Address 49654 Umpqua Rd City Milton Freewater State OR Zip

(2) TYPE OF WORK

New Well Deepening Alteration (repair/recondition) Abandonment

(3) DRILL METHOD:

Rotary Air Rotary Mud Cable Auger Other

(4) PROPOSED USE:

Domestic Community Industrial Irrigation Thermal Injection Livestock Other

(5) BORE HOLE CONSTRUCTION:

Special Construction approval Yes No Depth of Completed Well 660 ft. Explosives used Yes No Type Amount

Table with columns: HOLE Diameter, SEAL From, To, Material, From, To, Sacks or pounds. Includes data for diameters 20, 16, 14 3/4, 12 and seal materials like P70 Cam.

How was seal placed: Method A B C D E

Backfill placed from ft. to ft. Material Gravel placed from ft. to ft. Size of gravel

(6) CASING/LINER:

Table with columns: Diameter, From, To, Gauge, Steel, Plastic, Welded, Threaded. Rows for Casing and Liner.

Final location of shoe(s)

(7) PERFORATIONS/SCREENS:

Table with columns: From, To, Slot size, Number, Diameter, Tele/pipe size, Casing, Liner. Includes data for perforations at 150-495 and 567-623.

(8) WELL TESTS: Minimum testing time is 1 hour

Table with columns: Pump/Bailer/Air/Flowing Artesian, Yield gal/min, Drawdown, Drill stem at, Time. Includes data for yield 1000+ and drawdown 500.

Temperature of water 68 Depth Artesian Flow Found Was a water analysis done? Did any strata contain water not suitable for intended use? Depth of strata:

(9) LOCATION OF WELL by legal description:

County Umatilla Latitude Longitude Township 6N N or S Range 34E E or W. WM. Section 21 SE 1/4 NW 1/4 Tax Lot 403 Lot Block Subdivision Street Address of Well (or nearest address)

(10) STATIC WATER LEVEL:

84 ft. below land surface. Date 10-6-99 Artesian pressure lb. per square inch. Date

(11) WATER BEARING ZONES:

Depth at which water was first found

Table with columns: From, To, Estimated Flow Rate, SWL. Includes data for zones from 200-210, 430-500, 550-560.

(12) WELL LOG:

Table with columns: Material, From, To, SWL. Includes soil, cemented gravel, tan clay, green claystone, etc.

RECEIVED

JUN 28 2021

OWRD

Date started 4-28-99 Completed 10-7-99

(unbonded) Water Well Constructor Certification:

I certify that the work I performed on the construction, alteration, or abandonment of this well is in compliance with Oregon water supply well construction standards.

Signed Chad Courtney WWC Number 1735 Date 10-17-99

(bonded) Water Well Constructor Certification:

I accept responsibility for the construction, alteration, or abandonment work performed on this well during the construction dates reported above.

Signed Larry Baird WWC Number 544 Date 10-17-99

UMAT
53646

NOV 08 1999

STATE OF OREGON
WATER SUPPLY WELL REPORT
(as required by ORS 537.765)

WATER RESOURCES DEPT.
SALEM, OREGON

WELL I.D. # L 32546
START CARD # 100776

Instructions for completing this report are on the last page of this form.

(1) OWNER: Well Number _____
Name To. Williams + Assoc

Address 49654 Umagine Rd
City Milton Freewater State ore Zip 97

(2) TYPE OF WORK
 New Well Deepening Alteration (repair/recondition) Abandonment

(3) DRILL METHOD:
 Rotary Air Rotary Mud Cable Auger
 Other

(4) PROPOSED USE:
 Domestic Community Industrial Irrigation
 Thermal Injection Livestock Other

(5) BORE HOLE CONSTRUCTION:
Special Construction approval Yes No Depth of Completed Well 200 ft.
Explosives used Yes No Type _____ Amount _____

HOLE			SEAL			Sacks or pounds
Diameter	From	To	Material	From	To	
20	0	18				3 YDS
16	18	217				
14 3/4	217	511				
12	511	660				

How was seal placed: Method A B C D E
 Other _____
Backfill placed from _____ ft. to _____ ft. Material _____
Gravel placed from _____ ft. to _____ ft. Size of gravel _____

Casing/Liner	Diameter	From	To	Gauge	Material			
					Steel	Plastic	Welded	Threaded
Casing:	16	72	217	.25	<input checked="" type="checkbox"/>	<input type="checkbox"/>	<input checked="" type="checkbox"/>	<input type="checkbox"/>
	14	150	495		<input type="checkbox"/>	<input type="checkbox"/>	<input type="checkbox"/>	<input type="checkbox"/>
	10	420	660		<input type="checkbox"/>	<input type="checkbox"/>	<input type="checkbox"/>	<input type="checkbox"/>
Liner:					<input type="checkbox"/>	<input type="checkbox"/>	<input type="checkbox"/>	<input type="checkbox"/>

Final location of shoe(s) _____

(7) PERFORATIONS/SCREENS:
 Perforations Method torch
 Screens Type _____ Material _____

From	To	Slot size	Number	Diameter	Tele/pipe size	Casing	Liner
150	495	1"		14"		<input checked="" type="checkbox"/>	<input type="checkbox"/>
495	660	1"		10"		<input checked="" type="checkbox"/>	<input type="checkbox"/>

Bottom DOC
40' LP
80' E

(8) WELL TESTS: Minimum testing time is 1 hour

Yield gal/min	Drawdown	Drill stem at	Time
1000+			1 hr.

Pump Bailer Air Flowing Artesian

Temperature of water 68°F Depth Artesian Flow Found _____
Was a water analysis done? Yes By whom _____
Did any strata contain water not suitable for intended use? Too little
 Salty Muddy Odor Colored Other _____
Depth of strata: _____

495
100
395

(9) LOCATION OF WELL by legal description:
County Umatilla Latitude _____ Longitude _____
Township 6N N or S Range 34E E or W. WM.
Section 21 SE 1/4 NW 1/4
Tax Lot 403 Lot _____ Block _____ Subdivision _____
Street Address of Well (or nearest address) _____

(10) STATIC WATER LEVEL:
84 ft. below land surface. Date 10-6-99
Artesian pressure _____ lb. per square inch. Date _____

(11) WATER BEARING ZONES:
Depth at which water was first found 200

From	To	Estimated Flow Rate	SWL
200	210	200	
430	500	1000	
550	560	1500	80

(12) WELL LOG:
Ground Elevation _____

Material	From	To	SWL
SOIL	0	10	
Cemented gravel	10	50	
T2N CLAY	50	65	
Cemented Gravel	65	455	
Cemented Gravel/T2N CLAY	455	511	
GRAVEL with green claystone	511	550	
GRAVEL	550	560	
Green + brown claystone	560	620	
GRAVEL w/ green claystone	620	660	

RECEIVED

RECEIVED

JUN 28 2021

DEC 20 1999

OWRD

WATER RESOURCES DEPT.
SALEM, OREGON

Date started _____ Completed 10-7-99

(unbonded) Water Well Constructor Certification:
I certify that the work I performed on the construction, alteration, or abandonment of this well is in compliance with Oregon water supply well construction standards. Materials used and information reported above are true to the best of my knowledge and belief.

Signed Mad Lou WWC Number 1735 Date 10-17-99

(bonded) Water Well Constructor Certification:
I accept responsibility for the construction, alteration, or abandonment work performed on this well during the construction dates reported above. All work performed during this time is in compliance with Oregon water supply well construction standards. This report is true to the best of my knowledge and belief.

Signed Jamy Burel WWC Number 544 Date 10-17-99