



- POD "ON"
- Pipeline
-  POU IR "ON"
-  Section
- Quarter Quarter
-  Tax Lot
- River



**T22S R9E, WM
DESCHUTES COUNTY, OR**

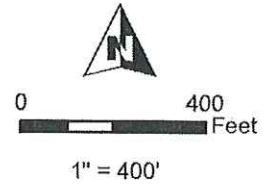

RENEWAL DATE 12/31/2022

POD "ON" Location:
850' S, 820' E of N 1/4 Cor Sec 25

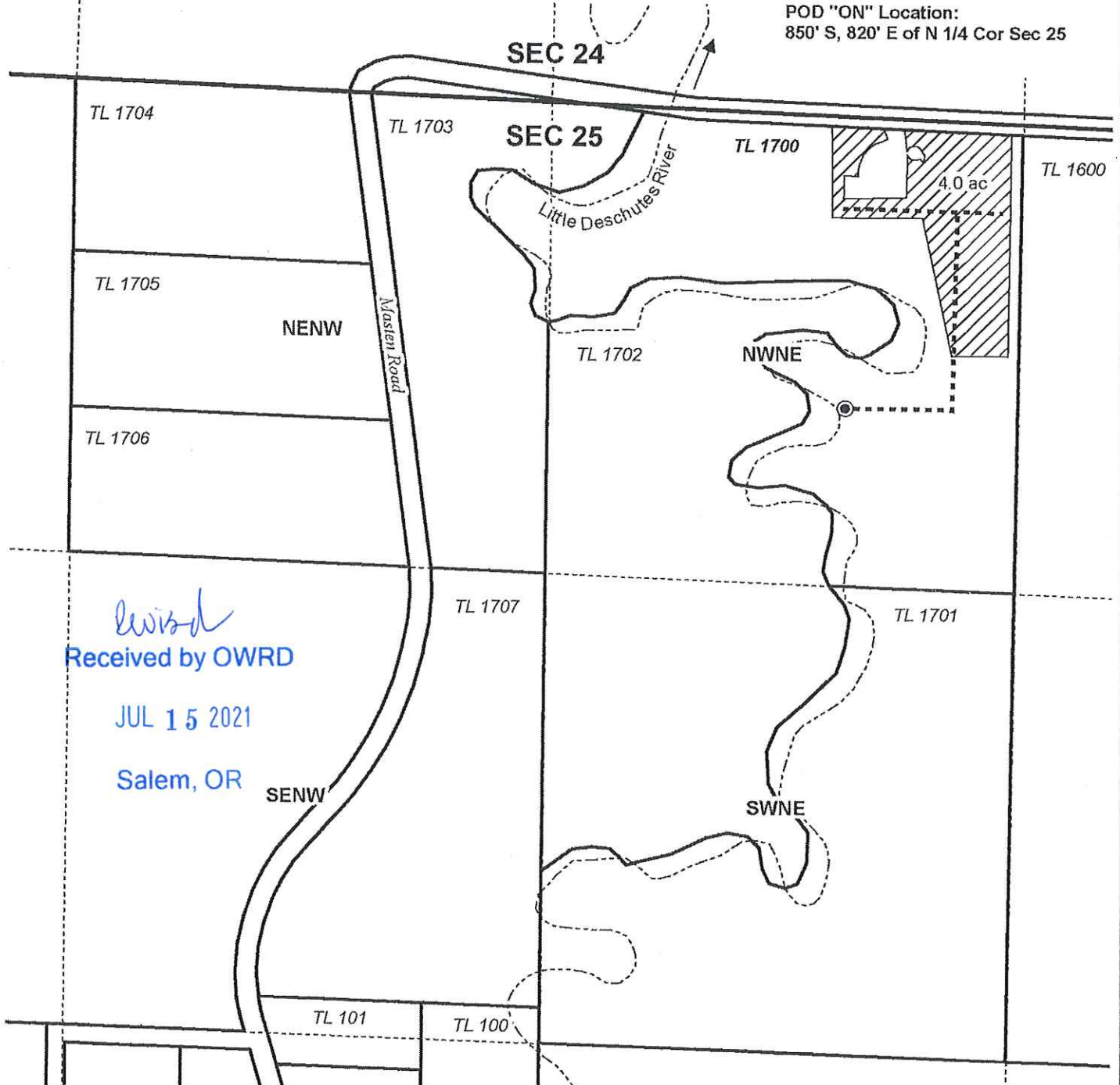

**PERMANENT TRANSFER "ON" MAP
Reed**

Date: 7/13/2021

C-95245

This map is not intended to provide legal dimensions or locations of property ownership lines.

WATER RIGHT SERVICES, LLC
PO BOX 1830, BEND, OR 97709
WWW.OREGONWATER.US CCB # 197121
johnshort@usa.com 541-389-2837

T-13724