

Application for Permanent Water Right Transfer

Part 1 of 5 – Minimum Requirements Checklist



Oregon Water Resources Department
 725 Summer Street NE, Suite A
 Salem, Oregon 97301-1266
 (503) 986-0900
 www.oregon.gov/OWRD

This transfer application will be returned if Parts 1 through 5 and all required attachments are not completed and included.

For questions, please call (503) 986-0900, and ask for Transfer Section.

RECEIVED

DEC 27 2021

Check all items included with this application. (N/A = Not Applicable)

- Part 1 – Completed Minimum Requirements Checklist.
- Part 2 – Completed Transfer Application Map Checklist.
- Part 3 – Application Fee, payable by check to the Oregon Water Resources Department, and completed Fee Worksheet, page 3. Try the new online fee calculator at: http://apps.wrd.state.or.us/apps/misc/wrd_fee_calculator. If you have questions, call Customer Service at (503) 986-0801.
- Part 4 – Completed Applicant Information and Signature.
- Part 5 – Information about Water Rights to be Transferred: **How many water rights are to be transferred? 1 List them here: 89509 (Attachment A)**
 Please include a separate Part 5 for each water right. (See instructions on page 6)

Attachments:

- Completed Transfer Application Map. **(Attachment B)**
- Completed Evidence of Use Affidavit and supporting documentation. **(Attachment C)**
- N/A Affidavit(s) of Consent from Landowner(s) (if the applicant does not own the land the water right is on.)
- N/A Supplemental Form D – For water rights served by or issued in the name of an irrigation district. Complete when the transfer applicant is not the irrigation district. **(Attachment D)**
- N/A Oregon Water Resources Department’s Land Use Information Form with approval and signature (or signed land use form receipt stub) from each local land use authority in which water is to be diverted, conveyed, and/or used. Not required if water is to be diverted, conveyed, and/or used only on federal lands or if all of the following apply: a) a change in place of use only, b) no structural changes, c) the use of water is for irrigation only, and d) the use is located within an irrigation district or an exclusive farm use zone. **(This water right is diverted, conveyed, and used only on federal lands.)**
- N/A Water Well Report/Well Log for changes in point(s) of appropriation (well(s)) or additional point(s) of appropriation. **(Attachment E)**
- N/A Geologist Report for a change from a surface water point of diversion to a ground water point of appropriation (well), if the proposed well is more than 500’ from the surface water source and more than 1000’ upstream or downstream from the point of diversion. See OAR 690-380-2130 for requirements and applicability.

(For Staff Use Only)

WE ARE RETURNING YOUR APPLICATION FOR THE FOLLOWING REASON(S):

<input type="checkbox"/> Application fee not enclosed/insufficient	<input type="checkbox"/> Map not included or incomplete
<input type="checkbox"/> Land Use Form not enclosed or incomplete	<input type="checkbox"/> Evidence of Use Form not enclosed or incomplete
<input type="checkbox"/> Additional signature(s) required	<input type="checkbox"/> Part _____ is incomplete

Other/Explanation _____

Staff: _____ 503-986-0 _____ Date: ____/____/____

13880

Part 2 of 5 – Transfer Application Map

Your transfer application will be returned if any of the map requirements listed below are not met.

Please be sure that the transfer application map you submit includes all the required items and matches the existing water right map. Check all boxes that apply.

- N/A Certified Water Right Examiner (CWRE) Stamp and Original Signature. For a list of CWREs, see http://apps.wrd.state.or.us/apps/wr/cwre_license_view/. CWRE stamp and signature are not required for substitutions.
- N/A If **more than three** water rights are involved, separate maps are needed for each water right.
- Permanent quality printed with dark ink on good quality paper.
- The size of the map can be 8½ x 11 inches, 8½ x 14 inches, 11 x 17 inches, or up to 30 x 30 inches. For 30 x 30 inch maps, one extra copy is required.
- A north arrow, a legend, and scale.
- The scale of the map must be: 1 inch = 400 feet, 1 inch = 1,320 feet, the scale of the Final Proof/Claim of Beneficial Use Map (the map used when the permit was certificated), the scale of the county assessor map if the scale is not smaller than 1 inch = 1,320 feet, or a scale that has been pre-approved by the Department.
- Township, Range, Section, ¼ ¼, DLC, Government Lot, and other recognized public land survey lines.
- Tax lot boundaries (property lines) are required. Tax lot numbers are recommended.
- Major physical features including rivers and creeks showing direction of flow, lakes and reservoirs, roads, and railroads.
- Major water delivery system features from the point(s) of diversion/appropriation such as main pipelines, canals, and ditches.
- Existing place of use that includes separate hachuring for each water right, priority date, and use including number of acres in each quarter-quarter section, government lot, or in each quarter-quarter section as projected within government lots, donation land claims, or other recognized public land survey subdivisions. If less than the entirety of the water right is being changed, a separate hachuring is needed for lands left unchanged.
- N/A Proposed place of use that includes separate hachuring for each water right, priority date, and use including number of acres in each quarter-quarter section, government lot, or in each quarter-quarter section as projected within government lots, donation land claims, or other recognized public land survey subdivisions.
- Existing point(s) of diversion or well(s) with distance and bearing or coordinates from a recognized survey corner. This information can be found in your water right certificate or permit.
- N/A If you are proposing a change in point(s) of diversion or well(s), show the proposed location and label it clearly with distance and bearing or coordinates. If GPS coordinates are used, latitude-longitude coordinates may be expressed as either degrees-minutes-seconds with at least one digit after the decimal (example – 42°32'15.5") or degrees-decimal with five or more digits after the decimal (example – 42.53764°).

RECEIVED

DEC 27 2021

OWRD

DEC 27 2021

Part 3 of 5 – Fee Worksheet

FEE WORKSHEET for PERMANENT TRANSFER (except Substitution) OWEB			
1	Base Fee (includes one type of change to one water right for up to 1 cfs)	1	\$1,360
2	Types of change proposed: <input type="checkbox"/> Place of Use <input type="checkbox"/> Character of Use <input checked="" type="checkbox"/> Point of Diversion/Appropriation Number of above boxes checked = <u>1 (2a)</u> Subtract 1 from the number in line 2a = <u>0 (2b)</u> <i>If only one change, this will be 0</i> Multiply line 2b by \$1090 and enter »	2	\$0
3	Number of water rights included in transfer <u>1 (3a)</u> Subtract 1 from the number in 3a above: <u>0 (3b)</u> <i>If only one water right this will be 0</i> Multiply line 3b by \$610 and enter »	3	\$0
4	Do you propose to add or change a well, or change from a surface water POD to a well? <input type="checkbox"/> No: enter 0 <input checked="" type="checkbox"/> Yes: enter \$480 for the 1 st well to be added or changed <u>\$480 (4a)</u> Do you propose to add or change additional wells? <input type="checkbox"/> No: enter 0 <input checked="" type="checkbox"/> Yes: multiply the number of additional wells by \$410 <u>\$820 (4b)</u> Add line 4a to line 4b and enter »	4	\$1,300
5	Do you propose to change the place of use or character of use? <input checked="" type="checkbox"/> No: enter 0 on line 5 <input type="checkbox"/> Yes: enter the cfs for the portions of the rights to be transferred (see below*): _____ (5a) Subtract 1.0 from the number in 5a above: _____ (5b) If 5b is 0 or less, enter 0 on line 5 » If 5b is greater than 0, round up to the nearest whole number: _____ (5c) and multiply 5c by \$410, then enter on line 5 »	5	\$0
6	Add entries on lines 1 through 5 above » » » » » » » » » » Subtotal:	6	\$2,660
7	Is this transfer: <input type="checkbox"/> necessary to complete a project funded by the Oregon Watershed Enhancement Board (OWEB) under ORS 541.932? <input type="checkbox"/> endorsed in writing by ODFW as a change that will result in a net benefit to fish and wildlife habitat? If one or more boxes is checked, multiply line 6 by 0.5 and enter on line 7 » If no box is applicable, enter 0 on line 7 »	7	\$0
8	Subtract line 7 from line 6 » Transfer Fee:	8	\$2,660

*Example for Line 5a calculation to transfer 45.0 acres of Primary Certificate 12345 (total 1.25 cfs for 100 acres) and 45.0 acres of Supplemental Certificate 87654 (1/80 cfs per acre) on the same land:

1. For irrigation calculate cfs for each water right involved as follows:
 - a. Divide total authorized cfs by total acres in the water right (for C12345, 1.25 cfs ÷ 100 ac); then multiply by the number of acres to be transferred to get the transfer cfs ($\times 45 \text{ ac} = 0.56 \text{ cfs}$).
 - b. If the water right certificate does not list total cfs, but identifies the allowable use as 1/40 or 1/80 of a cfs per acre; multiply number of acres proposed for change by either 0.025 (1/40) or 0.0125 (1/80). (For C87654, $45.0 \text{ ac} \times 0.0125 \text{ cfs/ac} = 0.56 \text{ cfs}$)
2. Add cfs for the portions of water rights on all the land included in the transfer; however **do not count cfs for supplemental rights on acreage for which you have already calculated the cfs fee for the primary right on the same land**. The fee should be assessed only once for each “on the ground” acre included in the transfer. (In this example, blank 5a would be only 0.56 cfs, since both rights serve the same 45.0 acres. Blank 5b would be 0 and Line 5 would then also become 0).

FEE WORKSHEET for SUBSTITUTION			
1	Base Fee (includes change to one well)	1	\$840.00
2	Number of wells included in substitution _____ (2a) Subtract 1 from the number in 2a above: _____ (2b) <i>If only one well this will be 0</i> Multiply line 2b by \$410 and enter »	2	
3	Add entries on lines 1 through 2 above » » » » » » Fee for Substitution:	3	

Part 4 of 5 – Applicant Information and Signature

Applicant Information

APPLICANT/BUSINESS NAME USDA Forest Service, Mt Hood National Forest		PHONE NO.	ADDITIONAL CONTACT NO.
ADDRESS 16400 Champion Way			FAX NO.
CITY Sandy	STATE Oregon	ZIP 97055	E-MAIL
BY PROVIDING AN E-MAIL ADDRESS, CONSENT IS GIVEN TO RECEIVE ALL CORRESPONDENCE FROM THE DEPARTMENT ELECTRONICALLY. COPIES OF THE FINAL ORDER DOCUMENTS WILL ALSO BE MAILED.			

Agent Information – The agent is authorized to represent the applicant in all matters relating to this application.

AGENT/BUSINESS NAME GSI Water Solutions, Inc., Attn: Robyn Cook		PHONE NO. 971-200-8505	ADDITIONAL CONTACT NO.
ADDRESS 55 SW Yamhill Street, Suite 300			FAX NO.
CITY Portland	STATE Oregon	ZIP 97204	E-MAIL rcook@gsiws.com
BY PROVIDING AN E-MAIL ADDRESS, CONSENT IS GIVEN TO RECEIVE ALL CORRESPONDENCE FROM THE DEPARTMENT ELECTRONICALLY. COPIES OF THE FINAL ORDER DOCUMENTS WILL ALSO BE MAILED.			

Explain in your own words what you propose to accomplish with this transfer application, and why:
The US Forest Service is proposing to add additional point(s) of appropriation to Certificate 89509. Several POAs are included in the application to provide flexibility in siting a future well(s).

If you need additional space, continue on a separate piece of paper and attach to the application as "Attachment 1".

Check One Box

- By signing this application, I understand that, upon receipt of the draft preliminary determination and prior to Department approval of the transfer, I will be required to provide landownership information and evidence that I am authorized to pursue the transfer as identified in OAR 690-380-4010(5); **OR**
- I affirm the applicant is a municipality as defined in ORS 540.510(3)(b) and that the right is in the name of the municipality or a predecessor; **OR**
- I affirm the applicant is an entity with the authority to condemn property and is acquiring by condemnation the property to which the water right proposed for transfer is appurtenant and have supporting documentation.

RECEIVED

DEC 27 2021

OWRD

DEC 27 2021

By my signature below, I confirm that I understand:

OWRD

- Prior to Department approval of the transfer application, I may be required to submit payment to the Department for publication of a notice in a newspaper with general circulation in the area where the water right is located, once per week for two consecutive weeks. If more than one qualifying newspaper is available, I suggest publishing the notice in the following newspaper: The Mountain Times.
- Amendments to the application may only be made in response to the Department's Draft Preliminary Determination (DPD). The applicant will have a period of at least 30 days to amend the application to address any issues identified by the Department in the DPD, or to withdraw the application. Note that amendments may be subject to additional fees, pursuant to ORS 536.050.
- Failure to complete an approved change in place of use and/or change in character of use, will result in loss of the water right (OAR 690-380-6010).

I (we) affirm that the information contained in this application is true and accurate.

Meta Loftsgaarden Digitally signed by Meta Loftsgaarden
Date: 2021.12.20 15:51:14 -08'00'

Applicant signature Print Name (and Title if applicable) Date

Is the applicant the sole owner of the land on which the water right, or portion thereof, proposed for transfer is located? Yes No *If NO, include signatures of all deeded landowners (and mailing and/or e-mail addresses if different than the applicant's) or attach affidavits of consent (and mailing and/or e-mail addresses) from all landowners or individuals/entities to which the water right(s) were conveyed.*

Check the following boxes that apply:

- The applicant is responsible for completion of change(s). Notices and correspondence should continue to be sent to the applicant.
- The receiving landowner will be responsible for completing the proposed change(s) after the final order is issued. Copies of notices and correspondence should be sent to this landowner.
- Both the receiving landowner and applicant will be responsible for completion of change(s). Copies of notices and correspondence should be sent to this landowner and the applicant.

At this time, are the lands in this transfer application in the process of being sold? Yes No

If YES, and you know who the new landowner will be, please complete the receiving landowner information table below. If you do not know who the new landowner will be, then a request for assignment will have to be filed for at a later date.

If a property sells, the certificated water right(s) located on the land belong to the new owner, unless a sale agreement or other document states otherwise. For more information see: https://www.oregon.gov/owrd/WRDFormsPDF/Transfer_Property_Transactions.pdf

RECEIVING LANDOWNER NAME			PHONE NO.	ADDITIONAL CONTACT NO.
ADDRESS				FAX NO.
CITY	STATE	ZIP	E-MAIL	
Describe any special ownership circumstances: <u>Lady Creek Water System (OR41 00700) owns and operates the drinking water system under a Special Use Permit from the US Forest Service.</u>				
The confirming Certificate shall be issued in the name of: <input checked="" type="checkbox"/> Applicant <input type="checkbox"/> Receiving Landowner				

13880

Check here if any of the water rights proposed for transfer are or will be located within or served by an irrigation or other water district. (Tip: Complete and attach Supplemental Form D.)

IRRIGATION DISTRICT NAME Lady Creek Water System	ADDRESS PO Box 206	
CITY Welches	STATE OR	ZIP 97067

Check here if water for any of the rights supplied under a water service agreement or other contract for stored water with a federal agency or other entity.

ENTITY NAME N/A	ADDRESS	
CITY	STATE	ZIP



To meet State Land Use Consistency Requirements, you must list all county, city, municipal corporation, or tribal governments within whose jurisdiction water will be diverted, conveyed or used.

ENTITY NAME Clackamas County	ADDRESS 150 Beavercreek Road, Room #225	
CITY Oregon City	STATE Oregon	ZIP 97045

ENTITY NAME	ADDRESS	
CITY	STATE	ZIP

RECEIVED

DEC 27 2021

OWRD

Part 5 of 5 – Water Right Information

Please use a separate Part 5 for each water right being changed. See instructions on page 6, to copy and paste additional Part 5s, or to add additional rows to tables within the form.

CERTIFICATE # 89509

RECEIVED

Description of Water Delivery System

System capacity: _____ cubic feet per second (cfs) OR
500 gallons per minute (gpm)

DEC 27 2021

OWRD

Describe the current water delivery system or the system that was in place at some time within the last five years. Include information on the pumps, canals, pipelines, and sprinklers used to divert, convey, and apply the water at the authorized place of use. **Each of the three existing wells has a pump that pumps water to a common 75,000-gallon above-ground storage tank. From there, water is delivered through an 11.8-mile network of 4-inch water lines to 428 residences (with a potential growth to a total of 440 residences).**

Table 1. Location of Authorized and Proposed Point(s) of Diversion (POD) or Appropriation (POA)

(Note: If the POD/POA name is not specified on the certificate, assign it a name or number here.)

POD/POA Name or Number	Is this POD/POA Authorized on the Certificate or is it Proposed?	If POA, OWRD Well Log ID# (or Well ID Tag # L-___)	Twp		Rng		Sec	¼ ¼		Tax Lot, DLC or Gov't Lot	Measured Distances (from a recognized survey corner)
Well 1	<input checked="" type="checkbox"/> Authorized <input type="checkbox"/> Proposed	CLAC 1910, CLAC 1908	3	S	8	E	16	SW	NW		1780 ft South and 220 ft East from NW corner, Section 16
Well 2	<input checked="" type="checkbox"/> Authorized <input type="checkbox"/> Proposed	CLAC 1907	3	S	8	E	16	SW	NW		1775 ft South and 175 ft East from NW corner, Section 16
Well 3	<input checked="" type="checkbox"/> Authorized <input type="checkbox"/> Proposed	CLAC 1906	3	S	8	E	16	SW	NW		1800 ft South and 180 ft East from NW corner, Section 16
Well 4	<input type="checkbox"/> Authorized <input checked="" type="checkbox"/> Proposed	N/A	3	S	8	E	16	SW	NW		1800 ft South and 200 ft East from NW corner, Section 16
Well 5	<input type="checkbox"/> Authorized <input checked="" type="checkbox"/> Proposed	N/A	3	S	8	E	16	SW	NW		1810 ft South and 310 ft East from NW corner, Section 16
Well 6	<input type="checkbox"/> Authorized <input checked="" type="checkbox"/> Proposed	N/A	3	S	8	E	16	SW	NW		1995 ft South and 555 ft East from NW corner, Section 16

Check all type(s) of change(s) proposed below (change "CODES" are provided in parentheses):

- | | |
|---|--|
| <input type="checkbox"/> Place of Use (POU) | <input type="checkbox"/> Supplemental Use to Primary Use (S to P) |
| <input type="checkbox"/> Character of Use (USE) | <input type="checkbox"/> Point of Appropriation/Well (POA) |
| <input type="checkbox"/> Point of Diversion (POD) | <input checked="" type="checkbox"/> Additional Point of Appropriation (APOA) |
| <input type="checkbox"/> Additional Point of Diversion (APOD) | <input type="checkbox"/> Substitution (SUB) |

- Surface Water POD to Ground Water POA (SW/GW) Government Action POD (GOV)

Will all of the proposed changes affect the entire water right?

- Yes Complete only the Proposed ("to" or "on" lands) section of Table 2 on the next page. Use the "CODES" listed above to describe the proposed changes.
- No Complete all of Table 2 to describe the portion of the water right to be changed.

RECEIVED

DEC 27 2021

OWRD

Please use and attach additional pages of Table 2 as needed.
See page 6 for instructions.

Do you have questions about how to fill-out the tables?
Contact the Department at 503-986-0900 and ask for Transfer Staff.

Table 2. Description of Changes to Water Right Certificate # 89509

List the change proposed for the acreage in each ¼ ¼. If more than one change is proposed, specify the acreage associated with each change. If there is more than one POD/POA involved in the proposed changes, specify the acreage associated with each POD/POA.

AUTHORIZED (the "from" or "off" lands) The listing that appears on the certificate BEFORE PROPOSED CHANGES List only that part or portion of the water right that will be changed.										Proposed Changes (see "CODES" from previous page)	PROPOSED (the "to" or "on" lands) The listing as it would appear AFTER PROPOSED CHANGES are made.									
Twp	Rng	Sec	¼ ¼	Tax Lot	Lot or DLC	Acres	Type of USE listed on Certificate	POD(s) or POA(s) (name or number from Table 1)	Priority Date		Twp	Rng	Sec	¼ ¼	Tax Lot	Lot or DLC	Acres	New Type of USE	POD(s)/ POA(s) to be used (from Table 1)	Priority Date
Entire Place of Use									Well 1, Well 2, Well 3	9/24/1992	Entire Place of Use						N/A	Quasi- Municipal	Well 1, Well 2, Well 3, Well 4, Well 5, Well 6	9/24/1992
TOTAL ACRES:							TOTAL ACRES:													

Additional remarks: _____.

13880

RECEIVED
DEC 27 2021
OWRD

For Place of Use or Character of Use Changes

Are there other water right certificates, water use permits or ground water registrations associated with the "from" or the "to" lands? Yes No

If YES, list the certificate, water use permit, or ground water registration numbers: **11724. However, neither right is for irrigation.**

 Pursuant to ORS 540.510, any "layered" water use such as an irrigation right that is supplemental to a primary right proposed for transfer must be included in the transfer or be cancelled. Any change to a ground water registration must be filed separately in a ground water registration modification application.

For Substitution (ground water supplemental irrigation will be substituted for surface water primary irrigation) **(N/A)**

Ground water supplemental Permit or Certificate # _____;
Surface water primary Certificate # _____.

RECEIVED
DEC 27 2021

For a change from Supplemental Irrigation Use to Primary Irrigation Use (N/A)

Identify the primary certificate to be cancelled. Certificate # _____

OWRD

For a change in point(s) of appropriation (well(s)) or additional point(s) of appropriation:

Well log(s) are attached for each authorized and proposed well(s) that are clearly labeled and associated with the corresponding well(s) in Table 1 above and on the accompanying application map.

Tip: You may search for well logs on the Department's web page at:
http://apps.wrd.state.or.us/apps/gw/well_log/Default.aspx

AND/OR

Describe the construction of the authorized and proposed well(s) in Table 3 for any wells that do not have a well log. For *proposed wells not yet constructed or built*, provide "a best estimate" for each requested information element in the table. The Department recommends you consult a licensed well driller, geologist, or certified water right examiner to assist with assembling the information necessary to complete Table 3.

Table 3. Construction of Point(s) of Appropriation

Any well(s) in this listing must be clearly tied to corresponding well(s) described in Table 1 and shown on the accompanying application map. Failure to provide the information will delay the processing of your transfer application until it is received. The information is necessary for the department to assess whether the proposed well(s) will access the same source aquifer as the authorized point(s) of appropriation (POA). The Department is prohibited by law from approving POA changes that do not access the same source aquifer.

Proposed or Authorized POA Name or Number	Is well already built? (Yes or No)	If an existing well: OWRD Well ID Tag No. L-____	Total well depth	Casing Diameter	Casing Intervals (feet)	Seal depth(s) (intervals)	Perforated or screened intervals (in feet)	Static water level of completed well (in feet)	Source aquifer (sand, gravel, basalt, etc.)	Well-specific rate (cfs or gpm). If less than full rate of water right
Well 1	Yes	CLAC 1910, CLAC 1908	200'	8" 6"	0-71' 0-168'	0-24'	168-200'	25'	Bedrock (Sardine fm)	
Well 2	Yes	CLAC 1907	365'	8" 6"	0-150' 0-190'	0-18'	190-365'	25'	Bedrock (Sardine fm)	

Well 3	Yes	CLAC 1906	200'	8"	0-177'	0-25'	177-200'	45'	Bedrock (Sardine fm)	
Well 4	No	N/A	365'	8"	0-180'	0-180'	180-365'	25'	Bedrock (Sardine fm)	
Well 5	No	N/A	365'	8"	0-180'	0-180'	180-365'	25'	Bedrock (Sardine fm)	
Well 6	No	N/A	365'	8"	0-180'	0-180'	180-365'	25'	Bedrock (Sardine fm)	

RECEIVED

DEC 27 2021

OWRD

13880

STATE OF OREGON
 COUNTY OF CLACKAMAS
 CERTIFICATE OF WATER RIGHT

RECEIVED

DEC 27 2021

OWRD

THIS CERTIFICATE ISSUED TO

U.S.D.A. FOREST SERVICE
 MT HOOD NATIONAL FOREST
 16400 CHAMPION WAY
 SANDY, OR 97055

confirms the right to use the waters of THREE WELLS in the ZIG ZAG RIVER BASIN for QUASI-MUNICIPAL USE.

This right was perfected under Permit G-11788. The date of priority is SEPTEMBER 24, 1992. The amount of water to which this right is entitled is limited to an amount actually used beneficially, and shall not exceed 1.0 CUBIC FOOT PER SECOND (CFS); BEING 0.445 CFS FROM WELL 1, 0.10 CFS FROM WELL 2, AND 0.445 CFS FROM WELL 3, in any combination, or its equivalent in case of rotation, measured at the wells.

The well is located as follows:

Twp	Rng	Mer	Sec	Q-Q	Measured Distances
3 S	8 E	WM	16	SW NW	WELL 1 - 1780 FEET SOUTH & 220 FEET EAST FROM NW CORNER, SECTION 16
3 S	8 E	WM	16	SW NW	WELL 2 - 1775 FEET SOUTH & 175 FEET EAST FROM NW CORNER, SECTION 16
3 S	8 E	WM	16	SW NW	WELL 3 - 1800 FEET SOUTH & 180 FEET EAST FROM NW CORNER, SECTION 16

A description of the place of use is as follows:

Twp	Rng	Mer	Sec	Q-Q	G Lot
3 S	7 E	WM	11	NE SW	8
3 S	7 E	WM	11	SE SW	
3 S	7 E	WM	11	NW SE	7
3 S	7 E	WM	11	SW SE	9
3 S	7 E	WM	13	NW NW	
3 S	7 E	WM	13	SW NW	
3 S	7 E	WM	13	SE NW	
3 S	7 E	WM	13	NE SW	
3 S	7 E	WM	13	SE SW	
3 S	7 E	WM	13	NE SE	4
3 S	7 E	WM	13	NW SE	
3 S	7 E	WM	13	SW SE	
3 S	7 E	WM	13	SE SE	5

NOTICE OF RIGHT TO PETITION FOR RECONSIDERATION OR JUDICIAL REVIEW

This is an order in other than a contested case. This order is subject to judicial review under ORS 183.484 and ORS 536.075. Any petition for judicial review must be filed within the 60-day time period specified by ORS 183.484(2). Pursuant to ORS 183.484, ORS 536.075 and OAR 137-004-0080, you may petition for judicial review and petition the Director for reconsideration of this order. A petition for reconsideration may be granted or denied by the Director, and if no action is taken within 60 days following the date the petition was filed, the petition shall be deemed denied. In addition, under ORS 537.260 any person with an application, permit or water right certificate subsequent in priority may jointly or severally contest the issuance of the certificate within three months after issuance of the certificate.

Twp	Rng	Mer	Sec	Q-Q	G Lot
3 S	7 E	WM	14	NE NE	
3 S	7 E	WM	14	NW NE	
3 S	7 E	WM	14	SW NE	
3 S	7 E	WM	14	NE NW	
3 S	7 E	WM	14	NW SE	
3 S	7 E	WM	24	NE NE	1
3 S	8 E	WM	17	SE NE	
3 S	8 E	WM	17	NE SW	
3 S	8 E	WM	17	NW SW	
3 S	8 E	WM	17	SE SW	
3 S	8 E	WM	17	NE SE	
3 S	8 E	WM	17	NW SE	
3 S	8 E	WM	17	SW SE	
3 S	8 E	WM	18	NE SW	
3 S	8 E	WM	18	NW SW	3
3 S	8 E	WM	18	SW SW	4
3 S	8 E	WM	18	SE SW	
3 S	8 E	WM	18	NE SE	
3 S	8 E	WM	18	NW SE	
3 S	8 E	WM	19	NE NE	
3 S	8 E	WM	19	NE NW	
3 S	8 E	WM	19	NW NW	1
3 S	8 E	WM	20	NE NW	
3 S	8 E	WM	20	NW NW	

RECEIVED

DEC 27 2021

OWRD

Measurement, recording and reporting conditions:

- A. The water user shall maintain the meter or measuring device in good working order.
- B. The water user shall allow the watermaster access to the meter or measuring device; provided however, where the meter or measuring device is located within a private structure, the watermaster shall request access upon reasonable notice.
- C. The Director may require the water user to keep and maintain a record of the amount (volume) of water used and may require the water user to report water use on a periodic schedule as established by the Director. In addition, the Director may require the water user to report general water use information, the periods of water use and the place and nature of use of water under the right. The Director may provide an opportunity for the water user to submit alternative reporting procedures for review and approval.

In the event of a request for a change in point of appropriation, an additional point of appropriation or alteration of the appropriation facility associated with this authorized diversion, the quantity of water allowed herein, together with any other right, shall not exceed the capacity of the facility at the time of perfection of this right.

The right is limited to any deficiency in the available supply of any prior right existing for the same land.

Under this right, water shall only be appropriated from between 168 feet and 177 below the land surface.

Use of water from the wells, as allowed herein, shall be controlled or shut off if any of the wells displays:

- (a) An average water level decline of three or more feet per year for five consecutive years; or
- (b) A total water level decline of fifteen or more feet; or
- (c) A hydraulic interference decline of fifteen or more feet in any neighboring well providing water for senior exempt uses or wells covered by prior rights.

The wells shall be maintained in accordance with the General Standards for the Construction and Maintenance of Water Wells in Oregon. The works shall be equipped with a useable access port, and may also include an air line and pressure gauge adequate to determine water level elevation in the wells at all times.

The Director may require water level or pump test results every ten years.

Failure to comply with any of the provisions of this right may result in action including, but not limited to, restrictions on the use, civil penalties, or cancellation of the right.

This right is for the beneficial use of water without waste. The water user is advised that new regulations may require the use of best practical technologies or conservation practices to achieve this end.

By law, the land use associated with this water use must be in compliance with statewide land-use goals and any local acknowledged land-use plan.

The use of water shall be limited when it interferes with any prior surface or ground water rights.

The right to the use of the water for the above purpose is restricted to beneficial use on the place of use described.

OCT 10 2014

Issued _____

Dwight French
Water Right Services Division Administrator, for
Thomas M. Byler, Director
Oregon Water Resources Department

RECEIVED

DEC 27 2021

OWRD

RECEIVED

DEC 27 2021

OWRD

THE THREE WELLS ARE LOCATED IN THE SW 1/4 OF NW 1/4 OF SECTION 16 TOWNSHIP 3 SOUTH, RANGE 8 EAST of the WM CLACKAMAS COUNTY, STATE OF OREGON

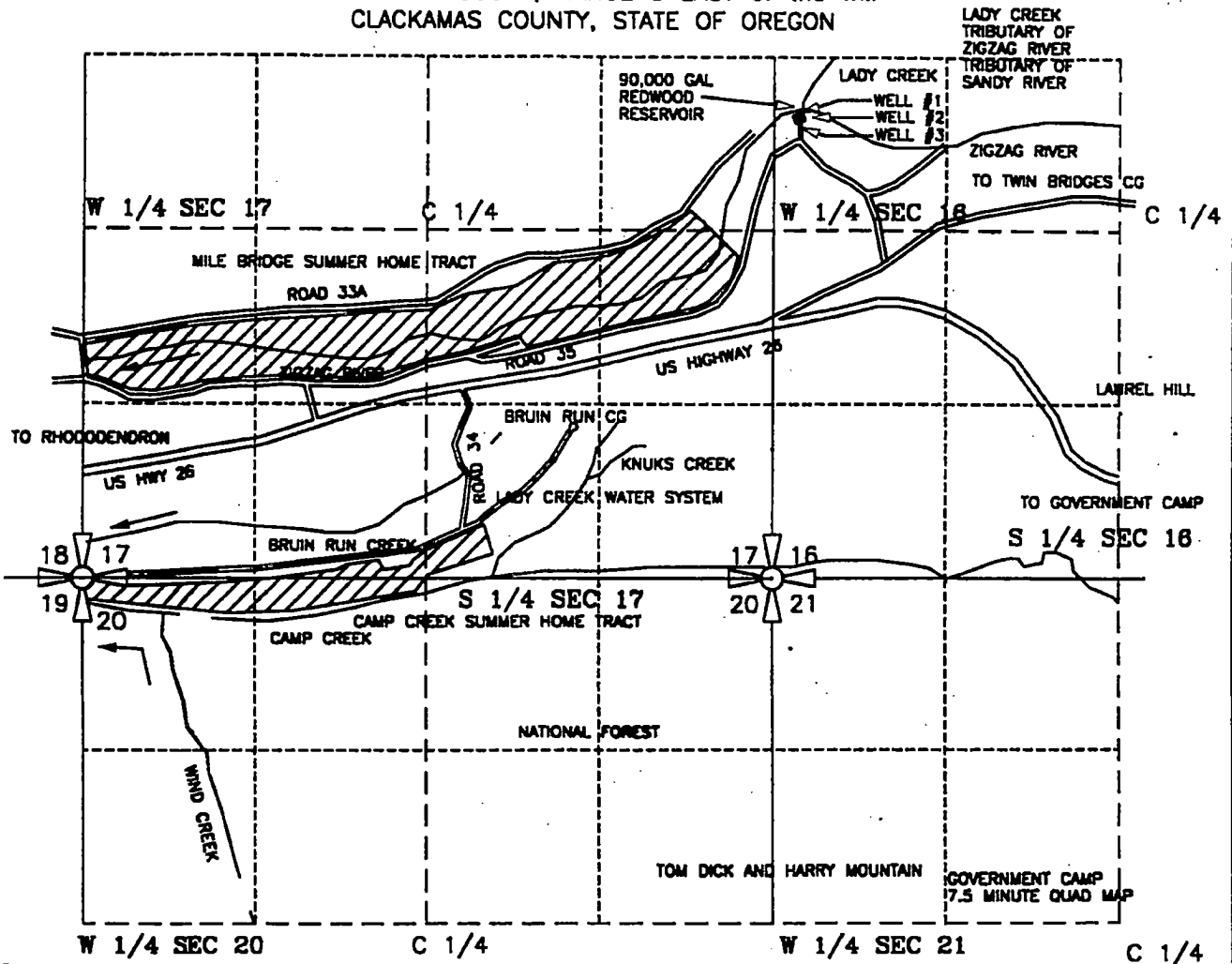

WELL #1 IS LOCATED 1780' SOUTH AND 220' EAST,
 WELL #2 IS LOCATED 1775' SOUTH AND 175' EAST,
 WELL #3 IS LOCATED 1800' SOUTH AND 180' EAST OF THE
 NORTHWEST CORNER OF SECTION 16, TOWNSHIP 3 SOUTH,
 RANGE 8 EAST OF THE WILLAMETTE MERIDIAN, CLACKAMAS
 COUNTY, STATE OF OREGON.

SIGNED: *Edward A. Crane*
 RENEWAL: DEC. 31, 1999

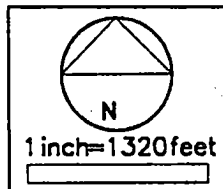
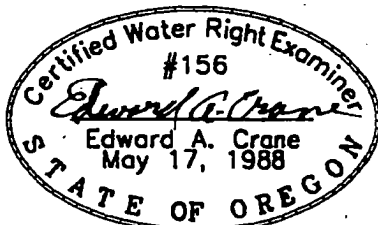

MT HOOD NATIONAL FOREST
 FINAL PROOF SURVEY
 GROUNDWATER PERMIT G-11788

PREPARED BY EDWARD A. CRANE, CWRE

PREPARATION OF THIS MAP WAS FOR THE PURPOSE
 OF IDENTIFYING THE LOCATION OF THE WATER RIGHTS
 ONLY AND HAS NO INTENT TO PROVIDE DIMENSIONS
 OR LOCATION OF PROPERTY OWNERSHIP LINES.

SURVEYED JAN. 23, 1998
 BY EDWARD A. CRANE, CWRE

HAWP_PROD\280-001\28000101.DWG

DATE MAR. 1998		CRANE & MERSETH Engineering/Surveying SUITE "D" 6566 SE LAKE ROAD MILWAUKIE, OREGON 97222 BUS: (503) 654-2005 FAX: (503) 654-2575	APPLICATION FOR PERMIT NUMBER G-13132 PERMIT NUMBER <u>G-11788</u> IN THE NAME OF:	SHEET 1/2
PROJECT NO. 280-001		ZIG ZAG RANGER DISTRICT MT. HOOD NATIONAL FOREST U.S.D.A. - U.S. FOREST SERVICE		

RECEIVED

DEC 27 2021

OWRD

Attachment B

Maps

Transfer Application for Certificate 89509

13880

RECEIVED

DEC 27 2021

OWRD

Attachment C

Affidavit and Evidence of Water Use

Transfer Application for Certificate 89509

13880

≡≡

Application for Water Right Transfer

Evidence of Use Affidavit



Oregon Water Resources Department
 725 Summer Street NE, Suite A
 Salem, Oregon 97301-1266
 (503) 986-0900
 www.wrd.state.or.us

Please print legibly or type. Be as specific as possible. Attach additional pages if you need more spacing.
 Supporting documentation must be attached.

RECEIVED

State of Oregon)
) ss
 County of CLACAMAS)

DEC 27 2021

I, DAVID JACOB, in my capacity as WATER SYSTEM ENGINEER,

OWRD

mailing address PO BOX 327, RHODODENDRON, OR 97049

telephone number (503)310-9262, being first duly sworn depose and say:

1. My knowledge of the exercise or status of the water right is based on (check one):

- Personal observation Professional expertise

2. I attest that:

Water was used during the previous five years on the **entire** place of use for Certificate # 89509; **OR**

My knowledge is specific to the use of water at the following locations within the last five years:

Certificate #	Township	Range	Mer	Sec	¼ ¼	Gov't Lot or DLC	Acres (if applicable)

OR

- Confirming Certificate # _____ has been issued within the past five years; **OR**
- Part or all of the water right was leased instream at some time within the last five years. The instream lease number is: _____ (Note: If the entire right proposed for transfer was not leased, additional evidence of use is needed for the portion not leased instream.); **OR**
- The water right is not subject to forfeiture and documentation that a presumption of forfeiture for non-use would be rebutted under ORS 540.610(2) is attached.
- Water has been used at the actual current point of diversion or appropriation for more than 10 years for Certificate # _____ (For Historic POD/POA Transfers)

(continues on reverse side)

13880

3. The water right was used for: (e.g., crops, pasture, etc.): DOMESTIC USE

4. I understand that if I do not attach one or more of the documents shown in the table below to support the above statements, my application will be considered incomplete.

RECEIVED

[Signature]
Signature of Affiant

7-9-2021
Date

DEC 27 2021

OWRD

Signed and sworn to (or affirmed) before me this 9 day of July, 2021.



[Signature]
Notary Public for Oregon

My Commission Expires: July 08, 2023

Supporting Documents	Examples
<input type="checkbox"/> Copy of a water right certificate that has been issued within the last five years. (not a remaining right certificate)	Copy of confirming water right certificate that shows issue date
<input type="checkbox"/> Copies of receipts from sales of irrigated crops or for expenditures related to use of water	<ul style="list-style-type: none"> • Power usage records for pumps associated with irrigation use • Fertilizer or seed bills related to irrigated crops • Farmers Co-op sales receipt
<input checked="" type="checkbox"/> Records such as FSA crop reports, irrigation district records, NRCS farm management plan, or records of other water suppliers	<ul style="list-style-type: none"> • District assessment records for water delivered • Crop reports submitted under a federal loan agreement • Beneficial use reports from district • IRS Farm Usage Deduction Report • Agricultural Stabilization Plan • CREP Report
<input type="checkbox"/> Aerial photos containing sufficient detail to establish location and date of photograph	<p>Multiple photos can be submitted to resolve different areas of a water right. If the photograph does not print with a "date stamp" or without the source being identified, the date of the photograph and source should be added.</p> <p>Sources for aerial photos: OSU – www.oregonexplorer.info/imagery OWRD – www.wrd.state.or.us Google Earth – earth.google.com TerraServer – www.terra-server.com</p>
<input type="checkbox"/> Approved Lease establishing beneficial use within the last 5 years	Copy of instream lease or lease number

13880

Lady Creek monthly operator report

Jan-16

DATE	TIME	Cl	Peak flow	Low flow	tank level	Read	use	Average Demand	Pr station	meter no	date read	
		PPM				97878	1000's	gpm			2/2/2016	
1/1/16	Fri		60.5	24.6		97878			35	62045927	33424167	
1/2/16	Sat	12:00	57.8	25.6	15	98066	188	32.64	4.00	35a	62472971	37526218
1/3/16	Sun		43	18.2		98066				30a	62123512	35965973
1/4/16	Mon		26.4	17.6		98066				29	62156803	47280783
1/5/16	Tue		29.3	19.4		98066				28a	62311246	18697797
1/6/16	Wed	18:00	51	27.1	15	98227	161	27.95	4.00	28b	65118783	15499903
1/7/16	Thu		45	40.1		98227				26	62156804	30649460
1/8/16	Fri		56	39.7		98227				20e	62123514	44233872
1/9/16	Sat		50.5	39.4		98227				20	65118782	14724110
1/10/16	Sun		53.9	39.4		98227				20d	69802383	48244806
1/11/16	Mon	13:00	48.8	38.3	15	98507	280	38.89	5.00	20T	69802384	75853493
1/12/16	Tue		41.3	17.4		98507						735423
1/13/16	Wed		21.2	16.7		98507						
1/14/16	Thu		35.8	17.8		98507						
1/15/16	Fri	13:00	37.4	19.5	15	98654	147	25.52	4.00			
1/16/16	Sat		36.4	19.3		98654						
1/17/16	Sun		38.9	20.4		98654						
1/18/16	Mon	12:00	43.2	19	15	98770	116	26.85	3.00			
1/19/16	Tue		22.4	17.1		98770						
1/20/16	Wed		26.9	17		98770						
1/21/16	Thu		21.4	16.6		98770						
1/22/16	Fri		39.9	17.8		98770						
1/23/16	Sat		39	20.7		98770						
1/24/16	Sun		40.4	21.2		98770						
1/25/16	Mon	15:00	27.7	18.1	15	98982	212	21.03	7.00			
1/26/16	Tue		21.7	17.3		98982						
1/27/16	Wed		20.3	16.9		98982						
1/28/16	Thu		24.6	16.8		98982						
1/29/16	Fri	15:30	40.8	17	15	99092	110	19.10	4.00			
1/30/16	Sat		41.2	20.7		99092						
1/31/16	Sun		41.1	17.7		99092						
			60.5	16.6			1214					

1000's of gallons
this month

08881

RECEIVED

DEC 27 2021

OWRD

Lady Creek monthly operator report

Feb-16

DATE	TIME	CI	Peak flow	Low flow	tank level	Read	use	Average Demand	Pr station	meter no	gpm	date read
		PPM				MT/YR	1000's	gpm				2/29/2016
2/1/16	Mon	0.40	20.8	16.6		99092						
2/2/16	Tue		25.7	16.5		99189	97					
2/3/16	Wed		20.1	16.2		99189		0.00	4.00	35	62045927	34063977
2/4/16	Thu		29.5	16.1		99189				35a	62472971	37526218
2/5/16	Fri	0.40	31	17	15	99297	108	18.75	4.00	30a	62123512	35785571
2/6/16	Sat		32.2	17.7		99297		#DIV/0!		29	62156803	51297665
2/7/16	Sun		36.4	17.2		99297				28a	62311246	18747942
2/8/16	Mon	0.40	20.3	16.3	15	99386	89	20.60	3.00	28b	65118783	15766771
2/9/16	Tue		21.5	16.2		99386				26	62156804	32308859
2/10/16	Wed		26.3	11.4		99386				20e	62123514	45695766
2/11/16	Thu		22.1	10.8		99386				20	65118782	14726694
2/12/16	Fri	0.40	22.9	10.9	15	99479	93	16.15	4.00	20d	69802383	48995345
2/13/16	Sat		37	14.5		99479				20T	69802384	75996337
2/14/16	Sun		41.7	19.4		99479						8327810
2/15/16	Mon	0.40	28.8	11.9	15	99569	90	20.83	3.00			
2/16/16	Tue		14	10.8		99569						
2/17/16	Wed		15.3	10.5		99569						
2/18/16	Thu		15.8	10.3		99569						
2/19/16	Fri	0.40	28.9	13.1	15	99643	74	12.85	4.00			
2/20/16	Sat		27	15		99643						
2/21/16	Sun		33.6	11.3		99643						
2/22/16	Mon	0.40	18.3	10.6	15	99724	81	18.75	3.00			
2/23/16	Tue		17.5	10.3		99724			4.00			
2/24/16	Wed		14	10.3		99724						
2/25/16	Thu	0.50	28.2	10.2	15	99772	48	11.11	3.00			
2/26/16	Fri		21	12.2		99772						
2/27/16	Sat		26.3	13.5		99772						
2/28/16	Sun		28.9	11		99772						
2/29/16	Mon	0.40	13.2	10.1	15	99867	95	16.49	4.00			
			41.7	10.1			775					

1000's of gallons this month

RECEIVED

DEC 27 2021

OWRD

Lady Creek monthly operator report

Mar-16

DATE	TIME	CI	Peak flow	Low flow	tank level	Read	use	Average Demand	Pr station	meter no	gpm	date read	
		PPM				MT/YR	1000's	gpm				3/31/2016	
3/1/16	Tue		14.9	9.9		99867							
3/2/16	Wed		16.1	10.3		99867			35	62045927		34710530	
3/3/16	Thu		20.1	10.3		99867			35a	62472971		37526218	
3/4/16	Fri	16:00	0.40	34.2	10.9	15	99940	73	12.67	4.00	30a	62123512	35878991
3/5/16	Sat			31.2	12.1		99940				29	62156803	56475319
3/6/16	Sun			18.9	10.5		99940				28a	62311246	19426209
3/7/16	Mon	10:00	0.50	13.5	10.5	15	7	67	15.51	3.00	28b	65118783	16046701
3/8/16	Tue			19.8	10.5		7				26	62156804	34464558
3/9/16	Wed			20.1	11.9		7				20e	62123514	47663187
3/10/16	Thu			38.2	11		7				20	65118782	14732776
3/11/16	Fri			42.3	12		7				20d	69802383	49736101
3/12/16	Sat	11:00	0.40	40.2	22		109	102	14.17	5.00	20T	69802384	76362341
3/13/16	Sun			24.9	12.3		109						970198
3/14/16	Mon			15.5	11.1		109						
3/15/16	Tue			15.5	10.9		109						
3/16/16	Wed			19.3	11.5		109						
3/17/16	Thu			23.9	11.2		109						
3/18/16	Fri	15:00	0.40	30.8	13.1		250	141	16.32	6.00			
3/19/16	Sat			37.2	14.5		250						
3/20/16	Sun			25.1	13.1		250						
3/21/16	Mon	11:25	0.40	25.2	13		324	74	12.85	4.00			
3/22/16	Tue			29.8	12.5		324						
3/23/16	Wed			31.3	21		324						
3/24/16	Thu			39.9	21.8		324						
3/25/16	Fri	12:00	0.30	40.6	26.2	14	442	118	20.49	4.00			
3/26/16	Sat			35.2	22.5		442						
3/27/16	Sun			25.4	21.3		442						
3/28/16	Mon	10:20	0.40	25.1	20.6		546	104	24.07	3.00			
3/29/16	Tue			25.1	13.1		546						
3/30/16	Wed			19.9	11.8		546						
3/31/16	Thu						546						
							679						
			42.3	9.9									

1000's of gallons this month

13880

RECEIVED

DEC 27 2021

OWRD

Lady Creek monthly operator report

MT/YR

Apr-16

DATE	TIME	Cl	Peak flow	Low flow	tank level	Read	use	Average Demand	Pr station	meter no	gpm	date read
		PPM				546	1000's	gpm				5/1/2016
4/1/16	Fri 16:00	0.40	23.3	11.6		659	113	19.62	35	62045927		
4/2/16	Sat		28.5	13.3		659			35a	62472971		35191428
4/3/16	Sun		32	15.3		659						37526218
4/4/16	Mon 13:00	0.40	20.4	14.9		733	74	17.13	30a	62123512		35927306
4/5/16	Tue		19.2	13.2		733			29	62156803		60224283
4/6/16	Wed		14	7.3		733			28a	62311246		19536527
4/7/16	Thu		16.1	7.2		733			28b	65118783		16167664
4/8/16	Fri 11:00	0.40	17.6	7.4		804	71	12.33	26	62156804		36534212
4/9/16	Sat		23.9	9.3		804			20e	62123514		49591263
4/10/16	Sun		29.8	8.2		804			20	65118782		14735913
4/11/16	Mon 11:00	0.40	18.2	7.9		868	64	14.81	20d	69802383		50456346
4/12/16	Tue		10.2	7.6		868			20f	69802384		76523876
4/13/16	Wed		12.4	8		868						1077153
4/14/16	Thu		17.7	9.2		868						
4/15/16	Fri 12:30	0.40	18.2	11.5		927	59	10.24				
4/16/16	Sat		29.4	8.8		927						
4/17/16	Sun		30	10.2		927						
4/18/16	Mon 9:30	0.40	19.7	9.2		990	63	14.58				
4/19/16	Tue		22.2	9		990						
4/20/16	Wed		22.7	9		990						
4/21/16	Thu		15.1	9.6		990						
4/22/16	Fri 10:00	0.40	18.6	10.1		1050	60	10.42				
4/23/16	Sat		26.6	9.9		1050						
4/24/16	Sun		25.4	10.3		1050						
4/25/16	Mon 10:30	0.40	15.8	9.8		1119	69	15.97				
4/26/16	Tue		13.4	10		1119						
4/27/16	Wed		13.2	10		1119						
4/28/16	Thu		13.4	10.1		1119						
4/29/16	Fri 11:40	0.50	21.5	9.3		1179	60	10.42				
4/30/16	Sat		25.2	11.3		1179						
			32	7.2			633					

1000's of gallons
this month

RECEIVED

DEC 27 2021

OWRD

Lady Creek monthly operator report

May-16

DATE	TIME	Cl	Peak flow	Low flow	tank level	Read	use	Average Demand	Pr station	meter no	gpm	date read	5/30/2016
		PPM				1179	1000's	gpm					
5/1/16	Sun		27.6	10.2		1179							
5/2/16	Mon	16:30	27.7	9.7	15	1244	65	#DIV/0!	35	62045927			35667748
5/3/16	Tue		31.7	27.7		1244			35a	62472971			37526218
5/4/16	Wed		30.3	9.8		1244			30a	62123512			35979954
5/5/16	Thu		13.2	9.9		1244			29	62156803			63742696
5/6/16	Fri	11:45	17.2	10.3	15	1345	101	17.53	4.00	28a	62311246		19581195
5/7/16	Sat		20.3	10.8		1345				28b	65118783		16311957
5/8/16	Sun		21.3	11.2		1345				26	62156804		38568267
5/9/16	Mon	11:00	13.2	8.4	15	1408	63	14.58	3.00	20e	62123514		51120974
5/10/16	Tue		14	8.5		1408				20	65118782		14737900
5/11/16	Wed		21.5	8.4		1408				20d	69802383		51087702
5/12/16	Thu		15.8	8.5		1408				20T	69802384		76679701
5/13/16	Fri	19:00	22.2	9	15	1469	61	10.59	4.00				1175362
5/14/16	Sat		26.6	13.5		1469							
5/15/16	Sun		28.4	9		1469							
5/16/16	Mon	11:30	16.3	8.4	15	1531	62	14.35	3.00				
5/17/16	Tue		18.5	8.3		1531							
5/18/16	Wed		15.6	7.9		1531							
5/19/16	Thu		13.9	10.3		1531							
5/20/16	Fri	17:30	19.6	10.7	15	1596	65	11.28	4.00				
5/21/16	Sat		21.7	12.4		1596							
5/22/16	Sun		23.5	8.9		1596							
5/23/16	Mon	12:00	13.1	8.1	15	1661	65	15.05	3.00				
5/24/16	Tue		11.3	7.5		1661							
5/25/16	Wed		12.7	7.6		1661							
5/26/16	Thu		12.9	7.8		1661							
5/27/16	Fri	12:00	24.2	8	15	1705	44	7.64	4.00				
5/28/16	Sat		34	10.5		1705							
5/29/16	Sun		43.9	9.9		1705							
5/30/16	Mon	19:00	40.5	8.9	15	1804	99	22.92	3.00				
5/31/16	Tue		12.2	7.3		1804							

1000's of gallons
this month

13880

RECEIVED

DEC 27 2021

OWRD

Lady Creek monthly operator report

Jun-16

DATE	TIME	Cl	Peak flow	Low flow	tank level	Read	use	Average Demand	Pr station	meter no	gpm	date read	7/2/2016
		PPM				1804	1000's	gpm					
6/1/16	Wed		22.2	7.3		1804		0.00	3.00	35	62045927		36350291
6/2/16	Thu		14.3	7.3		1804				35a	62472971		37526218
6/3/16	Fri	10:00	0.40	16.8	7.5	15	1850	46		30a	62123512		36003327
6/4/16	Sat		26.9	8.1		1850				29	62156803		67437519
6/5/16	Sun		24.9	8.2		1850		0.00	4.00	28a	62311246		19610020
6/6/16	Mon	17:00	0.40	14.2	7.3	15	1914	64		28b	65118783		16443571
6/7/16	Tue		19.6	7.2		1914				26	62156804		40891535
6/8/16	Wed		16.3	7.2		1914		0.00	3.00	20e	62123514		53264971
6/9/16	Thu		20.3	8.9		1914				20	65118782		14740239
6/10/16	Fri	13:00	0.40	32.9	9.2	15	1973	59		20d	69802383		51840876
6/11/16	Sat		40.1	27.1		1973				20T	69802384		76947561
6/12/16	Sun		44	26.8		1973		0.00	4.00				1300365
6/13/16	Mon	13:00	0.40	41.3	26.2	15	2093	120					
6/14/16	Tue		40.6	34.9		2093							
6/15/16	Wed		41.1	27.8		2093		0.00	3.00				
6/16/16	Thu		32.9	11.9		2093							
6/17/16	Fri	11:00	0.40	33.3	10.6	15	2243	150					
6/18/16	Sat		28.1	10.8		2243							
6/19/16	Sun		32.4	11.9		2243		0.00	4.00				
6/20/16	Mon	12:00	0.40	20.4	10.7	15	2322	79					
6/21/16	Tue		21	10.7		2322							
6/22/16	Wed		21.1	10.7		2322		0.00	3.00				
6/23/16	Thu		21.7	10.9		2322							
6/24/16	Fri	17:00	0.40	26	11.2	15	2411	89					
6/25/16	Sat		35.3	12.1		2411							
6/26/16	Sun		39.7	13.5		2411		0.00	4.00				
6/27/16	Mon	19:00	0.40	20.7	11.3	15	2492	81					
6/28/16	Tue		17	11.2		2492							
6/29/16	Wed		19	11.7		2492		0.00	3.00				
6/30/16	Thu	19:30	0.40	19.5	11.4	15	2542	50					
			44	7.2				738					

1000's of gallons this month

RECEIVED

DEC 27 2021

OWRD

Lady Creek monthly operator report

Jul-16

DATE	TIME	Cl	Peak flow	Low flow	tank level	Read	use	Average Demand	Pr station	meter no	gpm	date read	7/30/2016
		PPM				2542	1000's	gpm					
7/1/16	Fri		34.6	11.7		2542							
7/2/16	Sat		40.6	12.6		2542							
7/3/16	Sun		54.5	15.5		2542							
7/4/16	Mon	14:00	0.40	56.2	14.4	2696	154	35.65	3.00	30a	62123512		36065893
7/5/16	Tue			28.5	13	2696				29	62156803		71122027
7/6/16	Wed			22.5	12.1	2696				28a	62311246		19658638
7/7/16	Thu			20.6	10.4	2696				28b	65118783		16612394
7/8/16	Fri	17:00	0.40	20.8	9.5	2784	88	15.28	4.00	26	62156804		43011802
7/9/16	Sat			28.8	11.9	2784				20e	62123514		55227263
7/10/16	Sun			30.5	10.4	2784				20	65118782		14743499
7/11/16	Mon	13:00	0.40	18.9	9.8	2843	59	13.66	3.00	20d	69802383		52706747
7/12/16	Tue			19.2	9.9	2843				20T	69802384		77348276
7/13/16	Wed			19.5	9.9	2843							1451961
7/14/16	Thu			27.9	8.9	2843							
7/15/16	Fri	14:20	0.40	24.6	13.4	2935	92	15.97	4.00				
7/16/16	Sat			28	10.3	2935							
7/17/16	Sun			31.4	10.4	2935							
7/18/16	Mon	12:30	0.40	18.9	9.5	2998	63	14.58	3.00				
7/19/16	Tue			23.8	9.5	2998							
7/20/16	Wed			21.2	9	2998							
7/21/16	Thu			23.5	13.8	2998							
7/22/16	Fri	12:50	0.40	30.4	14	3081	83	14.41	4.00				
7/23/16	Sat			33.9	16.8	3081							
7/24/16	Sun			39.2	10.9	3081							
7/25/16	Mon	11:00	0.30	22.3	10.5	3163	82	18.98	3.00				
7/26/16	Tue			18.2	10.5	3163							
7/27/16	Wed			24.4	12	3163							
7/28/16	Thu			32.7	11.5	3163							
7/29/16	Fri	10L30	0.40	35.7	12.5	3252	89	15.45	4.00				
7/30/16	Sat			39.1	14.7	3252							
7/31/16	Sun			44.1	14.7	3252							
				56.2	8.9		710						

1000's of gallons
this month

13880

RECEIVED

DEC 27 2021

OWRD

Lady Creek monthly operator report

Aug-16

DATE	TIME	CI	Peak flow	Low flow	tank level	Read	use	Average Demand	Pr station	meter no	date read
		PPM				MT/YR	1000's	gpm			9/4/2016
8/1/16	Mon	14:00	0.40	23.9	12.5	15	3252				
8/2/16	Tue			26.5	13.1		3353	101	23.38	3.00	
8/3/16	Wed			24.2	12.8		3353				37909333
8/4/16	Thu			32	12.9		3353				37526218
8/5/16	Fri	12:00	0.40	29.2	12.9	15	3447	94	16.32	4.00	36157506
8/6/16	Sat			38	13.9		3447				76999409
8/7/16	Sun			38.2	14		3447				19718616
8/8/16	Mon	11:00	0.40	29.1	13.5	15	3530	83	19.21	3.00	17172045
8/9/16	Tue			25.1	13.4		3530				45610110
8/10/16	Wed			22.9	12.8		3530				57544756
8/11/16	Thu			34.6	13.4		3530				14749776
8/12/16	Fri	11:50	0.40	29.4	13.2	15	3630	100	17.36	4.00	53627514
8/13/16	Sat			43.8	14.1		3630				77742411
8/14/16	Sun			47.3	14.6		3630				1618678
8/15/16	Mon			32	13.4		3630				
8/16/16	Tue	10:15	0.40	29.4	14.1	15	3757	127	29.40	3.00	
8/17/16	Wed			25.3	12.8		3757				
8/18/16	Thu			30.3	14		3757				
8/19/16	Fri	10:40	0.40	42.3	19	15	3842	85	14.76	4.00	
8/20/16	Sat			46.6	14.3		3842				
8/21/16	Sun			51.6	14.1		3842				
8/22/16	Mon			31.8	18.8		3842				
8/23/16	Tue			30.7	18.8		3842				
8/24/16	Wed			34.6	19		3842				
8/25/16	Thu			36.4	19.2		3842				
8/26/16	Fri	12:15	0.40	39.1	19.7	15	4090	248	24.60	7.00	
8/27/16	Sat			50.5	20.5		4090				
8/28/16	Sun			42.2	20.2		4090				
8/29/16	Mon	17:51	0.40	33.4	19.6	15	4209	119	27.55	3.00	
8/30/16	Tue			27.6	18.9		4209				
8/31/16	Wed			26.6	18.9		4209				
							957	1000's of gallons this month			

RECEIVED

DEC 27 2021

OWRD

Lady Creek monthly operator report

Sep-16

DATE	TIME	CI	Peak flow	Low flow	tank level	Read	use	Average Demand	Pr station	meter no	gpm	date read
		PPM				MT/YR	1000's	gpm	days			10/2/2016
9/1/16	Thu		27	18.9		4209						
9/2/16	Fri	12:00	0.40	32.5	19.5	4209	121	21.01	3.00	35	62045927	38537171
9/3/16	Sat			46.2	20.9	4330			4.00	35a	62472971	37528453
9/4/16	Sun			56.7	22.6	4330				30a	62123512	35589069
9/5/16	Mon	15:07	0.40	56.6	20.5	4469	139	32.18	3.00	29	62156803	81791852
9/6/16	Tue			28.4	19.8	4469				28a	62311246	19857664
9/7/16	Wed			29.3	19	4469				28b	65118783	17266474
9/8/16	Thu			26.4	18.6	4469				26	62156804	47590401
9/9/16	Fri	8:50	0.40	30.8	18.6	4573	104	18.06	4.00	20e	62123514	59384898
9/10/16	Sat			42.7	19	4573				20	65118782	14752490
9/11/16	Sun			40.5	19.8	4573				20d	69802383	54341003
9/12/16	Mon	10:00	0.40	28.9	20.4	4685	112	25.93	3.00	20T	69802384	78002036
9/13/16	Tue			31.9	21.6	4685				20y	79433733	1735031
9/14/16	Wed			27.2	17.9	4685						
9/15/16	Thu			24.4	10.6	4685						
9/16/16	Fri	10:15	0.40	18.2	10.2	4773	88	15.28	4.00			
9/17/16	Sat			32.3	10.5	4773						
9/18/16	Sun			38.5	11.1	4773						
9/19/16	Mon	10:00	0.40	18.9	10.3	4872	99	22.92	3.00			
9/20/16	Tue			19.2	10.4	4872						
9/21/16	Wed			18.8	8	4872						
9/22/16	Thu			18.8	10.5	4872						
9/23/16	Fri	10:15	0.40	17.1	10.9	4946	74	12.85	4.00			
9/24/16	Sat			24	11.5	4946						
9/25/16	Sun			28.5	11.7	4946						
9/26/16	Mon	11:30	0.30	22.2	10.9	5012	66	15.28	3.00			
9/27/16	Tue			26.7	10.9	5012						
9/28/16	Wed			18.1	10.9	5012						
9/29/16	Thu			17.9	10.9	5012						
9/30/16	Fri	11:40	0.30	17.5	11.2	5087	75	13.02	4.00			

878

1000's of gallons
this month

13880

RECEIVED

DEC 27 2021

OWRD

Lady Creek monthly operator report

Oct-16

DATE	TIME	Cl	Peak flow	Low flow	tank level	Read	use	Average Demand	Pr station	meter no	gpm	date read	10/31/2016
		PPM				5087	1000's	gpm	days				
10/1/16	Sat		32.4	12.6		5087							
10/2/16	Sun		33.5	12.5		5087				35	62045927		39042798
10/3/16	Mon	12:30	0.40	22.4	11.9	15	5165	78	18.06	3.00	35a	62472971	37553340
10/4/16	Tue			18.4	11.4		5165				30a	62123512	34700672
10/5/16	Wed			15.8	11.4		5165				29	62156803	86028723
10/6/16	Thu			19.1	11.4		5165				28a	62311246	19894513
10/7/16	Fri	16:30	0.40	24.7	11.4	15	5247	82	14.24	4.00	28b	65118783	17342894
10/8/16	Sat			27.2	12.8		5247				26	62156804	49519637
10/9/16	Sun			30.3	12.5		5247				20e	62123514	61223337
10/10/16	Mon	14:45	0.40	18.9	12	15	5314	67	15.51	3.00	20	65118782	14754964
10/11/16	Tue			15.6	11.9		5314				20d	69802383	54922771
10/12/16	Wed			22.2	11.7		5314				20T	69802384	78179143
10/13/16	Thu			16	11.6		5314						1823277
10/14/16	Fri	11:11	0.40	23.3	11.7	15	5389	75	13.02	4.00			
10/15/16	Sat			26	12.4		5389						
10/16/16	Sun			26.2	12		5389						
10/17/16	Mon	10:15	0.40	20.4	11.7	15	5455	66	15.28	3.00			
10/18/16	Tue			19.1	12		5455						
10/19/16	Wed			15.9	11.8		5455						
10/20/16	Thu			18.4	12.1		5455						
10/21/16	Fri	11:30	0.40	19.2	12	15	5521	66	11.46	4.00			
10/22/16	Sat			29.8	13.4		5521						
10/23/16	Sun			32.6	14.9		5521						
10/24/16	Mon	11:00	0.40	21.2	14	15	5604	83	19.21	3.00			
10/25/16	Tue			17.6	14		5604						
10/26/16	Wed			18.5	13.8		5604						
10/27/16	Thu			33.6	13.9		5604						
10/28/16	Fri	11:45	0.40	33.1	15.6	15	5720	116	20.14	4.00			
10/29/16	Sat			31.3	12.9		5720						
10/30/16	Sun			27.1	12.5		5720						
10/31/16	Mon	11:57	0.40	22.1	12.1	15	5787	67	15.51	3.00			
				33.6	11.4			700					

1000's of gallons
this month

RECEIVED

DEC 27 2021

OWRD

Lady Creek monthly operator report

Nov-16

DATE	TIME	Cl	Peak flow	Low flow	tank level	Read	use	Average Demand	Pr station	meter no	gpm	date read
		PPM				5787	1000's	gpm				12/1/2016
11/1/16	Tue		16.1	11.6		5787						
11/2/16	Wed		25.7	11.9		5787						39275406
11/3/16	Thu		27.3	10.1		5787						37845119
11/4/16	Fri	11:00	0.40	14.6	9.4	15	5865	78	13.54	4.00		34674524
11/5/16	Sat			24.7	7.2		5865					89884266
11/6/16	Sun			24.5	8.1		5865					19950478
11/7/16	Mon			13.2	6.3		5865		0.00	3.00		17415177
11/8/16	Tue	17:40	0.40	14.3	6.2	15	5938	73				50856930
11/9/16	Wed			10	6.2		5938					62510400
11/10/16	Thu			16.2	7.2		5938					14757946
11/11/16	Fri	10:25	0.40	27.5	13	15	5974	36	6.25	4.00		55622450
11/12/16	Sat			44.2	14.1		5974					78374615
11/13/16	Sun			40.1	14.1		5974					1928713
11/14/16	Mon	12:20	0.43	18.3	13	15	6061	87	20.14	3.00		
11/15/16	Tue			25.9	11.4		6061					
11/16/16	Wed			64	10.7		6061					
11/17/16	Thu			61.6	14.6		6061					
11/18/16	Fri	11:45	0.30	22.9	13.8	15	6211	150	26.04	4.00		
11/19/16	Sat			43.5	15.4		6211					
11/20/16	Sun			33.7	11.4		6211					
11/21/16	Mon	10:00	0.40	15.8	9.9	14	6294	83	19.21	3.00		
11/22/16	Tue			15.4	9.9		6294					
11/23/16	Wed			24.1	9.3		6294					
11/24/16	Thu			30.8	8.8		6294					
11/25/16	Fri	13:24	0.40	31	8.6		6371	77	13.37	4.00		
11/26/16	Sat			32.5	8.1		6371					
11/27/16	Sun			48.3	7.5		6371					
11/28/16	Mon	9:45	0.40	25.1	21.3	15	6454	83	19.21	3.00		
11/29/16	Tue			22.3	8.5		6454					
11/30/16	Wed			11.5	7.9		6454					
							667					
			64	6.2								

1000's of gallons this month

13880

RECEIVED

DEC 27 2021

OWRD

Lady Creek monthly operator report

MT/YR

Dec-16

DATE	TIME	CI	Peak flow	Low flow	tank level	Read	use	Average Demand	Pr station	meter no	gpm	date read	
		PPM					1000's	gpm					
12/1/16	Thu		15.1	8		6454						1/2/2017	
12/2/16	Fri		23.9	10.4		6454		3.00	35	62045927		39297562	
12/3/16	Sat	13:45	0.30	33.1	11.3	15	6558	104	4.00	4.00	35a	62472971	38835529
12/4/16	Sun			21.5	11.2		6558				30a	62123512	34672524
12/5/16	Mon			24.6	13.7		6558		0.00	3.00	29	62156803	98274166
12/6/16	Tue			20.6	13.1		6558				28a	62311246	20594198
12/7/16	Wed			28.5	16		6558				28b	65118783	17878023
12/8/16	Thu			31.1	25.2		6558				26	62156804	54359763
12/9/16	Fri	14:50	0.30	39.4	24.8	15	6733	175	20.25	6.00	20e	62123514	
12/10/16	Sat			50.5	23.7		6733				20	65118782	
12/11/16	Sun			44.4	21.7		6733				20d	69802383	
12/12/16	Mon			25	21.1		6733		0.00	3.00	20T	69802384	
12/13/16	Tue			24.1	9.4		6733						
12/14/16	Wed			13.9	9.2		6733						
12/15/16	Thu			12.1	9.4		6733						
12/16/16	Fri	10:50	0.30	17.4	9.2	15	6934	201	19.94	7.00			
12/17/16	Sat			21.6	9.7		6934						
12/18/16	Sun			35.9	10.3		6934						
12/19/16	Mon			30.7	11.5		6934		0.00	3.00			
12/20/16	Tue	13:45	0.30	36.4	27.8	15	7033	99					
12/21/16	Wed			41	22.9		7033						
12/22/16	Thu			56	21.8		7033						
12/23/16	Fri	11:00	0.40	50.4	31.5	15	7165	132	30.56	3.00			
12/24/16	Sat			51.7	27.1		7165						
12/25/16	Sun			42.7	23.1		7165						
12/26/16	Mon			43.8	24.4		7165						
12/27/16	Tue			47.2	29.6		7165						
12/28/16	Wed			56.2	33.2		7165						
12/29/16	Thu			57.8	36.1		7165						
12/30/16	Fri			46	25.1		7165						
12/31/16	Sat	14:00	0.40	54.1	24.3	15	7603	438	38.02	8.00			
				57.8	8		1149						

1000's of gallons
this month

RECEIVED

DEC 27 2021

OWRD

Lady Creek monthly operator report

Jan-17

DATE	TIME	CI	Peak flow	Low flow	tank level	Read	use	Average Demand	Pr station	meter no	date read
		PPM				MT/YR	1000's	gpm			12/1/2016
1/1/17	Sun		55.8	23.7		7603					
1/2/17	Mon	12:00	43.2	21.1	15	7700	97	16.84	4.00	35 62045927	32557673
1/3/17	Tue		25.5	16.3		7700				35a 62472971	37526218
1/4/17	Wed		17.2	11		7700				30a 62123512	35364987
1/5/17	Thu		14.4	10.9		7700				29 62156803	41830643
1/6/17	Fri	11:30	17.5	10.8	15	7784	84	14.58	4.00	28a 62311246	18137606
1/7/17	Sat		23.9	10		7784				28b 65118783	15208845
1/8/17	Sun		57.9	9.8		7784				26 62156804	27386953
1/9/17	Mon	12:00	51.6	47.4	15	7885	101	23.38	3.00	20e 62123514	41248803
1/10/17	Tue		52.8	18.6		7885				20 65118782	14723177
1/11/17	Wed		21.2	16.4		7885				20d 69802383	47210666
1/12/17	Thu		22	16.6		7885				20T 69802384	75141189
1/13/17	Fri	10:00	27.2	18.5	15	8024	139	24.13	4.00	79433733	4934560
1/14/17	Sat		38.2	18.5		8024					
1/15/17	Sun		28	12.7		8024					
1/16/17	Mon		19	8.5		8024					
1/17/17	Tue		37.5	14.6		8024					
1/18/17	Wed		48.1	46.5		8024					
1/19/17	Thu		51.8	26.7		8024					
1/20/17	Fri	17:00	33.8	27.1	15	8300	276	27.38	7.00		
1/21/17	Sat		48	28.3		8300					
1/22/17	Sun		42.8	27.3		8300					
1/23/17	Mon	10:45	32.1	27.2	15	8423	123	28.47	3.00		
1/24/17	Tue		34.9	26.2		8423					
1/25/17	Wed		29.6	18.3		8423					
1/26/17	Thu		25.3	7.4		8423					
1/27/17	Fri	15:15	18.4	7.3	15	8549	126	21.88	4.00		
1/28/17	Sat		26.1	12.5		8549					
1/29/17	Sun		26.4	6.9		8549					
1/30/17	Mon	9:45	12.3	6.9	15	8601	52	12.04	3.00		
1/31/17	Tue		11	6.9		8601					
			57.9	6.9			998				

1000's of gallons
this month

13880

RECEIVED

DEC 27 2021

OWRD

Lady Creek monthly operator report

Feb-17

DATE	TIME	Cl	Peak flow	Low flow	tank level	Read	use	Average Demand	Pr station	meter no	gpm	date read	3/1/2017
		PPM				MT/YR	1000's	gpm					
2/1/17	Wed					8601							
2/2/17	Thu					8601				35	62045927		39798610
2/3/17	Fri	14:00	0.40			8659	58	10.07	4.00	35a	62472971		39539336
2/4/17	Sat					8659				30a	62123512		35364987
2/5/17	Sun					8659				29	62156803		7738735
2/6/17	Mon	12:00	0.40			8710	51	11.81	3.00	28a	62311246		21253063
2/7/17	Tue					8710				28b	65118783		18063931
2/8/17	Wed					8710				26	62156804		57607190
2/9/17	Thu	14:00	0.40			8745	35	8.10	3.00	20e	62123514		68853118
2/10/17	Fri					8745				20	65118782		
2/11/17	Sat					8745				20d	69802383		
2/12/17	Sun					8745				20T	69802384		
2/13/17	Mon	15:30	0.40			8862	117	20.31	4.00		79433733		
2/14/17	Tue					8862							
2/15/17	Wed					8862							
2/16/17	Thu	17:20	0.40			8897	35	8.10	3.00				
2/17/17	Fri					8897							
2/18/17	Sat					8897							
2/19/17	Sun					8897							
2/20/17	Mon	10:25	0.40			9003	106	18.40	4.00				
2/21/17	Tue					9003							
2/22/17	Wed					9003							
2/23/17	Thu					9003							
2/24/17	Fri					9003							
2/25/17	Sat	12:30	0.40			9067	64	8.89	5.00				
2/26/17	Sun					9067							
2/27/17	Mon					9067							
2/28/17	Tue	0:00	0.40			9117	50	11.57	3.00				
3/1/17	Wed					9117							

0 0

516

1000's of gallons
this month

RECEIVED

DEC 27 2021

OWRD

Lady Creek monthly operator report

Mar-17

DATE	TIME	Cl PPM	Peak flow	Low flow	tank level	Read	use 1000's	Average Demand gpm	Pr station	meter no	gpm	date read	4/1/2017
3/1/17	Wed					9117							
3/2/17	Thu					9117							
3/3/17	Fri				14	9167	50	11.57	35	62045927			40048823
3/4/17	Sat		63.1	17.4		9167		4.00	35a	62472971			39745855
3/5/17	Sun		58.6	16.8		9167			30a	62123512			11848430
3/6/17	Mon		28.4	16.6		9167			29	62156803			34674526
3/7/17	Tue		28.3	16.6		9167		0.00	28a	62311246			21410584
3/8/17	Wed		30.8	16.9		9167		3.00	28b	65118783			18167099
3/9/17	Thu		38.4	16.6		9167			26	62156804			59560361
3/10/17	Fri		51.9	17.2	14	9264	97	9.62	20c	62123514			70469417
3/11/17	Sat		43.7	7.9		9264		7.00	20	65118782			14768534
3/12/17	Sun		53.7	11.9		9264			20d	69802383			59662623
3/13/17	Mon		29.5	13.6	13	9335	71	16.44	20T	69802384			79579306
3/14/17	Tue		29.8	13.5		9335		3.00	20y	79433733			2546900
3/15/17	Wed		32.7	11.5		9335							
3/16/17	Thu		22.7	6.8	13	9401	66	15.28					
3/17/17	Fri		53.2	6.8		9401		3.00					
3/18/17	Sat		54.7	18.5		9401							
3/19/17	Sun		51.1	7.1		9401							
3/20/17	Mon		20.8	6.8	13	9518	117	20.31					
3/21/17	Tue		24.4	6.8		9518		4.00					
3/22/17	Wed		18.4	4.8		9518							
3/23/17	Thu		25.7	6.7		9518							
3/24/17	Fri		44.2	6.5	14	9564	46	7.99					
3/25/17	Sat		39.3	8.0		9564		4.00					
3/26/17	Sun		37.8	7.3		9564							
3/27/17	Mon		32.9	6.9	13	9629	65	15.05					
3/28/17	Tue		33.7	6.5		9629		3.00					
3/29/17	Wed		33.4	6.5		9629							
3/30/17	Thu		28.4	6.4		9629							
3/31/17	Fri		47.6	6.7	14	9690	61	10.59					
			0	0			573						

1000's of gallons
this month

08881

RECEIVED
DEC 27 2021
OWRD

Lady Creek monthly operator report

MT/YR

Apr-17

DATE	TIME	Cl	Peak flow	Low flow	tank level	Read	use	Average Demand	Pr station	meter no	gpm	date read
		PPM					1000's	gpm				
4/1/17	Sat		31	14.2		9690		0.00	4.00			4/30/2017
4/2/17	Sun		37.7	8.7		9690				35	62045927	40061712
4/3/17	Mon	13:40	12.6	7.8		9760	70	16.20	3.00	35a	62472971	40183227
4/4/17	Tue		12.9	8.1		9760				30a	62123512	34674526
4/5/17	Wed		12.4	8.4		9760				29	62156803	15945004
4/6/17	Thu		10.7	8.4		9760				28a	62311246	21427407
4/7/17	Fri	9:50	17.7	8.4		9807	47	8.16	4.00	28b	65118783	18228650
4/8/17	Sat		21.3	12.7		9807				26	62156804	62235956
4/9/17	Sun		24.9	12		9807				20e	62123514	72657274
4/10/17	Mon	15:00	16.5	10.9		9884	77	17.82	3.00	20	65118782	14776744
4/11/17	Tue		13.2	10.2		9884				20d	69802383	60565575
4/12/17	Wed		16.1	10.2		9884				20T	69802384	80664172
4/13/17	Thu		28.8	10.2		9884				20Y	79433733	2756207
4/14/17	Fri	10:00	40.6	26.4		9968	84	14.58	4.00			
4/15/17	Sat		36.2	13.6		9968						
4/16/17	Sun		27.2	10.4		9968						
4/17/17	Mon		14.8	10		9968						
4/18/17	Tue	12:00	13.7	10.8		10073	105	18.23	4.00			
4/19/17	Wed		14.7	10.9		10073						
4/20/17	Thu		18.5	10.9		10073						
4/21/17	Fri	16:20	18.8	10.9		10155	82	18.98	3.00			
4/22/17	Sat		21.4	10.9		10155						
4/23/17	Sun		27.7	11.5		10155						
4/24/17	Mon		14.4	10.6		10155		0.00	3.00			
4/25/17	Tue	12:00	12.3	7.9		10211	56	9.72	4.00			
4/26/17	Wed		10.2	7.6		10211						
4/27/17	Thu		13.1	7.6		10211						
4/28/17	Fri	10:25	19.7	10.5		10247	36	8.33	3.00			
4/29/17	Sat		21.1	10.9		10247		0.00	4.00			
4/30/17	Sun		24	11.2		10247						
			40.6	7.6			557					

1000's of gallons
this month

RECEIVED

DEC 27 2021

OWRD

Lady Creek monthly operator report

MT/YR

May-17

DATE	TIME	CI	Peak flow	Low flow	tank level	Read	use	Average Demand	gpm	Pr station	meter no	gpm	date read	5/31/2017
5/1/17	Mon		15.2	10.5		10247								
5/2/17	Tue		14.5	10.4		10311	64	14.81	3.00	35	62045927			40077871
5/3/17	Wed		32.5	10.5		10311				35a	62472971			40703982
5/4/17	Thu		30.3	11		10311				30a	62123512			18513138
5/5/17	Fri	0.40	27.1	12.6		10412	101	17.53	4.00	29	62156803			20747107
5/6/17	Sat		23.9	11.6		10412				28a	62311246			21709233
5/7/17	Sun		40.6	12		10412				28b	65118783			18513141
5/8/17	Mon	0.30	27.4	11.3		10501	89	20.60	3.00	26	62156804			63702561
5/9/17	Tue		14.6	9.6		10501				20e	62123514			74076831
5/10/17	Wed		13.8	9.8		10501				20	65118782			14779452
5/11/17	Thu		24	11.4		10501				20d	69802383			61511368
5/12/17	Fri	0.40	18.1	10.9		10563	62	10.76	4.00	20T	69802384			80945622
5/13/17	Sat		20.8	11.3		10563				20y	79433733			2892206
5/14/17	Sun		24.5	11.6		10563								
5/15/17	Mon	0.40	24.6	10.7		10628	65	15.05	3.00					
5/16/17	Tue		13.2	10.8		10628								
5/17/17	Wed		14	10.9		10628								
5/18/17	Thu	0.40	13.9	10.9		10690	62	14.35	3.00					
5/19/17	Fri		25.3	11.6		10690								
5/20/17	Sat		29.2	16.6		10690								
5/21/17	Sun		35.2	15.3		10690								
5/22/17	Mon	0.40	21.9	14.6		10791	101	17.53	4.00					
5/23/17	Tue		17.6	10		10791								
5/24/17	Wed		13.9	9.9		10791								
5/25/17	Thu		15.4	7.3		10791								
5/26/17	Fri	0.40	20.8	7.1		10855	64	11.11	4.00					
5/27/17	Sat		34.3	9.4		10855								
5/28/17	Sun		48.9	11.8		10855								
5/29/17	Mon	0.40	51.3	8.6		10958	103	23.84	3.00					
5/30/17	Tue		17.3	8.6		10958								
5/31/17	Wed		16.3	8.4		10958								
			51.3	7.1			711							

1000's of gallons
this month

08867

RECEIVED

DEC 27 2021

OWRD

Lady Creek monthly operator report

MT/YR

Jun-17

DATE	TIME	Cl	Peak flow	Low flow	tank level	Read	usc	Average Demand	Pr station	meter no	gpm	date read	7/2/2017
		PPM					1000's	gpm					
6/1/17	Thu		11.4	7.9		10958							
6/2/17	Fri	10:50	0.50	27.3	7.8	10958							
6/3/17	Sat			35.7	20.2	11011	53	9.20	4.00	35	62045927		40190349
6/4/17	Sun			31.3	20.4	11011				35a	62472971		41157405
6/5/17	Mon	9:22	0.40	25.4	8.7	11114	103	23.84	3.00	30a	62123512		18513138
6/6/17	Tue			13.1	8.1	11114				29	62156803		25565837
6/7/17	Wed			30	8.5	11114				28a	62311246		21975498
6/8/17	Thu			30.2	10.6	11114				28b	65118783		18635822
6/9/17	Fri	12:00	0.50	22.7	10.3	11184	70	12.15	4.00	26	62156804		65547073
6/10/17	Sat			26.6	11.8	11184				20e	62123514		75780196
6/11/17	Sun			27.4	11.7	11184				20	65118782		14784388
6/12/17	Mon			25.4	10.8	11184				20d	69802383		62541393
6/13/17	Tue	10:00	0.40	15.7	9.4	11276	92	15.97	4.00	20T	69802384		81355296
6/14/17	Wed			14.9	8.7	11276					79433733		3054613
6/15/17	Thu	14:00	0.40	30.1	8.7	11313	37	12.85	2.00				
6/16/17	Fri			22.7	12.8	11313							
6/17/17	Sat			29.3	14.4	11313							
6/18/17	Sun			34.2	15.9	11313							
6/19/17	Mon	11:00	0.20	22.7	9.9	11410	97	22.45	3.00				
6/20/17	Tue			36.3	9.4	11410							
6/21/17	Wed			15.7	9	11410							
6/22/17	Thu			19.1	9.1	11410							
6/23/17	Fri	14:45	0.30	28.3	10.7	11506	96	16.67	4.00				
6/24/17	Sat			42.3	13.6	11506							
6/25/17	Sun			37.4	13.9	11506							
6/26/17	Mon	9:45	0.40	25.4	12.6	11585	79	18.29	3.00				
6/27/17	Tue			31.5	12.8	11585							
6/28/17	Wed			19.4	12.8	11585							
6/29/17	Thu	10:50	0.40	20.8	13	11664	79	18.29	3.00				
6/30/17	Fri			32.7	14.1	11664							
				42.3	7.8		706						

1000's of gallons
this month

RECEIVED
DEC 27 2021
OWRD

Lady Creek monthly operator report

Jul-17

DATE	TIME	CI	Peak flow	Low flow	tank level	Read	use	Average Demand	Pr station	meter no	gpm	date read	8/1/2017
		PPM				11664	1000's	gpm					
7/1/17	Sat		47.7	23.9		11664							
7/2/17	Sun		53.8	21.3		11664							
7/3/17	Mon	12"	44.7	19.8	15	11824	160	37.04	3.00	35a	62472971		40240191
7/4/17	Tue		40.7	14.9		11824				30a	62123512		41772347
7/5/17	Wed		36.5	22.9		11824				29	62156803		31210499
7/6/17	Thu		40.8	21		11824				28a	62311246		22108377
7/7/17	Fri	11:00	31.4	19	15	11955	131	22.74	4.00	28b	65118783		18801389
7/8/17	Sat		46.8	21.6		11955				26	62156804		67311777
7/9/17	Sun		51.1	10.7		11955				20e	62123514		77743473
7/10/17	Mon	10:24	19	9.1	15	12061	106	24.54	3.00	20	65118782		14805748
7/11/17	Tue		15.7	8.7		12061				20d	69802383		63534311
7/12/17	Wed		21	8.8		12061				20T	69802384		81794664
7/13/17	Thu		21.6	10.2		12061					79433733		3223708
7/14/17	Fri	9:30	27.9	9	15	12137	76	13.19	4.00				
7/15/17	Sat		46.2	23.2		12137							
7/16/17	Sun		48.5	22.2		12137							
7/17/17	Mon	12:20	28.9	13.3	15	12261	124	28.70	3.00				
7/18/17	Tue		22.3	9.6		12261							
7/19/17	Wed		21.6	9.6		12261							
7/20/17	Thu		23.6	9.4		12261							
7/21/17	Fri	15:00	30	9.6	15	12344	83	14.41	4.00				
7/22/17	Sat		36.8	11.2		12344							
7/23/17	Sun		45.4	17.8		12344							
7/24/17	Mon	11:00	26.5	16.7	15	12430	86	19.91	3.00				
7/25/17	Tue		23.6	11.9		12430							
7/26/17	Wed		26.5	10.8		12430							
7/27/17	Thu		21.7	10.3		12430							
7/28/17	Fri	13:00	29.6	10	15	12531	101	17.53	4.00				
7/29/17	Sat		41.1	10.9		12531							
7/30/17	Sun		44.1	12.8		12531							
7/31/17	Mon	11:40	23.9	10	15	12619	88	20.37	3.00				
			53.8	8.7			955						

1000's of gallons
this month

08801

RECEIVED

DEC 27 2021

OWRD

Lady Creek monthly operator report

Aug-17

DATE	TIME	CI	Peak flow	Low flow	tank level	Read	use	Average Demand	Pr station	meter no	date read	
		PPM				MT/YR	1000's	gpm			9/1/2017	
8/1/17	Tue		18.5	9.9		12619						
8/2/17	Wed		29.3	10.6		12619			35	62045927	40339858	
8/3/17	Thu		26.2	11.3		12619			35a	62472971	42472513	
8/4/17	Fri	9:30	0.40	28.1	11	12707	88	15.28	4.00	30a	62123512	
8/5/17	Sat			37.7	14.8	12707				29	62156803	37665865
8/6/17	Sun			39.7	12.3	12707				28a	62311246	22396624
8/7/17	Mon	10:30	0.50	24.7	10.9	12799	92	21.30	3.00	28b	65118783	18946440
8/8/17	Tue			23.4	11	12799				26	62156804	69998222
8/9/17	Wed			26.1	11.2	12799				20e	62123514	79876313
8/10/17	Thu			25.2	12.5	12799				20	65118782	14845349
8/11/17	Fri	17:45	0.50	41.1	13.2	12899	100	17.36	4.00	20d	69802383	64864748
8/12/17	Sat			38.9	14.9	12899				20T	69802384	82212260
8/13/17	Sun			40.2	13.5	12899				20Y	79433733	3426628
8/14/17	Mon	13:30	0.40	44.8	11.4	12984	85	19.68	3.00			
8/15/17	Tue			29.7	15.5	12984						
8/16/17	Wed			25.1	15.2	12984						
8/17/17	Thu			28.4	14.4	12984						
8/18/17	Fri	10:50	0.40	36.6	14.8	13099	115	19.97	4.00			
8/19/17	Sat			38.8	15.3	13099						
8/20/17	Sun			45	20.8	13099						
8/21/17	Mon	11:30	0.40	36.9	17.7	13211	112	25.93	3.00			
8/22/17	Tue			31.2	15.5	13211						
8/23/17	Wed			29.6	15	13211						
8/24/17	Thu			29.4	21.8	13211						
8/25/17	Fri	7:40	0.40	42.9	19.5	13326	115	19.97	4.00			
8/26/17	Sat			49.3	33.1	13326						
8/27/17	Sun			50.5	21.8	13326						
8/28/17	Mon	12:15	0.40	31.4	17.6	13477	151	34.95	3.00			
8/29/17	Tue			27.5	13.5	13477						
8/30/17	Wed			28.3	12	13477						
8/31/17	Thu			23.8	12	13477						
				50.5	9.9		858					

1000's of gallons this month

RECEIVED

DEC 27 2021

OWRD

Lady Creek monthly operator report

Sep-17

DATE	TIME	CI	Peak flow	Low flow	tank level	Read	use	Average Demand	Pr station	meter no	gpm	date read	10/10/2017
9/1/17	Fri	17:45	0.40	26.8	12.6	13477	1000's	18.75	4.00				
9/2/17	Sat			45.2	14.1	13585				35	62045927		40400924
9/3/17	Sun			52.2	22	13585				35a	62472971		43127226
9/4/17	Mon	13:13	0.40	56.8	14.1	13700	115	26.62	3.00	30a	62123512		
9/5/17	Tue			30.8	13	13700				29	62156803		43562510
9/6/17	Wed			26.9	12.7	13700				28a	62311246		22548547
9/7/17	Thu			20.6	12.3	13700				28b	65118783		19051835
9/8/17	Fri	9:55	0.40	23.4	12.5	13785	85	14.76	4.00	26	62156804		72278090
9/9/17	Sat			24	13.2	13785				20e	62123514		82010362
9/10/17	Sun			27.5	13.1	13785				20	65118782		14863489
9/11/17	Mon	18:00	0.40	25.2	12.5	13877	92	21.30	3.00	20d	69802383		66027682
9/12/17	Tue			21.9	12.3	13877				20T	69802384		82822002
9/13/17	Wed			20.1	12.5	13877				20y	79433733		3627243
9/14/17	Thu			18.9	12.4	13877							
9/15/17	Fri	9:00	0.40	27.9	12.3	13947	70	12.15	4.00				
9/16/17	Sat			29.7	13.9	13947							
9/17/17	Sun			30.6	16	13947							
9/18/17	Mon	11:10	0.40	21.9	15.6	14032	85	19.68	3.00				
9/19/17	Tue			22.1	15.7	14032							
9/20/17	Wed			21.2	16.2	14032							
9/21/17	Thu			24.7	16.6	14032							
9/22/17	Fri			21.3	11	14032							
9/23/17	Sat	13:20	0.50	24.4	8.6	14166	134	18.61	5.00				
9/24/17	Sun			23.4	6.3	14166							
9/25/17	Mon	13:30	0.40	12	5.7	14189	23	5.32	3.00				
9/26/17	Tue			10.7	5.5	14189							
9/27/17	Wed			13.4	5.6	14189							
9/28/17	Thu			9.9	5.6	14189							
9/29/17	Fri	17:00	0.40	29.9	5.8	14241	52	9.03	4.00				
9/30/17	Sat			45.1	7.5	14241							
				56.8	5.5		764						

1000's of gallons
this month

13880

RECEIVED

DEC 27 2021

OWRD

Lady Creek monthly operator report

MT/YR

Oct-17

DATE	TIME	Cl	Peak flow	Low flow	tank level	Read	use	Average Demand	Pr station	meter no	gpm	date read
		PPM					1000's	gpm	days			11/4/2017
10/1/17	Sun		40.5	6.1		14241						
10/2/17	Mon	15:35	0.40	15.3	5.8	14316	75	17.36	3.00	35	62045927	40432816
10/3/17	Tue			11.7	6	14316				35a	62472971	43391675
10/4/17	Wed			10.5	5.8	14316				30a	62123512	
10/5/17	Thu			10.8	5.7	14316				29	62156803	45676838
10/6/17	Fri	17:50	0.50	13.3	6.2	14367	51	8.85	4.00	28a	62311246	22613463
10/7/17	Sat			21.7	6.7	14367				28b	65118783	19105273
10/8/17	Sun			36.1	11.5	14367				26	62156804	73622133
10/9/17	Mon	10:30	0.40	15.9	10.7	14420	53	12.27	3.00	20e	62123514	83245547
10/10/17	Tue			15.5	10.5	14420				20	65118782	14865520
10/11/17	Wed			15.6	8.8	14420				20d	69802383	66824163
10/12/17	Thu			14.2	7	14420				20T	69802384	83114087
10/13/17	Fri	13:35	0.40	17.2	6.2	14480	60	10.42	4.00		79433733	3745075
10/14/17	Sat			19.4	9.4	14480						
10/15/17	Sun			20.6	7	14480						
10/16/17	Mon			19.7	7.1	14480						
10/17/17	Tue			16.1	6.4	14480						
10/18/17	Wed			13.6	6.4	14480						
10/19/17	Thu	15:00	0.40	10.5	6.4	14566	86	9.95	6.00			
10/20/17	Fri			23.3	6.5	14566						
10/21/17	Sat			17.7	6.9	14566						
10/22/17	Sun			22.6	6.6	14566						
10/23/17	Mon			14.6	6.6	14566						
10/24/17	Tue	17:30	0.40	18.9	6.4	14638	72	10.00	5.00			
10/25/17	Wed			15.1	6.5	14638						
10/26/17	Thu			11.7	6.6	14638						
10/27/17	Fri			16.6	7	14638						
10/28/17	Sat			27.1	7.7	14638						
10/29/17	Sun			23.1	8.5	14638						
10/30/17	Mon	9:50	0.40	13.6	7	14733	95	11.00	6.00			
10/31/17	Tue			9.6	6.5	14733		0.00	3.00			
				40.5	5.7		492					

1000's of gallons
this month

RECEIVED

DEC 27 2021

OWRD

Lady Creek monthly operator report

Nov-17

DATE	TIME	CI	Peak flow	Low flow	tank level	Read	use	Average Demand	Pr station	meter no	gpm	date read
		PPM				14733	1000's	gpm				11/28/2017
11/1/17	Wed		9.8	6.5		14733						
11/2/17	Thu		12.9	6.5		14733						
11/3/17	Fri	15:45	0.50	18.1	6.6	14785	52	12.04	3.00	35	62045927	40457218
11/4/17	Sat			23.6	7.7	14785		0.00	4.00	35a	62472971	43690461
11/5/17	Sun			23.3	7.6	14785				29	62156803	48026966
11/6/17	Mon	12:50	0.50	17.2	6.7	14830	45	10.42	3.00	28a	62311246	22672385
11/7/17	Tue			14.9	6.9	14830				28b	65118783	19189696
11/8/17	Wed			10.7	6.9	14830				26	62156804	74927000
11/9/17	Thu			18.8	6.6	14830				20e	62123514	84500434
11/10/17	Fri	11:20	0.40	22.9	7	14886	56	9.72	4.00	20	65118782	14867163
11/11/17	Sat			26.8	7.3	14886				20d	69802383	67611652
11/12/17	Sun			32.5	9.3	14886				20T	69802384	83413816
11/13/17	Mon	17:00	0.40	12.5	7.1	14950	64	14.81	3.00		79433733	3864288
11/14/17	Tue			17.6	6.8	14950						
11/15/17	Wed			11	6.8	14950						
11/16/17	Thu	12:30	0.40	18.7	6.9	14988	38	8.80	3.00			
11/17/17	Fri			16.2	6.9	14988			3.00			
11/18/17	Sat			20.2	7.4	14988			3.00			
11/19/17	Sun			20.3	7.7	14988			3.00			
11/20/17	Mon			22.6	7.5	14988			3.00			
11/21/17	Tue	9:30	0.40	12.3	6.6	15063	75	10.42	5.00			
11/22/17	Wed			34.4	6.6	15063						
11/23/17	Thu			46.4	24.3	15063						
11/24/17	Fri	15:55	0.40	36.4	16.2	15159	96	16.67	4.00			
11/25/17	Sat			40.3	9.8	15159						
11/26/17	Sun			33.4	7.8	15159						
11/27/17	Mon	11:00	0.40	9.8	6.7	15234	75	17.36	3.00			
11/28/17	Tue			10	6.1	15234						
11/29/17	Wed			12.5	5.7	15234						
11/30/17	Thu			9.3	5.5	15234						
				46.4	5.5		501					

1000's of gallons this month

13880

RECEIVED

DEC 27 2021

OWRD

Lady Creek monthly operator report

Lady Creek monthly operator report					MT/YR	Dec-17					date	
DATE	TIME	Cl	Peak flow	Low flow	Read	use	Average Demand		Pr station	meter no	gpm	read
		PPM				1000's	gpm					1/1/2018
12/1/17	Fri		14.1	5.7	15234							
12/2/17	Sat		18.5	6.2	15274	40	6.94	4.00		35	62045927	40950189
12/3/17	Sun		21.3	6.6	15274					35a	62472971	43702956
12/4/17	Mon	14:45	12.6	6	15315	41	9.49	3.00		30a	62123512	
12/5/17	Tue		11.8	6	15315					29	62156803	52097454
12/6/17	Wed		12.4	6.5	15315					28a	62311246	22836128
12/7/17	Thu		9.6	6	15315					28b	65118783	19325285
12/8/17	Fri	19:15	17.1	6.2	15361	46	7.99	4.00		26	62156804	77234956
12/9/17	Sat		18.4	8.8	15361					20e	62123514	86622582
12/10/17	Sun		24	9.4	15361					20	65118782	14879583
12/11/17	Mon	10:16	15.9	6.6	15411	50	11.57	3.00		20d	69802383	69024312
12/12/17	Tue		16.6	6.3	15411					20T	69802384	
12/13/17	Wed		10.8	6.4	15411					20Y	79433733	
12/14/17	Thu		10.1	6.3	15411							
12/15/17	Fri		16.8	6.3	15411							
12/16/17	Sat	13:13	30.6	10.8	15484	73	8.45	6.00				
12/17/17	Sun		26.3	9.4	15484							
12/18/17	Mon		19.3	7.9	15484							
12/19/17	Tue	10:55	14.6	6.7	15544	60	13.89	3.00				
12/20/17	Wed		12.8	6.8	15544							
12/21/17	Thu		15.4	7.2	15544							
12/22/17	Fri	13:00	20.2	7.2	15600	56	12.96	3.00				
12/23/17	Sat		21.2	7.4	15600							
12/24/17	Sun		25.2	9	15600							
12/25/17	Mon	12:12	26.5	10.7	15650	50	11.57	3.00				
12/26/17	Tue		29.2	8.9	15650							
12/27/17	Wed		32.2	13.5	15650							
12/28/17	Thu		24.5	9	15650							
12/29/17	Fri	13:39	34.6	8.8	15760	110	19.10	4.00				
12/30/17	Sat		46.6	10.8	15760							
12/31/17	Sun	13:44	41.4	10.1	15868	108						
			46.6	5.7		634						

1000's of gallons
this month

RECEIVED

DEC 27 2021

OWRD

Lady Creek monthly operator report

MT/YR

Jan-18

DATE	TIME	CI	Peak flow	Low flow	tank level	Read	use	Average Demand	Pr station	meter no	date read
		PPM					1000's	gpm			
1/1/2018	Mon	13:44	0.30	34.148	8.858	15760		25.00			1/29/2018
1/2/2018	Tue			17.654	8.491	15868	108		35	62045927	41100471
1/3/2018	Wed			10.69	8.491	15868			35a	62472971	43989697
1/4/2018	Thu			18.021	8.491	15868			30a	62123512	
1/5/2018	Fri	14:40	0.30	17.899	9.469	15868			29	62156803	55674334
1/6/2018	Sat			18.998	10.935	15943	75	10.42	28a	62311246	23177245
1/7/2018	Sun			22.663	8.735	15943			28b	65118783	19394468
1/8/2018	Mon	9:30	0.20	9.469	8.002	15943			26	62156804	78962975
1/9/2018	Tue			24.13	8.125	16008	65	15.05	20e	62123514	88233908
1/10/2018	Wed			24.13	8.002	16008			20	65118782	14938319
1/11/2018	Thu			9.591	8.002	16008			20d	69802383	70009352
1/12/2018	Fri			18.509	8.125	16008			20T	69802384	84159985
1/13/2018	Sat	12:20	0.20	19.731	9.713	16008			20y	79433733	4217227
1/14/2018	Sun			19.853	8.735	16101	93	12.92			
1/15/2018	Mon	12:00	0.50	24.374	12.767	16101					
1/16/2018	Tue			19.365	7.636	16156	55	19.10			
1/17/2018	Wed			7.88	7.636	16156					
1/18/2018	Thu	14:45	0.40	7.88	7.514	16156					
1/19/2018	Fri			13.745	7.514	16212	56	12.96			
1/20/2018	Sat			20.586	10.446	16212					
1/21/2018	Sun			19.609	10.202	16212					
1/22/2018	Mon	11:00	0.50	11.546	7.514	16212					
1/23/2018	Tue			7.88	7.392	16280	68	11.81			
1/24/2018	Wed			7.636	7.392	16280					
1/25/2018	Thu			8.125	7.392	16280					
1/26/2018	Fri	16:45	0.30	13.989	7.514	16280					
1/27/2018	Sat			30.238	8.125	16350	70	12.15			
1/28/2018	Sun			33.17	7.758	16350					
1/29/2018	Mon			9.346	7.636	16350					
1/30/2018	Tue	16:00	0.50	8.369	7.88	16408	58	13.43			
1/31/2018	Wed			8.491	7.88	16408					
				34.148	7.392		648				

1000's of gallons
this month

19880

RECEIVED

DEC 27 2021

OWRD

Lady Creek monthly operator report

Feb-18

DATE	TIME	CI	Peak flow	Low flow	tank level	Read	use	Average Demand	Pr station	meter no	gpm	date read
		PPM				16408	1000's	gpm				2/28/2018
2/1/2018	Thu	15:00	0.40	8.491	7.758	16474	66	11.46				
2/2/2018	Fri			14.844	8.002	16474			35	62045927		41137441
2/3/2018	Sat			10.69	8.002	16474			35a	62472971		44509006
2/4/2018	Sun			12.889	7.88	16474			30a	62123512		
2/5/2018	Mon			9.346	7.758	16474			29	62156803		60420518
2/6/2018	Tue	14:16	0.40	9.591	7.758	16549	75	10.42	28a	62311246		23217201
2/7/2018	Wed			8.002	7.758	16549			28b	65118783		19516681
2/8/2018	Thu	12:45	0.40	8.369	7.88	16572	23	7.99	26	62156804		81058006
2/9/2018	Fri			10.812	7.88	16572			20e	62123514		90208674
2/10/2018	Sat			15.577	8.125	16572			20	65118782		
2/11/2018	Sun			19.12	8.002	16572			3	69802383		
2/12/2018	Mon	9:12	0.40	8.613	7.88	16649	77	13.37	20d	69802384		
2/13/2018	Tue			8.125	7.88	16649			20T	79433733		
2/14/2018	Wed			8.858	8.002	16649						
2/15/2018	Thu			8.735	8.002	16649						
2/16/2018	Fri	16:12	0.50	12.034	8.125	16709	60	10.42				
2/17/2018	Sat			19.243	8.491	16709						
2/18/2018	Sun			20.709	12.034	16709						
2/19/2018	Mon			15.944	8.735	16709						
2/20/2018	Tue			13.012	8.491	16709						
2/21/2018	Wed	11:00	0.40	9.591	8.491	16817	108	15.00				
2/22/2018	Thu			8.98	8.613	16817						
2/23/2018	Fri			14.6	8.735	16817						
2/24/2018	Sat			42.089	9.102	16817						
2/25/2018	Sun			49.664	38.057	16817						
2/26/2018	Mon			46.243	45.754	16817						
2/27/2018	Tue	17:30	0.40	46.121	45.754	17071	254	29.40				
2/28/2018	Wed			51.619	45.999	17071						
3/1/2018	Thu					17071						

663 1000's of gallons
this month

RECEIVED

DEC 27 2021

OWRD

Lady Creek monthly operator report

Mar-18

DATE	TIME	Cl PPM	Peak flow	Low flow	tank level	Read 17071	use 1000's	Average Demand gpm	Pr station	meter no	gpm	date read	3/31/2018
3/1/2018	Thu		46	50		17071		1					
3/2/2018	Fri		47	53		17071		2	35	62045927			41175806
3/3/2018	Sat		23	29		17071		3	35a	62472971			45062516
3/4/2018	Sun		15	26		17071		4	30a	62123512			
3/5/2018	Mon		12	16		17071		5	29	62156803			65475642
3/6/2018	Tue		11	19		17071		6	28a	62311246			23311044
3/7/2018	Wed		15	18		17071		7	28b	65118783			19694705
3/8/2018	Thu		15	25		17071		8	26	62156804			83903815
3/9/2018	Fri		23	37		17071		9	20e	62123514			92968104
3/10/2018	Sat	11:00	20	27		17442	371	0	20	65118782			14939281
3/11/2018	Sun		18	32		17442		1	20d	69802383			72230218
3/12/2018	Mon	10:30	15	20		17519	77	0	20T	69802384			85197518
3/13/2018	Tue		15	21		17519		1	20y	79433733			4668278
3/14/2018	Wed		12	16		17519		2					
3/15/2018	Thu		9	13		17519		3					
3/16/2018	Fri		13	22		17519		4					
3/17/2018	Sat	17:00	10	19		17617	98	0					
3/18/2018	Sun		13	22		17617		1					
3/19/2018	Mon	9:30	10	19		17656	39	0					
3/20/2018	Tue		10	14		17656		1					
3/21/2018	Wed		10	14		17656		2					
3/22/2018	Thu		12	27		17656		3					
3/23/2018	Fri	10:00	12	47		17729	73	0					
3/24/2018	Sat		21	25		17729		1					
3/25/2018	Sun		14	25		17729		2					
3/26/2018	Mon	9:30	15	26		17801	72	0					
3/27/2018	Tue		14	27		17801		1					
3/28/2018	Wed		13	29		17801		2					
3/29/2018	Thu		21	32		17801		3					
3/30/2018	Fri	14:00	14	26		17921	120	0					
3/31/2018	Sat		15	30		17921		1					
			47.024	12.636			850		1000's of gallons this month				

13880

RECEIVED
DEC 27 2018
OWRD

Lady Creek monthly operator report

MT/YR

Apr-18

DATE	TIME	Cl	Peak flow	Low flow	tank level	Read	usc	Average Demand	Pr station	meter no	gpm	date read
		PPM				17921	1000's	gpm				4/30/2018
4/1/2018	Sun		26	13		17921		2				
4/2/2018	Mon	14:30	15	13		17991	70	16.20	35	62045927		41217085
4/3/2018	Tue		19	13		17991		1	35a	62472971		45489817
4/4/2018	Wed		17	13		17991		2	30a	62123512		
4/5/2018	Thu		24	13		17991		3	29	62156803		69242486
4/6/2018	Fri	13:00	30	13		18076	85	14.76	28a	62311246		23609319
4/7/2018	Sat		30	19		18076		1	28b	65118783		19875388
4/8/2018	Sun		26	14		18076		2	26	62156804		85992391
4/9/2018	Mon	10:15	0.40	24	13	18150	74	17.13	20e	62123514		94960522
4/10/2018	Tue		22	14		18150		1	20	65118782		14947322
4/11/2018	Wed		19	14		18150		2	20d	69802383		73378716
4/12/2018	Thu		17	12		18150		3	20T	69802384		85825000
4/13/2018	Fri	10:15	0.40	42	11	18240	90	15.63	20Y	79433733		4857146
4/14/2018	Sat		26	16		18240		1				
4/15/2018	Sun		32	12		18240		2				
4/16/2018	Mon	10:45	0.60	15	11	18311	71	16.44				
4/17/2018	Tue		15	11		18311		1				
4/18/2018	Wed		15	12		18311		2				
4/19/2018	Thu	10:50	0.50	18	12	18368	57	13.19				
4/20/2018	Fri		31	12		18368		1				
4/21/2018	Sat		31	19		18368		2				
4/22/2018	Sun		32	13		18368		3				
4/23/2018	Mon	10:00	0.50	19	12	18468	100	17.36				
4/24/2018	Tue		17	13		18468		1				
4/25/2018	Wed		18	13		18468		2				
4/26/2018	Thu		22	13		18468		3				
4/27/2018	Fri	16:00	0.40	30	13	18560	92	15.97				
4/28/2018	Sat		36	24		18560		1				
4/29/2018	Sun		37	15		18560		2				
4/30/2018	Mon	10:45	0.50	24	10	18654	94	21.76				
						18654		0				
							733					
			41.964	10.248								

1000's of gallons
this month

RECEIVED

DEC 27 2021

OWRD

Lady Creek monthly operator report

May-18

DATE	TIME	CI	Peak flow	Low flow	tank level	Read	use	Average Demand	Pr station	meter no	gpm	date read	5/31/2018
		PPM				18654	1000's	gpm					
5/1/18	Tue		12.8	9.1		18654			1				
5/2/18	Wed		13.0	9.0		18654			2	35	62045927		41822652
5/3/18	Thu		14.5	9.2		18654			3	35a	62472971		45504595
5/4/18	Fri	9:00	0.60	26.4	9.2	18714	60	10.42	0	30a	62123512		18513138
5/5/18	Sat			27.8	11.7	18714			1	29	62156803		74047582
5/6/18	Sun			25.6	12.8	18714			2	28a	62311246		23826722
5/7/18	Mon	12:00	0.40	22.3	11.8	18785	71	16.44	0	28b	65118783		20231135
5/8/18	Tue			17.0	11.3	18785			1	26	62156804		88459826
5/9/18	Wed			15.9	11.4	18785			2	20e	62123514		96714492
5/10/18	Thu			24.7	11.9	18785			3	20	65118782		14978259
5/11/18	Fri	11:30	0.50	24.3	12.2	18866	81	14.06	0	20d	69802383		74541114
5/12/18	Sat			32.2	13.8	18866			1	20T	69802384		86143012
5/13/18	Sun			32.3	14.4	18866			2	20y	79433733		5022897
5/14/18	Mon			18.9	13.4	18951	85	19.68	0				
5/15/18	Tue			24.0	13.4	18951			1				
5/16/18	Wed			17.6	13.4	18951			2				
5/17/18	Thu			18.4	13.8	18951			3				
5/18/18	Fri	18:30	0.50	26.3	13.8	19046	95	16.49	0				
5/19/18	Sat			31.8	20.5	19046			1				
5/20/18	Sun			35.7	15.0	19046			2				
5/21/18	Mon	11:25	0.40	17.8	13.4	19121	75	17.36	0				
5/22/18	Tue			19.7	13.5	19121			1				
5/23/18	Wed			17.3	14.3	19121			2				
5/24/18	Thu			20.5	14.3	19121			3				
5/25/18	Fri	10:25	0.40	27.3	14.7	19212	91	15.80	0				
5/26/18	Sat			42.4	14.5	19212			1				
5/27/18	Sun			45.0	19.3	19212			2				
5/28/18	Mon			51.6	11.9	19212			3				
5/29/18	Tue	9:45	0.40	18.6	11.4	19350	138	23.96	0				
5/30/18	Wed			21.4	11.4	19350			1				
5/31/18	Thu			17.3	12.1	19350			2				
			51.574	9.021			696	1000's of gallons this month					

08881

RECEIVED

DEC 27 2021

OWRD

Lady Creek monthly operator report

MT/YR

Jun-18

DATE	TIME	Cl	Peak flow	Low flow	tank level	Read	use	Average Demand	Pr station	meter no	gpm	date read
		PPM				19350	1000's	gpm				6/30/2018
6/1/18	Fri	12:45	0.40	27.2	11.7	19413	63	10.94				
6/2/18	Sat			30.8	18.8	19413			35	62045927		42508359
6/3/18	Sun			35.5	14.1	19413			35a	62472971		45526751
6/4/18	Mon	11:00	0.40	17.5	12.9	19499	86	19.91	30a	62123512		18513138
6/5/18	Tue			20.4	13.2	19499			29	62156803		79386698
6/6/18	Wed			20.2	13.4	19499			28a	62311246		23979692
6/7/18	Thu			21.6	13.2	19499			28b	65118783		20580967
6/8/18	Fri	10:15	0.40	21.6	13.5	19585	86	14.93	26	62156804		90538026
6/9/18	Sat			28.8	17.4	19585			20e	62123514		98514499
6/10/18	Sun			33.2	15.7	19585			20	65118782		14983443
6/11/18	Mon			20.8	14.1	19585			20d	69802383		75746767
6/12/18	Tue	11:00	0.50	20.6	14.3	19693	108	18.75	20T	69802384		86426963
6/13/18	Wed			32.9	14.7	19693				79433733		5190988
6/14/18	Thu			29.7	16.0	19693						
6/15/18	Fri	11:30	0.30	23.1	16.0	19775	82	18.98				
6/16/18	Sat			26.1	13.5	19775						
6/17/18	Sun			30.1	14.0	19775						
6/18/18	Mon	12:00	0.50	21.1	13.7	19849	74	17.13				
6/19/18	Tue			26.2	14.2	19849						
6/20/18	Wed			31.3	14.3	19849						
6/21/18	Thu			39.4	25.9	19849						
6/22/18	Fri	16:00	0.40	38.9	25.9	19987	138	23.96				
6/23/18	Sat			45.0	26.8	19987						
6/24/18	Sun			52.0	27.1	19987						
6/25/18	Mon			36.3	13.3	19987						
6/26/18	Tue			17.8	12.1	19987						
6/27/18	Wed			19.0	12.1	19987						
6/28/18	Thu			23.1	12.2	19987						
6/29/18	Fri	19:30	0.40	25.5	13.3	20211	224	22.22				
6/30/18	Sat			33.7	14.0	20211						
							861					
			52.045	11.692			1000's of gallons this month					

Lady Creek monthly operator report

Jul-18

DATE	TIME	Cl PPM	Peak flow	Low flow	tank level	Read MT/YR	use 1000's	Average Demand gpm	Pr station	meter no	gpm	date read	7/31/2018
7/1/18	Sun		41.5	17.6		20211		1					
7/2/18	Mon		30.6	20.5		20211		2	35	62045927		43304970	
7/3/18	Tue	12:20	32.5	18.0		20340	129	29.86	0	35a	62472971	45563871	
7/4/18	Wed		32.2	16.2		20340		1		30a	62123512		
7/5/18	Thu		28.8	13.4		20340		2		29	62156803	86023928	
7/6/18	Fri	19:19	58.0	15.2		20438	98	22.69	0	28a	62311246	24073469	
7/7/18	Sat		61.7	18.7		20438		1		28b	65118783	20734175	
7/8/18	Sun		41.1	16.0		20438		2		26	62156804	92990903	
7/9/18	Mon		23.9	14.9		20438		3		20e	62123514	100369346	
7/10/18	Tue	10:18	23.4	14.9		20580	142	24.65	0	20	65118782	15045182	
7/11/18	Wed		23.3	12.6		20580		1		20d	69802383	76720988	
7/12/18	Thu		26.8	13.1		20580		2		20T	69802384	86832544	
7/13/18	Fri	15:15	30.6	18.7		20664	84	19.44	0		79433733	5358508	
7/14/18	Sat		41.2	20.0		20664		1					
7/15/18	Sun		42.5	20.2		20664		2					
7/16/18	Mon	15:45	33.6	17.3		20769	105	24.31	0				
7/17/18	Tue		32.7	16.4		20769		1					
7/18/18	Wed		24.7	13.3		20769		2					
7/19/18	Thu		23.5	13.3		20769		3					
7/20/18	Fri	12:25	35.9	13.5		20878	109	18.92	0				
7/21/18	Sat		37.2	16.7		20878		1					
7/22/18	Sun		47.4	15.5		20878		2					
7/23/18	Mon	12:25	26.1	14.2		20983	105	24.31	0				
7/24/18	Tue		27.5	14.1		20983		1					
7/25/18	Wed		23.0	14.9		20983		2					
7/26/18	Thu		27.4	14.6		20983		3					
7/27/18	Fri	12:45	40.5	14.8		21083	100	17.36	0				
7/28/18	Sat		60.3	20.0		21083		1					
7/29/18	Sun		45.4	16.5		21083		2					
7/30/18	Mon		32.6	19.0		21083		3					
7/31/18	Tue	11:40	30.9	17.7		21256	173	30.03	0				
							1045						
			61.724	12.559									

1000's of gallons
this month

13880

RECEIVED

DEC 27 2021

OWRD

Lady Creek monthly operator report

MT/YR

Aug-18

DATE	TIME	Cl	Peak flow	Low flow	tank level	Read	use	Average Demand	Pr station	meter no	date read
		PPM					1000's	gpm			8/31/2018
8/1/2018	Wed		31.314	17.132		21256		0			
8/2/2018	Thu		32.72	17.529		21256		1	35	62045927	43464193
8/3/2018	Fri		50.602	21.613		21256		2	35a	62472971	46262192
8/4/2018	Sat	12:00	66.944	49.067		21407	151	34.95	30a	62123512	
8/5/2018	Sun		67.637	21.418		21407		1	29	62156803	93263165
8/6/2018	Mon	9:25	44.662	19.091		21512	105	36.46	28a	62311246	24145889
8/7/2018	Tue		34.02	18.519		21512		1	28b	65118783	20835458
8/8/2018	Wed		37.828	19.169		21512		2	26	62156804	94846096
8/9/2018	Thu		37.336	18.897		21512		3	20e	62123514	1890484
8/10/2018	Fri	14:00	45.166	22.949		21660	148	25.69	20	65118782	15111270
8/11/2018	Sat		42.911	24.42		21660		1	20d	69802383	77298909
8/12/2018	Sun		48.937	23.562		21660		2	20T	69802384	87229816
8/13/2018	Mon	10:20	27.483	19.416		21787	127	29.40	20Y	79433733	5493585
8/14/2018	Tue		37.347	18.258		21787		0			
8/15/2018	Wed		37.831	14.085		21787		2			
8/16/2018	Thu	15:20	25.939	13.239		21875	88	20.37			
8/17/2018	Fri		29.095	13.108		21875		0			
8/18/2018	Sat		38.776	17.986		21875		1			
8/19/2018	Sun		46.695	14.345		21875		2			
8/20/2018	Mon	11:45	32.148	14.275		21998	123	21.35			
8/21/2018	Tue		25.046	14.319		21998		3			
8/22/2018	Wed		36.595	14.482		21998		0			
8/23/2018	Thu		22.737	14.367		22090	92	21.30			
8/24/2018	Fri	16:00	26.922	15.056		22117	27	18.75			
8/25/2018	Sat		31.453	15.197		22117		0			
8/26/2018	Sun		36.804	15.382		22117		1			
8/27/2018	Mon	13:00	22.854	14.812		22200	83	19.21			
8/28/2018	Tue		26.15	14.899		22200		2			
8/29/2018	Wed		26.566	14.669		22200		1			
8/30/2018	Thu		27.825	14.827		22200		2			
8/31/2018	Fri	16:30	30.254	14.47		22304	104	18.06			
							1048	0			
			67.637	13.108							

1000's of gallons
this month

RECEIVED

DEC 27 2021

OWRD

Lady Creek monthly operator report

Sep-18

DATE		TIME	Cl	Peak flow	Low flow	tank level	Read	use	Average Demand	days	Pr station	meter no	gpm	date read
			PPM				22304	1000's	gpm					10/3/2018
9/1/2018	Sat			41.5	19.4		22304			1				
9/2/2018	Sun			50.9	20.0		22304			2	35	62045927		43515061
9/3/2018	Mon	15:33	0.60	48.3	15.8	14	22426	122	28.24	0	35a	62472971		46825119
9/4/2018	Tue			23.0	15.2		22426			1	30a	62123512		
9/5/2018	Wed			26.3	15.3		22426			2	29	62156803		98488515
9/6/2018	Thu	15:25	0.50	22.8	15.4	14	22500	74	17.13	0	28a	62311246		24244394
9/7/2018	Fri			33.7	15.6		22500			1	28b	65118783		20953931
9/8/2018	Sat			33.1	16.2		22500			2	26	62156804		96400723
9/9/2018	Sun			38.6	15.8		22500			3	20e	62123514		3212181
9/10/2018	Mon	14:00	0.50	18.6	14.4	15	22617	117	20.31	0	20	65118782		15118871
9/11/2018	Tue			21.8	6.8		22617			1	20d	69802383		77843443
9/12/2018	Wed			19.0	6.0		22617			2	20T	69802384		87623768
9/13/2018	Thu			13.1	7.8		22617			3	20y	79433733		5614012
9/14/2018	Fri	12:00	0.50	21.3	7.4	15	22924	307	53.30	0				
9/15/2018	Sat			29.0	8.9		22924			1				
9/16/2018	Sun			30.7	8.9		22924			2				
9/17/2018	Mon			17.8	7.8		22924			3				
9/18/2018	Tue			13.4	7.6		22924			4				
9/19/2018	Wed			12.7	7.8		22924			5				
9/20/2018	Thu			13.7	7.7		22924			6				
9/21/2018	Fri	12:00	0.50	20.3	6.9	14	23212	288	28.57	0				
9/22/2018	Sat			25.2	10.6		23212			1				
9/23/2018	Sun			31.9	7.4		23212			2				
9/24/2018	Mon	12:00	0.40	12.6	6.9	14	23279	67	15.51	0				
9/25/2018	Tue			12.0	7.2		23279			1				
9/26/2018	Wed			12.6	7.3		23279			2				
9/27/2018	Thu			14.2	7.2		23279			3				
9/28/2018	Fri			17.1	7.4		23279			4				
9/29/2018	Sat	16:45	0.50	31.5	7.6	14	23354	75	10.42	0				
9/30/2018	Sun			31.5	7.7		23354			1				
										2				
				50.943	6.04			1050						

1000's of gallons
this month

13880

RECEIVED

DEC 27 2021

OWRD

Lady Creek monthly operator report

Oct-18

DATE	TIME	CI	Peak flow	Low flow	tank level	Read	use	Average Demand	Pr station	meter no	gpm	date read	10/31/2018
		PPM					1000's	gpm					
10/1/2018	Mon		12.3	7.1		23354							
10/2/2018	Tue	15:00	13.2	7.1		23404	50	11.57		35	62045927		43552018
10/3/2018	Wed		12.1	7.1		23404				35a	62472971		47159374
10/4/2018	Thu	15:00	13.2	7.4		23427	23	7.99		30a	62123512		
10/5/2018	Fri		20.1	7.3		23427				29	62156803		1449821
10/6/2018	Sat		24.1	11.2		23427				28a	62311246		24279921
10/7/2018	Sun		23.6	9.1		23427				28b	65118783		21030894
10/8/2018	Mon	17:00	15.7	7.5		23505	78	13.54		26	62156804		97748741
10/9/2018	Tue	18:00	11.0	7.7		23516	11	7.64		20e	62123514		4393241
#####	Wed		11.3	7.1		23516				20	65118782		15135508
#####	Thu		16.4	7.2		23516				20d	69802383		78408326
#####	Fri		21.0	7.4		23516				20f	69802384		87966560
#####	Sat	15:45	21.4	9.5		23577	61	10.59			79433733		5722914
#####	Sun		26.2	8.2		23577							
#####	Mon	12:50	14.0	7.4		23614	37	12.85					
#####	Tue		14.0	7.3		23614							
#####	Wed		13.6	7.5		23614							
#####	Thu		14.3	7.6		23614							
#####	Fri	17:00	20.2	8.3		23673	59	10.24					
#####	Sat		21.4	12.2		23673							
#####	Sun		29.7	8.4		23673							
#####	Mon		27.4	7.4		23673							
#####	Tue		10.7	7.4		23673							
#####	Wed		12.0	7.5		23673							
#####	Thu		14.0	7.8		23673							
#####	Fri	14:30	13.9	7.7		23783	110	10.91					
#####	Sat		18.9	8.2		23783							
#####	Sun		21.7	8.5		23783							
#####	Mon	12:00	12.1	7.9		23833	50	11.57					
#####	Tue		10.6	8.0		23833							
#####	Wed		11.1	8.1		23833							
							479						
			29.738	7.059			1000's of gallons this month						

RECEIVED

DEC 27 2021

OWRD

Lady Creek monthly operator report

Nov-18

DATE	TIME	CI	Peak flow	Low flow	tank level	Read	use	Average Demand	Pr station	meter no	gpm	date read
		PPM				23833	1000's	gpm				12/1/2018
11/1/2018	Thu		11.45	7.86		23833		1				
11/2/2018	Fri	14:00	18.99	8.27		23868	35	12.15	35	62045927		43597871
11/3/2018	Sat		19.52	8.40		23868		1	35a	62472971		47595216
11/4/2018	Sun		23.57	8.66		23868		2	30a	62123512		
11/5/2018	Mon	13:40	12.72	7.77		23933	65	15.05	29	62156803		5229958
11/6/2018	Tue		10.44	7.42		23933		1	28a	62311246		24342272
11/7/2018	Wed		10.37	7.45		23933		2	28b	65118783		21170687
11/8/2018	Thu	16:15	18.15	7.53		23976	43	9.95	26	62156804		99107474
11/9/2018	Fri		21.39	7.78		23976		1	20e	62123514		5554513
11/10/2018	Sat		28.50	9.07		23976		2	20	65118782		15142189
11/11/2018	Sun		34.88	10.88		23976		3	20d	69802383		79028597
11/12/2018	Mon	16:20	22.25	9.59		24063	87	15.10	20T	69802384		88242382
11/13/2018	Tue		21.35	9.44		24063		1	20 y	79433733		5827444
11/14/2018	Wed		15.31	9.15		24063		2				
11/15/2018	Thu		18.47	8.93		24063		3				
11/16/2018	Fri	12:15	14.08	8.08		24132	69	11.98				
11/17/2018	Sat		20.67	8.41		24132		1				
11/18/2018	Sun		21.94	8.88		24132		2				
11/19/2018	Mon		23.69	7.77		24132		3				
11/20/2018	Tue	14:45	23.99	7.63		24196	64	11.11				
11/21/2018	Wed		18.02	7.72		24196		1				
11/22/2018	Thu		24.52	8.45		24196		2				
11/23/2018	Fri	15:30	29.45	8.94		24260	64	14.81				
11/24/2018	Sat		33.98	10.13		24260		1				
11/25/2018	Sun		32.81	9.44		24260		2				
11/26/2018	Mon		12.99	9.17		24260		3				
11/27/2018	Tue	14:00	12.47	9.22		24344	84	14.58				
11/28/2018	Wed		13.23	9.24		24344		1				
11/29/2018	Thu		12.99	9.36		24344		2				
11/30/2018	Fri	16:15	24.36	8.67		24392	48	11.11				
						24392		1				
			34.875	7.421			559					

1000's of gallons
this month

13880

RECEIVED

DEC 27 2021

OWRD

Lady Creek monthly operator report

Dec-18

DATE	TIME	CI	Peak flow	Low flow	tank level	Read	use	Average Demand	Pr station	meter no	gpm	date read
		PPM				24392	1000's	gpm				12/30/2018
12/1/2018	Sat					24392		1				
12/2/2018	Sun					24392		2	35	62045927		43635626
12/3/2018	Mon	16:00				24456	64	0	35a	62472971		48052395
12/4/2018	Tue					24456		1	30a	62123512		
12/5/2018	Wed					24456		2	29	62156803		9256685
12/6/2018	Thu					24456		3	28a	62311246		24380329
12/7/2018	Fri					24456		4	28b	65118783		21402174
12/8/2018	Sat	11:25				24528	72	0	26	62156804		1040753
12/9/2018	Sun					24528		1	20e	62123514		5948558
12/10/2018	Mon	12:00				24566	38	0	20	65118782		15151721
12/11/2018	Tue					24566		1	20d	69802383		79743551
12/12/2018	Wed					24566		2	20T	69802384		88517927
12/13/2018	Thu					24566		3	20Y	79433733		6867659
12/14/2018	Fri	17:00				24656	90	0				
12/15/2018	Sat					24656		1				
12/16/2018	Sun					24656		2				
12/17/2018	Mon	15:15				24720	64	0				
12/18/2018	Tue					24720		1				
12/19/2018	Wed					24720		2				
12/20/2018	Thu					24720		3				
12/21/2018	Fri	13:00				24781	61	0				
12/22/2018	Sat					24781		1				
12/23/2018	Sun					24781		2				
12/24/2018	Mon	11:45				24848	67	0				
12/25/2018	Tue					24848		1				
12/26/2018	Wed					24848		2				
12/27/2018	Thu					24848		3				
12/28/2018	Fri	13:30				24966	118	0				
12/29/2018	Sat					24966		1				
12/30/2018	Sun					24966		2				
12/31/2018	Mon					24966		3				

574
1000's of gallons
this month

RECEIVED
DEC 27 2021
OWRD

Lady Creek monthly operator report

Jan-19

DATE	TIME	Cl	Peak flow	Low flow	tank level	Read	use	Average Demand	Pr station	meter no	date read
		PPM				24966	1000's	gpm			2/3/2019
1/1/2019	Tue		50.2	11.9		24966					
1/2/2019	Wed		19.8	11.1		24966			35	62045927	43684758
1/3/2019	Thu		18.5	9.6		24966			35a	62472971	48690137
1/4/2019	Fri	12:00	0.50	26.3	9.8	25199	233	26.97	30a	62123512	
1/5/2019	Sat			25.8	10.3	25199			29	62156803	14932631
1/6/2019	Sun			31.3	10.9	25199			28a	62311246	24442725
1/7/2019	Mon			15.6	9.6	25199			28b	65118783	22121323
1/8/2019	Tue	12:00	0.50	13.4	9.4	25268	69	11.98	26	62156804	3123183
1/9/2019	Wed			13.8	9.6	25268			20e	62123514	8635362
1/10/2019	Thu			13.8	9.6	25268			20	65118782	15171041
1/11/2019	Fri	14:00	0.50	21.8	10.3	25328	60	13.89	20d	69802383	80533246
1/12/2019	Sat			25.7	11.0	25328			20T	69802384	88944981
1/13/2019	Sun			31.0	11.7	25328			20y	79433733	6110284
1/14/2019	Mon			21.0	10.4	25328					
1/15/2019	Tue	15:45	0.40	14.1	10.5	25422	94	16.32			
1/16/2019	Wed			14.2	10.4	25422					
1/17/2019	Thu			16.8	10.4	25422					
1/18/2019	Fri	12:45	0.40	41.8	10.9	25472	50	11.57			
1/19/2019	Sat			35.6	16.7	25472					
1/20/2019	Sun			38.3	15.5	25472					
1/21/2019	Mon	12:22	0.50	33.1	10.1	25570	98	22.69			
1/22/2019	Tue			15.7	10.0	25570					
1/23/2019	Wed			14.3	9.8	25570					
1/24/2019	Thu			13.6	9.9	25570					
1/25/2019	Fri	17:30	0.40	20.8	10.1	25644	74	12.85			
1/26/2019	Sat			24.7	10.9	25644					
1/27/2019	Sun			28.7	10.8	25644					
1/28/2019	Mon	17:30	0.40	14.0	9.8	25714	70	16.20			
1/29/2019	Tue			12.9	9.6	25714					
1/30/2019	Wed			13.8	9.5	25714					
1/31/2019	Thu	11:55	0.50	18.5	9.9	25753	39	9.03			
							787				
			50.171	9.445							

1000's of gallons
this month

19880

RECEIVED
DEC 27 2021
OWRD

Lady Creek monthly operator report

Feb-19

DATE	TIME	CI PPM	Peak flow	Low flow	Bleach tank level	Read 1000's	use 1000's	Average Demand gpm	Pr station	meter no gpm	date read
2/1/2019	Fri		24.77	9.94		25753		3			2/26/2019
2/2/2019	Sat		29.76	10.59		25753		0			
2/3/2019	Sun		26.01	10.52		25753		1	35	62045927	43715684
2/4/2019	Mon	13:45	14.17	10.02	13	25842	89	20.60	35a	62472971	49062865
2/5/2019	Tue		12.26	9.44		25842		0	30a	62123512	
2/6/2019	Wed		14.92	9.23		25842		1	29	62156803	18319466
2/7/2019	Thu	9:00	12.28	9.12	12	25881	39	9.03	28a	62311246	24490346
2/8/2019	Fri		20.97	9.41		25881		0	28b	65118783	22506810
2/9/2019	Sat		27.16	15.77		25881		1	26	62156804	4104903
2/10/2019	Sun		24.32	9.83		25881		2	20e	62123514	
2/11/2019	Mon	12:00	13.05	9.50	7 49	25972	91	15.80	20	65118782	15173769
2/12/2019	Tue		12.44	9.76		25972		0	20d	69802383	81039260
2/13/2019	Wed		14.92	9.48		25972		1	20T	69802384	89115599
2/14/2019	Thu	14:50	19.54	9.86	44	26021	49	11.34		79433733	6195111
2/15/2019	Fri		29.38	12.84		26021		2			
2/16/2019	Sat		35.72	17.55		26021		1			
2/17/2019	Sun		37.68	16.23		26021		2			
2/18/2019	Mon	15:00	33.91	13.21	37	26155	134	23.26			
2/19/2019	Tue		15.63	10.25		26155		3			
2/20/2019	Wed		13.01	9.97		26155		1			
2/21/2019	Thu		14.23	10.53		26155		2			
2/22/2019	Fri	16:10	27.12	10.16	35	26214	59	10.24			
2/23/2019	Sat		25.87	12.49		26214		3			
2/24/2019	Sun		26.53	10.37		26214		1			
2/25/2019	Mon	13:15	15.46	9.97	31	26281	67	15.51			
2/26/2019	Tue		12.83	10.07		26281		2			
2/27/2019	Wed		13.74	10.01		26281		1			
2/28/2019	Thu		12.78	10.05		26281		2			
3/1/2019	Fri					26281		3			
								4			
								0			
								0			
								528			
			37.68	9.115				1000's of gallons this month			

RECEIVED

DEC 27 2021

OWRD

Lady Creek monthly operator report

Mar-19

DATE	TIME	Cl	Peak flow	Low flow	tank level	Read	use	Average Demand	Pr station	meter no	gpm	date read
		PPM				26281	1000's	gpm				4/2/2019
3/1/2019	Fri 16:00	0.40	27.5	10.1	28	26341	60	8.33				
3/2/2019	Sat		23.6	15.7		26341			35	62045927		43824517
3/3/2019	Sun		28.7	10.9		26341			35a	62472971		49720748
3/4/2019	Mon		13.9	9.9		26341			30a	62123512		
3/5/2019	Tue		12.8	9.8		26341			29	62156803		24383991
3/6/2019	Wed		14.9	10.1		26341			28a	62311246		24536036
3/7/2019	Thu		14.2	9.9		26341			28b	65118783		23295910
3/8/2019	Fri		20.4	10.6		26341			26	62156804		6493158
3/9/2019	Sat 11:00	0.40	24.3	10.8	19	26495	154	13.37	20e	62123514		11684598
3/10/2019	Sun		24.8	10.8		26495			20	65118782		15184241
3/11/2019	Mon		14.1	10.7		26495			20d	69802383		81878125
3/12/2019	Tue		14.6	10.9		26495			20T	69802384		89971979
3/13/2019	Wed		13.8	10.7		26495			20y	79433733		6392789
3/14/2019	Thu		19.0	10.9		26495						
3/15/2019	Fri 18:00	0.40	21.3	11.5	13	26720	225	26.04				
3/16/2019	Sat		30.5	18.0		26720						
3/17/2019	Sun		30.7	18.4		26720						
3/18/2019	Mon		23.7	17.4		26720						
3/19/2019	Tue 10:45	0.40	20.1	17.3	7	26825	105	18.23				
3/20/2019	Wed		26.9	17.3		26825						
3/21/2019	Thu		22.2	17.5		26825						
3/22/2019	Fri 10:00	0.40	39.5	17.7	3 48	26905	80	18.52				
3/23/2019	Sat		45.9	29.6		26905						
3/24/2019	Sun		50.0	27.1		26905						
3/25/2019	Mon		35.0	13.9		26905						
3/26/2019	Tue 9:00	0.60	18.9	12.8	45	26967	62	10.76				
3/27/2019	Wed		23.6	13.7		26967						
3/28/2019	Thu		29.8	14.7		26967						
3/29/2019	Fri 16:45	0.50	42.1	15.0	40	27054	87	20.14				
3/30/2019	Sat		42.3	18.1		27054						
3/31/2019	Sun		31.8	14.7		27054						
							773					
			50.016	9.769			1000's of gallons this month					

13880

RECEIVED

DEC 27 2021

OWRD

Lady Creek monthly operator report

MT/YR

Apr-19

DATE	TIME	CI	Peak flow	Low flow	tank level	Read	use	Average Demand	Pr station	meter no	gpm	date read	
		PPM				27054	1000's	gpm				5/1/2019	
4/1/2019	Mon		23	14	31	27148	94	65.28	2				
4/2/2019	Tue		25	15		27148			3	35	62045927	43856572	
4/3/2019	Wed		20	15		27148			4	35a	62472971	50292344	
4/4/2019	Thu		23	15		27148			5	30a	62123512		
4/5/2019	Fri		30	19		27148			6	29	62156803	28730469	
4/6/2019	Sat		28	16		27148			7	28a	62311246	24565482	
4/7/2019	Sun		30	16		27148			8	28b	65118783	23610647	
4/8/2019	Mon	14:00	0.40	21	15	23	27340	192	14.81	0	26	62156804	8134813
4/9/2019	Tue			23	15		27340		1	20e	62123514	13018721	
4/10/2019	Wed			16	12		27340		2	20	65118782	15185570	
4/11/2019	Thu			16	12		27340		3	20d	69802383	82510067	
4/12/2019	Fri	12:00	0.40	19	12	18	27417	77	13.37	0	20T	69802384	90326722
4/13/2019	Sat			32	15		27417		1	20Y	79433733	6515917	
4/14/2019	Sun			26	13		27417		2				
4/15/2019	Mon	19:45	0.50	20	13	14	27499	82	18.98	0			
4/16/2019	Tue			17	12		27499		1				
4/17/2019	Wed			17	13		27499		2				
4/18/2019	Thu			21	13		27499		3				
4/19/2019	Fri			22	13		27499		4				
4/20/2019	Sat	14:00	0.40	28	14	9	27604	105	14.58	0			
4/21/2019	Sun			31	14		27604		1				
4/22/2019	Mon	12:30	0.50	22	15	6 47	27660	56	19.44	0			
4/23/2019	Tue			20	13		27660		1				
4/24/2019	Wed			19	14		27660		2				
4/25/2019	Thu			22	14		27660		3				
4/26/2019	Fri	16:30	0.40	24	15	45	27753	93	16.15	0			
4/27/2019	Sat			27	14		27753		1				
4/28/2019	Sun			29	15		27753		2				
4/29/2019	Mon			21	14		27753		3				
4/30/2019	Tue	12:45	0.50	18	14	41	27848	95	16.49	0			
						27848			0				
							794						
			31.713	11.984									

1000's of gallons
this month

RECEIVED
DEC 27 2021
OWRD

Lady Creek monthly operator report

May-19

DATE	TIME	CI	Peak flow	Low flow	tank level	Read	use	Average Demand	Pr station	meter.no	gpm	date read	5/31/2019
		PPM				27848	1000's	gpm					
5/1/19	Wed		17.2	12.3		27848		1					
5/2/19	Thu		15.8	11.3		27848		2	35	62045927			43897658
5/3/19	Fri		26.4	13.7		27848		3	35a	62472971			50892052
5/4/19	Sat		29.0	12.0		27848		4	30a	62123512			18513138
5/5/19	Sun	15:15	0.40	33.2	12.4	37	27940	92	29	62156803	12.78		34411538
5/6/19	Mon			19.4	11.3		27940		1	28a	62311246		24629579
5/7/19	Tue	14:30	0.40	18.0	11.5	35	27987	47	0	28b	65118783		23785517
5/8/19	Wed			16.5	11.7		27987		1	26	62156804		10504795
5/9/19	Thu			33.8	11.6		27987		2	20e	62123514		14919340
5/10/19	Fri			29.7	11.9		27987		3	20	65118782		15187352
5/11/19	Sat	17:00	0.50	29.7	16.0	30	28075	88	0	20d	69802383		83176125
5/12/19	Sun			30.3	12.8		28075		1	20T	69802384		91122813
5/13/19	Mon			27.9	11.2		28075		2	20y	79433733		6694772
5/14/19	Tue	12:00	0.40	17.8	11.3	27	28148	73	0		16.90		
5/15/19	Wed			15.4	11.4		28148		1				
5/16/19	Thu			16.8	11.4		28148		2				
5/17/19	Fri			21.5	11.1		28148		3				
5/18/19	Sat	9:20	0.30	22.3	11.4	24	28224	76	0		13.19		
5/19/19	Sun			28.7	11.9		28224		1				
5/20/19	Mon			31.7	24.9		28224		2				
5/21/19	Tue	10:00	0.50	30.6	25.9	19	28303	79	0		18.29		
5/22/19	Wed			29.3	12.6		28303		1				
5/23/19	Thu			19.3	12.5		28303		2				
5/24/19	Fri	16:40	0.40	39.4	12.6	13	28428	125	0		28.94		
5/25/19	Sat			36.5	23.5		28428		1				
5/26/19	Sun			47.0	15.7		28428		2				
5/27/19	Mon	13:30	0.40	43.4	14.7	9 45	28549	121	0		28.01		
5/28/19	Tue			data lost due to radio transfer			28549		1				
5/29/19	Wed						28549		2				
5/30/19	Thu			18.5	13.3		28549		3				
5/31/19	Fri	17:45	0.50	23.2	12.2	42	28642	93	0		16.15		
							794						
			46.978	11.127									

1000's of gallons
this month

19880

RECEIVED

DEC 27 2021

OWRD

Lady Creek monthly operator report

Jun-19

DATE	TIME	CI	Peak flow	Low flow	tank level	Read	use	Average Demand	Pr station	meter no	gpm	date read
		PPM				MT/YR	1000's	gpm				7/1/2019
6/1/19	Sat					28642		3				
6/2/19	Sun					28642		4				
6/3/19	Mon	19:00	0.40		39	28717	75	8.68	35	62045927		43942687
6/4/19	Tue					28717		1	35a	62472971		51589186
6/5/19	Wed					28717		2	30a	62123512		
6/6/19	Thu					28717		3	29	62156803		40953240
6/7/19	Fri	15:00	0.40		35	28806	89	15.45	28a	62311246		24667297
6/8/19	Sat					28806		1	28b	65118783		24530084
6/9/19	Sun					28806		2	26	62156804		12333540
6/10/19	Mon	15:50	0.40		31	28886	80	18.52	20e	62123514		16157625
6/11/19	Tue					28886		1	20	65118782		15187352
6/12/19	Wed					28886		2	20d	69802383		83752108
6/13/19	Thu					28886		3	20T	69802384		91371427
6/14/19	Fri	16:00	0.40		27	28988	102	17.71		79433733		6810802
6/15/19	Sat					28988		1				
6/16/19	Sun					28988		2				
6/17/19	Mon	11:30	0.60		23	29095	107	24.77				
6/18/19	Tue					29095		1				
6/19/19	Wed					29095		2				
6/20/19	Thu	13:45	0.50		17	29198	103	23.84				
6/21/19	Fri					29198		1				
6/22/19	Sat					29198		2				
6/23/19	Sun					29198		3				
6/24/19	Mon	20:20	0.40		10	29338	140	24.31				
6/25/19	Tue					29338		1				
6/26/19	Wed					29338		2				
6/27/19	Thu					29338		3				
6/28/19	Fri					29338		4				
6/29/19	Sat					29338		5				
6/30/19	Sun					29338		6				
								0				

696
1000's of gallons
this month

RECEIVED

DEC 27 2021

OWRD

Lady Creek monthly operator report

Jul-19

DATE	TIME	CI	Peak flow	Low flow	tank level	Read	use	Average Demand	Pr station	meter no	gpm	date read	7/31/2019
		PPM				29338	1000's	gpm					
7/1/19	Mon	18:20	0.20		2 49	29531	193	19.15					
7/2/19	Tue					29531			35	62045927			43992644
7/3/19	Wed					29531			35a	62472971			52141926
7/4/19	Thu					29531			30a	62123512			
7/5/19	Fri					29531			29	62156803			45728164
7/6/19	Sat	17:00	0.40		39	29714	183	25.42	28a	62311246			24769202
7/7/19	Sun					29714			28b	65118783			24654065
7/8/19	Mon	12:00	0.40		36	29781	67	23.26	26	62156804			14487585
7/9/19	Tue					29781			20e	62123514			17913782
7/10/19	Wed		23.2	8.5		29781			20	65118782			15222080
7/11/19	Thu		22.8	7.5		29781			20d	69802383			84467075
7/12/19	Fri	16:00	0.50	23.9	7.4	32	29871	90	15.63	20T	69802384		91868808
7/13/19	Sat			25.6	8.2		29871			79433733			6973044
7/14/19	Sun			31.4	7.9		29871						
7/15/19	Mon	17:30	0.40	15.1	7.8	29	29935	64	14.81				
7/16/19	Tue			16.7	7.3		29935						
7/17/19	Wed			15.1	7.4		29935						
7/18/19	Thu			16.4	7.2		29935						
7/19/19	Fri	10:20	0.50	35.8	7.3	26	29994	59	10.24				
7/20/19	Sat			48.7	15.0		29994						
7/21/19	Sun			50.0	9.2		29994						
7/22/19	Mon	18:00	0.50	37.6	7.6	21	30096	102	23.61				
7/23/19	Tue			19.7	7.6		30096						
7/24/19	Wed			13.6	7.4		30096						
7/25/19	Thu			16.6	7.4		30096						
7/26/19	Fri	14:30	0.50	25.7	7.4	18	30154	58	10.07				
7/27/19	Sat			30.7	10.4		30154						
7/28/19	Sun			36.2	11.3		30154						
7/29/19	Mon			31.5	9.2		30154						
7/30/19	Tue	11:20	0.50	21.7	7.2	14	30236	82	14.24				
7/31/19	Wed			24.7	13.1		30236						
							898	1000's of gallons this month					
			50.009	7.176									

13880

RECEIVED

DEC 27 2021

OWRD

Lady Creek monthly operator report

Aug-19

DATE	TIME	Cl	Peak flow	Low flow	tank level	Read	use	Average Demand	Pr station	meter no	date read	9/1/2019
		PPM				MT/YR	1000's	gpm				
8/1/2019	Thu					30236						
8/2/2019	Fri	19:00	0.40		10	30236		3	35	62045927		
8/3/2019	Sat					30319	83	14.41	35a	62472971		44053520
8/4/2019	Sun					30319			30a	62123512		52613207
8/5/2019	Mon	12:45	0.40		8 46	30386	67	15.51	29	62156803		49761199
8/6/2019	Tue					30386			28a	62311246		24870999
8/7/2019	Wed					30386			28b	65118783		24784931
8/8/2019	Thu					30386			26	73573467		16776694
8/9/2019	Fri	14:00	0.50		42	30460	74	12.85	20e	62123514		19774513
8/10/2019	Sat					30460			20	65118782		15235906
8/11/2019	Sun					30460			20d	69802383		85286582
8/12/2019	Mon	17:30	0.50		38	30541	81	18.75	20T	69802384		92369820
8/13/2019	Tue					30541			20Y	79433733		7149488
8/14/2019	Wed					30541						
8/15/2019	Thu					30541						
8/16/2019	Fri	12:00	0.50		35	30594	53	9.20				
8/17/2019	Sat					30594						
8/18/2019	Sun					30594						
8/19/2019	Mon	16:30	0.50		31	30681	87	20.14				
8/20/2019	Tue					30681						
8/21/2019	Wed					30681						
8/22/2019	Thu					30681						
8/23/2019	Fri	6:00	0.50		27	30762	81	14.06				
8/24/2019	Sat					30762						
8/25/2019	Sun					30762						
8/26/2019	Mon					30762						
8/27/2019	Tue	15:30	0.50		23	30855	93	16.15				
8/28/2019	Wed					30855						
8/29/2019	Thu					30855						
8/30/2019	Fri					30855						
8/31/2019	Sat	18:00	0.40		16	30936	81	14.06				
							700					

1000's of gallons
this month

RECEIVED

DEC 27 2021

OWRD

Lady Creek monthly operator report

MT/YR

Sep-19

DATE	TIME	CI	Peak flow	Low flow	tank level	Read	use	Average Demand	Pr station	meter no	gpm	date read
		PPM				30936	1000's	gpm				9/30/2019
9/1/2019	Sun		37.2	9.8		30936						
9/2/2019	Mon		42.4	9.2		30936			35	62045927		44113216
9/3/2019	Tue	18:00	23.2	8.0	16	31009	73	16.90	35a	62472971		52974026
9/4/2019	Wed		15.4	8.1		31009			30a	62123512		
9/5/2019	Thu		15.3	8.2		31009			29	62156803		52523443
9/6/2019	Fri	19:45	15.6	7.7	14	31059	50	11.57	28a	62311246		24933938
9/7/2019	Sat		17.8	8.1		31059			28b	65118783		24902549
9/8/2019	Sun		20.1	8.1		31059			26	62156804		18411621
9/9/2019	Mon	12:00	12.1	7.6	11	31108	49	11.34	20e	62123514		21052865
9/10/2019	Tue		13.8	7.8		31108			20	65118782		15243954
9/11/2019	Wed		25.8	7.8		31108			20d	69802383		85978324
9/12/2019	Thu		12.2	7.8		31108			20T	69802384		92610696
9/13/2019	Fri	8:45	21.1	8.0	8	31156	48	8.33	20y	79433733		7273349
9/14/2019	Sat		24.0	10.8		31156						
9/15/2019	Sun		30.8	8.1		31156						
9/16/2019	Mon	12:00	12.6	7.4	5 49	31223	67	15.51				
9/17/2019	Tue		17.6	7.0		31223						
9/18/2019	Wed		12.3	7.5		31223						
9/19/2019	Thu		14.5	7.6		31223						
9/20/2019	Fri	15:30	16.8	8.1	47	31281	58	10.07				
9/21/2019	Sat		22.2	8.4		31281						
9/22/2019	Sun		25.5	9.5		31281						
9/23/2019	Mon		18.9	7.8		31281						
9/24/2019	Tue	12:20	17.1	8.5	44	31357	76	13.19				
9/25/2019	Wed		14.3	7.8		31357						
9/26/2019	Thu		17.9	7.7		31357						
9/27/2019	Fri	15:00	19.9	7.8	42	31407	50	11.57				
9/28/2019	Sat		22.9	13.4		31407						
9/29/2019	Sun		28.9	11.9		31407						
9/30/2019	Mon	17:00	29.8	12.7	39	31478	71	16.44				
							542					
			42.403	7.013								

1000's of gallons
this month

08881

RECEIVED

DEC 27 2021

OWRD

Lady Creek monthly operator report

MT/YR

Oct-19

DATE	TIME	Cl	Peak flow	Low flow	tank level	Read	use	Average Demand	Pr station	meter no	gpm	date read
		PPM					1000's	gpm				10/31/2019
10/1/2019	Tue		18.1	8.9		31478						
10/2/2019	Wed		12.5	8.5		31478			35	62045927		
10/3/2019	Thu		19.6	7.9		31478			35a	62472971		44179435.8
10/4/2019	Fri	18:00	20.3	9.8	35	31547	69	9.58	30a	62123512		53391185.2
10/5/2019	Sat		26.6	13.3		31547			29	62156803		55268749
10/6/2019	Sun		29.2	10.4		31547			28a	62311246		24995103
10/7/2019	Mon		14.6	9.5		31547			28b	65118783		24984153
10/8/2019	Tue	13:00	14.9	9.5	31	31625	78	13.54	26	62156804		19977648
10/9/2019	Wed		14.3	9.3		31625			20e	62123514		22309924
#####	Thu		23.0	9.2		31625			20	65118782		15252538
#####	Fri	15:00	22.7	9.9	28	31675	50	11.57	20d	69802383		86637076
#####	Sat		27.3	12.8		31675			20T	69802384		92803870
#####	Sun		28.9	10.5		31675				79433733		7393916
#####	Mon		16.4	10.2		31675						
#####	Tue	14:20	13.8	9.6	24	31766	91	15.80				
#####	Wed		15.9	9.7		31766						
#####	Thu		14.1	9.6		31766						
#####	Fri	16:30	44.7	9.5	21	31830	64	14.81				
#####	Sat		44.3	33.7		31830						
#####	Sun		40.0	11.4		31830						
#####	Mon	10:30	17.8	10.0	16	31932	102	23.61				
#####	Tue		15.7	10.2		31932						
#####	Wed		14.5	9.6		31932						
#####	Thu		13.5	9.7		31932						
#####	Fri	14:45	17.1	10.4	13	32006	74	12.85				
#####	Sat		20.7	9.6		32006						
#####	Sun		19.7	9.3		32006						
#####	Mon		13.9	9.0		32006						
#####	Tue		13.6	9.3		32006						
#####	Wed	10:45	13.0	9.0	8 15	32092	86	11.94				
#####	Thu		14.1	9.3		32092						
							614					
								1000's of gallons				
								this month				

RECEIVED
 DEC 27 2021
 OWRD

Lady Creek monthly operator report

Nov-19

DATE	TIME	CI	Peak flow	Low flow	tank level	Read	use	Average Demand	Pr station	meter no	gpm	date read	12/2/2019
		PPM				32092	1000's	gpm					
11/1/2019	Fri		17.09	9.66		32092		1					
11/2/2019	Sat	16:15	25.99	10.92	13	32151	59	20.49	35	62045927		104816	
11/3/2019	Sun		32.30	10.53		32151		1	35a	62472971		520234	
11/4/2019	Mon	11:00	14.56	9.38	11	32196	45	15.63	30a	62123512			
11/5/2019	Tue		13.04	9.30		32196		1	29	62156803		58348099	
11/6/2019	Wed		11.81	9.10		32196		2	28a	62311246	new meters	6404	
11/7/2019	Thu	14:30	22.70	9.50	8 48	32242	46	10.65	28b	65118783	new meters	3184	
11/8/2019	Fri		23.26	9.20		32242		1	26	62156804		21766719	
11/9/2019	Sat		32.09	11.98		32242		2	20e	62123514		23734736	
11/10/2019	Sun		41.02	12.49		32242		3	20	65118782		15271031	
11/11/2019	Mon		27.37	9.17		32242		4	20d	69802383		87338097	
11/12/2019	Tue		12.32	8.75		32242		5	20T	69802384		92999132	
11/13/2019	Wed		20.01	8.35		32242		6	20 y	79433733		7528382	
11/14/2019	Thu		16.44	8.11		32242		7					
11/15/2019	Fri	12:00	19.86	8.09	39	32391	149	12.93					
11/16/2019	Sat		25.04	12.67		32391		1					
11/17/2019	Sun		28.67	9.31		32391		2					
11/18/2019	Mon		11.20	8.30		32391		3					
11/19/2019	Tue	11:30	16.51	8.13	35	32477	86	14.93					
11/20/2019	Wed		13.47	8.21		32477		1					
11/21/2019	Thu		11.76	8.17		32477		2					
11/22/2019	Fri	11:10	21.76	8.52	33	32512	35	8.10					
11/23/2019	Sat		28.87	9.60		32512		1					
11/24/2019	Sun		31.28	8.52		32512		2					
11/25/2019	Mon	11:30	15.99	7.06	30	32579	67	15.51					
11/26/2019	Tue		11.47	6.30		32579		1					
11/27/2019	Wed		21.74	6.57		32579		2					
11/28/2019	Thu		22.38	7.84		32579		3					
11/29/2019	Fri	13:45	29.67	11.97	27	32648	69	11.98					
11/30/2019	Sat		37.29	10.23		32648		2					

556
1000's of gallons
this month

41.024 6.304

13880

RECEIVED

DEC 27 2021

OWRD

Lady Creek monthly operator report

MT/YR

Dec-19

DATE	TIME	Cl PPM	Peak flow	Low flow	bleach tank	Read	use 1000's	Average Demand gpm	Pr station	meter no	gpm	date read	1/1/2020
12/1/2019	Sun		27.28	7.39		32648							
12/2/2019	Mon		16.13	6.97		32648			35	62045927			185822
12/3/2019	Tue	13:00	9.61	7.01	24	32719	71	16.44	35a	62472971			876358
12/4/2019	Wed		11.58	6.94		32719			30a	62123512			
12/5/2019	Thu	13:00	10.32	7.73	21	32753	34	11.81	29	62156803			61456673
12/6/2019	Fri		20.89	7.16		32753			28a	62311246			15949
12/7/2019	Sat		17.55	7.63		32753			28b	65118783			13493
12/8/2019	Sun		23.84	7.69		32753			26	62156804			23810373
12/9/2019	Mon	12:30	13.49	7.51	19	32816	63	10.94	20c	62123514			25356231
12/10/2019	Tue		12.52	7.32		32816			20	65118782			15271683
12/11/2019	Wed		10.36	7.25		32816			20d	69802383			88023876
12/12/2019	Thu		13.50	7.22		32816			20T	69802384			93221758
12/13/2019	Fri	11:00	19.12	7.31	16	32861	45	7.81	20Y	79433733			7670432
12/14/2019	Sat		21.47	10.24		32861							
12/15/2019	Sun		21.76	7.28		32861							
12/16/2019	Mon		11.79	7.52		32861							
12/17/2019	Tue		13.50	6.92		32861							
12/18/2019	Wed	10:00	12.93	7.05	14	32936	75	10.42					
12/19/2019	Thu		13.25	7.37		32936							
12/20/2019	Fri	18:00	18.14	9.92	12	32974	38	13.19					
12/21/2019	Sat		21.11	11.03		32974							
12/22/2019	Sun		25.79	12.26		32974							
12/23/2019	Mon	11:00	32.53	11.13	9	33037	63	14.58					
12/24/2019	Tue		18.49	7.69		33037							
12/25/2019	Wed		21.83	8.09		33037							
12/26/2019	Thu		21.69	8.21		33037							
12/27/2019	Fri	13:00	29.77	8.95	5 45	33125	88	15.28					
12/28/2019	Sat		38.54	12.20		33125							
12/29/2019	Sun		43.00	9.57		33125							
12/30/2019	Mon	16:00	27.74	9.10	42	33223	98	22.69					
12/31/2019	Tue	16:30	49.55	12.39	40	33243	20	13.89					
			49.55	6.923			595						

1000's of gallons
this month

24966
8277

RECEIVED
DEC 27 2021
OWRD

Lady Creek monthly operator report

Jan-20

DATE	TIME	CI	Peak flow	Low flow	tank level	Read	use	Average Demand	Pr station	meter no	date read	
		PPM				33243	1000's	gpm			1/30/2020	
1/1/2020	Wed		27.7	11.1		33243						
1/2/2020	Thu		23.2	7.9		33243			35	62045927	274362	
1/3/2020	Fri	17:45	0.50	25.8	8.0	37	33311	68	9.44	0	35a 62472971	1300083
1/4/2020	Sat			23.9	10.8		33311			1	30a 62123512	
1/5/2020	Sun			18.3	8.0		33311			2	29 62156803	65027425
1/6/2020	Mon	7:20	0.50	11.8	7.5	35	33362	51	11.81	0	28a 62311246	28459
1/7/2020	Tue			10.5	7.3		33362			1	28b 65118783	29909
1/8/2020	Wed			10.6	7.3		33362			2	26 62156804	25911779
1/9/2020	Thu			20.3	7.6		33362			3	20e 62123514	27053268
1/10/2020	Fri	14:00	0.40	26.3	17.2	32	33432	70	12.15	0	20 65118782	15272009
1/11/2020	Sat			42.7	10.6		33432			1	20d 69802383	88724438
1/12/2020	Sun			42.2			33432			2	20T 69802384	93432826
1/13/2020	Mon	14:00	0.40	10.0	7.5	28	33516	84	19.44	0	20y 79433733	7809762
1/14/2020	Tue			10.1	7.5		33516			1		
1/15/2020	Wed			10.3	7.6		33516			2		
1/16/2020	Thu			10.4	7.6		33516			3		
1/17/2020	Fri	10:45	0.40	21.5	7.9	24	33562	46	7.99	0		
1/18/2020	Sat			43.6	10.5		33562			1		
1/19/2020	Sun			40.5	13.3		33562			2		
1/20/2020	Mon	13:00	0.50	32.5	8.5	21	33639	77	17.82	0		
1/21/2020	Tue			10.7	7.8		33639			1		
1/22/2020	Wed			11.4	7.8		33639			2		
1/23/2020	Thu			13.6	7.9		33639			3		
1/24/2020	Fri	12:30	0.40	38.1	8.3	18	33700	61	10.59	0		
1/25/2020	Sat			43.6	21.3		33700			1		
1/26/2020	Sun			42.2	8.7		33700			2		
1/27/2020	Mon	17:45	0.40	12.2	8.1	14	33801	101	23.38	0		
1/28/2020	Tue			13.3	7.9		33801			1		
1/29/2020	Wed			11.4	8.1		33801			2		
1/30/2020	Thu			17.9	8.1		33801			3		
1/31/2020	Fri	19:15	0.40	17.8	8.4	11	33869	68	11.81	0		
							626					
			43.612	7.33								

1000's of gallons
this month

13880

RECEIVED

DEC 27 2021

OWRD

Lady Creek monthly operator report

Feb-20

DATE	TIME	Cl PPM	Peak flow	Low flow	Bleach tank level	Read	use 1000's	Average Demand gpm		Pr station	meter no	gpm	date read	
2/1/2020	Sat		22.84	9.65		33869			0					2/28/2020
2/2/2020	Sun		29.49	9.69		33869			1					
2/3/2020	Mon	14:00	0.40	17.82	9.85	7 49	33936	67	15.51	0	35	62045927		364850
2/4/2020	Tue			12.83	9.38		33936			1	35a	62472971		1771550
2/5/2020	Wed			11.73	9.16		33936			2	30a	62123512		
2/6/2020	Thu			13.71	9.17		33936			3	29	62156803		69122600
2/7/2020	Fri	17:30	0.40	23.58	13.61	45	34008	72	12.50	0	28a	62311246		38966
2/8/2020	Sat			30.36	13.58		34008			1	28b	65118783		36150
2/9/2020	Sun			32.91	12.51		34008			2	26	62156804		28051699
2/10/2020	Mon			15.39	11.22		34008			3	20e	62123514		28789606
2/11/2020	Tue	11:00	0.40	15.37	10.94	42	34096	88	15.28	0	20	65118782		15285277
2/12/2020	Wed			16.57	10.94		34096			1	20d	69802383		89457891
2/13/2020	Thu			15.12	10.82		34096			2	20T	69802384		93739778
2/14/2020	Fri	15:30	0.40	40.10	11.81	39	34152	56	12.96	0		79433733		7973735
2/15/2020	Sat			45.11	28.22		34152			1				
2/16/2020	Sun			50.30	29.22		34152			2				
2/17/2020	Mon			40.64	12.89		34152			3				
2/18/2020	Tue	13:45	0.40	15.36	11.41	32	34312	160	27.78	0				
2/19/2020	Wed			15.37	10.96		34312			1				
2/20/2020	Thu			26.35	11.18		34312			2				
2/21/2020	Fri	11:00	0.40	31.19	11.56	30	34362	50	11.57	0				
2/22/2020	Sat			27.99	12.49		34362			1				
2/23/2020	Sun			32.99	12.31		34362			2				
2/24/2020	Mon			15.17	11.60		34362			3				
2/25/2020	Tue	18:00	0.40	14.12	11.60	25	34466	104	18.06	0				
2/26/2020	Wed			16.52	11.60		34466			1				
2/27/2020	Thu			15.68	11.93		34466			2				
2/28/2020	Fri	16:30	0.40	31.44	11.96	22	34516	50	11.57	0				
2/29/2020	Sat			33.431	13.256		34516			1				
										0				
										0				
										0				
										647				
			50.302	9.159										

1000's of gallons
this month

RECEIVED

DEC 27 2021

OWRD

Lady Creek monthly operator report

Mar-20

DATE	TIME	Cl	Peak flow	Low flow	tank level	Read	use	Average Demand	Pr station	meter no	gpm	date read
		PPM				34516	1000's	gpm				3/31/2020
3/1/2020	Sun		37.7	8.4		34516		4				
3/2/2020	Mon	12:00	12.2	8.0	17	34600	84	5	35	62045927		480247
3/3/2020	Tue		11.5	7.9		34600		0	35a	62472971		2269218
3/4/2020	Wed		10.5	7.9		34600		1	30a	62123512		
3/5/2020	Thu		25.0	8.0		34600		2	29	62156803		73246722
3/6/2020	Fri		24.9	7.9		34600		3	28a	62311246		52775
3/7/2020	Sat	14:00	29.3	15.4	15	34679	79	4	28b	65118783		46688
3/8/2020	Sun		31.5	11.4		34679		0	26	62156804		30958719
3/9/2020	Mon	15:45	14.7	11.1	14	34728	49	1	20e	62123514		30897308
3/10/2020	Tue		18.6	11.9		34728		1	20	65118782		5085
3/11/2020	Wed		18.6	15.6		34728		2	20d	69802383		33864
3/12/2020	Thu		23.1	14.4		34728		3	20T	69802384		94211377
3/13/2020	Fri	12:00	21.3	10.6	8 48	34820	92	0	20y	79433733		8160699
3/14/2020	Sat		27.3	13.0		34820		1				
3/15/2020	Sun		33.0	13.1		34820		2				
3/16/2020	Mon	11:45	26.5	11.7	45	34890	70	0				
3/17/2020	Tue		15.7	8.6		34890		1				
3/18/2020	Wed		16.0	8.5		34890		2				
3/19/2020	Thu		17.1	8.9		34890		3				
3/20/2020	Fri	15:30	24.9	8.6	42	34964	74	0				
3/21/2020	Sat		33.1	14.0		34964		1				
3/22/2020	Sun		36.6	9.5		34964		2				
3/23/2020	Mon	9:45	27.1	9.9	38	35046	82	0				
3/24/2020	Tue		34.9	12.1		35046		1				
3/25/2020	Wed		35.9	12.9		35046		2				
3/26/2020	Thu		37.5	9.2		35046		3				
3/27/2020	Fri	12:00	33.4	9.9	33	35167	121	0				
3/28/2020	Sat		32.5	14.2		35167		1				
3/29/2020	Sun		34.8	13.6		35167		2				
3/30/2020	Mon	13:00	19.0	10.4	26	35251	84	0				
3/31/2020	Tue		18.7	9.4		35251		1				
						735						

19880

1000's of gallons
this month

RECEIVED

DEC 27 2021

OWRD

Lady Creek monthly operator report

MT/YR

Apr-20

DATE	TIME	CI	Peak flow	Low flow	tank level	Read	use	Average Demand	Pr station	meter no	gpm	date read
		PPM				35251	1000's	gpm				4/28/2020
4/1/2020	Wed		16	9		35251		2				
4/2/2020	Thu		19	9		35251		3	35	62045927		610410
4/3/2020	Fri	12:00	0.40	22	13	26	35327	76	13.19	35a	62472971	2679553
4/4/2020	Sat		34	10		35327		1	30a	62123512		
4/5/2020	Sun		28	13		35327		2	29	62156803		77016203
4/6/2020	Mon	12:00	0.40	20	10	23	35399	72	16.67	28a	62311246	67127
4/7/2020	Tue		17	10		35399		1	28b	65118783		73484
4/8/2020	Wed		21	10		35399		2	26	62156804		32965739
4/9/2020	Thu		23	10		35399		3	20e	62123514		32963684
4/10/2020	Fri	18:15	0.50	32	10	20	35490	91	15.80	20	65118782	26648
4/11/2020	Sat		47	22		35490		1	20d	69802383		107588
4/12/2020	Sun		42	12		35490		2	20T	69802384		94419611
4/13/2020	Mon	10:30	0.40	25	10	14	35592	102	23.61	20Y	79433733	8347663
4/14/2020	Tue		19	9		35592		1				
4/15/2020	Wed		22	10		35592		2				
4/16/2020	Thu		21	10		35592		3				
4/17/2020	Fri	12:00	0.40	29	10	10	35667	75	13.02			
4/18/2020	Sat		37	13		35667		1				
4/19/2020	Sun		43	14		35667		2				
4/20/2020	Mon	10:15	0.40	25	12	6 49	35756	89	20.60			
4/21/2020	Tue		22	12		35756		1				
4/22/2020	Wed		19	12		35756		2				
4/23/2020	Thu		19	10		35756		3				
4/24/2020	Fri	11:15	0.50	23	11	46	35847	91	15.80			
4/25/2020	Sat		27	12		35847		1				
4/26/2020	Sun		30	12		35847		2				
4/27/2020	Mon	8:45	0.50	23	12	42	35916	69	15.97			
4/28/2020	Tue		19	9		35916		1				
4/29/2020	Wed		18	9		35916		2				
4/30/2020	Thu		22	10		35916		3				
						35916		0				
			47.106	8.564				665				

1000's of gallons
this month

RECEIVED

DEC 27 2021

OWRD

Lady Creek monthly operator report

May-20

DATE	TIME	Cl	Peak flow	Low flow	tank level	Read	use	Average Demand	Pr station	meter no	gpm	date read	5/30/2020
		PPM				35916	1000's	gpm					
5/1/20	Fri		22.6	13.1		35916		4					
5/2/20	Sat	12:15	0.50	32.5	12.9	36019	103	14.31	0	35	62045927		713803
5/3/20	Sun			46.5	13.2	36019		1	1	35a	62472971		3235826
5/4/20	Mon	12:30	0.50	20.6	12.1	36083	64	22.22	0	30a	62123512		
5/5/20	Tue			18.4	12.1	36083		1	1	29	62156803		82455714
5/6/20	Wed			22.7	12.3	36083		2	2	28a	62311246		88303
5/7/20	Thu			20.4	12.3	36083		3	3	28b	65118783		85671
5/8/20	Fri	16:00	0.50	26.9	12.6	36183	100	17.36	0	26	62156804		36311373
5/9/20	Sat			45.6	13.0	36183		1	1	20e	62123514		35184327
5/10/20	Sun			38.0	13.1	36183		2	2	20	65118782		56009
5/11/20	Mon	13:30	0.50	29.0	15.8	36276	93	21.53	0	20d	69802383		202736
5/12/20	Tue			26.3	16.7	36276		1	1	20T	69802384		94733184
5/13/20	Wed			26.2	16.6	36276		2	2	20y	79433733		8588144
5/14/20	Thu			23.3	16.8	36276		3	3				
5/15/20	Fri	16:00	0.50	28.8	17.5	36394	118	20.49	0				
5/16/20	Sat			41.5	15.9	36394		1	1				
5/17/20	Sun			29.8	11.4	36394		2	2				
5/18/20	Mon	16:00	0.50	16.7	9.4	36470	76	17.59	0				
5/19/20	Tue			17.4	9.7	36470		1	1				
5/20/20	Wed			15.9	9.6	36470		2	2				
5/21/20	Thu			16.9	9.7	36470		3	3				
5/22/20	Fri	16:30	0.40	25.8	9.7	36545	75	13.02	0				
5/23/20	Sat			37.1	10.4	36545		1	1				
5/24/20	Sun			44.4	11.0	36545		2	2				
5/25/20	Mon	15:25	0.50	36.4	10.8	36650	105	24.31	0				
5/26/20	Tue			23.1	10.1	36650		1	1				
5/27/20	Wed			19.8	9.7	36650		2	2				
5/28/20	Thu			21.9	9.8	36650		3	3				
5/29/20	Fri	9:15	0.60	26.2	9.8	36725	75	13.02	0				
5/30/20	Sat			31.6	9.9	36725		1	1				
5/31/20	Sun			47.5	11.7	36725		2	2				
				47.5	9.4		809						

1000's of gallons
this month

13880

RECEIVED

DEC 27 2021

OWRD

Lady Creek monthly operator report

MT/YR

Jun-20

DATE	TIME	Cl	Peak flow	Low flow	tank level	Read	use	Average Demand	Pr station	meter no	gpm	date read
		PPM					1000's	gpm				7/3/2020
6/1/20	Mon	14:00	0.50	44.4	26.1	45	36725					
6/2/20	Tue			37.7	31.5		36826	101	17.53	3		
6/3/20	Wed			39.3	32.7		36826			1	35	62045927
6/4/20	Thu			42.3	32.9		36826			2	35a	62472971
6/5/20	Fri	12:00	0.50	57.0	36.3	38	37008	182	31.60	3	30a	62123512
6/6/20	Sat			63.6	37.2		37008			0	29	62156803
6/7/20	Sun			51.9	34.9		37008			1	28a	62311246
6/8/20	Mon			40.6	10.9		37008			2	28b	65118783
6/9/20	Tue	15:45	0.50	16.6	9.7	27	37216	208	36.11	3	26	62156804
6/10/20	Wed			19.4	9.3		37216			0	20e	62123514
6/11/20	Thu			34.3	9.5		37216			1	20	65118782
6/12/20	Fri	13:00	0.40	39.6	28.0	23	37290	74	17.13	2	20d	69802383
6/13/20	Sat			46.3	28.5		37290			0	20T	69802384
6/14/20	Sun			48.3	12.9		37290			1	20y	79433733
6/15/20	Mon			22.0	9.4		37290			2		
6/16/20	Tue	16:00	0.50	19.7	9.4	16	37425	135	23.44	3		
6/17/20	Wed			32.1	9.7		37425			0		2019195
6/18/20	Thu			35.5	9.8		37425			1		
6/19/20	Fri	14:40	0.50	47.8	10.8	13	37504	79	18.29	2		
6/20/20	Sat			32.1	11.4		37504			0		
6/21/20	Sun			38.5	12.5		37504			1		
6/22/20	Mon	19:20	0.40	24.4	11.9	8 49	37594	90	20.83	2		
6/23/20	Tue			25.5	9.9		37594			0		
6/24/20	Wed			20.6	11.5		37594			1		
6/25/20	Thu			18.2	9.6		37594			2		
6/26/20	Fri			24.8	9.7		37594			3		
6/27/20	Sat	17:45	0.40	32.9	10.2	43	37706	112	15.56	4		
6/28/20	Sun			31.9	10.3		37706			0		
6/29/20	Mon	17:30	0.50	18.7	9.9	40	37762	56	19.44	1		
6/30/20	Tue			15.9	8.7		37762			0		
											1037	
			63.626	8.674								1000's of gallons this month

RECEIVED

DEC 27 2021

GWRD

Lady Creek monthly operator report

MT/YR

Jul-20

DATE	TIME	Cl	Peak flow	Low flow	tank level	Read	use	Average Demand	Pr station	meter no	gpm	date read	8/1/2020
		PPM				37762	1000's	gpm					
7/1/20	Wed		15.9	8.8		37762		6					
7/2/20	Thu		21.2	9.0		37762		7	35	62045927			867874.2
7/3/20	Fri	16:30	0.50	46.8	12.7	37842	80	6.17	0	35a	62472971		4635702.8
7/4/20	Sat			47.3	14.8	37842		1		30a	62123512		
7/5/20	Sun			54.4	14.6	37842		2		29	62156803		95916362
7/6/20	Mon	10:15	0.50	35.9	10.4	37938	96	22.22	0	28a	62311246		120657.3
7/7/20	Tue			19.5	9.5	37938		1		28b	65118783		116074.9
7/8/20	Wed			17.3	9.3	37938		2		26	62156804		40728465
7/9/20	Thu			21.3	9.0	37938		3		20e	62123514		41379668
7/10/20	Fri	13:30	0.50	30.4	15.1	38032	94	16.32	0	20	65118782		95627.5
7/11/20	Sat			36.6	13.4	38032		1		20d	69802383		538428
7/12/20	Sun			39.1	14.0	38032		2		20T	69802384		96045698
7/13/20	Mon	16:45	0.40	27.3	13.5	38127	95	21.99	0		79433733		9188785
7/14/20	Tue			26.8	14.0	38127		1					
7/15/20	Wed			25.0	14.4	38127		2					
7/16/20	Thu			25.1	15.1	38127		3					
7/17/20	Fri	13:50	0.40	30.3	15.5	38215	88	15.28	0				
7/18/20	Sat			40.5	16.8	38215		1					
7/19/20	Sun			43.4	17.5	38215		2					
7/20/20	Mon			32.2	17.1	38215		3					
7/21/20	Tue	8:40	0.40	31.4	18.0	38341	126	21.88	0				
7/22/20	Wed			34.0	18.2	38341		1					
7/23/20	Thu			31.9	17.4	38341		2					
7/24/20	Fri	16:00	0.40	31.2	17.5	38453	112	25.93	0				
7/25/20	Sat			40.9	18.1	38453		1					
7/26/20	Sun			44.4	20.1	38453		2					
7/27/20	Mon	17:00	0.50	37.2	17.1	38586	133	30.79	0				
7/28/20	Tue			27.0	16.1	38586		1					
7/29/20	Wed			27.1	15.4	38586		2					
7/30/20	Thu			27.0	14.9	38586		3					
7/31/20	Fri	18:15	0.50	31.2	15.5	38706	120	20.83	0				
							944						
			54.368	8.798									

1000's of gallons
this month

13880

RECEIVED

DEC 27 2021

OWRD

Lady Creek monthly operator report

MT/YR

Aug-20

DATE	TIME	Cl PPM	Peak flow	Low flow	tank level	Read	use 1000's	Average Demand gpm	Pr station	meter no	date read	9/1/2020
8/1/2020	Sat		40.3	17.2		38706		3				
8/2/2020	Sun		55.1	19.1		38706		4	35	62045927		
8/3/2020	Mon	17:45	0.40	37.4	18.9	38817	111	15.42	35a	62472971		960284.1
8/4/2020	Tue		31.6	19.4	34	38817		1	30a	62123512		5522195.9
8/5/2020	Wed		38.2	19.4		38817		2	29	62156803		4440313
8/6/2020	Thu		29.1	19.4		38817		3	28a	62311246		144061.1
8/7/2020	Fri	11:00	0.40	37.1	20.8	38985	168	29.17	28b	65118783		136367.2
8/8/2020	Sat		46.7	21.5		38985		1	26	73573467		78650.9
8/9/2020	Sun		51.5	23.4		38985		2	20c	62123514		60001.8
8/10/2020	Mon		32.0	22.8		38985		3	20	65118782		10094.1
8/11/2020	Tue	18:15	0.40	37.5	23.7	39126	141	24.48	20d	69802383		609068.1
8/12/2020	Wed		46.8	24.8	16	39126		1	20T	69802384		96423994
8/13/2020	Thu		41.9	25.7		39126		2	20Y	79433733		9353123
8/14/2020	Fri	9:00	0.30	41.7	24.6	39232	106	24.54				
8/15/2020	Sat		51.8	26.3	6 48	39232		1				
8/16/2020	Sun		55.3	29.0		39232		2				
8/17/2020	Mon		52.1	29.3		39232		3				
8/18/2020	Tue		50.6	35.0		39232		4				
8/19/2020	Wed		56.8	40.5		39232		5				
8/20/2020	Thu		55.8	42.2		39232		6				
8/21/2020	Fri	14:00	0.40	52.4	10.8	39628	396	39.29				
8/22/2020	Sat	12:30	0.40	30.9	8.9	39663	35	24.31				
8/23/2020	Sun		34.7	10.3		39663		1				
8/24/2020	Mon	10:30	0.50	25.9	9.1	39706	43	14.93				
8/25/2020	Tue		27.1	8.4	28	39706		1				
8/26/2020	Wed		20.0	8.3		39706		2				
8/27/2020	Thu		20.7	8.3		39706		3				
8/28/2020	Fri		24.1	8.6		39706		4				
8/29/2020	Sat	11:45	0.50	39.8	9.2	39811	105	14.58				
8/30/2020	Sun		33.2	9.8	24	39811		1				
8/31/2020	Mon	18:15	0.50	26.4	9.7	39882	71	24.65				
							1176					
			56.771	8.318								

1000's of gallons
this month

RECEIVED

DEC 27 2021

OWRD

Lady Creek monthly operator report

Sep-20

DATE	TIME	Cl	Peak flow	Low flow	tank level	Read	use	Average Demand	Pr station	meter no	gpm	date read
		PPM				39882	1000's	gpm				10/1/2020
9/1/2020	Tue		16.9	8.6		39882						
9/2/2020	Wed		17.1	9.6		39882			35	62045927		1116191
9/3/2020	Thu		21.8	8.7		39882			35a	62472971		5948696
9/4/2020	Fri	12:30	30.3	9.5	18	39944	62	10.76	30a	62123512		
9/5/2020	Sat		37.7	11.0		39944			29	62156803		8291325
9/6/2020	Sun		50.9	11.0		39944			28a	62311246		156499.4
9/7/2020	Mon		48.1	8.7	power out	39944			28b	65118783		143400
9/8/2020	Tue		20.2	8.7		39944			26	62156804		230906.4
9/9/2020	Wed		26.2	8.8		39944			20e	62123514		189274.7
9/10/2020	Thu		9.4	-25.0	gen off	39944			20	65118782		103719.5
9/11/2020	Fri					39944			20d	69802383		669097.6
9/12/2020	Sat					39944			20T	69802384		96658431
9/13/2020	Sun					39944			20y	79433733		9474215
9/14/2020	Mon				power on late	39944						
9/15/2020	Tue	11:20	0.60	14.1	8 48	40129	185	11.68				
9/16/2020	Wed			15.5		40129						
9/17/2020	Thu			10.1		40129						
9/18/2020	Fri	17:45	0.50	10.5	44	40215	86	19.91				
9/19/2020	Sat			13.2		40215						
9/20/2020	Sun			19.3		40215						
9/21/2020	Mon	14:35	0.50	14.4	42	40265	50	11.57				
9/22/2020	Tue			15.5		40265						
9/23/2020	Wed			17.3		40265						
9/24/2020	Thu			17.1		40265						
9/25/2020	Fri			34.4		40265						
9/26/2020	Sat	14:15	0.50	44.3	37	40390	125	17.36				
9/27/2020	Sun			40.8		40390						
9/28/2020	Mon			37.0		40390						
9/29/2020	Tue			38.0		40390						
9/30/2020	Wed			36.0		40570	180	31.25				
							688					
			50.942	-24.985								

1000's of gallons
this month

19880

RECEIVED

DEC 27 2021

OWRD

Lady Creek monthly operator report

MT/YR

Oct-20

DATE	TIME	CI	Peak flow	Low flow	tank level	Read	use	Average Demand	Pr station	meter no	gpm	date read
		PPM					1000's	gpm	days			11/1/2020
10/1/2020	Thu		33.5	12.4		40570			5			
10/2/2020	Fri	12:30	26.9	11.1	26	40618	48	5.56	0	35	62045927	1183466.5
10/3/2020	Sat		32.0	13.3		40618			1	35a	62472971	6501289.3
10/4/2020	Sun		33.6	11.2		40618			2	30a	62123512	
10/5/2020	Mon		21.5	12.6		40618			3	29	62156803	13653070
10/6/2020	Tue	13:25	29.8	12.0	21	40727	109	18.92	0	28a	62311246	172825
10/7/2020	Wed		19.0	12.2		40727			1	28b	65118783	152257
10/8/2020	Thu		25.8	10.8		40727			2	26	62156804	469728.8
10/9/2020	Fri	12:55	22.3	10.9	18	40793	66	15.28	0	20e	62123514	394898.7
#####	Sat		40.6	12.9		40793			1	20	65118782	105000.5
#####	Sun		27.6	12.2		40793			2	20d	69802383	749564.5
#####	Mon	11:45	27.7		16	40864	71	16.44	0	20T	69802384	97203032
#####	Tue		30.7	23.3		40864			1	20y	79433733	9677066
#####	Wed		27.8	12.6		40864			2			
#####	Thu		24.0	12.1		40864			3			
#####	Fri	12:30	25.4	12.3	9 49	40990	126	21.88	0			
#####	Sat		21.7	11.8		40990			1			
#####	Sun		29.5	10.6		40990			2			
#####	Mon	12:00	17.0	9.7	46	41059	69	15.97	0			
#####	Tue		14.2	8.9		41059			1			
#####	Wed		21.7	8.7		41059			2		105000.5	
#####	Thu		27.3	8.7		41059			3		749564.5	
#####	Fri	15:15	29.8	9.2	43	41130	71	12.33	0		394898.7	
#####	Sat		27.8	12.9		41130			1		469728.8	
#####	Sun		31.1	11.1		41130			2		172824.5	
#####	Mon	16:30	23.5	10.5	40	41199	69	15.97	0		152256.9	
#####	Tue		22.1	11.5		41199			1		1183466.5	
#####	Wed		20.8	10.6		41199			2		6501289.3	
#####	Thu		16.8	10.7		41199			3			
#####	Fri	15:00	27.6	11.0	36	41285	86	14.93	0			
#####	Sat		28.6	10.3		41285			0			
							715					
							1000's of gallons this month					

RECEIVED

DEC 27 2021

OWRD

Lady Creek monthly operator report

Nov-20

DATE	TIME	Cl	Peak flow	Low flow	tank level	Read	use	Average Demand	Pr station	meter no	gpm	date read	
		PPM				41285	1000's	gpm				12/1/2020	
11/1/2020	Sun		29.53	11.92		41285		1					
11/2/2020	Mon	14:00	0.50	25.25	14.44	32	41356	71	24.65	0	35	62045927	1237471.4
11/3/2020	Tue			26.68	12.57		41356			1	35a	62472971	7022549.1
11/4/2020	Wed			15.61	12.17		41356			2	30a	62123512	
11/5/2020	Thu			18.14	12.02		41356			3	29	62156803	18349626
11/6/2020	Fri	16:45	0.40	39.08	12.80	28	41448	92	15.97	0	28a	62311246	186515.7
11/7/2020	Sat			34.14	17.34		41448			1	28b	65118783	164445.1
11/8/2020	Sun			35.83	15.87		41448			2	26	62156804	705071.8
11/9/2020	Mon	11:45	0.60	30.05	13.48	24	41539	91	21.06	0	20e	62123514	586077.1
11/10/2020	Tue			29.18	13.09		41539			1	20	65118782	114839
11/11/2020	Wed			24.76	13.66		41539			2	20d	69802383	840294.3
11/12/2020	Thu			24.41	14.10		41539			3	20T	69802384	97403921
11/13/2020	Fri	14:00	0.50	23.39	12.48	18	41637	98	17.01	0	20 y	79433733	9808608
11/14/2020	Sat			30.45	9.89		41637			1			
11/15/2020	Sun			24.57	10.43		41637			2			
11/16/2020	Mon	16:45	0.40	17.02	9.54	15	41695	58	13.43	0			
11/17/2020	Tue			12.24	9.38		41695			1			
11/18/2020	Wed			22.90	9.22		41695			2			
11/19/2020	Thu			17.33	9.04		41695			3			
11/20/2020	Fri	15:15	0.50	22.10	9.76	12	41762	67	11.63	0			
11/21/2020	Sat			33.16	11.21		41762			1			
11/22/2020	Sun			32.46	15.06		41762			2			
11/23/2020	Mon	10:00	0.50	17.88	10.41	6 48	41841	79	18.29	0			
11/24/2020	Tue			21.90	8.73		41841			1			
11/25/2020	Wed			25.13	9.03		41841			2			
11/26/2020	Thu			29.73	9.28		41841			3			
11/27/2020	Fri	15:00	0.40	30.37	10.29	42	41930	89	15.45	0			
11/28/2020	Sat			37.89	10.87		41930			1			
11/29/2020	Sun			38.68	9.68		41930			2			
11/30/2020	Mon	13:15	0.60	16.55	8.63	35	42012	82	18.98	0			
							42012			1			

727
1000's of gallons
this month

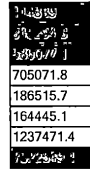

13880

RECEIVED

DEC 27 2021

OWRD

Lady Creek monthly operator report

MT/YR

Dec-20

DATE	TIME	Cl PPM	Peak flow	Low flow	bleach tank	Read	use 1000's	Average Demand gpm	Pr station	meter no	gpm	date read	1/1/2021
12/1/2020	Tue		16.78	9.68		42012					1		
12/2/2020	Wed		21.52	9.03		42012					2		
12/3/2020	Thu		23.85	13.33		42012					3		
12/4/2020	Fri	10:30	0.40	45.89	12.69	24	42089	77	13.37	0	30a	62123512	
12/5/2020	Sat			42.67	14.97		42089			1	29	62156803	
12/6/2020	Sun			28.57	10.22		42089			2	28a	62311246	23095383
12/7/2020	Mon	10:45	0.40	17.62	9.96	21	42174	85	19.68	0	28b	65118783	199292.3
12/8/2020	Tue			16.26	9.76		42174			1	26	62156804	176164.2
12/9/2020	Wed			19.31	9.43		42174			2	20c	62123514	908179.1
12/10/2020	Thu			14.44	9.68		42174			3	20	65118782	766660.5
12/11/2020	Fri	11:00	0.50	20.60	10.14	17	42248	74	12.85	0	20d	69802383	115647.6
12/12/2020	Sat			33.07	10.30		42248			1	20T	69802384	956492.2
12/13/2020	Sun			31.52	12.63		42248			2	20Y	79433733	97774471
12/14/2020	Mon			17.09	9.48		42248			3			9984336
12/15/2020	Tue	12:30	0.50	31.41	10.66	12	42333	85	14.76	0			
12/16/2020	Wed			20.51	12.35		42333			1			
12/17/2020	Thu			19.62	10.95		42333			2			
12/18/2020	Fri	13:15	0.40	25.82	10.88	9	42410	77	17.82	0			
12/19/2020	Sat			24.57	9.93		42410			1			
12/20/2020	Sun			27.49	10.14		42410			2			
12/21/2020	Mon			22.60	9.32		42410			3			
12/22/2020	Tue	9:20	0.40	20.32	9.55	5 48	42491	81	14.06	0			
12/23/2020	Wed			28.68	9.84		42491			1			
12/24/2020	Thu			21.26	9.34		42491			2			
12/25/2020	Fri			26.44	9.65		42491			3			
12/26/2020	Sat	14:45	0.40	40.24	10.79	44	42628	137	23.78	0			
12/27/2020	Sun			37.71	11.95		42628			1			
12/28/2020	Mon			40.92	11.92		42628			2			
12/29/2020	Tue			40.75	12.13		42628			3			
12/30/2020	Wed	13:30	0.50	43.15	18.88	37	42766	138	23.96	0			
12/31/2020	Thu			42.06	11.18		42766			1			
				45.891	9.025			754					

1000's of gallons
this month

RECEIVED

DEC 27 2021

OWRD

Water Use - Lady Creek Water System (Certificate 89509)

Water Year	Oct	Nov	Dec	Jan	Feb	Mar	Apr	May	Jun	Jul	Aug	Sep	Total Water Used (Acre-Feet)
2021	2.19	2.23	2.31	0.00	0.00	0.00	0.00	0.00	0.00	0.00	0.00	0.00	6.74
2020	1.88	1.71	1.83	1.92	1.99	2.26	2.04	2.48	3.18	2.90	3.61	2.11	27.90
2019	1.47	1.72	1.76	2.42	1.62	2.37	2.44	2.44	2.14	2.76	2.15	1.66	24.93
2018	1.51	1.54	1.95	1.99	2.03	2.61	2.37	2.14	2.64	3.21	3.22	3.22	28.42
2017	2.15	2.05	3.53	3.06	1.58	1.76	1.71	2.18	2.17	2.93	2.63	2.34	28.09
2016	1.58	2.30	3.02	3.73	2.38	2.08	1.94	1.92	2.26	2.18	2.94	2.69	29.03

0
00
00
00
11

RECEIVED

DEC 27 2021

OWWRD

RECEIVED

DEC 27 2021

OWRD

Attachment D

Supplemental Form D

Transfer Application for Certificate 89509

13880

DEC 27 2021

Supplemental Form D

OWRD

Water Right Transfers Within the Boundaries of or Served by an Irrigation District or other Water Supplier (Association, Ditch Co., etc.)

[For transfers submitted under OAR Chapter 690 Division 380]



Oregon Water Resources Department
725 Summer Street NE, Suite A
Salem, Oregon 97301-1266
503-986-0900
www.oregon.gov/OWRD

The Department requires non-district applicants to communicate with districts/water suppliers during the planning and preparation of transfer applications involving water rights having a point of diversion or appropriation (POD/POA) or place of use (POU) served by or located within the boundaries of an irrigation district, or other type of water supplier to which assessments are paid. In some cases consent will be required from the district or water supplier.

This form must be included with any transfer application that involves rights served by or located within the boundaries of a district or other type of water supplier.

1. APPLICANT INFORMATION

NAME USDA FOREST SERVICE; ATTN: META LOFTSGAARDEN			PHONE (HM)	
PHONE (WK) 503-310-7953	CELL		FAX	
ADDRESS 16400 CHAMPION WAY				
CITY SANDY	STATE OR	ZIP 97055	E-MAIL** META.LOFTSGAARDEN@USDA.GOV	

2. DISTRICT or WATER SUPPLIER INFORMATION

DISTRICT/WATER SUPPLIER NAME LADY CREEK WATER SYSTEM			PHONE (HM)	
PHONE (WK) 503-310-9262	CELL		FAX	
ADDRESS PO Box 206				
CITY WELCHES	STATE OR	ZIP 97067	E-MAIL** OFFICE@LADYCREEK.ORG	

** By providing an e-mail address, the applicant and/or the district/water supplier consents to receive all correspondence from the Department electronically. Copies of final order documents will also be mailed.

3. WATER RIGHTS ISSUED IN THE NAME OF, or LOCATED WITHIN, or SERVED BY AN IRRIGATION DISTRICT, OTHER DISTRICT, OR WATER SUPPLIER

a. List the water right(s) involved in this transfer:

	Application / Decree	Permit / Previous Transfer	Certificate	Is the water right in the name of a district, water supplier, or BOR*?
1.	G-13132	G-11788	89509	YES <input type="checkbox"/>
2.		-		YES <input type="checkbox"/>
3.		-		YES <input type="checkbox"/>

Attach additional pages for additional water rights if necessary.

*Bureau of Reclamation

b. Determine a district's/water supplier's connection to your points of diversion (POD) or appropriation (POA) and places of use (POU). [You may need to consult with your district/water supplier.]

CURRENT ASSOCIATIONS Please answer the following "yes" or "no" questions:

- YES NO One or more of the current POD(s) / POA(s) involved in the transfer are served by a district/water supplier or rely on BOR water.
- YES NO All or a portion of the current POU involved in this proposed transfer receives water for either primary or supplemental irrigation from the district/water supplier; i.e., the POU is currently layered with a district or BOR water supplied water right(s).

PROPOSED ASSOCIATIONS Please answer the following "yes" or "no" questions:

- YES NO One or more of the proposed POD(s) / POA(s) involved in the transfer are currently served or will be served by a district/water supplier if the transfer is approved, or rely on BOR water.
- YES NO All or a portion of the proposed POU involved in this proposed transfer currently receives or will receive either primary or supplemental irrigation from the district/water supplier; i.e., the POU will be layered with a district/water supplier or BOR water supplied water right(s).

COMMENTS OR ADDITIONAL INFORMATION *The permit is held by the USDA Forest Service; but the water system is owned and operated by Lady Creek Water System for Quasi-Municipal use.*

4. APPLICANT'S SIGNATURE

(1) I certify that I have notified the district/water supplier about the proposed water right transfer application by [check one]:

email, phone, postal mail, in person, or other (please specify) _____

(2) I certify that to the best of my knowledge the information contained in this Supplemental Form D is true and accurate.

Meta Loftsgaarden

Digitally signed by Meta Loftsgaarden
Date: 2021.12.20 15:53:21 -08'00'

Applicant Signature

Name (print)

Date

5. (WHEN REQUIRED) DISTRICT or WATER SUPPLIER CONSENT TO THE PROPOSED WATER RIGHT TRANSFER

District Manager or Water Supplier consent is **required** if any box on this form is marked "YES."

The district/water supplier certifies the following:

- (1) The district/water supplier has reviewed the applicant's proposed water right transfer application and maps; and
- (2) The district/water supplier consents to the proposed water right transfer application.