

# Application for Permanent Water Right Transfer



Oregon Water Resources Department  
 725 Summer Street NE, Suite A  
 Salem, Oregon 97301-1266  
 (503) 986-0900  
 www.oregon.gov/OWRD

## Part 1 of 5 – Minimum Requirements Checklist

**This transfer application will be returned if Parts 1 through 5 and all required attachments are not completed and included.**  
 For questions, please call (503) 986-0900, and ask for Transfer Section.

**RECEIVED**

**FEB 07 2022**

**Check all items included with this application. (N/A = Not Applicable)**

**OWRD**

- Part 1 – Completed Minimum Requirements Checklist.
- Part 2 – Completed Transfer Application Map Checklist.
- Part 3 – Application Fee, payable by check to the Oregon Water Resources Department, and completed Fee Worksheet, page 3. Try the new online fee calculator at: [http://apps.wrd.state.or.us/apps/misc/wrd\\_fee\\_calculator](http://apps.wrd.state.or.us/apps/misc/wrd_fee_calculator).
- Part 4 – Completed Applicant Information and Signature.
- Part 5 – Information about Water Rights to be Transferred: **How many water rights are to be transferred? 1 List them here: 73838**  
 Please include a separate Part 5 for each water right. (See instructions on page 6)  
**NOTE: A separate transfer application is required for each water right unless the criteria in OAR 690-380-3220 are met.**

**Attachments:**

- Completed Transfer Application Map.
- Completed Evidence of Use Affidavit and supporting documentation.
- N/A Affidavit(s) of Consent from Landowner(s) (if the applicant does not own the land the water right is on.)
- N/A Supplemental Form D – For water rights served by or issued in the name of an irrigation district. Complete when the transfer applicant is not the irrigation district.
- N/A Oregon Water Resources Department’s Land Use Information Form with approval and signature (or signed land use form receipt stub) from each local land use authority in which water is to be diverted, conveyed, and/or used. Not required if water is to be diverted, conveyed, and/or used only on federal lands or if **all** of the following apply: a) a change in place of use only, b) no structural changes, c) the use of water is for irrigation only, and d) the use is located within an irrigation district or an exclusive farm use zone.
- N/A Water Well Report/Well Log for changes in point(s) of appropriation (well(s)) or additional point(s) of appropriation.
- N/A Geologist Report for a change from a surface water point of diversion to a ground water point of appropriation (well), if the proposed well is more than 500’ from the surface water source and more than 1000’ upstream or downstream from the point of diversion. See OAR 690-380-2130 for requirements and applicability.

**(For Staff Use Only)**

**WE ARE RETURNING YOUR APPLICATION FOR THE FOLLOWING REASON(S):**

<input type="checkbox"/> Application fee not enclosed/insufficient	<input type="checkbox"/> Map not included or incomplete
<input type="checkbox"/> Land Use Form not enclosed or incomplete	<input type="checkbox"/> Evidence of Use Form not enclosed or incomplete
<input type="checkbox"/> Additional signature(s) required	<input type="checkbox"/> Part _____ is incomplete
Other/Explanation _____	
Staff: _____ 503- _____	Date: <u>13016</u> - - -

## Part 2 of 5 – Transfer Application Map

OWRD

Your transfer application will be returned if any of the map requirements listed below are not met.

Please be sure that the transfer application map you submit includes all the required items and matches the existing water right map. Check all boxes that apply.

- N/A Certified Water Right Examiner (CWRE) Stamp and Original Signature. For a list of CWREs, see [http://apps.wrd.state.or.us/apps/wr/cwre\\_license\\_view/](http://apps.wrd.state.or.us/apps/wr/cwre_license_view/). CWRE stamp and signature are not required for substitutions.
- N/A If more than three water rights are involved, separate maps are needed for each water right.
- Permanent quality printed with dark ink on good quality paper.
- The size of the map can be 8½ x 11 inches, 8½ x 14 inches, 11 x 17 inches, or up to 30 x 30 inches. For 30 x 30 inch maps, one extra copy is required.
- A north arrow, a legend, and scale.
- The scale of the map must be: 1 inch = 400 feet, 1 inch = 1,320 feet, the scale of the Final Proof/Claim of Beneficial Use Map (the map used when the permit was certificated), the scale of the county assessor map if the scale is not smaller than 1 inch = 1,320 feet, or a scale that has been pre-approved by the Department.
- Township, Range, Section, ¼, DLC, Government Lot, and other recognized public land survey lines.
- Tax lot boundaries (property lines) are required. Tax lot numbers are recommended.
- Major physical features including rivers and creeks showing direction of flow, lakes and reservoirs, roads, and railroads.
- Major water delivery system features from the point(s) of diversion/appropriation such as main pipelines, canals, and ditches.
- Existing place of use that includes separate hachuring for each water right, priority date, and use including number of acres in each quarter-quarter section, government lot, or in each quarter-quarter section as projected within government lots, donation land claims, or other recognized public land survey subdivisions. If less than the entirety of the water right is being changed, a separate hachuring is needed for lands left unchanged.
- N/A Proposed place of use that includes separate hachuring for each water right, priority date, and use including number of acres in each quarter-quarter section, government lot, or in each quarter-quarter section as projected within government lots, donation land claims, or other recognized public land survey subdivisions.
- Existing point(s) of diversion or well(s) with distance and bearing or coordinates from a recognized survey corner. This information can be found in your water right certificate or permit.
- N/A If you are proposing a change in point(s) of diversion or well(s), show the proposed location and label it clearly with distance and bearing or coordinates. If GPS coordinates are used, latitude-longitude coordinates may be expressed as either degrees-minutes-seconds with at least one digit after the decimal (example – 42°32'15.5") or degrees-decimal with five or more digits after the decimal (example – 42.53764°).



**Part 4 of 5 – Applicant Information and Signature**

**Applicant Information**

APPLICANT/BUSINESS NAME <b>Donna Boyer</b>		PHONE NO. <b>503.264.1807</b>	ADDITIONAL CONTACT NO. <b>503.863.1983</b>
ADDRESS <b>42007 SW Vandehey Road</b>			FAX NO. <b>N/A</b>
CITY <b>Gaston</b>	STATE <b>OR</b>	ZIP <b>97119</b>	E-MAIL <b>donnajboyer@yahoo.com</b>
BY PROVIDING AN E-MAIL ADDRESS, CONSENT IS GIVEN TO RECEIVE ALL CORRESPONDENCE FROM THE DEPARTMENT ELECTRONICALLY. COPIES OF THE FINAL ORDER DOCUMENTS WILL ALSO BE MAILED.			

**Agent Information** – The agent is authorized to represent the applicant in all matters relating to this application.

AGENT/BUSINESS NAME <b>Aspen Rural Land Consulting c/o Eric Urstadt</b>		PHONE NO. <b>971.250.1520</b>	ADDITIONAL CONTACT NO. <b>503.647.1919</b>
ADDRESS <b>39290 NW Murtaugh Road</b>			FAX NO. <b>N/A</b>
CITY <b>North Plains</b>	STATE <b>OR</b>	ZIP <b>97133</b>	E-MAIL <b>ericurstadt@hotmail.com</b>
BY PROVIDING AN E-MAIL ADDRESS, CONSENT IS GIVEN TO RECEIVE ALL CORRESPONDENCE FROM THE DEPARTMENT ELECTRONICALLY. COPIES OF THE FINAL ORDER DOCUMENTS WILL ALSO BE MAILED.			

Explain in your own words what you propose to accomplish with this transfer application, and why:

This application is being done to change the Character of Use of the reservoir to "Multipurpose". If you need additional space, continue on a separate piece of paper and attach to the application as "Attachment 1".

**Check One Box**

- By signing this application, I understand that, upon receipt of the draft preliminary determination and prior to Department approval of the transfer, I will be required to provide landownership information and evidence that I am authorized to pursue the transfer as identified in OAR 690-380-4010(5); OR
- I affirm the applicant is a municipality as defined in ORS 540.510(3)(b) and that the right is in the name of the municipality or a predecessor; OR
- I affirm the applicant is an entity with the authority to condemn property and is acquiring by condemnation the property to which the water right proposed for transfer is appurtenant and have supporting documentation.

**RECEIVED**

**FEB 07 2022**

**OWRD**

By my signature below, I confirm that I understand:

- Prior to Department approval of the transfer application, I may be required to submit payment to the Department for publication of a notice in a newspaper with general circulation in the area where the water right is located, once per week for two consecutive weeks. If more than one qualifying newspaper is available, I suggest publishing the notice in the following newspaper: Forest Grove Times.
- Amendments to the application may only be made in response to the Department's Draft Preliminary Determination (DPD). The applicant will have a period of at least 30 days to amend the application to address any issues identified by the Department in the DPD, or to withdraw the application. Note that amendments may be subject to additional fees, pursuant to ORS 536.050.
- Failure to complete an approved change in place of use and/or change in character of use, will result in loss of the water right (OAR 690-380-6010).
- Refunds may only be granted upon request and, as set forth in ORS 536.050(4)(a), if the Director determines that a refund of all or part of a fee is appropriate in the interests of fairness to the public or necessary to correct an error of the Department.

I (we) affirm that the information contained in this application is true and accurate.



  
 Applicant signature

Donna Boyer, Owner  
 Print Name (and Title if applicable)

1/28/22  
 Date

---

Applicant signature

Print Name (and Title if applicable)

Date

Is the applicant the sole owner of the land on which the water right, or portion thereof, proposed for transfer is located?  Yes  No\*

\*If NO, include signatures of all deeded landowners (and mailing and/or e-mail addresses if different than the applicant's) or attach affidavits of consent (and mailing and/or e-mail addresses) from all landowners or individuals/entities to which the water right(s) were conveyed.

Check the following boxes that apply:

- The applicant is responsible for completion of change(s). Notices and correspondence should continue to be sent to the applicant.
- The receiving landowner will be responsible for completing the proposed change(s) after the final order is issued. Copies of notices and correspondence should be sent to this landowner.
- Both the receiving landowner and applicant will be responsible for completion of change(s). Copies of notices and correspondence should be sent to this landowner and the applicant.

At this time, are the lands in this transfer application in the process of being sold?  Yes  No

If YES, and you know who the new landowner will be, please complete the receiving landowner information table below. If you do not know who the new landowner will be, then a request for assignment will have to be filed for at a later date.

If a property sells, the certificated water right(s) located on the land belong to the new owner, unless a sale agreement or other document states otherwise. For more information see:

[https://www.oregon.gov/owrd/WRDFormsPDF/Transfer\\_Property\\_Transactions.pdf](https://www.oregon.gov/owrd/WRDFormsPDF/Transfer_Property_Transactions.pdf)

RECEIVING LANDOWNER NAME			PHONE NO.	ADDITIONAL CONTACT NO.
ADDRESS				FAX NO.
CITY	STATE	ZIP	E-MAIL	
Describe any special ownership circumstances:				
The confirming Certificate shall be issued in the name of: <input type="checkbox"/> Applicant <input type="checkbox"/> Receiving Landowner				

Check here if any of the water rights proposed for transfer are or will be located within or served by an irrigation or other water district. (Tip: Complete and attach Supplemental Form D.)

IRRIGATION DISTRICT NAME <b>Tualatin Valley Irrigation District</b>	ADDRESS <b>2330 Elm Street</b>	
CITY <b>Forest Grove</b>	STATE <b>OR</b>	ZIP <b>97116</b>

Check here if water for any of the rights supplied under a water service agreement or other contract for stored water with a federal agency or other entity.

ENTITY NAME <b>N/A</b>	ADDRESS	
CITY	STATE	ZIP



To meet State Land Use Consistency Requirements, you must list all county, city, municipal corporation, or tribal governments within whose jurisdiction water will be diverted, conveyed or used.

ENTITY NAME <b>Wash County - Dept of Land Use &amp; Transportation</b>	ADDRESS <b>155 N. First Ave. Ste. 350-14</b>	
CITY <b>Hillsboro</b>	STATE <b>OR</b>	ZIP <b>97124-3072</b>

ENTITY NAME	ADDRESS	
CITY	STATE	ZIP

RECEIVED

FEB 07 2022

OWRD

13916

**Part 5 of 5 – Water Right Information**

Please use a separate Part 5 for each water right being changed. See instructions on page 6, to copy and paste additional Part 5s, or to add additional rows to tables within the form.

**CERTIFICATE # 73838**

**Description of Water Delivery System**

System capacity: See Note\*\* cubic feet per second (cfs) OR  
 \_\_\_\_\_ gallons per minute (gpm)

**Note\*\* the system capacity is 2.0 acre-feet of storage. Joan Smith of the Water Resources Transfer Section stated this would be an adequate answer for this section.**

Describe the current water delivery system or the system that was in place at some time within the last five years. Include information on the pumps, canals, pipelines, and sprinklers used to divert, convey, and apply the water at the authorized place of use. **The current delivery system is a shallow ditch or depression coming from the main channel to the reservoir. The reservoir simply fills when the river is high enough. At flood stage there are several conveyance paths which have moved over time with the river.**

**Table 1. Location of Authorized and Proposed Point(s) of Diversion (POD) or Appropriation (POA)**

(Note: If the POD/POA name is not specified on the certificate, assign it a name or number here.)

POD/POA Name or Number	Is this POD/POA Authorized on the Certificate or is it Proposed?	If POA, OWRD Well Log ID# (or Well ID Tag # L-___)	Twp		Rng		Sec	¼ ¼		Tax Lot, DLC or Gov't Lot	Measured Distances (from a recognized survey corner)
<b>POD 1</b>	<input checked="" type="checkbox"/> Authorized <input type="checkbox"/> Proposed	N/A	1	S	3	W	30	SW	NW	700**	745' North and 670' East of W 1/4 S30.

**\*\*Note: The certificate map shows the reservoir about 1/4 mile northeast of where it truly is and also on the wrong tax lot. The included map fixes that and any related errors.**

**Check all type(s) of change(s) proposed below (change "CODES" are provided in parentheses):**

- |                                                                        |                                                                   |
|------------------------------------------------------------------------|-------------------------------------------------------------------|
| <input type="checkbox"/> Place of Use (POU)                            | <input type="checkbox"/> Supplemental Use to Primary Use (S to P) |
| <input checked="" type="checkbox"/> Character of Use (USE)             | <input type="checkbox"/> Point of Appropriation/Well (POA)        |
| <input type="checkbox"/> Point of Diversion (POD)                      | <input type="checkbox"/> Additional Point of Appropriation (APOA) |
| <input type="checkbox"/> Additional Point of Diversion (APOD)          | <input type="checkbox"/> Substitution (SUB)                       |
| <input type="checkbox"/> Surface Water POD to Ground Water POA (SW/GW) | <input type="checkbox"/> Government Action POD (GOV)              |

**Will all of the proposed changes affect the entire water right?**

- Yes Complete only the Proposed ("to" or "on" lands) section of Table 2 on the next page. Use the "CODES" listed above to describe the proposed changes.
- No Complete all of Table 2 to describe the portion of the water right to be changed.

Please use and attach additional pages of Table 2 as needed.  
See page 6 for instructions.

Do you have questions about how to fill-out the tables?  
Contact the Department at 503-986-0900 and ask for Transfer Staff.

**Table 2. Description of Changes to Water Right Certificate # 73838**

List the change proposed for the acreage in each ¼ ¼. If more than one change is proposed, specify the acreage associated with each change.  
If there is more than one POD/POA involved in the proposed changes, specify the acreage associated with each POD/POA.

AUTHORIZED (the "from" or "off" lands) The listing that appears on the certificate BEFORE PROPOSED CHANGES List only that part or portion of the water right that will be changed.											Proposed Changes (see "CODES" from previous page)	PROPOSED (the "to" or "on" lands) The listing as it would appear AFTER PROPOSED CHANGES are made.											
Twp	Rng	Sec	¼ ¼	Tax Lot	Gvt Lot or DLC	Acres	Type of USE listed on Certificate	POD(s) or POA(s) (name or number from Table 1)	Priority Date	Twp		Rng	Sec	¼ ¼	Tax Lot	Gvt Lot or DLC	Acres	New Type of USE	POD(s)/ POA(s) to be used (from Table 1)	Priority Date			
										USE	1	S	3	W	30	SW	NW	700	GLot 2	0.7	Multi	POD 1	1993
TOTAL ACRES:						0.7						TOTAL ACRES:						0.7					

Additional remarks: **\*\*\*Note: The certificate map shows the reservoir about 1/4 mile northeast of where it truly is and also on the wrong tax lot. The included map fixes that and any related errors.**

RECEIVED

FEB 07 2022

OWRD



**For Place of Use or Character of Use Changes**

Are there other water right certificates, water use permits or ground water registrations associated with the "from" or the "to" lands?  Yes  No

If YES, list the certificate, water use permit, or ground water registration numbers: N/A.



Pursuant to ORS 540.510, any "layered" water use such as an irrigation right that is supplemental to a primary right proposed for transfer must be included in the transfer or be cancelled. Any change to a ground water registration must be filed separately in a ground water registration modification application.

**For Substitution (ground water supplemental irrigation will be substituted for surface water primary irrigation)**

Ground water supplemental Permit or Certificate # N/A.

Surface water primary Certificate # N/A.

**For a change from Supplemental Irrigation Use to Primary Irrigation Use**

Identify the primary certificate to be cancelled. Certificate # N/A

**For a change in point(s) of appropriation (well(s)) or additional point(s) of appropriation:**

Well log(s) are attached for each authorized and proposed well(s) that are clearly labeled and associated with the corresponding well(s) in Table 1 above and on the accompanying application map.

**Tip:** You may search for well logs on the Department's web page at:

[http://apps.wrd.state.or.us/apps/gw/well\\_log/Default.aspx](http://apps.wrd.state.or.us/apps/gw/well_log/Default.aspx)

**AND/OR**

Describe the construction of the authorized and proposed well(s) in Table 3 for any wells that do not have a well log. For *proposed wells not yet constructed or built*, provide "a best estimate" for each requested information element in the table. The Department recommends you consult a licensed well driller, geologist, or certified water right examiner to assist with assembling the information necessary to complete Table 3.

**Table 3. Construction of Point(s) of Appropriation**

Any well(s) in this listing must be clearly tied to corresponding well(s) described in Table 1 and shown on the accompanying application map. Failure to provide the information will delay the processing of your transfer application until it is received. The information is necessary for the department to assess whether the proposed well(s) will access the same source aquifer as the authorized point(s) of appropriation (POA). The Department is prohibited by law from approving POA changes that do not access the same source aquifer.

Proposed or Authorized POA Name or Number	Is well already built? (Yes or No)	If an existing well: OWRD Well ID Tag No. L-__	Total well depth	Casing Diameter	Casing Intervals (feet)	Seal depth(s) (intervals)	Perforated or screened intervals (in feet)	Static water level of completed well (in feet)	Source aquifer (sand, gravel, basalt, etc.)	Well-specific rate (cfs or gpm), if less than full rate of water right
<b>N/A</b>										

RECEIVED

FEB 07 2022 9 16

# Application for Water Right Transfer

## Evidence of Use Affidavit



Oregon Water Resources Department  
725 Summer Street NE, Suite A  
Salem, Oregon 97301-1266  
(503) 986-0900  
www.wrd.state.or.us

Please print legibly or type. Be as specific as possible. Attach additional pages if you need more spacing. Supporting documentation must be attached.

RECEIVED  
FEB 07 2022  
OWRD

State of Oregon )  
 ) ss  
County of WASHINGTON)

I, DONNA BOYER, in my capacity as LANDOWNER,  
mailing address 42007 SW VANDEHEY ROAD, GASTON, OR 97119  
telephone number (503)264.1807, being first duly sworn depose and say:

1. My knowledge of the exercise or status of the water right is based on (check one):
- Personal observation       Professional expertise

2. I attest that:

- Water was used during the previous five years on the **entire** place of use for Certificate # 73838; **OR**
- My knowledge is specific to the use of water at the following locations within the last five years:

Certificate #	Township	Range	Mer	Sec	¼ ¼	Gov't Lot or DLC	Acres (if applicable)
N/A							

OR

- Confirming Certificate # \_\_\_\_\_ has been issued within the past five years; **OR**
- Part or all of the water right was leased instream at some time within the last five years. The instream lease number is: \_\_\_\_\_ (Note: If the entire right proposed for transfer was not leased, additional evidence of use is needed for the portion not leased instream.); **OR**
- The water right is not subject to forfeiture and documentation that a presumption of forfeiture for non-use would be rebutted under ORS 540.610(2) is attached.
- Water has been used at the actual current point of diversion or appropriation for more than 10 years for Certificate # \_\_\_\_\_ (For Historic POD/POA Transfers)

(continues on reverse side)

13916

3. The water right was used for: (e.g., crops, pasture, etc.): WILDLIFE AND/OR LIVESTOCK

4. I understand that if I do not attach one or more of the documents shown in the table below to support the above statements, my application will be considered incomplete.

RECEIVED

FEB 07 2022

[Signature]  
Signature of Affiant

1/28/22  
Date

OWRD

Signed and sworn to (or affirmed) before me this 28<sup>th</sup> day of January, 2022.

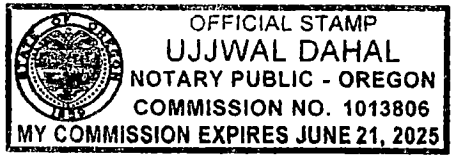

[Signature]  
Notary Public for Oregon, Washington County  
My Commission Expires: 06/21/2025

Supporting Documents	Examples
<input type="checkbox"/> Copy of a water right certificate that has been issued within the last five years. (not a remaining right certificate)	Copy of <b>confirming</b> water right certificate that shows issue date
<input type="checkbox"/> Copies of receipts from sales of irrigated crops or for expenditures related to use of water	<ul style="list-style-type: none"> <li>• Power usage records for pumps associated with irrigation use</li> <li>• Fertilizer or seed bills related to irrigated crops</li> <li>• Farmers Co-op sales receipt</li> </ul>
<input type="checkbox"/> Records such as FSA crop reports, irrigation district records, NRCS farm management plan, or records of other water suppliers	<ul style="list-style-type: none"> <li>• District assessment records for water delivered</li> <li>• Crop reports submitted under a federal loan agreement</li> <li>• Beneficial use reports from district</li> <li>• IRS Farm Usage Deduction Report</li> <li>• Agricultural Stabilization Plan</li> <li>• CREP Report</li> </ul>
<input checked="" type="checkbox"/> Aerial photos containing sufficient detail to establish location and date of photograph	<p>Multiple photos can be submitted to resolve different areas of a water right. If the photograph does not print with a "date stamp" or without the source being identified, the date of the photograph and source should be added.</p> <p>Sources for aerial photos: OSU – <a href="http://www.oregonexplorer.info/imagery">www.oregonexplorer.info/imagery</a> OWRD – <a href="http://www.wrd.state.or.us">www.wrd.state.or.us</a> Google Earth – <a href="http://earth.google.com">earth.google.com</a> TerraServer – <a href="http://www.terraserver.com">www.terraserver.com</a></p>
<input type="checkbox"/> Approved Lease establishing beneficial use within the last 5 years	Copy of instream lease or lease number

13916

B - 3/3

RECEIVED

FEB 07 2022

OWRD

# Evidence of Use

June 2021 Google Aerial Photo

Tax Lot 500 in outlined in yellow

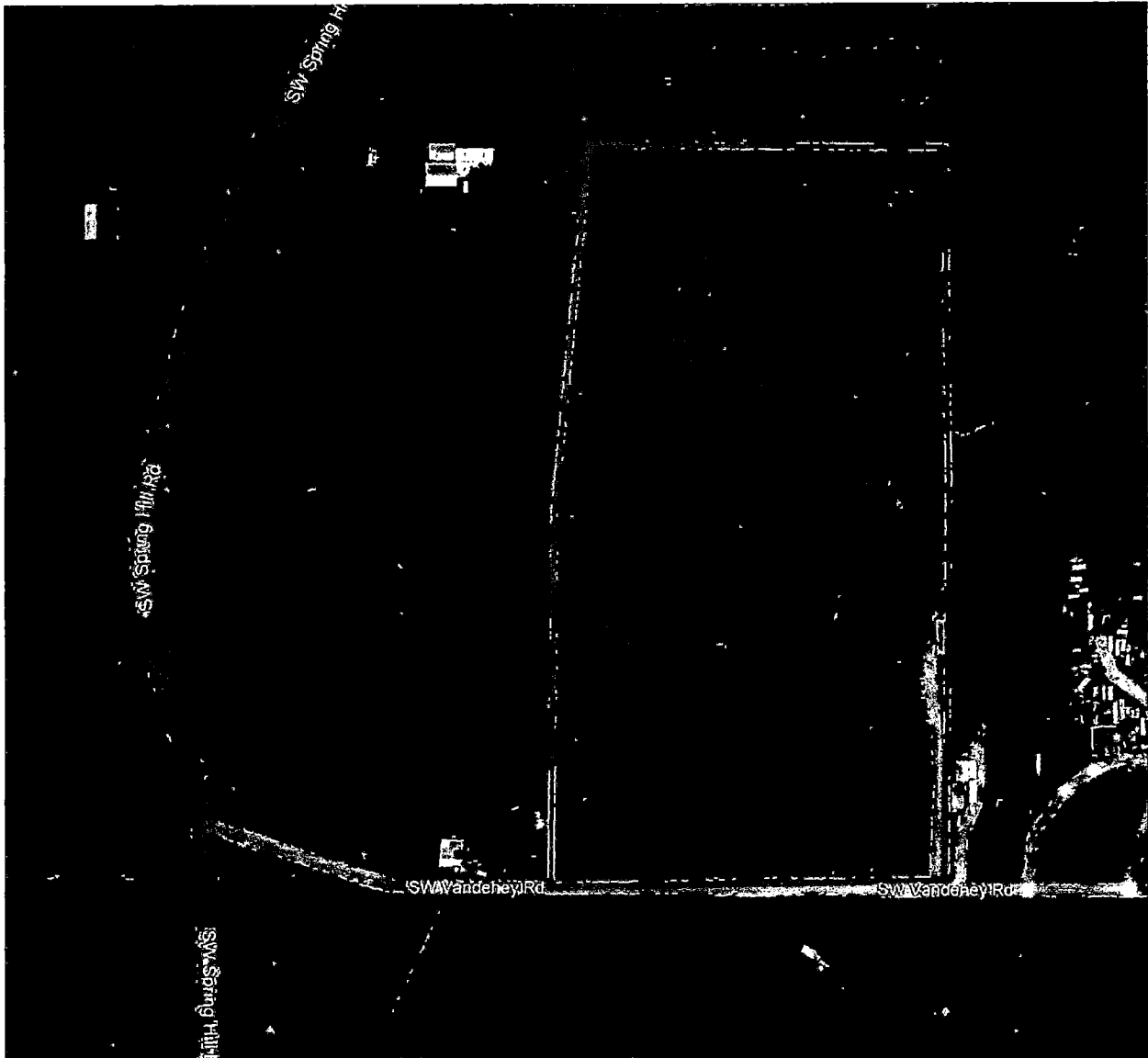

reservoir

13916

ATTACH C-1/4



The RIGHT choice...your choice!

Customer Service
Phone: 503.219.1000
Email: Ticor.Resource@TicorTitle.com
Washington (OR)

RECEIVED

FEB 07 2022

OWRD

OWNERSHIP INFORMATION

Owner(s) : Boyer Donna J
CoOwner(s) :
Site Address : 42007 SW Vandehey Rd Gaston 97119
Mail Address : 42007 SW Vandehey Rd Gaston Or 97119

Parcel Number : R0437012
Ref Parcel # : 1533000 00700
T: 01S R: 03W S: 30 Q: QQ:
Telephone :

PROPERTY DESCRIPTION

Map Page Grid :
Census Tract : 330.00 Block: 2
Neighborhood : 1S36
School District : Forest Grove
Subdivision/Plat : Spring Hill Farm #17, 18
Class Code : Single Family Res
Land Use : 5515 Agr,Farm Zone,Improved
Legal : ACRES 20.49, ZONED FARMLAND-
: POTENTIAL ADDITIONAL TAX LIABILITY

ASSESSMENT AND TAX INFORMATION

Mkt Land : \$339,300
Mkt Structure : \$192,560
Mkt Total : \$560,170
%Improved : 36
M50 Total : \$220,870
Levy Code : 01503
16-17 Taxes : \$2,873.80
Millage Rate : 13.0113

PROPERTY CHARACTERISTICS

Bedrooms : 3 Lot Acres : 20.49 Year Built : 1996
Bathrooms : 3.00 Lot SqFt : 892,544 EffYearBlt : 1996
HeatMethod : Heat Pump BsmFin SF : Floor Cover : 225
Pool : BsmUnfinSF : Foundation : Concrete Ftg
Appliances : Yes Bldg SqFt : 2,288 Roof Shape : Gable
Dishwasher : 1stFlrSF : 2,288 Roof Matl : Comp Shingle
Hood Fan : UpperFISF : InteriorMatl : Drywall
Deck : Porch SqFt : 1,080 Paving Matl : Concrete
GarageType : Attached Attic SqFt : Ext Finish : Wood Std
Garage SF : 1,056 Deck SqFt : Const Type : Wdstud\no Shtg

TRANSFER HISTORY

Owner(s) Date Doc # Price Deed Loan Type
:Boyer Donna J :09/08/2014 56571 :\$475,000 :Warranty :\$380,000 :Convent
:Aguirre John Charles/Minerva S :05/04/1994 44121 :\$10 :Assign of Co :

13916

This title information has been furnished, without charge, in conformance with the guidelines approved by the State of Oregon Insurance Commissioner. The Insurance Division cautions intermediaries that this service is designed to benefit the ultimate insureds. Indiscriminate use only benefiting intermediaries will not be permitted. Said services may be discontinued. No liability is assumed for any errors in this report. Information is deemed reliable but not guaranteed

C-2/4



After recording return to:  
Donna J. Boyer  
42007 SW Vandehey Rd  
Gaston, OR 97119

Until a change is requested all tax  
statements shall be sent to the  
following address:  
Donna J. Boyer  
42007 SW Vandehey Rd  
Gaston, OR 97119

File No.: 7032-2293487 (LB)  
Date: August 18, 2014

FIRST AMERICAN 2293487-48

Washington County, Oregon **2014-056571**  
D-DW  
Str=4 K GRUNEWALD 09/08/2014 01:28:13 PM  
\$20.00 \$11.00 \$5.00 \$475.00 \$20.00 **\$531.00**  
I, Richard Hobernicht, Director of Assessment and Taxation and Ex-  
Officio County Clerk for Washington County, Oregon, do hereby  
certify that the within instrument of writing was received and  
recorded in the book of records of said county.  
Richard Hobernicht, Director of  
Assessment and Taxation, Ex-Officio

THIS SPACE RES

RECEIVED  
FEB 07 2022  
OWRD

**STATUTORY WARRANTY DEED**

**Minerva S. Aguirre**, Grantor, conveys and warrants to **Donna J. Boyer, an unmarried woman**,  
Grantee, the following described real property free of liens and encumbrances, except as specifically set  
forth herein:

See Legal Description attached hereto as Exhibit A and by this reference incorporated herein.

**Subject to:**

1. The **2014-2015** Taxes, a lien not yet payable.
2. Covenants, conditions, restrictions and/or easements, if any, affecting title, which may appear in  
the public record, including those shown on any recorded plat or survey.

The true consideration for this conveyance is **\$475,000.00**. (Here comply with requirements of ORS 93.030)

13916

C- 5/4

RECEIVED

FEB 07 2022

OWRD

APN: R437012

Statutory Warranty Deed  
- continued

File No.: 7032-2293487 (LB)

BEFORE SIGNING OR ACCEPTING THIS INSTRUMENT, THE PERSON TRANSFERRING FEE TITLE SHOULD INQUIRE ABOUT THE PERSON'S RIGHTS, IF ANY, UNDER ORS 195.300, 195.301 AND 195.305 TO 195.336 AND SECTIONS 5 TO 11, CHAPTER 424, OREGON LAWS 2007, SECTIONS 2 TO 9 AND 17, CHAPTER 855, OREGON LAWS 2009, AND SECTIONS 2 TO 7, CHAPTER 8, OREGON LAWS 2010. THIS INSTRUMENT DOES NOT ALLOW USE OF THE PROPERTY DESCRIBED IN THIS INSTRUMENT IN VIOLATION OF APPLICABLE LAND USE LAWS AND REGULATIONS. BEFORE SIGNING OR ACCEPTING THIS INSTRUMENT, THE PERSON ACQUIRING FEE TITLE TO THE PROPERTY SHOULD CHECK WITH THE APPROPRIATE CITY OR COUNTY PLANNING DEPARTMENT TO VERIFY THAT THE UNIT OF LAND BEING TRANSFERRED IS A LAWFULLY ESTABLISHED LOT OR PARCEL, AS DEFINED IN ORS 92.010 OR 215.010, TO VERIFY THE APPROVED USES OF THE LOT OR PARCEL, TO DETERMINE ANY LIMITS ON LAWSUITS AGAINST FARMING OR FOREST PRACTICES, AS DEFINED IN ORS 30.930, AND TO INQUIRE ABOUT THE RIGHTS OF NEIGHBORING PROPERTY OWNERS, IF ANY, UNDER ORS 195.300, 195.301 AND 195.305 TO 195.336 AND SECTIONS 5 TO 11, CHAPTER 424, OREGON LAWS 2007, SECTIONS 2 TO 9 AND 17, CHAPTER 855, OREGON LAWS 2009, AND SECTIONS 2 TO 7, CHAPTER 8, OREGON LAWS 2010.

Dated this 30 day of SEPTEMBER, 2014.

Minerva S. Aguirre  
Minerva S. Aguirre

STATE OF Oregon )  
                                          )ss.  
County of Washington )

This instrument was acknowledged before me on this 30 day of SEPTEMBER, 2014  
by **Minerva S. Aguirre**.

[Signature]

Notary Public for Oregon  
My commission expires:

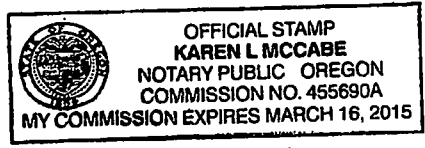

13916

C - 7/4

RECEIVED

FEB 07 2022

OWRD

APN: R437012

Statutory Warranty Deed  
- continued

File No.: 7032-2293487 (LB)

**EXHIBIT A**

**LEGAL DESCRIPTION:** Real property in the County of Washington, State of Oregon, described as follows:

**The East half of Tract No. 17, and all of Tract No. 18, SPRING HILL FARM, in the County of Washington and State of Oregon.**

**EXCEPT** the following described property:

**Being a part of that tract of land conveyed to Paul and Wanda Ott by Deed recorded on page 38, in Book 316 and on page 271, Book 333, Deed records of said County, and being more particularly described as follows:**

**Beginning at a point in the center of Spring Hill Road at the NW corner of Tract 18, SPRING HILL FARM; thence South 89°41' East along the North line of said Tract 18, 550 feet, more or less, to a fence corner; thence Southerly along said fence 660 feet, more or less, to a point on the South line of said Tract 18; thence North 89°41' West along said South line 740 feet, more or less, to the SW corner of said Tract 18, a point in the center of said Spring Hill Road; thence North 14°40' East in the center of said road 419.76 feet to an angle point thereon; thence continuing in the center of said road North 25°38' East 280.37 feet to the point of beginning.**

**EXCEPTING** any portion within County road right of way.

**NOTE:** This legal description was created prior to January 1, 2008.

13916



**Supplemental Form D**

**Water Right Transfers Within the Boundaries of or Served by an Irrigation District or other Water Supplier (Association, Ditch Co., etc.)**

[For transfers submitted under OAR Chapter 690 Division 380]



**Oregon Water Resources Department**  
 725 Summer Street NE, Suite A  
 Salem, Oregon 97301-1266  
 503-986-0900  
 www.oregon.gov/OWRD

The Department requires non-district applicants to communicate with districts/water suppliers during the planning and preparation of transfer applications involving water rights having a point of diversion or appropriation (POD/POA) or place of use (POU) served by or located within the boundaries of an irrigation district, or other type of water supplier to which assessments are paid. In some cases consent will be required from the district or water supplier.

This form must be included with any transfer application that involves rights served by or located within the boundaries of a district or other type of water supplier.

RECEIVED

**1. APPLICANT INFORMATION**

NAME <b>Donna Boyer</b>		PHONE (HM) <b>503.264.1807</b>	
PHONE (WK)	CELL <b>503.863.1983</b>	FAX <b>N/A</b>	
ADDRESS <b>42007 SW Vandehy Road</b>			
CITY <b>Gaston</b>	STATE <b>OR</b>	ZIP <b>97119</b>	E-MAIL** <b>donna.jboyer@yahoo.com</b>

FEB 07 2022  
OWRD

**2. DISTRICT or WATER SUPPLIER INFORMATION**

DISTRICT/WATER SUPPLIER NAME <b>Tualatin Valley Irrigation District</b>		PHONE (HM) <b>503.357.3118</b>	
PHONE (WK)	CELL	FAX	
ADDRESS <b>2330 Elm Street</b>			
CITY <b>Forest Grove</b>	STATE <b>OR</b>	ZIP <b>97116</b>	E-MAIL** <b>bobby.nuvolini@tvid.org</b>

\*\* By providing an e-mail address, the applicant and/or the district/water supplier consents to receive all correspondence from the Department electronically. Copies of final order documents will also be mailed.

**3. WATER RIGHTS ISSUED IN THE NAME OF, or LOCATED WITHIN, or SERVED BY AN IRRIGATION DISTRICT, OTHER DISTRICT, OR WATER SUPPLIER**

a. List the water right(s) involved in this transfer:

	Application / Decree	Permit / Previous Transfer	Certificate	Is the water right in the name of a district, water supplier, or BOR*?
1.	R-76738	none found	73838	YES <input type="checkbox"/>
2.		-		YES <input type="checkbox"/>
3.		-		YES <input type="checkbox"/>

Attach additional pages for additional water rights if necessary.

\*Bureau of Reclamation

b. Determine a district's/water supplier's connection to your points of diversion (POD) or appropriation (POA) and places of use (POU). [You may need to consult with your district/water supplier.]

**CURRENT ASSOCIATIONS** Please answer the following "yes" or "no" questions:

YES  NO  One or more of the current POD(s) / POA(s) involved in the transfer are served by a district/water supplier or rely on BOR water.

YES  NO  All or a portion of the current POU involved in this proposed transfer receives water for either primary or supplemental irrigation from the district/water supplier; i.e., the POU is currently layered with a district or BOR water supplied water right(s).

**PROPOSED ASSOCIATIONS** Please answer the following "yes" or "no" questions:

YES  NO  One or more of the proposed POD(s) / POA(s) involved in the transfer are currently served or will be served by a district/water supplier if the transfer is approved, or rely on BOR water.

YES  NO  All or a portion of the proposed POU involved in this proposed transfer currently receives or will receive either primary or supplemental irrigation from the district/water supplier; i.e., the POU will be layered with a district/water supplier or BOR water supplied water right(s).

**COMMENTS OR ADDITIONAL INFORMATION**

**4. APPLICANT'S SIGNATURE**

(1) I certify that I have notified the district/water supplier about the proposed water right transfer application by [check one]:

email,  phone\*,  postal mail,  in person, or  other (please specify) \_\_\_\_\_

\*The phone call was with Eric Urstadt, CWRE, who prepared the application.

(2) I certify that to the best of my knowledge the information contained in this Supplemental Form D is true and accurate.

  
Applicant Signature

Donna Boyer  
Name (print)

1/27/22  
Date

**5. (WHEN REQUIRED) DISTRICT or WATER SUPPLIER CONSENT TO THE PROPOSED WATER RIGHT TRANSFER**

**District Manager or Water Supplier consent is required if any box on this form is marked "YES."**

The district/water supplier certifies the following:

- (1) The district/water supplier has reviewed the applicant's proposed water right transfer application and maps; and
- (2) The district/water supplier consents to the proposed water right transfer application.

RECEIVED

FEB 07 2022

OWRD

YES  NO  After proof of completion, the confirming water right certificate is to remain in the name of the U.S. Bureau of Reclamation or the district/water supplier.

YES  NO  The district/water supplier will be responsible for submitting the claim of beneficial use prepared by a Certified Water Rights Examiner (CWRE).

Not Applicable  
Signature of District Manager /Water Supplier      Name (print), Title      Date