





Place of use Transfer  
Certificate 81319  
Bales  
T3N, R29E, W.M. Section 21  
Umatilla County, Oregon  
TO Lands

**Legend**

-  Buried Main Line
-  Wheel Line
-  7.14 AC TO Lands
-  Area not Involved in this Transfer

**Point of Appropriation**

Well #1  
Located 720' North and 530' West from the SE corner, section 21.  
Tax Lot 9300

**Certified Water Rights Examiner Stamp**

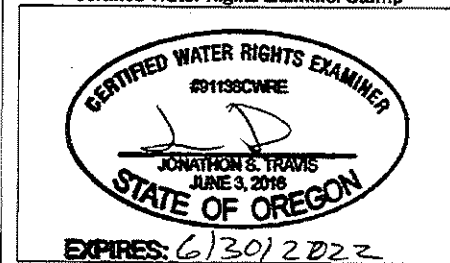

**Disclaimer**

This map was prepared for the purpose of identifying the location of a water right only and it is not intended to provide legal dimensions or location of property ownership lines.

**Map Notes**

Date: 09/31/21  
Data Sources: ESRI  
Prepared By: GeoEngineers

**GEOENGINEERS**

RECEIVED

FEB 01 2022

OWRD

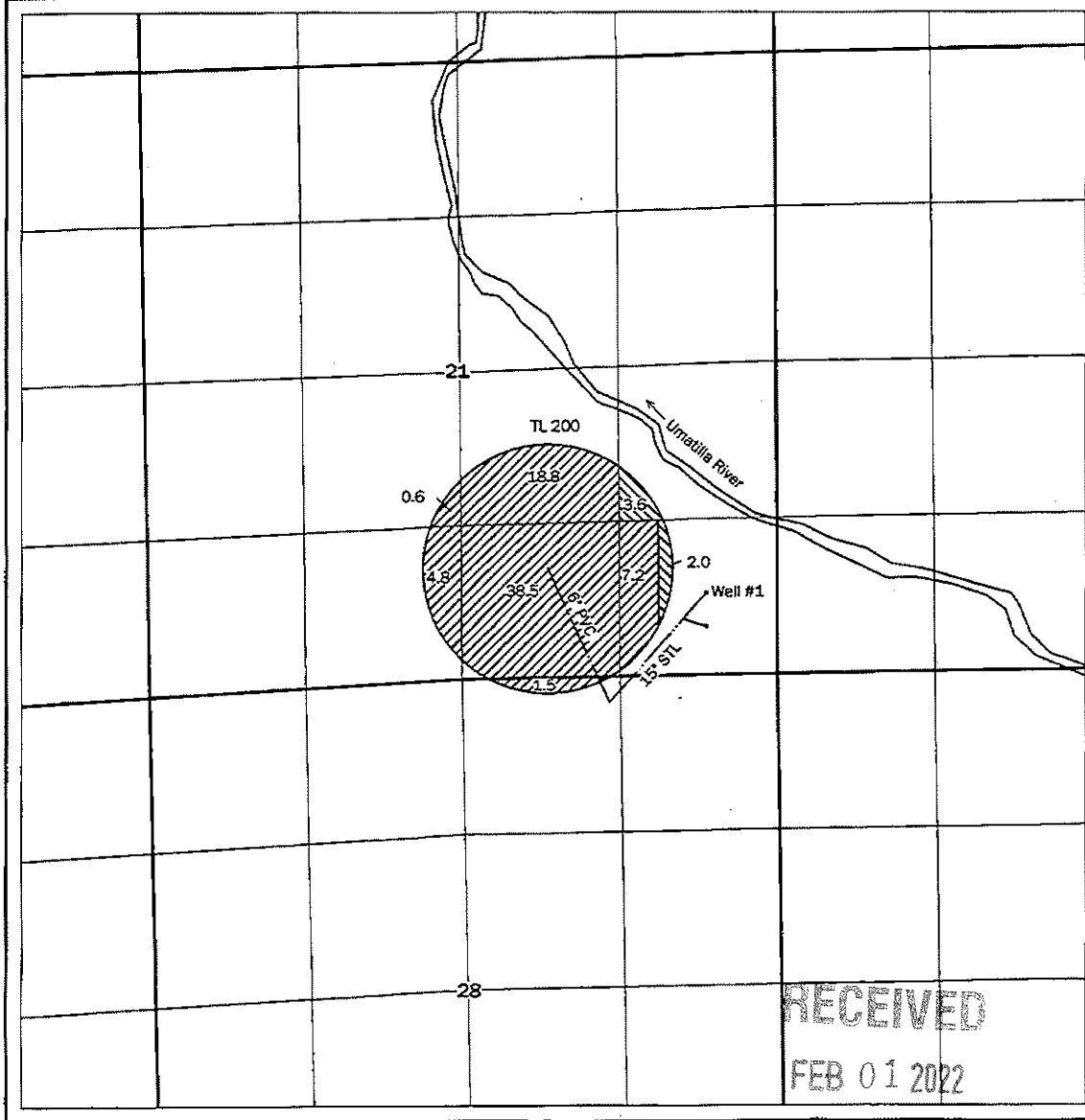

**Place of use Transfer  
Certificate 81319**  
Bales  
T3N, R29E, W.M. Section 21  
Umatilla County, Oregon  
FROM Lands

- Legend**
- Buried Main Line
  - Wheel Line
  - 71.4 AC FROM Lands
  - Area not involved in this Transfer

**Point of Appropriation**  
Well #1  
Located 720' North and 530' West from the SE corner, section 21

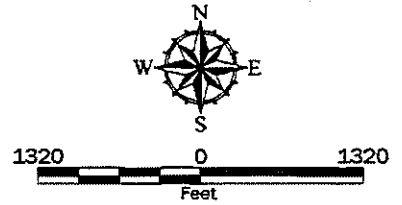
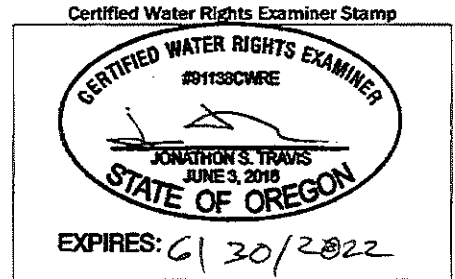

**Disclaimer**  
This map was prepared for the purpose of identifying the location of a water right only and it is not intended to provide legal dimensions or location of property ownership lines.

**Map Notes**  
Date: 09/31/21  
Data Sources: ESRI  
Prepared By: GeoEngineers



RECEIVED  
FEB 01 2022  
OWRD