

# Application for Permanent Water Right Transfer

## Part 1 of 5 – Minimum Requirements Checklist



Oregon Water Resources Department  
725 Summer Street NE, Suite A  
Salem, Oregon 97301-1266  
(503) 986-0900  
www.oregon.gov/OWRD

**This transfer application will be returned if Parts 1 through 5 and all required attachments are not completed and included.**  
For questions, please call (503) 986-0900, and ask for Transfer Section.

RECEIVED  
JUL 28 2022

OWRD

**Check all items included with this application. (N/A = Not Applicable)**

- Part 1 – Completed Minimum Requirements Checklist.
- Part 2 – Completed Transfer Application Map Checklist.
- Part 3 – Application Fee, payable by check to the Oregon Water Resources Department, and completed Fee Worksheet, page 3. Try the new online fee calculator at: [http://apps.wrd.state.or.us/apps/misc/wrd\\_fee\\_calculator](http://apps.wrd.state.or.us/apps/misc/wrd_fee_calculator). If you have questions, call Customer Service at (503) 986-0801.
- Part 4 – Completed Applicant Information and Signature.
- Part 5 – Information about Water Rights to be Transferred: **How many water rights are to be transferred? 6** List them here: [92990](#), [92992](#), [92993](#), [92994](#), [93872](#), [95662](#)  
Please include a separate Part 5 for each water right. (See instructions on page 6)

**Attachments:**

- Completed Transfer Application Map.
- Completed Evidence of Use Affidavit and supporting documentation.
- N/A Affidavit(s) of Consent from Landowner(s) (if the applicant does not own the land the water right is on.)
- N/A Supplemental Form D – For water rights served by or issued in the name of an irrigation district. Complete when the transfer applicant is not the irrigation district.
- N/A Oregon Water Resources Department’s Land Use Information Form with approval and signature (or signed land use form receipt stub) from each local land use authority in which water is to be diverted, conveyed, and/or used. Not required if water is to be diverted, conveyed, and/or used only on federal lands or if **all** of the following apply: a) a change in place of use only, b) no structural changes, c) the use of water is for irrigation only, and d) the use is located within an irrigation district or an exclusive farm use zone.
- N/A Water Well Report/Well Log for changes in point(s) of appropriation (well(s)) or additional point(s) of appropriation.
- N/A Geologist Report for a change from a surface water point of diversion to a ground water point of appropriation (well), if the proposed well is more than 500’ from the surface water source and more than 1000’ upstream or downstream from the point of diversion. See OAR 690-380-2130 for requirements and applicability.

**(For Staff Use Only)**

**WE ARE RETURNING YOUR APPLICATION FOR THE FOLLOWING REASON(S):**

<input type="checkbox"/> Application fee not enclosed/insufficient	<input type="checkbox"/> Map not included or incomplete
<input type="checkbox"/> Land Use Form not enclosed or incomplete	<input type="checkbox"/> Evidence of Use Form not enclosed or incomplete
<input type="checkbox"/> Additional signature(s) required	<input type="checkbox"/> Part _____ is incomplete

Other/Explanation \_\_\_\_\_

Staff: \_\_\_\_\_ 503-986-0\_\_\_\_\_ Date: \_\_\_\_/\_\_\_\_/\_\_\_\_



## Part 2 of 5 – Transfer Application Map

Your transfer application will be returned if any of the map requirements listed below are not met.

Please be sure that the transfer application map you submit includes all the required items and matches the existing water right map. Check all boxes that apply.

- N/A Certified Water Right Examiner (CWRE) Stamp and Original Signature. For a list of CWREs, see [http://apps.wrd.state.or.us/apps/wr/cwre\\_license\\_view/](http://apps.wrd.state.or.us/apps/wr/cwre_license_view/). CWRE stamp and signature are not required for substitutions.
- N/A If **more than three** water rights are involved, separate maps are needed for each water right.
- Permanent quality printed with dark ink on good quality paper.
- The size of the map can be 8½ x 11 inches, 8½ x 14 inches, 11 x 17 inches, or up to 30 x 30 inches. For 30 x 30 inch maps, one extra copy is required.
- A north arrow, a legend, and scale.
- The scale of the map must be: 1 inch = 400 feet, 1 inch = 1,320 feet, the scale of the Final Proof/Claim of Beneficial Use Map (the map used when the permit was certificated), the scale of the county assessor map if the scale is not smaller than 1 inch = 1,320 feet, or a scale that has been pre-approved by the Department.
- Township, Range, Section, ¼ ¼, DLC, Government Lot, and other recognized public land survey lines.
- Tax lot boundaries (property lines) are required. Tax lot numbers are recommended.
- Major physical features including rivers and creeks showing direction of flow, lakes and reservoirs, roads, and railroads.
- Major water delivery system features from the point(s) of diversion/appropriation such as main pipelines, canals, and ditches.
- Existing place of use that includes separate hachuring for each water right, priority date, and use including number of acres in each quarter-quarter section, government lot, or in each quarter-quarter section as projected within government lots, donation land claims, or other recognized public land survey subdivisions. If less than the entirety of the water right is being changed, a separate hachuring is needed for lands left unchanged.
- N/A Proposed place of use that includes separate hachuring for each water right, priority date, and use including number of acres in each quarter-quarter section, government lot, or in each quarter-quarter section as projected within government lots, donation land claims, or other recognized public land survey subdivisions.
- Existing point(s) of diversion or well(s) with distance and bearing or coordinates from a recognized survey corner. This information can be found in your water right certificate or permit.
- N/A If you are proposing a change in point(s) of diversion or well(s), show the proposed location and label it clearly with distance and bearing or coordinates. If GPS coordinates are used, latitude-longitude coordinates may be expressed as either degrees-minutes-seconds with at least one digit after the decimal (example – 42°32'15.5") or degrees-decimal with five or more digits after the decimal (example – 42.53764°).

RECEIVED  
JUL 28 2022

QUED



### Part 3 of 5 – Fee Worksheet

FEE WORKSHEET for PERMANENT TRANSFER (except Substitution)			
1	Base Fee (includes one type of change to one water right for up to 1 cfs)	1	\$1,160
	Types of change proposed: <input checked="" type="checkbox"/> Place of Use <input type="checkbox"/> Character of Use <input checked="" type="checkbox"/> Point of Diversion/Appropriation Number of above boxes checked = <u>2 (2a)</u> Subtract 1 from the number in line 2a = <u>1 (2b)</u> <i>If only one change, this will be 0</i>		
2	Multiply line 2b by \$930 and enter » » » » » » » » » » » » » » » »	2	\$930
3	Number of water rights included in transfer <u>6 (3a)</u> Subtract 1 from the number in 3a above: <u>5 (3b)</u> <i>If only one water right this will be 0</i> Multiply line 3b by \$520 and enter » » » » » » » » » » » » » » » »	3	\$2,600
4	Do you propose to add or change a well, or change from a surface water POD to a well? <input checked="" type="checkbox"/> No: enter 0 » <input type="checkbox"/> Yes: enter \$410 »	4	0
5	Do you propose to change the place of use or character of use? <input type="checkbox"/> No: enter 0 on line 5 » <input checked="" type="checkbox"/> Yes: enter the cfs for the portions of the rights to be transferred (see example below*): <u>48.95 (5a)</u> Subtract 1.0 from the number in 5a above: <u>47.95 (5b)</u> If 5b is 0 or less, enter 0 on line 5 » If 5b is greater than 0, round up to the nearest whole number: <u>48 (5c)</u> and multiply 5c by \$350, then enter on line 5 » » » » » » » » » » » » » » » »	5	\$16,800
6	Add entries on lines 1 through 5 above » » » » » » » » » » Subtotal:	6	\$21,490
7	Is this transfer: <input type="checkbox"/> necessary to complete a project funded by the Oregon Watershed Enhancement Board (OWEB) under ORS 541.932? <input type="checkbox"/> endorsed in writing by ODFW as a change that will result in a net benefit to fish and wildlife habitat? If one or more boxes is checked, multiply line 6 by 0.5 and enter on line 7 » If no box is applicable, enter 0 on line 7 »	7	0
8	Subtract line 7 from line 6 » » » » » » » » » » » » » » » » <b>Transfer Fee:</b>	8	\$21,490

\*Example for Line 5a calculation to transfer 45.0 acres of Primary Certificate 12345 (total 1.25 cfs for 100 acres) and 45.0 acres of Supplemental Certificate 87654 (1/80 cfs per acre) on the same land:

- For irrigation calculate cfs for each water right involved as follows:
  - Divide total authorized cfs by total acres in the water right (for C12345,  $1.25 \text{ cfs} \div 100 \text{ ac}$ ); then multiply by the number of acres to be transferred to get the transfer cfs ( $\times 45 \text{ ac} = 0.56 \text{ cfs}$ ).
  - If the water right certificate does not list total cfs, but identifies the allowable use as 1/40 or 1/80 of a cfs per acre; multiply number of acres proposed for change by either 0.025 (1/40) or 0.0125 (1/80). (For C87654,  $45.0 \text{ ac} \times 0.0125 \text{ cfs/ac} = 0.56 \text{ cfs}$ )
- Add cfs for the portions of water rights on all the land included in the transfer; however **do not count cfs for supplemental rights on acreage for which you have already calculated the cfs fee for the primary right on the same land.** The fee should be assessed only once for each "on the ground" acre included in the transfer. (In this example, blank 5a would be only 0.56 cfs, since both rights serve the same 45.0 acres. Blank 5b would be 0 and Line 5 would then also become 0).

FEE WORKSHEET for SUBSTITUTION			
1	Base Fee (includes change to one well)	1	\$840.00
	Number of wells included in substitution _____ (2a) Subtract 1 from the number in 2a above: _____ (2b) <i>If only one well this will be 0</i>		
2	Multiply line 2b by \$410 and enter » » » » » » » » » » » » » » » »	2	N/A
3	Add entries on lines 1 through 2 above » » » » » » <b>Fee for Substitution:</b>	3	N/A



## Part 4 of 5 – Applicant Information and Signature

### Applicant Information

APPLICANT/BUSINESS NAME <b>Farmland Reserve, Inc., Attn: Jens Rasmussen, AgriNorthwest</b>		PHONE NO. <b>509-820-3234</b>	ADDITIONAL CONTACT NO.
ADDRESS <b>PO Box 2308</b>		FAX NO. <b>509-734-1092</b>	
CITY <b>Pasco</b>	STATE <b>WA</b>	ZIP <b>99302</b>	E-MAIL <b>jasmussen@agrinw.com</b>
BY PROVIDING AN E-MAIL ADDRESS, CONSENT IS GIVEN TO RECEIVE ALL CORRESPONDENCE FROM THE DEPARTMENT ELECTRONICALLY. COPIES OF THE FINAL ORDER DOCUMENTS WILL ALSO BE MAILED.			

**Agent Information** – The agent is authorized to represent the applicant in all matters relating to this application.

AGENT/BUSINESS NAME <b>Summit Water Resources LLS, Attn: Ted Ressler</b>		PHONE NO. <b>503-701-4535</b>	ADDITIONAL CONTACT NO.
ADDRESS <b>PO Box 11268</b>		FAX NO.	
CITY <b>Portland</b>	STATE <b>OR</b>	ZIP <b>97211</b>	E-MAIL <b>tressler@summitwr.com</b>
BY PROVIDING AN E-MAIL ADDRESS, CONSENT IS GIVEN TO RECEIVE ALL CORRESPONDENCE FROM THE DEPARTMENT ELECTRONICALLY. COPIES OF THE FINAL ORDER DOCUMENTS WILL ALSO BE MAILED.			

Explain in your own words what you propose to accomplish with this transfer application, and why:  
**The Applicant is proposing to change the entire Place of Use for Certificates, 92990, 92992, 92993, and 93872, and a portion of the Place of Use for 92994 and 95662.**

If you need additional space, continue on a separate piece of paper and attach to the application as "Attachment 1".

### Check One Box

- By signing this application, I understand that, upon receipt of the draft preliminary determination and prior to Department approval of the transfer, I will be required to provide landownership information and evidence that I am authorized to pursue the transfer as identified in OAR 690-380-4010(5); **OR**
- I affirm the applicant is a municipality as defined in ORS 540.510(3)(b) and that the right is in the name of the municipality or a predecessor; **OR**
- I affirm the applicant is an entity with the authority to condemn property and is acquiring by condemnation the property to which the water right proposed for transfer is appurtenant and have supporting documentation.

RECEIVED

JUL 28 2022

OWNED

By my signature below, I confirm that I understand:

- Prior to Department approval of the transfer application, I may be required to submit payment to the Department for publication of a notice in a newspaper with general circulation in the area where the water right is located, once per week for two consecutive weeks. If more than one qualifying newspaper is available, I suggest publishing the notice in the following newspaper: East Oregonian.
- Amendments to the application may only be made in response to the Department's Draft Preliminary Determination (DPD). The applicant will have a period of at least 30 days to amend the application to address any issues identified by the Department in the DPD, or to withdraw the application. Note that amendments may be subject to additional fees, pursuant to ORS 536.050.
- Failure to complete an approved change in place of use and/or change in character of use, will result in loss of the water right (OAR 690-380-6010).

I (we) affirm that the information contained in this application is true and accurate.

  
Applicant signature

**Patrick Tolman, Vice President**  
Print Name (and Title if applicable)

7/11/22  
Date

Is the applicant the sole owner of the land on which the water right, or portion thereof, proposed for transfer is located?  Yes  No *If NO, include signatures of all deeded landowners (and mailing and/or e-mail addresses if different than the applicant's) or attach affidavits of consent (and mailing and/or e-mail addresses) from all landowners or individuals/entities to which the water right(s) were conveyed.*



Check the following boxes that apply:

- The applicant is responsible for completion of change(s). Notices and correspondence should continue to be sent to the applicant.
- The receiving landowner will be responsible for completing the proposed change(s) after the final order is issued. Copies of notices and correspondence should be sent to this landowner.
- Both the receiving landowner and applicant will be responsible for completion of change(s). Copies of notices and correspondence should be sent to this landowner and the applicant.

At this time, are the lands in this transfer application in the process of being sold?  Yes  No

If YES, and you know who the new landowner will be, please complete the receiving landowner information table below. If you do not know who the new landowner will be, then a request for assignment will have to be filed for at a later date.

If a property sells, the certificated water right(s) located on the land belong to the new owner, unless a sale agreement or other document states otherwise. For more information see:

[https://www.oregon.gov/owrd/WRDFormsPDF/Transfer\\_Property\\_Transactions.pdf](https://www.oregon.gov/owrd/WRDFormsPDF/Transfer_Property_Transactions.pdf)

RECEIVING LANDOWNER NAME			PHONE NO.	ADDITIONAL CONTACT NO.
ADDRESS				FAX NO.
CITY	STATE	ZIP	E-MAIL	

RECEIVED  
JUL 28 2022

Describe any special ownership circumstances here: \_\_\_\_\_

- Check here if any of the water rights proposed for transfer are or will be located within or served by an irrigation or other water district. (Tip: Complete and attach Supplemental Form D) OWRD

IRRIGATION DISTRICT NAME <b>Columbia Improvement District</b>	ADDRESS <b>501 Columbia Ave</b>	
CITY <b>Boardman</b>	STATE <b>OR</b>	ZIP <b>97818</b>

- Check here if water for any of the rights supplied under a water service agreement or other contract for stored water with a federal agency or other entity.

ENTITY NAME	ADDRESS	
CITY	STATE	ZIP



To meet State Land Use Consistency Requirements, you must list all county, city, municipal corporation, or tribal governments within whose jurisdiction water will be diverted, conveyed or used.

ENTITY NAME <b>Morrow County</b>	ADDRESS <b>100 S. Court St.</b>	
CITY <b>Heppner</b>	STATE <b>OR</b>	ZIP <b>97836</b>

ENTITY NAME <b>Umatilla County</b>	ADDRESS <b>216 SE Fourth St.</b>	
CITY <b>Pendleton</b>	STATE <b>OR</b>	ZIP <b>97801</b>



## Part 5 of 5 – Water Right Information

Please use a separate Part 5 for each water right being changed. See instructions on page 6, to copy and paste additional Part 5s, or to add additional rows to tables within the form.

CERTIFICATE # 92990

**RECEIVED**

### Description of Water Delivery System

System capacity: \_\_\_\_\_ cubic feet per second (cfs) **OR**

**JUL 28 2022**

CID System – 142,000 gallons per minute (gpm)

**OWRD**

Describe the current water delivery system or the system that was in place at some time within the last five years. Include information on the pumps, canals, pipelines, and sprinklers used to divert, convey, and apply the water at the authorized place of use. Water is withdrawn at a pump station located on the Columbia River. The water is then transported through a series of pipelines and boosters into the CID canal. From the canal, water enters an underground pipeline and is pumped into the sprinkler system.

**Table 1. Location of Authorized and Proposed Point(s) of Diversion (POD) or Appropriation (POA)**

(Note: If the POD/POA name is not specified on the certificate, assign it a name or number here.)

POD/POA Name or Number	Is this POD/POA Authorized on the Certificate or is it Proposed?	If POA, OWRD Well Log ID# (or Well ID Tag # L-___)	Twp		Rng		Sec	¼ ¼		Tax Lot, DLC or Gov't Lot	Measured Distances (from a recognized survey corner)
Columbia River Pump Station (CRPS)	<input checked="" type="checkbox"/> Authorized <input type="checkbox"/> Proposed		4	N	25	E	2	NE	NW		South 86 degrees 22 minutes 46 seconds West, 2829 feet from the NE Corner of Section 2

**Check all type(s) of change(s) proposed below (change "CODES" are provided in parentheses):**

- |  |   |
|--|---|
| <input checked="" type="checkbox"/> Place of Use (POU)                 | <input type="checkbox"/> Supplemental Use to Primary Use (S to P) |
| <input type="checkbox"/> Character of Use (USE)                        | <input type="checkbox"/> Point of Appropriation/Well (POA)        |
| <input type="checkbox"/> Point of Diversion (POD)                      | <input type="checkbox"/> Additional Point of Appropriation (APOA) |
| <input type="checkbox"/> Additional Point of Diversion (APOD)          | <input type="checkbox"/> Substitution (SUB)                       |
| <input type="checkbox"/> Surface Water POD to Ground Water POA (SW/GW) | <input type="checkbox"/> Government Action POD (GOV)              |

**Will all of the proposed changes affect the entire water right?**

- Yes** Complete only the Proposed ("to" or "on" lands) section of Table 2 on the next page. Use the "CODES" listed above to describe the proposed changes.
- No** Complete all of Table 2 to describe the portion of the water right to be changed.



Please use and attach additional pages of Table 2 as needed.  
See page 6 for instructions.

Do you have questions about how to fill-out the tables?  
Contact the Department at 503-986-0900 and ask for Transfer Staff.

**Table 2. Description of Changes to Water Right Certificate # 92990**

List the change proposed for the acreage in each ¼ ¼. If more than one change is proposed, specify the acreage associated with each change.  
If there is more than one POD/POA involved in the proposed changes, specify the acreage associated with each POD/POA.

AUTHORIZED (the "from" or "off" lands) The listing that appears on the certificate BEFORE PROPOSED CHANGES List only that part or portion of the water right that will be changed.											Proposed Changes (see "CODES" from previous page)	PROPOSED (the "to" or "on" lands) The listing as it would appear AFTER PROPOSED CHANGES are made.											
Twp	Rng	Sec	¼ ¼	Tax Lot	Gvt Lot or DLC	Acres	Type of USE listed on Certificate	POD(s) or POA(s) (name or number from Table 1)	Priority Date	Twp		Rng	Sec	¼ ¼	Tax Lot	Gvt Lot or DLC	Acres	New Type of USE	POD(s)/ POA(s) to be used (from Table 1)	Priority Date			
										POU	2	N	27	E	1	SE	NE	500		6.38	Irrigation	CRPS	7/25/1973
										POU	2	N	27	E	1	NW	SE	500		2.42	Irrigation	CRPS	7/25/1973
										POU	2	N	27	E	1	NE	SE	500		37.75	Irrigation	CRPS	7/25/1973
										POU	2	N	27	E	1	SE	SE	500		26.40	Irrigation	CRPS	7/25/1973
										POU	2	N	27	E	1	SW	SE	500		0.47	Irrigation	CRPS	7/25/1973
										POU	2	N	28	E	8	SW	NW	1501		4.42	Irrigation	CRPS	7/25/1973
										POU	2	N	28	E	8	NW	SW	1701		36.09	Irrigation	CRPS	7/25/1973
										POU	2	N	28	E	8	NE	SW	1701		0.23	Irrigation	CRPS	7/25/1973
										POU	2	N	28	E	8	SW	SW	1701		19.43	Irrigation	CRPS	7/25/1973
TOTAL ACRES:						133.59						TOTAL ACRES:						133.59					

Additional remarks: The transfer involves the entire place of Certificate 92990.

RECEIVED  
 JUL 28 2022  
 OWRD



**For Place of Use or Character of Use Changes**

Are there other water right certificates, water use permits or ground water registrations associated with the "from" or the "to" lands?  Yes  No

If YES, list the certificate, water use permit, or ground water registration numbers:

- Permit G-17354 is associated with the TO land; the permit holder is intending to file a permit amendment to move this water right off of the TO land.
- Permits S-55061, S-55190, and S-55192 are mitigation water rights held by NOWA. These permits will temporarily cover the TO lands in this application until there is a permanent mitigation program in place that will allow them to be certificated.
- Certificate 44654 is associated with the TO land; the water right holder would like to diminish this water right to supplemental (Attachment E) with primary provided by this transfer.



Pursuant to ORS 540.510, any "layered" water use such as an irrigation right that is supplemental to a primary right proposed for transfer must be included in the transfer or be cancelled. Any change to a ground water registration must be filed separately in a ground water registration modification application.

**For Substitution** (ground water supplemental irrigation will be substituted for surface water primary irrigation)

Ground water supplemental Permit or Certificate # N/A;  
Surface water primary Certificate # \_\_\_\_\_.

**RECEIVED**

**JUL 28 2022**

**For a change from Supplemental Irrigation Use to Primary Irrigation Use**

**OWRD**

Identify the primary certificate to be cancelled. Certificate # N/A

**For a change in point(s) of appropriation (well(s)) or additional point(s) of appropriation: N/A**

- Well log(s) are attached for each authorized and proposed well(s) that are clearly labeled and associated with the corresponding well(s) in Table 1 above and on the accompanying application map.

**Tip:** You may search for well logs on the Department's web page at:

[http://apps.wrd.state.or.us/apps/gw/well\\_log/Default.aspx](http://apps.wrd.state.or.us/apps/gw/well_log/Default.aspx)

**AND/OR**

- Describe the construction of the authorized and proposed well(s) in Table 3 for any wells that do not have a well log. For *proposed wells not yet constructed or built*, provide "a best estimate" for each requested information element in the table. The Department recommends you consult a licensed well driller, geologist, or certified water right examiner to assist with assembling the information necessary to complete Table 3.

**Table 3. Construction of Point(s) of Appropriation**

Any well(s) in this listing must be clearly tied to corresponding well(s) described in Table 1 and shown on the accompanying application map. Failure to provide the information will delay the processing of your transfer application until it is received. The information is necessary for the department to assess whether the proposed well(s) will access the same source aquifer as the authorized point(s) of appropriation (POA). The Department is prohibited by law from approving POA changes that do not access the same source aquifer.



Proposed or Authorized POA Name or Number	Is well already built? (Yes or No)	If an existing well: OWRD Well ID Tag No. L-_____	Total well depth	Casing Diameter	Casing Intervals (feet)	Seal depth(s) (intervals)	Perforated or screened intervals (in feet)	Static water level of completed well (in feet)	Source aquifer (sand, gravel, basalt, etc.)	Well-specific rate (cfs or gpm). If less than full rate of water right

**RECEIVED**  
**JUL 28 2022**  
**OWRD**



## Part 5 of 5 – Water Right Information

Please use a separate Part 5 for each water right being changed. See instructions on page 6, to copy and paste additional Part 5s, or to add additional rows to tables within the form.

CERTIFICATE # 92992

RECEIVED

JUL 28 2022

OWRD

### Description of Water Delivery System

System capacity: \_\_\_\_\_ cubic feet per second (cfs) OR

CID System – 142,000 gallons per minute (gpm)

Describe the current water delivery system or the system that was in place at some time within the last five years. Include information on the pumps, canals, pipelines, and sprinklers used to divert, convey, and apply the water at the authorized place of use. Water is withdrawn at a pump station located on the Columbia River. The water is then transported through a series of pipelines and boosters into the CID canal. From the canal, water enters an underground pipeline and is pumped into the sprinkler system.

**Table 1. Location of Authorized and Proposed Point(s) of Diversion (POD) or Appropriation (POA)**

(Note: If the POD/POA name is not specified on the certificate, assign it a name or number here.)

POD/POA Name or Number	Is this POD/POA Authorized on the Certificate or is it Proposed?	If POA, OWRD Well Log ID# (or Well ID Tag # L-___)	Twp		Rng		Sec	¼ ¼		Tax Lot, DLC or Gov't Lot	Measured Distances (from a recognized survey corner)
Columbia River Pump Station (CRPS)	<input checked="" type="checkbox"/> Authorized <input type="checkbox"/> Proposed		4	N	25	E	2	NE	NW		South 86 degrees 22 minutes 46 seconds West, 2829 feet from the NE Corner of Section 2

### Check all type(s) of change(s) proposed below (change "CODES" are provided in parentheses):

- |  |   |
|--|---|
| <input checked="" type="checkbox"/> Place of Use (POU)                 | <input type="checkbox"/> Supplemental Use to Primary Use (S to P) |
| <input type="checkbox"/> Character of Use (USE)                        | <input type="checkbox"/> Point of Appropriation/Well (POA)        |
| <input type="checkbox"/> Point of Diversion (POD)                      | <input type="checkbox"/> Additional Point of Appropriation (APOA) |
| <input type="checkbox"/> Additional Point of Diversion (APOD)          | <input type="checkbox"/> Substitution (SUB)                       |
| <input type="checkbox"/> Surface Water POD to Ground Water POA (SW/GW) | <input type="checkbox"/> Government Action POD (GOV)              |

### Will all of the proposed changes affect the entire water right?

- Yes Complete only the Proposed ("to" or "on" lands) section of Table 2 on the next page. Use the "CODES" listed above to describe the proposed changes.
- No Complete all of Table 2 to describe the portion of the water right to be changed.



Please use and attach additional pages of Table 2 as needed.  
See page 6 for instructions.

Do you have questions about how to fill-out the tables?  
Contact the Department at 503-986-0900 and ask for Transfer Staff.

**Table 2. Description of Changes to Water Right Certificate # [92992](#)**

List the change proposed for the acreage in each ¼ ¼. If more than one change is proposed, specify the acreage associated with each change.  
If there is more than one POD/POA involved in the proposed changes, specify the acreage associated with each POD/POA.

AUTHORIZED (the "from" or "off" lands) The listing that appears on the certificate BEFORE PROPOSED CHANGES List only that part or portion of the water right that will be changed.											Proposed Changes (see "CODES" from previous page)	PROPOSED (the "to" or "on" lands) The listing as it would appear AFTER PROPOSED CHANGES are made.											
Twp	Rng	Sec	¼ ¼	Tax Lot	Gvt Lot or DLC	Acres	Type of USE listed on Certificate	POD(s) or POA(s) (name or number from Table 1)	Priority Date	Twp		Rng	Sec	¼ ¼	Tax Lot	Gvt Lot or DLC	Acres	New Type of USE	POD(s)/ POA(s) to be used (from Table 1)	Priority Date			
										POU	2	N	28	E	4	NW	NW	800		0.01	Irrigation	CRPS	7/25/1973
										POU	2	N	28	E	5	NW	NW	900	L4	30.61	Irrigation	CRPS	7/25/1973
										POU	2	N	28	E	5	NE	NW	900	L3	33.11	Irrigation	CRPS	7/25/1973
										POU	2	N	28	E	5	SE	NW	900		31.01	Irrigation	CRPS	7/25/1973
										POU	2	N	28	E	5	SW	NW	900		30.42	Irrigation	CRPS	7/25/1973
										POU	2	N	28	E	5	NW	NE	900	L2	31.09	Irrigation	CRPS	7/25/1973
										POU	2	N	28	E	5	NE	NE	900	L1	33.07	Irrigation	CRPS	7/25/1973
										POU	2	N	28	E	5	SE	NE	900		30.04	Irrigation	CRPS	7/25/1973
										POU	2	N	28	E	5	SW	NE	900		29.83	Irrigation	CRPS	7/25/1973
										POU	2	N	28	E	5	NW	SE	900		31.48	Irrigation	CRPS	7/25/1973

RECEIVED  
 JUL 28 2022  
 OWRD



AUTHORIZED (the "from" or "off" lands) The listing that appears on the certificate BEFORE PROPOSED CHANGES List only that part or portion of the water right that will be changed.										Proposed Changes (see "CODES" from previous page)	PROPOSED (the "to" or "on" lands) The listing as it would appear AFTER PROPOSED CHANGES are made.												
Twp	Rng	Sec	¼ ¼	Tax Lot	Gvt Lot or DLC	Acres	Type of USE listed on Certificate	POD(s) or POA(s) (name or number from Table 1)	Priority Date		Twp	Rng	Sec	¼ ¼	Tax Lot	Gvt Lot or DLC	Acres	New Type of USE	POD(s)/ POA(s) to be used (from Table 1)	Priority Date			
										POU	2	N	28	E	5	NE	SE	900		32.96	Irrigation	CRPS	7/25/1973
										POU	2	N	28	E	5	SE	SE	900		29.32	Irrigation	CRPS	7/25/1973
										POU	2	N	28	E	5	SW	SE	900		29.62	Irrigation	CRPS	7/25/1973
										POU	2	N	28	E	5	NW	SW	900		30.61	Irrigation	CRPS	7/25/1973
										POU	2	N	28	E	5	NE	SW	900		32.62	Irrigation	CRPS	7/25/1973
										POU	2	N	28	E	5	SE	SW	900		30.23	Irrigation	CRPS	7/25/1973
										POU	2	N	28	E	5	SW	SW	900		30.10	Irrigation	CRPS	7/25/1973
										POU	2	N	28	E	6	NE	NW	1000	L3	1.35	Irrigation	CRPS	7/25/1973
										POU	2	N	28	E	6	SE	NW	1000		0.66	Irrigation	CRPS	7/25/1973
										POU	2	N	28	E	6	NW	NE	1000	L2	37.06	Irrigation	CRPS	7/25/1973
										POU	2	N	28	E	6	NE	NE	1000	L1	35.62	Irrigation	CRPS	7/25/1973
										POU	2	N	28	E	6	SE	NE	1000		28.54	Irrigation	CRPS	7/25/1973
										POU	2	N	28	E	6	SW	NE	1000		31.34	Irrigation	CRPS	7/25/1973
										POU	2	N	28	E	7	NW	NE	1300		9.75	Irrigation	CRPS	7/26/1973
										POU	2	N	28	E	7	NE	NE	1300		30.25	Irrigation	CRPS	7/27/1973
										POU	2	N	28	E	7	SE	NE	1300		28.77	Irrigation	CRPS	7/28/1973
										POU	2	N	28	E	7	SW	NE	1300		8.76	Irrigation	CRPS	7/29/1973

RECEIVED  
 JUL 28 2022  
 OWRD



AUTHORIZED (the "from" or "off" lands) The listing that appears on the certificate BEFORE PROPOSED CHANGES List only that part or portion of the water right that will be changed.										Proposed Changes (see "CODES" from previous page)	PROPOSED (the "to" or "on" lands) The listing as it would appear AFTER PROPOSED CHANGES are made.												
Twp	Rng	Sec	¼ ¼	Tax Lot	Gvt Lot or DLC	Acres	Type of USE listed on Certificate	POD(s) or POA(s) (name or number from Table 1)	Priority Date		Twp	Rng	Sec	¼ ¼	Tax Lot	Gvt Lot or DLC	Acres	New Type of USE	POD(s)/ POA(s) to be used (from Table 1)	Priority Date			
										POU	2	N	28	E	7	NW	SE	1300		0.01	Irrigation	CRPS	7/25/1973
										POU	2	N	28	E	7	NE	SE	1300		0.01	Irrigation	CRPS	7/25/1973
										POU	2	N	28	E	8	NW	NW	1501		28.72	Irrigation	CRPS	7/25/1973
										POU	2	N	28	E	8	NE	NW	1500		30.25	Irrigation	CRPS	7/25/1973
										POU	2	N	28	E	8	SE	NW	1500		30.60	Irrigation	CRPS	7/25/1973
										POU	2	N	28	E	8	SW	NW	1501		30.30	Irrigation	CRPS	7/25/1973
										POU	2	N	28	E	8	NW	NE	1600		30.47	Irrigation	CRPS	7/25/1973
										POU	2	N	28	E	8	NE	NE	1600		31.03	Irrigation	CRPS	7/25/1973
										POU	2	N	28	E	8	SE	NE	1600		30.71	Irrigation	CRPS	7/25/1973
										POU	2	N	28	E	8	SW	NE	1600		32.34	Irrigation	CRPS	7/25/1973
										POU	2	N	28	E	8	NW	SE	1700		39.83	Irrigation	CRPS	7/25/1973
										POU	2	N	28	E	8	NE	SE	1700		12.74	Irrigation	CRPS	7/25/1973
										POU	2	N	28	E	8	SE	SE	1700		9.83	Irrigation	CRPS	7/25/1973
										POU	2	N	28	E	8	SW	SE	1700		35.70	Irrigation	CRPS	7/25/1973
										POU	2	N	28	E	8	NE	SW	1700		14.33	Irrigation	CRPS	7/26/1973
										POU	2	N	28	E	8	SE	SW	1700		12.07	Irrigation	CRPS	7/27/1973
										POU	3	N	28	E	31	NW	SE	300		6.15	Irrigation	CRPS	7/28/1973

RECEIVED  
 JUL 28 2022  
 OWRD



AUTHORIZED (the "from" or "off" lands) The listing that appears on the certificate BEFORE PROPOSED CHANGES List only that part or portion of the water right that will be changed.										Proposed Changes (see "CODES" from previous page)	PROPOSED (the "to" or "on" lands) The listing as it would appear AFTER PROPOSED CHANGES are made.												
Twp	Rng	Sec	¼ ¼	Tax Lot	Gvt Lot or DLC	Acres	Type of USE listed on Certificate	POD(s) or POA(s) (name or number from Table 1)	Priority Date		Twp	Rng	Sec	¼ ¼	Tax Lot	Gvt Lot or DLC	Acres	New Type of USE	POD(s)/ POA(s) to be used (from Table 1)	Priority Date			
										POU	3	N	28	E	31	SE	SE	300		2.18	Irrigation	CRPS	7/25/1973
										POU	3	N	28	E	31	SW	SE	300		34.15	Irrigation	CRPS	7/25/1973
										POU	3	N	28	E	31	NE	SW	300		23.61	Irrigation	CRPS	7/25/1973
										POU	3	N	28	E	31	SE	SW	300		32.17	Irrigation	CRPS	7/25/1973
										POU	3	N	28	E	32	NW	SE	9000		29.90	Irrigation	CRPS	7/25/1973
										POU	3	N	28	E	32	NE	SE	9000		31.43	Irrigation	CRPS	7/25/1973
										POU	3	N	28	E	32	SE	SE	9000		31.72	Irrigation	CRPS	7/25/1973
										POU	3	N	28	E	32	SW	SE	9000		30.79	Irrigation	CRPS	7/25/1973
										POU	3	N	28	E	32	NW	SW	9000		30.25	Irrigation	CRPS	7/25/1973
										POU	3	N	28	E	32	NE	SW	9000		32.22	Irrigation	CRPS	7/25/1973
										POU	3	N	28	E	32	SE	SW	9000		32.33	Irrigation	CRPS	7/25/1973
										POU	3	N	28	E	32	SW	SW	9000		30.98	Irrigation	CRPS	7/25/1973
										POU	3	N	28	E	33	NW	SW	8103		0.01	Irrigation	CRPS	7/25/1973
										POU	3	N	28	E	33	SW	SW	8103		0.01	Irrigation	CRPS	7/25/1973
TOTAL ACRES: 1425.07											TOTAL ACRES: 1425.07												

Additional remarks: The transfer involves the entire place of Certificate 92992. The "From" place of use for Certificate 92992 is located in 8-ft wide strips and the place of use for Certificate 92993 is in 2-ft wide strips interlaced between the 8-ft strips of Certificate 92992. While there is common land between these two water rights, the rights DO NOT OVERLAP and will therefore be transferred separately.

RECEIVED  
 JUL 28 2022  
 OWRD



**For Place of Use or Character of Use Changes**

Are there other water right certificates, water use permits or ground water registrations associated with the "from" or the "to" lands?  Yes  No

If YES, list the certificate, water use permit, or ground water registration numbers:

- Permit S-51017 is associated with the TO land; the permit holder has filed a permit amendment to move this water right off of the TO land (T-13367).
- Permits S-54675 and G-17354 are associated with the TO land; the permit holder is intending to file a permit amendment to move these water rights off of the TO land.
- Permits S-55061, S-55190, and S-55192 are mitigation water rights held by NOWA. These permits will temporarily cover the TO lands in this application until there is a permanent mitigation program in place that will allow them to be certificated.
- Certificate 44654 is associated with the TO land; the water right holder would like to diminish this water right to supplemental (Attachment E) with primary provided by this transfer.



Pursuant to ORS 540.510, any "layered" water use such as an irrigation right that is supplemental to a primary right proposed for transfer must be included in the transfer or be cancelled. Any change to a ground water registration must be filed separately in a ground water registration modification application.

**For Substitution** (ground water supplemental irrigation will be substituted for surface water primary irrigation)

Ground water supplemental Permit or Certificate # N/A;  
Surface water primary Certificate # \_\_\_\_\_.

RECEIVED

JUL 28 2022

**For a change from Supplemental Irrigation Use to Primary Irrigation Use**

OWRD

Identify the primary certificate to be cancelled. Certificate # N/A

**For a change in point(s) of appropriation (well(s)) or additional point(s) of appropriation: N/A**

- Well log(s) are attached for each authorized and proposed well(s) that are clearly labeled and associated with the corresponding well(s) in Table 1 above and on the accompanying application map.

**Tip:** You may search for well logs on the Department's web page at:

[http://apps.wrd.state.or.us/apps/gw/well\\_log/Default.aspx](http://apps.wrd.state.or.us/apps/gw/well_log/Default.aspx)

**AND/OR**

- Describe the construction of the authorized and proposed well(s) in Table 3 for any wells that do not have a well log. For *proposed wells not yet constructed or built*, provide "a best estimate" for each requested information element in the table. The Department recommends you consult a licensed well driller, geologist, or certified water right examiner to assist with assembling the information necessary to complete Table 3.



**Table 3. Construction of Point(s) of Appropriation**

Any well(s) in this listing must be clearly tied to corresponding well(s) described in Table 1 and shown on the accompanying application map. Failure to provide the information will delay the processing of your transfer application until it is received. The information is necessary for the department to assess whether the proposed well(s) will access the same source aquifer as the authorized point(s) of appropriation (POA). The Department is prohibited by law from approving POA changes that do not access the same source aquifer.

Proposed or Authorized POA Name or Number	Is well already built? (Yes or No)	If an existing well: OWRD Well ID Tag No. L-___	Total well depth	Casing Diameter	Casing Intervals (feet)	Seal depth(s) (intervals)	Perforated or screened intervals (in feet)	Static water level of completed well (in feet)	Source aquifer (sand, gravel, basalt, etc.)	Well-specific rate (cfs or gpm). If less than full rate of water right

RECEIVED

JUL 28 2022

OWRD



**Part 5 of 5 – Water Right Information**

Please use a separate Part 5 for each water right being changed. See instructions on page 6, to copy and paste additional Part 5s, or to add additional rows to tables within the form.

CERTIFICATE # 92993

RECEIVED

JUL 28 2022

OWRD

**Description of Water Delivery System**

System capacity: \_\_\_\_\_ cubic feet per second (cfs) OR  
CID System – 142,000 gallons per minute (gpm)

Describe the current water delivery system or the system that was in place at some time within the last five years. Include information on the pumps, canals, pipelines, and sprinklers used to divert, convey, and apply the water at the authorized place of use. Water is withdrawn at a pump station located on the Columbia River. The water is then transported through a series of pipelines and boosters into the CID canal. From the canal, water enters an underground pipeline and is pumped into the sprinkler system.

**Table 1. Location of Authorized and Proposed Point(s) of Diversion (POD) or Appropriation (POA)**  
 (Note: If the POD/POA name is not specified on the certificate, assign it a name or number here.)

POD/POA Name or Number	Is this POD/POA Authorized on the Certificate or Is it Proposed?	If POA, OWRD Well Log ID# (or Well ID Tag # L-___)	Twp		Rng		Sec	¼ ¼		Tax Lot, DLC or Gov't Lot	Measured Distances (from a recognized survey corner)
<u>Columbia River Pump Station (CRPS)</u>	<input checked="" type="checkbox"/> Authorized <input type="checkbox"/> Proposed		<u>4</u>	<u>N</u>	<u>25</u>	<u>E</u>	<u>2</u>	<u>NE</u>	<u>NW</u>		<u>South 86 degrees 22 minutes 46 seconds West, 2829 feet from the NE Corner of Section 2</u>

**Check all type(s) of change(s) proposed below (change "CODES" are provided in parentheses):**

- |  |   |
|--|---|
| <input checked="" type="checkbox"/> Place of Use (POU)                 | <input type="checkbox"/> Supplemental Use to Primary Use (S to P) |
| <input type="checkbox"/> Character of Use (USE)                        | <input type="checkbox"/> Point of Appropriation/Well (POA)        |
| <input type="checkbox"/> Point of Diversion (POD)                      | <input type="checkbox"/> Additional Point of Appropriation (APOA) |
| <input type="checkbox"/> Additional Point of Diversion (APOD)          | <input type="checkbox"/> Substitution (SUB)                       |
| <input type="checkbox"/> Surface Water POD to Ground Water POA (SW/GW) | <input type="checkbox"/> Government Action POD (GOV)              |

**Will all of the proposed changes affect the entire water right?**

- Yes Complete only the Proposed ("to" or "on" lands) section of Table 2 on the next page. Use the "CODES" listed above to describe the proposed changes.
- No Complete all of Table 2 to describe the portion of the water right to be changed.



Please use and attach additional pages of Table 2 as needed.  
See page 6 for instructions.

Do you have questions about how to fill-out the tables?  
Contact the Department at 503-986-0900 and ask for Transfer Staff.

**Table 2. Description of Changes to Water Right Certificate # 92993**

List the change proposed for the acreage in each ¼ ¼. If more than one change is proposed, specify the acreage associated with each change.  
If there is more than one POD/POA involved in the proposed changes, specify the acreage associated with each POD/POA.

AUTHORIZED (the "from" or "off" lands) The listing that appears on the certificate BEFORE PROPOSED CHANGES List only that part or portion of the water right that will be changed.											Proposed Changes (see "CODES" from previous page)	PROPOSED (the "to" or "on" lands) The listing as it would appear AFTER PROPOSED CHANGES are made.											
Twp	Rng	Sec	¼ ¼	Tax Lot	Gvt Lot or DLC	Acres	Type of USE listed on Certificate	POD(s) or POA(s) (name or number from Table 1)	Priority Date	Twp		Rng	Sec	¼ ¼	Tax Lot	Gvt Lot or DLC	Acres	New Type of USE	POD(s)/ POA(s) to be used (from Table 1)	Priority Date			
										POU	3	N	28	E	31	NW	SE	300		4.16	Irrigation	CRPS	7/25/1973
										POU	3	N	28	E	31	NE	SE	300		28.95	Irrigation	CRPS	7/25/1973
										POU	3	N	28	E	32	NW	SW	9000		5.27	Irrigation	CRPS	7/25/1973
										POU	3	N	28	E	31	NE	SW	300		1.32	Irrigation	CRPS	7/25/1973
										POU	3	N	28	E	31	SE	SW	300		0.01	Irrigation	CRPS	7/25/1973
TOTAL ACRES:						39.71						TOTAL ACRES:						39.71					

Additional remarks: The transfer involves the entire place of Certificate 92993. The "From" place of use for Certificate 92993 is located in 2-ft wide strips and the "From" place of use for Certificate 92992 is in 8-ft wide strips interlaced between the 2-ft strips of Certificate 92992. While there is common land between these two water rights, the rights DO NOT OVERLAP and will therefore be transferred separately.

RECEIVED  
 JUL 28 2022  
 OWRD



**For Place of Use or Character of Use Changes**

Are there other water right certificates, water use permits or ground water registrations associated with the "from" or the "to" lands?  Yes  No

If YES, list the certificate, water use permit, or ground water registration numbers:

- Permit S-51017 is associated with the TO land; the permit holder has filed a permit amendment to move this water right off of the TO land (T-13367).
- Permits S-54675 and G-17354 are associated with the TO land; the permit holder is intending to file a permit amendment to move these water rights off of the TO land.
- Permits S-55061, S-55190, and S-55192 are mitigation water rights held by NOWA. These permits will temporarily cover the TO lands in this application until there is a permanent mitigation program in place that will allow them to be certificated.

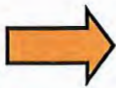

Pursuant to ORS 540.510, any "layered" water use such as an irrigation right that is supplemental to a primary right proposed for transfer must be included in the transfer or be cancelled. Any change to a ground water registration must be filed separately in a ground water registration modification application.

**For Substitution** (ground water supplemental irrigation will be substituted for surface water primary irrigation)

Ground water supplemental Permit or Certificate # N/A;

Surface water primary Certificate # \_\_\_\_\_.

RECEIVED

JUL 28 2022

**For a change from Supplemental Irrigation Use to Primary Irrigation Use**

Identify the primary certificate to be cancelled. Certificate # N/A

OWRD

**For a change in point(s) of appropriation (well(s)) or additional point(s) of appropriation:** N/A

- Well log(s) are attached for each authorized and proposed well(s) that are clearly labeled and associated with the corresponding well(s) in Table 1 above and on the accompanying application map.

**Tip:** You may search for well logs on the Department's web page at:

[http://apps.wrd.state.or.us/apps/gw/well\\_log/Default.aspx](http://apps.wrd.state.or.us/apps/gw/well_log/Default.aspx)

**AND/OR**

- Describe the construction of the authorized and proposed well(s) in Table 3 for any wells that do not have a well log. For *proposed wells not yet constructed or built*, provide "a best estimate" for each requested information element in the table. The Department recommends you consult a licensed well driller, geologist, or certified water right examiner to assist with assembling the information necessary to complete Table 3.



**Table 3. Construction of Point(s) of Appropriation**

Any well(s) in this listing must be clearly tied to corresponding well(s) described in Table 1 and shown on the accompanying application map. Failure to provide the information will delay the processing of your transfer application until it is received. The information is necessary for the department to assess whether the proposed well(s) will access the same source aquifer as the authorized point(s) of appropriation (POA). The Department is prohibited by law from approving POA changes that do not access the same source aquifer.

Proposed or Authorized POA Name or Number	Is well already built? (Yes or No)	If an existing well: OWRD Well ID Tag No. L-_____	Total well depth	Casing Diameter	Casing Intervals (feet)	Seal depth(s) (intervals)	Perforated or screened intervals (in feet)	Static water level of completed well (in feet)	Source aquifer (sand, gravel, basalt, etc.)	Well-specific rate (cfs or gpm). If less than full rate of water right

RECEIVED

JUL 28 2022

OWRD



## Part 5 of 5 – Water Right Information

Please use a separate Part 5 for each water right being changed. See instructions on page 6, to copy and paste additional Part 5s, or to add additional rows to tables within the form.

CERTIFICATE # 92994

RECEIVED

### Description of Water Delivery System

JUL 28 2022

System capacity: \_\_\_\_\_ cubic feet per second (cfs) OR

CID System – 142,000 gallons per minute (gpm)

OWRD

Describe the current water delivery system or the system that was in place at some time within the last five years. Include information on the pumps, canals, pipelines, and sprinklers used to divert, convey, and apply the water at the authorized place of use. Water is withdrawn at a pump station located on the Columbia River. The water is then transported through a series of pipelines and boosters into the CID canal. From the canal, water enters an underground pipeline and is pumped into the sprinkler system.

**Table 1. Location of Authorized and Proposed Point(s) of Diversion (POD) or Appropriation (POA)**  
(Note: If the POD/POA name is not specified on the certificate, assign it a name or number here.)

POD/POA Name or Number	Is this POD/POA Authorized on the Certificate or is it Proposed?	If POA, OWRD Well Log ID# (or Well ID Tag # L-___)	Twp		Rng		Sec	¼ ¼		Tax Lot, DLC or Gov't Lot	Measured Distances (from a recognized survey corner)
<u>Columbia River Pump Station (CRPS)</u>	<input checked="" type="checkbox"/> Authorized <input type="checkbox"/> Proposed		<u>4</u>	<u>N</u>	<u>25</u>	<u>E</u>	<u>2</u>	<u>NE</u>	<u>NW</u>		<u>South 86 degrees 22 minutes 46 seconds West, 2829 feet from the NE Corner of Section 2</u>

Check all type(s) of change(s) proposed below (change "CODES" are provided in parentheses):

- |  |   |
|--|---|
| <input checked="" type="checkbox"/> Place of Use (POU)                 | <input type="checkbox"/> Supplemental Use to Primary Use (S to P) |
| <input type="checkbox"/> Character of Use (USE)                        | <input type="checkbox"/> Point of Appropriation/Well (POA)        |
| <input type="checkbox"/> Point of Diversion (POD)                      | <input type="checkbox"/> Additional Point of Appropriation (APOA) |
| <input type="checkbox"/> Additional Point of Diversion (APOD)          | <input type="checkbox"/> Substitution (SUB)                       |
| <input type="checkbox"/> Surface Water POD to Ground Water POA (SW/GW) | <input type="checkbox"/> Government Action POD (GOV)              |

Will all of the proposed changes affect the entire water right?

- Yes Complete only the Proposed ("to" or "on" lands) section of Table 2 on the next page. Use the "CODES" listed above to describe the proposed changes.
- No Complete all of Table 2 to describe the portion of the water right to be changed.



Please use and attach additional pages of Table 2 as needed.  
See page 6 for instructions.

Do you have questions about how to fill-out the tables?  
Contact the Department at 503-986-0900 and ask for Transfer Staff.

**Table 2. Description of Changes to Water Right Certificate # 92994**

List the change proposed for the acreage in each ¼ ¼. If more than one change is proposed, specify the acreage associated with each change.  
If there is more than one POD/POA involved in the proposed changes, specify the acreage associated with each POD/POA.

AUTHORIZED (the "from" or "off" lands) The listing that appears on the certificate BEFORE PROPOSED CHANGES List only that part or portion of the water right that will be changed.											Proposed Changes (see "CODES" from previous page)	PROPOSED (the "to" or "on" lands) The listing as it would appear AFTER PROPOSED CHANGES are made.													
Twp	Rng	Sec	¼	¼	Tax Lot	Gvt Lot or DLC	Acres	Type of USE listed on Certificate	POD(s) or POA(s) (name or number from Table 1)	Priority Date		Twp	Rng	Sec	¼	¼	Tax Lot	Gvt Lot or DLC	Acres	New Type of USE	POD(s)/ POA(s) to be used (from Table 1)	Priority Date			
4	N	26	E	16	NW	NW	3418	26.31	Irrigation	CRPS	6/29/1973	POU	2	N	28	E	17	NW	NW	1702	28.89	Irrigation	CRPS	6/29/1973	
4	N	26	E	16	NE	NW	3418	36.63	Irrigation	CRPS	6/29/1973	POU	2	N	28	E	17	NE	NW	1700	1.25	Irrigation	CRPS	6/29/1973	
4	N	26	E	16	SE	NW	3418	2.2	Irrigation	CRPS	6/29/1973	POU	2	N	28	E	17	SE	NW	1700	3.84	Irrigation	CRPS	6/29/1973	
4	N	26	E	16	NW	NE	3418	38.98	Irrigation	CRPS	6/29/1973	POU	2	N	28	E	17	SW	NW	1702	29.99	Irrigation	CRPS	6/29/1973	
4	N	26	E	16	NE	NE	3418	30.99	Irrigation	CRPS	6/29/1973	POU	2	N	28	E	17	NW	SW	1700	29.46	Irrigation	CRPS	6/29/1973	
4	N	26	E	16	SE	NE	3418	2.41	Irrigation	CRPS	6/29/1973	POU	2	N	28	E	17	NE	SW	1700	4.22	Irrigation	CRPS	6/29/1973	
4	N	26	E	16	SW	NE	3418	14.21	Irrigation	CRPS	6/29/1973	POU	2	N	28	E	17	SE	SW	1700	19.94	Irrigation	CRPS	6/29/1973	
4	N	26	E	17	NE	NE	3418	12.31	Irrigation	CRPS	6/29/1973	POU	2	N	28	E	17	SW	SW	1700	29.57	Irrigation	CRPS	6/29/1973	
4	N	26	E	17	NW	NE	3418	0.86	Irrigation	CRPS	6/29/1973	POU	3	N	28	E	31	NE	SW	300	1.42	Irrigation	CRPS	6/29/1973	
												POU	3	N	28	E	31	SE	SW	300	0.01	Irrigation	CRPS	6/29/1973	
												POU	4	N	26	E	19	NW	NW	3416	1	0.57	Irrigation	CRPS	6/29/1973
												POU	4	N	26	E	19	SE	NW	3416 3419		4.09	Irrigation	CRPS	6/29/1973
												POU	4	N	26	E	19	SW	NW	3416 3419	2	11.65	Irrigation	CRPS	6/29/1973
TOTAL ACRES:							164.90						TOTAL ACRES:							164.90					

Additional remarks: The lands described above are a portion of Certificate 92994. The remaining lands are not listed on the above table.

RECEIVED  
 JUL 28 2022  
 OWRD



**For Place of Use or Character of Use Changes**

Are there other water right certificates, water use permits or ground water registrations associated with the "from" or the "to" lands?  Yes  No

If YES, list the certificate, water use permit, or ground water registration numbers:

- Permit S-51017 is associated with the TO land; the permit holder has filed a permit amendment to move this water right off of the TO land (T-13367).
- Permits S-54675 and G-17354 are associated with the TO land; the permit holder is intending to file a permit amendment to move these waters right off of the TO land.
- Permits S-55061, S-55190, and S-55192 are mitigation water rights held by NOWA. These permits will temporarily cover the TO lands in this application until there is a permanent mitigation program in place that will allow them to be certificated.
- Certificate 44654 is associated with the TO land; the water right holder would like to diminish this water right to supplemental (Attachment E) with primary provided by this transfer.



Pursuant to ORS 540.510, any "layered" water use such as an irrigation right that is supplemental to a primary right proposed for transfer must be included in the transfer or be cancelled. Any change to a ground water registration must be filed separately in a ground water registration modification application.

**For Substitution** (ground water supplemental irrigation will be substituted for surface water primary irrigation)

Ground water supplemental Permit or Certificate # N/A;  
Surface water primary Certificate # \_\_\_\_\_.

RECEIVED

JUL 28 2022

**For a change from Supplemental Irrigation Use to Primary Irrigation Use**

OWRD

Identify the primary certificate to be cancelled. Certificate # N/A

**For a change in point(s) of appropriation (well(s)) or additional point(s) of appropriation: N/A**

- Well log(s) are attached for each authorized and proposed well(s) that are clearly labeled and associated with the corresponding well(s) in Table 1 above and on the accompanying application map.

**Tip:** You may search for well logs on the Department's web page at:

[http://apps.wrd.state.or.us/apps/gw/well\\_log/Default.aspx](http://apps.wrd.state.or.us/apps/gw/well_log/Default.aspx)

**AND/OR**

- Describe the construction of the authorized and proposed well(s) in Table 3 for any wells that do not have a well log. For *proposed wells not yet constructed or built*, provide "a best estimate" for each requested information element in the table. The Department recommends you consult a licensed well driller, geologist, or certified water right examiner to assist with assembling the information necessary to complete Table 3.



**Table 3. Construction of Point(s) of Appropriation**

Any well(s) in this listing must be clearly tied to corresponding well(s) described in Table 1 and shown on the accompanying application map. Failure to provide the information will delay the processing of your transfer application until it is received. The information is necessary for the department to assess whether the proposed well(s) will access the same source aquifer as the authorized point(s) of appropriation (POA). The Department is prohibited by law from approving POA changes that do not access the same source aquifer.

Proposed or Authorized POA Name or Number	Is well already built? (Yes or No)	If an existing well: OWRD Well ID Tag No. L-_____	Total well depth	Casing Diameter	Casing Intervals (feet)	Seal depth(s) (intervals)	Perforated or screened intervals (in feet)	Static water level of completed well (in feet)	Source aquifer (sand, gravel, basalt, etc.)	Well-specific rate (cfs or gpm). If less than full rate of water right

RECEIVED

JUL 28 2022

OWRD



**Part 5 of 5 – Water Right Information**

Please use a separate Part 5 for each water right being changed. See instructions on page 6, to copy and paste additional Part 5s, or to add additional rows to tables within the form.

CERTIFICATE # 93872

RECEIVED

**Description of Water Delivery System**

JUL 28 2022

System capacity: \_\_\_\_\_ cubic feet per second (cfs) OR

CID System – 142,000 gallons per minute (gpm)

OWRD

Stahl Diversion – 7,140 gallons per minute (gpm)

Describe the current water delivery system or the system that was in place at some time within the last five years. Include information on the pumps, canals, pipelines, and sprinklers used to divert, convey, and apply the water at the authorized place of use.

CID System - Water is withdrawn at a pump station located on the Columbia River. The water is then transported through a series of pipelines and boosters into the CID canal. From the canal, water enters an underground pipeline and is pumped into the sprinkler system.

Stahl Diversion - water is withdrawn at a pump station located on the Columbia River. The water is then transported through a series of pipelines and boosters to the sprinkler systems.

**Table 1. Location of Authorized and Proposed Point(s) of Diversion (POD) or Appropriation (POA)**  
(Note: If the POD/POA name is not specified on the certificate, assign it a name or number here.)

POD/POA Name or Number	Is this POD/POA Authorized on the Certificate or is it Proposed?	If POA, OWRD Well Log ID# (or Well ID Tag # L-___)	Twp		Rng		Sec	¼ ¼		Tax Lot, DLC or Gov't Lot	Measured Distances (from a recognized survey corner)
Columbia River Pump Station (CRPS)	<input checked="" type="checkbox"/> Authorized <input type="checkbox"/> Proposed		4	N	25	E	2	NE	NW		South 86 degrees 22 minutes 46 seconds West, 2829 feet from the NE Corner of Section 2
Stahl Pump Station (PS)	<input checked="" type="checkbox"/> Authorized <input type="checkbox"/> Proposed		5	N	30	E	8	SW	NW		2860 feet North and 70 feet East from the SW corner of Section 8 **
East Improvement District (EID) Pump Station (PS)	<input type="checkbox"/> Authorized <input checked="" type="checkbox"/> Proposed		5	N	30	E	8	SW	NW		2910 feet North and 120 feet East from the SW corner of Section 8

**\*\*NOTE: This is an updated location description to more accurately locate the existing Stahl Diversion POD.**

Check all type(s) of change(s) proposed below (change "CODES" are provided in parentheses):

- |  |   |
|--|---|
| <input checked="" type="checkbox"/> Place of Use (POU)                   | <input type="checkbox"/> Supplemental Use to Primary Use (S to P) |
| <input type="checkbox"/> Character of Use (USE)                          | <input type="checkbox"/> Point of Appropriation/Well (POA)        |
| <input checked="" type="checkbox"/> Point of Diversion (POD)             | <input type="checkbox"/> Additional Point of Appropriation (APOA) |
| <input checked="" type="checkbox"/> Additional Point of Diversion (APOD) | <input type="checkbox"/> Substitution (SUB)                       |



Surface Water POD to Ground Water  
POA (SW/GW)

Government Action POD (GOV)

**Will all of the proposed changes affect the entire water right?**

Yes Complete only the Proposed ("to" or "on" lands) section of Table 2 on the next page. Use the "CODES" listed above to describe the proposed changes.

No Complete all of Table 2 to describe the portion of the water right to be changed.

RECEIVED

JUL 28 2022

OWRD



Please use and attach additional pages of Table 2 as needed.  
See page 6 for instructions.

Do you have questions about how to fill-out the tables?  
Contact the Department at 503-986-0900 and ask for Transfer Staff.

**Table 2. Description of Changes to Water Right Certificate # [93872](#)**

List the change proposed for the acreage in each ¼ ¼. If more than one change is proposed, specify the acreage associated with each change.  
If there is more than one POD/POA involved in the proposed changes, specify the acreage associated with each POD/POA.

AUTHORIZED (the "from" or "off" lands) The listing that appears on the certificate BEFORE PROPOSED CHANGES List only that part or portion of the water right that will be changed.												Proposed Changes (see "CODES" from previous page)	PROPOSED (the "to" or "on" lands) The listing as it would appear AFTER PROPOSED CHANGES are made.											
Twp	Rng	Sec	¼	¼	Tax Lot	Gvt Lot or DLC	Acres	Type of USE listed on Certificate	POD(s) or POA(s) (name or number from Table 1)	Priority Date	Twp		Rng	Sec	¼	¼	Tax Lot	Gvt Lot or DLC	Acres	New Type of USE	POD(s)/ POA(s) to be used (from Table 1)	Priority Date		
<b>↓ 368.93-acre portion with proposed APOD ↓</b>																								
3	N	29	E	3	NE	NE		30.73	Irrigation	Stahl PS	6/29/1973	APOD	3	N	29	E	3	NE	NE		30.73	Irrigation	EID PS & Stahl PS	6/29/1973
3	N	29	E	3	NW	NE		34.24	Irrigation	Stahl PS	6/29/1973	APOD	3	N	29	E	3	NW	NE		34.24	Irrigation	EID PS & Stahl PS	6/29/1973
3	N	29	E	3	SW	NE		32.16	Irrigation	Stahl PS	6/29/1973	APOD	3	N	29	E	3	SW	NE		32.16	Irrigation	EID PS & Stahl PS	6/29/1973
3	N	29	E	3	SE	NE		28.26	Irrigation	Stahl PS	6/29/1973	APOD	3	N	29	E	3	SE	NE		28.26	Irrigation	EID PS & Stahl PS	6/29/1973
3	N	29	E	3	NE	NW		0.37	Irrigation	Stahl PS	6/29/1973	APOD	3	N	29	E	3	NE	NW		0.37	Irrigation	EID PS & Stahl PS	6/29/1973
3	N	29	E	3	SE	NW		0.3	Irrigation	Stahl PS	6/29/1973	APOD	3	N	29	E	3	SE	NW		0.3	Irrigation	EID PS & Stahl PS	6/29/1973
3	N	29	E	3	NE	SW		29.31	Irrigation	Stahl PS	6/29/1973	APOD	3	N	29	E	3	NE	SW		29.31	Irrigation	EID PS & Stahl PS	6/29/1973
3	N	29	E	3	NW	SW		29.91	Irrigation	Stahl PS	6/29/1973	APOD	3	N	29	E	3	NW	SW		29.91	Irrigation	EID PS & Stahl PS	6/29/1973
3	N	29	E	3	SW	SW		30.28	Irrigation	Stahl PS	6/29/1973	APOD	3	N	29	E	3	SW	SW		30.28	Irrigation	EID PS & Stahl PS	6/29/1973
3	N	29	E	3	SE	SW		28.43	Irrigation	Stahl PS	6/29/1973	APOD	3	N	29	E	3	SE	SW		28.43	Irrigation	EID PS & Stahl PS	6/29/1973
3	N	29	E	3	NE	SE		30	Irrigation	Stahl PS	6/29/1973	APOD	3	N	29	E	3	NE	SE		30	Irrigation	EID PS & Stahl PS	6/29/1973

RECEIVED  
 JUL 28 2022  
 OWRD



AUTHORIZED (the "from" or "off" lands) The listing that appears on the certificate BEFORE PROPOSED CHANGES List only that part or portion of the water right that will be changed.											Proposed Changes (see "CODES" from previous page)	PROPOSED (the "to" or "on" lands) The listing as it would appear AFTER PROPOSED CHANGES are made.													
Twp	Rng	Sec	¼	¼	Tax Lot	Gvt Lot or DLC	Acres	Type of USE listed on Certificate	POD(s) or POA(s) (name or number from Table 1)	Priority Date		Twp	Rng	Sec	¼	¼	Tax Lot	Gvt Lot or DLC	Acres	New Type of USE	POD(s)/ POA(s) to be used (from Table 1)	Priority Date			
3	N	29	E	3	NW	SE		32.88	Irrigation	Stahl PS	6/29/1973	APOD	3	N	29	E	3	NW	SE		32.88	Irrigation	EID PS & Stahl PS	6/29/1973	
3	N	29	E	3	SW	SE		32.9	Irrigation	Stahl PS	6/29/1973	APOD	3	N	29	E	3	SW	SE		32.9	Irrigation	EID PS & Stahl PS	6/29/1973	
3	N	29	E	3	SE	SE		29.16	Irrigation	Stahl PS	6/29/1973	APOD	3	N	29	E	3	SE	SE		29.16	Irrigation	EID PS & Stahl PS	6/29/1973	
↓ 497.83-acre portion with proposed change in POU, POD, and APOD ↓																									
2	N	28	E	5	NE	NE	1	31.39	Irrigation	CRPS	6/29/1973	POU, POD, APOD	2	N	27	E	1	NE	NE	500		1.02	Irrigation	EID PS & Stahl PS	6/29/1973
2	N	28	E	5	NW	NE	2	30.43	Irrigation	CRPS	6/29/1973	POU, POD, APOD	2	N	27	E	1	SE	NE	500		0.57	Irrigation	EID PS & Stahl PS	6/29/1973
2	N	28	E	5	SW	NE		31.35	Irrigation	CRPS	6/29/1973	POU, POD, APOD	2	N	28	E	6	NE	NW	1000	3	34.33	Irrigation	EID PS & Stahl PS	6/29/1973
2	N	28	E	5	SE	NE		30.43	Irrigation	CRPS	6/29/1973	POU, POD, APOD	2	N	28	E	6	NW	NW	1000	5	11.93	Irrigation	EID PS & Stahl PS	6/29/1973
2	N	28	E	5	NE	SW		31.75	Irrigation	CRPS	6/29/1973	POU, POD, APOD	2	N	28	E	6	SW	NW	1000	4	21.36	Irrigation	EID PS & Stahl PS	6/29/1973
2	N	28	E	5	NW	SW		30.77	Irrigation	CRPS	6/29/1973	POU, POD, APOD	2	N	28	E	6	SE	NW	1000		16.84	Irrigation	EID PS & Stahl PS	6/29/1973
2	N	28	E	5	SW	SW		31.71	Irrigation	CRPS	6/29/1973	POU, POD, APOD	3	N	28	E	31	SW	SW	300		0.84	Irrigation	EID PS & Stahl PS	6/29/1973
2	N	28	E	5	SE	SW		30.77	Irrigation	CRPS	6/29/1973	POU, POD, APOD	3	N	28	E	31	SE	SW	300		4.99	Irrigation	EID PS & Stahl PS	6/29/1973
2	N	28	E	5	NE	SE		31.38	Irrigation	CRPS	6/29/1973	POU, POD, APOD	3	N	29	E	2	NE	NW	400		32.88	Irrigation	EID PS & Stahl PS	6/29/1973
2	N	28	E	5	NW	SE		30.44	Irrigation	CRPS	6/29/1973	POU, POD, APOD	3	N	29	E	2	NW	NW	400		20.14	Irrigation	EID PS & Stahl PS	6/29/1973
2	N	28	E	5	SW	SE		31.34	Irrigation	CRPS	6/29/1973	POU, POD, APOD	3	N	29	E	2	SW	NW	400		9.74	Irrigation	EID PS & Stahl PS	6/29/1973

RECEIVED  
 JUL 28 2022  
 OMTD



AUTHORIZED (the "from" or "off" lands) The listing that appears on the certificate BEFORE PROPOSED CHANGES List only that part or portion of the water right that will be changed.											Proposed Changes (see "CODES" from previous page)	PROPOSED (the "to" or "on" lands) The listing as it would appear AFTER PROPOSED CHANGES are made.													
Twp	Rng	Sec	¼	¼	Tax Lot	Gvt Lot or DLC	Acres	Type of USE listed on Certificate	POD(s) or POA(s) (name or number from Table 1)	Priority Date		Twp	Rng	Sec	¼	¼	Tax Lot	Gvt Lot or DLC	Acres	New Type of USE	POD(s)/ POA(s) to be used (from Table 1)	Priority Date			
2	N	28	E	5	SE	SE		30.44	Irrigation	CRPS	6/29/1973	POU, POD, APOD	3	N	29	E	2	SE	NW	400		16.72	Irrigation	EID PS & Stahl PS	6/29/1973
2	N	28	E	8	SW	NE		1.13	Irrigation	CRPS	6/29/1973	POU, POD, APOD	3	N	29	E	2	NE	SW	400		8.49	Irrigation	EID PS & Stahl PS	6/29/1973
2	N	28	E	8	NE	SW		14.33	Irrigation	CRPS	6/29/1973	POU, POD, APOD	3	N	29	E	2	NW	SW	400		19.26	Irrigation	EID PS & Stahl PS	6/29/1973
2	N	28	E	8	SE	SW		12.07	Irrigation	CRPS	6/29/1973	POU, POD, APOD	3	N	29	E	2	SW	SW	400		34.81	Irrigation	EID PS & Stahl PS	6/29/1973
2	N	28	E	8	NE	SE		12.74	Irrigation	CRPS	6/29/1973	POU, POD, APOD	3	N	29	E	2	SE	SW	400		16.65	Irrigation	EID PS & Stahl PS	6/29/1973
2	N	28	E	8	NW	SE		39.83	Irrigation	CRPS	6/29/1973	POU, POD, APOD	3	N	29	E	3	NW	NW	400		22.87	Irrigation	EID PS & Stahl PS	6/29/1973
2	N	28	E	8	SW	SE		35.7	Irrigation	CRPS	6/29/1973	POU, POD, APOD	3	N	29	E	3	NE	NW	400		29.64	Irrigation	EID PS & Stahl PS	6/29/1973
2	N	28	E	8	SE	SE		9.83	Irrigation	CRPS	6/29/1973	POU, POD, APOD	3	N	29	E	3	SE	NW	400		11.46	Irrigation	EID PS & Stahl PS	6/29/1973
												POU, POD, APOD	3	N	29	E	3	SE	SE	400		0.28	Irrigation	EID PS & Stahl PS	6/29/1973
												POU, POD, APOD	3	N	29	E	13	SE	SE	3700		30.29	Irrigation	EID PS & Stahl PS	6/29/1973
												POU, POD, APOD	3	N	29	E	13	SW	SE	3700		31.36	Irrigation	EID PS & Stahl PS	6/29/1973
												POU, POD, APOD	3	N	29	E	24	NE	NE	8700		0.01	Irrigation	EID PS & Stahl PS	6/29/1973
												POU, POD, APOD	3	N	29	E	24	NW	NE	8700		0.01	Irrigation	EID PS & Stahl PS	6/29/1973
												POU, POD, APOD	3	N	30	E	3	SW	SE	500		24.07	Irrigation	EID PS & Stahl PS	6/29/1973
												POU, POD, APOD	3	N	30	E	3	NW	SW	500		21.76	Irrigation	EID PS & Stahl PS	6/29/1973

RECEIVED  
 JUL 28 2022  
 OWRD



AUTHORIZED (the "from" or "off" lands) The listing that appears on the certificate BEFORE PROPOSED CHANGES List only that part or portion of the water right that will be changed.										Proposed Changes (see "CODES" from previous page)	PROPOSED (the "to" or "on" lands) The listing as it would appear AFTER PROPOSED CHANGES are made.													
Twp	Rng	Sec	¼	¼	Tax Lot	Gvt Lot or DLC	Acres	Type of USE listed on Certificate	POD(s) or POA(s) (name or number from Table 1)		Priority Date	Twp	Rng	Sec	¼	¼	Tax Lot	Gvt Lot or DLC	Acres	New Type of USE	POD(s)/ POA(s) to be used (from Table 1)	Priority Date		
											POU, POD, APOD	3	N	30	E	3	NE	SW	500		14.63	Irrigation	EID PS & Stahl PS	6/29/1973
											POU, POD, APOD	3	N	30	E	3	SE	SW	500		27.33	Irrigation	EID PS & Stahl PS	6/29/1973
											POU, POD, APOD	3	N	30	E	3	SW	SW	500		33.55	Irrigation	EID PS & Stahl PS	6/29/1973
TOTAL ACRES:							<b>866.76</b>						TOTAL ACRES:					<b>866.76</b>						

Additional remarks: The transfer involves the entirety of Certificate 93872; however, not all of the proposed changes are made uniformly. An APOD is proposed for a 368.93-acre portion of Certificate 93872. A change in POU, a change in POD, and an APOD are proposed for a 497.83-acre portion of Certificate 93872.

RECEIVED  
 JUL 28 2022  
 OWRD



**For Place of Use or Character of Use Changes**

Are there other water right certificates, water use permits or ground water registrations associated with the "from" or the "to" lands?  Yes  No

If YES, list the certificate, water use permit, or ground water registration numbers:

- 124.50 acres of the FROM lands are layered with Certificate 44654 (NESW, SESW, NESE, NWSE, SWSE, and SESE of Section 8, T2N, R28E). The 124.50 acres of FROM lands for Certificate 93872 are the TO lands for Certificate 92992. Certificate 93872 and Certificate 92992 authorize use of the same source and are of similar reliability. The water right holder proposes to leave the layered portion of Certificate 44654 in place and to diminish this layered portion to supplemental (Attachment E) with primary irrigation provided by this transfer (TO lands for Certificate 92992).



Pursuant to ORS 540.510, any "layered" water use such as an irrigation right that is supplemental to a primary right proposed for transfer must be included in the transfer or be cancelled. Any change to a ground water registration must be filed separately in a ground water registration modification application.

**For Substitution** (ground water supplemental irrigation will be substituted for surface water primary irrigation)

Ground water supplemental Permit or Certificate # N/A;  
Surface water primary Certificate # \_\_\_\_\_.

RECEIVED

JUL 28 2022

OWRD

**For a change from Supplemental Irrigation Use to Primary Irrigation Use**

Identify the primary certificate to be cancelled. Certificate # N/A

**For a change in point(s) of appropriation (well(s)) or additional point(s) of appropriation:** N/A

- Well log(s) are attached for each authorized and proposed well(s) that are clearly labeled and associated with the corresponding well(s) in Table 1 above and on the accompanying application map.

**Tip:** You may search for well logs on the Department's web page at:

[http://apps.wrd.state.or.us/apps/gw/well\\_log/Default.aspx](http://apps.wrd.state.or.us/apps/gw/well_log/Default.aspx)

**AND/OR**

- Describe the construction of the authorized and proposed well(s) in Table 3 for any wells that do not have a well log. For *proposed wells not yet constructed or built*, provide "a best estimate" for each requested information element in the table. The Department recommends you consult a licensed well driller, geologist, or certified water right examiner to assist with assembling the information necessary to complete Table 3.



**Table 3. Construction of Point(s) of Appropriation**

Any well(s) in this listing must be clearly tied to corresponding well(s) described in Table 1 and shown on the accompanying application map. Failure to provide the information will delay the processing of your transfer application until it is received. The information is necessary for the department to assess whether the proposed well(s) will access the same source aquifer as the authorized point(s) of appropriation (POA). The Department is prohibited by law from approving POA changes that do not access the same source aquifer.

Proposed or Authorized POA Name or Number	Is well already built? (Yes or No)	If an existing well: OWRD Well ID Tag No. L-__	Total well depth	Casing Diameter	Casing Intervals (feet)	Seal depth(s) (intervals)	Perforated or screened intervals (in feet)	Static water level of completed well (in feet)	Source aquifer (sand, gravel, basalt, etc.)	Well-specific rate (cfs or gpm). If less than full rate of water right

RECEIVED

JUL 28 2022

OWRD



## Part 5 of 5 – Water Right Information

Please use a separate Part 5 for each water right being changed. See instructions on page 6, to copy and paste additional Part 5s, or to add additional rows to tables within the form.

CERTIFICATE # 95662

RECEIVED

JUL 28 2022

OWRD

### Description of Water Delivery System

System capacity: \_\_\_\_\_ cubic feet per second (cfs) OR

CID System – 142,000 gallons per minute (gpm)

Describe the current water delivery system or the system that was in place at some time within the last five years. Include information on the pumps, canals, pipelines, and sprinklers used to divert, convey, and apply the water at the authorized place of use. Water is withdrawn at a pump station located on the Columbia River. The water is then transported through a series of pipelines and boosters into the CID canal. From the canal, water enters an underground pipeline and is pumped into the sprinkler system.

**Table 1. Location of Authorized and Proposed Point(s) of Diversion (POD) or Appropriation (POA)**

(Note: If the POD/POA name is not specified on the certificate, assign it a name or number here.)

POD/POA Name or Number	Is this POD/POA Authorized on the Certificate or is it Proposed?	If POA, OWRD Well Log ID# (or Well ID Tag # L-___)	Twp		Rng		Sec	¼ ¼		Tax Lot, DLC or Gov't Lot	Measured Distances (from a recognized survey corner)
<b>Columbia River Pump Station (CRPS)</b>	<input checked="" type="checkbox"/> Authorized <input type="checkbox"/> Proposed		4	N	25	E	2	NE	NW		<b>South 86 degrees 22 minutes 46 seconds West, 2829 feet from the NE Corner of Section 2</b>

Check all type(s) of change(s) proposed below (change "CODES" are provided in parentheses):

- |  |   |
|--|---|
| <input checked="" type="checkbox"/> Place of Use (POU)                 | <input type="checkbox"/> Supplemental Use to Primary Use (S to P) |
| <input type="checkbox"/> Character of Use (USE)                        | <input type="checkbox"/> Point of Appropriation/Well (POA)        |
| <input type="checkbox"/> Point of Diversion (POD)                      | <input type="checkbox"/> Additional Point of Appropriation (APOA) |
| <input type="checkbox"/> Additional Point of Diversion (APOD)          | <input type="checkbox"/> Substitution (SUB)                       |
| <input type="checkbox"/> Surface Water POD to Ground Water POA (SW/GW) | <input type="checkbox"/> Government Action POD (GOV)              |

Will all of the proposed changes affect the entire water right?

- Yes Complete only the Proposed ("to" or "on" lands) section of Table 2 on the next page. Use the "CODES" listed above to describe the proposed changes.
- No Complete all of Table 2 to describe the portion of the water right to be changed.



Please use and attach additional pages of Table 2 as needed.  
See page 6 for instructions.

Do you have questions about how to fill-out the tables?  
Contact the Department at 503-986-0900 and ask for Transfer Staff.

**Table 2. Description of Changes to Water Right Certificate # 95662**

List the change proposed for the acreage in each ¼ ¼. If more than one change is proposed, specify the acreage associated with each change.  
If there is more than one POD/POA involved in the proposed changes, specify the acreage associated with each POD/POA.

AUTHORIZED (the "from" or "off" lands) The listing that appears on the certificate BEFORE PROPOSED CHANGES List only that part or portion of the water right that will be changed.											Proposed Changes (see "CODES" from previous page)	PROPOSED (the "to" or "on" lands) The listing as it would appear AFTER PROPOSED CHANGES are made.														
Twp	Rng	Sec	¼	¼	Tax Lot	Gvt Lot or DLC	Acres	Type of USE listed on Certificate	POD(s) or POA(s) (name or number from Table 1)	Priority Date		Twp	Rng	Sec	¼	¼	Tax Lot	Gvt Lot or DLC	Acres	New Type of USE	POD(s)/ POA(s) to be used (from Table 1)	Priority Date				
4	N	26	E	26	NW	SW	3414		4.45	Irrigation	CRPS	6/29/1973	POU	4	N	26	E	19	NW	NW	3416	1	14.15	Irrigation	CRPS	6/29/1973
4	N	26	E	26	SE	SW	3414		0.26	Irrigation	CRPS	6/29/1973	POU	4	N	26	E	19	SW	NW	3416	2	16.43	Irrigation	CRPS	6/29/1973
4	N	26	E	26	SW	SW	3414		20.62	Irrigation	CRPS	6/29/1973	POU													
4	N	26	E	35	NW	NW	3414		5.25	Irrigation	CRPS	6/29/1973	POU													
									TOTAL ACRES:	30.58												TOTAL ACRES:	30.58			

Additional remarks: The lands described above are a portion of Certificate 95662. The remaining lands are not listed on the above table.

RECEIVED  
 JUL 28 2022  
 OMRD



**For Place of Use or Character of Use Changes**

Are there other water right certificates, water use permits or ground water registrations associated with the "from" or the "to" lands?  Yes  No

If YES, list the certificate, water use permit, or ground water registration numbers:

- Permit G-16151 is associated with the FROM land; however, this permit is for industrial use and is therefore not layered with Certificate 95662.

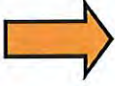

Pursuant to ORS 540.510, any "layered" water use such as an irrigation right that is supplemental to a primary right proposed for transfer must be included in the transfer or be cancelled. Any change to a ground water registration must be filed separately in a ground water registration modification application.

**For Substitution** (ground water supplemental irrigation will be substituted for surface water primary irrigation)

Ground water supplemental Permit or Certificate # N/A;  
Surface water primary Certificate # \_\_\_\_\_.

RECEIVED  
JUL 28 2022  
OWRD

**For a change from Supplemental Irrigation Use to Primary Irrigation Use**

Identify the primary certificate to be cancelled. Certificate # N/A

**For a change in point(s) of appropriation (well(s)) or additional point(s) of appropriation:** N/A

- Well log(s) are attached for each authorized and proposed well(s) that are clearly labeled and associated with the corresponding well(s) in Table 1 above and on the accompanying application map.

**Tip:** You may search for well logs on the Department's web page at:

[http://apps.wrd.state.or.us/apps/gw/well\\_log/Default.aspx](http://apps.wrd.state.or.us/apps/gw/well_log/Default.aspx)

**AND/OR**

- Describe the construction of the authorized and proposed well(s) in Table 3 for any wells that do not have a well log. For *proposed wells not yet constructed or built*, provide "a best estimate" for each requested information element in the table. The Department recommends you consult a licensed well driller, geologist, or certified water right examiner to assist with assembling the information necessary to complete Table 3.



**Table 3. Construction of Point(s) of Appropriation**

Any well(s) in this listing must be clearly tied to corresponding well(s) described in Table 1 and shown on the accompanying application map. Failure to provide the information will delay the processing of your transfer application until it is received. The information is necessary for the department to assess whether the proposed well(s) will access the same source aquifer as the authorized point(s) of appropriation (POA). The Department is prohibited by law from approving POA changes that do not access the same source aquifer.

Proposed or Authorized POA Name or Number	Is well already built? (Yes or No)	If an existing well: OWRD Well ID Tag No. L-___	Total well depth	Casing Diameter	Casing Intervals (feet)	Seal depth(s) (intervals)	Perforated or screened intervals (in feet)	Static water level of completed well (in feet)	Source aquifer (sand, gravel, basalt, etc.)	Well -specific rate (cfs or gpm). If less than full rate of water right

RECEIVED  
 JUL 28 2022  
 OWRD



RECEIVED

JUL 28 2022

OWRD

Attachment A  
Water Right Certificates 92990, 92992, 92993, 92994,  
93872, and 95662

Application for a Water Right Transfer – AgriNorthwest

---



STATE OF OREGON  
 COUNTY OF MORROW  
 CERTIFICATE OF WATER RIGHT

**RECEIVED**

**JUL 28 2022**

**OWRD**

THIS CERTIFICATE ISSUED TO

POTLATCH CORPORATION  
 PO BOX 38  
 BOARDMAN, OR 97818

confirms the right to use the waters of the COLUMBIA RIVER, a tributary of the PACIFIC OCEAN for IRRIGATION of 133.59 ACRES.

This right was perfected under Permit S-37150. The date of priority is JULY 25, 1973. The amount of water to which this right is entitled is limited to an amount actually used beneficially and shall not exceed 3.51 CUBIC FEET PER SECOND (CFS), PROVIDED THE TOTAL QUANTITY DIVERTED UNDER THE RIGHTS PERFECTED UNDER PERMIT 37150 DOES NOT EXCEED 140.1 CFS, or its equivalent in case of rotation, measured at the point of diversion.

The point of diversion is located as follows:

Twp	Rng	Mer	Sec	Q - Q	GLot	Measured Distances
4 N	25 E	WM	2	NE NW	7	SOUTH 86 DEGREES 22 MINUTES 46 SECONDS WEST, 2829 FEET FROM THE NE CORNER OF SECTION 2

The amount of water used for irrigation, together with the amount secured under any other right existing for the same lands, is limited to a diversion of ONE-FORTIETH of one cubic foot per second, or its equivalent for each acre irrigated, and shall be further limited to a diversion of not to exceed 4½ acre-foot per acre for each acre irrigated during the irrigation season of each year. The use shall conform to such reasonable rotation system as may be ordered by the proper state officer.

A description of the place of use to which this right is appurtenant is as follows:

Twp	Rng	Mer	Sec	Q - Q	Acres
3 N	27 E	WM	4	NE SW	6.05
3 N	27 E	WM	4	NW SW	5.88
3 N	27 E	WM	4	SW SW	5.89
3 N	27 E	WM	4	SE SW	7.16
3 N	27 E	WM	7	NE SE	0.18
3 N	27 E	WM	7	SE SE	0.27
3 N	27 E	WM	8	NE SW	8.23
3 N	27 E	WM	8	NW SW	5.45
3 N	27 E	WM	8	SW SW	5.84

**NOTICE OF RIGHT TO PETITION FOR RECONSIDERATION OR JUDICIAL REVIEW**

This is an order in other than a contested case. This order is subject to judicial review under ORS 183.482. Any petition for judicial review must be filed within the 60-day time period specified by ORS 183.482. Pursuant to ORS 183.482, ORS 536.075 and OAR 137-003-0675, you may petition for judicial review and petition the Director for reconsideration of this order. A petition for reconsideration may be granted or denied by the Director, and if no action is taken within 60 days following the date the petition was filed, the petition shall be deemed denied.



Twp	Rng	Mer	Sec	Q - Q	Acres
3 N	27 E	WM	8	SE SW	7.44
3 N	27 E	WM	8	NE SE	7.07
3 N	27 E	WM	8	NW SE	6.18
3 N	27 E	WM	8	SW SE	6.32
3 N	27 E	WM	8	SE SE	6.27
3 N	27 E	WM	9	NE NW	6.69
3 N	27 E	WM	9	NW NW	6.56
3 N	27 E	WM	9	SW NW	6.79
3 N	27 E	WM	9	SE NW	7.59
3 N	27 E	WM	9	NE SW	7.10
3 N	27 E	WM	9	NW SW	6.57
3 N	27 E	WM	9	SW SW	6.46
3 N	27 E	WM	9	SE SW	7.60
<b>TOTAL:</b>					<b>133.59</b>

The water user shall install and maintain headgates, in-line flow meters, weirs, or other suitable devices for controlling, measuring and recording the quantity of water diverted. In-line flow meters shall be installed at each canal pump station. The type and plans of the headgate and measuring devices must be approved by the Department prior to beginning construction and shall be installed under the general supervision of the Department.

The water user shall operate and maintain the headgates and measuring devices, as needed. The Watermaster may operate the headgates and monitor accuracy of the measuring devices, as needed.

The water user shall install and maintain a soil moisture monitoring program. The monitoring shall include neutron probe data (or other monitoring data of similar or superior accuracy) at 1, 2, 3, 4 and 5 foot depths, at weekly intervals, beginning one week prior to the irrigation season and continuing one week past the end of the irrigation season. The monitoring program and the location of the monitoring sites shall be approved by the Watermaster. Review of the monitoring program can occur at any time with a formal request from the water user or the Watermaster.

Monitoring shall include one paired data sampling site with access tubes between adjacent tree rows for every 1000 acres of each major soil type in each age class (each paired site shall consist of a pair of access tubes located within the non-irrigated strip between the tree rows and at the outer edges of that strip). Major soil types with less than 1000 acres in a given age class will have one paired site. Monitoring shall include one access tube for each soil type located outside the planted area to be used as control for each major soil type. Soil types are as identified in attached soil classification map dated 12/2/2000. This data will be supplemented with other ongoing monitoring data from tubes in the tree rows as normally required by the water user for accurate irrigation scheduling, and as reasonably approved by the Watermaster.

The water user shall supply, to the Watermaster, bi-annual reports of water use and monitoring data. The first report will cover the period through June of each year and the second report will cover the remainder of the growing season. Monitoring equipment, monitoring sites and monitoring data in a reasonable summary format as approved by the Watermaster shall be available to the Watermaster promptly upon request. The water user shall promptly inform the Watermaster of encroachment events into any areas without water rights, including the areas between tree rows and inform the Watermaster of the course of action to correct the problem.



If water use under the irrigation system delivers water to areas without water rights, including the area between the tree rows, the Watermaster may regulate the water use until soil moisture and flow data demonstrate that the areas without water rights are no longer receiving water.

This certificate is issued to correct a scrivener's error in the date of issuance of the Final Order approving T-12522 described on Certificate 92926. This Certificate supersedes Certificate 92926, and describes the portion of water right Certificate 76584, NOT modified by the provisions of an order of the Water Resources Director entered March 31, 2017, and recorded at Volume 104, Page 293, approving Transfer Application T-12522.

The issuance of this superseding certificate does not confirm the status of the water right in regard to the provisions of ORS 540.610 pertaining to forfeiture or abandonment.

The right to the use of the water for the above purpose is restricted to beneficial use on the lands or place of use described. The use confirmed herein may be made only at times when sufficient water is available to satisfy all prior rights, including prior rights for maintaining instream flows.

WITNESS the signature of the Water Resources Director, affixed APR 11 2017.

  
\_\_\_\_\_  
*Dwight French, Water Right Services Administrator, for*  
Thomas M. Byler, Director  
Oregon Water Resources Department

RECEIVED

JUL 28 2022

OWRD



STATE OF OREGON  
 COUNTY OF MORROW  
 CERTIFICATE OF WATER RIGHT

RECEIVED

JUL 28 2022

OWRD

THIS CERTIFICATE ISSUED TO

POTLATCH CORPORATION  
 PO BOX 38  
 BOARDMAN, OR 97818

confirms the right to use the waters of the COLUMBIA RIVER, a tributary of the PACIFIC OCEAN for IRRIGATION of 1425.07 ACRES.

This right was perfected under Permit S-37150. The date of priority is JULY 25, 1973. The amount of water to which this right is entitled is limited to an amount actually used beneficially, and shall not exceed 30.72 CUBIC FEET PER SECOND, PROVIDED THE TOTAL QUANTITY DIVERTED UNDER THE RIGHTS PERFECTED UNDER PERMIT 37150 DOES NOT EXCEED 140.1 CFS or its equivalent in case of rotation, measured at the point of diversion from the source.

The point of diversion is located as follows:

Twp	Rng	Mer	Sec	Q - Q	GLot	Measured Distances
4 N	25 E	WM	2	NE NW	7	SOUTH 86 DEGREES 22 MINUTES 46 SECONDS WEST, 2829 FEET FROM THE NE CORNER OF SECTION 2

The amount of water used for irrigation, together with the amount secured under any other right existing for the same lands, is limited to a diversion of ONE-FORTIETH of one cubic foot per second, or its equivalent for each acre irrigated, and shall be further limited to a diversion of not to exceed 4.5 acre-foot per acre for each acre irrigated during the irrigation season of each year. The use shall conform to such reasonable rotation system as may be ordered by the proper state officer.

A description of the place of use to which this right is appurtenant is as follows:

Twp	Rng	Mer	Sec	Q - Q	Acres
3 N	26 E	WM	1	NE NE	6.32
3 N	26 E	WM	1	NW NE	6.40
3 N	26 E	WM	1	SW NE	6.92
3 N	26 E	WM	1	SE NE	7.24
3 N	26 E	WM	1	NE NW	6.14
3 N	26 E	WM	1	NW NW	6.36
3 N	26 E	WM	1	SW NW	6.29
3 N	26 E	WM	1	SE NW	6.35
3 N	26 E	WM	1	NE SW	5.37

**NOTICE OF RIGHT TO PETITION FOR RECONSIDERATION OR JUDICIAL REVIEW**

This is an order in other than a contested case. This order is subject to judicial review under ORS 183.482. Any petition for judicial review must be filed within the 60-day time period specified by ORS 183.482. Pursuant to ORS 183.482, ORS 536.075 and OAR 137-003-0675, you may petition for judicial review and petition the Director for reconsideration of this order. A petition for reconsideration may be granted or denied by the Director, and if no action is taken within 60 days following the date the petition was filed, the petition shall be deemed denied.



Twp	Rng	Mer	Sec	Q - Q	Acres
3 N	26 E	WM	1	NW SW	9.47
3 N	26 E	WM	1	SW SW	8.36
3 N	26 E	WM	1	SE SW	4.93
3 N	26 E	WM	1	NE SE	6.58
3 N	26 E	WM	1	NW SE	9.91
3 N	26 E	WM	1	SW SE	10.24
3 N	26 E	WM	1	SE SE	6.61
3 N	26 E	WM	2	NE NE	5.54
3 N	26 E	WM	2	NW NE	7.43
3 N	26 E	WM	2	SW NE	7.59
3 N	26 E	WM	2	SE NE	5.64
3 N	26 E	WM	2	NE NW	6.15
3 N	26 E	WM	2	NW NW	6.22
3 N	26 E	WM	2	SW NW	6.45
3 N	26 E	WM	2	SE NW	6.19
3 N	26 E	WM	2	NE SW	6.51
3 N	26 E	WM	2	NW SW	7.08
3 N	26 E	WM	2	SW SW	7.01
3 N	26 E	WM	2	SE SW	5.88
3 N	26 E	WM	2	NE SE	7.30
3 N	26 E	WM	2	NW SE	9.05
3 N	26 E	WM	2	SW SE	8.25
3 N	26 E	WM	2	SE SE	5.92
3 N	26 E	WM	3	NE NE	4.05
3 N	26 E	WM	3	NW NE	7.15
3 N	26 E	WM	3	SW NE	7.65
3 N	26 E	WM	3	SE NE	6.21
3 N	26 E	WM	3	NE NW	8.06
3 N	26 E	WM	3	NW NW	7.72
3 N	26 E	WM	3	SW NW	6.71
3 N	26 E	WM	3	SE NW	6.66
3 N	26 E	WM	3	NE SW	6.90
3 N	26 E	WM	3	NW SW	6.57
3 N	26 E	WM	3	SW SW	6.92
3 N	26 E	WM	3	SE SW	6.68
3 N	26 E	WM	3	NE SE	5.44
3 N	26 E	WM	3	NW SE	6.45
3 N	26 E	WM	3	SW SE	8.07
3 N	26 E	WM	3	SE SE	6.42
3 N	26 E	WM	5	NE NE	7.98
3 N	26 E	WM	5	NW NE	6.45
3 N	26 E	WM	5	SW NE	5.44
3 N	26 E	WM	5	SE NE	6.59
3 N	26 E	WM	5	NE NW	7.57
3 N	26 E	WM	5	NW NW	4.80
3 N	26 E	WM	5	SW NW	5.00
3 N	26 E	WM	5	SE NW	8.53
3 N	26 E	WM	5	NE SW	6.88
3 N	26 E	WM	5	NW SW	6.12
3 N	26 E	WM	5	SW SW	5.85
3 N	26 E	WM	5	SE SW	7.26
3 N	26 E	WM	5	NE SE	6.88
3 N	26 E	WM	5	NW SE	7.32



Twp	Rng	Mer	Sec	Q - Q	Acres
3 N	26 E	WM	5	SW SE	7.43
3 N	26 E	WM	5	SE SE	7.22
3 N	26 E	WM	6	NE NE	6.53
3 N	26 E	WM	6	NW NE	6.14
3 N	26 E	WM	6	SW NE	5.89
3 N	26 E	WM	6	SE NE	6.94
3 N	26 E	WM	6	NE NW	12.15
3 N	26 E	WM	6	NW NW	6.54
3 N	26 E	WM	6	SW NW	5.98
3 N	26 E	WM	6	SE NW	11.95
3 N	26 E	WM	6	NE SW	11.59
3 N	26 E	WM	6	NW SW	7.07
3 N	26 E	WM	6	SW SW	6.20
3 N	26 E	WM	6	SE SW	11.24
3 N	26 E	WM	6	NE SE	7.66
3 N	26 E	WM	6	NW SE	5.04
3 N	26 E	WM	6	SW SE	4.55
3 N	26 E	WM	6	SE SE	7.49
3 N	26 E	WM	7	NE NE	9.49
3 N	26 E	WM	7	NW NE	3.57
3 N	26 E	WM	7	SW NE	3.95
3 N	26 E	WM	7	SE NE	10.22
3 N	26 E	WM	7	NE NW	10.93
3 N	26 E	WM	7	NW NW	6.45
3 N	26 E	WM	7	SW NW	5.79
3 N	26 E	WM	7	SE NW	10.45
3 N	26 E	WM	7	NE SW	11.48
3 N	26 E	WM	7	NW SW	6.67
3 N	26 E	WM	7	SW SW	4.90
3 N	26 E	WM	7	SE SW	10.57
3 N	26 E	WM	7	NE SE	9.28
3 N	26 E	WM	7	NW SE	4.00
3 N	26 E	WM	7	SW SE	3.17
3 N	26 E	WM	7	SE SE	8.13
3 N	26 E	WM	8	NE NE	6.84
3 N	26 E	WM	8	NW NE	5.60
3 N	26 E	WM	8	SW NE	3.24
3 N	26 E	WM	8	SE NE	9.04
3 N	26 E	WM	8	NE SE	7.15
3 N	26 E	WM	8	NW SE	2.32
3 N	26 E	WM	8	SW SE	4.79
3 N	26 E	WM	8	SE SE	0.08
3 N	26 E	WM	9	NE NE	6.69
3 N	26 E	WM	9	NW NE	6.11
3 N	26 E	WM	9	SW NE	6.01
3 N	26 E	WM	9	SE NE	6.96
3 N	26 E	WM	9	NE NW	7.94
3 N	26 E	WM	9	NW NW	6.25
3 N	26 E	WM	9	SW NW	4.88
3 N	26 E	WM	9	SE NW	7.22
3 N	26 E	WM	9	NE SW	9.29
3 N	26 E	WM	9	NW SW	5.66
3 N	26 E	WM	9	SW SW	0.01

RECEIVED

JUL 28 2022

OWRD



Twp	Rng	Mer	Sec	Q - Q	Acres
3 N	26 E	WM	9	SE SW	2.98
3 N	26 E	WM	9	NE SE	7.40
3 N	26 E	WM	9	NW SE	5.80
3 N	26 E	WM	9	SW SE	2.10
3 N	26 E	WM	9	SE SE	3.55
3 N	26 E	WM	11	NE NE	7.15
3 N	26 E	WM	11	NW NE	6.99
3 N	26 E	WM	11	SW NE	7.90
3 N	26 E	WM	11	SE NE	7.12
3 N	26 E	WM	11	NE NW	7.39
3 N	26 E	WM	11	NW NW	7.16
3 N	26 E	WM	11	SW NW	6.88
3 N	26 E	WM	11	SE NW	5.97
3 N	26 E	WM	11	NE SW	7.33
3 N	26 E	WM	11	NW SW	4.14
3 N	26 E	WM	11	SW SW	6.02
3 N	26 E	WM	11	SE SW	6.08
3 N	26 E	WM	11	NE SE	6.18
3 N	26 E	WM	11	NW SE	7.01
3 N	26 E	WM	11	SW SE	7.76
3 N	26 E	WM	11	SE SE	5.71
3 N	26 E	WM	12	NE NE	5.69
3 N	26 E	WM	12	NW NE	9.18
3 N	26 E	WM	12	SW NE	9.09
3 N	26 E	WM	12	SE NE	6.42
3 N	26 E	WM	12	NE NW	6.36
3 N	26 E	WM	12	NW NW	5.79
3 N	26 E	WM	12	SW NW	7.74
3 N	26 E	WM	12	SE NW	6.29
3 N	26 E	WM	12	NE SW	6.45
3 N	26 E	WM	12	NW SW	6.98
3 N	26 E	WM	12	SW SW	6.97
3 N	26 E	WM	12	SE SW	7.54
3 N	26 E	WM	12	NE SE	5.52
3 N	26 E	WM	12	NW SE	8.28
3 N	26 E	WM	12	SW SE	7.86
3 N	26 E	WM	12	SE SE	5.10
3 N	26 E	WM	13	NE NE	6.99
3 N	26 E	WM	13	NW NE	6.05
3 N	26 E	WM	13	SW NE	6.87
3 N	26 E	WM	13	SE NE	0.06
3 N	26 E	WM	13	NE NW	5.95
3 N	26 E	WM	13	NW NW	5.49
3 N	26 E	WM	13	SW NW	1.18
3 N	26 E	WM	13	SE NW	7.58
3 N	26 E	WM	13	NE SW	7.36
3 N	26 E	WM	13	NW SW	1.74
3 N	26 E	WM	13	SW SW	6.45
3 N	26 E	WM	13	SE SW	7.73
3 N	26 E	WM	13	NE SE	7.30
3 N	26 E	WM	13	NW SE	6.46
3 N	26 E	WM	13	SW SE	6.70
3 N	26 E	WM	13	SE SE	7.68



RECEIVED

JUL 28 2022

OWSD

Twp	Rng	Mer	Sec	Q - Q	Acres
3 N	27 E	WM	5	NE SW	7.38
3 N	27 E	WM	5	NW SW	5.92
3 N	27 E	WM	5	SW SW	6.60
3 N	27 E	WM	5	SE SW	7.71
3 N	27 E	WM	5	NE SE	1.79
3 N	27 E	WM	5	NW SE	7.72
3 N	27 E	WM	5	SW SE	5.99
3 N	27 E	WM	5	SE SE	6.71
3 N	27 E	WM	6	NE NE	3.89
3 N	27 E	WM	6	NW NE	3.66
3 N	27 E	WM	6	SW NE	5.14
3 N	27 E	WM	6	SE NE	7.47
3 N	27 E	WM	6	NE NW	11.53
3 N	27 E	WM	6	NW NW	4.88
3 N	27 E	WM	6	SW NW	5.94
3 N	27 E	WM	6	SE NW	11.75
3 N	27 E	WM	6	NE SW	8.87
3 N	27 E	WM	6	NW SW	9.86
3 N	27 E	WM	6	SW SW	10.11
3 N	27 E	WM	6	SE SW	8.11
3 N	27 E	WM	6	NE SE	7.73
3 N	27 E	WM	6	NW SE	6.03
3 N	27 E	WM	6	SW SE	4.28
3 N	27 E	WM	6	SE SE	7.09
3 N	27 E	WM	7	NE NE	6.25
3 N	27 E	WM	7	NW NE	5.67
3 N	27 E	WM	7	SW NE	6.71
3 N	27 E	WM	7	SE NE	8.28
3 N	27 E	WM	7	NE NW	11.20
3 N	27 E	WM	7	NW NW	8.59
3 N	27 E	WM	7	SW NW	10.46
3 N	27 E	WM	7	SE NW	11.63
3 N	27 E	WM	7	NE SW	11.88
3 N	27 E	WM	7	NW SW	8.72
3 N	27 E	WM	7	SW SW	4.01
3 N	27 E	WM	7	SE SW	11.05
3 N	27 E	WM	7	NE SE	9.06
3 N	27 E	WM	7	NW SE	4.65
3 N	27 E	WM	7	SW SE	3.94
3 N	27 E	WM	7	SE SE	7.67
3 N	27 E	WM	9	NE SE	0.42
3 N	27 E	WM	9	NW SE	0.15
3 N	27 E	WM	9	SW SE	5.98
3 N	27 E	WM	9	SE SE	6.13
4 N	26 E	WM	34	SW SE	0.22
<b>TOTAL:</b>					<b>1425.07</b>



The water user shall install and maintain headgates, in-line flow meters, weirs, or other suitable devices for controlling, measuring and recording the quantity of water diverted. In-line flow meters shall be installed at each canal pump station. The type and plans of the headgate and measuring devices must be approved by the Department prior to beginning construction and shall be installed under the general supervision of the Department.

The water user shall operate and maintain the headgates and measuring devices, as needed. The Watermaster may operate the headgates and monitor accuracy of the measuring devices, as needed.

The water user shall install and maintain a soil moisture monitoring program. The monitoring shall include neutron probe data (or other monitoring data of similar or superior accuracy) at 1, 2, 3, 4 and 5 foot depths, at weekly intervals, beginning one week prior to the irrigation season and continuing one week past the end of the irrigation season. The monitoring program and the location of the monitoring sites shall be approved by the Watermaster. Review of the monitoring program can occur at any time with a formal request from the water user or the Watermaster.

Monitoring shall include one paired data sampling site with access tubes between adjacent tree rows for every 1000 acres of each major soil type in each age class (each paired site shall consist of a pair of access tubes located within the non-irrigated strip between the tree rows and at the outer edges of that strip). Major soil types with less than 1000 acres in a given age class will have one paired site. Monitoring shall include one access tube for each soil type located outside the planted area to be used as control for each major soil type. Soil types are as identified in attached soil classification map dated 12/2/2000. This data will be supplemented with other ongoing monitoring data from tubes in the tree rows as normally required by the water user for accurate irrigation scheduling, and as reasonably approved by the Watermaster.

The water user shall supply, to the Watermaster, bi-annual reports of water use and monitoring data. The first report will cover the period through June of each year and the second report will cover the remainder of the growing season. Monitoring equipment, monitoring sites and monitoring data in a reasonable summary format as approved by the Watermaster shall be available to the Watermaster promptly upon request. The water user shall promptly inform the Watermaster of encroachment events into any areas without water rights, including the areas between tree rows and inform the Watermaster of the course of action to correct the problem.

If water use under the irrigation system delivers water to areas without water rights, including the area between the tree rows, the Watermaster may regulate the water use until soil moisture and flow data demonstrate that the areas without water rights are no longer receiving water.

This certificate is issued to correct a scrivener's error in the date of issuance of the Final Order approving T-12522 described on Certificate 92928. This Certificate supersedes Certificate 92928, and describes the portion of water right Certificate 76586, NOT modified by the provisions of an order of the Water Resources Director entered March 31, 2017, and recorded at Volume 104, Page 293, approving Transfer Application T-12522.



The issuance of this superseding certificate does not confirm the status of the water right in regard to the provisions of ORS 540.610 pertaining to forfeiture or abandonment.

The right to the use of the water for the above purpose is restricted to beneficial use on the lands or place of use described.

WITNESS the signature of the Water Resources Director, affixed APR 11 2017.

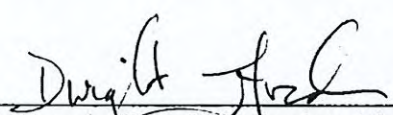

Dwight French, Water Right Services Administrator, for  
Thomas M. Byle, Director  
Oregon Water Resources Department

RECEIVED

JUL 28 2022

OWRD



STATE OF OREGON  
 COUNTY OF MORROW  
 CERTIFICATE OF WATER RIGHT

RECEIVED

JUL 28 2022

OWRD

THIS CERTIFICATE ISSUED TO

POTLATCH CORPORATION  
 PO BOX 38  
 BOARDMAN, OREGON 97818

confirms the right to use the waters of the COLUMBIA RIVER, a tributary of the PACIFIC OCEAN for IRRIGATION of 39.71 ACRES.

This right was perfected under Permit S-37150. The date of priority is JULY 25, 1973. The amount of water to which this right is entitled is limited to an amount actually used beneficially, and shall not exceed 0.99 CUBIC FOOT PER SECOND (CFS), provided the total quantity diverted under the rights perfected under permit 37150 does not exceed 140.1 CFS, if available at the original point of diversion; LOT 7 (NE¼ NW), Section 2, T 2 N, R 25 E, WM; 150 SOUTH AND 2990 FEET WEST FROM THE NE CORNER, SECTION 2, or its equivalent in case of rotation, measured at the point of diversion.

The point of diversion is located as follows:

Twp	Rng	Mer	Sec	Q - Q	GLot	Measured Distances
4 N	25 E	WM	2	NE NW	7	SOUTH 86 DEGREES 22 MINUTES 46 SECONDS WEST, 2829 FEET FROM NE CORNER OF SECTION 2

The amount of water used for irrigation, together with the amount secured under any other right existing for the same lands, is limited to a diversion of ONE-FORTIETH of one cubic foot per second, or its equivalent for each acre irrigated, and shall be further limited to a diversion of not to exceed 4.5 acre-feet per acre for each acre irrigated during the irrigation season of each year. The use shall conform to such reasonable rotation system as may be ordered by the proper state officer.

A description of the place of use to which this right is appurtenant is as follows:

Twp	Rng	Mer	Sec	Q - Q	Acres
3 N	26 E	WM	2	NW NE	0.05
3 N	26 E	WM	2	SW NE	0.05
3 N	26 E	WM	2	NE NW	1.54
3 N	26 E	WM	2	NW NW	1.58
3 N	26 E	WM	2	SW NW	1.64
3 N	26 E	WM	2	SE NW	1.53
3 N	26 E	WM	2	NE SW	1.61

**NOTICE OF RIGHT TO PETITION FOR RECONSIDERATION OR JUDICIAL REVIEW**

This is an order in other than a contested case. This order is subject to judicial review under ORS 183.482. Any petition for judicial review must be filed within the 60-day time period specified by ORS 183.482. Pursuant to ORS 183.482, ORS 536.075 and OAR 137-003-0675, you may petition for judicial review and petition the Director for reconsideration of this order. A petition for reconsideration may be granted or denied by the Director, and if no action is taken within 60 days following the date the petition was filed, the petition shall be deemed denied.



Twp	Rng	Mer	Sec	Q - Q	Acres
3 N	26 E	WM	2	NW SW	1.80
3 N	26 E	WM	2	SW SW	1.67
3 N	26 E	WM	2	SE SW	1.34
3 N	26 E	WM	2	NW SE	0.25
3 N	26 E	WM	2	SW SE	0.24
3 N	26 E	WM	3	NE NE	0.99
3 N	26 E	WM	3	NW NE	1.77
3 N	26 E	WM	3	SW NE	1.91
3 N	26 E	WM	3	SE NE	1.53
3 N	26 E	WM	3	NE NW	2.04
3 N	26 E	WM	3	NW NW	1.96
3 N	26 E	WM	3	SW NW	1.71
3 N	26 E	WM	3	SE NW	1.67
3 N	26 E	WM	3	NE SW	1.46
3 N	26 E	WM	3	NW SW	1.67
3 N	26 E	WM	3	SW SW	1.76
3 N	26 E	WM	3	SE SW	1.42
3 N	26 E	WM	3	NE SE	0.06
3 N	26 E	WM	3	NW SE	0.10
3 N	26 E	WM	11	NE SW	1.84
3 N	26 E	WM	11	NW SW	1.05
3 N	26 E	WM	11	SW SW	1.53
3 N	26 E	WM	11	SE SW	1.54
3 N	26 E	WM	13	SW NE	0.39
3 N	26 E	WM	13	SE NE	0.01
<b>TOTAL:</b>					<b>39.71</b>

The location of the place of use is in the irrigation of 2 foot wide strips, in between the 8 foot wide strip/tree rows, which are currently being irrigated.

The water user shall install and maintain headgates, in-line flow meters, weirs, or other suitable devices for controlling, measuring and recording the quantity of water diverted. In-line flow meters shall be installed at each canal pump station. The type and plans of the headgate and measuring devices must be approved by the Department prior to beginning construction and shall be installed under the general supervision of the Department.

The water user shall install and maintain a soil moisture monitoring program. The monitoring shall include the Gro-Point Sensor data (or other monitoring data of similar or superior accuracy) at 1, 3 and 5 foot depths, at weekly intervals, beginning one week prior to the irrigation season and continuing one week past the end of the irrigation season. The monitoring program and the location of the monitoring sites shall be approved by the Watermaster. Review of the monitoring program can occur at any time with a formal request from the water user or the Watermaster. Modification to the monitoring program could occur if approved by the Watermaster.

Monitoring shall include one paired data sampling site with access tubes between adjacent tree rows for every 1000 acres of each major soil type in each age class. Each paired site shall consist of a pair of access tubes located on the outer edge of the irrigated strip between the tree rows such that the outer edge of the sphere of influence is at the edge of the dry zone. (In this description, outer means area farthest away from the tree). Major soil types with less than 1000 acres in a given age class will have one paired site. Monitoring shall include one access tube for each soil type located outside the planted



area to be used as control for each major soil type. Soil types are as identified in attached soil classification map dated 12/2/2000. This data will be supplemented with other ongoing monitoring data from tubes in the tree rows as normally required by Potlatch for accurate irrigation scheduling, and as reasonably approved by the Watermaster.

Monitoring sites, monitoring data and flow data, including access to real time data on an internal web site, shall be available to the Watermaster promptly upon request.

The water user shall supply, to the Watermaster, bi-annual reports of water use and monitoring data. The first report will cover the period through June of each year and the second report will cover the remainder of the growing season. Monitoring equipment, monitoring sites and monitoring data in a reasonable summary format as approved by the Watermaster shall be available to the Watermaster promptly upon request. The water user shall promptly inform the Watermaster of encroachment events into any areas without water rights, including the areas between tree rows and inform the Watermaster of the course of action to correct the problem.

If water use under the irrigation system delivers water to areas without water rights, including the area between the tree rows, the Watermaster may regulate the water use until soil moisture and flow data demonstrate that the areas without water rights are no longer receiving water.

This certificate is issued to correct a scrivener's error in the date of issuance of the Final Order approving T-12522 described on Certificate 92929. This Certificate supersedes Certificate 92929, and describes the portion of water right Certificate 83588, NOT modified by the provisions of an order of the Water Resources Director entered March 31, 2017, and recorded at Volume 104, Page 293, approving Transfer Application T-12522.

The issuance of this superseding certificate does not confirm the status of the water right in regard to the provisions of ORS 540.610 pertaining to forfeiture or abandonment.

The right to the use of the water for the above purpose is restricted to beneficial use on the lands or place of use described.

WITNESS the signature of the Water Resources Director, affixed

APR 11 2017

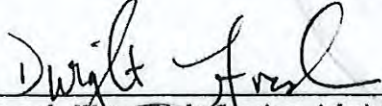
  
Dwight French, Water Right Services Administrator, for  
Thomas M. Byler, Director  
Oregon Water Resources Department

RECEIVED

JUL 28 2022

OWRD



STATE OF OREGON  
 COUNTY OF MORROW  
 CERTIFICATE OF WATER RIGHT

RECEIVED

JUL 28 2022

OWRD

THIS CERTIFICATE ISSUED TO

POTLATCH CORP.  
 PO BOX 38  
 BOARDMAN, OR 97818

confirms the right to use the waters of the COLUMBIA RIVER, a tributary of the PACIFIC OCEAN for IRRIGATION of 234.89 ACRES.

This right was perfected under Permit S-36940. The date of priority is JUNE 29, 1973. The amount of water to which this right is entitled is limited to an amount actually used beneficially, and shall not exceed 5.81 CUBIC FEET PER SECOND, or its equivalent in case of rotation, measured at the point of diversion.

The point of diversion is located as follows:

Twp	Rng	Mer	Sec	Q - Q	GLot	Measured Distances
4 N	25 E	WM	2	NE NW	7	SOUTH 86 DEGREES 22 MINUTES 46 SECONDS WEST, 2829 FEET FROM THE NE CORNER OF SECTION 2

The amount of water used for irrigation, together with the amount secured under any other right existing for the same lands, is limited to a diversion of ONE-FORTIETH of one cubic foot per second, or its equivalent for each acre irrigated, and shall be further limited to a diversion of not to exceed 4.5 acre-feet per acre for each acre irrigated during the irrigation season of each year. The use shall conform to such reasonable rotation system as may be ordered by the proper state officer.

A description of the place of use to which this right is appurtenant is as follows:

Twp	Rng	Mer	Sec	Q - Q	Acres
4 N	26 E	WM	16	NE NE	30.99
4 N	26 E	WM	16	NW NE	38.98
4 N	26 E	WM	16	SW NE	14.21
4 N	26 E	WM	16	SE NE	2.41
4 N	26 E	WM	16	NE NW	36.63
4 N	26 E	WM	16	NW NW	26.31
4 N	26 E	WM	16	SE NW	2.20
4 N	26 E	WM	17	NE NE	25.28
4 N	26 E	WM	17	NW NE	5.91

**NOTICE OF RIGHT TO PETITION FOR RECONSIDERATION OR JUDICIAL REVIEW**

This is an order in other than a contested case. This order is subject to judicial review under ORS 183.482. Any petition for judicial review must be filed within the 60-day time period specified by ORS 183.482. Pursuant to ORS 183.482, ORS 536.075 and OAR 137-003-0675, you may petition for judicial review and petition the Director for reconsideration of this order. A petition for reconsideration may be granted or denied by the Director, and if no action is taken within 60 days following the date the petition was filed, the petition shall be deemed denied.



4 N	26 E	WM	17	SW NE	33.49
4 N	26 E	WM	17	SE NE	17.06
4 N	26 E	WM	17	SE NW	1.42
<b>TOTAL:</b>					<b>234.89</b>

The water user shall install and maintain headgates, in-line flow meters, weirs, or other suitable devices for controlling, measuring and recording the quantity of water diverted. In-line flow meters shall be installed at the Cherokee Strip pump site, Booster Pump station #1, and each field control manifold. The type of plans of the headgates and measuring devices must be approved by the Department prior to beginning construction and shall be installed under the general supervision of the Department.

The water user shall operate and maintain the headgates and measuring devices, as needed. The Watermaster may operate the headgates and monitor accuracy of the measuring devices, as needed.

The water user shall install and maintain a soil moisture monitoring program. The monitoring shall include Troxler Sentry capacitance probe data (or other monitoring data of similar or superior accuracy) at 1, 2, 3, 4 and 5 foot depths, at weekly intervals, beginning one week prior to the irrigation season and continuing one week past the end of the irrigation season. The monitoring program and the location of the monitoring sites shall be approved by the Watermaster. Review of the monitoring program can occur at any time with a formal request from the water user or the Watermaster.

Monitoring shall include one paired data sampling site with access tubes between adjacent tree rows for every 1000 acres of each major soil type in each age class (each paired site shall consist of a pair of access tubes located within the non-irrigated strip between the tree rows and at the outer edges of that strip). Major soil types with less than 1000 acres in a given age class will have one paired site. Monitoring shall include one access tube for each soil type located outside the planted area to be used as control for each major soil type. Soil types are as identified in attached soil classification map dated 12/2/2000. This data will be supplemented with other ongoing monitoring data from tubes in the tree rows as normally required by the water user for accurate irrigation scheduling, and as reasonably approved by the Watermaster.

Monitoring sites, and monitoring data and flow data shall be available to the Watermaster promptly upon request.

The water user shall supply, to the Watermaster, bi-annual reports of water use and monitoring data. The first report will cover the period through June of each year and the second report will cover the remainder of the growing season. Monitoring data report shall be provided in a reasonable summary format as approved by the Watermaster. The water user shall promptly inform the Watermaster of encroachment events into any areas without water rights, including the areas between tree rows and inform the Watermaster of the course of action to correct the problem.

If water use under the irrigation system delivers water to areas without water rights, including the area between the tree rows, the Watermaster may regulate the water use until soil moisture and flow data demonstrate that the areas without water rights are no longer receiving water.



This certificate is issued to correct a scrivener's error in the date of issuance of the Final Order approving T-12522 described on Certificate 92930. This Certificate supersedes Certificate 92930, and describes the portion of water right Certificate 89511, NOT modified by the provisions of an order of the Water Resources Director entered March 31, 2017, and recorded at Volume 104, Page 293, approving Transfer Application T-12522.

The issuance of this superseding certificate does not confirm the status of the water right in regard to the provisions of ORS 540.610 pertaining to forfeiture or abandonment.

The right to the use of the water for the above purpose is restricted to beneficial use on the lands or place of use described.

WITNESS the signature of the Water Resources Director, affixed APR 11 2017.

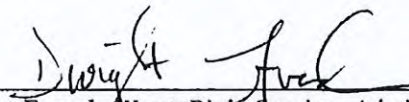
  
\_\_\_\_\_  
Dwight French, ~~Water Right Services Administrator~~, for  
Thomas M. Byler, Director  
Oregon Water Resources Department

RECEIVED

JUL 28 2022

OWRD



STATE OF OREGON  
COUNTIES OF UMATILLA AND MORROW

CERTIFICATE OF WATER RIGHT

RECEIVED

JUL 28 2022

OWSD

THIS CERTIFICATE ISSUED TO

FARMLAND RESERVE INC.  
C/O AGRINORTHWEST  
6716 W RIO GRANDE  
KENNEWICK WA 99336

confirms the right to the use of water perfected under the terms of Permit S-36940. The amount of water used to which this right is entitled is limited to the amount used beneficially, and shall not exceed the amount specified, or its equivalent in the case of rotation, measured at the point(s) of diversion from the source. The specific limits and conditions of the use are listed below.

SOURCE OF WATER: COLUMBIA RIVER, A TRIBUTARY OF PACIFIC OCEAN

PURPOSE OR USE: IRRIGATION OF 866.76 ACRES, BEING 5.25 CFS FROM POD 1 FOR IRRIGATION OF 497.83 ACRES AND 3.89 CFS FROM POD 2 FOR IRRIGATION OF 368.93 ACRES

MAXIMUM RATE: 9.14 CUBIC FEET PER SECOND (CFS), BEING 5.25 CFS FROM POD 1 AND 3.89 CFS FROM POD 2

PERIOD OF USE: MARCH 1 THROUGH OCTOBER 31

DATE OF PRIORITY: JUNE 29, 1973

The points of diversion are located as follows:

Twp	Rng	Mer	Sec	Q-Q	GLot	Measured Distances
4 N	25 E	WM	2	NE NW	7	POD 1 (ORIGINAL) - SOUTH 86 DEGREES 22 MINUTES 46 SECONDS WEST, 2829 FEET FROM NE CORNER, SECTION 2
5 N	30 E	WM	8	SW NW		POD 2 (NEW) - 2910 FEET NORTH AND 120 FEET EAST FROM SW CORNER, SECTION 8

The amount of water used for irrigation is limited to 1/95 of one cubic foot per second per acre, or its equivalent for each acre irrigated, and shall be further limited to a diversion of not to exceed 1.53 acre-feet per acre for each acre irrigated during the irrigation season of each year, and limited to an annual volume of 1325.07 acre-feet, being 761.06 acre feet from POD 1 and 564.01 acre feet from POD 2.

The use shall conform to such reasonable rotation system as may be ordered by the proper state officer.

**NOTICE OF RIGHT TO PETITION FOR RECONSIDERATION OR JUDICIAL REVIEW**

This is an order in other than a contested case. This order is subject to judicial review under ORS 183.482. Any petition for judicial review must be filed within the 60-day time period specified by ORS 183.482. Pursuant to ORS 183.482, ORS 536.075 and OAR 137-003-0675, you may petition for judicial review and petition the Director for reconsideration of this order. A petition for reconsideration may be granted or denied by the Director, and if no action is taken within 60 days following the date the petition was filed, the petition shall be deemed denied.



A description of the place of use is as follows:

IRRIGATION FROM POD 1							
Twp	Rng	Mer	Sec	Q-Q	GLot	Tax Lot	Acres
2 N	28 E	WM	5	NE NE	1	900	31.39
2 N	28 E	WM	5	NW NE	2	900	30.43
2 N	28 E	WM	5	SW NE		900	31.35
2 N	28 E	WM	5	SE NE		900	30.43
2 N	28 E	WM	5	NE SW		900	31.75
2 N	28 E	WM	5	NW SW		900	30.77
2 N	28 E	WM	5	SW SW		900	31.71
2 N	28 E	WM	5	SE SW		900	30.77
2 N	28 E	WM	5	NE SE		900	31.38
2 N	28 E	WM	5	NW SE		900	30.44
2 N	28 E	WM	5	SW SE		900	31.34
2 N	28 E	WM	5	SE SE		900	30.44
2 N	28 E	WM	8	SW NE		1600	1.13
2 N	28 E	WM	8	NE SW		1700	14.33
2 N	28 E	WM	8	SE SW		1700	12.07
2 N	28 E	WM	8	NE SE		1700	12.74
2 N	28 E	WM	8	NW SE		1700	39.83
2 N	28 E	WM	8	SW SE		1700	35.70
2 N	28 E	WM	8	SE SE		1700	9.83

IRRIGATION FROM POD 2						
Twp	Rng	Mer	Sec	Q-Q	Tax Lot	Acres
3 N	29E	WM	3	NE NE	400	30.73
3 N	29E	WM	3	NW NE	400	34.24
3 N	29E	WM	3	SW NE	400	32.16
3 N	29E	WM	3	SE NE	400	28.26
3 N	29E	WM	3	NE NW	400	0.37
3 N	29E	WM	3	SE NW	400	0.30
3 N	29E	WM	3	NE SW	400	29.31
3 N	29E	WM	3	NW SW	400	29.91
3 N	29E	WM	3	SW SW	400	30.28
3 N	29E	WM	3	SE SW	400	28.43
3 N	29E	WM	3	NE SE	400	30.00
3 N	29E	WM	3	NW SE	400	32.88
3 N	29E	WM	3	SW SE	400	32.90
3 N	29E	WM	3	SE SE	400	29.16

Measurement, recording and reporting conditions:

- A. The water user shall maintain the totalizing flow meter or other suitable measuring device as approved by the Director in good working order at each point of diversion (new and existing).
- B. The water user shall allow the watermaster access to the meter or measuring device; provided however, where the meter or measuring device is located within a private structure, the watermaster shall request access upon reasonable notice.



To prevent expansion of the original right (Certificate 79482), Farmland Reserve, Inc., shall install such measuring devices deemed appropriate by the District #5 Watermaster.

The quantity of water diverted at the new point of diversion (POD 2), together with that diverted at the original point of diversion (POD 1), shall not exceed the quantity of water lawfully available at the original point of diversion.

The right to the use of the water for the above purpose is restricted to beneficial use on the place of use described.

This certificate is issued to confirm an ALLOCATION OF CONSERVED WATER approved by an order of the Water Resources Director entered MAY 27, 2014, and recorded at Special Order Volume 92, Page 615, approving Conserved Water Application CW-84, and the disposition of the conserved water entered September 5, 2017, and recorded in Special Order Volume 105, Page 716. This certificate together with Certificates 89303, 89304, and 89305, supersede Certificate 79482, State Record of Water Right Certificates:

Issued JUL 10 2018

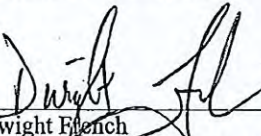
  
Dwight French  
Water Right Services Division Administrator, for  
Thomas M. Byler, Director  
Oregon Water Resources Department

RECEIVED  
JUL 28 2022  
OWRD





STATE OF OREGON

RECEIVED

COUNTY OF MORROW

JUL 28 2022

CERTIFICATE OF WATER RIGHT

OWRD

THIS CERTIFICATE ISSUED TO

FARMLAND RESERVE INC.  
C/O AGRINORTHWEST  
PO BOX 2308  
PASCO, WA 99302

confirms the right to use the waters of the COLUMBIA RIVER, a tributary of the PACIFIC OCEAN for IRRIGATION of 7472.54 ACRES.

This right was perfected under Permit S-36940. The date of priority is JUNE 29, 1973. The amount of water to which this right is entitled is limited to an amount actually used beneficially and shall not exceed 124.79 CUBIC FEET PER SECOND, if available at the original point of diversion: Lot 7 (NE NW, Section 2, T 4 N, R 25 E. W.M.; South 86 Degrees 22 Minutes 46 Seconds West, 2811 Feet from the NE Corner of Section 2) or its equivalent in case of rotation, measured at the point of diversion.

The points of diversion are located as follows:

Twp	Rng	Mer	Sec	Q-Q	GLot	Measured Distances
4 N	25 E	WM	2	NE NW	7	COLUMBIA RIVER PUMP STATION: SOUTH 86 DEGREES 22 MINUTES 46 SECONDS WEST, 2829 FEET FROM NE CORNER, SECTION 2

The amount of water used for irrigation, together with the amount secured under any other right existing for the same lands, is limited to a diversion of ONE-SIXTIETH (1/60) of one cubic foot per second, or its equivalent for each acre irrigated, and shall be further limited to a diversion of not to exceed 3.5 acre-feet per acre for each acre irrigated during the irrigation season of each year and an annual volume limitation of 26,153.69 acre feet. The use shall conform to such reasonable rotation system as may be ordered by the proper state officer.

A description of the place of use to which this right is appurtenant is as follows:

Twp	Rng	Mer	Sec	Q-Q	GLot	Acres
3 N	26 E	WM	5	NE NE	2	30.71
3 N	26 E	WM	5	NW NE	2	32.42

**NOTICE OF RIGHT TO PETITION FOR RECONSIDERATION OR JUDICIAL REVIEW**

This is an order in other than a contested case. This order is subject to judicial review under ORS 183.482. Any petition for judicial review must be filed within the 60-day time period specified by ORS 183.482. Pursuant to ORS 183.482, ORS 536.075 and OAR 137-003-0675, you may petition for judicial review and petition the Director for reconsideration of this order. A petition for reconsideration may be granted or denied by the Director, and if no action is taken within 60 days following the date the petition was filed, the petition shall be deemed denied.



Twp	Rng	Mer	Sec	Q-Q	GLot	Acres
3 N	26 E	WM	5	SW NE	1	31.18
3 N	26 E	WM	5	SE NE	1	29.86
3 N	26 E	WM	5	NE NW	2	31.08
3 N	26 E	WM	5	NW NW	2	33.35
3 N	26 E	WM	5	SW NW	1	32.43
3 N	26 E	WM	5	SE NW	1	30.06
3 N	26 E	WM	6	NE NE	2	29.74
3 N	26 E	WM	6	NW NE	2	32.63
3 N	26 E	WM	6	SW NE	1	31.99
3 N	26 E	WM	6	SE NE	1	28.50
3 N	26 E	WM	6	NE NW	2	29.18
3 N	26 E	WM	6	NW NW	2	32.48
3 N	26 E	WM	6	SW NW	1	33.04
3 N	26 E	WM	6	SE NW	1	28.48
3 N	26 E	WM	6	NE SW	1	28.77
3 N	26 E	WM	6	NW SW	2	32.41
3 N	26 E	WM	6	SW SW	2	33.00
3 N	26 E	WM	6	SE SW	1	28.64
3 N	26 E	WM	6	NE SE		29.63
3 N	26 E	WM	6	NW SE		31.73
3 N	26 E	WM	6	SW SE		31.79
3 N	26 E	WM	6	SE SE		29.09
3 N	26 E	WM	7	NE NE		23.83
3 N	26 E	WM	7	NW NE		35.24
3 N	26 E	WM	7	SW NE		35.17
3 N	26 E	WM	7	SE NE		23.29
3 N	26 E	WM	7	NE NW	1	25.96
3 N	26 E	WM	7	NW NW	2	38.30
3 N	26 E	WM	7	SW NW	2	38.87
3 N	26 E	WM	7	SE NW	1	26.26
3 N	26 E	WM	7	NE SW	1	25.23
3 N	26 E	WM	7	NW SW	2	37.54
3 N	26 E	WM	7	SW SW	2	37.10
3 N	26 E	WM	7	SE SW	1	24.92
3 N	26 E	WM	7	NE SE		24.48
3 N	26 E	WM	7	NW SE		35.09
3 N	26 E	WM	7	SW SE		34.66
3 N	26 E	WM	7	SE SE		24.90
3 N	27 E	WM	18	NE SW		3.70
4 N	26 E	WM	16	NE SW		1.01
4 N	26 E	WM	16	NW SW		12.26
4 N	26 E	WM	16	SW SW		32.57
4 N	26 E	WM	16	SE SW		37.73
4 N	26 E	WM	16	SW SE		16.69
4 N	26 E	WM	16	SE SE		5.43
4 N	26 E	WM	17	NE SE		22.08
4 N	26 E	WM	17	NW SE		7.48
4 N	26 E	WM	17	SW SE		31.72
4 N	26 E	WM	17	SE SE		31.67



Twp	Rng	Mer	Sec	Q-Q	GLot	Acres
4 N	26 E	WM	20	NE NE		38.90
4 N	26 E	WM	20	NW NE		25.71
4 N	26 E	WM	20	SW NE		31.70
4 N	26 E	WM	20	SE NE		32.36
4 N	26 E	WM	20	NE SE		38.32
4 N	26 E	WM	20	NW SE		26.46
4 N	26 E	WM	20	SW SE		32.19
4 N	26 E	WM	20	SE SE		33.41
4 N	26 E	WM	21	NE NE		40.40
4 N	26 E	WM	21	NW NE		33.72
4 N	26 E	WM	21	SW NE		34.42
4 N	26 E	WM	21	SE NE		35.69
4 N	26 E	WM	21	NE NW		34.19
4 N	26 E	WM	21	NW NW		36.07
4 N	26 E	WM	21	SW NW		30.93
4 N	26 E	WM	21	SE NW		39.56
4 N	26 E	WM	21	NE SW		36.17
4 N	26 E	WM	21	NW SW		36.65
4 N	26 E	WM	21	SW SW		32.52
4 N	26 E	WM	21	SE SW		40.13
4 N	26 E	WM	21	NE SE		40.20
4 N	26 E	WM	21	NW SE		33.79
4 N	26 E	WM	21	SW SE		33.35
4 N	26 E	WM	21	SE SE		36.31
4 N	26 E	WM	22	NE NE		11.64
4 N	26 E	WM	22	NW NE		23.49
4 N	26 E	WM	22	SW NE		35.32
4 N	26 E	WM	22	SE NE		16.15
4 N	26 E	WM	22	NE NW		2.43
4 N	26 E	WM	22	NW NW		14.36
4 N	26 E	WM	22	SW NW		35.29
4 N	26 E	WM	22	SE NW		39.13
4 N	26 E	WM	22	NE SW		34.29
4 N	26 E	WM	22	NW SW		33.26
4 N	26 E	WM	22	SW SW		35.72
4 N	26 E	WM	22	SE SW		38.98
4 N	26 E	WM	22	NE SE		32.95
4 N	26 E	WM	22	NW SE		39.04
4 N	26 E	WM	22	SW SE		33.37
4 N	26 E	WM	22	SE SE		23.35
4 N	26 E	WM	23	SW NE		22.41
4 N	26 E	WM	23	SE NE		21.67
4 N	26 E	WM	23	NE NW		4.87
4 N	26 E	WM	23	NW NW		4.09
4 N	26 E	WM	23	SW NW		35.92
4 N	26 E	WM	23	SE NW		37.96
4 N	26 E	WM	23	NE SW		28.30
4 N	26 E	WM	23	NW SW		31.82
4 N	26 E	WM	23	SW SW		37.89

RECEIVED

JUL 28 2022

OWRD



Twp	Rng	Mer	Sec	Q-Q	GLot	Acres
4 N	26 E	WM	23	SE SW		35.15
4 N	26 E	WM	23	NE SE		35.70
4 N	26 E	WM	23	NW SE		35.03
4 N	26 E	WM	23	SW SE		37.35
4 N	26 E	WM	23	SE SE		35.56
4 N	26 E	WM	24	SW NE	1	0.56
4 N	26 E	WM	24	SW NW		8.56
4 N	26 E	WM	24	SE NW	6	1.15
4 N	26 E	WM	24	NE SW		35.45
4 N	26 E	WM	24	NW SW		35.91
4 N	26 E	WM	24	SW SW		37.11
4 N	26 E	WM	24	SE SW		35.51
4 N	26 E	WM	24	NE SE		26.73
4 N	26 E	WM	24	NW SE		33.87
4 N	26 E	WM	24	SW SE		37.24
4 N	26 E	WM	24	SE SE		35.32
4 N	26 E	WM	25	NE NE		29.76
4 N	26 E	WM	25	NW NE		34.04
4 N	26 E	WM	25	SW NE		36.81
4 N	26 E	WM	25	SE NE		37.84
4 N	26 E	WM	25	NE NW		34.00
4 N	26 E	WM	25	NW NW		35.24
4 N	26 E	WM	25	SW NW		36.80
4 N	26 E	WM	25	SE NW		39.33
4 N	26 E	WM	25	NE SW		34.32
4 N	26 E	WM	25	NW SW		34.10
4 N	26 E	WM	25	SW SW		38.33
4 N	26 E	WM	25	SE SW		36.53
4 N	26 E	WM	25	NE SE		32.75
4 N	26 E	WM	25	NW SE		33.14
4 N	26 E	WM	25	SW SE		38.09
4 N	26 E	WM	25	SE SE		34.17
4 N	26 E	WM	26	NE NE		34.21
4 N	26 E	WM	26	NW NE		34.05
4 N	26 E	WM	26	SW NE		37.52
4 N	26 E	WM	26	SE NE		38.46
4 N	26 E	WM	26	NE NW		32.72
4 N	26 E	WM	26	NW NW		25.98
4 N	26 E	WM	26	SW NW		37.34
4 N	26 E	WM	26	SE NW		38.90
4 N	26 E	WM	26	NE SW		33.54
4 N	26 E	WM	26	NW SW		17.41
4 N	26 E	WM	26	SW SW		20.62
4 N	26 E	WM	26	SE SW		36.41
4 N	26 E	WM	26	NE SE		33.64
4 N	26 E	WM	26	NW SE		33.39
4 N	26 E	WM	26	SW SE		38.42
4 N	26 E	WM	26	SE SE		36.86
4 N	26 E	WM	27	NE NE		33.16



Twp	Rng	Mer	Sec	Q-Q	GLot	Acres
4 N	26 E	WM	27	NW NE		38.48
4 N	26 E	WM	27	SW NE		33.35
4 N	26 E	WM	27	SE NE		25.32
4 N	26 E	WM	27	NE NW		33.79
4 N	26 E	WM	27	NW NW		32.95
4 N	26 E	WM	27	SW NW		35.59
4 N	26 E	WM	27	SE NW		38.55
4 N	26 E	WM	27	NE SW		34.47
4 N	26 E	WM	27	NW SW		33.25
4 N	26 E	WM	27	SW SW		35.42
4 N	26 E	WM	27	SE SW		38.87
4 N	26 E	WM	27	NE SE		33.01
4 N	26 E	WM	27	NW SE		38.93
4 N	26 E	WM	27	SW SE		34.29
4 N	26 E	WM	27	SE SE		25.79
4 N	26 E	WM	28	NE NE		39.72
4 N	26 E	WM	28	NW NE		33.35
4 N	26 E	WM	28	SW NE		33.34
4 N	26 E	WM	28	SE NE		35.56
4 N	26 E	WM	28	NE NW		35.40
4 N	26 E	WM	28	NW NW		36.57
4 N	26 E	WM	28	SW NW		33.26
4 N	26 E	WM	28	SE NW		39.11
4 N	26 E	WM	28	NE SW		35.45
4 N	26 E	WM	28	NW SW		36.39
4 N	26 E	WM	28	SW SW		33.71
4 N	26 E	WM	28	SE SW		38.75
4 N	26 E	WM	28	NE SE		39.68
4 N	26 E	WM	28	NW SE		33.21
4 N	26 E	WM	28	SW SE		33.80
4 N	26 E	WM	28	SE SE		36.36
4 N	26 E	WM	29	NE NE		37.94
4 N	26 E	WM	29	NW NE		26.76
4 N	26 E	WM	29	SW NE		31.16
4 N	26 E	WM	29	SE NE		33.30
4 N	26 E	WM	29	NE SE		37.15
4 N	26 E	WM	29	NW SE		26.65
4 N	26 E	WM	29	SW SE		31.00
4 N	26 E	WM	29	SE SE		34.32
4 N	26 E	WM	32	NE NE		36.91
4 N	26 E	WM	32	NW NE		27.38
4 N	26 E	WM	32	SW NE		31.52
4 N	26 E	WM	32	SE NE		34.71
4 N	26 E	WM	32	NE SE		36.22
4 N	26 E	WM	32	NW SE		29.74
4 N	26 E	WM	32	SW SE		31.68
4 N	26 E	WM	32	SE SE		34.83
4 N	26 E	WM	33	NE NE		39.63
4 N	26 E	WM	33	NW NE		33.04

RECEIVED

JUL 28 2022

OWRD



Twp	Rng	Mer	Sec	Q-Q	Glott	Acres
4 N	26 E	WM	33	SW NE		34.08
4 N	26 E	WM	33	SE NE		35.58
4 N	26 E	WM	33	NE NW		35.50
4 N	26 E	WM	33	NW NW		35.79
4 N	26 E	WM	33	SW NW		33.56
4 N	26 E	WM	33	SE NW		38.23
4 N	26 E	WM	33	NE SW		35.71
4 N	26 E	WM	33	NW SW		34.26
4 N	26 E	WM	33	SW SW		33.35
4 N	26 E	WM	33	SE SW		36.70
4 N	26 E	WM	33	NE SE		3.13
4 N	26 E	WM	33	NW SE		23.25
4 N	26 E	WM	33	SW SE		18.98
4 N	26 E	WM	34	NE NE		32.57
4 N	26 E	WM	34	NW NE		38.43
4 N	26 E	WM	34	SW NE		32.90
4 N	26 E	WM	34	SE NE		24.06
4 N	26 E	WM	34	NE NW		34.20
4 N	26 E	WM	34	NW NW		33.28
4 N	26 E	WM	34	SW NW		34.64
4 N	26 E	WM	34	SE NW		38.44
4 N	26 E	WM	34	NE SW		33.35
4 N	26 E	WM	34	NW SW		21.95
4 N	26 E	WM	34	NW SE		2.66
4 N	26 E	WM	35	NE NE		36.01
4 N	26 E	WM	35	NW NE		35.17
4 N	26 E	WM	35	SW NE		31.08
4 N	26 E	WM	35	SE NE		32.06
4 N	26 E	WM	35	NE NW		36.38
4 N	26 E	WM	35	NW NW		34.97
4 N	26 E	WM	35	SW NW		30.55
4 N	26 E	WM	35	SE NW		31.07
4 N	26 E	WM	36	NE NE		32.14
4 N	26 E	WM	36	NW NE		35.95
4 N	26 E	WM	36	SW NE		32.14
4 N	26 E	WM	36	SE NE		30.39
4 N	26 E	WM	36	NE NW		35.46
4 N	26 E	WM	36	NW NW		35.96
4 N	26 E	WM	36	SW NW		32.00
4 N	26 E	WM	36	SE NW		30.65
Total						7472.54

The right to the use of the water for the above purpose is restricted to beneficial use on the lands or place of use herein described.

The issuance of this superseding certificate does not confirm the status of the water right in regard to the provisions of ORS 540.610 pertaining to forfeiture or abandonment.



This certificate describes that portion of water right Certificate 95155, State Record of Water Right Certificates, REDUCED IN RATE by the provisions of an order of the Water Resources Director entered APR 15 2021, approving Conserved Water Application CW-119. This certificate together with Certificate 95661 and the conserved water under CW-119, supersedes Certificate 95155 State Record of Water Right Certificates.

WITNESS the signature of the Water Resources Director, affixed APR 15 2021.



Lisa J. Jaramillo, Transfer and Conservation Section Manager, for  
THOMAS M. BYLER, Director  
Oregon Water Resources Department

RECEIVED  
JUL 28 2022  
OWRD



RECEIVED

JUL 28 2022

OWRD

**Attachment B**  
**Application Maps**

Application for a Water Right Transfer – AgriNorthwest



# Application for a Permanent Water Right Transfer - Point of Diversion Map 1

Certificates 92990, 92992, 92993, 92994, 93872, and 95622 **RECEIVED**

Water Rights in the Name of Farmland Reserve, Inc.  
Morrow County  
Township 4 North, Range 25 East (W.M.)

**JUL 28 2022**

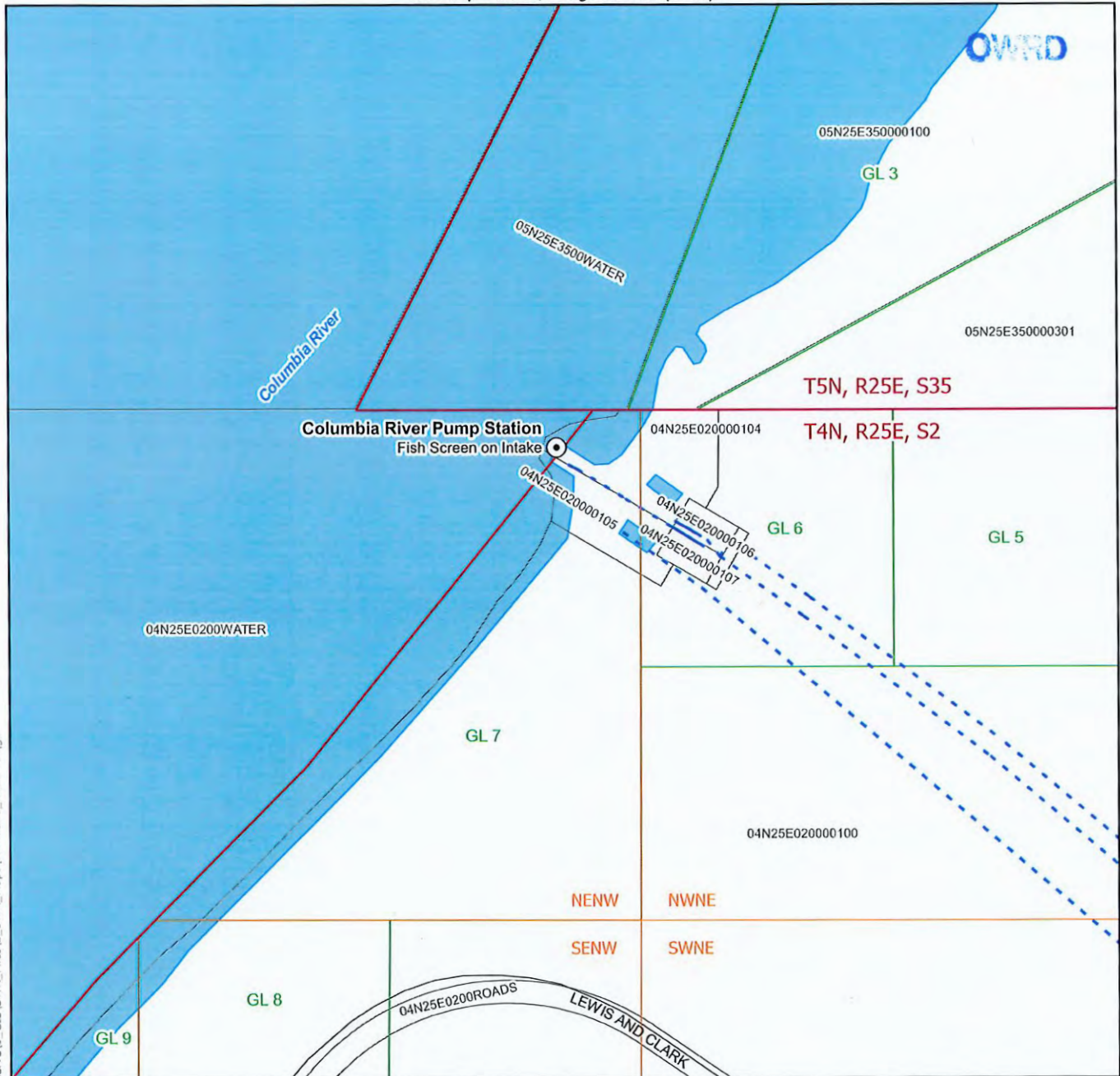

### LEGEND

- Point of Diversion (POD)
- Government Lots
- Pipeline
- Railroad
- Road
- Watercourse

### POD Location Description

Columbia River Pump Station  
Located South 86 degrees 22 minutes 46 seconds West,  
2,829 feet from the NE corner of Section 2, Township 4 North,  
Range 25 East (W.M.)



RENEWS: **12-31-2022**

CWRE Seal and Signature

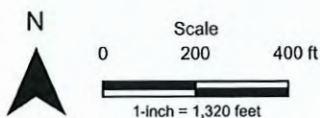

Date: 6/10/2022  
Data Sources: BLM, OGIC, ESRI, USGS, Morrow Co.  
Disclaimer: This map was prepared for the purpose of identifying  
the location of a water right only and is not intended to provide  
legal dimensions or location of property ownership lines.



C:\OneDrive\Geo-Logic Associates, Inc\SWR - Files\Project\Farmland Reserve\1\_GIS\SWR\_Files\1\_SWR\_Maps\Farmland\_Reserve.qgz



**Application for a Permanent Water Right Transfer - Point of Diversion Map 2**  
**Certificate - 93872**

A Water Right in the Name of Farmland Reserve, Inc.  
 Umatilla County  
 Township 5 North, Range 30 East (W.M.)

RECEIVED

JUL 28 2022

OWRD

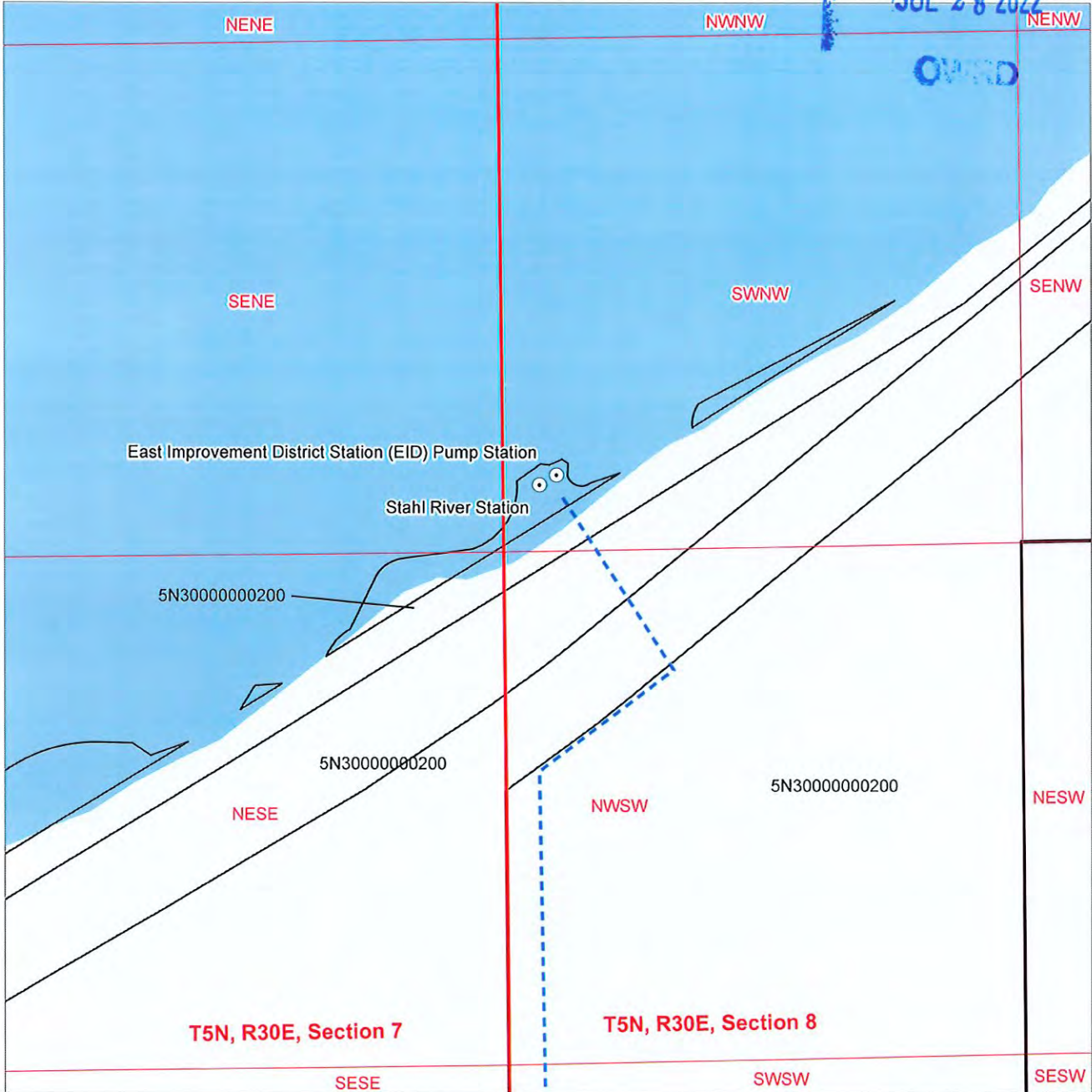

**Legend**

- ⊙ Point of Diversion (POD)
- Pipeline
- Taxlot
- Watercourse

**POD Location Description**

**Stahl Pump Station:** Located 2860 feet North and 70 feet East from the SW corner of Section 8, Township 5 North, Range 30 East (W.M.)  
**East Improvement (EID) District Pump Station:** Located 2910 feet North and 120 feet East from the SW corner of Section 8, Township 5 North, Range 30 East (W.M.)



RENEWS: 12-31-2022

CWRE Seal and Signature

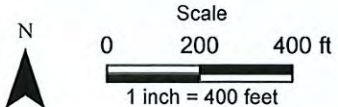

Date: 6/13/2022  
 Data Sources: BLM, ESRI, OWRD, USGS, Coos. Co.  
 Disclaimer: This map was prepared for the purpose of identifying the location of a water right only and is not intended to provide legal dimensions or location of property ownership lines.





Copy of map already on-file for T13252 - No changes

# Application for a Permanent Water Right Transfer – FROM Lands Map Certificate 92990

A Water Right in the Name of Farmland Reserve, Inc.  
Morrow County  
Township 3 North, Range 27 East (W.M.)

RECEIVED

JUL 28 2022

OWRD

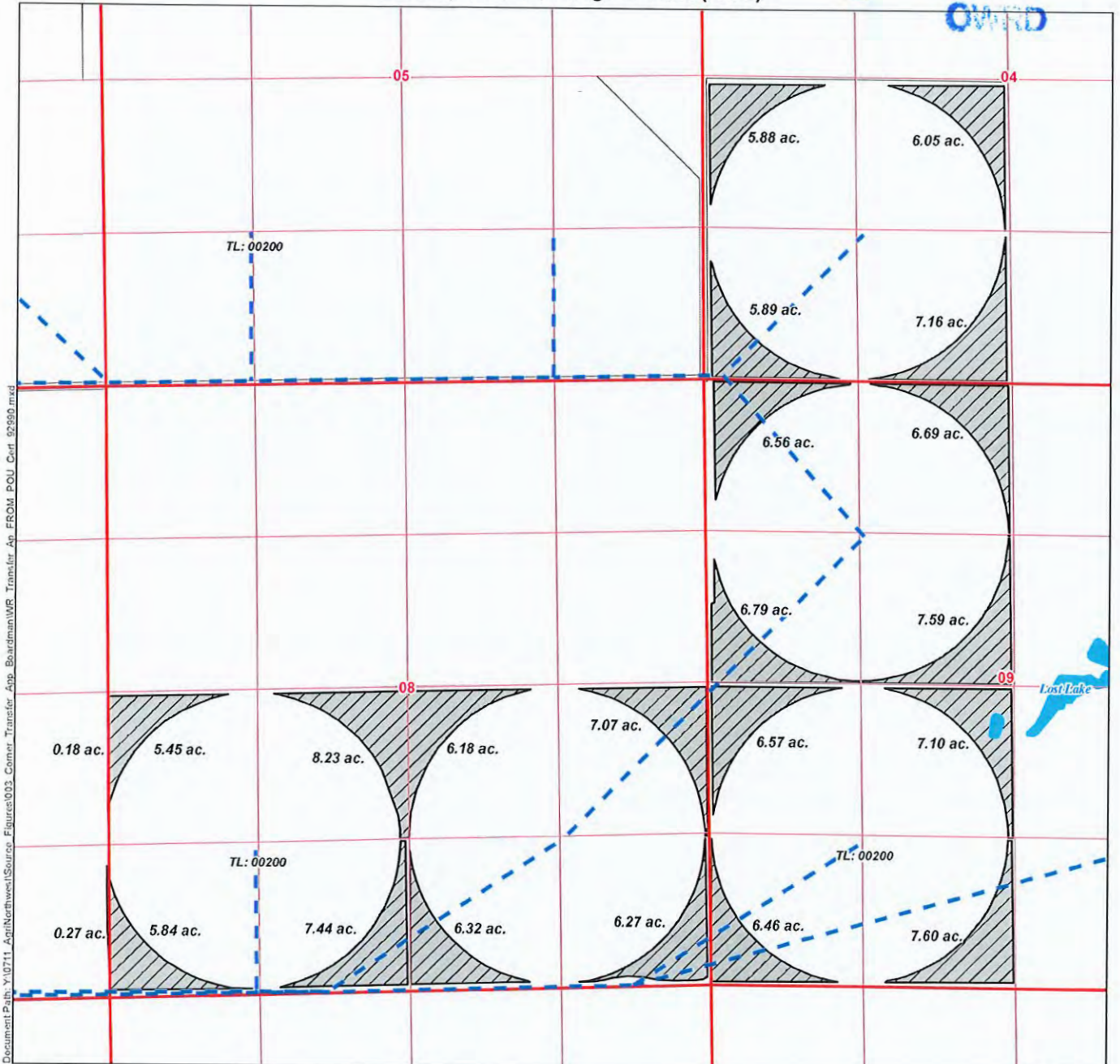

Document Path: Y:\0711\_ApplNorthwest\Source\_Figures\003\_Corner\_Transfer\_Appl\_Boardman\WB\_Transfer\_Appl\_FROM\_POU\_Cert\_92990.mxd

### LEGEND

#### Place of Use

From Lands, 133.59 ac.

#### All Other Features

Pipeline

Road

Watercourse

Waterbody

### Certified Water Rights Examiner Stamp



### DISCLAIMER

This map was prepared for the purpose of identifying the location of a water right only and it is not intended to provide legal dimensions or location of property ownership lines.

### MAP NOTES

Date: June 23, 2020

Data Sources: BLM, OGIC, ESRI, USGS, Morrow Co.

