

Application for Permanent Water Right Transfer



Oregon Water Resources Department
725 Summer Street NE, Suite A
Salem, Oregon 97301-1266
(503) 986-0900
www.oregon.gov/OWRD

Part 1 of 5 – Minimum Requirements Checklist

This transfer application will be returned if Parts 1 through 5 and all required attachments are not completed and included.

For questions, please call (503) 986-0900, and ask for Transfer Section.

RECEIVED

JAN 23 2023

OWRD

Check all items included with this application. (N/A = Not Applicable)

- Part 1 – Completed Minimum Requirements Checklist.
- Part 2 – Completed Transfer Application Map Checklist.
- Part 3 – Application Fee, payable by check to the Oregon Water Resources Department, and completed Fee Worksheet, page 3. Try the new online fee calculator at: http://apps.wrd.state.or.us/apps/misc/wrd_fee_calculator.
- Part 4 – Completed Applicant Information and Signature.
- Part 5 – Information about Water Rights to be Transferred: **How many water rights are to be transferred? 1 List them here: 89345**

Please include a separate Part 5 for each water right. (See instructions on page 6)

NOTE: A separate transfer application is required for each water right unless the criteria in OAR 690-380-3220 are met.

RECEIVED

FEB 21 2023

Attachments:

- Completed Transfer Application Map.
- Completed Evidence of Use Affidavit and supporting documentation.
- N/A Affidavit(s) of Consent from Landowner(s) (if the applicant does not own the land the water right is on.)
- N/A Supplemental Form D – For water rights served by or issued in the name of an irrigation district. Complete when the transfer applicant is not the irrigation district.
- N/A Oregon Water Resources Department’s Land Use Information Form with approval and signature from each local land use authority in which water is to be diverted, conveyed, and/or used. Not required if water is to be diverted, conveyed, and/or used only on federal lands or if **all** of the following apply: a) a change in place of use only, b) no structural changes, c) the use of water is for irrigation only, and d) the use is located within an irrigation district or an exclusive farm use zone.
- N/A Water Well Report/Well Log for changes in point(s) of appropriation (well(s)) or additional point(s) of appropriation.
- N/A Geologist Report for a change from a surface water point of diversion to a ground water point of appropriation (well), if the proposed well is more than 500’ from the surface water source and more than 1000’ upstream or downstream from the point of diversion. See OAR 690-380-2130 for requirements and applicability.

OWRD

(For Staff Use Only)

WE ARE RETURNING YOUR APPLICATION FOR THE FOLLOWING REASON(S):

- | | |
|--|--|
| <input type="checkbox"/> Application fee not enclosed/insufficient | <input type="checkbox"/> Map not included or incomplete |
| <input type="checkbox"/> Land Use Form not enclosed or incomplete | <input type="checkbox"/> Evidence of Use Form not enclosed or incomplete |
| <input type="checkbox"/> Additional signature(s) required | <input type="checkbox"/> Part _____ is incomplete |

Other/Explanation _____

Staff: _____ 503- _____ Date: ____/____/____

Part 2 of 5 – Transfer Application Map

Your transfer application will be returned if any of the map requirements listed below are not met.

Please be sure that the transfer application map you submit includes all the required items and matches the existing water right map. Check all boxes that apply.

- N/A Certified Water Right Examiner (CWRE) Stamp and Original Signature. For a list of CWREs, see http://apps.wrd.state.or.us/apps/wr/cwre_license_view/. CWRE stamp and signature are not required for substitutions.
- N/A If **more than three** water rights are involved, separate maps are needed for each water right.
- Permanent quality printed with dark ink on good quality paper.
- The size of the map can be 8½ x 11 inches, 8½ x 14 inches, 11 x 17 inches, or up to 30 x 30 inches. For 30 x 30 inch maps, one extra copy is required.
- A north arrow, a legend, and scale.
- The scale of the map must be: 1 inch = 400 feet, 1 inch = 1,320 feet, the scale of the Final Proof/Claim of Beneficial Use Map (the map used when the permit was certificated), the scale of the county assessor map if the scale is not smaller than 1 inch = 1,320 feet, or a scale that has been pre-approved by the Department.
- Township, Range, Section, ¼ ¼, DLC, Government Lot, and other recognized public land survey lines.
- Tax lot boundaries (property lines) are required. Tax lot numbers are recommended.
- Major physical features including rivers and creeks showing direction of flow, lakes and reservoirs, roads, and railroads.
- Major water delivery system features from the point(s) of diversion/appropriation such as main pipelines, canals, and ditches.
- Existing place of use that includes separate hachuring for each water right, priority date, and use including number of acres in each quarter-quarter section, government lot, or in each quarter-quarter section as projected within government lots, donation land claims, or other recognized public land survey subdivisions. If less than the entirety of the water right is being changed, a separate hachuring is needed for lands left unchanged.
- N/A Proposed place of use that includes separate hachuring for each water right, priority date, and use including number of acres in each quarter-quarter section, government lot, or in each quarter-quarter section as projected within government lots, donation land claims, or other recognized public land survey subdivisions.
- Existing point(s) of diversion or well(s) with distance and bearing or coordinates from a recognized survey corner. This information can be found in your water right certificate or permit.
- N/A If you are proposing a change in point(s) of diversion or well(s), show the proposed location and label it clearly with distance and bearing or coordinates. If GPS coordinates are used, latitude-longitude coordinates may be expressed as either degrees-minutes-seconds with at least one digit after the decimal (example – 42°32'15.5") or degrees-decimal with five or more digits after the decimal (example – 42.53764°).

RECEIVED

FEB 21 2023

14177
OWRD

Part 3 of 5 – Fee Worksheet

FEE WORKSHEET for PERMANENT TRANSFER (except Substitution)			
1	Base Fee (includes one type of change to one water right for up to 1 cfs)	1	\$1,360
2	Types of change proposed: <input type="checkbox"/> Place of Use <input type="checkbox"/> Character of Use <input checked="" type="checkbox"/> Point of Diversion/Appropriation Number of above boxes checked = <u>1 (2a)</u> Subtract 1 from the number in line 2a = <u>0 (2b)</u> <i>If only one change, this will be 0</i> Multiply line 2b by \$1090 and enter »	2	0
3	Number of water rights included in transfer <u>1 (3a)</u> Subtract 1 from the number in 3a above: <u>0 (3b)</u> <i>If only one water right this will be 0</i> Multiply line 3b by \$610 and enter »	3	0
4	Do you propose to add or change a well, or change from a surface water POD to a well? <input type="checkbox"/> No: enter 0 <input checked="" type="checkbox"/> Yes: enter \$480 for the 1 st well to be added or changed <u>\$480 (4a)</u> Do you propose to add or change additional wells? <input type="checkbox"/> No: enter 0 <input checked="" type="checkbox"/> Yes: multiply the number of additional wells by \$410 <u>\$1230 (4b)</u> Add line 4a to line 4b and enter »	4	\$1,710
5	Do you propose to change the place of use or character of use? <input checked="" type="checkbox"/> No: enter 0 on line 5 <input type="checkbox"/> Yes: enter the cfs for the portions of the rights to be transferred (see below*): _____ (5a) Subtract 1.0 from the number in 5a above: _____ (5b) If 5b is 0 or less, enter 0 on line 5 » If 5b is greater than 0, round up to the nearest whole number: _____ (5c) and multiply 5c by \$410, then enter on line 5 »	5	0
6	Add entries on lines 1 through 5 above » » » » » » » » » » Subtotal:	6	\$3,070
7	Is this transfer: <input type="checkbox"/> necessary to complete a project funded by the Oregon Watershed Enhancement Board (OWEB) under ORS 541.932? <input type="checkbox"/> endorsed in writing by ODFW as a change that will result in a net benefit to fish and wildlife habitat? If one or more boxes is checked, multiply line 6 by 0.5 and enter on line 7 » If no box is applicable, enter 0 on line 7 »	7	0
8	Subtract line 7 from line 6 » Transfer Fee:	8	\$3,070

RECEIVED
 JAN 23 2023
 OWRD

RECEIVED
 FEB 21 2023
 OWRD

*Example for Line 5a calculation to transfer 45.0 acres of Primary Certificate 12345 (total 1.25 cfs for 100 acres) and 45.0 acres of Supplemental Certificate 87654 (1/80 cfs per acre) on the same land:

1. For irrigation calculate cfs for each water right involved as follows:
 - a. Divide total authorized cfs by total acres in the water right (*for C12345, 1.25 cfs ÷ 100 ac*); then multiply by the number of acres to be transferred to get the transfer cfs (*x 45 ac = 0.56 cfs*).
 - b. If the water right certificate does not list total cfs, but identifies the allowable use as 1/40 or 1/80 of a cfs per acre; multiply number of acres proposed for change by either 0.025 (1/40) or 0.0125 (1/80). (*For C87654, 45.0 ac x 0.0125 cfs/ac = 0.56 cfs*)
2. Add cfs for the portions of water rights on all the land included in the transfer; however **do not count cfs for supplemental rights on acreage for which you have already calculated the cfs fee for the primary right on the same land**. The fee should be assessed only once for each "on the ground" acre included in the transfer. (*In this example, blank 5a would be only 0.56 cfs, since both rights serve the same 45.0 acres. Blank 5b would be 0 and Line 5 would then also become 0.*)

FEE WORKSHEET for SUBSTITUTION			
1	Base Fee (includes change to one well)	1	\$990.00
2	Number of wells included in substitution _____ (2a) Subtract 1 from the number in 2a above: _____ (2b) <i>If only one well this will be 0</i> Multiply line 2b by \$480 and enter »	2	
3	Add entries on lines 1 through 2 above » » » » » » » » » » Fee for Substitution:	3	

Part 4 of 5 – Applicant Information and Signature

Applicant Information

APPLICANT/BUSINESS NAME Bell A Land & Cattle Co		PHONE NO. 541-433-2556	ADDITIONAL CONTACT NO. 541-419-6613
ADDRESS PO Box 97			FAX NO.
CITY LaPine	STATE OR	ZIP 97739	E-MAIL BellACattle@gmail.com
BY PROVIDING AN E-MAIL ADDRESS, CONSENT IS GIVEN TO RECEIVE ALL CORRESPONDENCE FROM THE DEPARTMENT ELECTRONICALLY. COPIES OF THE FINAL ORDER DOCUMENTS WILL ALSO BE MAILED.			

Agent Information – The agent is authorized to represent the applicant in all matters relating to this application.

AGENT/BUSINESS NAME Scott D Montgomery/All Points Engr & Surveying, Inc		PHONE NO. 541-548-5833	ADDITIONAL CONTACT NO. 541-420-0401
ADDRESS PO Box 767			FAX NO.
CITY Terrebonne	STATE OR	ZIP 97760	E-MAIL scott@apeands.com
BY PROVIDING AN E-MAIL ADDRESS, CONSENT IS GIVEN TO RECEIVE ALL CORRESPONDENCE FROM THE DEPARTMENT ELECTRONICALLY. COPIES OF THE FINAL ORDER DOCUMENTS WILL ALSO BE MAILED.			

Explain in your own words what you propose to accomplish with this transfer application, and why:
Adding new wells to existing water right to provide more flexibility to existing systems.

If you need additional space, continue on a separate piece of paper and attach to the application as "Attachment 1".

Check One Box

- By signing this application, I understand that, upon receipt of the draft preliminary determination and prior to Department approval of the transfer, I will be required to provide landownership information and evidence that I am authorized to pursue the transfer as identified in OAR 690-380-4010(5); **OR**
- I affirm the applicant is a municipality as defined in ORS 540.510(3)(b) and that the right is in the name of the municipality or a predecessor; **OR**
- I affirm the applicant is an entity with the authority to condemn property and is acquiring by condemnation the property to which the water right proposed for transfer is appurtenant and have supporting documentation.

RECEIVED

JAN 23 2023

OWRD

RECEIVED

FEB 21 2023

OWRD

By my signature below, I confirm that I understand:

- Prior to Department approval of the transfer application, I may be required to submit payment to the Department for publication of a notice in a newspaper with general circulation in the area where the water right is located, once per week for two consecutive weeks. If more than one qualifying newspaper is available, I suggest publishing the notice in the following newspaper: Lake County Examiner.
- Amendments to the application may only be made in response to the Department's Draft Preliminary Determination (DPD). The applicant will have a period of at least 30 days to amend the application to address any issues identified by the Department in the DPD, or to withdraw the application. Note that amendments may be subject to additional fees, pursuant to ORS 536.050.
- Failure to complete an approved change in place of use and/or change in character of use, will result in loss of the water right (OAR 690-380-6010).
- Refunds may only be granted upon request and, as set forth in ORS 536.050(4)(a), if the Director determines that a refund of all or part of a fee is appropriate in the interests of fairness to the public or necessary to correct an error of the Department.

I (we) affirm that the information contained in this application is true and accurate.

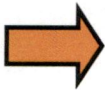

[Handwritten Signature]
Applicant signature

Theresa Cliff, President
Print Name (and Title if applicable)

11-20-2022
Date

Is the applicant the sole owner of the land on which the water right, or portion thereof, proposed for transfer is located? Yes No*

**If NO, include signatures of all deeded landowners (and mailing and/or e-mail addresses if different than the applicant's) or attach affidavits of consent (and mailing and/or e-mail addresses) from all landowners or individuals/entities to which the water right(s) were conveyed.*

Check the following boxes that apply:

- The applicant is responsible for completion of change(s). Notices and correspondence should continue to be sent to the applicant.
- The receiving landowner will be responsible for completing the proposed change(s) after the final order is issued. Copies of notices and correspondence should be sent to this landowner.
- Both the receiving landowner and applicant will be responsible for completion of change(s). Copies of notices and correspondence should be sent to this landowner and the applicant.

At this time, are the lands in this transfer application in the process of being sold? Yes No

If YES, and you know who the new landowner will be, please complete the receiving landowner information table below. If you do not know who the new landowner will be, then a request for assignment will have to be filed for at a later date.

If a property sells, the certificated water right(s) located on the land belong to the new owner, unless a sale agreement or other document states otherwise. For more information see:

https://www.oregon.gov/owrd/WRDFormsPDF/Transfer_Property_Transactions.pdf

RECEIVING LANDOWNER NAME NA			PHONE NO.	ADDITIONAL CONTACT NO.
ADDRESS				FAX NO.
CITY	STATE	ZIP	E-MAIL	RECEIVED JAN 23 2023
Describe any special ownership circumstances:				
The confirming Certificate shall be issued in the name of: <input type="checkbox"/> Applicant <input type="checkbox"/> Receiving Landowner				OWRD

RECEIVED

FEB 21 2023

14177
OWRD

Check here if any of the water rights proposed for transfer are or will be located within or served by an irrigation or other water district. (Tip: Complete and attach Supplemental Form D.)

IRRIGATION DISTRICT NAME Silver Lake Irrigation District	ADDRESS	
CITY	STATE	ZIP

Check here if water for any of the rights supplied under a water service agreement or other contract for stored water with a federal agency or other entity.

To meet State Land Use Consistency Requirements, you must list all county, city, municipal corporation, or tribal governments within whose jurisdiction water will be diverted, conveyed or used.

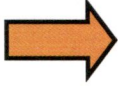

ENTITY NAME Lake County	ADDRESS 513 Center St	
CITY Lakeview	STATE OR	ZIP 97630

RECEIVED
JAN 23 2023
OWRD

RECEIVED
FEB 21 2023
OWRD

Part 5 of 5 – Water Right Information

Please use a separate Part 5 for each water right being changed. See instructions on page 6, to copy and paste additional Part 5s, or to add additional rows to tables within the form.

CERTIFICATE # 89345

RECEIVED

Description of Water Delivery System

RECEIVED

JAN 23 2023

System capacity: 19.81 cubic feet per second (cfs) OR

FEB 21 2023

OWRD

_____ gallons per minute (gpm)

OWRD

Describe the current water delivery system or the system that was in place at some time within the last five years. Include information on the pumps, canals, pipelines, and sprinklers used to divert, convey, and apply the water at the authorized place of use. **Water is pumped from authorized wells and conveyed into existing flood & wheel line systems that irrigate the place of use**

Table 1. Location of Authorized and Proposed Point(s) of Diversion (POD) or Appropriation (POA)

(Note: If the POD/POA name is not specified on the certificate, assign it a name or number here.)

POD/POA Name or Number	Is this POD/POA Authorized on the Certificate or is it Proposed?	If POA, OWRD Well Log ID# (or Well ID Tag # L-___)	Twp		Rng		Sec		¼ ¼	Tax Lot, DLC or Gov't Lot	Measured Distances (from a recognized survey corner)
1	<input checked="" type="checkbox"/> Authorized <input type="checkbox"/> Proposed	LAKE 1245	28	S	14	E	15	NW	NW	100	50' S & 60' E from NW cor, Sec 15
2	<input checked="" type="checkbox"/> Authorized <input type="checkbox"/> Proposed	LAKE 743	28	S	14	E	15	NW	SW	100	80' S & 850' E from ¼ cor, Sec 15 & 16
3	<input checked="" type="checkbox"/> Authorized <input type="checkbox"/> Proposed	LAKE 746	28	S	14	E	15	SE	SW	100	600' N & 2550' E from SW cor, Sec 15
4	<input checked="" type="checkbox"/> Authorized <input type="checkbox"/> Proposed	LAKE 747	28	S	14	E	22	SE	NW	100	2150' S & 1800' E from NW cor, Sec 22
5	<input checked="" type="checkbox"/> Authorized <input type="checkbox"/> Proposed	LAKE 742	28	S	14	E	24	NW	NE	1400	950' S & 2510' W from NE cor, Sec 24
6	<input type="checkbox"/> Authorized <input checked="" type="checkbox"/> Proposed	LAKE 1317	28	S	14	E	23	SE	NE	3000	1380' S & 1260' W from NE cor, Sec 23
7	<input type="checkbox"/> Authorized <input checked="" type="checkbox"/> Proposed	UNBUILT	28	S	14	E	13	NW	SE	1400	3125' S & 2645' E from NW cor, Sec 13
8	<input type="checkbox"/> Authorized <input checked="" type="checkbox"/> Proposed	UNBUILT	28	S	14	E	22	NW	NW	100	50' S & 1255' E from NW cor, Sec 22
9	<input type="checkbox"/> Authorized <input checked="" type="checkbox"/> Proposed	UNBUILT	28	S	14	E	15	SE	SW	100	80' N & 2420' E from SW cor, Sec 15

Check all type(s) of change(s) proposed below (change "CODES" are provided in parentheses):

- | | |
|---|--|
| <input type="checkbox"/> Place of Use (POU) | <input type="checkbox"/> Supplemental Use to Primary Use (S to P) |
| <input type="checkbox"/> Character of Use (USE) | <input type="checkbox"/> Point of Appropriation/Well (POA) |
| <input type="checkbox"/> Point of Diversion (POD) | <input checked="" type="checkbox"/> Additional Point of Appropriation (APOA) |
| <input type="checkbox"/> Additional Point of Diversion (APOD) | <input type="checkbox"/> Substitution (SUB) |

- Surface Water POD to Ground Water POA (SW/GW) Government Action POD (GOV)

Will all of the proposed changes affect the entire water right?

- Yes Complete only the Proposed (“to” or “on” lands) section of Table 2 on the next page. Use the “CODES” listed above to describe the proposed changes.
- No Complete all of Table 2 to describe the portion of the water right to be changed.

RECEIVED

JAN 23 2023

OWRD

RECEIVED

FEB 21 2023

OWRD

Table 2. Description of Changes to Water Right Certificate # 89345

List the change proposed for the acreage in each ¼ ¼. If more than one change is proposed, specify the acreage associated with each change. If there is more than one POD/POA involved in the proposed changes, specify the acreage associated with each POD/POA.

AUTHORIZED (the "from" or "off" lands) The listing that appears on the certificate BEFORE PROPOSED CHANGES List only that part or portion of the water right that will be changed.											Proposed Changes (see "CODES" from previous page)	PROPOSED (the "to" or "on" lands) The listing as it would appear AFTER PROPOSED CHANGES are made.											
Twp	Rng	Sec	¼ ¼	Tax Lot	Gvt Lot or DLC	Acres	Type of USE listed on Certificate	POD(s) or POA(s) (name or number from Table 1)	Priority Date	Twp		Rng	Sec	¼ ¼	Tax Lot	Gvt Lot or DLC	Acres	New Type of USE	POD(s)/ POA(s) to be used (from Table 1)	Priority Date			
										APOA	27	S	15	E	19	SW	SW	3600	4	23.97	IS	1-9	1983
										APOA	27	S	15	E	19	SE	SW			14.00	IS	1-9	1983
										APOA	27	S	15	E	30	SW	NE			26.10	IS	1-9	1983
										APOA	27	S	15	E	30	NE	NW			38.60	IS	1-9	1983
										APOA	27	S	15	E	30	NW	NW	1	24.10	IS	1-9	1983	
										APOA	27	S	15	E	30	SW	NW	2	17.10	IS	1-9	1983	
										APOA	27	S	15	E	30	SE	NW			38.50	IS	1-9	1983
										APOA	27	S	15	E	30	NE	SW			39.00	IS	1-9	1983
										APOA	27	S	15	E	30	NW	SW	4800	3	24.48	IS	1-9	1983
										APOA	27	S	15	E	30	SW	SW		4	24.67	IS	1-9	1983
										APOA	27	S	15	E	30	SE	SW			40.00	IS	1-9	1983
										APOA	27	S	15	E	30	NE	SE	3600		1.00	IS	1-9	1983
										APOA	27	S	15	E	30	NW	SE			39.00	IS	1-9	1983
TOTAL ACRES:							TOTAL ACRES:																

14177

AUTHORIZED (the "from" or "off" lands) The listing that appears on the certificate BEFORE PROPOSED CHANGES List only that part or portion of the water right that will be changed.										Proposed Changes (see "CODES" from previous page)	PROPOSED (the "to" or "on" lands) The listing as it would appear AFTER PROPOSED CHANGES are made.												
Twp	Rng	Sec	¼ ¼	Tax Lot	Gvt Lot or DLC	Acres	Type of USE listed on Certificate	POD(s) or POA(s) (name or number from Table 1)	Priority Date		Twp	Rng	Sec	¼ ¼	Tax Lot	Gvt Lot or DLC	Acres	New Type of USE	POD(s)/ POA(s) to be used (from Table 1)	Priority Date			
										APOA	27	S	15	E	30	SW	SE	3600		40.00	IS	1-9	1983
										APOA	27	S	15	E	30	SE	SE	3600		7.00	IS	1-9	1983
										APOA	27	S	15	E	31	NE	NE	3600		13.00	IS	1-9	1983
										APOA	27	S	15	E	31	NW	NE	3600		40.00	IS	1-9	1983
										APOA	27	S	15	E	31	SW	NE	3600		30.80	IS	1-9	1983
										APOA	27	S	15	E	31	SE	NE	3600		2.00	IS	1-9	1983
										APOA	27	S	15	E	31	NE	SW	4900		25.00	IS	1-9	1983
										APOA	27	S	15	E	31	SE	SW	4900		32.00	IS	1-9	1983
										APOA	27	S	15	E	31	NW	SE	3600		10.50	IS	1-9	1983
										APOA	27	S	15	E	31	SW	SE	3600		25.40	IS	1-9	1983
										APOA	28	S	14	E	1	SW	NE	3600	9	43.95	IS	1-9	1983
										APOA	28	S	14	E	1	SE	NE	3600	2	35.65	IS	1-9	1983
										APOA	28	S	14	E	1	NE	SW	3600	4	24.80	IS	1-9	1983
TOTAL ACRES:											TOTAL ACRES:												

RECEIVED
FEB 21 2023
OWRD
RECEIVED
JAN 23 2023
OWRD

14177

AUTHORIZED (the "from" or "off" lands) The listing that appears on the certificate BEFORE PROPOSED CHANGES List only that part or portion of the water right that will be changed.											Proposed Changes (see "CODES" from previous page)	PROPOSED (the "to" or "on" lands) The listing as it would appear AFTER PROPOSED CHANGES are made.											
Twp	Rng	Sec	¼ ¼	Tax Lot	Gvt Lot or DLC	Acres	Type of USE listed on Certificate	POD(s) or POA(s) (name or number from Table 1)	Priority Date	Twp		Rng	Sec	¼ ¼	Tax Lot	Gvt Lot or DLC	Acres	New Type of USE	POD(s)/ POA(s) to be used (from Table 1)	Priority Date			
										APOA	28	S	14	E	1	NE	SW	100	7	10.00	IS	1-9	1983
										APOA	28	S	14	E	1	NW	SW		6	6.00	IS	1-9	1983
										APOA	28	S	14	E	1	NW	SW		5	7.30	IS	1-9	1983
										APOA	28	S	14	E	1	SE	SW			37.30	IS	1-9	1983
										APOA	28	S	14	E	1	NE	SE			34.40	IS	1-9	1983
										APOA	28	S	14	E	1	NW	SE		3	38.40	IS	1-9	1983
										APOA	28	S	14	E	1	NW	SE		8	1.60	IS	1-9	1983
										APOA	28	S	14	E	1	SW	SE			31.40	IS	1-9	1983
										APOA	28	S	14	E	1	SE	SE			6.90	IS	1-9	1983
										APOA	28	S	14	E	2	SE	SW		11	35.80	IS	1-9	1983
										APOA	28	S	14	E	2	SE	SW		3	4.20	IS	1-9	1983
										APOA	28	S	14	E	2	SW	SE		2	19.20	IS	1-9	1983
										APOA	28	S	14	E	2	SW	SE		12	20.80	IS	1-9	1983
TOTAL ACRES:											TOTAL ACRES:												

RECEIVED
JAN 23 2023
OWRD
RECEIVED
FEB 21 2023
OWRD

14177

AUTHORIZED (the "from" or "off" lands) The listing that appears on the certificate BEFORE PROPOSED CHANGES List only that part or portion of the water right that will be changed.											Proposed Changes (see "CODES" from previous page)	PROPOSED (the "to" or "on" lands) The listing as it would appear AFTER PROPOSED CHANGES are made.											
Twp	Rng	Sec	¼ ¼	Tax Lot	Gvt Lot or DLC	Acres	Type of USE listed on Certificate	POD(s) or POA(s) (name or number from Table 1)	Priority Date	Twp		Rng	Sec	¼ ¼	Tax Lot	Gvt Lot or DLC	Acres	New Type of USE	POD(s)/ POA(s) to be used (from Table 1)	Priority Date			
										APOA	28	S	14	E	2	SE	SE	100	1	39.60	IS	1-9	1983
										APOA	28	S	14	E	10	NE	NE			39.10	IS	1-9	1983
										APOA	28	S	14	E	10	NW	NE			39.70	IS	1-9	1983
										APOA	28	S	14	E	10	SW	NE			40.00	IS	1-9	1983
										APOA	28	S	14	E	10	SE	NE			39.10	IS	1-9	1983
										APOA	28	S	14	E	10	NE	NW			16.70	IS	1-9	1983
										APOA	28	S	14	E	10	SW	NE			9.50	IS	1-9	1983
										APOA	28	S	14	E	10	SE	NW			40.00	IS	1-9	1983
										APOA	28	S	14	E	10	NE	SW			40.00	IS	1-9	1983
										APOA	28	S	14	E	10	NW	SW			10.50	IS	1-9	1983
										APOA	28	S	14	E	10	SE	SW			8.60	IS	1-9	1983
										APOA	28	S	14	E	10	NE	SE			39.10	IS	1-9	1983
										APOA	28	S	14	E	10	NW	SE			40.00	IS	1-9	1983
TOTAL ACRES:											TOTAL ACRES:												

RECEIVED
FEB 21 2023
OWRD

RECEIVED
JAN 23 2023
OWRD

14177

AUTHORIZED (the "from" or "off" lands) The listing that appears on the certificate BEFORE PROPOSED CHANGES List only that part or portion of the water right that will be changed.											Proposed Changes (see "CODES" from previous page)	PROPOSED (the "to" or "on" lands) The listing as it would appear AFTER PROPOSED CHANGES are made.										
Twp	Rng	Sec	¼ ¼	Tax Lot	Gvt Lot or DLC	Acres	Type of USE listed on Certificate	POD(s) or POA(s) (name or number from Table 1)	Priority Date	Twp		Rng	Sec	¼ ¼	Tax Lot	Gvt Lot or DLC	Acres	New Type of USE	POD(s)/ POA(s) to be used (from Table 1)	Priority Date		
										APOA	28	S	14	E	10	SW	SE		40.00	IS	1-9	1983
										APOA	28	S	14	E	10	SE	SE		39.10	IS	1-9	1983
										APOA	28	S	14	E	10	NE	NE		38.90	IS	1-9	1983
										APOA	28	S	14	E	10	NW	NE		40.00	IS	1-9	1983
										APOA	28	S	14	E	10	NE	NW		40.00	IS	1-9	1983
										APOA	28	S	14	E	10	NW	NW		24.00	IS	1-9	1983
										APOA	28	S	14	E	10	SW	NW	1100	39.10	IS	1-9	1983
										APOA	28	S	14	E	10	SE	NW		40.00	IS	1-9	1983
										APOA	28	S	14	E	10	NE	SW		13.00	IS	1-9	1983
										APOA	28	S	14	E	10	NW	SW		37.50	IS	1-9	1983
										APOA	28	S	14	E	12	NE	NE	100	40.00	IS	1-9	1983
										APOA	28	S	14	E	12	NW	NE		39.10	IS	1-9	1983
										APOA	28	S	14	E	12	SW	NE		27.20	IS	1-9	1983
TOTAL ACRES:											TOTAL ACRES:											

RECEIVED
FEB 21 2023
OWRD

RECEIVED
JAN 23 2023
OWRD

14177

AUTHORIZED (the "from" or "off" lands) The listing that appears on the certificate BEFORE PROPOSED CHANGES List only that part or portion of the water right that will be changed.											Proposed Changes (see "CODES" from previous page)	PROPOSED (the "to" or "on" lands) The listing as it would appear AFTER PROPOSED CHANGES are made.												
Twp	Rng	Sec	¼ ¼	Tax Lot	Gvt Lot or DLC	Acres	Type of USE listed on Certificate	POD(s) or POA(s) (name or number from Table 1)	Priority Date	Twp		Rng	Sec	¼ ¼	Tax Lot	Gvt Lot or DLC	Acres	New Type of USE	POD(s)/POA(s) to be used (from Table 1)	Priority Date				
										APOA	28	S	14	E	12	SE	NE	100	14.60	IS	1-9	1983		
																NE	NW		39.10					
																NW	NW		40.00					
																SW	NW		38.80					
																SE	NW		28.50					
																NE	SW		38.50					
																NW	SW		33.40					
																SE	SW		11.00					
																13	SW	NE	1400	39.10				
																SE	NE		40.00					
																NE	SE		28.40					
																NW	SE		39.10					
																SW	SE		39.10					
TOTAL ACRES:											TOTAL ACRES:													

14179

AUTHORIZED (the "from" or "off" lands) The listing that appears on the certificate BEFORE PROPOSED CHANGES List only that part or portion of the water right that will be changed.										Proposed Changes (see "CODES" from previous page)	PROPOSED (the "to" or "on" lands) The listing as it would appear AFTER PROPOSED CHANGES are made.													
Twp	Rng	Sec	¼	¼	Tax Lot	Gvt Lot or DLC	Acres	Type of USE listed on Certificate	POD(s) or POA(s) (name or number from Table 1)		Priority Date	Twp	Rng	Sec	¼	¼	Tax Lot	Gvt Lot or DLC	Acres	New Type of USE	POD(s)/ POA(s) to be used (from Table 1)	Priority Date		
											APOA	28	S	14	E	13	SE	SE	1400		9.30	IS	1-9	1983
											APOA	28	S	14	E	14	NW	NE	1500		40.00	IS	1-9	1983
											APOA	28	S	14	E	14	SW	NE			40.00	IS	1-9	1983
											APOA	28	S	14	E	14	NE	NW			40.00	IS	1-9	1983
											APOA	28	S	14	E	14	NW	NW			27.30	IS	1-9	1983
											APOA	28	S	14	E	14	SW	NW			39.10	IS	1-9	1983
											APOA	28	S	14	E	14	SE	NW			40.00	IS	1-9	1983
											APOA	28	S	14	E	15	NE	NE	100		8.10	IS	1-9	1983
											APOA	28	S	14	E	15	NE	NE			31.00	IS	1-9	1983
											APOA	28	S	14	E	15	NW	NE			38.20	IS	1-9	1983
											APOA	28	S	14	E	15	SW	NE			9.60	IS	1-9	1983
											APOA	28	S	14	E	15	SW	NE			9.80	IS	1-9	1983
											APOA	28	S	14	E	15	SW	NE			18.50	IS	1-9	1983
TOTAL ACRES:											TOTAL ACRES:													

RECEIVED

JAN 23 2023

OWRD

RECEIVED

FEB 21 2023

OWRD

14177

AUTHORIZED (the "from" or "off" lands) The listing that appears on the certificate BEFORE PROPOSED CHANGES List only that part or portion of the water right that will be changed.											Proposed Changes (see "CODES" from previous page)	PROPOSED (the "to" or "on" lands) The listing as it would appear AFTER PROPOSED CHANGES are made.										
Twp	Rng	Sec	¼ ¼	Tax Lot	Gvt Lot or DLC	Acres	Type of USE listed on Certificate	POD(s) or POA(s) (name or number from Table 1)	Priority Date	Twp		Rng	Sec	¼ ¼	Tax Lot	Gvt Lot or DLC	Acres	New Type of USE	POD(s)/ POA(s) to be used (from Table 1)	Priority Date		
										APOA	28	S	14	E	15	SE	NE	100	0.50	IS	1-9	1983
										APOA	28	S	14	E	15	SE	NE		38.60	IS	1-9	1983
										APOA	28	S	14	E	15	SW	NW		4.20	IS	1-9	1983
										APOA	28	S	14	E	15	SE	NW		2.30	IS	1-9	1983
										APOA	28	S	14	E	15	SE	NW		22.80	IS	1-9	1983
										APOA	28	S	14	E	15	NE	SW		37.30	IS	1-9	1983
										APOA	28	S	14	E	15	NE	SW		2.70	IS	1-9	1983
										APOA	28	S	14	E	15	NW	SW		28.50	IS	1-9	1983
										APOA	28	S	14	E	15	SW	SW		31.90	IS	1-9	1983
										APOA	28	S	14	E	15	SE	SW		32.20	IS	1-9	1983
										APOA	28	S	14	E	15	SE	SW		6.80	IS	1-9	1983
										APOA	28	S	14	E	15	NE	SE		29.70	IS	1-9	1983
										APOA	28	S	14	E	15	NE	SE		5.00	IS	1-9	1983
TOTAL ACRES:												TOTAL ACRES:										

RECEIVED
JAN 23 2023
OWRD

RECEIVED
FEB 21 2023
OWRD

14177

AUTHORIZED (the "from" or "off" lands) The listing that appears on the certificate BEFORE PROPOSED CHANGES List only that part or portion of the water right that will be changed.											Proposed Changes (see "CODES" from previous page)	PROPOSED (the "to" or "on" lands) The listing as it would appear AFTER PROPOSED CHANGES are made.												
Twp	Rng	Sec	¼	¼	Tax Lot	Gvt Lot or DLC	Acres	Type of USE listed on Certificate	POD(s) or POA(s) (name or number from Table 1)	Priority Date		Twp	Rng	Sec	¼	¼	Tax Lot	Gvt Lot or DLC	Acres	New Type of USE	POD(s)/ POA(s) to be used (from Table 1)	Priority Date		
											APOA	28	S	14	E	15	NW	SE	100		2.60	IS	1-9	1983
											APOA	28	S	14	E	15	NW	SE			35.40	IS	1-9	1983
											APOA	28	S	14	E	15	SW	SE			29.20	IS	1-9	1983
											APOA	28	S	14	E	15	SW	SE			5.50	IS	1-9	1983
											APOA	28	S	14	E	15	SE	SE			2.00	IS	1-9	1983
											APOA	28	S	14	E	15	SE	SE			31.40	IS	1-9	1983
											APOA	28	S	14	E	22	NE	NE	100		30.20	IS	1-9	1983
											APOA	28	S	14	E	22	NW	NE			2.50	IS	1-9	1983
											APOA	28	S	14	E	22	NW	NE			17.40	IS	1-9	1983
											APOA	28	S	14	E	22	SW	NE			12.00	IS	1-9	1983
											APOA	28	S	14	E	22	SE	NE			1.00	IS	1-9	1983
											APOA	28	S	14	E	22	NE	NW			5.00	IS	1-9	1983
											APOA	28	S	14	E	22	SE	NW			16.50	IS	1-9	1983
TOTAL ACRES:												TOTAL ACRES:												

RECEIVED
FEB 21 2023
OWRD

RECEIVED
JAN 23 2023
OWRD

14179

AUTHORIZED (the "from" or "off" lands) The listing that appears on the certificate BEFORE PROPOSED CHANGES List only that part or portion of the water right that will be changed.										Proposed Changes (see "CODES" from previous page)	PROPOSED (the "to" or "on" lands) The listing as it would appear AFTER PROPOSED CHANGES are made.												
Twp	Rng	Sec	¼ ¼	Tax Lot	Gvt Lot or DLC	Acres	Type of USE listed on Certificate	POD(s) or POA(s) (name or number from Table 1)	Priority Date		Twp	Rng	Sec	¼ ¼	Tax Lot	Gvt Lot or DLC	Acres	New Type of USE	POD(s)/ POA(s) to be used (from Table 1)	Priority Date			
										APOA	28	S	14	E	24	NE	NE	1400		18.00	IS	1-9	1983
										APOA	28	S	14	E	24	NW	NE			32.50	IS	1-9	1983
										APOA	28	S	15	E	6	NW	NE	400	12	12.10	IS	1-9	1983
										APOA	28	S	15	E	6	NE	NW		1	9.90	IS	1-9	1983
										APOA	28	S	15	E	6	Nw	Nw		2	33.70	IS	1-9	1983
										APOA	28	S	15	E	6	Sw	Nw		3	24.0	IS	1-9	1983
										APOA	28	S	15	E	6	Se	Nw		4	2.00	IS	1-9	1983
										APOA	28	S	15	E	6	Nw	Sw		6	27.70	IS	1-9	1983
										APOA	28	S	15	E	6	Sw	Sw		7	28.30	IS	1-9	1983
										APOA	28	S	15	E	7	Ne	Ne			13.10	IS	1-9	1983
										APOA	28	S	15	E	7	Nw	Ne			4.00	IS	1-9	1983
										APOA	28	S	15	E	7	Sw	Ne			33.20	IS	1-9	1983
										APOA	28	S	15	E	7	Se	Ne			36.00	IS	1-9	1983
TOTAL ACRES:											TOTAL ACRES:												

RECEIVED
FEB 21 2023
OWRD

RECEIVED
JAN 23 2023
OWRD

14177

AUTHORIZED (the "from" or "off" lands) The listing that appears on the certificate BEFORE PROPOSED CHANGES List only that part or portion of the water right that will be changed.											Proposed Changes (see "CODES" from previous page)	PROPOSED (the "to" or "on" lands) The listing as it would appear AFTER PROPOSED CHANGES are made.											
Twp	Rng	Sec	¼ ¼	Tax Lot	Gvt Lot or DLC	Acres	Type of USE listed on Certificate	POD(s) or POA(s) (name or number from Table 1)	Priority Date	Twp		Rng	Sec	¼ ¼	Tax Lot	Gvt Lot or DLC	Acres	New Type of USE	POD(s)/ POA(s) to be used (from Table 1)	Priority Date			
										APOA	28	S	15	E	7	NE	NW	400		22.50	IS	1-9	1983
										APOA	28	S	15	E	7	NW	NW		1	31.00	IS	1-9	1983
										APOA	28	S	15	E	7	SW	NW		2	35.00	IS	1-9	1983
										APOA	28	S	15	E	7	SE	NW			34.20	IS	1-9	1983
										APOA	28	S	15	E	7	NE	SW			34.10	IS	1-9	1983
										APOA	28	S	15	E	7	NW	SW		3	19.60	IS	1-9	1983
										APOA	28	S	15	E	7	SW	SW		4	15.70	IS	1-9	1983
										APOA	28	S	15	E	7	SE	SW			25.60	IS	1-9	1983
										APOA	28	S	15	E	7	NE	SE			40.00	IS	1-9	1983
										APOA	28	S	15	E	7	NW	SE			40.00	IS	1-9	1983
										APOA	28	S	15	E	7	SW	SE			40.00	IS	1-9	1983
										APOA	28	S	15	E	7	SE	SE			33.70	IS	1-9	1983
										APOA	28	S	15	E	8	NW	NW		1	23.40	IS	1-9	1983
TOTAL ACRES:												TOTAL ACRES:											

14177

RECEIVED
FEB 21 2023
OWRD

RECEIVED
JAN 23 2023
OWRD

AUTHORIZED (the "from" or "off" lands) The listing that appears on the certificate BEFORE PROPOSED CHANGES List only that part or portion of the water right that will be changed.											Proposed Changes (see "CODES" from previous page)	PROPOSED (the "to" or "on" lands) The listing as it would appear AFTER PROPOSED CHANGES are made.												
Twp	Rng	Sec	¼	¼	Tax Lot	Gvt Lot or DLC	Acres	Type of USE listed on Certificate	POD(s) or POA(s) (name or number from Table 1)	Priority Date		Twp	Rng	Sec	¼	¼	Tax Lot	Gvt Lot or DLC	Acres	New Type of USE	POD(s)/ POA(s) to be used (from Table 1)	Priority Date		
											APOA	28	S	15	E	8	SW	NW	400	2	26.20	IS	1-9	1983
											APOA	28	S	15	E	8	NE	SW		3	27.10	IS	1-9	1983
											APOA	28	S	15	E	8	NW	SW		4	19.30	IS	1-9	1983
											APOA	28	S	15	E	17	NW	NW		1	5.40	IS	1-9	1983
											APOA	28	S	15	E	17	NW	NW		9	11.50	IS	1-9	1983
											APOA	28	S	15	E	17	SW	NW		8	0.40	IS	1-9	1983
											APOA	28	S	15	E	17	SW	NW		2	15.20	IS	1-9	1983
											APOA	28	S	15	E	18	NE	NE	120		9.10	IS	1-9	1983
											APOA	28	S	15	E	18	NW	NE		39.80	IS	1-9	1983	
											APOA	28	S	15	E	18	SW	NE		40.0	IS	1-9	1983	
											APOA	28	S	15	E	18	SE	NE		10.50	IS	1-9	1983	
											APOA	28	S	15	E	18	NE	NW		32.70	IS	1-9	1983	
											APOA	28	S	15	E	18	NW	NW	1	13.50	IS	1-9	1983	
TOTAL ACRES:												TOTAL ACRES:												

RECEIVED
FEB 21 2023
OWRD

RECEIVED
JAN 23 2023
OWRD

14177

AUTHORIZED (the "from" or "off" lands) The listing that appears on the certificate BEFORE PROPOSED CHANGES List only that part or portion of the water right that will be changed.											Proposed Changes (see "CODES" from previous page)	PROPOSED (the "to" or "on" lands) The listing as it would appear AFTER PROPOSED CHANGES are made.											
Twp	Rng	Sec	¼ ¼	Tax Lot	Gvt Lot or DLC	Acres	Type of USE listed on Certificate	POD(s) or POA(s) (name or number from Table 1)	Priority Date	Twp		Rng	Sec	¼ ¼	Tax Lot	Gvt Lot or DLC	Acres	New Type of USE	POD(s)/ POA(s) to be used (from Table 1)	Priority Date			
										APOA	28	S	15	E	18	SW	NW	1200	2	39.97	IS	1-9	1983
										APOA	28	S	15	E	18	SE	NW			32.90	IS	1-9	1983
TOTAL ACRES:												TOTAL ACRES:						4000.49					

Additional remarks: **No change of place of use proposed. Only additional POAs are proposed..**

RECEIVED
FEB 21 2023
OWRD

RECEIVED
JAN 23 2023
OWRD

14177

For Place of Use or Character of Use Changes

Are there other water right certificates, water use permits or ground water registrations associated with the “from” or the “to” lands? Yes No

If YES, list the certificate, water use permit, or ground water registration numbers: Silver Creek Decree (V9, P253), 2060, 8569, 8571, 8582, 37617, 44111, 60692, 86158, 86159, 91055, 91056 and S55013..



Pursuant to ORS 540.510, any “layered” water use such as an irrigation right that is supplemental to a primary right proposed for transfer must be included in the transfer or be cancelled. Any change to a ground water registration must be filed separately in a ground water registration modification application.

For Substitution (ground water supplemental irrigation will be substituted for surface water primary irrigation)

Ground water supplemental Permit or Certificate # _____;
Surface water primary Certificate # _____.

RECEIVED

FEB 21 2023 RECEIVED

For a change from Supplemental Irrigation Use to Primary Irrigation Use

Identify the primary certificate to be cancelled. Certificate # _____

OWRD JAN 23 2023

OWRD

For a change in point(s) of appropriation (well(s)) or additional point(s) of appropriation:

Well log(s) are attached for each authorized and proposed well(s) that are clearly labeled and associated with the corresponding well(s) in Table 1 above and on the accompanying application map.

Tip: You may search for well logs on the Department’s web page at:
http://apps.wrd.state.or.us/apps/gw/well_log/Default.aspx

AND/OR

Describe the construction of the authorized and proposed well(s) in Table 3 for any wells that do not have a well log. For *proposed wells not yet constructed or built*, provide “a best estimate” for each requested information element in the table. The Department recommends you consult a licensed well driller, geologist, or certified water right examiner to assist with assembling the information necessary to complete Table 3.

Table 3. Construction of Point(s) of Appropriation

Any well(s) in this listing must be clearly tied to corresponding well(s) described in Table 1 and shown on the accompanying application map. Failure to provide the information will delay the processing of your transfer application until it is received. The information is necessary for the department to assess whether the proposed well(s) will access the same source aquifer as the authorized point(s) of appropriation (POA). The Department is prohibited by law from approving POA changes that do not access the same source aquifer.

Proposed or Authorized POA Name or Number	Is well already built? (Yes or No)	If an existing well: OWRD Well ID Tag No. L-_____	Total well depth	Casing Diameter	Casing Intervals (feet)	Seal depth(s) (intervals)	Perforated or screened intervals (in feet)	Static water level of completed well (in feet)	Source aquifer (sand, gravel, basalt, etc.)	Well -specific rate (cfs or gpm). If less than full rate of water right
#7	no	n/a	400'	16"	+1 to 150'	0 to -150	NA	60'	Basalt	
#8	no	n/a	400'	16"	+1 to 150'	0 to -150	NA	60'	Basalt	
#9	no	n/a	400'	16"	+1 to 150'	0 to -150	NA	60'	Basalt	

14177

Application for Water Right Transfer

Evidence of Use Affidavit



Oregon Water Resources Department
 725 Summer Street NE, Suite A
 Salem, Oregon 97301-1266
 (503) 986-0900
 www.wrd.state.or.us

Please print legibly or type. Be as specific as possible. Attach additional pages if you need more spacing.
 Supporting documentation must be attached.

State of Oregon)
) ss
 County of ~~Harney~~ *lake*

I, THERESA CLIFF, in my capacity as OWNER/WATER RIGHT HOLDER,
 mailing address P.O. Box 97, LA PINE, OR 97739
 telephone number (541)433-2556, being first duly sworn depose and say:

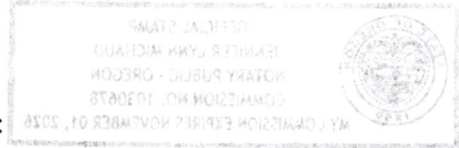

1. My knowledge of the exercise or status of the water right is based on (check one):

- Personal observation Professional expertise

RECEIVED
 JAN 23 2023
 OWRD

2. I attest that:

Water was used during the previous five years on the **entire** place of use for Certificate # 89345; **OR**

My knowledge is specific to the use of water at the following locations within the last five years:

Certificate #	Township	Range	Mer	Sec	¼ ¼	Gov't Lot or DLC	Acres (if applicable)

RECEIVED
 FEB 21 2023
 OWRD

OR

- Confirming Certificate # _____ has been issued within the past five years; **OR**
- Part or all of the water right was leased instream at some time within the last five years. The instream lease number is: _____ (Note: If the entire right proposed for transfer was not leased, additional evidence of use is needed for the portion not leased instream.); **OR**
- The water right is not subject to forfeiture and documentation that a presumption of forfeiture for non-use would be rebutted under ORS 540.610(2) is attached.
- Water has been used at the actual current point of diversion or appropriation for more than 10 years for Certificate # _____ (For Historic POD/POA Transfers)

(continues on reverse side)

3. The water right was used for: (e.g., crops, pasture, etc.): CROPS AND PASTURE
4. I understand that if I do not attach one or more of the documents shown in the table below to support the above statements, my application will be considered incomplete.

[Signature]
 Signature of Affiant

12/22/22
 Date

Signed and sworn to (or affirmed) before me this 23rd day of December, 2022.

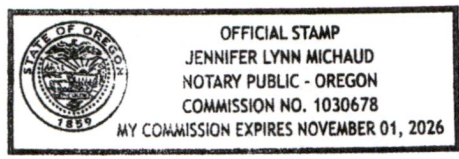

[Signature]
 Notary Public for Oregon
 My Commission Expires: 11/1/2024

Supporting Documents	Examples
<input type="checkbox"/> Copy of a water right certificate that has been issued within the last five years. (not a remaining right certificate)	Copy of confirming water right certificate that shows issue date
<input type="checkbox"/> Copies of receipts from sales of irrigated crops or for expenditures related to use of water	<ul style="list-style-type: none"> • Power usage records for pumps associated with irrigation use • Fertilizer or seed bills related to irrigated crops • Farmers Co-op sales receipt
<input type="checkbox"/> Records such as FSA crop reports, irrigation district records, NRCS farm management plan, or records of other water suppliers	<ul style="list-style-type: none"> • District assessment records for water delivered • Crop reports submitted under a federal loan agreement • Beneficial use reports from district • IRS Farm Usage Deduction Report • Agricultural Stabilization Plan • CREP Report
<input checked="" type="checkbox"/> Aerial photos containing sufficient detail to establish location and date of photograph	<p>Multiple photos can be submitted to resolve different areas of a water right. If the photograph does not print with a "date stamp" or without the source being identified, the date of the photograph and source should be added.</p> <p>Sources for aerial photos: OSU – www.oregonexplorer.info/imagery OWRD – www.wrd.state.or.us Google Earth – earth.google.com TerraServer – www.terra-server.com</p>
<input type="checkbox"/> Approved Lease establishing beneficial use within the last 5 years	Copy of instream lease or lease number

RECEIVED
 FEB 21 2023
 OWRD
 RECEIVED
 JAN 23 2023
 OWRD

Certificate 89345 Place of Use

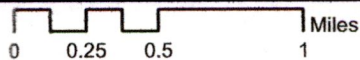
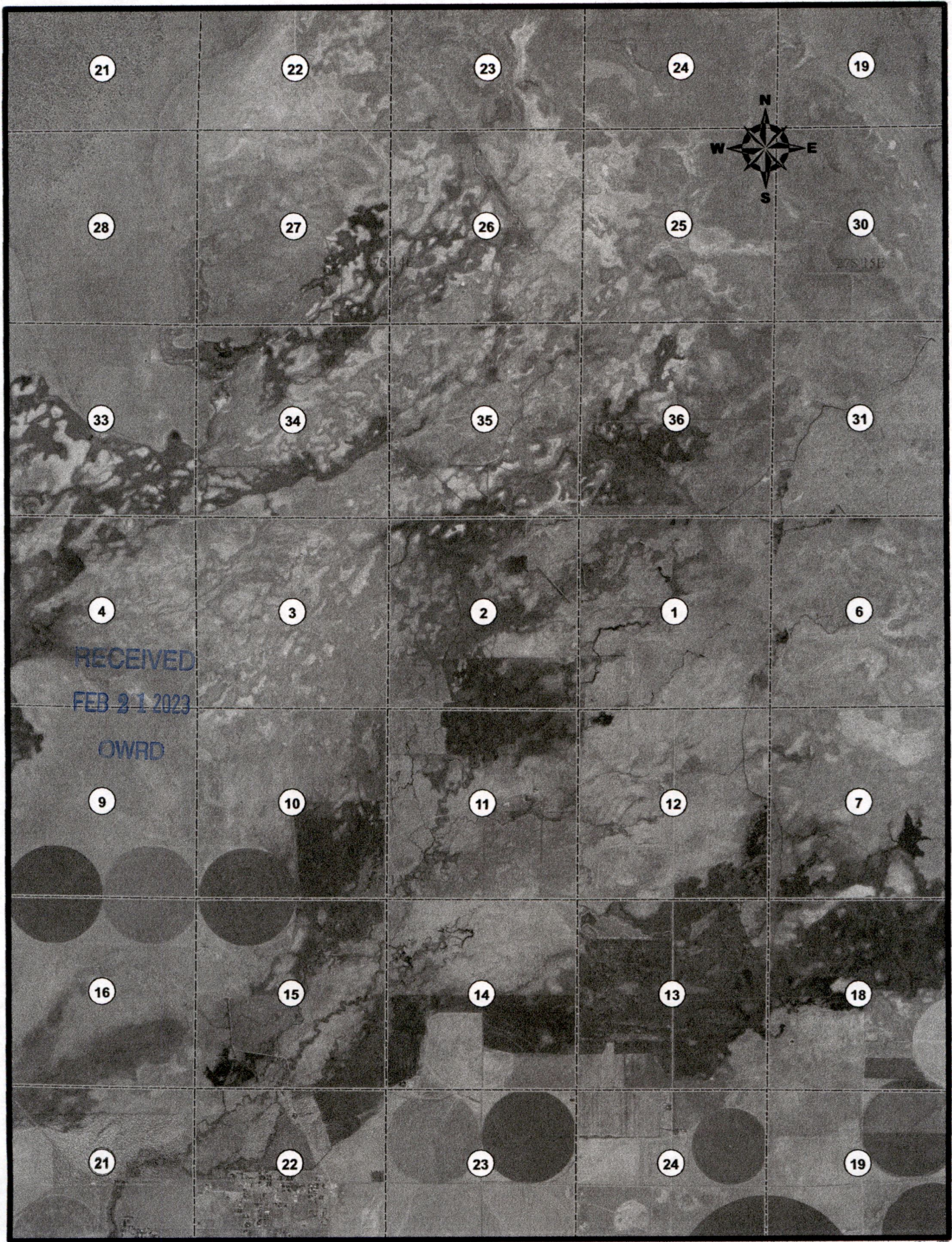

14177

Feb 14, 2023

OWRD,

Please find the enclosed a aerial photo for the application, certificate 89345,

According to my water rights examiner, Evidence of Use Affidavit states, "time and location stamped photo's of irrigation system demonstrating the ability to irrigate the place of use will be provided upon request. We only have to show the ability to irrigate since these are supplemental rights.

Sincerely

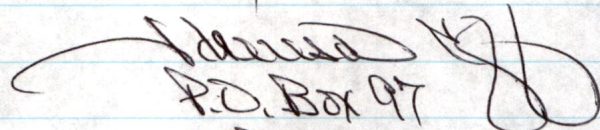
P.O. Box 97
LaPine, Oregon 97739

RECEIVED

FEB 21 2023

OWRD

14177

=

ESP M 2023

DWR

Please find the enclosed aerial photo for the application for the site. The application is for a residential development. The site is located on the corner of Main Street and 1st Street. The site is currently vacant. The proposed development consists of 10 residential units. The site is zoned R-1. The proposed development is consistent with the zoning. The site is located in a residential neighborhood. The proposed development is a single-story building. The site is located on a corner lot. The proposed development is a residential development. The site is located on the corner of Main Street and 1st Street. The site is currently vacant. The proposed development consists of 10 residential units. The site is zoned R-1. The proposed development is consistent with the zoning. The site is located in a residential neighborhood. The proposed development is a single-story building. The site is located on a corner lot. The proposed development is a residential development.

Sincerely,

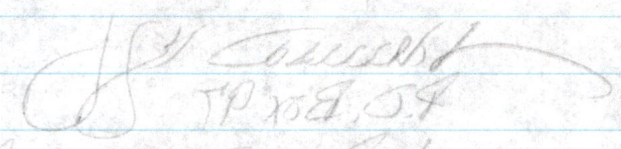

J. J. [unclear]
 P.O. Box 123
 Irvine, CA 92614

RECEIVED
 FEB 2 2023
 MAIL

Land Use Information Form



Oregon Water Resources Department
725 Summer Street NE, Suite A
Salem, Oregon 97301-1266
(503) 986-0900
www.oregon.gov/OWRD

RECEIVED

JAN 23 2023

OWRD

NOTE TO APPLICANTS

In order for your application to be processed by the Water Resources Department (WRD), this Land Use Information Form must be completed by a local government planning official in the jurisdiction(s) where your water right will be used and developed. The planning official may choose to complete the form while you wait, or return the receipt stub to you. Applications received by WRD without the Land Use Form or the receipt stub will be returned to you. Please be aware that your application will not be approved without land use approval.

This form is NOT required if:

- 1) Water is to be diverted, conveyed, and/or used only on federal lands; **OR**
- 2) The application is for a water right transfer, allocation of conserved water, exchange, permit amendment, or ground water registration modification, and **all** of the following apply:
 - a) The existing and proposed water use is located entirely within lands zoned for exclusive farm-use or within an irrigation district;
 - b) The application involves a change in place of use only;
 - c) The change does not involve the placement or modification of structures, including but not limited to water diversion, impoundment, distribution facilities, water wells and well houses; **and**
 - d) The application involves irrigation water uses only.

RECEIVED

FEB 21 2023

OWRD

NOTE TO LOCAL GOVERNMENTS

The person presenting the attached Land Use Information Form is applying for or modifying a water right. The Water Resources Department (WRD) requires its applicants to obtain land-use information to be sure the water rights do not result in land uses that are incompatible with your comprehensive plan. Please complete the form or detach the receipt stub and return it to the applicant for inclusion in their water right application. You will receive notice once the applicant formally submits his or her request to the WRD. The notice will give more information about WRD's water rights process and provide additional comment opportunities. You will have 30 days from the date of the notice to complete the land-use form and return it to the WRD. If no land-use information is received from you within that 30-day period, the WRD may presume the land use associated with the proposed water right is compatible with your comprehensive plan. Your attention to this request for information is greatly appreciated by the Water Resources Department. If you have any questions concerning this form, please contact the WRD's Customer Service Group at 503-986-0801.

Land Use Information Form



Oregon Water Resources Department
 725 Summer Street NE, Suite A
 Salem, Oregon 97301-1266
 (503) 986-0900
 www.oregon.gov/OWRD

Applicant(s): Bell A Land and Cattle Co., Inc.

Mailing Address: P.O. Box 97

City: La Pine

State: OR

Zip Code: 97739

Daytime Phone: 541-433-2556

A. Land and Location

Please include the following information for all tax lots where water will be diverted (taken from its source), conveyed (transported), and/or used or developed. Applicants for municipal use, or irrigation uses within irrigation districts may substitute existing and proposed service-area boundaries for the tax-lot information requested below.

Township	Range	Section	Tax Lot #	Plan Designation (e.g., Rural Residential/RR-5)	Water to be:	Proposed Land Use:
<u>27S</u>	<u>15E</u>	<u>19, 30, & 31</u>	<u>3600, 4800, & 4900</u>	<u>EFU</u>	<input type="checkbox"/> Diverted <input checked="" type="checkbox"/> Conveyed <input checked="" type="checkbox"/> Used	<u>farming</u>
<u>28S</u>	<u>14E</u>	<u>1, 2, 10-15, & 24</u>	<u>100, 1100, 1400, & 3000</u>	<u>EFU</u>	<input checked="" type="checkbox"/> Diverted <input checked="" type="checkbox"/> Conveyed <input checked="" type="checkbox"/> Used	<u>farming</u>
<u>28S</u>	<u>14E</u>	<u>22</u>	<u>100</u>	<u>EFU</u>	<input checked="" type="checkbox"/> Diverted <input checked="" type="checkbox"/> Conveyed <input checked="" type="checkbox"/> Used	<u>farming</u>
<u>28S</u>	<u>15E</u>	<u>5-8, 17, & 18</u>	<u>400 & 1200</u>	<u>EFU</u>	<input checked="" type="checkbox"/> Diverted <input checked="" type="checkbox"/> Conveyed <input checked="" type="checkbox"/> Used	<u>farming</u>

RECEIVED
 FEB 21 2023
 OWRD

List all counties and cities where water is proposed to be diverted, conveyed, and/or used or developed:

Lake

RECEIVED
 JAN 23 2023
 OWRD

B. Description of Proposed Use

Type of application to be filed with the Water Resources Department:

- Permit to Use or Store Water Water Right Transfer Permit Amendment or Ground Water Registration Modification
 Limited Water Use License Allocation of Conserved Water Exchange of Water

Source of water: Reservoir/Pond Ground Water Surface Water (name) _____

Estimated quantity of water needed: 19.81 cubic feet per second gallons per minute acre-feet

Intended use of water: Irrigation Commercial Industrial Domestic for _____ household(s)
 Municipal Quasi-Municipal Instream Other _____

Briefly describe:

Adding 4 wells to existing certificated water right

Note to applicant: If the Land Use Information Form cannot be completed while you wait, please have a local government representative sign the receipt at the bottom of the next page and include it with the application filed with the Water Resources Department.

See bottom of Page 3. →

For Local Government Use Only

The following section must be completed by a planning official from each county and city listed unless the project will be located entirely within the city limits. In that case, only the city planning agency must complete this form. This deals only with the local land-use plan. Do not include approval for activities such as building or grading permits.

Please check the appropriate box below and provide the requested information

- Land uses to be served by the proposed water uses (including proposed construction) are allowed outright or are not regulated by your comprehensive plan. Cite applicable ordinance section(s): Yavapai County Zoning Ordinance - Article 2 + 3 (A-1 + A-2)
- Land uses to be served by the proposed water uses (including proposed construction) involve discretionary land-use approvals as listed in the table below. (Please attach documentation of applicable land-use approvals which have already been obtained. Record of Action/land-use decision and accompanying findings are sufficient.) **If approvals have been obtained but all appeal periods have not ended, check "Being pursued."**

Type of Land-Use Approval Needed (e.g., plan amendments, rezones, conditional-use permits, etc.)	Cite Most Significant, Applicable Plan Policies & Ordinance Section References	Land-Use Approval:	
		<input type="checkbox"/> Obtained <input type="checkbox"/> Denied	<input type="checkbox"/> Being Pursued <input type="checkbox"/> Not Being Pursued
		<input type="checkbox"/> Obtained <input type="checkbox"/> Denied	<input type="checkbox"/> Being Pursued <input type="checkbox"/> Not Being Pursued
		<input type="checkbox"/> Obtained <input type="checkbox"/> Denied	<input type="checkbox"/> Being Pursued <input type="checkbox"/> Not Being Pursued
		<input type="checkbox"/> Obtained <input type="checkbox"/> Denied	<input type="checkbox"/> Being Pursued <input type="checkbox"/> Not Being Pursued
		<input type="checkbox"/> Obtained <input type="checkbox"/> Denied	<input type="checkbox"/> Being Pursued <input type="checkbox"/> Not Being Pursued
		<input type="checkbox"/> Obtained <input type="checkbox"/> Denied	<input type="checkbox"/> Being Pursued <input type="checkbox"/> Not Being Pursued

Local governments are invited to express special land-use concerns or make recommendations to the Water Resources Department regarding this proposed use of water below, or on a separate sheet.

Beck A Land + Cattle Co. Inc.
27-15 - (3600, 4800, 4900)
28-14 - (100, 1100, 1400, 3000)
28-15 - (400, 1200)

Name: Diana Johnson Title: Planning Director
 Signature: [Signature] Phone: 541-947-6036 Date: 28 Nov 2022
 Government Entity: LARS County Planning Department

RECEIVED
 FEB 21 2023
 OWRD

Note to local government representative: Please complete this form or sign the receipt below and return it to the applicant. If you sign the receipt, you will have 30 days from the Water Resources Department's notice date to return the completed Land Use Information Form or WRD may presume the land use associated with the proposed use of water is compatible with local comprehensive plans.

Receipt for Request for Land Use Information

Applicant name: _____
 City or County: _____ Staff contact: _____
 Signature: _____ Phone: _____ Date: _____

RECEIVED
 JAN 23 2023
 OWRD
 WR / FS

NOTICE TO WATER WELL CONTRACTOR

The original and first copy of this report are to be filed with the

RECEIVED WATER WELL REPORT
 STATE OF OREGON
 (Please type or print)
 not write above this line

STATE ENGINEER, SALEM, OREGON 97330
 within 30 days from the date of well completion

State Well No. 28/14-15
 State Permit No. _____

Lake 1245
 G-5762

10cc
 28/14-15

(1) OWNER:

Name CAMERON CLIFF
 Address LAPINE ORE

(2) TYPE OF WORK (check):

New Well Deepening Reconditioning Abandon
 If abandonment, describe material and procedure in Item 12.

(3) TYPE OF WELL:

Rotary Driven
 Cable Jetted
 Dug Bored

(4) PROPOSED USE (check):

Domestic Industrial Municipal
 Irrigation Test Well Other

CASING INSTALLED:

Threaded Welded
1 3/4" Diam. from 0 ft. to 120 ft. Gage 1/4 IN.
1 1/4" Diam. from 0 ft. to 120 ft. Gage 1/4 IN.

PERFORATIONS:

Perforated? Yes No
 Type of perforator used CUTTING TORCH
 Size of perforations 3/8 in. by 3 in.
 perforations from 100 ft. to 120 ft.
 perforations from _____ ft. to _____ ft.
 perforations from _____ ft. to _____ ft.
 perforations from _____ ft. to _____ ft.

(7) SCREENS:

Well screen installed? Yes No
 Manufacturer's Name _____
 Type _____ Model No. _____
 Diam. _____ Slot size _____ Set from _____ ft. to _____ ft.
 Diam. _____ Slot size _____ Set from _____ ft. to _____ ft.

(8) WATER LEVEL: Completed well.

Static level 30 ft. below land surface Date 9-30-70
 Barometric pressure _____ lbs. per square inch Date _____

(9) WELL TESTS:

Drawdown is amount water level is lowered below static level
 Was a pump test made? Yes No If yes, by whom?
 Yield: _____ gal./min. with _____ ft. drawdown after _____ hrs.

air blow test

Bailer test 1000 gal./min. with 0 ft. drawdown after 3 hrs.
 Artesian flow _____ g.p.m. Date _____

Temperature of water 50 Was a chemical analysis made? Yes No

(10) CONSTRUCTION:

Well seal—Material used CEMENT + BENTONITE
 Depth of seal _____ ft.
 Diameter of well bore to bottom of seal 2 1/2 in.
 Were any loose strata cemented off? Yes No Depth _____
 Was a drive shoe used? Yes No
 Did any strata contain unusable water? Yes No
 Type of water? _____ depth of strata _____
 Method of sealing strata off _____
 Was well gravel packed? Yes No Size of gravel: _____
 Gravel placed from _____ ft. to _____ ft.

(11) LOCATION OF WELL:

County LAKE Driller's well number _____
NE 1/4 NW 1/4 Section 15 T. 28 S. R. 14 E W.M.
 Bearing and distance from section or subdivision corner _____

(12) WELL LOG:

Diameter of well below casing 14 IN.
 Depth drilled 405 ft. Depth of completed well 405 ft.
 Formation: Describe color, texture, grain size and structure of materials; and show thickness and nature of each stratum and aquifer penetrated, with at least one entry for each change of formation. Report each change in position of Static Water Level as drilling proceeds. Note drilling rates.

MATERIAL	From	To	SWL
SOFT SANDY LOAM	0	5	
HARD BROWN CLAY	5	69	
DRY BLACK SAND	69	71	
SOFT BROWN CLAY	71	90	
HARD BROWN CLAY	90	95	
COARSE BLACK SAND	95	98	
BLUE CLAY SOFT	98	110	
COARSE BLACK SAND	110	114	
SOFT GREY CLAY	114	138	
SOFT BLUE CLAY	138	160	
BLACK SAND COARSE	160	164	
HARD BROWN CLAY	164	199	
COARSE BROWN SAND	199	201	
SOFT BROWN CLAY	201	230	
FINE RED SANDERS	230	234	
HARD RED CLAY	234	251	
HARD BROWN CLAY	251	267	
FINE BROWN SAND	267	269	
HARD BLUE CLAY STONE	269	285	
COARSE BLUE SAND	285	288	
HARD BROWN CLAY	288	371	
FINE BLACK GRAVEL	371	375	

Work started 4-9 1970 Completed 9-30 1970
 Date well drilling machine moved off of well 9-30 1970

Drilling Machine Operator's Certification:

This well was constructed under my direct supervision. Materials used and information reported above are true to my best knowledge and belief.

[Signed] Silas Blaylock Date 10-28, 1970
 (Drilling Machine Operator)

Drilling Machine Operator's License No. 383

Water Well Contractor's Certification:

This well was drilled under my jurisdiction and this report is true to the best of my knowledge and belief.

NAME SILAS BLAYLOCK
 (Person, firm or corporation) (Type or print)

Address SILVER LAKE OREGON

[Signed] Silas Blaylock 43
 (Water Well Contractor)

Contractor's License No. 425 Date 10-28, 1970

RECEIVED
 FEB 21 2023

RECEIVED
 JAN 23 2023
 OWFD

RECEIVED
 JUN 27 2022

NOTICE TO WATER WELL CONTRACTOR
 The original and first copy of this report are to be filed with the
STATE ENGINEER, SALEM, OREGON
 within 30 days from the date of well completion.

RECEIVED
 OCT 30 1970
STATE ENGINEER
 SALEM, OREGON

WATER WELL REPORT
 STATE OF OREGON
 (Please type or print)
 (Do not write above this line)

10ccc
 28/14-156A
 State Well No. _____
 State Permit No. _____

(1) OWNER:

Name _____
 Address _____

(2) TYPE OF WORK (check):

New Well Deepening Reconditioning Abandon

If abandonment, describe material and procedure in Item 12.

(3) TYPE OF WELL:

Rotary Driven
 Cable Jetted
 Dug Bored

(4) PROPOSED USE (check):

Domestic Industrial Municipal
 Irrigation Test Well Other

CASING INSTALLED:

Threaded Welded

_____ " Diam. from _____ ft. to _____ ft. Gage _____
 _____ " Diam. from _____ ft. to _____ ft. Gage _____
 _____ " Diam. from _____ ft. to _____ ft. Gage _____

PERFORATIONS:

Perforated? Yes No.

Type of perforator used _____

Size of perforations	in.	by	in.
_____ perforations from _____	ft.	to _____	ft.
_____ perforations from _____	ft.	to _____	ft.
_____ perforations from _____	ft.	to _____	ft.
_____ perforations from _____	ft.	to _____	ft.
_____ perforations from _____	ft.	to _____	ft.

(7) SCREENS:

Well screen installed? Yes No

Manufacturer's Name _____
 Type _____ Model No. _____
 Diam. _____ Slot size _____ Set from _____ ft. to _____ ft.
 Diam. _____ Slot size _____ Set from _____ ft. to _____ ft.

(8) WATER LEVEL: Completed well.

Static level _____ ft. below land surface Date _____
 Artesian pressure _____ lbs. per square inch Date _____

(9) WELL TESTS:

Drawdown is amount water level is lowered below static level

Was a pump test made? Yes No If yes, by whom? _____
 Yield: _____ gal./min. with _____ ft. drawdown after _____ hrs.

Baller test _____ gal./min. with _____ ft. drawdown after _____ hrs.
 Artesian flow _____ g.p.m. Date _____
 Temperature of water _____ Was a chemical analysis made? Yes No

(10) CONSTRUCTION:

Well seal—Material used _____
 Depth of seal _____ ft.
 Diameter of well bore to bottom of seal _____ in.
 Were any loose strata cemented off? Yes No Depth _____
 Was a drive shoe used? Yes No
 Did any strata contain unusable water? Yes No
 Type of water? _____ depth of strata _____
 Method of sealing strata off _____
 Was well gravel packed? Yes No Size of gravel: _____
 Gravel placed from _____ ft. to _____ ft.

(11) LOCATION OF WELL:

County _____ Driller's well number _____
 _____ ¼ _____ ¼ Section T. R. W.M.
 Bearing and distance from section or subdivision corner _____

(12) WELL LOG:

Diameter of well below casing _____

Depth drilled _____ ft. Depth of completed well _____ ft.

Formation: Describe color, texture, grain size and structure of materials; and show thickness and nature of each stratum and aquifer penetrated, with at least one entry for each change of formation. Report each change in position of Static Water Level as drilling proceeds. Note drilling rates.

MATERIAL	From	To	SWL
HARD GREY CLAY	375	380	
FINE GREY GRAVEL	390	392	
HARD GREY CLAY	392	403	
COARSE GREY SAND	403	405	

RECEIVED
 FEB 21 2023
 RECEIVED
 OWRD
 JUN 27 2022
 RECEIVED
 OWRD
 JAN 23 2023
 OWRD

Work started _____ 19 Completed _____ 19
 Date well drilling machine moved off of well _____ 19

Drilling Machine Operator's Certification:
 This well was constructed under my direct supervision. Materials used and information reported above are true to my best knowledge and belief.

[Signed] _____ Date _____, 19____
 (Drilling Machine Operator)

Drilling Machine Operator's License No. _____

Water Well Contractor's Certification:
 This well was drilled under my jurisdiction and this report is true to the best of my knowledge and belief.

NAME _____
 (Person, firm or corporation) (Type or print)

Address _____

[Signed] _____
 (Water Well Contractor)

Contractor's License No. _____ Date _____, 19____

The original and first copy of this report are to be filed with the

RECEIVED WATER WELL REPORT RECEIVED

WATER RESOURCES DEPARTMENT
SALEM, OREGON 97310
within 30 days from the date
of well completion

JUN 1 1981

STATE OF OREGON

MAR 17 1981

State Well No. 285/14E-15bc

State Permit No.

G-10662

SALEM, OREGON

SALEM, OREGON

(1) OWNER:

Name CAMERON CLIFF
Address DIAMOND 13AA RANCH
SILVER LAKE OREGON 97638

(10) LOCATION OF WELL:

County LAKE Driller's well number 1
NE 1/4 NE 1/4 Section 15 T. 27S R. 14E W.M.
Bearing and distance from section or subdivision corner

(2) TYPE OF WORK (check):

New Well Deepening Reconditioning Abandon
If abandonment, describe material and procedure in Item 12.

(3) TYPE OF WELL:

Rotary Cable Dug
Driven Jetted Bored

(4) PROPOSED USE (check):

Domestic Industrial Municipal
Irrigation Test Well Other

CASING INSTALLED:

Threaded Welded
14" Diam. from 0 ft. to 80 ft. Gage 0.250
" Diam. from ft. to ft. Gage
" Diam. from ft. to ft. Gage

PERFORATIONS:

Perforated? Yes No.

Type of perforator used

Size of perforations in. by in.
perforations from ft. to ft.
perforations from ft. to ft.
perforations from ft. to ft.

(7) SCREENS:

Well screen installed? Yes No

Manufacturer's Name
Type Model No.
Diam. Slot size Set from ft. to ft.
Diam. Slot size Set from ft. to ft.

(8) WELL TESTS:

Drawdown is amount water level is lowered below static level.

Was a pump test made? Yes No INTERSTATE PUMP CO
Yield: 2600 gal./min. with 45 ft. drawdown after 8 hrs.
" " " " " " " "
" " " " " " " "
Bailer test gal./min. with ft. drawdown after hrs.
Artesian flow g.p.m.

(9) CONSTRUCTION:

Well seal—Material used CEMENT GROUT
Well sealed from land surface to 33 ft.
Diameter of well bore to bottom of seal 18 in.
Diameter of well bore below seal 14" in.
Number of sacks of cement used in well seal 47 sacks
How was cement grout placed?
WESTERN WELL CO GROUT
PUMP
Was a drive shoe used? Yes No Plugs Size: location ft.
Did any strata contain unusable water? Yes No
Type of water? GOOD depth of strata 45 FT
Method of sealing strata off 150 FT TO 195
Was well gravel packed? Yes No Size of gravel:
Gravel placed from ft. to ft.

(11) WATER LEVEL: Completed well.

Depth at which water was first found 65 ft.
Static level 44 ft. below land surface. Date 3/24/81
Artesian pressure lbs. per square inch. Date

(12) WELL LOG:

Diameter of well below casing 13 7/8
Depth drilled 428 ft. Depth of completed well 428 ft.

Formation: Describe color, texture, grain size and structure of materials; and show thickness and nature of each stratum and aquifer penetrated, with at least one entry for each change of formation. Report each change in position of Static Water Level and indicate principal water-bearing strata.

MATERIAL	From	To	SWL
BROWN CLAY	0	20	
SANDSTONE	20	25	
BROWN CLAY	25	65	
SAND & GRAVEL	65	75	
BROWN CLAY	75	143	
HARD ROCK	143	150	
WB BLACK SANDSTONE	150	195	44
HARD BASALT	195	230	
BROKEN ROCK	230	315	
HARD BASALT	315	380	
MEDIUM BASALT	380	415	
BROKEN ROCK	415	428	

ALL WATER WAS FOUND BETWEEN 180 and 195 FT. WATER AT 65 FT SEALED OFF WITH CASING

Work started 3/17 1980 Completed 9/26, 1980
Date well drilling machine moved off of well 9/26, 1980

Drilling Machine Operator's Certification:

This well was constructed under my direct supervision. Materials used and information reported above are true to my best knowledge and belief.

[Signed] [Signature] Date 9/26, 1980
(Drilling Machine Operator)

Drilling Machine Operator's License No. 1323

Water Well Contractor's Certification:

This well was drilled under my jurisdiction and this report is true to the best of my knowledge and belief.

Name LEONARD CHRISTENSEN OWRD
(Person, firm or corporation) (Type or print)

Address Box 461 CHRISTMAS WILLEY

[Signed] [Signature]
(Water Well Contractor)

Contractor's License No. 767 Date 9/26, 1980

NOTICE TO WATER WELL CONTRACTORS
The original and first copy of this report
are to be filed with the

WATER WELL REPORT

WATER RESOURCES DEPARTMENT
SALEM, OREGON 97310
within 30 days from the date
of well completion.

STATE OF OREGON

(Please type or print)

(Do not write above this line)

State Well No. 28S/14E-150d

State Permit No. _____

*Lake
146*

(1) OWNER:

Name CAMERON CLIFT
Address DIAMOND BAR RANCH
SILVER LAKE OREGON 97038

(2) TYPE OF WORK (check):

New Well Deepening Reconditioning Abandon
If abandonment, describe material and procedure in Item 12.

(3) TYPE OF WELL:

Rotary Driven
Cable Jetted
Dug Bored

(4) PROPOSED USE (check):

Domestic Industrial Municipal
Irrigation Test Well Other

CASING INSTALLED:

Threaded Welded
1/4" Diam. from 0 ft. to 90 ft. Gage 0.250
" Diam. from _____ ft. to _____ ft. Gage _____
" Diam. from _____ ft. to _____ ft. Gage _____

PERFORATIONS:

Perforated? Yes No.

Type of perforator used _____

Size of perforations in. by in.
_____ perforations from _____ ft. to _____ ft.
_____ perforations from _____ ft. to _____ ft.
_____ perforations from _____ ft. to _____ ft.

(7) SCREENS:

Well screen installed? Yes No

Manufacturer's Name _____
Type _____ Model No. _____
Diam. _____ Slot size _____ Set from _____ ft. to _____ ft.
Diam. _____ Slot size _____ Set from _____ ft. to _____ ft.

(8) WELL TESTS:

Drawdown is amount water level is lowered below static level

Was a pump test made? Yes No If yes, by whom? OWWEN
Yield: 2700 gal./min. with 10 ft. drawdown after 2 hrs.
" " " " " "
" " " " " "
Bailer test gal./min. with ft. drawdown after hrs.
Artesian flow g.p.m.

(9) CONSTRUCTION:

Well seal—Material used CEMENT GROUT
Well sealed from land surface to 30 ft.
Diameter of well bore to bottom of seal 22 in.
Diameter of well bore below seal 15 1/2 in. 10" TO 30"
Number of sacks of cement used in well seal 59 sacks
How was cement grout placed? CROUT PUMP

Was a drive shoe used? Yes No Plugs _____ Size: location _____ ft.
Did any strata contain unusable water? Yes No
Type of water? _____ depth of strata _____
Method of sealing strata off _____
Was well gravel packed? Yes No Size of gravel: _____
Gravel placed from _____ ft. to _____ ft.

(10) LOCATION OF WELL:

County LAKE Driller's well number 2
NE 1/4 NE 1/4 Section 22 T. 27S R. 14E. W.M.
Bearing and distance from section or subdivision corner _____

(11) WATER LEVEL: Completed well.

Depth at which water was first found 245 ft.
Static level 44 ft. below land surface. Date 5/31/80
Artesian pressure _____ lbs. per square inch. Date _____

(12) WELL LOG:

Diameter of well below casing 10 1/2"

Depth drilled 300 ft. Depth of completed well 300 ft.

Formation: Describe color, texture, grain size and structure of materials; and show thickness and nature of each stratum and aquifer penetrated, with at least one entry for each change of formation. Report each change in position of Static Water Level and indicate principal water-bearing strata.

MATERIAL	From	To	SWL
BROWN CLAY	0	65	
CLAY AND GRAVEL MIXED	65	96	
BASALT HARD	96	136	
RED CINDEIRS	136	172	
GREY SLATE	172	220	
HARD BASALT	220	245	
RED CINDEIRS	245	282	44
HARD VOLCANIC ROCK	282	300	

RECEIVED

RECEIVED
JAN 23 2023
OWRD

RECEIVED

JUN 27 2022

AUG 11 1980

OWRD

WATER RESOURCES DEPT
SALEM, OREGON

Work started 4/25 1980 Completed 5/51 1980
Date well drilling machine moved off of well 5/6 1980

Drilling Machine Operator's Certification:

This well was constructed under my direct supervision. Materials used and information reported above are true to my best knowledge and belief.

[Signed] [Signature] Date 5/7/1980
(Drilling Machine Operator)

Drilling Machine Operator's License No. 1323

Water Well Contractor's Certification:

This well was drilled under my jurisdiction and this report is true to the best of my knowledge and belief.

Name L. RONARD CHRISTENSEN
(Person, firm or corporation) (Type or print)

Address Box 23 SILVER LAKE, OR 97038

[Signed] [Signature]
(Water Well Contractor)

Contractor's License No. 767 Date 5/7/1980

NOTICE TO WATER WELL CONTRACTOR
The original and first copy of this report are to be filed with the

WATER WELL REPORT

WATER RESOURCES DEPARTMENT
SALEM, OREGON 97310
within 30 days from the date of well completion.

STATE OF OREGON

(Please type or print)

(Do not write above this line)

State Well No. 285/14E-226

State Permit No. _____

(1) OWNER:

Name CAMERON CLIFF
Address DIAMOND BAR RANCH
SILVER LAKE OREGON 97638

(2) TYPE OF WORK (check):

New Well Deepening Reconditioning Abandon
If abandonment, describe material and procedure in Item 12.

(3) TYPE OF WELL:

Driven
Jetted
Bored

(4) PROPOSED USE (check):

Domestic Industrial Municipal
Irrigation Test Well Other

(5) CASING INSTALLED:

Threaded Welded
1 1/4" Diam. from 0 ft. to 156 ft. Gage 1.250
" Diam. from _____ ft. to _____ ft. Gage _____
" Diam. from _____ ft. to _____ ft. Gage _____

(6) PERFORATIONS:

Perforated? Yes No
Type of perforator used _____
Size of perforations _____ in. by _____ in.
_____ perforations from _____ ft. to _____ ft.
JUN 27 2022
_____ perforations from _____ ft. to _____ ft.
_____ perforations from _____ ft. to _____ ft.

(7) SCREENS:

Well screen installed? Yes No
Manufacturer's Name _____
Type _____ Model No. _____
Diam. _____ Slot size _____ Set from _____ ft. to _____ ft.
Diam. _____ Slot size _____ Set from _____ ft. to _____ ft.

(8) WELL TESTS:

Drawdown is amount water level is lowered below static level
Is a pump test made? Yes No If yes, by whom? OWNER
Yield: 2000 gal./min. with 60 ft. drawdown after 14 hrs.
" " " " " "
" " " " " "
Pump test _____ gal./min. with _____ ft. drawdown after _____ hrs.
Artesian flow _____ g.p.m.
Temperature of water _____ Depth artesian flow encountered _____ ft.

(9) CONSTRUCTION:

Well seal—Material used CEMENT GROUT
Well sealed from land surface to 150 ft.
Diameter of well bore to bottom of seal 16 in.
Diameter of well bore below seal 12 in.
Number of sacks of cement used in well seal 93 sacks
How was cement grout placed?
GROUT PUMP
Was a drive shoe used? Yes No Plugs _____ Size: location _____ ft.
Did any strata contain unusable water? Yes No
Type of water? Cool depth of strata 60 ft.
Method of sealing strata off CEMENT GROUT
Was well gravel packed? Yes No Size of gravel: _____
Gravel placed from _____ ft. to _____ ft.

(10) LOCATION OF WELL:

County LAKE Driller's well number 3
NW 1/4 NW 1/4 Section 22 T. 27 S. R. 14 E W.M.
Bearing and distance from section or subdivision corner _____

(11) WATER LEVEL: Completed well.

Depth at which water was first found 30 ft.
Static level 54 ft. below land surface. Date 6/3/80
Artesian pressure _____ lbs. per square inch. Date _____

(12) WELL LOG:

Diameter of well below casing 1 1/4"
Depth drilled 400 ft. Depth of completed well 400 ft.

Formation: Describe color, texture, grain size and structure of materials; and show thickness and nature of each stratum and aquifer penetrated, with at least one entry for each change of formation. Report each change in position of Static Water Level and indicate principal water-bearing strata.

MATERIAL	From	To	SWL
BROWN CLAY	0	25	
SANDSTONE	25	30	
W.B. GRAVEL	30	75	
BROWN CLAY	75	95	
HARD BASALT	95	120	
HARD CLAY	120	158	
W.B. BLACK SANDSTONE	158	195	54
RED CINIZERS	195	240	
BRACKEN ROCK	240	284	
GREY CINIZERS	284	295	
HARD BASALT	295	360	
RED CINIZERS	360	390	wt.
HARD RED BASALT	390	400	

Work started 5/8 1980 Completed 6/4 1980
Date well drilling machine moved off of well 6/5 1980

Drilling Machine Operator's Certification:

This well was constructed under my direct supervision. Materials used and information reported above are true to my best knowledge and belief.

[Signed] John R. Hansen Date 6/4, 1980
(Drilling Machine Operator)

Drilling Machine Operator's License No. 1323

Water Well Contractor's Certification:

This well was drilled under my jurisdiction and this report is true to the best of my knowledge and belief.

Name LEONARD CHRISTENSEN
(Person, firm or corporation) (Type or print)

Address Box 23 Silver Lake OR 97638

[Signed] L. Christensen
(Water Well Contractor)

Contractor's License No. 76743 Date 6/4/80, 1980

fake 747

RECEIVED
FEB 21 2023

OWRD

RECEIVED
JUN 27 2022

W.B. GRAVEL
W.B. BLACK SANDSTONE

RECEIVED
SEP 19 1980

WATER RESOURCES DEPT
SALEM, OREGON

RECEIVED
JAN 23 2023

NOTICE TO WATER WELL CONTRACTOR
The original and first copy
of this report are to be
filed with the

RECEIVED WATER WELL REPORT AUG 14 1972
STATE OF OREGON
STATE ENGINEER SALEM, OREGON
June 1317
28/14-23 00
State Well No.
State Permit No. G-8915

STATE ENGINEER, SALEM, OREGON JUN 6 - 1972
(Please type or print)
STATE ENGINEER SALEM, OREGON
Do not write above this line.

(1) OWNER:
Name Cliff Cameron
Address Lapwai Ave 97739

(2) TYPE OF WORK (check):
New Well [X] Deepening [] Reconditioning [] Abandon []
If abandonment, describe material and procedure in Item 12.

(3) TYPE OF WELL: (4) PROPOSED USE (check):
Rotary [X] Driven [] Domestic [] Industrial [] Municipal []
Cable [] Jetted [] Irrigation [X] Test Well [] Other []
Dug [] Bored []

(5) CASING INSTALLED: Threaded [] Welded [X]
14" Diam. from +2 ft. to +95 ft. Gage 1250
" Diam. from ft. to ft. Gage
" Diam. from ft. to ft. Gage

(6) PERFORATIONS: Perforated? [X] Yes [] No.
Type of perforator used Torch
Size of perforations 2 in. by 6 in.
40 perforations from 90 ft. to 93 ft.
perforations from ft. to ft.
perforations from ft. to ft.

(7) SCREENS: Well screen installed? [] Yes [X] No
Manufacturer Name
Type Model No.
Diam. Slot size Set from ft. to ft.
Diam. Slot size Set from ft. to ft.

(8) WELL TESTS: Drawdown is amount water level is lowered below static level
Was a pump test made? [] Yes [X] No If yes, by whom?
: gal./min. with ft. drawdown after hrs.
" " "
" Blowing approx. 1000 gallons min.
Baller test gal./min. with 0 ft. drawdown after 2 hrs.
Artesian flow g.p.m.
Temperature of water 50 Depth artesian flow encountered ft.

(9) CONSTRUCTION:
Well seal—Material used Cement & drill cuttings
Well sealed from land surface to 28 ft.
Diameter of well bore to bottom of seal 18 in.
Diameter of well bore below seal 16 in.
Number of sacks of cement used in well seal 11 sacks
Number of sacks of bentonite used in well seal 0 sacks
Brand name of bentonite
Number of pounds of bentonite per 100 gallons of water lbs./100 gals.
Was a drive shoe used? [] Yes [X] No Plugs Size: location
Did any strata contain unusable water? [] Yes [X] No
Type of water? depth of strata
Method of sealing strata off
Was well gravel packed? [] Yes [X] No Size of gravel:
Gravel placed from ft. to ft.

(10) LOCATION OF WELL:
County Lapeer Driller's well number
NE 1/4 NE 1/4 Section 23 T. 28 R. 14E W.M.
Bearing and distance from section or subdivision corner 1320 ft.
S 1320 ft. south of the NE corner of sec 23

(11) WATER LEVEL: Completed well
Depth at which water was first found 36 ft.
Static level 35 ft. below land surface. Date 6-1-72
Artesian pressure lbs. per square inch. Date

(12) WELL LOG: Diameter of well below casing 12
Depth drilled 335 ft. Depth of completed well 335 ft.
Formation: Describe color, texture, grain size and structure of materials; and show thickness and nature of each stratum and aquifer penetrated, with at least one entry for each change of formation. Report each change in position of Static Water Level and indicate principal water-bearing strata.

Table with columns: MATERIAL, From, To, SWL. Rows include: BROWN SANDY SOIL (0-5), BROWN CONGLOMERATE (5-22), HARD YELLOW CLAYSTONE (22-36), BLUE CLAY & BLACK SAND (36-88) w/ GRAVEL WITH WATER, BLACK HARD ROCK-STRIPS OF (88-160), YELLOW CLAY, RED CINDER ROCK (160-169), BLACK HARD ROCK-STRIPS (169-217) w/ YELLOW CLAY, BROWN BROKEN HARD ROCK (217-252), YELLOW CLAY & GRAVEL (252-257), BROWN BROKEN ROCK (257-295), COURSE SAND & MULTI-COLOR (295-335), GRAVEL-WATER BEARING (335-35).

Work started 5-21 1972 Completed 6-1 1972
Date well drilling machine moved off of well 6-1 1972

Drilling Machine Operator's Certification:
This well was constructed under my direct supervision. Materials used and information reported above are true to my best knowledge and belief.
[Signed] Dale Crawford Date 6-5 1972 (Drilling Machine Operator)
Drilling Machine Operator's License No. 440

Water Well Contractor's Certification:
This well was drilled under my jurisdiction and this report is true to the best of my knowledge and belief.
Name CRAWFORD WELL DRILLING (Person, firm or corporation) (Type or print)
Address Box 17 TERREBONNE ORE
[Signed] Dale Crawford (Water Well Contractor)
Contractor's License No. 451 Date 6-5 1972



Oregon

Tina Kotek, Governor

Water Resources Department
725 Summer St NE, Suite A
Salem, OR 97301
(503)-986-0900
Fax: (503)-986-0904

January 25, 2023

Bell A Land and Cattle Co.
ATTN: Theresa Cliff
PO Box 97
La Pine, OR 97739

Dear Ms. Cliff:

On January 23, 2023, the Department received your application for permanent transfer for Certificate 89345.

We are returning your application for an incomplete Evidence of Use Affidavit. We have received the Evidence of Use Form provided by the Department however, it came without the required supplemental documentation to confirm evidence of use (Please see OAR 690-380-3000 12(a)-12(b)). On the form, aerial photos were checked to be provided, but no such photos came with the application.

Please re-submit the application with the appropriate supplemental documentation for the Evidence of Use Affidavit.

Sincerely,

Dante J. Luongo
Transfers Specialist
Transfers and Conservation Section

Enclosure:
Transfer Application and Attachments

RECEIVED

FEB 21 2023

OWRD

14177



ALL POINTS ENGINEERING & SURVEYING

P.O. Box 767
Terrebonne, Oregon 97760

TRANSMITTAL

To:
Oregon Water Resources Department
725 Summer St. NE Suite A
Salem, OR 97301-1266

Date: 1/16/2023 Job: 22-175
Attention: Transfer Section
Re: Application for APOAs

Prints Plans Map/Plat Specifications Change order Other

Copies	No.	Description
1	1	Application (22 sheets letter bond)
1	2	LUCS (2 sheets letter bond)
1	3	Use Affidavit (1 sheet 2-sided letter bond)
1	4	Map (2 sheets ARCH C bond)
1	5	Well Reports (6 sheets letter bond)
1	6	Check for OWRD fee

These are transmitted as checked below:

For OWRD approval Approved as submitted Approved as noted
 Copies for distribution Returned for corrections Returned corrected prints
 Review and comment For bids due Other

Remarks:

Thanks and if you have questions please don't hesitate to call (541) 548-5833.

Signed: _____

RECEIVED
FEB 21 2023
OWRD

RECEIVED
JAN 23 2023
OWRD

14177

Permanent Transfer Application Checklist

Check the Certificates in WRIS

Transfer # T- 14177

Checked by <u> Dante </u> Date <u> 2/23/2023 </u>	Type of Change(s) Proposed: <u>NO</u> other changes allowed other than those listed	
Fee Received: \$3070	<input type="checkbox"/> POU <input type="checkbox"/> POD <input type="checkbox"/> APOD <input type="checkbox"/> POA <input checked="" type="checkbox"/> APOA <input type="checkbox"/> USE	
Calculated Fee: \$3070		How many rights to be Transferred? <u> 1 </u>
Deficiencies and Observations: Supplemental right adding POD's Lots of other rights associated		Certificate #(s) <u> 89345 </u>

If OK, check box; if not, fill in.

- 1. Is the applicant information complete? Have all the applicants listed at the top of the page signed at the bottom?
If not, what is missing? Whose signature is missing? _____
- 2. Has the applicant indicated that the place of use is in or near an irrigation district? Have they included a Form D? N/A.
Name of the District _____
- 3. Part 5 of application, has the applicant completed the entire page and does the information match the description of the explanation of the reasons on Part 4 of the application?
If not, you may need to contact the applicant or agent? _____
- 4. For multiple certificates, do each of the certificates listed on Application Page 1 have their own separate completed Part 5 tables 1 & 2? (*compare with OAR 690-380-3220-may need to return*)
If no, which certificates are missing a separate Part 5, tables 1 & 2? _____
- 5. Has the map been completed and signed by a CWRE? Does the map meet the requirements?
If not, what is missing? _____. Map waiver included?
- 6. If a change in point of appropriation, have the well logs been included? N/A.
- 7. If a change in place of use within Umatilla County, have the applicant(s) provided a Supplemental Form U? N/A.
- 8. Has applicant filled out the Minimum Requirements Checklist (Part 1 of 5)? Is the application complete? If not, what is missing (check Evidence of Use and Land Use)? _____

- 9. If all boxes on this checklist are checked (with no remaining deficiencies identified), accept the application. Put this check sheet in the transfer folder.

OR:

- This application is deficient, and **CANNOT** be accepted.
It should be returned and the **deficiencies listed in the "staff" section at the bottom of Application Page 1**, unless the applicant or agent can resolve the deficiencies within 2-3 days.

Actions taken:

_____ date _____

Permanent Transfer Application Checklist

FEE WORKSHEET for PERMANENT TRANSFER (except Substitution)			
1	Base Fee (includes one type of change to one water right for up to 1 cfs)	1	\$1,360
	Types of change proposed: <input type="checkbox"/> Place of Use <input type="checkbox"/> Character of Use <input type="checkbox"/> Point of Diversion/Appropriation Number of above boxes checked = _____ (2a) Subtract 1 from the number in line 2a = _____ (2b) <i>If only one change, this will be 0</i>		
2	Multiply line 2b by \$930 and enter »	2	0
	Number of water rights included in transfer _____ (3a) Subtract 1 from the number in 3a above: _____ (3b) <i>If only one water right this will be 0</i>		
3	Multiply line 3b by \$520 and enter »	3	0
	Do you propose to add or change a well, or change from a surface water POD to a well? <input type="checkbox"/> No: enter 0 » <input type="checkbox"/> Yes: enter \$410 »		
4		4	0
	Do you propose to change the place of use or character of use? <input type="checkbox"/> No: enter 0 on line 5 » <input type="checkbox"/> Yes: enter the cfs for the portions of the rights to be transferred (see example below*): _____ (5a) Subtract 1.0 from the number in 5a above: _____ (5b) If 5b is 0 or less, enter 0 on line 5 » If 5b is greater than 0, round up to the nearest whole number: _____ (5c) and multiply 5c by \$350, then enter on line 5 » » » » » » » » » »		
5		5	0
6	Add entries on lines 1 through 5 above » » » » » » » » » » Subtotal:	6	0
	Is this transfer: <input type="checkbox"/> necessary to complete a project funded by the Oregon Watershed Enhancement Board (OWEB) under ORS 541.932? <input type="checkbox"/> endorsed in writing by ODFW as a change that will result in a net benefit to fish and wildlife habitat? If one or more boxes is checked, multiply line 6 by 0.5 and enter on line 7 »		
7	If no box is applicable, enter 0 on line 7 »	7	0
8	Subtract line 7 from line 6 » Transfer Fee:	8	