

# Application for Permanent Water Right Transfer



Oregon Water Resources Department  
 725 Summer Street NE, Suite A  
 Salem, Oregon 97301-1266  
 (503) 986-0900  
[www.oregon.gov/OWRD](http://www.oregon.gov/OWRD)

## Part 1 of 5 – Minimum Requirements Checklist

**This transfer application will be returned if Parts 1 through 5 and all required attachments are not completed and included.**  
 For questions, please call (503) 986-0900, and ask for Transfer Section.

RECEIVED  
 MAR 29 2023  
 OWRD

Check all items included with this application. (N/A = Not Applicable)

- Part 1 – Completed Minimum Requirements Checklist.
- Part 2 – Completed Transfer Application Map Checklist.
- Part 3 – Application Fee, payable by check to the Oregon Water Resources Department, and completed Fee Worksheet, page 3. Try the new online fee calculator at: [http://apps.wrd.state.or.us/apps/misc/wrd\\_fee\\_calculator](http://apps.wrd.state.or.us/apps/misc/wrd_fee_calculator). **Fee in amount of \$3,270 enclosed**
- Part 4 – Completed Applicant Information and Signature.
- Part 5 – Information about Water Rights to be Transferred: **How many water rights are to be transferred? 2 List them here: Certificates 87381 and 87380 (Attachment A)**  
 Please include a separate Part 5 for each water right. (See instructions on page 6)  
**NOTE: A separate transfer application is required for each water right unless the criteria in OAR 690-380-3220 are met.**

**Attachments:**

- Completed Transfer Application Map. **See Attachment B**
- Completed Evidence of Use Affidavit and supporting documentation. **See Attachment C**
- N/A Affidavit(s) of Consent from Landowner(s) (if the applicant does not own the land the water right is on.)
- N/A Supplemental Form D – For water rights served by or issued in the name of an irrigation district. Complete when the transfer applicant is not the irrigation district.
- N/A Oregon Water Resources Department’s Land Use Information Form with approval and signature from each local land use authority in which water is to be diverted, conveyed, and/or used. Not required if water is to be diverted, conveyed, and/or used only on federal lands or if **all** of the following apply: a) a change in place of use only, b) no structural changes, c) the use of water is for irrigation only, and d) the use is located within an irrigation district or an exclusive farm use zone. **See Attachment D**
- N/A Water Well Report/Well Log for changes in point(s) of appropriation (well(s)) or additional point(s) of appropriation. **See Attachment E**
- N/A Geologist Report for a change from a surface water point of diversion to a ground water point of appropriation (well), if the proposed well is more than 500’ from the surface water source and more than 1000’ upstream or downstream from the point of diversion. See OAR 690-380-2130 for requirements and applicability.

**(For Staff Use Only)**

**WE ARE RETURNING YOUR APPLICATION FOR THE FOLLOWING REASON(S):**

<input type="checkbox"/> Application fee not enclosed/insufficient	<input type="checkbox"/> Map not included or incomplete
<input type="checkbox"/> Land Use Form not enclosed or incomplete	<input type="checkbox"/> Evidence of Use Form not enclosed or incomplete
<input type="checkbox"/> Additional signature(s) required	<input type="checkbox"/> Part _____ is incomplete

Other/Explanation \_\_\_\_\_

Staff: \_\_\_\_\_ 503- \_\_\_\_\_ Date: \_\_\_\_/\_\_\_\_/\_\_\_\_

## Part 2 of 5 – Transfer Application Map

OWRD

Your transfer application **will be returned** if any of the map requirements listed below are not met.

Please be sure that the transfer application map you submit includes all the required items and matches the existing water right map. Check all boxes that apply.

- N/A Certified Water Right Examiner (CWRE) Stamp and Original Signature. For a list of CWREs, see [http://apps.wrd.state.or.us/apps/wr/cwre\\_license\\_view/](http://apps.wrd.state.or.us/apps/wr/cwre_license_view/). CWRE stamp and signature are not required for substitutions.
- N/A If **more than three** water rights are involved, separate maps are needed for each water right.
- Permanent quality printed with dark ink on good quality paper.
- The size of the map can be 8½ x 11 inches, 8½ x 14 inches, 11 x 17 inches, or up to 30 x 30 inches. For 30 x 30 inch maps, one extra copy is required.
- A north arrow, a legend, and scale.
- The scale of the map must be: 1 inch = 400 feet, 1 inch = 1,320 feet, the scale of the Final Proof/Claim of Beneficial Use Map (the map used when the permit was certificated), the scale of the county assessor map if the scale is not smaller than 1 inch = 1,320 feet, or a scale that has been pre-approved by the Department.
- Township, Range, Section, ¼ ¼, DLC, Government Lot, and other recognized public land survey lines.
- Tax lot boundaries (property lines) are required. Tax lot numbers are recommended.
- Major physical features including rivers and creeks showing direction of flow, lakes and reservoirs, roads, and railroads.
- Major water delivery system features from the point(s) of diversion/appropriation such as main pipelines, canals, and ditches.
- Existing place of use that includes separate hachuring for each water right, priority date, and use including number of acres in each quarter-quarter section, government lot, or in each quarter-quarter section as projected within government lots, donation land claims, or other recognized public land survey subdivisions. If less than the entirety of the water right is being changed, a separate hachuring is needed for lands left unchanged.
- N/A Proposed place of use that includes separate hachuring for each water right, priority date, and use including number of acres in each quarter-quarter section, government lot, or in each quarter-quarter section as projected within government lots, donation land claims, or other recognized public land survey subdivisions.
- Existing point(s) of diversion or well(s) with distance and bearing or coordinates from a recognized survey corner. This information can be found in your water right certificate or permit.
- N/A If you are proposing a change in point(s) of diversion or well(s), show the proposed location and label it clearly with distance and bearing or coordinates. If GPS coordinates are used, latitude-longitude coordinates may be expressed as either degrees-minutes-seconds with at least one digit after the decimal (example – 42°32'15.5") or degrees-decimal with five or more digits after the decimal (example – 42.53764°).



**Applicant Information**

**OWRD**

APPLICANT/BUSINESS NAME <b>City of Aurora, Attn: Mark Gunter</b>		PHONE NO. <b>(971)930-3597</b>	ADDITIONAL CONTACT NO.
ADDRESS <b>21420 Main Street</b>			FAX NO.
CITY <b>Aurora</b>	STATE <b>OR</b>	ZIP <b>97002</b>	E-MAIL <b>PWS@ci.aurora.or.us</b>
<b>BY PROVIDING AN E-MAIL ADDRESS, CONSENT IS GIVEN TO RECEIVE ALL CORRESPONDENCE FROM THE DEPARTMENT ELECTRONICALLY. COPIES OF THE FINAL ORDER DOCUMENTS WILL ALSO BE MAILED.</b>			

**Agent Information** – The agent is authorized to represent the applicant in all matters relating to this application.

AGENT/BUSINESS NAME <b>GSI Water Solutions, Inc. Attn: Owen McMurtrey</b>		PHONE NO. <b>(541)740-5619</b>	ADDITIONAL CONTACT NO.
ADDRESS <b>1600 SW Western Blvd, Suite 240</b>			FAX NO.
CITY <b>Corvallis</b>	STATE <b>OR</b>	ZIP <b>97333</b>	E-MAIL <b>OMcMurtrey@gsiws.com</b>
<b>BY PROVIDING AN E-MAIL ADDRESS, CONSENT IS GIVEN TO RECEIVE ALL CORRESPONDENCE FROM THE DEPARTMENT ELECTRONICALLY. COPIES OF THE FINAL ORDER DOCUMENTS WILL ALSO BE MAILED.</b>			

Explain in your own words what you propose to accomplish with this transfer application, and why:  
**The applicant is proposing to add three additional points of appropriation, Well 3R, Well 6A, and Well 6B, to its Certificates 87381 and 87380. The place and character of use will not change.**

If you need additional space, continue on a separate piece of paper and attach to the application as "Attachment 1".

**Check One Box**

- By signing this application, I understand that, upon receipt of the draft preliminary determination and prior to Department approval of the transfer, I will be required to provide landownership information and evidence that I am authorized to pursue the transfer as identified in OAR 690-380-4010(5); **OR**
- I affirm the applicant is a municipality as defined in ORS 540.510(3)(b) and that the right is in the name of the municipality or a predecessor; **OR**
- I affirm the applicant is an entity with the authority to condemn property and is acquiring by condemnation the property to which the water right proposed for transfer is appurtenant and have supporting documentation.

**By my signature below, I confirm that I understand:**

- Prior to Department approval of the transfer application, I may be required to submit payment to the Department for publication of a notice in a newspaper with general circulation in the area where the water right is located, once per week for two consecutive weeks. If more than one qualifying newspaper is available, I suggest publishing the notice in the following newspaper: \_\_\_\_\_
- Amendments to the application may only be made in response to the Department’s Draft Preliminary Determination (DPD). The applicant will have a period of at least 30 days to amend the application to address any issues identified by the Department in the DPD, or to withdraw the application. Note that amendments may be subject to additional fees, pursuant to ORS 536.050.
- Failure to complete an approved change in place of use and/or change in character of use, will result in loss of the water right (OAR 690-380-6010).
- Refunds may only be granted upon request and, as set forth in ORS 536.050(4)(a), if the Director determines that a refund of all or part of a fee is appropriate in the interests of fairness to the public or necessary to correct an error of the Department.

I (we) affirm that the information contained in this application is true and accurate.

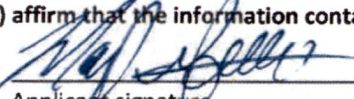

  
 Applicant signature

**Mark Gunter, Public Works Supervisor**  
 Print Name (and Title if applicable)

**3/15/23**  
 Date

Applicant signature

Print Name (and Title if applicable)

Date

Is the applicant the sole owner of the land on which the water right, or portion thereof, proposed for transfer is located?  Yes  No\*

*\*If NO, include signatures of all deeded landowners (and mailing and/or e-mail addresses if different than the applicant's) or attach affidavits of consent (and mailing and/or e-mail addresses) from all landowners or individuals/entities to which the water right(s) were conveyed.*

Check the following boxes that apply:

- The applicant is responsible for completion of change(s). Notices and correspondence should continue to be sent to the applicant.
- The receiving landowner will be responsible for completing the proposed change(s) after the final order is issued. Copies of notices and correspondence should be sent to this landowner.
- Both the receiving landowner and applicant will be responsible for completion of change(s). Copies of notices and correspondence should be sent to this landowner and the applicant.

At this time, are the lands in this transfer application in the process of being sold?  Yes  No

If YES, and you know who the new landowner will be, please complete the receiving landowner information table below. If you do not know who the new landowner will be, then a request for assignment will have to be filed for at a later date.

If a property sells, the certificated water right(s) located on the land belong to the new owner, unless a sale agreement or other document states otherwise. For more information see:

[https://www.oregon.gov/owrd/WRDFormsPDF/Transfer\\_Property\\_Transactions.pdf](https://www.oregon.gov/owrd/WRDFormsPDF/Transfer_Property_Transactions.pdf)

RECEIVING LANDOWNER NAME <b>N/A</b>			PHONE NO.	ADDITIONAL CONTACT NO.
ADDRESS				FAX NO.
CITY	STATE	ZIP	E-MAIL	
Describe any special ownership circumstances:				
The confirming Certificate shall be issued in the name of: <input type="checkbox"/> Applicant <input type="checkbox"/> Receiving Landowner				

RECEIVED  
MAR 29 2023  
OWRD

Check here if any of the water rights proposed for transfer are or will be located within or served by an irrigation or other water district. (Tip: Complete and attach Supplemental Form D.) N/A

IRRIGATION DISTRICT NAME	ADDRESS	
CITY	STATE	ZIP

Check here if water for any of the rights supplied under a water service agreement or other contract for stored water with a federal agency or other entity. N/A

ENTITY NAME	ADDRESS	
CITY	STATE	ZIP

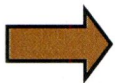

To meet State Land Use Consistency Requirements, you must list all county, city, municipal corporation, or tribal governments within whose jurisdiction water will be diverted, conveyed or used.

ENTITY NAME <b>Marion County Planning Division</b>	ADDRESS <b>5155 Silverton Rd NE</b>	
CITY <b>Salem</b>	STATE <b>OR</b>	ZIP <b>97305</b>

ENTITY NAME <b>City of Aurora (Planning Review by MWVCOG)</b>	ADDRESS <b>100 High Street, Suite 200</b>	
CITY <b>Salem</b>	STATE <b>OR</b>	ZIP <b>97302</b>

RECEIVED  
MAR 29 2023  
OWRD

## Part 5 of 5 – Water Right Information

Please use a separate Part 5 for each water right being changed. See instructions on page 6, to copy and paste additional Part 5s, or to add additional rows to tables within the form.

CERTIFICATE # 87381

RECEIVED

### Description of Water Delivery System

MAR 29 2023

System capacity: 0.5 cubic feet per second (cfs) OR

\_\_\_\_\_ gallons per minute (gpm)

OWRD

Describe the current water delivery system or the system that was in place at some time within the last five years. Include information on the pumps, canals, pipelines, and sprinklers used to divert, convey, and apply the water at the authorized place of use. **The distribution system consists of an estimated 8.2 miles of pipelines, ranging from 2-inch to 10 inches in diameter. Well 3 is 244 ft deep and is equipped with a 20 HP pump with a capacity of 140 gpm and a static water level of 97 ft BGS. Well 4 is 266 ft deep and is equipped with a 20 HP pump with a capacity of 140 gpm and a static water level of 105.5 ft BGS. Well 3 and 4 have submersible pumps. Well 5 is 273 ft deep and has a pumping capacity of 170 gpm and a static water level of 73 ft BGS. Water is appropriated from all three wells, then is treated and conveyed through the distribution system for municipal use.**

**Table 1. Location of Authorized and Proposed Point(s) of Diversion (POD) or Appropriation (POA)**

(Note: If the POD/POA name is not specified on the certificate, assign it a name or number here.)

POD/POA Name or Number	Is this POD/POA Authorized on the Certificate or is it Proposed?	If POA, OWRD Well Log ID# (or Well ID Tag # L-___)	Twp		Rng		Sec	¼ ¼		Tax Lot, DLC or Gov't Lot	Measured Distances (from a recognized survey corner)
Well 3	<input checked="" type="checkbox"/> Authorized <input type="checkbox"/> Proposed	MARI 492	4	S	1	W	13	SE	NW	5700	810 feet North and 430 feet West from Center of Section 13
Well 4	<input checked="" type="checkbox"/> Authorized <input type="checkbox"/> Proposed	MARI 1301	4	S	1	W	13	SE	NW	5700	1840 feet South and 2515 feet East from NW Corner of Section 13
Well 5	<input checked="" type="checkbox"/> Authorized <input type="checkbox"/> Proposed	MARI 59058	4	S	1	W	13	NE	SW	17800	966 feet South and 410 feet West from Center of Section 13
Well 3R	<input type="checkbox"/> Authorized <input checked="" type="checkbox"/> Proposed		4	S	1	W	13	SE	NW	5700	1935 feet South and 2210 feet East from NW Corner of Section 13
Well 6A	<input type="checkbox"/> Authorized <input checked="" type="checkbox"/> Proposed		4	S	1	W	11	NE	SE	100	1945 feet North and 55 feet West from SE Corner of Section 13
Well 6B	<input type="checkbox"/> Authorized <input checked="" type="checkbox"/> Proposed		4	S	1	W	12	NW	SW	1400	2065 feet North and 80 feet East from SW Corner of Section 13

Check all type(s) of change(s) proposed below (change "CODES" are provided in parentheses):

- |   |  |
|---|--|
| <input type="checkbox"/> Place of Use (POU)       | <input type="checkbox"/> Supplemental Use to Primary Use (S to P)            |
| <input type="checkbox"/> Character of Use (USE)   | <input type="checkbox"/> Point of Appropriation/Well (POA)                   |
| <input type="checkbox"/> Point of Diversion (POD) | <input checked="" type="checkbox"/> Additional Point of Appropriation (APOA) |

- |   |  |
|---|--|
| <input type="checkbox"/> Additional Point of Diversion (APOD)             | <input type="checkbox"/> Substitution (SUB)          |
| <input type="checkbox"/> Surface Water POD to Ground Water<br>POA (SW/GW) | <input type="checkbox"/> Government Action POD (GOV) |

**Will all of the proposed changes affect the entire water right?**

- Yes Complete only the Proposed (“to” or “on” lands) section of Table 2 on the next page. Use the “CODES” listed above to describe the proposed changes.
- No Complete all of Table 2 to describe the portion of the water right to be changed.

RECEIVED

MAR 29 2023

OWRD



Please use and attach additional pages of Table 2 as needed.  
See page 6 for instructions.

Do you have questions about how to fill-out the tables?  
Contact the Department at 503-986-0900 and ask for Transfer Staff.

**Table 2. Description of Changes to Water Right Certificate # 87381**

List the change proposed for the acreage in each ¼ ¼. If more than one change is proposed, specify the acreage associated with each change. If there is more than one POD/POA involved in the proposed changes, specify the acreage associated with each POD/POA.

AUTHORIZED (the "from" or "off" lands) The listing that appears on the certificate BEFORE PROPOSED CHANGES List only that part or portion of the water right that will be changed.											Proposed Changes (see "CODES" from previous page)	PROPOSED (the "to" or "on" lands) The listing as it would appear AFTER PROPOSED CHANGES are made.														
Twp	Rng	Sec	¼	¼	Tax Lot	Gvt Lot or DLC	Acres	Type of USE listed on Certificate	POD(s) or POA(s) (name or number from Table 1)	Priority Date		Twp	Rng	Sec	¼	¼	Tax Lot	Gvt Lot or DLC	Acres	New Type of USE	POD(s)/ POA(s) to be used (from Table 1)	Priority Date				
<b>EXAMPLE</b>																										
2	S	9	E	15	NE	NW	100		15.0	Irrigation	POD #1 POD #2	1901	POU/POD	2	S	9	E	1	NW	NW	500	1	10.0		POD #5	1901
														2	S	9	E	2	SW	NW	500		5.0		POD #6	1901
													APOA	See Map (Attachment B) for place of use								Well 3, Well 4, Well 5, Well 3R, Well 6A, Well 6B	11/25/1966			
TOTAL ACRES:												TOTAL ACRES: N/A														

Additional remarks: The Applicant is proposing to add three additional points of appropriation, Well 3R, Well 6A, and Well 6B to Certificates 87381 and 87380. Well 6A and Well 6B represent two possible locations for an additional well to be drilled, but the City plans to only drill one Well.

14205

RECEIVED  
MAR 29 2023  
OWRD

**For Place of Use or Character of Use Changes N/A**

Are there other water right certificates, water use permits or ground water registrations associated with the “from” or the “to” lands?  Yes  No N/A

If YES, list the certificate, water use permit, or ground water registration numbers: N/A.

 Pursuant to ORS 540.510, any “layered” water use such as an irrigation right that is supplemental to a primary right proposed for transfer must be included in the transfer or be cancelled. Any change to a ground water registration must be filed separately in a ground water registration modification application.

**For Substitution** (ground water supplemental irrigation will be substituted for surface water primary irrigation)

Ground water supplemental Permit or Certificate # N/A;

Surface water primary Certificate # N/A.

**RECEIVED**

**MAR 29 2023**

**For a change from Supplemental Irrigation Use to Primary Irrigation Use N/A**

Identify the primary certificate to be cancelled. Certificate # N/A

**OWRD**

**For a change in point(s) of appropriation (well(s)) or additional point(s) of appropriation:**

- Well log(s) are attached for each authorized and proposed well(s) that are clearly labeled and associated with the corresponding well(s) in Table 1 above and on the accompanying application map.

**Tip:** You may search for well logs on the Department’s web page at:

[http://apps.wrd.state.or.us/apps/gw/well\\_log/Default.aspx](http://apps.wrd.state.or.us/apps/gw/well_log/Default.aspx)

**AND/OR**

- Describe the construction of the authorized and proposed well(s) in Table 3 for any wells that do not have a well log. For *proposed wells not yet constructed or built*, provide “a best estimate” for each requested information element in the table. The Department recommends you consult a licensed well driller, geologist, or certified water right examiner to assist with assembling the information necessary to complete Table 3.

**Table 3. Construction of Point(s) of Appropriation**

Any well(s) in this listing must be clearly tied to corresponding well(s) described in Table 1 and shown on the accompanying application map. Failure to provide the information will delay the processing of your transfer application until it is received. The information is necessary for the department to assess whether the proposed well(s) will access the same source aquifer as the authorized point(s) of appropriation (POA). The Department is prohibited by law from approving POA changes that do not access the same source aquifer.

Proposed or Authorized POA Name or Number	Is well already built? (Yes or No)	If an existing well: OWRD Well ID Tag No. L-___	Total well depth	Casing Diameter	Casing Intervals (feet)	Seal depth(s) (intervals)	Perforated or screened intervals (in feet)	Static water level of completed well (in feet)	Source aquifer (sand, gravel, basalt, etc.)	Well-specific rate (cfs or gpm). If less than full rate of water right
Well 3R	No	N/A	260 ft	16 in	+1-260	0-140	205-250	80-120	Alluvial supply in Willamette Basin	200-300 gpm
Well 6A and 6B	No	N/A	250 ft	16 in	+1-250	0-130	180-190; 200-220	70		

## Part 5 of 5 – Water Right Information

Please use a separate Part 5 for each water right being changed. See instructions on page 6, to copy and paste additional Part 5s, or to add additional rows to tables within the form.

CERTIFICATE # 87380

RECEIVED

MAR 29 2023

OWRD

### Description of Water Delivery System

System capacity: 0.56 cubic feet per second (cfs) OR  
 \_\_\_\_\_ gallons per minute (gpm)

Describe the current water delivery system or the system that was in place at some time within the last five years. Include information on the pumps, canals, pipelines, and sprinklers used to divert, convey, and apply the water at the authorized place of use. **The distribution system consists of an estimated 8.2 miles of pipelines, ranging from 2-inch to 10 inches in diameter. Well 3 is 244 ft deep and has a pumping capacity of 140 gpm and a static water level of 97 ft BGS. Well 4 is 266 ft deep and has a pumping capacity of 140 gpm and a static water level of 105.5 ft BGS. Well 3 and 4 have submersible pumps. Well 5 is 273 ft deep and has a pumping capacity of 170 gpm and a static water level of 73 ft BGS. Water is appropriated from all three wells, then is treated and conveyed through the distribution system for municipal use.**

**Table 1. Location of Authorized and Proposed Point(s) of Diversion (POD) or Appropriation (POA)**

(Note: If the POD/POA name is not specified on the certificate, assign it a name or number here.)

POD/POA Name or Number	Is this POD/POA Authorized on the Certificate or is it Proposed?	If POA, OWRD Well Log ID# (or Well ID Tag # L-___)	Twp		Rng		Sec		¼ ¼		Tax Lot, DLC or Gov't Lot	Measured Distances (from a recognized survey corner)
Well 3	<input checked="" type="checkbox"/> Authorized <input type="checkbox"/> Proposed	MARI 492	4	S	1	W	13	SE	NW	5700	810 feet North and 430 feet West from Center of Section 13	
Well 4	<input checked="" type="checkbox"/> Authorized <input type="checkbox"/> Proposed	MARI 1301	4	S	1	W	13	SE	NW	5700	1840 feet South and 2515 feet East from NW Corner of Section 13	
Well 5	<input checked="" type="checkbox"/> Authorized <input type="checkbox"/> Proposed	MARI 59058	4	S	1	W	13	NE	SW	17800	966 feet South and 410 feet West from Center of Section 13	
Well 3R	<input type="checkbox"/> Authorized <input checked="" type="checkbox"/> Proposed		4	S	1	W	13	SE	NW	5700	1935 feet South and 2210 feet East from NW Corner of Section 13	
Well 6A	<input type="checkbox"/> Authorized <input checked="" type="checkbox"/> Proposed		4	S	1	W	11	NE	SE	100	1945 feet North and 55 feet West from SE Corner of Section 13	
Well 6B	<input type="checkbox"/> Authorized <input checked="" type="checkbox"/> Proposed		4	S	1	W	12	NW	SW	1400	2065 feet North and 80 feet East from SW Corner of Section 13	

Check all type(s) of change(s) proposed below (change "CODES" are provided in parentheses):

- |   |  |
|---|--|
| <input type="checkbox"/> Place of Use (POU)       | <input type="checkbox"/> Supplemental Use to Primary Use (S to P)            |
| <input type="checkbox"/> Character of Use (USE)   | <input type="checkbox"/> Point of Appropriation/Well (POA)                   |
| <input type="checkbox"/> Point of Diversion (POD) | <input checked="" type="checkbox"/> Additional Point of Appropriation (APOA) |

- Additional Point of Diversion (APOD)       Substitution (SUB)  
 Surface Water POD to Ground Water POA (SW/GW)       Government Action POD (GOV)

**Will all of the proposed changes affect the entire water right?**

- Yes    Complete only the Proposed (“to” or “on” lands) section of Table 2 on the next page. Use the “CODES” listed above to describe the proposed changes.
- No    Complete all of Table 2 to describe the portion of the water right to be changed.

RECEIVED

MAR 29 2023

OWRD

Please use and attach additional pages of Table 2 as needed.  
See page 6 for instructions.

Do you have questions about how to fill-out the tables?  
Contact the Department at 503-986-0900 and ask for Transfer Staff.

**Table 2. Description of Changes to Water Right Certificate # 87380**

List the change proposed for the acreage in each ¼ ¼. If more than one change is proposed, specify the acreage associated with each change.  
If there is more than one POD/POA involved in the proposed changes, specify the acreage associated with each POD/POA.

AUTHORIZED (the "from" or "off" lands) The listing that appears on the certificate BEFORE PROPOSED CHANGES List only that part or portion of the water right that will be changed.											Proposed Changes (see "CODES" from previous page)	PROPOSED (the "to" or "on" lands) The listing as it would appear AFTER PROPOSED CHANGES are made.														
Twp	Rng	Sec	¼	¼	Tax Lot	Gvt Lot or DLC	Acre	Type of USE listed on Certificate	POD(s) or POA(s) (name or number from Table 1)	Priority Date		Twp	Rng	Sec	¼	¼	Tax Lot	Gvt Lot or DLC	Acre	New Type of USE	POD(s)/ POA(s) to be used (from Table 1)	Priority Date				
<b>EXAMPLE</b>																										
2	S	9	E	15	NE	NW	100		15.0	Irrigation	POD #1 POD #2	1901	POU/POD	2	S	9	E	1	NW	NW	500	1	10.0		POD #5	1901
														2	S	9	E	2	SW	NW	500		5.0		POD #6	1901
													APOA	See Map (Attachment B) for place of use								Well 3, Well 4, Well 5, Well 3R, Well 6A, Well 6B	11/25/1966			
TOTAL ACRES:												TOTAL ACRES: N/A														

Additional remarks: **The Applicant is proposing to add three additional points of appropriation, Well 3R, Well 6A, and Well 6B to Certificates 87381 and 87380. Well 6A and Well 6B represent two possible locations for an additional well to be drilled, but the City plans to only drill one Well.**

RECEIVED  
MAR 29 2023  
OWRD

14205

**For Place of Use or Character of Use Changes N/A**

Are there other water right certificates, water use permits or ground water registrations associated with the “from” or the “to” lands?  Yes  No N/A

If YES, list the certificate, water use permit, or ground water registration numbers: N/A.

 Pursuant to ORS 540.510, any “layered” water use such as an irrigation right that is supplemental to a primary right proposed for transfer must be included in the transfer or be cancelled. Any change to a ground water registration must be filed separately in a ground water registration modification application.

**For Substitution** (ground water supplemental irrigation will be substituted for surface water primary irrigation)

Ground water supplemental Permit or Certificate # N/A;

Surface water primary Certificate # N/A.

RECEIVED

MAR 29 2023

**For a change from Supplemental Irrigation Use to Primary Irrigation Use N/A**

Identify the primary certificate to be cancelled. Certificate # N/A

OWRD

**For a change in point(s) of appropriation (well(s)) or additional point(s) of appropriation:**

- Well log(s) are attached for each authorized and proposed well(s) that are clearly labeled and associated with the corresponding well(s) in Table 1 above and on the accompanying application map.

**Tip:** You may search for well logs on the Department’s web page at:

[http://apps.wrd.state.or.us/apps/gw/well\\_log/Default.aspx](http://apps.wrd.state.or.us/apps/gw/well_log/Default.aspx)

**AND/OR**

- Describe the construction of the authorized and proposed well(s) in Table 3 for any wells that do not have a well log. For *proposed wells not yet constructed or built*, provide “a best estimate” for each requested information element in the table. The Department recommends you consult a licensed well driller, geologist, or certified water right examiner to assist with assembling the information necessary to complete Table 3.

**Table 3. Construction of Point(s) of Appropriation**

Any well(s) in this listing must be clearly tied to corresponding well(s) described in Table 1 and shown on the accompanying application map. Failure to provide the information will delay the processing of your transfer application until it is received. The information is necessary for the department to assess whether the proposed well(s) will access the same source aquifer as the authorized point(s) of appropriation (POA). The Department is prohibited by law from approving POA changes that do not access the same source aquifer.

Proposed or Authorized POA Name or Number	Is well already built? (Yes or No)	If an existing well: OWRD Well ID Tag No. L-___	Total well depth	Casing Diameter	Casing Intervals (feet)	Seal depth(s) (intervals)	Perforated or screened intervals (in feet)	Static water level of completed well (in feet)	Source aquifer (sand, gravel, basalt, etc.)	Well-specific rate (cfs or gpm). If less than full rate of water right
Well 3R	No	N/A	260 ft	16 in	+1-260	0-140	205-250	80-120	Alluvial supply in Willamette Basin	200-300 gpm
Well 3R	No	N/A	260 ft	16 in	+1-260	0-140	205-250	80-120	Alluvial supply in Willamette Basin	200-300 gpm

RECEIVED

MAR 29 2023

OWRD

## **Attachment A**

Certificates 87380 and 87381

---

Application for a Permanent Water Right Transfer - Certificates 82380 & 87381

City of Aurora

14205

STATE OF OREGON

COUNTY OF MARION

CERTIFICATE OF WATER RIGHT

THIS CERTIFICATE ISSUED TO

CITY OF AURORA  
21420 MAIN STREET NE  
AURORA OR 97002

confirms the right to use the waters of THREE WELLS, in the WILLAMETTE BASIN for MUNICIPAL USE.

This right was perfected under Permit G-9890. The date of priority is MAY 19, 1982. The amount of water to which this right is entitled is limited to an amount actually used beneficially, and shall not exceed 0.56 CUBIC FOOT PER SECOND, in any combination from the wells or its equivalent in case of rotation, measured at the wells.

The wells are located as follows:

Twp	Rng	Mer	Sec	Q-Q	Measured Distances
4 S	1 W	WM	13	SE NW	WELL 4 - 1840 FEET SOUTH & 2515 FEET EAST FROM NW CORNER OF SECTION 13
4 S	1 W	WM	13	SE NW	WELL 3 - 810 FEET NORTH & 430 FEET WEST FROM CENTER OF SECTION 13
4 S	1 W	WM	13	NE SW	WELL 5 - 966 FEET SOUTH & 410 FEET WEST FROM CENTER OF SECTION 13

A description of the place of use is as follows:

MUNICIPAL USE				
Twp	Rng	Mer	Sec	Q-Q
4 S	1 W	WM	12	NE SW
4 S	1 W	WM	12	NW SW
4 S	1 W	WM	12	SW SW
4 S	1 W	WM	12	SE SW
4 S	1 W	WM	12	NW SE
4 S	1 W	WM	12	SW SE
4 S	1 W	WM	13	NW NE
4 S	1 W	WM	13	SW NE
4 S	1 W	WM	13	NE NW
4 S	1 W	WM	13	NW NW
4 S	1 W	WM	13	SW NW
4 S	1 W	WM	13	SE NW
4 S	1 W	WM	13	NE SW

RECEIVED  
MAR 29 2023  
OWRD

NOTICE OF RIGHT TO RECONSIDERATION OR JUDICIAL REVIEW

This is an order in other than a contested case. This order is subject to judicial review under ORS 183.482. Any petition for judicial review must be filed within the 60-day time period specified by ORS 183.482. Pursuant to ORS 183.482, ORS 536.075 and OAR 137-003-0675, you may petition for judicial review and petition the Director for reconsideration of this order. A petition for reconsideration may be granted or denied by the Director, and if no action is taken within 60 days following the date the petition was filed, the petition shall be deemed denied.



MUNICIPAL USE				
Twp	Rng	Mer	Sec	Q-Q
4 S	1 W	WM	13	NW SW
4 S	1 W	WM	13	NW SE
4 S	1 W	WM	14	NE SE

The wells shall be maintained in accordance with the General Standards for the Construction and Maintenance of Water Wells in Oregon.

Water may be applied to lands which are not specifically described above, provided the holder of this right complies with ORS 540.510(3).

The quantity of water diverted at the additional two points of appropriation, together with that diverted at the original point of appropriation, shall not exceed the quantity of water lawfully available at the original point of appropriation.

When required by the Department, the water user shall install and maintain in-line flow meter(s) or other suitable device(s) for measuring and recording the quantity of water appropriated. The type and plans of the measuring device(s) must be approved by the Department prior to beginning construction and shall be installed under the general supervision of the Department.

This certificate is issued to confirm additional points of appropriation and change in place of use approved by an order of the Water Resources Director entered January 3, 2006, at Special Order Volume 68, Page 7, approving Transfer Application 9944, and supersedes Certificate 81591, State record of Water Right Certificates.

The right to the use of the water for the above purpose is restricted to beneficial use on the lands or place of use described.

Issued JAN 24 2012

  
 \_\_\_\_\_  
 Dwight W. French  
 Water Right Services Administrator, for  
 Phillip C. Ward, Director

RECEIVED  
 MAR 29 2023  
 OWRD

STATE OF OREGON

COUNTY OF MARION

CERTIFICATE OF WATER RIGHT

THIS CERTIFICATE ISSUED TO

CITY OF AURORA  
21420 MAIN STREET NE  
AURORA OR 97002

confirms the right to use the waters of THREE WELLS, TRIBUTARIES OF PUDDING RIVER for MUNICIPAL USE.

This right was perfected under Permit G-3526. The date of priority is NOVEMBER 25, 1966. The amount of water to which this right is entitled is limited to an amount actually used beneficially, and shall not exceed 0.5 CUBIC FOOT PER SECOND, or its equivalent in case of rotation, measured at the wells.

The wells are located as follows:

Twp	Rng	Mer	Sec	Q-Q	Measured Distances
4 S	1 W	WM	13	SE NW	WELL 3 - 810 FEET NORTH & 430 FEET WEST FROM CENTER, OF SECTION 13
4 S	1 W	WM	13	SE NW	WELL 4 - 1840 FEET SOUTH & 2515 FEET EAST FROM NW CORNER, OF SECTION 13
4 S	1 W	WM	13	NE SW	WELL 5 - 966 FEET SOUTH & 410 FEET WEST FROM CENTER, OF SECTION 13

The use shall conform to such reasonable rotation system as may be ordered by the proper state officer.

A description of the place of use is as follows:

MUNICIPAL USE				
Twp	Rng	Mer	Sec	Q-Q
4 S	1 W	WM	12	NE SW
4 S	1 W	WM	12	NW SW
4 S	1 W	WM	12	SW SW
4 S	1 W	WM	12	SE SW
4 S	1 W	WM	12	NW SE
4 S	1 W	WM	12	SW SE
4 S	1 W	WM	13	NW NE
4 S	1 W	WM	13	SW NE
4 S	1 W	WM	13	NE NW
4 S	1 W	WM	13	NW NW
4 S	1 W	WM	13	SW NW

RECEIVED  
MAR 29 2023  
OWRD

**NOTICE OF RIGHT TO RECONSIDERATION OR JUDICIAL REVIEW**

This is an order in other than a contested case. This order is subject to judicial review under ORS 183.482. Any petition for judicial review must be filed within the 60-day time period specified by ORS 183.482. Pursuant to ORS 183.482, ORS 536.075 and OAR 137-003-0675, you may petition for judicial review and petition the Director for reconsideration of this order. A petition for reconsideration may be granted or denied by the Director, and if no action is taken within 60 days following the date the petition was filed, the petition shall be deemed denied.

MUNICIPAL USE				
Twp	Rng	Mer	Sec	Q-Q
4 S	1 W	WM	13	SE NW
4 S	1 W	WM	13	NE SW
4 S	1 W	WM	13	NW SW
4 S	1 W	WM	13	NW SE
4 S	1 W	WM	14	NE SE

The quantity of water diverted at the additional points of appropriation, together with that diverted at the original point of appropriation, shall not exceed the quantity of water lawfully available at the original point of appropriation.

When required by the Department, the water user shall install and maintain in-line flow meter(s) or other suitable device(s) for measuring and recording the quantity of water appropriated. The type and plans of the measuring device(s) must be approved by the Department prior to beginning construction and shall be installed under the general supervision of the Department.

Water may be applied to lands which are not specifically described above, provided the holder of the right complies with ORS 540.510(3).

This certificate is issued to confirm additional points of appropriation and change in place of use approved by an order of the Water Resources Director entered September 21, 2005, at Special Order Volume 67, Page 173, approving Transfer Application 9927, and supersedes Certificate 36316, State record of Water Right Certificates.

The right to the use of the water for the above purpose is restricted to beneficial use on the lands or place of use described.

Issued JAN 24 2012.

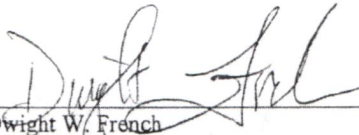
  
 Dwight W. French  
 Water Right Services Administrator, for  
 Phillip C. Ward, Director

RECEIVED  
 MAR 29 2023  
 OWRD

RECEIVED  
MAR 29 2023  
OWRD

## **Attachment B**

Application Map

---

Application for a Permanent Water Right Transfer - Certificates 82380 & 87381

City of Aurora

14205

RECEIVED

MAR 29 2023

OWRD

## **Attachment C**

Evidence of Use Affidavit

---

Application for a Permanent Water Right Transfer – Certificates 82380 & 87381

City of Aurora

14205

# Application for Water Right Transfer

## Evidence of Use Affidavit



Oregon Water Resources Department  
 725 Summer Street NE, Suite A  
 Salem, Oregon 97301-1266  
 (503) 986-0900  
 www.wrd.state.or.us

Please print legibly or type. Be as specific as possible. Attach additional pages if you need more spacing. Supporting documentation must be attached.

State of Oregon )  
 ) ss  
 County of MARION

I, MARK GUNTER, in my capacity as PUBLIC WORKS SUPERVISOR,

mailing address 21420 MAIN STREET, AURORA, OR 97002

telephone number (971)930-3597, being first duly sworn depose and say:

1. My knowledge of the exercise or status of the water right is based on (check one):

- Personal observation                       Professional expertise

2. I attest that:

Water was used during the previous five years on the **entire** place of use for Certificates # 87381 AND 87380; **OR**

My knowledge is specific to the use of water at the following locations within the last five years:

Certificate #	Township	Range	Mer	Sec	¼ ¼	Gov't Lot or DLC	Acres (if applicable)

OR

- Confirming Certificate # \_\_\_\_\_ has been issued within the past five years; **OR**
- Part or all of the water right was leased instream at some time within the last five years. The instream lease number is: \_\_\_\_\_ (Note: If the entire right proposed for transfer was not leased, additional evidence of use is needed for the portion not leased instream.); **OR**
- The water right is not subject to forfeiture and documentation that a presumption of forfeiture for non-use would be rebutted under ORS 540.610(2) is attached.
- Water has been used at the actual current point of diversion or appropriation for more than 10 years for Certificate # \_\_\_\_\_ (For Historic POD/POA Transfers)

3. The water right was used for: (e.g., crops, pasture, etc.): MUNICIPAL

4. I understand that if I do not attach one or more of the documents shown in the table below to support the above statements, my application will be considered incomplete.

(continues on reverse side)

RECEIVED  
 MAR 29 2023  
 OWRD

[Signature]  
 Signature of Affiant

March 16, 2023  
 Date

Signed and sworn to (or affirmed) before me this 16<sup>th</sup> day of March, 2023.



[Signature]  
 Notary Public for Oregon

My Commission Expires: July 5, 2025

Supporting Documents	Examples
<input type="checkbox"/> Copy of a water right certificate that has been issued within the last five years. (not a remaining right certificate)	Copy of <b>confirming</b> water right certificate that shows issue date
<input type="checkbox"/> Copies of receipts from sales of irrigated crops or for expenditures related to use of water	<ul style="list-style-type: none"> <li>• Power usage records for pumps associated with irrigation use</li> <li>• Fertilizer or seed bills related to irrigated crops</li> <li>• Farmers Co-op sales receipt</li> </ul>
<input type="checkbox"/> Records such as FSA crop reports, irrigation district records, NRCS farm management plan, or records of other water suppliers	<ul style="list-style-type: none"> <li>• District assessment records for water delivered</li> <li>• Crop reports submitted under a federal loan agreement</li> <li>• Beneficial use reports from district</li> <li>• IRS Farm Usage Deduction Report</li> <li>• Agricultural Stabilization Plan</li> <li>• CREP Report</li> </ul>
<input type="checkbox"/> Aerial photos containing sufficient detail to establish location and date of photograph	<p>Multiple photos can be submitted to resolve different areas of a water right.            If the photograph does not print with a "date stamp" or without the source being identified, the date of the photograph and source should be added.</p> <p>Sources for aerial photos:            OSU – <a href="http://www.oregonexplorer.info/imagery">www.oregonexplorer.info/imagery</a>            OWRD – <a href="http://www.wrd.state.or.us">www.wrd.state.or.us</a>            Google Earth – <a href="http://earth.google.com">earth.google.com</a>            TerraServer – <a href="http://www.terraserver.com">www.terraserver.com</a></p>
<input type="checkbox"/> Approved Lease establishing beneficial use within the last 5 years	Copy of instream lease or lease number
<input checked="" type="checkbox"/> The water right is not subject to forfeiture and documentation that a presumption of forfeiture for non-use would be rebutted under ORS 540.610(2) is attached.	<b>This is a municipal water right and a presumption of forfeiture would be rebutted under ORS 540.610(2)(a) and (b). See water right Certificate 94816 (Attachment A).</b>

RECEIVED  
 MAR 29 2023  
 OWRD

RECEIVED  
MAR 29 2023  
OWRD

## **Attachment D**

Land Use Information Forms

---

Application for a Permanent Water Right Transfer – Certificates 82380 & 87381

City of Aurora

14205



# Land Use Information Form



Oregon Water Resources Department  
725 Summer Street NE, Suite A  
Salem, Oregon 97301-1266  
(503) 986-0900  
www.oregon.gov/OWRD

## NOTE TO APPLICANTS

In order for your application to be processed by the Water Resources Department (WRD), this Land Use Information Form must be completed by a local government planning official in the jurisdiction(s) where your water right will be used and developed. The planning official may choose to complete the form while you wait, or return the receipt stub to you. Applications received by WRD without the Land Use Form or the receipt stub will be returned to you. Please be aware that your application will not be approved without land use approval.

**This form is NOT required if:**

- 1) Water is to be diverted, conveyed, and/or used only on federal lands; **OR**
- 2) The application is for a water right transfer, allocation of conserved water, exchange, permit amendment, or ground water registration modification, and **all** of the following apply:
  - a) The existing and proposed water use is located entirely within lands zoned for exclusive farm-use or within an irrigation district;
  - b) The application involves a change in place of use only;
  - c) The change does not involve the placement or modification of structures, including but not limited to water diversion, impoundment, distribution facilities, water wells and well houses; **and**
  - d) The application involves irrigation water uses only.

## NOTE TO LOCAL GOVERNMENTS

The person presenting the attached Land Use Information Form is applying for or modifying a water right. The Water Resources Department (WRD) requires its applicants to obtain land-use information to be sure the water rights do not result in land uses that are incompatible with your comprehensive plan. Please complete the form or detach the receipt stub and return it to the applicant for inclusion in their water right application. You will receive notice once the applicant formally submits his or her request to the WRD. The notice will give more information about WRD's water rights process and provide additional comment opportunities. You will have 30 days from the date of the notice to complete the land-use form and return it to the WRD. If no land-use information is received from you within that 30-day period, the WRD may presume the land use associated with the proposed water right is compatible with your comprehensive plan. Your attention to this request for information is greatly appreciated by the Water Resources Department. If you have any questions concerning this form, please contact the WRD's Customer Service Group at 503-986-0801.

RECEIVED

MAR 29 2023

OWRD

14205

# Land Use Information Form

Applicant(s): City of Aurora, Attn: Mark Gunter

Mailing Address: 21420 Main Street

City: Aurora

State: OR

Zip Code: 97002

Daytime Phone: 971-930-3597

## A. Land and Location

Please include the following information for all tax lots where water will be diverted (taken from its source), conveyed (transported), and/or used or developed. Applicants for municipal use, or irrigation uses within irrigation districts may substitute existing and proposed service-area boundaries for the tax-lot information requested below.

Township	Range	Section	¼ ¼	Tax Lot #	Plan Designation (e.g., Rural Residential/RR-5)	Water to be:	Proposed Land Use:
<u>4S</u>	<u>1W</u>	<u>13</u>	<u>SE NW</u>	<u>5700</u>	<u>City Parks</u>	<input checked="" type="checkbox"/> Diverted <input checked="" type="checkbox"/> Conveyed <input checked="" type="checkbox"/> Used	<u>Municipal</u>

List all counties and cities where water is proposed to be diverted, conveyed, and/or used or developed:

**City of Aurora**

**Marion County**

## B. Description of Proposed Use

Type of application to be filed with the Water Resources Department:

- Permit to Use or Store Water   
  Water Right Transfer   
  Permit Amendment or Ground Water Registration Modification  
 Limited Water Use License   
  Allocation of Conserved Water   
  Exchange of Water

Source of water:  Reservoir/Pond     Ground Water     Surface Water (name) \_\_\_\_\_

Estimated quantity of water needed: 1.06     cubic feet per second     gallons per minute     acre-feet

Intended use of water:  Irrigation     Commercial     Industrial     Domestic for \_\_\_\_\_ household(s)  
 Municipal     Quasi-Municipal     Instream     Other \_\_\_\_\_

Briefly describe:

**The Applicant is proposing to add three additional points of appropriation, Well 3R, Well 6a, and Well 6b, to Certificates 87381 and 87380. The location of Well 3R is listed in the above table and shown on the attached map. Wells 6a and 6b are not within the City's UGB, and are included on a separate land use form for the county.**

**Note to applicant:** If the Land Use Information Form cannot be completed while you wait, please have a local government representative sign the receipt at the bottom of the next page and include it with the application filed with the Water Resources Department.

See bottom of Page 3. →

  
**RECEIVED**  
**MAR 29 2023**  
**OWRD**

# For Local Government Use Only

The following section must be completed by a planning official from each county and city listed unless the project will be located entirely within the city limits. In that case, only the city planning agency must complete this form. This deals only with the local land-use plan. Do not include approval for activities such as building or grading permits.

**Please check the appropriate box below and provide the requested information**

- Land uses to be served by the proposed water uses (including proposed construction) are allowed outright or are not regulated by your comprehensive plan. Cite applicable ordinance section(s):
- Land uses to be served by the proposed water uses (including proposed construction) involve discretionary land-use approvals as listed in the table below. (Please attach documentation of applicable land-use approvals which have already been obtained. Record of Action/land-use decision and accompanying findings are sufficient.) **If approvals have been obtained but all appeal periods have not ended, check "Being pursued."**

Type of Land-Use Approval Needed (e.g., plan amendments, rezones, conditional-use permits, etc.)	Cite Most Significant, Applicable Plan Policies & Ordinance Section References	Land-Use Approval:	
		<input type="checkbox"/> Obtained <input type="checkbox"/> Denied	<input type="checkbox"/> Being Pursued <input type="checkbox"/> Not Being Pursued
	<b>RECEIVED</b>	<input type="checkbox"/> Obtained <input type="checkbox"/> Denied	<input type="checkbox"/> Being Pursued <input type="checkbox"/> Not Being Pursued
	<b>MAR 29 2023</b>	<input type="checkbox"/> Obtained <input type="checkbox"/> Denied	<input type="checkbox"/> Being Pursued <input type="checkbox"/> Not Being Pursued
	<b>OWRD</b>	<input type="checkbox"/> Obtained <input type="checkbox"/> Denied	<input type="checkbox"/> Being Pursued <input type="checkbox"/> Not Being Pursued
		<input type="checkbox"/> Obtained <input type="checkbox"/> Denied	<input type="checkbox"/> Being Pursued <input type="checkbox"/> Not Being Pursued

Local governments are invited to express special land-use concerns or make recommendations to the Water Resources Department regarding this proposed use of water below, or on a separate sheet.

Section 6 of the 2009 Water System Master Plan Update includes extensive analysis and documentation supporting the Plan's recommendation to maintain and incrementally increase the City's well supply in order to meet projected water demands. The new POA is consistent with the City's applicable long range plans and policies.

Name: Curt Fisher, AICP Title: City Planner

Signature: Curt Fisher  Phone: 503-588-1616 Date: 3/22/2023

Government Entity: City of Aurora

**Note to local government representative:** Please complete this form or sign the receipt below and return it to the applicant. If you sign the receipt, you will have 30 days from the Water Resources Department's notice date to return the completed Land Use Information Form or WRD may presume the land use associated with the proposed use of water is compatible with local comprehensive plans.



**Receipt for Request for Land Use Information**

Applicant name: \_\_\_\_\_

City or County: \_\_\_\_\_ Staff contact: \_\_\_\_\_

Signature: \_\_\_\_\_ Phone: \_\_\_\_\_ Date: \_\_\_\_\_

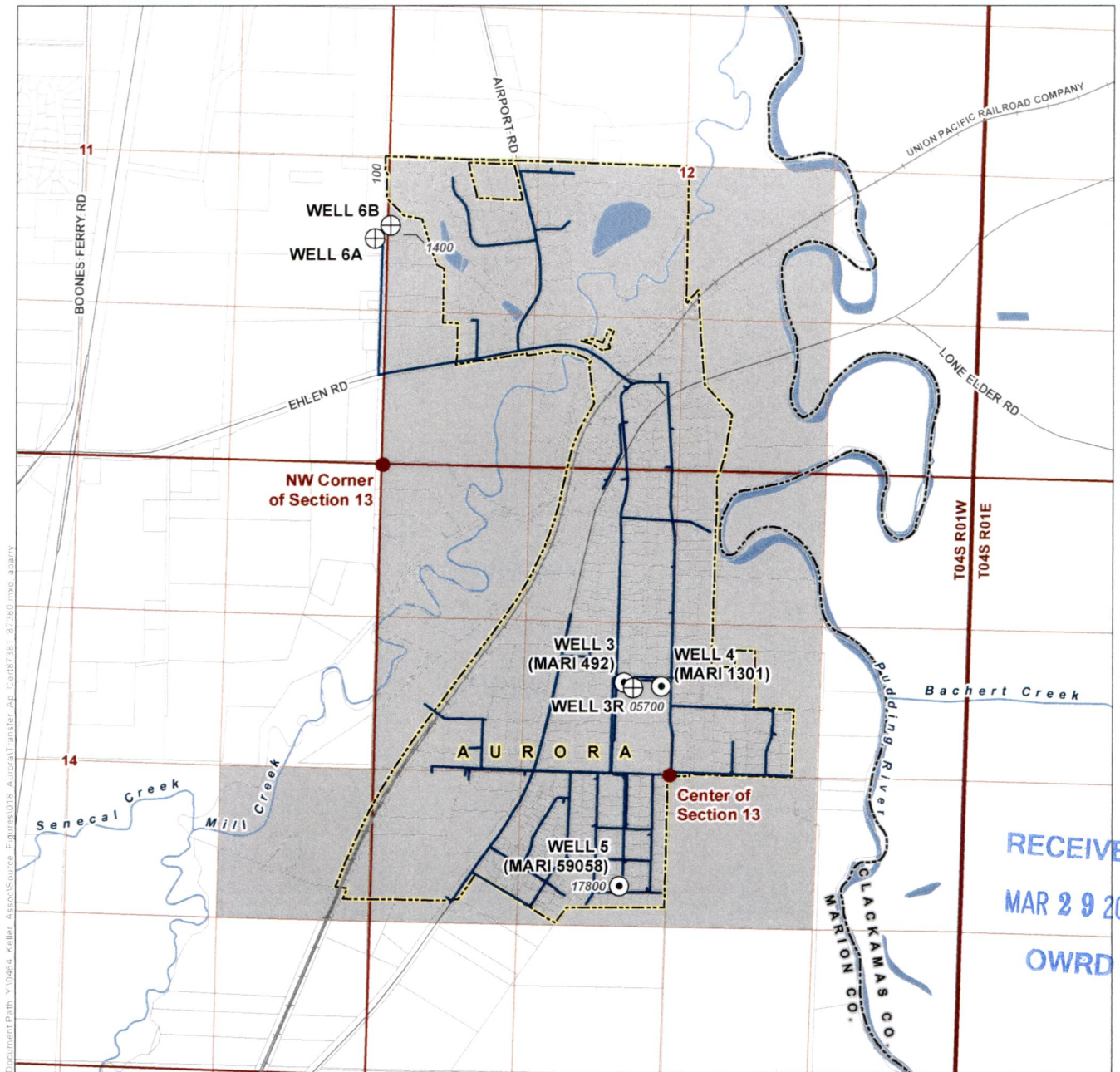

RECEIVED  
MAR 29 2023  
OWRD

**LEGEND**

- Authorized POA
- Proposed Additional POA
- Conveyance Line
- Authorized Place of Use
- Tax Lot
- City Boundary
- County Boundary
- Major Road
- Railroad
- Watercourse
- Waterbody

**Transfer Application for Certificates 87381 and 87380  
in the Name of City of Aurora  
Authorized and Proposed Additional  
Points of Appropriation, Authorized Place of Use Map  
Township 4 South, Range 1 West (W.M.)**

**CERTIFIED WATER RIGHTS EXAMINER STAMP**

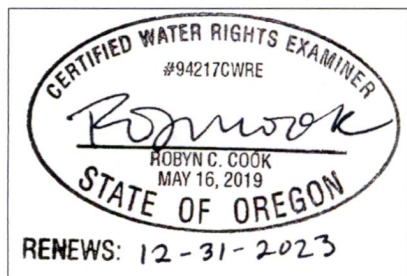

**LOCATION DESCRIPTION**

- Authorized Point of Appropriation (POA)**  
**Well 3:** Located 810 feet North and 430 feet West from Center of Section 13, Township 4 South, Range 1 West (W.M.)  
**Well 4:** Located 1840 feet South and 2515 feet East from NW Corner of Section 13, Township 4 South, Range 1 West (W.M.)  
**Well 5:** Located 966 feet South and 410 feet West from Center of Section 13, Township 4 South, Range 1 West (W.M.)  
**Proposed Additional POA**  
**Well 3R:** Located 1935 feet South and 2210 feet East from NW Corner of Section 13, Township 4 South, Range 1 West (W.M.)  
**Well 6A:** Located 1945 feet North and 55 feet West from NW Corner of Section 13, Township 4 South, Range 1 West (W.M.)  
**Well 6B:** Located 2065 feet North and 80 feet East from NW Corner of Section 13, Township 4 South, Range 1 West (W.M.)

**DISCLAIMER**

This map was prepared for the purpose of identifying the location of a water right only and it is not intended to provide legal dimensions or location of property ownership lines.

Date: March 24, 2023  
Data Sources: BLM, ESRI, OWRD, USGS, Marion Co.

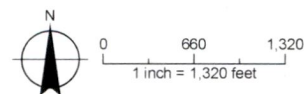

# Land Use Information Form



Oregon Water Resources Department  
725 Summer Street NE, Suite A  
Salem, Oregon 97301-1266  
(503) 986-0900  
www.oregon.gov/OWRD

## NOTE TO APPLICANTS

In order for your application to be processed by the Water Resources Department (WRD), this Land Use Information Form must be completed by a local government planning official in the jurisdiction(s) where your water right will be used and developed. The planning official may choose to complete the form while you wait, or return the receipt stub to you. Applications received by WRD without the Land Use Form or the receipt stub will be returned to you. Please be aware that your application will not be approved without land use approval.

**This form is NOT required if:**

- 1) Water is to be diverted, conveyed, and/or used only on federal lands; **OR**
- 2) The application is for a water right transfer, allocation of conserved water, exchange, permit amendment, or ground water registration modification, and **all** of the following apply:
  - a) The existing and proposed water use is located entirely within lands zoned for exclusive farm-use or within an irrigation district;
  - b) The application involves a change in place of use only;
  - c) The change does not involve the placement or modification of structures, including but not limited to water diversion, impoundment, distribution facilities, water wells and well houses; **and**
  - d) The application involves irrigation water uses only.

RECEIVED

MAR 29 2023

OWRD

## NOTE TO LOCAL GOVERNMENTS

The person presenting the attached Land Use Information Form is applying for or modifying a water right. The Water Resources Department (WRD) requires its applicants to obtain land-use information to be sure the water rights do not result in land uses that are incompatible with your comprehensive plan. Please complete the form or detach the receipt stub and return it to the applicant for inclusion in their water right application. You will receive notice once the applicant formally submits his or her request to the WRD. The notice will give more information about WRD's water rights process and provide additional comment opportunities. You will have 30 days from the date of the notice to complete the land-use form and return it to the WRD. If no land-use information is received from you within that 30-day period, the WRD may presume the land use associated with the proposed water right is compatible with your comprehensive plan. Your attention to this request for information is greatly appreciated by the Water Resources Department. If you have any questions concerning this form, please contact the WRD's Customer Service Group at 503-986-0801.

# Land Use Information Form



Oregon Water Resources Department  
 725 Summer Street NE, Suite A  
 Salem, Oregon 97301-1266  
 (503) 986-0900  
 www.oregon.gov/OWRD

RECEIVED

MAR 29 2023

OWRD

Applicant(s): City of Aurora, Attn: Mark Gunter

Mailing Address: 21420 Main Street

City: Aurora

State: OR

Zip Code: 97002

Daytime Phone: 971-930-3597

## A. Land and Location

Please include the following information for all tax lots where water will be diverted (taken from its source), conveyed (transported), and/or used or developed. Applicants for municipal use, or irrigation uses within irrigation districts may substitute existing and proposed service-area boundaries for the tax-lot information requested below.

Township	Range	Section	¼ ¼	Tax Lot #	Plan Designation (e.g., Rural Residential/RR-5)	Water to be:			Proposed Land Use:
<u>4S</u>	<u>1W</u>	<u>11</u>	<u>NE SE</u>	<u>100</u>	<u>Exclusive Farm Use (EFU)</u>	<input checked="" type="checkbox"/> Diverted	<input checked="" type="checkbox"/> Conveyed	<input type="checkbox"/> Used	<u>Municipal</u>
		<u>12</u>	<u>NW SW</u>	<u>1400</u>		<input checked="" type="checkbox"/> Diverted	<input checked="" type="checkbox"/> Conveyed	<input type="checkbox"/> Used	

List all counties and cities where water is proposed to be diverted, conveyed, and/or used or developed:

**Marion County**

**City of Aurora**

## B. Description of Proposed Use

Type of application to be filed with the Water Resources Department:

- Permit to Use or Store Water   
  Water Right Transfer   
  Permit Amendment or Ground Water Registration Modification  
 Limited Water Use License   
  Allocation of Conserved Water   
  Exchange of Water

Source of water:  Reservoir/Pond   
 Ground Water   
 Surface Water (name) \_\_\_\_\_

Estimated quantity of water needed: 1.06   
 cubic feet per second   
 gallons per minute   
 acre-feet

Intended use of water:  Irrigation   
 Commercial   
 Industrial   
 Domestic for \_\_\_\_\_ household(s)  
 Municipal   
 Quasi-Municipal   
 Instream   
 Other \_\_\_\_\_

Briefly describe:

**The Applicant is proposing to add three additional points of appropriation, Well 3R, Well 6A, and Well 6B to Certificates 87381 and 87380. The locations of Wells 6A and 6B is listed in the above table and shown on the attached map. Well 6A and Well 6B represent two possible locations for an additional well to be drilled. Well 3R is located in the City of Aurora and is included in a separate land use form for the City.**



**Note to applicant:** If the Land Use Information Form cannot be completed while you wait, please have a local government representative sign the receipt at the bottom of the next page and include it with the application filed with the Water Resources Department.

See bottom of Page 3. →

## For Local Government Use Only

The following section must be completed by a planning official from each county and city listed unless the project will be located entirely within the city limits. In that case, only the city planning agency must complete this form. This deals only with the local land-use plan. Do not include approval for activities such as building or grading permits.

**Please check the appropriate box below and provide the requested information**

- Land uses to be served by the proposed water uses (including proposed construction) are allowed outright or are not regulated by your comprehensive plan. Cite applicable ordinance section(s): **Only for tax lot 04-1W-12CB-01400 zoned UT-20. MCC 16.13.010 (H)**
- Land uses to be served by the proposed water uses (including proposed construction) involve discretionary land-use approvals as listed in the table below. (Please attach documentation of applicable land-use approvals which have already been obtained. Record of Action/land-use decision and accompanying findings are sufficient.) **If approvals have been obtained but all appeal periods have not ended, check "Being pursued."**

Type of Land-Use Approval Needed (e.g., plan amendments, rezones, conditional-use permits, etc.)	Cite Most Significant, Applicable Plan Policies & Ordinance Section References	Land-Use Approval:	
Administrative Review for tax lots zoned 04-1W-11D-00100, 04-1W-12CB-01500	EFU: MCC 17.136.040(I)	<input type="checkbox"/> Obtained <input type="checkbox"/> Denied	<input type="checkbox"/> Being Pursued <input checked="" type="checkbox"/> Not Being Pursued
		<input type="checkbox"/> Obtained <input type="checkbox"/> Denied	<input type="checkbox"/> Being Pursued <input type="checkbox"/> Not Being Pursued
		<input type="checkbox"/> Obtained <input type="checkbox"/> Denied	<input type="checkbox"/> Being Pursued <input type="checkbox"/> Not Being Pursued
		<input type="checkbox"/> Obtained <input type="checkbox"/> Denied	<input type="checkbox"/> Being Pursued <input type="checkbox"/> Not Being Pursued
		<input type="checkbox"/> Obtained <input type="checkbox"/> Denied	<input type="checkbox"/> Being Pursued <input type="checkbox"/> Not Being Pursued

Local governments are invited to express special land-use concerns or make recommendations to the Water Resources Department regarding this proposed use of water below, or on a separate sheet.

Municipal water supply is allowed outright in the UT-20 zone (taxlot 04-1W-12CB-01400). Such use requires and Administrative Reivew in the EFU zone (taxlots 04-1W-12CB-01500 and 04-1W-11D-00100).

Name: Nicole Inman Title: Associate Planner  
 Signature: *Nicole Inman* Phone: 503-588-5038 Date: 3/22/2023  
 Government Entity: Marion County Planning

**Note to local government representative:** Please complete this form or sign the receipt below and return it to the applicant. If you sign the receipt, you will have 30 days from the Water Resources Department's notice date to return the completed Land Use Information Form or WRD may presume the land use associated with the proposed use of water is compatible with local comprehensive plans.



**Receipt for Request for Land Use Information**

Applicant name: \_\_\_\_\_  
 City or County: \_\_\_\_\_ Staff contact: \_\_\_\_\_  
 Signature: \_\_\_\_\_ Phone: \_\_\_\_\_ Date: \_\_\_\_\_

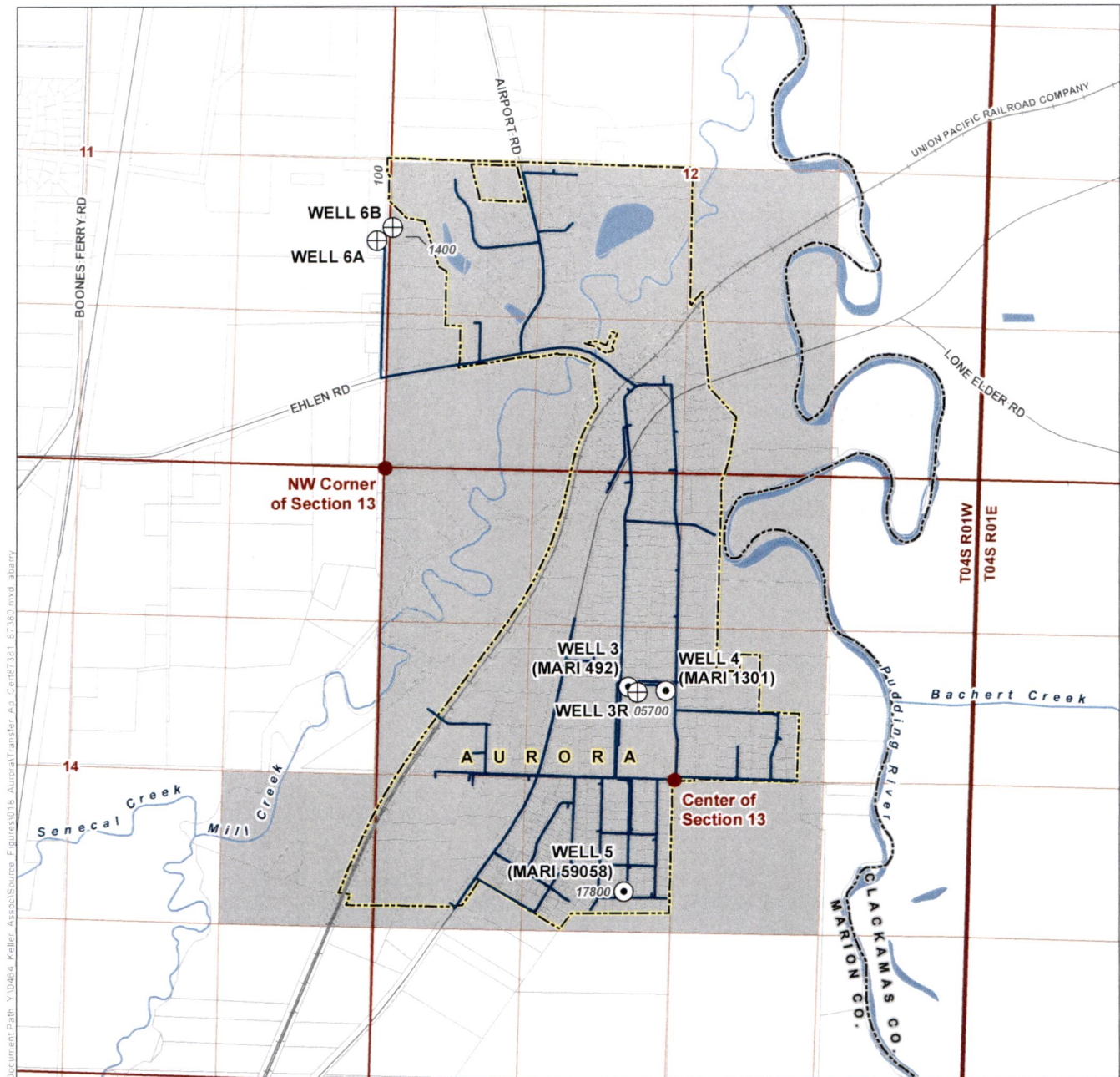

DocumentPath: Y:\0454\_keller\_Aspen\Source\_Figures\018\_Aurora\Transfer\_Ap\_Cert87381\_87380.mxd\_albany

**LEGEND**

- Authorized POA
- Proposed Additional POA
- Conveyance Line
- Authorized Place of Use
- Tax Lot
- City Boundary
- County Boundary
- Major Road
- Railroad
- Watercourse
- Waterbody

**CERTIFIED WATER RIGHTS EXAMINER STAMP**

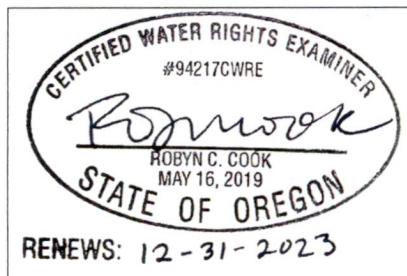

**Transfer Application for Certificates 87381 and 87380  
in the Name of City of Aurora**

RECEIVED  
MAR 29 2023  
OWRD

**Authorized and Proposed Additional  
Points of Appropriation, Authorized Place of Use Map**

Township 4 South, Range 1 West (W.M.)

**LOCATION DESCRIPTION**

**Authorized Point of Appropriation (POA)**

- Well 3:** Located 810 feet North and 430 feet West from Center of Section 13, Township 4 South, Range 1 West (W.M.)
- Well 4:** Located 1840 feet South and 2515 feet East from NW Corner of Section 13, Township 4 South, Range 1 West (W.M.)
- Well 5:** Located 966 feet South and 410 feet West from Center of Section 13, Township 4 South, Range 1 West (W.M.)

**Proposed Additional POA**

- Well 3R:** Located 1935 feet South and 2210 feet East from NW Corner of Section 13, Township 4 South, Range 1 West (W.M.)
- Well 6A:** Located 1945 feet North and 55 feet West from NW Corner of Section 13, Township 4 South, Range 1 West (W.M.)
- Well 6B:** Located 2065 feet North and 80 feet East from NW Corner of Section 13, Township 4 South, Range 1 West (W.M.)

**DISCLAIMER**

This map was prepared for the purpose of identifying the location of a water right only and it is not intended to provide legal dimensions or location of property ownership lines.

Date: March 24, 2023  
Data Sources: BLM, ESRI, OWRD, USGS, Marion Co.

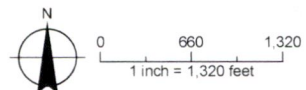



RECEIVED

MAR 29 2023

OWRD

## **Attachment E**

Well Logs

Well 3 (MARI 492)

Well 4 (MARI 1301)

Well 5 (MARI 59058)

---

Application for a Permanent Water Right Transfer – Certificates 82380 & 87381

City of Aurora

14205

MAR 1 492

NOTICE TO WATER WELL CONTRACTOR

The original and first copy of this report are to be filed with the

RECEIVED

NOV 18 1966 WATER WELL REPORT

State Well No. 4/1w-13 F

STATE ENGINEER, SALEM, OREGON 97310

STATE ENGINEER, STATE OF OREGON (Please type or print) SALEM, OREGON

G-3732

State Permit No.

(1) OWNER:

Name City of Aurora
Address Aurora, Oregon

(2) LOCATION OF WELL:

County Marian Driller's well number
1/4 1/4 Section 13 T. 4S R. 1W W.M.
Bearing and distance from section or subdivision corner

(3) TYPE OF WORK (check):

New Well [x] Deepening [ ] Reconditioning [ ] Abandon [ ]
Abandonment, describe material and procedure in Item 12.

(4) PROPOSED USE (check):

Domestic [ ] Industrial [ ] Municipal [x] Irrigation [ ] Test Well [ ] Other [ ]
Rotary [ ] Driven [ ] Cable [x] Jetted [ ] Dug [ ] Bored [ ]

(5) TYPE OF WELL:

(6) CASING INSTALLED:

Threaded [ ] Welded [x]
16" Diam. from 0 ft. to 226 ft. Gage 1/4"
12" Diam. from 184 ft. to 244 ft. Gage 1/4"

(7) PERFORATIONS:

Perforated? [x] Yes [ ] No
Type of perforator used Torch
Size of perforations 1/2 in. by 10 in.
216 perforations from 206 ft. to 242 ft.

(8) SCREENS:

Well screen installed? [ ] Yes [x] No
Manufacturer's Name
Model No.
Slot size Set from ft. to ft.
Diam. Slot size Set from ft. to ft.

(9) CONSTRUCTION:

Well seal—Material used in seal Bentonite Mud
Depth of seal 35 ft. Was a packer used? no
Diameter of well bore to bottom of seal 20 in.
Were any loose strata cemented off? [ ] Yes [x] No Depth
Was a drive shoe used? [ ] Yes [x] No
Was well gravel packed? [x] Yes [ ] No Size of gravel: 1" minus
Gravel placed from 202 ft. to 244 ft.
Did any strata contain unusable water? [ ] Yes [x] No
Type of water? depth of strata
Method of sealing strata off

(10) WATER LEVELS:

Static level 67 ft. below land surface Date 11/15/66
Artesian pressure lbs. per square inch Date

(11) WELL TESTS:

Drawdown is amount water level is lowered below static level
Was a pump test made? [x] Yes [ ] No If yes, by whom? driller
Yield: 275 gal./min. with 105 ft. drawdown after 12 hrs.
" 225 " 85 " 12 "
" 200 " 73 " 14 "
Bailer test gal./min. with ft. drawdown after hrs.
Artesian flow g.p.m. Date
Temperature of water Was a chemical analysis made? [ ] Yes [x] No

(12) WELL LOG:

Diameter of well below casing
Depth drilled 244 ft. Depth of completed well 244 ft.
Formation: Describe by color, character, size of material and structure, and show thickness of aquifers and the kind and nature of the material in each stratum penetrated, with at least one entry for each change of formation.

Table with columns MATERIAL, FROM, TO. Rows include Soil, Brown clay, Brown sandy clay, Brown sand, Brown sandy clay, Brown sand, Broken sand & gravel (brown), Blue clay, Black sand, Blue sandy clay, Black sand (fine), Blue sandy clay, Black sand, Blue clay, Black sand & gravel, Blue clay.

RECEIVED

MAR 29 2023

OWRD

Work started October 11 1966 Completed November 15 1966
Date well drilling machine moved off of well November 15 1966

(13) PUMP:

Manufacturer's Name
Type: H.P.

Water Well Contractor's Certification:

This well was drilled under my jurisdiction and this report is true to the best of my knowledge and belief.

NAME John Truman Miller (Person, firm or corporation) (Type or print)

Address P O Box 42 Hubbard, Oregon

Drilling Machine Operator's License No. 26

[Signed] John T. Miller (Water Well Contractor)

Contractor's License No. 277 Date November 16, 1966



RECEIVED

OCT 20 1981

WATER RESOURCES DEPT  
SALEM, OREGON

*Marion 4s/w-13ba*

LOG OF CITY OF AURORA 12" PRODUCTION  
WELL OCTOBER 15, 1981

Top Soil.....	0'-	1'
Brown Clay .....	1 -	7
Sandy Brown Clay .....	7 -	45
Silty Brown Clay .....	45 -	56
Brown Clay with Layers .....	56 -	
of Sand.....		- 63
Medium Brown Sand .....	63 -	83
Sand and Gravel .....	83 -	96
Brown Clay .....	96 -	100
Grey Clay .....	100 -	111
Grey Clay with .....	111 -	
Brown Streaks .....		-114
Sandy Brown Clay .....	114 -	123
Grey Clay with .....	123 -	
Brown Streaks .....		-126
Green Clay .....	126 -	129
Sandy Gray Clay .....	129 -	184
Black Sand with Clay .....	184 -	188
Grey Clay with Fine Sand .....	188 -	199
Black Sand with Small .....	199 -	
Wood Chips .....		-203
Sandy Grey Clay .....	203 -	207
Black Sand .....	207 -	226
Sand with Wood Chips .....	226 -	234
Brown Clay .....	234 -	241
Brown Claystone .....	241 -	250
Black Sand .....	250 -	261
Black Sandstone .....	261 -	277
Brown Clay .....	277 -	298
Sandy Blue Clay .....	298 -	303
Green Clay .....	303 -	307
Sandy Grey Clay .....	307 -	389

RECEIVED

MAR 29 2023

OWRD





Geo-Tech Explorations  
 A Division of **Boart Longyear**  
 19700 SW Teton Ave  
 Tualatin, OR 97062  
 503-692-6400  
 503-692-4759 (fax)

RECEIVED

MAR 29 2023

OWRD

RECEIVED

JUL 08 2005

WATER RESOURCES DEPT  
 SALEM, OREGON

Start Card: 173486  
 Well Label: L73600  
 Boring #: Aurora #5

**Casing/Liner**

Casing	Liner	Diameter	From	To	Gauge	Steel	Plastic	Welded	Threaded
<input checked="" type="checkbox"/>	<input type="checkbox"/>	16"	+2	165'	.375	<input checked="" type="checkbox"/>	<input type="checkbox"/>	<input checked="" type="checkbox"/>	<input type="checkbox"/>
<input type="checkbox"/>	<input checked="" type="checkbox"/>	10"	149.5	167	.365 ss/304	<input checked="" type="checkbox"/>	<input type="checkbox"/>	<input checked="" type="checkbox"/>	<input type="checkbox"/>
<input type="checkbox"/>	<input checked="" type="checkbox"/>	10"	187	226	.365 ss/304	<input checked="" type="checkbox"/>	<input type="checkbox"/>	<input checked="" type="checkbox"/>	<input type="checkbox"/>
<input type="checkbox"/>	<input checked="" type="checkbox"/>	10"	248	255	.365	<input checked="" type="checkbox"/>	<input type="checkbox"/>	<input checked="" type="checkbox"/>	<input type="checkbox"/>
<input type="checkbox"/>	<input checked="" type="checkbox"/>	10"	268	272.5	.365	<input checked="" type="checkbox"/>	<input type="checkbox"/>	<input checked="" type="checkbox"/>	<input type="checkbox"/>
<input type="checkbox"/>	<input type="checkbox"/>					<input type="checkbox"/>	<input type="checkbox"/>	<input type="checkbox"/>	<input type="checkbox"/>
<input type="checkbox"/>	<input type="checkbox"/>					<input type="checkbox"/>	<input type="checkbox"/>	<input type="checkbox"/>	<input type="checkbox"/>
<input type="checkbox"/>	<input type="checkbox"/>					<input type="checkbox"/>	<input type="checkbox"/>	<input type="checkbox"/>	<input type="checkbox"/>

Final Location of Shoe(s): \_\_\_\_\_

**Soil Profile Continued from Log:**

Material	From	To	SWL
Top soil	0	2	
Red clay	2	15	
Brown sand w/ clay	15	39	
Brown clay w/ coarse sand and small, rounded pea gravel	39	53	
Red & brown packed sand – coarse	53	62	
Sandy gravels – slightly cemented	62	80	
Brown sands & gravel w/ a lens of brown clay	80	83	
Gravel / sand – medium	83	88	
Brown clay w/ gravels	88	89	
Blue-green clay	89	119	
Course black sand	119	121	
Blue-green clay w/ silt	121	125	
Green / blue clay w/ layers of tan (sticky)	125	138	
Coarse black sand	138	140	
Blue green sand (sticky)	140	152	
Blue-gray sandy clay (coarse) w/ wood layers	152	162	
Blue-green clay	162	169	
Sand – med. coarse	169	178	
Clay – tan/brown	178	180	
Sand – med. coarse	180	187	
Clay – green	187	197	



# Permanent Transfer Application Checklist

Check the Certificates in WRIS

Transfer # T- 14205

Checked by <u>   Dante   </u> Date <u>   3/30/2023   </u>	Type of Change(s) Proposed: <b>NO</b> other changes allowed other than those listed	
Fee Received: \$3270	<input type="checkbox"/> POU <input type="checkbox"/> POD <input type="checkbox"/> APOD <input type="checkbox"/> POA <input checked="" type="checkbox"/> APOA <input type="checkbox"/> USE	
Calculated Fee: \$3270		How many rights to be Transferred? 2
Deficiencies and Observations:		Certificate #(s) 87380  87381

If OK, check box; if not, fill in.

1. Is the applicant information complete? Have all the applicants listed at the top of the page signed at the bottom?  
 If not, what is missing? Whose signature is missing? \_\_\_\_\_
2. Has the applicant indicated that the place of use is in or near an irrigation district? Have they included a Form D?  N/A.  
 Name of the District \_\_\_\_\_
3. Part 5 of application, has the applicant completed the entire page and does the information match the description of the explanation of the reasons on Part 4 of the application?  
 If not, you may need to contact the applicant or agent? \_\_\_\_\_
4. For multiple certificates, do each of the certificates listed on Application Page 1 have their own separate completed Part 5 tables 1 & 2? (compare with OAR 690-380-3220-may need to return)  
 If no, which certificates are missing a separate Part 5, tables 1 & 2? \_\_\_\_\_
5. Has the map been completed and signed by a CWRE? Does the map meet the requirements?  
 If not, what is missing? \_\_\_\_\_. Map waiver included?
6. If a change in point of appropriation, have the well logs been included?  N/A.
7. If a change in place of use within Umatilla County, have the applicant(s) provided a Supplemental Form U?  N/A.
8. Has applicant filled out the Minimum Requirements Checklist (Part 1 of 5)? Is the application complete? If not, what is missing (check Evidence of Use and Land Use)? \_\_\_\_\_  
 \_\_\_\_\_
9. If all boxes on this checklist are checked (with no remaining deficiencies identified), accept the application. Put this check sheet in the transfer folder.

OR:

- This application is deficient, and **CANNOT** be accepted.  
 It should be returned and the **deficiencies listed in the "staff" section at the bottom of Application Page 1**, unless the applicant or agent can resolve the deficiencies within 2-3 days.

**Actions taken:**

\_\_\_\_\_ date \_\_\_\_\_



## Permanent Transfer Application Checklist

FEE WORKSHEET for PERMANENT TRANSFER (except Substitution)			
1	Base Fee (includes one type of change to one water right for up to 1 cfs)	1	\$1,360
	Types of change proposed: <input type="checkbox"/> Place of Use <input type="checkbox"/> Character of Use <input type="checkbox"/> Point of Diversion/Appropriation Number of above boxes checked = _____ (2a) Subtract 1 from the number in line 2a = _____ (2b) <i>If only one change, this will be 0</i>		
2	Multiply line 2b by \$930 and enter » » » » » » » » » » » » » » » »	2	0
	Number of water rights included in transfer _____ (3a) Subtract 1 from the number in 3a above: _____ (3b) <i>If only one water right this will be 0</i>		
3	Multiply line 3b by \$520 and enter » » » » » » » » » » » » » » » »	3	0
	Do you propose to add or change a well, or change from a surface water POD to a well? <input type="checkbox"/> No: enter 0 » <input type="checkbox"/> Yes: enter \$410 »		
4		4	0
	Do you propose to change the place of use or character of use? <input type="checkbox"/> No: enter 0 on line 5 » <input type="checkbox"/> Yes: enter the cfs for the portions of the rights to be transferred (see example below*): _____ (5a) Subtract 1.0 from the number in 5a above: _____ (5b) If 5b is 0 or less, enter 0 on line 5 » If 5b is greater than 0, round up to the nearest whole number: _____ (5c) and multiply 5c by \$350, then enter on line 5 » » » » » » » » » »		
5		5	0
6	Add entries on lines 1 through 5 above » » » » » » » » » » Subtotal:	6	0
	Is this transfer: <input type="checkbox"/> necessary to complete a project funded by the Oregon Watershed Enhancement Board (OWEB) under ORS 541.932? <input type="checkbox"/> endorsed in writing by ODFW as a change that will result in a net benefit to fish and wildlife habitat? If one or more boxes is checked, multiply line 6 by 0.5 and enter on line 7 »		
7	If no box is applicable, enter 0 on line 7» »	7	0
8	Subtract line 7 from line 6 » <b>Transfer Fee:</b>	8	



March 24, 2023

Kelly Starnes  
Oregon Water Resources Department  
725 Summer Street NE, Suite A  
Salem, OR 97301

RE: Transfer Application for Certificates 87380 and 87381 in the name of The City of Aurora

Dear Kelly:

The City of Aurora is the holder of water right Certificate 87380, which authorizes the appropriation of 0.56 cubic feet per section (cfs) of groundwater for municipal use, and Certificate 87381, which authorizes the use of 0.5 cfs of groundwater for municipal use. The City is filing the enclosed transfer application to add three wells (Well 3R, Well 6A, and Well 6B) to the Certificates. Please note that the City intends to complete construction of either Well 6A or Well 6B, but not both. The City's application includes two proposed additional points of appropriation in order to reflect the possibility that the well will be completed on either tax lot 100 or 1400 (both of which are owned by the City) as reflected in the Land Use Information Form signed by Marion County. As noted in the Land Use Information Form provided by Marion County, the City has not yet submitted an application to Marion County planning for approval of the wells on the identified tax lots. The City plans to submit the necessary applications to Marion County in the future and will provide an updated Land Use Information Form reflecting that the City is pursuing approval or has received required approvals prior to the issuance of a Preliminary Determination.

Also enclosed is a check for the required processing fee of \$3,270.

Please contact me if you have any questions or concerns. My email address is [OMcMurtrey@gsiws.com](mailto:OMcMurtrey@gsiws.com).

Sincerely,

A handwritten signature in black ink that reads "Owen McMurtrey". The signature is written in a cursive style.

Owen McMurtrey  
Water Resources Consultant

Enclosures: Water Right Transfer Application  
Check for application fee in the amount of \$3,270.

RECEIVED  
MAR 29 2023  
OWRD