

# Application for Instream Lease

## Part 1 of 4 – Minimum Requirements Checklist



Oregon Water Resources Department  
 725 Summer Street NE, Suite A  
 Salem, Oregon 97301-1266  
 (503) 986-0900  
 www.oregon.gov/OWRD

Complete Part 1 through 4 and include the required attachments Fill in or check boxes as indicated. (N/A= Not Applicable)	OWRD # <u>11-1979</u>
	Fee- _____

Pursuant to ORS 537.348(2) and OAR 690-077

Check all items included with this application. (N/A = Not Applicable)

RECEIVED

Yes **Part 1 – Completed Minimum Requirements Checklist and Application Fee**

MAY 26 2023

Fees	<input type="checkbox"/> \$610.00 for a lease involving <b>four or more landowners or four or more water rights</b>	<input checked="" type="checkbox"/> \$410.00 for all other leases
	<input checked="" type="checkbox"/> Check enclosed <u>or</u> <input type="checkbox"/> Fee Charged to customer account _____ (account name)	

OWRD

Yes **Part 2 – Completed Instream Lease Application Map Checklist.**

Yes **Part 3 – Completed Water Right and Instream Use Information**  
 Include a separate **Part 3** for **each water right**

Yes **Part 4 – Completed Instream Lease Provisions and Signatures**

Yes **How many water rights are leased?** 1 **List them here:** 17218  
 Include a separate **Part 3** for **each water right.**

Yes  N/A **Other Water Rights**, if any, appurtenant to the lands involved in the lease application and not proposed to be leased instream?  
**List those other water rights here:** \_\_\_\_\_

Yes  No **Conservation Reserve Enhancement Program (CREP).** Are some or all of the lands to be leased part of CREP or another Federal program (list here: \_\_\_\_\_)?

**Attachments:**

Yes  N/A **Map:** Instream Lease map requirements (see Part 2 of this application)

Yes  N/A **Tax Lot Map:** If a portion of the water right *not included in the lease* is appurtenant to lands owned by others, a tax lot map must be included with the lease application. The tax lot map should clearly show the property involved in the lease.

Yes  N/A Supporting documentation describing why a right (or portion thereof) is valid and not subject to forfeiture even though the right has not been exercised for five or more consecutive years. This information only needs to be provided if the checkbox has been checked to identify that the water right has not been used in the last five years and is not subject to forfeiture (See Part 4 of 4). **Attachment A**

Yes  N/A If the Lessor (water right holder) is not the deeded landowner - provide one of the following.

- A notarized statement from the landowner consenting to the lease and a copy of the recorded deed; or.
- A water right conveyance agreement and a copy of the recorded deed for the landowner at the time the water right was conveyed; or
- Other documentation which provides authority to pursue the lease absent consent of the landowner.

## Part 2 of 4 – Instream Lease Application Map Checklist

**A Map is generally required for each water right not leased in its entirety**

The application map (if required) should include all the items listed below and match the existing water right(s) of record. Check all boxes that apply.

This should be a simple map. (See example below). A copy of a final proof survey map with the portion to be leased shaded or hachured in will also suffice.

- N/A A map is required for each water right not leased in its entirety. More than one QQ and property may be included on each map. A map is not required, if leasing the entire right or if the right to be leased is for municipal or quasi-municipal water use.
- The map should be of sufficient quality to be reproducible. Please do not use highlighters to mark items on the map as highlighters do not always copy.
- A North arrow and map scale (no smaller than 1" = 1320').
- Township, Range, Section, quarter quarter (QQ), and a clearly labeled survey corner.
- For irrigation or other similar use, the number of acres to be leased in each quarter-quarter clearly labeled and hachured to differentiate between the acres being leased and any remaining. If the place of use is broken down by more than one priority date, or source stream, and/or point of diversion you must identify each with separate hachuring and clearly label.
- If available, identify the existing point(s) of diversion.

**EXAMPLE MAP (the darker shaded portion representing the portion leased instream)**

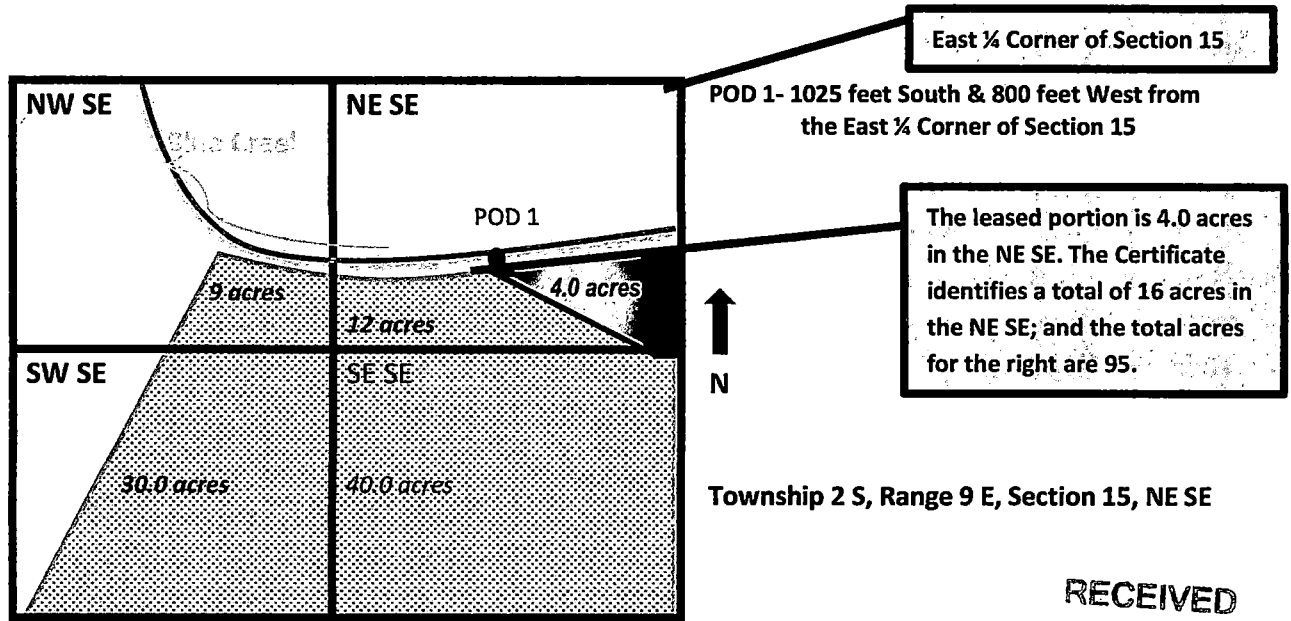

**RECEIVED**

MAY 26 2023

OWRD

**Part 3 of 4 – Water Right and Instream Use Information**

**Use a separate Part 3 for each water right to be leased instream**

**Water Right Information**

Water right # 17218

**Table 1**

Water Right Information: Provide a description of the originating water right to be leased. Also include your tax lot number(s). Fill in all applicable information. For example, if your water right has multiple points of diversion (POD) but they're not numbered, you do not need to include a number. If not enough room below, you may add additional rows (see instructions) or attach spreadsheet (matching Table 1). Please clearly label any attachments.

<input type="checkbox"/> If only leasing a portion of the right - complete Table 1 as indicated					<input checked="" type="checkbox"/> Entirety - If the entire water right is to be leased, skip to Table 3.					
Priority Date	POD #	Twp	Rng	Sec	Q-Q	Tax Lot	Gov't Lot/DLC	Acres	USE	Previous Lease # (if any)
EXAMPLE										
12/2/1901	3	2-S	9-E	15	NE SE	100	47	4.0	IR	IL-1100
		-	-		-					
		-	-		-					RECEIVED
		-	-		-					MAY 26 2023
		-	-		-					

Total Acres: \_\_\_\_\_

OWRD

**Table 2**

**To illustrate the totals for the water right proposed to be leased instream**

Total rate and volume by priority date, POD, use and acreage as appropriate considering the right to be leased. If not enough room below, you may add additional rows (see instructions) or attach spreadsheet (matching Table 2). Please clearly label any attachments. (cfs = cubic feet per second and af = acre-feet)

Priority Date	POD #	Use	Total Acres	Other Information (such as conditions/limitations on the right)	Total Rate (cfs)	Total Volume (af)
1904	1	Irrigation	50	N/A	0.9	326.6

Total af from storage, if applicable: \_\_\_\_\_ AF or  N/A

Any additional information about the right:

**Table 3**

**Point of Diversion (POD) description:** If the POD is not described on the certificate or if there is more than one POD listed on the certificate, then the specific POD(s) involved in the lease must be described. If not enough room below, you may add additional rows (see instructions) or attach spreadsheet (matching Table 3). Please clearly label any attachments.

POD #	Twp	Rng	Sec	Q-Q	DLC/ Gov't lot	Measured Distances, latitude/longitude coordinates, or river mile (if unknown you may indicate "unknown")
1	38 - S	3 - E	20	SW - NE	4400	42.252626, -122.491371
	-	-		-		

Please check this box if you don't know the location of the POD(s) and want the Department to identify the location of the POD(s) for the purpose of the instream lease.

**Instream Use Information**

**Table 4**

<b>Instream Use Created by the Lease</b>						
<b>River/ Stream Name:</b> <u>West Branch of Lalgawa (Dead Indian) Cr</u>			<b>tributary to</b> <u>Lalgawa (Dead Indian) Cr</u>		<b>River Basin:</b> <u>Rogue</u>	
<p><b>Instream Portion:</b> Use Table 4 to illustrate the instream rate, volume and instream period by priority date, POD (if more than one), Use (if more than one), and acreage as appropriate considering the right to be leased.</p> <p>If not enough room below, you may add additional rows (see instructions) or attach a spreadsheet (matching the below portion of Table 4). Please clearly label any attachments.</p>						
Priority date	POD #	Use	Acres	Proposed Instream Period	Total instream rate (cfs)	Total instream volume (af)
1904	1	Irrigation	50	Apr 1-Oct 1	0.9	170
<p>Note: If not certain of the instream rate, volume and/or instream period, see the instructions and/or contact Department Staff for assistance. The instream rate and volume may be up to the maximum rate and duty/volume allowed by the right, as described in Table 2 or on your Certificate if leasing the entire right. The proposed instream period may be no longer than the irrigation season or the authorized period of allowed use.</p>						
<p><b>OR</b> <input type="checkbox"/> Please check this box if you are not sure of the proposed rate, volume and instream period. As part of its review process, the Department will identify the appropriate instream rate, volume and period considering the water right(s) being leased and instream benefits.</p>						
<b>Instream Reach</b>						
<p><b>Proposed Instream Reach:</b></p> <p><input type="checkbox"/> A reach typically begins at the point of diversion (POD) and ends at the mouth of the source stream: From the POD to _____</p>				<p><b>Or Proposed Instream Point:</b></p> <p><input checked="" type="checkbox"/> Instream use protected at the POD</p>		
<p><b>OR</b> <input type="checkbox"/> Please check this box if you are not sure of the proposed reach and want water to be protected within a reach below the POD, if possible. (If no reach is identified or the above box is not checked, and there is only one POD listed on the certificate, the lease may be processed to be protected at the POD.)</p>						
<b>Additional Instream Information</b>						
<p><input checked="" type="checkbox"/> Yes <input type="checkbox"/> N/A <b>Conditions to avoid enlargement or injury to other water rights, if any, or other limitations:</b> list here <u>To avoid enlargement, the duty was limited to beneficial use calculated as 3.4 ac-ft per acre [3.06 ac-ft per ac plus evaporative loss (10%)]</u></p> <p>Note: The Department may identify additional conditions to prevent injury and/or enlargement.</p>						
<p><b>Any additional information about the proposed instream use:</b> _____</p>						

RECEIVED

MAY 26 2023

OWRD

**Part 4 of 4 – Lease Provisions and Party Signatures**

<p><b>Term of the Lease (may be from 1 year up to 5 years):</b>                  The lease is requested to begin in: month <u>April</u> year <u>2023</u> and end: month <u>Oct</u> year <u>2028</u>                  Note: The begin month is generally the first month of the irrigation season and the end month is the last month in the irrigation season. If not an irrigation right, this would be the first and last month of your authorized period of allowed use.</p>	
<p><b>Public use: Check the public use(s) this lease will serve (as defined by ORS 537.332):</b>  <input checked="" type="checkbox"/> Conservation, maintenance and enhancement of aquatic, fish and wildlife, fish and wildlife habitat and any other ecological values.  <input type="checkbox"/> Recreation  <input type="checkbox"/> Pollution abatement  <input type="checkbox"/> Navigation</p>	<p><b>Termination provision (for multiyear leases):</b>  <b>The parties to the lease request (choose one):</b>  <input checked="" type="checkbox"/> a. The option of terminating the lease prior to expiration of the full term with written notice to the Department by the Lessor(s) and/or Lessee.  <input type="checkbox"/> b. The option of terminating the lease prior to expiration of the full term, with consent by all parties to the lease.  <input type="checkbox"/> c. The parties would not like to include a Termination Provision.                  (See instructions for limitations to this provision)</p>
<p><b>Additive/Replacing Relationship to other instream water rights:</b> Instream leases are generally additive to other existing instream water rights created as a result of instream leases, transfers and/or allocations of conserved water. Since instream leases are also generally senior to other instream rights created through a state agency process or conversion of minimum flows, they generally replace a portion of these junior instream rights.                  If you would like this lease to relate to other instream water rights differently, please check this box. <input type="checkbox"/>                  And attach an explanation of your intent.</p>	
<p><b>Validity of the Right(s) to be leased (check the appropriate box):</b>  <input type="checkbox"/> The water right(s) to be leased have been used under the terms and conditions of the right(s) during the last five years or have been leased instream; or  <input checked="" type="checkbox"/> The water right(s) have not been used for the last five years according to the terms and conditions of the right(s). However, the water right(s) is not subject to forfeiture under ORS 540.610(2). Documentation describing why the water right(s) is not subject to forfeiture is provided. See Attachment A</p>	

**Precedent:** If a right which has been leased is later proposed to be leased again or later transferred or become part of an allocation of conserved water project, a new injury review shall be required. An instream lease shall not set a precedent on a future transaction.

**The undersigned declare:**

1. The Lessor(s) agree during the term of this lease, to suspend use of water allowed under the subject water right(s) and under any appurtenant primary or supplemental water right(s) not involved in the lease application; and
2. The Lessor(s) certify that I/we are the water right holder(s) of the right(s) described in this instream lease application. If not the deeded landowner, I/we have provided documentation with the lease application that I/we have authorization to pursue the lease application and/or have obtained consent from the deeded landowner; and
3. All parties affirm that information provided in this lease application is true and accurate.

Carol McRoss \_\_\_\_\_ Date: 5/23/23  
 Signature of Lessor

RECEIVED  
MAY 26 2023

Printed name (and title): CAROL McROSS Business name, if applicable: \_\_\_\_\_ OWRD  
 Mailing Address (with state and zip): 100 Sixth St Ashland OR 97520  
 Phone number (include area code): 503-722-0198 \*\*E-mail address: 32paint@gmail.com

See next page for additional signatures.

\_\_\_\_\_  
Signature of Co-Lessor Date: \_\_\_\_\_  
Printed name (and title): \_\_\_\_\_ Business name, if applicable: \_\_\_\_\_  
Mailing Address (with state and zip): \_\_\_\_\_  
Phone number (include area code): \_\_\_\_\_ \*\*E-mail address: \_\_\_\_\_

Julie Cymore  
Signature of Lessee Date: 5/23/2023  
Printed name (and title): Julie Cymore, Project Manager Business name, if applicable: Trout Unlimited  
Mailing Address (with state and zip): 1777 N Kent St, Suite 100, Arlington, VA 22209  
Phone number (include area code): 541-200-4469 \*\*E-mail address: Julie.Cymore@tu.org

**\*\* BY PROVIDING AN E-MAIL ADDRESS, CONSENT IS GIVEN TO RECEIVE ALL CORRESPONDENCE FROM THE DEPARTMENT ELECTRONICALLY. COPIES OF THE FINAL ORDER DOCUMENTS WILL ALSO BE MAILED TO THE LESSOR.**

RECEIVED  
MAY 26 2023  
OWRD

**Attachment A: Supporting Documentation**

As the water right holder, my personal knowledge of the history of water use of the water right (C-17218) pertains to the period of my ownership of the property (2021 and 2022 irrigation seasons). Prior to my purchase of the property in June 2021, it is my understanding that the previous landowner, who owned the property for several decades, used the property for irrigated pasture for cattle and the property has perimeter fencing to support this beneficial use. The water right(s) is not subject to forfeiture under ORS 540.610(2j) "The owner or occupant of the property to which the water right is appurtenant was unable to make full beneficial use of the water because water was not available." As the water right holder, I was and am ready, willing, and able to make full use the water had it been available. All irrigation seasons of my ownership, 2021-2022, have been during a declared drought. In the early season, water was available, but soil moisture content was too high to require irrigation. And during the later season, due to drought conditions, water was not available. This water right is junior to the senior water right (C-95728) which was not fulfilled for those two years. I am ready, willing, and able to irrigate this season, but my preference is to lease the water right instream to support ecological flows. I affirm that information provided in this lease application is true and accurate.

Carol M. Ross Date: 5/23/23  
Signature of Lessor

Printed name (and title): Carol M. Ross

Mailing Address (with state and zip): 100 Sixth St, Ashland OR 97520

RECEIVED  
MAY 26 2023  
OWRD