

Additional POD Cert. 13593

CERTIFIED WATER RIGHT EXAMINER
 72665
Gabriel M. Williams
 GABRIEL M. WILLIAMS
 JULY 10, 2018
 STATE OF OREGON
 RENEWS: 6/30/24

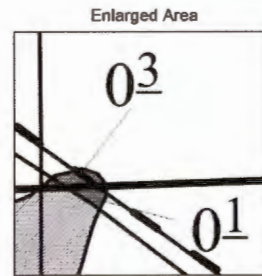
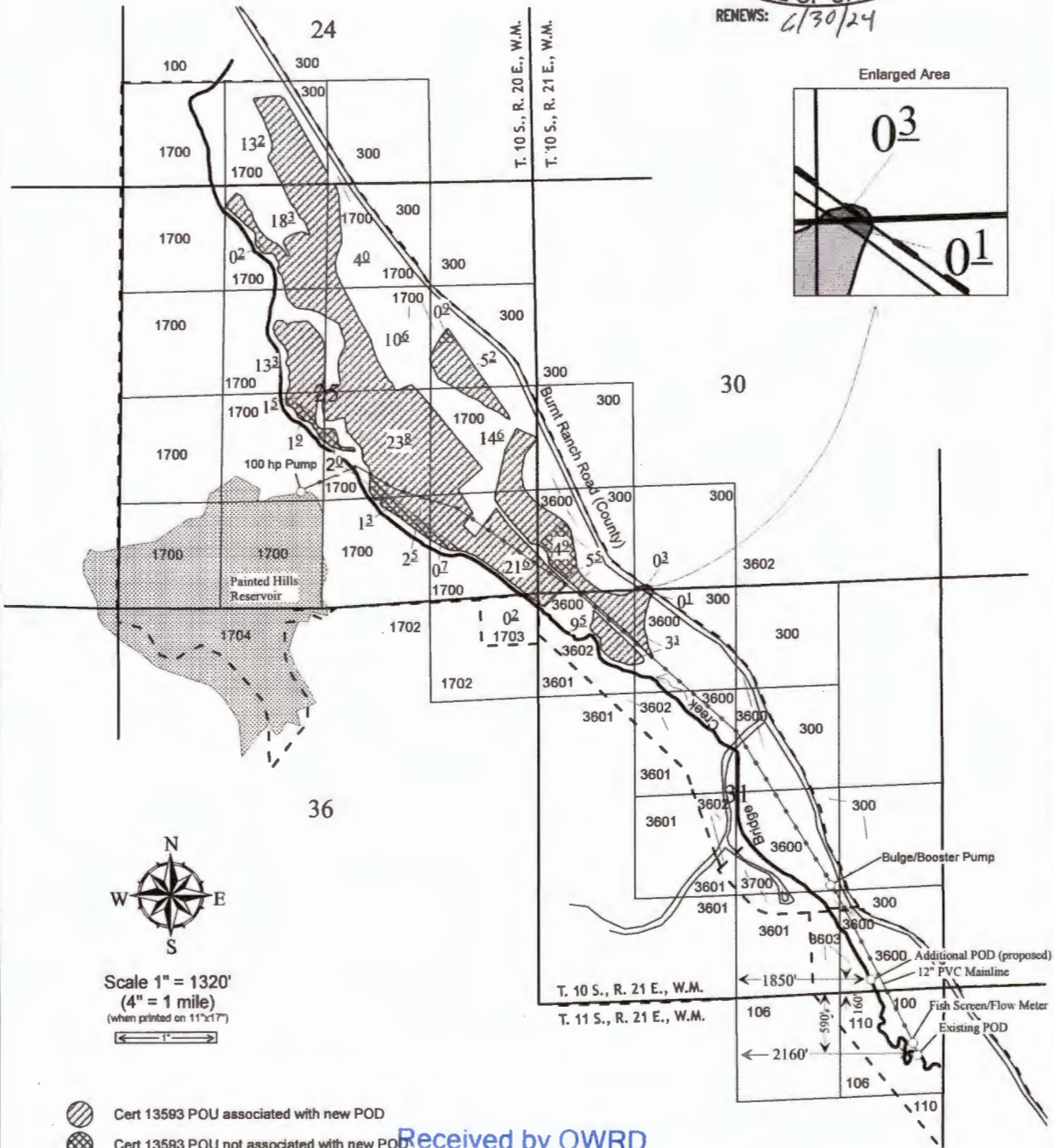

Scale 1" = 1320'
 (4" = 1 mile)
 (when printed on 11"x17")

- Cert 13593 POU associated with new POD
- Cert 13593 POU not associated with new POD
- Key Elements (pumps, meters, etc)
- Approximate Ownership Boundary
- Pipeline

This map is for the purpose of locating a water right only and is not intended to provide legal dimensions or locations of property ownership lines.

Received by OWRD

JUN 26 2023

Salem, OR

Federal Land Ownership Taxdots: 100, 106, 110, 300, 1702, 3601, 3602, 3603, 3700

6 SUPERSEDED

14158 -

BCR - 1.1	DRAWING:	PROJECT:
	DRAWN BY: GAW	13593 Additional POD
	SHEET TITLE:	PROJECT LOCATION:
	POD Map	MITCHELL, OREGON
	CLIENT:	BRIDGE CREEK RANCH, LLC

RSI Resource Specialists INC.

20340 Empire Ave. STE E8 BEND, OR 97703 (541) 771-6911 gabe@RSIengr.com

DRAWING STATUS	DATE	No.	REVISION	DATE
DRAFT	12/9/22			
FINAL	1/18/23			
REV A	6/26/23			