

# Groundwater Transfer Review Summary Form

Transfer/PA # T- 13611

GW Reviewer Grayson Fish Date Review Completed: 9/19/2023

## Summary of Same Source Review:

☐ The proposed change in point of appropriation is not within the same aquifer as per OAR 690-380-2110(2).

## Summary of Injury Review:

☐ The proposed transfer will result in another, existing water right not receiving previously available water to which it is legally entitled or result in significant interference with a surface water source as per 690-380-0100(3).

## Summary of GW-SW Transfer Similarity Review:

☐ The proposed SW-GW transfer doesn't meet the definition of "similarly" as per OAR 690-380-2130.

*This is only a summary. Documentation is attached and should be read thoroughly to understand the basis for determinations.*



Oregon Water Resources Department  
725 Summer Street NE, Suite A  
Salem, Oregon 97301-1271  
(503) 986-0900  
www.wrd.state.or.us

## Ground Water Review Form:

- ☒ **Water Right Transfer**  
☐ **Permit Amendment**  
☐ **GR Modification**  
☐ **Other**

Application: T-13611

Applicant Name: Boersma Family LLC

Proposed Changes: ☒ POA ☐ APOA ☐ SW→GW ☐ RA  
☐ USE ☒ POU ☐ OTHER

Reviewer(s): Grayson Fish

Date of Review: 9/19/2023

Date Reviewed by GW Mgr. and Returned to WRSD: 2/15/24

The information provided in the application is insufficient to evaluate whether the proposed transfer may be approved because:

- ☐ The water well reports provided with the application do not correspond to the water rights affected by the transfer.
- ☐ The application does not include water well reports or a description of the well construction details sufficient to establish the ground water body developed or proposed to be developed.
- ☐ Other \_\_\_\_\_

1. Basic description of the changes proposed in this transfer: **NOTE: The application forms identify "Well #4" as KLAM 59552, however, this well log does not match the provided T/R-S or mapped location of "Well #4". OWRD's GWIS correlates the applicant's mapped location of "Well #4" as KLAM 57552. Given the closeness of the Well Report ID number, it is likely that a scrivener's error occurred when filling out the transfer application. This groundwater transfer review assumes the correct Well Report ID for "Well #4" is KLAM 57552.**

The applicant proposes the following:

- POA and POU transfer of **Cert. 20707**: Transfer 90.01 acres of use associated with authorized POA Well #6 (**KLAM 12415**) as follows:
  - 30.29 acres to proposed POA **Hoefler Well (KLAM 12416)**
  - 59.72 acres to proposed POA **Well #4 (KLAM 57552)**
- POU transfer of **Cert. 22851**: Change the place of use of 112.74 acres.
- POA and POU transfer of **Cert. 27209**: Transfer 22.79 acres of use associated with authorized POA **Hoefler Well** as follows:
  - 14.51 acres change POU, POA remains **Hoefler Well**.

- 8.25 acres to proposed POA **Well #4**.
- POA and PU transfer of **Cert. 40185**: Transfer 30.77 acres of use associated with authorized POA Well #4 as follows:
  - 30.77 acres to proposed POA **Hoefler Well**.

The above proposed transfer will result in the following changes in total groundwater appropriation (rates are 1/80 of cfs per acre):

- **Well #6 (KLAM 12415)** = -90.01 acres and -1.125 cfs
  - **Hoefler Well (KLAM 12416)** = +52.01 acres and +0.66 cfs
  - **Well #4 (KLAM 57552)** = +37.20 acres and +0.465 cfs
2. Will the proposed POA develop the same aquifer (source) as the existing authorized POA?
   
☒ Yes   ☐ No   Comments: Despite the various completion depths of the wells affected by this transfer, the wells all appear to source water from the Tertiary volcanic rock and sediment aquifer and exhibit similar static water level elevations. Other wells in the area drilled to various depths also have similar static water level elevations suggesting a vertically-continuous aquifer system.
  3. a) Is there more than one source developed under the right (e.g., basalt and alluvium)?
   
☐ Yes   ☒ No N/A
  
b) If yes, estimate the portion of the right supplied by each of the sources and describe any limitations that will need to be placed on the proposed change (rate, duty, etc.): N/A
  4. a) Will this proposed change, at its maximum allowed rate of use, likely result in an increase in interference with **another ground water right**?
   
☒ Yes   ☐ No   Comments: The increased rates of appropriation from the Hoefler Well and Well #4 would likely result in an increase in interference with other POAs near those wells.
  
b) If yes, would this proposed change, at its maximum allowed rate of use, likely result in another groundwater right not receiving the water to which it is legally entitled?
   
☐ Yes   ☒ No   If yes, explain: A majority of the irrigation wells in the area report large well yields (1000 gpm or more) due to the high transmissivity of the aquifer system. The expected degree of interference resulting from this transfer is not likely to result in injury to existing water rights.
  5. a) Will this proposed change, at its maximum allowed rate of use, likely result in an increase in interference with **another surface water source**?
   
☐ Yes   ☒ No   Comments: While proposed POA Well #4 is closer to Buck Creek than authorized POA Well #6, however, the Hoefler Well is further from Buck Creek than Well #6 is. Considering that more use will be transferred to the Hoefler well than to Well #4, it is unlikely that this transfer will result in an increase in interference with Buck Creek.
  
b) If yes, at its maximum allowed rate of use, what is the expected change in degree of interference with any **surface water sources** resulting from the proposed change?

Stream: \_\_\_\_\_

☐ Minimal ☐ Significant

Stream: \_\_\_\_\_

☐ Minimal ☐ Significant

Provide context for minimal/significant impact: \_\_\_\_\_

6. For SW-GW transfers, will the proposed change in point of diversion affect the surface water source similarly (as per OAR 690-380-2130) to the authorized point of diversion specified in the water use subject to transfer?

☐ Yes ☐ No Comments: \_\_\_\_\_

7. What conditions or other changes in the application are necessary to address any potential issues identified above: \_\_\_\_\_

8. Any additional comments: \_\_\_\_\_

### Area Hydrographs

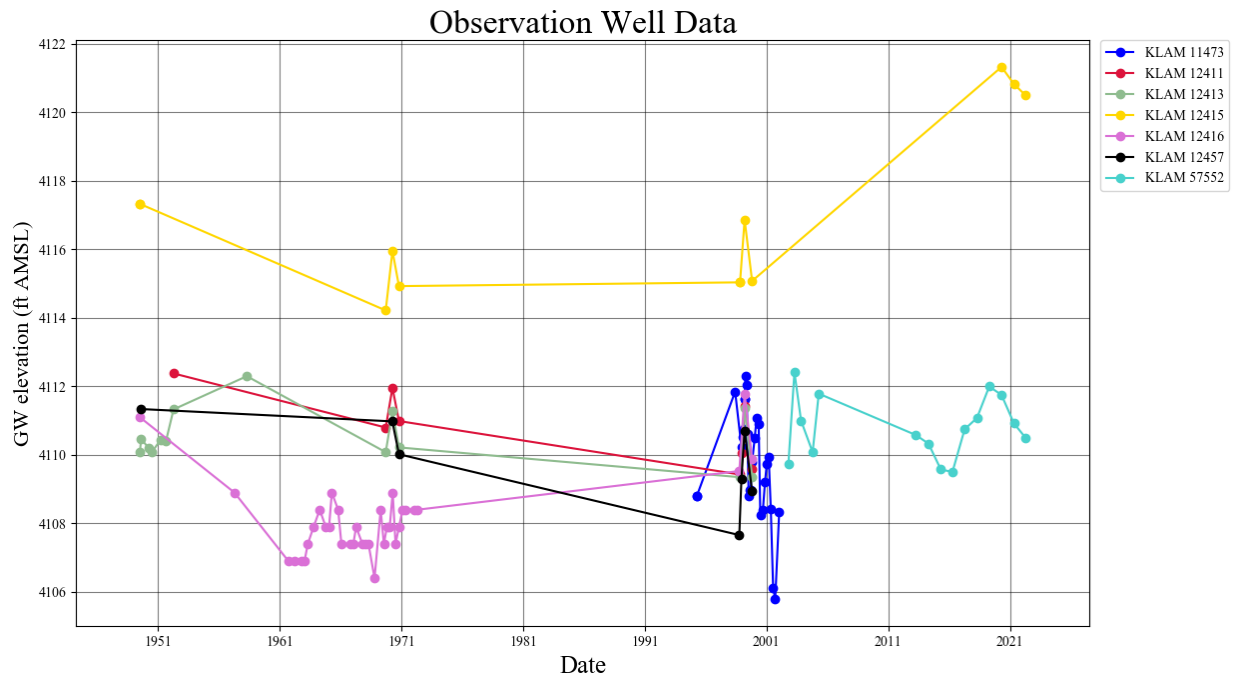

## Transfer Review Map

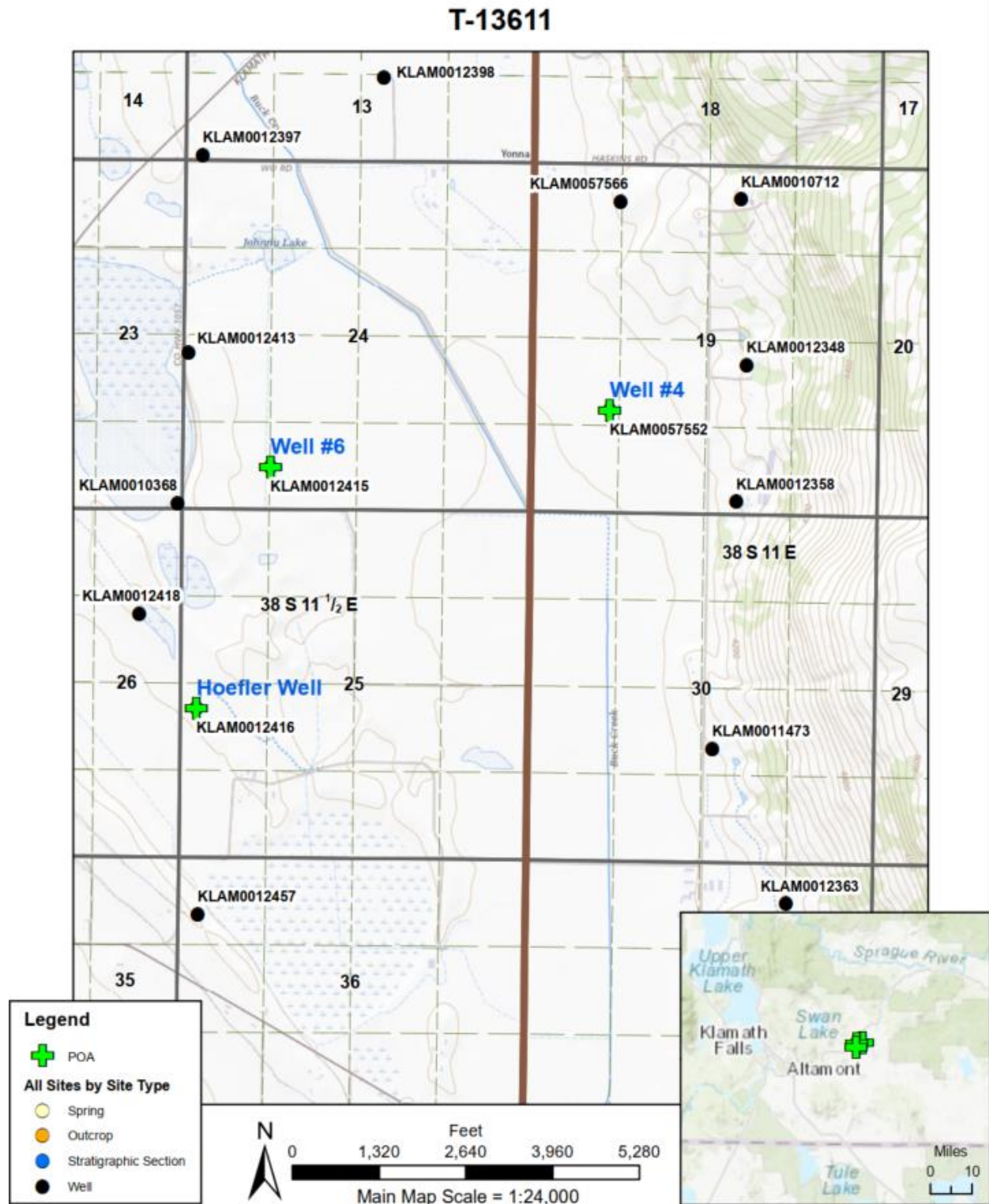

Service Layer Credits: Sources: Esri, HERE, Garmin, Intermap, increment P Corp., GEBCO, USGS, FAO, NPS, NRCAN, GeoBase, IGN, Kadaster NL, Ordnance Survey, Esri Japan, METI, Esri China (Hong Kong), (c) OpenStreetMap contributors, and the GIS User Community  
 USGS The National Map, National Boundaries Dataset, 3DEP Elevation Program, Geographic Names Information System, National Hydrography Dataset, National Land Cover Database, National Structures Dataset, and National Transportation Dataset; USGS Global Ecosystems; U.S. Census Bureau TIGER/Line data; USFS Road Data; Natural Earth Data; U.S. Department of State