

Application for Groundwater Registration Modification



Oregon Water Resources Department
725 Summer Street NE, Suite A
Salem, Oregon 97301-1266
(503) 986-0900
www.oregon.gov/OWRD

Part 1 of 5 – Minimum Requirements Checklist

This Groundwater Registration Modification application will be returned if Parts 1 through 4 and all required attachments are not completed and included.

For questions, please call (503) 986-0900, and ask for Transfer Section.

Check all included with this application (N/A = Not Applicable)

RECEIVED

MAR 04 2024

OWRD

- Part 1 – Completed Minimum Requirements Checklist.
- Part 2 – Completed Application Map Checklist.
- Part 3 – Completed Applicant Information and Signature.
- Part 4 – Completed Groundwater Registration Modification Application – Groundwater Registration Information. (Only one Groundwater registration per application, unless the Groundwater registrations to be modified are layered). **(See Attachment A - GR-951)**
- Completed Groundwater Registration Modification Application Map (Does not have to be prepared by a Certified Water Right Examiner). **(See Attachment B)**
- Groundwater registration modification fees – Amount enclosed: \$ 1,250. (\$875.00 for a place of use change only; \$1,250.00 for any other change or combination).

Attachments:

- N/A Request for Assignment Form and statutory fee. This form needs to be completed if the applicant owns the land to which the registration is appurtenant and is **not** the registration certificate holder of record. The Request for Assignment Form is available at <https://www.oregon.gov/OWRD/Forms/Pages/default.aspx>.
Assignment is not needed for any person or entity who can demonstrate authorization to request recognition of a modification (e.g. legal representative, power of attorney, agent, etc.) **or** the applicant is named on the certificate of registration, or has been assigned to the certificate of registration. **A Request for Assignment and statutory fee in the amount of \$120 are being submitted concurrently with this application.**
- N/A Oregon Water Resources Department’s Land Use Information Form with approval and signature (or signed land use form receipt stub) from each local land use authority in which water is to be diverted, conveyed, and/or used. Not required if water is to be diverted, conveyed, and/or used only on federal lands or if **all** of the following apply: a) a change in place of use only, b) no structural changes, c) the use of water is for irrigation only, and d) the use is located within an irrigation district or an exclusive farm use zone. **(See Attachment C)**
- N/A Water Well Report/Well Log for changes in point(s) of appropriation (well(s)) or additional point(s) of appropriation. **(See Attachment D)**

(For Staff Use Only)

WE ARE RETURNING YOUR APPLICATION FOR THE FOLLOWING REASON(S):

- | | |
|--|--|
| <input type="checkbox"/> Application fee not enclosed/insufficient | <input type="checkbox"/> Map not included or incomplete |
| <input type="checkbox"/> Land Use Form not enclosed or incomplete | <input type="checkbox"/> Assignment Form and fee not enclosed/insufficient |
| <input type="checkbox"/> Additional signature(s) required | <input type="checkbox"/> Part _____ is incomplete |

Other/Explanation _____

Staff: _____ 503- _____ Date: ____/____/____

14416 -

Part 2 of 4 – Groundwater Registration Modification Map Checklist

Your Groundwater Registration Modification application will be returned if any of the map requirements listed below are not met.

Please be sure that the map you submit includes all the items listed below and meets the requirements of OAR 690-380-3100, however, the map does not have to be prepared by a Certified Water Right Examiner. Check all boxes that apply.

RECEIVED

MAR 04 2024

OWRD

- Permanent quality printed with dark ink on good quality paper.
- The size of the map can be 8½ x 11 inches, 8½ x 14 inches, 11 x 17 inches, or up to 30 x 30 inches. For 30 x 30 inch maps, one extra copy is required.
- A north arrow, a legend, and scale.
- The scale of the map must be: 1 inch = 400 feet, 1 inch = 1,320 feet, the scale of the county assessor map if the scale is not smaller than 1 inch = 1,320 feet, or a scale that has been pre-approved by the Department.
- Township, Range, Section, ¼ ¼, DLC, Government Lot, and other recognized public land survey lines.
- Tax lot boundaries (property lines) are required. Tax lot numbers are recommended.
- Major physical features including rivers and creeks showing direction of flow, lakes and reservoirs, roads and railroads.
- Major water delivery system features from the point(s) of appropriation such as main pipelines, canals, and ditches.
- Existing place of use that includes hachuring, priority date, and use including number of acres in each quarter-quarter section, government lot, or in each quarter-quarter section as projected within government lots, donation land claims, or other recognized public land survey subdivisions. If less than the entirety of the registration is being changed, a separate hachuring is needed for the portion of the registration left unchanged.
- N/A If you are proposing a modification in place of use, show the proposed place of use with hachuring including priority date and use including number of acres in each quarter-quarter section, government lot, or in each quarter-quarter section as projected within government lots, donation land claims, or other recognized public land survey subdivisions.
- Existing point(s) of appropriation with distance and bearing or coordinates from a recognized survey corner.
- N/A If you are proposing a modification in point(s) of appropriation, show the proposed location and label it clearly with distance and bearing or coordinates. If GPS coordinates are used, latitude-longitude coordinates may be expressed as either degrees-minutes-seconds with at least one digit after the decimal (example – 42°32'15.5") or degrees-decimal with five or more digits after the decimal (example – 42.53764°).

Part 3 of 4 – Applicant Information and Signature

Applicant Information

APPLICANT/BUSINESS NAME Westwood Farms, Inc., Attn: John Coleman		PHONE NO. 503-633-2787	ADDITIONAL CONTACT NO.
ADDRESS PO Box 82		FAX NO.	
CITY St. Paul	STATE OR	ZIP 97137	E-MAIL john@wwfarms.org
<p align="center">BY PROVIDING AN E-MAIL ADDRESS, CONSENT IS GIVEN TO RECEIVE ALL CORRESPONDENCE FROM THE DEPARTMENT ELECTRONICALLY. COPIES OF THE FINAL ORDER DOCUMENTS WILL ALSO BE MAILED.</p>			

RECEIVED
MAR 04 2024
DOWRD

Agent Information – The agent is authorized to represent the applicant in all matters relating to this application

AGENT/BUSINESS NAME GSI Water Solutions, Inc., Attn: Zach Pike-Urlacher		PHONE NO. 541-753-0933	ADDITIONAL CONTACT NO.
ADDRESS 1600 SW Western Blvd, Suite 240		FAX NO.	
CITY Corvallis	STATE OR	ZIP 97333	E-MAIL zpikeurlacher@gsiws.com
<p align="center">BY PROVIDING AN E-MAIL ADDRESS, CONSENT IS GIVEN TO RECEIVE ALL CORRESPONDENCE FROM THE DEPARTMENT ELECTRONICALLY. COPIES OF THE FINAL ORDER DOCUMENTS WILL ALSO BE MAILED.</p>			

Explain in your own words what you propose to accomplish with this modification; and why:
The Applicant is proposing to add Well 2 (MARI 4811) as a point of appropriation to a portion of GR-951.

If you need additional space, continue on a separate piece of paper and attach to the application as "Attachment 1".

Check this box if this project is fully or partially funded by the American Recovery and Reinvestment Act. (Federal stimulus dollars)

(Check one box)

- By signing this application, I (we) understand that, upon receipt of the draft preliminary determination and prior to Department approval of the Groundwater modification, I (we) will be required to provide landownership information and evidence that I am authorized to pursue the modification as identified in OAR 690-382-0400(16)(a); **OR**
- I (we) affirm the applicant is a municipality as defined in ORS 540.510(3)(b) and that the right is in the name of the municipality or a predecessor; **OR**
- I (we) affirm that the applicant is an entity with the authority to condemn property and is acquiring the property to which the Groundwater registration proposed for modification is appurtenant by condemnation and have attached supporting documentation.

I understand that prior to Department approval of the groundwater registration modification, I may be required to submit payment to the Department for publication of a notice in a newspaper with general circulation in the area where the groundwater registration is located, once per week for two consecutive weeks. If more than one qualifying newspaper is available, I suggest publishing the notice in the following paper: Statesman Journal.

I (we) affirm that the information contained in this application is true and accurate.

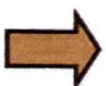

John Coleman
Applicant Signature

John Coleman, Owner
Print Name (and Title if applicable)

2/24/2024
Date

Is the applicant the sole owner of the land on which the Groundwater registration modification or portion thereof, is located? Yes No *If NO, include signatures of all deeded landowners (and mailing and/or e-mail addresses if different than the applicant's) or attach affidavits of consent (and mailing and/or e-mail addresses) from all landowners or individuals/entities to which the Groundwater registration has been conveyed.*

Check the appropriate box, if applicable:

- Check here if the Groundwater registration proposed for modification is or will be located within or served by an irrigation or other water district.

IRRIGATION DISTRICT NAME N/A	ADDRESS	
CITY	STATE	ZIP

- Check here if water for the Groundwater registration is supplied under a water service agreement or other contract with a federal agency or other entity.

ENTITY NAME N/A	ADDRESS	
CITY	STATE	ZIP

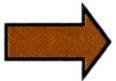

To meet State Land Use Consistency Requirements, you must list all local governments (each county, city, municipal corporation, or tribal government) within whose jurisdiction water will be diverted, conveyed or used.

ENTITY NAME Marion County Planning	ADDRESS 5155 Silvertown Rd NE	
CITY Salem	STATE OR	ZIP 97305

ENTITY NAME	ADDRESS	
CITY	STATE	ZIP

RECEIVED
MAR 04 2024
OWRD

Part 4 of 4 – Groundwater Registration Information

Please use a separate Part 4 for each registration being modified. See instructions on page 5, to copy and paste additional Part 4s, or to add additional rows to tables within the form.

Groundwater Registration # GR-951 (Certificate # GR-923)

Table 1. Location of Authorized and Proposed Point(s) of Appropriation (POA)

(Note: If the POA name is not specified in the registration, assign it a name or number here.)

POA Name or Number	Is this POA Authorized by the registration or is it Proposed?	OWRD Well Log ID# (or Well ID Tag # L-___)	Twp		Rng		Sec	¼ ¼		Tax Lot, DLC or Gov't Lot	Measured Distances (from a recognized survey corner)
Well 1	<input checked="" type="checkbox"/> Authorized <input type="checkbox"/> Proposed	MARI 4799	6	S	3	W	2	SW	SW	Garrison DLC 37	425 feet North and 5,000 feet West from SE corner, Section 2
Well 2	<input type="checkbox"/> Authorized <input checked="" type="checkbox"/> Proposed	MARI 4811	6	S	3	W	3	SE	SE	Garrison DLC 37	1,140 feet South and 1,570 feet West from the NW corner of DLC 38

Check all type(s) of modifications(s) proposed below (modification "CODES" are provided in parentheses):

- | | |
|---|--|
| <input type="checkbox"/> Place of Use (POU) | <input type="checkbox"/> Point of Appropriation (well) (POA) |
| <input type="checkbox"/> Character of Use (USE) | <input checked="" type="checkbox"/> Additional Point of Appropriation (APOA) |

Will all of the proposed changes affect the entire Groundwater registration?

- Yes Complete only the proposed ("to" lands) section of Table 2 on the next page. Use the "CODES" listed above to describe the proposed changes.
- No Complete all of Table 2 to describe the portion of the registration to be changed.

RECEIVED
MAR 04 2024
OWRD

Please use and attach additional pages of Table 2 as needed.
See page 5 for instructions.

Do you have questions about how to fill-out the tables?
Contact the Department at 503-986-0900 and ask for Transfer

Table 2. Description of Modifications to Registration GR-951 (Certificate # GR-923)

List only the part of the registration that will be modified. For the acreage in each ¼ ¼, list the modification proposed. If more than one modification, specify the acreage associated with each modification. If more than one POA, specify the acreage associated with each POA.

AUTHORIZED (the "from" or "off" lands) The listing that appears in the registration BEFORE PROPOSED CHANGES List only that part or portion of the groundwater registration that will be changed.													Proposed Changes (see "CODES" from previous page)	PROPOSED (the "to" or "on" lands) The listing as it would appear AFTER PROPOSED CHANGES are made.												
Twp	Rng	Sec	¼	¼	Tax Lot	Gvt Lot or DLC	Acres	Type of USE listed on Certificate	POA(s) (name or number from Table 1)	Priority Date	Twp	Rng		Sec	¼	¼	Tax Lot	Gvt Lot or DLC	Acres	New Type of USE	POA(s) to be used (from Table 1)	Priority Date				
EXAMPLE																										
2	S	9	E	15	NE	NW	100		15.0	Irrigation	POD #1 POD #2	1901	POU/POD	2	S	9	E	1	NW	NW	500	1	10.0		POD #5	1901
"	"	"	"	"	"	"	"	"	"	EXAMPLE	"	"	"	2	S	9	E	2	SW	NW	500		5.0		POD #6	1901
6	S	3	W	2	SW	SW	600	DLC 37	2.05	Irrigation	Well 1	September 1949	APOA	6	S	3	W	2	SW	SW	600	DLC 37	2.05	Irrigation	Well 1, Well 2	September 1949
6	S	3	W	3	SE	SE	600	DLC 37	12.20	Irrigation	Well 1	September 1949	APOA	6	S	3	W	3	SE	SE	600	DLC 37	12.20	Irrigation	Well 1, Well 2	September 1949
TOTAL ACRES									14.25	TOTAL ACRES										14.25						

Additional remarks: _____.

RECEIVED
MAR 04 2024
OWRD

Groundwater Registration # GR-951 (Certificate # GR-923)

For a modification in place of use or character of use: N/A

Are there other water right certificates, water use permits, or Groundwater registrations associated with the “from” or “to” lands? Yes No

If YES, list the other certificate, water use permit, or other Groundwater registration numbers:
N/A



Pursuant to OAR 690-382-0200, any “layered” water use, such as an irrigation right that is supplemental to a primary irrigation right proposed for transfer, must be concurrently transferred with the registration or be cancelled. Any change to a water right must be filed separately in a transfer application. Any change to a water use permit must be filed separately with a permit amendment. Any modification to a Groundwater registration on the “to” lands must be filed separately with a Groundwater registration modification.

For modifications in point(s) of appropriation (well(s) or additional point(s) of appropriation:

- Well log(s) are attached for each well that are clearly labeled and associated with the corresponding well(s) in Table 1 above and on the accompanying application map.
Well Logs are included in Attachment D.

AND/OR

- Describe the construction of the authorized and proposed well(s) in Table 3 for any wells that do not have a well log. For *proposed wells not yet constructed or built*, provide “a best estimate” for each requested information element in the table. The Department recommends you consult a licensed well driller, geologist, or certified water right examiner to assist with assembling the information necessary to complete Table 3.

Table 3. Construction of Point(s) of Appropriation

Any well(s) in this listing must be clearly tied to corresponding well(s) described in Table 1 and shown on the accompanying application map. Failure to provide adequate information is likely to delay the processing of your modification application until it is received. The information is necessary for the department to assess whether the proposed well(s) will access the same source aquifer as the authorized point(s) of appropriation (POA). The Department is prohibited by law from approving POA changes that do not access the same source aquifer.

Proposed or Authorized POA Name or Number	Is well already built? (Yes or No)	If an existing well, OWRD Well ID Tag No. L-___	Total well depth	Casing Diameter	Casing Intervals (feet)	Seal depth(s) (intervals)	Perforated or screened intervals (in feet)	Static water level of completed well (in feet)	Source aquifer (sand, gravel, basalt, etc.)	Well - specific rate (cfs or gpm). If less than full rate of water right

RECEIVED

MAR 04 2024

OWRD

14416 -

RECEIVED

MAR 04 2024

OWRD

Attachment A

GR-951

Application for a Groundwater Registration Modification
Westwood Farms, Inc.

14416 -

Registration No. GR - 951

RECEIVED

Certificate No. GR - 923

MAR 04 2024

Registration Statement

OWRD

OF CLAIMANT OF RIGHT TO APPROPRIATE GROUND WATER

TO THE STATE ENGINEER OF OREGON:

I, Paul Townsend
 of Home Rd, Oregon County of Wasco
(Mailing address)
 State of Oregon, do hereby make application for a certificate of registration as evidence of a right to appropriate ground water.

1. Source from which water is withdrawn is Pond Well
(Flowing well, pump well, infiltration trench, or tunnel)

2. Location is: 10 miles N of Seaside
(Approximate distance and direction from nearest city or town)

and is more particularly described as follows:

(a) 5000' W & 425' N from SE corner Section 2
(Give distance and bearing to corner of section or other legal subdivision)
 being within SW 1/4 SW 1/4 of Sec. 2, Twp. 6S, Rge. 3W
(Smallest legal subdivision) (N. or S.) (E. or W.)

or (b) within limits of recorded platted property, town or city:
 in Lot _____, Block _____ of _____
(Name of plat or addition)

County of _____
(If within city or town, give name)

3. Construction Work was begun on Sept 1949; was completed on Nov 1949
(Date) (Date)

and the ground water claimed was first used for the purposes set out below on May 1950
(Date)

since which time the water has been used Continuously
(Continuously or intermittently)

from May to Oct
(Date) (Date)

4. Quantity of water claimed and used is 8400 gallons per minute; 90 acre feet per year.

5. Purpose or Purposes for which water is used Industrial
(Domestic, irrigation, municipal, manufacturing, industrial, etc.)

6. Description of Well: Depth 63 feet. Type Hand
(Dug or drilled)
 diameter 10 inches. Elevation of ground at well site 117 feet, mean sea level.
(As near as known)

Depth to water table 30 feet.

7. Capacity of Well: 900 g.p.m. with 15 feet drawdown.
 _____ g.p.m. with _____ feet drawdown.

Date of test Feb 12 1949

If Flowing Well: Measured discharge 800 g.p.m. on Feb 12 1949
(Date)

Shut-in pressure at ground surface 75 lbs. per sq. in. on Feb 12 1949
(Date)

Water is controlled by Hand
(Cap, valve, etc.)

RECEIVED

MAR 04 2024

OWRD

If log of well is not available, give name and address of driller. J.A. Arnold & Sons

Salem, Oregon

11. Infiltration Trench: Covered or open Covered

Dimensions: Length 63 ft. Minimum depth _____ ft. Maximum depth _____ ft.

Bottom width _____ ft. Discharge _____ g.p.m. Date of test _____

12. Tunnel: Type of lining _____

Dimensions: _____
(Length, course, and cross sectional size)

Position of water bearing stratum with reference to portal of tunnel _____

Log of tunnel: (Preceding table for log of well may be used, if desired. Give footage from portal and character of materials, as pertinent.)

13. Pumping Equipment:

(a) Pump Whisper Co. B 40 HP Capacity 800 g.p.m.
(Make, type and size)

(b) Motor _____
(Type and horsepower)

14. Location of area irrigated or to be irrigated, or place of use if for purposes other than irrigation.

Township North or South	Range E. or W. of Willamette Meridian	Section	Forty-acre Tract	Number Acres To Be Irrigated	Date of Reclamation
6S	3W	2	SW $\frac{1}{4}$ SW $\frac{1}{4}$	26	May 1950
"	"	2	SE $\frac{1}{4}$ SW $\frac{1}{4}$	3	"
"	"	3	SE $\frac{1}{4}$ SE $\frac{1}{4}$	18	"
"	"	10	NE $\frac{1}{4}$ NE $\frac{1}{4}$	6	"
"	"	11	NW $\frac{1}{4}$ NW $\frac{1}{4}$	17	"
				Add <u>70</u>	

15. If the ground water supply is supplemental to an existing water supply, identification of any application for a permit, permit, certificate or adjudicated right to appropriate water made or held by the registrant.

RECEIVED
MAR 04 2024
OWRD

Township 65 Range 3 W, W.M.
North

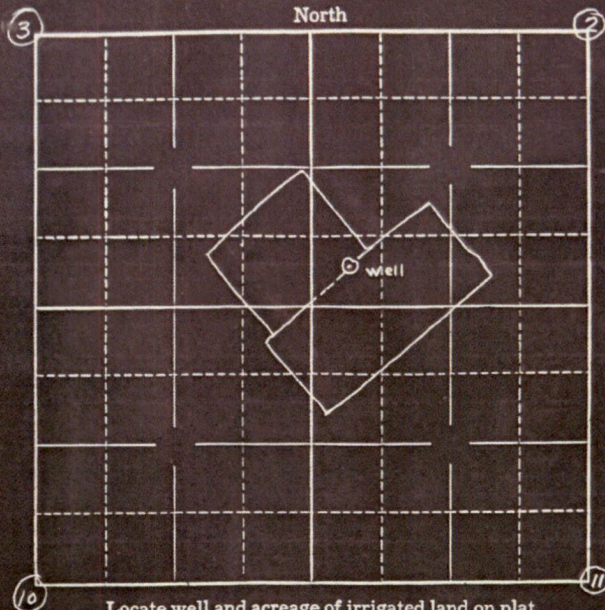

Locate well and acreage of irrigated land on plat.

Scale: 2" = 1 Mile
4

STATE OF OREGON

County of

Marion

} ss.

I, _____, being first duly sworn, do hereby certify that I have read the foregoing Registration Statement and that all of the items therein contained are true to the best of my knowledge and belief.

Paul Jounseul
(Signature of Registrant)

Subscribed and sworn to before me this *30th* day of *January*, 19*58*.

My commission expires *12th June 1961*

Wm. S. Baitholmeu
(Notary Public)

(SEAL)

CERTIFICATE OF REGISTRATION

STATE OF OREGON

County of Marion

} ss.

This is to certify that the foregoing Registration Statement was received in the office of the State Engineer on the *30* day of *January*, 19*58*, at *10:00* o'clock *A.M.* and has been duly recorded in said office in Book No. *5* of Registration Statements on page *923*.

Witness my hand this *7* day of *May*, 19*58*

Lewis A. Stanley
(State Engineer)

By

(Deputy)

GR - 923 C

RECEIVED

MAR 04 2024

OWRD

Attachment B

Application Map

Application for a Groundwater Registration Modification
Westwood Farms, Inc.

14416 -

Attachment C

Land Use Information Form

Application for a Groundwater Registration Modification
Westwood Farms, Inc.

14416 -

RECEIVED

MAR 04 2024

OWRD

Land Use Information Form



Oregon Water Resources Department
725 Summer Street NE, Suite A
Salem, Oregon 97301-1266
(503) 986-0900
www.oregon.gov/OWRD

NOTE TO APPLICANTS

In order for your application to be processed by the Oregon Water Resources Department (OWRD), this Land Use Information Form must be completed by a local government planning official in the jurisdiction(s) where your water right will be diverted, conveyed, used, and developed. The planning official may choose to complete the form while you wait or return the "Receipt Acknowledging Request for Land Use Information" to you. Applications received by OWRD without the Land Use Information Form, or the signed receipt, will be returned to you. **IMPORTANT:** Please note that while OWRD can accept a signed receipt as part of intake for an application for a new permit to use or store water, a completed Land Use Information Form is required for OWRD's acceptance of all other applications. Please be aware that your application cannot be approved without land use approval.

This form is **NOT** required if:

- 1) Water is to be diverted, conveyed, and used on federal lands only; **OR**
- 2) The application is for a water right transfer, allocation of conserved water, exchange, permit amendment, or ground water registration modification, and **all** of the following apply:
 - a. The existing and proposed water use is located entirely within lands zoned for exclusive farm-use or within an irrigation district;
 - b. The application involves a change in place of use only;
 - c. The change does not involve the placement or modification of structures, including but not limited to water diversion, impoundment, distribution facilities, water wells and well houses; **and**
 - d. The application involves irrigation water uses only.

NOTE TO LOCAL GOVERNMENTS

The person presenting the attached Land Use Information Form is applying for a new water right or modifying an existing water right. The Oregon Water Resources Department (OWRD) requires applicants to obtain land use information to ensure the water right does not result in land uses that are incompatible with your comprehensive plan. Please complete the form and return it to the applicant for inclusion in their application. **NOTE:** For new water right applications only, if you are unable to complete this form while the applicant waits, you may complete the "Receipt Acknowledging Request for Land Use Information" and return it to the applicant.

You will receive notice via OWRD's weekly Public Notice once the applicant formally submits their request to OWRD. The notice will give more information about OWRD's water right process and provide additional comment opportunities. If you previously only completed the receipt for an application for a new permit to use or store water, you will have 30 days from the Public Notice date to complete the Land Use Information Form and return it to OWRD. Your attention to this request for information is greatly appreciated. If you have questions concerning this form, please contact OWRD's Customer Service Group at 503-986-0900 or WRD_DL_customerservice@water.oregon.gov.

RECEIVED
MAR 04 2024
OWRD

14416 -

Land Use Information Form



Oregon Water Resources Department
 725 Summer Street NE, Suite A
 Salem, Oregon 97301-1266
 (503) 986-0900
 www.oregon.gov/OWRD

NAME Westwood Farms, Inc., Attn: John Coleman				PHONE 503-633-2787	
MAILING ADDRESS PO Box 82					
CITY St. Paul		STATE OR	ZIP 97137	EMAIL john@wwfarms.org	

A. Land and Location

Please include the following information for all tax lots where water will be diverted (taken from its source), conveyed (transported), and/or used or developed. Applicants for municipal use, or irrigation uses within irrigation districts, may substitute existing and proposed service-area boundaries for the tax-lot information requested below.

Township	Range	Section	¼ ¼	Tax Lot #	Plan Designation (e.g., Rural Residential/RR-5)	Water to be:	Proposed Land Use:
6S	3W	2	SWSW	600	EFU	<input type="checkbox"/> Diverted <input type="checkbox"/> Conveyed <input checked="" type="checkbox"/> Used	Irrigation
6S	3W	3	SESE	600	EFU	<input checked="" type="checkbox"/> Diverted <input checked="" type="checkbox"/> Conveyed <input checked="" type="checkbox"/> Used	Irrigation

List all counties and cities where water is proposed to be diverted, conveyed, and/or used or developed:

Marion County

NOTE: A separate Land Use Information Form must be completed and submitted for each county and city, as applicable.

B. Description of Proposed Use

Type of application to be filed with the Oregon Water Resources Department:

- Permit to Use or Store Water
 Water Right Transfer
 Permit Amendment or **Ground Water Registration Modification**
 Limited Water Use License
 Exchange of Water
 Allocation of Conserved Water

Source of water: Reservoir/Pond Ground Water Surface Water (name) _____

Estimated quantity of water needed: **0.38** cubic feet per second gallons per minute acre-feet

Intended use of water: Irrigation Commercial Industrial Domestic for _____ household(s)
 Municipal Quasi-Municipal Instream Other _____

Briefly describe:

The Applicant is proposing to add an existing well (Well 2) as an additional point of appropriation to a portion of Groundwater Registration 951.

Note to applicant: For new water right applications only, if the Land Use Information Form cannot be completed while you wait, please have a local government representative sign the receipt on the bottom of page 4 and include it with the application filed with the Oregon Water Resources Department.

See Page 4 →

RECEIVED

MAR 04 2024

OWRD

For Local Government Use Only

The following section must be completed by a planning official from each county and city listed unless the project will be located entirely within the city limits. In that case, only the city planning agency must complete this form. This deals only with the local land use plan. Do not include approval for activities such as building or grading permits.

Please check the appropriate box below and provide the requested information

- Land uses to be served by the proposed water use(s), including proposed construction, are allowed outright or are not regulated by your comprehensive plan. Cite applicable ordinance section(s): 17.136.020 (A) Farm Use
- Land uses to be served by the proposed water use(s), including proposed construction, involve discretionary land-use approvals as listed in the table below. (Please attach documentation of applicable land-use approvals which have already been obtained. Record of Action/land-use decision and accompanying findings are sufficient.) **If approvals have been obtained but all appeal periods have not ended, check "Being Pursued."**

Type of Land-Use Approval Needed (e.g., plan amendments, rezones, conditional-use permits, etc.)	Cite Most Significant, Applicable Plan Policies & Ordinance Section References	Land-Use Approval:
		<input type="checkbox"/> Obtained <input type="checkbox"/> Being Pursued <input type="checkbox"/> Denied <input type="checkbox"/> Not Being Pursued
		<input type="checkbox"/> Obtained <input type="checkbox"/> Being Pursued <input type="checkbox"/> Denied <input type="checkbox"/> Not Being Pursued
		<input type="checkbox"/> Obtained <input type="checkbox"/> Being Pursued <input type="checkbox"/> Denied <input type="checkbox"/> Not Being Pursued
		<input type="checkbox"/> Obtained <input type="checkbox"/> Being Pursued <input type="checkbox"/> Denied <input type="checkbox"/> Not Being Pursued

Local governments are invited to express special land use concerns or make recommendations to the Oregon Water Resources Department regarding this proposed use of water in the box below or on a separate sheet.

RECEIVED
MAR 04 2024

Name: John Speckman Title: Assistant Planner

Signature: *John Speckman* Date: 2-22-2024

Governmental Entity: Marion County Planning Phone: 503-588-5038

OWRD

Receipt Acknowledging Request for Land Use Information	
<p>Note to Local Government Representative: Please complete this form and return it to the applicant. For new water right applications only, if you are unable to complete this form while the applicant waits, you may complete this receipt and return it to the applicant. If you sign the receipt, you will have 30 days from the date of OWRD's Public Notice of the application to submit the completed Land Use Information Form to Oregon Water Resources Department. Please note while OWRD can accept a signed receipt as part of intake for an application for a new permit to use or store water, a completed Land Use Information Form is required for all other applications.</p>	
Applicant Name: _____	
Staff Name: _____	Title: _____
Staff Signature: _____	Date: _____
Governmental Entity: _____	Phone: _____

RECEIVED
MAR 04 2024
OWRD

RECEIVED
MAR 04 2024
OWRD

Well Name	Well Log
Well 1	MARI 4799
Well 2	MARI 4811

Attachment D

Well Logs

Application for a Groundwater Registration Modification
Westwood Farms, Inc.

STATE ENGINEER
Salem, Oregon

4799
MARI...

Well Record

STATE WELL NO. 6/3W-2N
COUNTY Marion
APPLICATION NO. Gr-951

OWNER: Paul Townsend

MAILING ADDRESS: Rt. 1

LOCATION OF WELL: Owner's No.

CITY AND STATE: Gervais, Oregon

SW 1/4 SW 1/4 Sec. 2 T. 6 S., R. 2 W., W.M.

Bearing and distance from section or subdivision corner 5000' W. & 425' N. from SE cor. of sec. 2.

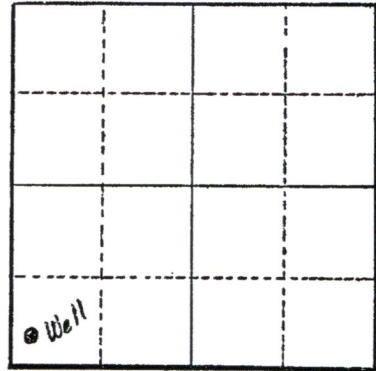

Altitude at well 117 ft.

TYPE OF WELL: Drilled Date Constructed 1949

Depth drilled 63 ft. Depth cased

Section 2

CASING RECORD:

10 inch

FINISH:

AQUIFERS:

WATER LEVEL:

20 ft. (9- -49)

PUMPING EQUIPMENT: Type Cook turbine

H.P. 40

Capacity 800 G.P.M.

WELL TESTS:

Drawdown 15 ft. after 900 hours G.P.M.

Drawdown ft. after hours G.P.M.

USE OF WATER Irrigation

Temp. °F. 19

SOURCE OF INFORMATION G.R. Record

DRILLER or DIGGER J. A. Sneed & Son

ADDITIONAL DATA:

Log Water Level Measurements Chemical Analysis Aquifer Test

REMARKS:

Irrigation of 70 acres.

RECEIVED

MAR 04 2024

OWRD

MAR 4 8 11

NOTICE TO WATER WELL CONTRACTOR
The original and first copy of this report are to be filed with the STATE ENGINEER, SALEM, OREGON 97310 within 30 days from the date of well completion.

RECEIVED
MAY 10 1967
STATE ENGINEER
WATER WELL REPORT
STATE OF OREGON
(Please type or print)
G-4263

State Well No. 6/3W-3R
State Permit No. _____

(1) OWNER: VERMONT OREGON
Name VERN HANDCOCK % FLAVORLAND FARMS
Address RT. 1, BOX 63A
BROOKS, OREGON 97305

(2) LOCATION OF WELL:
County MARION Driller's well number I206
1/4 1/4 Section T. R. W.M.
Bearing and distance from section or subdivision corner
SEC. 2-3-10-II T-6-R3W

(3) TYPE OF WORK (check):
Well Deepening Reconditioning Abandon
andonment, describe material and procedure in Item 12.

(4) PROPOSED USE (check): Domestic Industrial Municipal Irrigation Test Well Other
(5) TYPE OF WELL: Rotary Cable Dug Driven Jetted Bored

(6) CASING INSTALLED: Threaded Welded
" Diam. from _____ ft. to _____ ft. Gage _____
10 " Diam. from TOP ft. to 60 ft. Gage 250
" Diam. from _____ ft. to _____ ft. Gage _____

(7) PERFORATIONS: Perforated? Yes No
Type of perforator used MILLS
Size of perforations 2 in. by 3/8 in.
330 perforations from 30 ft. to 59 ft.
_____ perforations from _____ ft. to _____ ft.
_____ perforations from _____ ft. to _____ ft.
_____ perforations from _____ ft. to _____ ft.
_____ perforations from _____ ft. to _____ ft.

(8) SCREENS: Well screen installed? Yes No
Manufacturer's Name _____ Model No. _____
_____ Slot size _____ Set from _____ ft. to _____ ft.
Diam. _____ Slot size _____ Set from _____ ft. to _____ ft.

(9) CONSTRUCTION:
Well seal—Material used in seal CEMENT & PUDDLE CLAY
Depth of seal 20 ft. Was a packer used? _____
Diameter of well bore to bottom of seal 12 in.
Were any loose strata cemented off? Yes No Depth _____
Was a drive shoe used? Yes No
Was well gravel packed? Yes No Size of gravel: _____
Gravel placed from _____ ft. to _____ ft.
Did any strata contain unusable water? Yes No
Type of water? _____ depth of strata _____
Method of sealing strata off _____

(10) WATER LEVELS:
Static level 20 ft. below land surface Date 4/12/67
Artesian pressure _____ lbs. per square inch Date _____

(11) WELL TESTS: Drawdown is amount water level is lowered below static level
Was a pump test made? Yes No If yes, by whom? DRILLER
Yield: 500 gal./min. with 5 ft. drawdown after 4 hrs.
" 400 " " 3 " " 4 "
" 330 " " 2 " " 4 "
Bailer test gal./min. with _____ ft. drawdown after _____ hrs.
Artesian flow _____ g.p.m. Date _____
Temperature of water _____ Was a chemical analysis made? Yes No

(12) WELL LOG: Diameter of well below casing _____
Depth drilled 60 ft. Depth of completed well 60 ft.
Formation: Describe by color, character, size of material and structure, and show thickness of aquifers and the kind and nature of the material in each stratum penetrated, with at least one entry for each change of formation.

MATERIAL	FROM	TO
TOP SOIL	0	2
BROWN SANDY SILT	2	30
BROWN SAND & GRAVEL	30	60

RECEIVED

MAR 04 2024

OWRD

Work started APRIL 10 1967 completed APRIL 12 1967
Date well drilling machine moved off of well APRIL 12 1967

(13) PUMP:
Manufacturer's Name _____ Type: _____ H.P. _____
Water Well Contractor's Certification:

This well was drilled under my jurisdiction and this report is true to the best of my knowledge and belief.
NAME WILLAMETTE DRILLING CO (Type or print)
Address RT. 2 BOX 276 SALEM, OREGON 97303
Drilling Machine Operator's License No. I51
[Signed] Emil O. Beier (Water Well Contractor)
Contractor's License No. 2 Date APRIL 12 1967